

# PRIME DESIGN™

A Safe Fleet Brand

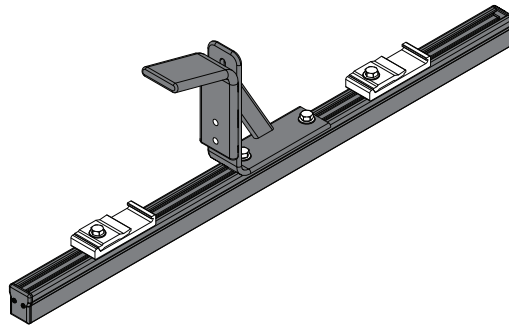
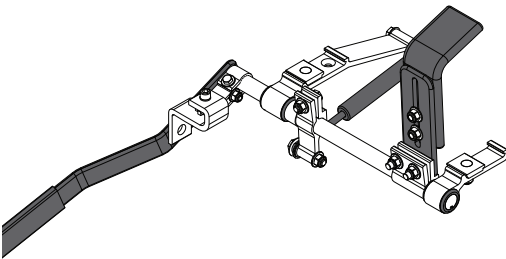

PRIME DESIGN, A SAFE FLEET BRAND

Address: 580 Opperman Drive, Eagan, MN 55123 • Toll Free: 1.8.PRIME.RACK  
Fax: 651-552-1799 • Email: [info@primedesign.net](mailto:info@primedesign.net) • Website: [www.primedesign.net](http://www.primedesign.net)

# ACX

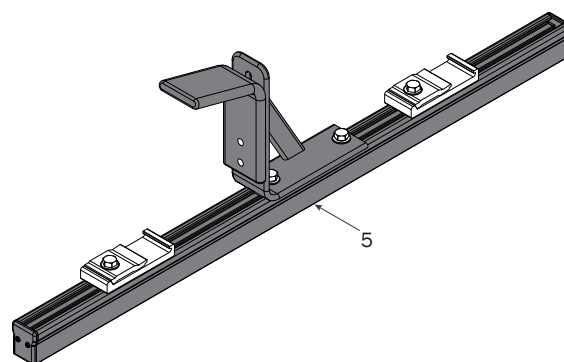
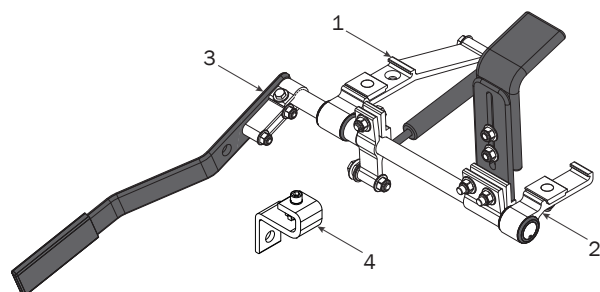

1—Quick Clamp Assembly .....Qty 1)  
Left Hand, Rear, w/Handle

2—Rear Clamp Support Assembly..... (Qty 1)  
AluRack

3—Clamp Down Handle Assembly ..... (Qty 1)  
Left Hand, 14.00", Bent w/Hardware

4—Lock Bracket Assembly..... (Qty 1)  
AluRack, w/Hardware

5—Quick Clamp Front Hook Assembly ..... (Qty 1)  
AluRack, Adjustable

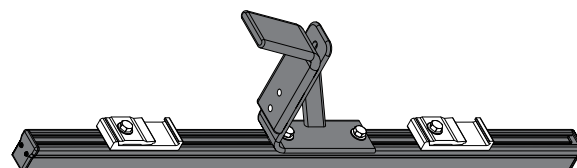
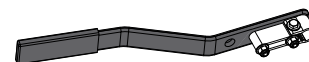
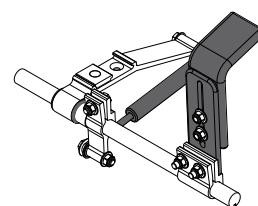

## RIGHT ACX ASSEMBLY SEQUENCE



This ACX Left Hand Quick Clamp Assembly is shown installed onto a Prime Design AluRack for illustrative purposes only.

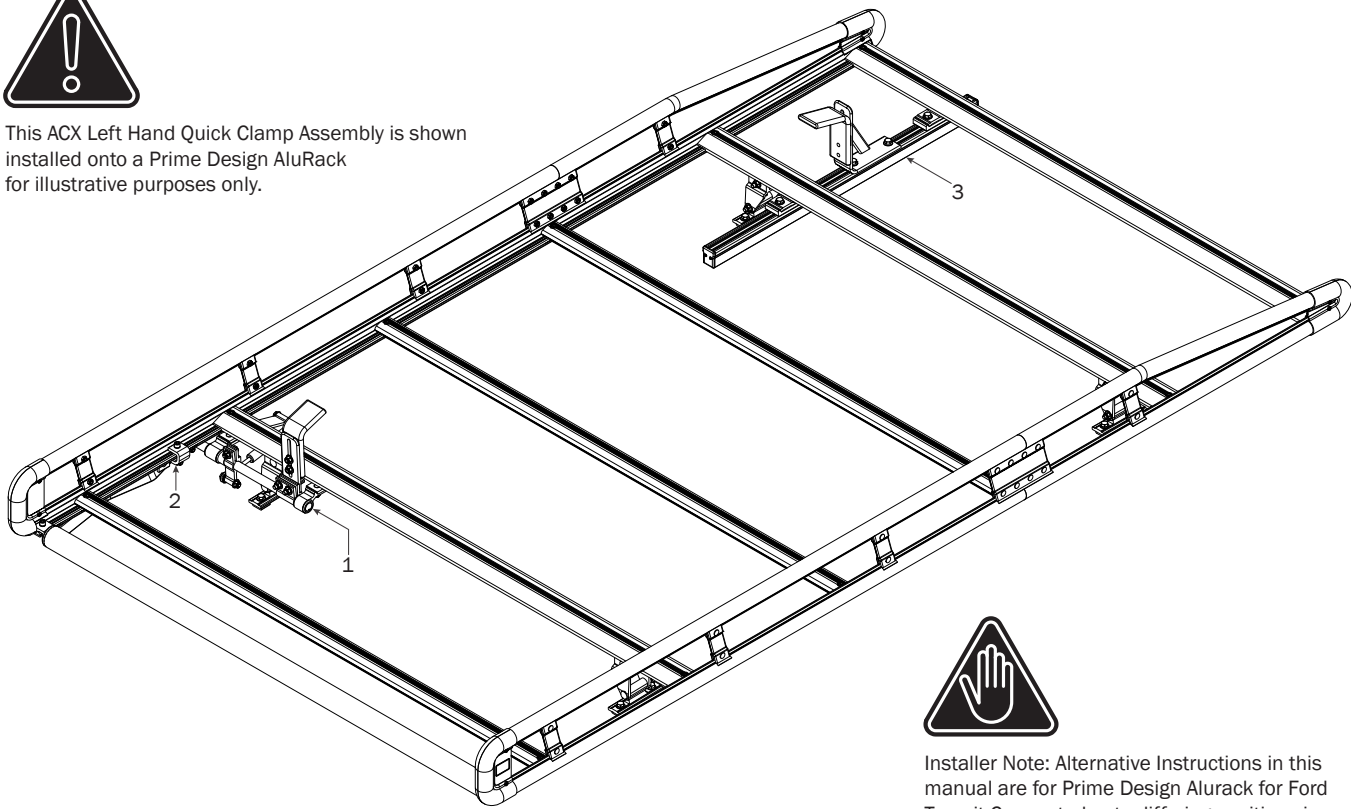

Installer Note: Alternative Instructions in this manual are for Prime Design Alurack for Ford Transit Connect, due to differing positions in Channel Mounts.

## REAR QUICK CLAMP

SEE QUICK START GUIDE FOR ADJUSTMENTS

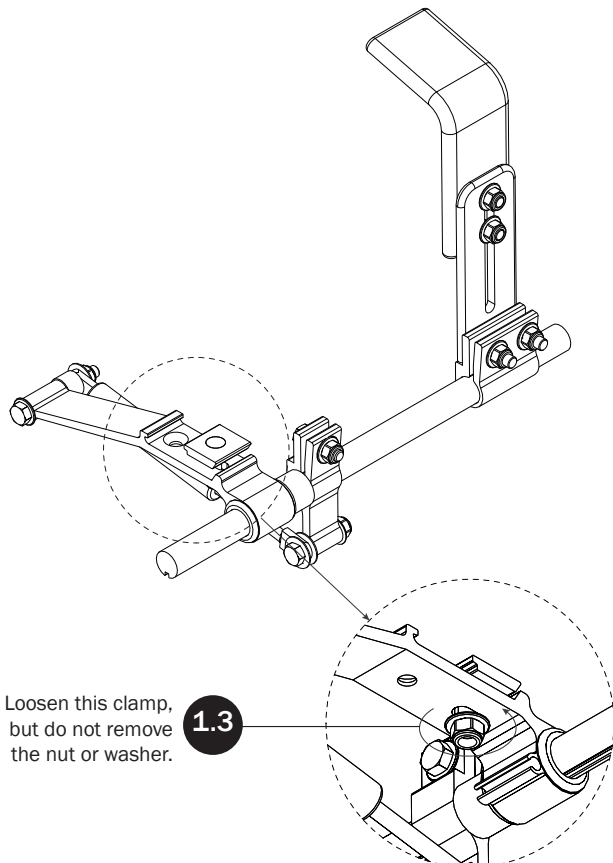
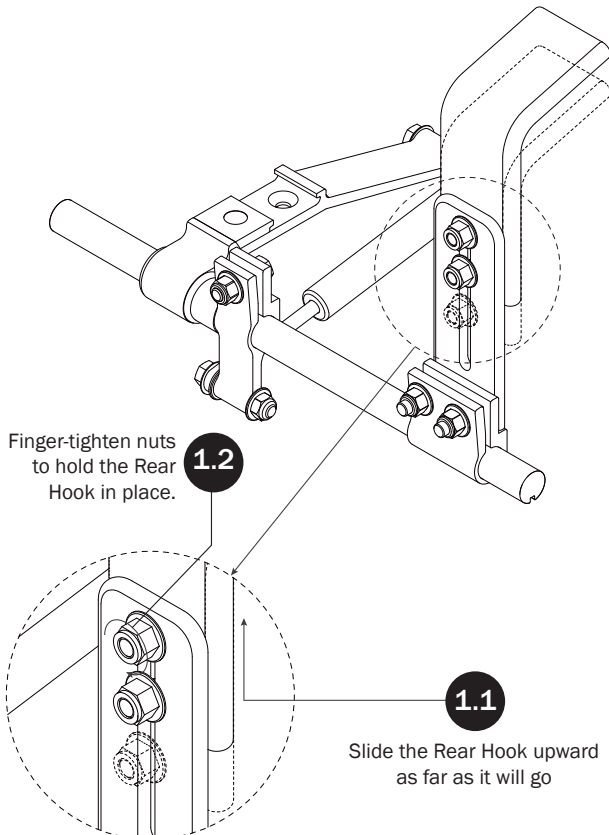

1.4

Position the Clamp into the bottom groove on the AluRack Crossbar

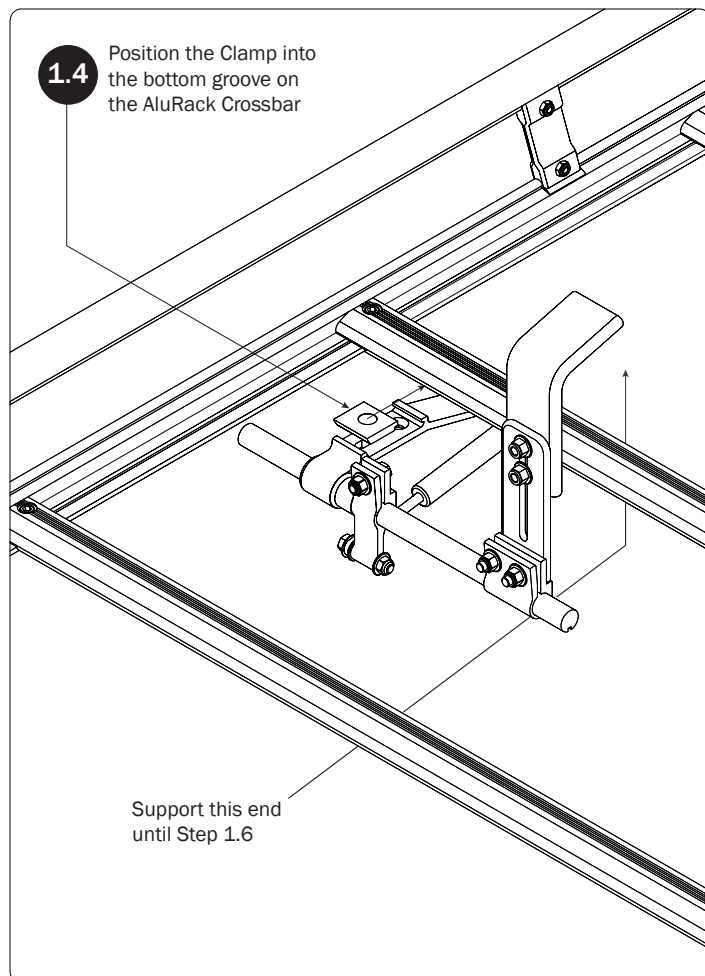

Support this end until Step 1.6

1.5

For maximum Handle distance from the vehicle, position the Gas Spring Clamp firmly against the Side Rail as shown in Figure A

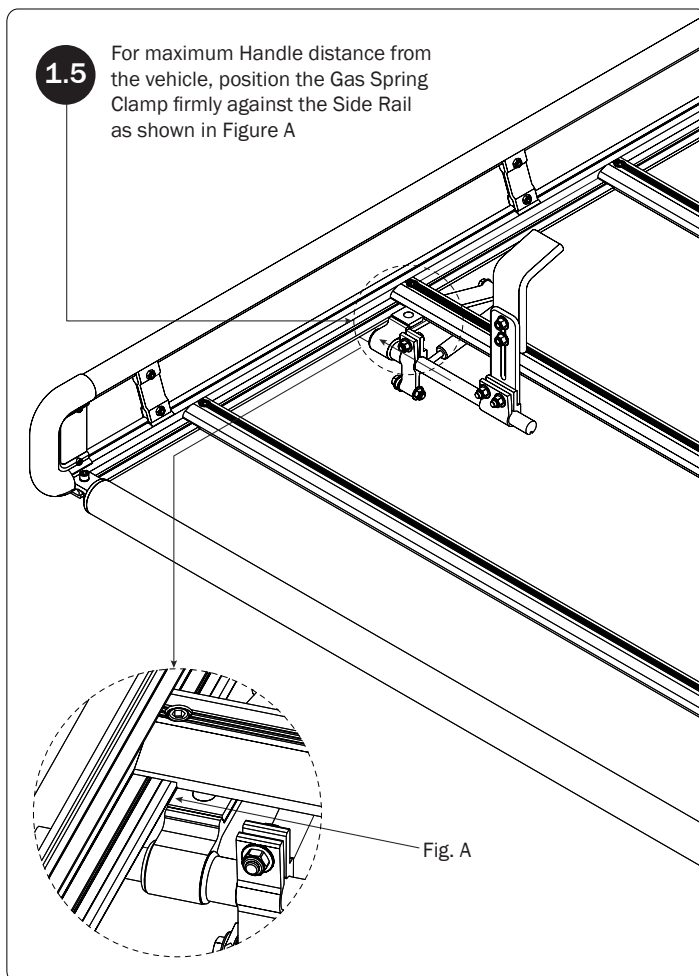
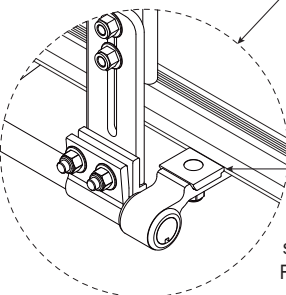
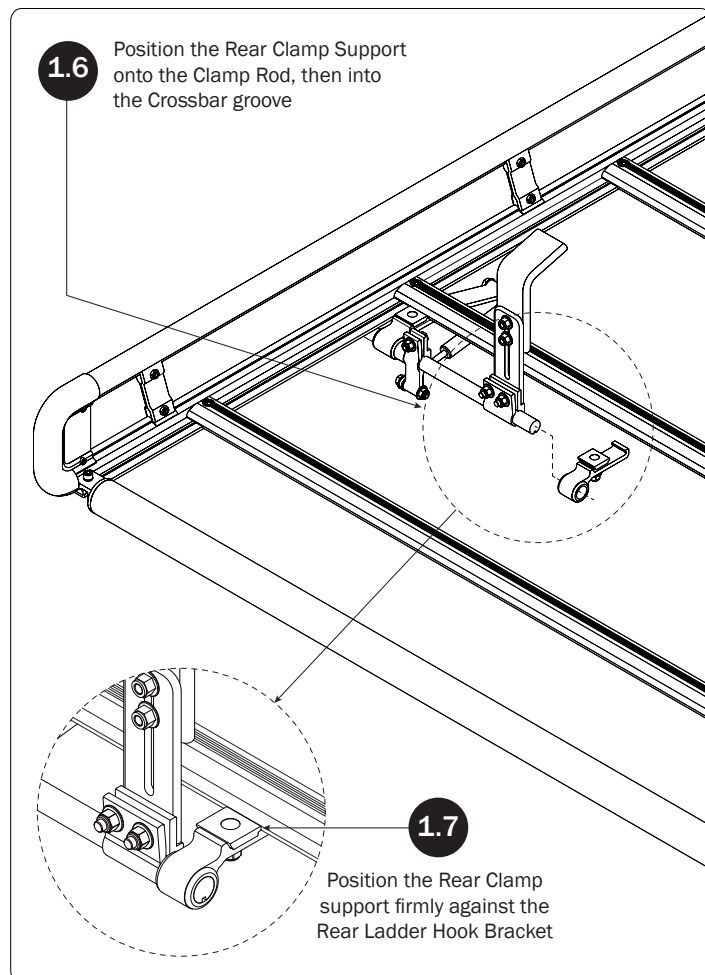

Fig. A

1.6

Position the Rear Clamp Support onto the Clamp Rod, then into the Crossbar groove



1.7

Position the Rear Clamp support firmly against the Rear Ladder Hook Bracket

1.8

Torque the indicated Clamp Bracket Nuts to 120 in-lbs.

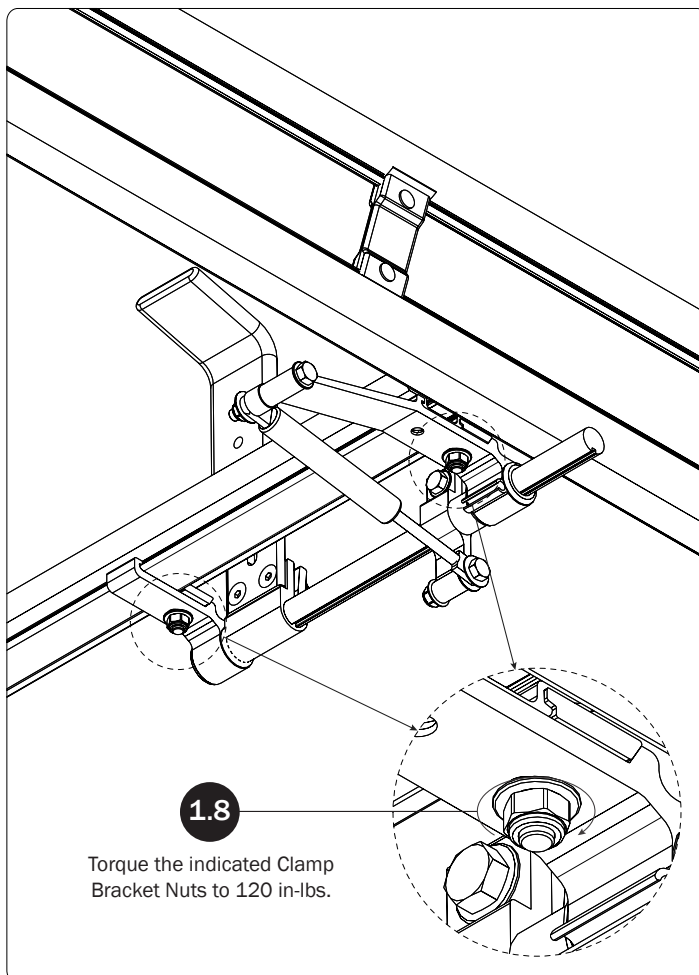

## ALTERNATIVE POSITIONING FOR FORD TRANSIT CONNECT RACK MODELS

Position the Clamp into the bottom groove on the AluRack Crossbar

1.9

Support this end until Step 1.11

For maximum Handle distance from the vehicle, position the Gas Spring Clamp firmly against the Channel Mount as shown in Figure B

1.10

Fig. B

Position the Rear Clamp Support onto the Clamp Rod, then into the Crossbar groove

1.11

1.12

Position the Rear Clamp support firmly against the Rear Ladder Hook Bracket

Torque the indicated Clamp Bracket Nuts to 120 in-lbs.

1.13



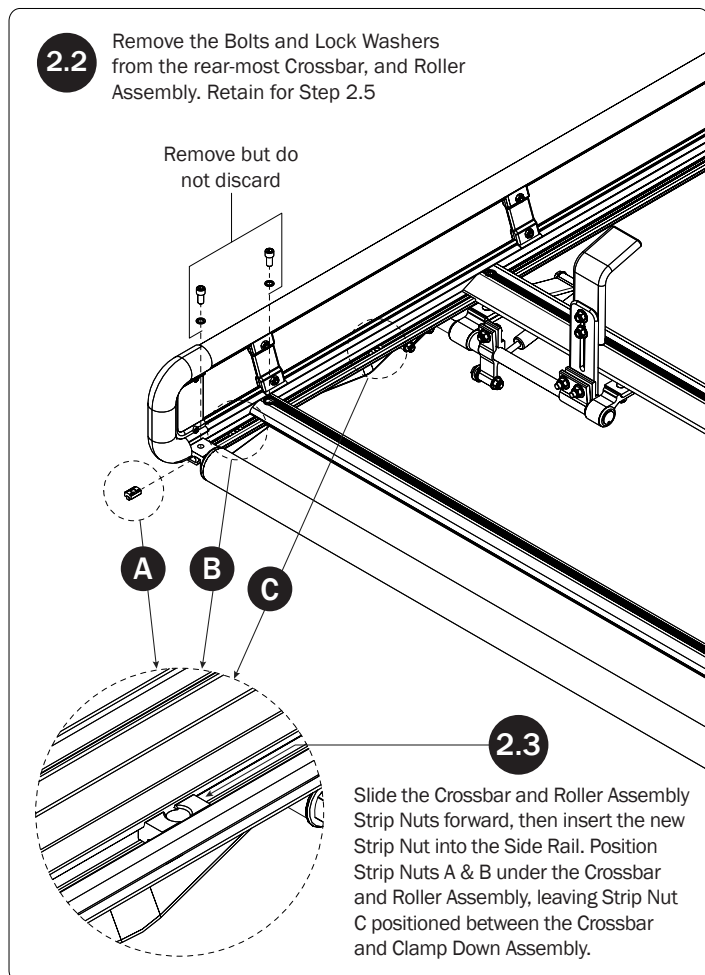
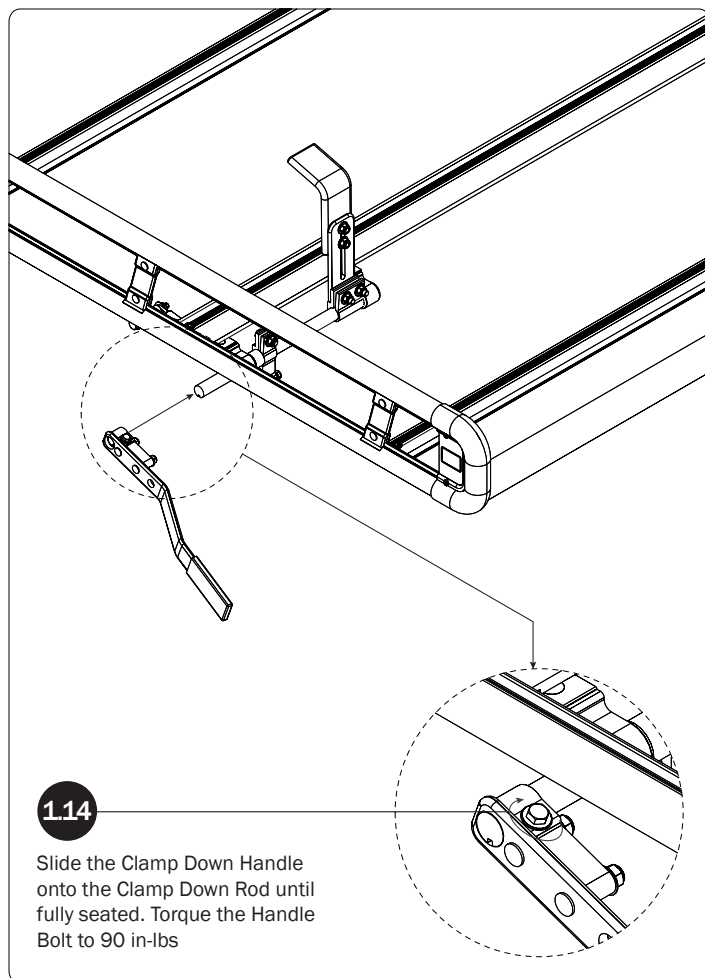

## CLAMP DOWN LOCK BRACKET SEE QUICK START GUIDE FOR ADJUSTMENTS

- 2.1** Remove the Lock Bracket hardware and retain for Step 2.4

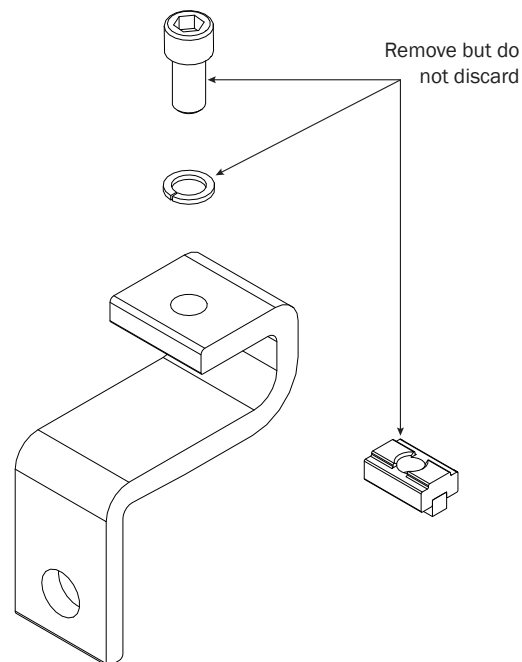

- Attach Lock Bracket using hardware removed in Step 2.1. Do not tighten bolt until Step 2.7

**2.4**

**Anti-Seize**  
Must apply Anti-Seize Compound. Do not tighten at this time.

- Reinstall the Crossbar and Roller Assembly hardware removed in Step 2.2 and torque to 90 in-lbs

**2.5**

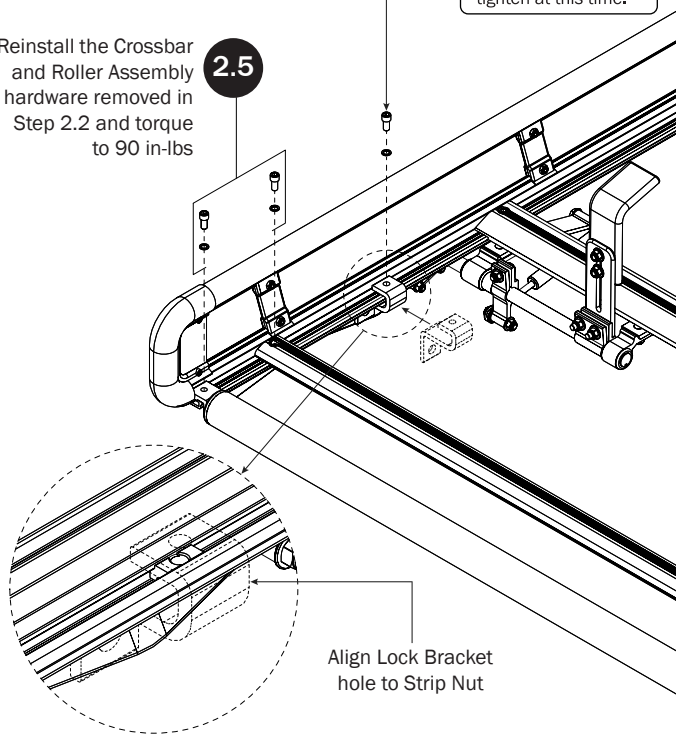

2.6

Align the hole on the Lock Bracket to the lock hole on the Handle as shown below

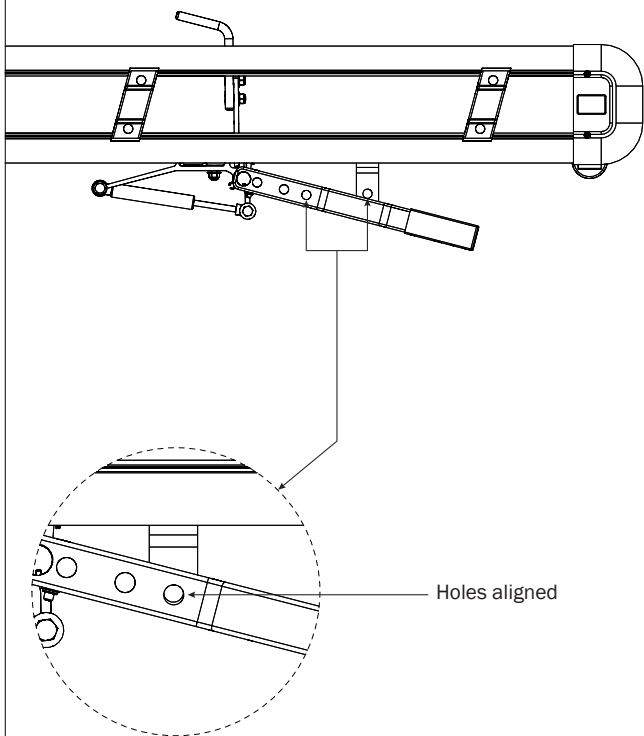

7

2.7

Torque Lock Bracket Bolt to 80 in-lbs

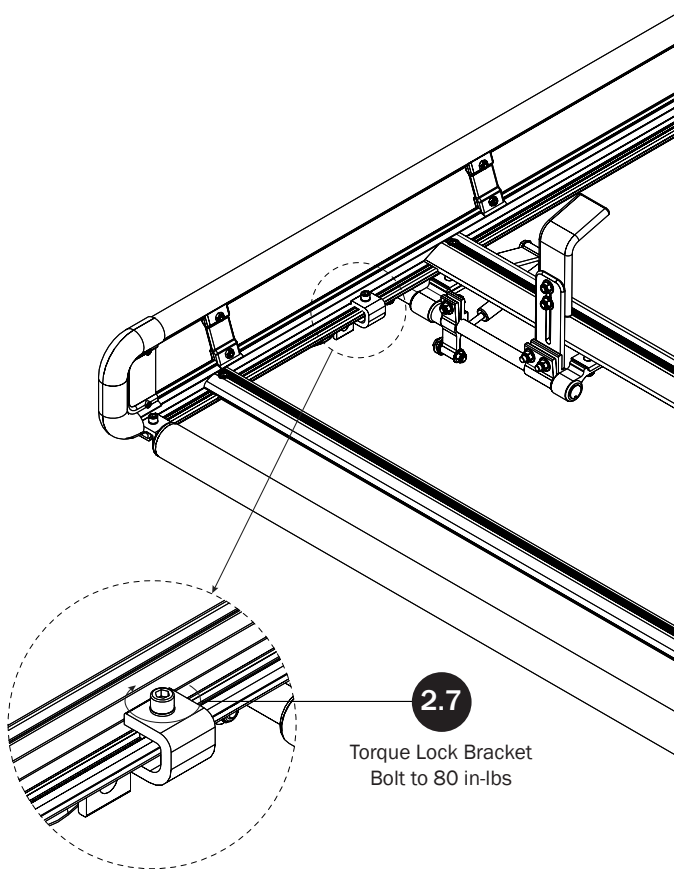

## FRONT HOOK ASSEMBLY SEE QUICK START GUIDE FOR ADJUSTMENTS

3.1

Loosen, but do not remove, the indicated bolts on the Front Ladder Assembly

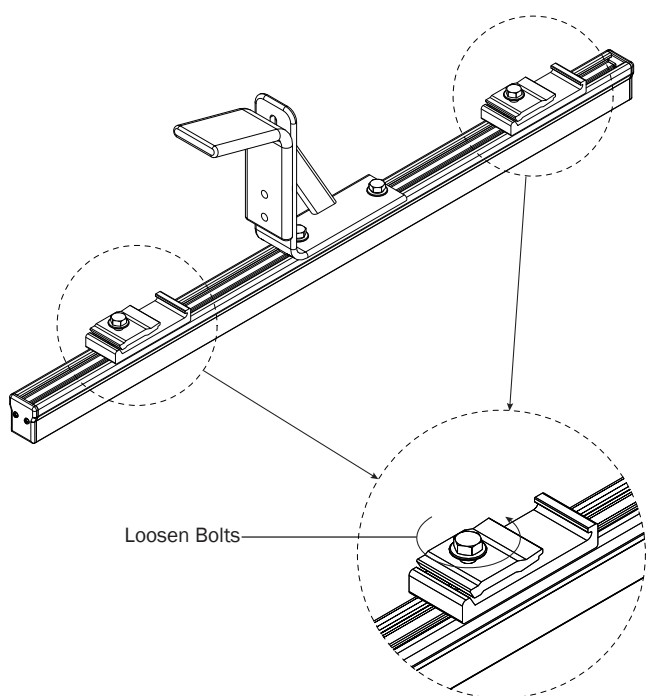

3.2

After determining Front to Rear Ladder Hook spacing based upon ladder size, slide the Front Hook Assembly under the Crossbars to that determined distance.

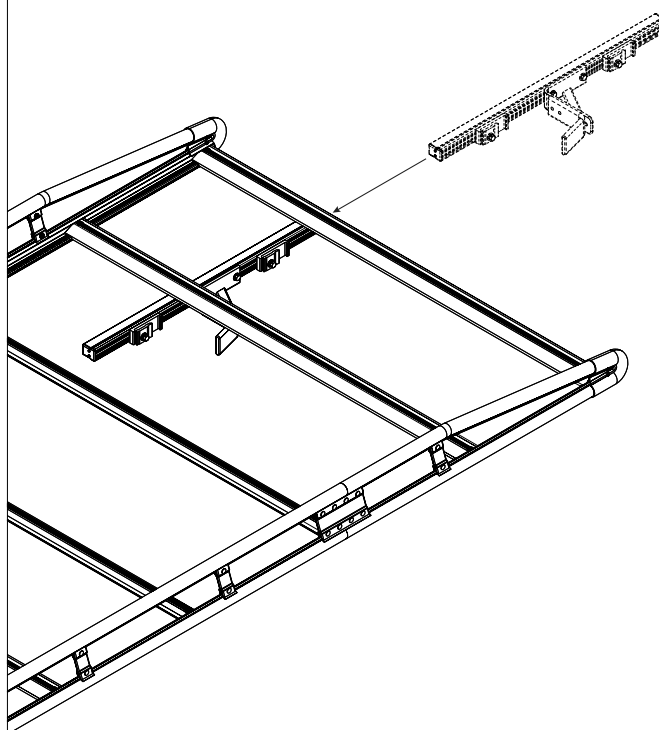

3.3

Attach the Front Hook Assembly onto your designated Crossbars. The Channel Connectors must seat into the bottom groove of the Crossbar as shown below. Do not tighten until Step 3.7

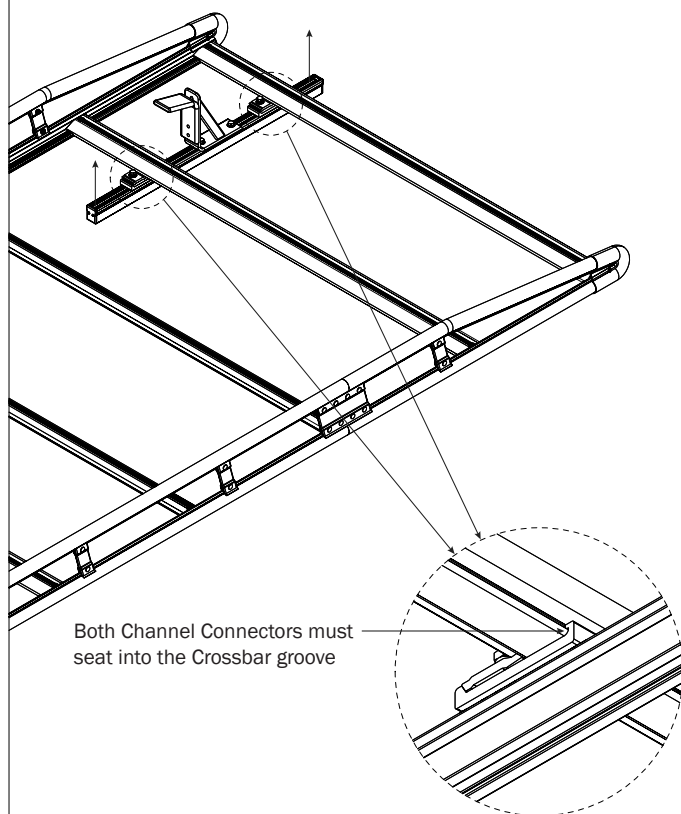

3.5

Position the Front Hook Assembly until it centers with the Rear Clamp Down Hook.

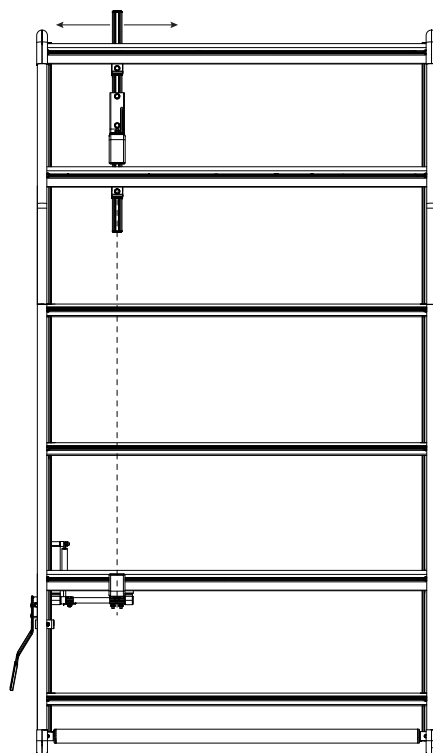

3.6

Position the Front Hook Assembly until the front of the Hook Channel is even to, or less than, the end of the Side Rails as shown in Figure C

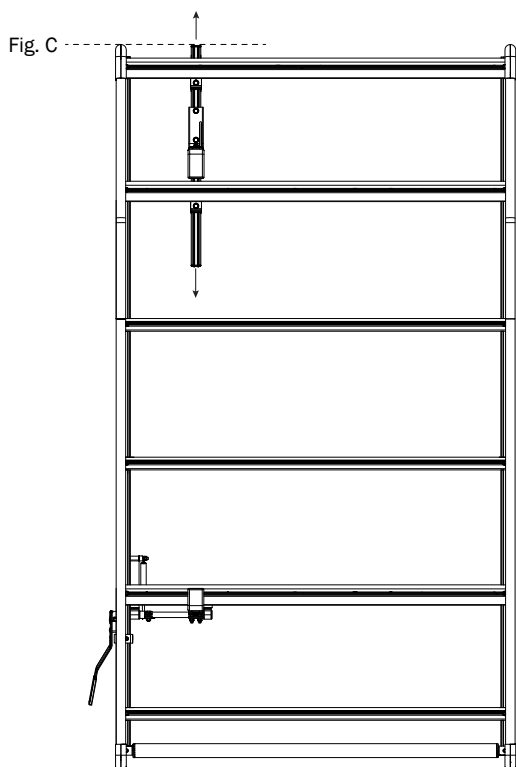

3.7

Torque to 90 in-lbs

