

PRIME DESIGN™

A Safe Fleet Brand

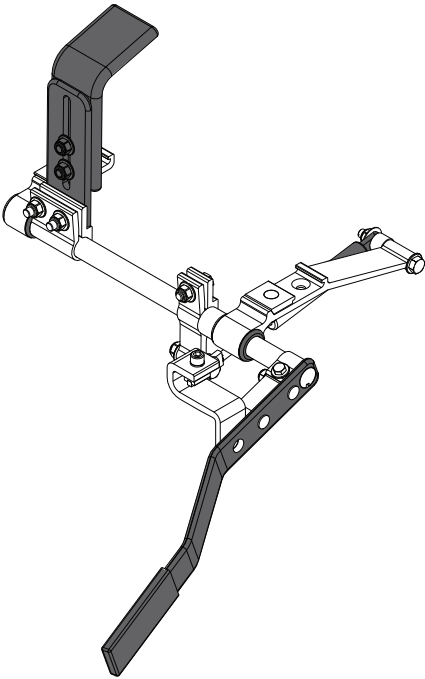
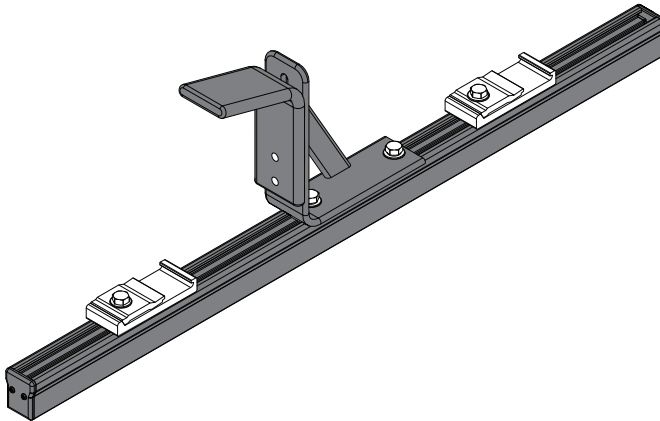

PRIME DESIGN, A SAFE FLEET BRAND

Address: 680 Cape Field Drive, Edgemoor, MN 55128 • Toll Free: #1.82.PRIMESPAK, Minnesota 55118
Tel: 651.552.1790 • Fax: 651.552.1790 • E-mail: info@primedesign.net • Website: www.primedesign.net

Q&A

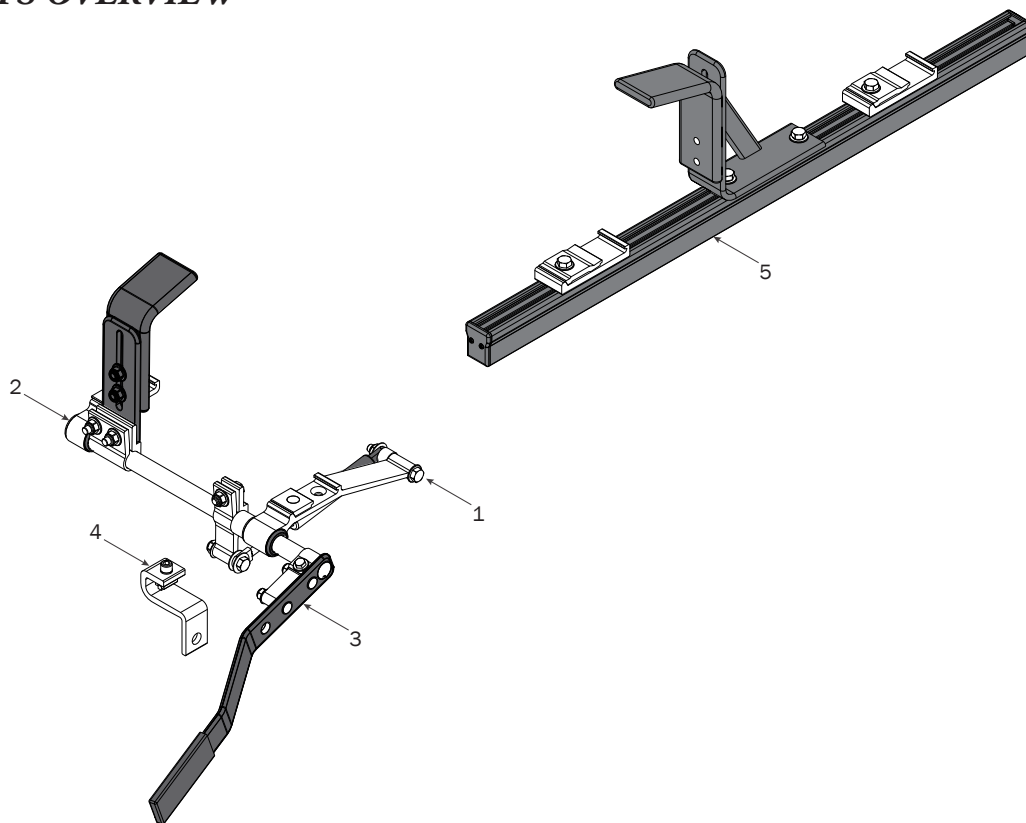

1—Quick Clamp Assembly (Qty 1)
Right Hand, Rear, w/Handle

2—Rear Clamp Support Assembly..... (Qty 1)
AluRack

3—Clamp Down Handle Assembly (Qty 1)
Right Hand, 14.00", Bent w/Hardware

4—Lock Bracket Assembly..... (Qty 1)
AluRack, w/Hardware

5—Quick Clamp Front Hook Assembly (Qty 1)
AluRack, Adjustable

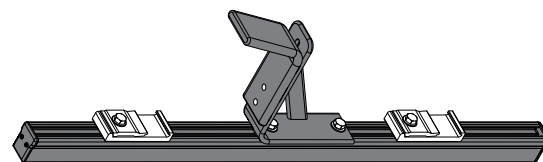
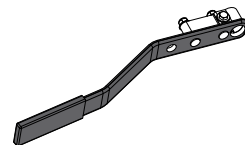
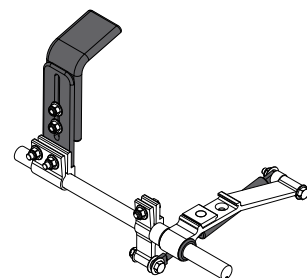

RIGHT AXC ASSEMBLY SEQUENCE



This AXC Right Hand Quick Clamp Assembly is shown installed onto a Prime Design AluRack for illustrative purposes only.

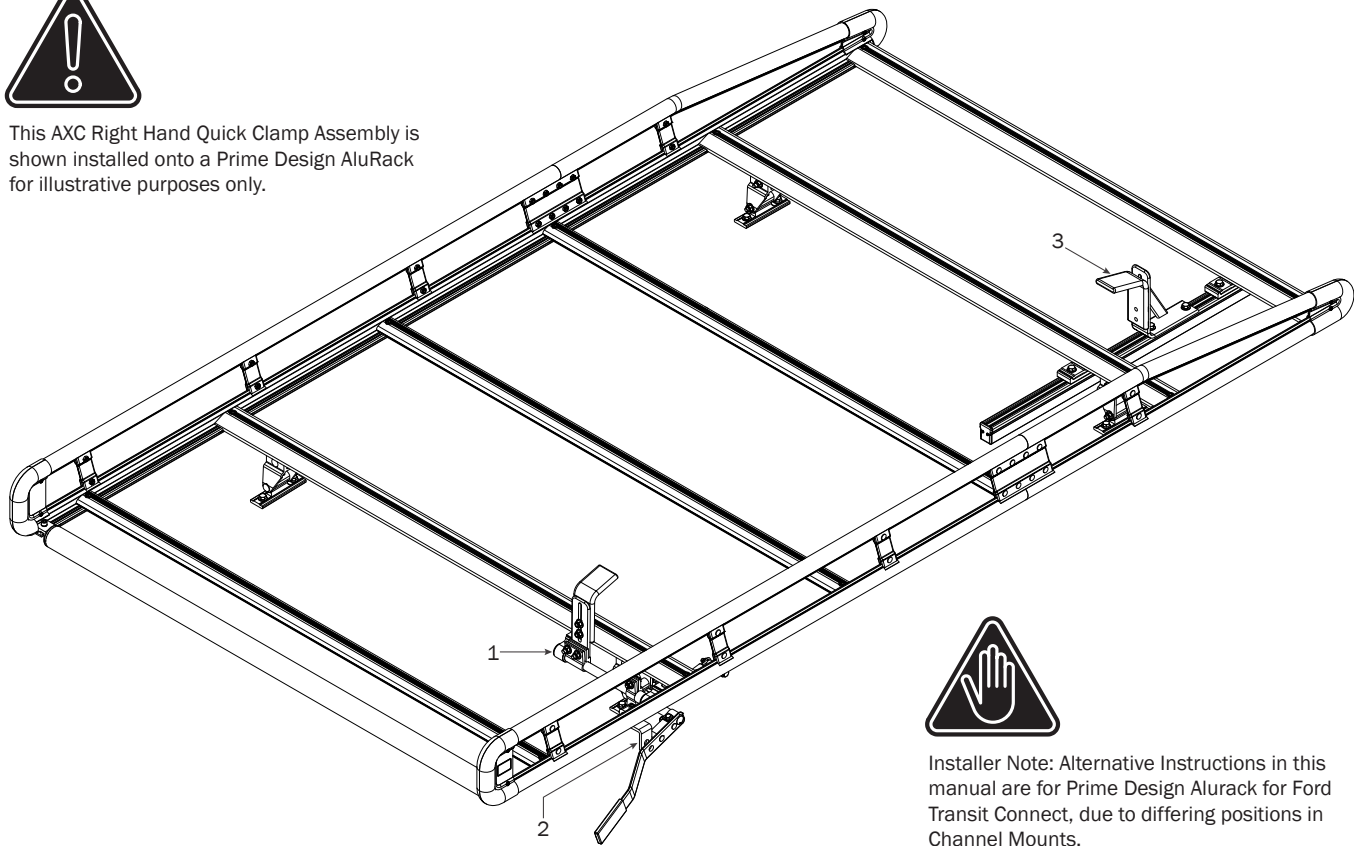

Installer Note: Alternative Instructions in this manual are for Prime Design Alurack for Ford Transit Connect, due to differing positions in Channel Mounts.

REAR QUICK CLAMP

SEE QUICK START GUIDE FOR ADJUSTMENTS

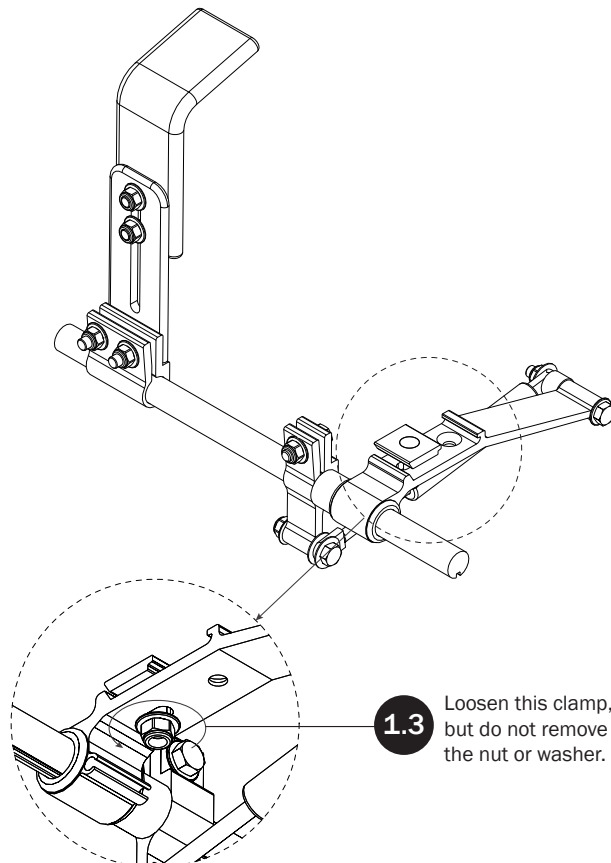
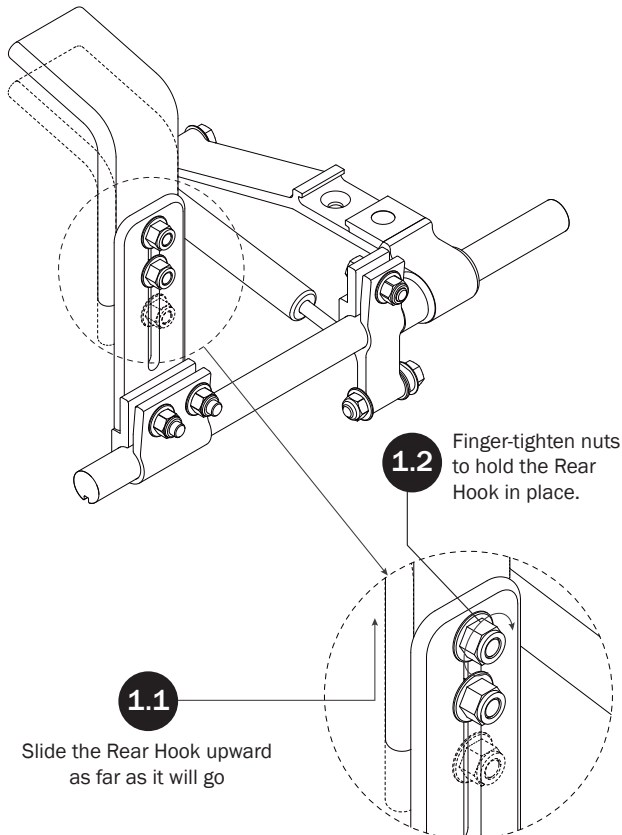

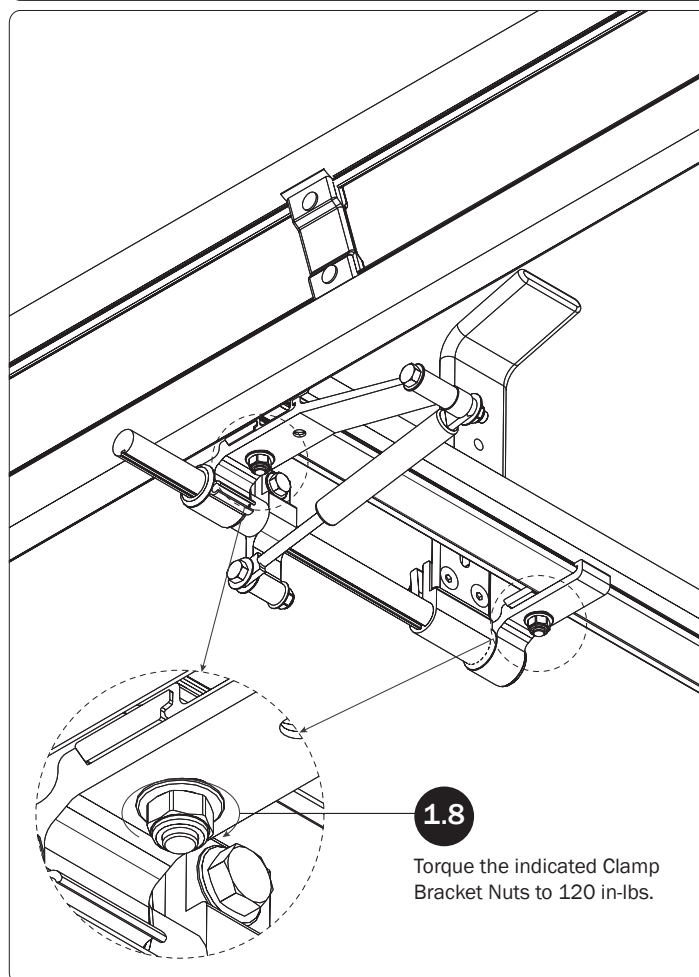
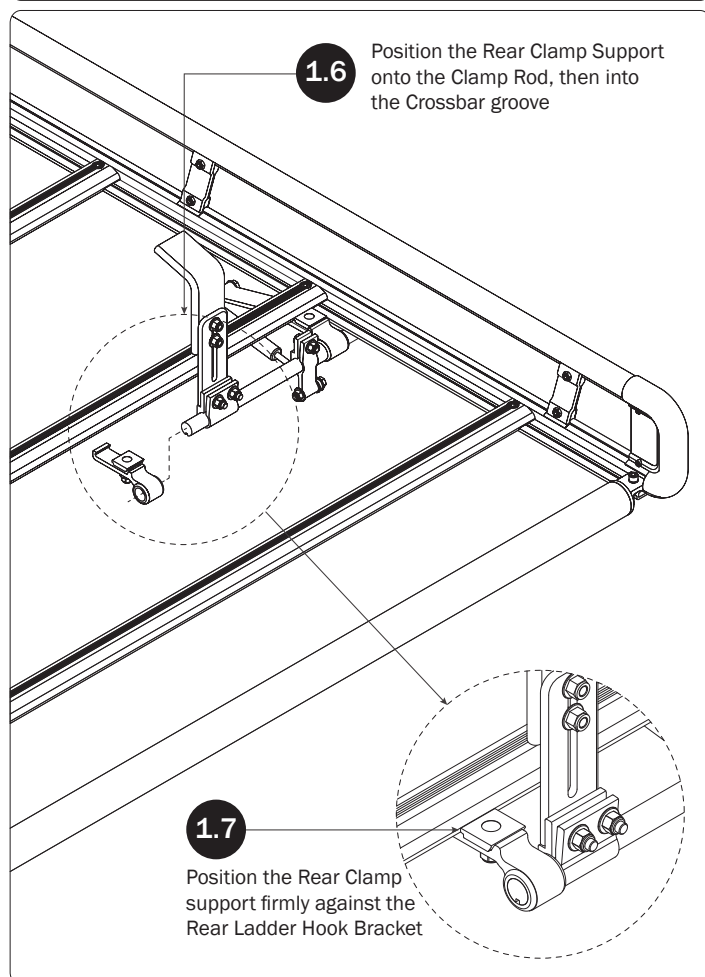
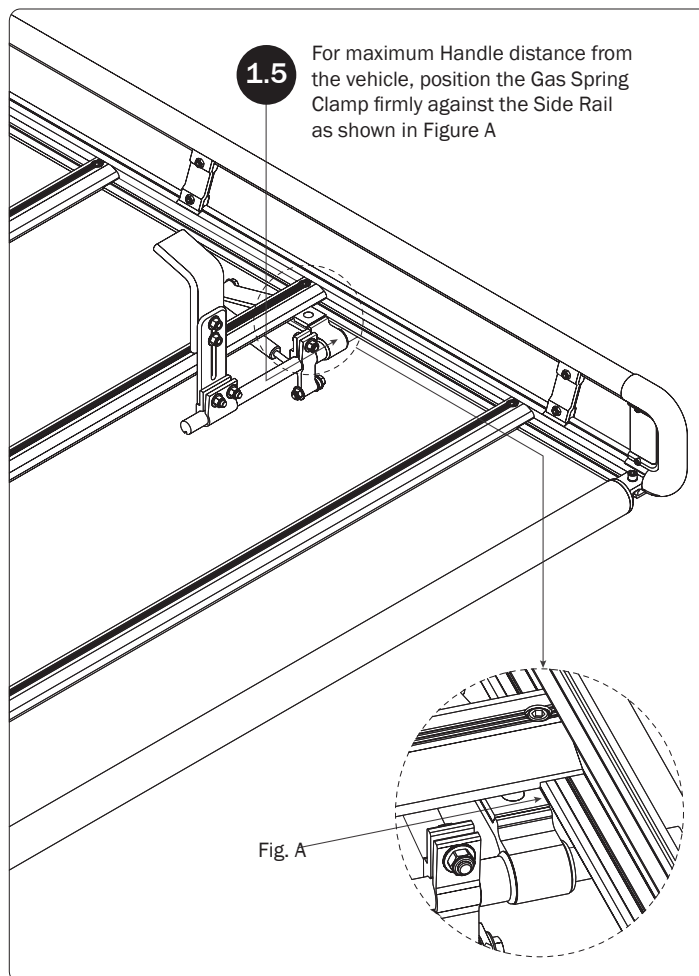
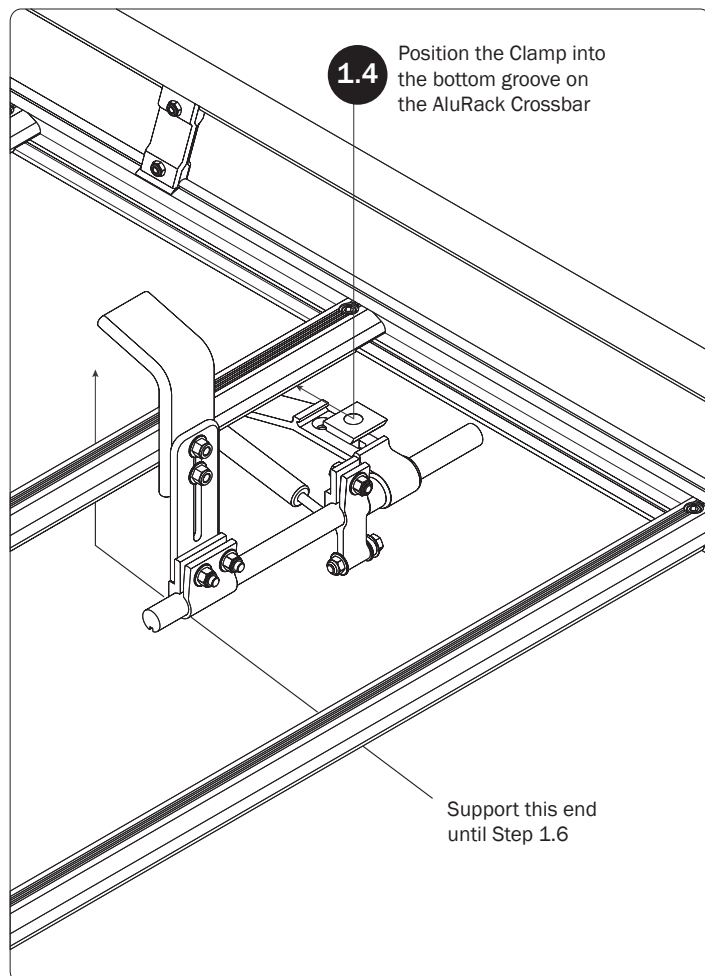

ALTERNATIVE POSITIONING FOR FORD TRANSIT CONNECT RACK MODELS

1.9 Position the Clamp into the bottom groove on the AluRack Crossbar

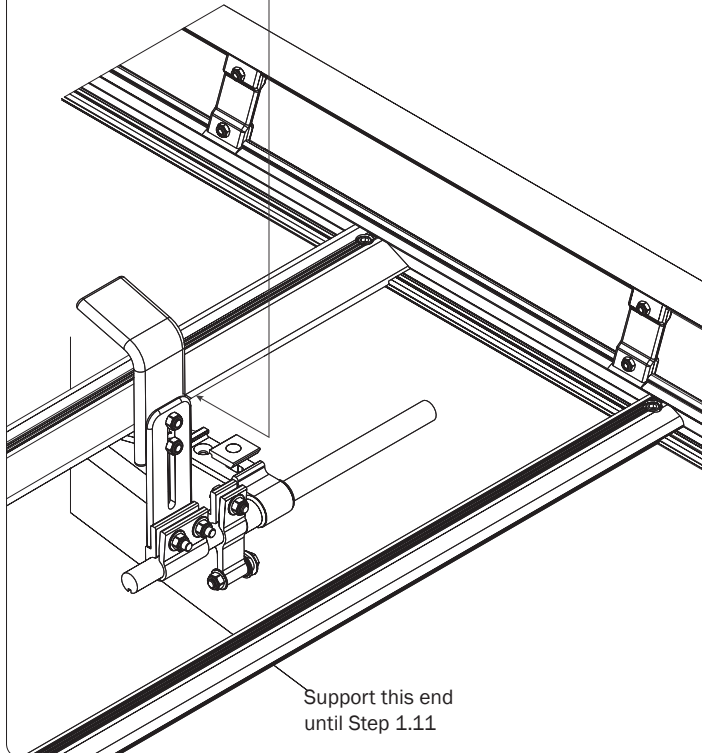

1.10

For maximum Handle distance from the vehicle, position the Gas Spring Clamp firmly against the Channel Mount as shown in Figure B

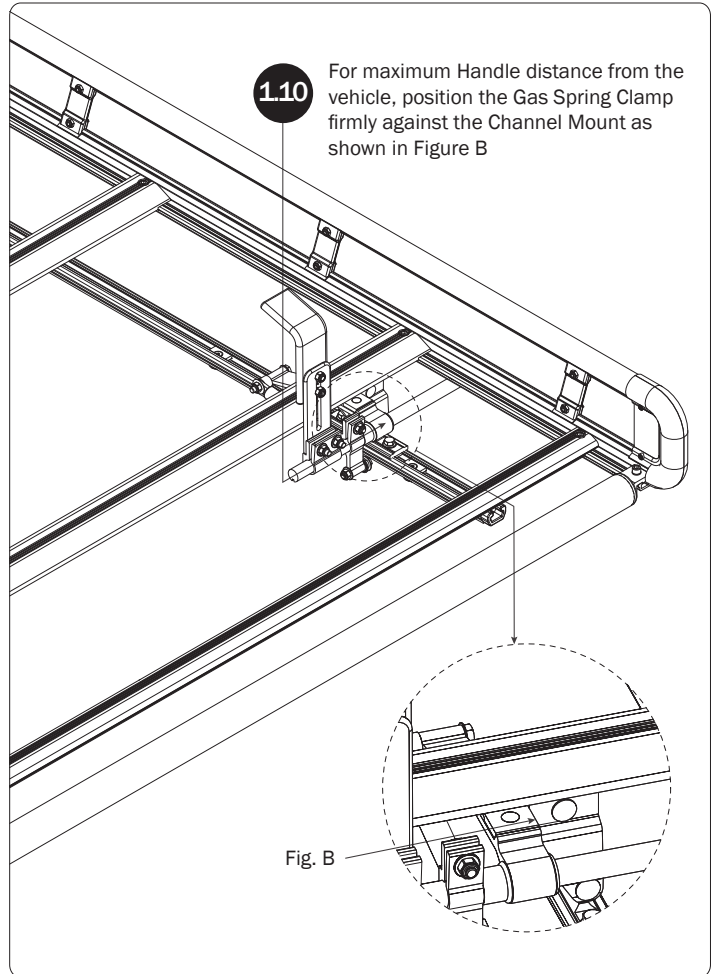

1.11

Position the Rear Clamp Support onto the Clamp Rod, then into the Crossbar groove

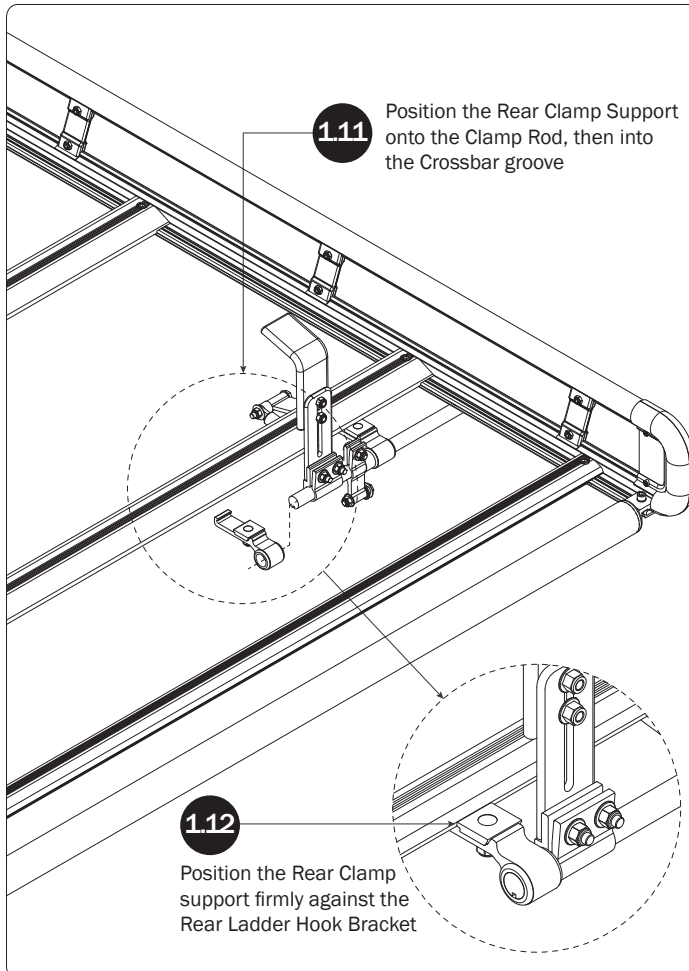

1.12

Position the Rear Clamp support firmly against the Rear Ladder Hook Bracket

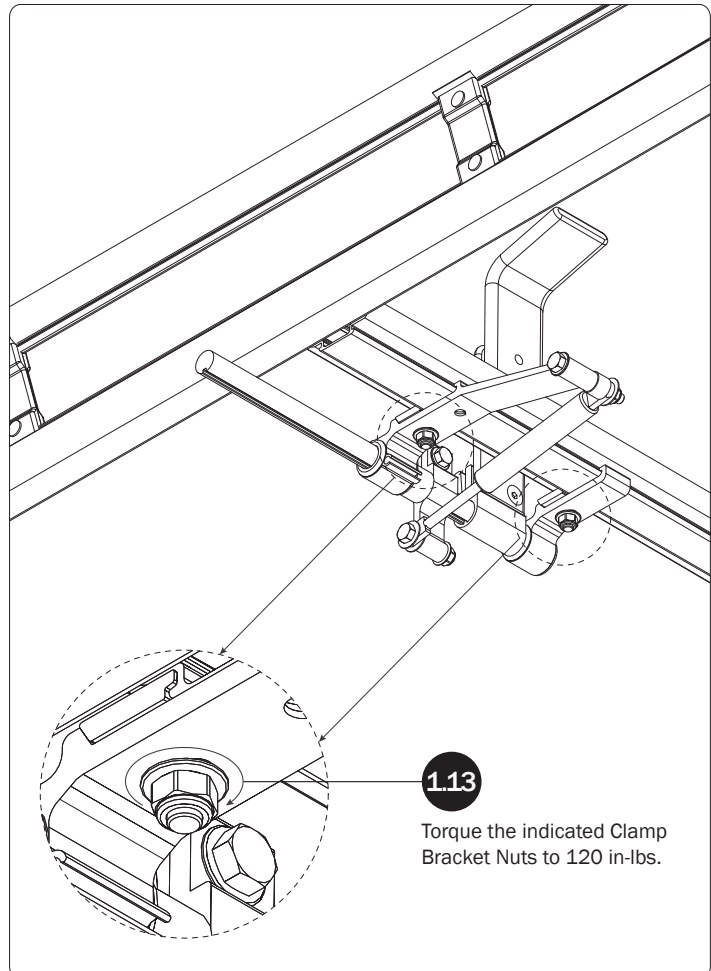

1.13

Torque the indicated Clamp Bracket Nuts to 120 in-lbs.

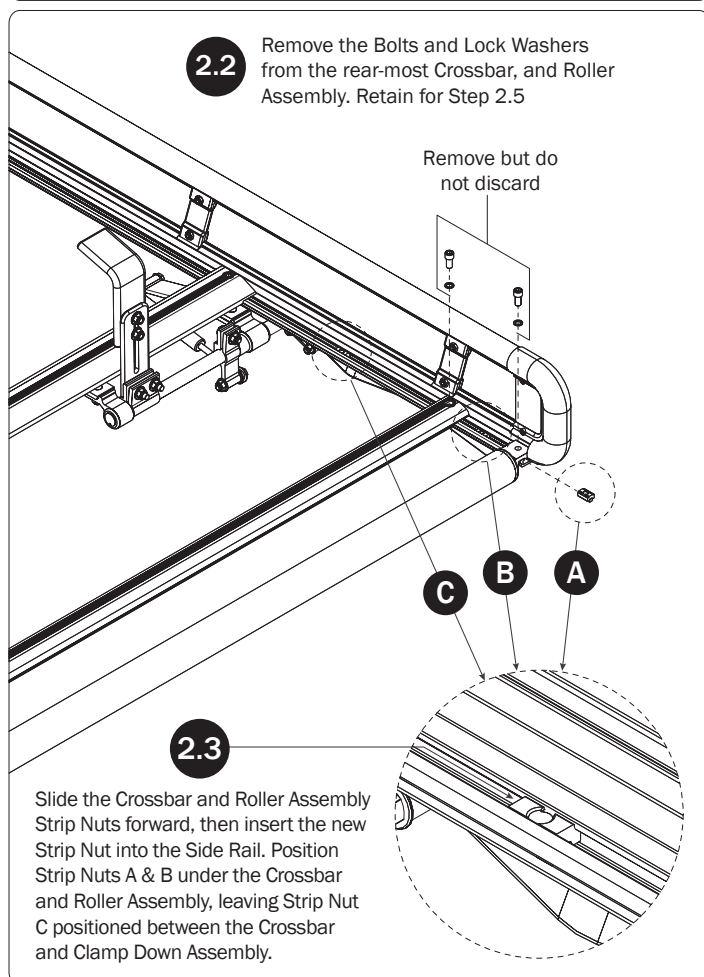
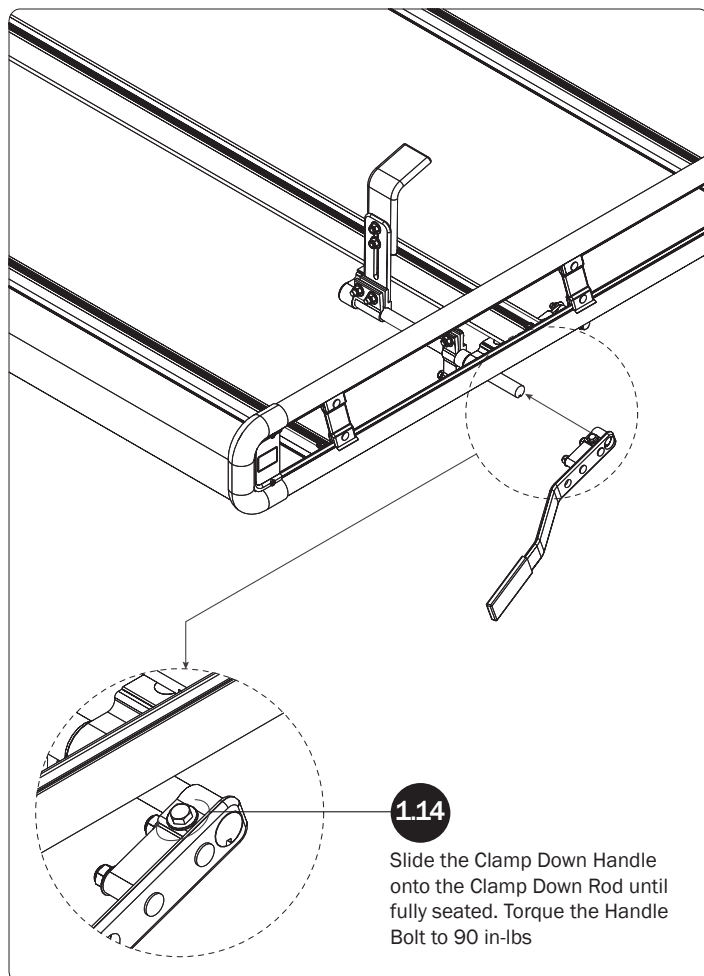

CLAMP DOWN LOCK BRACKET SEE QUICK START GUIDE FOR ADJUSTMENTS

- 2.1** Remove the Lock Bracket hardware and retain for Step 2.4

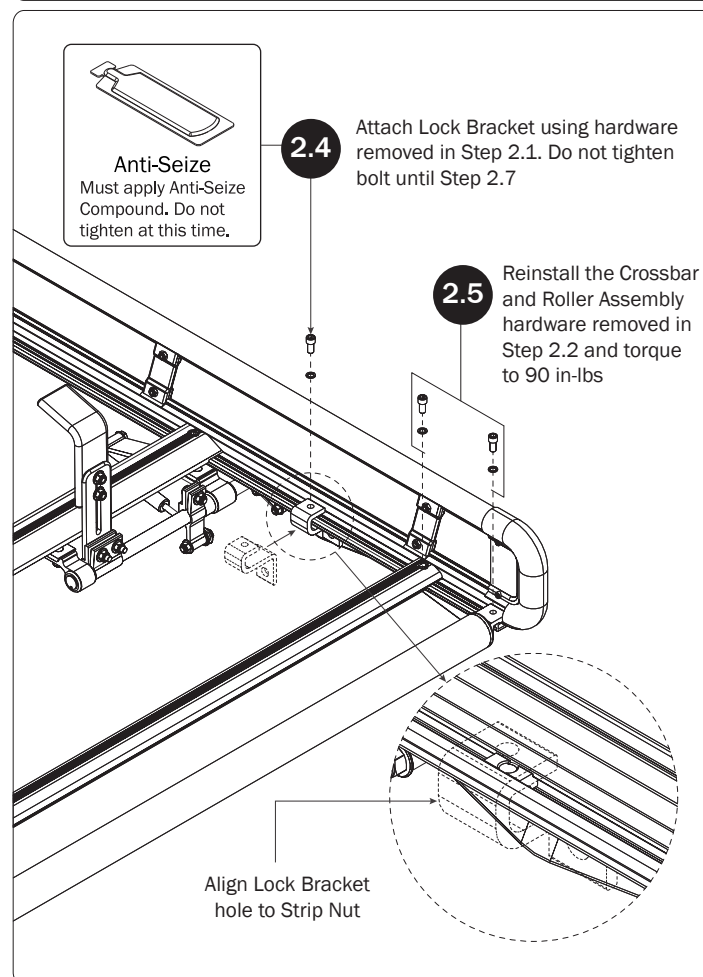
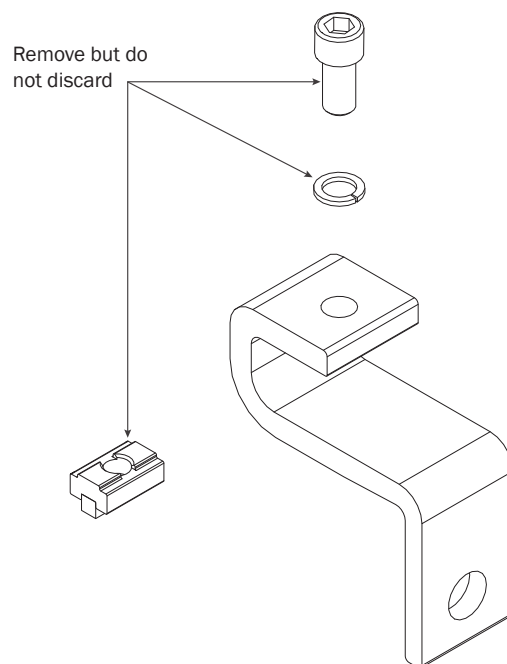

2.6

Align the hole on the Lock Bracket to the lock hole on the Handle as shown below

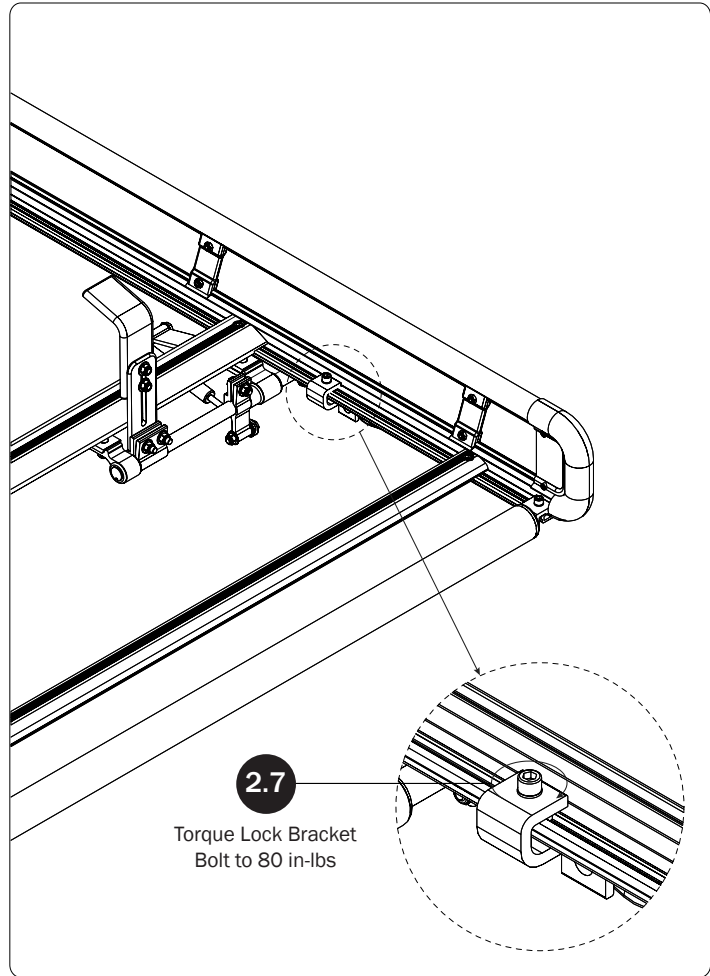
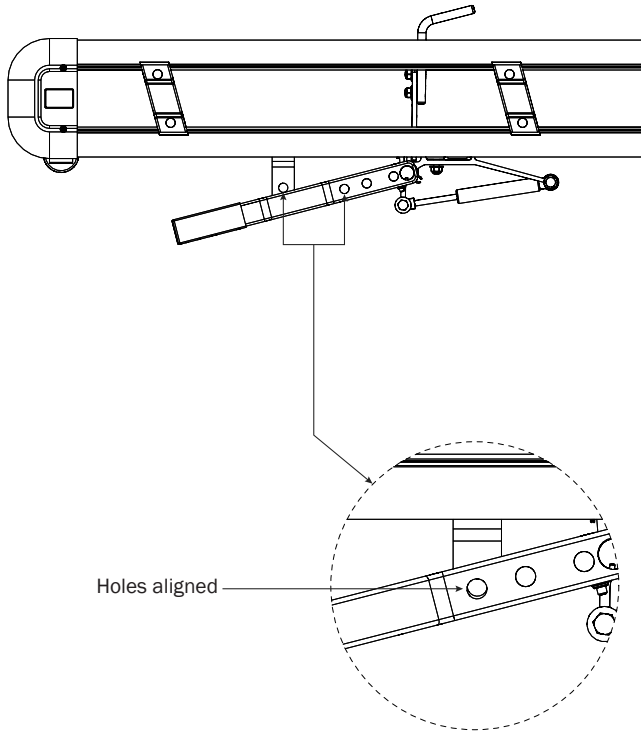

FRONT HOOK ASSEMBLY SEE QUICK START GUIDE FOR ADJUSTMENTS

3.1

Loosen, but do not remove, the indicated bolts on the Front Ladder Assembly

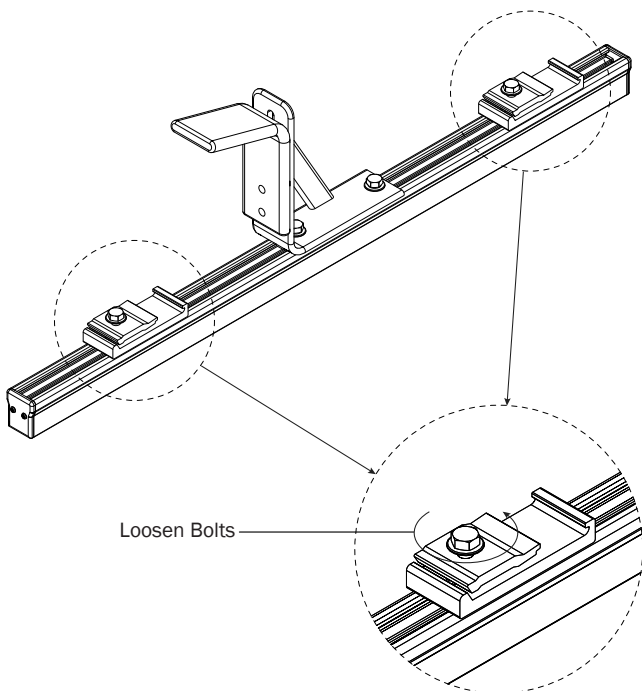

3.2

After determining Front to Rear Ladder Hook spacing based upon ladder size, slide the Front Hook Assembly under the Crossbars to that determined distance.

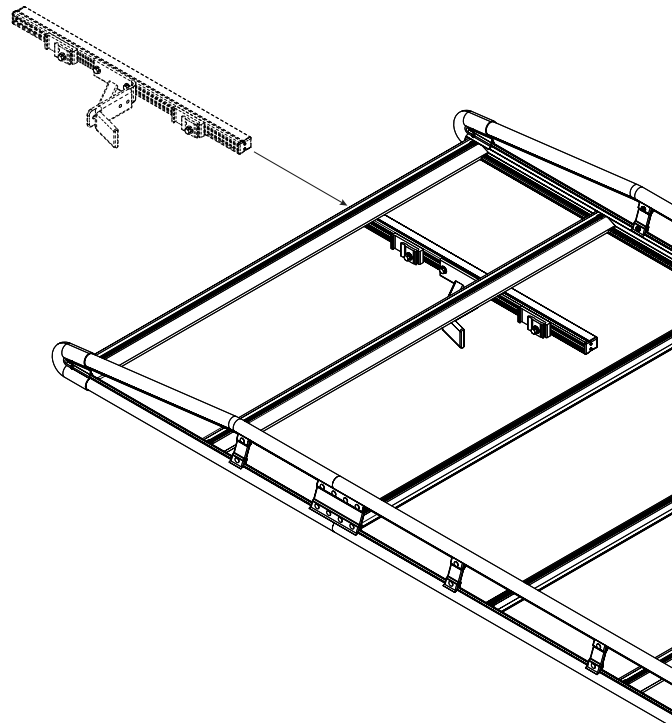

- 3.3** Attach the Front Hook Assembly onto your designated Crossbars. The Channel Connectors must seat into the bottom groove of the Crossbar as shown below. Do not tighten until Step 3.7

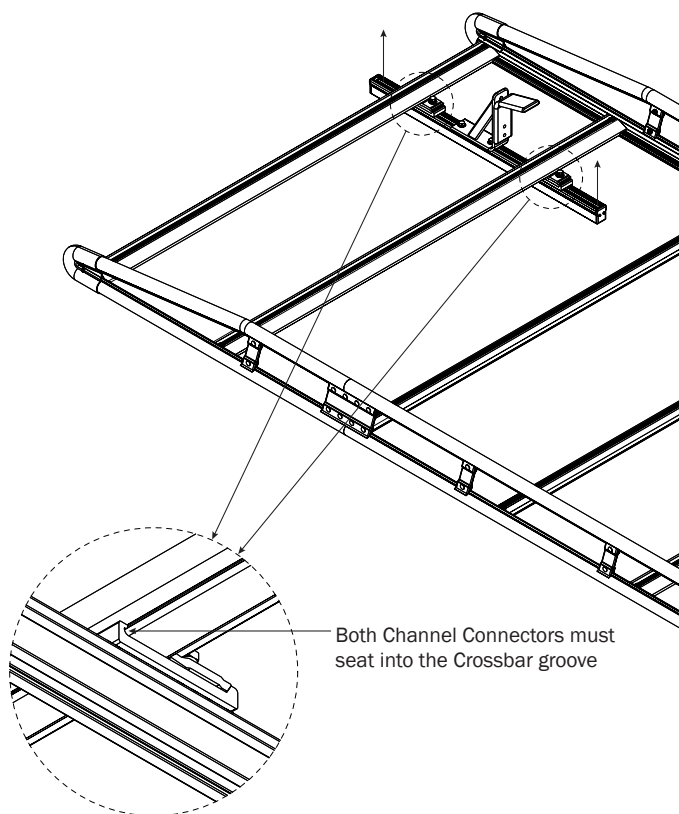

- 3.5** Position the Front Hook Assembly until it centers with the Rear Clamp Down Hook.

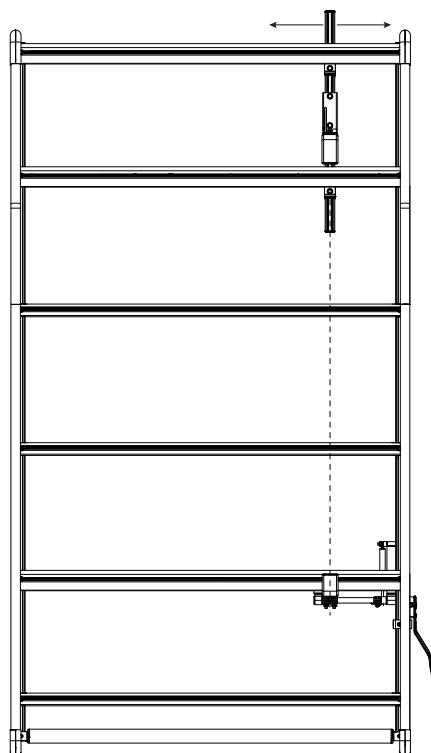

- 3.6** Position the Front Hook Assembly until the front of the Hook Channel is even to, or less than, the end of the Side Rails as shown in Figure C

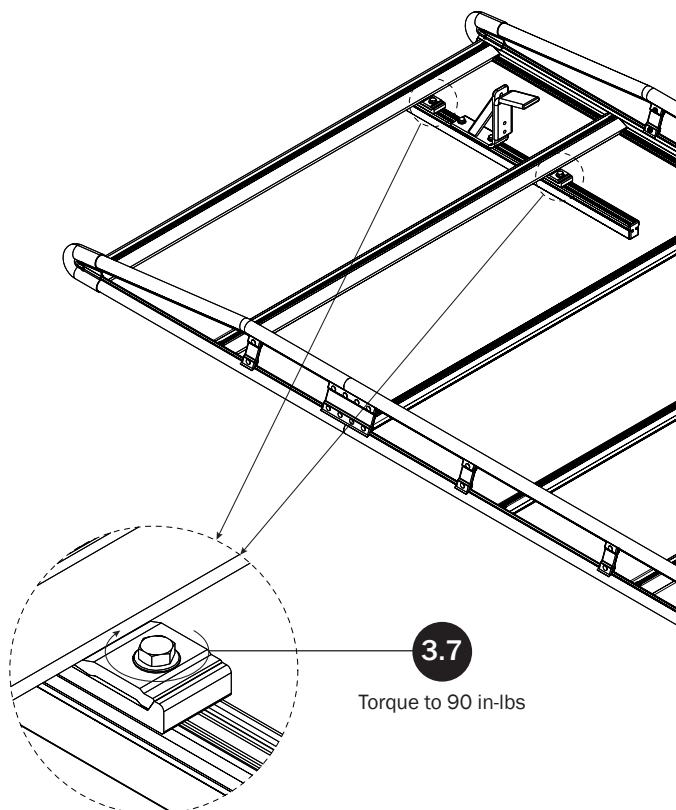
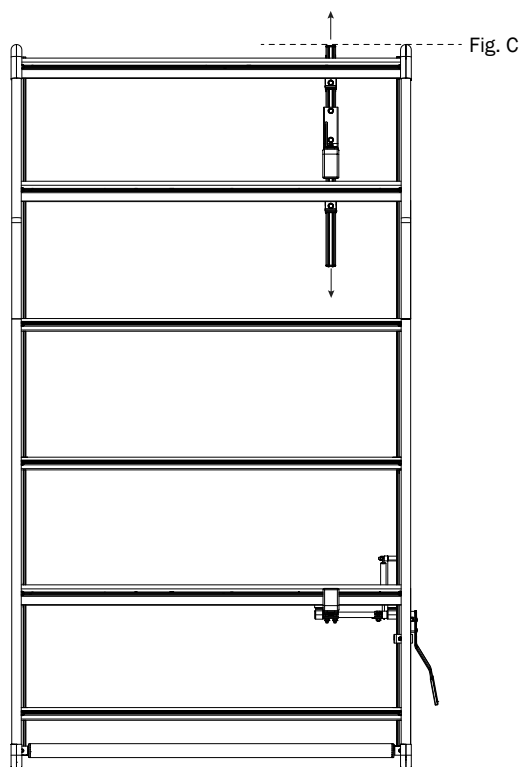

USAM-AXC-US01 Rev-C 0719