

CBA-3007

72" Crossbar Assembly Module

Dimensional Specifications on Page 2

Configuration as shown:

Base Left/Slide Rotation Right
Two Crossbars, Powder Coat Finish
Weight: 39 lbs

A: CB4-9303-72 RH Rear Slide Rotation
A1:..... CBR-1311-72 Crossbar
A2:..... BRT-8201 Ladder Stop
A3:..... ELR-8160 Slide Upper Z-Post
A4:..... ELR-7281 Slide Z-Post Bracket
A5:..... ELR-7080 Z-Post
A6:..... CYL-8801 Cylinder
B:..... CBR-1311-72 RH Front Rotation
B1:..... CBR-1311-72 Crossbar
B2:..... BRT-8201 Ladder Stop
B3:..... ELR-7073 L-Post
B4:..... ELR-7282 Z-Post Bracket
B5:..... ELR-7080 Z-Post
C:Quick Start Guide (not shown)

[Modular Assembly Manuals](#)

**Note: Mounting Hardware, Drive Shafts, and
Connecting Bars are purchased separately.
For more information, please contact Sales & Support.*

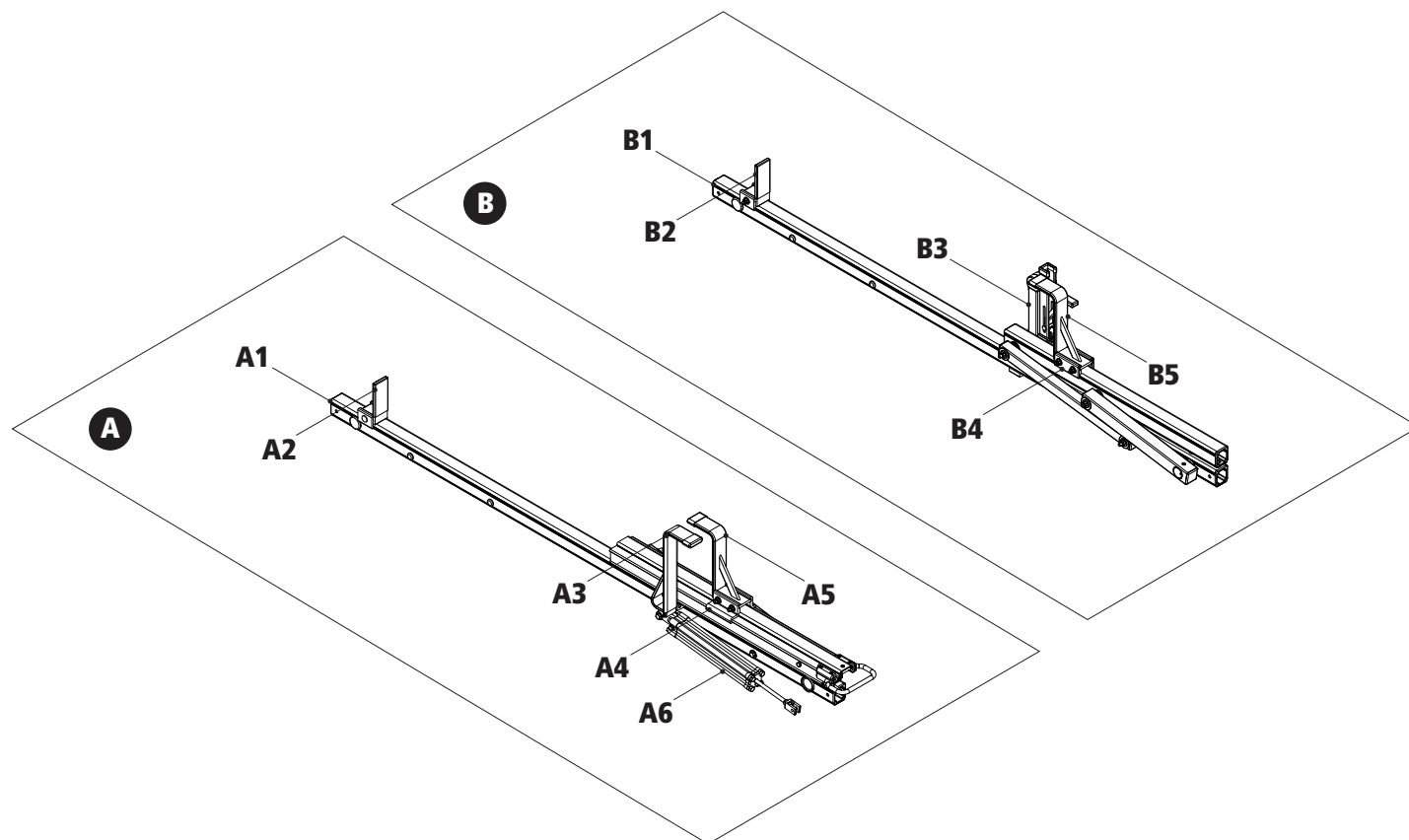

CBA-3007

72" Crossbar Assembly Module

Approximate dimensions as shown:

A: Assembly Width..... 76"
 B: Assembly Height..... 13"
 C: Crossbar Length..... 72"

**Note: Mounting Hardware, Drive Shafts, and Connecting Bars are purchased separately.
 For more information, please contact Sales & Support.*

Assembly Manual also available:

[CBA-3007](#)

USOV-CBA3007-US01 Rev-A 1118

**Other Parts and Hardware ordered separately*

Typical Assembly with CBA-3007

