

CBA-3008

72" Crossbar Assembly Module

Dimensional Specifications on Page 2

Configuration as shown:

Slide Rotation Left/Slide Rotation Right

Two Crossbars, White Powder Finish

Weight: 62 lbs

A: CB4-9333-72 LH/RH Rear Slide Rotation

A1:..... CBR-1311-72 Crossbar

A2:..... CYL-8801 Cylinder

A3:..... ELR-7281 Slide Z-Post Bracket

A4:..... ELR-8160 Slide Upper Z-Post

A5:..... ELR-7080 Z-Post

B:..... CB4-9111-72-11 LH/RH Front Rotation

B1:..... CBR-1311-72 Crossbar

B2:..... ELR-7282 Z-Post Bracket

B3:..... ELR-7073 L-Post

B4:..... ELR-7080 Z-Post

C:Quick Start Guide (not shown)

[Modular Assembly Manuals](#)

**Note: Mounting Hardware, Drive Shafts,
and Connecting Bars are purchased separately.*

For more information, please contact Sales & Support.

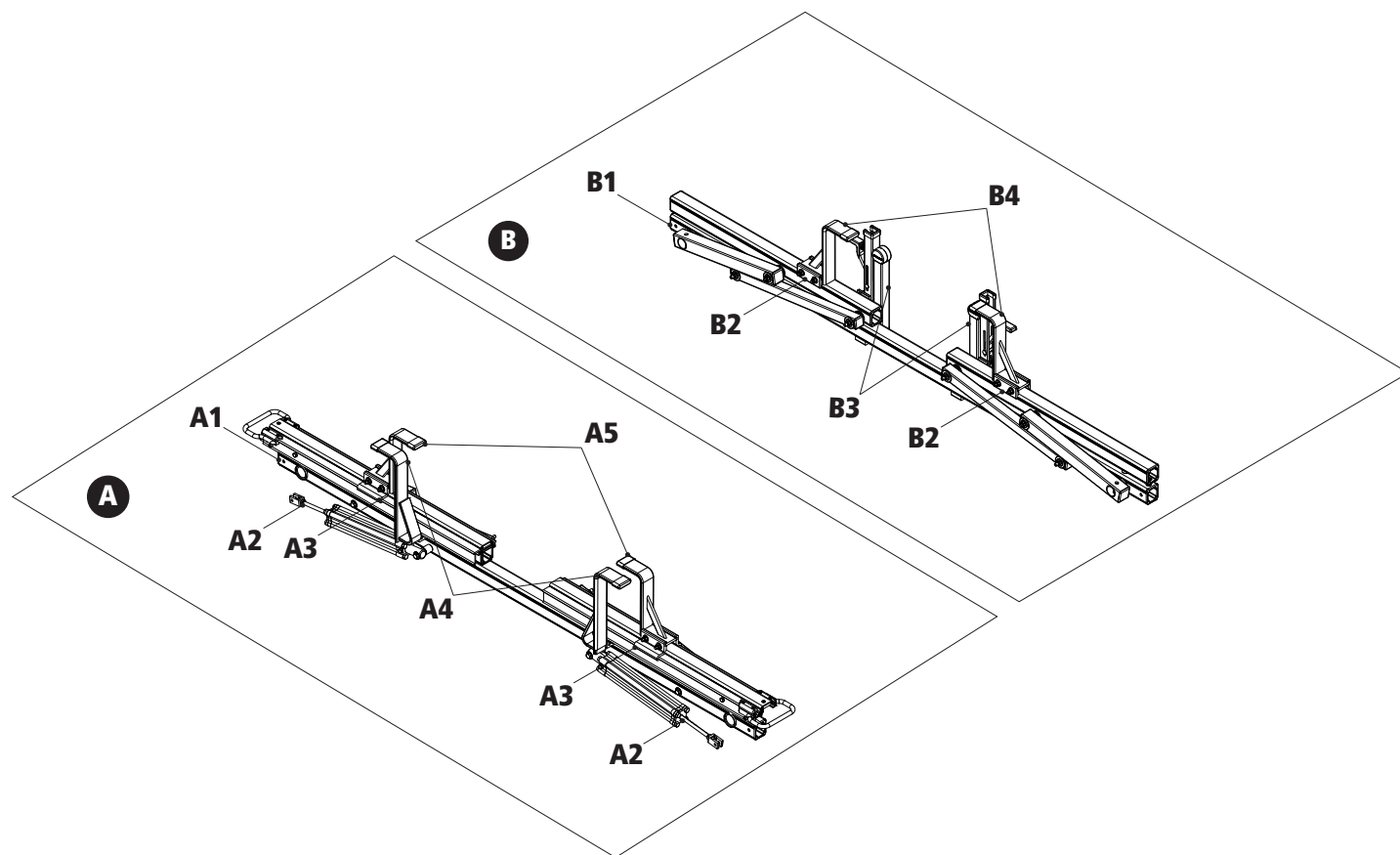

CBA-3008

72" Crossbar Assembly Module

Approximate dimensions as shown:

A: Assembly Width.....	80"
B: Assembly Height.....	13"
C: Crossbar Length.....	72"

**Note: Mounting Hardware, Drive Shafts, and Connecting Bars are purchased separately.
For more information, please contact Sales & Support.*

Assembly Manual also available:

CBA-3008

USOV-CBA3008-US01 Rev-A 1118

Typical Assembly with CBA-3008

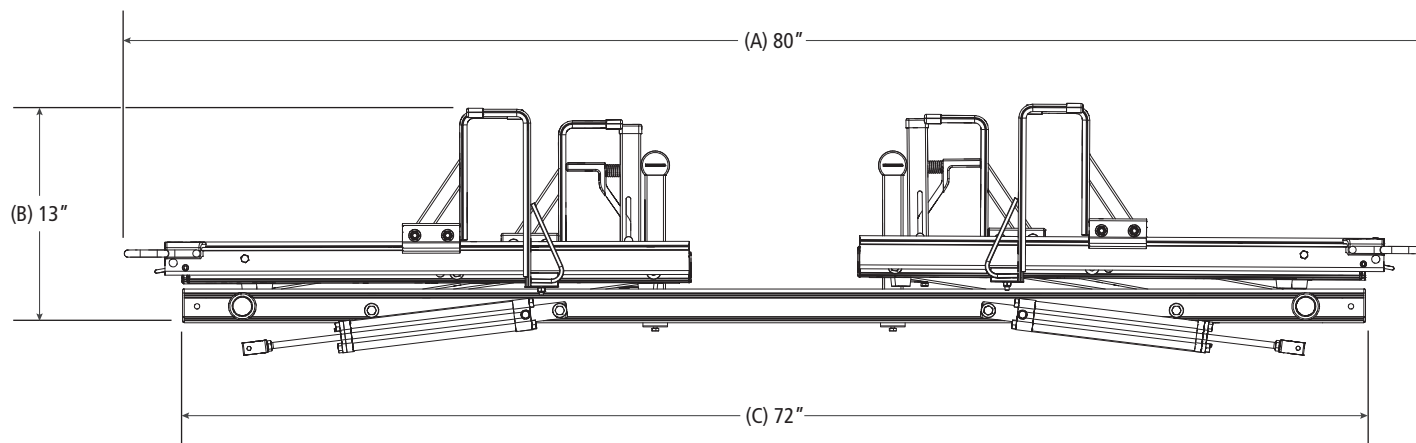
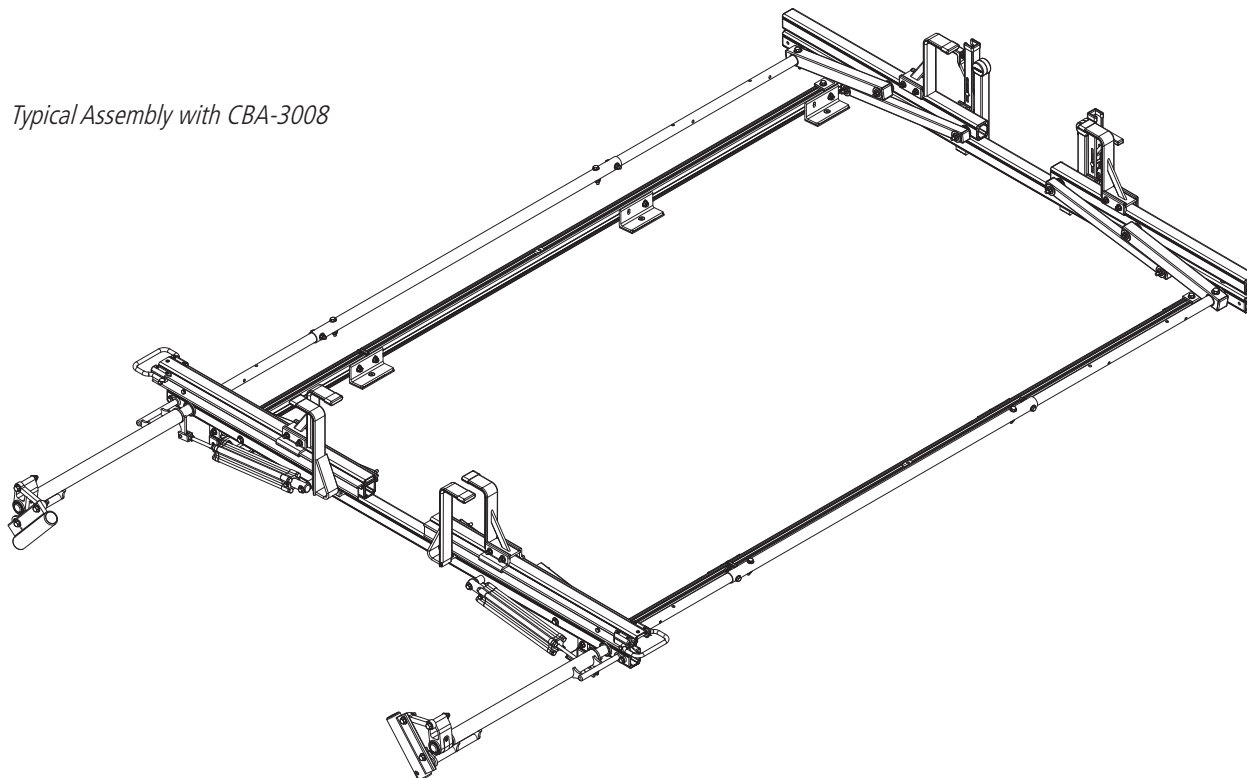

**Other Parts and Hardware ordered separately*