

CBA-3010

78" Crossbar Assembly Module

Dimensional Specifications on Page 2

Configuration as shown:

Base Left/Rotation Right
Two Crossbars, Powder Coat Finish
Weight: 36 lbs

A: CB4-9701-78-01 RH Rear Rotation
A1:.....BRT-8201 Ladder Stop
A2:..... CBR-1711-78 Interlocking Crossbar
A3:..... ELR-7073 L-Post
A4:..... ELR-7282 Z-Post Bracket
A5:..... ELR-7080 Z-Post
A6:..... CYL-8801 Cylinder
B:..... CB4-9101-78-01 RH Front Rotation
B1:.....BRT-8201 Ladder Stop
B2:..... CBR-1311-78 Crossbar
B3:..... ELR-7073 L-Post
B4:..... ELR-7282 Z-Post Bracket
B5:..... ELR-7080 Z-Post
C:Quick Start Guide (not shown)

[Modular Assembly Manuals](#)

**Note: Mounting Hardware, Drive Shafts, and
Connecting Bars are purchased separately.
For more information, please contact Sales & Support.*

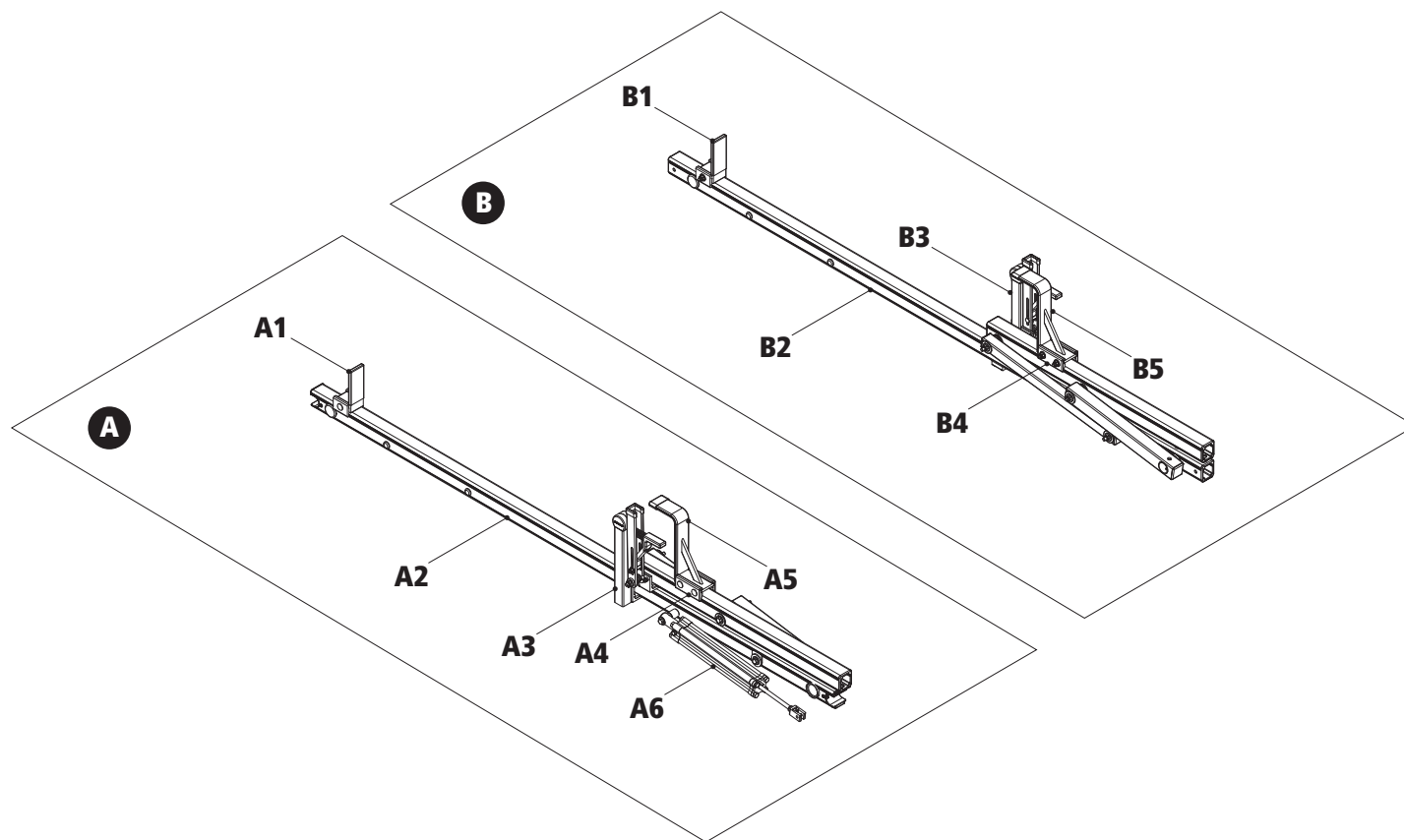

CBA-3010

78" Crossbar Assembly Module

Approximate dimensions as shown:

A: Crossbar Length..... 78"
B: Assembly Height..... 12.50"

**Note: Mounting Hardware, Drive Shafts, and
Connecting Bars are purchased separately.
For more information, please contact Sales & Support.*

Assembly Manual also available:

[CBA-3010](#)

USOV-CBA3010-US01 Rev-A 1118

**Other Parts and Hardware ordered separately*

Typical Assembly with CBA-3010

