

PLR-8234

DeployPro Lock N Go

Specifications on Page 2

Configuration as shown:

Step Ladder Clamp System

Feature for DPS-8000/8001

Finish: White Powder Coat

Rack Weight (empty): 7 lbs

Load specifications as shown:

Maximum Ladder Weight..... 75 lbs

Maximum Ladder Length..... 32 ft

Maximum Ladder Section 16 ft

**Note: DeployPro purchased separately. For more information, please contact Sales & Support.*

**DeployPro System ordered separately*

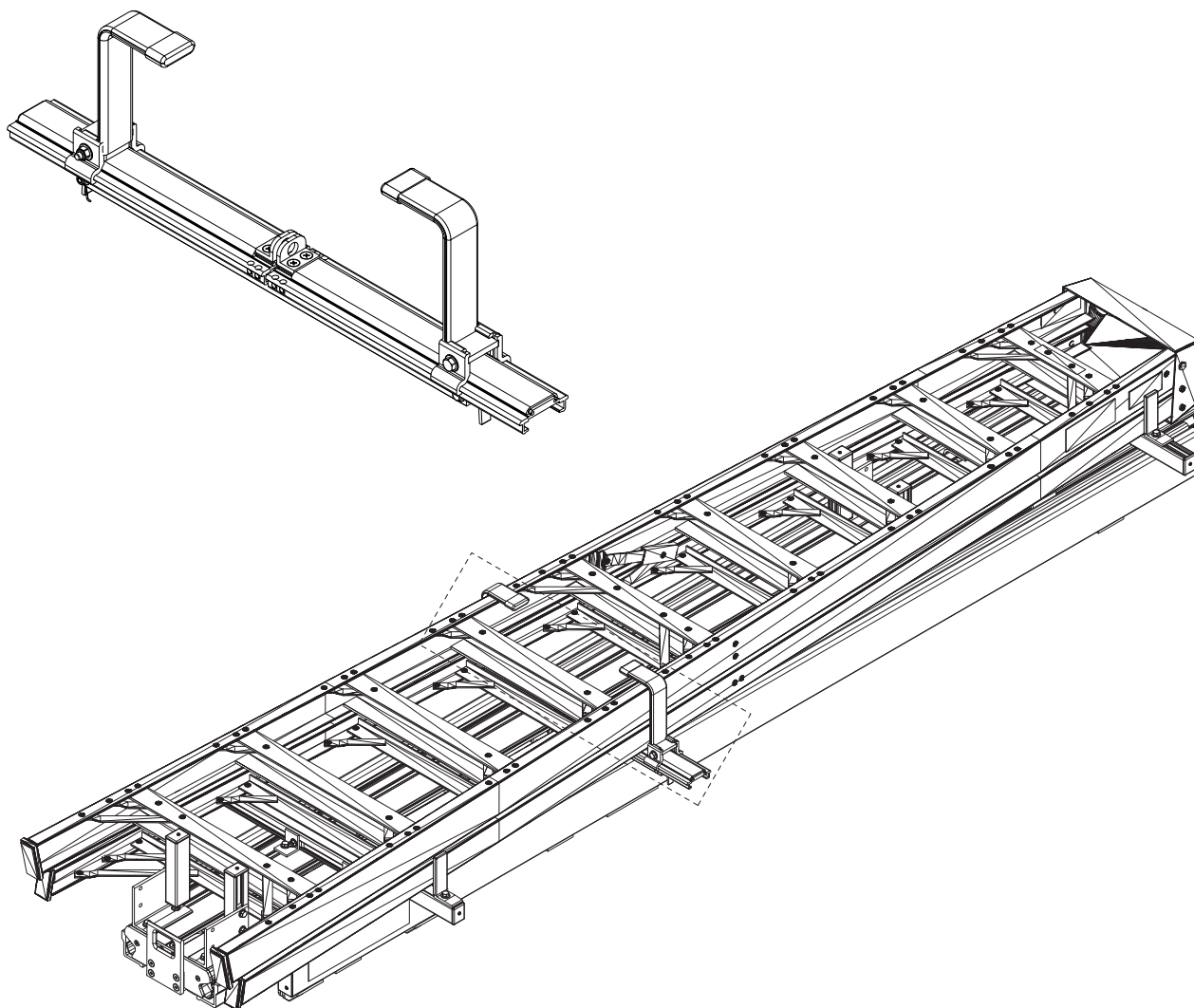

PLR-8234

DeployPro Lock N Go

Approximate height as shown:

A: Width 29.50"

B: Total Height (DPS & PLR) 13.25"

**Note: DeployPro and Ladder Rack purchased separately.
For more information, please contact Sales & Support.*

Assembly Manual also available:

PLR-8234

USOV-PLR8234-US01 Rev-A 0719

**DeployPro System and Ladder Rack ordered separately*

