

HRR-E-SP-HM

ErgoRack, Sprinter

Two Crossbars, Powder Coat Finish
Rack Weight (empty): 124 lbs

*Callouts in this Configuration Overview indicate full module assemblies only.

For details on individual parts, please refer to the linked Module Overviews below.

- A: [FBM-1008-BLK Mounting System](#)
B: [CBA-3008 Hybrid Crossbar Assembly](#)
C: [FEA-0019 Rotation Driveshaft Assembly](#)
D: [FEA-0020 Rotation Driveshaft Assembly](#)

[Modular Assembly Manuals](#)

ErgoRack Van—Load specifications:

Check vehicle manufacturer recommendations for roof capacity weight limits.

CROSSBAR SPACING	STEP LADDER	EXT. LADDER
4 ft Spacing	6 – 8 ft.	16 – 20 ft.
5 ft Spacing	8 – 10 ft.	16 – 24 ft.
6 ft Spacing	8 – 12 ft. [†]	16 – 28 ft.
7 ft Spacing	10 – 12 ft. [†]	20 – 32 ft.
8 ft Spacing	10 – 12 ft. [†]	20 – 36 ft.

[†]Rotation Configurations: 12 ft. step ladders require an extended upper add-on component.

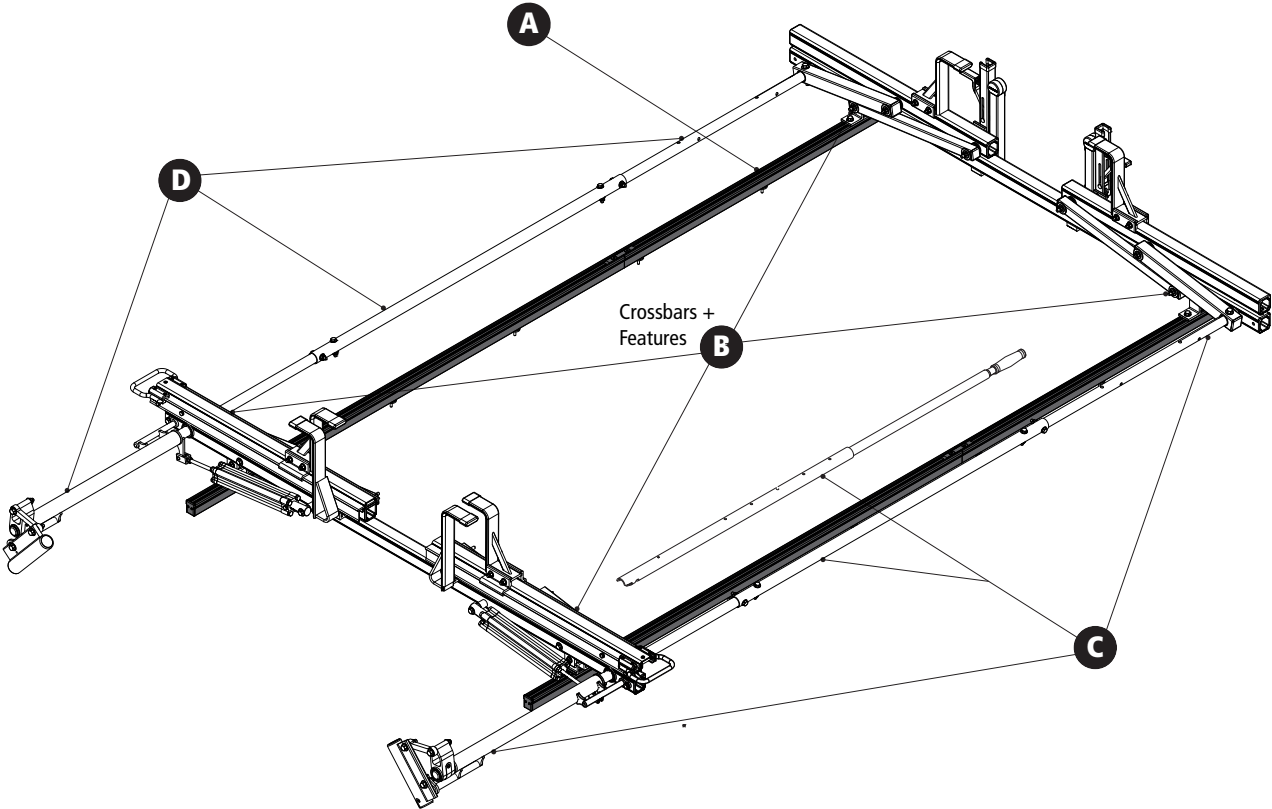

HRR-E-SP-HM

ErgoRack, Sprinter

*Approximate dimensions as shown:
Shown installed on a Sprinter L1H2*

All Wheelbases and Roof Heights

A: Rack Width	79"
B: Rack Height	16.50"
C: Rear Crossbar Offset (Left).....	10.125"
D: Mount Spacing L/R.....	52"
E: Total Crossbar Spacing.....	6'-8'
F: Rack Length	131.50"

Compatible Accessories Available

(Sold Separately)

Rear Access Ladder.....	AAL Series
8'-12' Conduit Carriers.....	CON Series
WorkPro LED Lighting.....	LED Series
Systems and Safety Components	RVS Series
Safety monitoring.....	DS2 Series

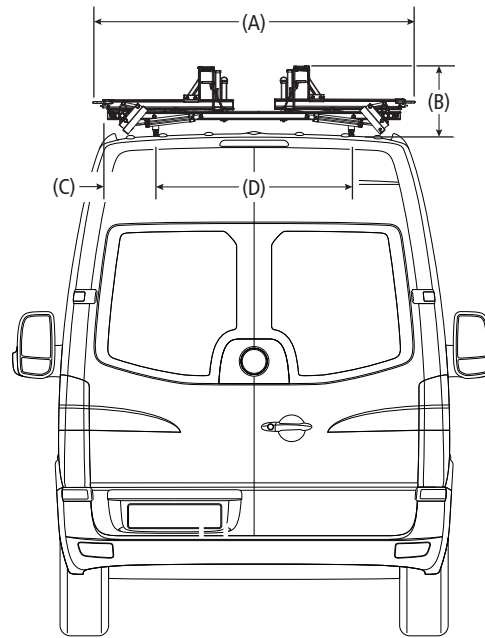

Rear Drive Shaft Offset: 29"

Note: The end of the driveshaft must not extend beyond the vehicle bumper

