

VBR-NV200-HM

ErgoRack, Nissan NV200

Two Crossbars, Powder Coat Finish
Rack Weight (empty): 59 lbs

*Callouts in this Configuration Overview indicate full module assemblies only.

For details on individual parts, please refer to the linked Module Overviews below.

- A: [FBM-1014-BLK Mounting System](#)
B: [CBA-3002 Hybrid Crossbar Assembly](#)
C: [FEA-0015 Rotation Driveshaft Feature](#)

[Modular Assembly Manuals](#)

ErgoRack Van—Load specifications:

Check vehicle manufacturer recommendations for roof capacity weight limits.

| CROSSBAR SPACING | STEP LADDER | EXT. LADDER |
|------------------|--------------------------|-------------|
| 4 ft Spacing | 6 – 8 ft. | 16 – 20 ft. |
| 5 ft Spacing | 8 – 10 ft. | 16 – 24 ft. |
| 6 ft Spacing | 8 – 12 ft. [†] | 16 – 28 ft. |
| 7 ft Spacing | 10 – 12 ft. [†] | 20 – 32 ft. |
| 8 ft Spacing | 10 – 12 ft. [†] | 20 – 36 ft. |

[†]Rotation Configurations: 12 ft. step ladders require an extended upper add-on component.

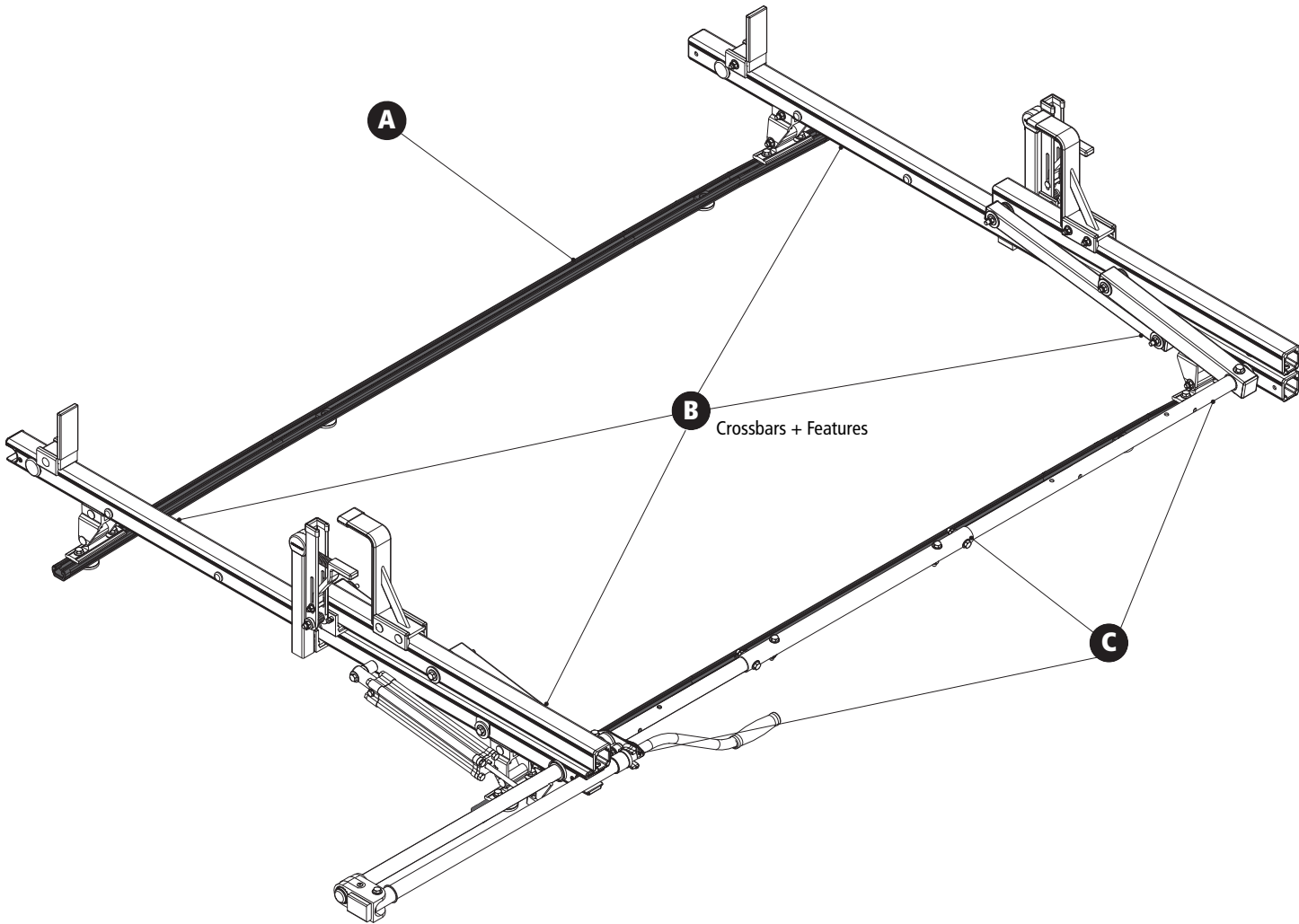

VBR-NV200-HM

ErgoRack, Nissan NV200

Approximate dimensions as shown:

| | |
|-------------------------------------|----------------|
| A: Rack Width | 62" |
| B: Rack Height | 17.50" |
| C: Rear Crossbar Offset (Left)..... | Even |
| D: Mount Bolt Spacing L/R..... | Set at install |
| E: Total Crossbar Spacing..... | 5'–7' |
| F: Rack Length | 76"–100" |

Compatible Accessories Available

(Sold Separately)

| | |
|-------------------------------------|----------------------------|
| Retractable Ratchet Tie-Down | ACC-8000 |
| 8'–12' Conduit Carriers..... | CON Series |
| WorkPro LED Lighting..... | LED Series |
| Systems and Safety Components | RVS Series |
| Safety monitoring..... | DS2 Series |

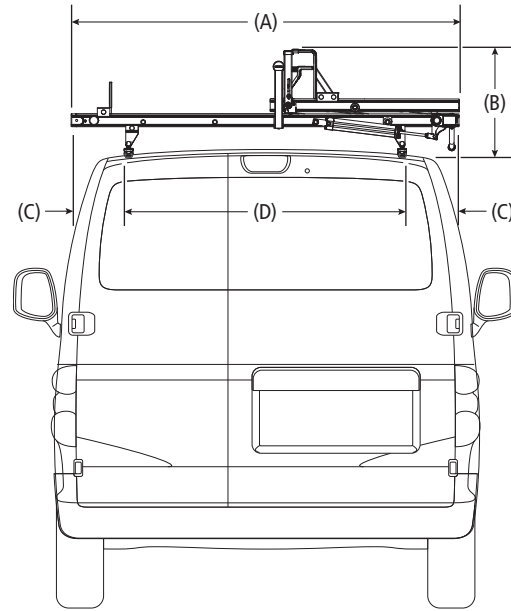

Rear Drive Shaft Offset: 24"

Note: The end of the driveshaft must not extend beyond the vehicle bumper

