

VRC-CE-M

ErgoRack, City Express

Two Crossbars, Powder Coat Finish
Rack Weight (empty): 95 lbs

*Callouts in this Configuration Overview indicate full module assemblies only.

For details on individual parts, please refer to the linked Module Overviews below.

- A:[FEA-0008 Clamp Down Assembly](#)
- B:[FBM-1014-BLK Mounting System](#)
- C:[CBR-0001 Crossbar Assembly](#)
- D:[FEA-0002 Rotation Assembly](#)
- E:[FEA-0016 Rotation Driveshaft Feature](#)

[Modular Assembly Manuals](#)

ErgoRack Van—Load specifications:

Check vehicle manufacturer recommendations for roof capacity weight limits.

CROSSBAR SPACING	STEP LADDER	EXT. LADDER
4 ft Spacing	6 – 8 ft.	16 – 20 ft.
5 ft Spacing	8 – 10 ft.	16 – 24 ft.
6 ft Spacing	8 – 12 ft. [†]	16 – 28 ft.
7 ft Spacing	10 – 12 ft. [†]	20 – 32 ft.
8 ft Spacing	10 – 12 ft. [†]	20 – 36 ft.

[†]Rotation Configurations: 12 ft. step ladders require an extended upper add-on component.

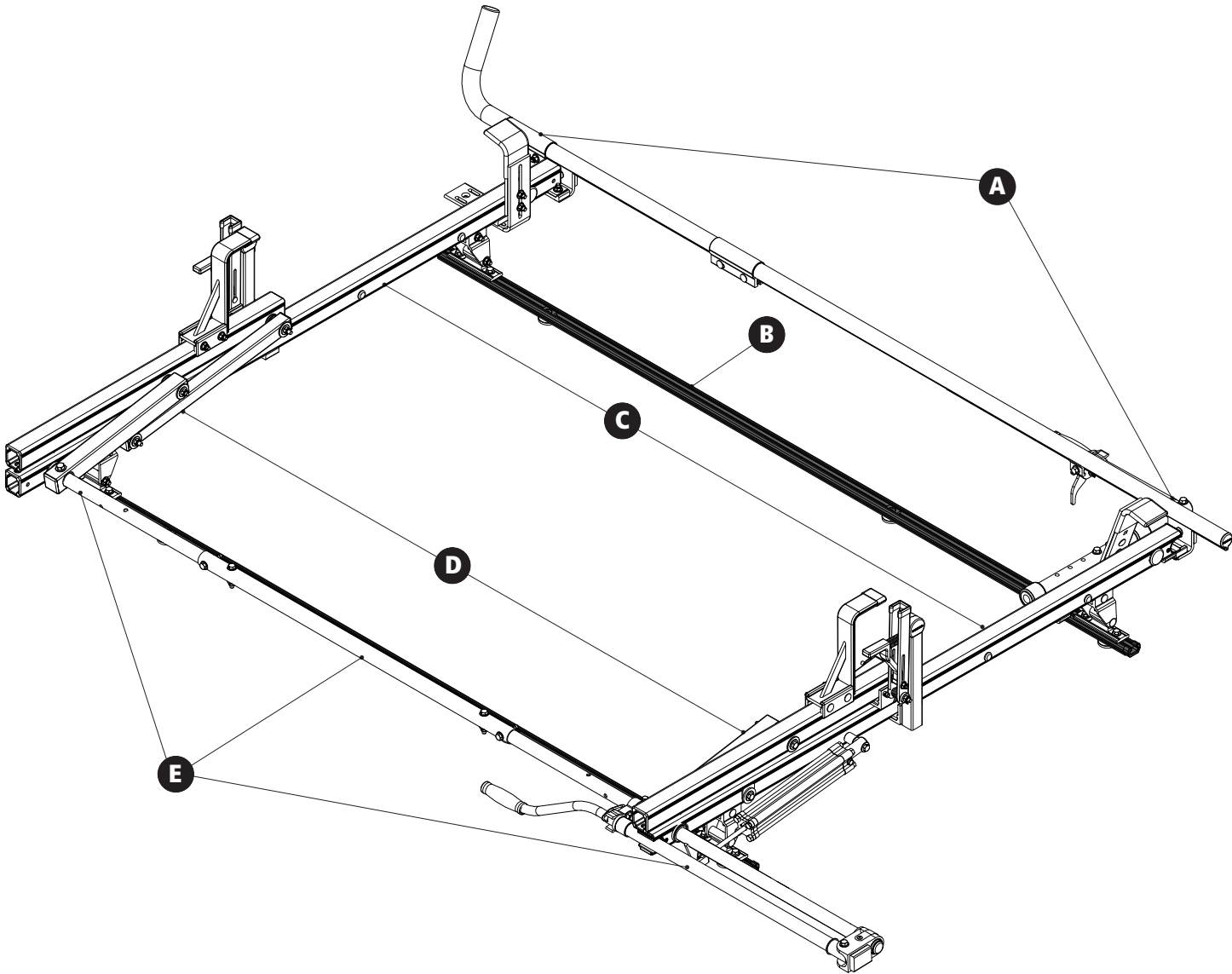

VRC-CE-M

ErgoRack, City Express

Approximate dimensions as shown:

A: Rack Width	66"
B: Rack Height	17.50"
C: Rear Crossbar Offset (Left).....	Even
D: Mount Bolt Spacing L/R.....	Set at install
E: Total Crossbar Spacing.....	5'–7'
F: Rack Length	88"–124"

Compatible Accessories Available

(Sold Separately)

8'–12' Conduit Carriers.....	CON Series
WorkPro LED Lighting.....	LED Series
Systems and Safety Components	RVS Series
Safety monitoring.....	DS2 Series

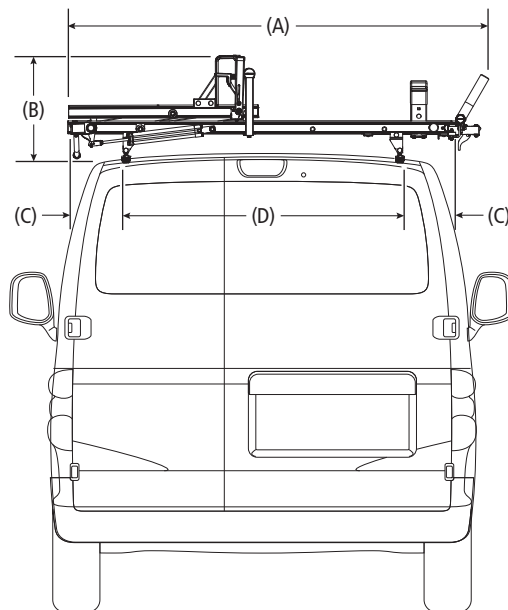

Rear Drive Shaft Offset: 24"

Note: The end of the driveshaft must not extend beyond the vehicle bumper

