

# PRIME DESIGN™

A Safe Fleet Brand

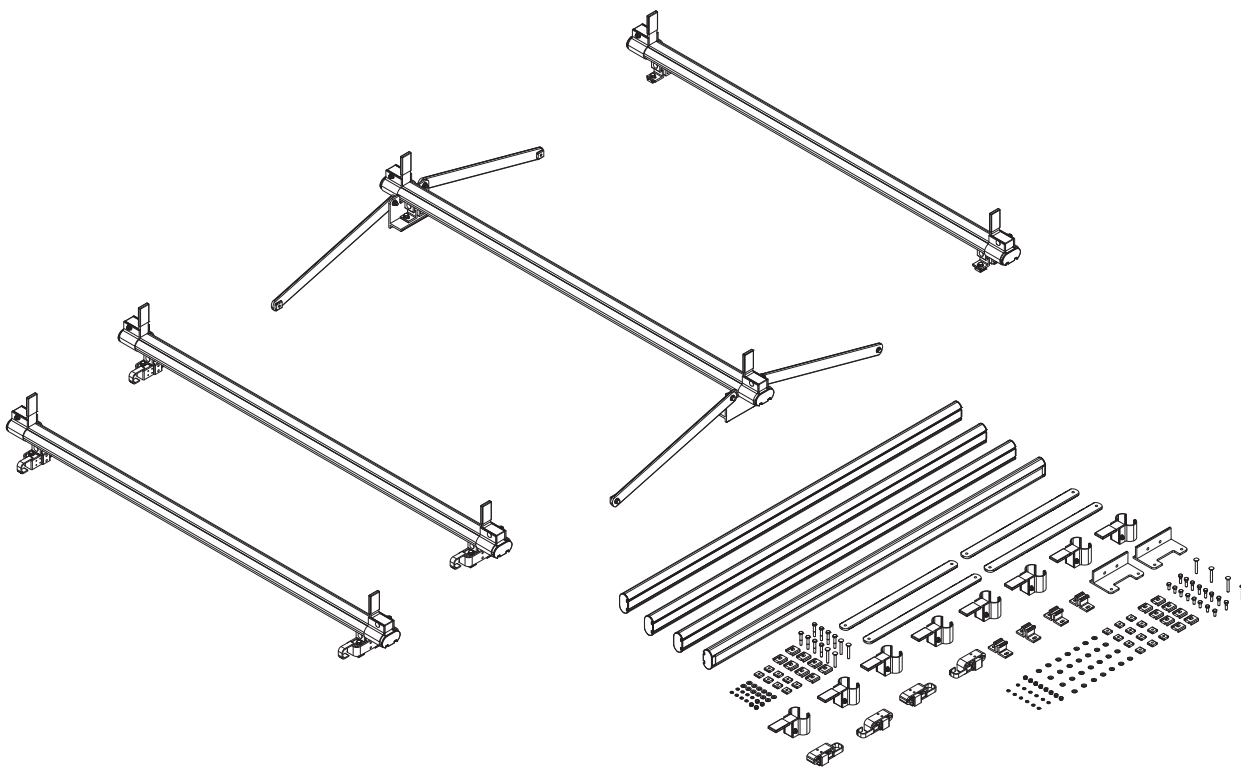

## *OVER THE CAB 4-CROSSBAR MODULE*

PRIME DESIGN, A SAFE FLEET BRAND

Address: 580 Opperman Drive, Eagan, MN 55123 • Toll Free: 1.8.PRIME.RACK

Fax: 651-552-1799 • Email: [info@primedesign.net](mailto:info@primedesign.net) • Website: [www.primedesign.net](http://www.primedesign.net)

# OCM-3030

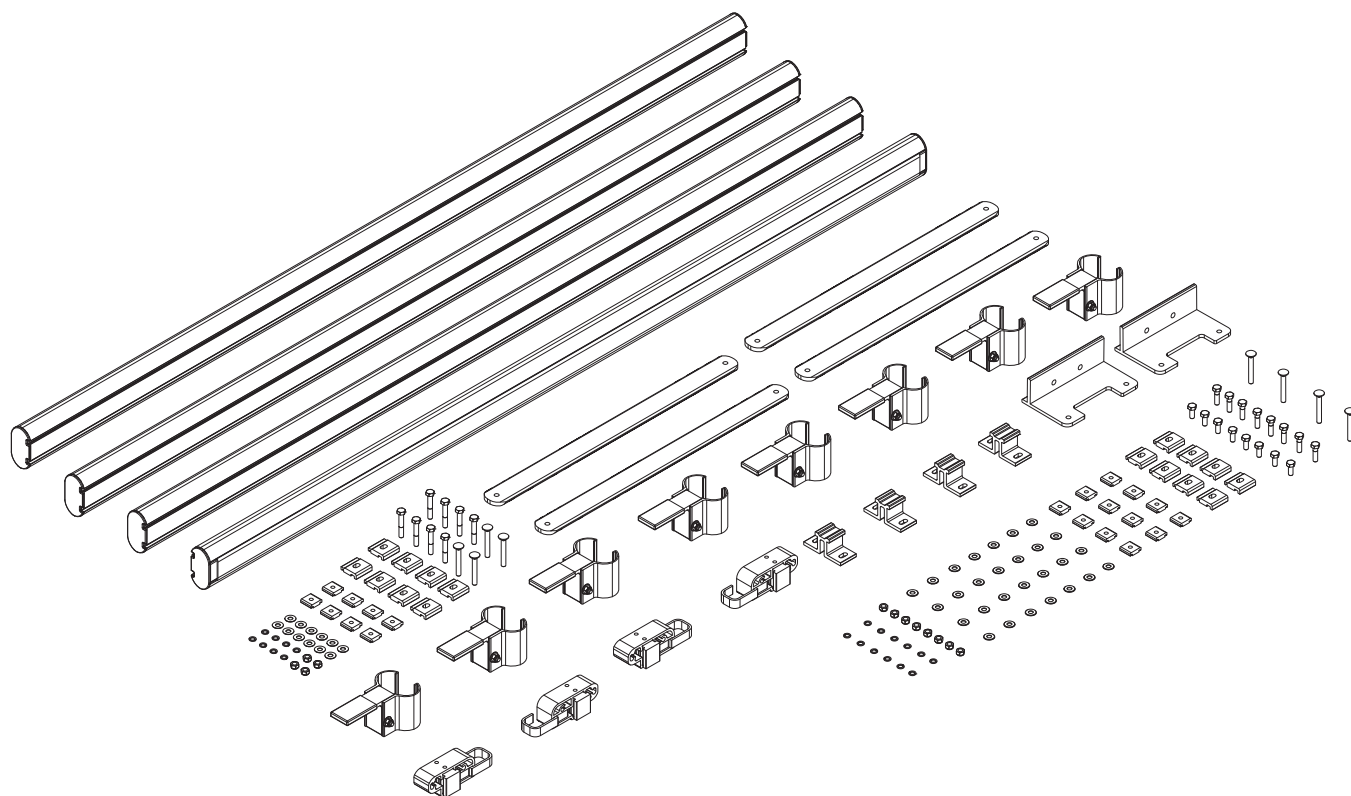

Pickup Crossbar ..... (Qty 4)  
67.00", with caps

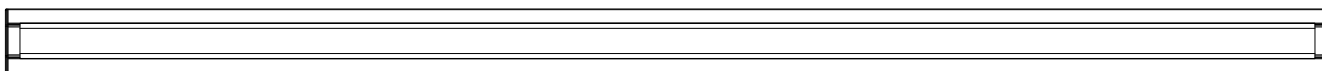

Side Rail Tension Brace ..... (Qty 4)



Crossbar to Channel Connector ..... (Qty 4)



Pickup Rack End Stop..... (Qty 8)

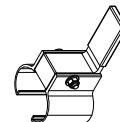

LH Removable Crossbar Mount ..... (Qty 2)

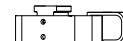

RH Removable Crossbar Mount..... (Qty 2)

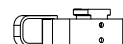

Tension Brace Mounting Bracket..... (Qty 2)

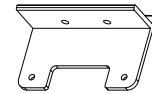

HKT-0183 Removable Crossbar Hardware Kit (x2)

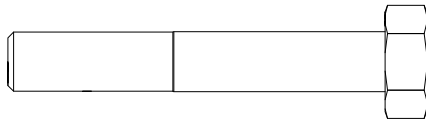

M8 x 50MM (4X)

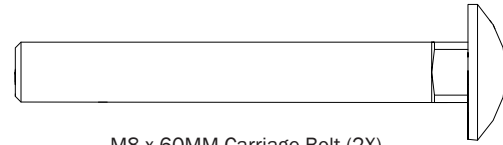

M8 x 60MM Carriage Bolt (2X)

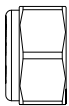

M8 Lock Nut (2X)

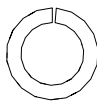

Lock Washer (4X)

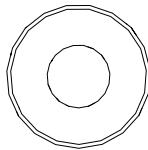

5/16" Flat Washer (6X)

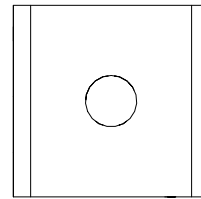

M8 Nut Bracket (4X)

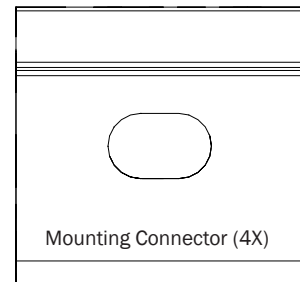

Mounting Connector (4X)

HKT-0182 Standard Crossbar Kit

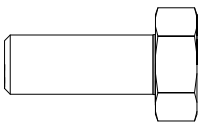

M8 x 20MM (8X)

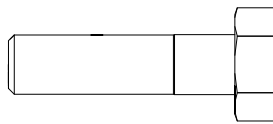

M8 x 30MM (8X)

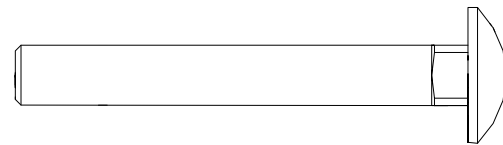

M8 x 60MM Carriage Bolt (4X)

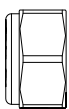

M8 Lock Nut (8X)

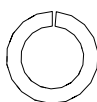

Lock Washer (12X)

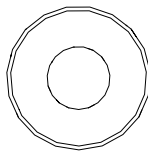

5/16" Flat Washer (28X)

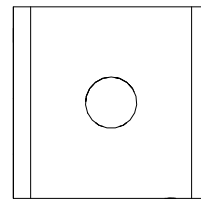

M8 Nut Bracket (12X)

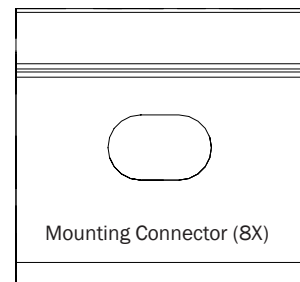

Mounting Connector (8X)

Anti-Seize (included with all Hardware Kits)



## ASSEMBLY INSTRUCTIONS

NOTE: Channels in this Overview are shown for reference only. Specific channels and configurations are determined by Service Body size.

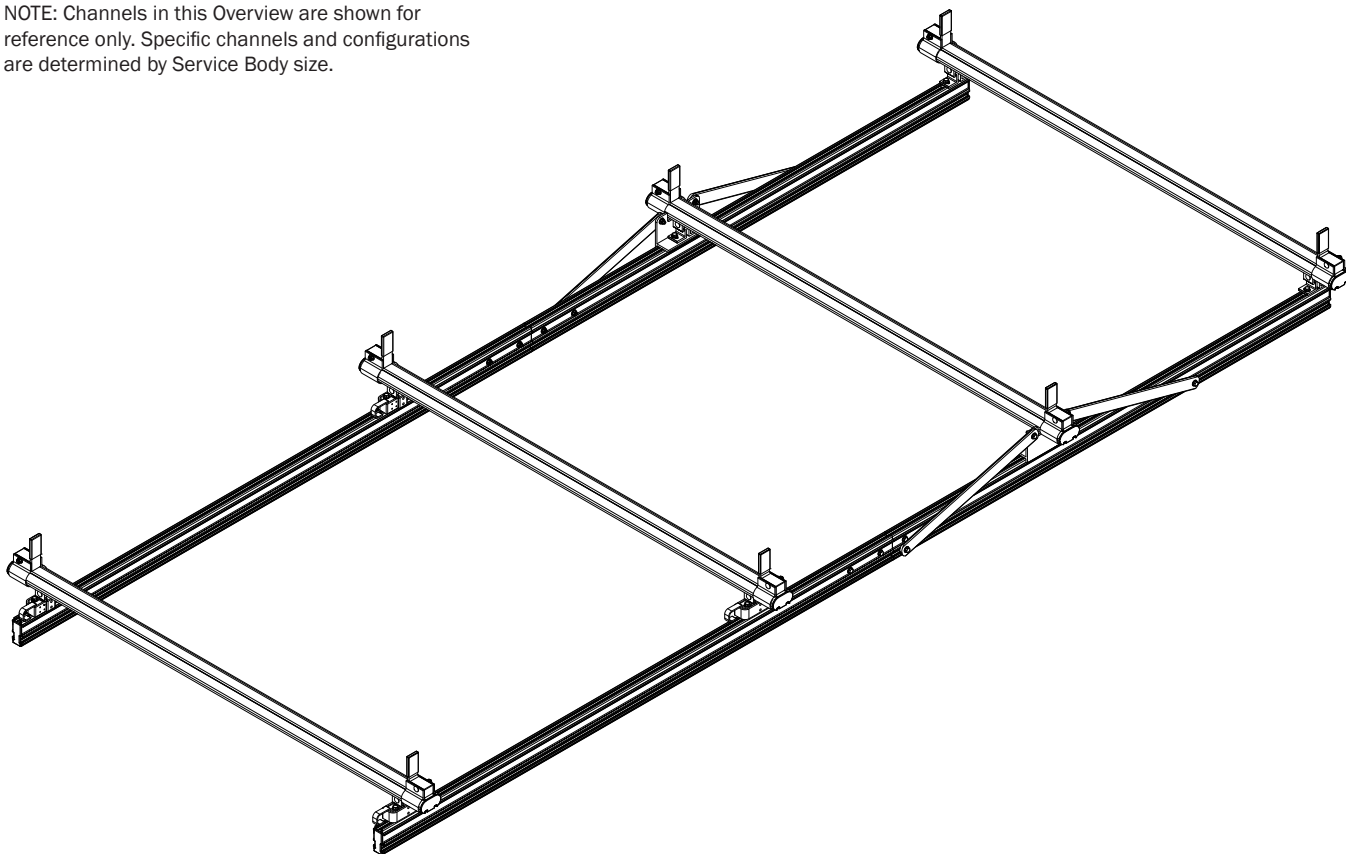

### CROSSBAR MOUNT BUILDS

- 1.1** Install M8 Nut Brackets and Hardware from HKT-0183 into the Removable Crossbar Mounts as shown, but do not fully tighten.

NOTE: Approximate Mount placements on the Channels shown below for clarity.

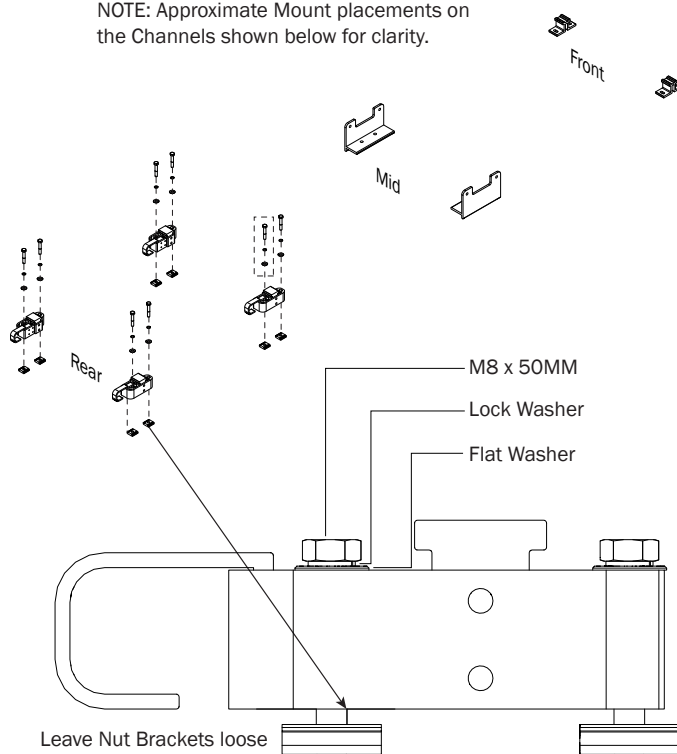

- 1.2** Set two Crossbar to Channel Connectors onto the Tension Brace Mounting Brackets as shown below, and install M8 Nut Brackets and Hardware from HKT-0182. Do not fully tighten.

Note differing Bolt sizes below. Lock Washers and Flat Washers are used with all Bolts as shown.

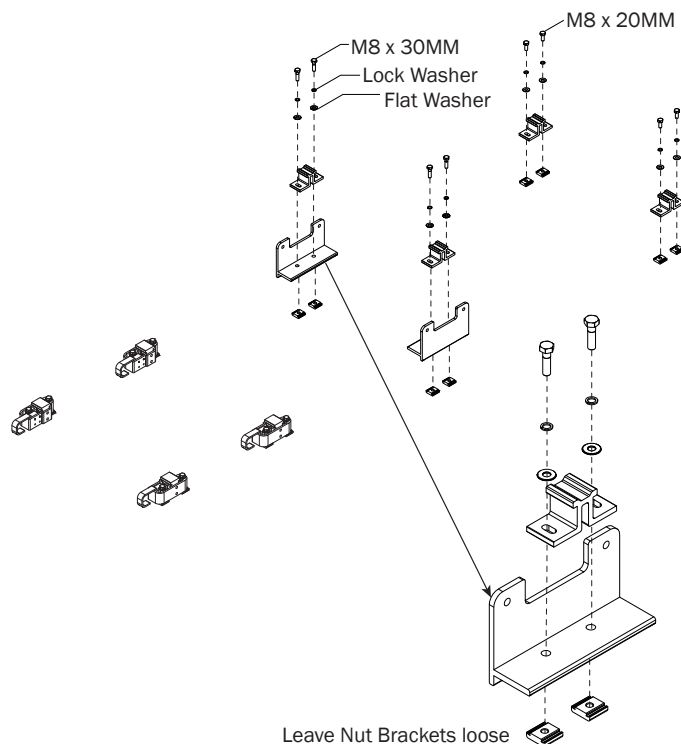

1.3

Install the Mounting Connectors along with Hardware from HKT-0182 and HKT-0183 as shown in example below (M8 x 60MM Carriage Bolts are used on all Connectors). Finger-tighten only until Step 3.2.

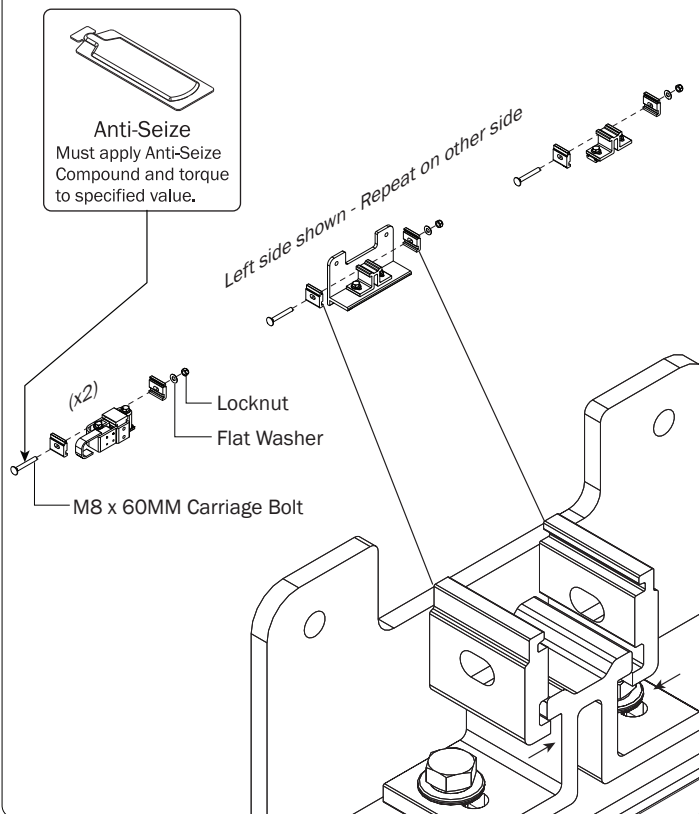

## CROSSBAR MOUNTS INSTALLATION

2.1

Install Mounts into Channels as shown below.

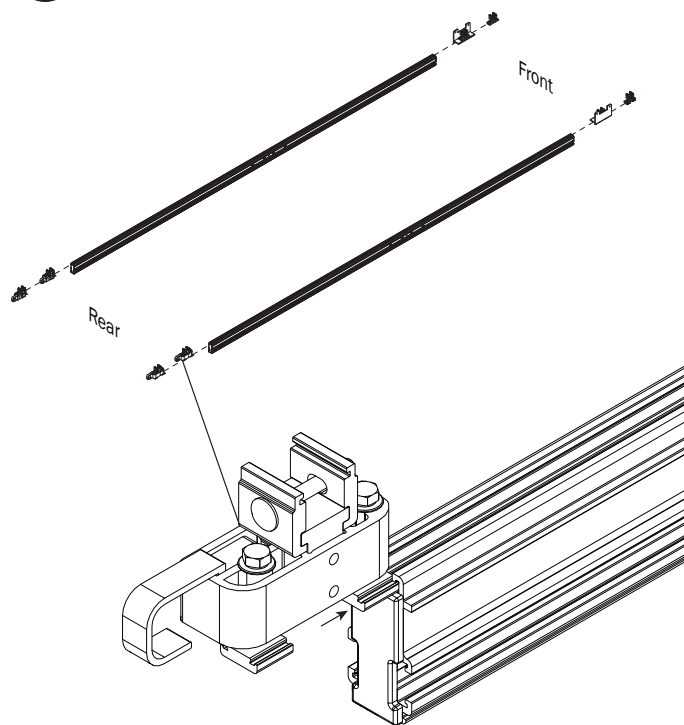

2.2

Set to distances according to your Service Body sizing. Recommended distances are shown below.

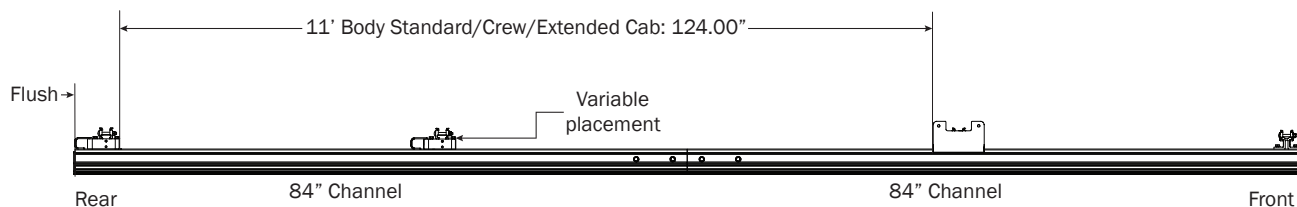
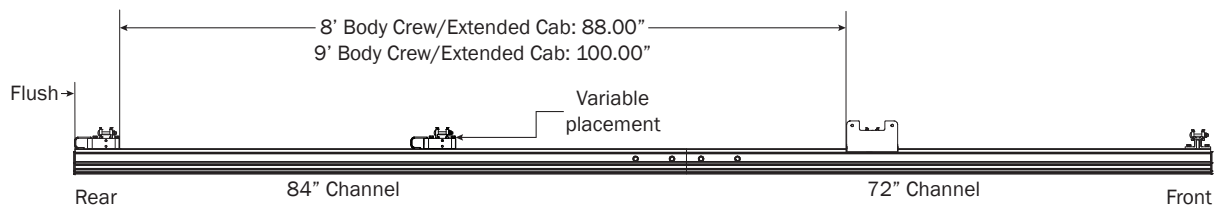
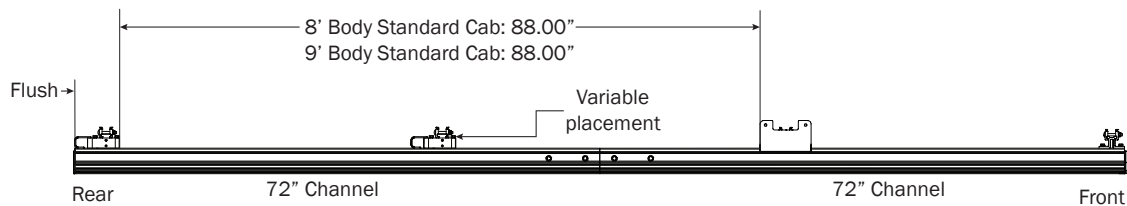

**2.3** Torque Front Mount Hardware to 90 in-lbs as shown.

NOTE: Finger-tighten Mid and Rear Mounts only at this time. Final Adjustments will be shown in your configuration's FBM Manual.

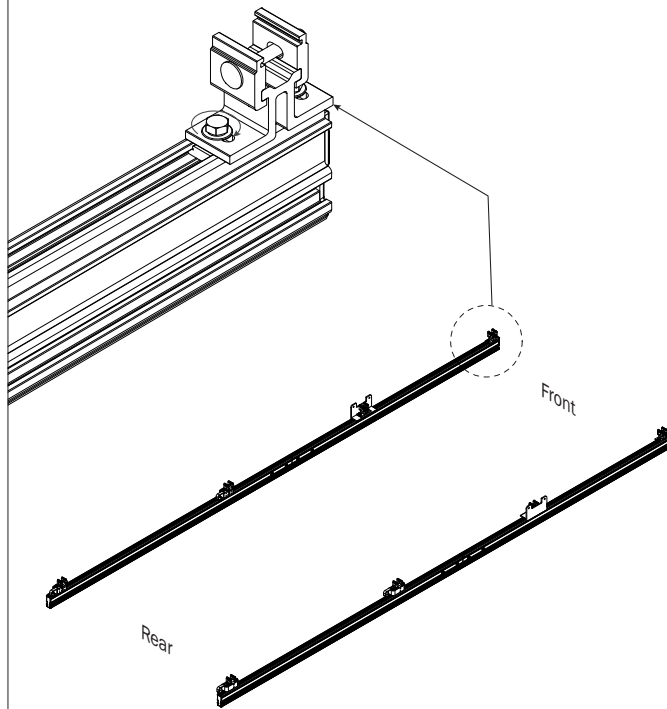
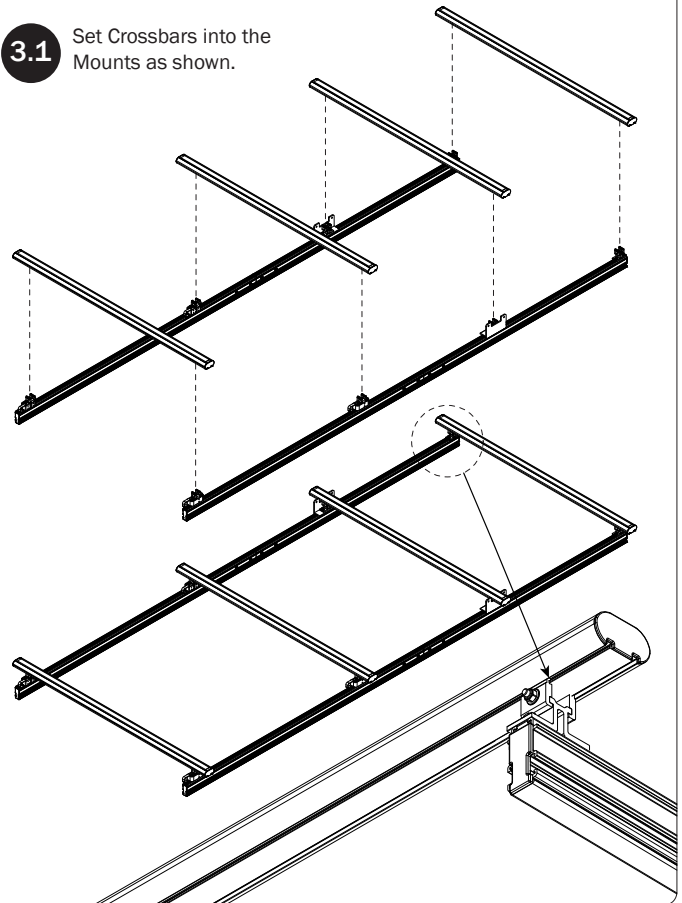
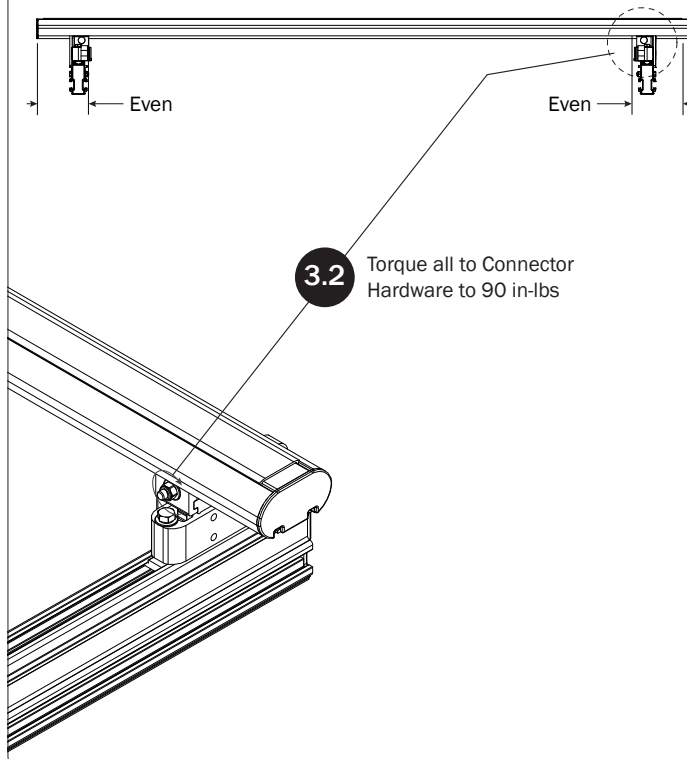
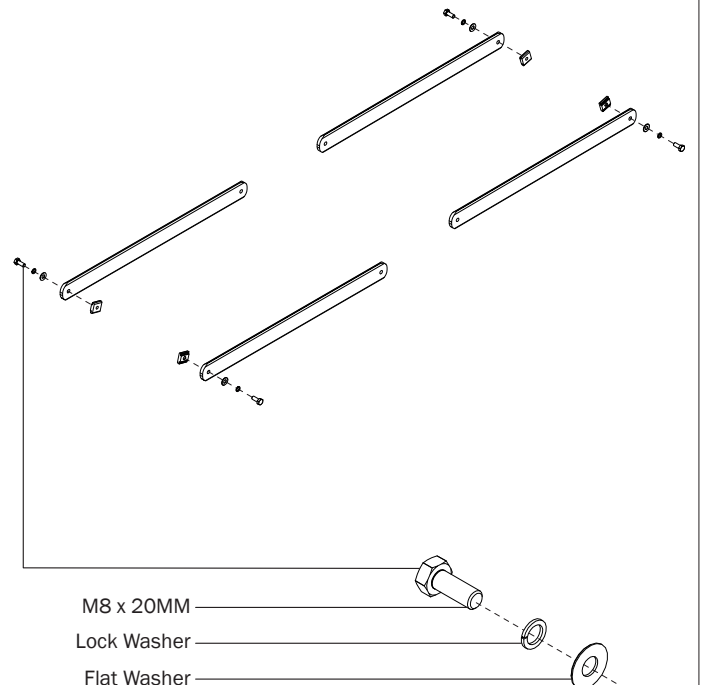
**CROSSBARS****3.1** Set Crossbars into the Mounts as shown.**CROSSBAR ADJUSTMENT****3.2** Torque all to Connector Hardware to 90 in-lbs**TENSION BRACE INSTALLATION****4.1** Install M8 Nut Brackets and Hardware from HKT-0182 as shown, but do not fully tighten. 20MM Bolts, Lock Washers, and Flat Washers are used as shown.

- 4.2** Install Tensions Braces into the Channel sides as shown below.

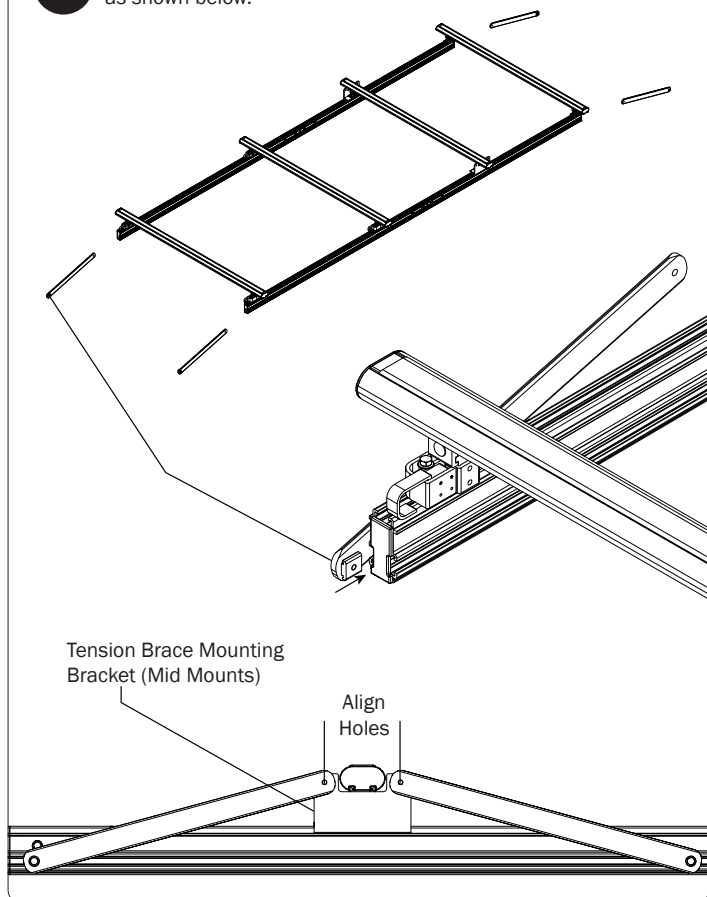

- 4.3** Install Hardware from HKT-0182: 30MM Bolts, Flat Washers, and Locknuts are used as shown.

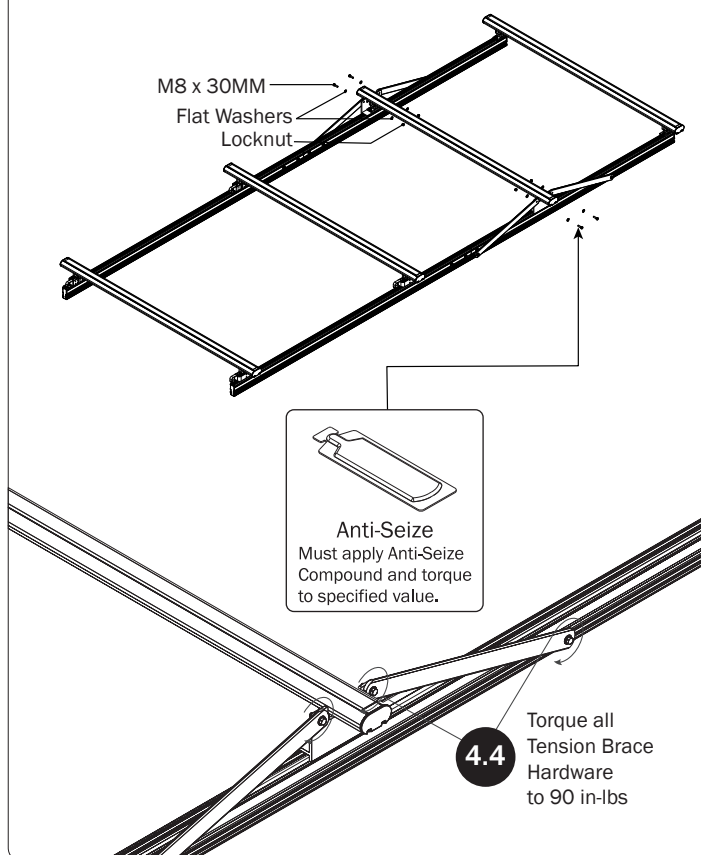

## LADDER STOPS

- 5** Attach Ladder stops as shown and torque to 90 in-lbs.

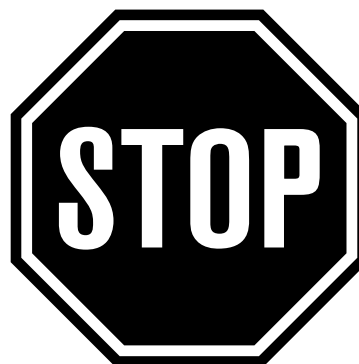
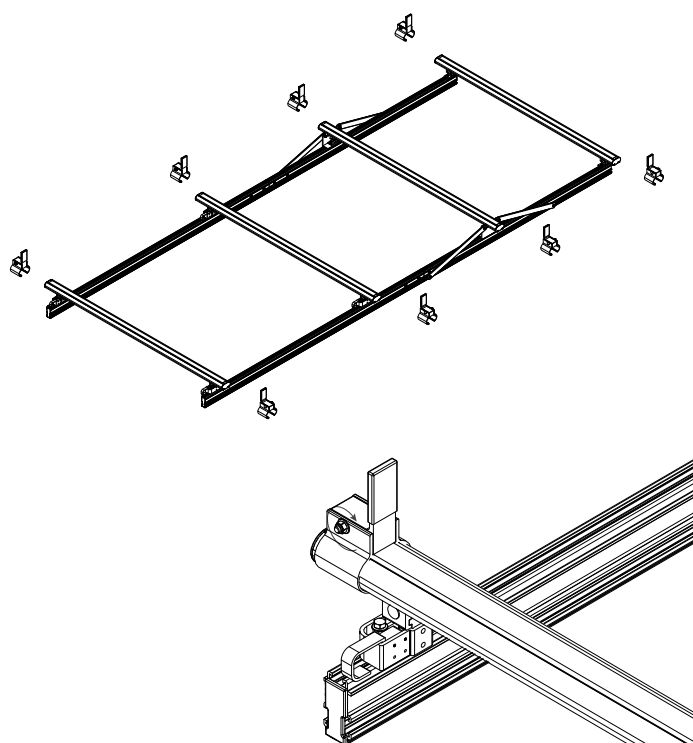

Refer to the respective FBM Assembly Manual(s) included with your chosen rack configuration features.

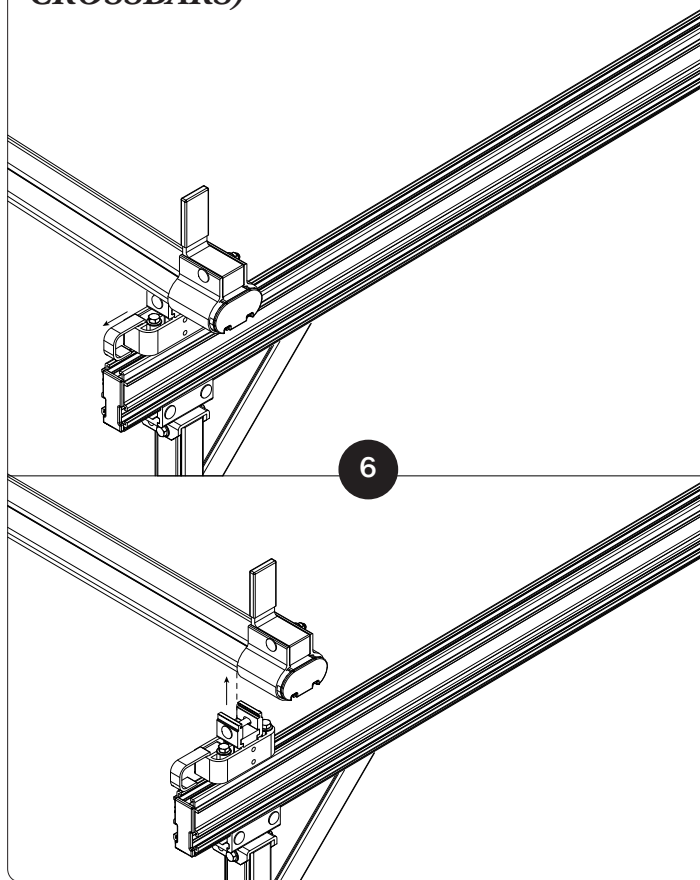

**EASY PULL LATCH (REMOVABLE CROSSBARS)****OPTIONAL EASY PULL LATCH LOCKING BOLT**

- 7** The Easy Pull Latch Locking Bolt may be used if desired as shown below.

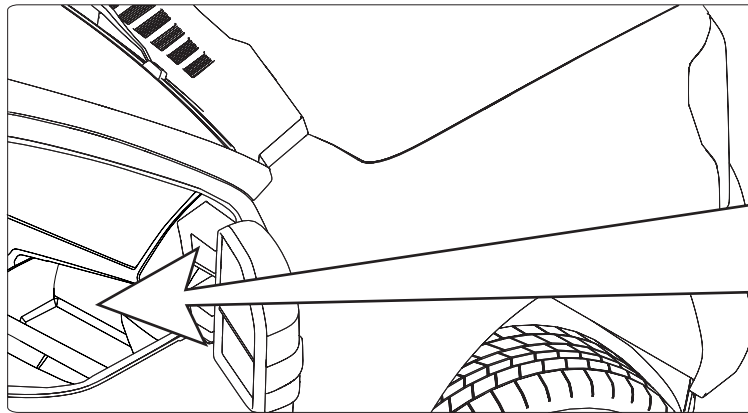
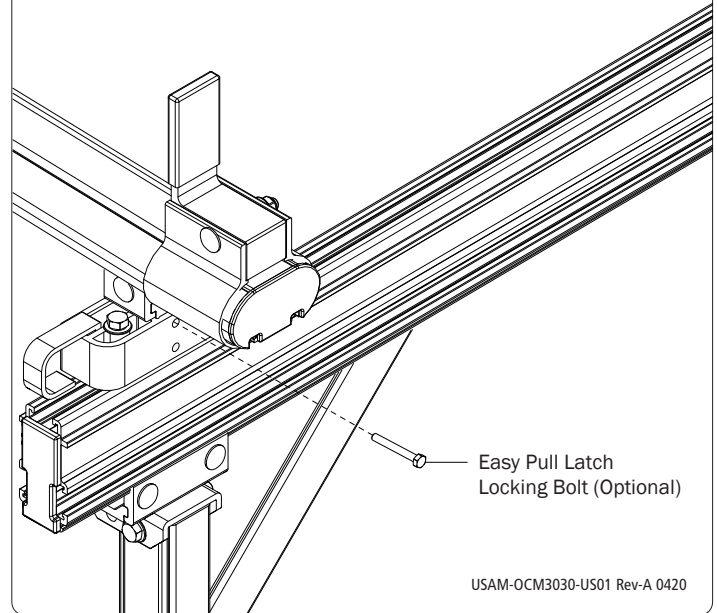
**INSTALLER NOTE:**

Place all manuals and extra hardware into the vehicles glove compartment after installation.

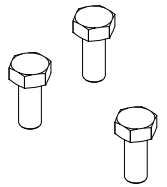

Professionally installed by: \_\_\_\_\_

Date: \_\_\_\_\_

Notes: \_\_\_\_\_

\_\_\_\_\_  
\_\_\_\_\_  
\_\_\_\_\_