

PRIME DESIGN™

A Safe Fleet Brand

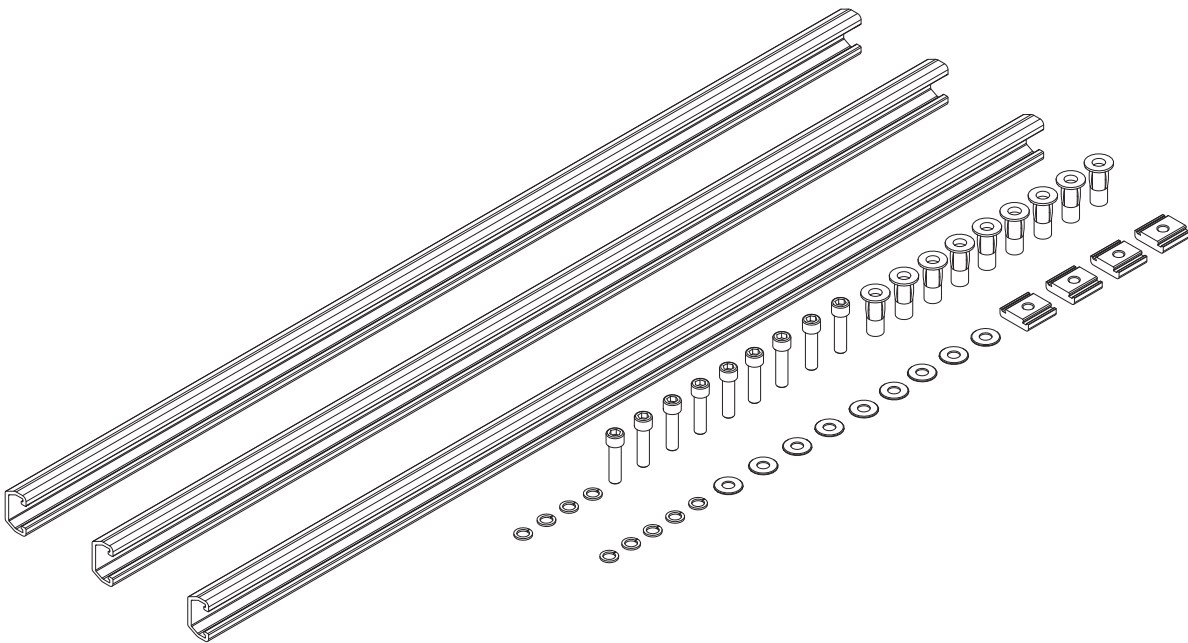

2 Person Lift Recommended

Cantilever Shelving Mounting Assembly– ProMaster

Page 2–3	Packaging Contents & Requirements
Page 3–4	Assembly Instructions
Page 5–13	ProMaster Layouts

CSM-1014

CONTENTS OVERVIEW

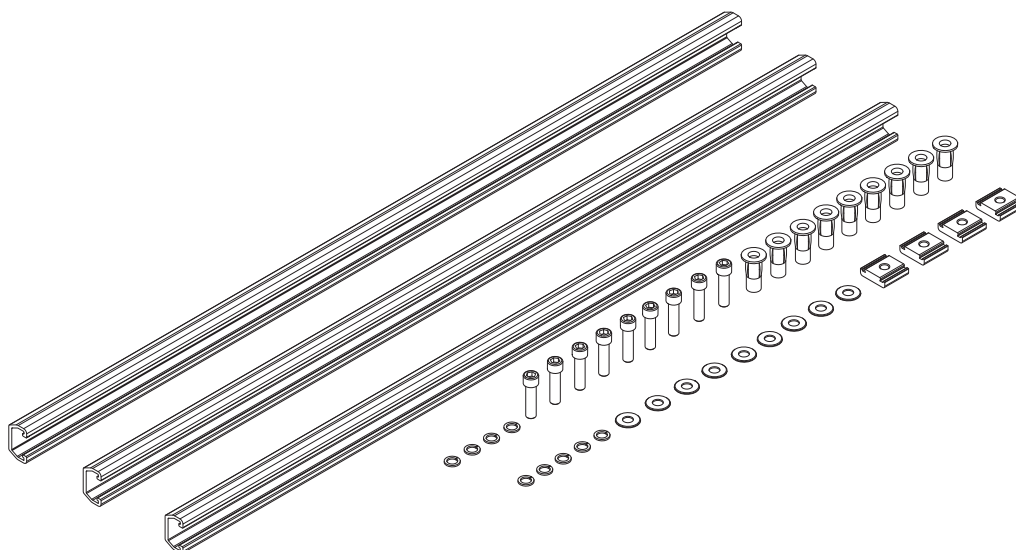

- 1—Canilever Shelving Mounting Channel..... (Qty 3)
ProMaster, 30.00"



Mounting Channel

- 2—HKT-0209 (Qty 1)
ProMaster Mounting Hardware Kit

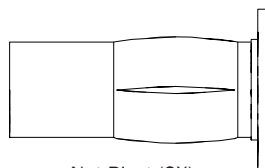

Nut Rivet (9X)

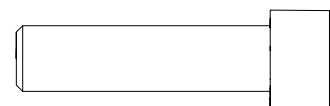

M8 x 30MM (9X)

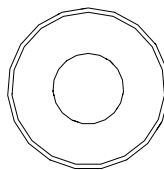

Flat Washer (9X)

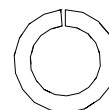

Lock Washer (9X)

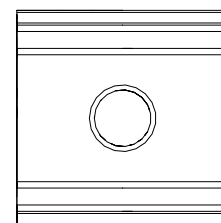

Nut Bracket (4X)

- 3—Hardware supplied in Cantilever Shelving Upright
Packaging (sold separately).

* Used in Steps 3.1–3.2

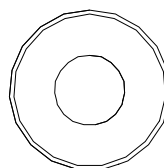

Flat Washer (1X)

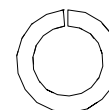

Lock Washer (1X)

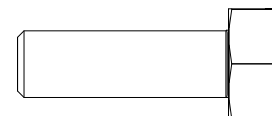

M8 x 25MM (1X)

ASSEMBLY REQUIREMENTS



INSTALLER NOTE: It is important to correctly follow these assembly instructions. These instructions for assembly are provided by the manufacturer at time of Cantilever Shelving delivery, and reflect the technical specifications applicable at the time of writing.

- These instructions are subject to change if the manufacturer revises the parts and/or production of the subsystems and accessories used in the brand's vehicles. Following the instructions for assembly will ensure proper installation of the product. The manufacturer will not be held liable if these instructions are not followed.
- The addition of parts and/or components not original to this Cantilever Shelving are discouraged. Use only OEM supplied parts.
- Consultation of the OEM vehicle may be required during assembly to avoid vehicle damage. Ensure bolt locations will not damage any critical parts of the vehicle—i.e. gas tank, wiring harnesses, or hoses—before drilling.

REQUIRED

Plus Nut Applicator Tool

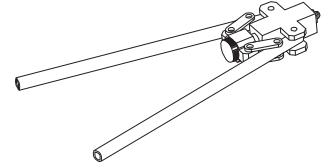

Torque Wrench w/
13MM Socket, and
6MM Hex Bit Socket

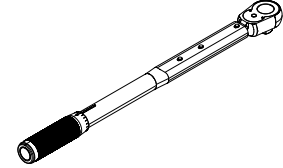

Power Drill w/
½" Drill Bit

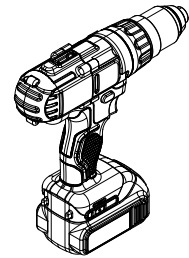

HARDWARE INSTALLATION PROCEDURES

NOTE: Mounting Assembly Layouts and Placements vary according to your Vehicle Model. Refer to views on pages 4–12 to determine your Model configuration, and install according to your OEM.

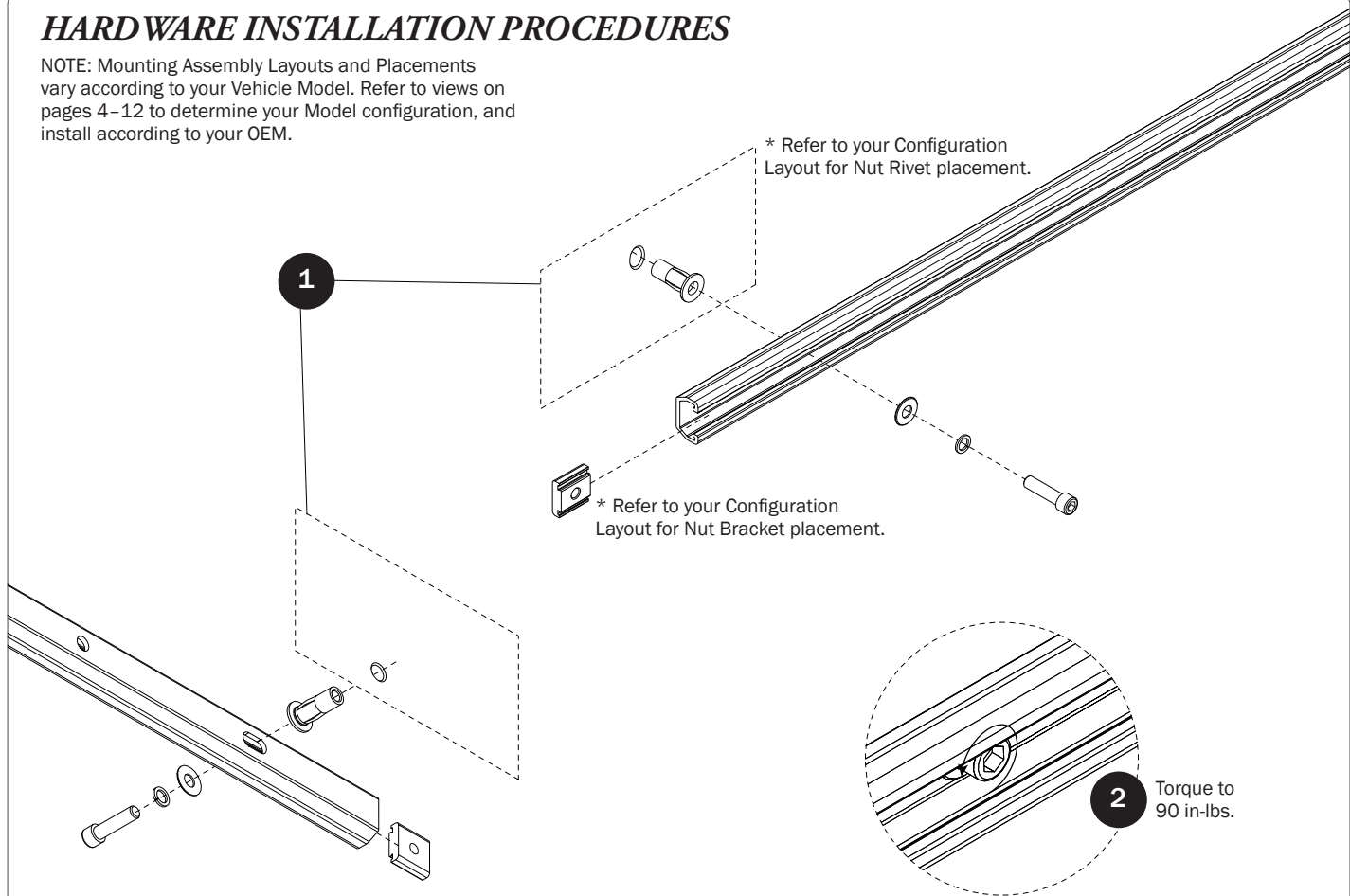

UPRIGHT INSTALLATION PROCEDURES

- 3.1** Install Cantilever Shelving Uprights using provided Upright Hardware (sold separately) into Mounting Channel Nut Brackets as shown below.

NOTE: Shelving is removed from the views below for illustrative purposes only.

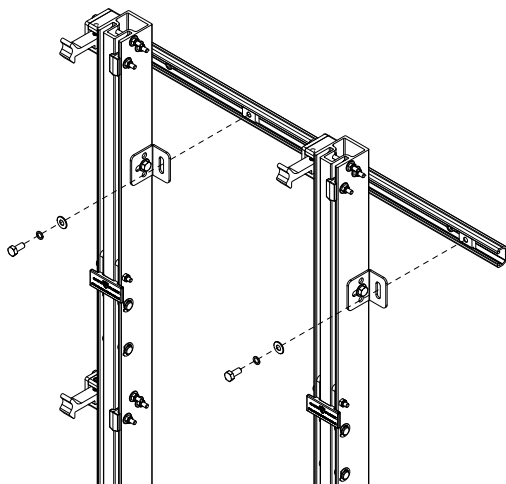

Torque Hardware
to 90 in-lbs.

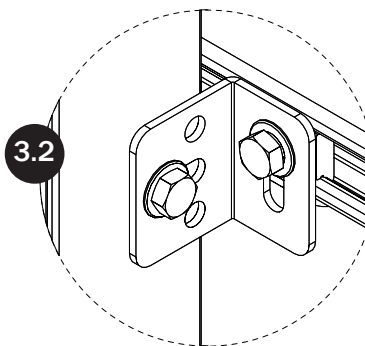
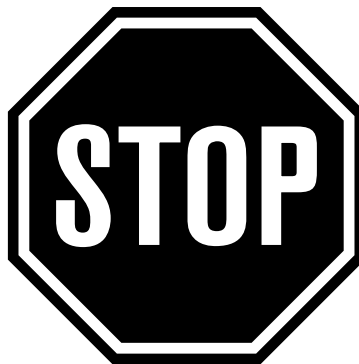
**CANTILEVER SHELVING LAYOUTS
FOR PROMASTER**

NOTE: Drilling into the vehicle wall and cutting a Mounting Channel may be required for proper fitting, according to varying wall layout and door placements. Refer to views on pages 5–13 to determine your Model configuration, and install according to your OEM.



WARNING: Before drilling, ensure the bolt location will not damage any critical parts of the vehicle

CANTILEVER SHELVING LAYOUT: LOW ROOF, 118" WHEEL BASE (PM11)

DRIVER SIDE ONLY

Drill into indicated locations and
install Nut Rivets as shown.

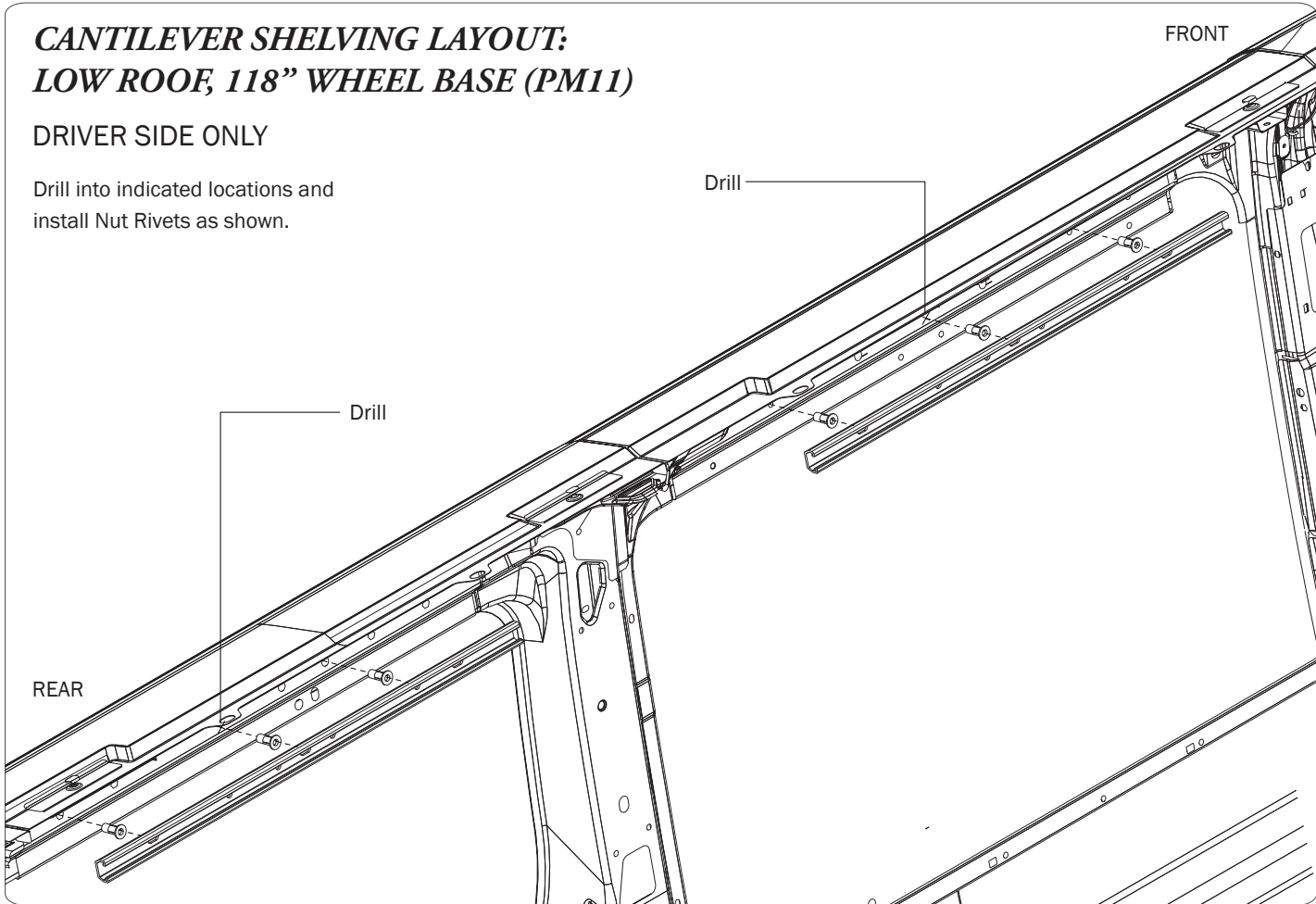

Install Hardware and Uprights in the sequence shown according to the
Hardware and Upright Installation Procedures on Page 3.

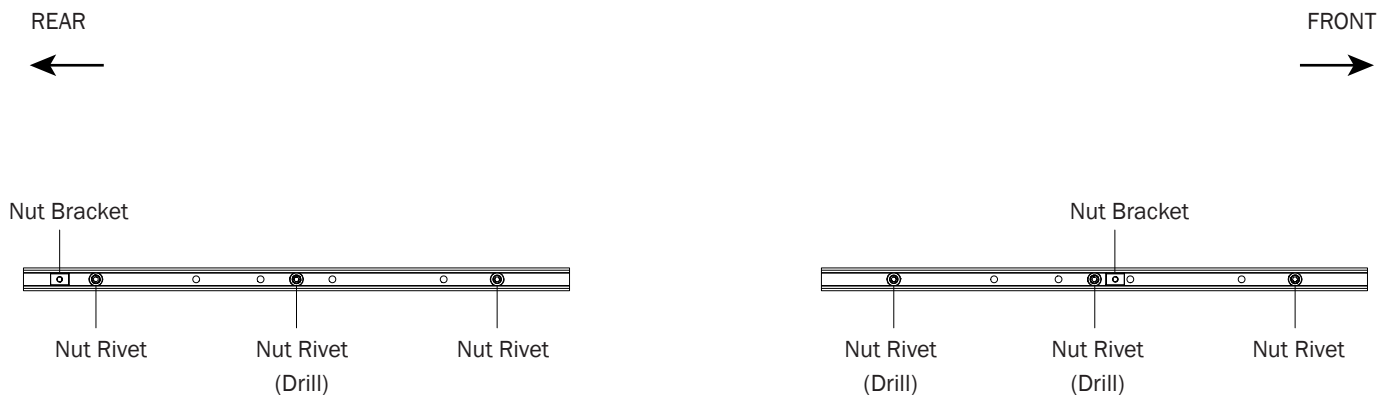

CANTILEVER SHELVING LAYOUT: LOW ROOF, 136" WHEEL BASE (PM21)

DRIVER SIDE

Cut center channel as shown (approximately 15.50")
to fit your wall layout.

Drill into indicated locations and
install Nut Rivets as shown.

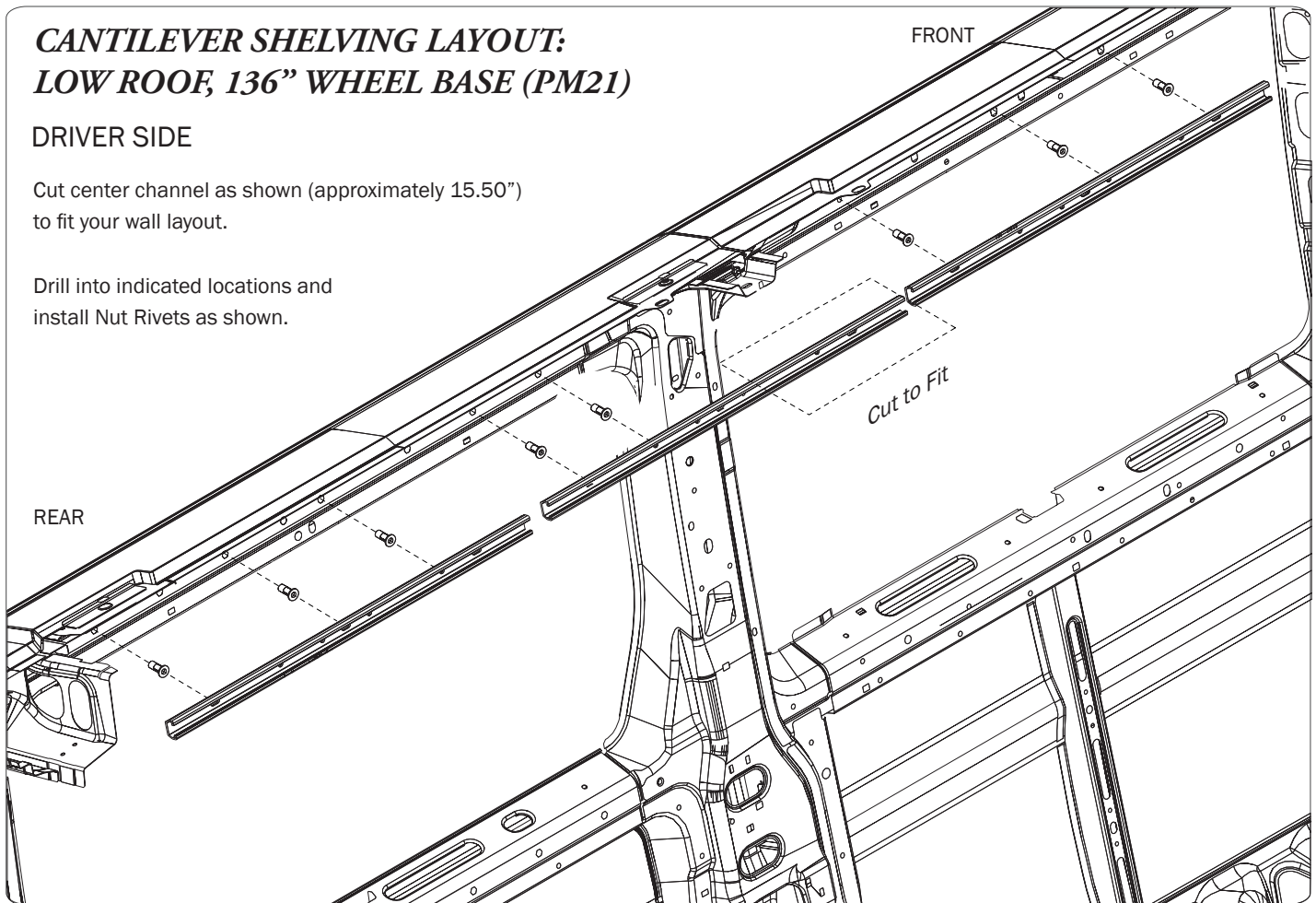

Install Hardware and Uprights in the sequence shown according to the
Hardware and Upright Installation Procedures on Page 3.

REAR



FRONT

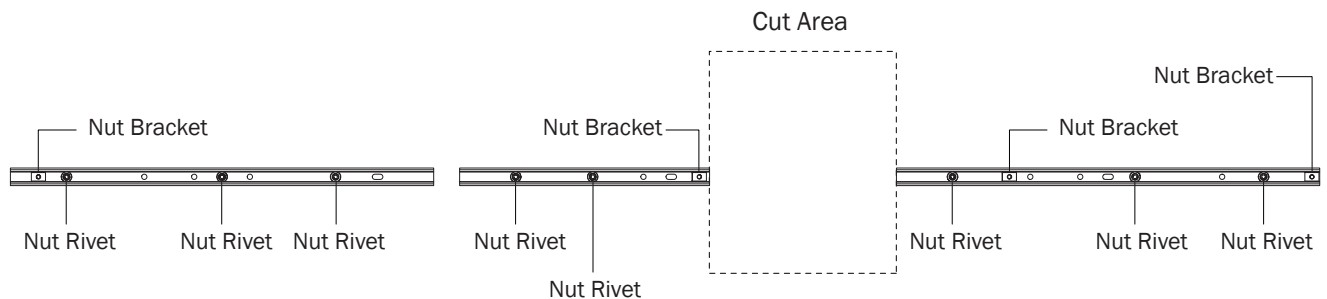

CANTILEVER SHELVING LAYOUT: LOW ROOF, 136" WHEEL BASE (PM21)

PASSENGER SIDE

Cut front channel as shown (approximately 15.50")
to fit your wall layout.

Drill into indicated locations and
install Nut Rivets as shown.

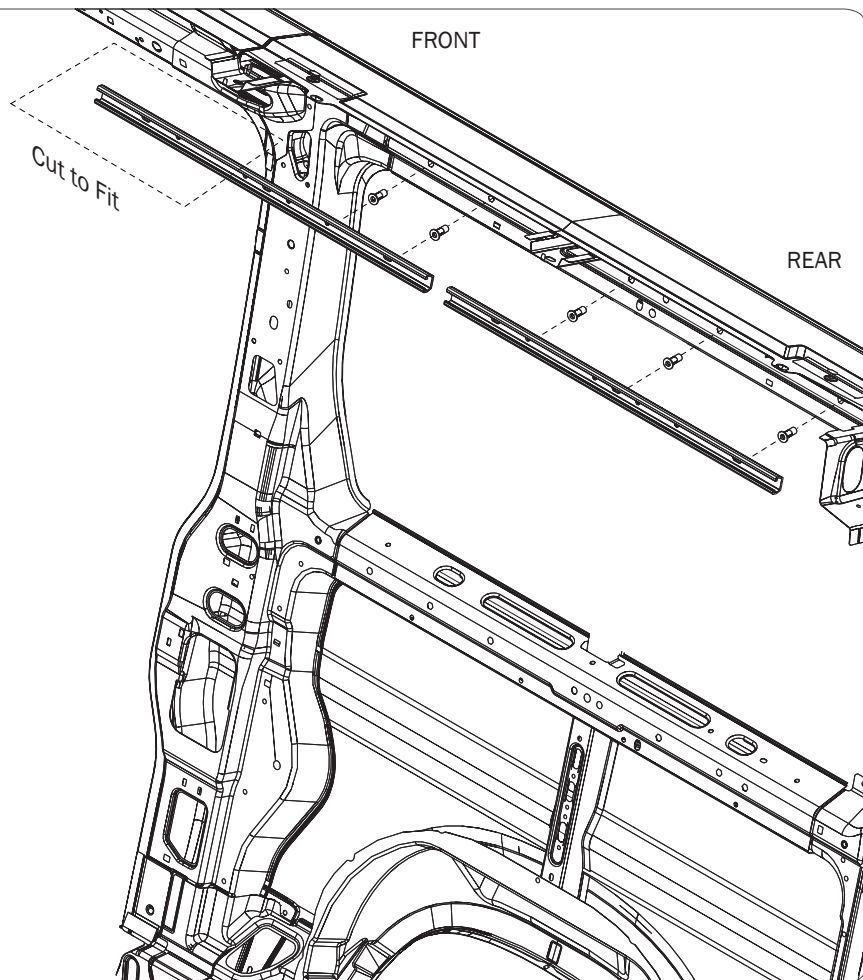

Install Hardware and Uprights in the sequence shown according to the
Hardware and Upright Installation Procedures on Page 3.

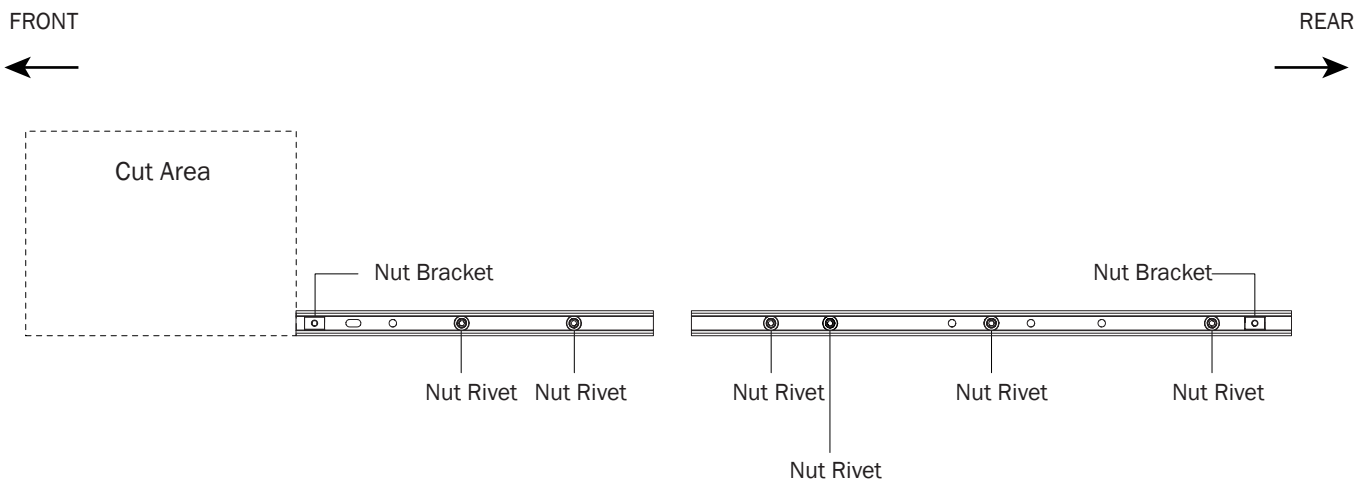

CANTILEVER SHELVING LAYOUT: HIGH ROOF, 136" WHEEL BASE (PM22)

DRIVER SIDE

Cut center channel as shown (approximately 15.50")
to fit your wall layout.

Drill into indicated locations and
install Nut Rivets as shown.

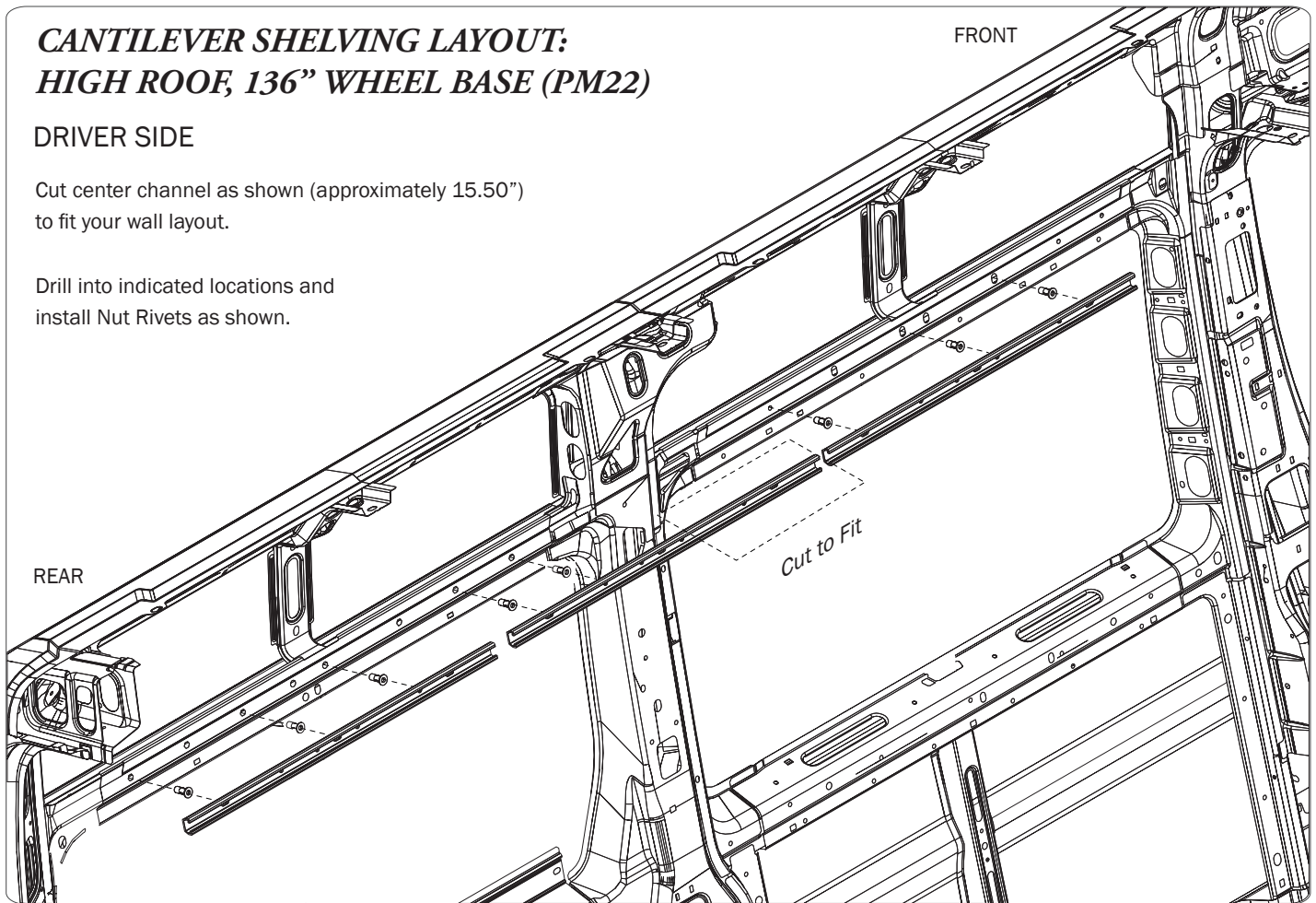

Install Hardware and Uprights in the sequence shown according to the
Hardware and Upright Installation Procedures on Page 3.

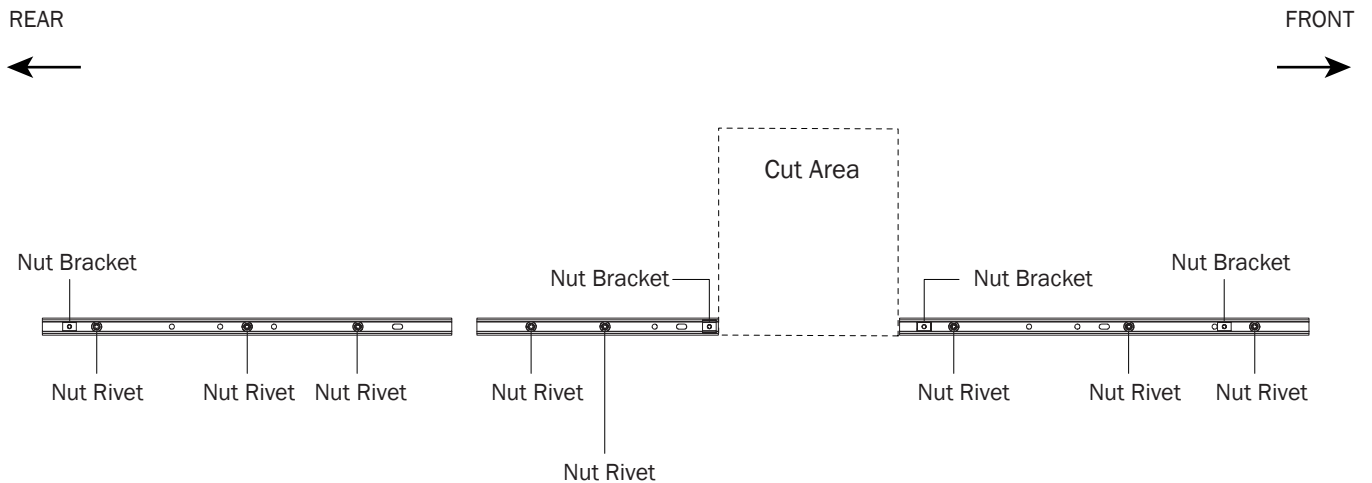

CANTILEVER SHELVING LAYOUT: HIGH ROOF, 136" WHEEL BASE (PM22)

PASSENGER SIDE

Cut front channel as shown
(approximately 15.50")
to fit your wall layout.

Drill into indicated locations and
install Nut Rivets as shown.

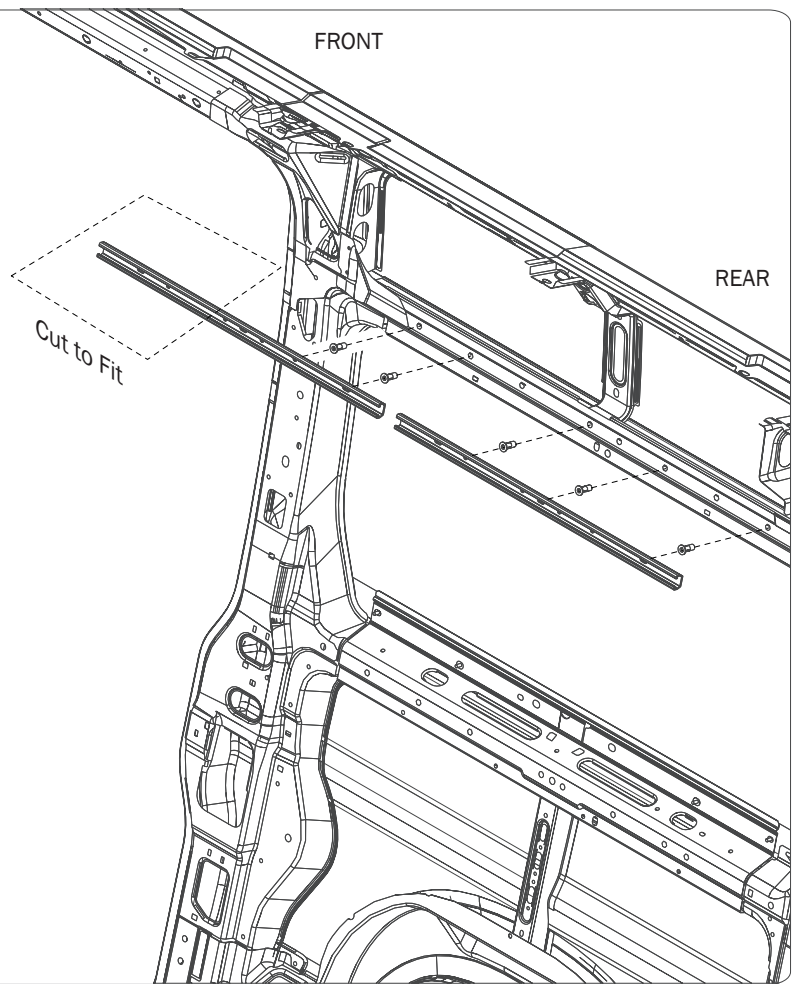

Install Hardware and Uprights in the sequence shown according to the
Hardware and Upright Installation Procedures on Page 3.

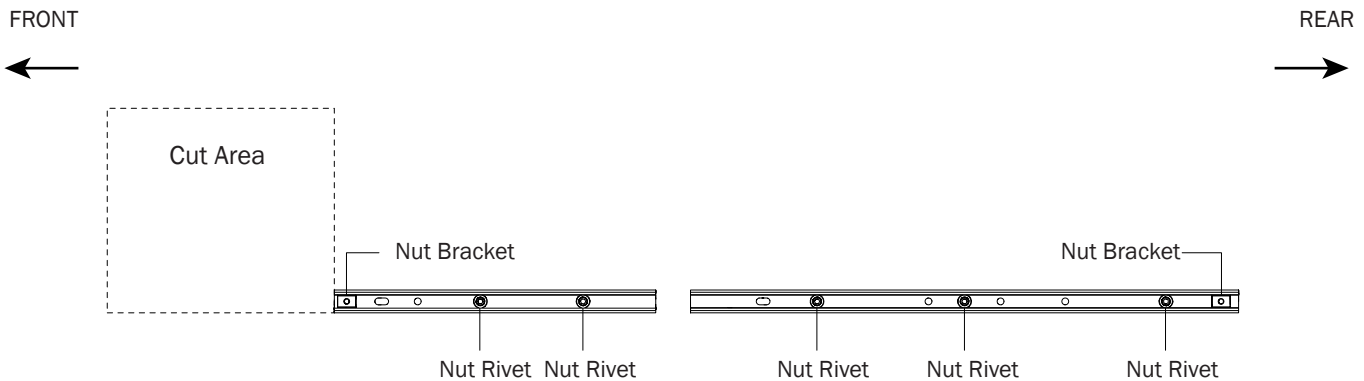

CANTILEVER SHELVING LAYOUT: HIGH ROOF, 159" WHEEL BASE (PM42)

DRIVER SIDE

Install Nut Rivets as shown.

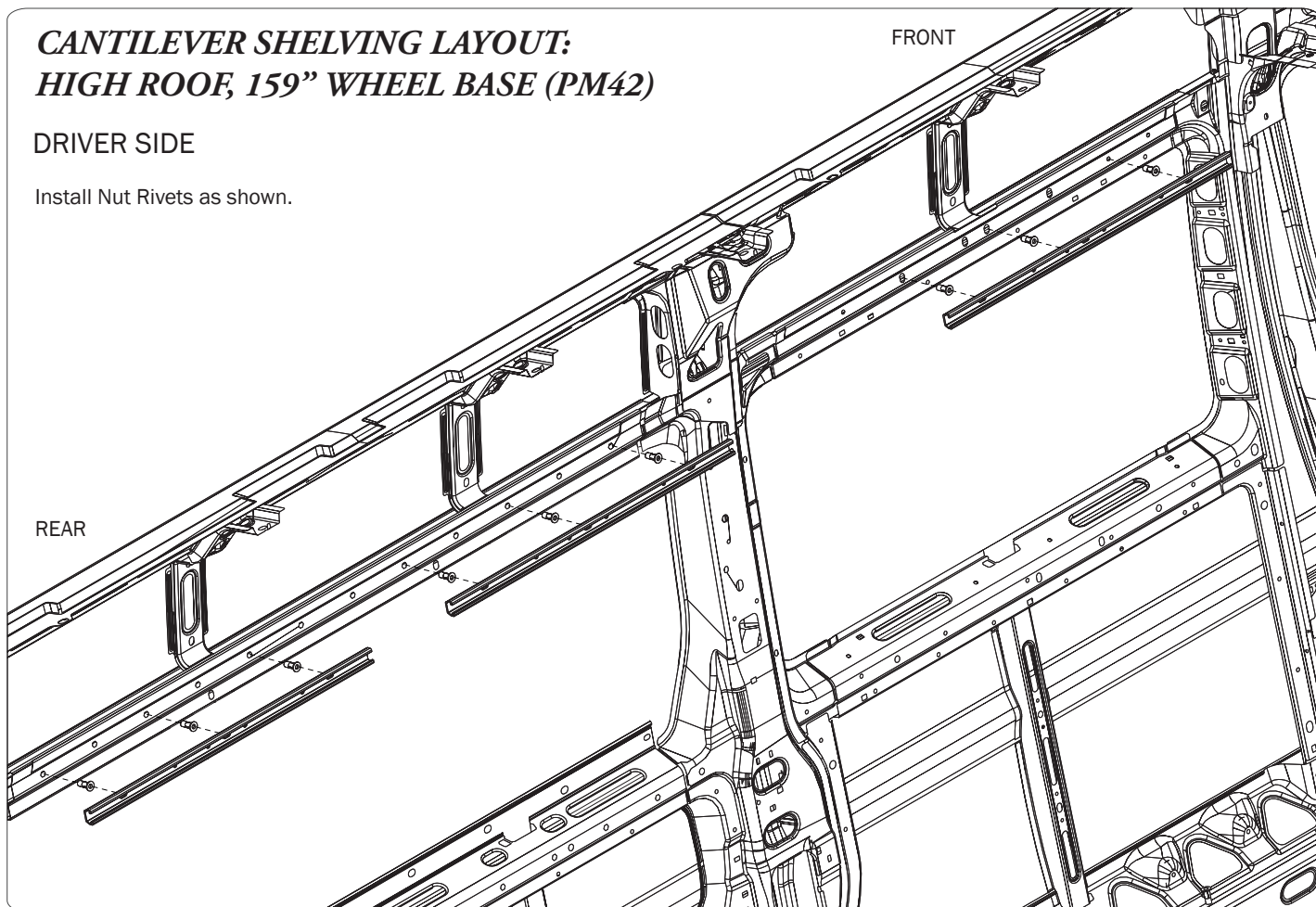

Install Hardware and Uprights in the sequence shown according to the Hardware and Upright Installation Procedures on Page 3.

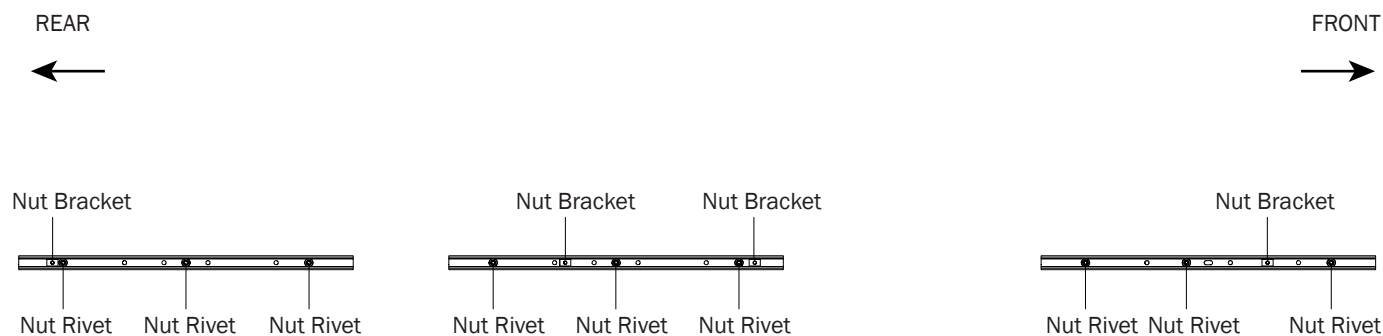

**CANTILEVER SHELVING
LAYOUT: HIGH ROOF,
159" WHEEL BASE (PM42)**

PASSENGER SIDE

Install Nut Rivets as shown.

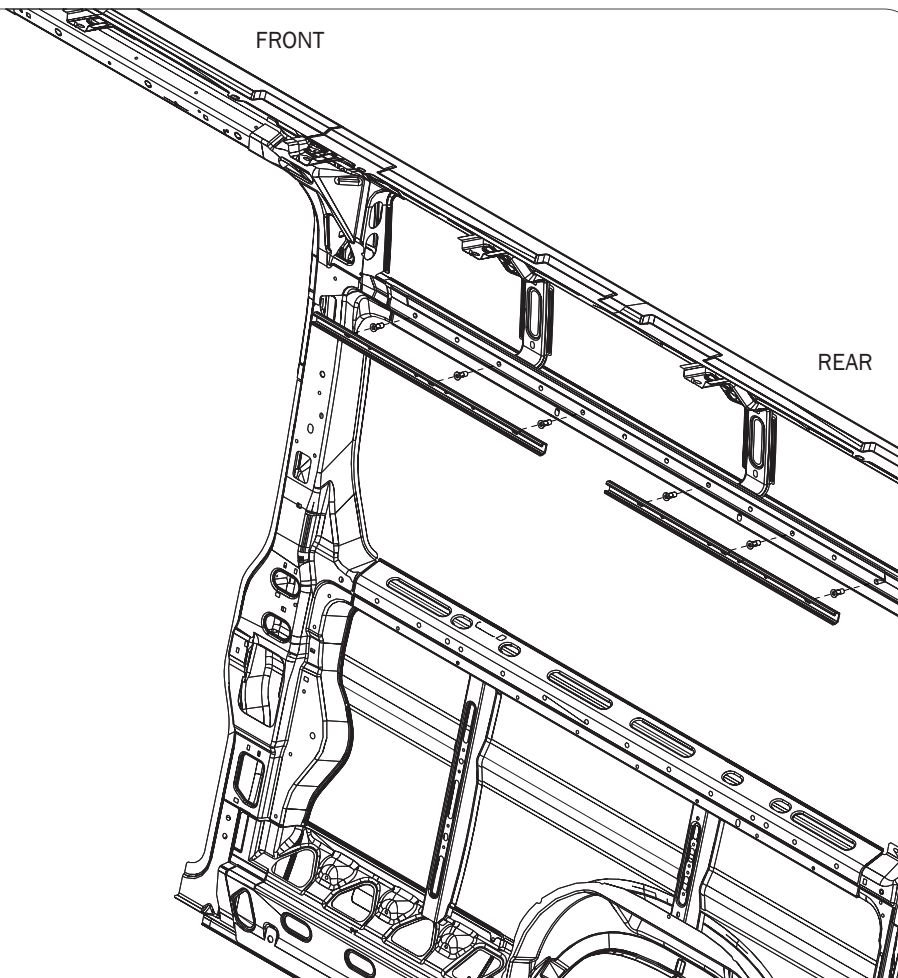

Install Hardware and Uprights in the sequence shown according to the Hardware and Upright Installation Procedures on Page 3.

FRONT



REAR

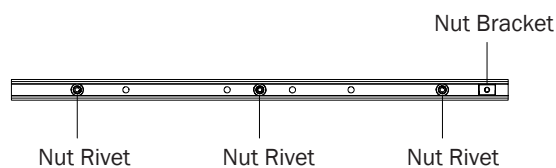
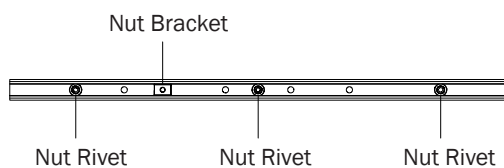

CANTILEVER SHELVING LAYOUT: HIGH ROOF, 159" EXT. WHEEL BASE (PM52)

DRIVER SIDE

Install Nut Rivets as shown.

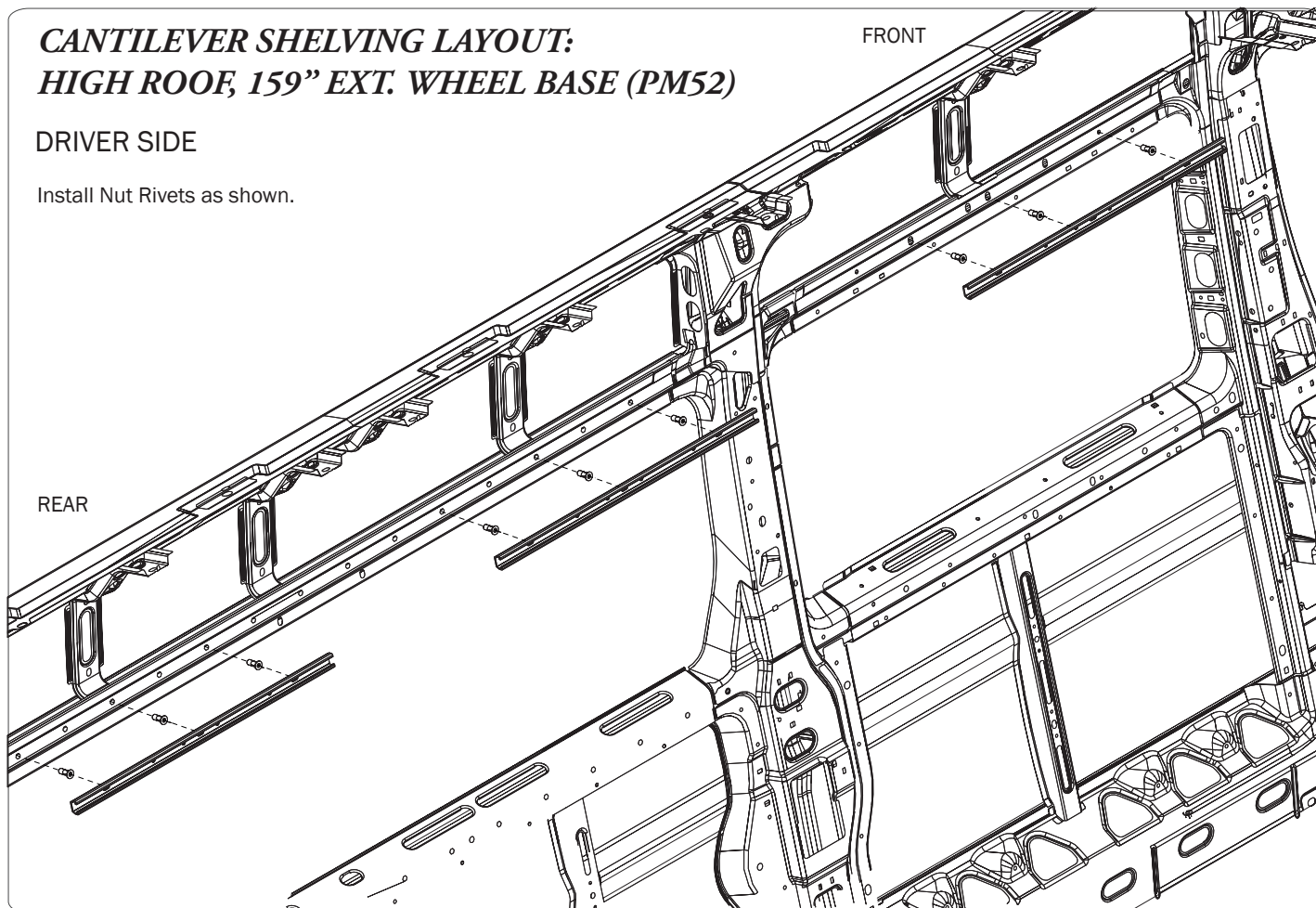

Install Hardware and Uprights in the sequence shown according to the Hardware and Upright Installation Procedures on Page 3.

REAR



Nut Bracket



Nut Rivet Nut Rivet Nut Rivet

Nut Bracket Nut Bracket



Nut Rivet Nut Rivet Nut Rivet

Nut Bracket



Nut Rivet Nut Rivet Nut Rivet

FRONT



**CANTILEVER SHELVING
LAYOUT: HIGH ROOF,
159" EXT. WHEEL BASE (PM52)**

PASSENGER SIDE

Install Nut Rivets as shown.

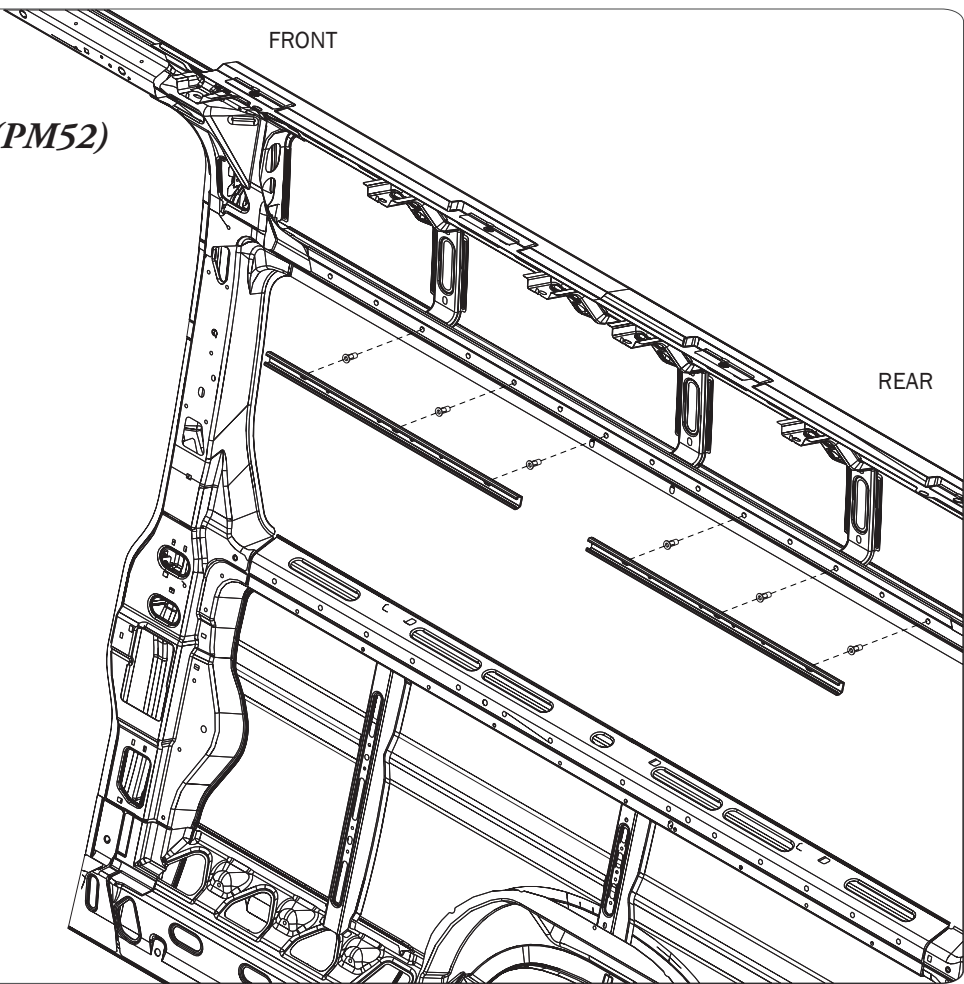

Install Hardware and Uprights in the sequence shown according to the Hardware and Upright Installation Procedures on Page 3.

FRONT

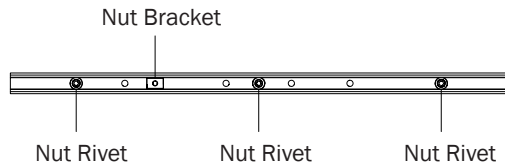

REAR

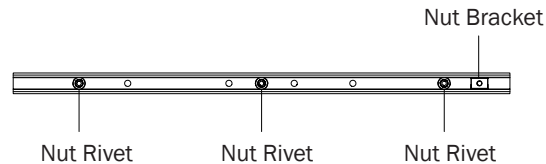

Page Intentionally Left Blank

Page Intentionally Left Blank

