

PRIME DESIGN™

A Safe Fleet Brand

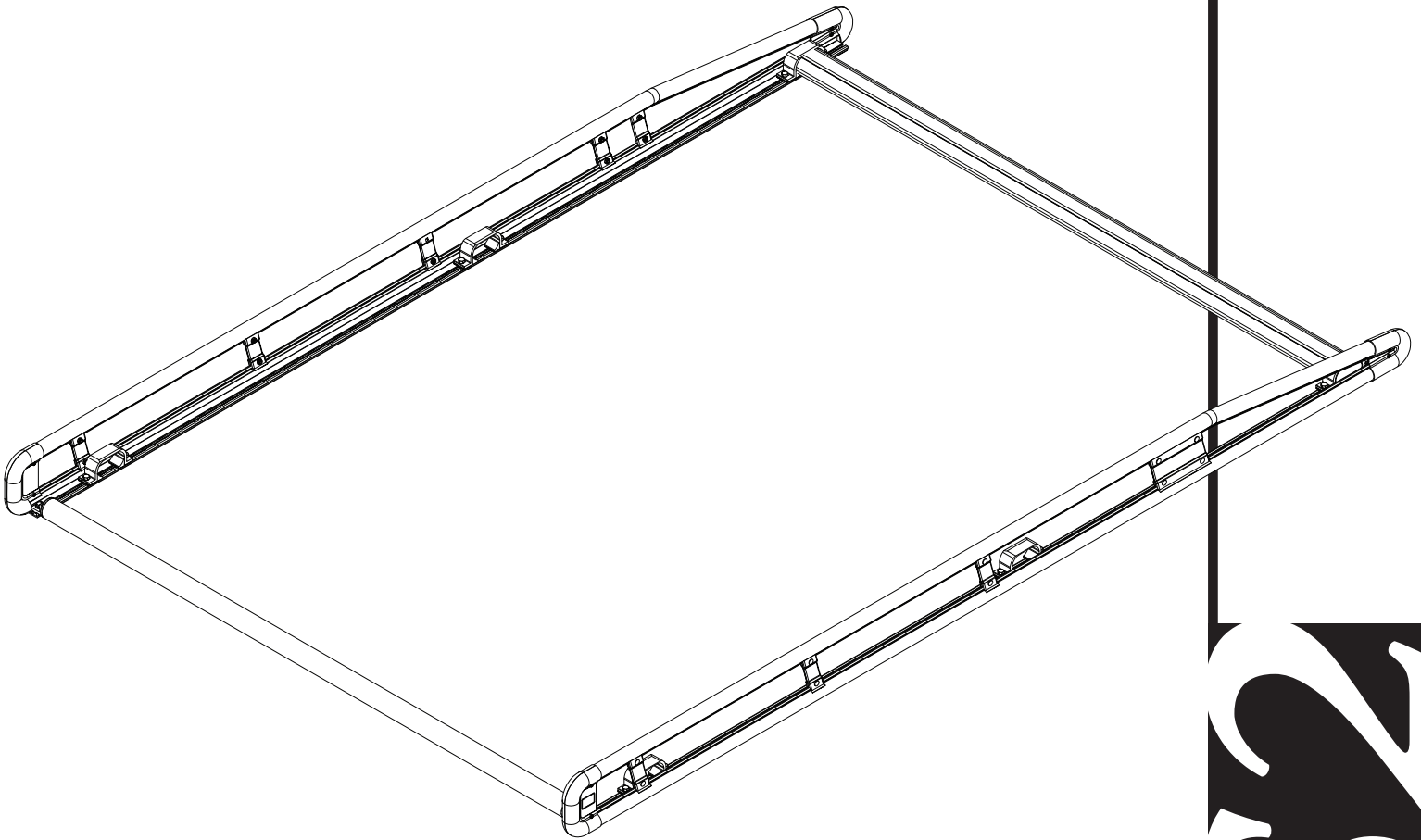

PRIME DESIGN, A SAFE FLEET BRAND

Address: 580 Opperman Drive, Eagan, MN 55123 • Toll Free: 1.8.PRIME.RACK
Fax: 651-552-1799 • Email: info@primedesign.net • Website: www.primedesign.net

PTR'S

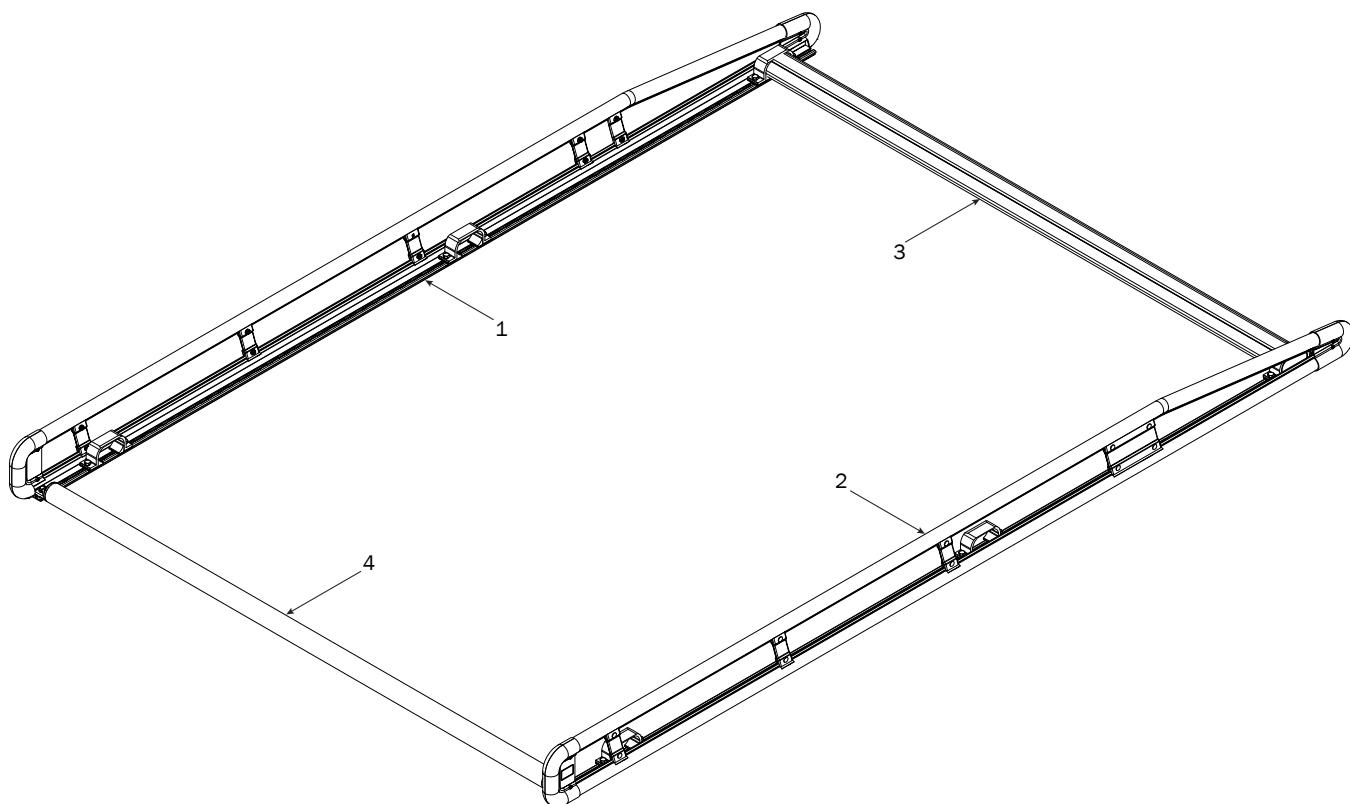

1—PAR-I L..... (Qty 1)
PTR Side Rail, Left, 99"

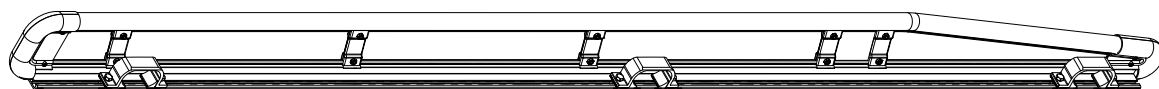

2—PAR-I R..... (Qty 1)
PTR Side Rail, Right, 99"

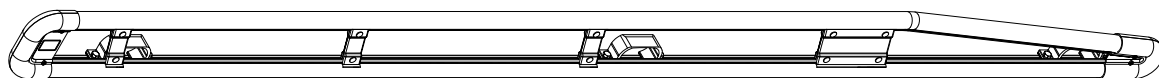

3—PUR-7365..... (Qty 1)
PTR Crossbars w/End Caps, 67"



4—PTR-R2 (Qty 1)
 Roller Assembly, 63.50" w/Hardware

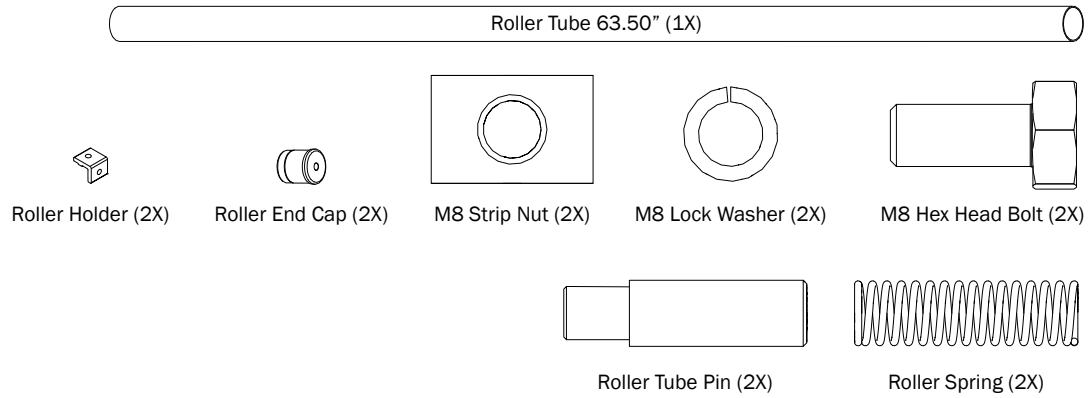

5—ASZ-0101 (Qty 1)
 Anti-Seize (not shown)

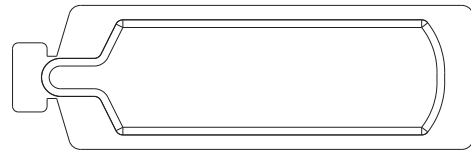

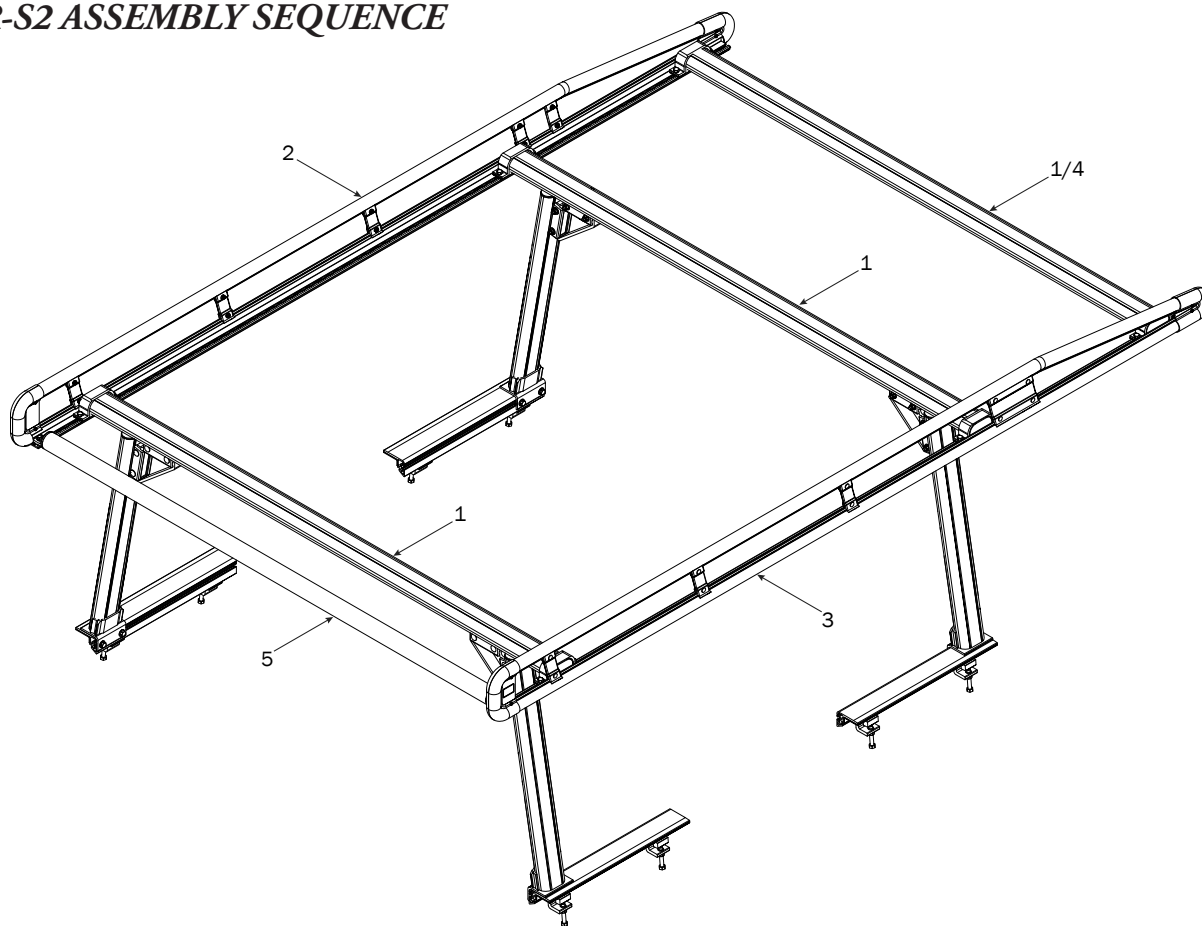
PTR-S2 ASSEMBLY SEQUENCE***CROSSBAR PREPARATION***

- 1.1** Measure to distance shown, and cut Crossbar padding.

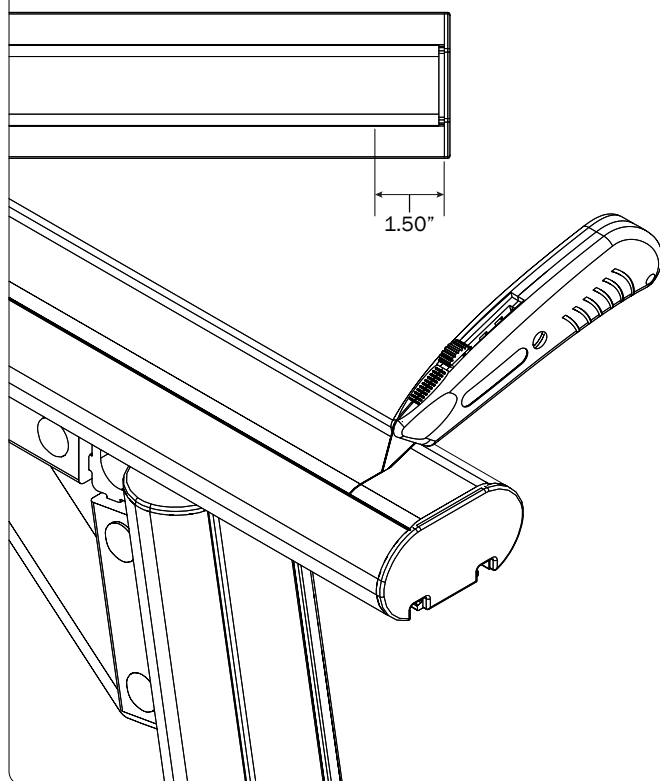

- 1.2** Undercut Crossbar Padding to remove section as shown.

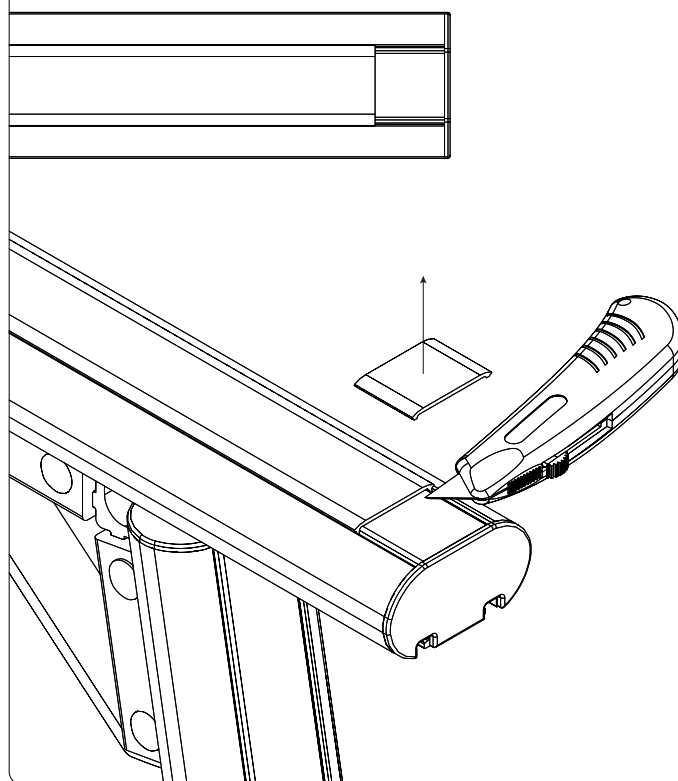

PTR LEFT SIDE RAIL

- 2.1** Loosen all Crossbar Hanger Clamp bolts as shown.

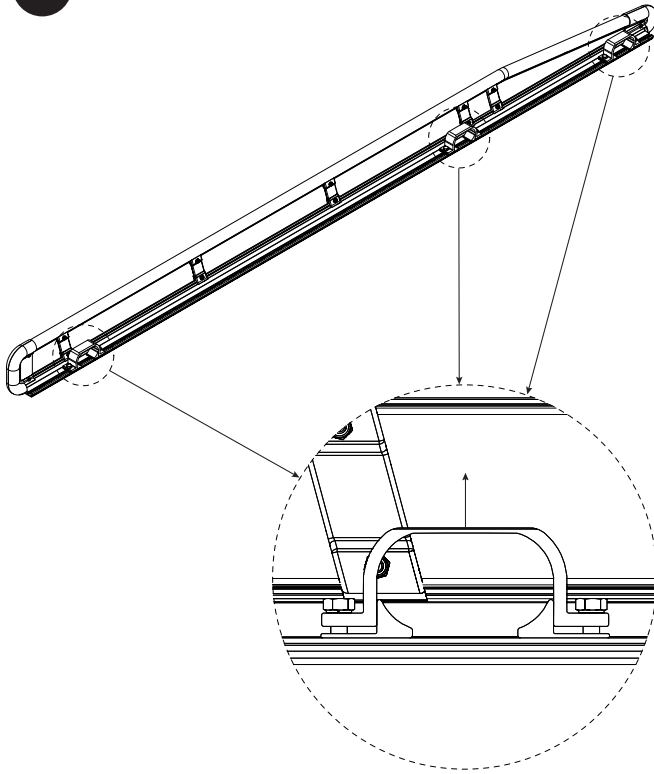

- 2.2** Place Left Side Rail onto PTR Crossbars.

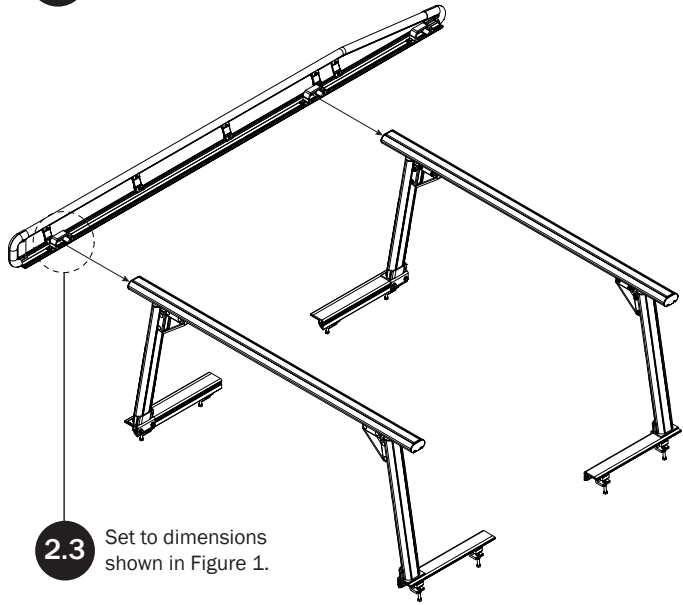

- 2.3** Set to dimensions shown in Figure 1.

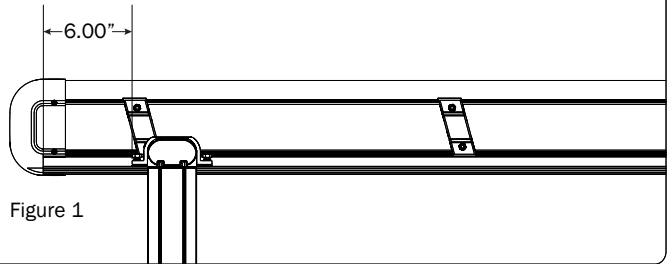

- 2.4** Torque Hanger Clamp bolts to 150 in-lbs.

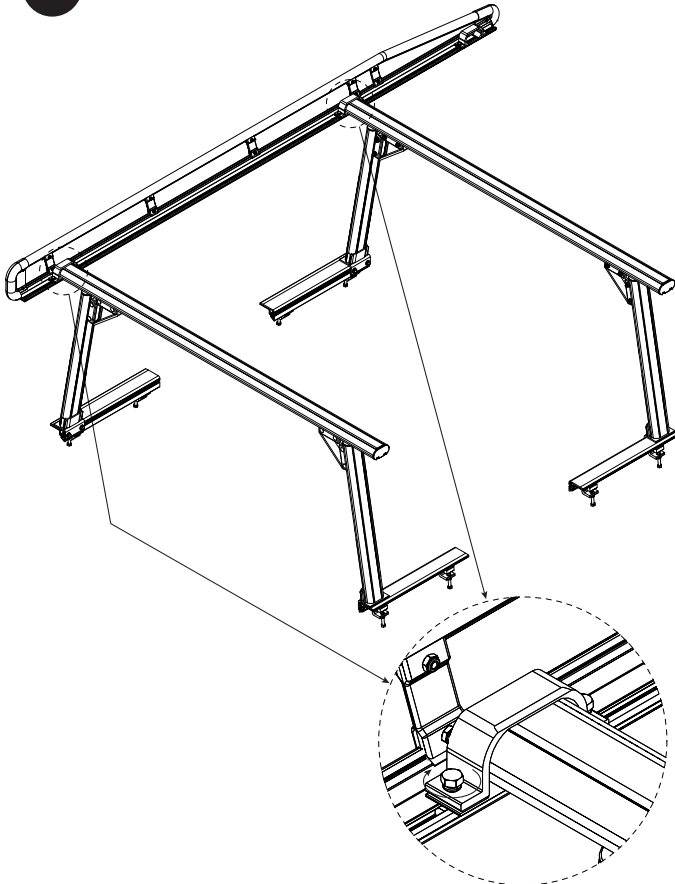

PTR RIGHT SIDE RAIL

- 3.1** Loosen all Crossbar Hanger Clamp bolts as shown.

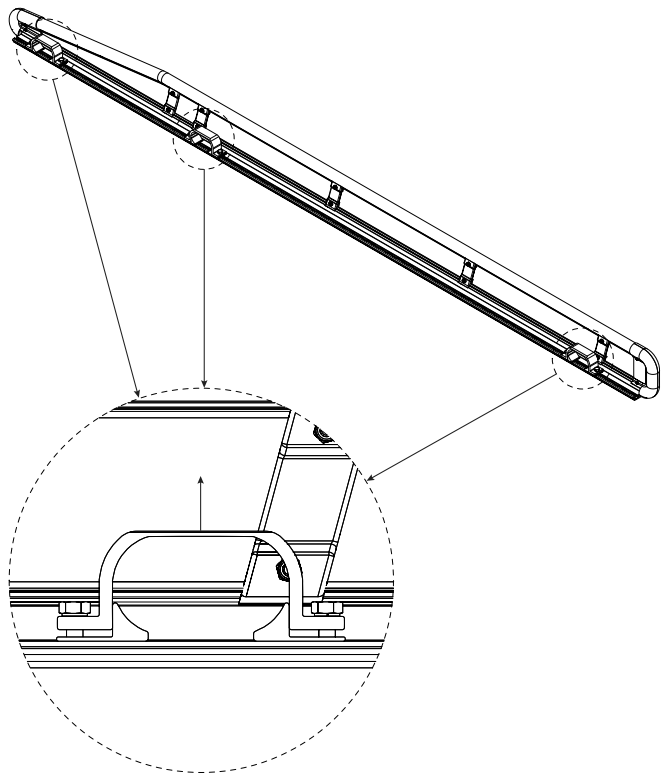

- 3.2** Place the Right Side Rail onto the PTR Crossbars.

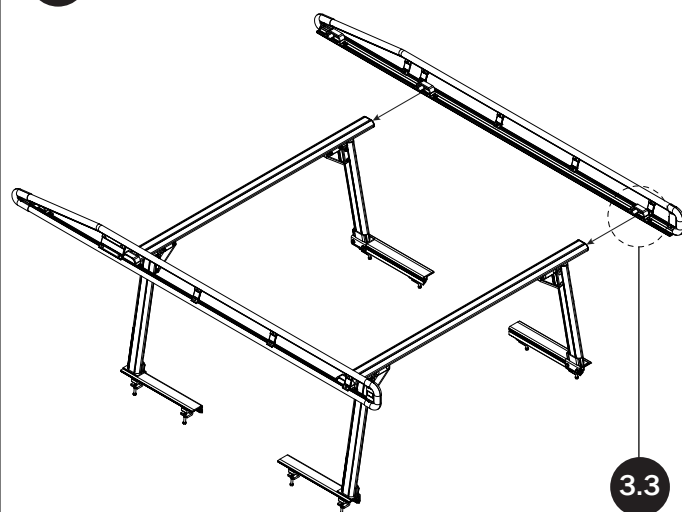

3.3

Set to dimensions shown in Figure 2.

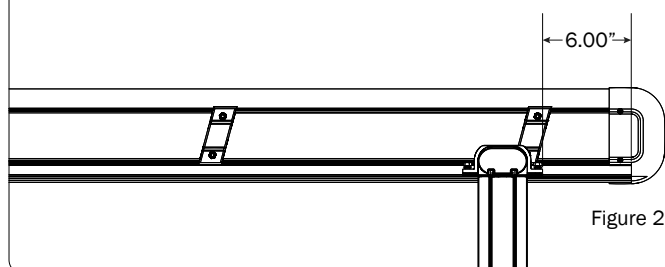

- 3.4** Torque Hanger Clamp bolts to 150 in-lbs.

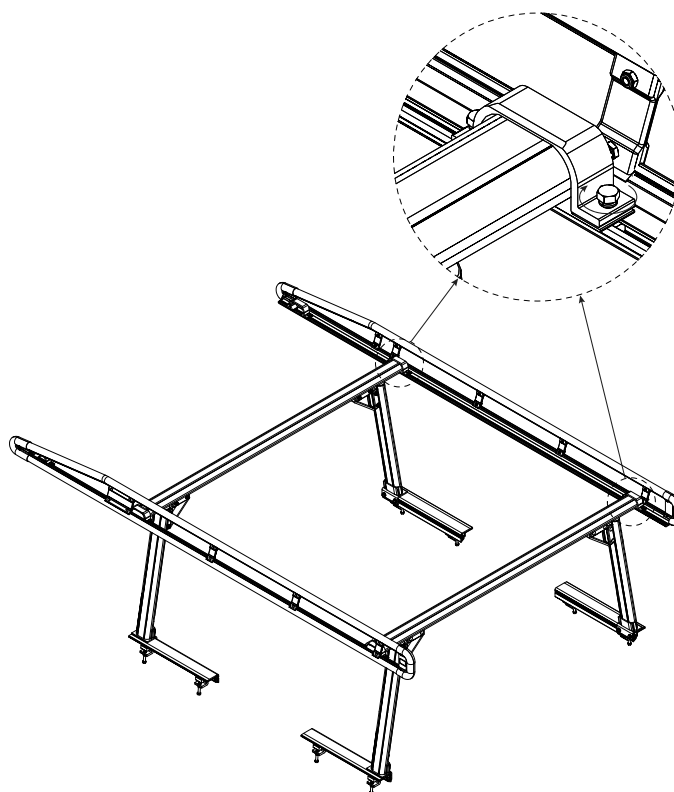

PTR FRONT CROSSBAR

- 4.1** Remove the front Hanger Clamp, bolt, and lock washer from the Right Side Rail as shown.

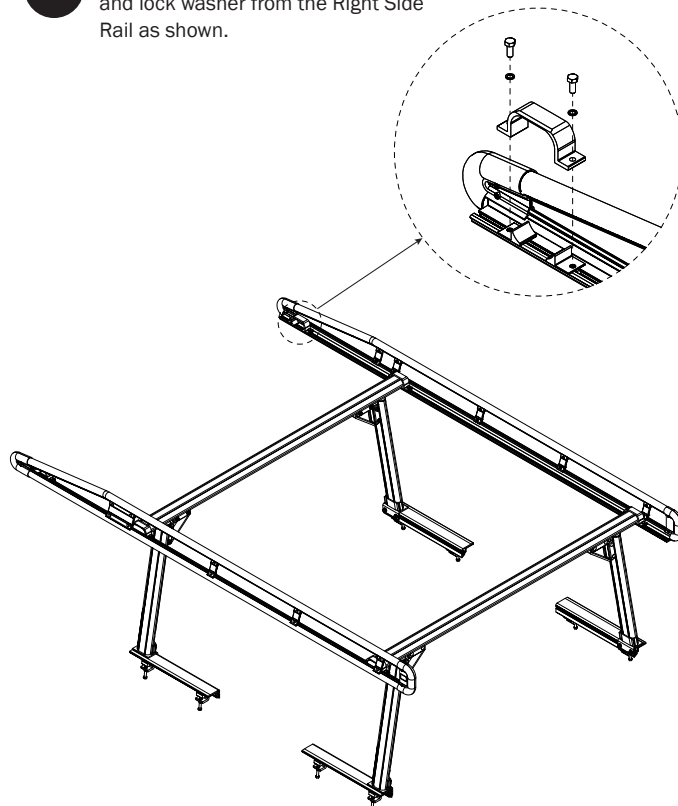

- 4.2** Place the PTR Crossbar into the Left Side Rail Hanger Clamp, then place the Right Side Rail Hanger Clamp and hardware onto the PTR Crossbar as shown.

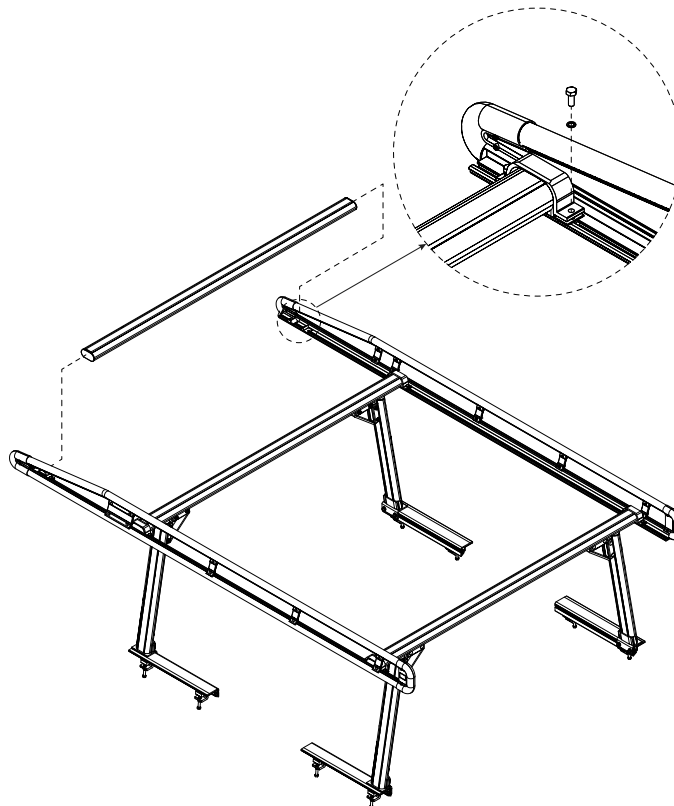

4.3

Position the front PTR Crossbar Hanger Clamps firmly against the front of both the Left and Right Side Rails.

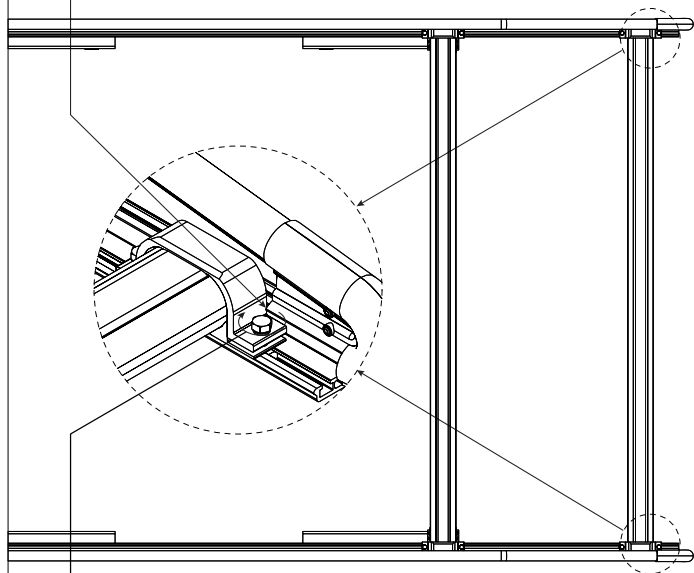

4.4

Torque the PTR Crossbar Hanger Clamp bolts to 150 in-lb.

PTR ROLLER ASSEMBLY

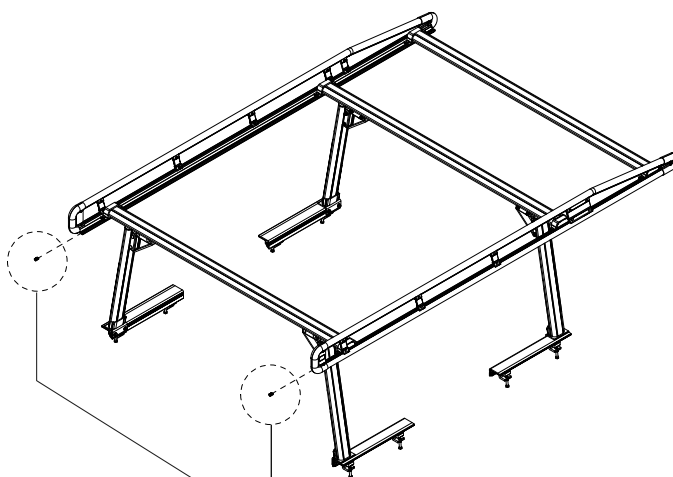

Slide the Roller Assembly Strip Nuts into the back ends of the Left and Right Side Rails.

5.1

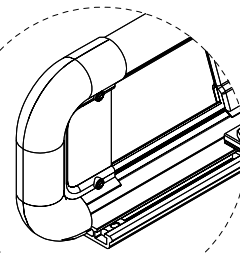

5.2

Assemble the PTR Roller Assembly as shown.

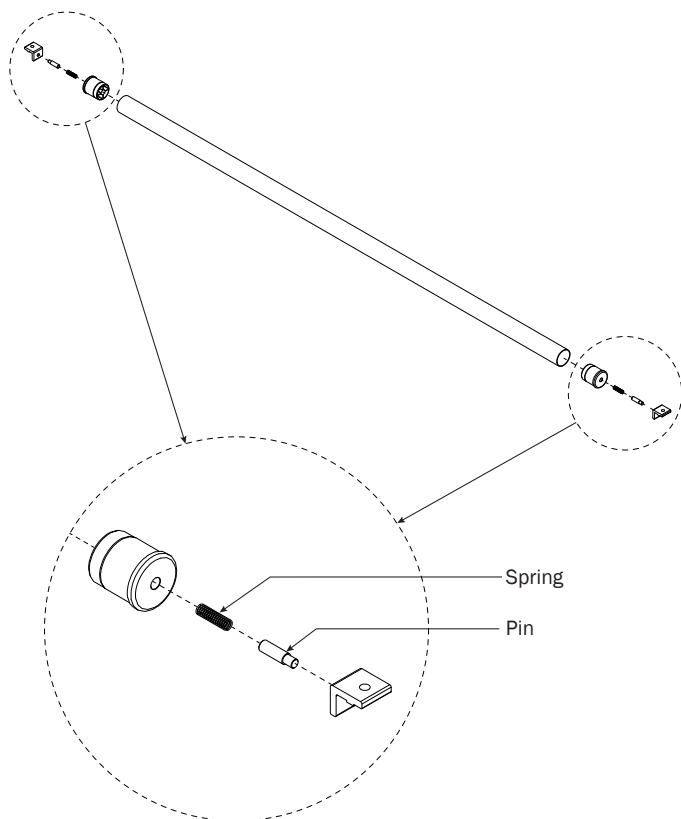

Spring

Pin

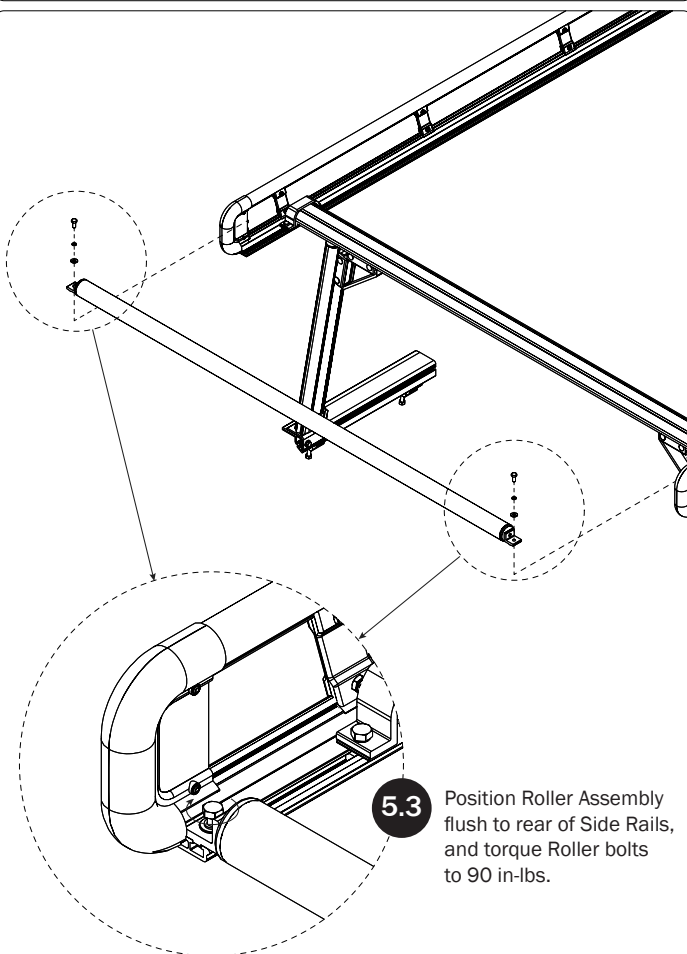

5.3

Position Roller Assembly flush to rear of Side Rails, and torque Roller bolts to 90 in-lbs.

PTR-S2 RACK ASSEMBLY

PRIME DESIGN™

A Safe Fleet Brand

