

FEA-0015

Right Hand Rotation Driveshaft

Dimensional Specifications on Page 2

Configuration as shown:

Bent Handle, White Powder Coat Finish

Kit Weight: 24 lbs

A: ELR-8292 Rear Drive Shaft

B: ELR-8068 Front Drive Shaft

C: HKT-8163 Hardware Kit

D: RKT-7889 Handle Clamp

E: ELR-8203 Connecting Bar

[Modular Assembly Manuals](#)

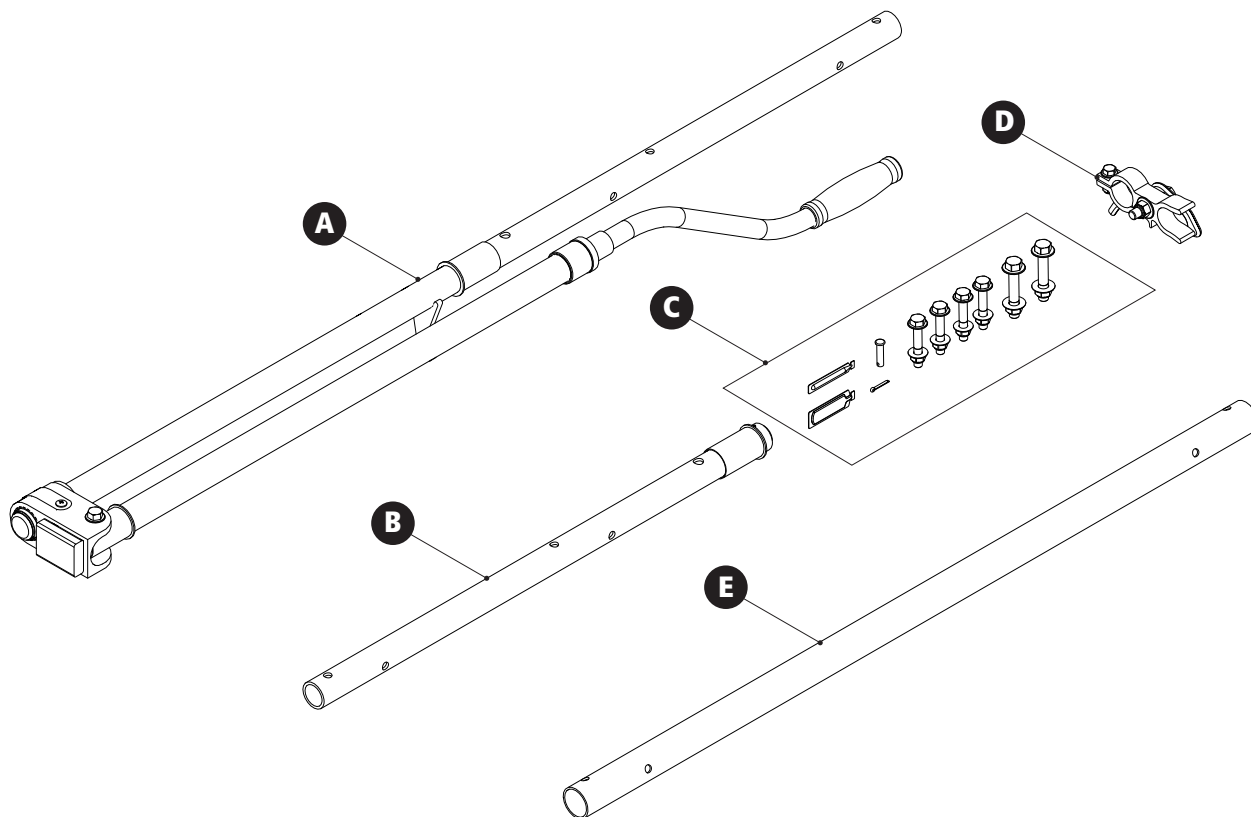

FEA-0015

Right Hand Rotation Driveshaft

Approximate dimensions as shown:

A: Crossbar Spacing 4'-6'

B: Length 98"

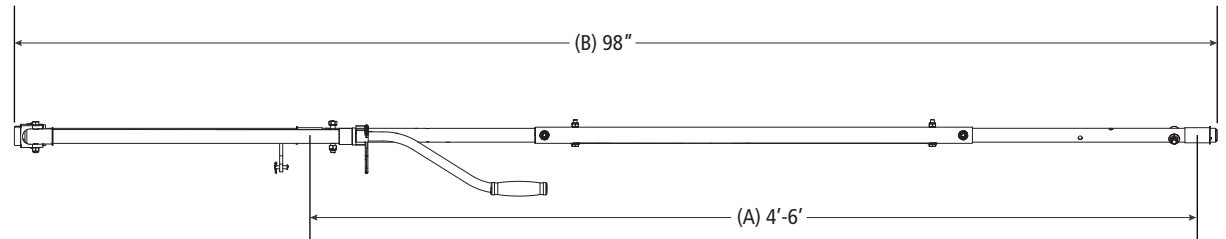
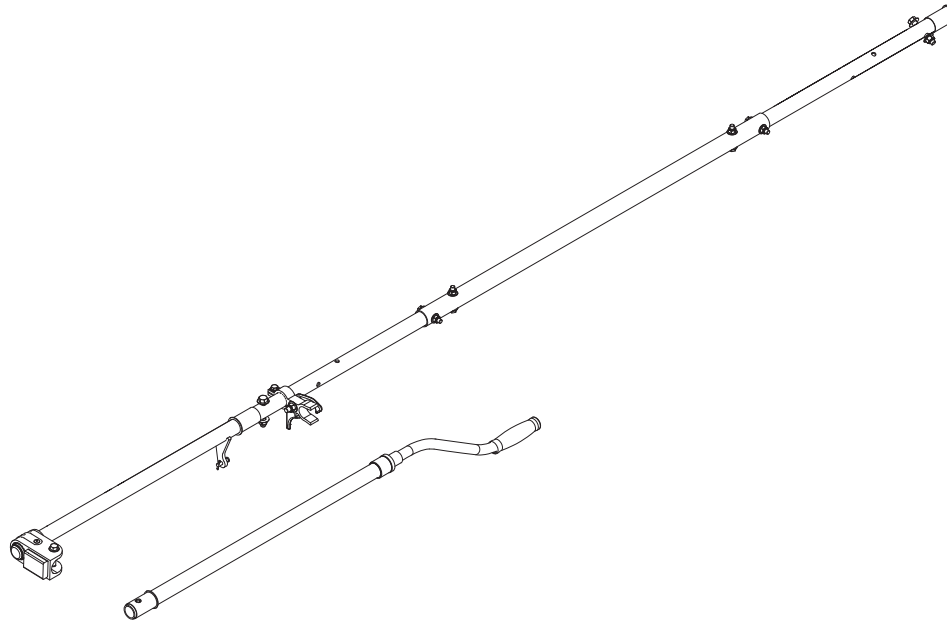

Assembly Manual also available:

[FEA-0015](#)

USOV-FEA0015-US01 Rev-D 1221