

PRIME DESIGN™

A Safe Fleet Brand

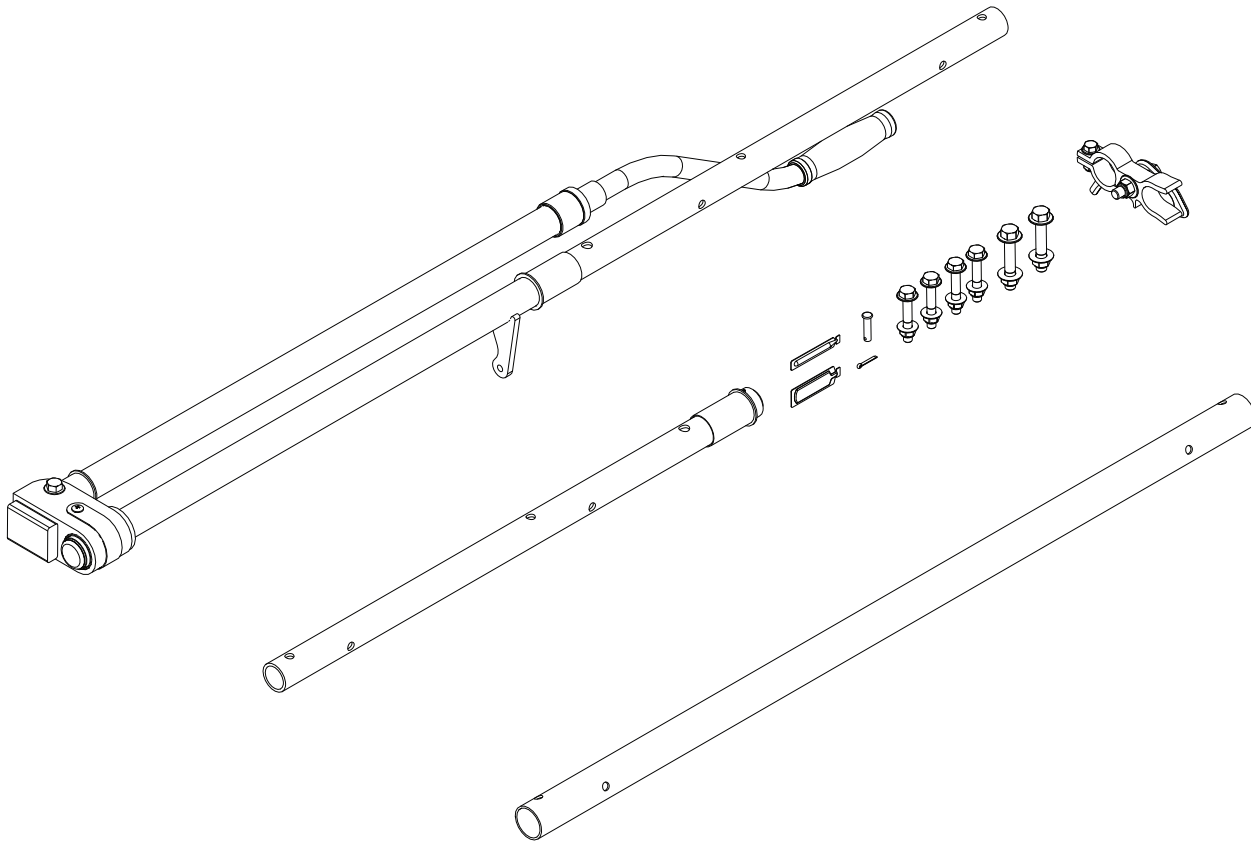

LEFT SIDE DRIVE SHAFT KIT, LOW ROOF

PRIME DESIGN, A SAFE FLEET BRAND

Address: 580 Opperman Drive, Eagan, MN 55123 • Toll Free: 1.8.PRIME.RACK

Fax: 651-552-1799 • Email: info@primedesign.net • Website: www.primedesign.net

FEA0016

CONTENTS OVERVIEW

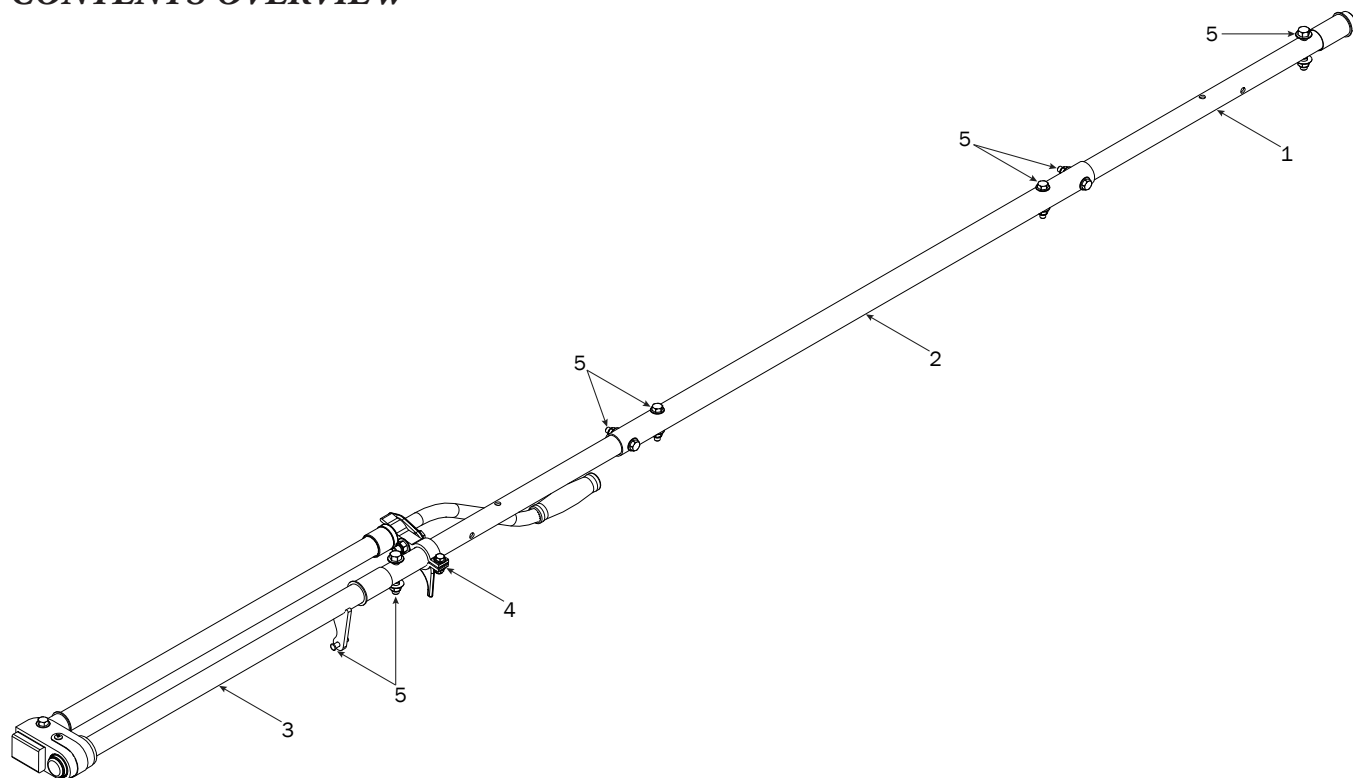

1—Front Drive Shaft (Qty 1)
B Version, 23.75"

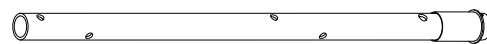

2—Connecting Bar..... (Qty 1)
36.00"

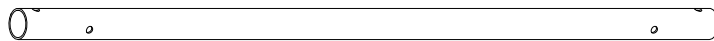

3—Rear Drive Shaft..... (Qty 1)
Left Hand, B4 Version, 46.00"

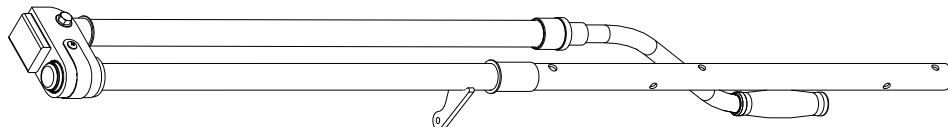

4—Handle Latch Assembly (Qty 1)
Left Hand

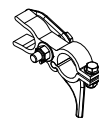

5—HKT-8162..... (Qty 1)
Modular Rotation Hardware Kit



Cotter Pin (1X) Clevis Pin (1X)

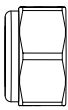
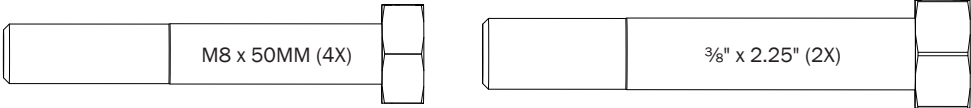

M8 Lock Nut (4X)

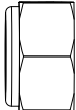

3/8" Lock Nut (2X)

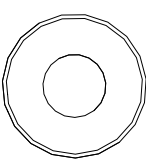

5/16" Flat Washer (8X)

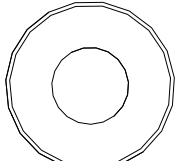

3/8" Flat Washer (4X)

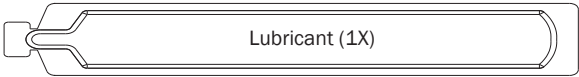
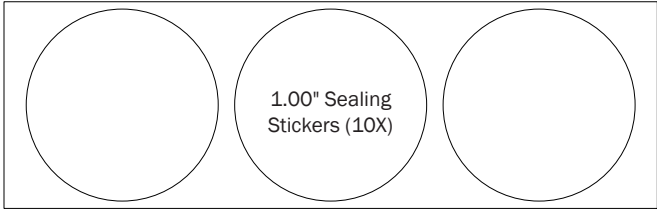

LEFT DRIVE SHAFT ASSEMBLY SEQUENCE



NOTE: Crossbars and LH Rotation feature are shown for illustrative purposes only. Crossbars and Rotations are not included with this Drive Shaft feature, and must be purchased separately.

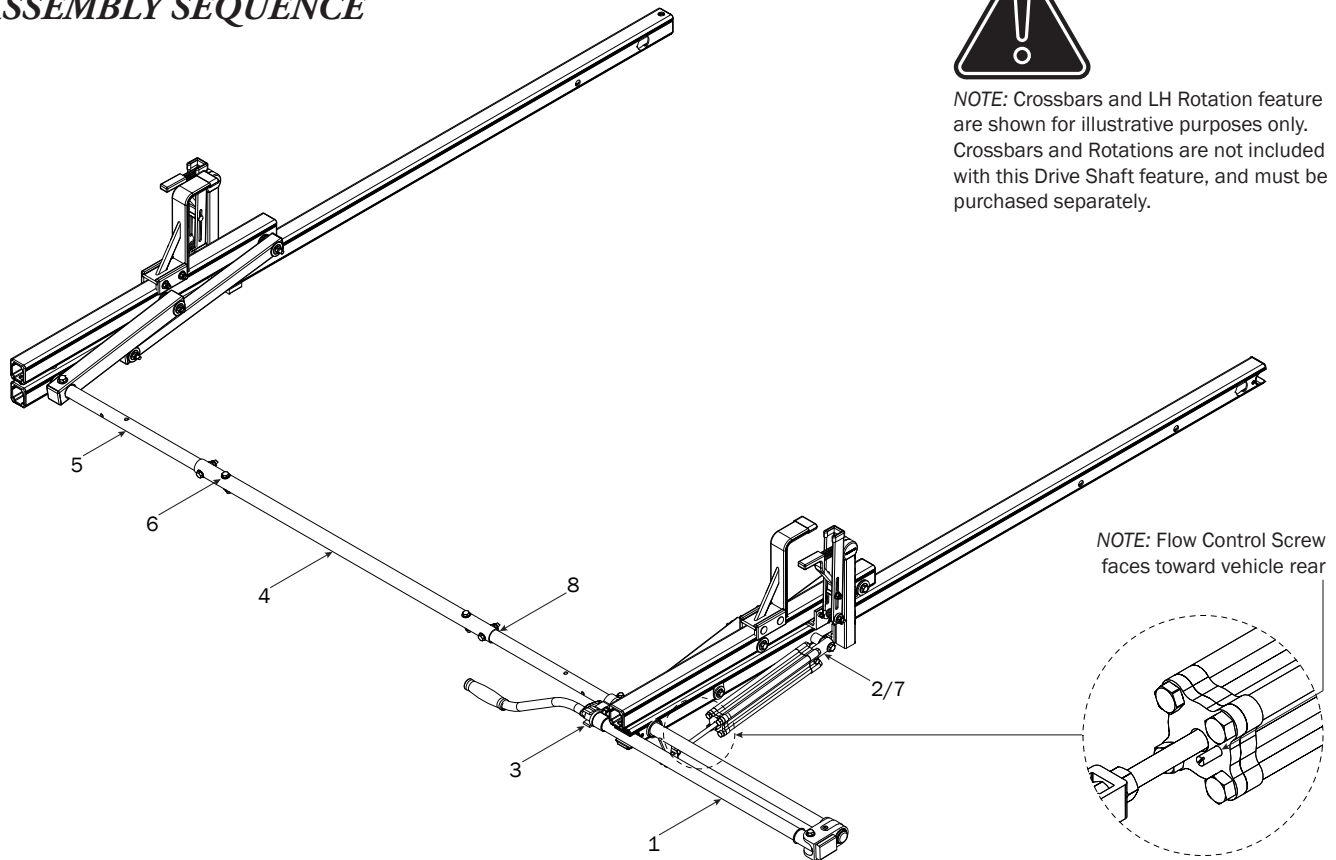

NOTE: Flow Control Screw faces toward vehicle rear

REAR DRIVE SHAFT

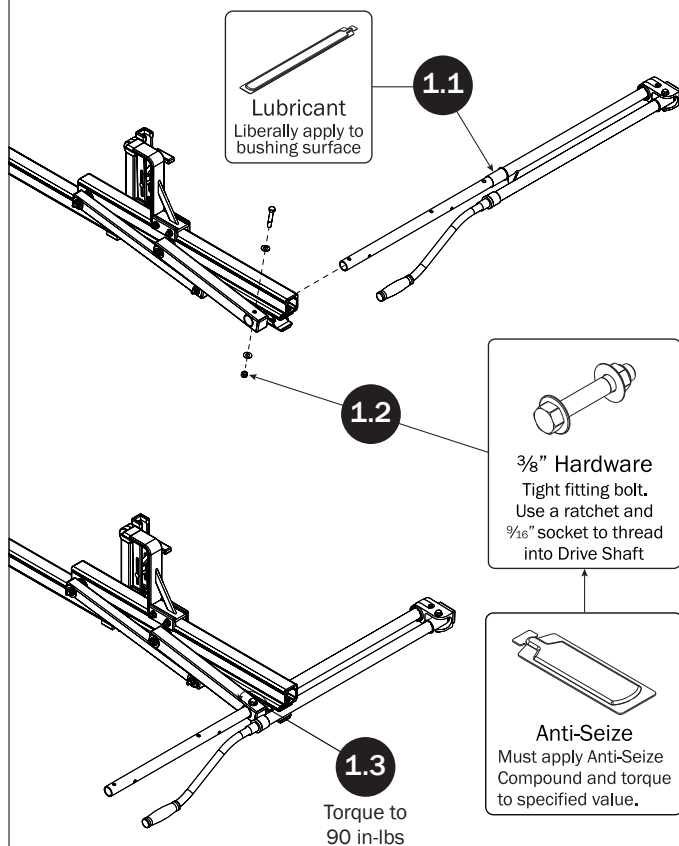

CYLINDER HARDWARE

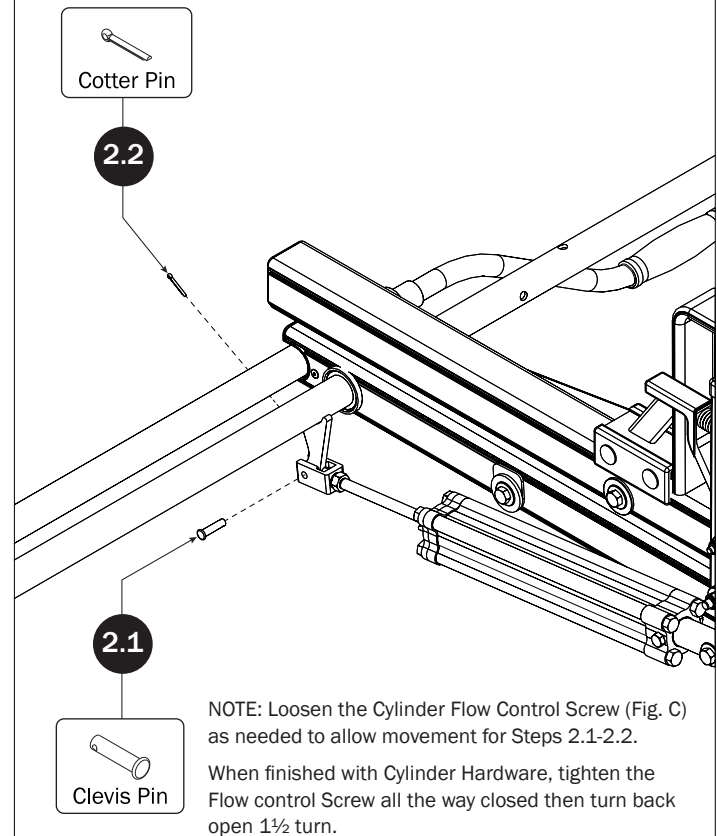

HANDLE LATCH INSTALLATION

3.1

Remove and retain
for Step 3.5

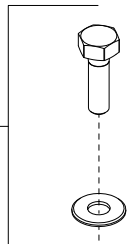

3.1

Remove and retain
for Step 3.5

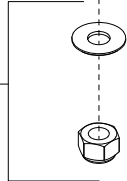

3.2

Remove and retain
for Step 3.4

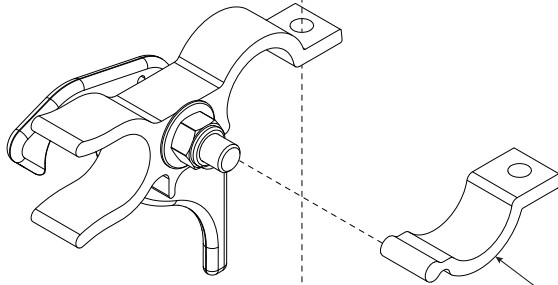

3.3

As shown in Figure A, lightly pull the Release Latch outward prior to setting the Latch Assembly onto the Drive Shaft.

Note: To prevent damage to the Release Latch, do not rotate the lever beyond the position shown in Figure A.

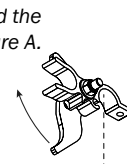

Approximate
positioning

Figure A

Slide into Handle
Clamp Body

3.4

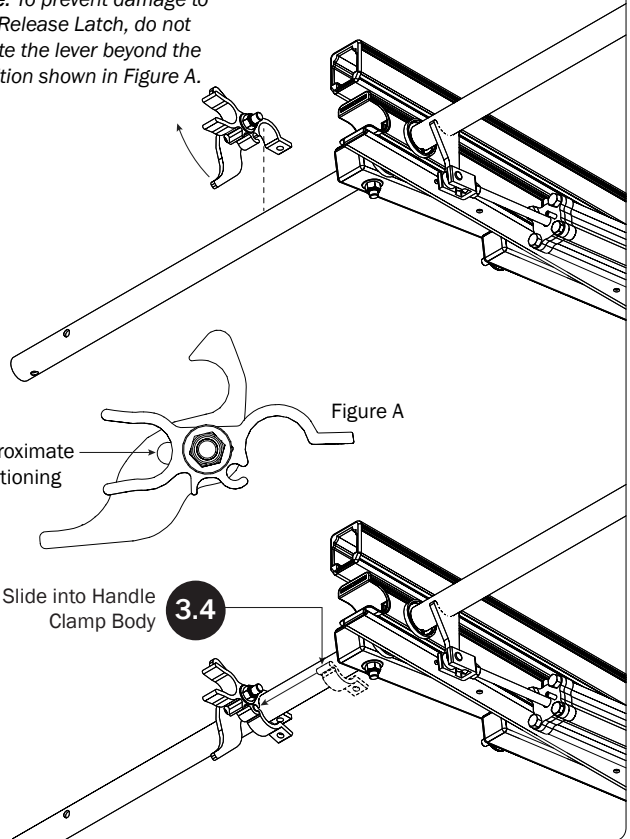

3.5

Apply Anti-Seize Compound to the Hardware removed during Step 3.1, then install Hardware into Handle Clamp Body.

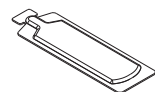

Anti-Seize
Must apply Anti-Seize
Compound. Do not
tighten at this time.

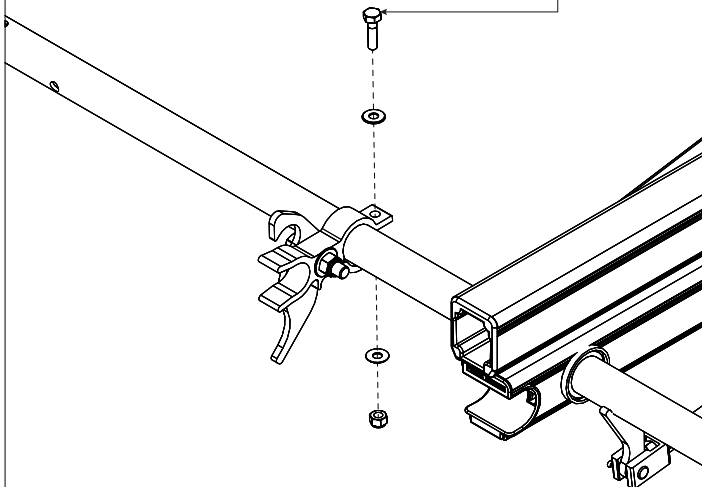

3.6

Position the Handle Latch Assembly with the Rotation in its full resting position. The Handle must engage the Crossbar Interlock before final tightening.

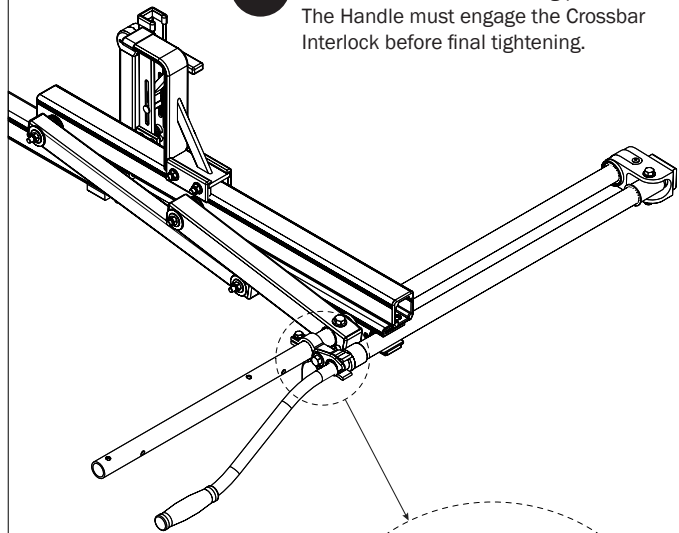

Torque to
90 in-lbs

3.7

Handle must engage
the Latch as shown.

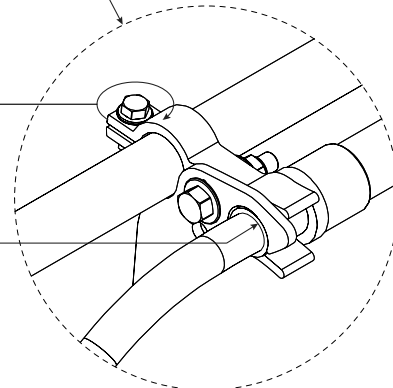

5

FEA-0015 ASSEMBLY INSTRUCTIONS—RIGHT DRIVE SHAFT

PRIME DESIGN™
A Safe Fleet Brand

CONNECTING BAR VARIATIONS

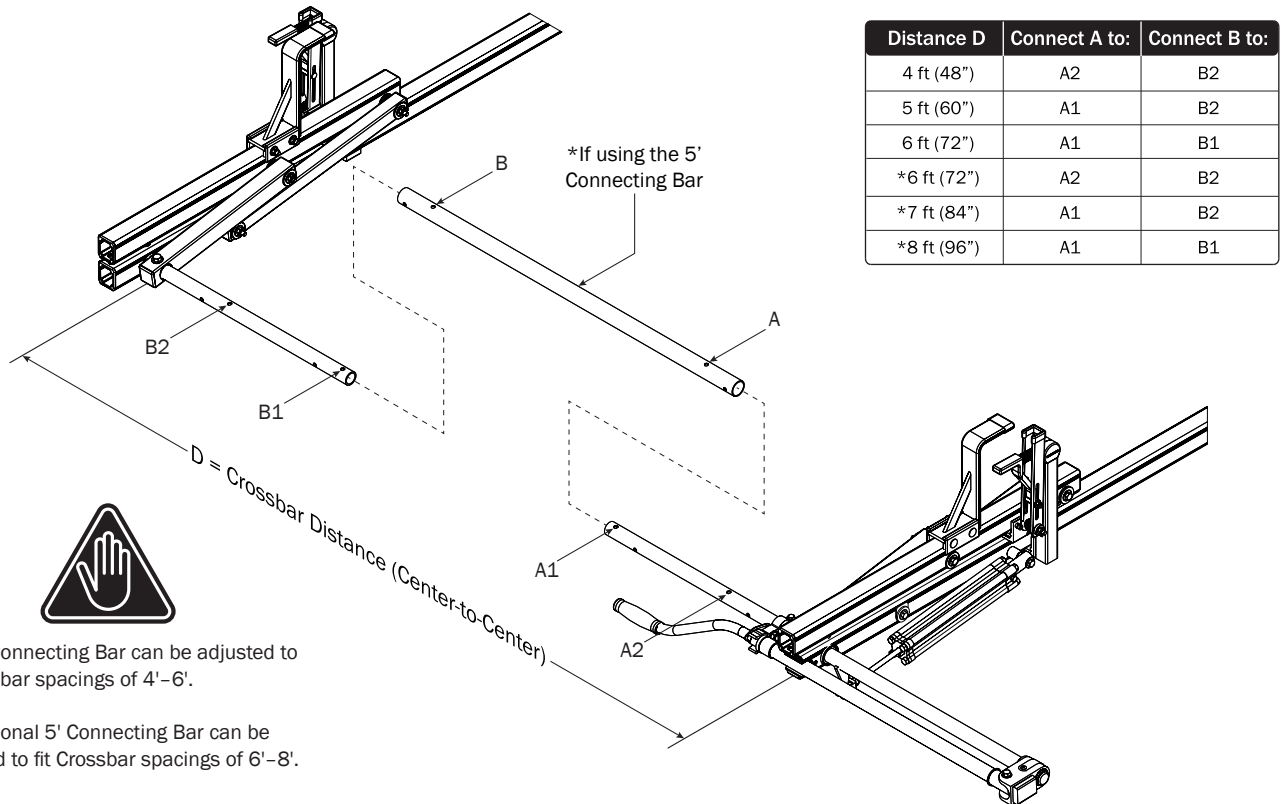

CONNECTING BAR

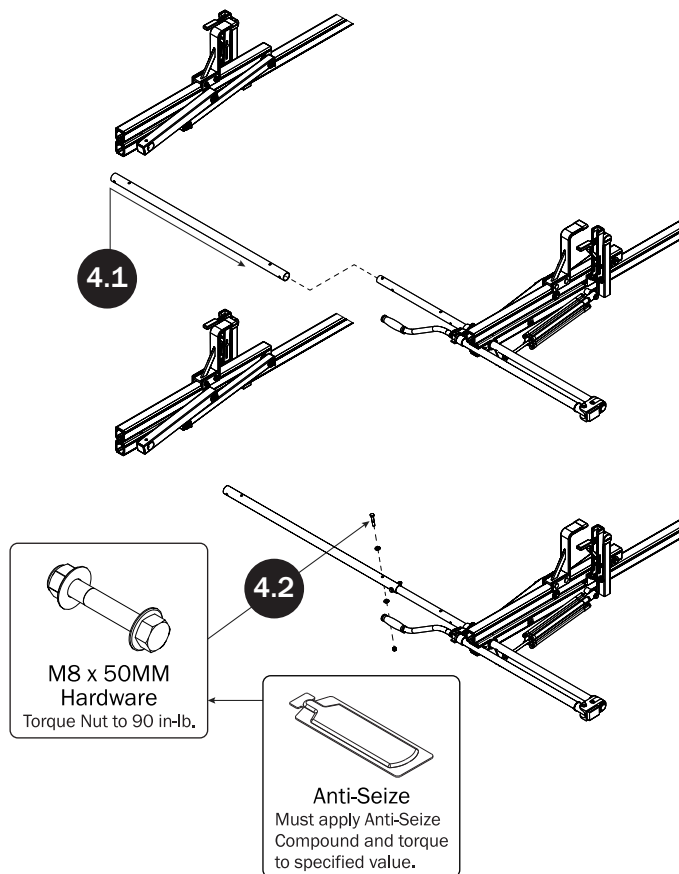

FRONT DRIVE SHAFT

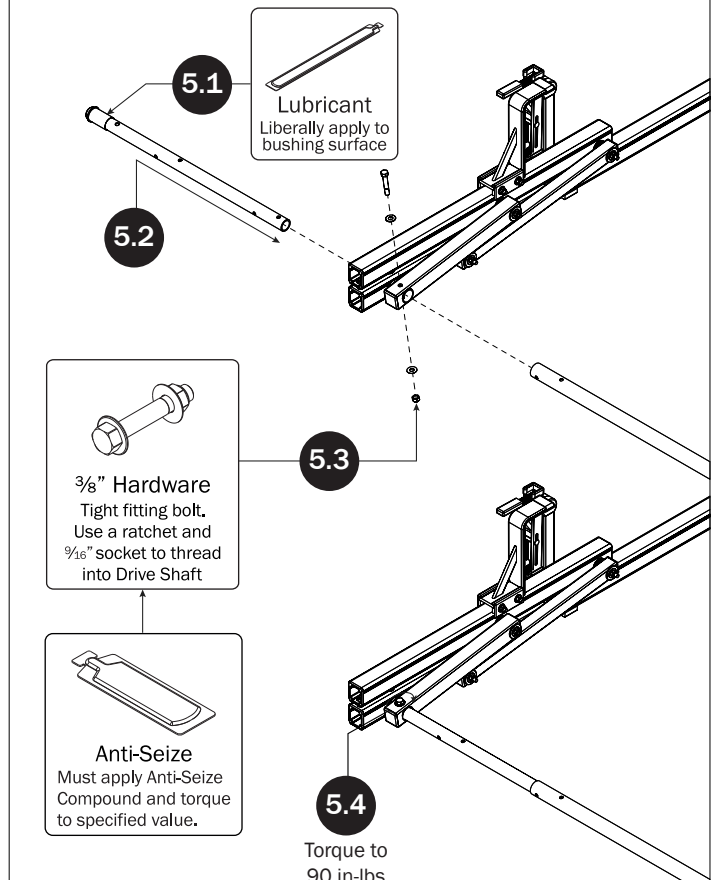

CONNECTING BAR FASTENERS

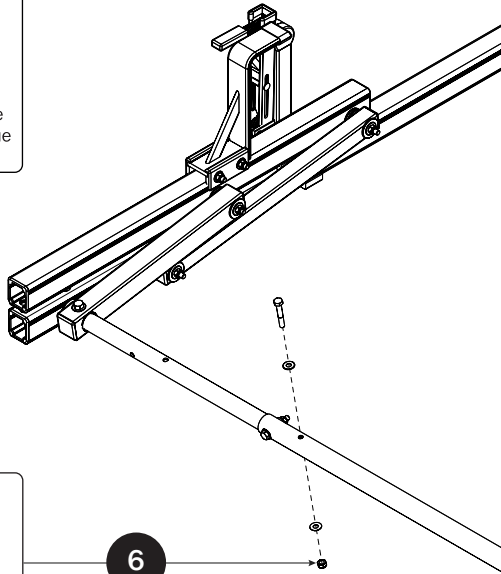
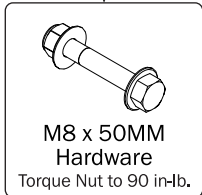

CYLINDER ADJUSTMENT

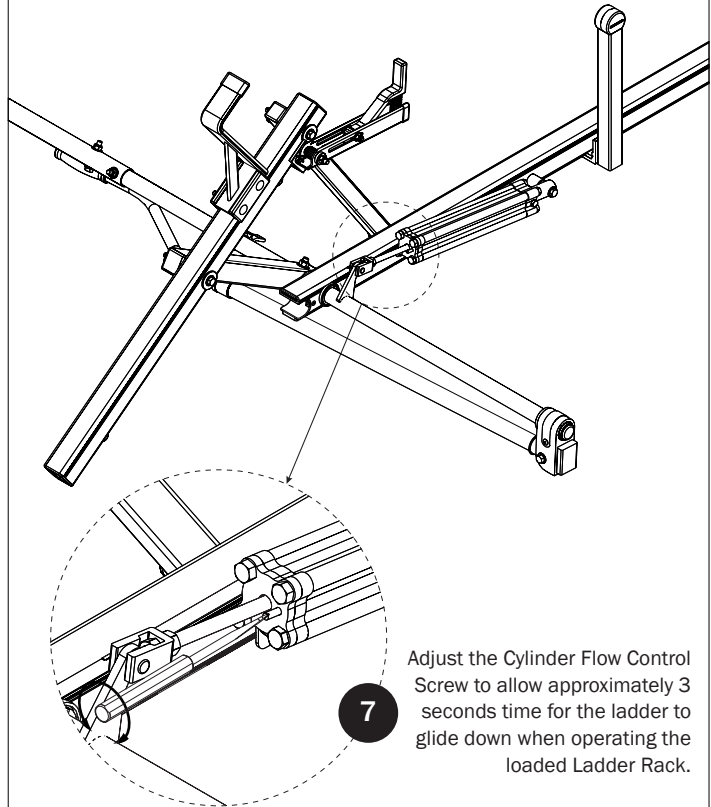

DRIVE SHAFT SEALING

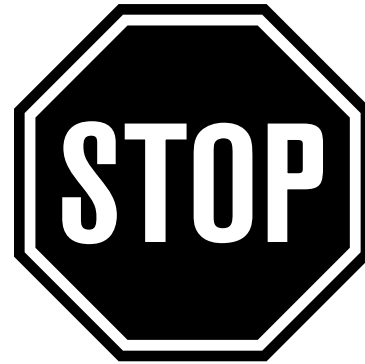
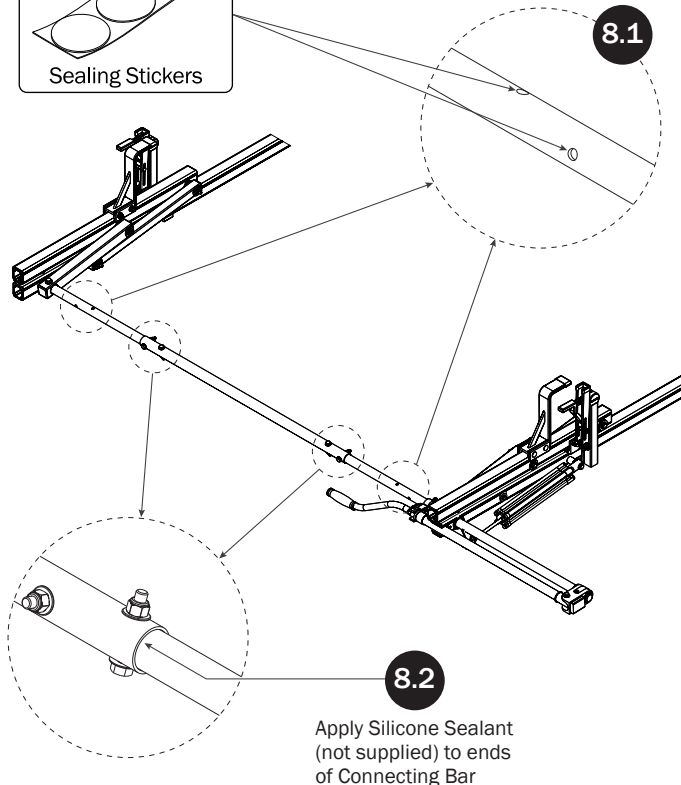
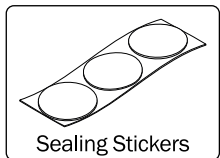

NOTE: This completes the right hand assembling of FEA-0016. For right side Drive Shaft assembly procedures, see FEA-0015 Assembly Manual.

If applicable, refer to your next FEA Assembly Manual.

If completed, refer back to your FBM Assembly Manual, and resume assembling at Step 3.1.

WARNING: Failure to position the Crossbars as shown in your FBM Assembly Manual may result in damage to the sliding door and/or ladder rack.

