

PRIME DESIGN™

A Safe Fleet Brand

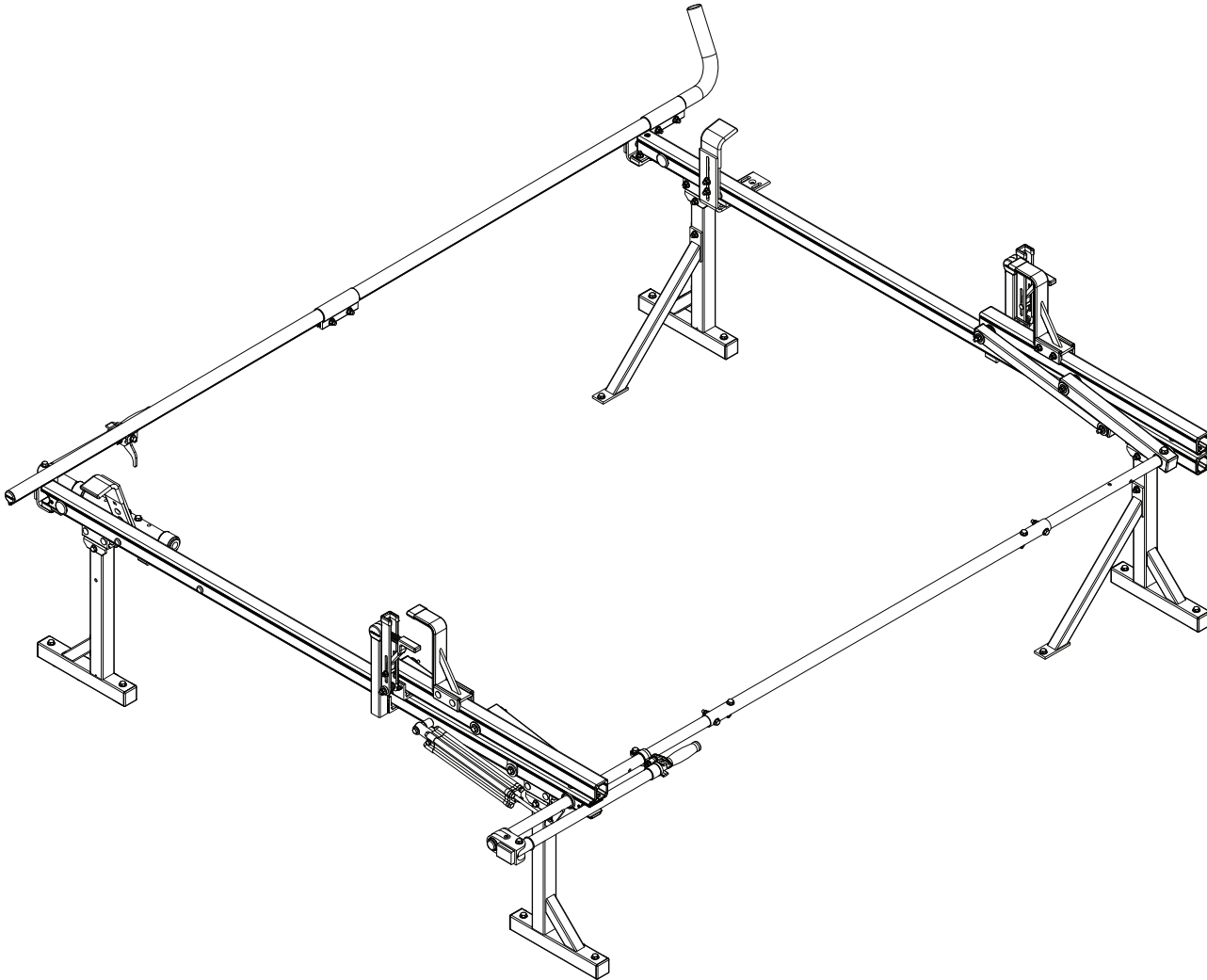

PCR

PRIME DESIGN, A SAFE FLEET BRAND

Address: 580 Opperman Drive, Eagan, MN 55123 • Toll Free: 1.8.PRIME.RACK

Fax: 651-552-1799 • Email: info@primedesign.net • Website: www.primedesign.net

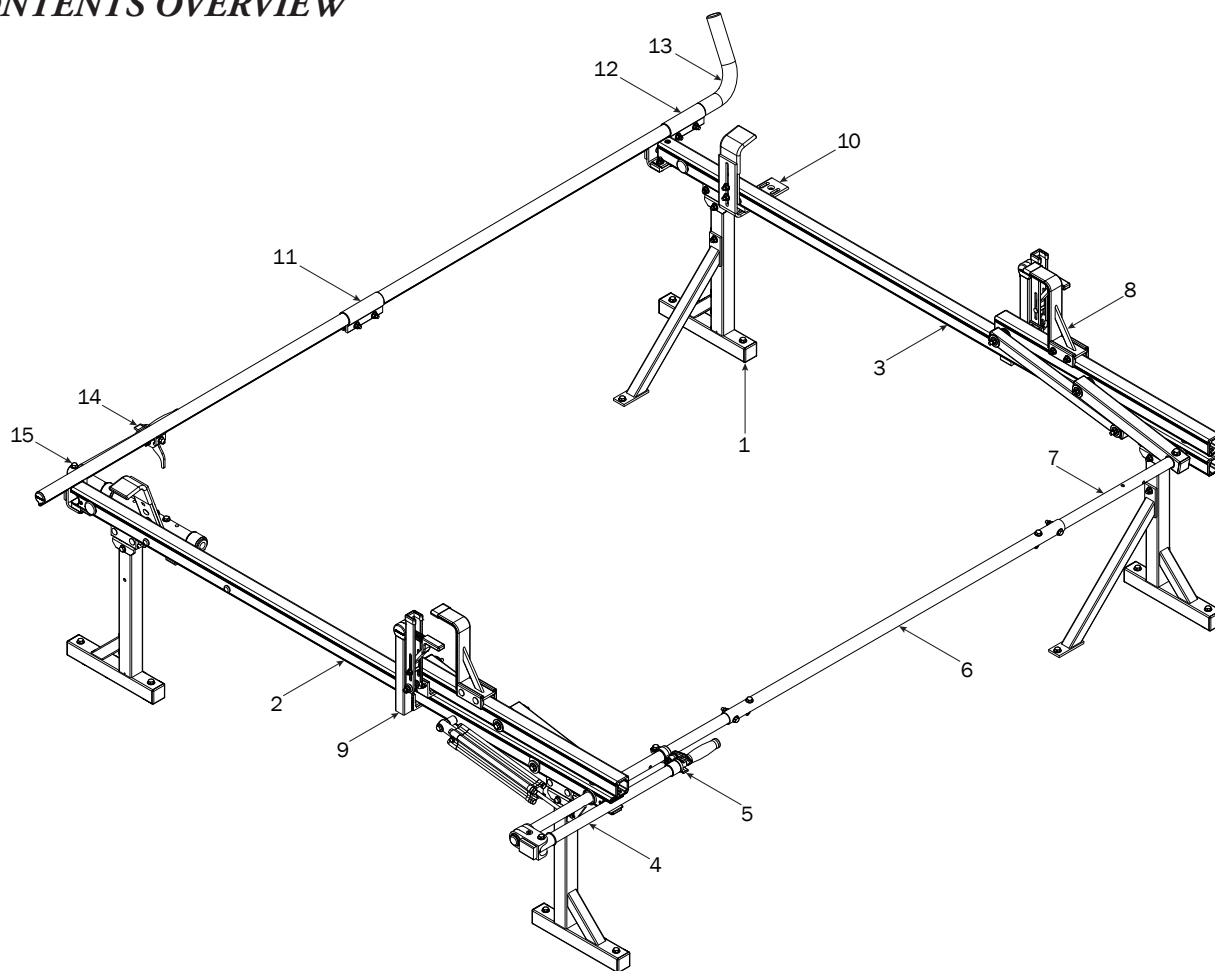

- 1—FBM-0067 (Qty 1)
Utility Elevated Base Mounting w/hardware

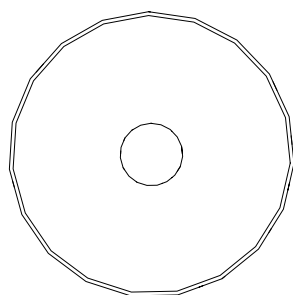

Fender Washer (10X)

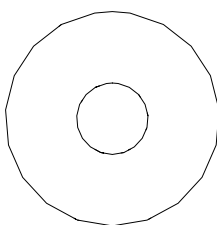

Neoprene Washer (10X)

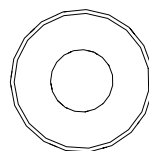

5/16" Flat Washer (14X)

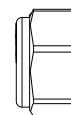

M8 Lock Nut (12X)

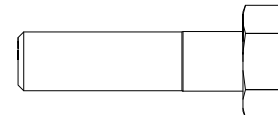

M8 x 30MM (2X)

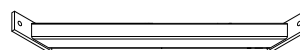

Bracket Braces (2X)

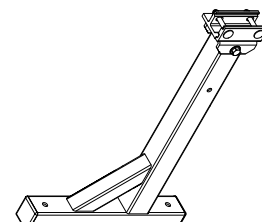

Mounting Brackets (4X)

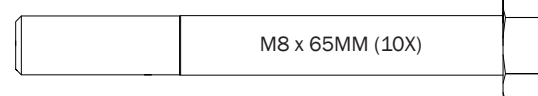

M8 x 65MM (10X)

- 2—Rear Crossbar Assembly (Qty 1)

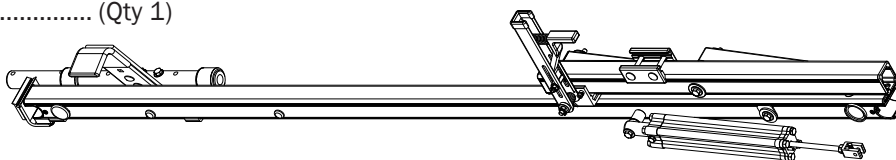

- 3—Front Crossbar Assembly (Qty 1)



4—Rear Drive Shaft..... (Qty 1)
Right Hand, 34.00"

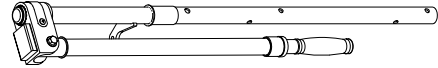

5—Handle Latch Assembly (Qty 1)



6—Connecting Bar..... (Qty 1)
48.00"

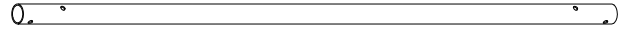

7—Front Drive Shaft (Qty 1)
B Version, 35.75"

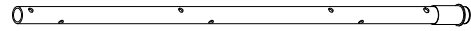

8—Z Post (Qty 2)
Adjustable, 7.25"

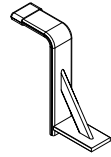

9—L Post..... (Qty 2)
Roller Cap, 9.25"

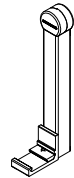

10—Front Hook Assembly (Qty 1)

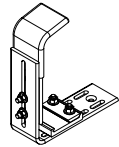

11—Clamp Down Tube (Qty 1)
92.00"

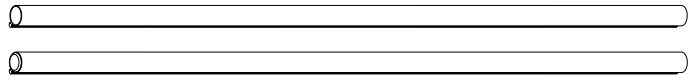

12—Quick Clamp Tube Splice Assembly..... (Qty 1)
5.00"



13—Removeable Horn with Cap..... (Qty 1)
15.00"

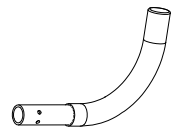

14—Clamp Down Handle Latch Assembly (Qty 1)



15—Clamp Down Handle Assembly (Qty 1)

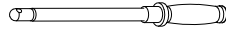

Clamp Down Handle (1X)

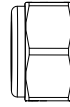

M8 Lock Nut (1X)

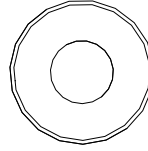
 $\frac{5}{16}$ " Flat Washer (2X)

M8 x 45MM (1X)

16—HKT-8163 (Not called out in Overview) (Qty 1)



M8 x 25MM (1X)

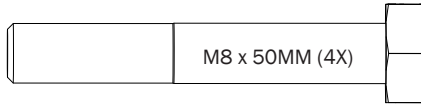

M8 x 50MM (4X)

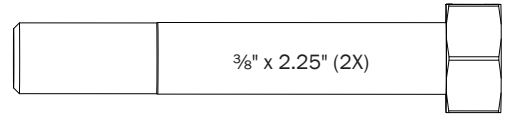
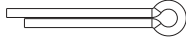
 $\frac{3}{8}$ " x 2.25" (2X)

Cotter Pin (1X)



Clevis Pin (1X)

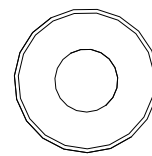
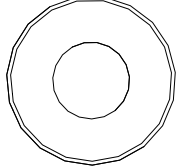
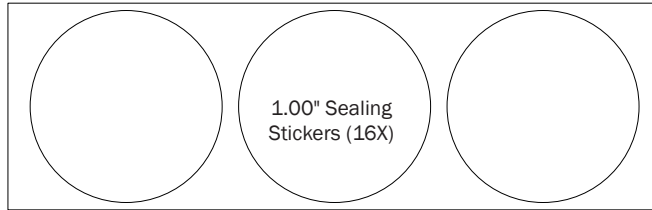

M8 Lock Nut (5X)

 $\frac{3}{8}$ " Lock Nut (2X) $\frac{5}{16}$ " Flat Washer (10X) $\frac{3}{8}$ " Flat Washer (4X)1.00" Sealing
Stickers (16X)

Anti-Seize (1X)

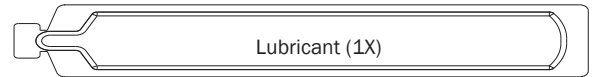

Lubricant (1X)

FBM-0067

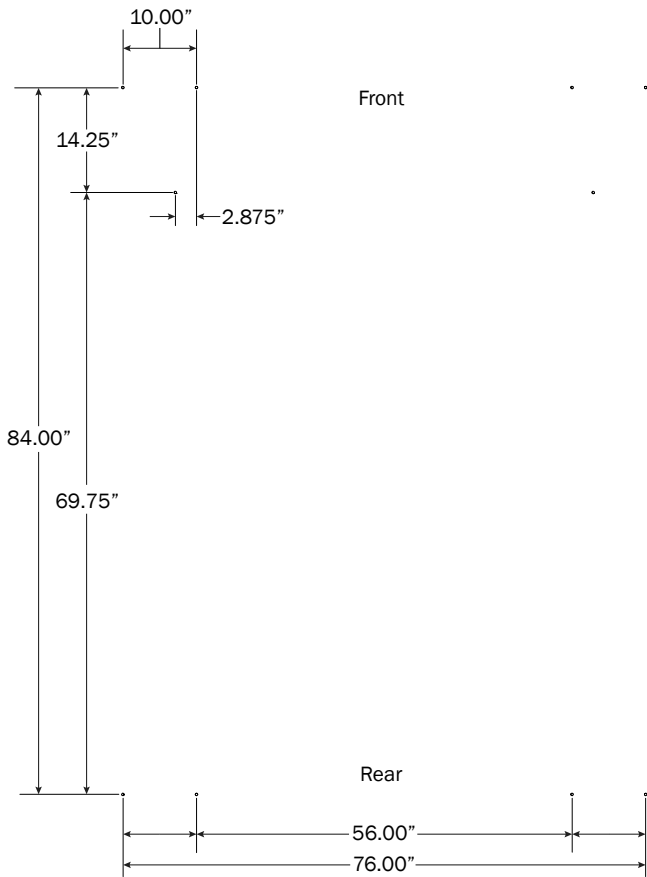

0.1

Install all Mounting Brackets using supplied hardware.

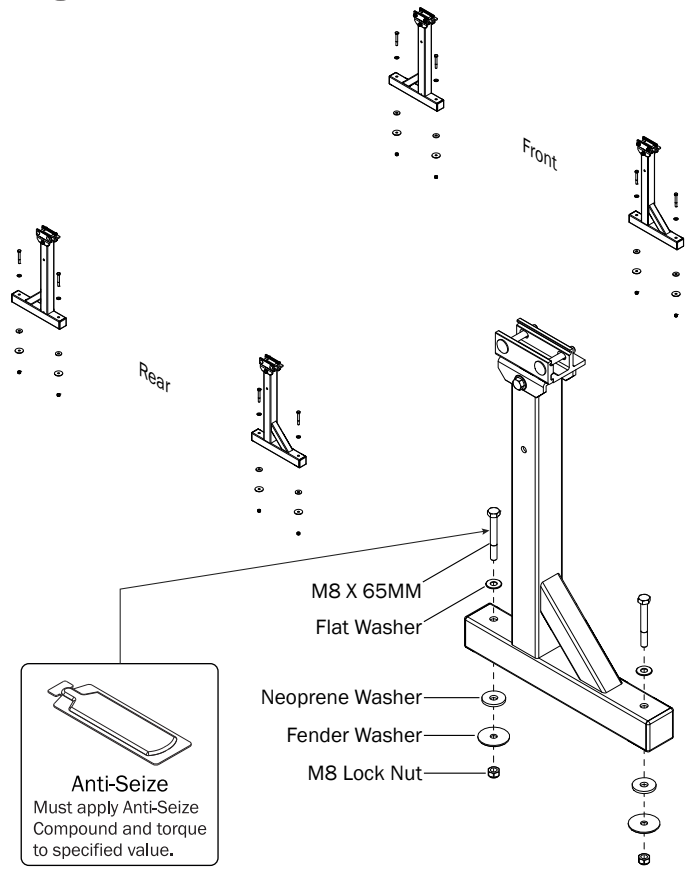

0.2

Attach Brace using supplied hardware. Do not tighten until Step 0.4

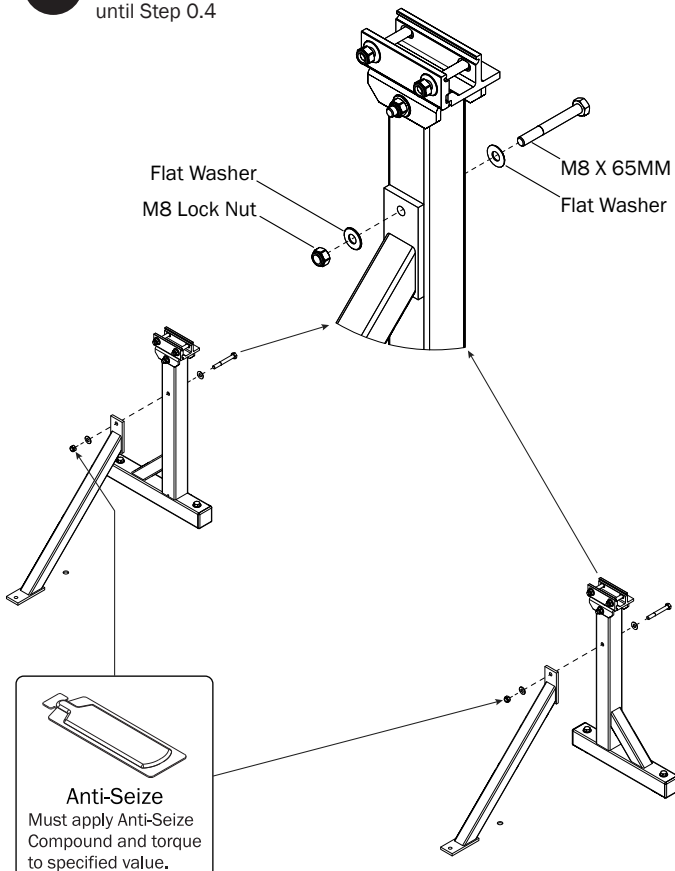

0.3

Apply Anti-Seize to Mounting Bolts and complete installation of mounting system.

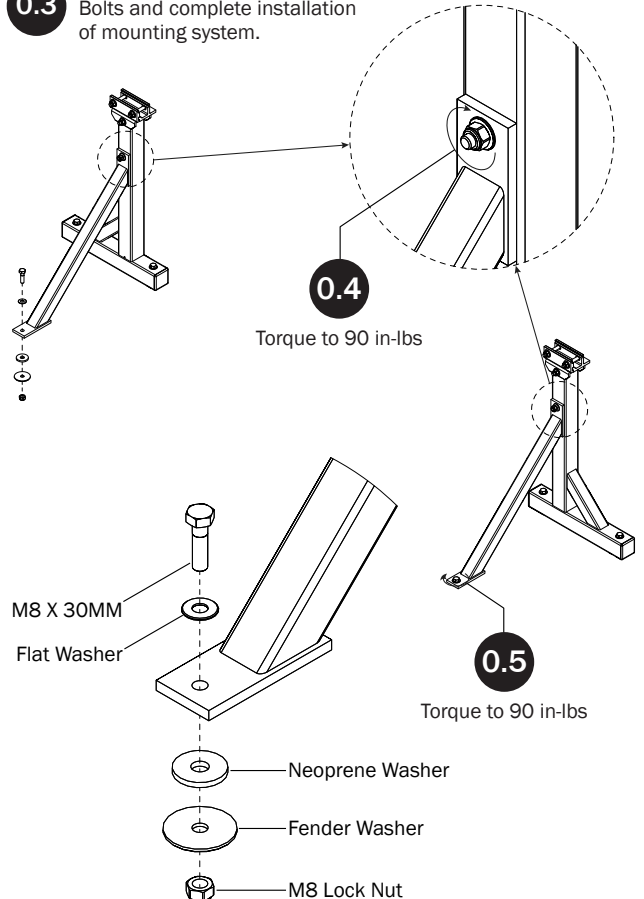

RIGHT ROTATION ASSEMBLY SEQUENCE

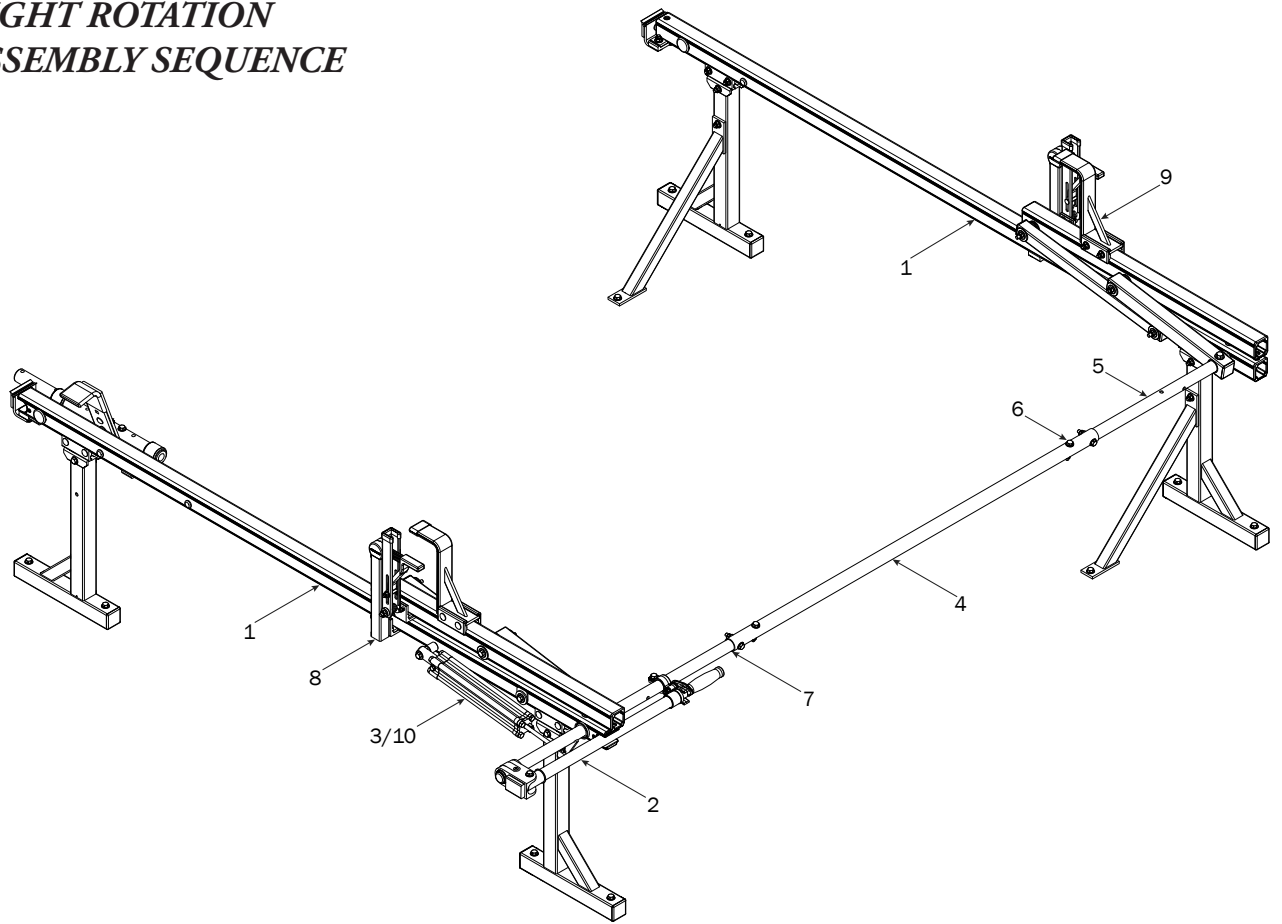

CROSSBARS

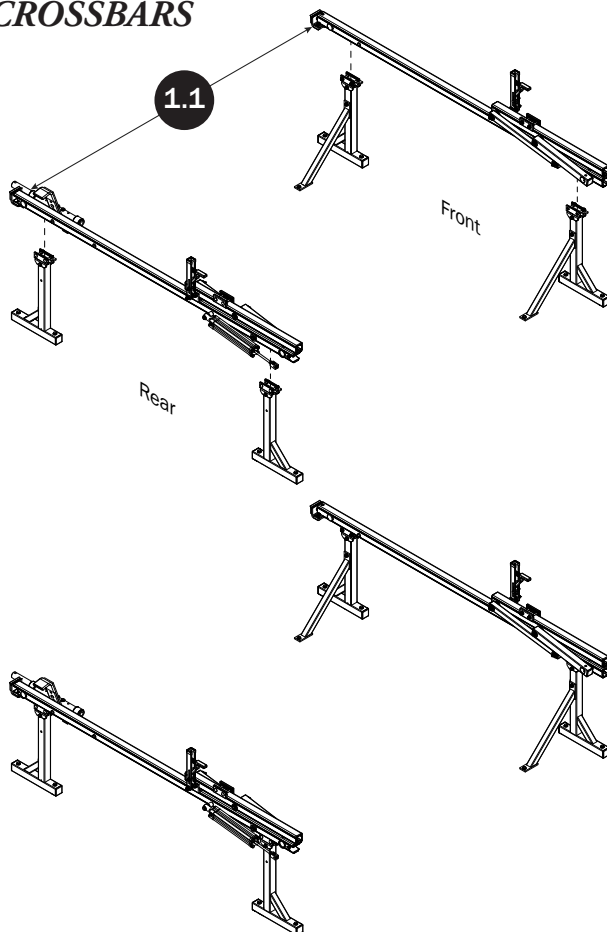

CROSSBAR ADJUSTMENT

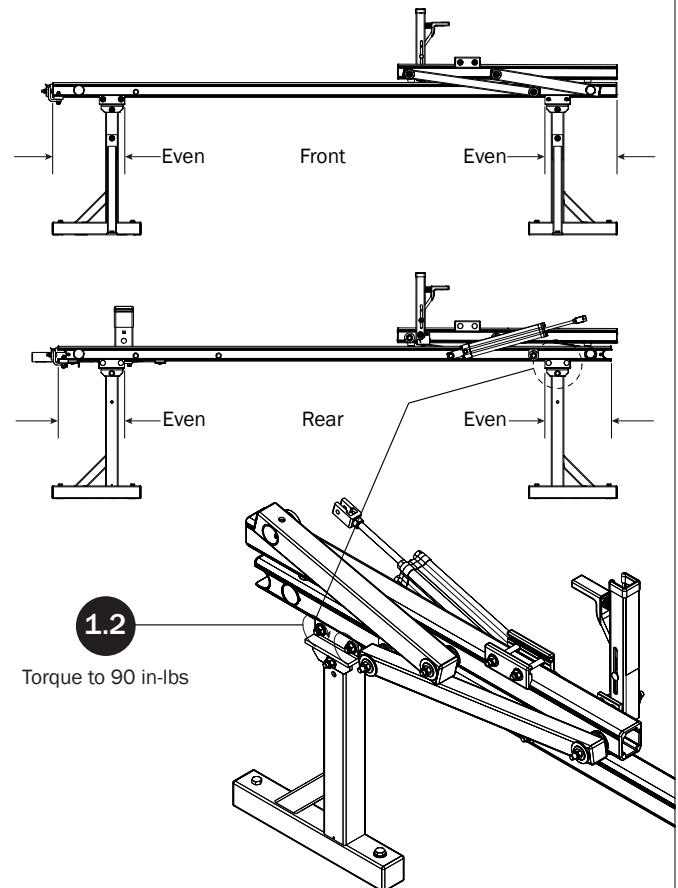

REAR DRIVE SHAFT

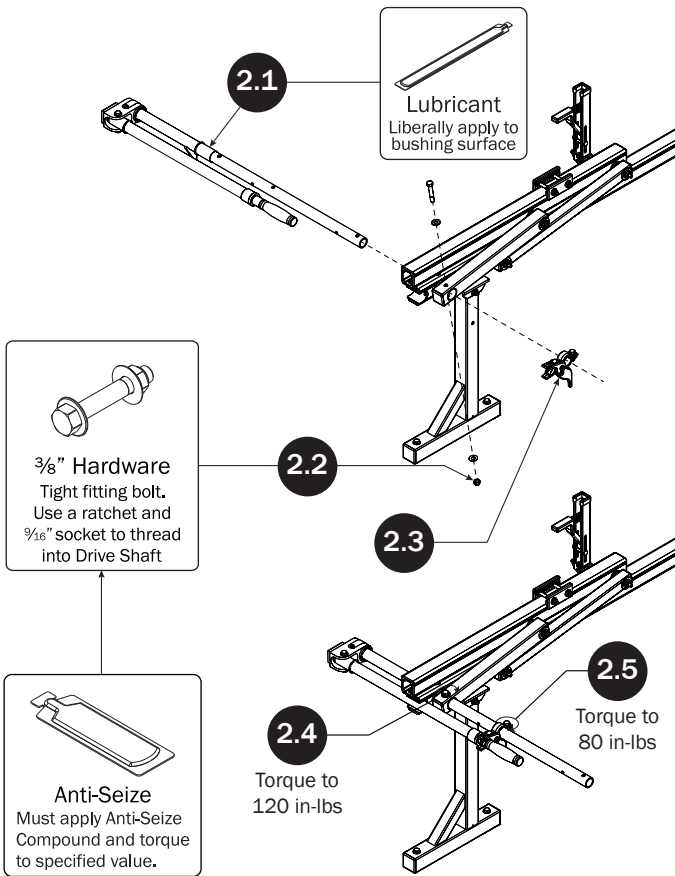

CYLINDER HARDWARE

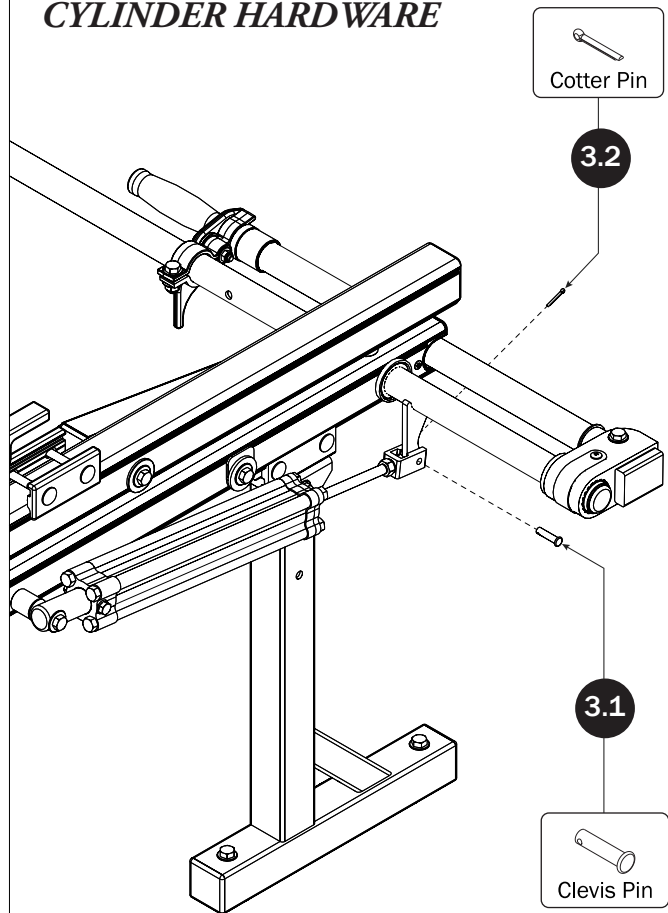

CONNECTING BAR

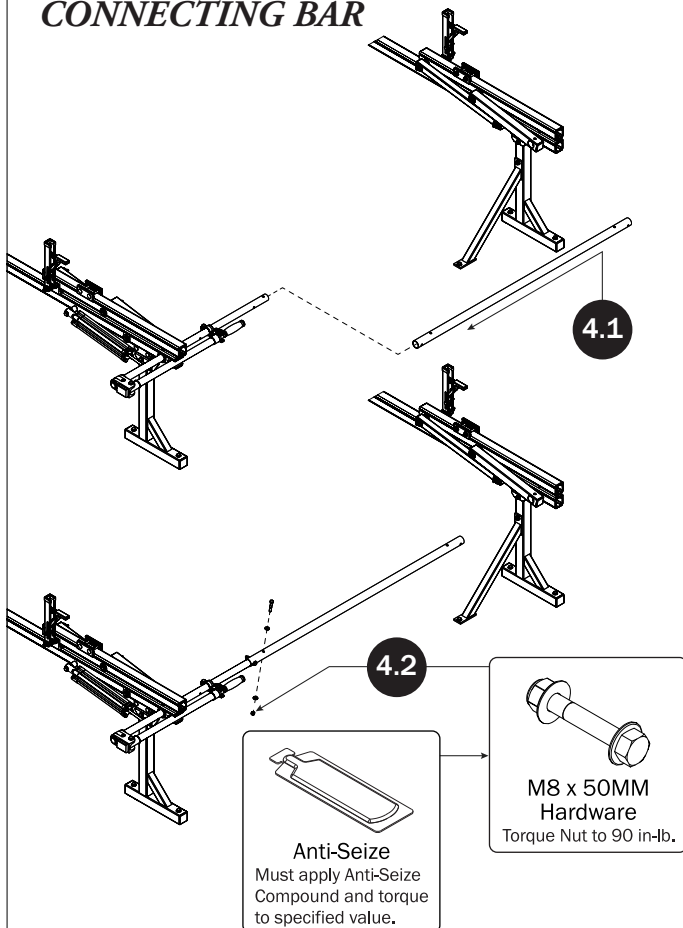

FRONT DRIVE SHAFT

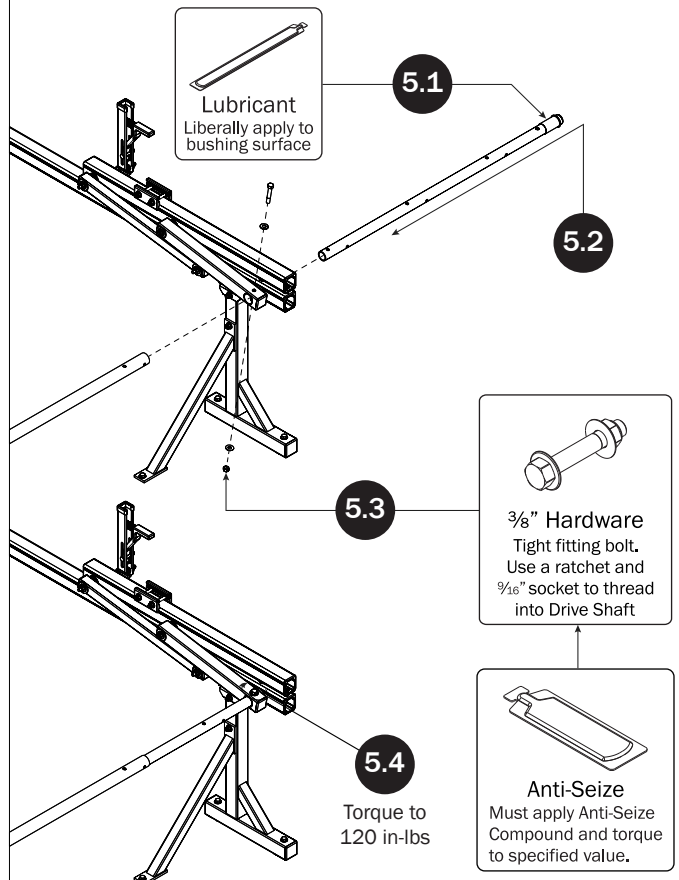

CONNECTING BAR FASTENERS

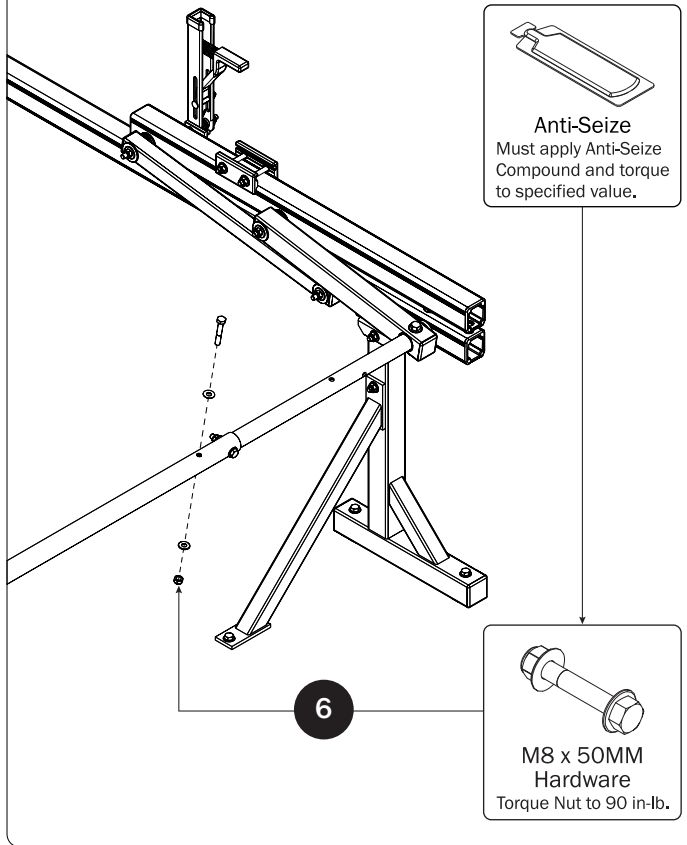

DRIVE SHAFT SEALING

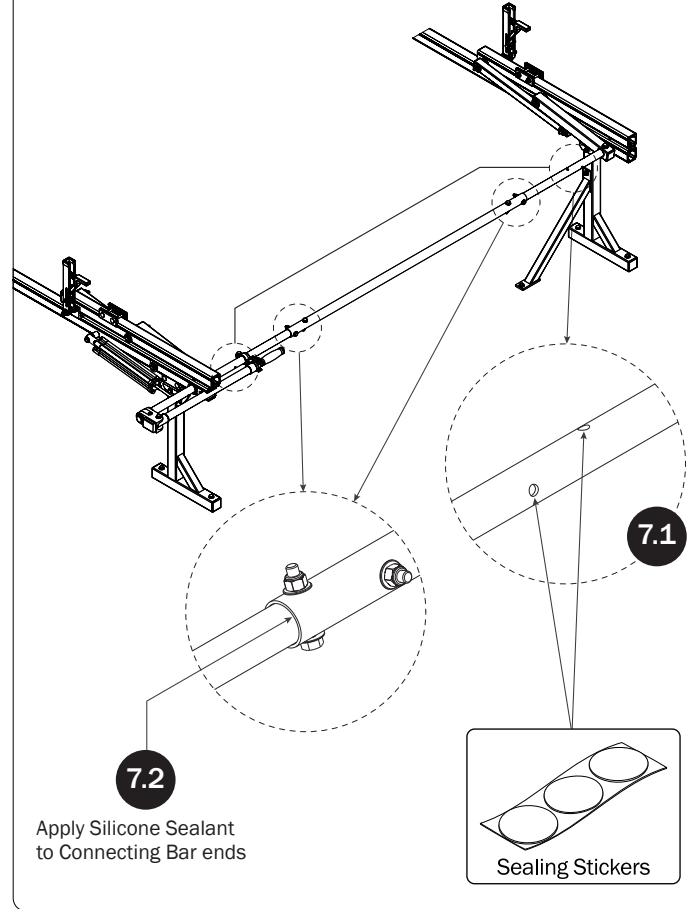

L POSTS

SEE QUICK START GUIDE FOR ADJUSTMENTS

NOTE: The Auto Clamps may come preset from the factory for packaging purposes only. To assemble the L Posts to the Crossbars, the Auto Clamps may need to be repositioned.

Ensure the Auto Clamp Spring is seated into the spring catch.

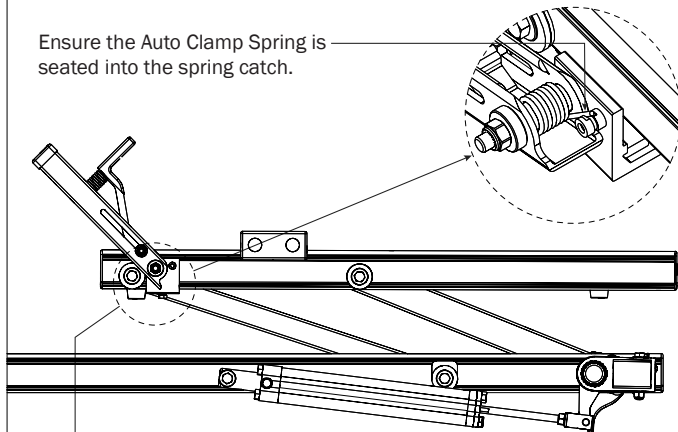

8.1 Beginning with the Rear Crossbar, loosen the bolt at the bottom of the Auto Clamp, then slide the Auto Clamp toward the inside end of the Rotation Upper. Reposition the Auto Clamp leaving a minimum of 1/4" distance from the rubber bumper to the edge of the Auto Clamp Bracket as shown, then finger-tighten if adjusting later, or torque to 80 in-lbs.

8.2

Prepare the L Post by removing the hex head bolt, lock washer, flat washer, and Bracket Clamp. Retain for installation Steps 8.4—8.8.

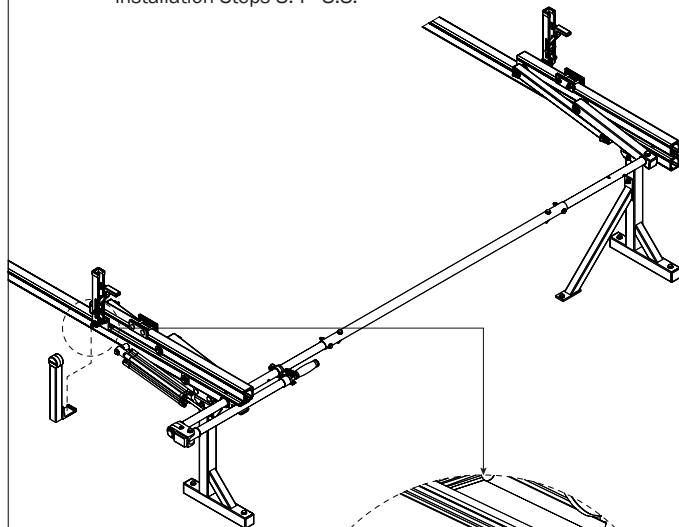

8.3

Place the L Post into the bottom groove of the Rear Crossbar, ensuring the L Post seats into the Crossbar's inside bottom groove as seen from the front of the Rear Crossbar.

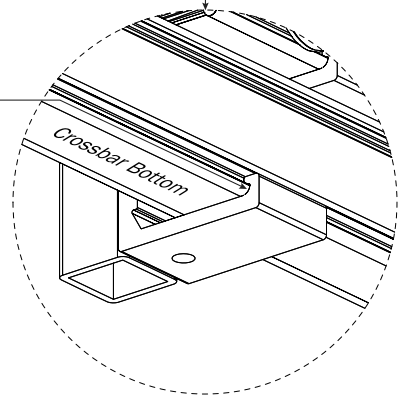

8.4

Slide L Post Bracket Clamp into bottom groove, then slide into L Post Bracket as shown.

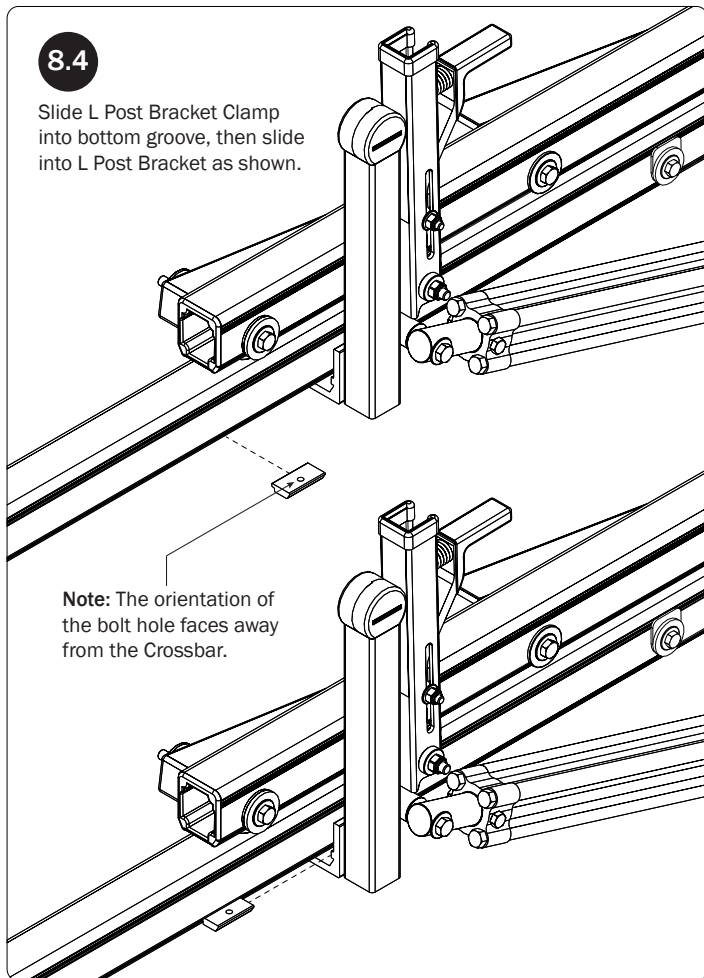

Note: The orientation of the bolt hole faces away from the Crossbar.

8.5

Bracket Clamp sits in L Post Bracket as shown.

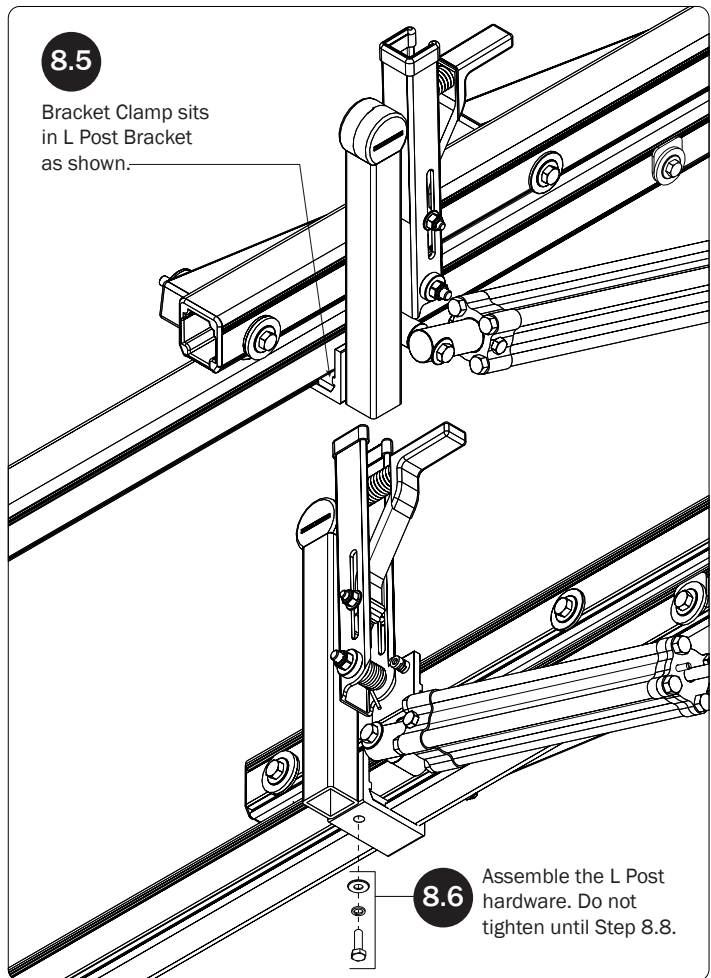

8.6

Assemble the L Post hardware. Do not tighten until Step 8.8.

8.7

Slide the L Post until parallel to the Auto Clamp and the gap between the two is even from top to bottom.

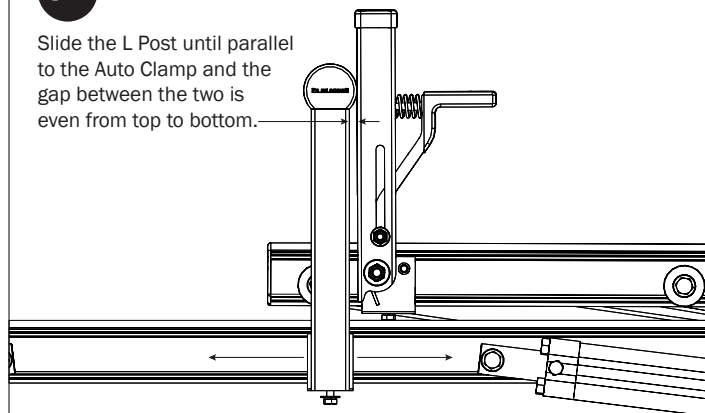

Torque to 80 in-lbs

8.8

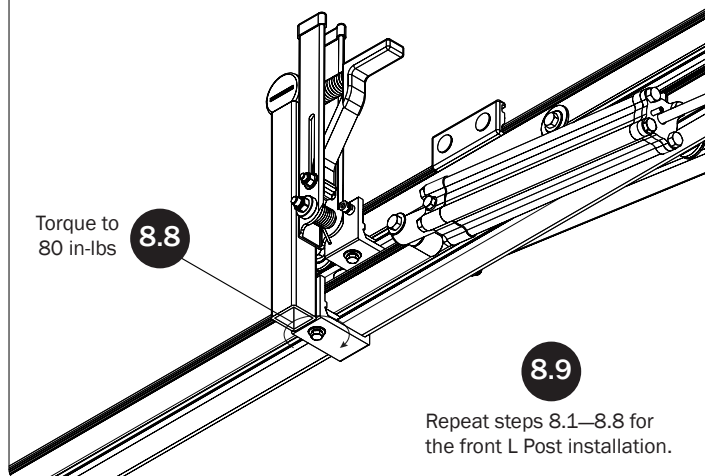

8.9

Repeat steps 8.1—8.8 for the front L Post installation.

9.2

Refer to the Quick Start Guide for Z Post positioning.

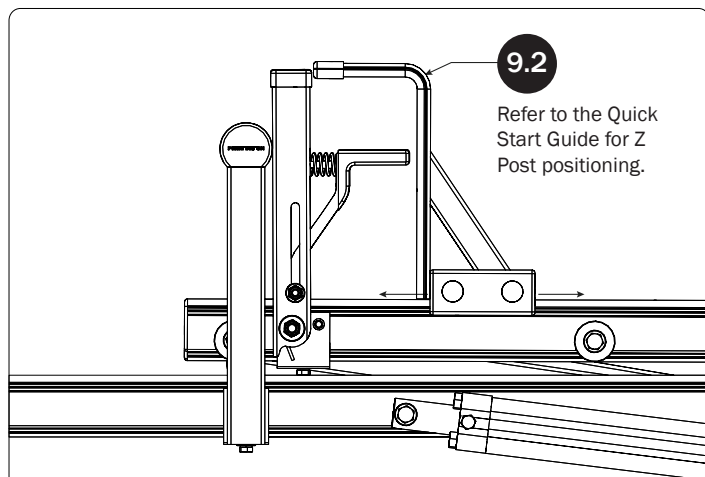

9.3

Torque to 90 in-lbs

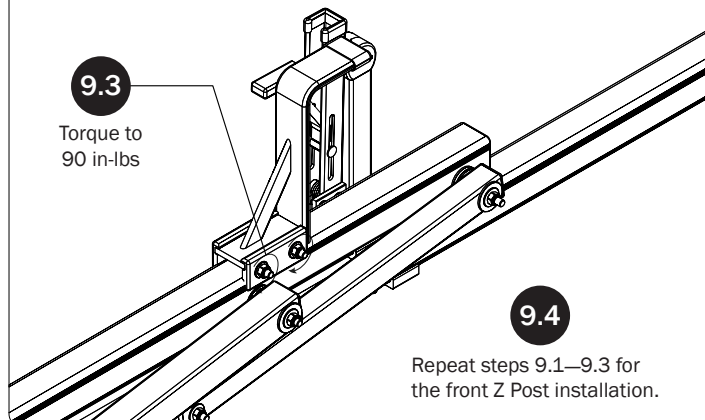

9.4

Repeat steps 9.1—9.3 for the front Z Post installation.

Z POSTS

SEE QUICK START GUIDE FOR ADJUSTMENTS

9.1

Slide the Z Post into the Mounting Clamp Assembly.

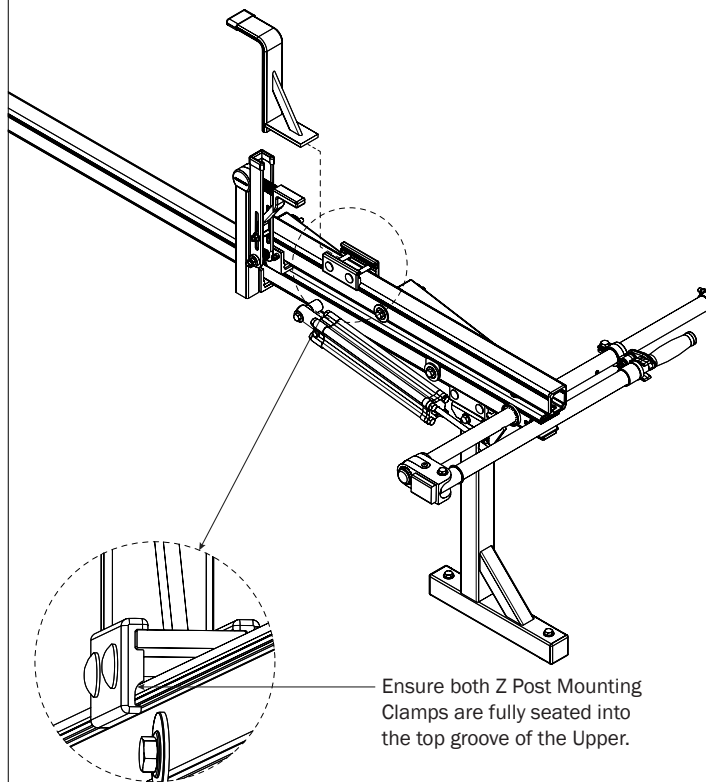

Ensure both Z Post Mounting Clamps are fully seated into the top groove of the Upper.

CYLINDER ADJUSTMENT

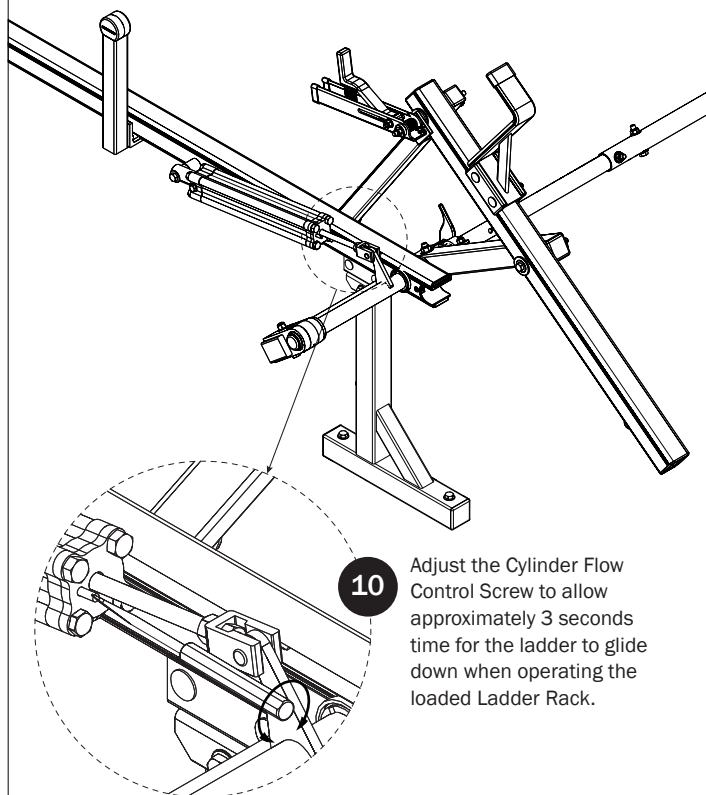

10

Adjust the Cylinder Flow Control Screw to allow approximately 3 seconds time for the ladder to glide down when operating the loaded Ladder Rack.

LEFT CLAMP DOWN ASSEMBLY SEQUENCE

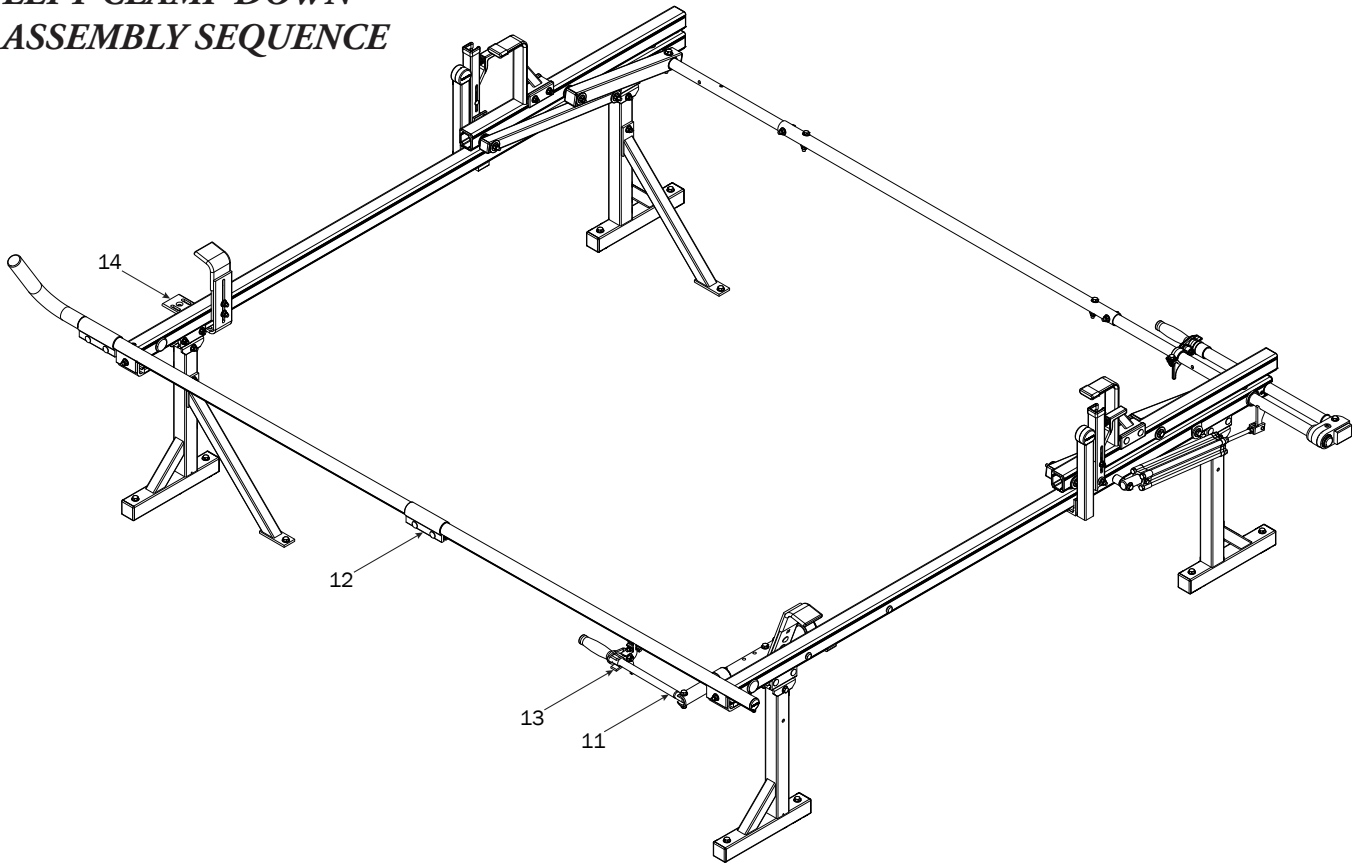

CLAMP DOWN HANDLE

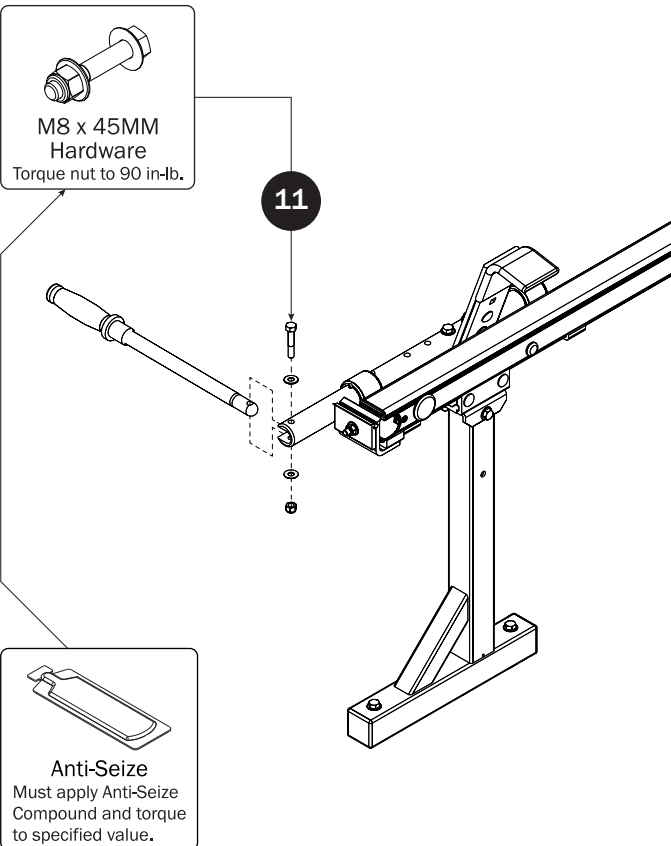

CLAMP DOWN TUBE

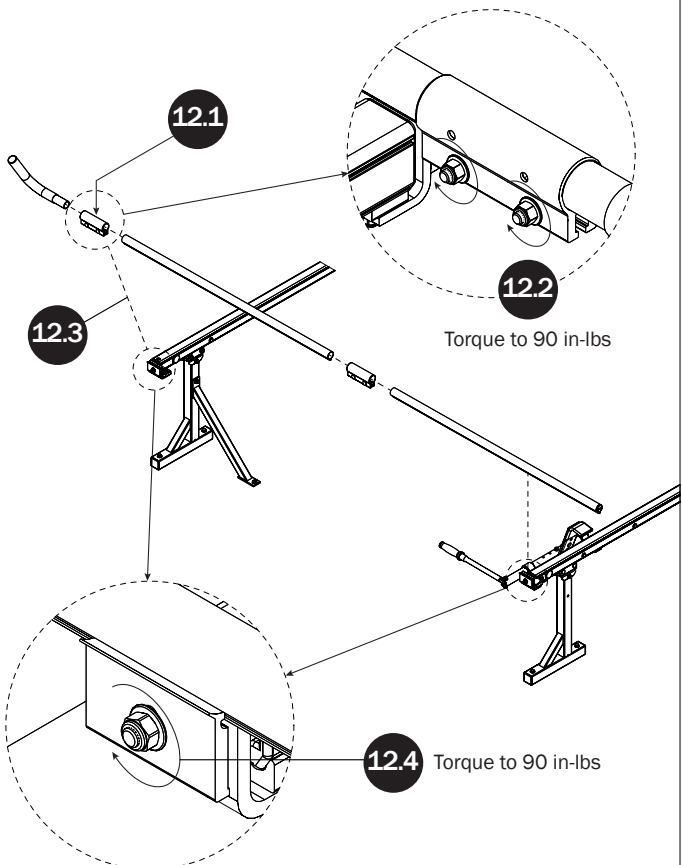

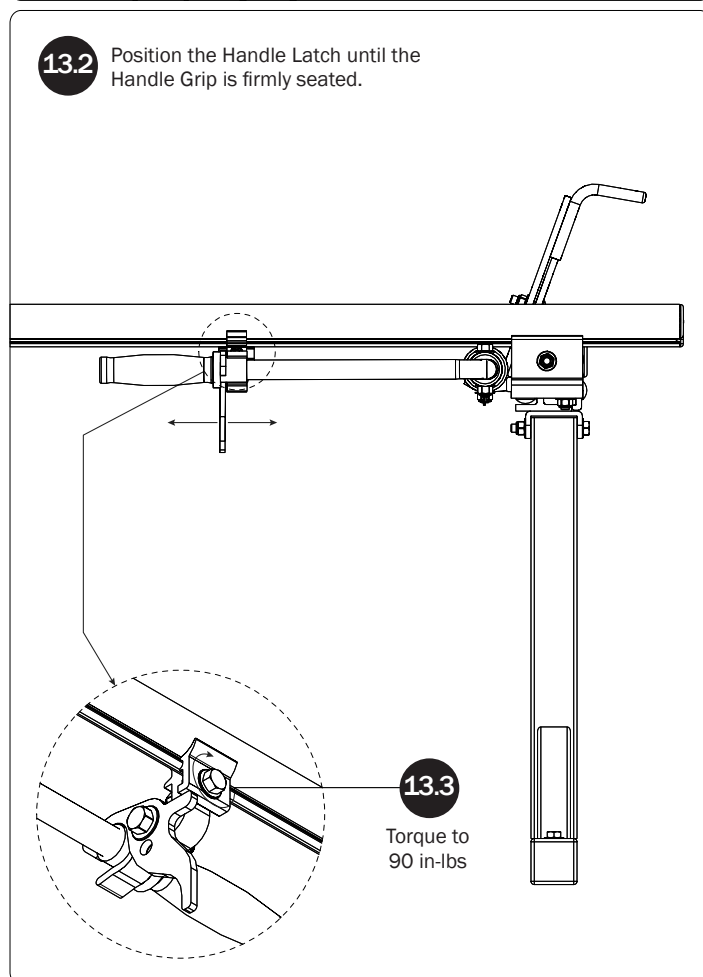
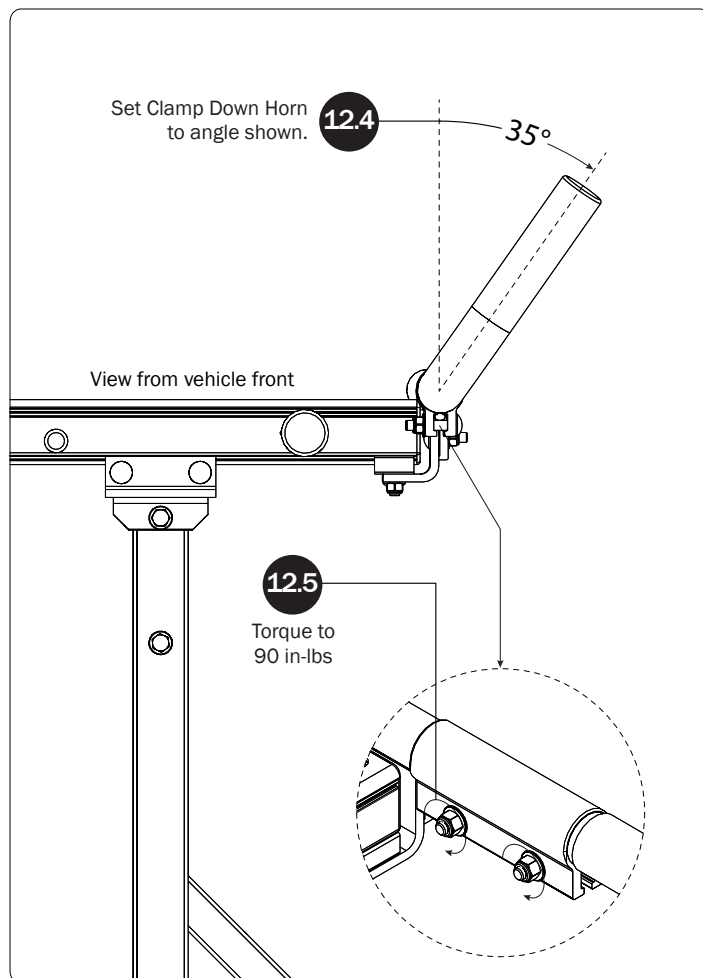
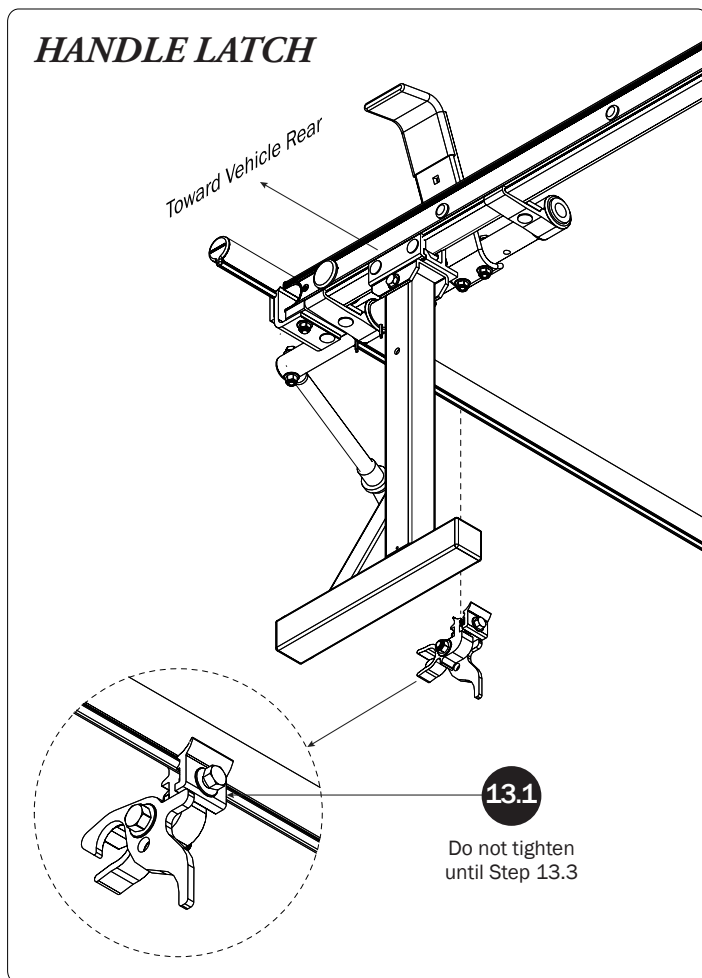
**HANDLE LATCH****FRONT LADDER HOOK**
SEE QUICK START GUIDE FOR ADJUSTMENTS

14.1 Remove and retain the Front Ladder Hook fastening hardware (not shown in this view) for Steps 14.3 and 14.4

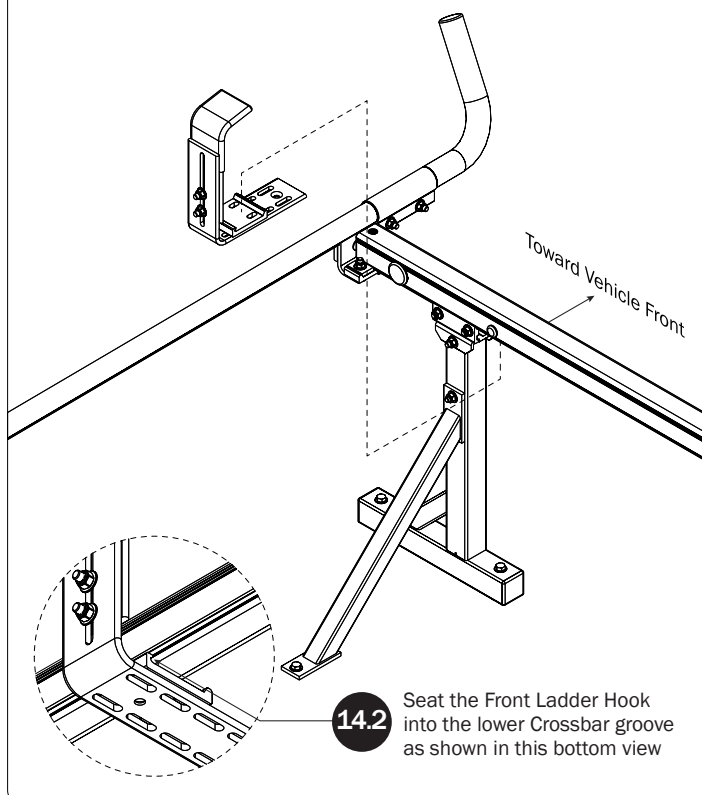

14.3

Place the Front Hook Clamp Bracket removed in Step 14.1 into the lower groove of the Crossbar, and slide it on top of the Front Ladder Hook Clamp

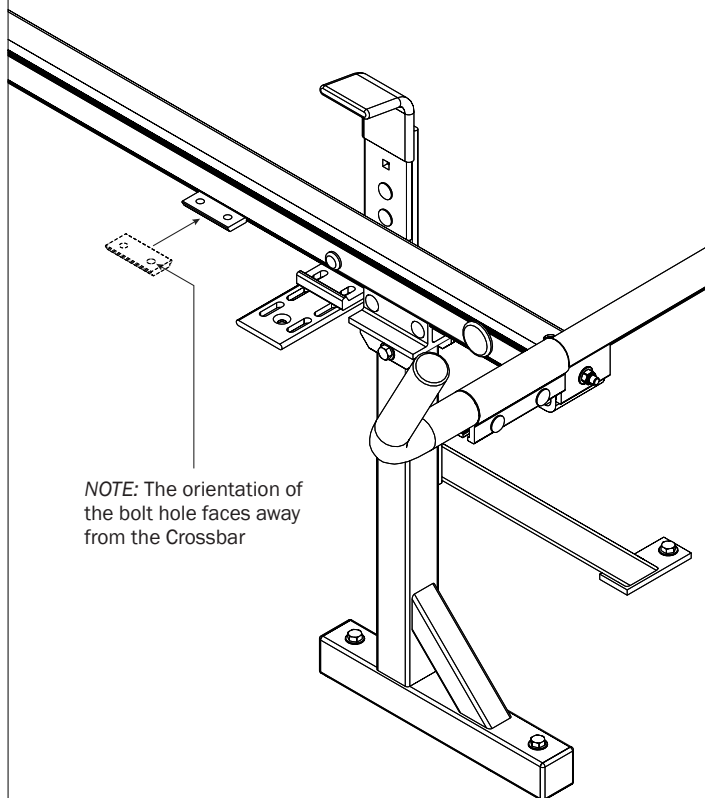

14.4

Reassemble the Front Clamp Down Tube Holder using the fastening hardware removed at Step 14.1. Do not tighten until Step 14.6

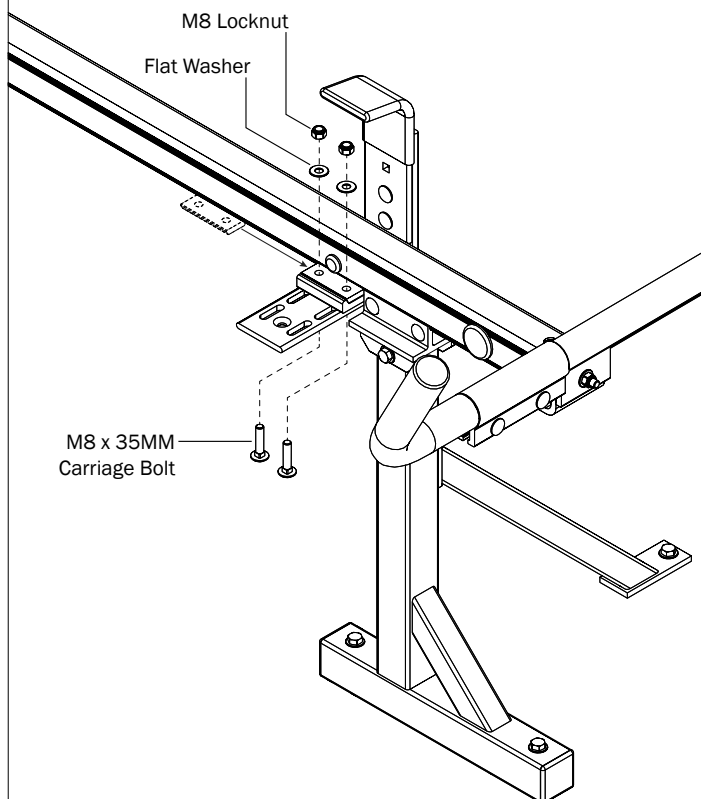

14.5

Adjust the Front Hook until it aligns with the Rear Hook. Perfect alignment may not be possible in all instances, and depends upon the location of the Crossbar Mounting Brackets. If such interference should occur, align the Hook as close as possible.

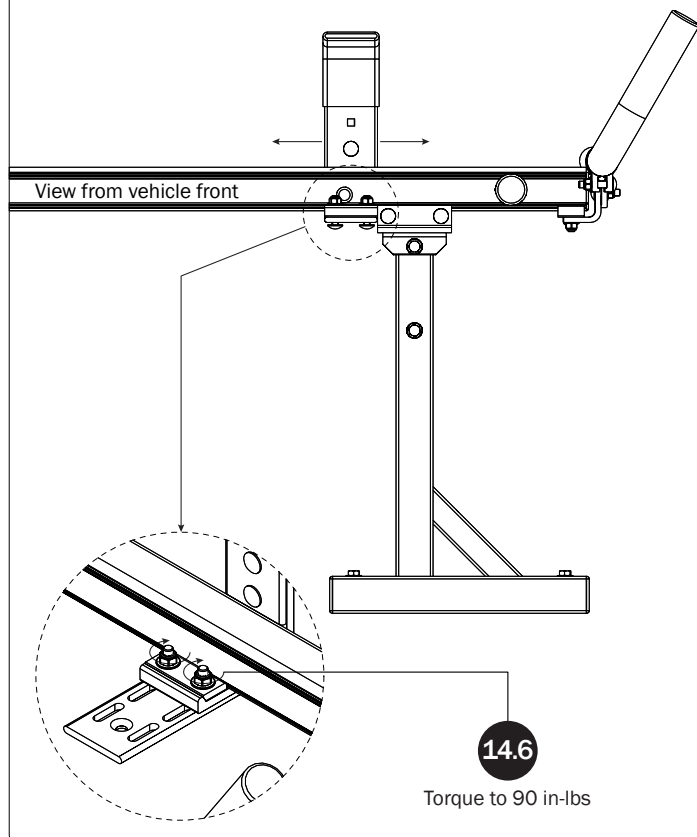

Page Intentionally Left Blank

Page Intentionally Left Blank

