

PRIME DESIGN™

A Safe Fleet Brand

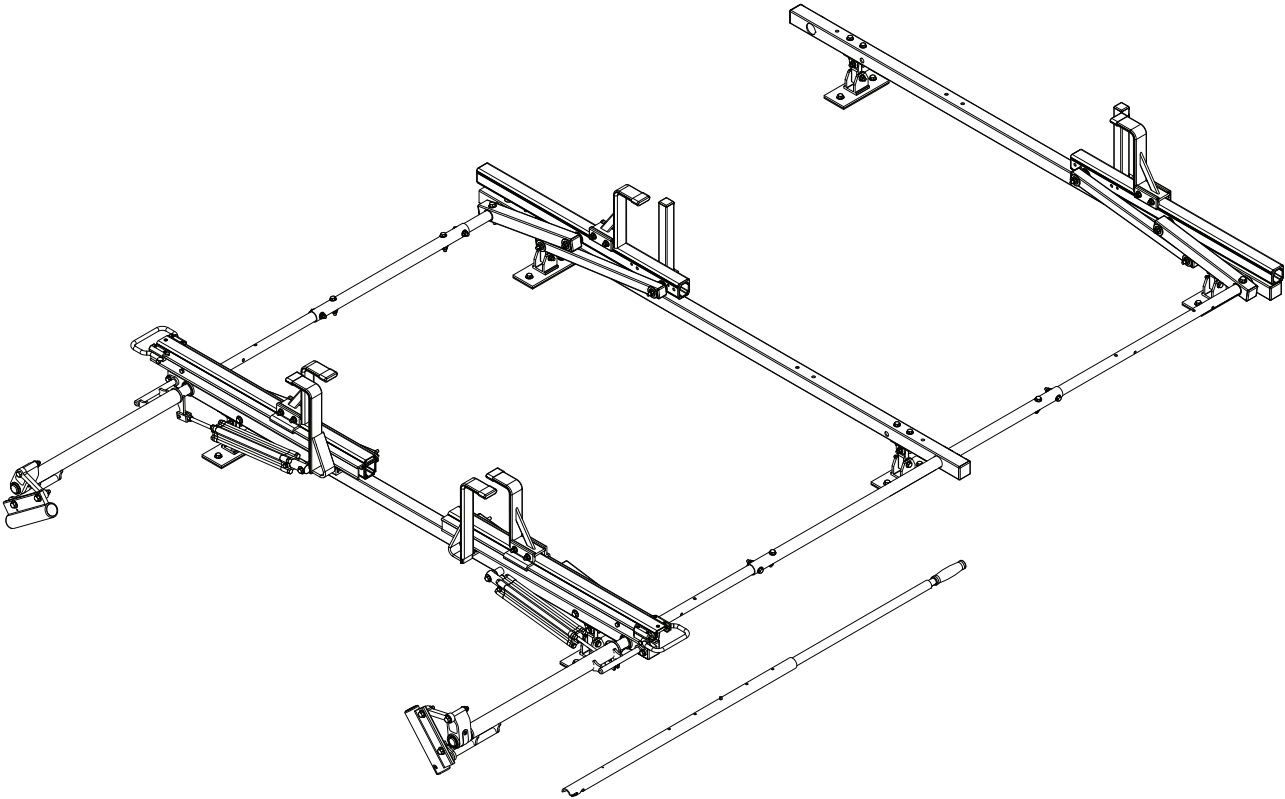

HRR-369-E-UM3

4

CONTENTS OVERVIEW

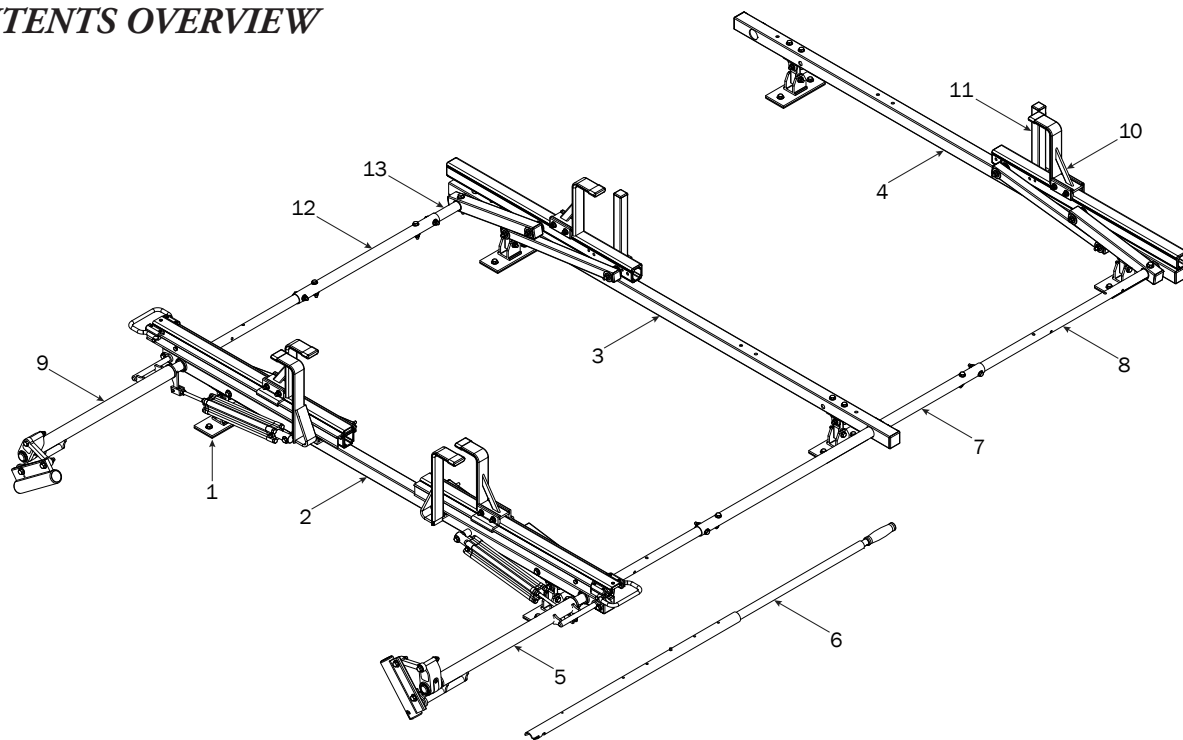

1—MTG-8003..... (Qty 3)
Mounting Feet w/HKT-8129



Mounting Top (2X)



Mounting Post (2X)

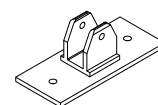

Mounting Foot (2X)

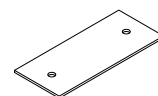

Foam Pad (2X)

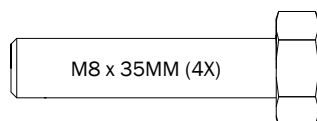

M8 x 35MM (4X)

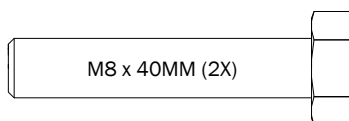

M8 x 40MM (2X)



M8 x 55MM (2X)



M8 x 70MM (4X)

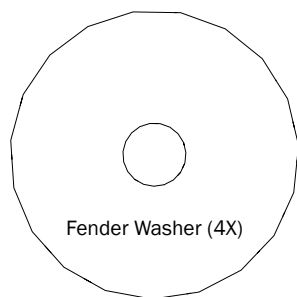

Fender Washer (4X)

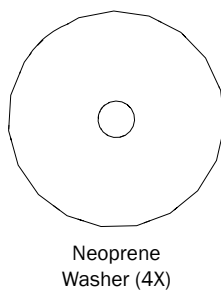
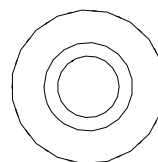
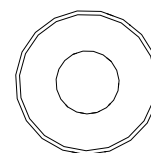
Neoprene
Washer (4X)Sealing
Washer (4X)

Flat Washer (8X)



Lock Nut (4X)

2—Rear Crossbar Assembly..... (Qty 1)

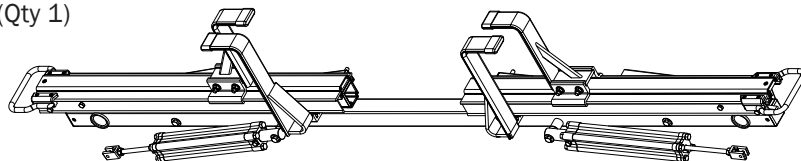

3—Center Crossbar Assembly..... (Qty 1)

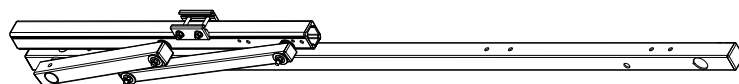

4—Front Crossbar Assembly..... (Qty 1)

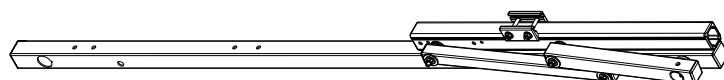

5—Rear Drive Shaft (Qty 1)
Right Hand, A Version, 50.00"

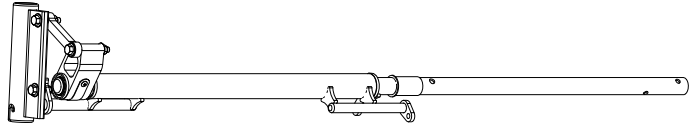

6—HHR Handle Assembly (Qty 1)
35.00"

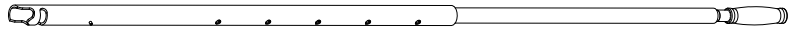

7—Connecting Bar (Qty 2)
48.00"

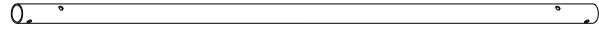

8—Front Drive Shaft (Qty 2)
B Version, 35.75"

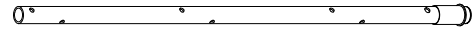

9—Rear Drive Shaft (Qty 1)
Left Hand, A Version, 50.00"

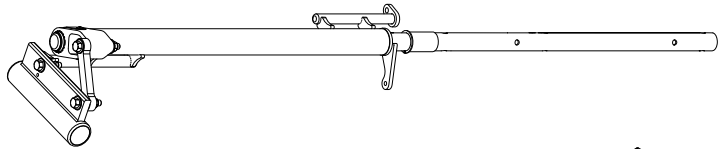

10—Z Post (Qty 2)
Adjustment, 7.25"

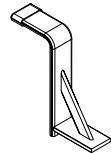

11—L Post (Qty 2)
Square Cap, 9.25"

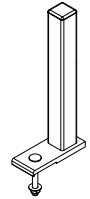

12—Connecting Bar (Qty 1)
24.00"

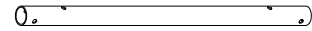

13—Front Drive Shaft (Qty 1)
B Version, 11.75"

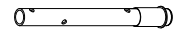

HKT-8163-Rotation Hardware Kit

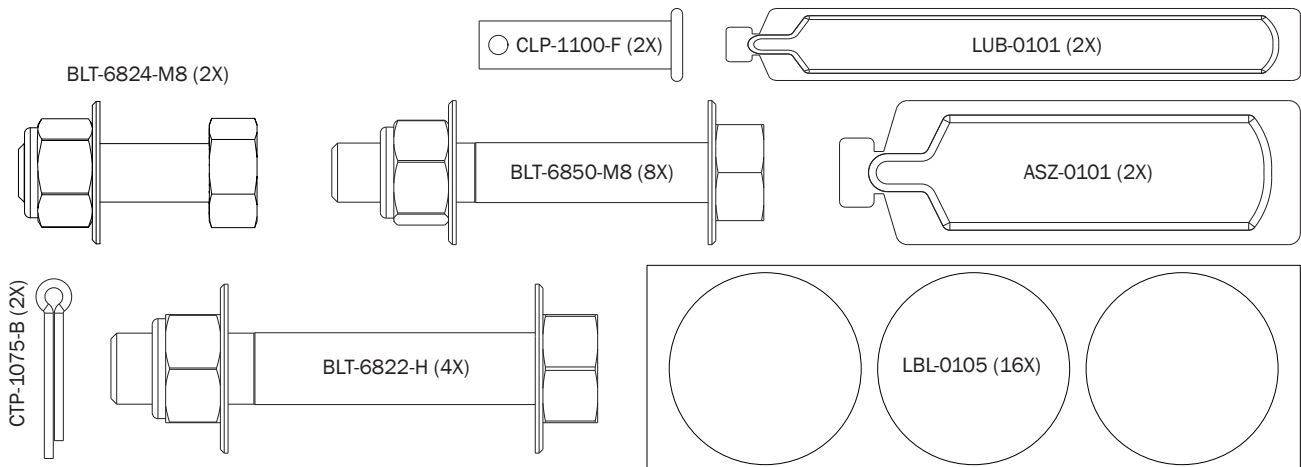

MTG-8003 MOUNTING BRACKETS TO ROOF

- 0.1** Assemble the Mounting Post to the Mounting Foot using the hardware as shown below.

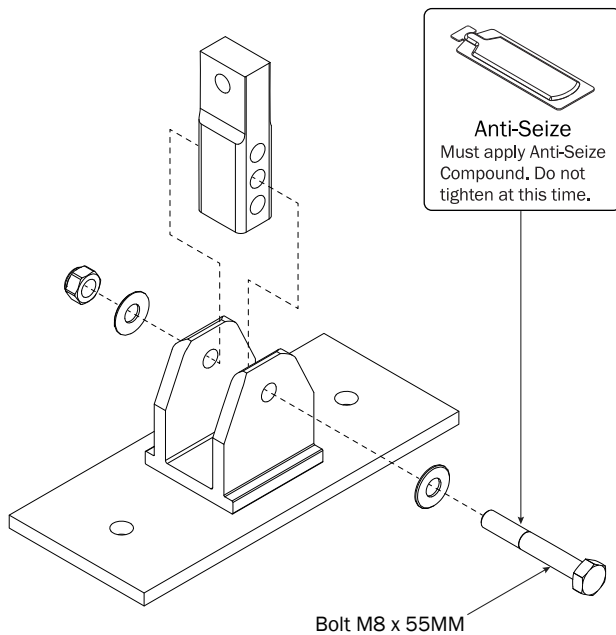

- 0.2** Assemble the Mounting Top to the Mounting Post using the hardware as shown below.

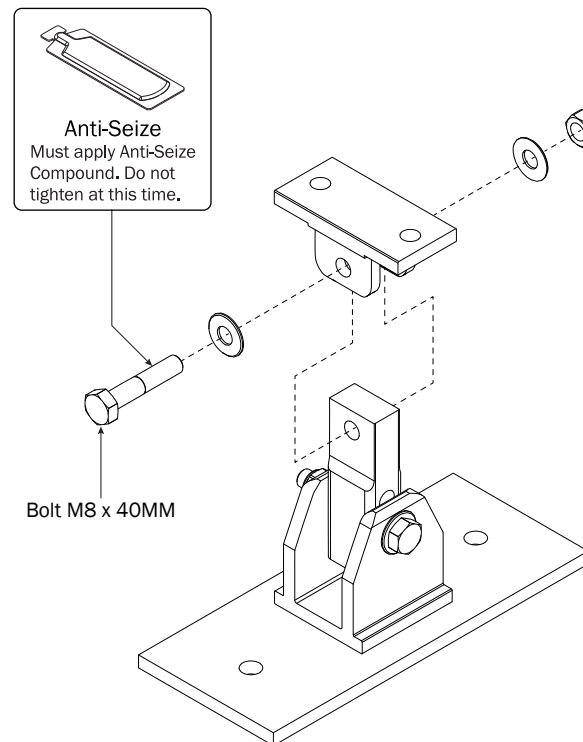

- 0.3** Drill bolt holes according to the dimensions shown.

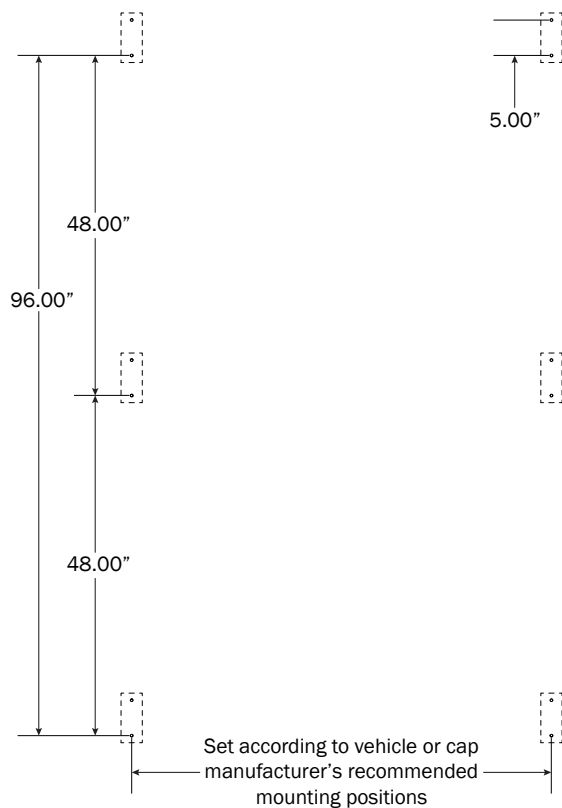

- 0.4** Assemble unto vehicle roof as shown, then torque the Mounting Feet nuts to 130 in-lbs.

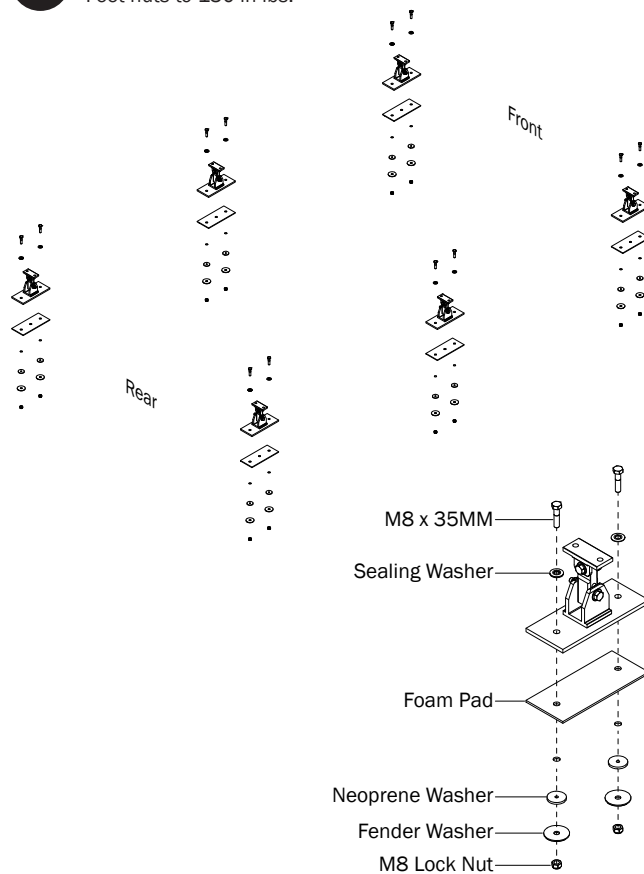

RIGHT ROTATION ASSEMBLY SEQUENCE



This Ladder Rack is engineered to fit a variety of vehicles and truck caps. As such, the Crossbars come without mounting holes and must be drilled to attach to the Bracket Tops after the Mounting Brackets have been installed to the vehicle or cap.

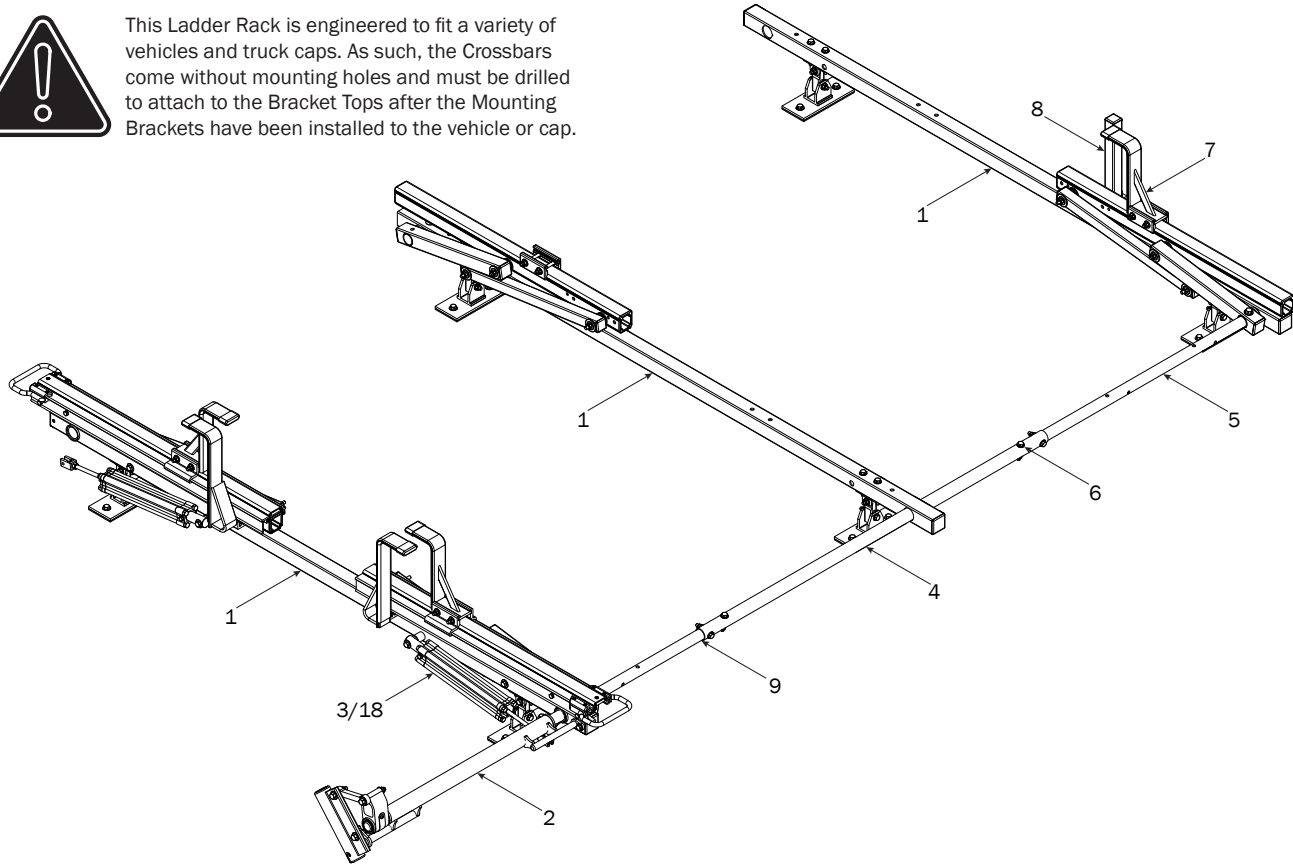

CROSSBARS

1.1 Center the Front and Rear Crossbars onto Mounting Brackets.

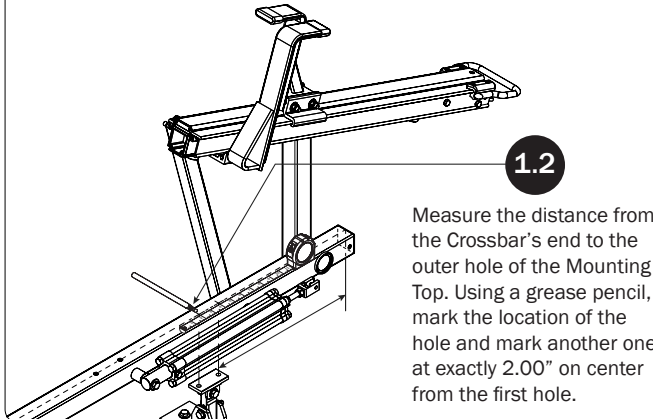
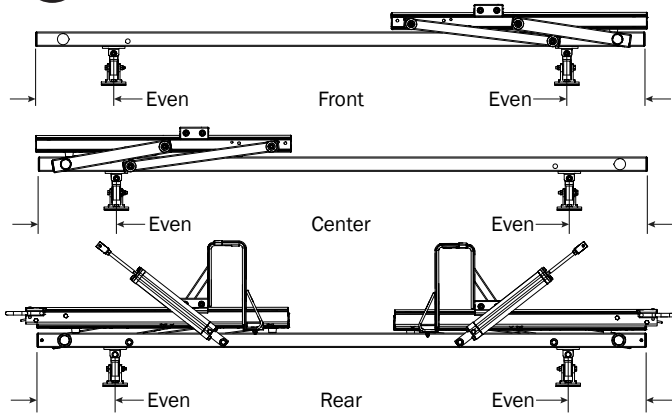

1.2

Measure the distance from the Crossbar's end to the outer hole of the Mounting Top. Using a grease pencil, mark the location of the hole and mark another one at exactly 2.00" on center from the first hole.

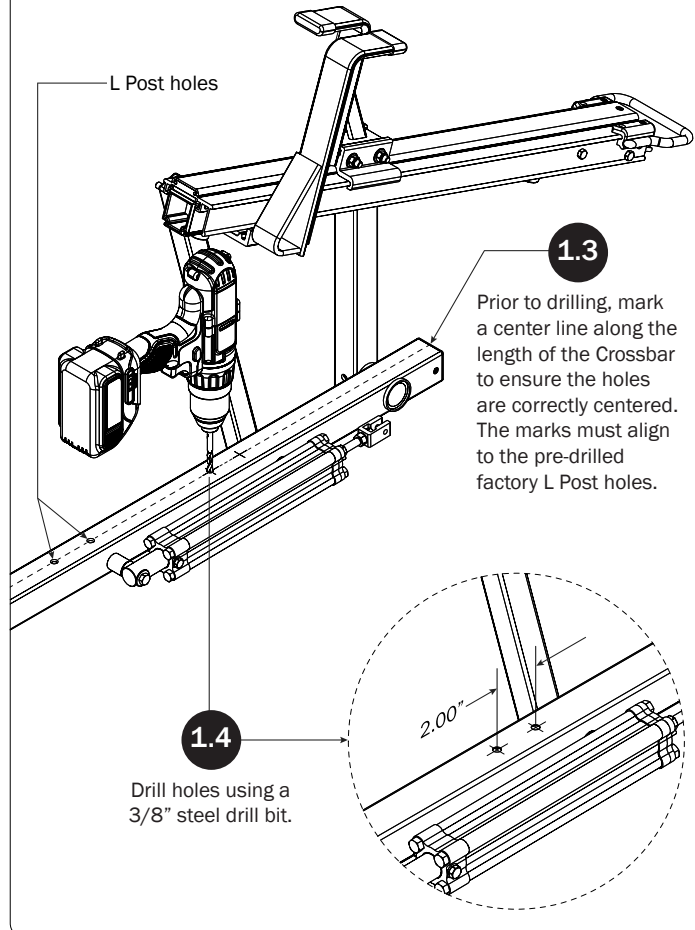

L Post holes

1.3

Prior to drilling, mark a center line along the length of the Crossbar to ensure the holes are correctly centered. The marks must align to the pre-drilled factory L Post holes.

1.4

Drill holes using a 3/8" steel drill bit.

2.00"

1.5

Attach the Crossbars to the Mounting Brackets using the supplied hardware.

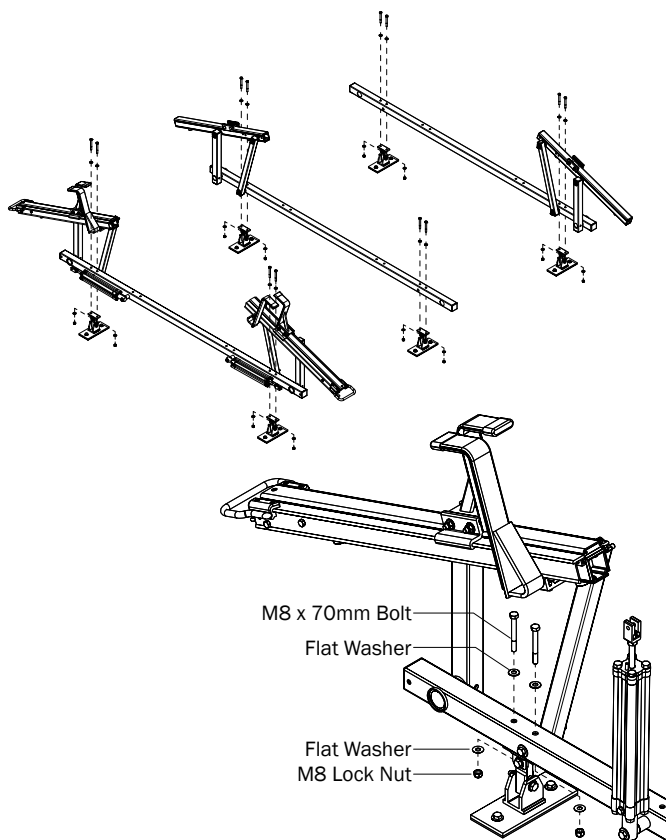

1.6

Torque to 90 in-lbs

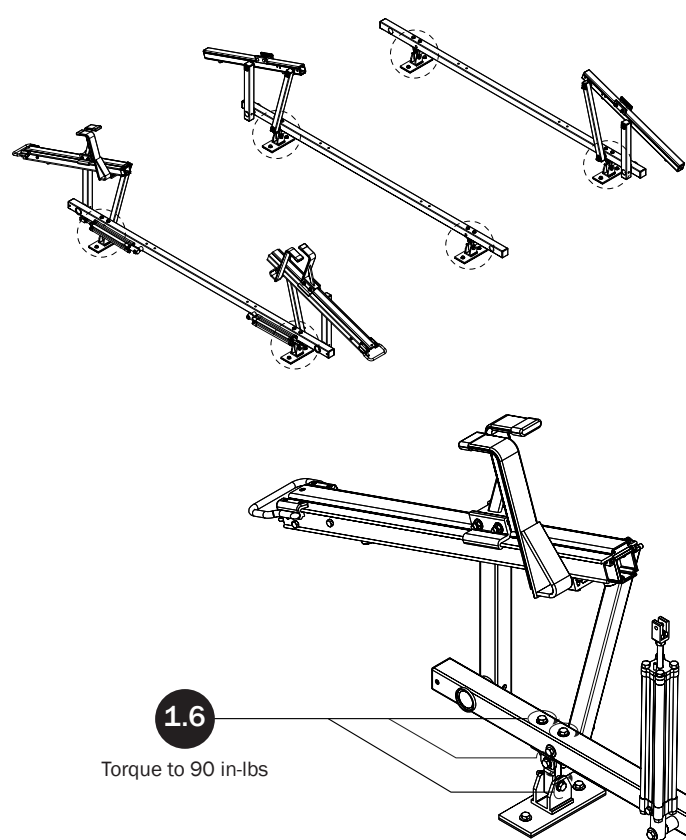

REAR DRIVE SHAFT

2.1

Lubricant
Liberal apply to
bushing surface

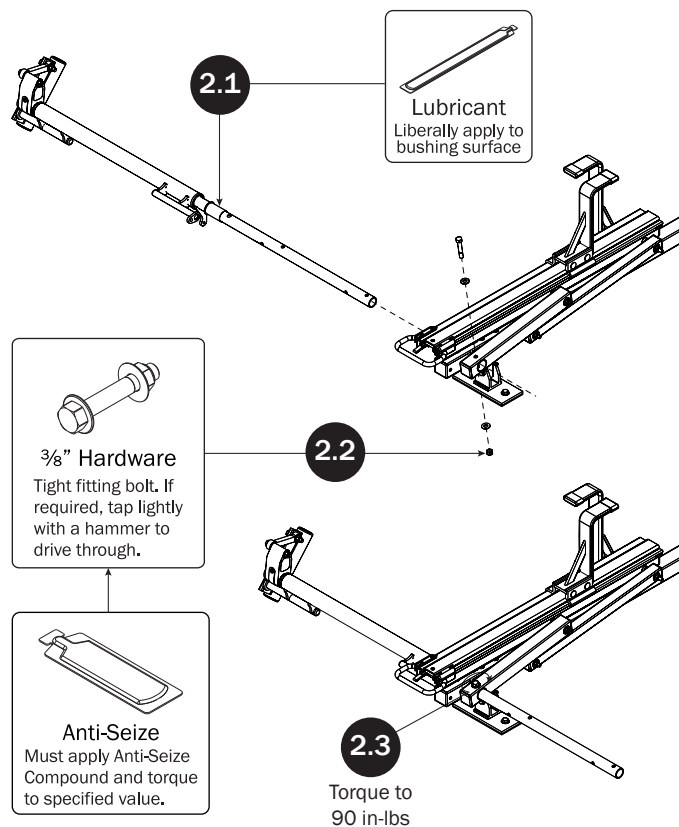

$\frac{3}{8}$ " Hardware
Tight fitting bolt. If
required, tap lightly
with a hammer to
drive through.

2.2

Anti-Seize
Must apply Anti-Seize
Compound and torque
to specified value.

2.3

Torque to
90 in-lbs

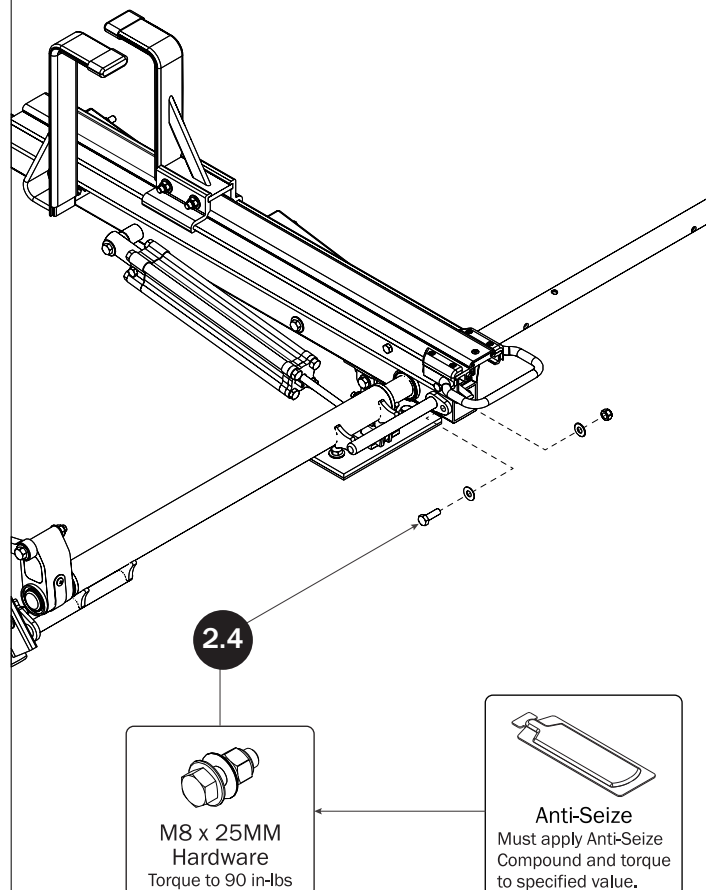

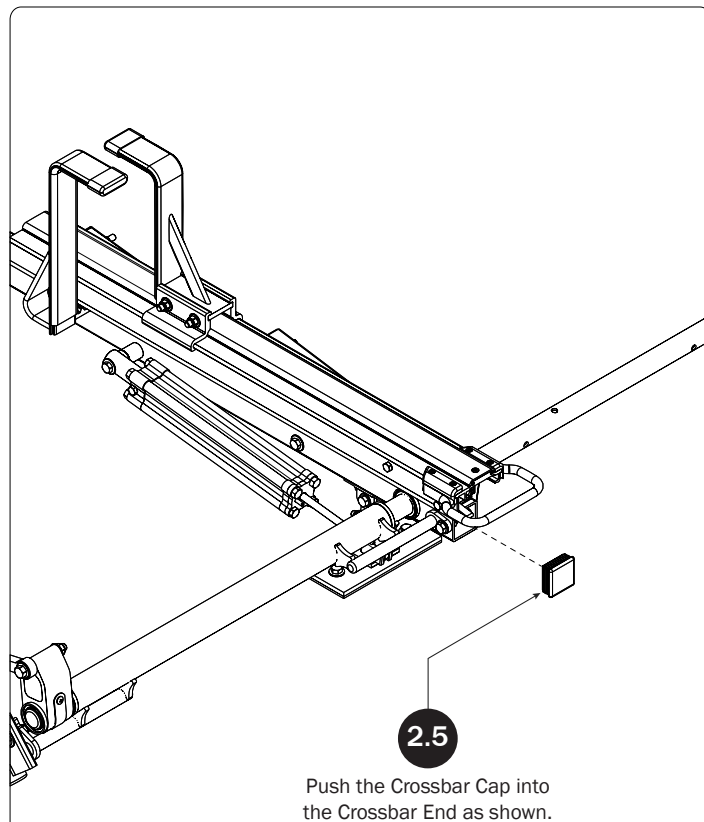
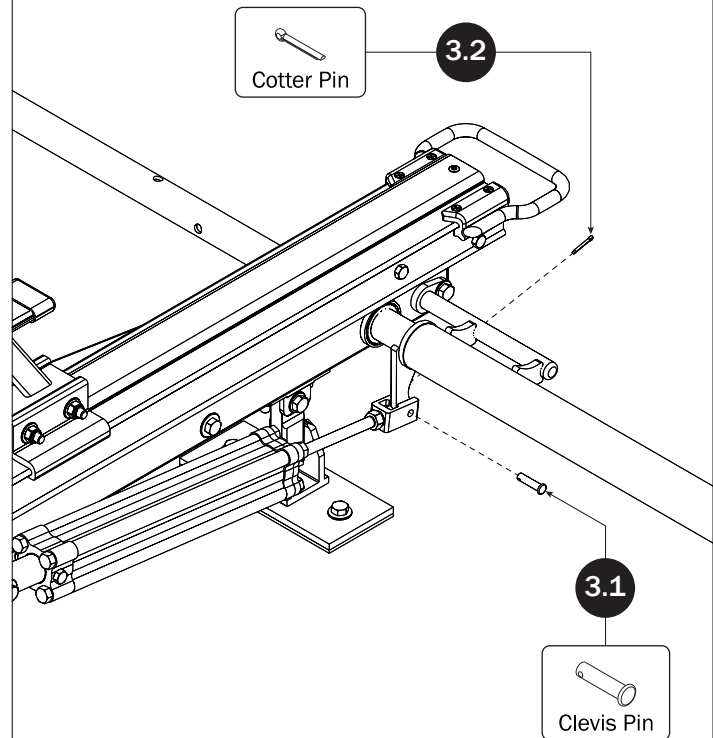
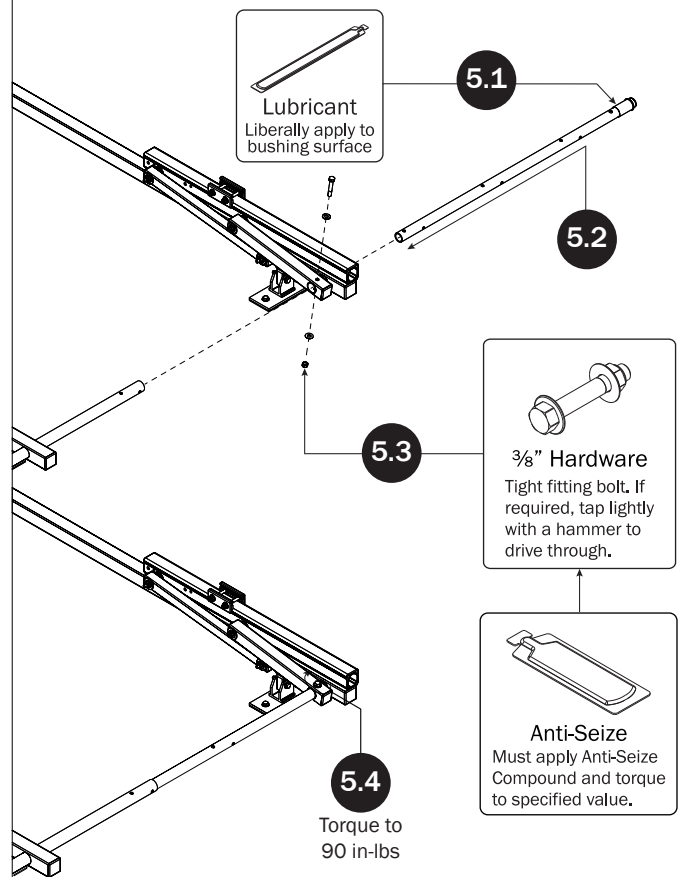
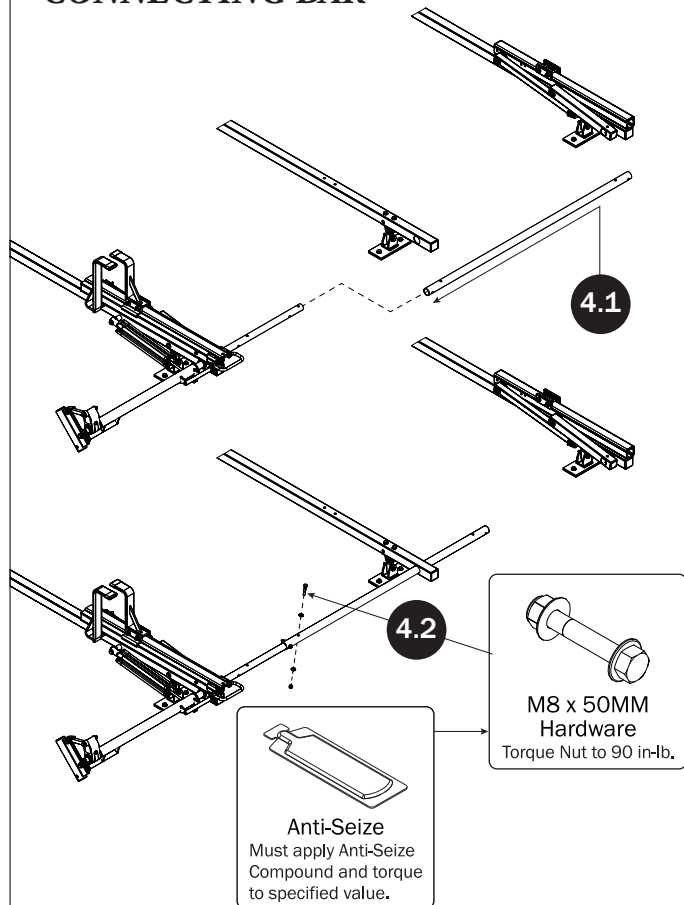
CYLINDER HARDWARE**FRONT DRIVE SHAFT****CONNECTING BAR**

CONNECTING BAR FASTENERS

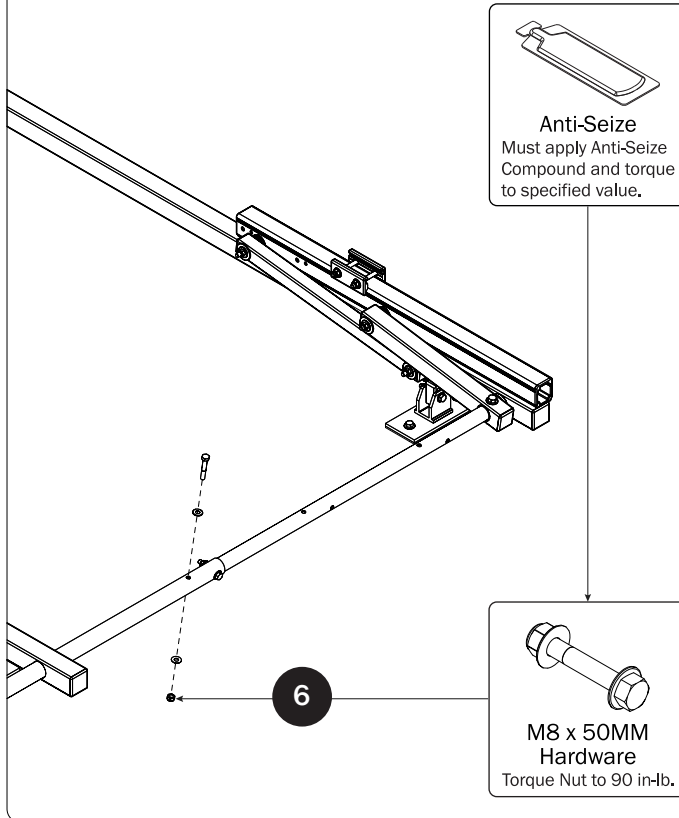

Z POST

SEE QUICK START GUIDE FOR ADJUSTMENTS

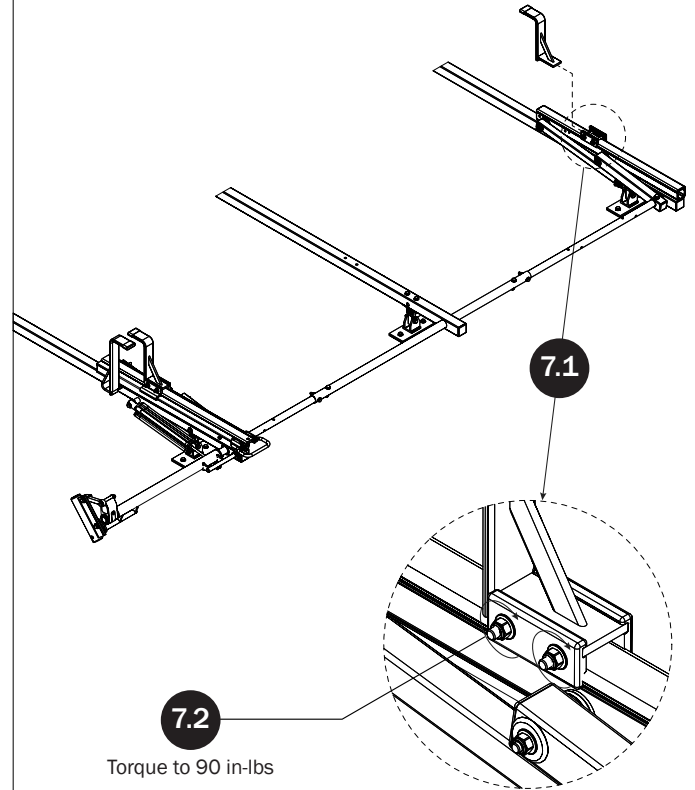

L POST

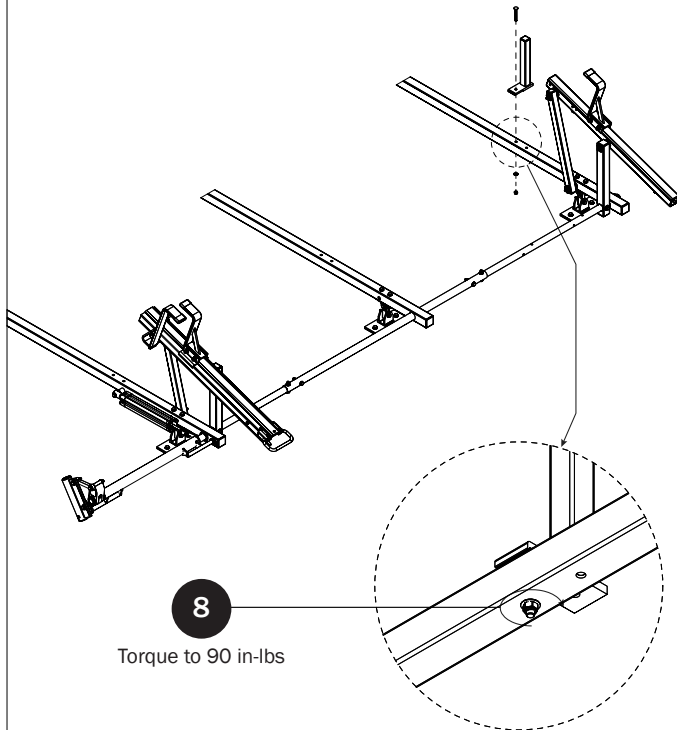

DRIVE SHAFT SEALING

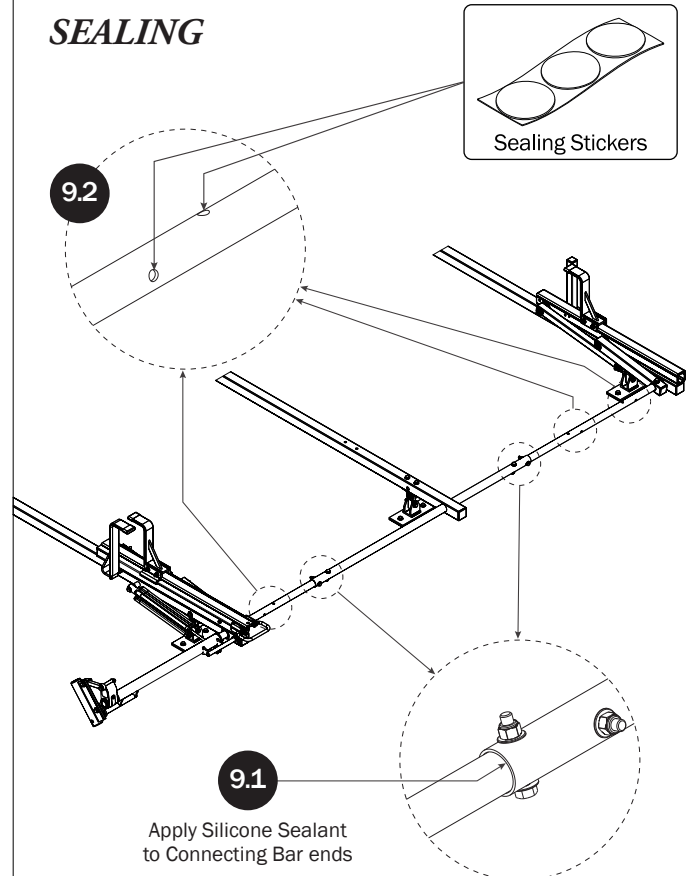

LEFT ROTATION ASSEMBLY SEQUENCE

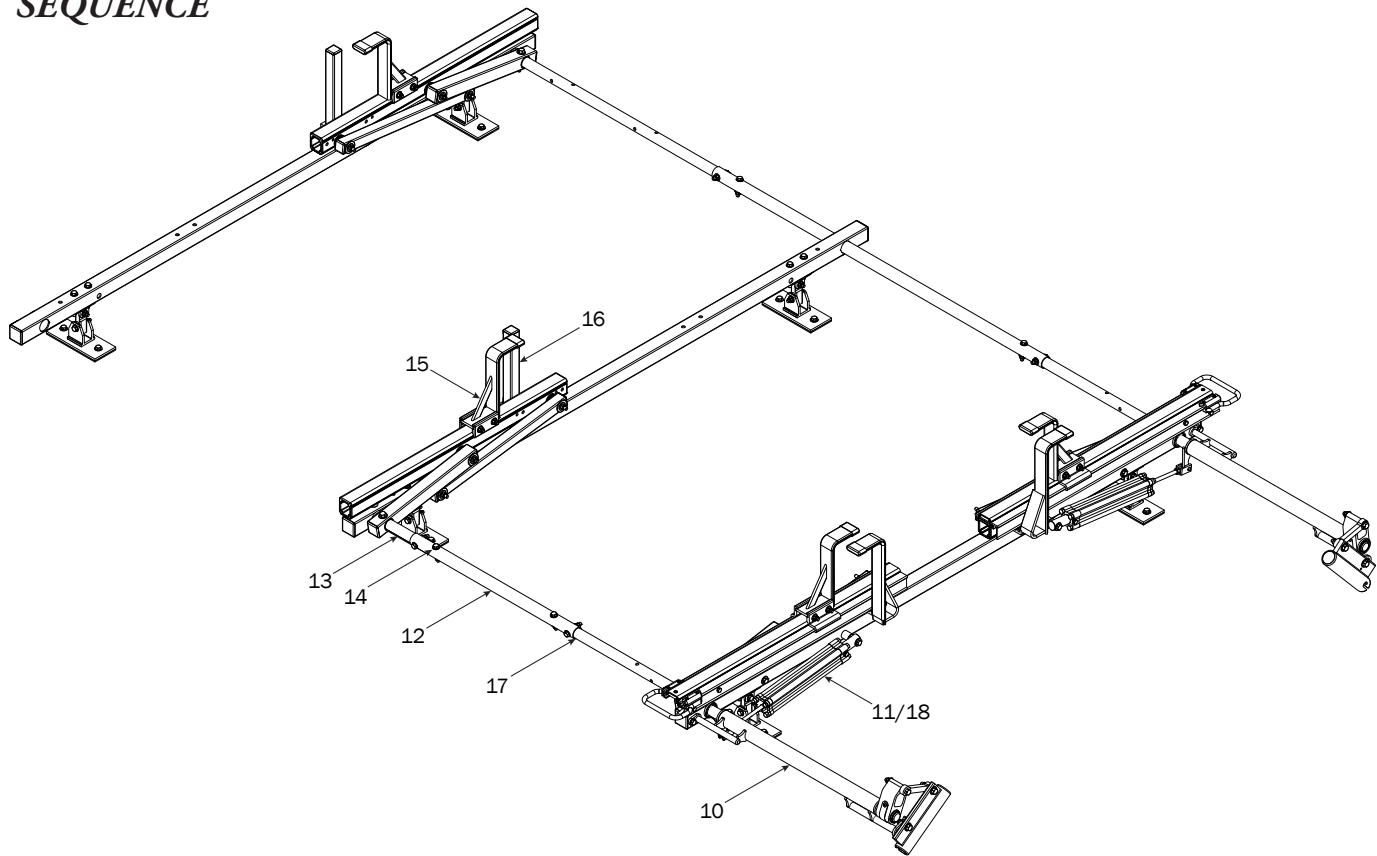

REAR DRIVE SHAFT

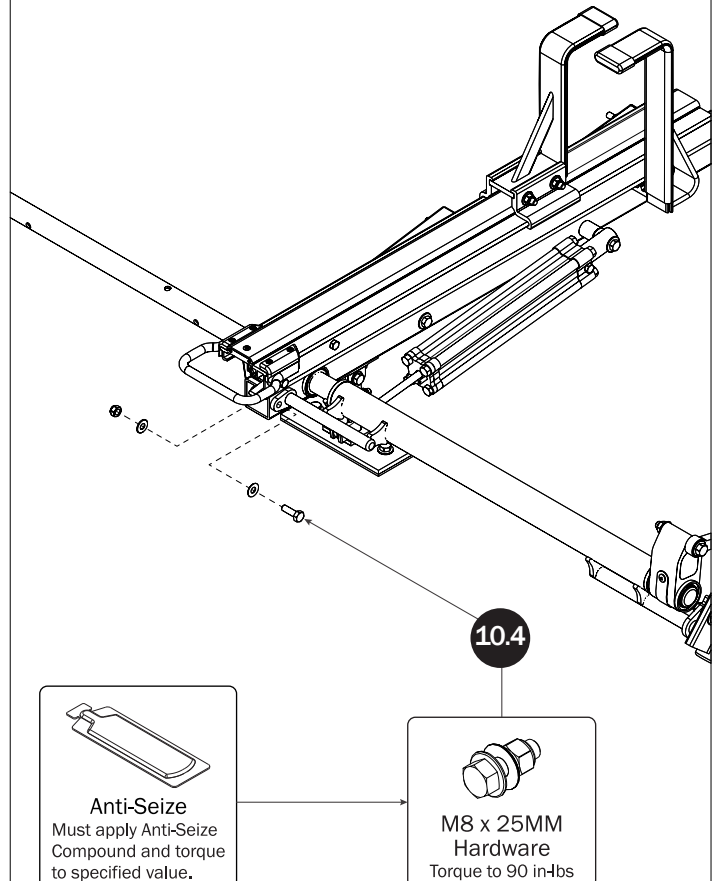
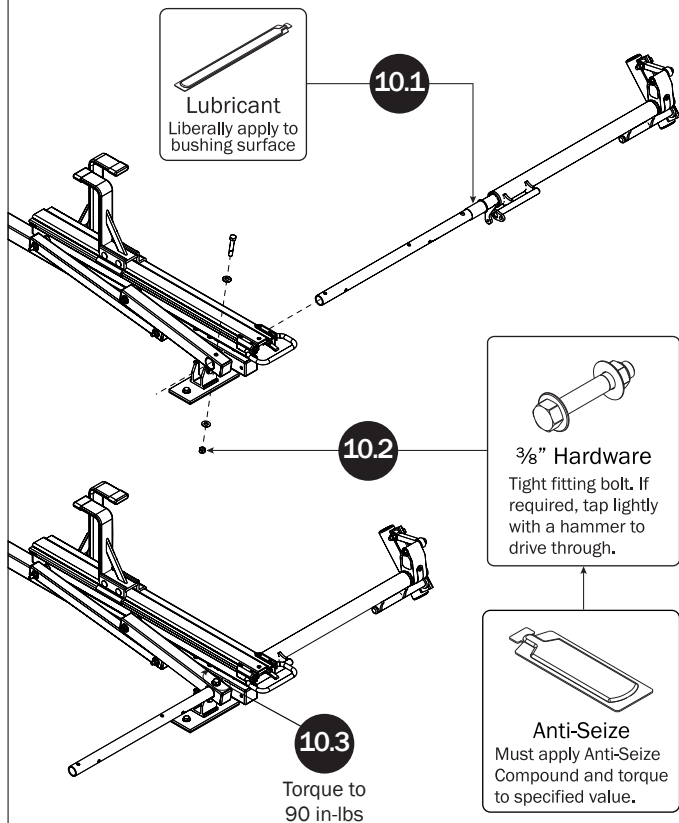

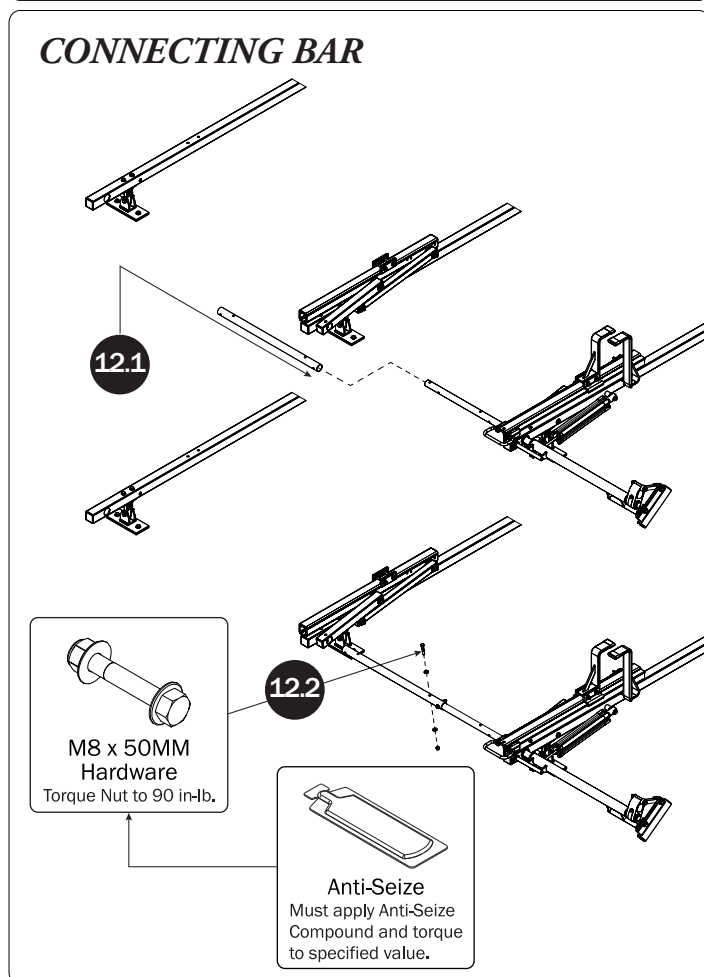
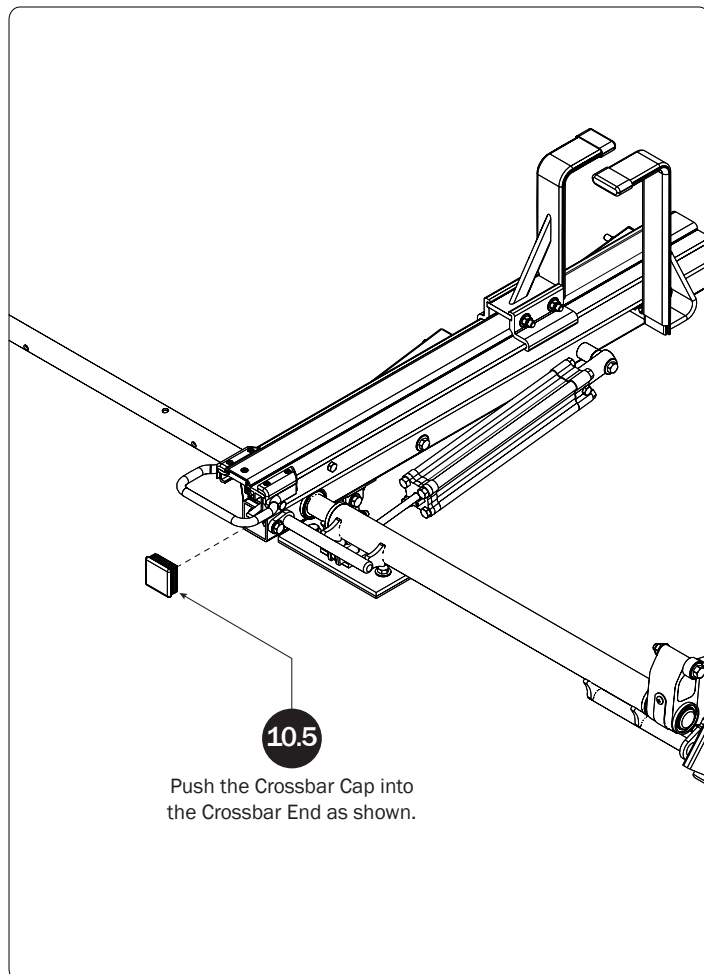

CYLINDER HARDWARE

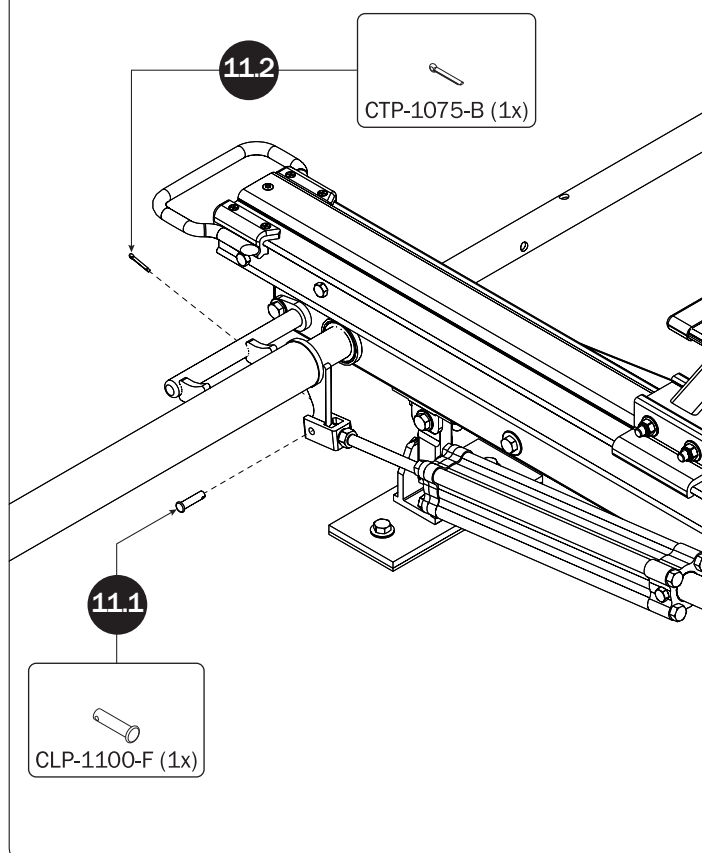

FRONT DRIVE SHAFT

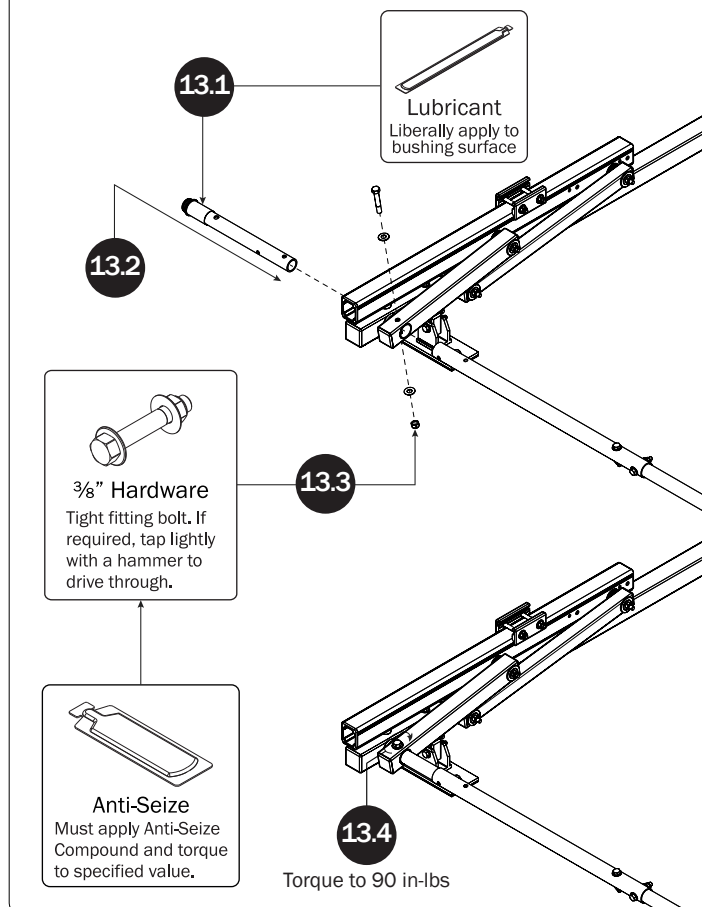

CONNECTING BAR FASTENERS

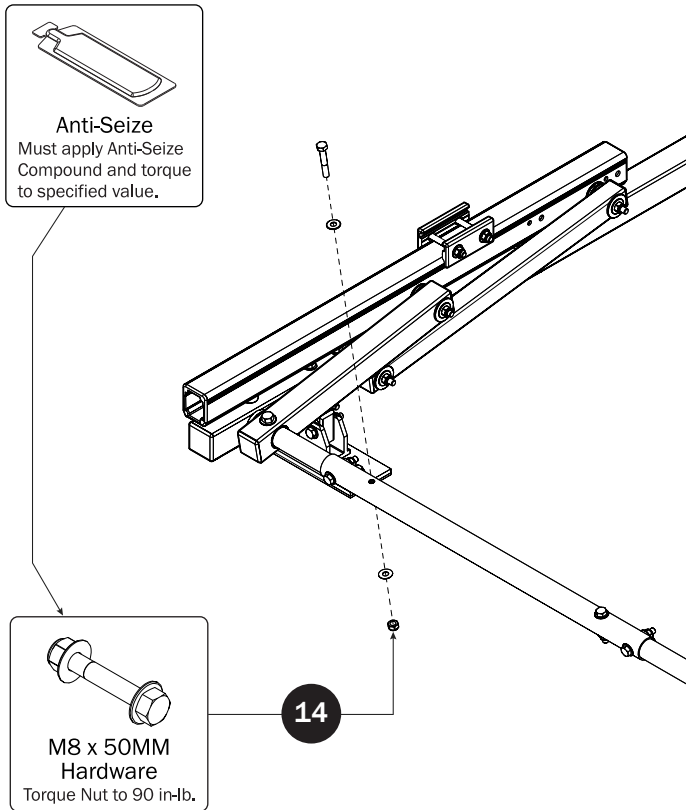

Z POST

SEE QUICK START GUIDE FOR ADJUSTMENTS

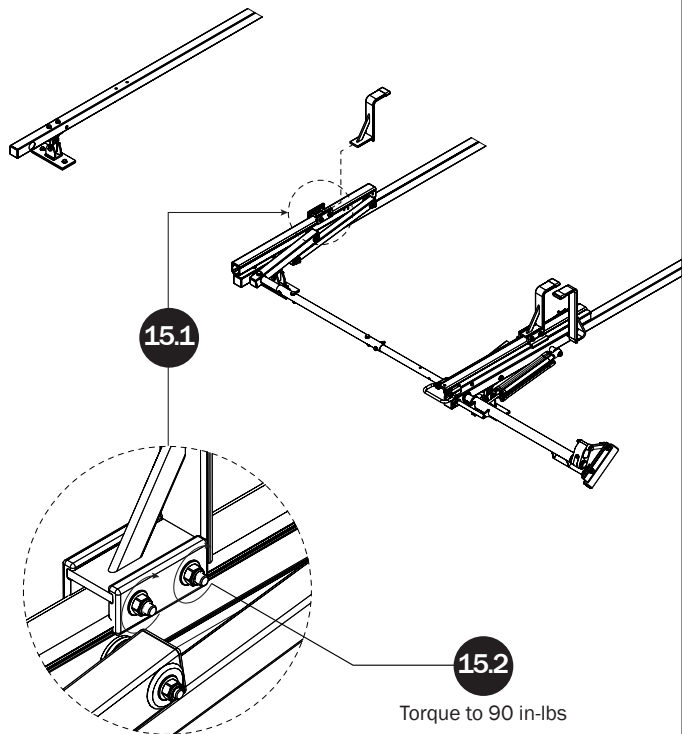

L POST

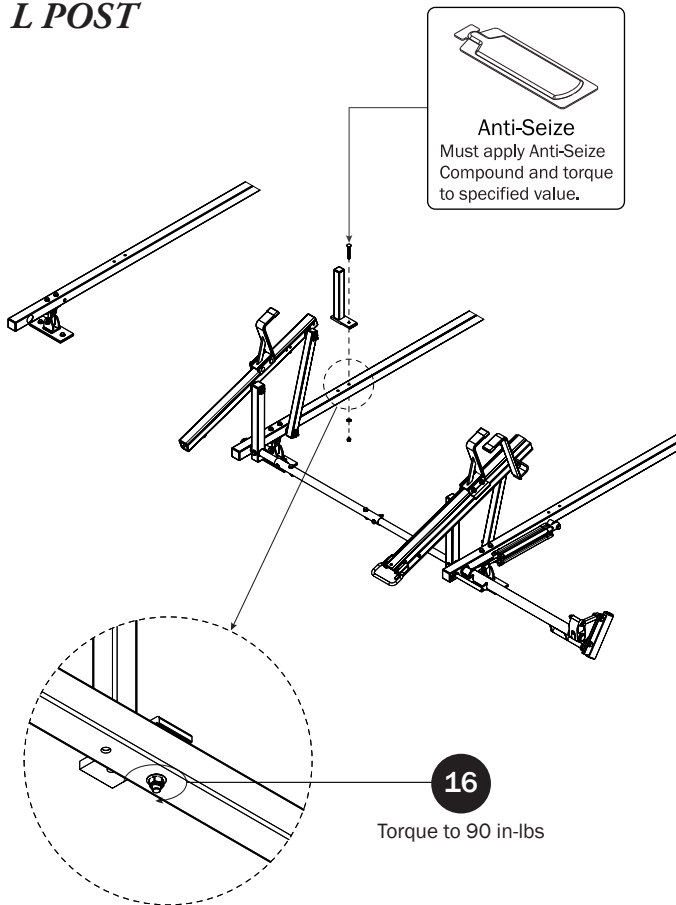

DRIVE SHAFT SEALING

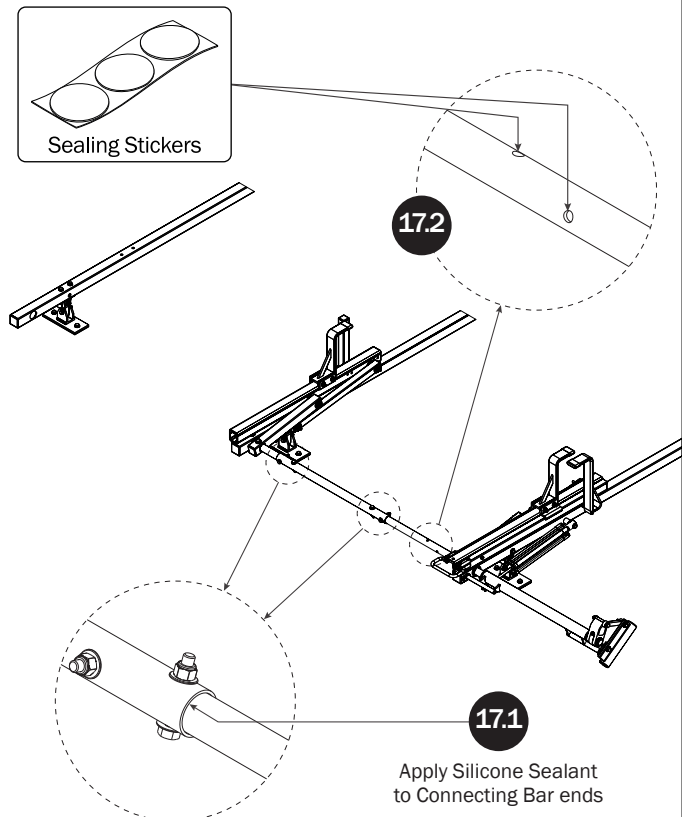

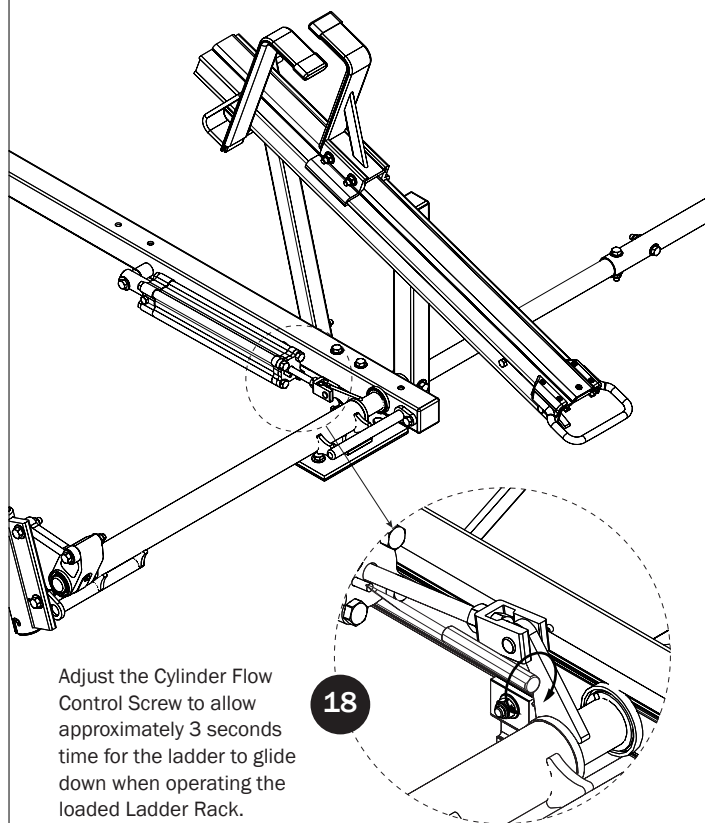
CYLINDER ADJUSTMENT**ADDITIONAL INFORMATION**

For additional information regarding your HRR-369-E-UM3-74 Ladder Rack, please visit the Prime Design website at: www.primedesign.net.

Using a QR code reader in your smart phone or tablet, read the QR Code shown below and follow the same steps as you would from your laptop or computer.

If you're viewing this document as an interactive PDF, you may simply click on the QR Code below to access the Prime Design website.

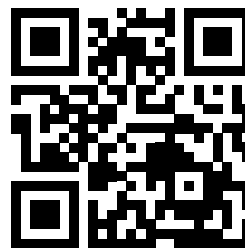

USAM-HRR369EUM374-US01 Rev-B 0316