

HRR-E-6000

Pickup Rack, Universal

Dimensional Specifications on Page 2

Configuration as shown:

Slide Rotation Left/Slide Rotation Right

Two Crossbars, US Gen4

Finish: White Powder Coat

Rack Weight (empty): 108.25 lbs

Load specifications as shown:

Maximum Ladder Weight LH..... 75 lbs

Maximum Ladder Length LH..... 24 ft

Maximum Ladder Section LH..... 12 ft

Maximum Ladder Weight RH..... 75 lbs

Maximum Ladder Length RH..... 24 ft

Maximum Ladder Section RH..... 12 ft

**Note: Mounting Hardware purchased separately. For more information, please contact Sales & Support.*

**Mounting Hardware ordered separately*

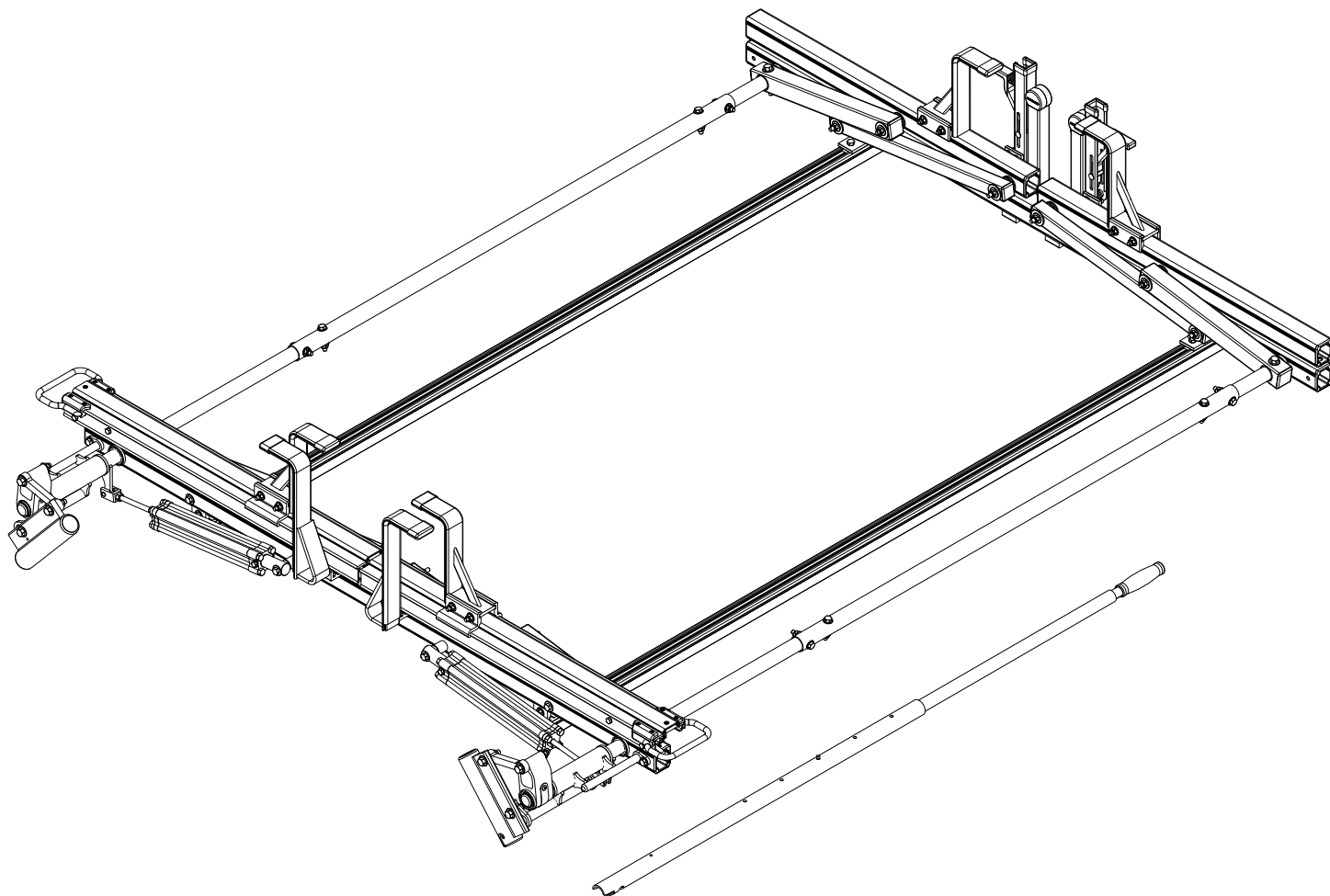

HRR-E-6000

Pickup Rack, Universal

Shown with MPK-0007 for illustrative purposes only

Approximate dimensions as shown:

A: Maximum Mount Spacing L/R.....	48"
B: Minimum Mount Spacing L/R.....	36"
C: Rack Width	69"
D: Rack Length.....	88"
E: Crossbar Spacing.....	6'
F: Mount Spacing F/R (Typ).....	58"–76"
G: Maximum Mount Offset	18"
H: Mount Spacing F/R (Alt)	40"–76"
I: Rack Height.....	17"

Assembly Manual also available:

HRR-E-6000

**Note: Mounting Hardware purchased separately. For more information, please contact Sales & Support.*

USOV-HRRE6000-US01 Rev-A 1215

**Mounting Hardware ordered separately*

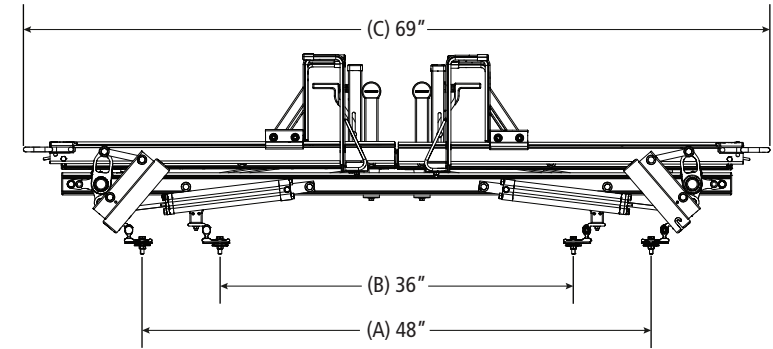
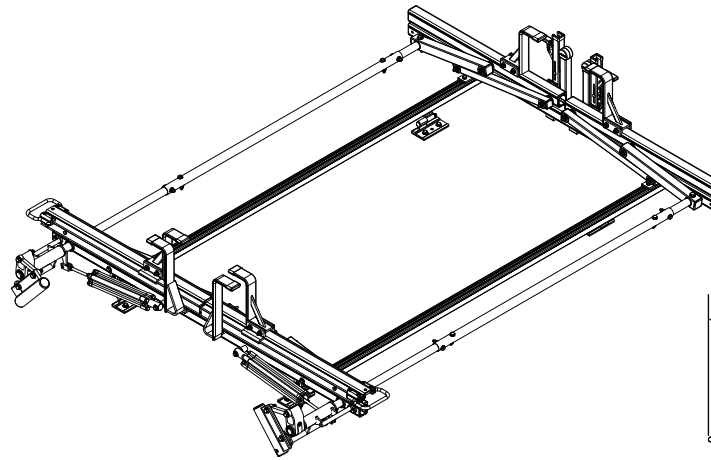

Typical Installation

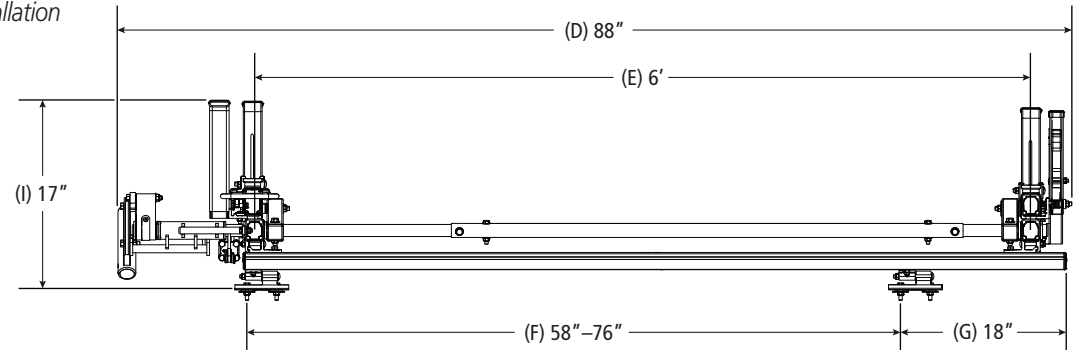

Alternate Installation

