

PRIME DESIGN™

A Safe Fleet Brand

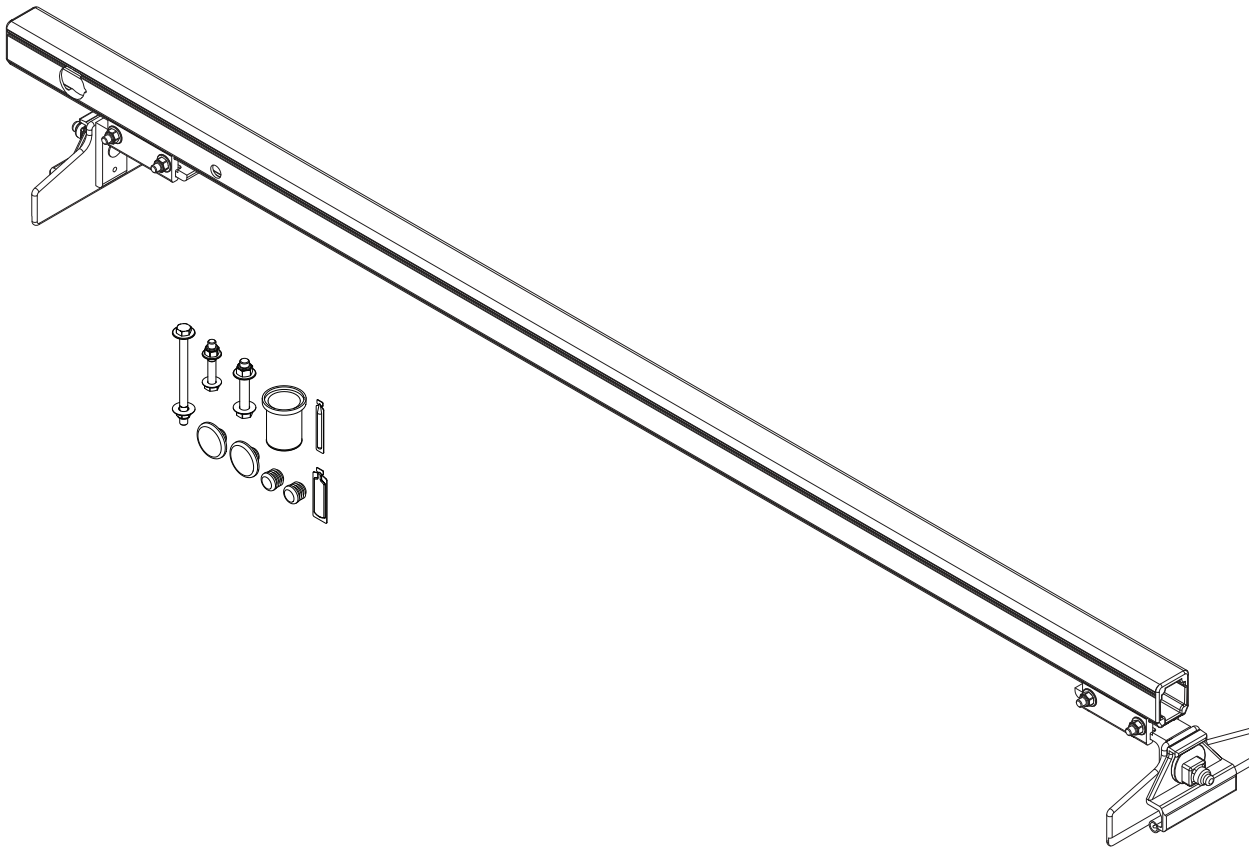

MID CROSSBAR KIT, 63"
1996+ CHEVROLET EXPRESS GUTTER MOUNT

CBR
0009

CONTENTS OVERVIEW



NOTE: This Mid Crossbar can be installed as a retrofit conversion or new install. For retrofitting purposes, this modular kit contains a Rotation hardware kit.

Use only the Crossbar Caps if fitting the left side with a Clamp Down or Base Ladder Stop features.

For safety purposes, it's recommended to position the protruding Top Clamp bolts toward the vehicle rear as shown on page 4: Frame 1, Fig. 1 and Frame 4, Fig. 3.

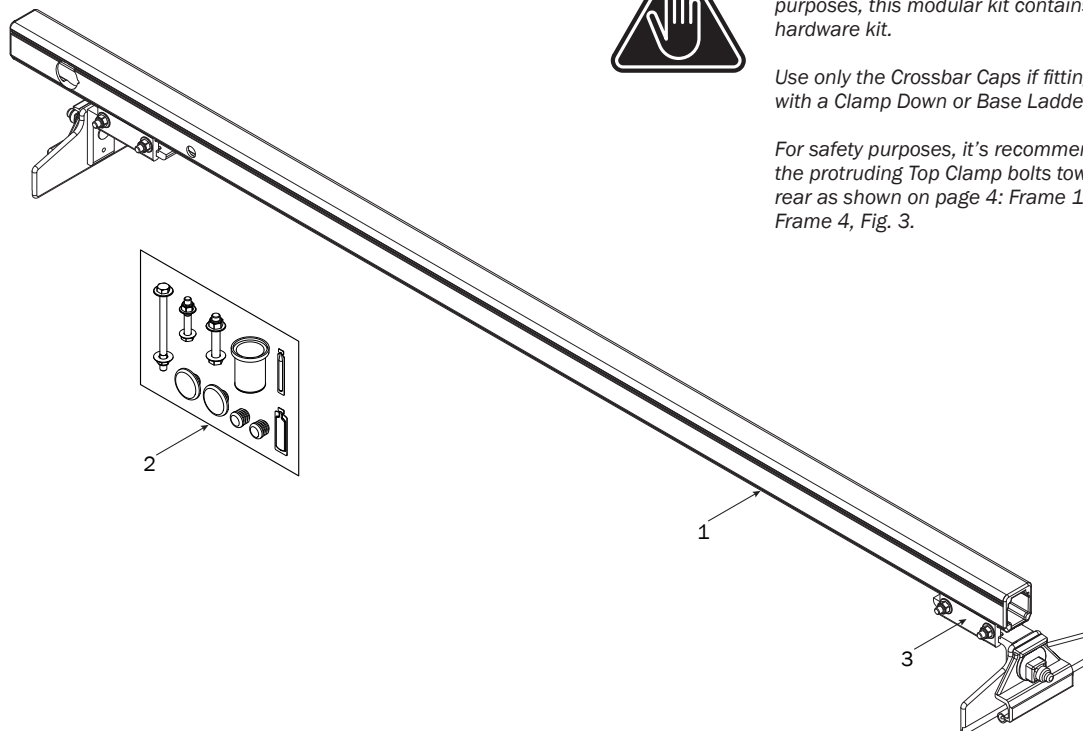

- 1—Crossbar..... (Qty 1)
Gen 4, Mid, 63.00"



- 2—HKT-8407 (Qty 1)
Hardware Kit, Retrofit w/Caps

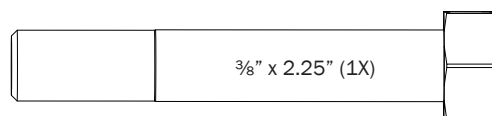
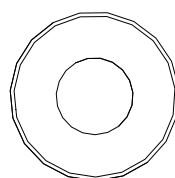
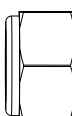
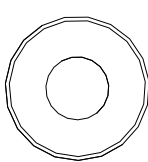
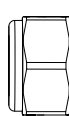
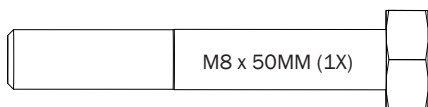

- M8 Lock Nut (2X) 5/16" Flat Washer (2X) 3/8" Lock Nut (1X) 3/8" Flat Washer (4X)

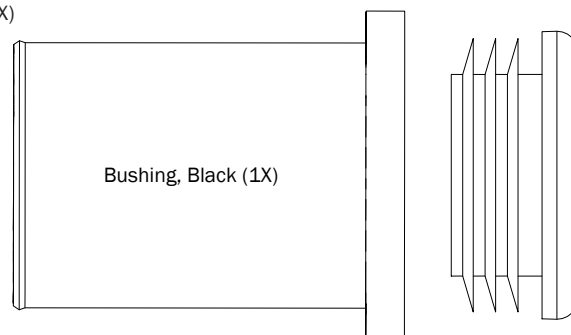
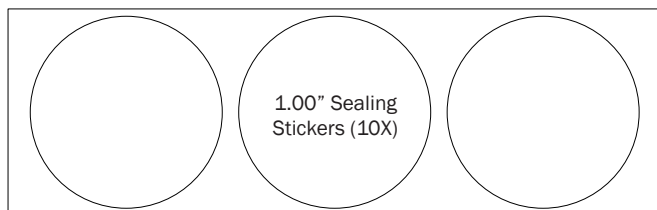

Cap, Large (2X)

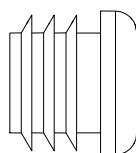

Cap, Small (2X)



Anti-Seize (1X)

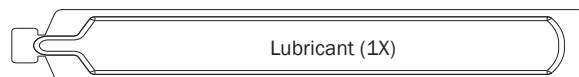

Lubricant (1X)

3—HKT-8408 (Qty 1)
Crossbar Mounting Brackets, set of 2

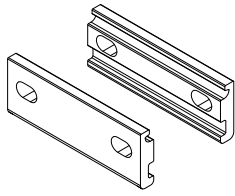

Top Clamp (2X pair)

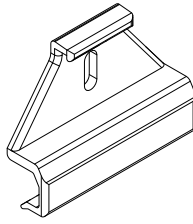

Z Plate (2X)

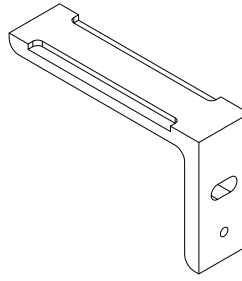

Mounting Brace (2X)

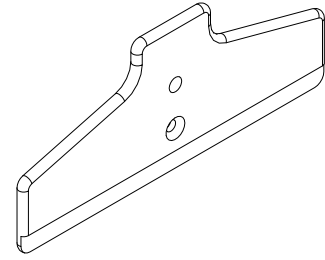

Mounting Plate (2X)

HKT-8017-Mounting Bracket Hardware Kit
(Included in HKT-8408)

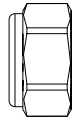

M8 Lock Nut (6X)

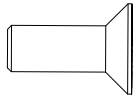

M6 Allen Head (2X)



M8 x 45MM (2X)

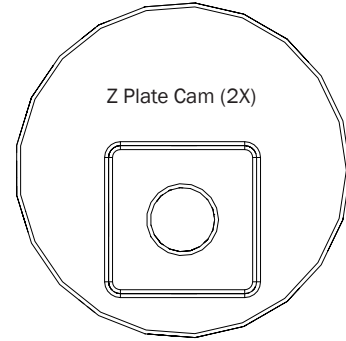

Z Plate Cam (2X)

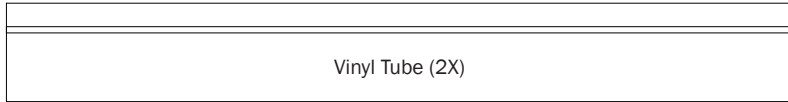

Vinyl Tube (2X)

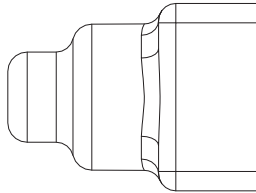

Cam Bolt Cap (2X)

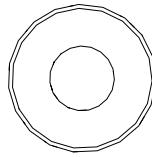

5/16" Flat Washer (6X)



M8 x 60MM (4X)



READ FIRST!

Do not mount this Crossbar to the vehicle at this time.

Refer to the respective FEA Assembly Manual(s) included with your chosen rack configuration features. Depending upon the features chosen, you may need to perform a complete feature assembly onto the Crossbars prior to mounting as noted in that feature's Assembly Manual.

WARNING: Failure to position the Crossbars as shown in your FBM Assembly Manual may result in damage to the sliding and/or swinging doors, and/or ladder rack.

INSTALLER NOTE: Base, Clamp Down, or Rotation features are not included in this CBR kit, and must be purchased separately. To purchase applicable features and accessories, please contact your authorized distributor, or a Prime Design Sales & Service Representative.

MOUNTING BRACKET RIGHT SIDE AS SHOWN FROM VEHICLE REAR

- 1.1** Assemble the RH Mounting Bracket using the parts and hardware as shown. When fully assembled, this Mounting Bracket must appear the same as shown in Fig.1

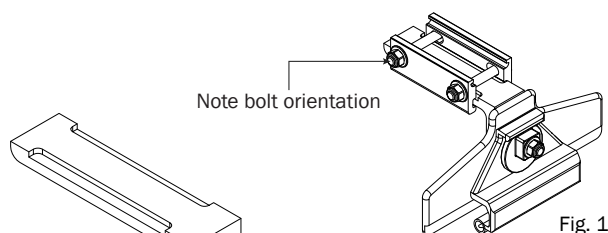

M6 Allen Head Screw

1.2

Torque to 80 in-lbs

- 1.4** Attach the Flat Washer and Lock Nut onto the Carriage Bolt. Do not tighten at this time. Slide and center the protective Vinyl Sleeve onto the bottom edge of the Z Plate.

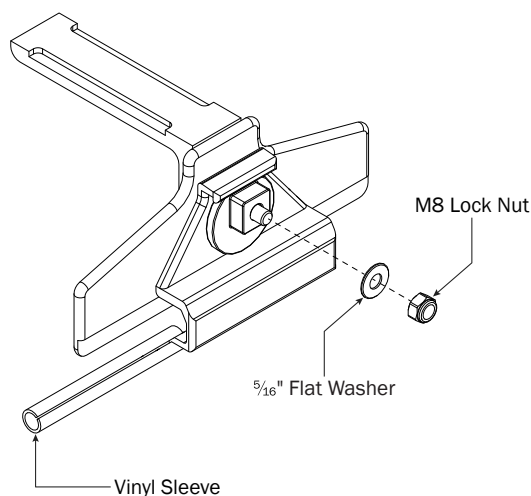

The Cam Lobe and Z Plate will rest at their lowest vertical position and inline with the Mounting Bracket.

Do not tighten until required as noted in your configuration's FBM Assembly Manual.

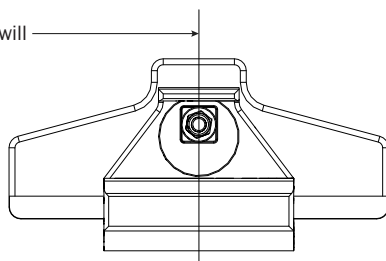

- 1.3** Insert the indicated Carriage Bolt through the backside of the Mounting Bracket, then attach the Z Plate and Z Plate Cam onto the Carriage Bolt as shown below. The Z Plate Cam must slide under the top rail of the Z Plate as shown in Fig. 2 prior to bolt insertion.

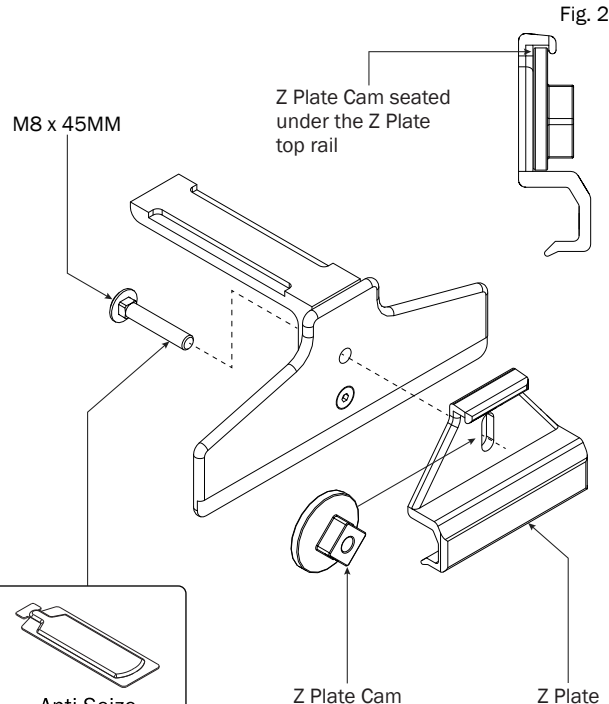

Anti-Seize
Must apply Anti-Seize Compound. Do not tighten at this time.

- 1.5** Complete the Mounting Bracket assembly using the hardware and Top Clamps as shown below. Do not tighten. These must be left loose for Crossbar installation and adjustment as shown in your vehicle-specific FBM Assembly Manual.

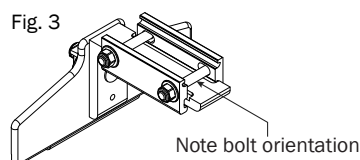
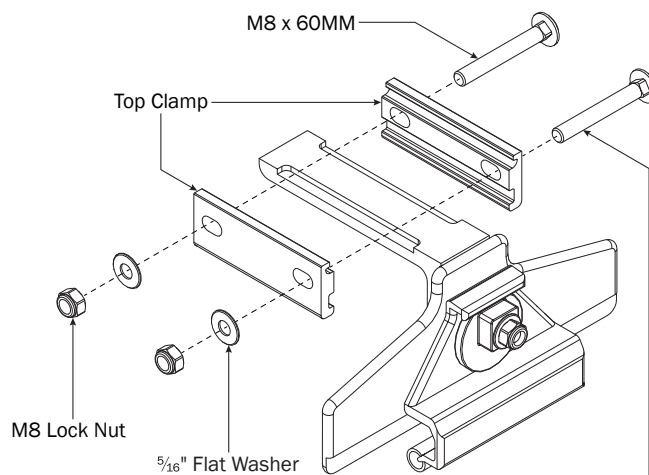

- 1.6** Repeat Steps 1.1–1.5 to assemble the LH Mounting Bracket as shown in Fig. 3

Anti-Seize
Must apply Anti-Seize Compound. Do not tighten at this time.

USAM-CBR0009-US01 Rev-A 0618