

PRIME DESIGN™

A Safe Fleet Brand

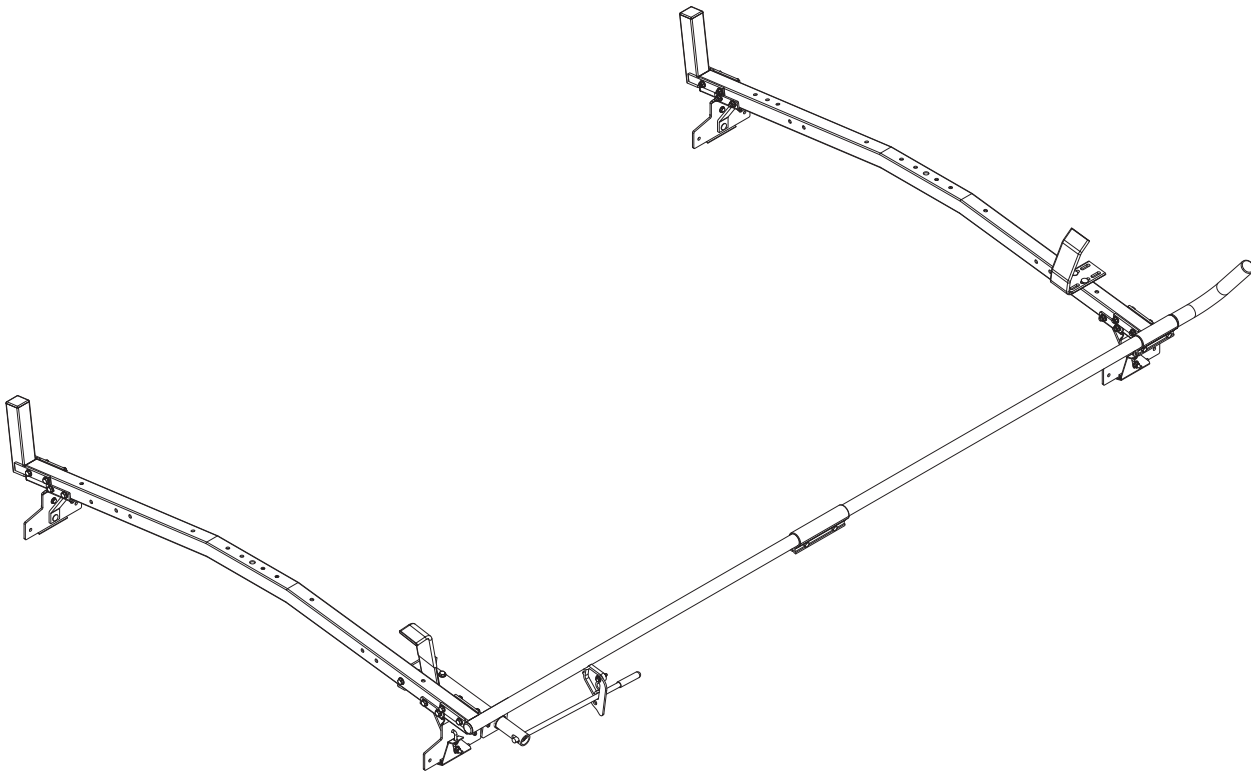

VBC 226

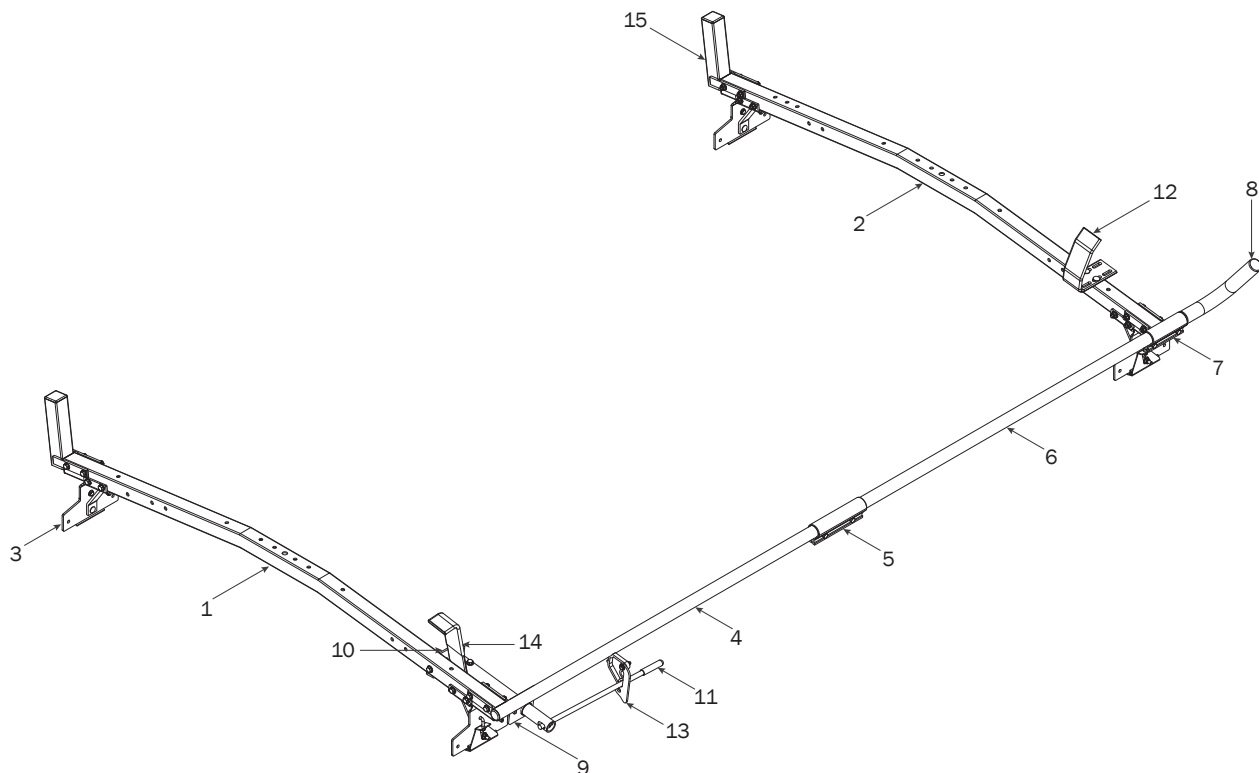

1—Rear Crossbar Assembly..... (Qty 1)

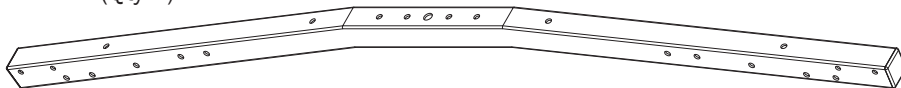

2—Front Crossbar Assembly (Qty 1)

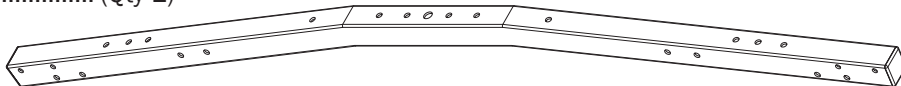

3—Mounting Bracket Assembly.....(Qty 4)
Horizontal, Low Mounting, 4.50", GM

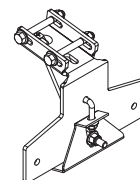

4—Clamp Down Tube Assembly(Qty 1)
Rear, Left Hand, 50.00"

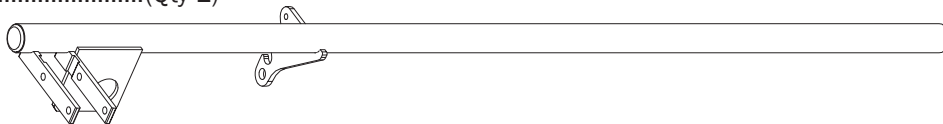

5—Clamp Down Tube Splice(Qty 1)
7.00"

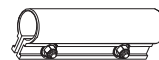

6—Clamp Down Tube(Qty 1)
Front, 48.00"

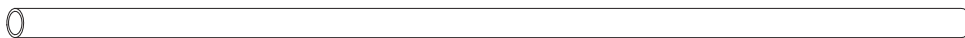

7—Clamp Down Tube Splice(Qty 1)
Welded, 5.00"

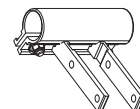

8—Clamp Down Horn(Qty 1)
Left Hand, with Cap, 15.00"

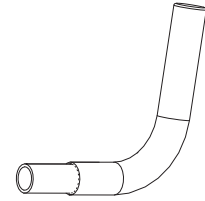

9—Clamp Down Handle Tube(Qty 1)
14.50"



10—Clamp Down Handle Tube Bracket(Qty 1)
Rear, Left Hand

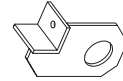

11—Clamp Down Handle(Qty 1)
With Black Grip, 18.00"

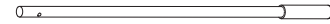

12—Clamp Down Hook(Qty 1)
Front, Slotted

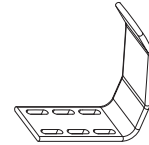

13—Handle Latch Lock Plate (Qty 1)
With Hardware, Gen1

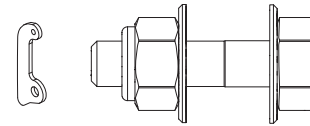

14—Clamp Down Hook (Qty 1)
Rear

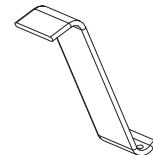

15—Ladder Stop.....(Qty 2)
With fingers and hardware, 8.00"

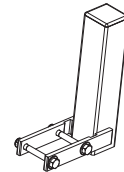

HKT-8112-Clamp Down Hardware Kit

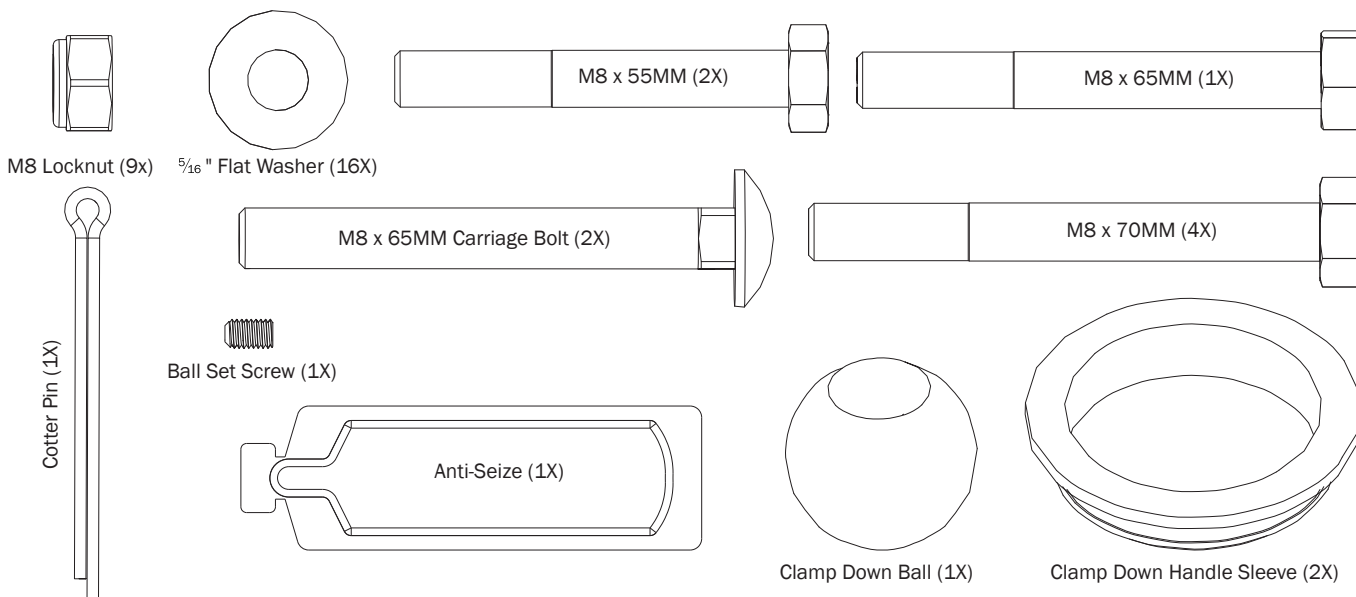

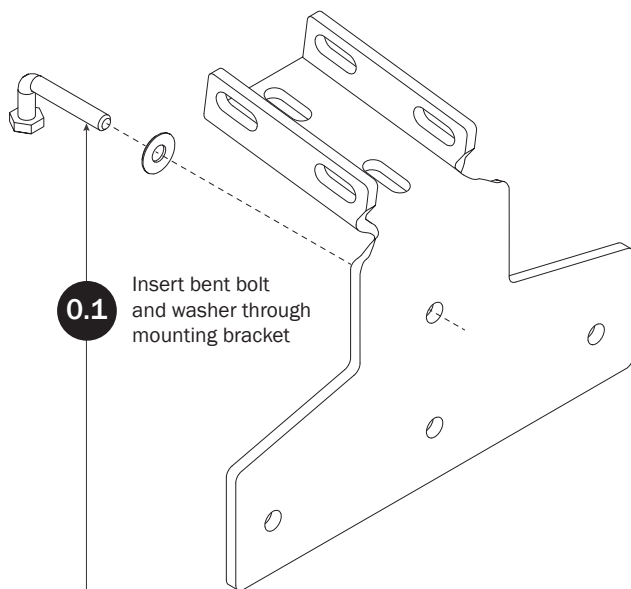
**MOUNTING BRACKETS—HORIZONTAL
BRACKET PRE-ASSEMBLY**

0.1 Insert bent bolt
and washer through
mounting bracket

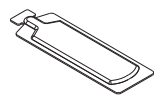

Anti-Seize
Must apply Anti-Seize
Compound and torque
to specified value.

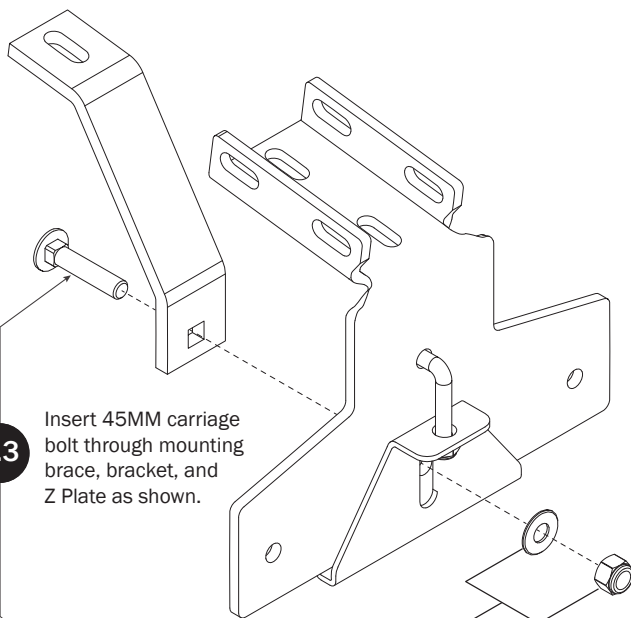

0.3 Insert 45MM carriage
bolt through mounting
brace, bracket, and
Z Plate as shown.

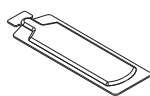

Anti-Seize
Must apply Anti-Seize
Compound and torque
to specified value.

0.4

Secure mounting assembly
with washer and nut. Do
not tighten until installed on
vehicle roof.

0.2

Assemble the Z Plate and secure with washer and nut. Do not
tighten until installed on vehicle roof.

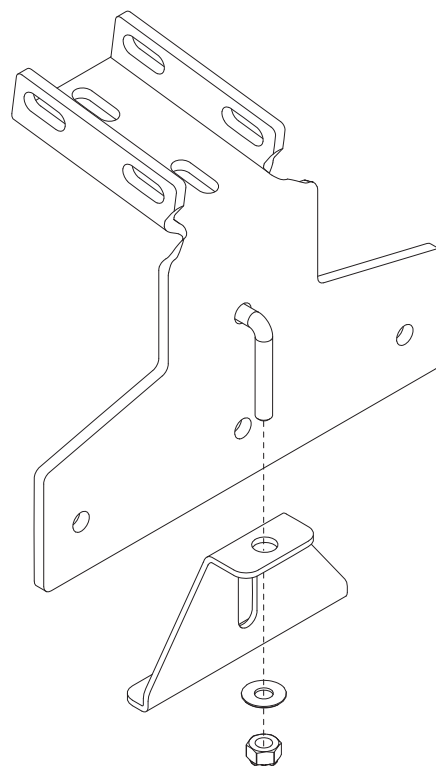

0.5

Repeat Steps 0.1–0.5 to assemble the remaining Horizontal
Mounting Brackets.

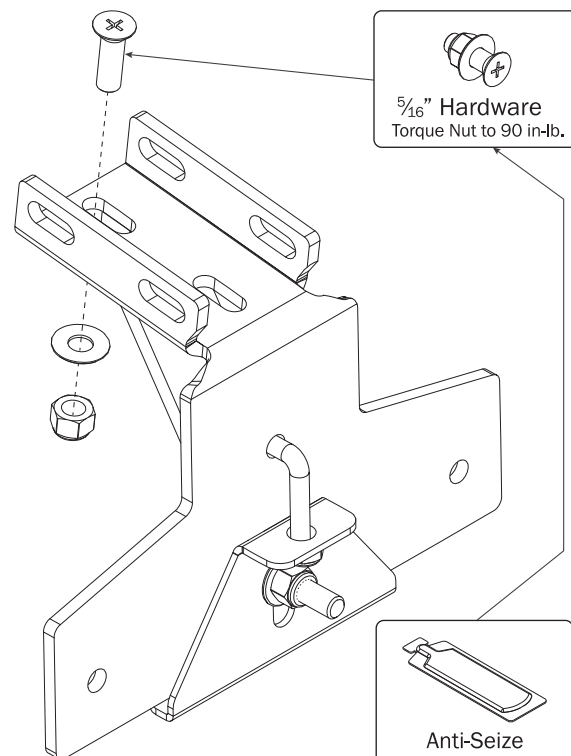

5/16" Hardware
Torque Nut to 90 in-lb.

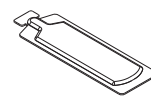

Anti-Seize
Must apply Anti-Seize
Compound and torque
to specified value.

RIGHT CLAMP DOWN ASSEMBLY SEQUENCE

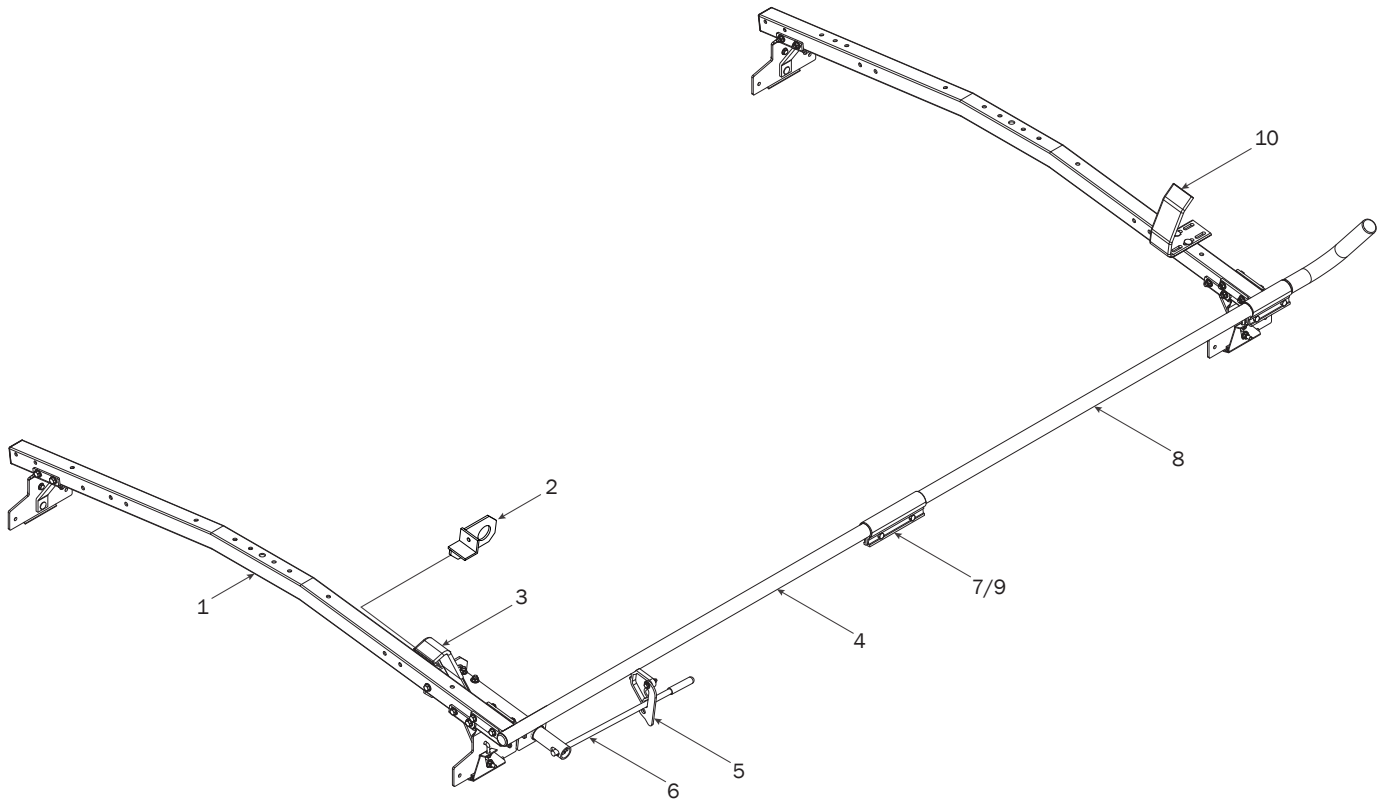

CROSSBARS

- 1.1** Apply Anti-Seize compound to Mounting Bracket bolts

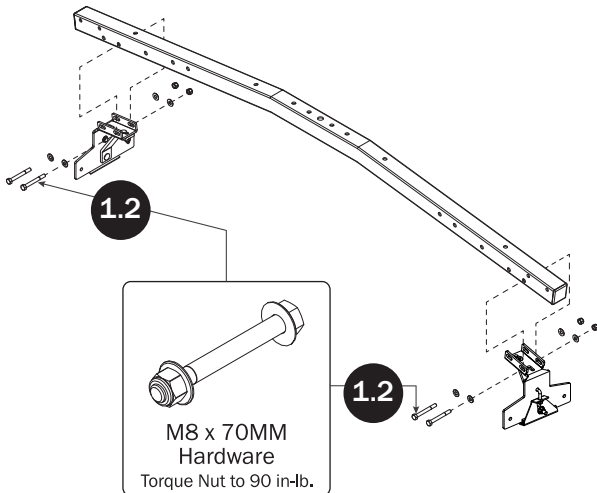

- 1.3** Repeat Steps 1.2 to install the remaining Mounting Brackets onto the front Crossbar

CLAMP DOWN HANDLE TUBE BRACKET

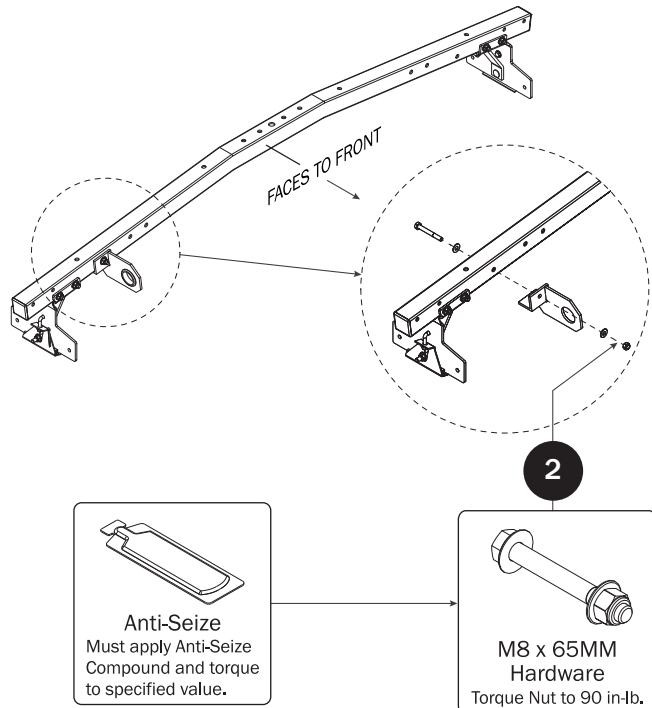

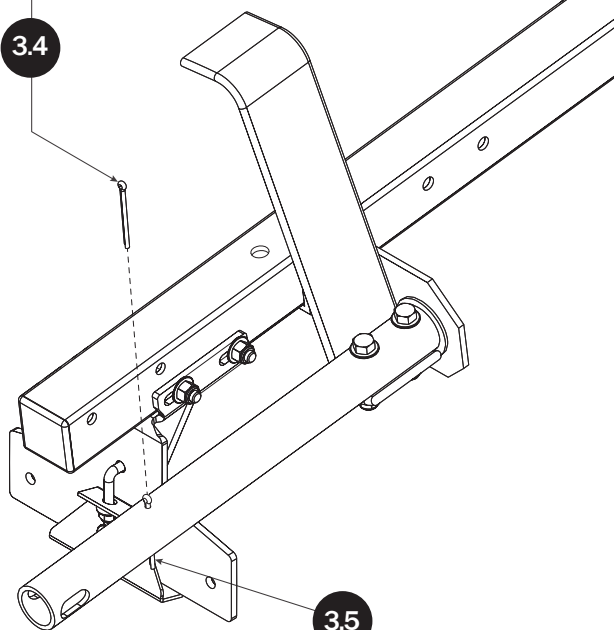
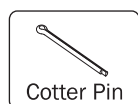
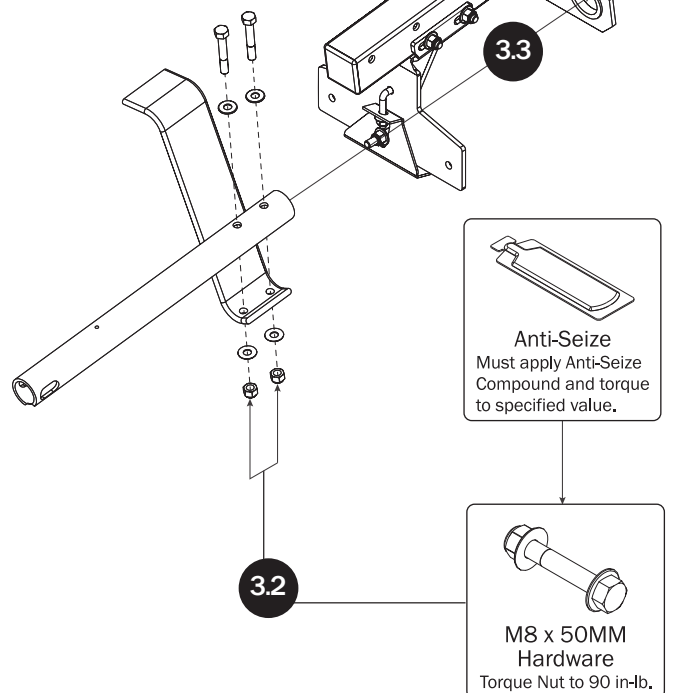
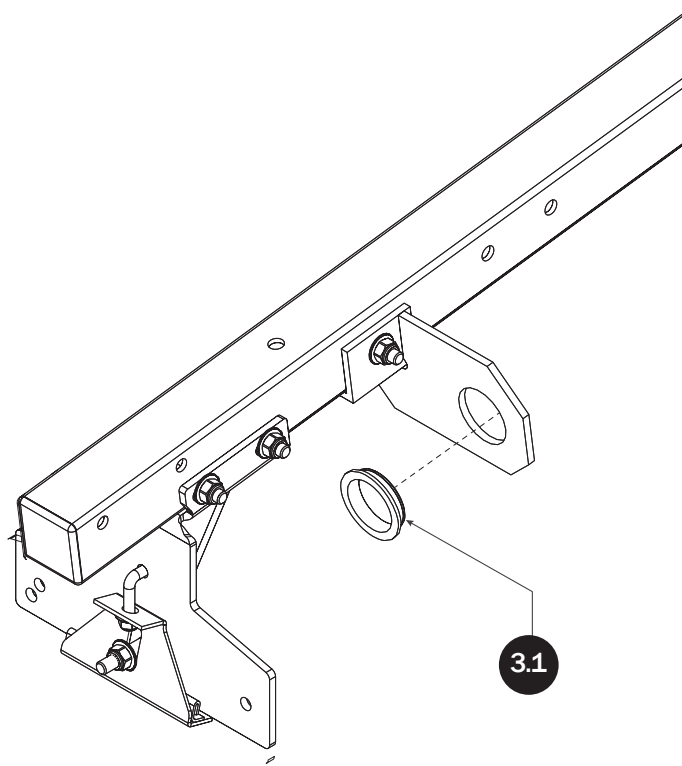
CLAMP DOWN HANDLE TUBE

Bend the Cotter Pin to secure it in the Handle Tube as shown

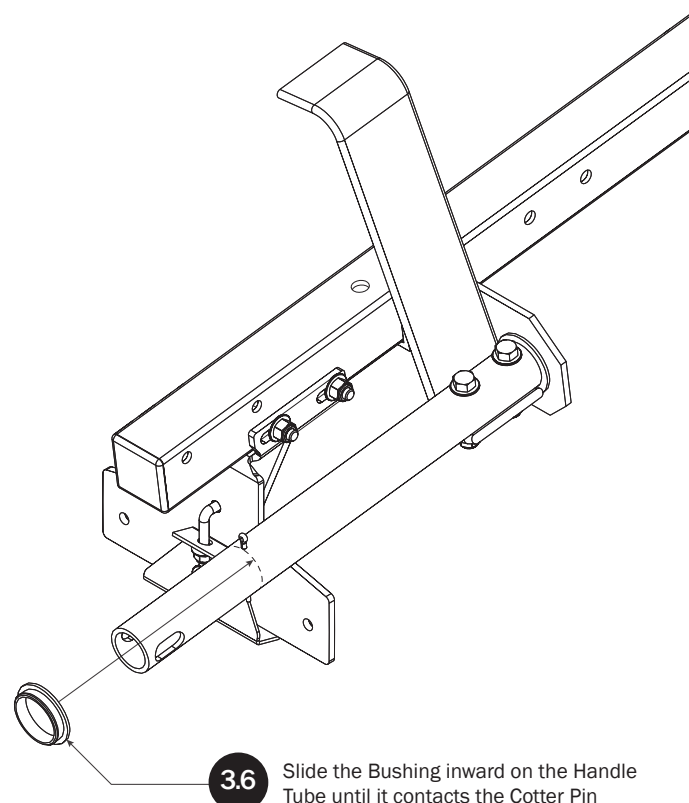

REAR CLAMP DOWN TUBE

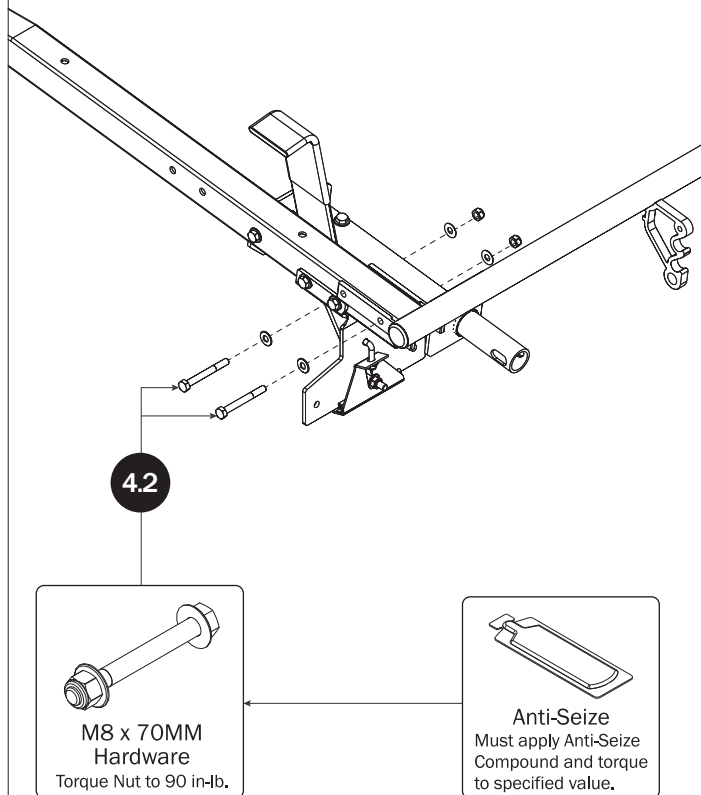
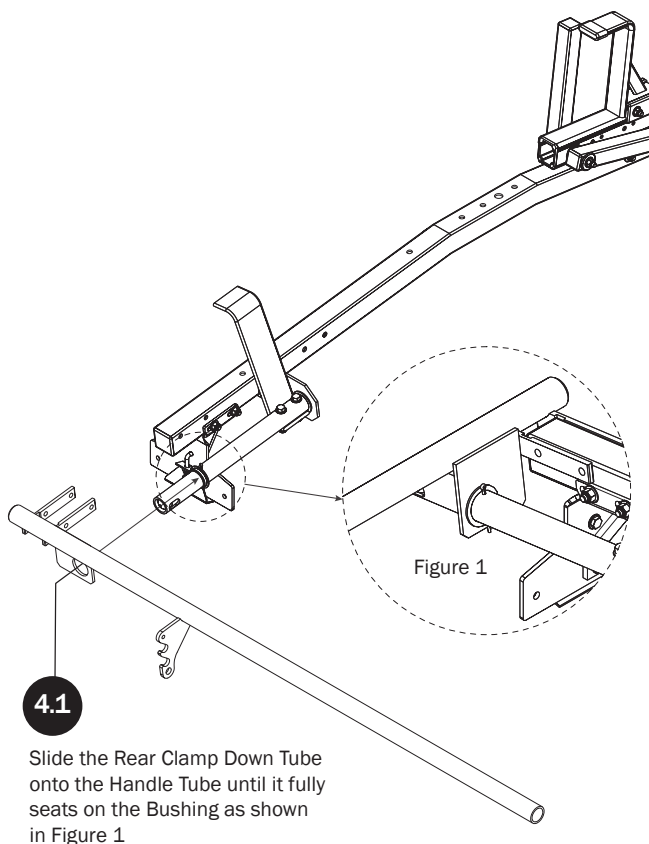

HANDLE LATCH

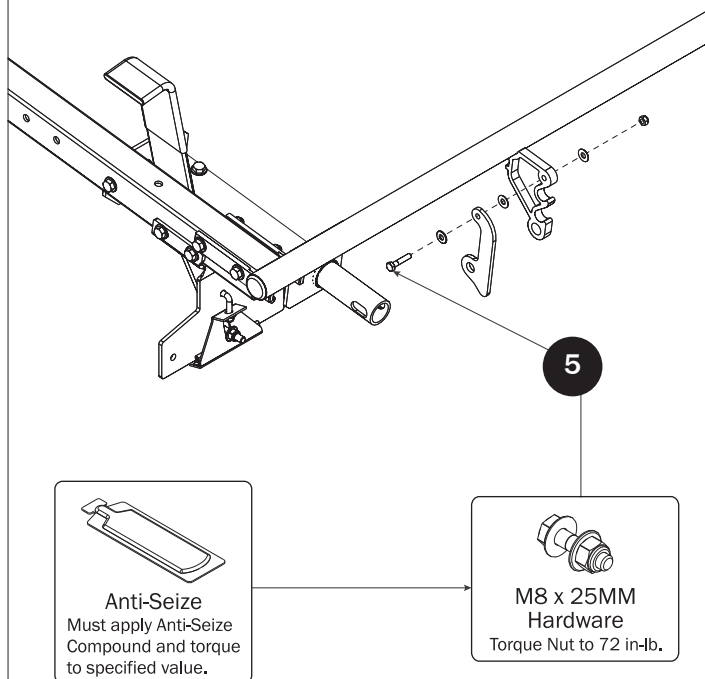

CLAMP DOWN HANDLE

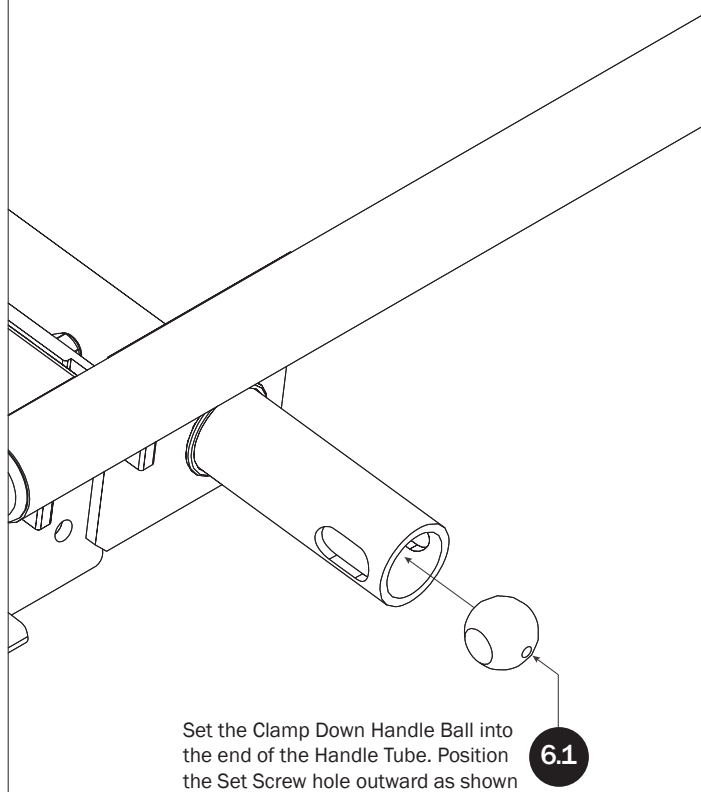

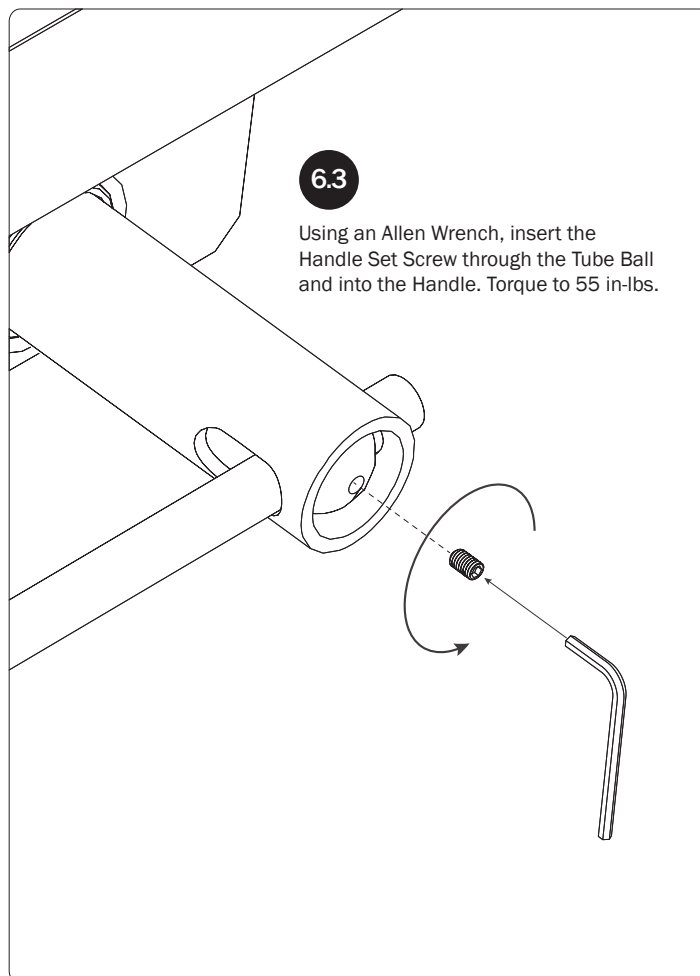
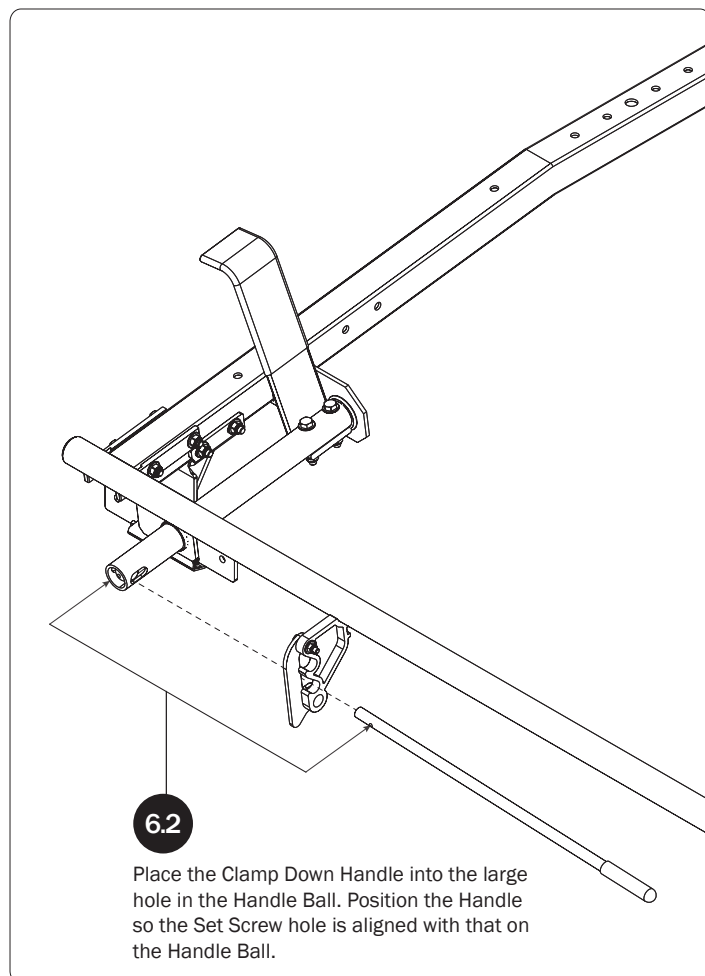

CLAMP DOWN TUBE SPLICE

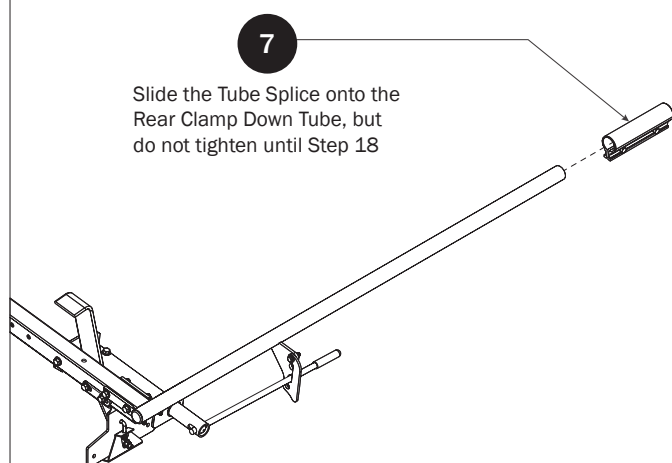

FRONT CLAMP DOWN TUBE

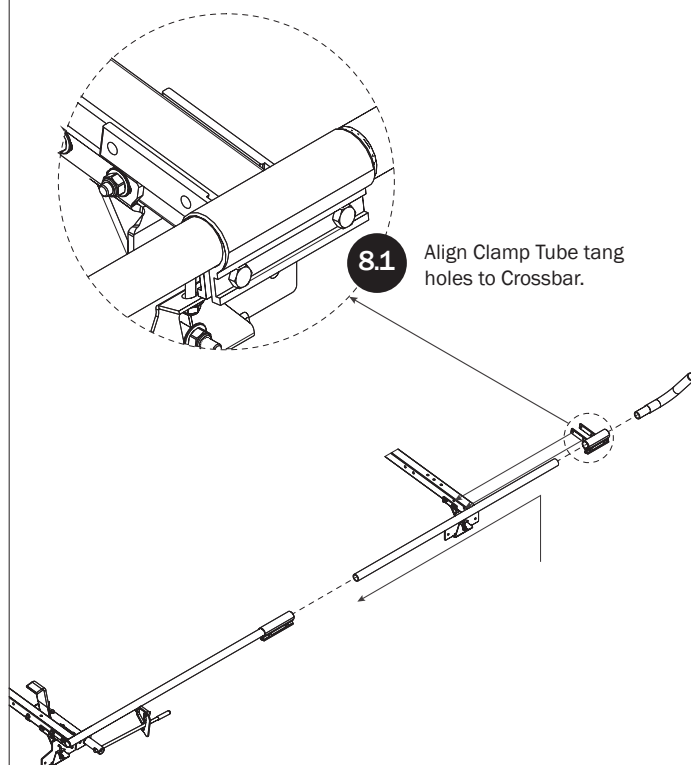

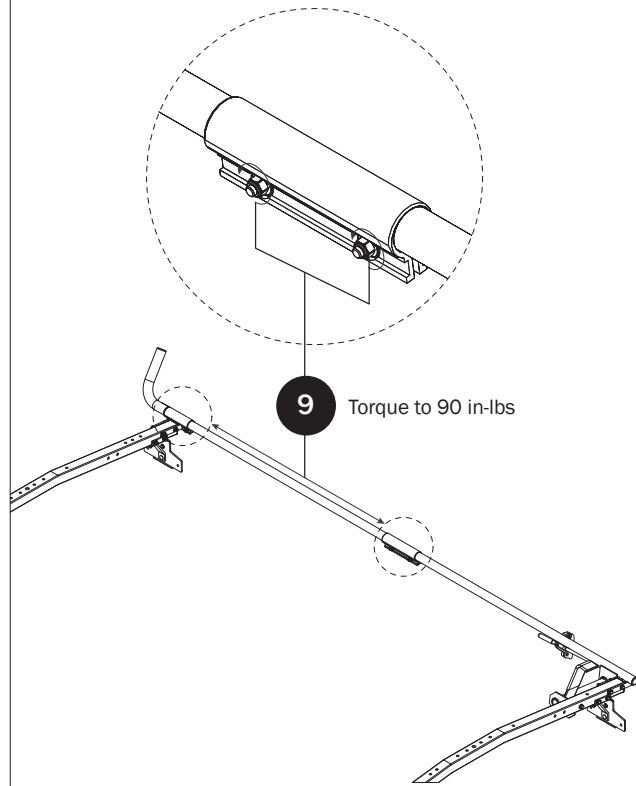
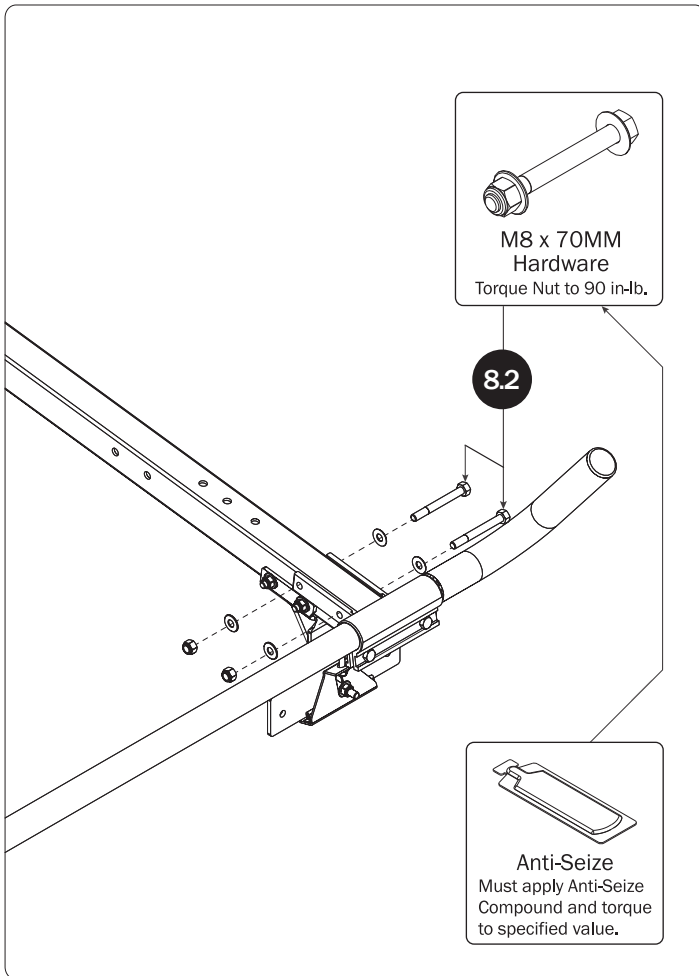
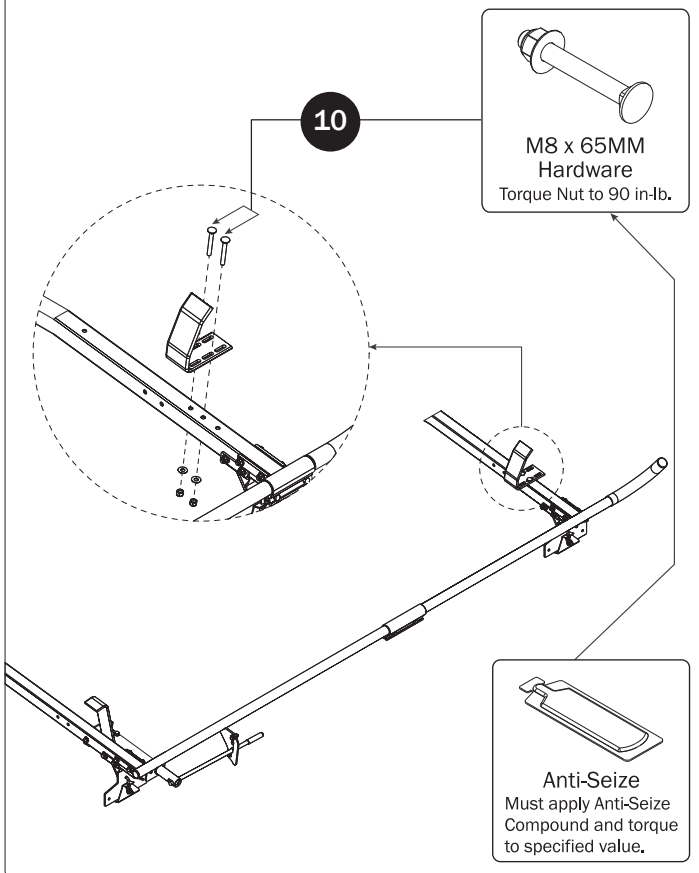
CLAMP DOWN TUBE ADJUSTMENTS**FRONT LADDER HOOK**

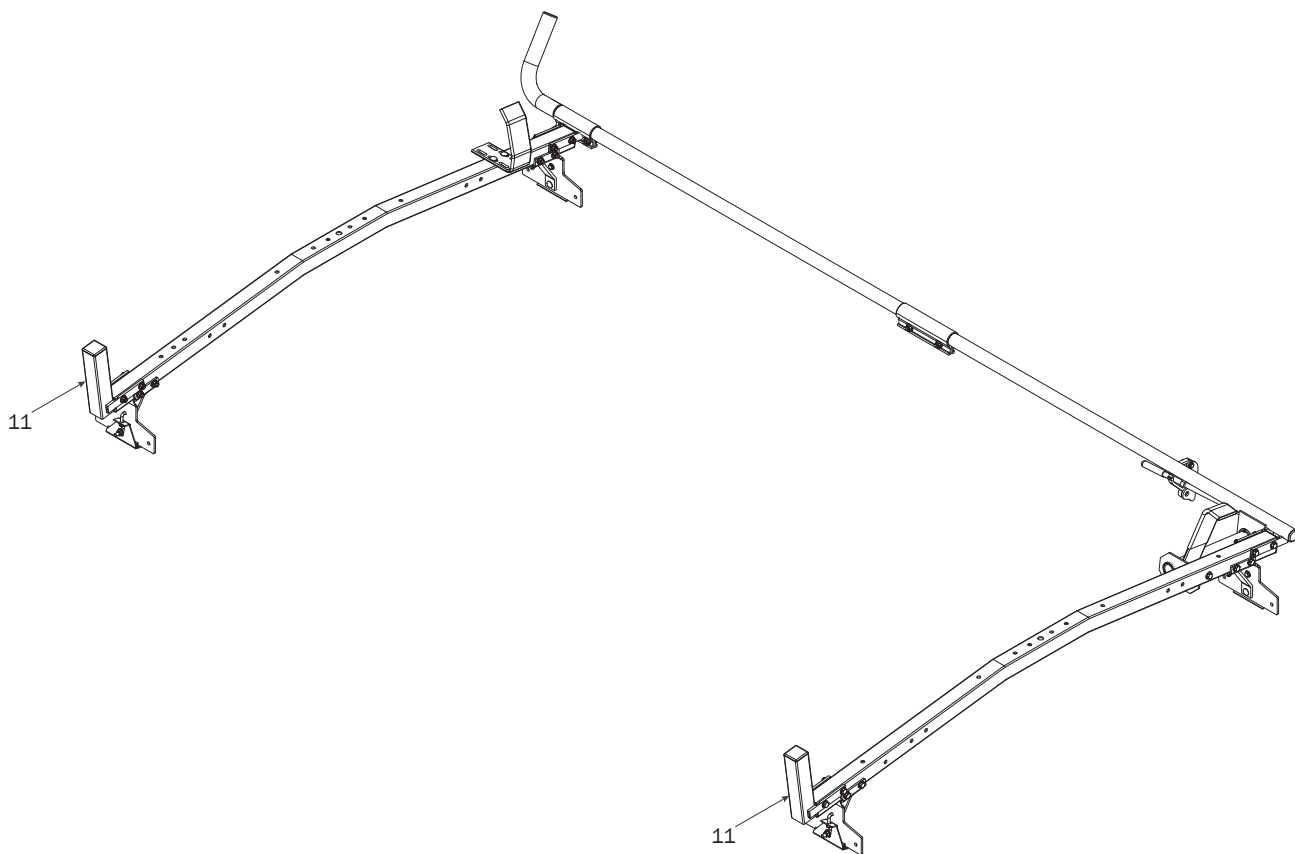
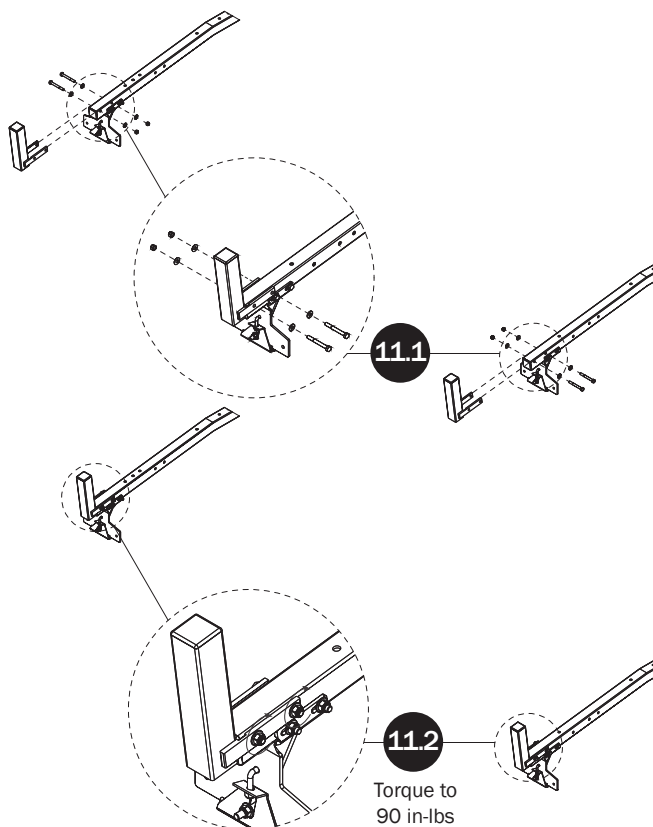
LEFT SIDE BASE ASSEMBLY SEQUENCE**LADDER STOPS****ADDITIONAL INFORMATION**

For additional information regarding your VBC-226 Ladder Rack, please visit the Prime Design website at: www.primedesign.net.

Using a QR code reader in your smart phone or tablet, read the QR Code shown below and follow the same steps as you would from your laptop or computer.

If you're viewing this document as an interactive PDF, you may simply click on the QR Code below to access the Prime Design website.

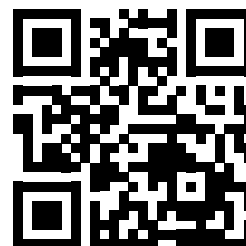

Page Intentionally Left Blank

