

PRIME DESIGN™

A Safe Fleet Brand

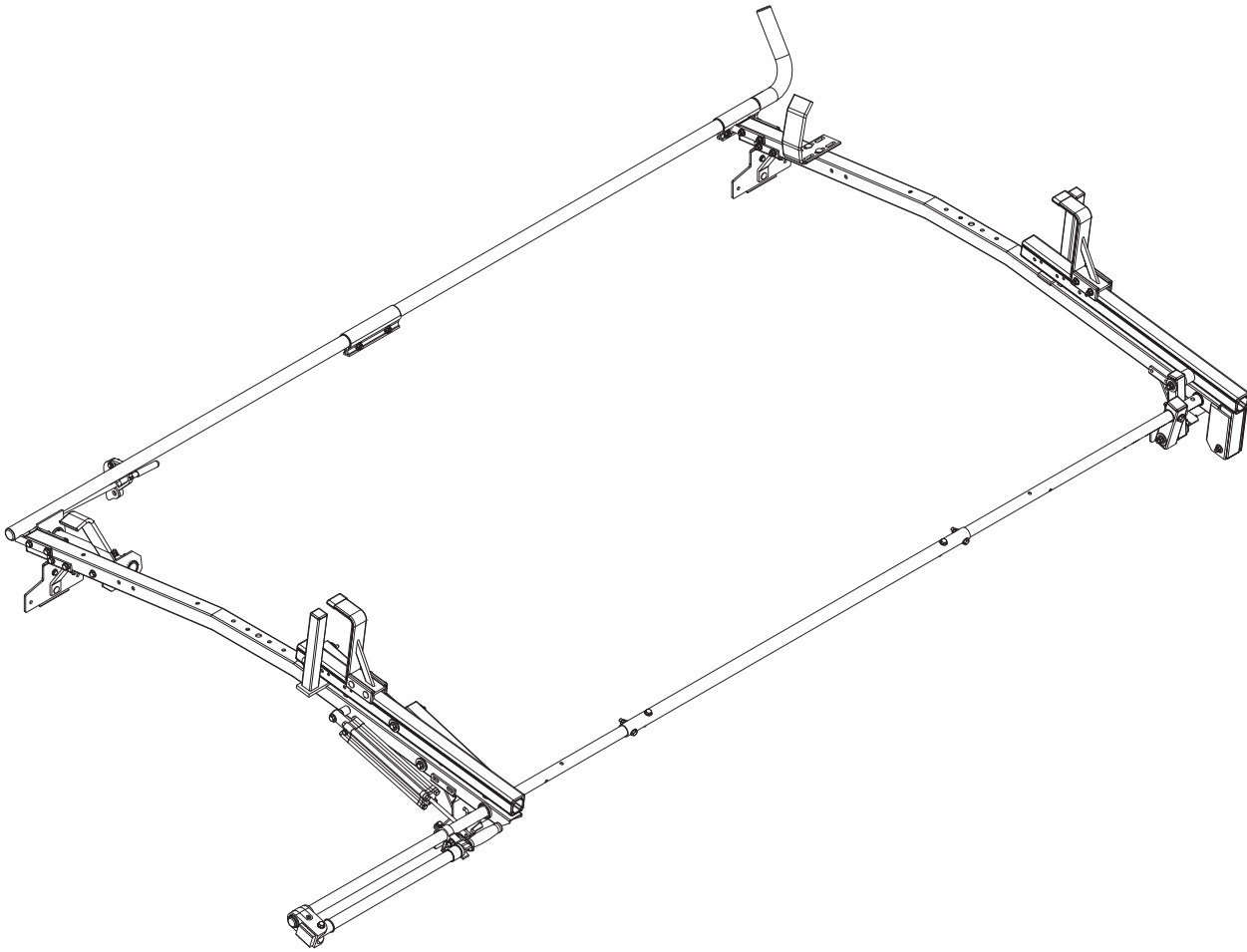

VCI 226

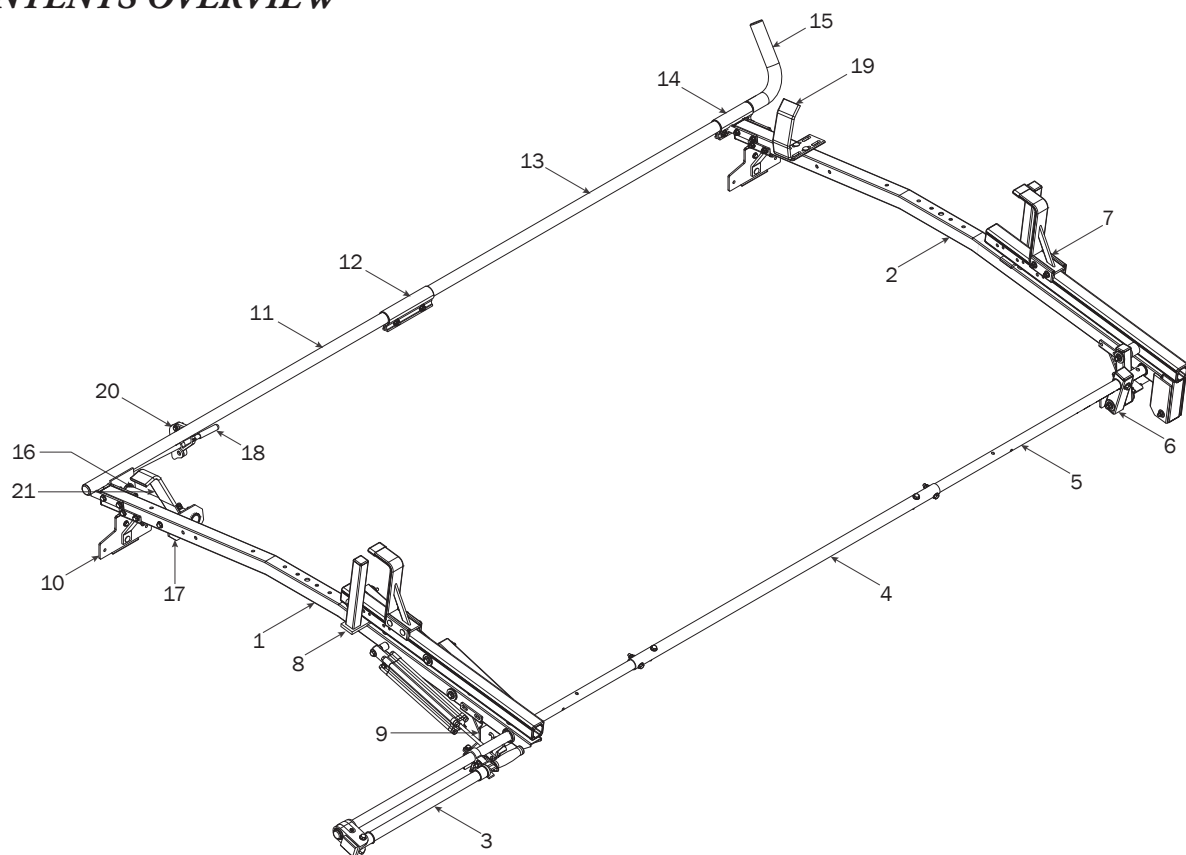

1—Rear Crossbar Assembly (Qty 1)

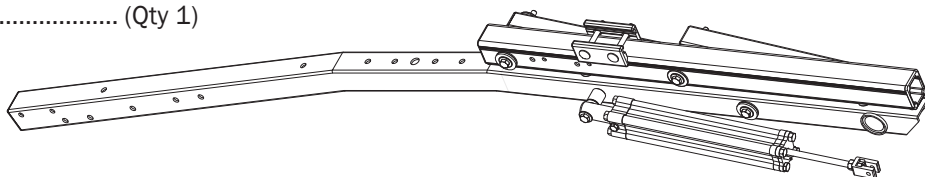

2—Front Crossbar Assembly (Qty 1)

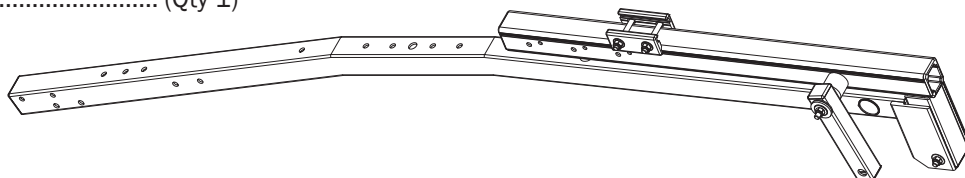

3—Rear Drive Shaft (Qty 1)
Right Hand, B4 Version, 50.00"

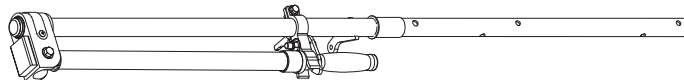

4—Connecting Bar (Qty 1)
48.00"

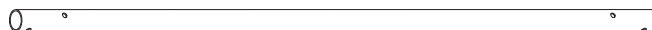

5—Front Drive Shaft (Qty 1)
B Version, 38.75"

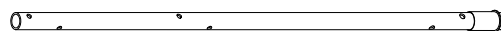

- 6—Drive Arm (Qty 1)
Incline Version with Bushing and Hardware

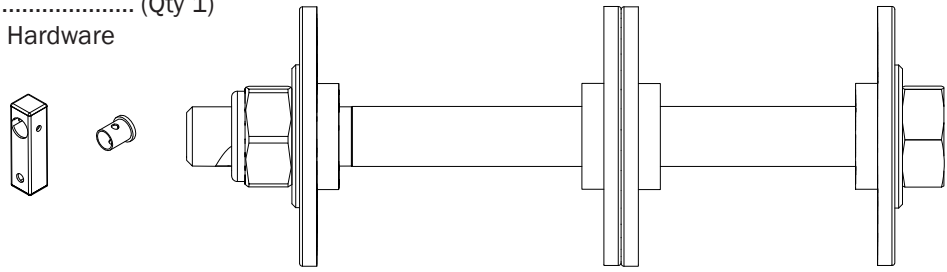

- 7—Z Post (Qty 2)
Adjustable, 7.25"

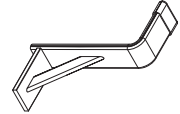

- 8—L Post (Qty 2)
Top Mount, 9.25"

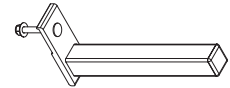

- 9—Mounting Bracket Assembly (Qty 2)
Vertical, Guttered Mounting, GM

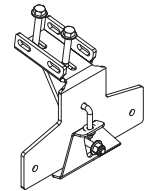

- 10—Mounting Bracket Assembly (Qty 2)
Horizontal, Guttered Mounting, GM

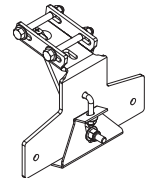

- 11—Clamp Down Tube Assembly (Qty 1)
Rear, Left Hand, 50.00"

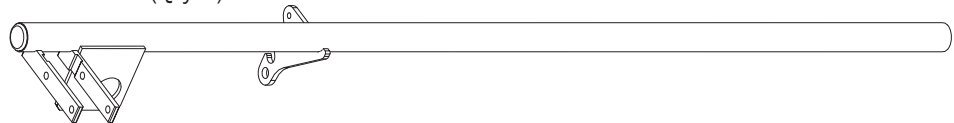

- 12—Clamp Down Tube Splice (Qty 1)
7.00"



- 13—Clamp Down Tube (Qty 1)
Front, 51.00"



- 14—Clamp Down Tube Splice (Qty 1)
Welded, 5.00"

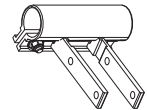

- 15—Clamp Down Horn (Qty 1)
Left Hand, with Cap, 15.00"

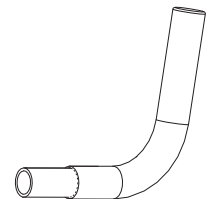

- 16—Clamp Down Handle Tube (Qty 1)
14.50"



- 17—Clamp Down Handle Tube Bracket (Qty 1)
Rear, Left Hand

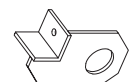

18—Clamp Down Handle(Qty 1)
With Black Grip, 18.00"

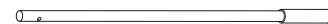

19—Clamp Down Hook(Qty 1)
Front, Slotted

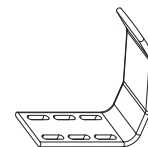

20—Handle Latch Lock Plate (Qty 1)
With Hardware, Gen1

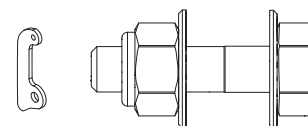

21—Clamp Down Hook (Qty 1)
Rear

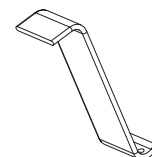

HKT-8112-Clamp Down Hardware Kit

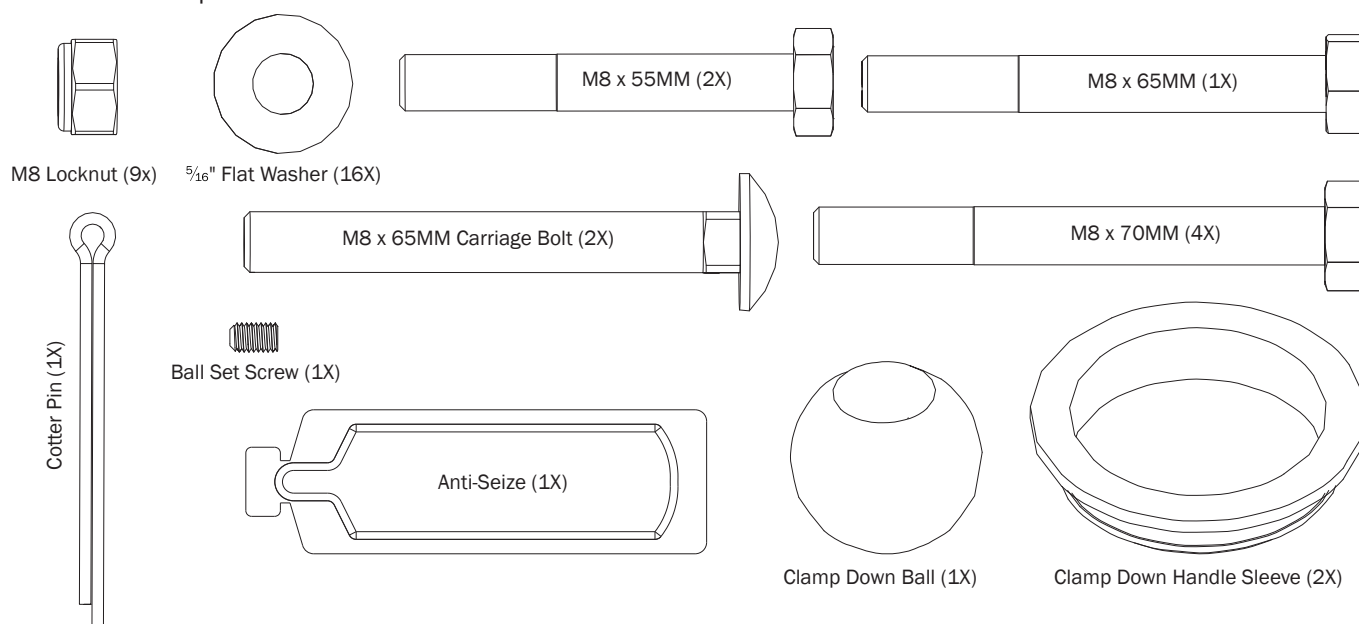

HKT-8163-Rotation Hardware Kit

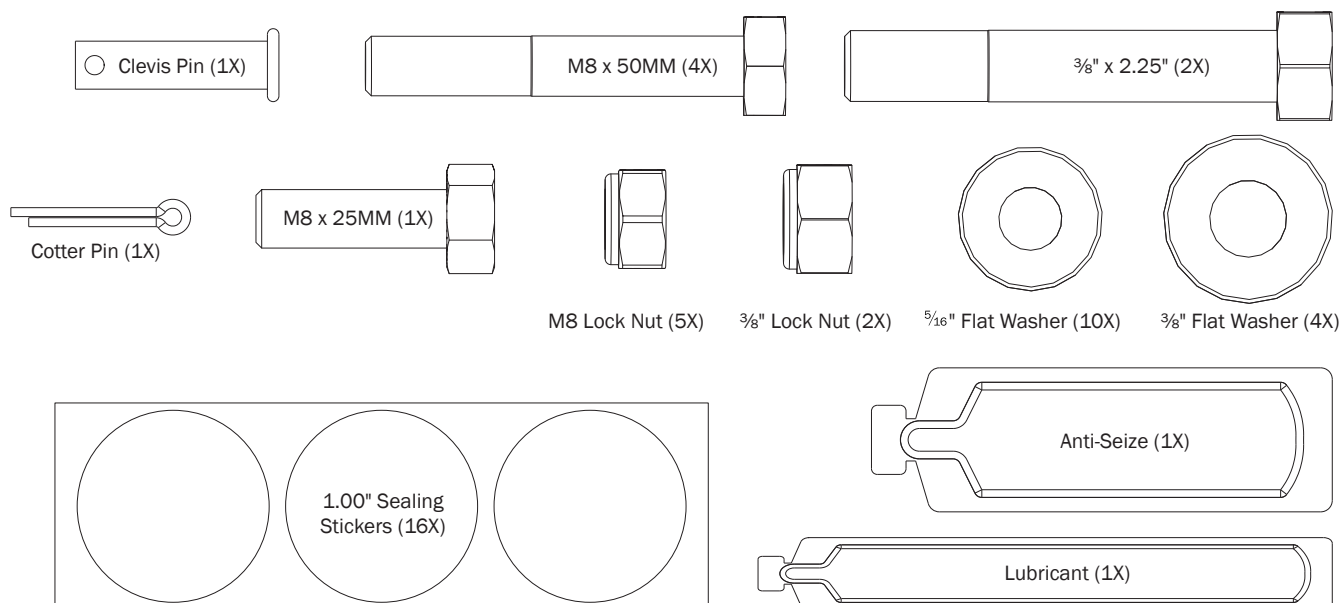

MOUNTING BRACKETS—VERTICAL BRACKET PRE-ASSEMBLY

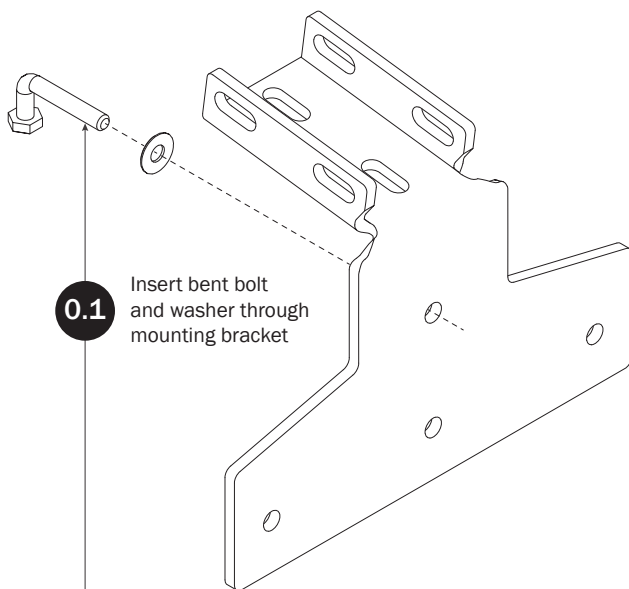

0.1 Insert bent bolt and washer through mounting bracket

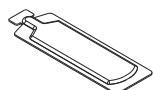

Anti-Seize
Must apply Anti-Seize Compound and torque to specified value.

0.2

Assemble the Z Plate and secure with washer and nut. Do not tighten until installed on vehicle roof.

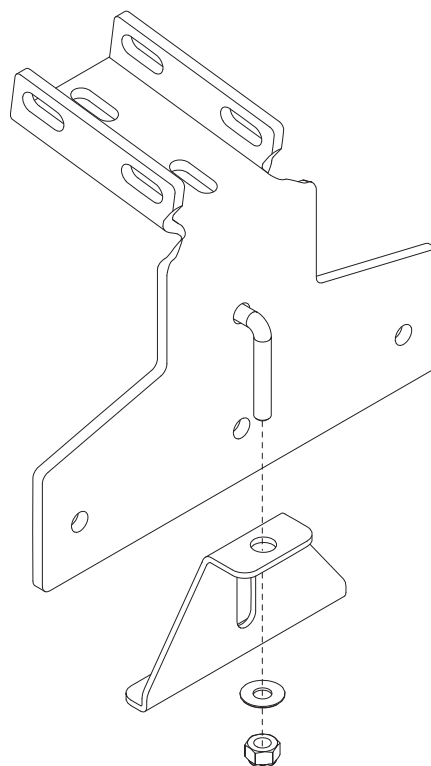

0.5

Repeat Steps 0.1–0.4 to assemble the remaining Vertical Mounting Brackets.

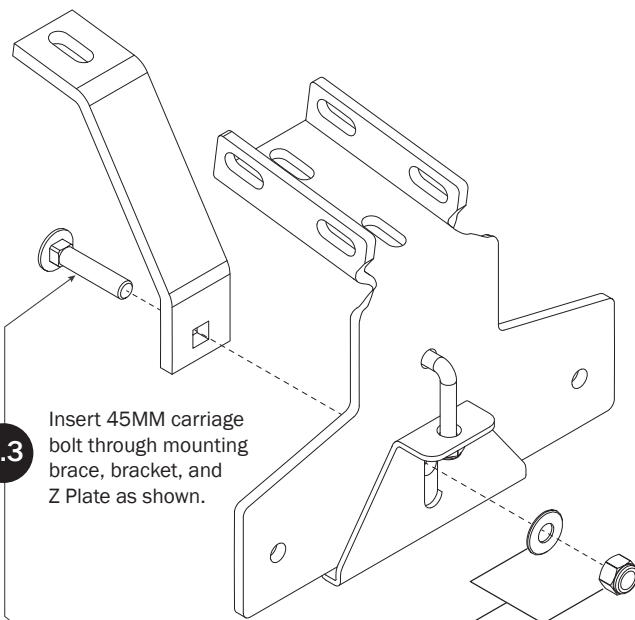

0.3 Insert 45MM carriage bolt through mounting brace, bracket, and Z Plate as shown.

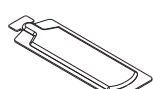

Anti-Seize
Must apply Anti-Seize Compound and torque to specified value.

0.4

Secure mounting assembly with washer and nut. Do not tighten until installed on vehicle roof.

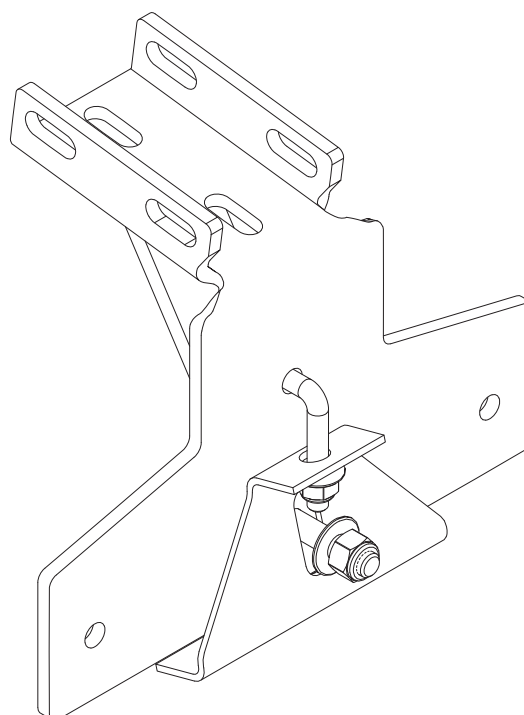

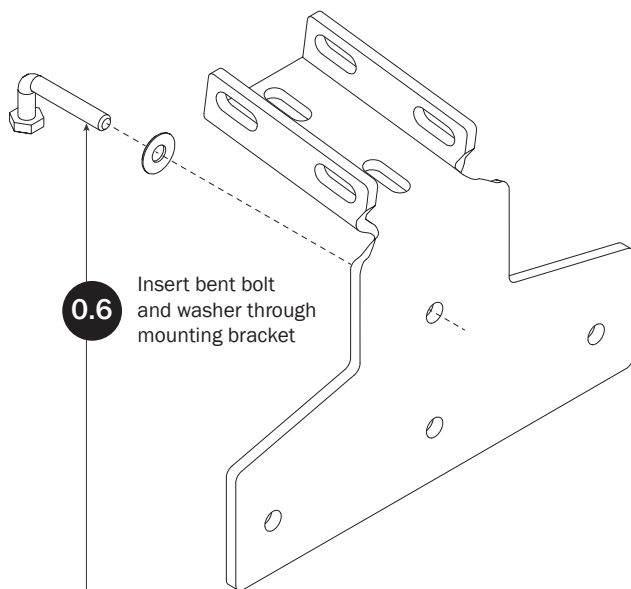
**MOUNTING BRACKETS—HORIZONTAL
BRACKET PRE-ASSEMBLY**

0.6 Insert bent bolt and washer through mounting bracket

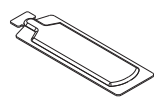

Anti-Seize
Must apply Anti-Seize Compound and torque to specified value.

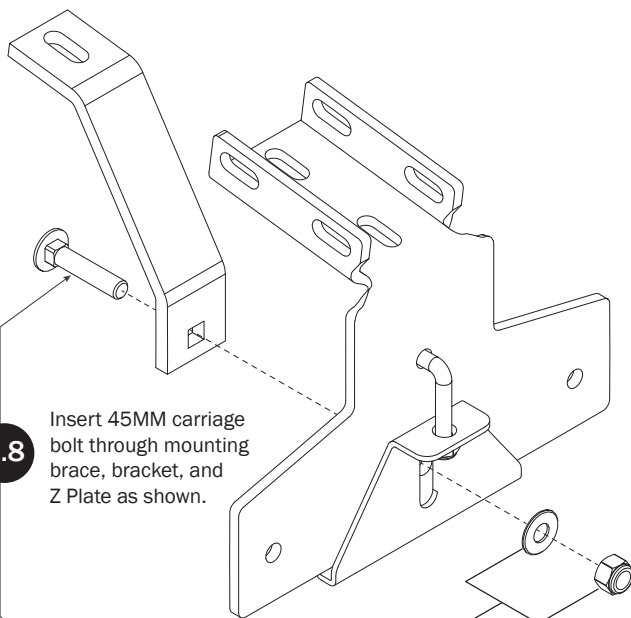

0.8 Insert 45MM carriage bolt through mounting brace, bracket, and Z Plate as shown.

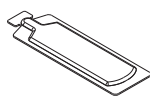

Anti-Seize
Must apply Anti-Seize Compound and torque to specified value.

0.9

Secure mounting assembly with washer and nut. Do not tighten until installed on vehicle roof.

0.7

Assemble the Z Plate and secure with washer and nut. Do not tighten until installed on vehicle roof.

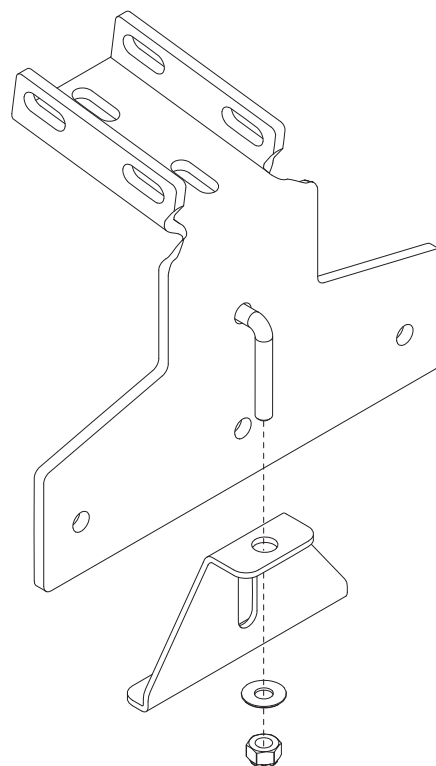

0.10

Repeat Steps 0.6–0.10 to assemble the remaining Horizontal Mounting Brackets.

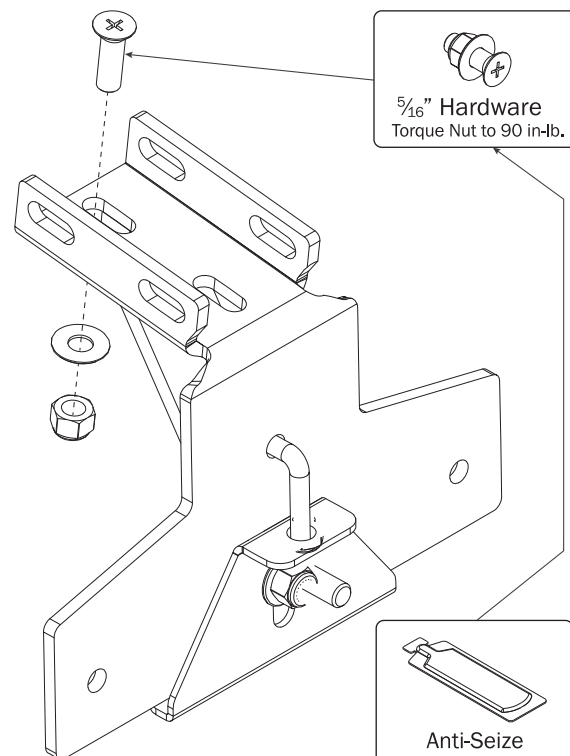

5/16" Hardware
Torque Nut to 90 in-lb.

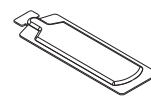

Anti-Seize
Must apply Anti-Seize Compound and torque to specified value.

RIGHT ROTATION ASSEMBLY SEQUENCE

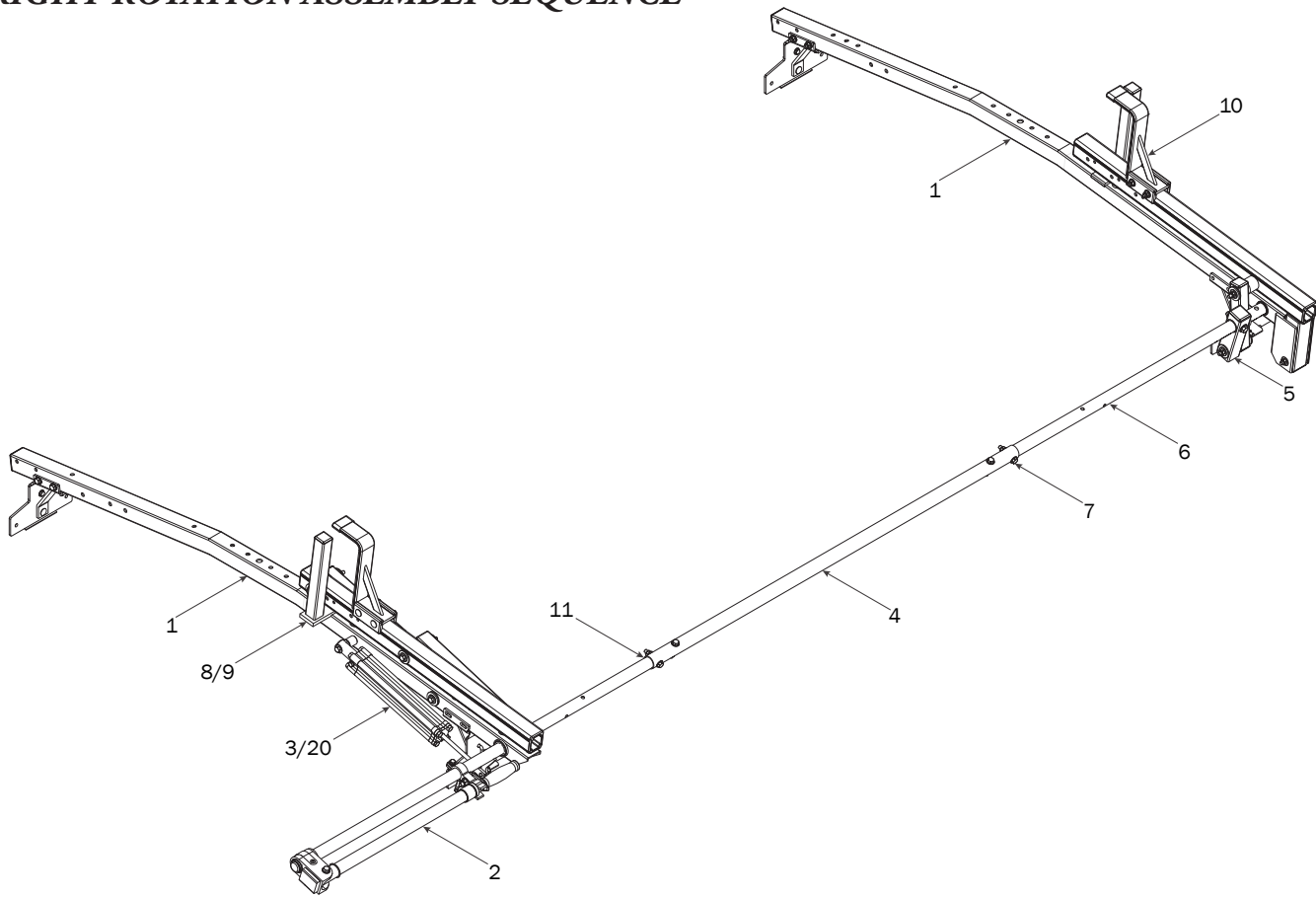

CROSSBARS

- 1.1** Apply Anti-Seize compound to Mounting Bracket bolts.

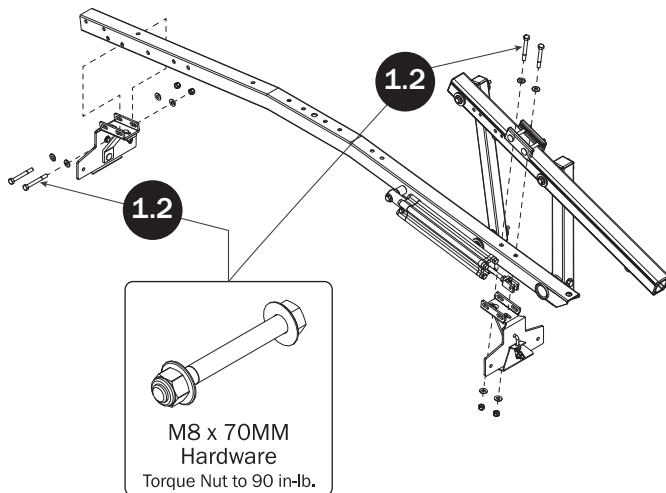

- 1.3** Repeat Steps 1.1–1.3 to install the remaining Mounting Brackets onto the front Crossbar.

REAR DRIVE SHAFT

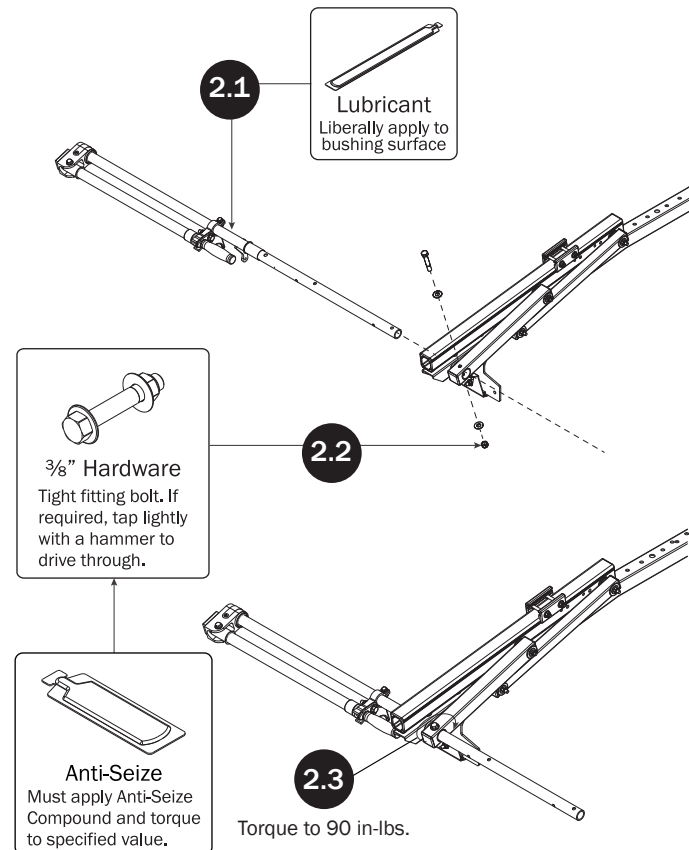

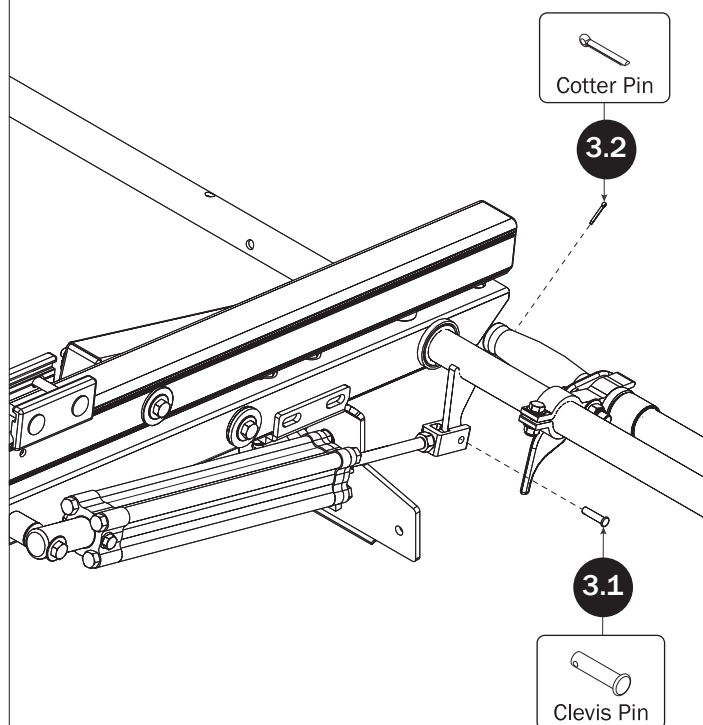
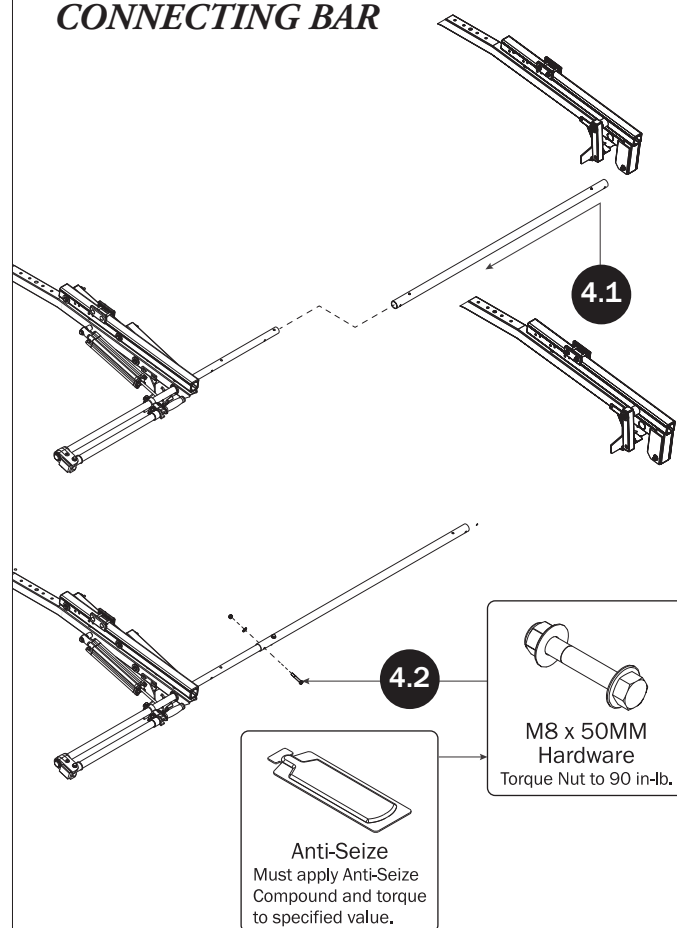
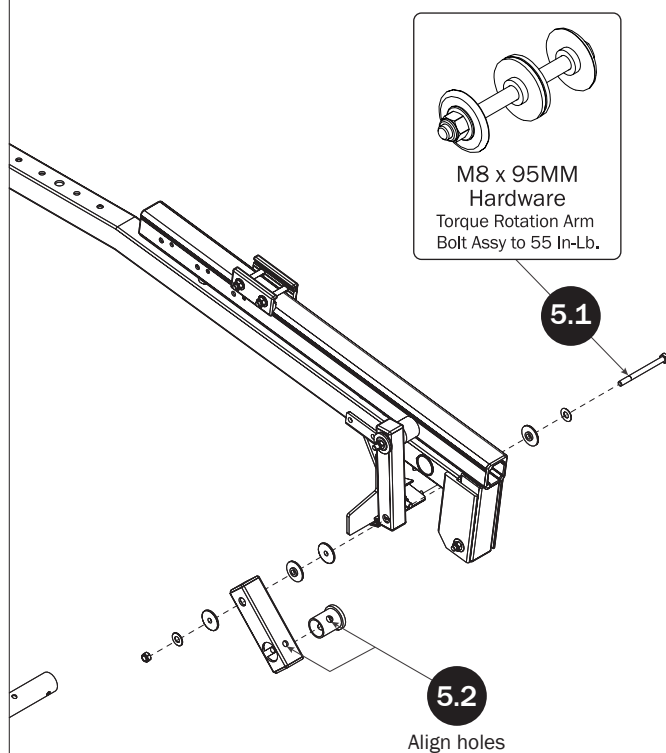
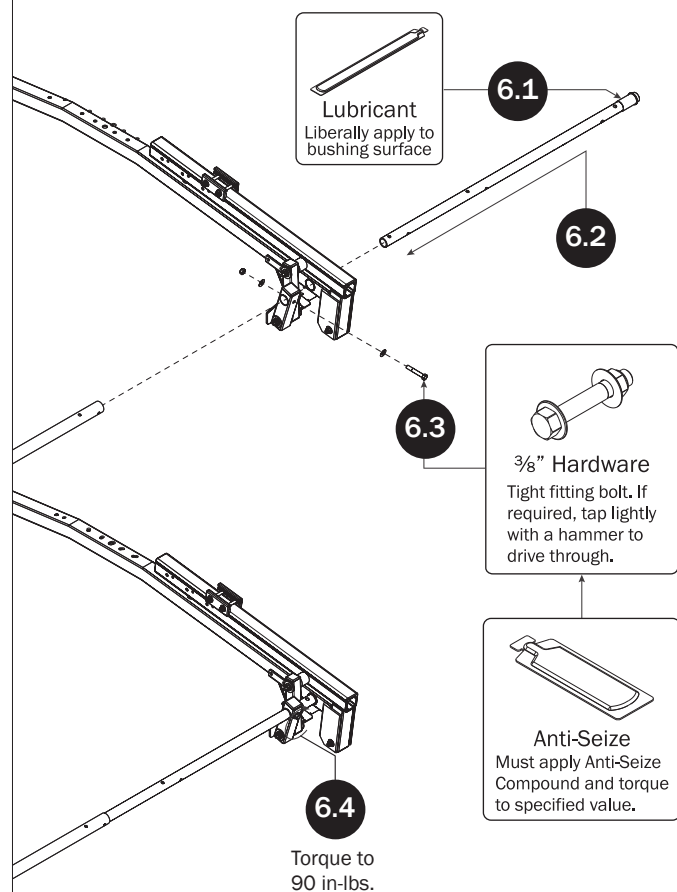
CYLINDER ASSEMBLY**CONNECTING BAR****FRONT DRIVE ARM****FRONT DRIVE SHAFT**

CONNECTING BAR FASTENERS

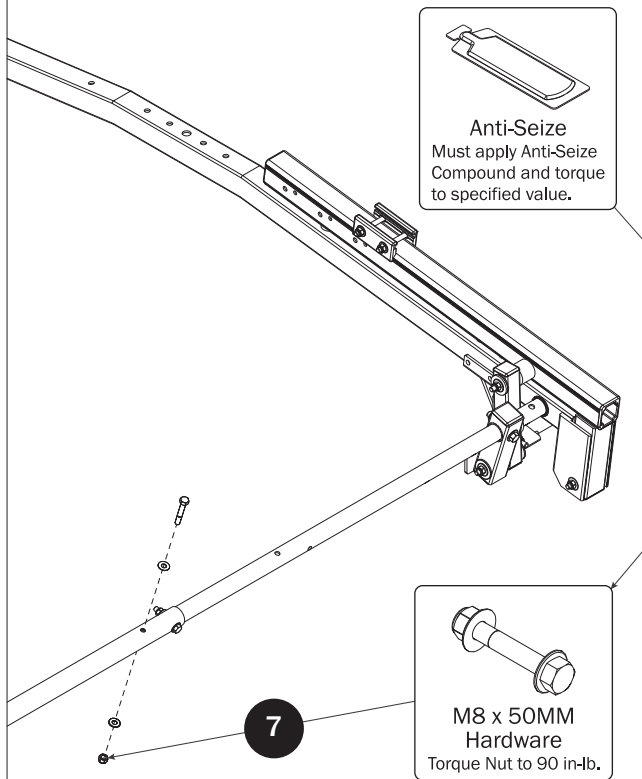

CROSSBAR SEALING

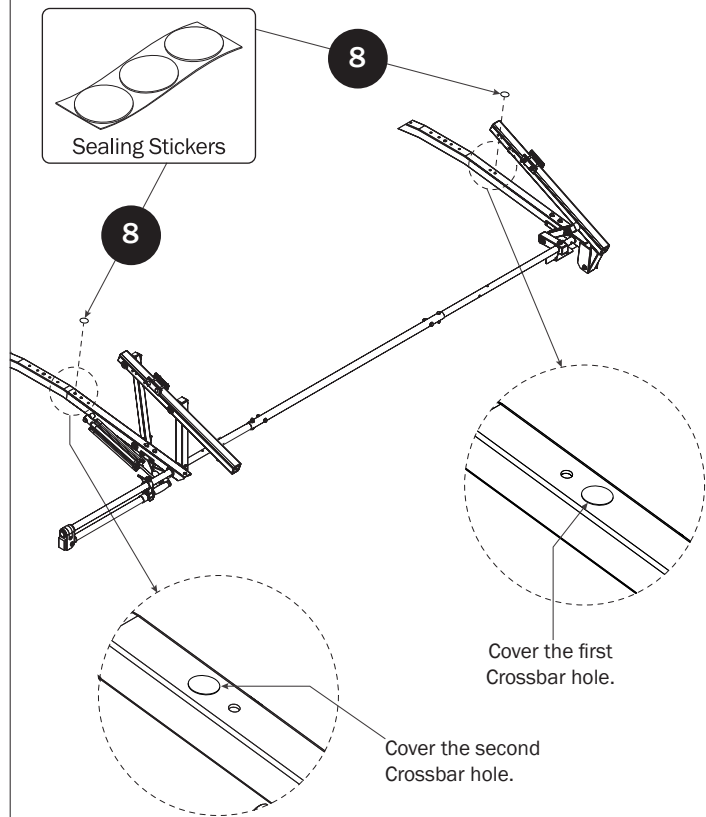

L POSTS

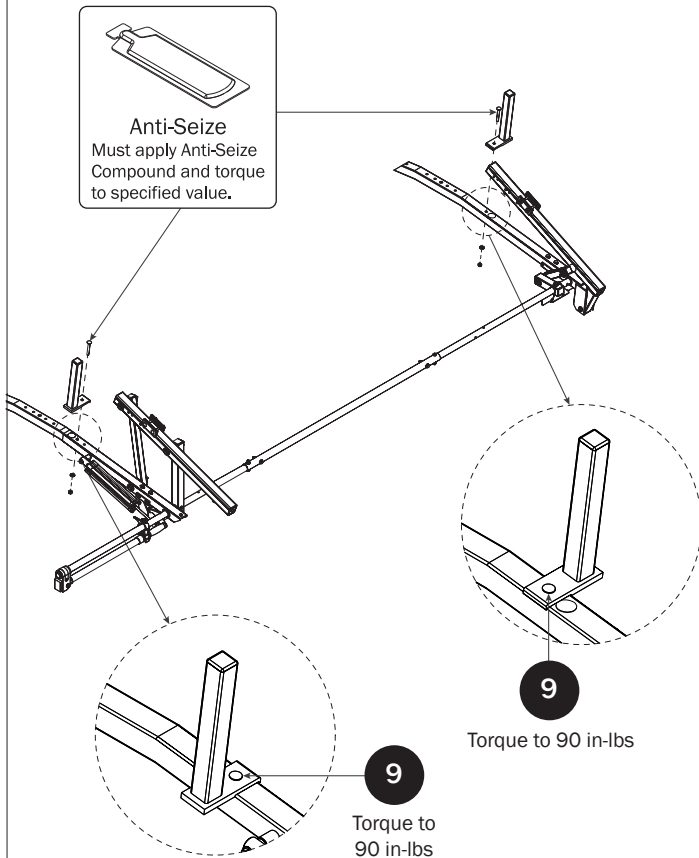

Z POSTS

SEE QUICK START GUIDE FOR ADJUSTMENTS

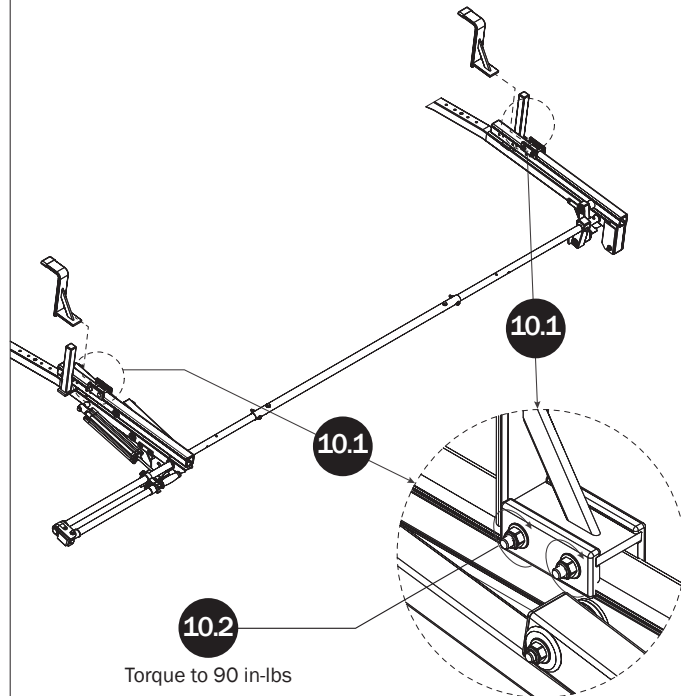

DRIVE SHAFT SEALING

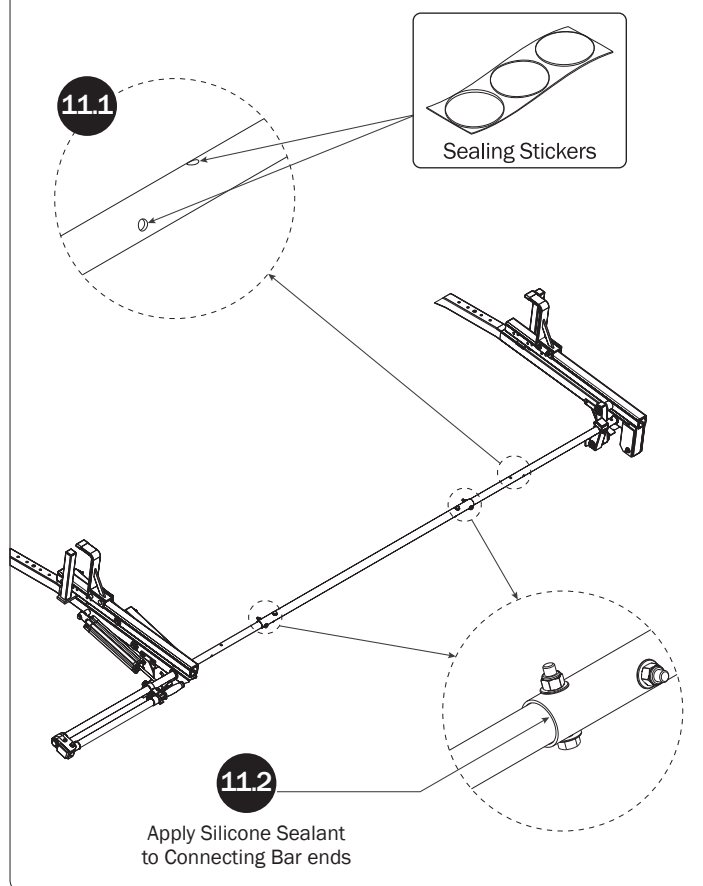

LEFT CLAMP DOWN ASSEMBLY SEQUENCE

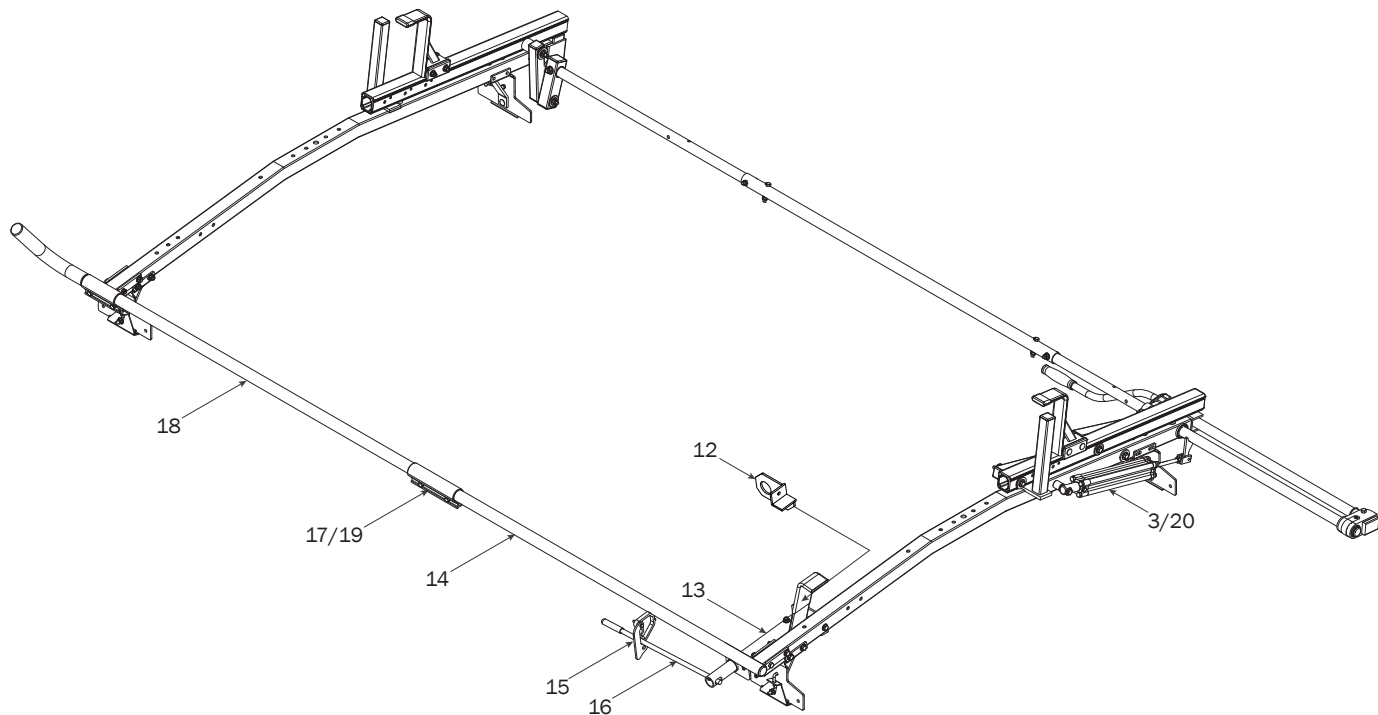

CLAMP DOWN HANDLE TUBE BRACKET

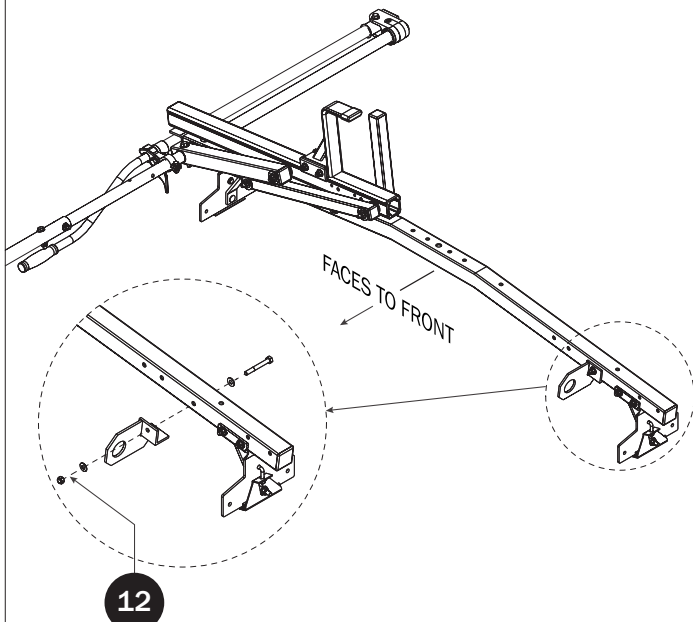

12

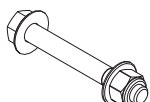

M8 x 65MM
Hardware
Torque Nut to 90 in-lb.

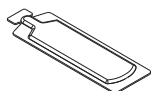

Anti-Seize
Must apply Anti-Seize
Compound and torque
to specified value.

CLAMP DOWN HANDLE TUBE

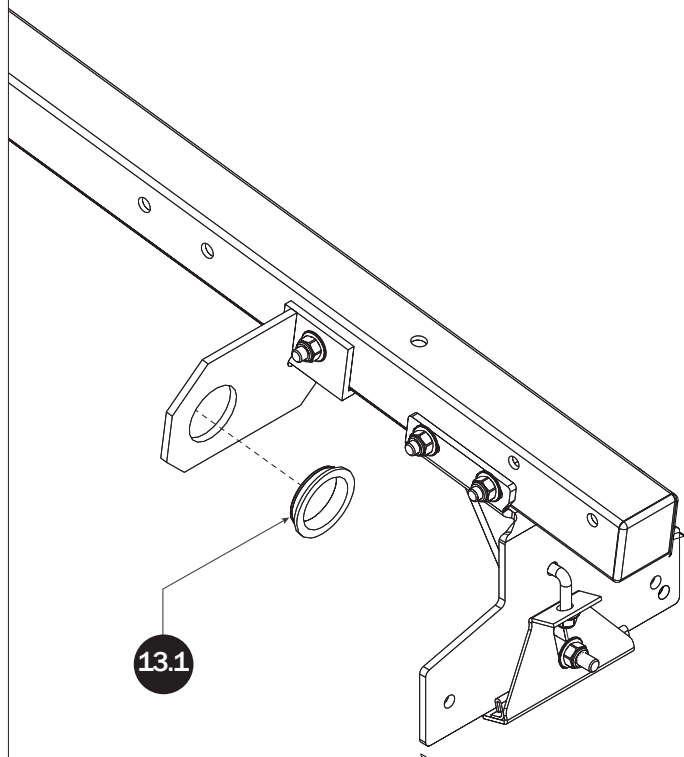

13.1

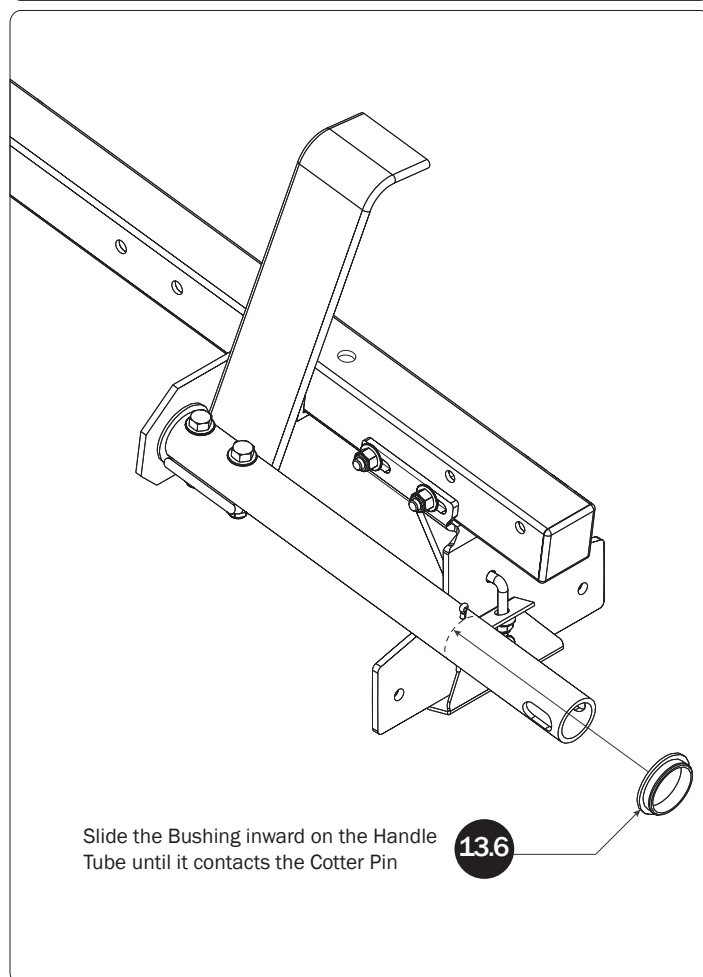
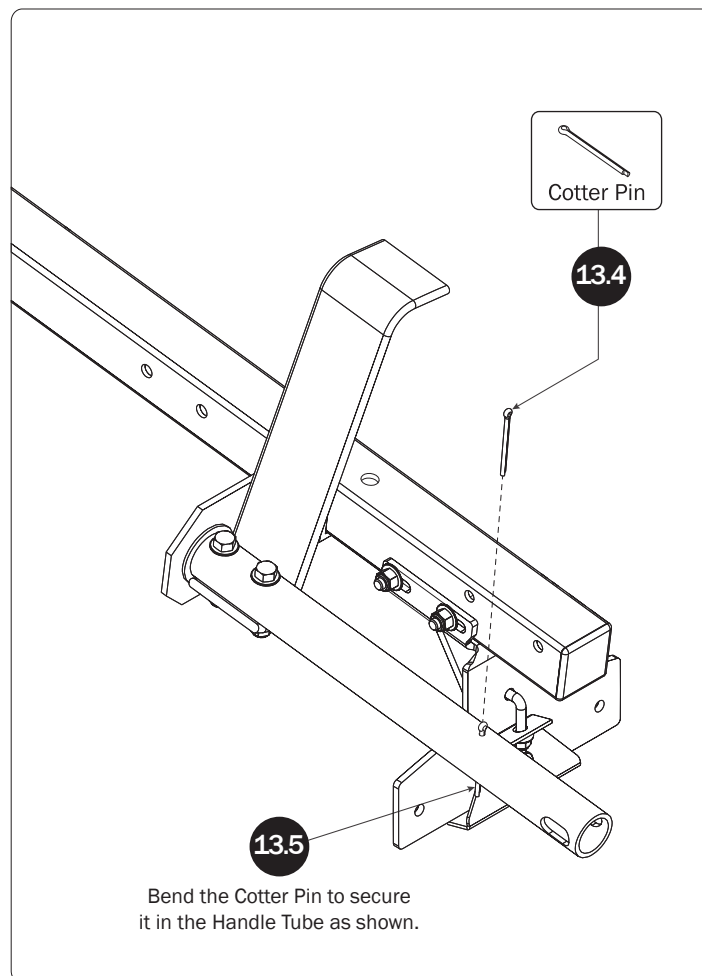
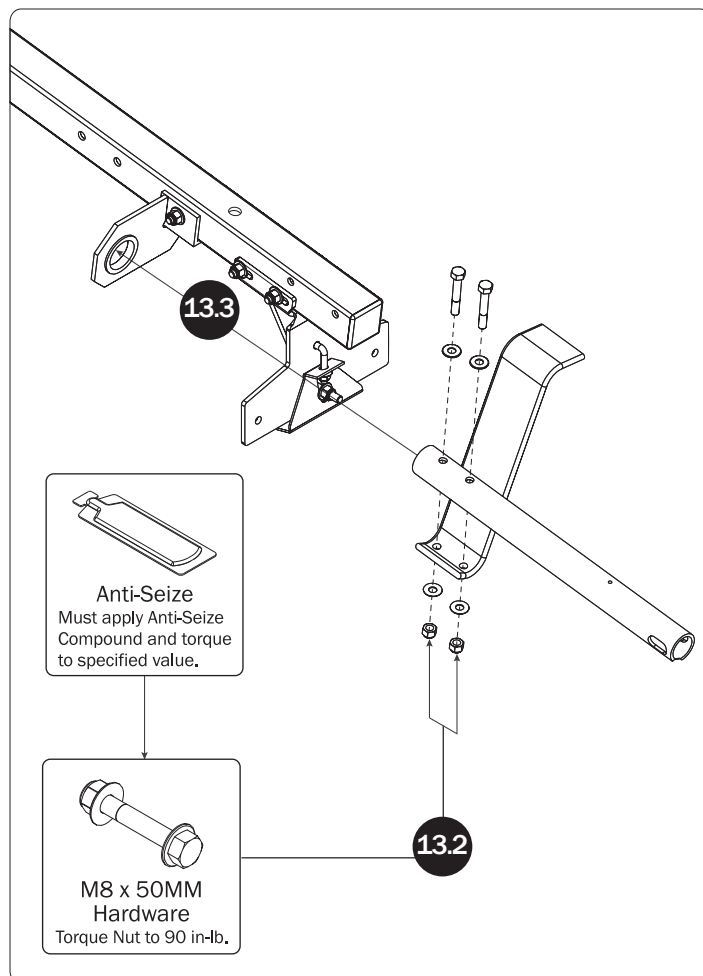

REAR CLAMP DOWN TUBE

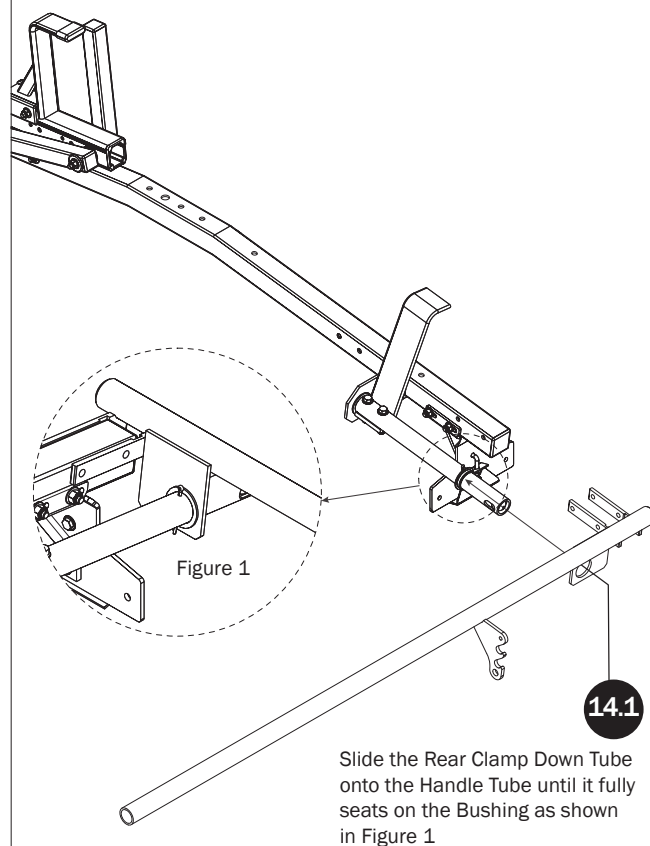

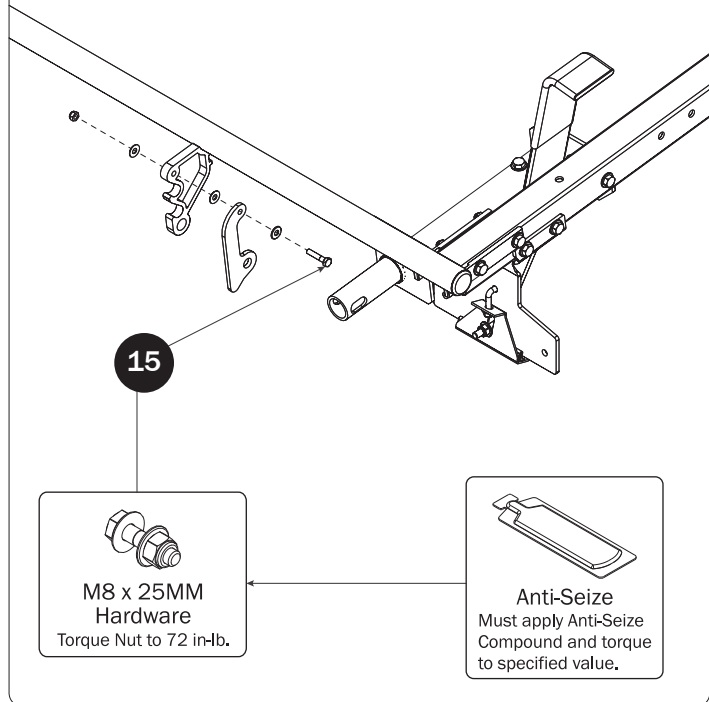
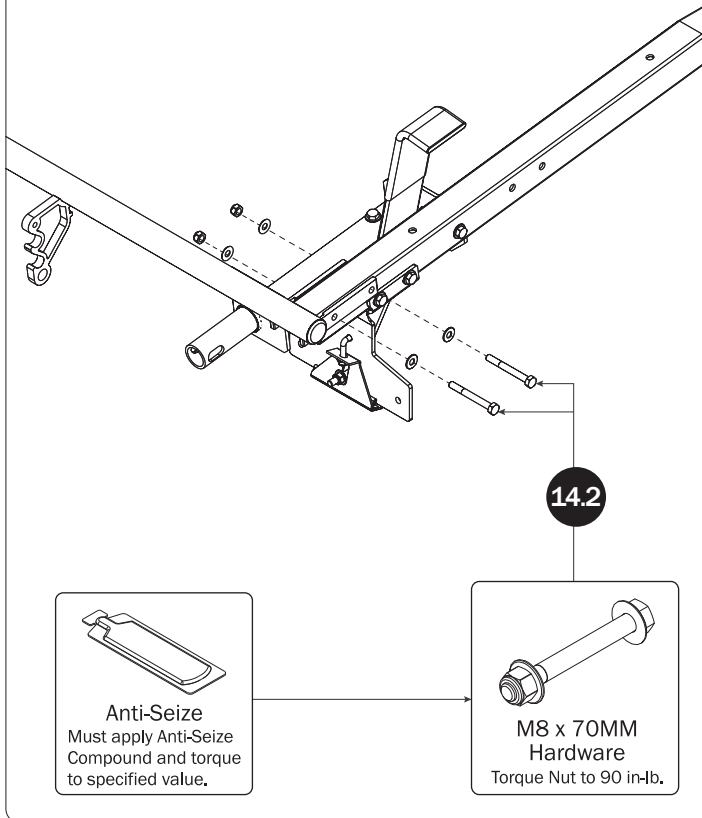
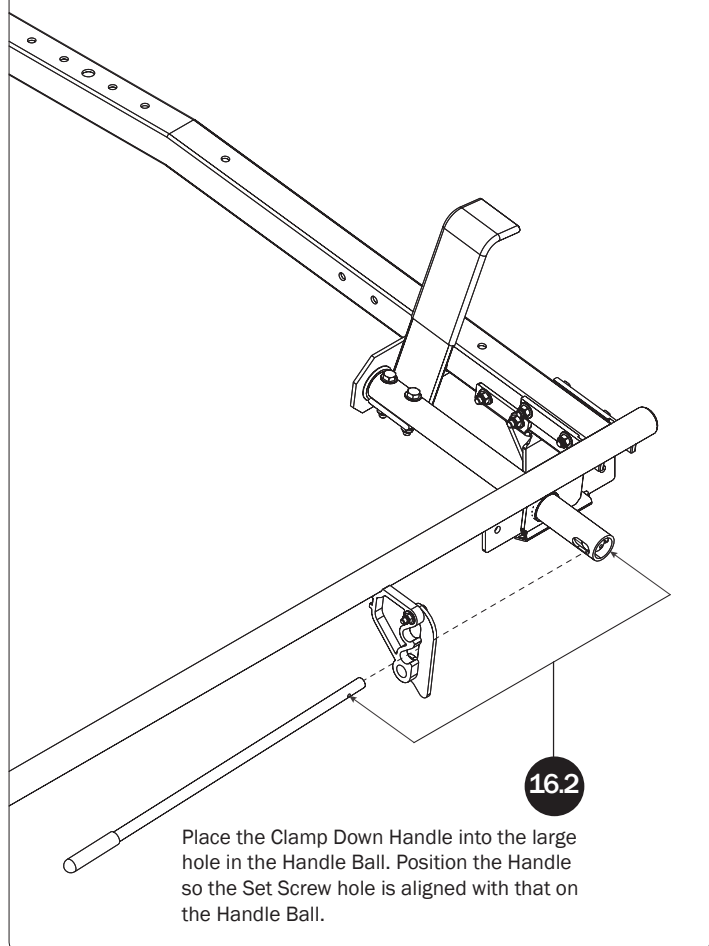
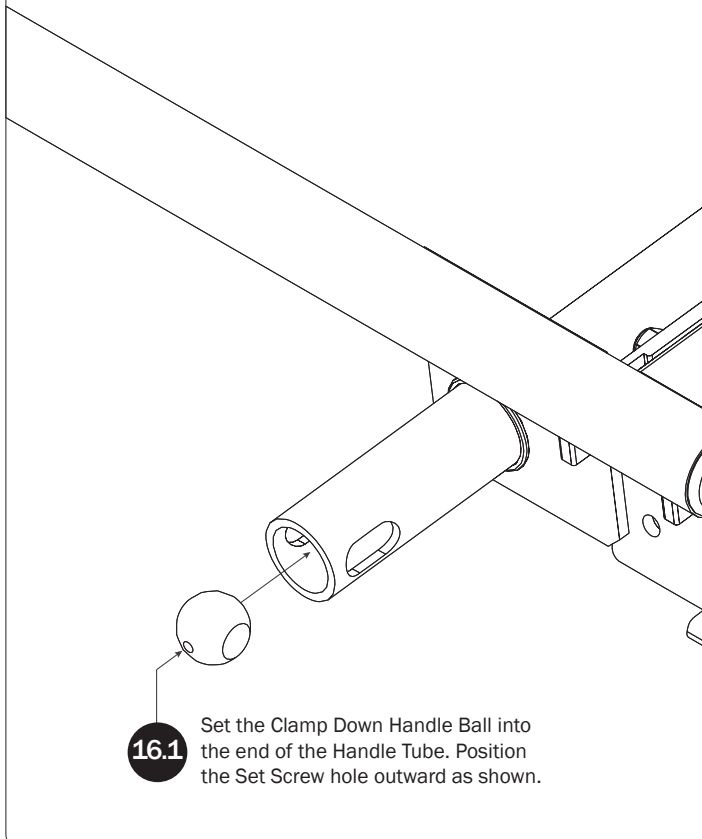
HANDLE LATCH**CLAMP DOWN HANDLE**

16.3

Using an Allen Wrench, insert the Handle Set Screw through the Tube Ball and into the Handle. Torque to 55 in-lbs.

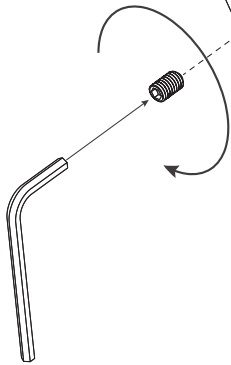
**CLAMP DOWN TUBE SPLICE**

17

Slide the Tube Splice onto the Rear Clamp Down Tube, but do not tighten until Step 18

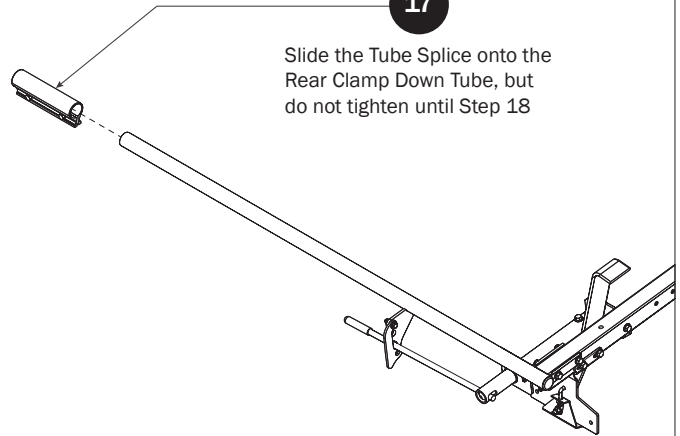
**FRONT CLAMP DOWN TUBE**

Align Clamp Tube tang holes to Crossbar.

18.1

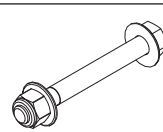
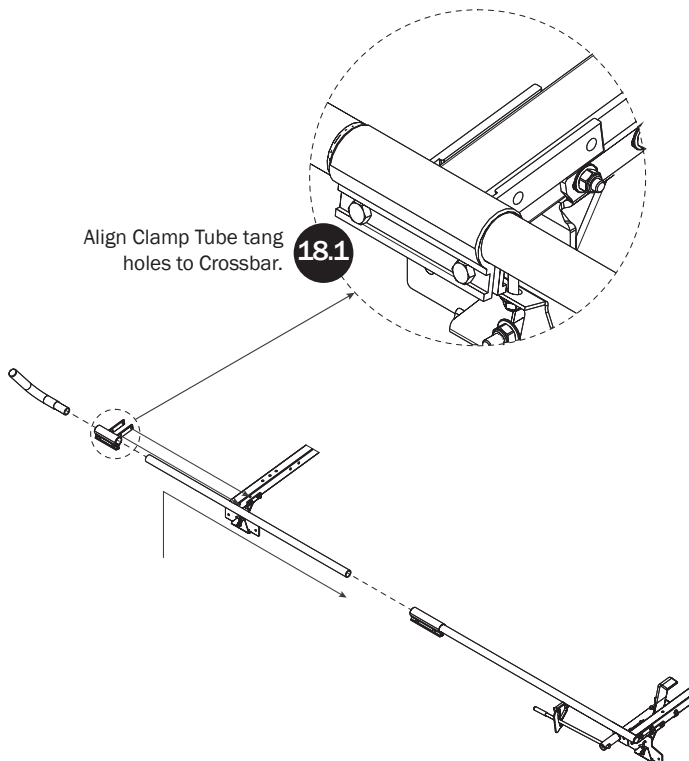

M8 x 70MM
Hardware
Torque Nut to 90 in-lb.

18.2

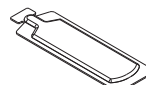
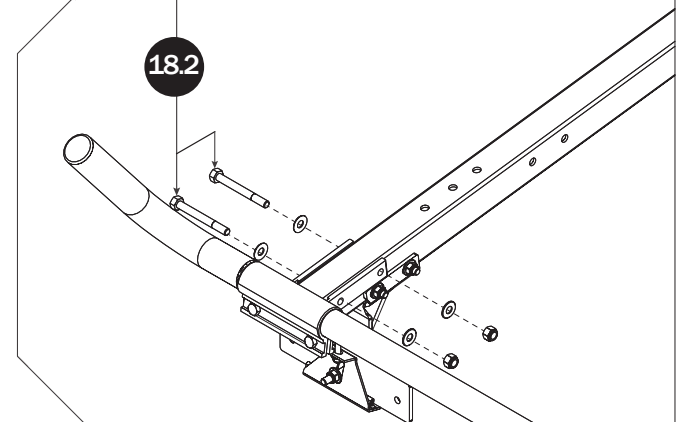

Anti-Seize
Must apply Anti-Seize
Compound and torque
to specified value.

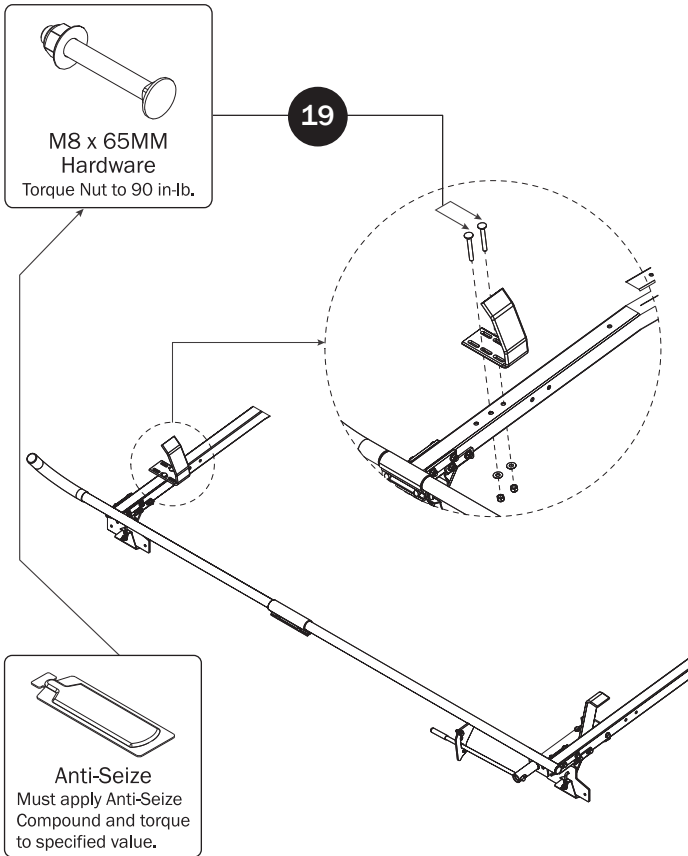
FRONT LADDER HOOK

Torque to 90 in-lbs

19

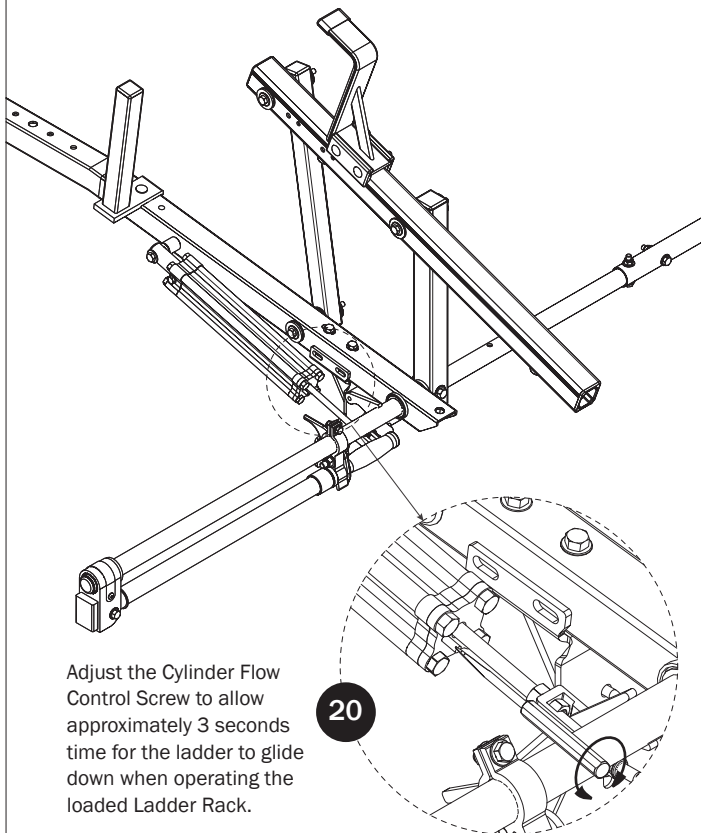
CYLINDER ADJUSTMENT

Adjust the Cylinder Flow Control Screw to allow approximately 3 seconds time for the ladder to glide down when operating the loaded Ladder Rack.

20

