

PRIME DESIGN™

A Safe Fleet Brand

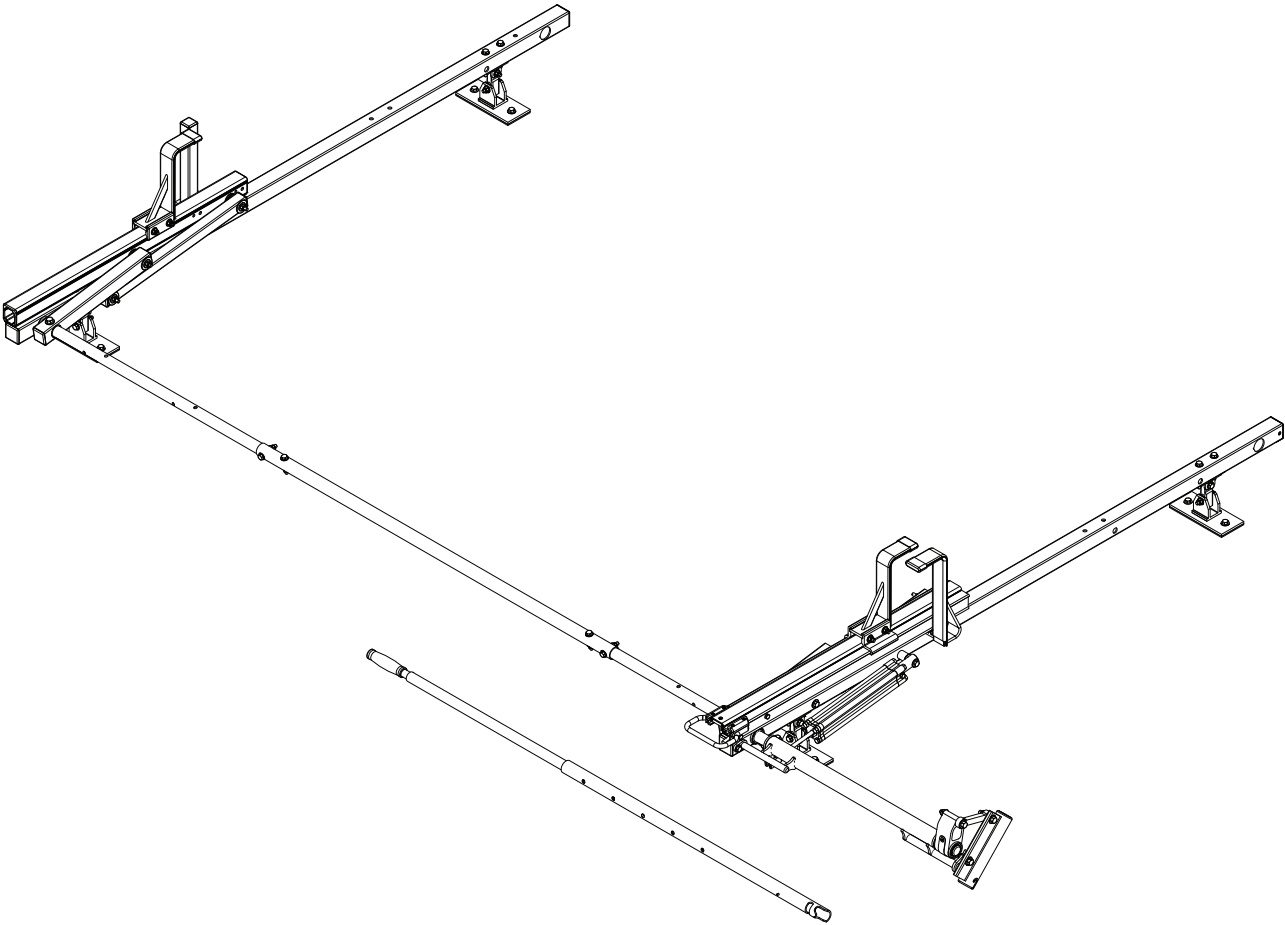

HRX-269-E-UM3

4

CONTENTS OVERVIEW

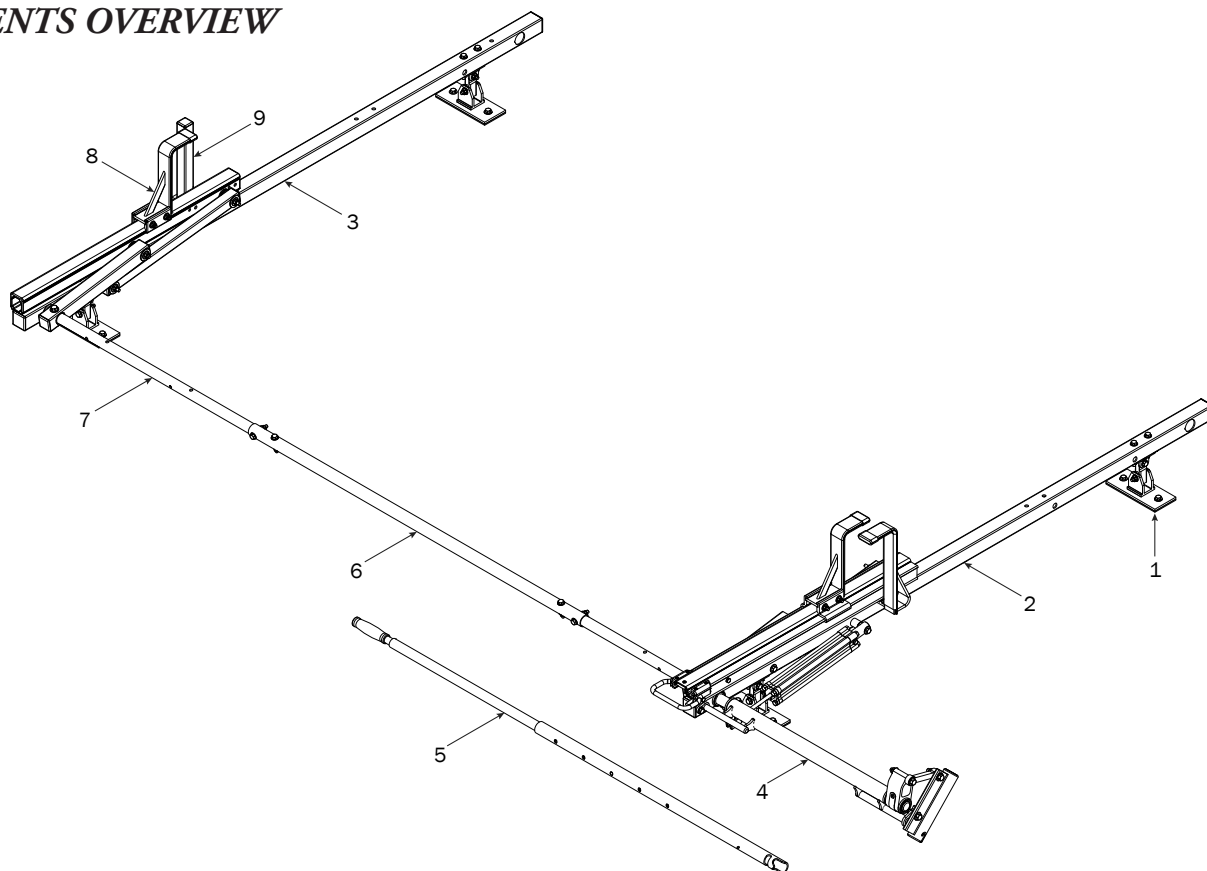

1—MTG-8003..... (Qty 2)
Mounting Feet w/HKT-8129



Mounting Top (2X)



Mounting Post (2X)

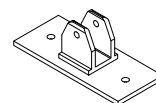

Mounting Foot (2X)

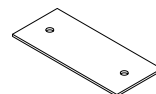

Foam Pad (2X)

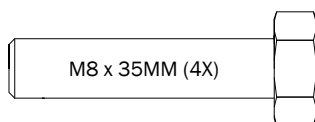

M8 x 35MM (4X)



M8 x 40MM (2X)



M8 x 55MM (2X)

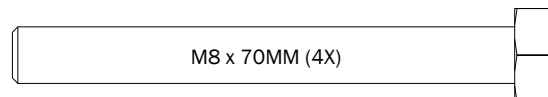

M8 x 70MM (4X)

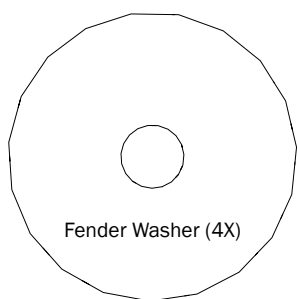

Fender Washer (4X)

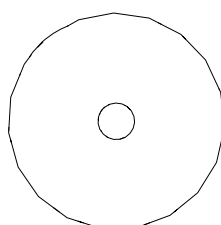
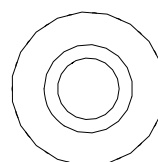
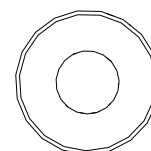
Neoprene
Washer (4X)Sealing
Washer (4X)

Flat Washer (8X)

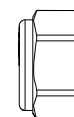

Lock Nut (4X)

2—Rear Crossbar Assembly..... (Qty 1)

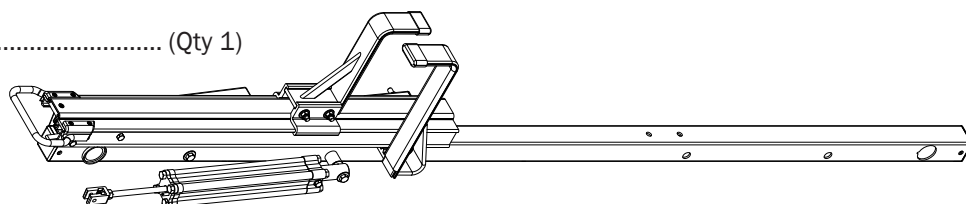

3—Front Crossbar Assembly..... (Qty 1)

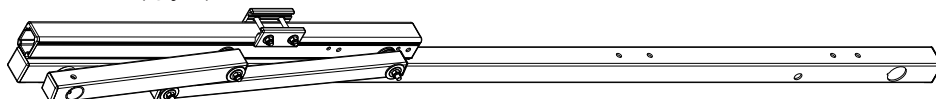

- 4—Rear Drive Shaft (Qty 1)
Left Hand, A Version, 50.00"

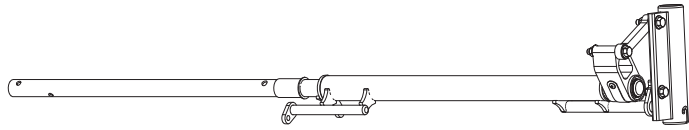

- 5—HHR Handle Assembly (Qty 1)
35.00"

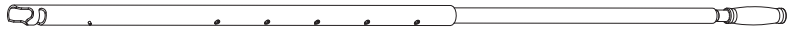

- 6—Connecting Bar (Qty 1)
4.00'



- 7—Front Drive Shaft (Qty 1)
B Version, 35.75"

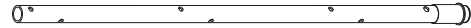

- 8—Z Post (Qty 1)
Adjustment, 7.25"

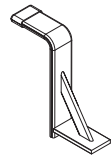

- 9—L Post (Qty 1)
Square Cap, 9.25"

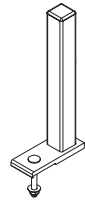

- 10—HKT-8163 (Not called out in Overview) (Qty 1)

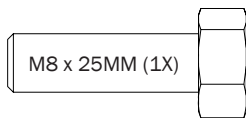

M8 x 25MM (1X)

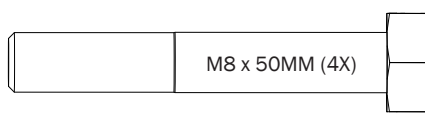

M8 x 50MM (4X)

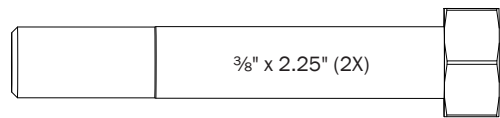

3/8" x 2.25" (2X)

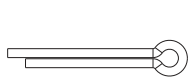

Cotter Pin (1X)



Clevis Pin (1X)

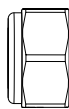

M8 Lock Nut (5X)

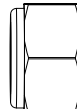

3/8" Lock Nut (2X)

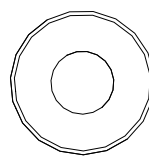

5/16" Flat Washer (10X)

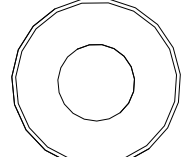

3/8" Flat Washer (4X)

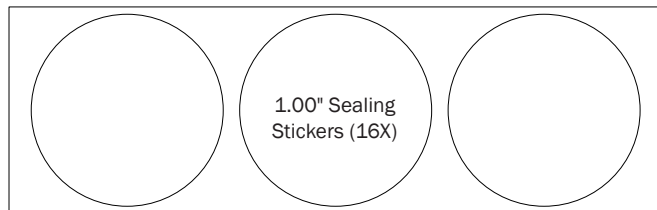

1.00" Sealing
Stickers (16X)



Anti-Seize (1X)

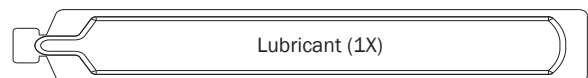

Lubricant (1X)

MTG-8003 MOUNTING BRACKETS TO ROOF

- 0.1** Assemble the Mounting Post to the Mounting Foot using the hardware as shown below.

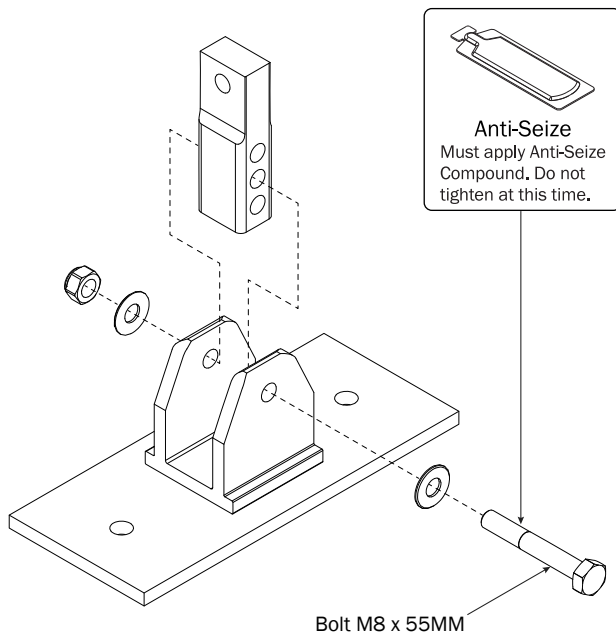

- 0.2** Assemble the Mounting Top to the Mounting Post using the hardware as shown below.

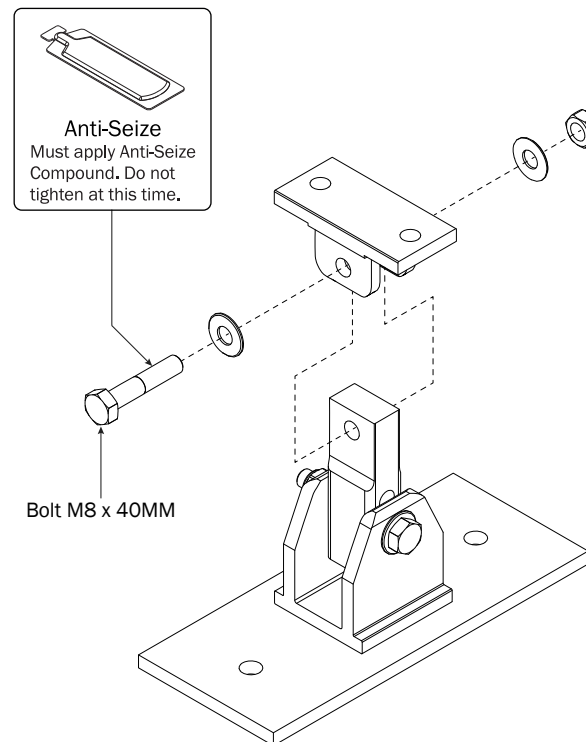

- 0.3** Drill bolt holes according to the dimensions shown.

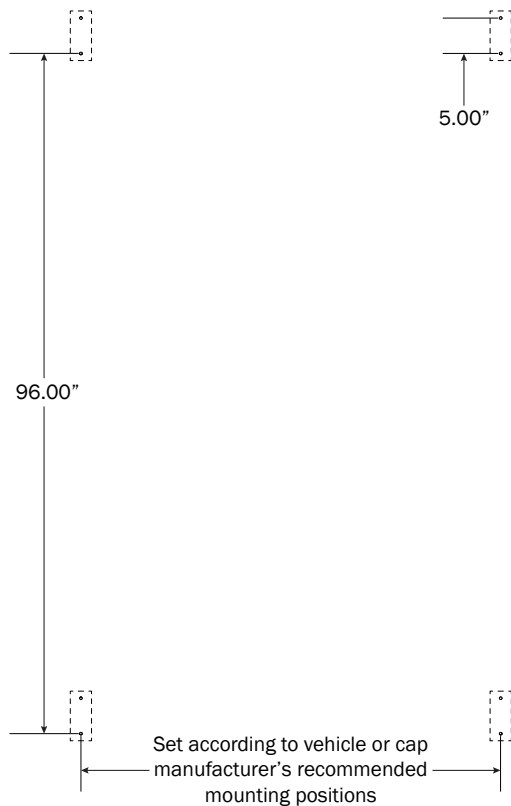

- 0.4** Assemble unto vehicle roof as shown, then torque the Mounting Feet nuts to 130 in-lbs.

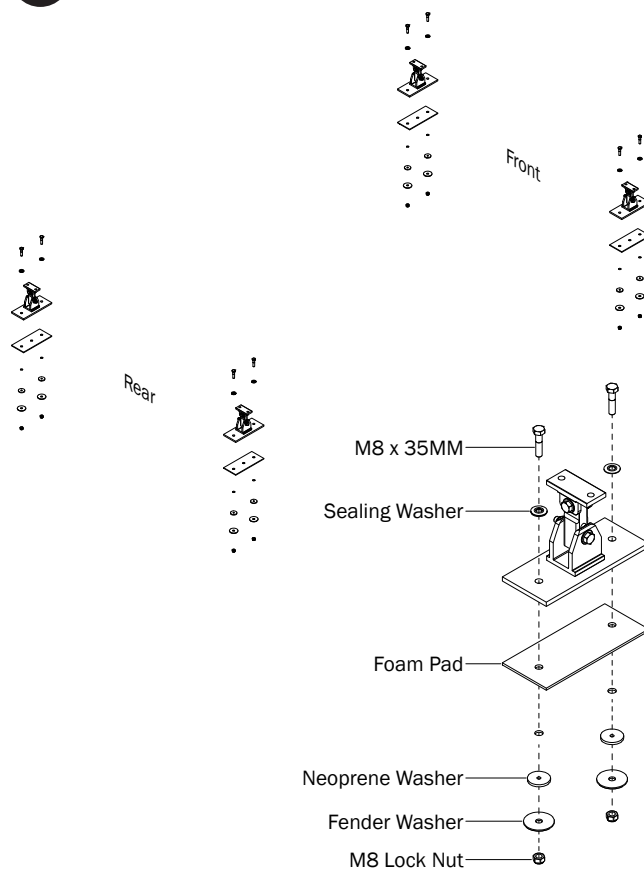

LEFT ROTATION ASSEMBLY SEQUENCE

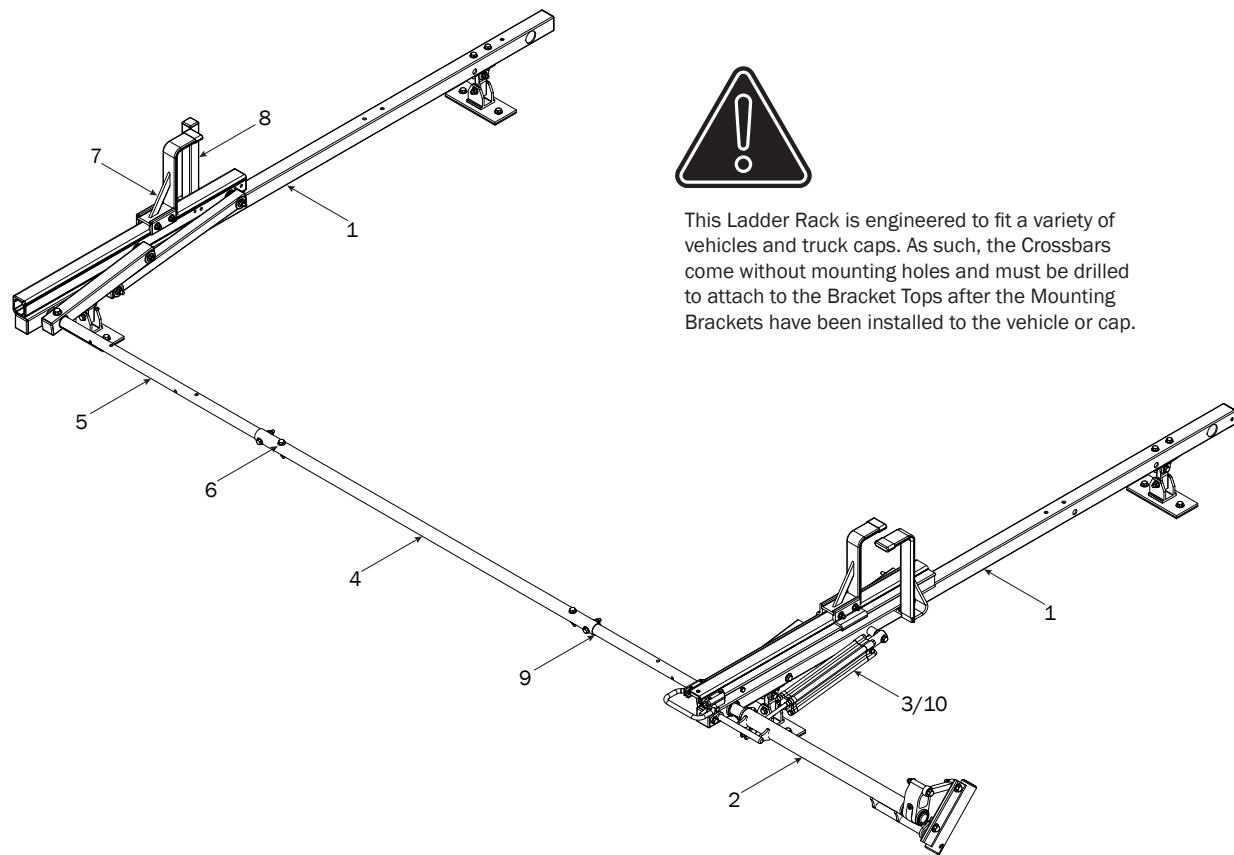

CROSSBARS

1.1 Center the Front and Rear Crossbars onto Mounting Brackets.

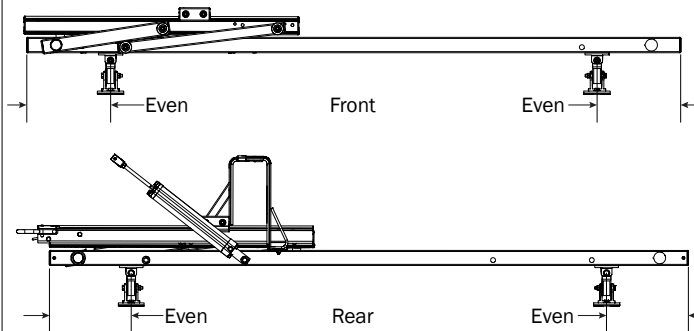

1.2

Measure the distance from the Crossbar's end to the outer hole of the Mounting Top. Using a grease pencil, mark the location of the hole and mark another one at exactly 2.00" on center from the first hole.

1.3

Prior to drilling, mark a center line along the length of the Crossbar to ensure the holes are correctly centered. The marks must align to the pre-drilled factory L Post holes.

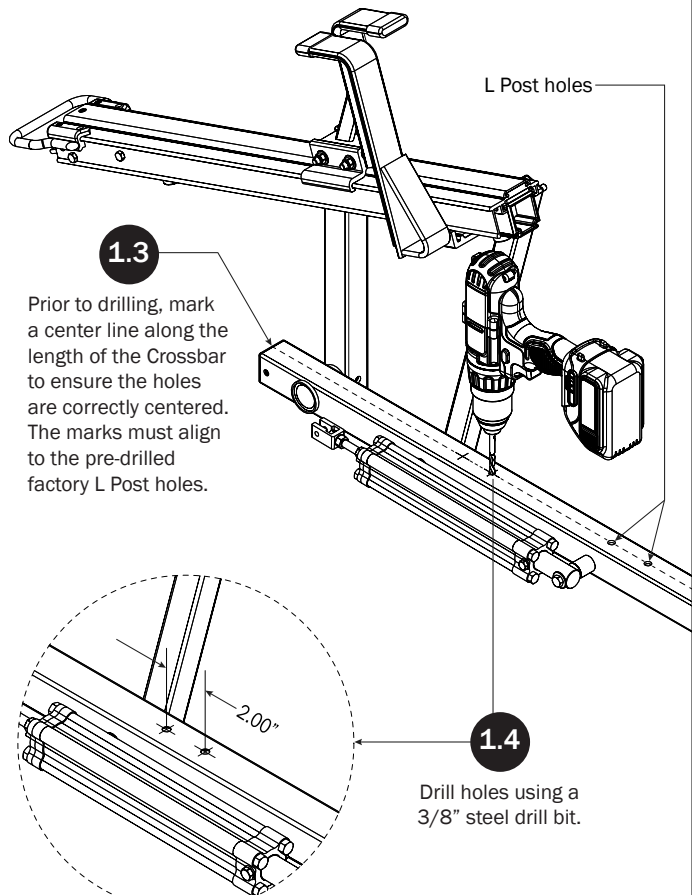

1.4

Drill holes using a 3/8" steel drill bit.

1.5

Attach the Crossbars to the Mounting Brackets using the supplied hardware.

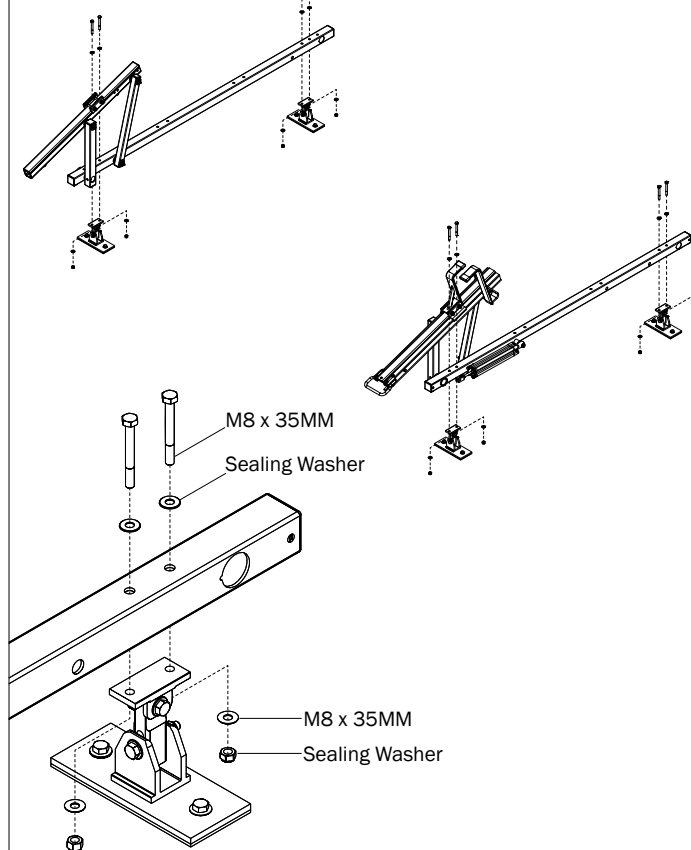

1.6

Torque to 90 in-lbs

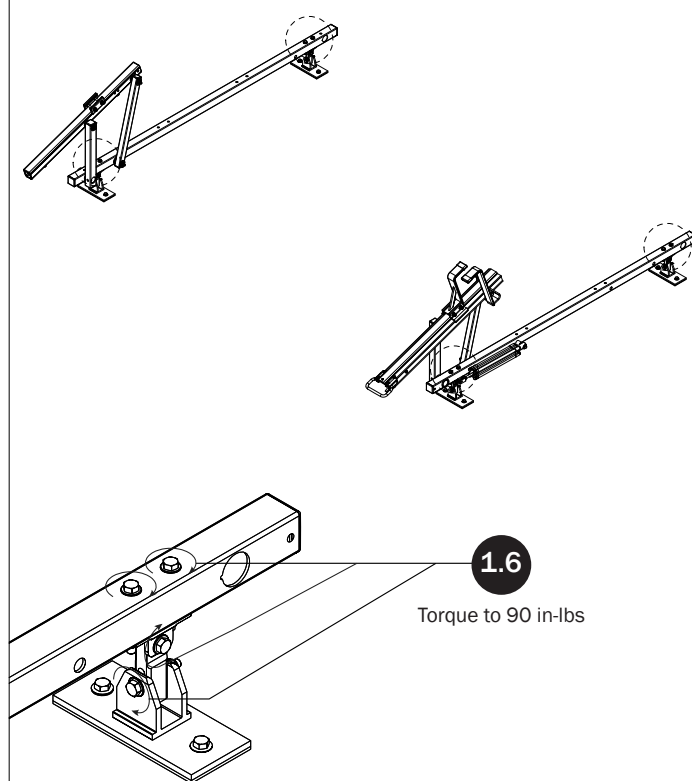

REAR DRIVE SHAFT

2.1

Lubricant
Liberal apply to
bushing surface

2.2

$\frac{3}{8}$ " Hardware
Tight fitting bolt.
Use a ratchet and
 $\frac{9}{16}$ " socket to thread
into Drive Shaft

2.3

Torque to
90 in-lbs

Anti-Seize
Must apply Anti-Seize
Compound and torque
to specified value.

2.4

Anti-Seize
Must apply Anti-Seize
Compound and torque
to specified value.

M8 x 25MM
Hardware
Torque to 90 in-lbs

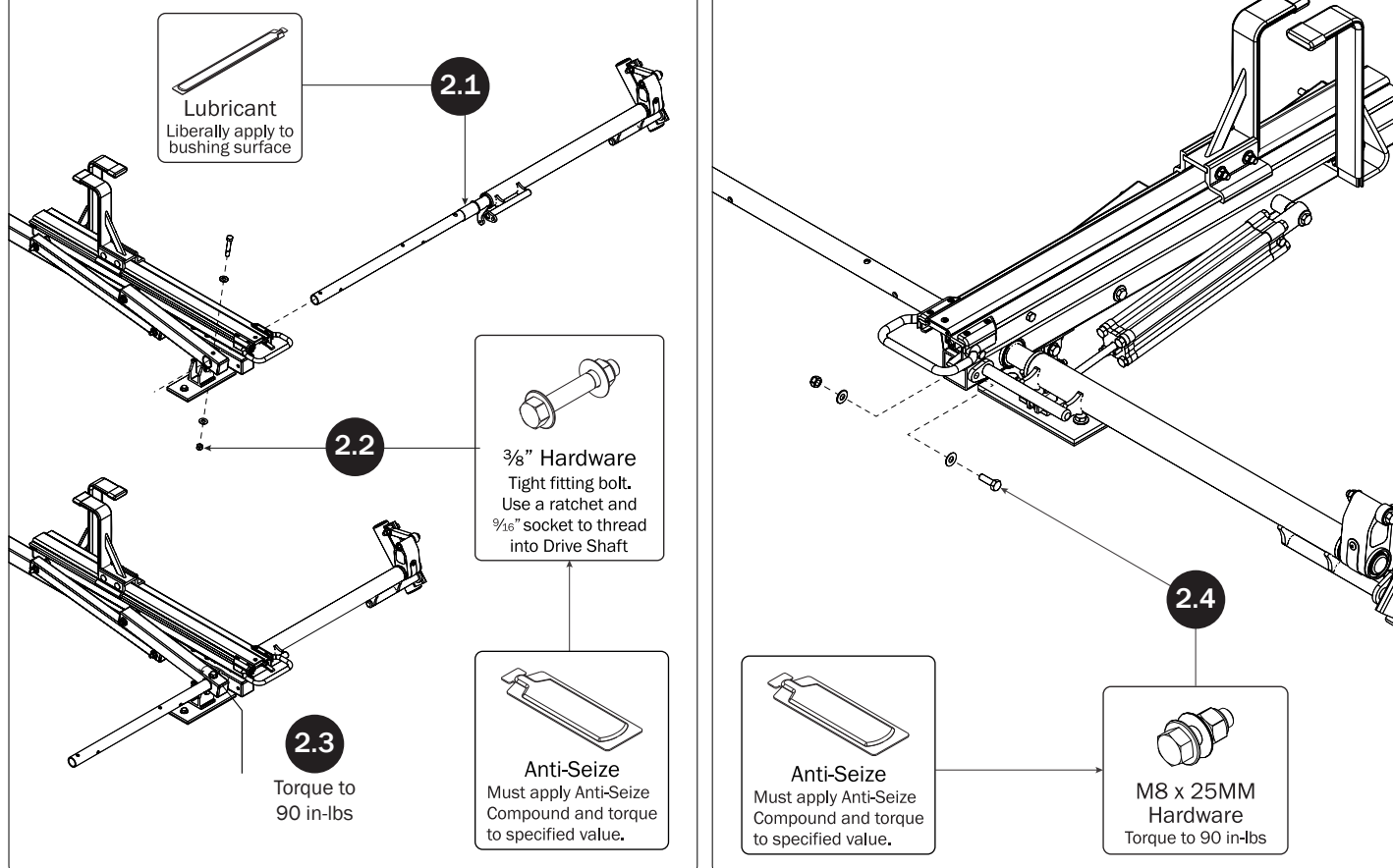

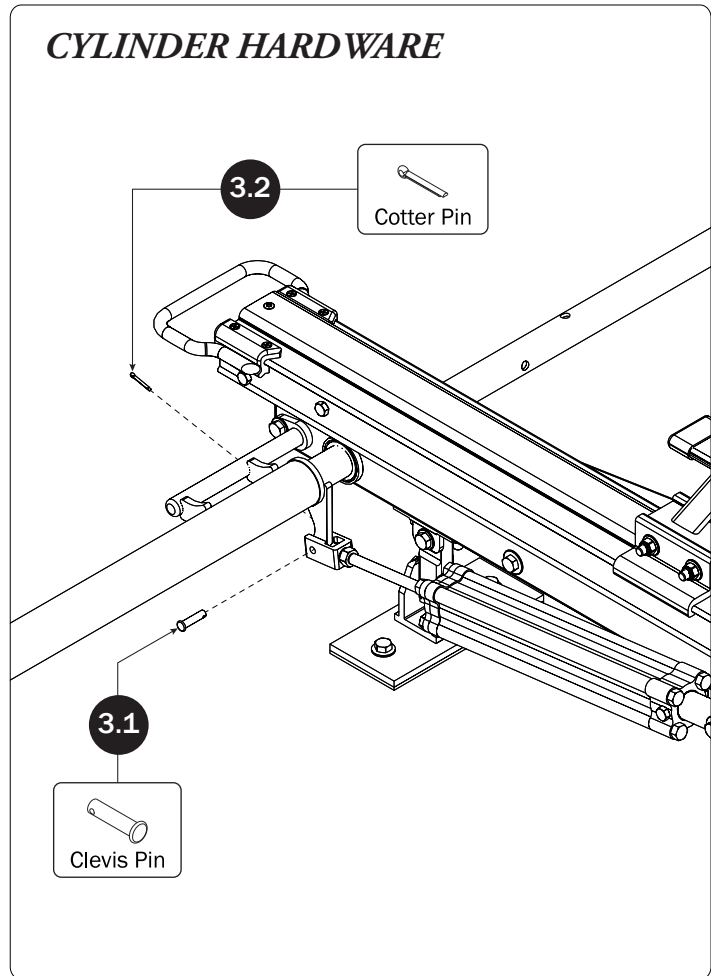
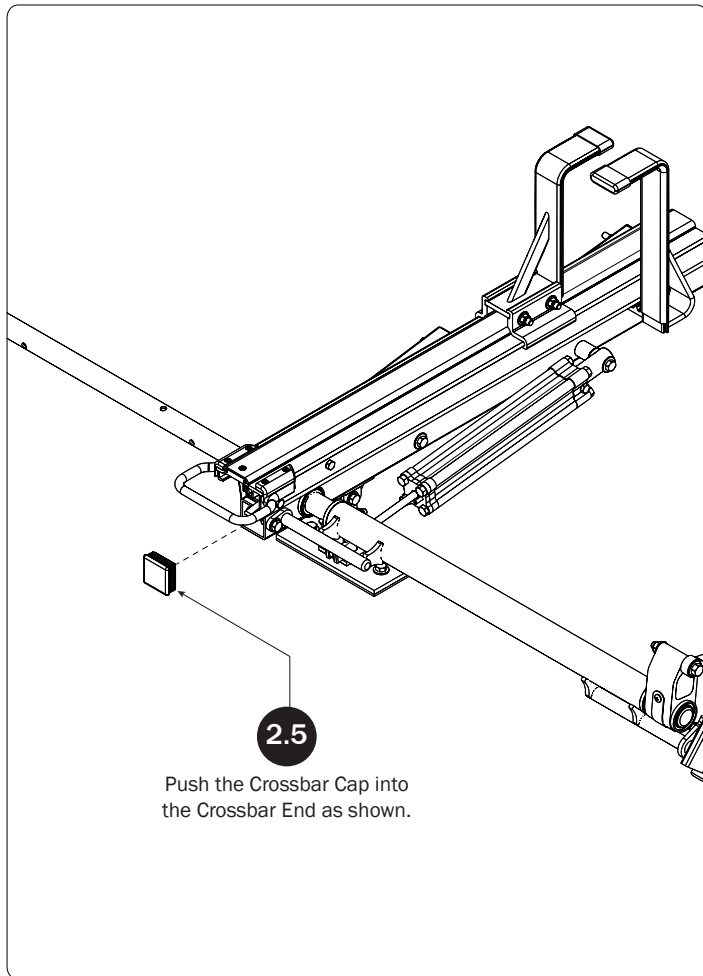
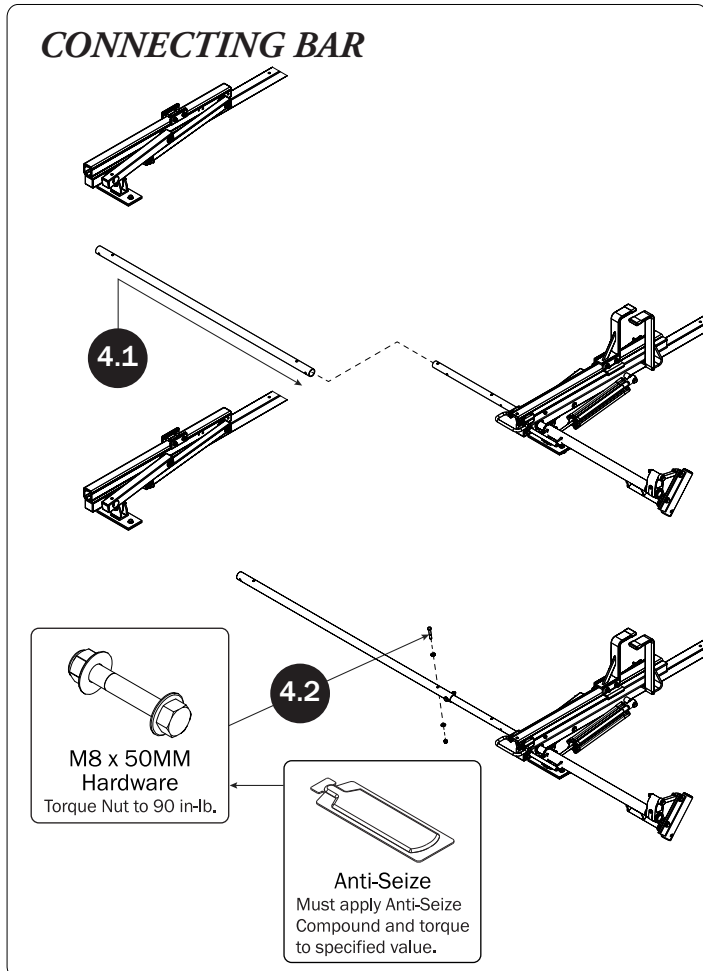
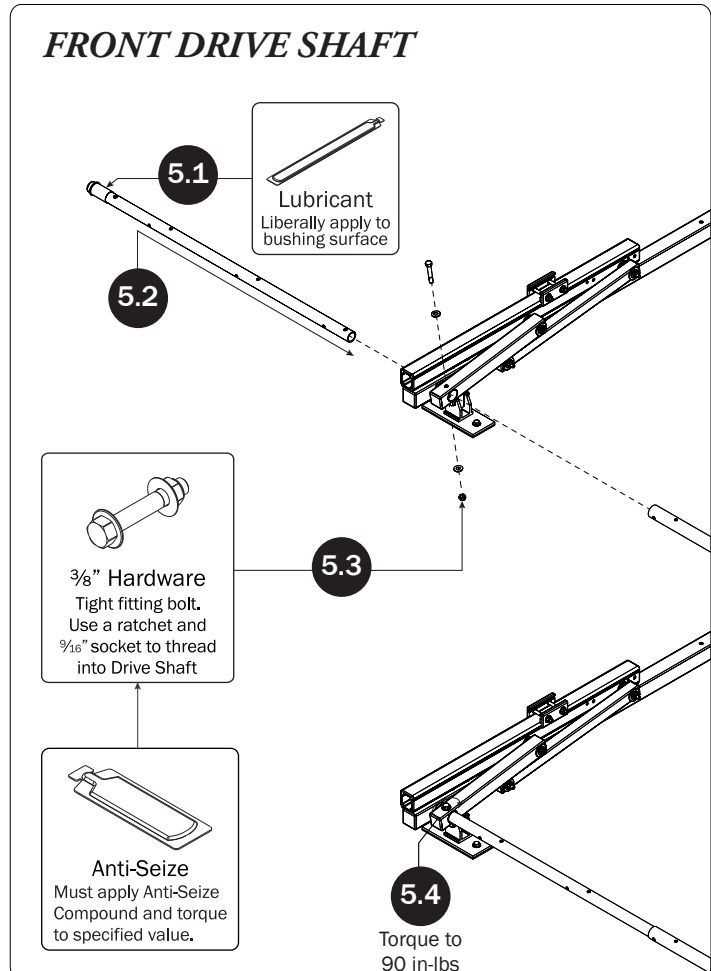
CYLINDER HARDWARE**CONNECTING BAR****FRONT DRIVE SHAFT**

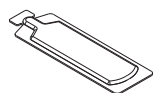
CONNECTING BAR FASTENERS

Anti-Seize
Must apply Anti-Seize
Compound and torque
to specified value.

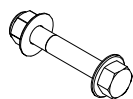

**M8 x 50MM
Hardware**
Torque Nut to 90 in-lb.

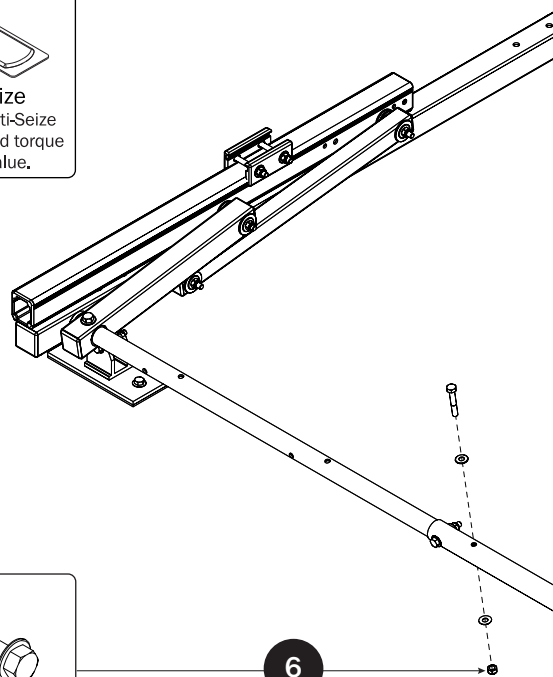

6

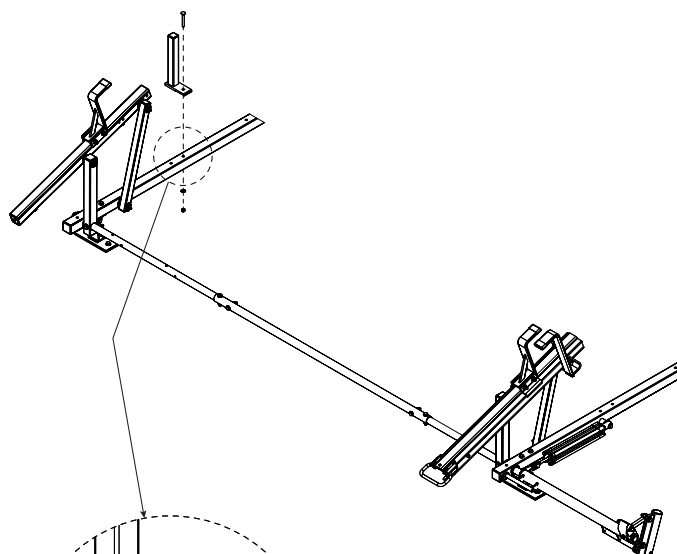
L POST

8

Torque to 90 in-lbs

Z POST

SEE QUICK START GUIDE FOR ADJUSTMENTS

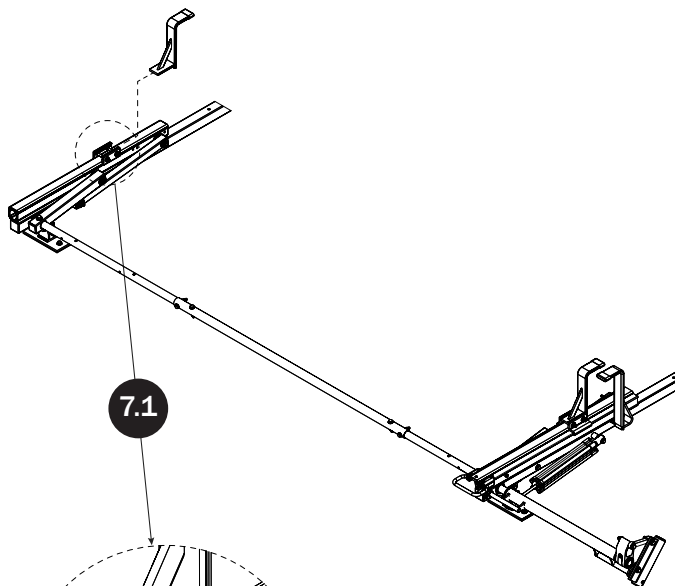

7.1

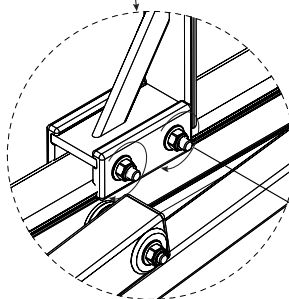

7.2

Torque to 90 in-lbs

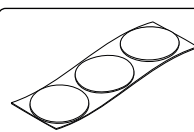
DRIVE SHAFT SEALING

Sealing Stickers

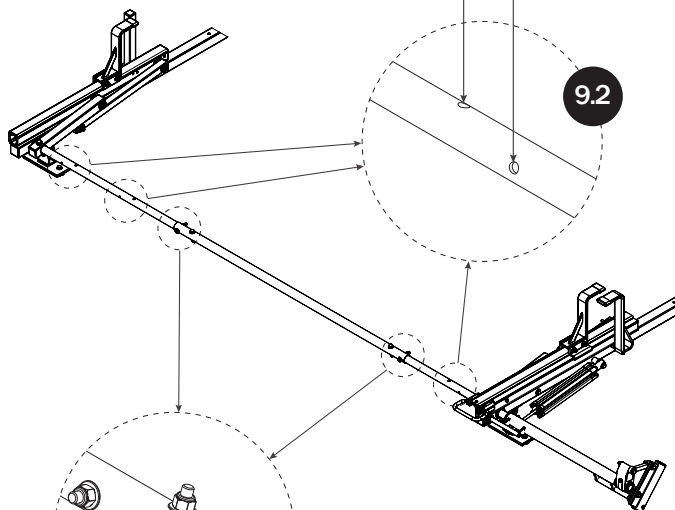

9.2

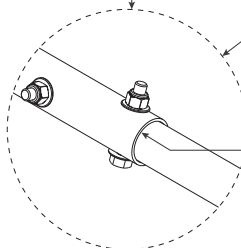

9.1

Apply Silicone Sealant
to Connecting Bar ends

CYLINDER ADJUSTMENT

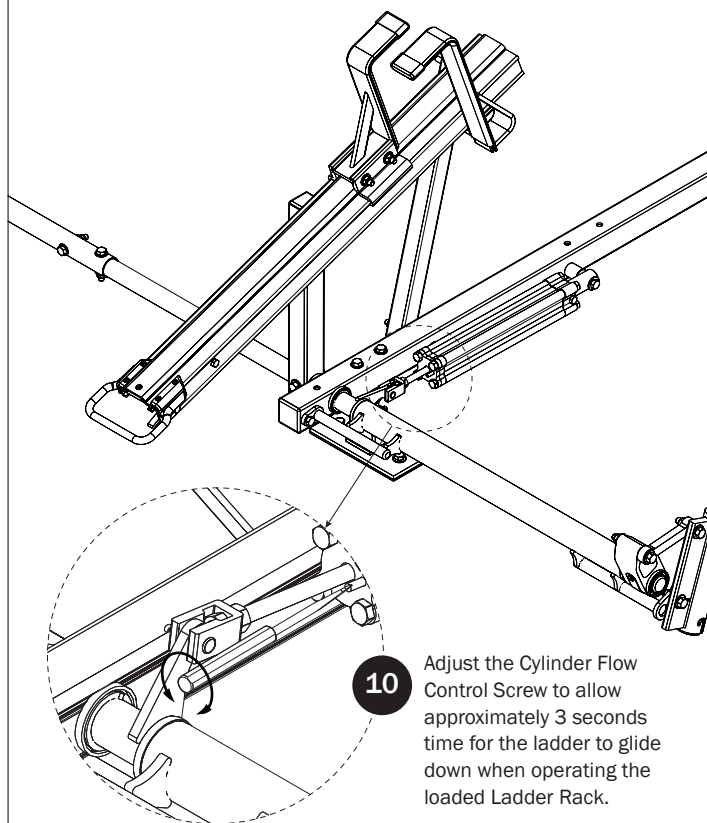

Page Intentionally Left Blank

Page Intentionally Left Blank

