

PRIME DESIGN™

A Safe Fleet Brand

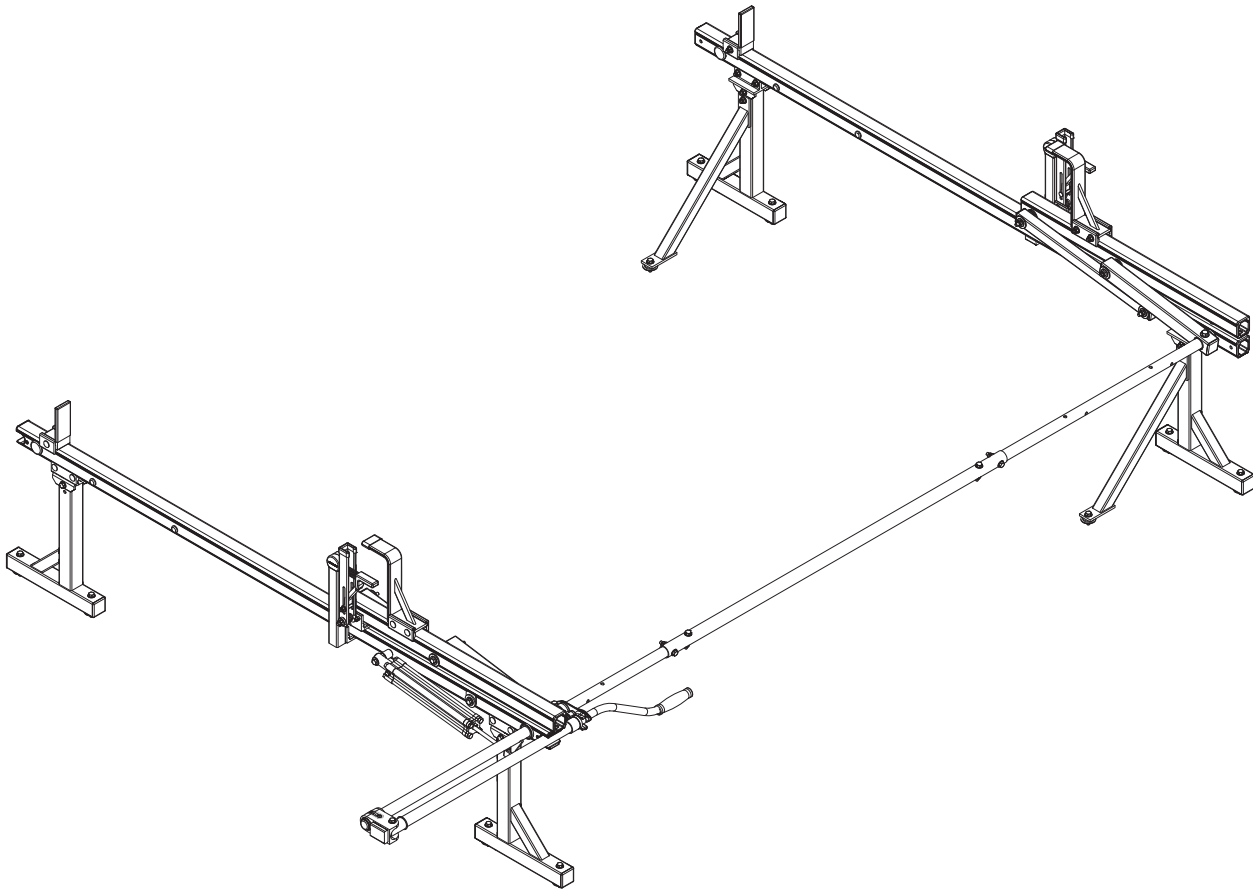

PRIME DESIGN, A SAFE FLEET BRAND

Address: 580 Opperman Drive, Eagan, MN 55123 • Toll Free: 1.8.PRIME.RACK
Fax: 651-552-1799 • Email: info@primedesign.net • Website: www.primedesign.net

PBR 0005

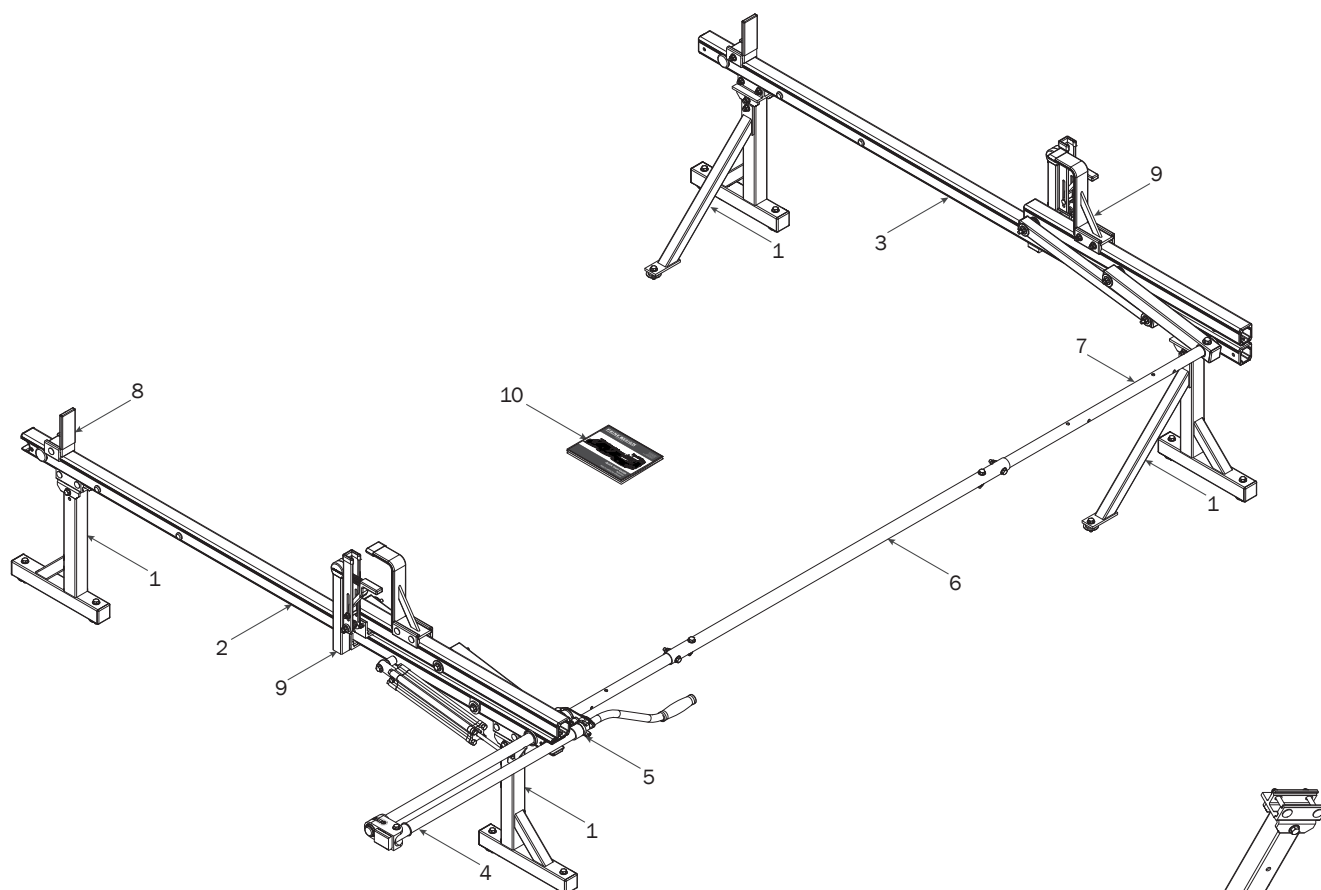

1—FBM-0067 (Qty 1)
Utility Elevated Base Mounting w/hardware

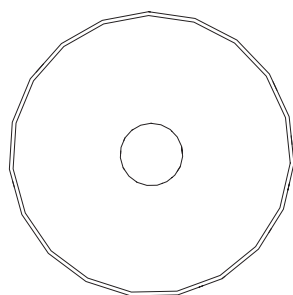

Fender Washer (10X)

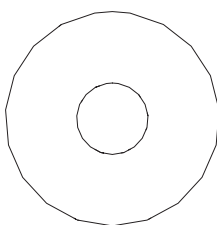

Neoprene Washer (10X)

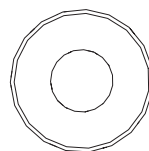

5/16" Flat Washer (14X)

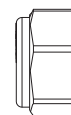

M8 Lock Nut (12X)

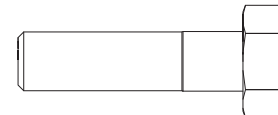

M8 x 30MM (2X)

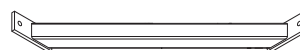

Bracket Braces (2X)

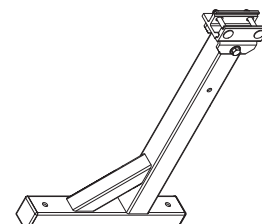

Mounting Brackets (4X)



M8 x 65MM (10X)

2—Rear Crossbar Assembly (Qty 1)

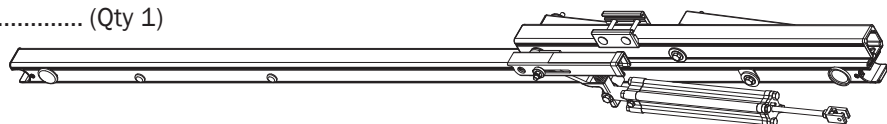

3—Front Crossbar Assembly (Qty 1)

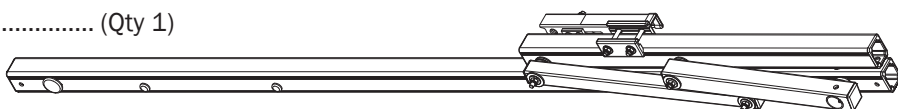

4—Rear Drive Shaft..... (Qty 1)
Right Hand, B4 Version, 46.00"

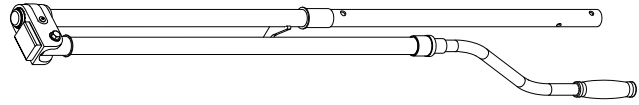

5—Handle Latch Assembly (Qty 1)



6—Connecting Bar..... (Qty 1)
48.00"

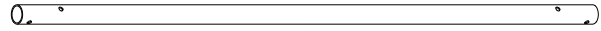

7—Front Drive Shaft (Qty 1)
B Version, 35.75"

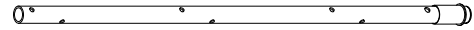

8—Ladder Stop Assembly (Qty 3)
1.75"

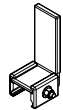

9—L & Z Post Kit..... (Qty 1)
Adj. Z Post, 7.25", L Post, w/HKT-0160



M6 x 20MM (2X)



1/4 Lock Washer (2X)

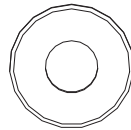

1/4 Flat Washer (2X)

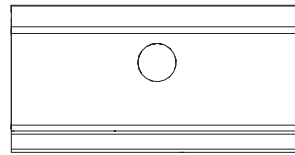

L Post Bracket Clamp (2X)

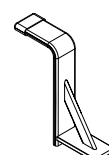

Z Post (2X)

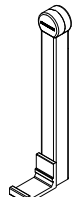

L Post (2X)

10—USQSG-Ergorack (Qty 1)
Quick Start Guide, Rotation



11—HKT-8163 (Not called out in Overview)..... (Qty 1)



Clevis Pin (1X)

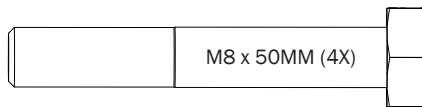

M8 x 50MM (4X)

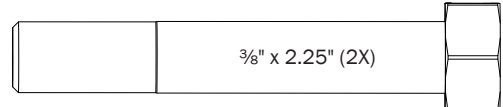

3/8" x 2.25" (2X)



Cotter Pin (1X)

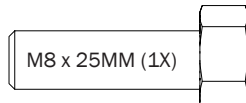

M8 x 25MM (1X)



M8 Lock Nut (5X)

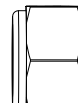

3/8" Lock Nut (2X)

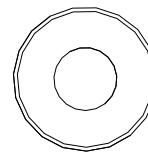

5/16" Flat Washer (10X)

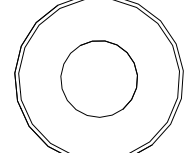

3/8" Flat Washer (4X)

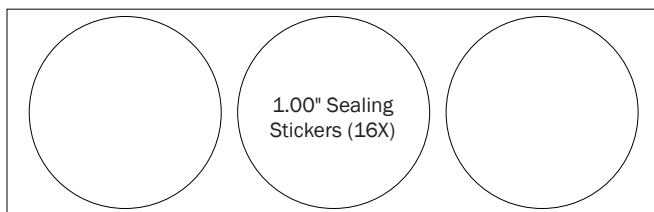

1.00" Sealing
Stickers (16X)



Anti-Seize (1X)

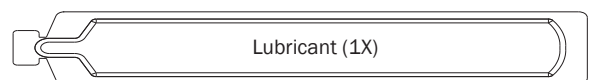

Lubricant (1X)

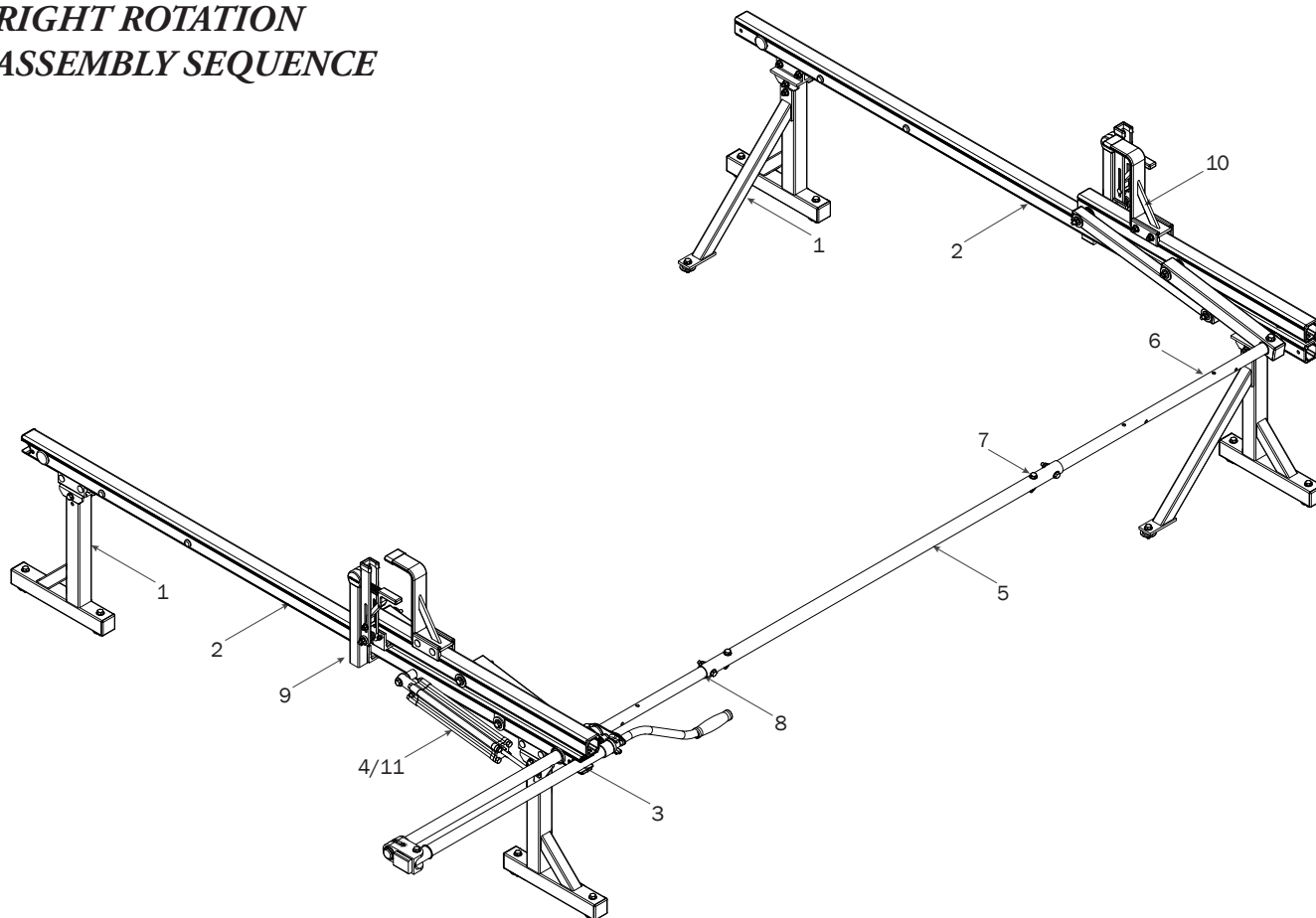
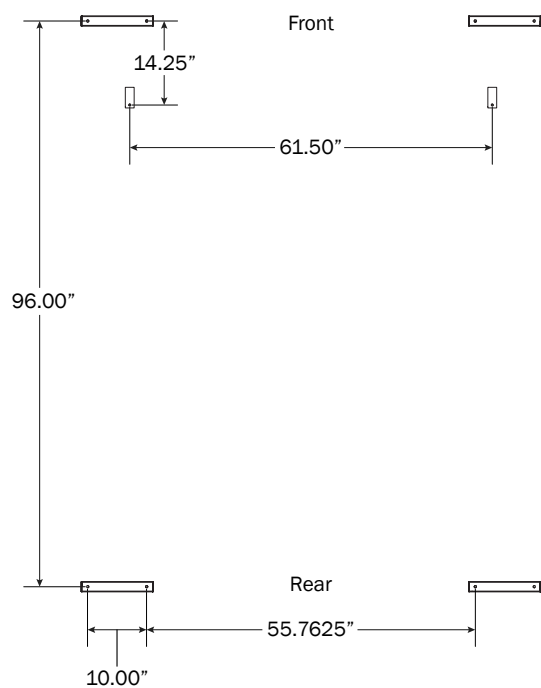
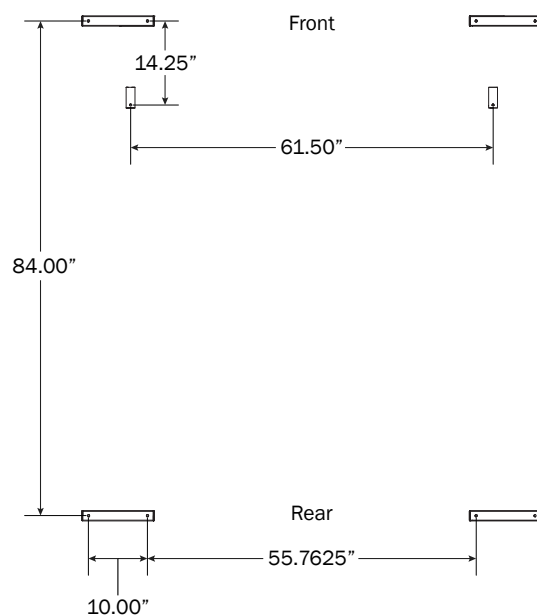
**RIGHT ROTATION
ASSEMBLY SEQUENCE****FBM-0031****8' (96") CONFIGURATION****7' (84") CONFIGURATION**

6' (72") CONFIGURATION

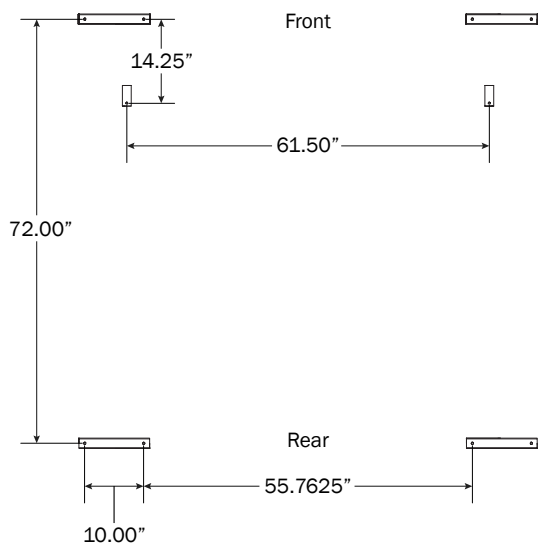

- 1.1** Attach Brace using supplied hardware. Do not tighten until Step 1.3

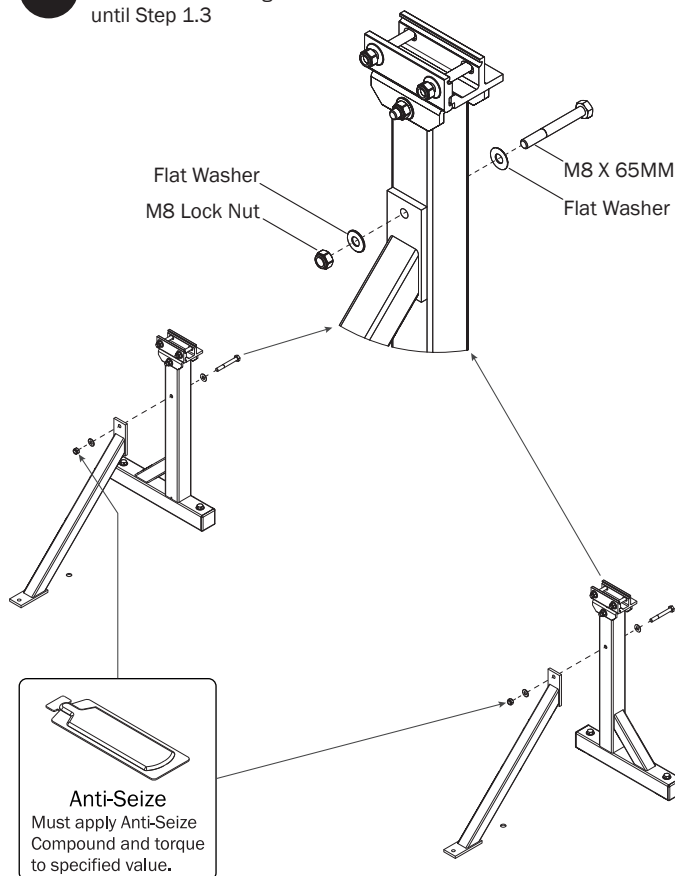

- 1.2** Apply Anti-Seize to Mounting Bolts and complete installation of mounting system.

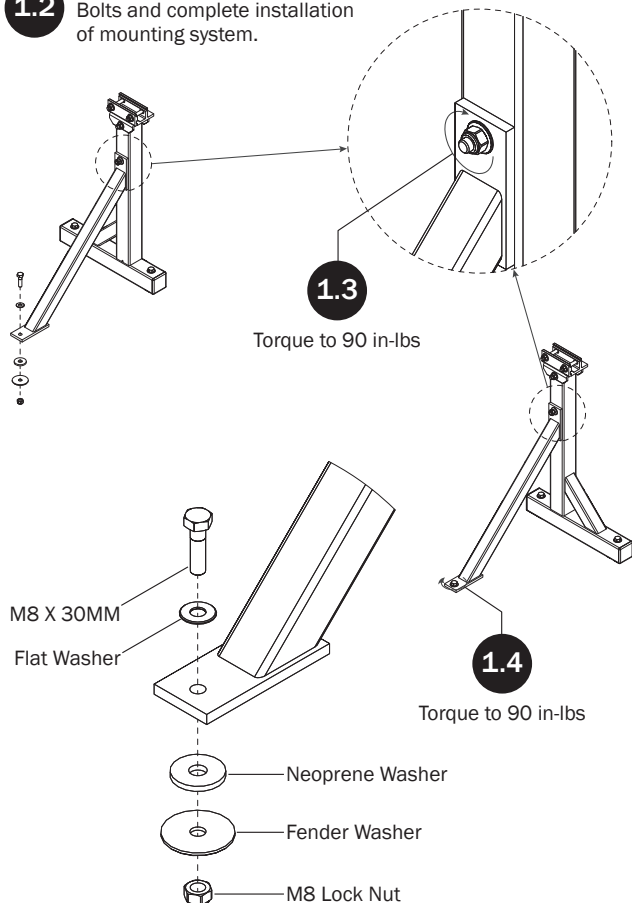

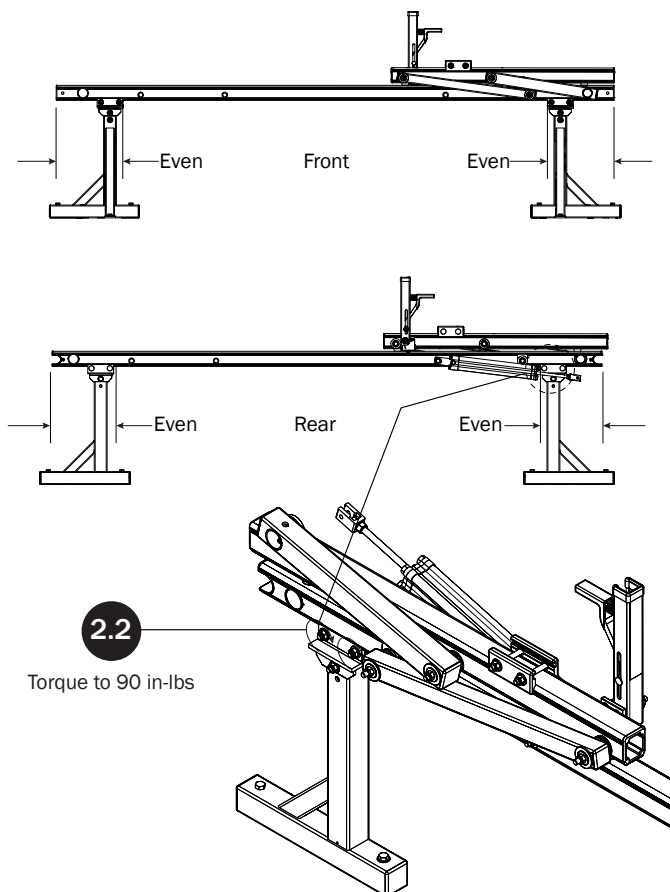
CROSSBARS**CROSSBAR ADJUSTMENT****REAR DRIVE SHAFT**

NOTE: For instructional clarity, the FBM Mounting System will not be shown for the remainder of this Assembly Manual.

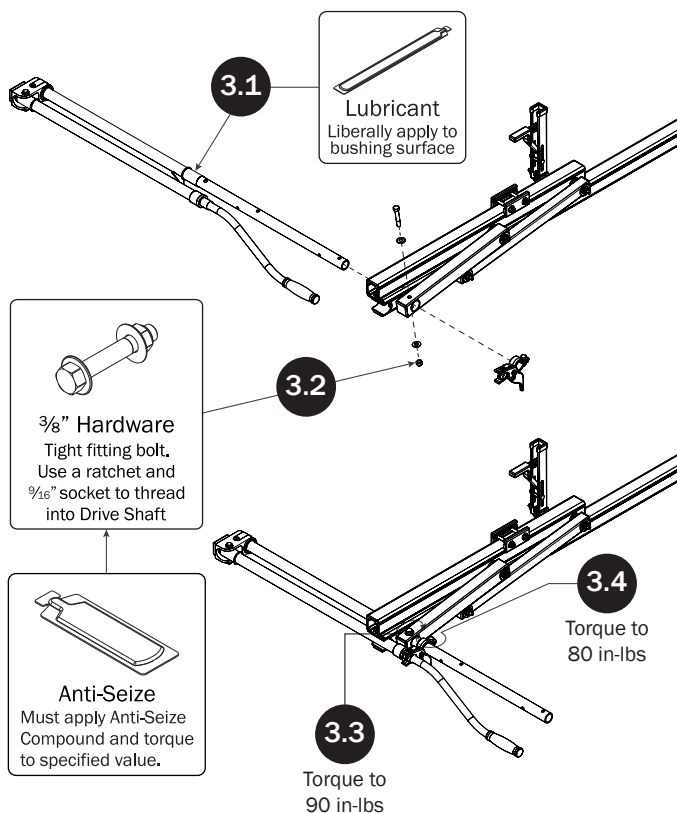
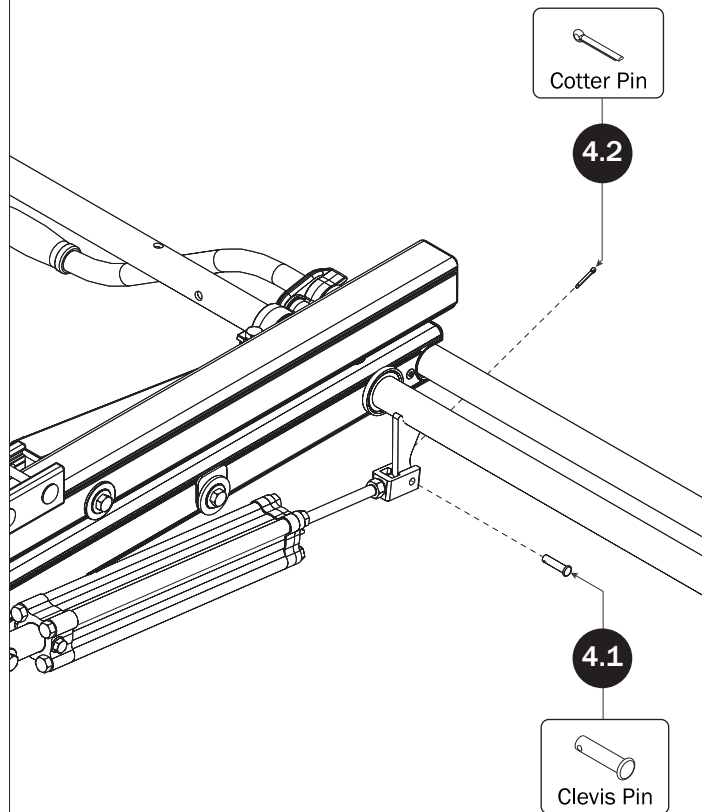
**CYLINDER HARDWARE**

CONNECTING BAR

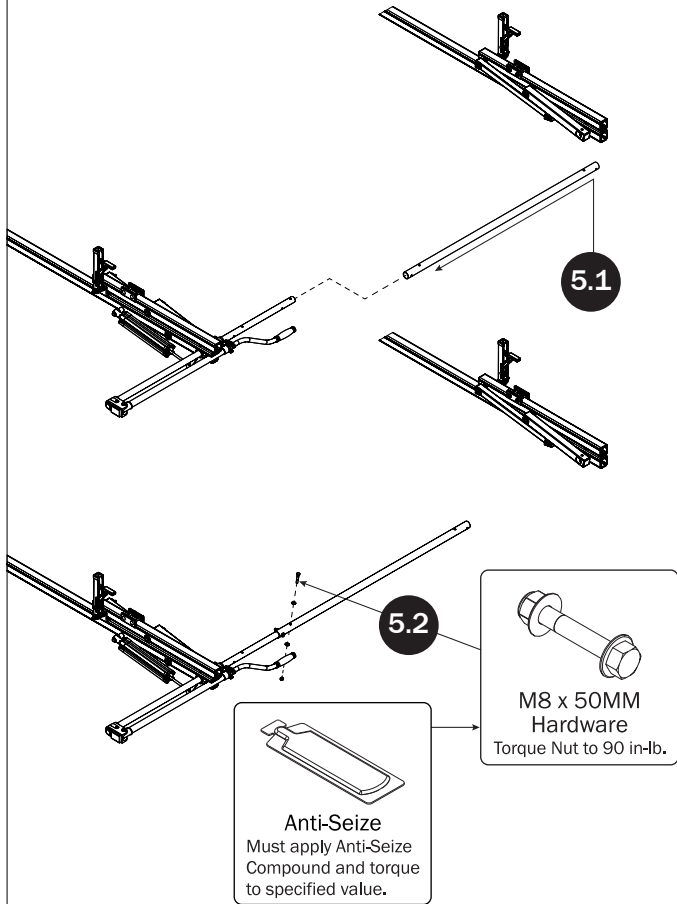

FRONT DRIVE SHAFT

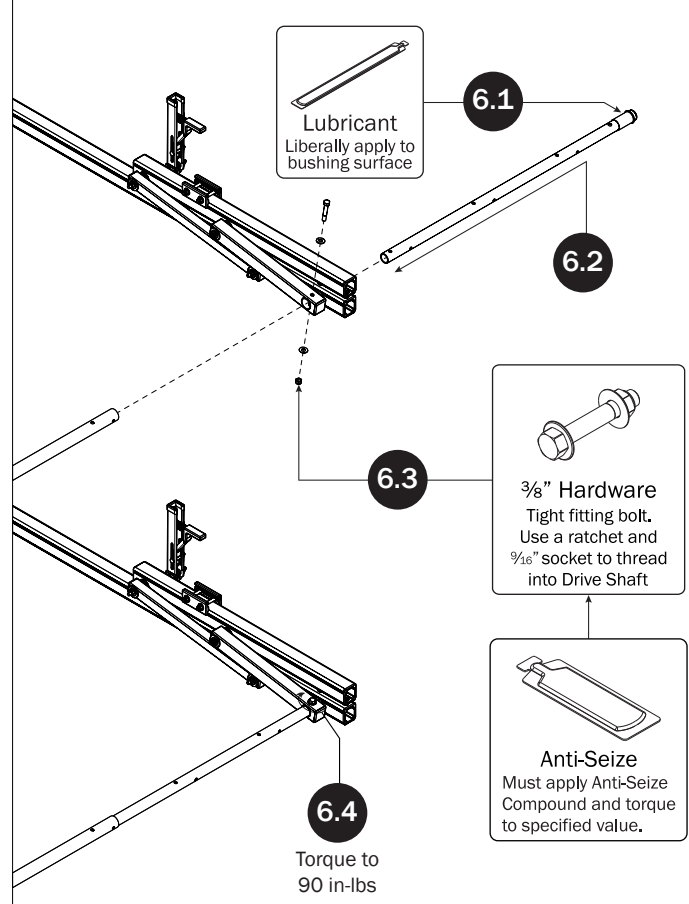

CONNECTING BAR FASTENERS

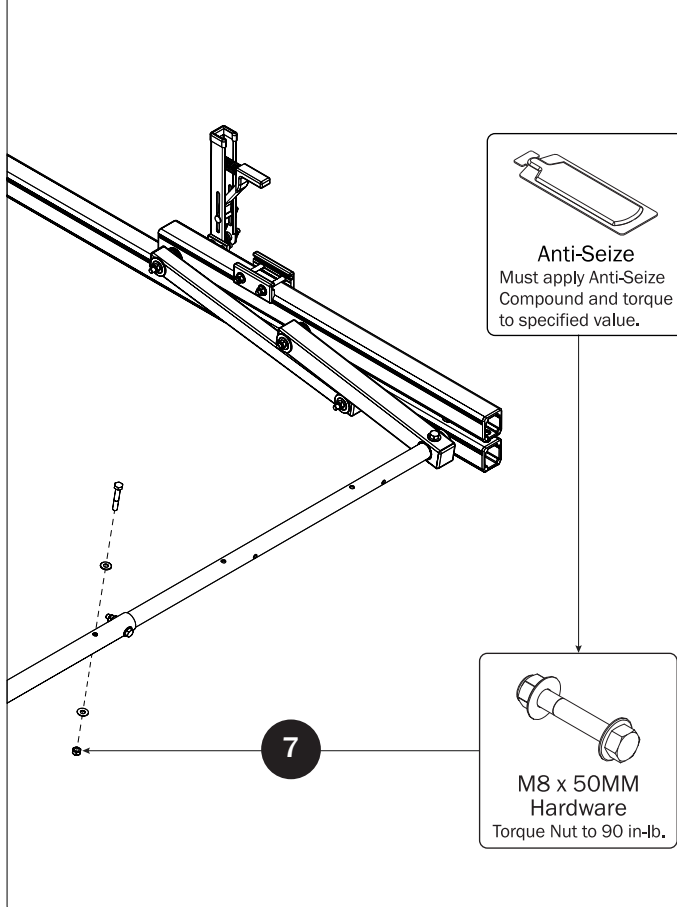

DRIVE SHAFT SEALING

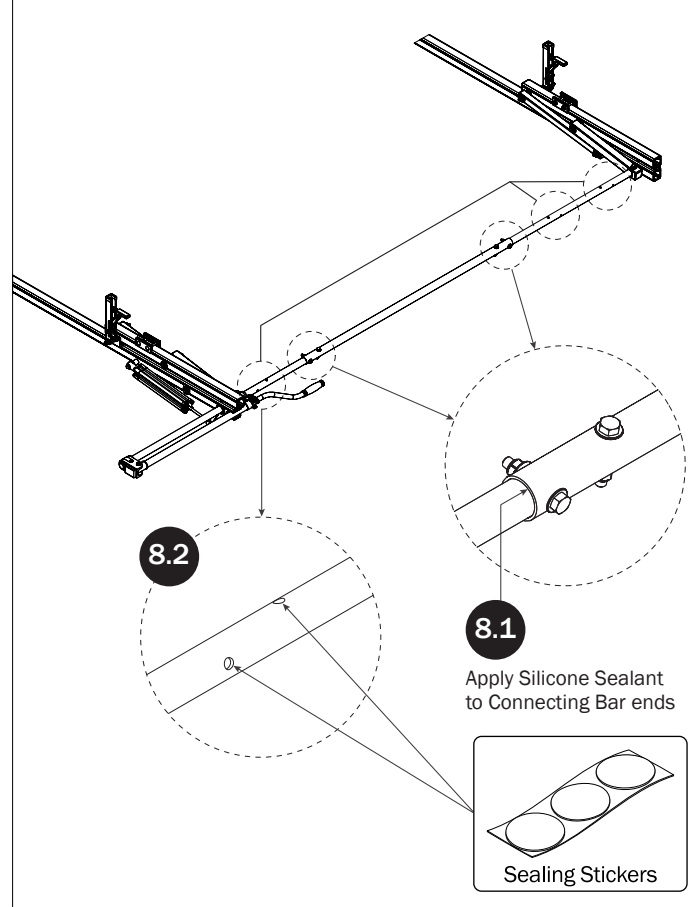

L POSTS**SEE QUICK START GUIDE FOR ADJUSTMENTS**

NOTE: The Auto Clamps may come preset from the factory for packaging purposes only. To assemble the L Posts to the Crossbars, the Auto Clamps may need to be repositioned.

Ensure the Auto Clamp Spring is seated into the spring catch

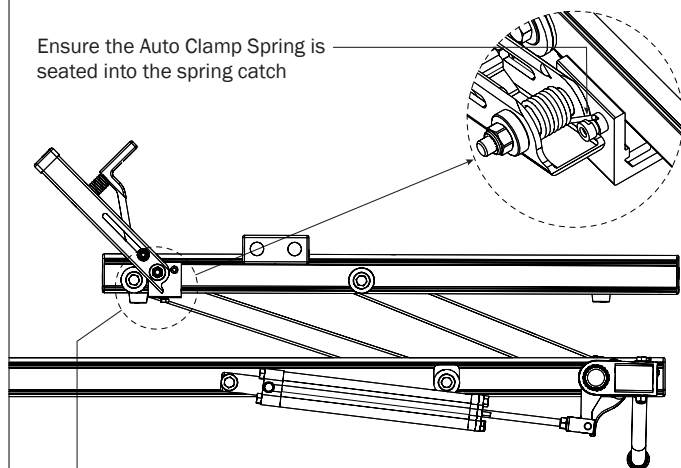

9.1 Beginning with the Rear Crossbar, loosen the bolt at the bottom of the Auto Clamp, then slide the Auto Clamp toward the inside end of the Rotation Upper. Reposition the Auto Clamp leaving a minimum of 1/4" distance from the rubber bumper to the edge of the Auto Clamp Bracket as shown, then finger-tighten if adjusting later, or torque to 80 in-lbs.

9.4

Slide L Post Bracket Clamp into bottom groove, then slide into L Post Bracket as shown

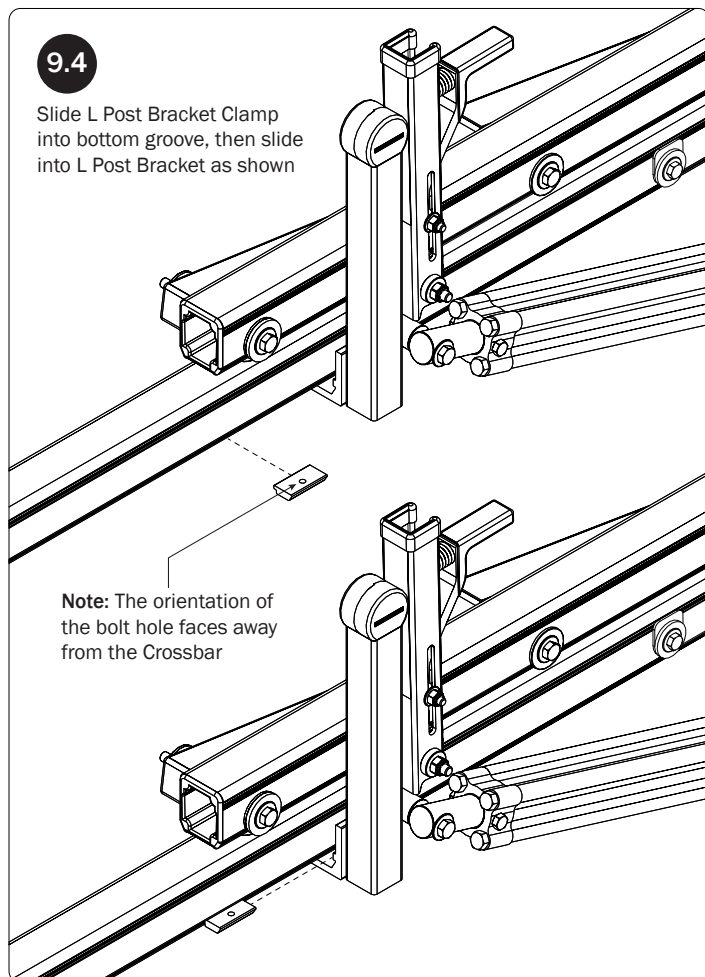

Note: The orientation of the bolt hole faces away from the Crossbar

9.2

Prepare the L Post by removing the hex head bolt, lock washer, flat washer, and Bracket Clamp. Retain for installation Steps 10.4–10.8.

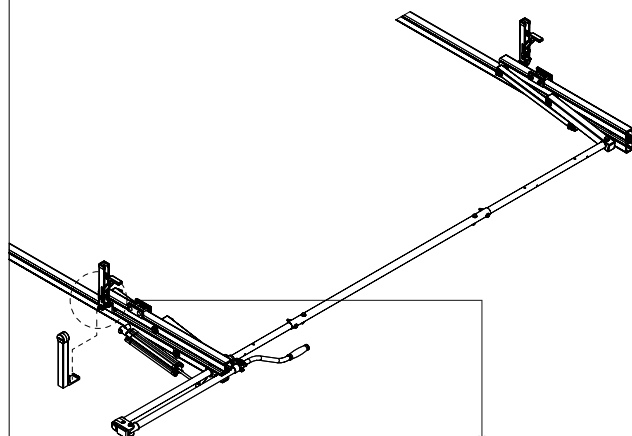

9.3

Place the L Post into the bottom groove of the Rear Crossbar, ensuring the L Post seats into the Crossbar's inside bottom groove as seen from the front of the Rear Crossbar

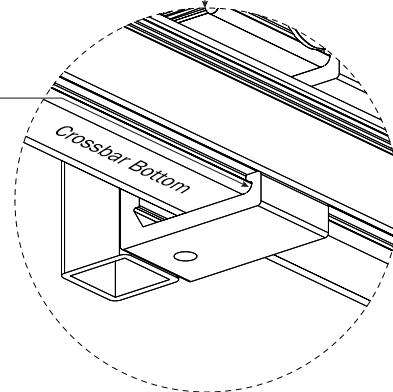

9.5

Bracket Clamp sits in L Post Bracket as shown

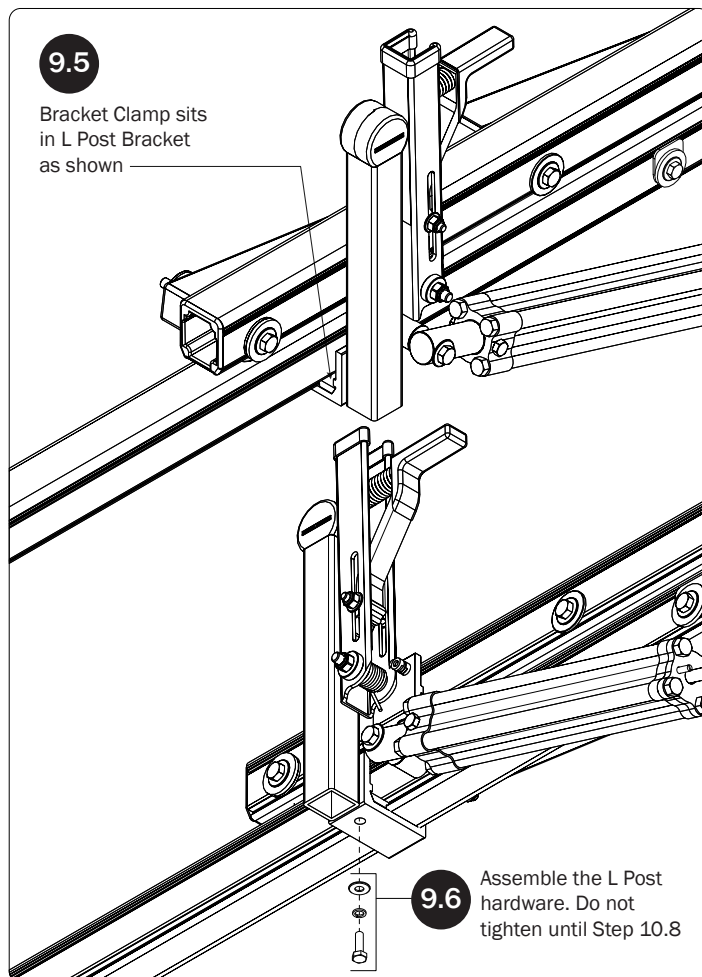

9.6

Assemble the L Post hardware. Do not tighten until Step 10.8

9.7

Slide the L Post until parallel to the Auto Clamp and the gap between the two is even from top to bottom

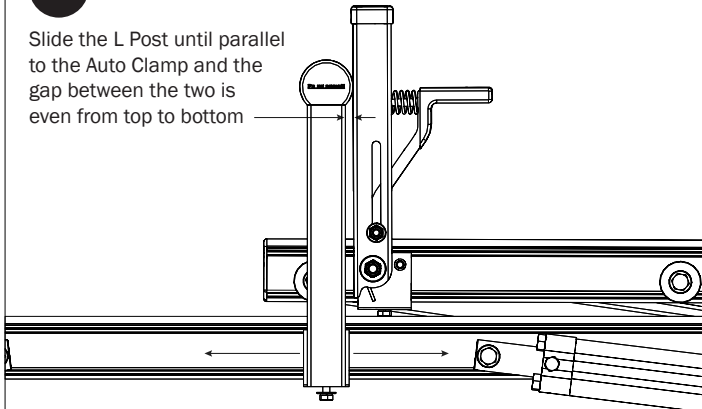

Torque to 80 in-lbs

9.8

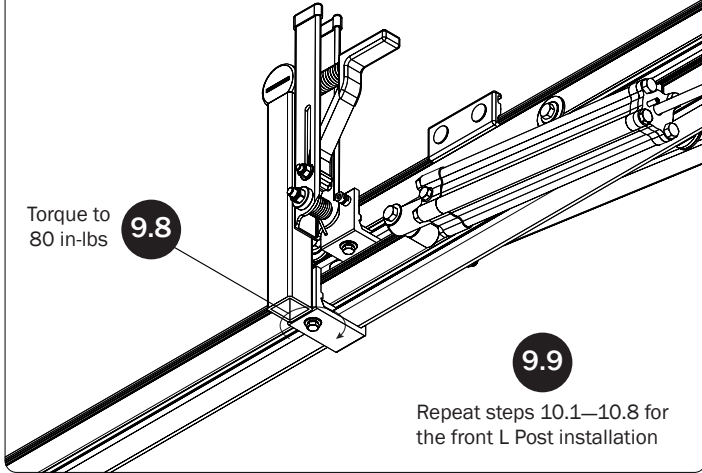

9.9

Repeat steps 10.1–10.8 for the front L Post installation

10.2

Refer to the Quick Start Guide for Z Post positioning.

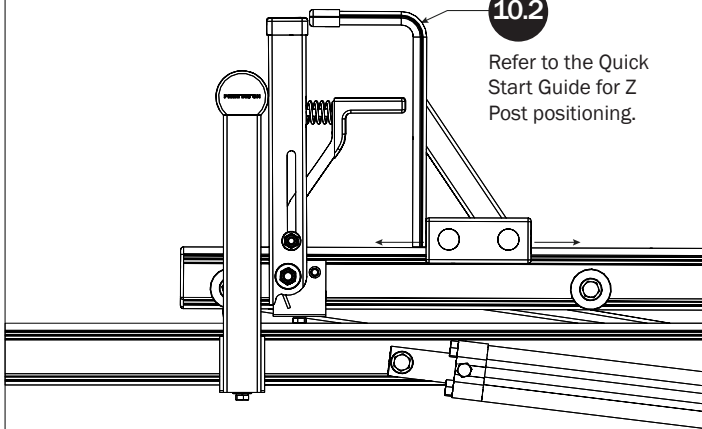

10.3

Torque to 90 in-lbs

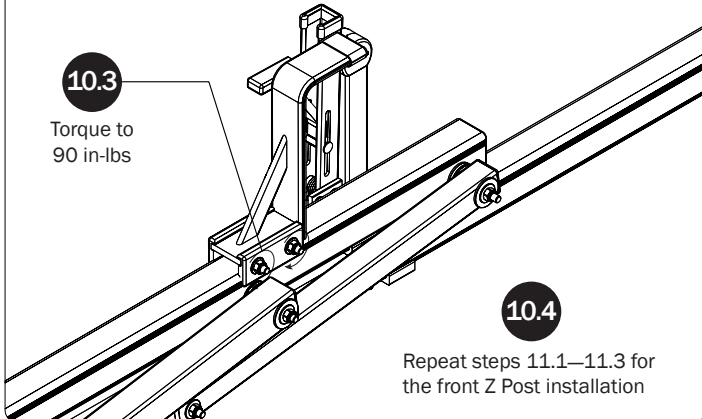

10.4

Repeat steps 11.1–11.3 for the front Z Post installation

Z POSTS

SEE QUICK START GUIDE FOR ADJUSTMENTS

10.1

Slide the Z Post into the Mounting Clamp Assembly

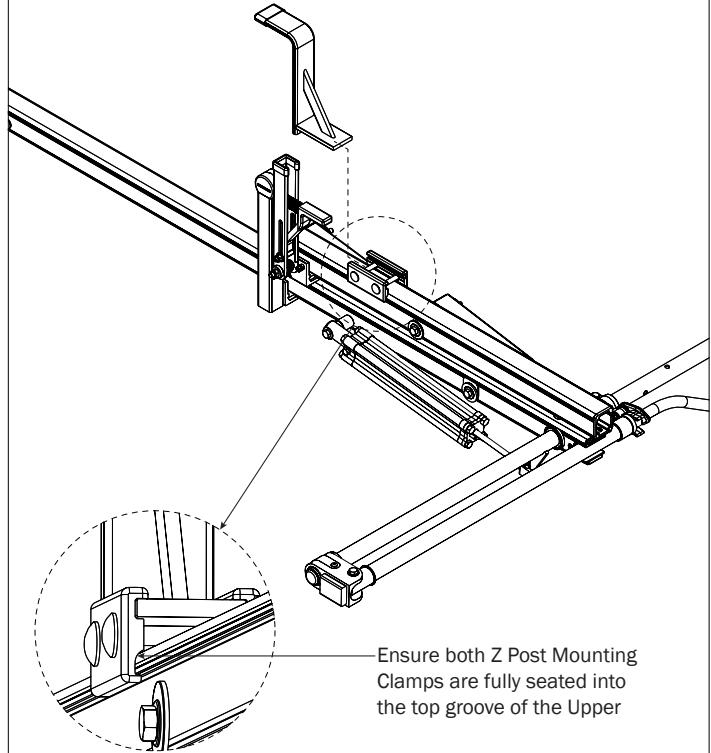

Ensure both Z Post Mounting Clamps are fully seated into the top groove of the Upper

CYLINDER ADJUSTMENT

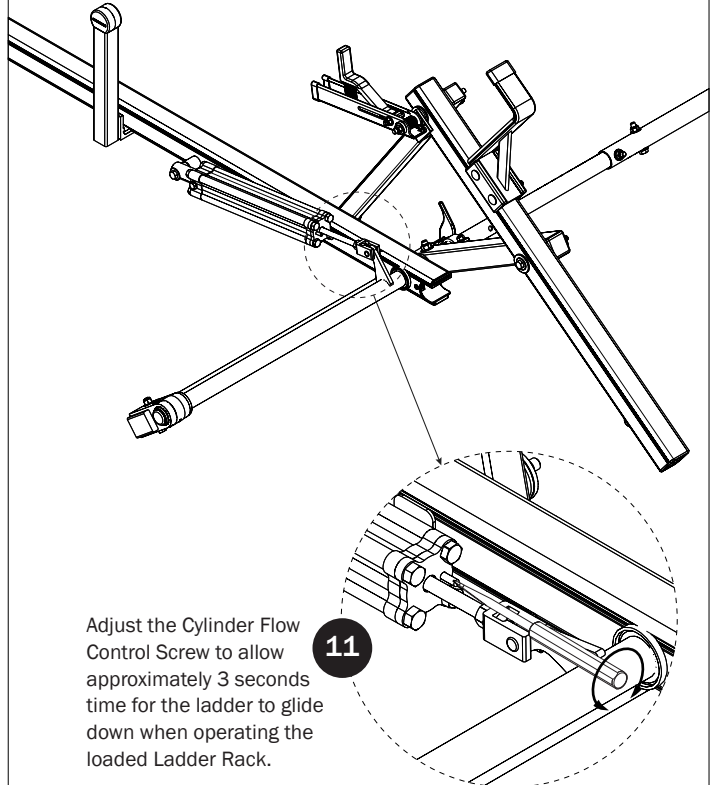

Adjust the Cylinder Flow Control Screw to allow approximately 3 seconds time for the ladder to glide down when operating the loaded Ladder Rack.

11

LEFT SIDE ASSEMBLY SEQUENCE

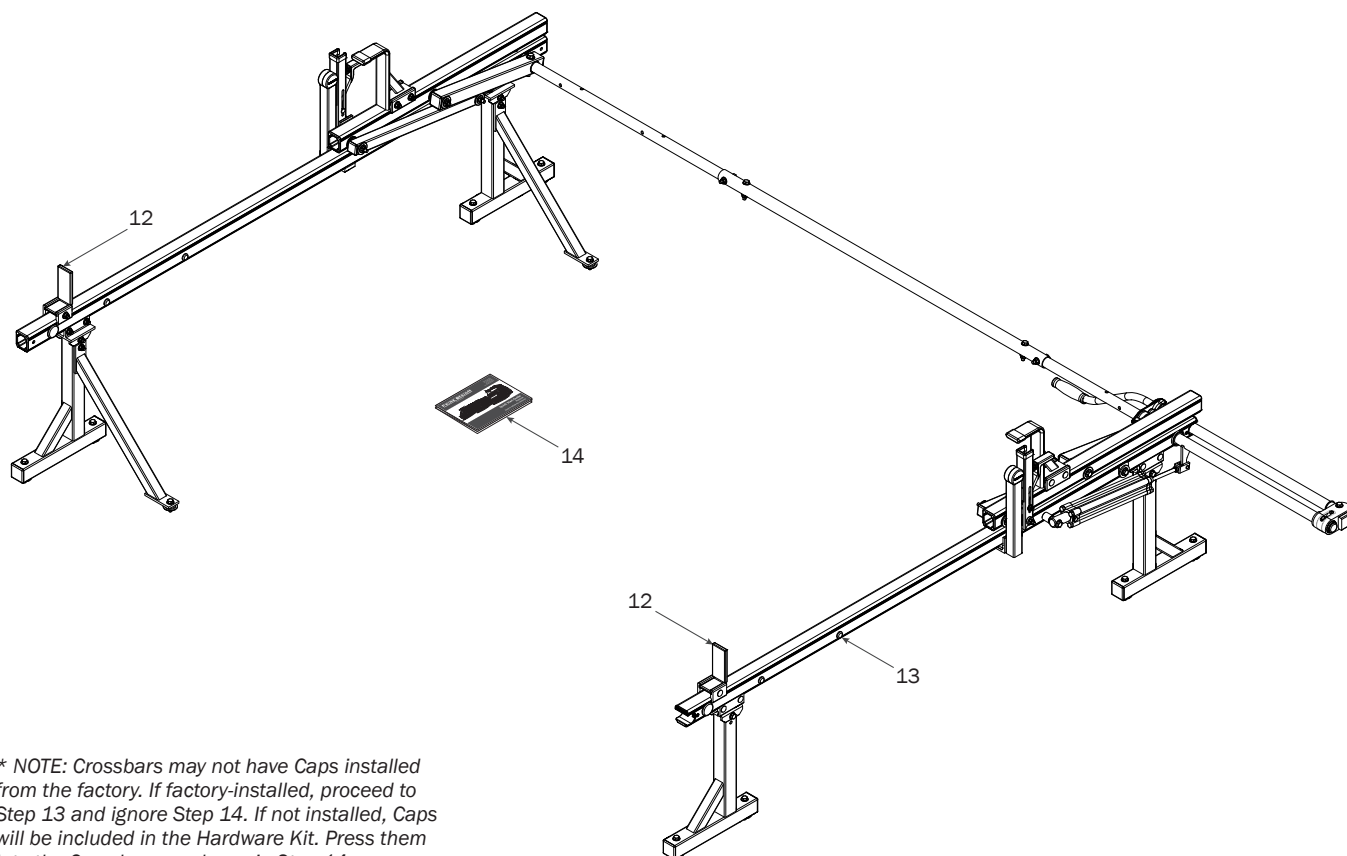

LADDER STOPS

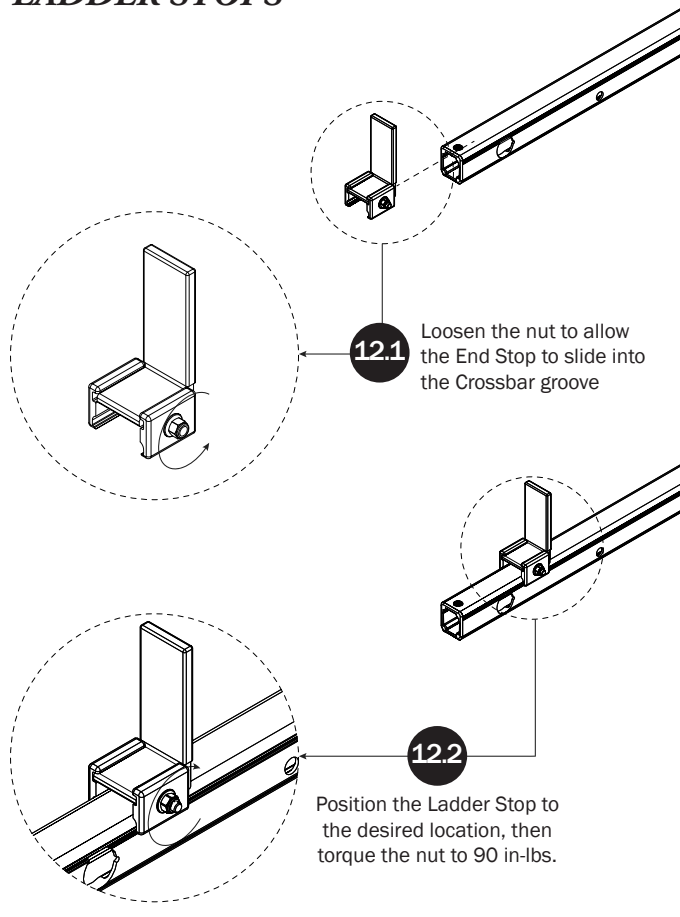

CROSSBAR CAPS

NOTE: Some Front Crossbars may have additional drilled holes. Press Crossbar Caps into Crossbar holes if present and unused.

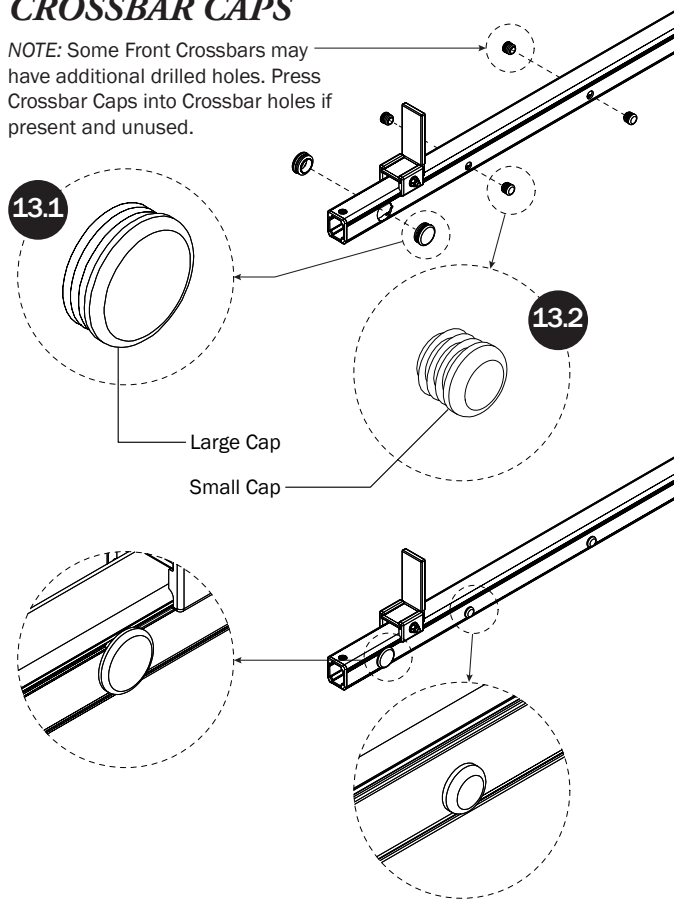

QUICK START GUIDE

- 14** Place the Quick Start Guide into the vehicle's glove box for ladder setup and adjustment.

