

PRIME DESIGN™

A Safe Fleet Brand

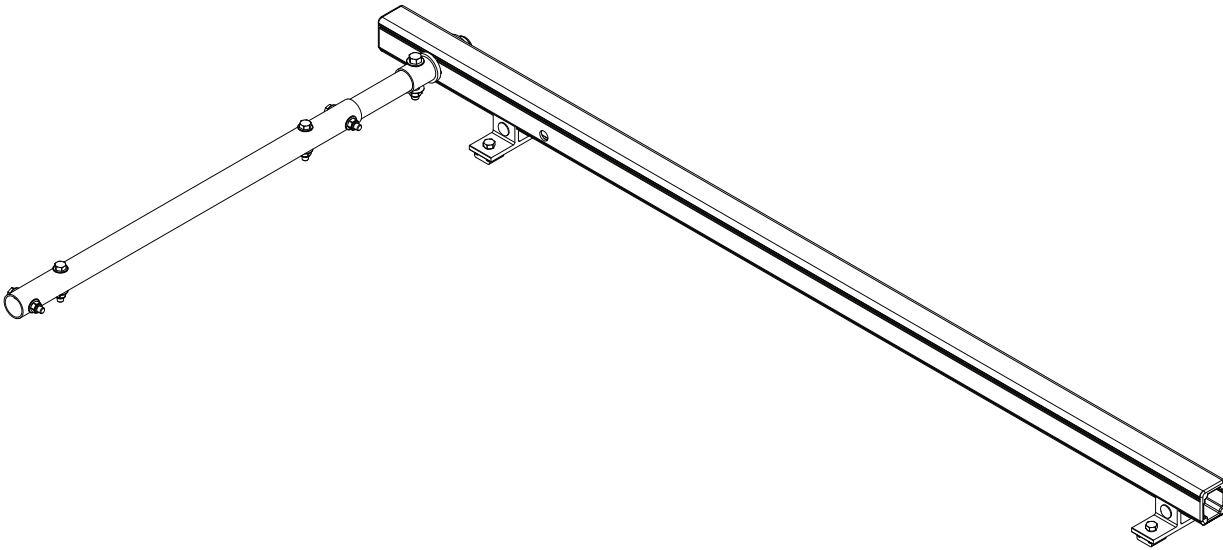

CBR

PRIME DESIGN, A SAFE FLEET BRAND

Address: 580 Opperman Drive, Eagan, MN 55123 • Toll Free: 1.8.PRIME.RACK
Fax: 651-552-1799 • Email: info@primedesign.net • Website: www.primedesign.net

CONTENTS OVERVIEW

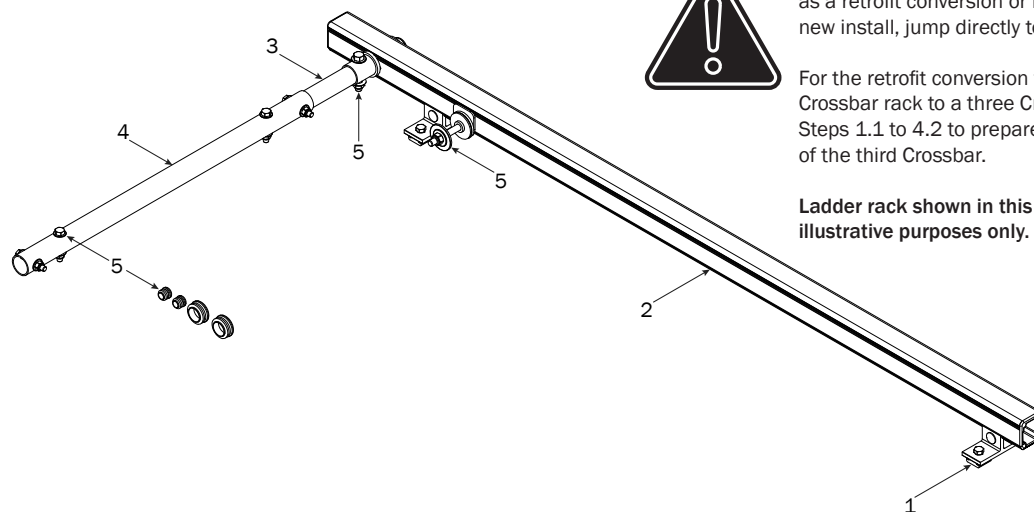

Note: This modular Crossbar kit can be installed as a retrofit conversion or new install. If this is a new install, jump directly to Step 5.1.

For the retrofit conversion from a completed two Crossbar rack to a three Crossbar rack: perform Steps 1.1 to 4.2 to prepare rack for the addition of the third Crossbar.

Ladder rack shown in this manual is for illustrative purposes only.

1—Mounting Brackets..... (Qty 2)



2—Crossbar..... (Qty 1)
57.00"

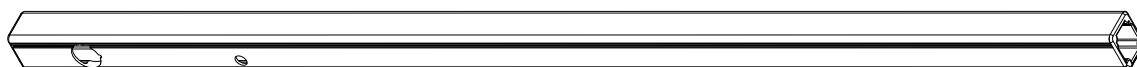

3—Front Drive Shaft (Qty 1)
11.75"



4—Connecting Bar..... (Qty 1)
24.00"

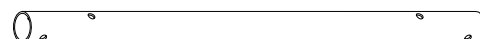

5—HKT-8407 (Qty 1)
Rotation Hardware Kit

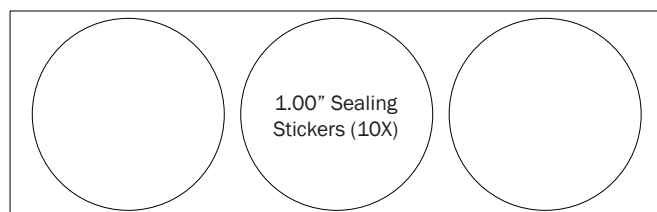
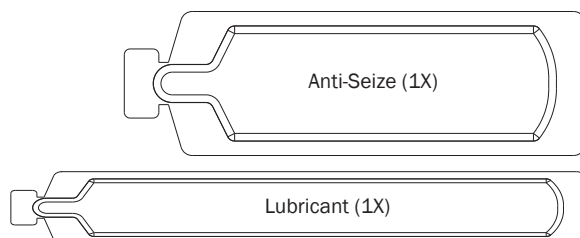
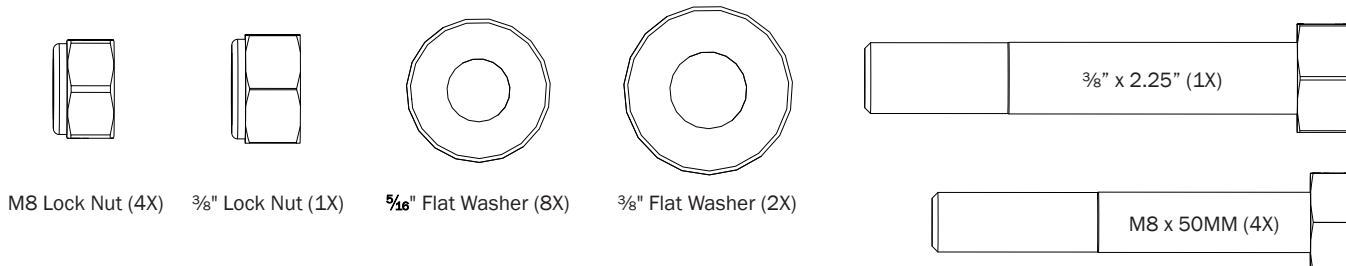
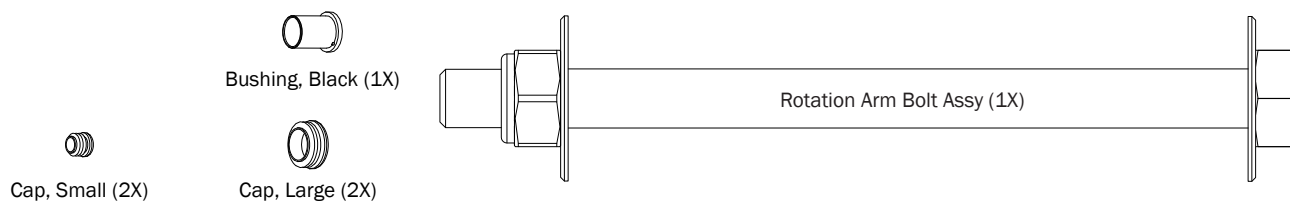

LEFT ROTATION RETROFIT
CONVERSION SEQUENCE

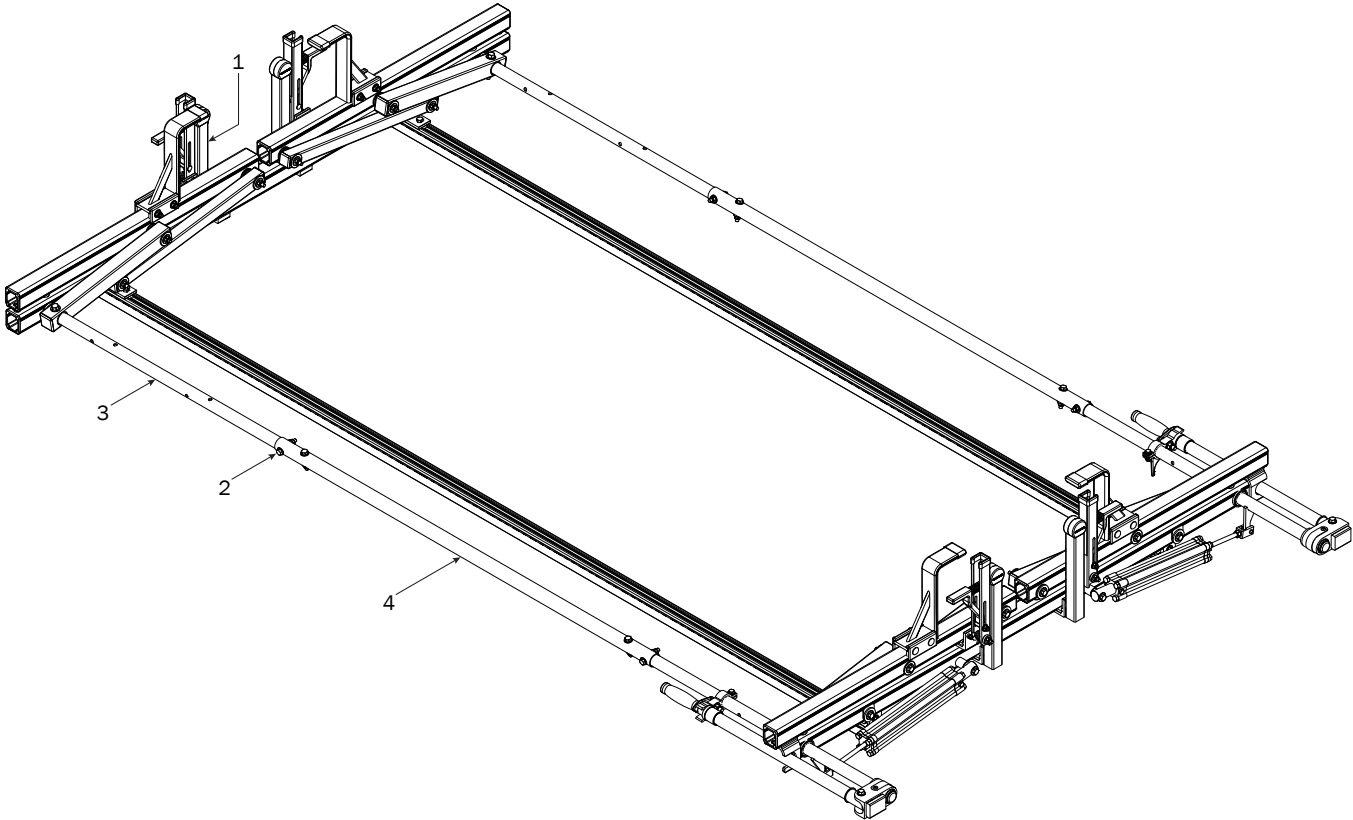

L POST

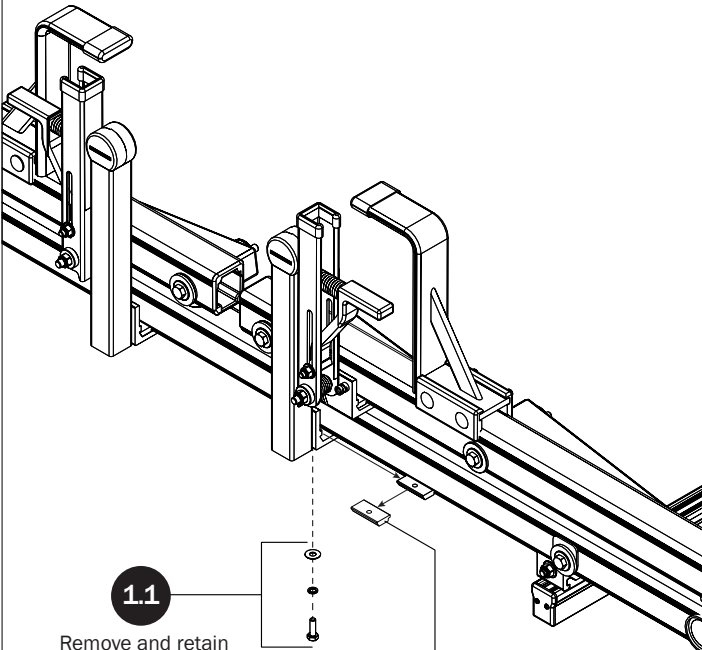

1.3 Remove and retain for Step 11.1

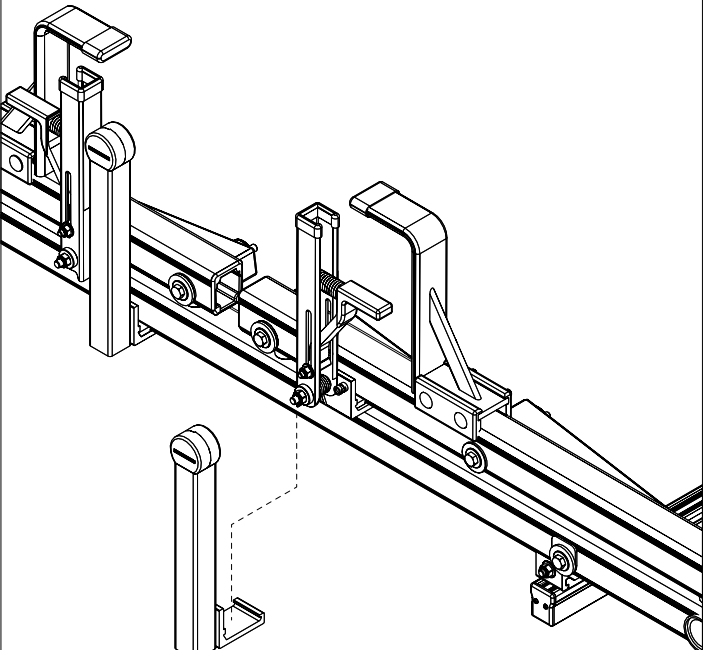

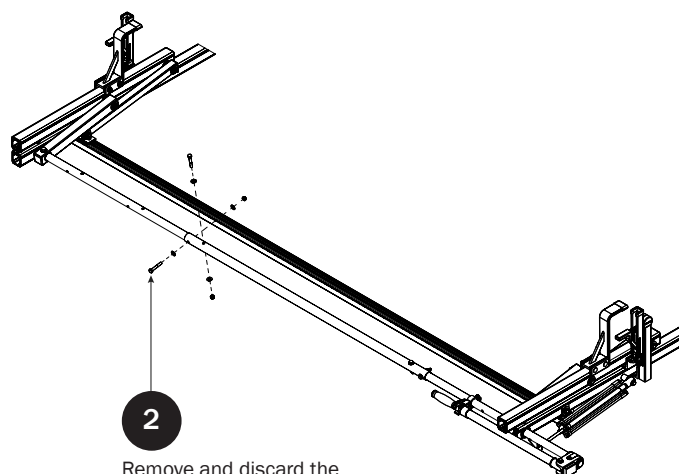
FRONT DRIVE SHAFT

Remove and discard the Connecting Bar hardware.

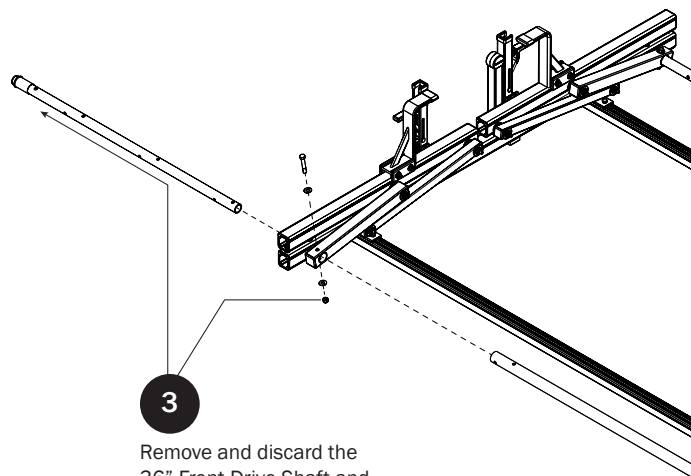

Remove and discard the 36" Front Drive Shaft and Drive Arm hardware.

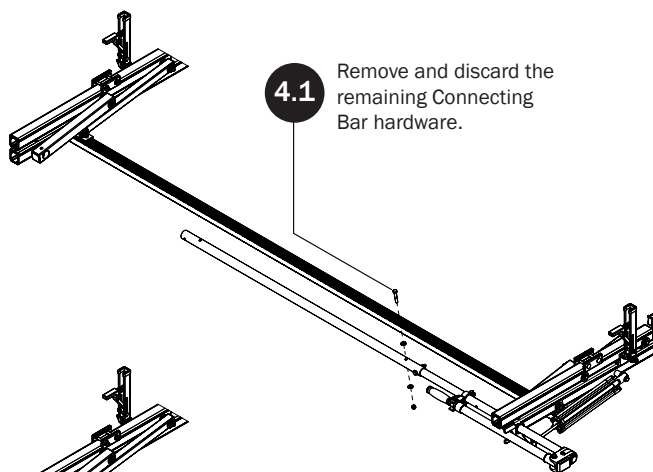
CONNECTING BAR

Remove and discard the remaining Connecting Bar hardware.

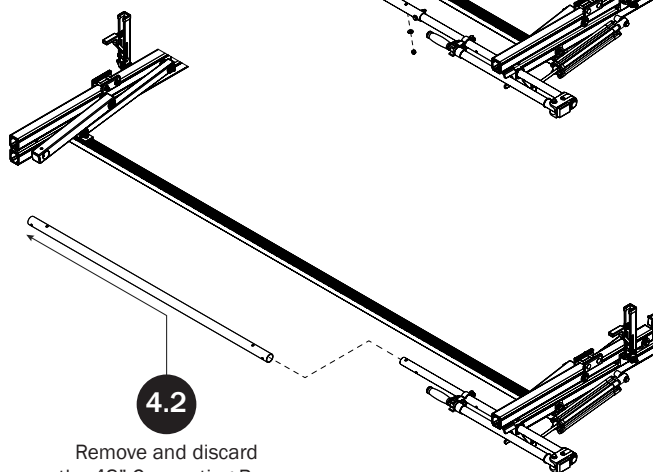

Remove and discard the 48" Connecting Bar.

LEFT ROTATION ASSEMBLY SEQUENCE

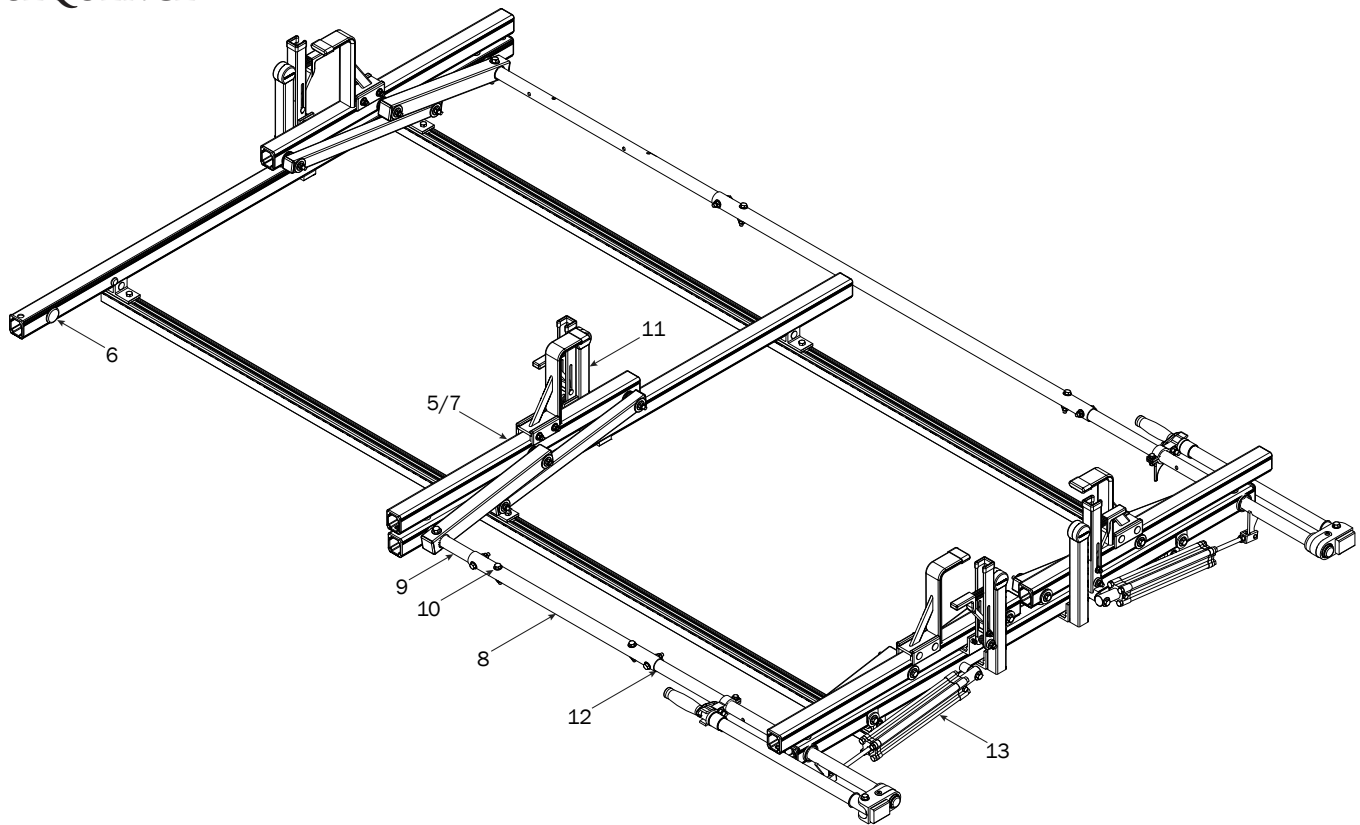

FRONT ROTATION REMOVAL

- 5.1** Remove the Rotation Arm to Crossbar hardware from the Front Crossbar and discard the steel hardware. It will not be reused.

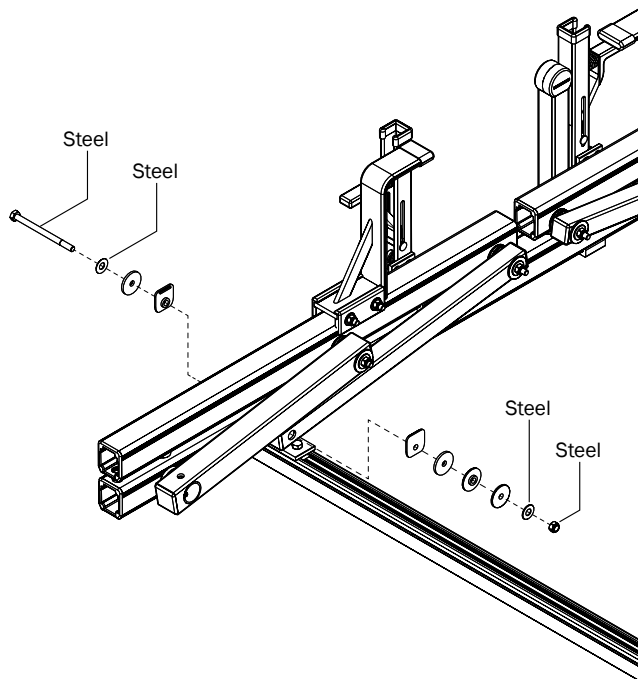

5.2

For a retrofit conversion: Remove and replace the black Drive Shaft (B) Bushing.

For new installations: Leave the white Drive Arm Bushing (A) in place, and remove the black Drive Shaft Bushing from the Front Crossbar. Set aside all components until Steps 7.8-7.11

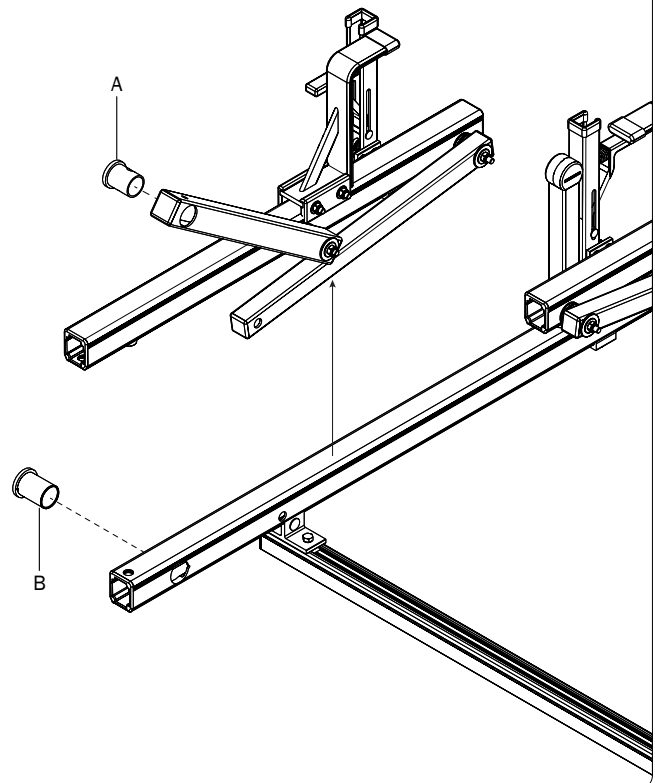

FRONT CROSSBAR

- 6** Install small .75" (C) and large 1.50" (D) round Caps into the Front Crossbar holes as shown.

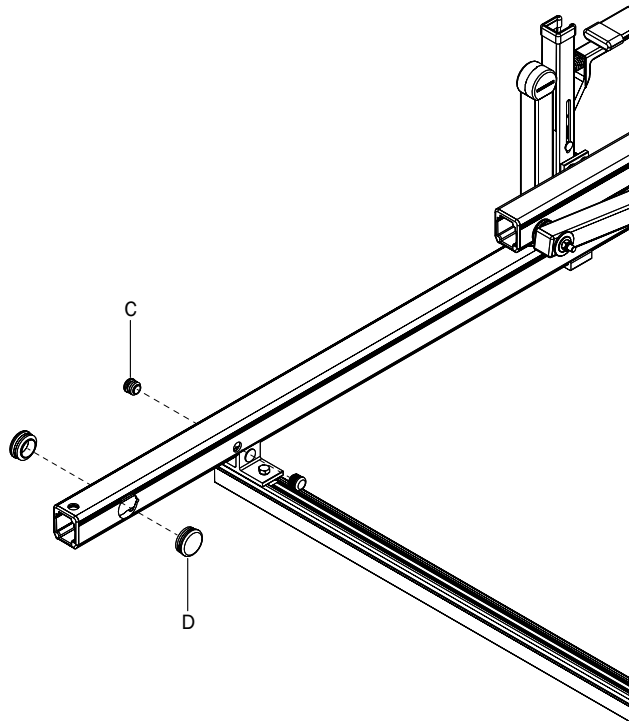
**CENTER CROSSBAR**

- 7.1** Remove and retain Channel End Caps and screws for Step 7.4

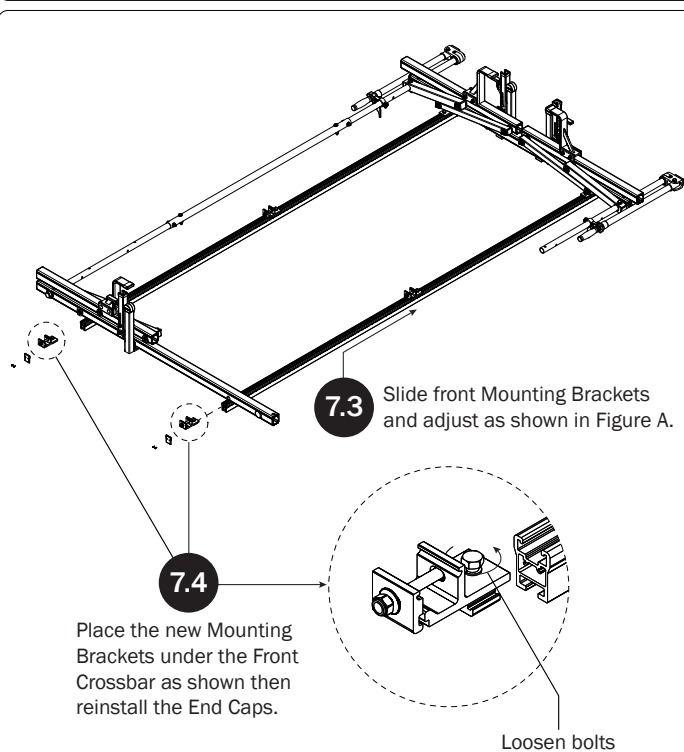
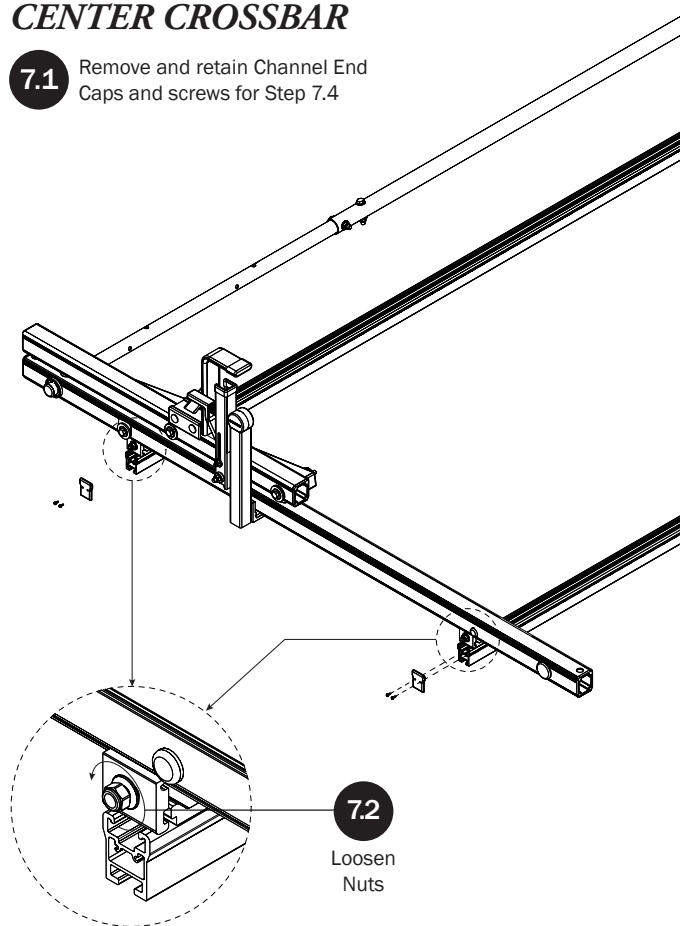
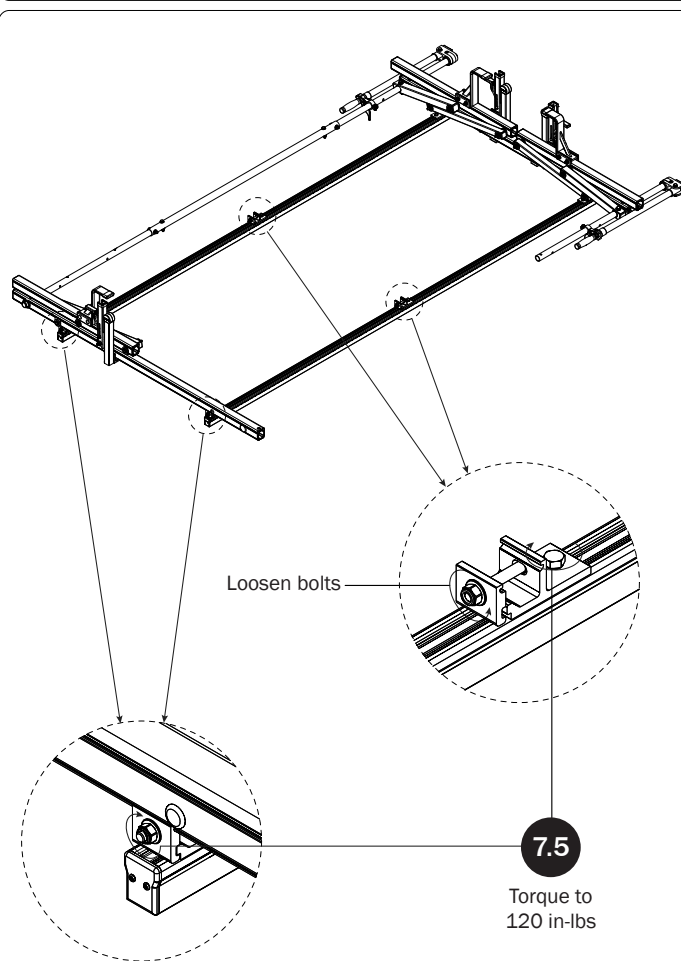
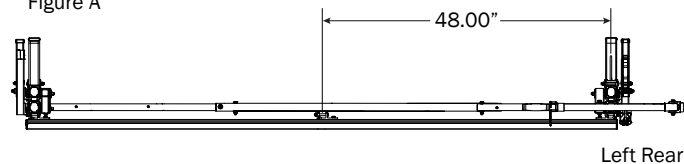

Figure A



- 7.6** Place the Center Crossbar onto the Mounting Brackets, then position as shown in Figure B.

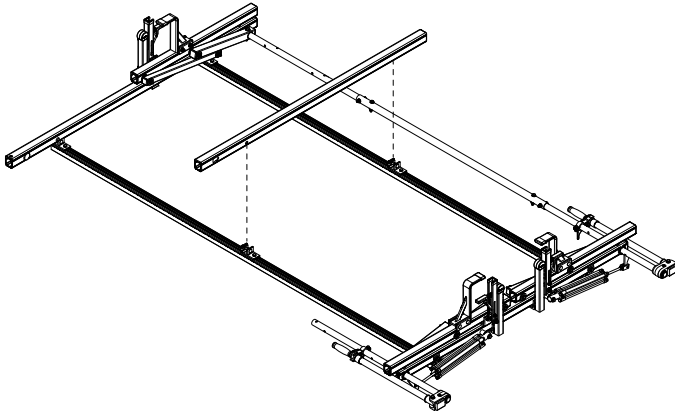
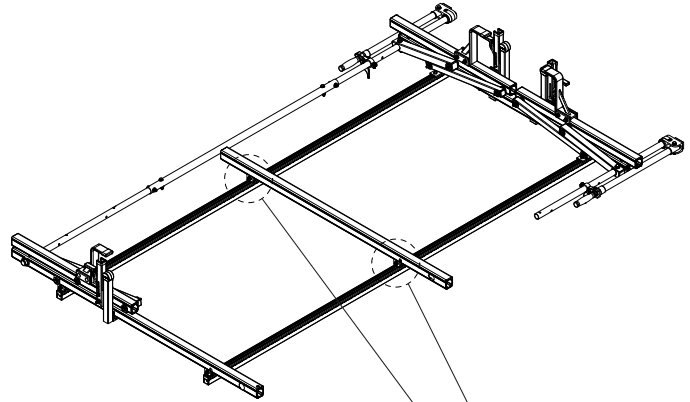
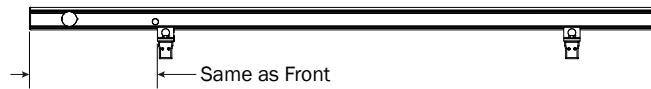

Figure B



7.7

Torque to 120 in-lbs

Rotation Arm
Bolt Assembly

Anti-Seize
Must apply Anti-Seize
Compound and torque
to specified value.

7.8

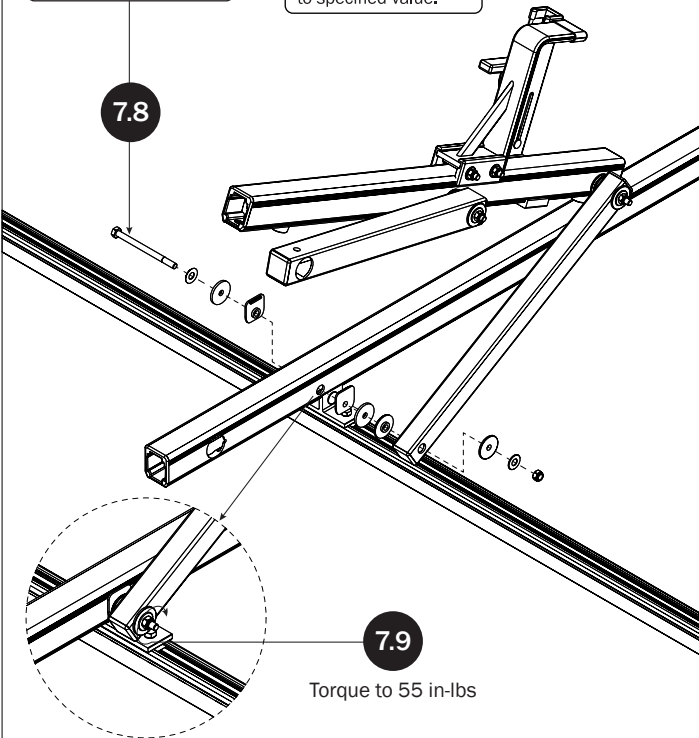

7.9

Torque to 55 in-lbs

7.10 White Bushing

7.11 Black Bushing

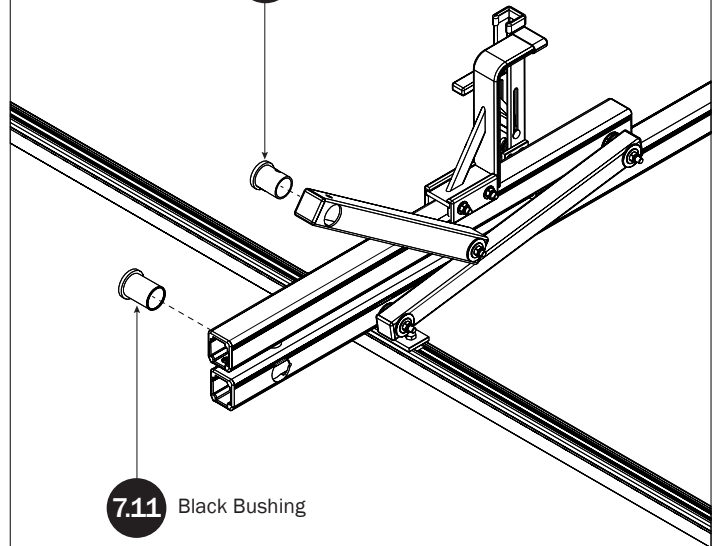

CONNECTING BAR

8.1

8.2

M8 x 50MM Hardware
Torque Nut to 90 in-lb.

Anti-Seize
Must apply Anti-Seize Compound and torque to specified value.

FRONT DRIVE SHAFT

9.1

9.2

9.3

9.4 Torque to 120 in-lbs

Lubricant
Liberally apply to bushing surface

3/8" Hardware
Tight fitting bolt. If required, tap lightly with a hammer to drive through.

Anti-Seize
Must apply Anti-Seize Compound and torque to specified value.

CONNECTING BAR FASTENERS

10

11

Anti-Seize
Must apply Anti-Seize Compound and torque to specified value.

M8 x 50MM Hardware
Torque Nut to 90 in-lb.

L POST SEE QUICK START GUIDE FOR ADJUSTMENTS

11.1

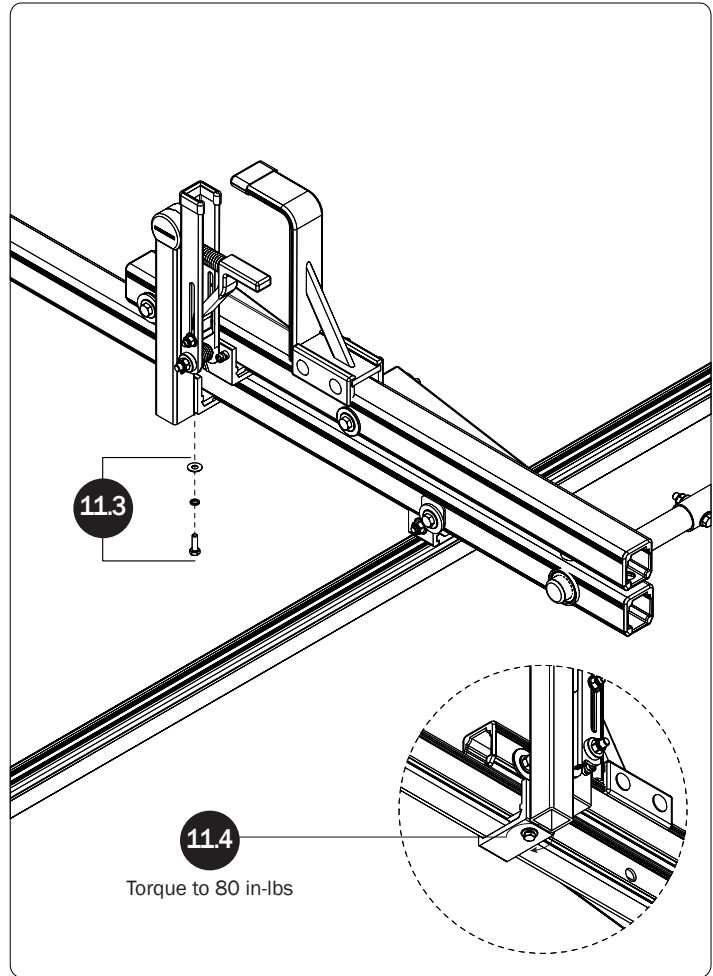
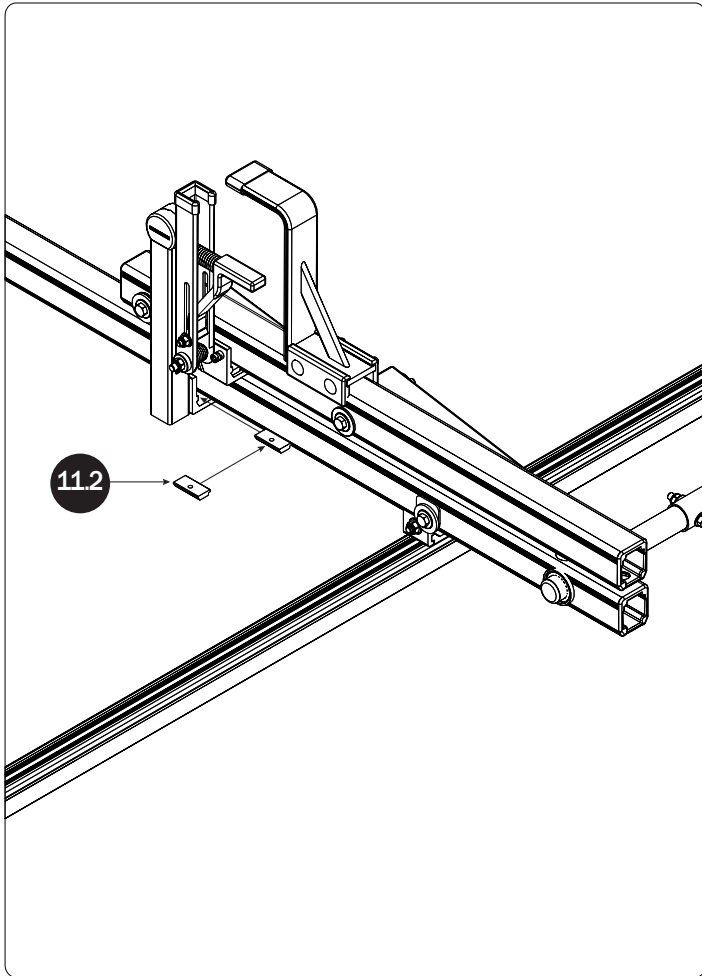

DRIVE SHAFT SEALING

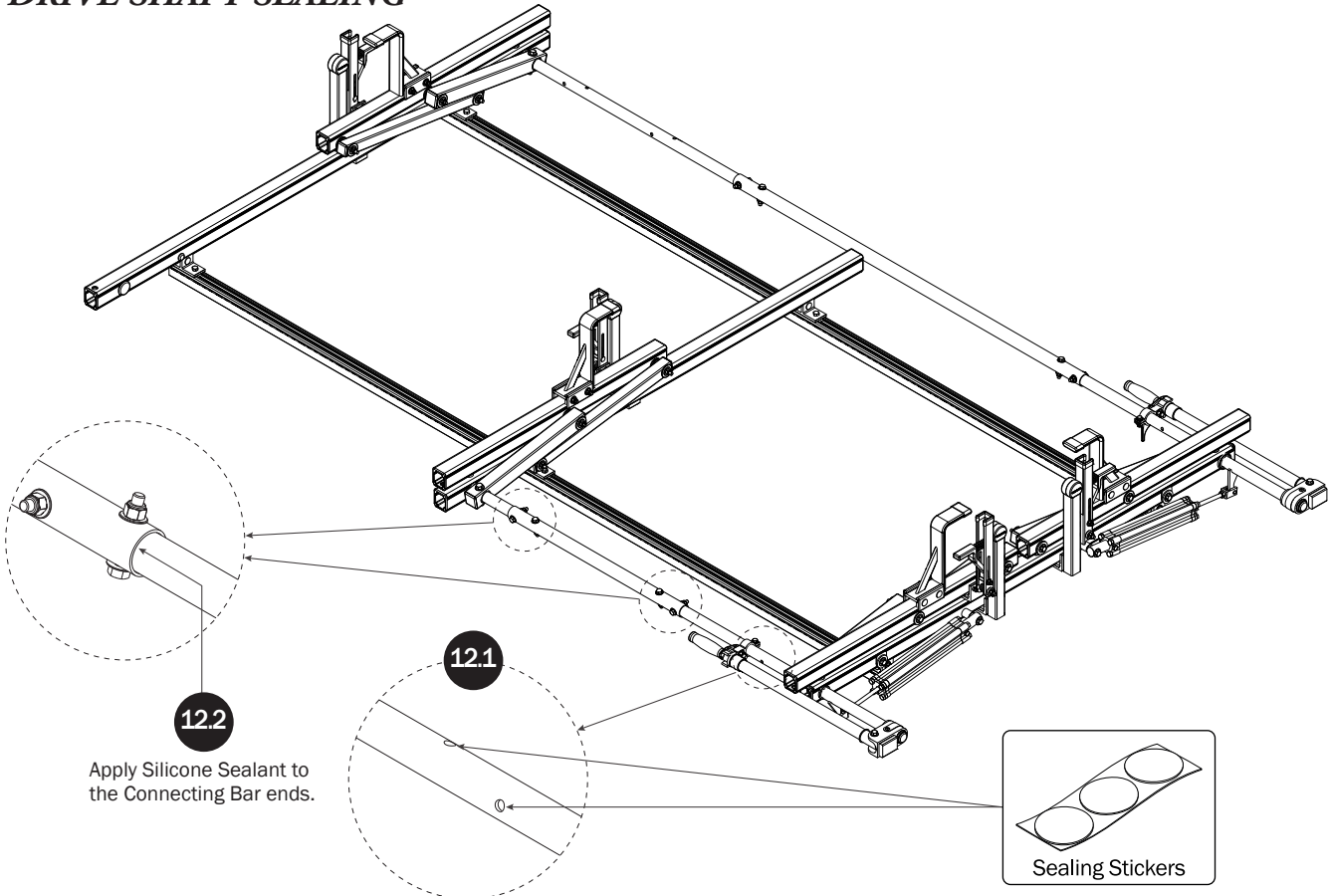

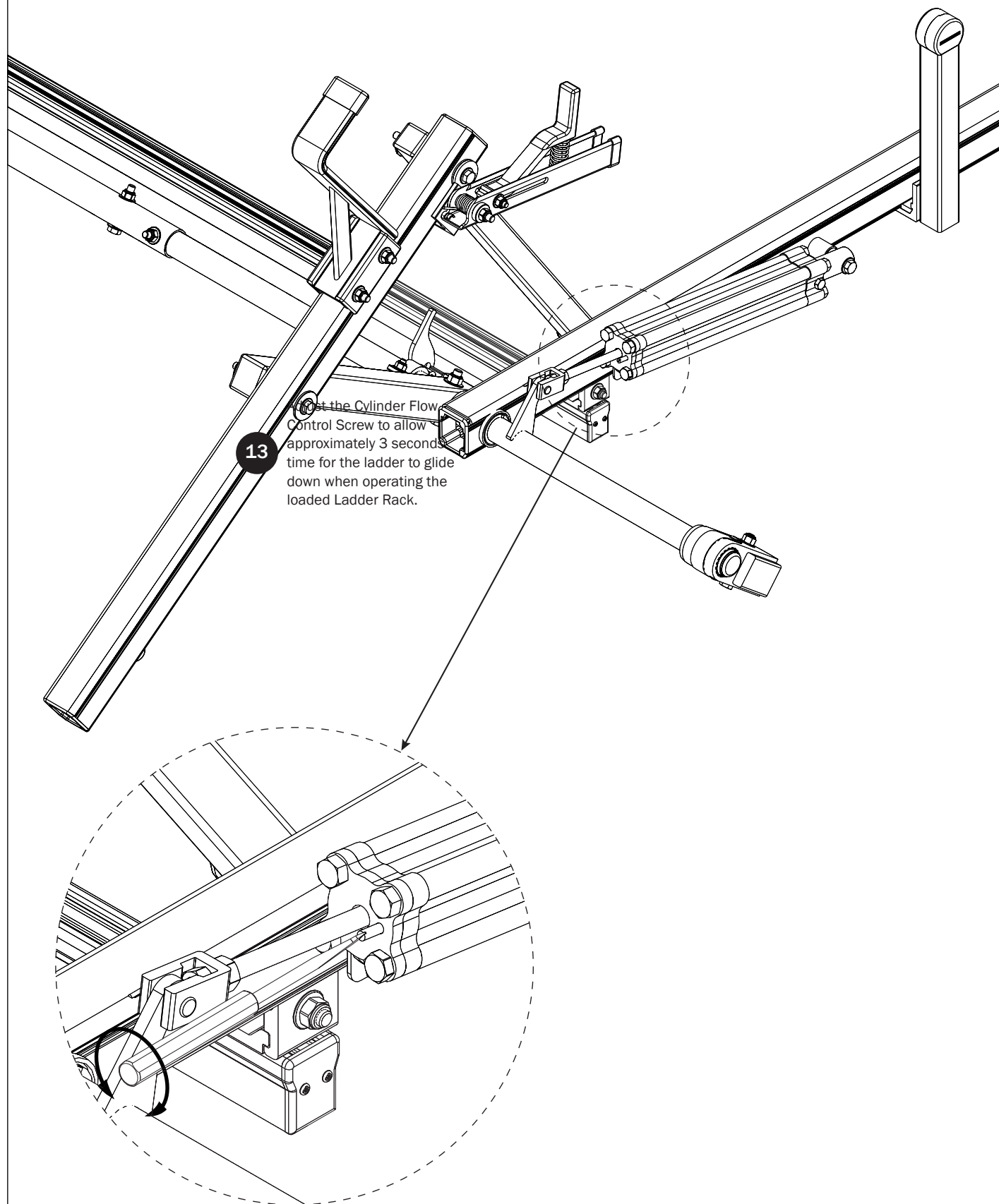

Page Intentionally Left Blank

