

PRIME DESIGN™

A Safe Fleet Brand

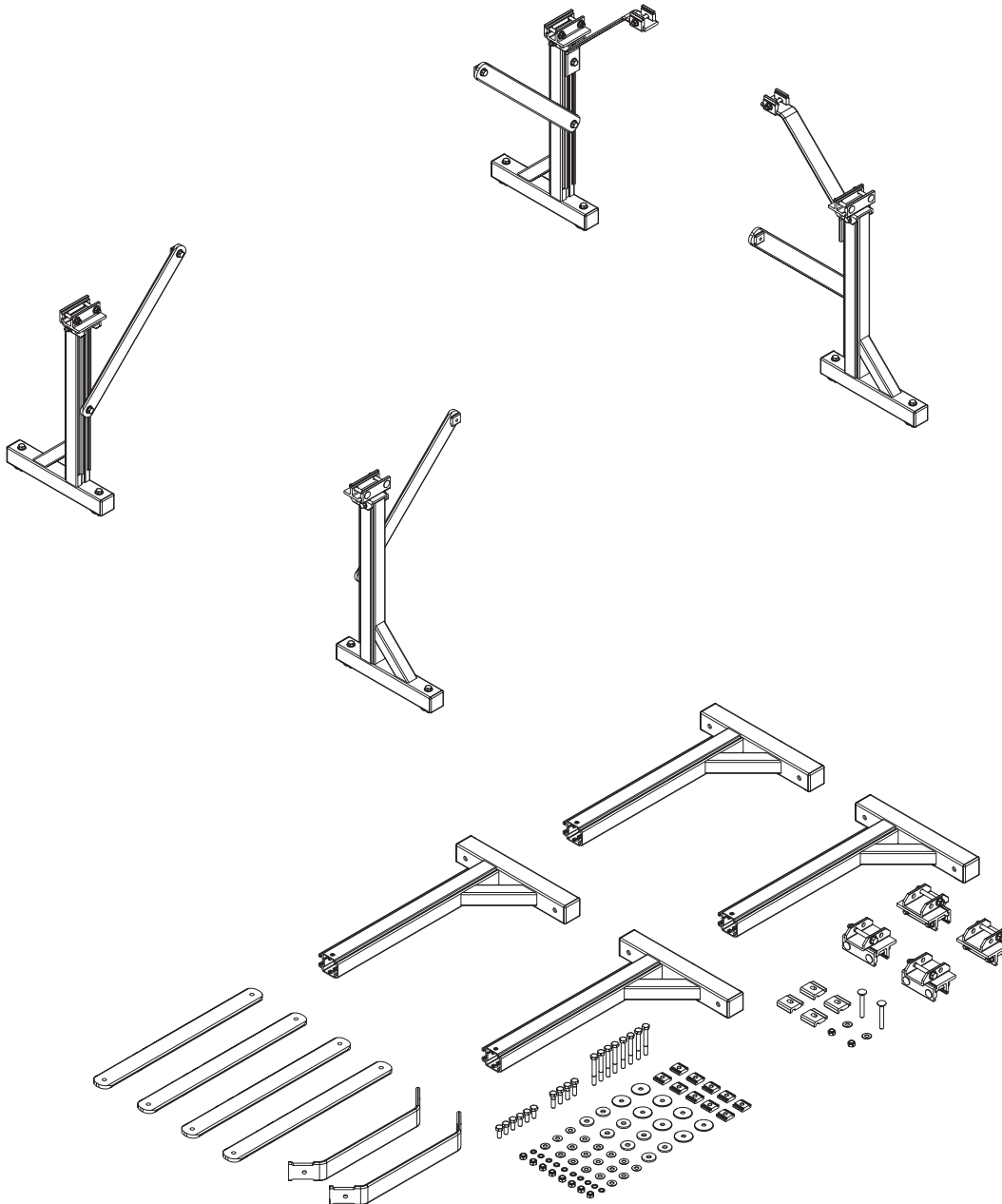

OTC Base Mounting System

Pages 2-3	Packaging Contents
Pages 4	FBM Mounting
Pages 5-6	Mounting to OTC Channels
Pages 7-8	Installing Mount Braces

PRIME DESIGN, A SAFE FLEET BRAND

Address: 580 Opperman Drive, Eagan, MN 55123 • Toll Free: 1.8.PRIME.RACK

Fax: 651-552-1799 • Email: info@primedesign.net • Website: www.primedesign.net

FBM-1051

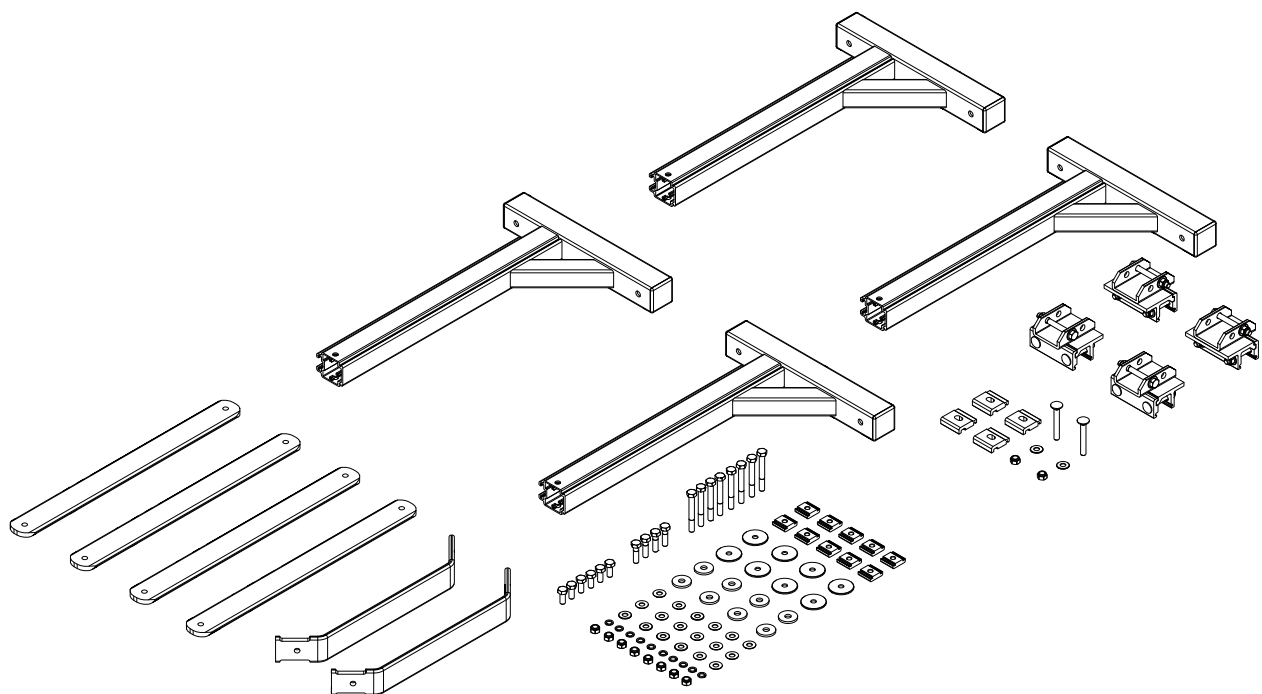

Base Mounting Leg..... (Qty 4)

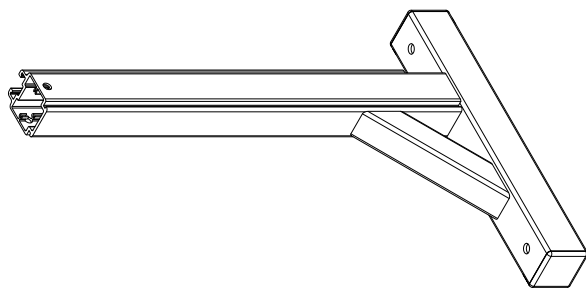

Mounting Leg Connector Assembly (Qty 4)

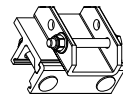

Crossbar Mounting Brace..... (Qty 2)

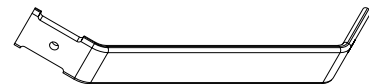

Channel Mounting Brace..... (Qty 4)

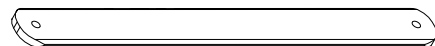

HKT-0188 Crossbar Mounting Connector Hardware Kit

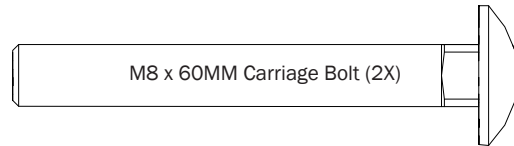
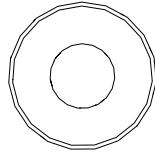
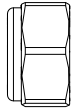
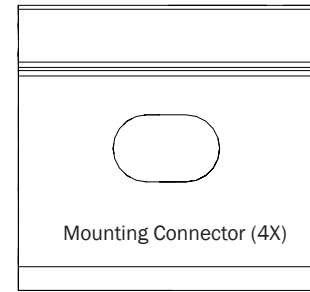

HKT-8061 FBM Hardware Kit

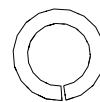
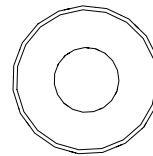
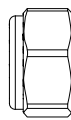
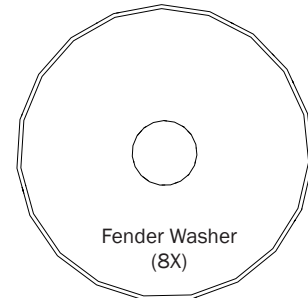
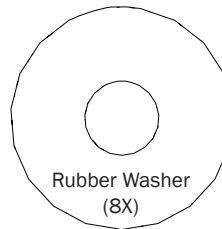
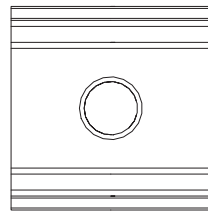
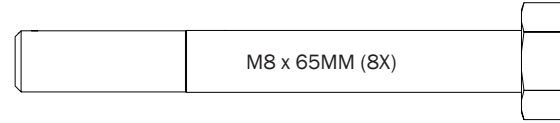
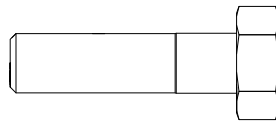
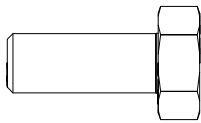

Anti-Seize (included Hardware Kits)



INSTALLING MOUNTING LEGS**8' BODY CONFIGURATIONS**

NOTE: Recommended installation distances are as shown.

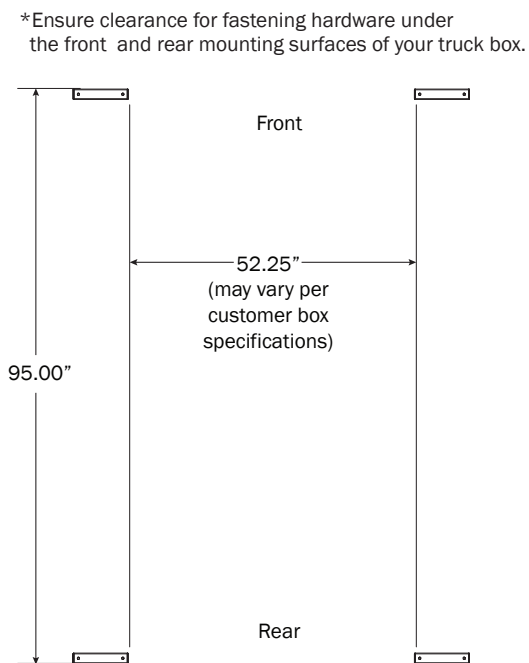
**9' BODY CONFIGURATIONS**

NOTE: Recommended installation distances are as shown.

*Ensure clearance for fastening hardware under the front and rear mounting surfaces of your truck box.

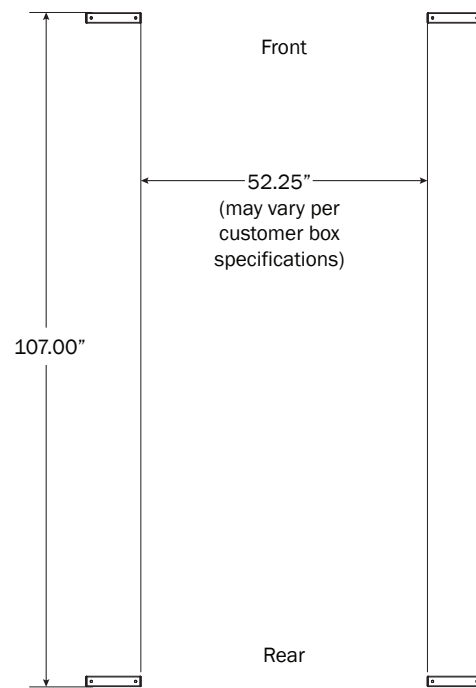
**11' BODY CONFIGURATIONS**

NOTE: Recommended installation distances are as shown.

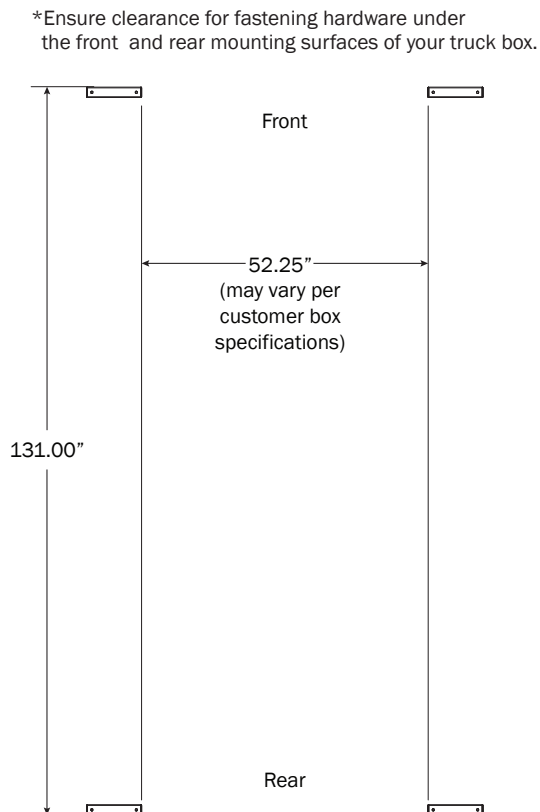
**1**

Install Mounting Hardware from HKT-8061 as shown..

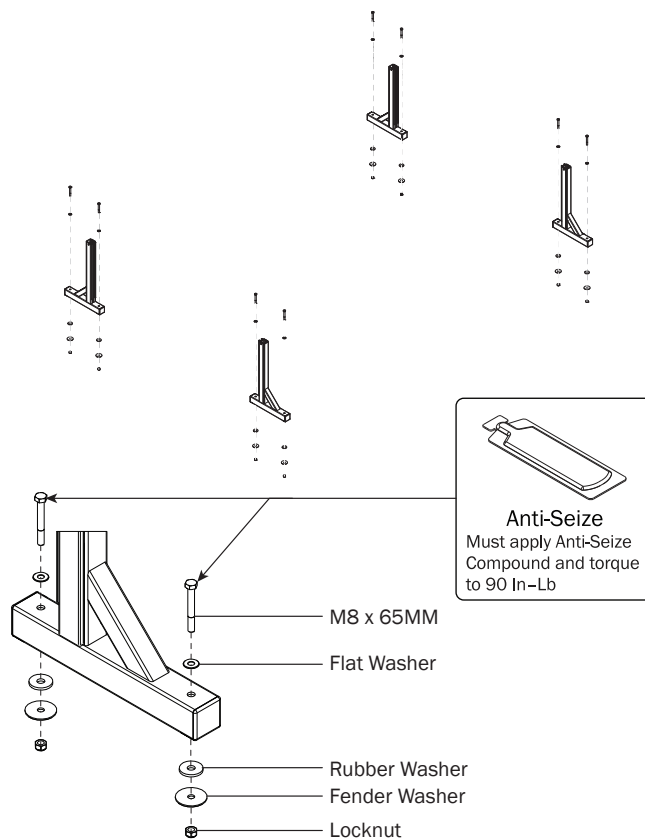

INSTALLING MOUNTING LEGS

- 2.1** Install Mounting Leg Connectors onto the Base Mounting Legs as shown.

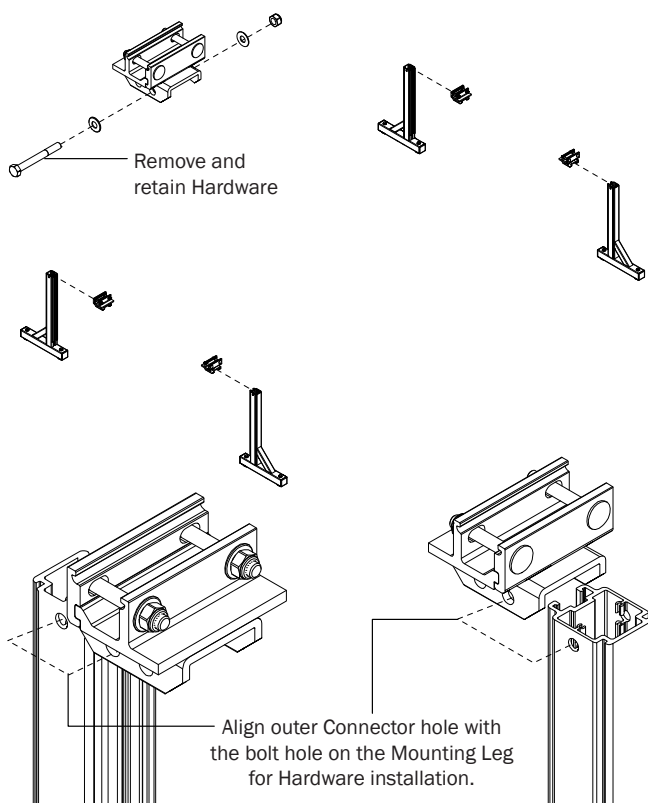

- 2.2** Re-install Mounting Leg Connector Hardware as shown.

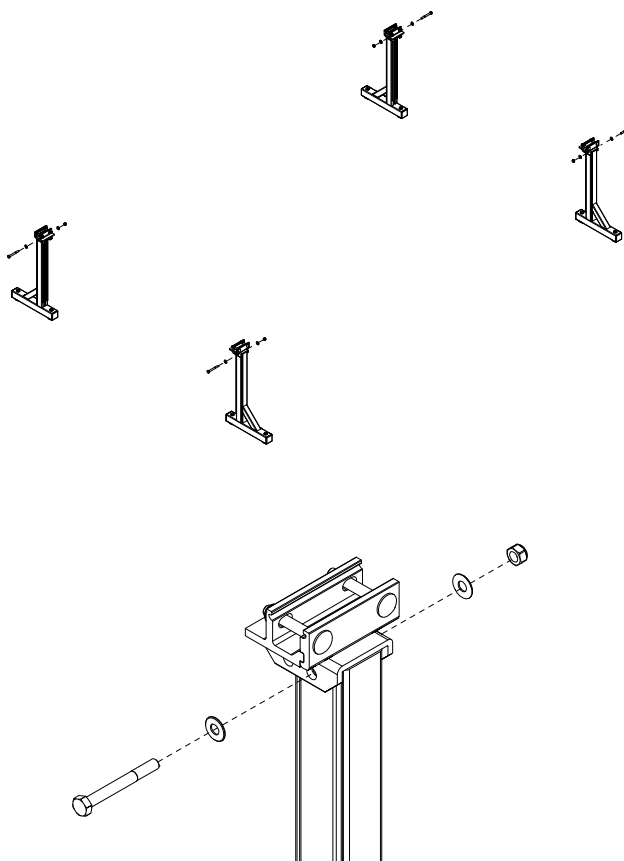

OVERVIEW: MOUNTING TO OTC CHANNELS

NOTE: Channels and Crossbars in this Overview are shown for reference only. Specific configurations are determined by Service Body size, and Crossbar preferences.

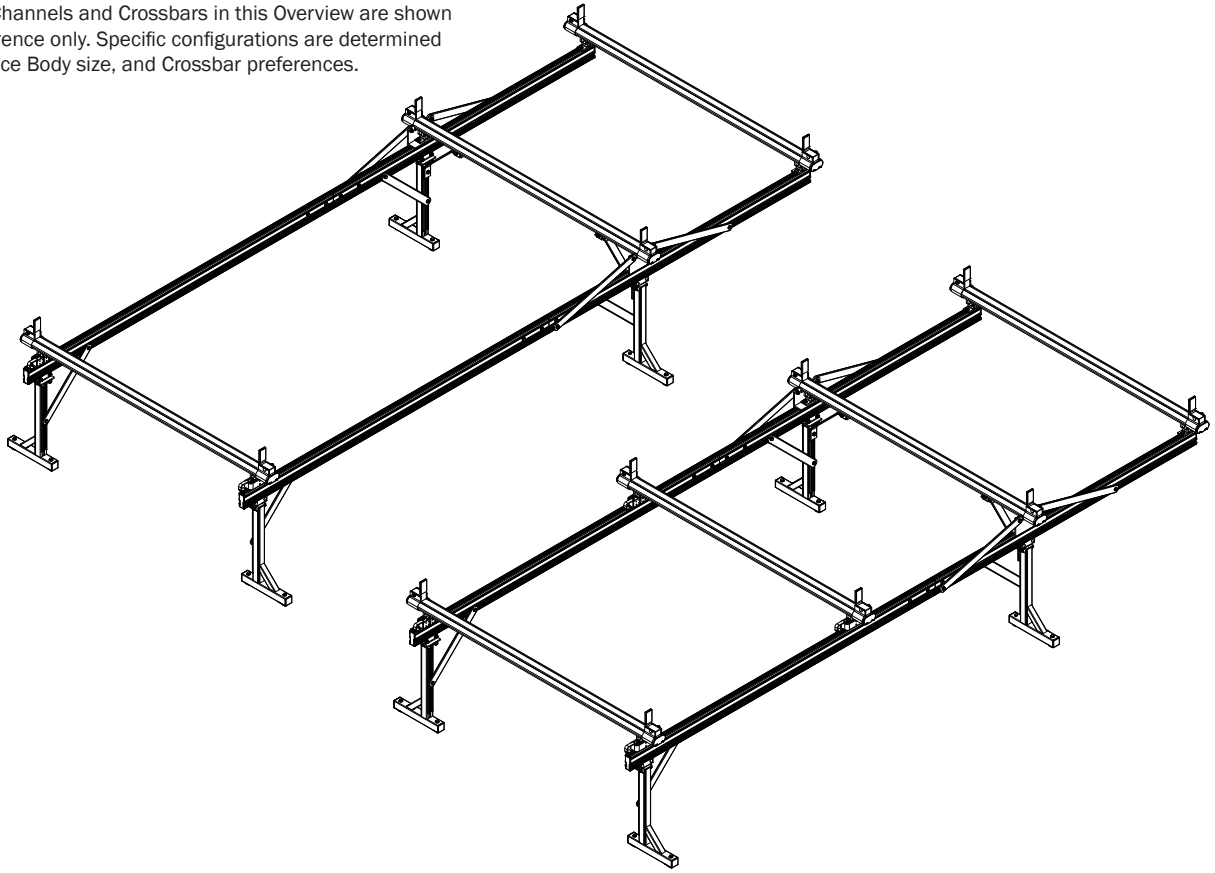
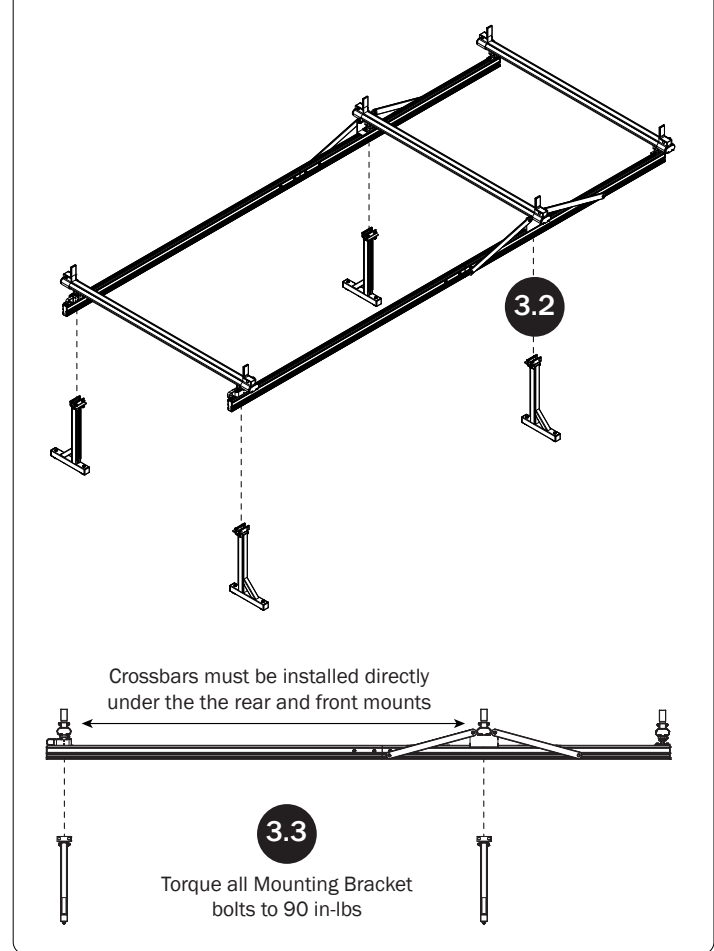
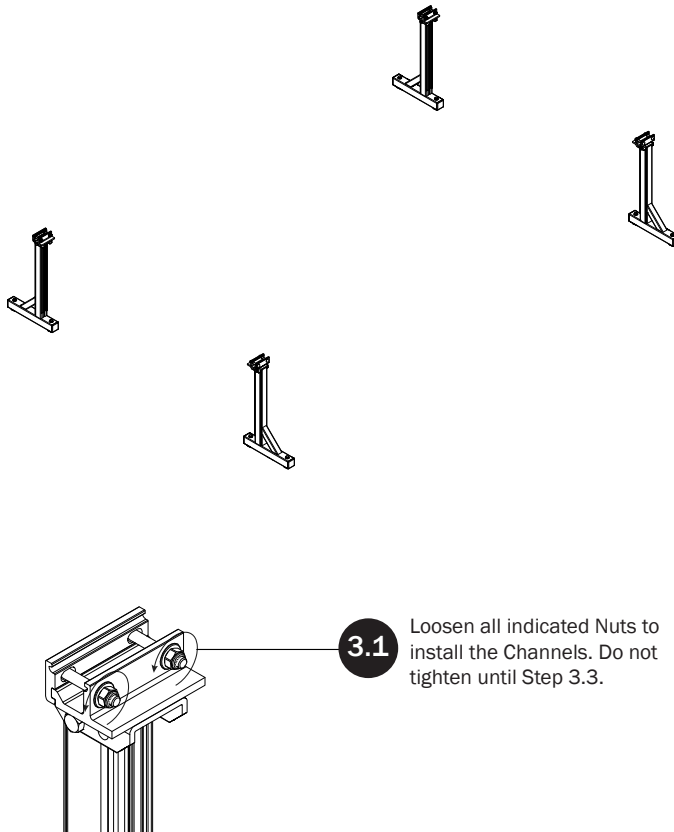
**MOUNTING TO CHANNELS**

REAR MOUNTING FOOT NUT BRACKETS

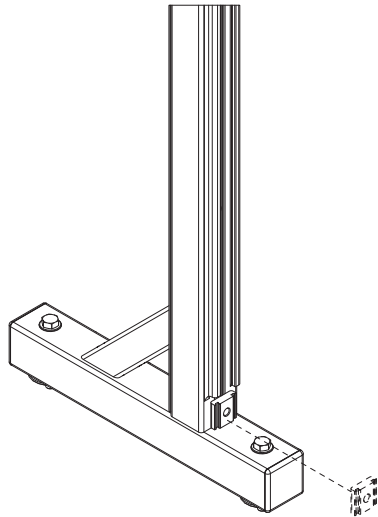

- 4.1** Install one M8 Nut Bracket in each rear Mounting Foot channel as shown.

MID MOUNTING FOOT NUT BRACKETS

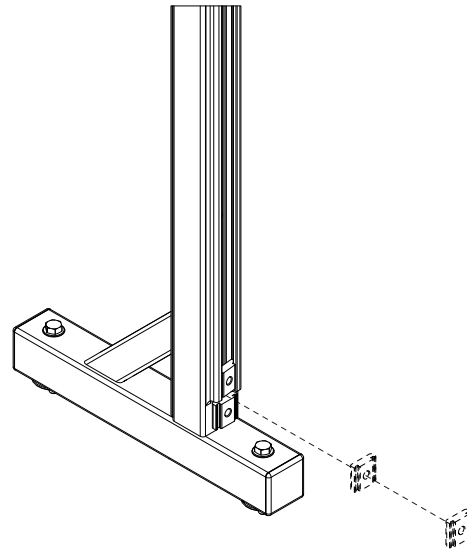

- 4.2** Install two M8 Nut Brackets in each mid Mounting Foot channel as shown.

MID CROSSBAR BRACE INSTALLATION

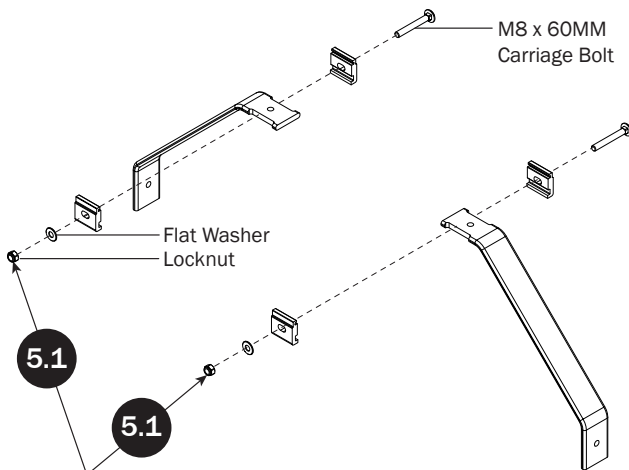

5.1

5.1

Finger-tighten



Anti-Seize
Must apply Anti-Seize Compound and torque to specified value.

- 5.2** Install the mid Crossbar Braces as shown. Do not torque until Step 5.3.

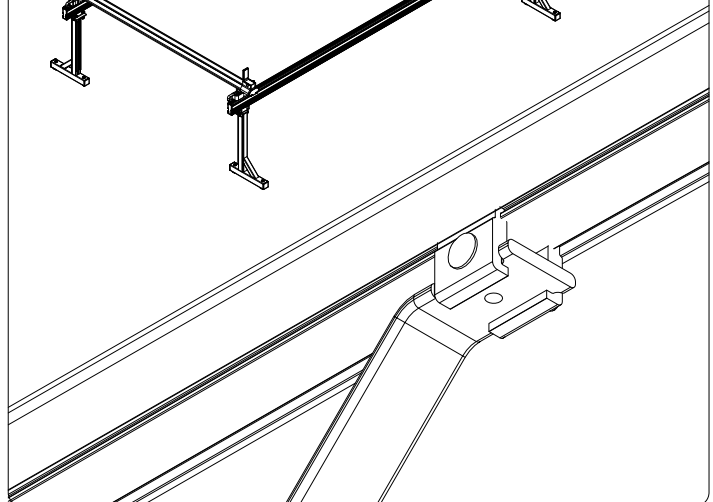
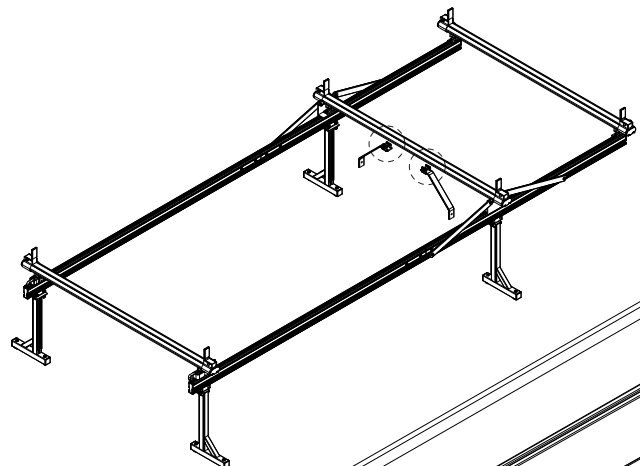

- 5.3** Install the mid Crossbar Brace Hardware into the top Nut Bracket as shown. Torque all Hardware to 90 in-lbs.

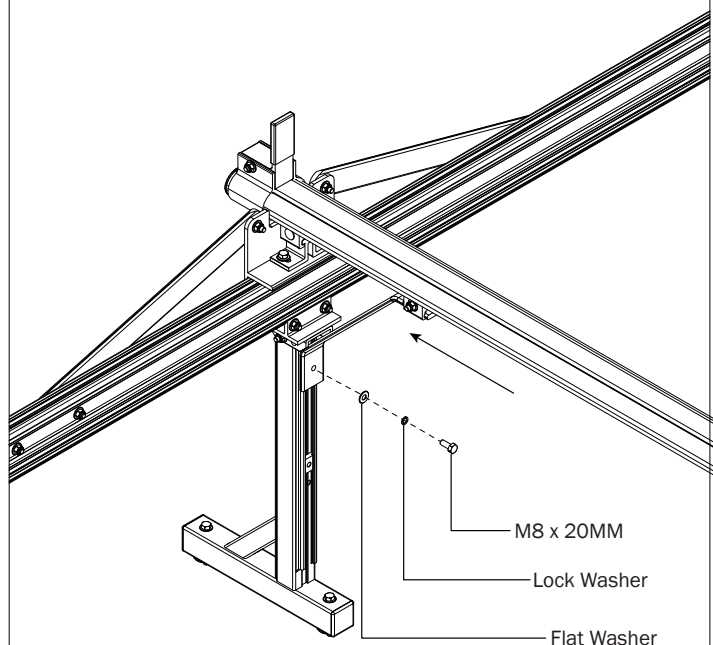

REAR/MID CROSSBAR-CHANNEL BRACE INSTALLATION

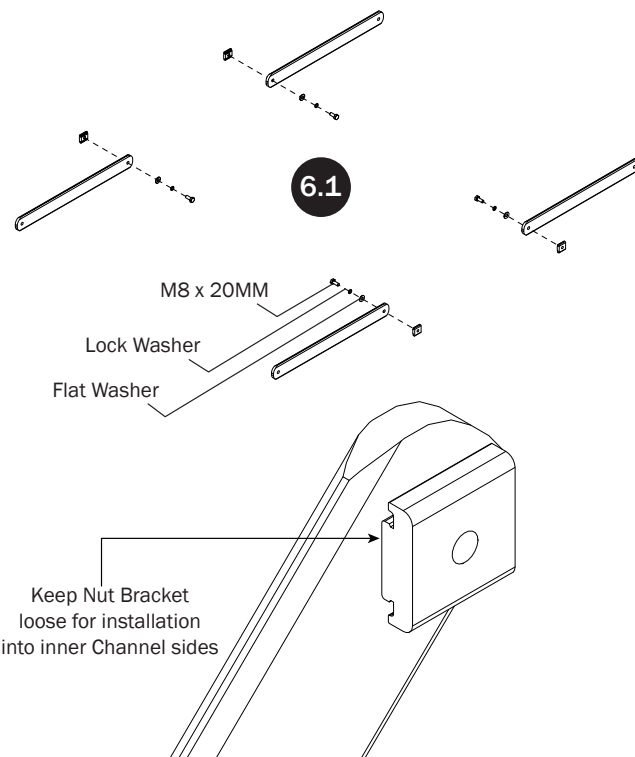

- 6.2** Install Braces into the inside of the Channels as shown.

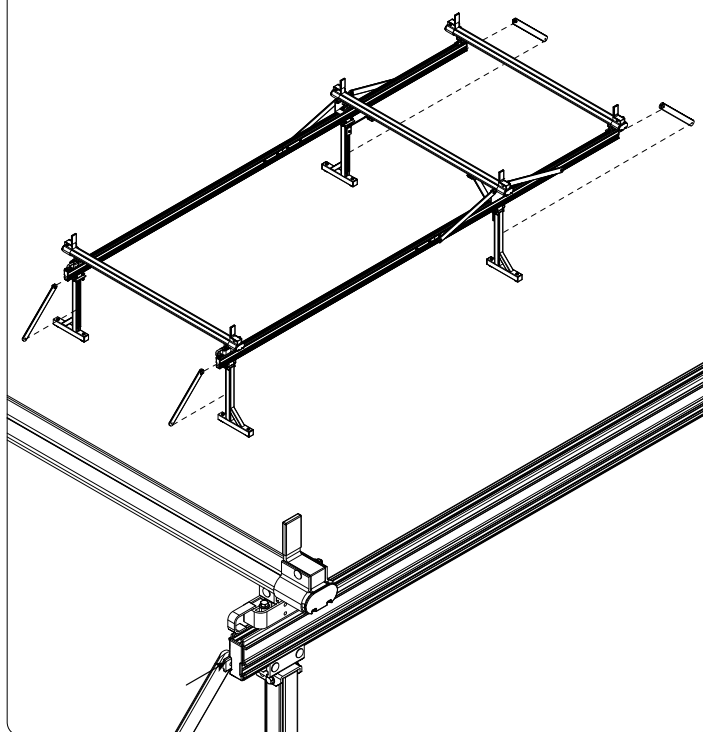

- 6.3** Install the lower end of the Braces into the Mounting Foot channels using the remaining Nut Brackets and Hardware as shown. Torque to 90 in-lbs.

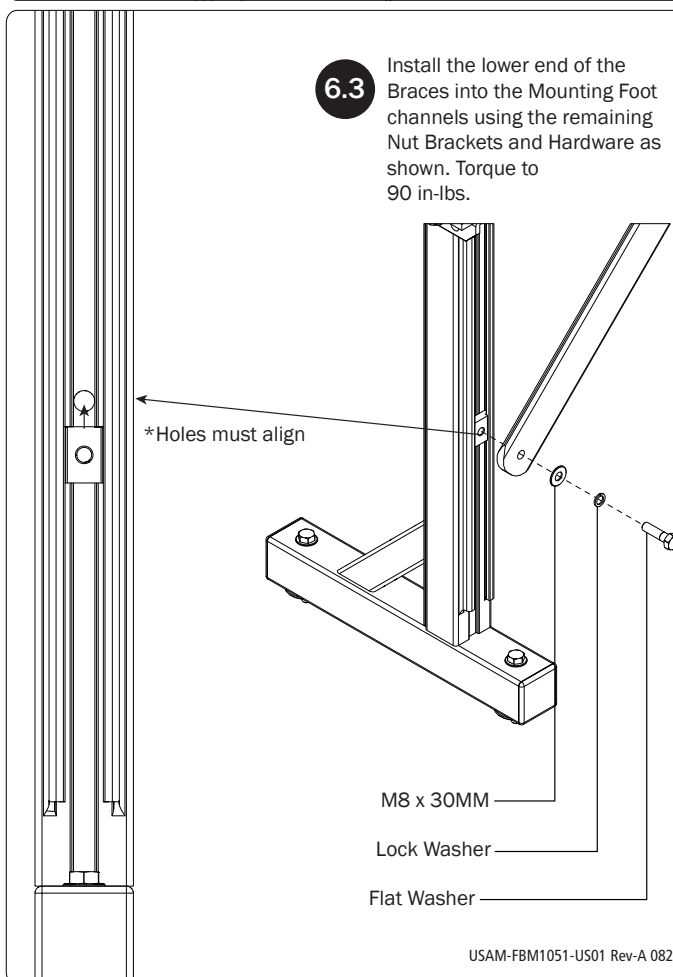

USAM-FBM1051-US01 Rev-A 0820