

PRIME DESIGN™

A Safe Fleet Brand



SRM SERIES

OTC Side Rail Pairs, 72" - 84"

Page 2-3	Packaging Contents and Configurations
Page 4	Side Rail Assembly

CONTENT OVERVIEWS

NOTE: Side Rail pairs are packaged with Hardware Kit HKT-0186 and require assembly. See Page 3–4 for Service Body Configurations and Assembly Instructions.

SRM-0084–84” Side Rail Module



Side Rail (2X)



Side Rail Channel Splice (1X)



Anti-Seize (1X)

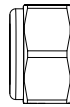

M8 Lock Nut (4X)

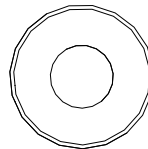

5/16" Flat Washer (8X)

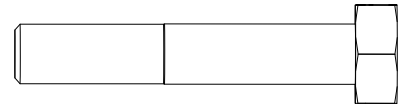

M8 x 45MM (4X)

SRM-0072–72” Side Rail Module



Side Rail (2X)



Side Rail Channel Splice (1X)

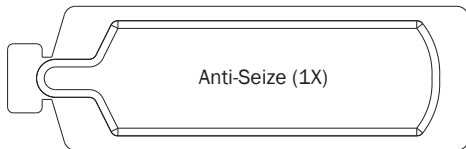

Anti-Seize (1X)

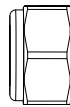

M8 Lock Nut (4X)

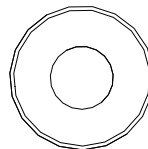

5/16" Flat Washer (8X)

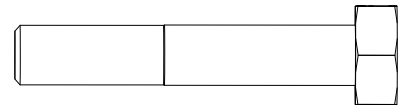

M8 x 45MM (4X)

SERVICE BODY CONFIGURATIONS

SERVICE BODY SIZE	REAR CHANNEL MODULE	FRONT CHANNEL MODULE
8'-9' Body, Standard Cab	SRM-0072	SRM-0072
8'-9' Body, Crew Cab	SRM-0084	SRM-0072
8'-9' Body, Extended Cab	SRM-0084	SRM-0072
11' Body, Standard Cab	SRM-0084	SRM-0084
11' Body, Crew Cab	SRM-0084	SRM-0084
11' Body, Extended Cab	SRM-0084	SRM-0084

Side Rail Dimensions (R/F)

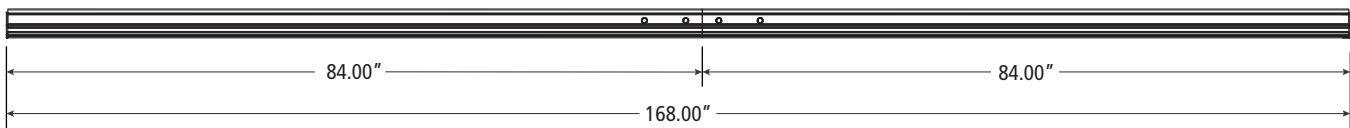
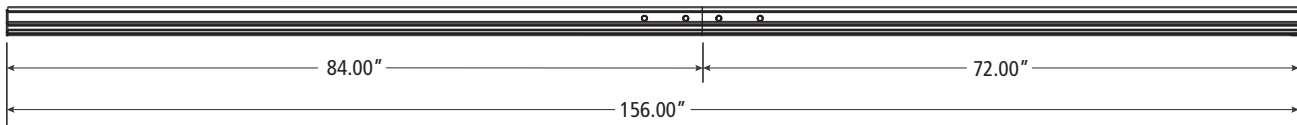
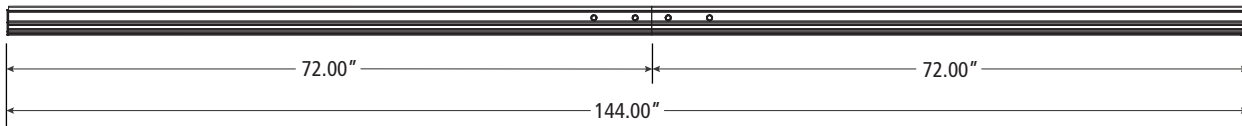

SIDE RAIL ASSEMBLY

1.1 Assemble Side rails as shown.

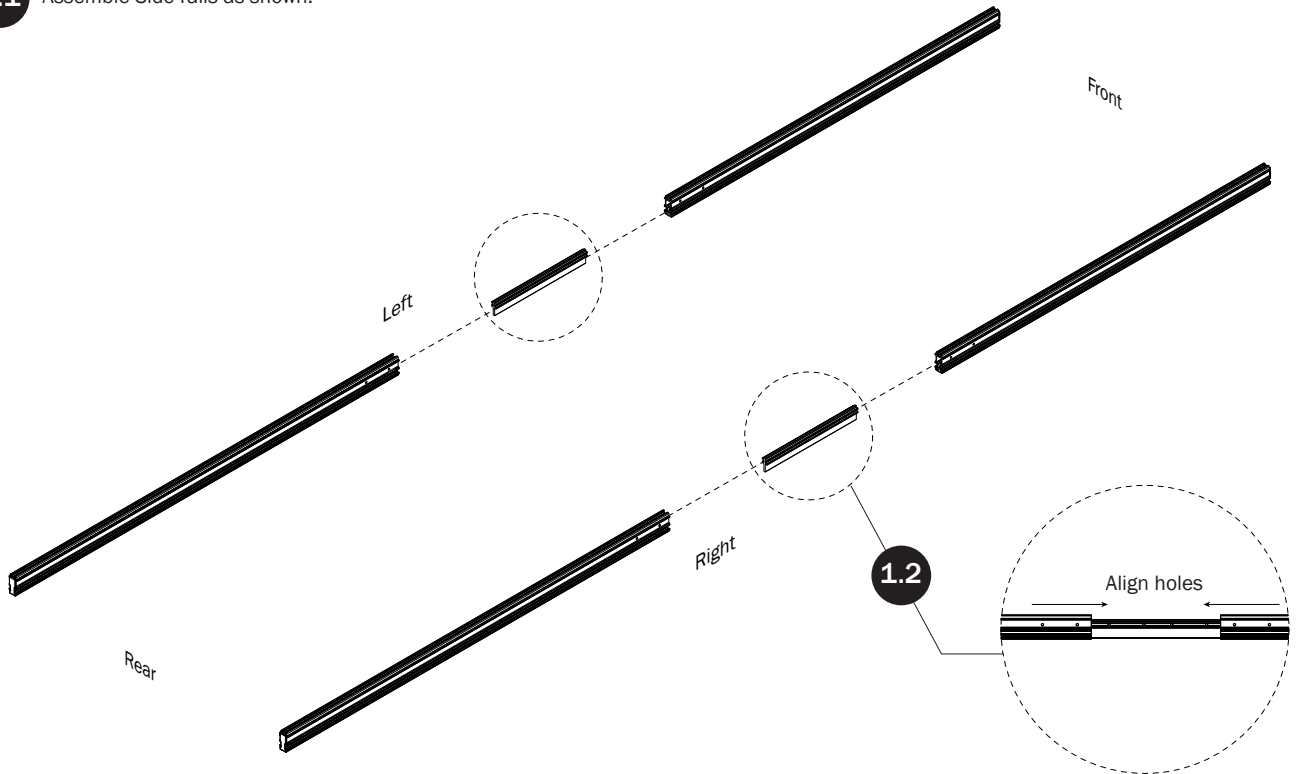

2.1 Install Hardware as shown.

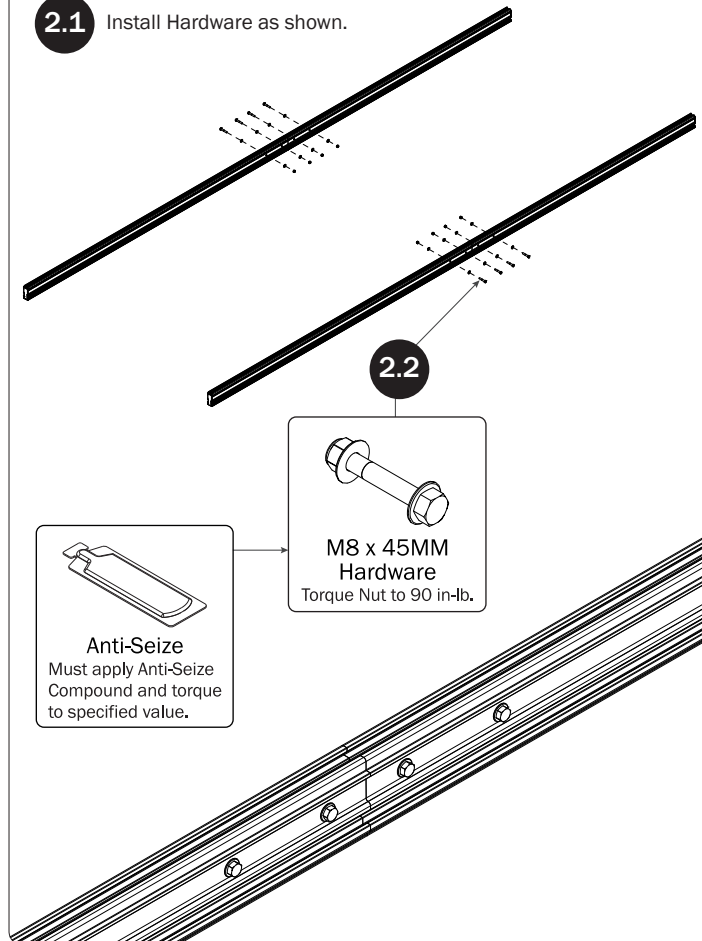

To install Crossbars, refer to your respective OCM Crossbar Module Assembly Manual included with your chosen rack configuration features.

INSTALLER NOTE: To purchase applicable features and accessories, please contact your authorized distributor, or a Prime Design Sales & Service Representative.

USAM-SRMSERIES-US01 Rev-A 0120