

PRIME DESIGN™

A Safe Fleet Brand

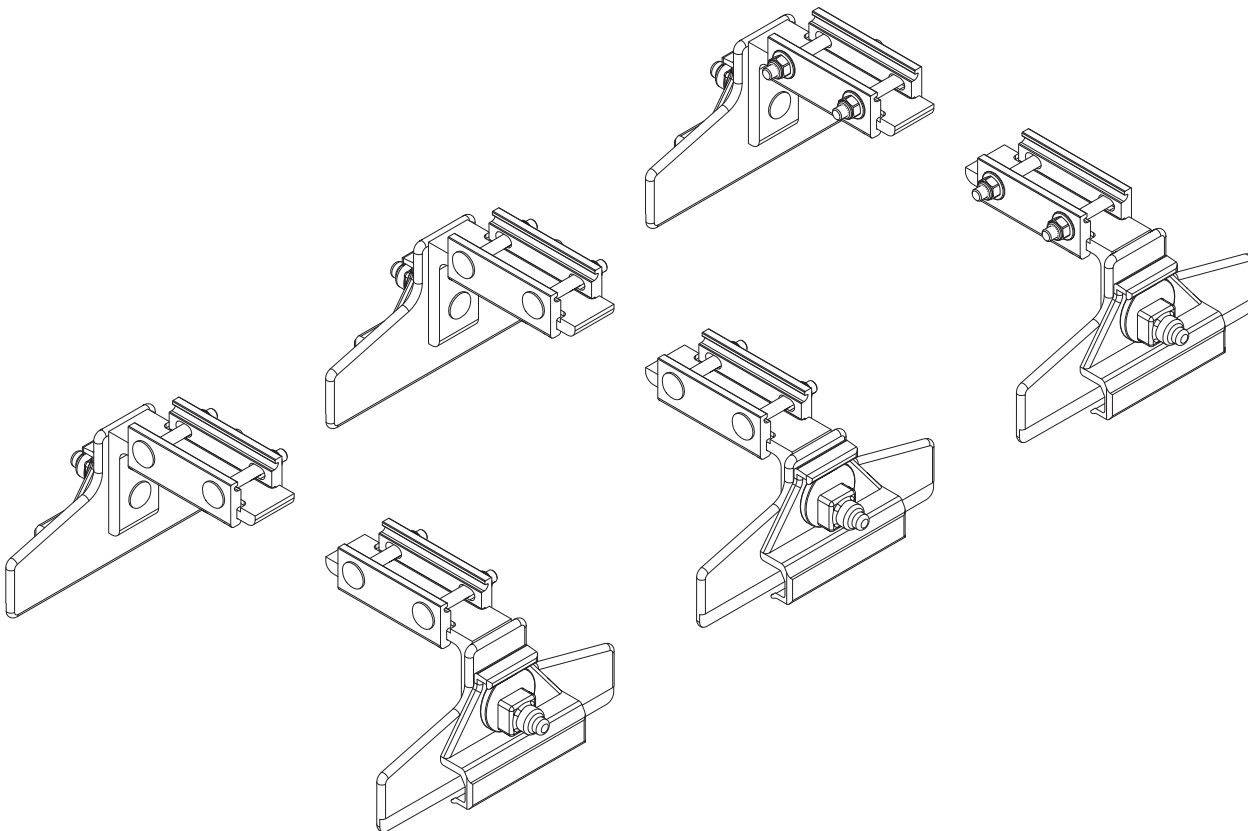

1996+ Chevrolet Express Gutter Mount Frame Base Mounting Kit

Page 2 Packaging Contents

Pages 3-6 Low Roof Medium/Extended Wheelbase (135"-155")

PRIME DESIGN, A SAFE FLEET BRAND

Address: 580 Opperman Drive, Eagan, MN 55123 • Toll Free: 1.8.PRIME.RACK

Fax: 651-552-1799 • Email: info@primedesign.net • Website: www.primedesign.net

FBM-1025

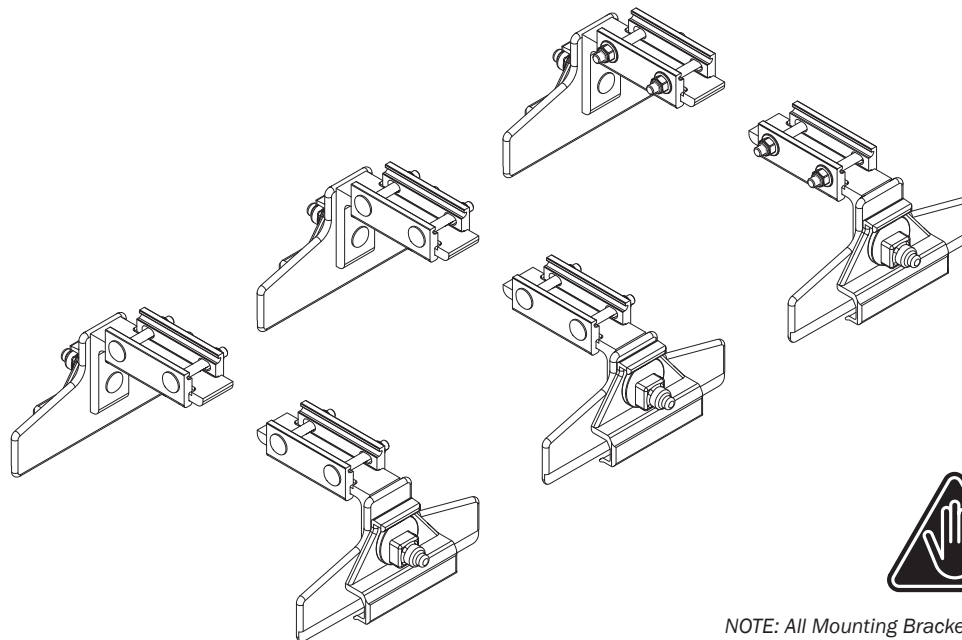

NOTE: All Mounting Brackets come pre-assembled with bolts facing the same orientation. For safety, it's recommended to position all protruding Top Clamp bolts inward. This will necessitate a partial reassemble of two of the four Mounting Brackets as shown in Steps 1.1–1.6 on pages 3 & 4.

1—FBM-1025..... (Qty 1)
Channel Mounting Brackets, w/HKT-8018



Cam Bolt Cap (6X)

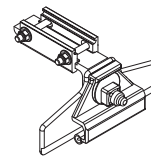

Mid Mounting Brackets (2X)

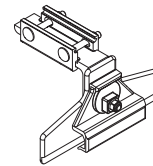

Mounting Brackets (4X)

2—Crossbars (shown for illustrative purposes only)
Ordered separately

ErgoRack, Gen4

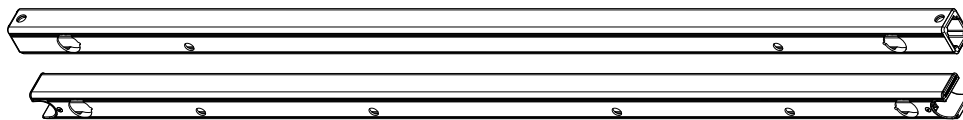

AluRack

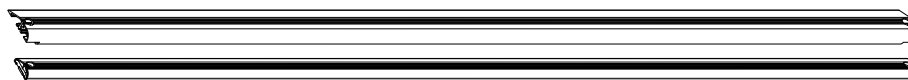

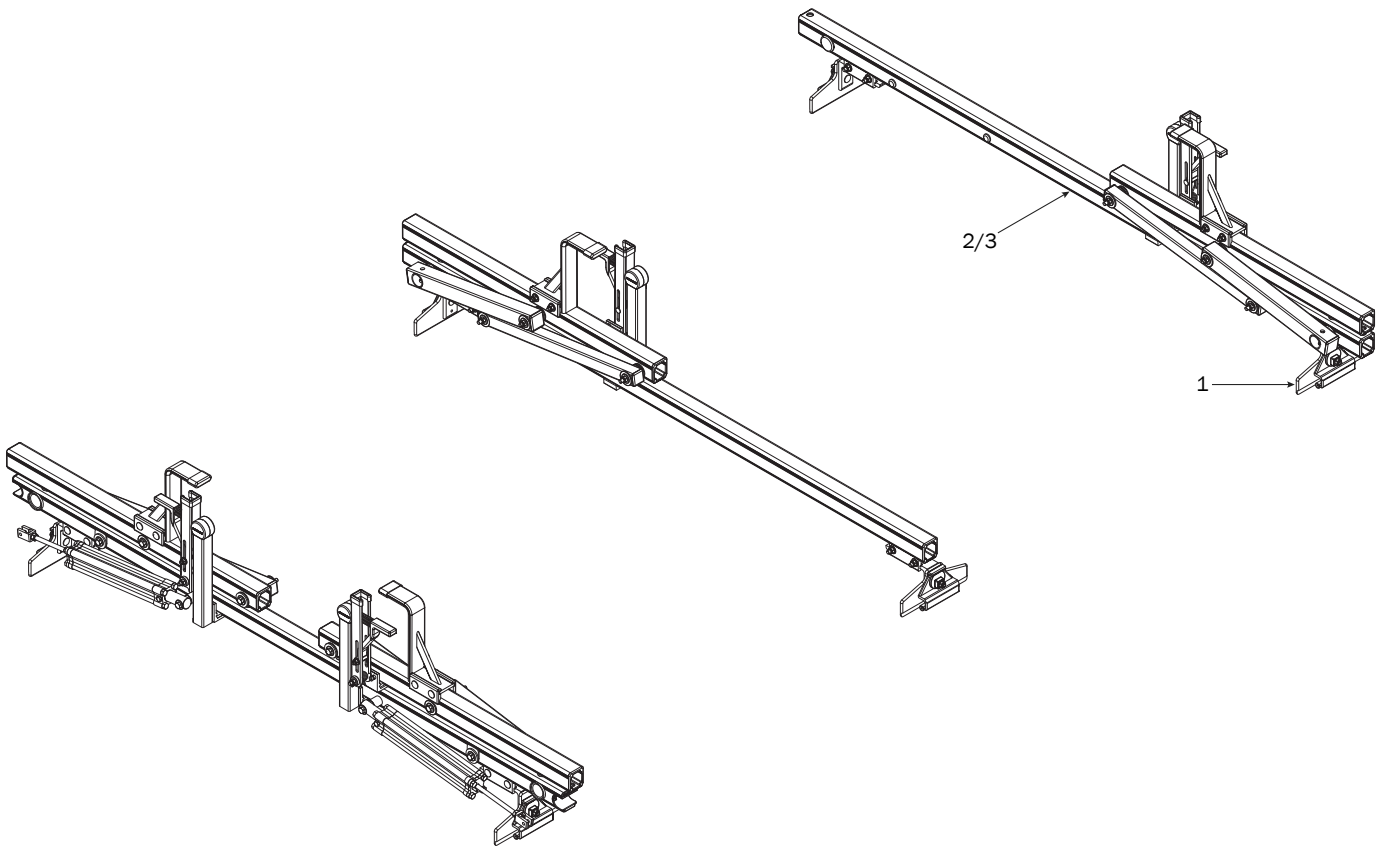

MOUNTING BRACKETS

Set aside two of six Mounting Brackets, and perform Steps 1.1–1.6 to all, then proceed to Step 2.1

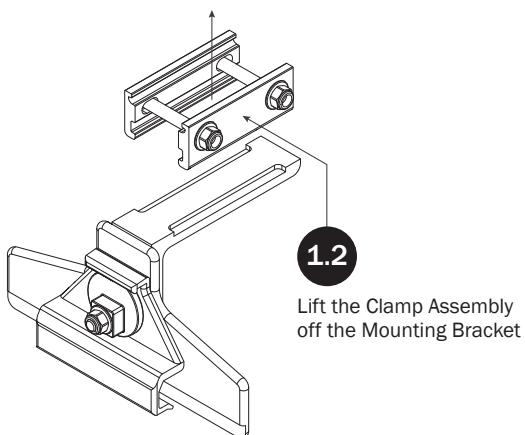
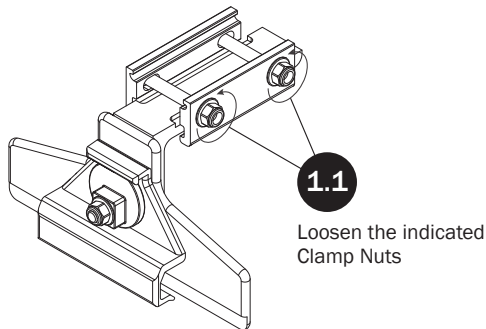

Rotate the Clamp
Assembly 180°

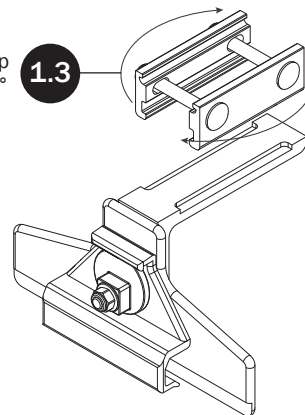

Lower the Clamp Assembly onto
the Mounting Bracket. Tighten
only enough to retain Clamps on
Mounting Bracket.

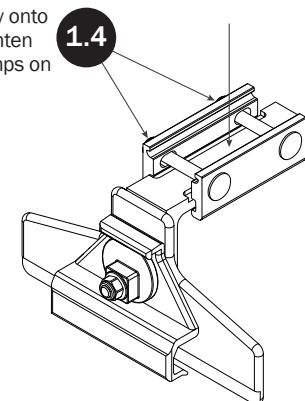

1.5

Loosen the Mounting Z Plate Cam Nut, but do not remove

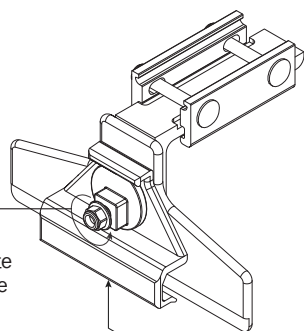

Z Plate

1.6

Rotate the Mounting Z Plate Cam 180° to allow the Z Plate to rest at its full bottom position. Do not tighten the Cam Nut until Step 3.4. Repeat Steps 1.1–1.6 for the second Mounting Bracket.

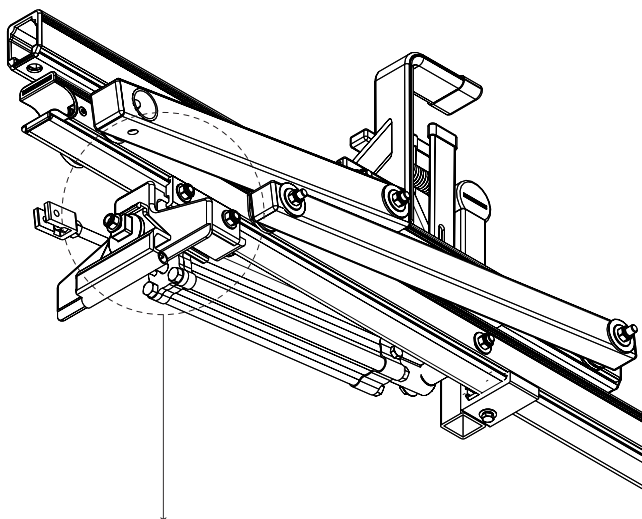
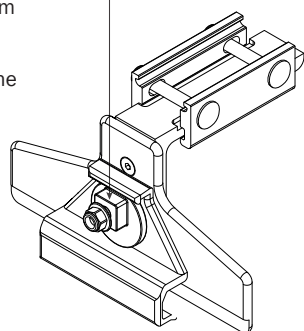

2.2

Ensure the Mounting Bracket Clamps fully seat into the Crossbar bottom grooves as shown. Lightly snug the nuts to allow for adjustment in Step 2.3

Repeat this procedure for all Mounting Brackets.

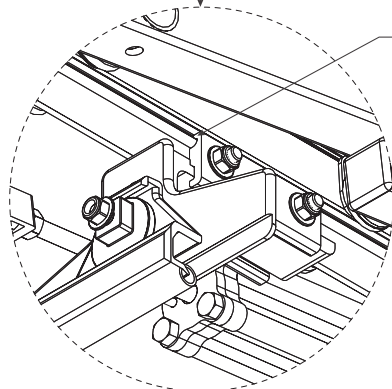

CROSSBARS

Shown with LH Base, and RH Rotation for illustrative purposes only

2.1

Position the applicable Mounting Brackets according to the illustrations shown below while ensuring all bolts protrude inward as noted on page 2.

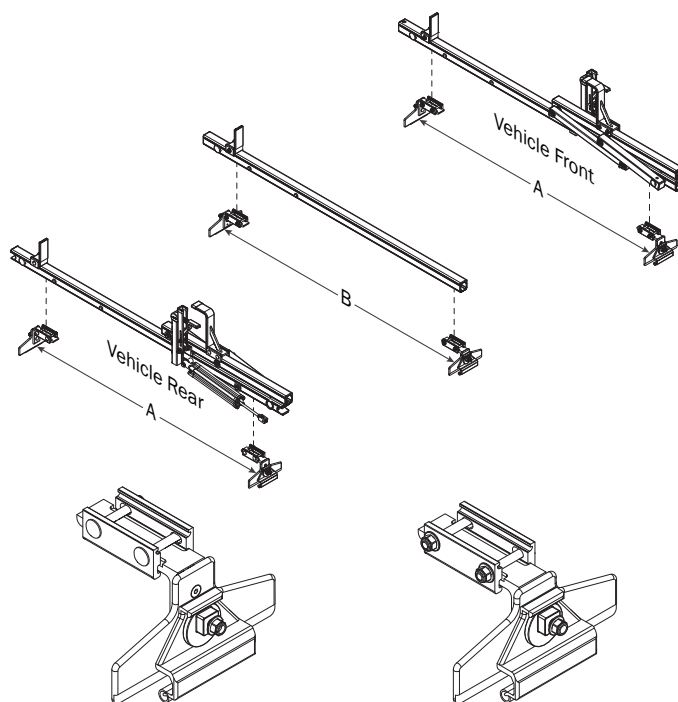

A—Tall Mounting Bracket
Front & Rear Crossbars

B—Short Mounting Bracket
Mid-Crossbar only

CROSSBAR ADJUSTMENT

2.3

Position all Crossbars onto the Mounting Brackets according to the dimensions shown below.

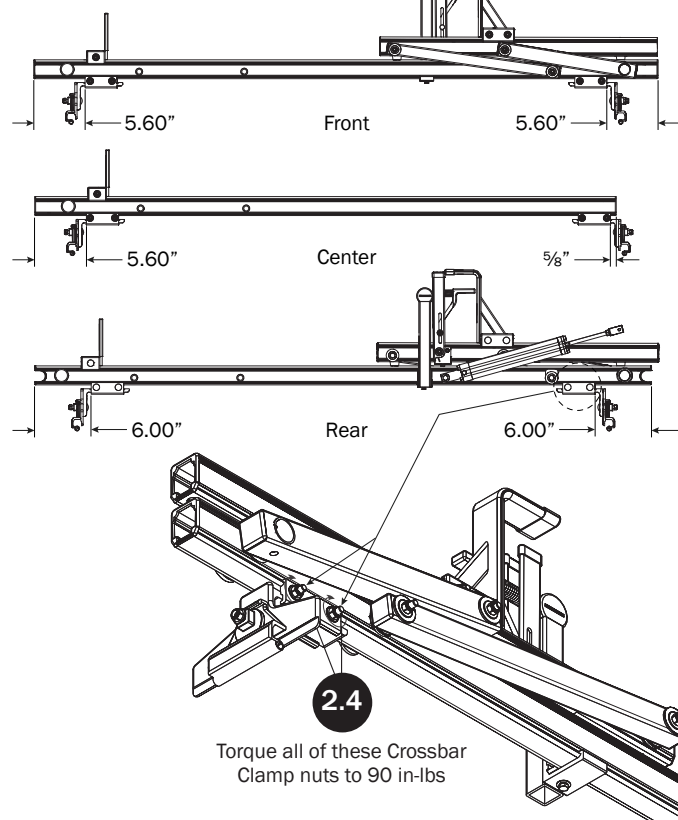

2.4

Torque all of these Crossbar
Clamp nuts to 90 in-lbs

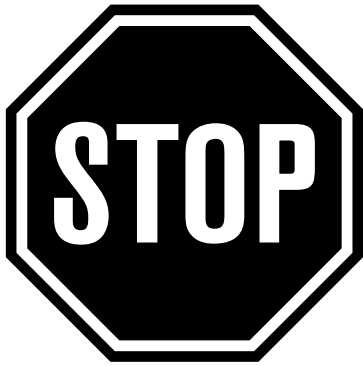

Refer to the respective FEA or AR Assembly Manual(s) included with your chosen rack configuration features. Depending upon the features chosen, you may need to perform a complete feature assembly onto the Crossbars as noted in that feature's Assembly Manual.

WARNING: Failure to position the Crossbars as shown in this FBM Assembly Manual may result in damage to the vehicle and/or ladder rack.

NOTE: Crossbars, Side Rails, Base, Clamp Down, or Rotation features are not included in this FBM kit, and must be purchased separately. To purchase applicable features and accessories, please contact your authorized distributor, or a Prime Design Sales & Service Representative.

VEHICLE MOUNTING SEQUENCE

3.1 Set to distances shown below:

Beginning with the Rear Crossbar, position it on the vehicle's roof, then proceed to Step 3.2 to tighten the Rear Crossbar Mounting Brackets in place. Place the remaining Crossbar(s) onto the roof and set according to designated dimensions shown below, but do not tighten. Proceed to your Feature (FEA) Assembly Manual if required.

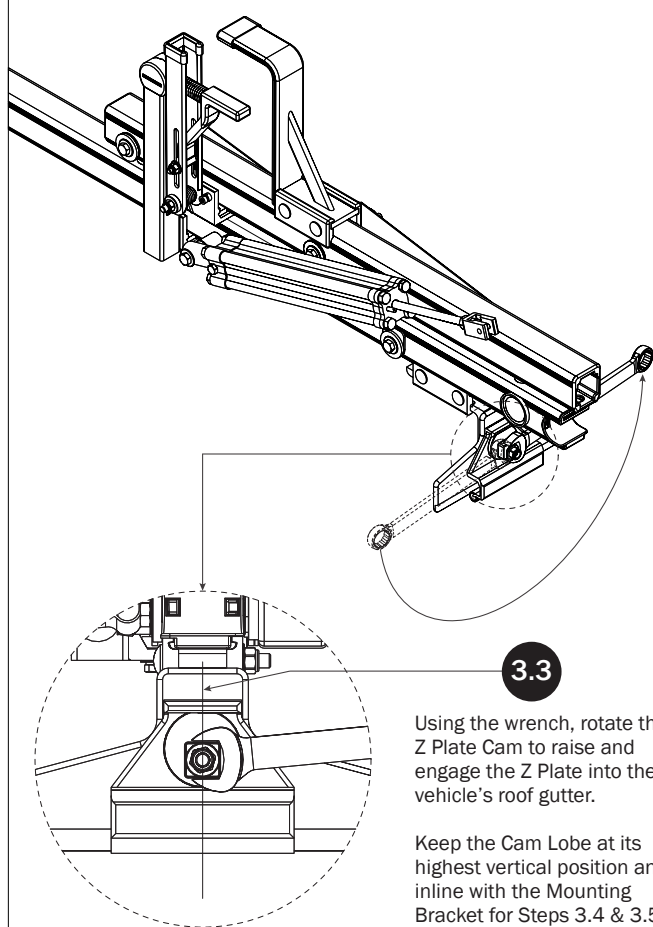
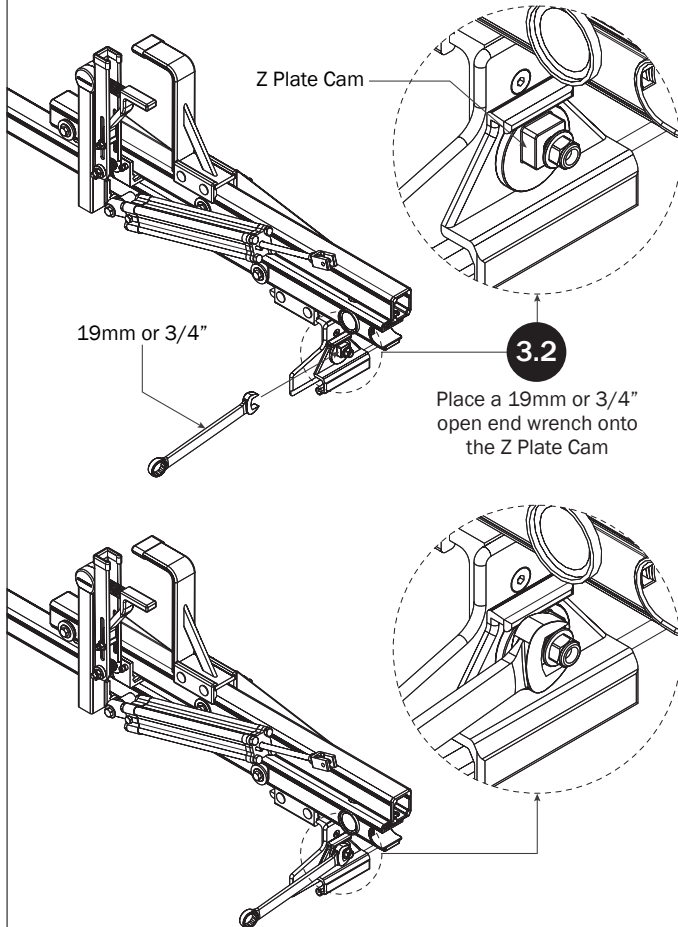
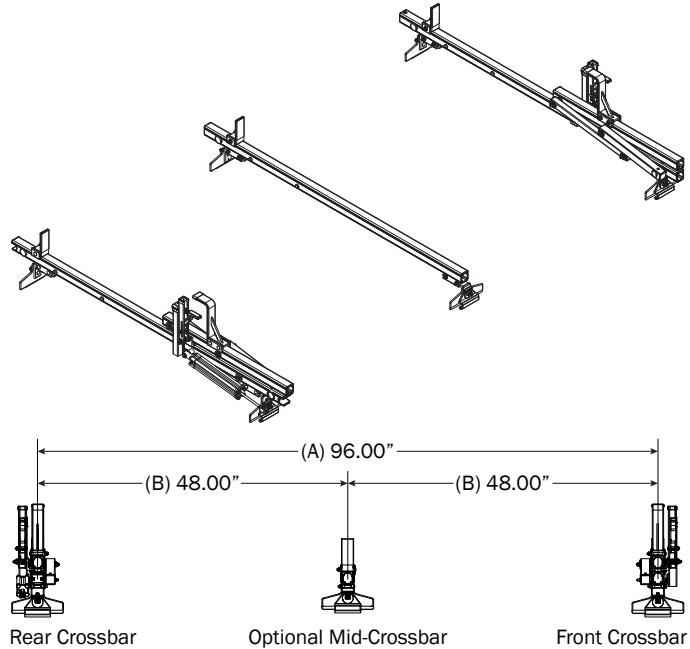

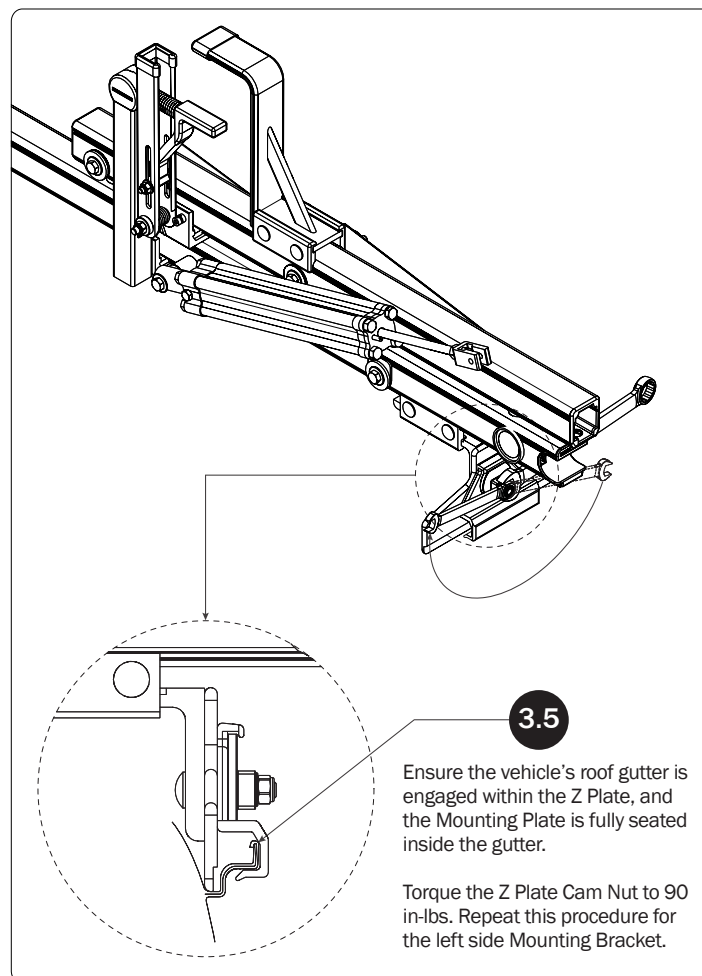
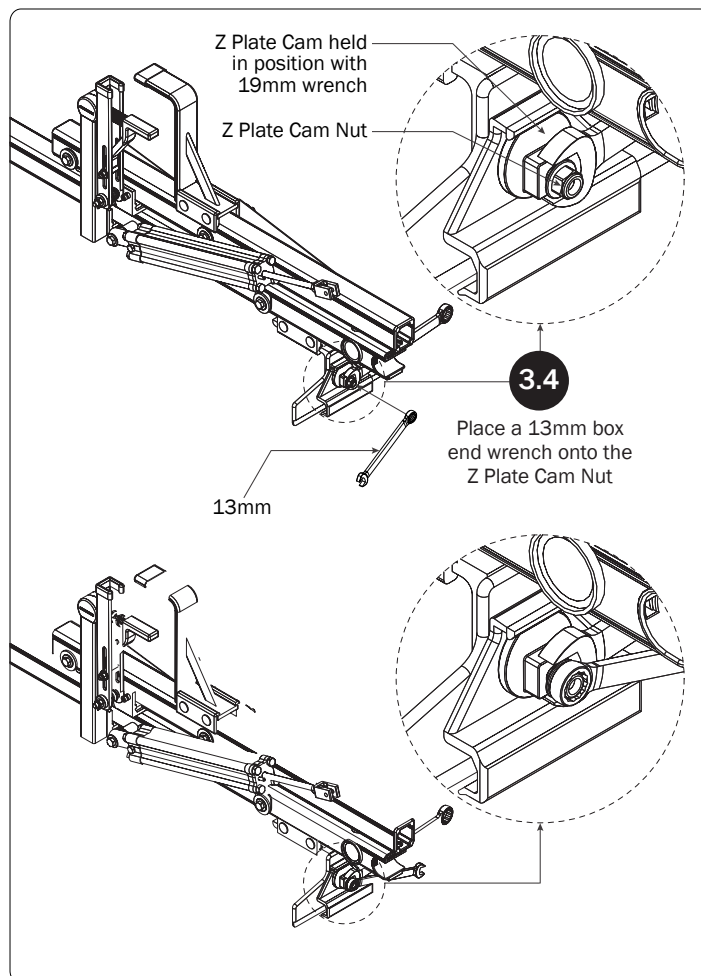

- 3.6 Verify positioning of the Front Crossbar and Mid Crossbar, then proceed with the designated Mounting Bracket tightening sequence performed during Steps 3.1–3.5.

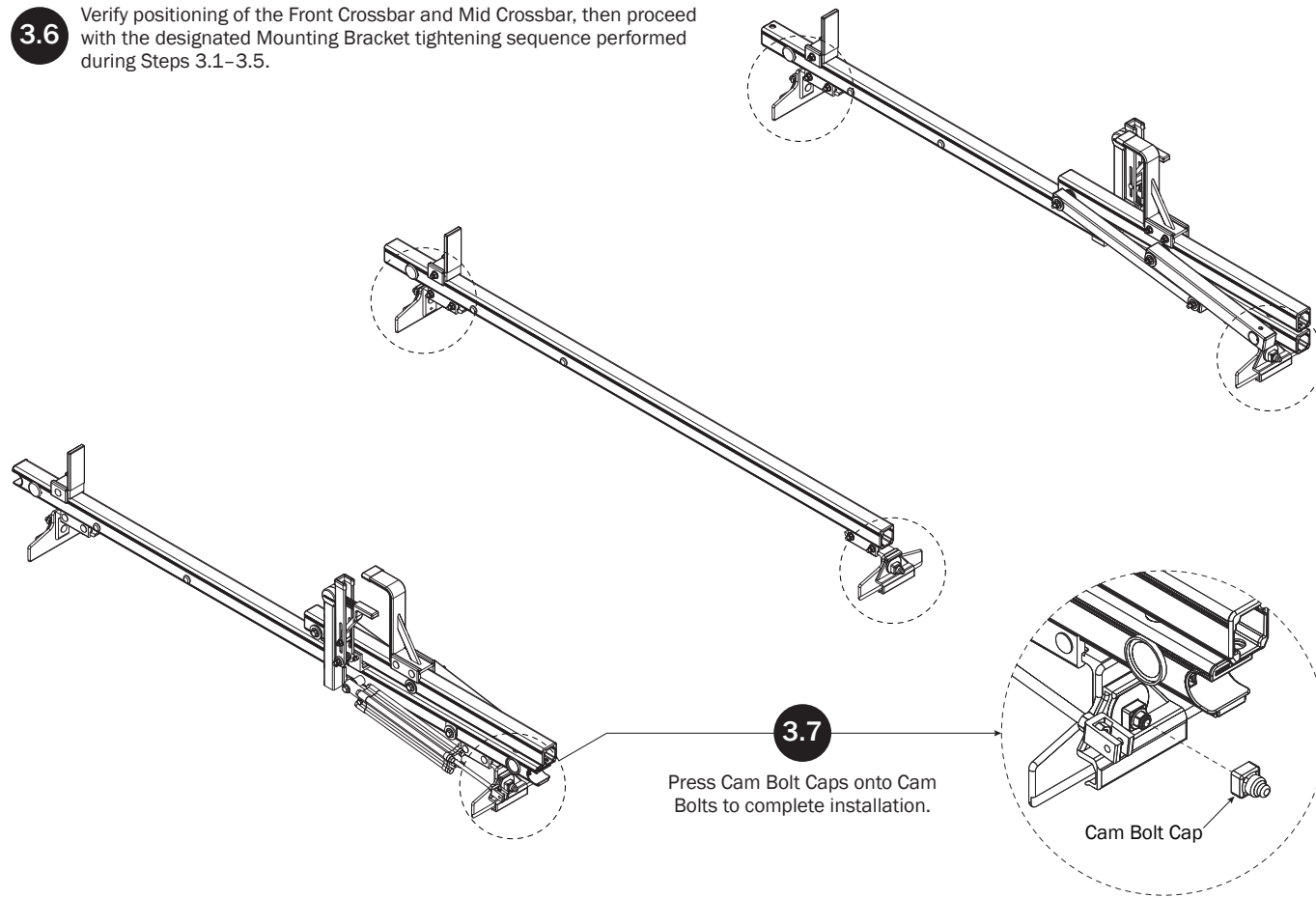

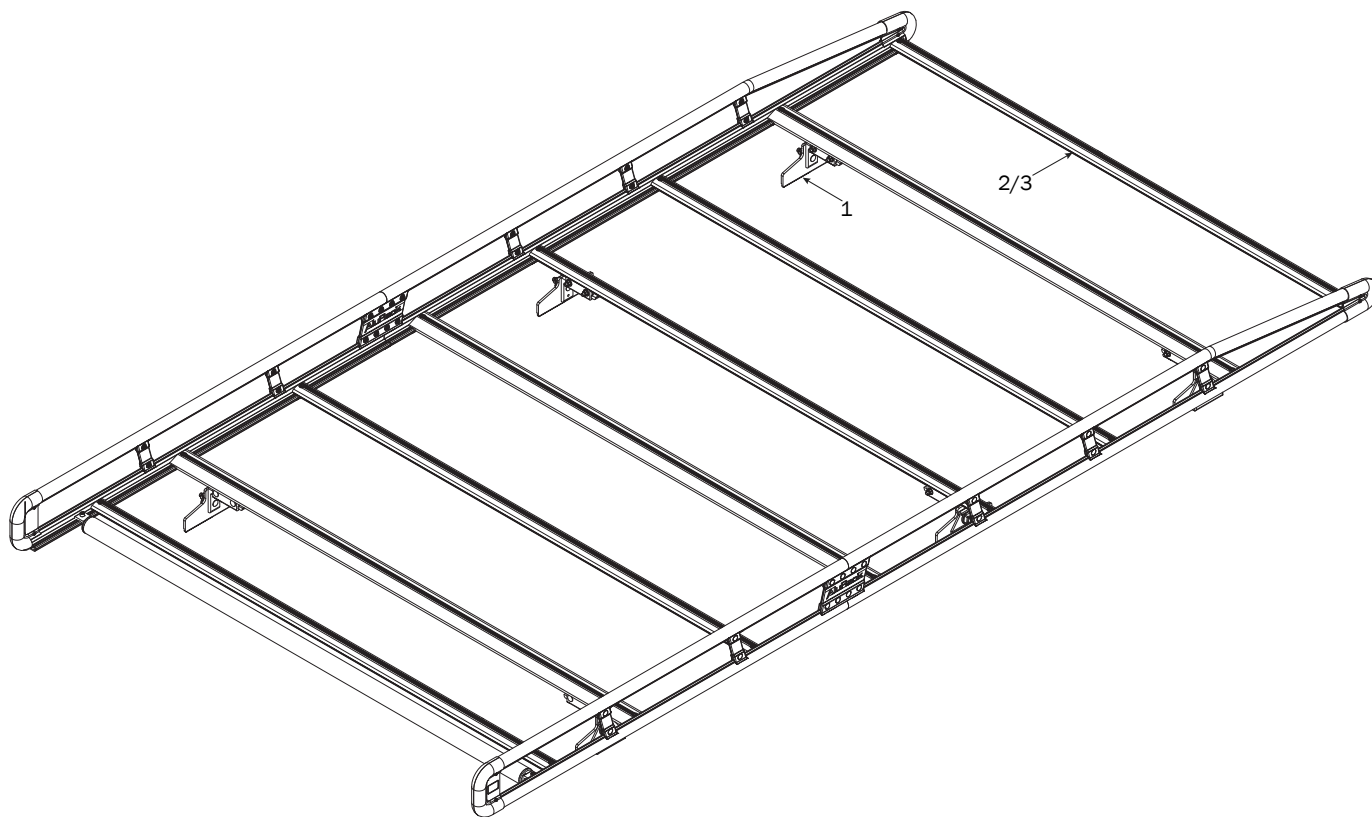

MOUNTING BRACKETS

Set aside two of six Mounting Brackets, and perform Steps 1.1–1.6 to all, then proceed to Step 2.1

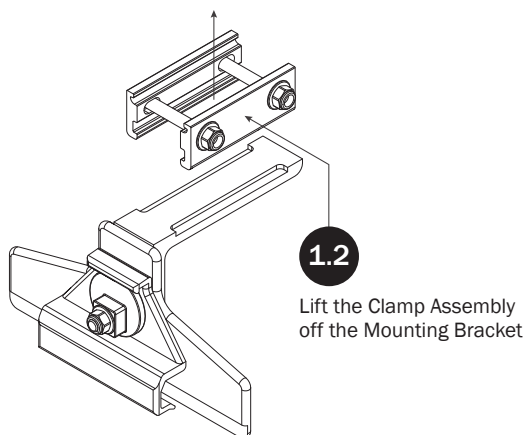
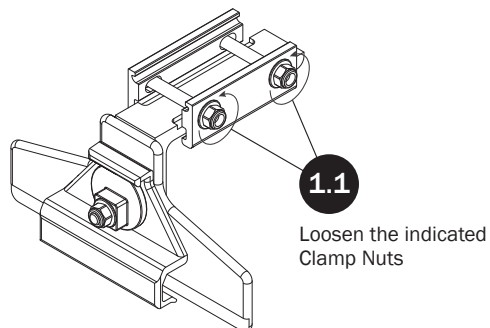

Rotate the Clamp
Assembly 180°

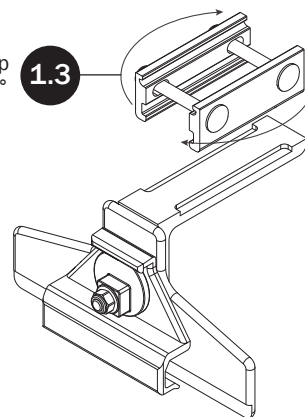

Lower the Clamp Assembly onto
the Mounting Bracket. Tighten
only enough to retain Clamps on
Mounting Bracket.

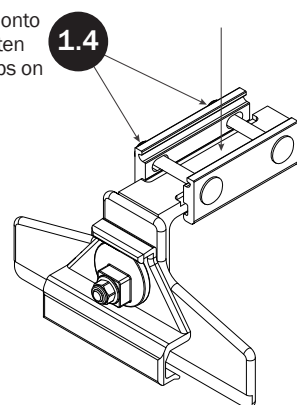

1.5

Loosen the Mounting Z Plate Cam Nut, but do not remove

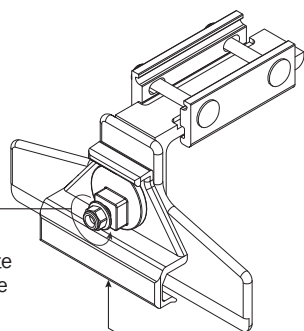

Z Plate

1.6

Rotate the Mounting Z Plate Cam 180° to allow the Z Plate to rest at its full bottom position. Do not tighten the Cam Nut until Step 3.4. Repeat Steps 1.1–1.6 for the second Mounting Bracket.

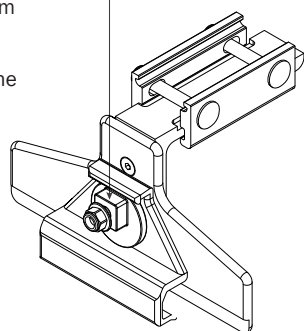

CROSSBARS

Shown with GM AluRack for illustrative purposes only

2.1

Position the applicable Mounting Brackets according to the illustrations shown below while ensuring all bolts protrude inward as noted on page 2.

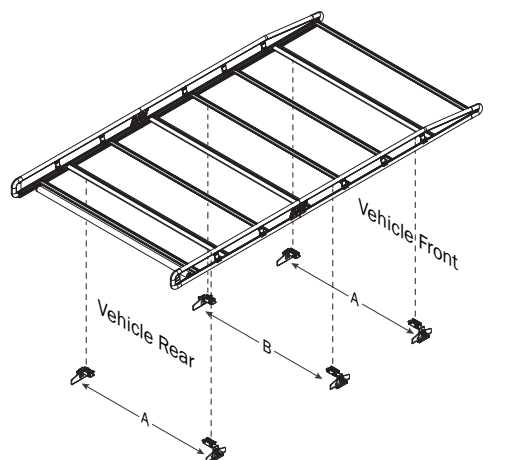

A—Tall Mounting Bracket
Front & Rear Crossbars

B—Short Mounting Bracket
Mid—Crossbar only

CROSSBAR ADJUSTMENT

2.3

Position Crossbars onto the Mounting Brackets according to the dimensions shown below.

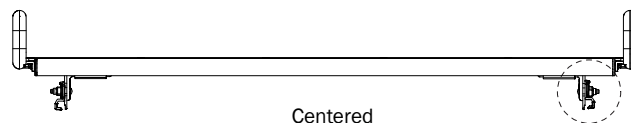

Centered

Torque all of these Crossbar
Clamp nuts to 90 in-lbs

2.4

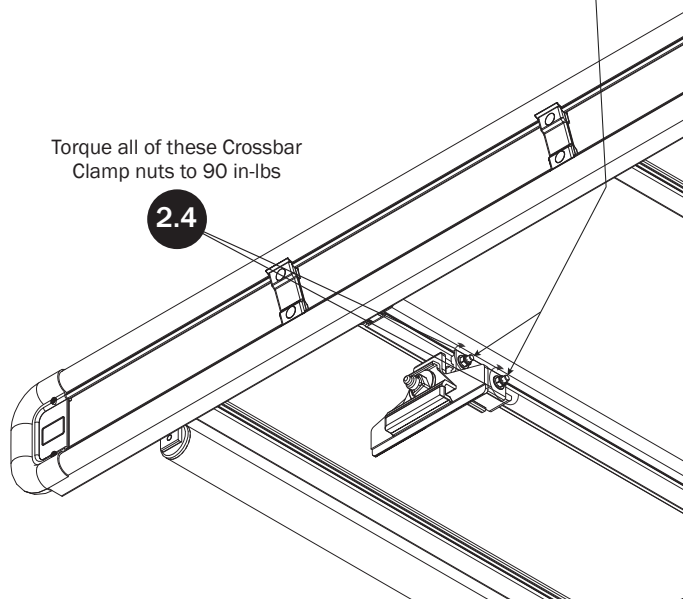

2.2

Ensure the Mounting Bracket Clamps fully seat into the Crossbar bottom grooves as shown. Lightly snug the nuts to allow for adjustment in Step 2.3

Repeat this procedure for all Mounting Brackets.

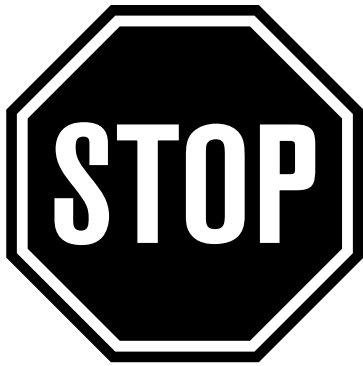

Refer to the respective FEA or AR Assembly Manual(s) included with your chosen rack configuration features. Depending upon the features chosen, you may need to perform a complete feature assembly onto the Crossbars as noted in that feature's Assembly Manual.

WARNING: Failure to position the Crossbars as shown in this FBM Assembly Manual may result in damage to the vehicle and/or ladder rack.

NOTE: Crossbars, Side Rails, Base, Clamp Down, or Rotation features are not included in this FBM kit, and must be purchased separately. To purchase applicable features and accessories, please contact your authorized distributor, or a Prime Design Sales & Service Representative.

VEHICLE MOUNTING SEQUENCE

3.1 Set to distances shown below:

Beginning with the Rear Crossbar, position it on the vehicle's roof, then proceed to Step 3.2 to tighten the Rear Crossbar Mounting Brackets in place. Place the remaining Crossbar(s) onto the roof and set according to designated dimensions shown below, but do not tighten. Proceed to your Feature (FEA) Assembly Manual if required.

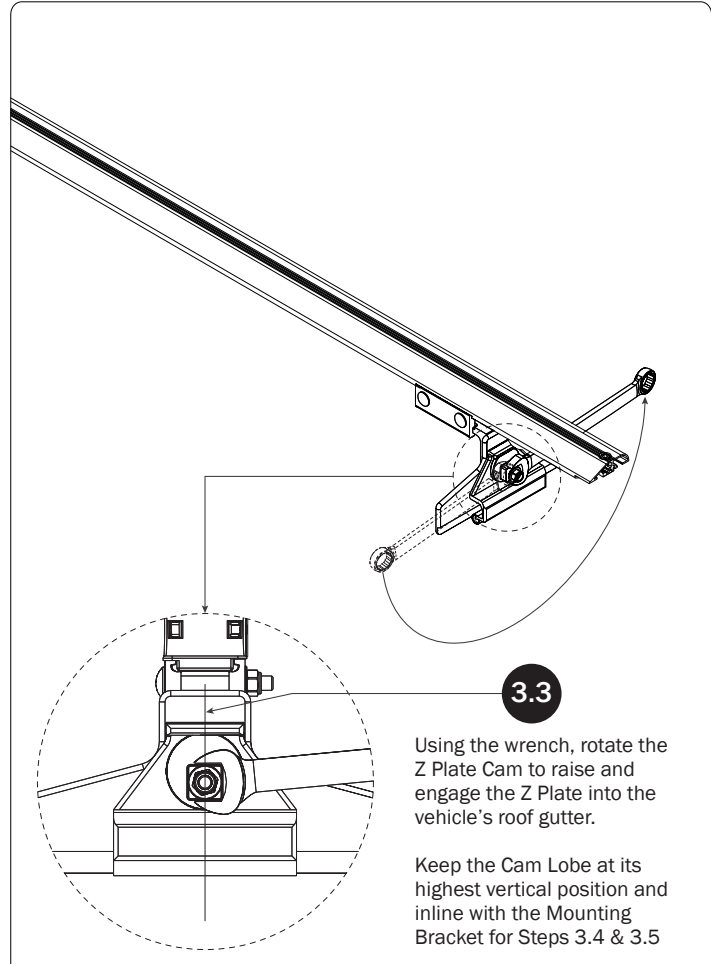
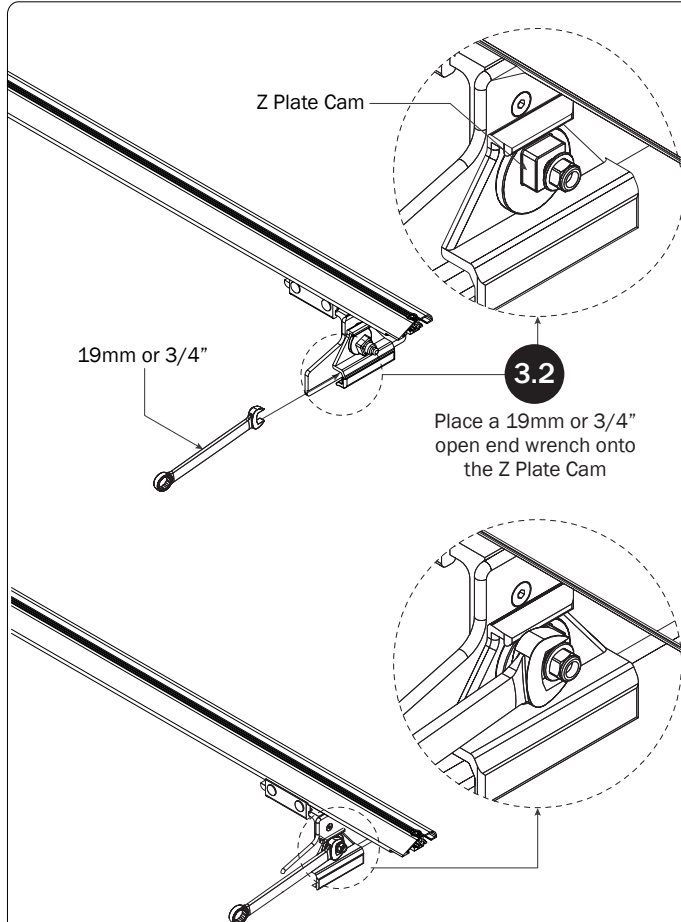
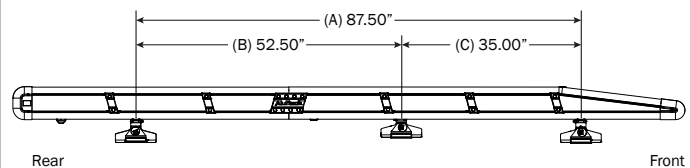
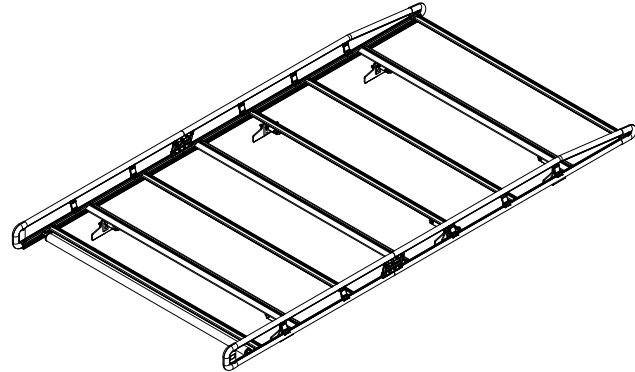

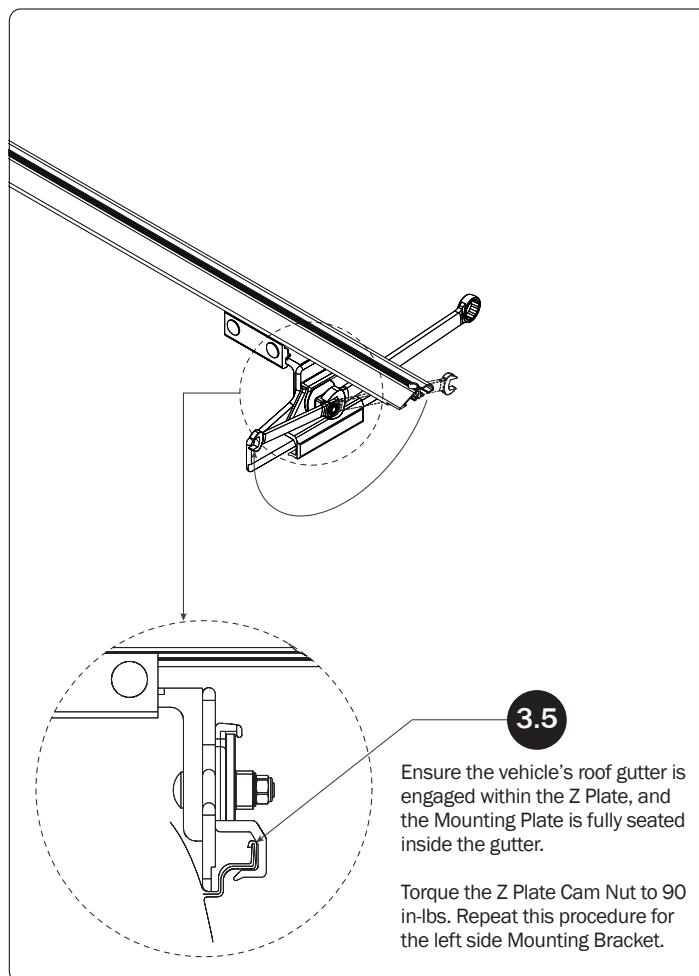
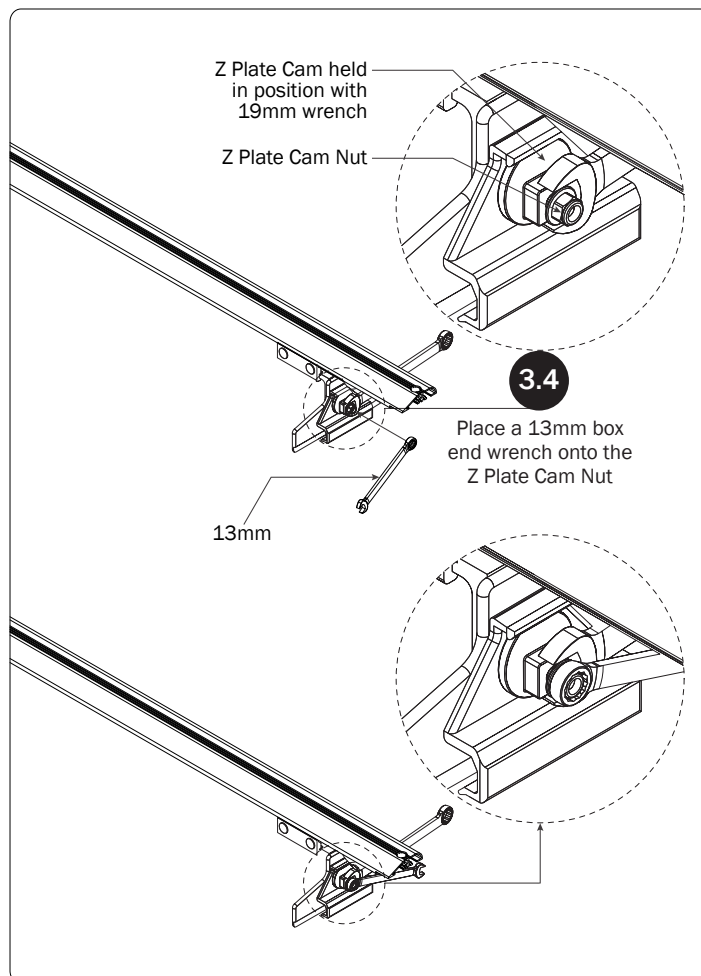

- 3.6 Verify positioning of the Front Crossbar and Mid Crossbar, then proceed with the designated Mounting Bracket tightening sequence performed during Steps 3.1–3.5.

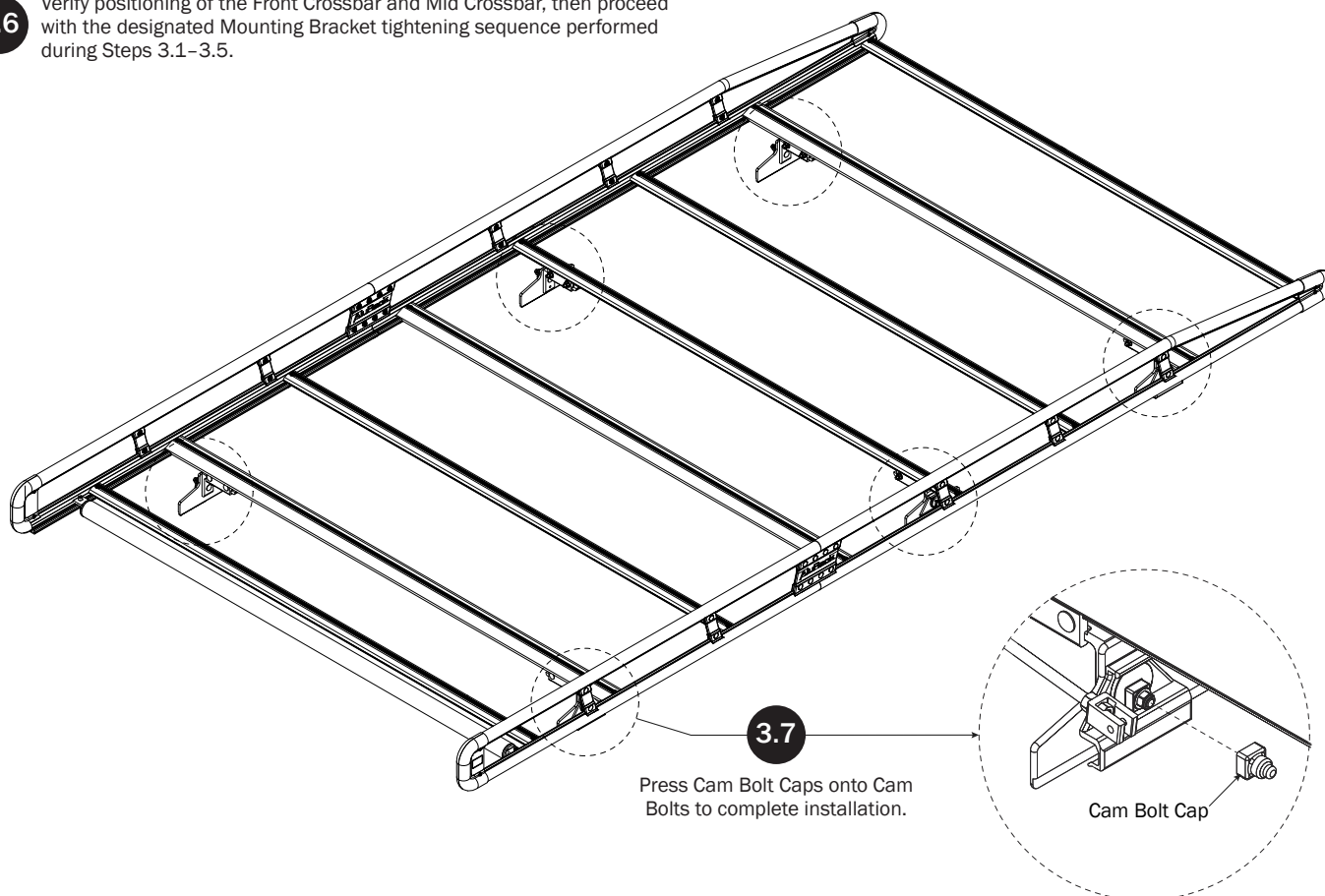

Page Intentionally Left Blank

