

PRIME DESIGN™

A Safe Fleet Brand

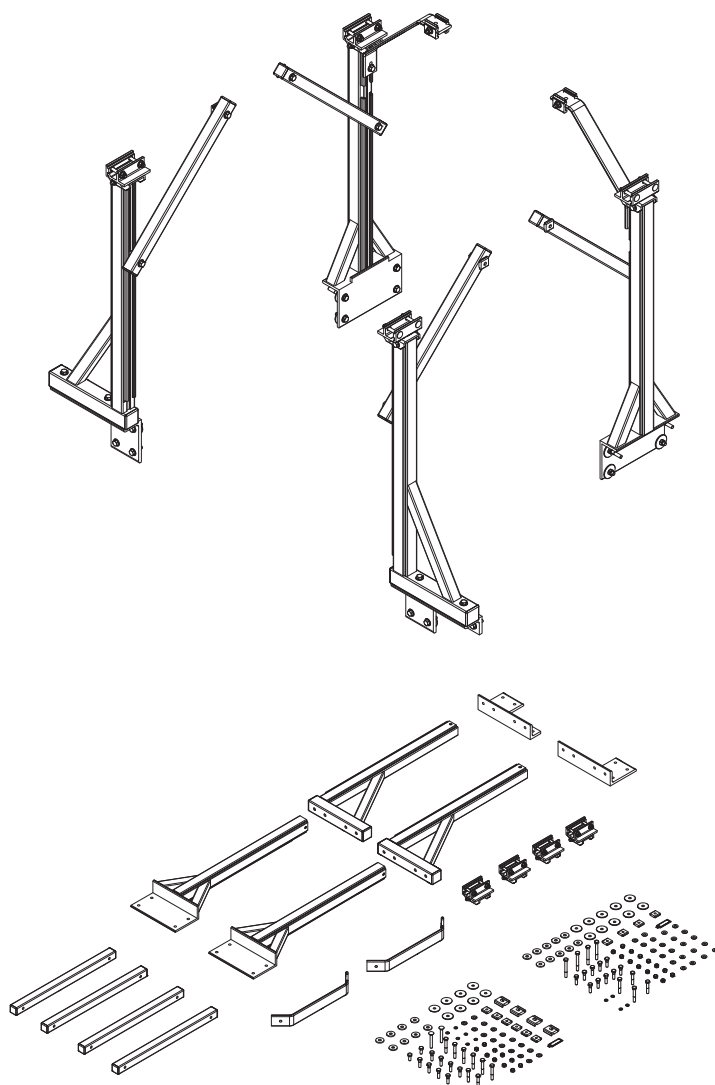

OTC Mounting System—Low-Profile Height Service Body, Flip Top Lid Model

Pages 2-4	Packaging Contents
Pages 5-8	FBM Mounting
Page 9	Mounting to OTC Channels
Pages 9-11	Installing Mount Braces

PRIME DESIGN, A SAFE FLEET BRAND

Address: 580 Opperman Drive, Eagan, MN 55123 • Toll Free: 1.8.PRIME.RACK
Fax: 651-552-1799 • Email: info@primedesign.net • Website: www.primedesign.net

FBM-1063

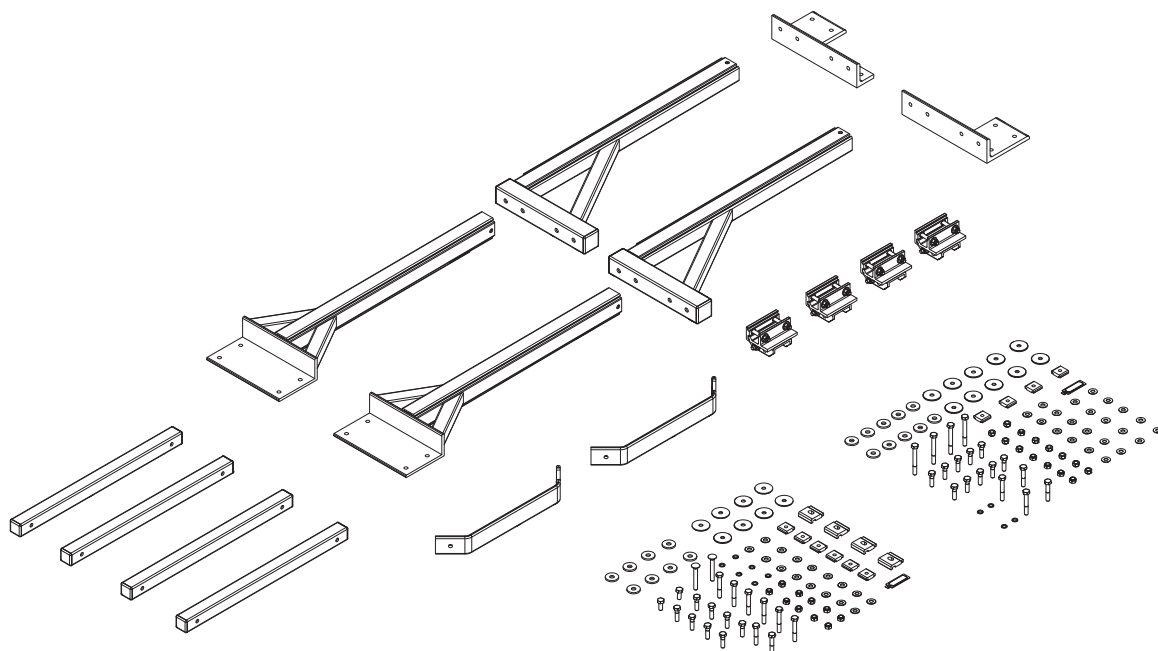

Front Base Mounting Leg..... (Qty 2)

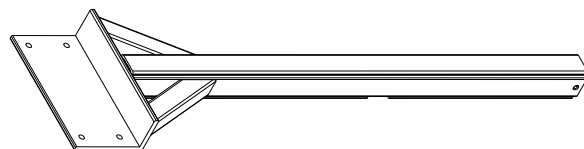

Rear Base Mounting Leg (Qty 2)

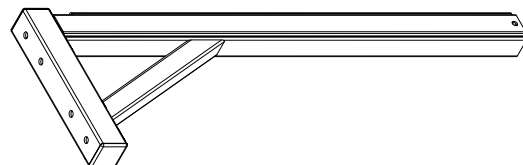

Mounting Leg Connector Assembly (Qty 4)



Rear Mounting Leg Bracket..... (Qty 2)

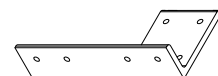

Crossbar Mounting Brace..... (Qty 2)

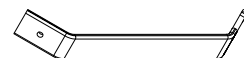

Channel Mounting Brace..... (Qty 4)

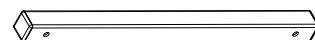

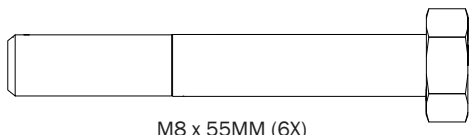

M8 x 55MM (6X)

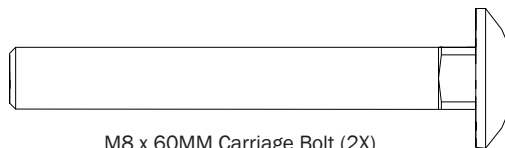

M8 x 60MM Carriage Bolt (2X)

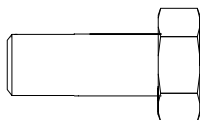

M8 x 20MM (2X)

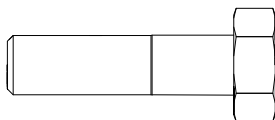

M8 x 30MM (8X)

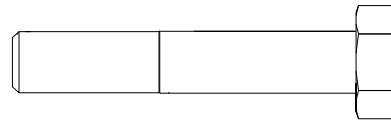

M8 x 45MM (2X)

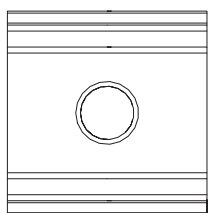

M8 Nut Bracket (6X)

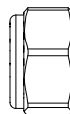

M8 Lock Nut (10X)

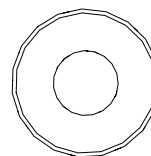

$\frac{5}{16}$ " Flat Washer (16X)

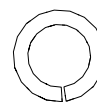

Lock Washer (6X)

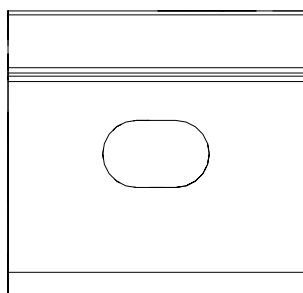

Crossbar Mounting Connector (4X)

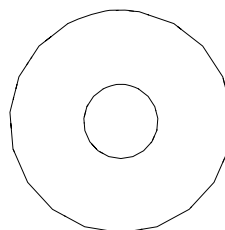

Rubber Washer (8X)

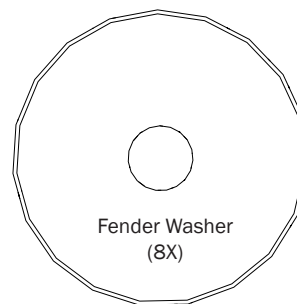

Fender Washer (8X)



Anti-Seize

HKT-8064 Rear Mount Hardware Kit

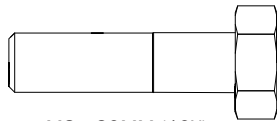

M8 x 30MM (10X)

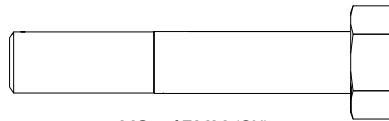

M8 x 45MM (2X)

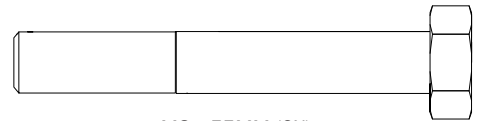

M8 x 55MM (2X)

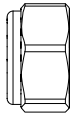

M8 Lock Nut (14X)

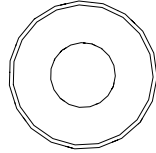
 $\frac{5}{16}$ " Flat Washer (22X)

Lock Washer (4X)

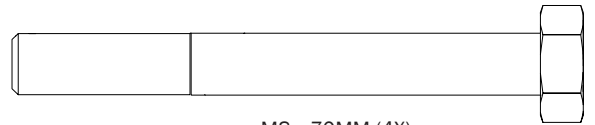

M8 x 70MM (4X)

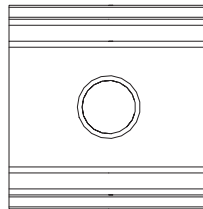

M8 Nut Bracket (4X)

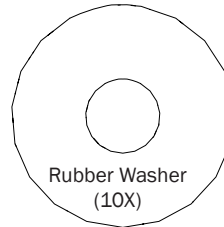
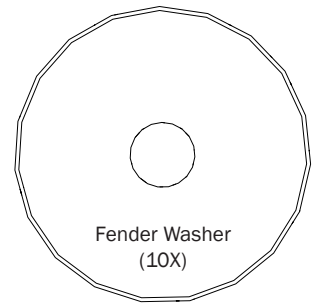
Rubber Washer
(10X)Fender Washer
(10X)

Anti-Seize

OVERVIEW: MOUNTING TO OTC CHANNELS

NOTE: Channels and Crossbars in this Overview are shown for reference only. Specific configurations are determined by Service Body size, and Crossbar preferences.

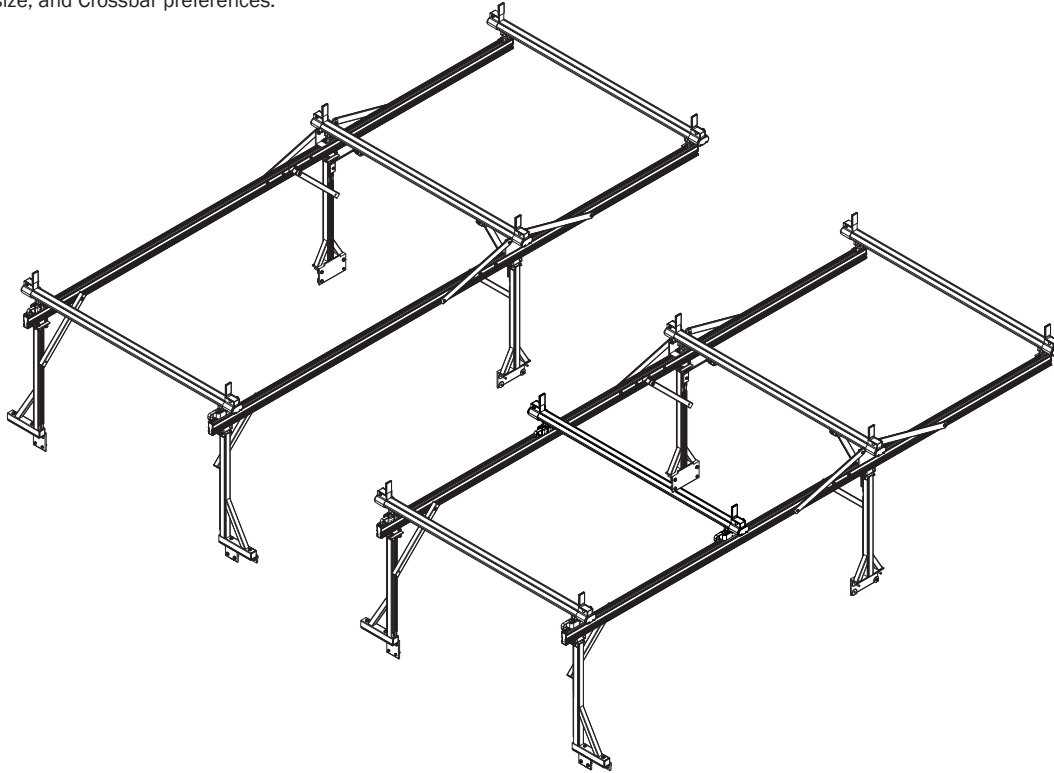

REAR MOUNTING LEG BRACKETS

- 1 Install Rear Mounting Leg Brackets onto the Rear Mounting Legs as shown and torque to 90 in-lbs.

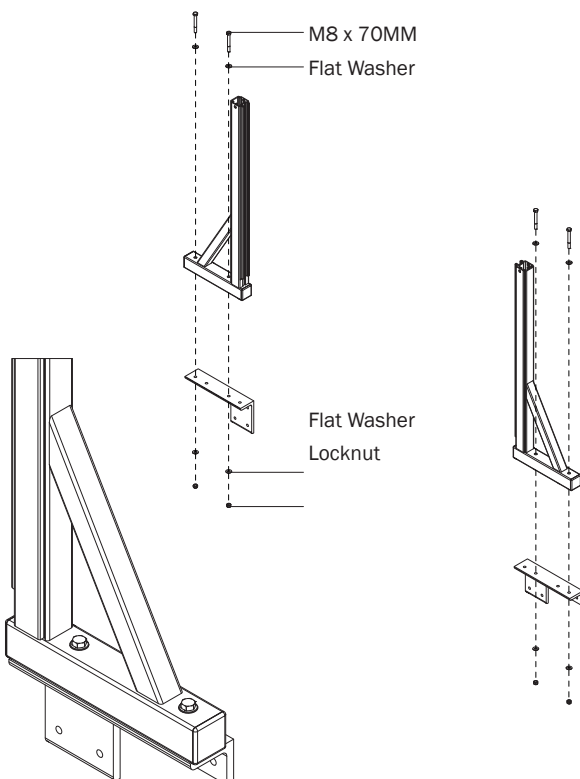

LEG CONNECTORS

- 2.1 Install Mounting Leg Connectors onto the Base Mounting Legs as shown.

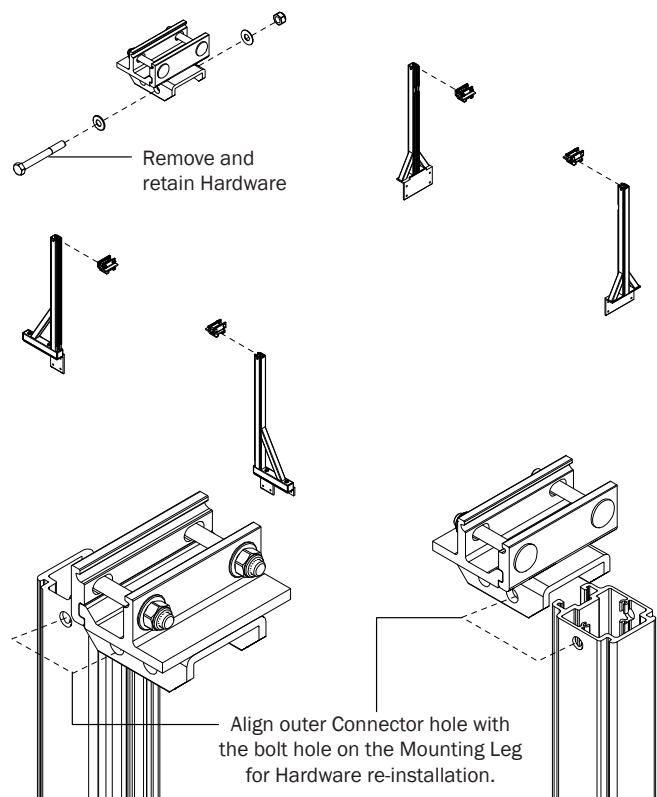

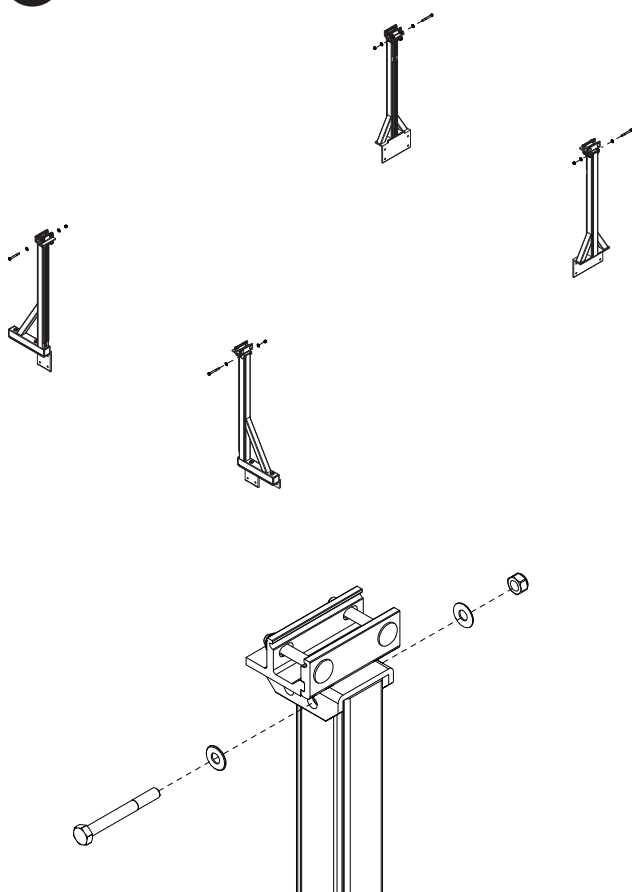
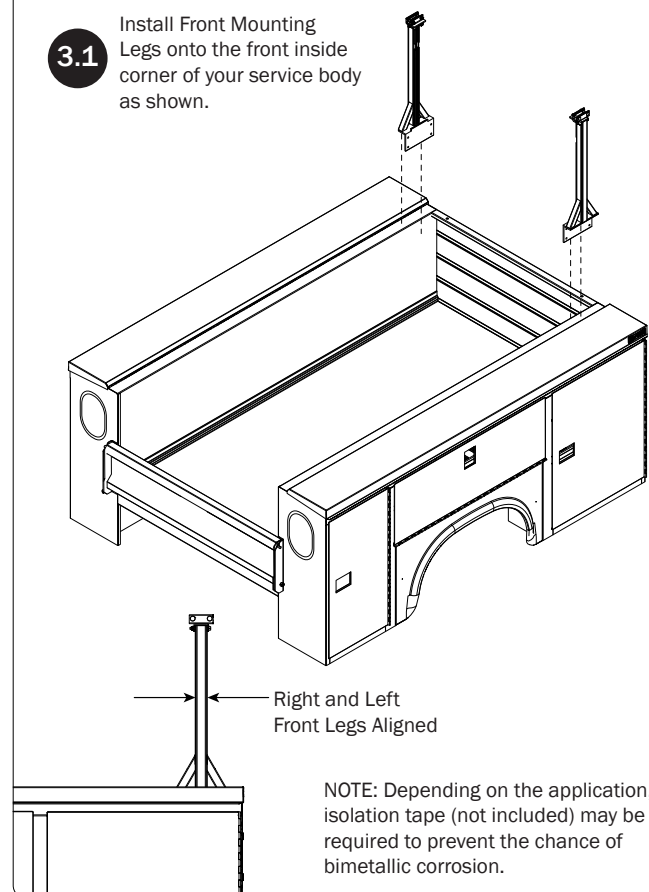
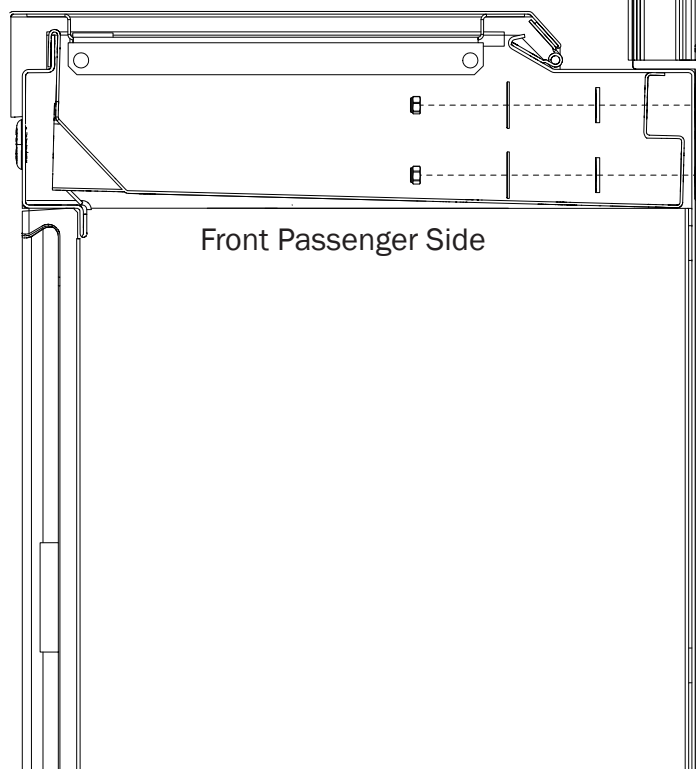
2.2 Re-install Mounting Leg Connector Hardware as shown.**FRONT MOUNTING LEG PLACEMENT****3.1** Install Front Mounting Legs onto the front inside corner of your service body as shown.**FRONT MOUNTING LEG
DRILLING & BOLT SIZING**

M8 x 30MM and M8 x 55MM available the thickness of your utility body. Drill and attach hardware as needed according to your utility body's OEM specifications.

NOTE: Parts of the utility body are cutaway for illustrative purposes

FASTENING FRONT MOUNTING LEGS

- 3.2** Install Hardware with the appropriate bolt size needed for your service body. Torque to 90 in-lbs.

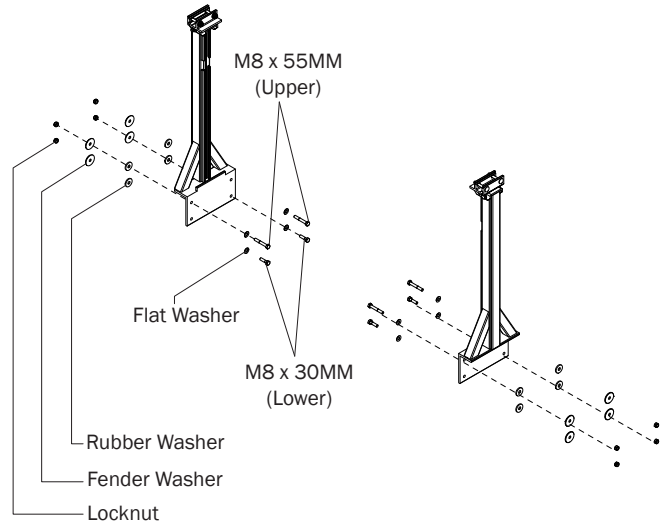
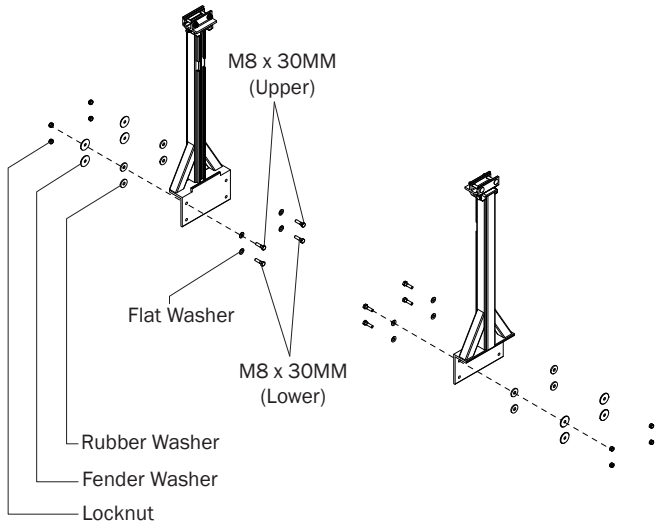

Example shown with utility body requiring the M8 x 55MM bolts in the upper drilling locations.

Front Passenger Side

NOTE: Parts of the utility body are cutaway for illustrative purposes

REAR MOUNTING LEGS

- 4.1** Install Rear Mounting Legs onto the outside rear of your service body as shown.

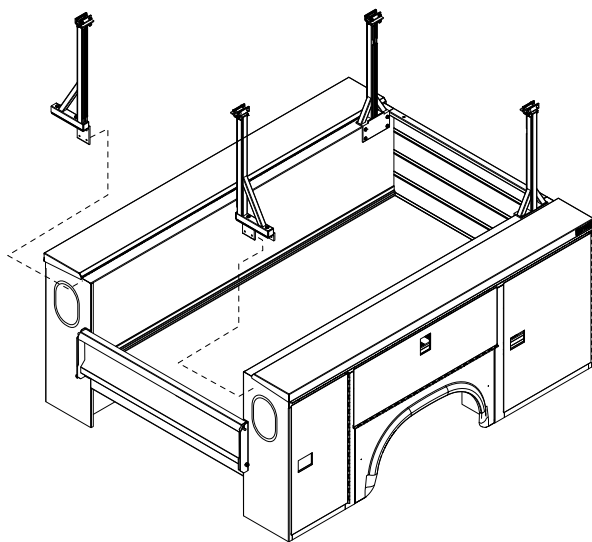

NOTE: Depending on the application, isolation tape (not included) may be required to prevent the chance of bimetallic corrosion.

- 4.3** Ensure alignment and light clearance as shown below.

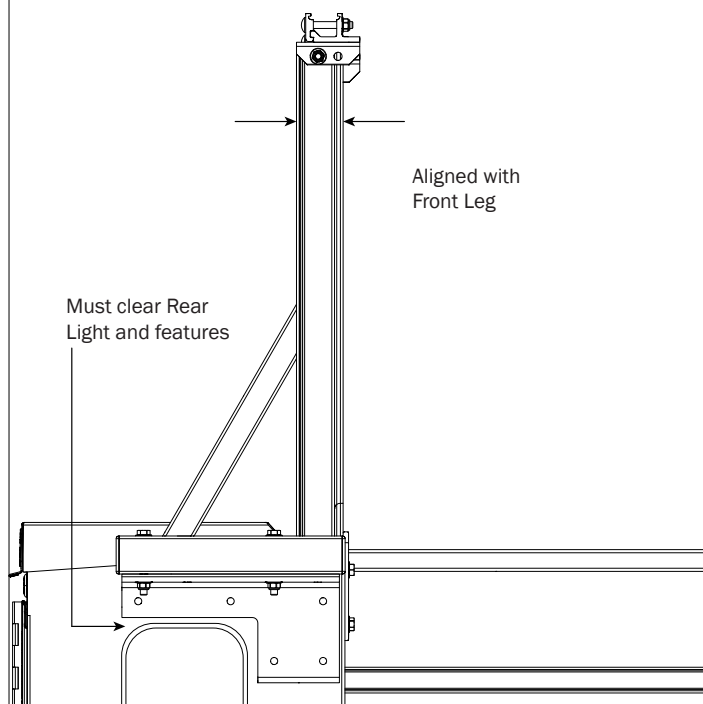

NOTE: Refer to OEM recommendations for the installation of a support or backing plate behind the mounts.

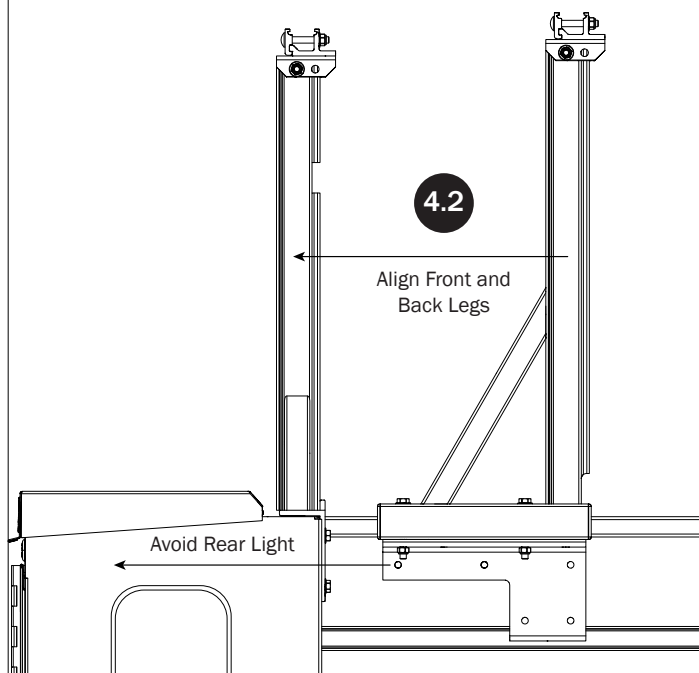

- 4.4** Install Hardware as shown and torque to 90 in-lbs.

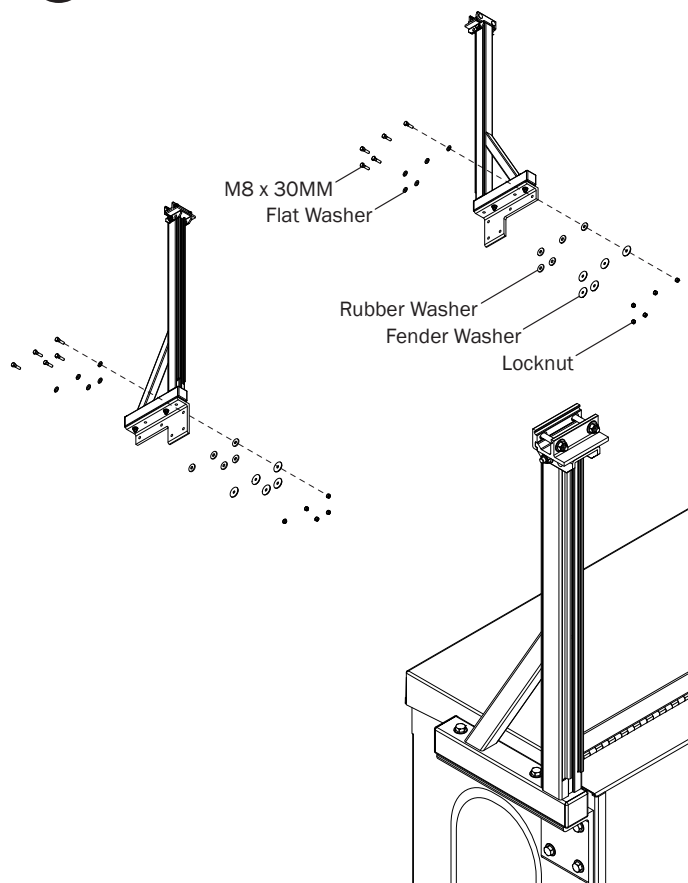

MOUNTING TO CHANNELS

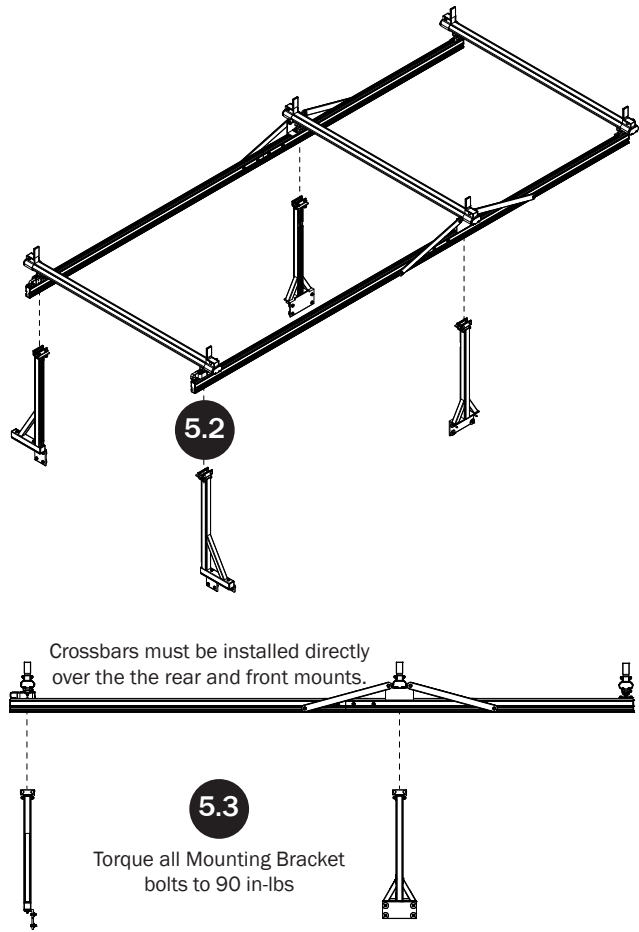
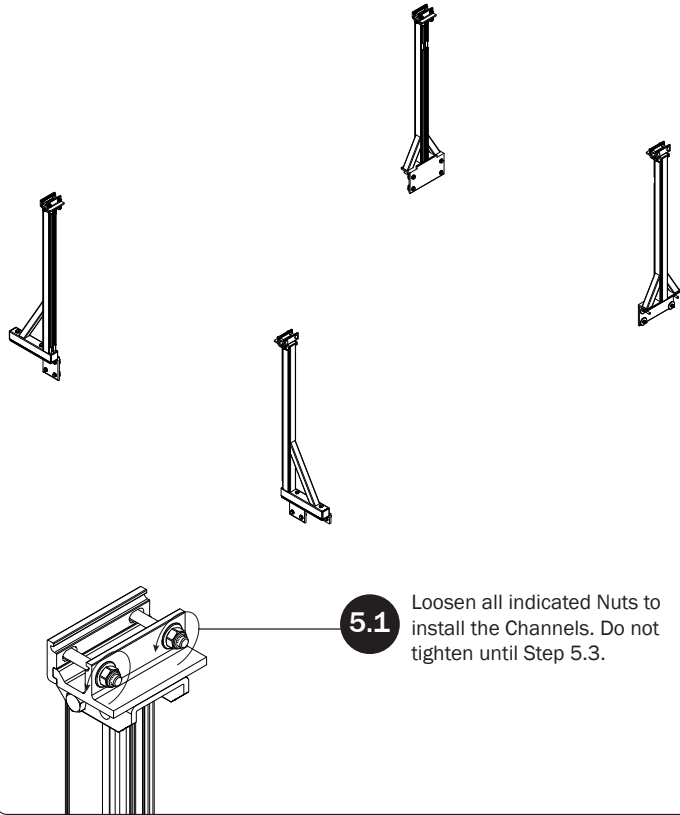

REAR MOUNTING FOOT NUT BRACKETS

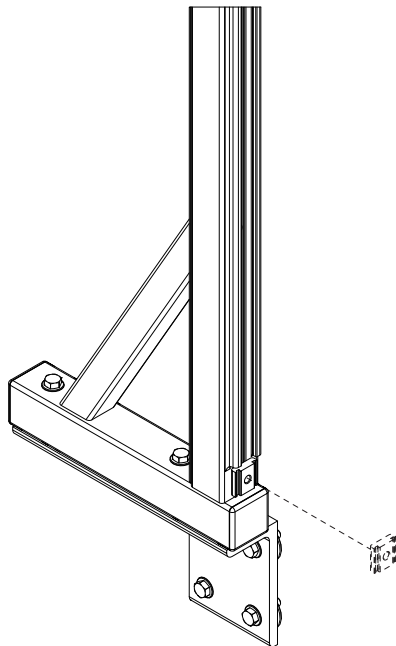

6.1 Install one M8 Nut Bracket in each rear Mounting Foot channel as shown.

FRONT MOUNTING FOOT NUT BRACKETS

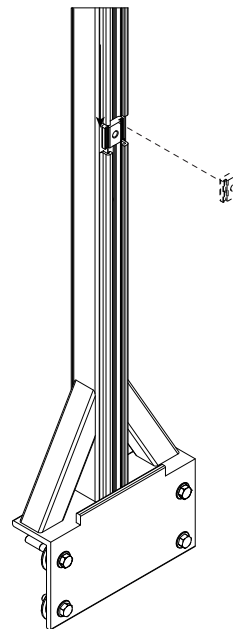

6.2 Install one M8 Nut Bracket in each front Mounting Foot channel as shown.

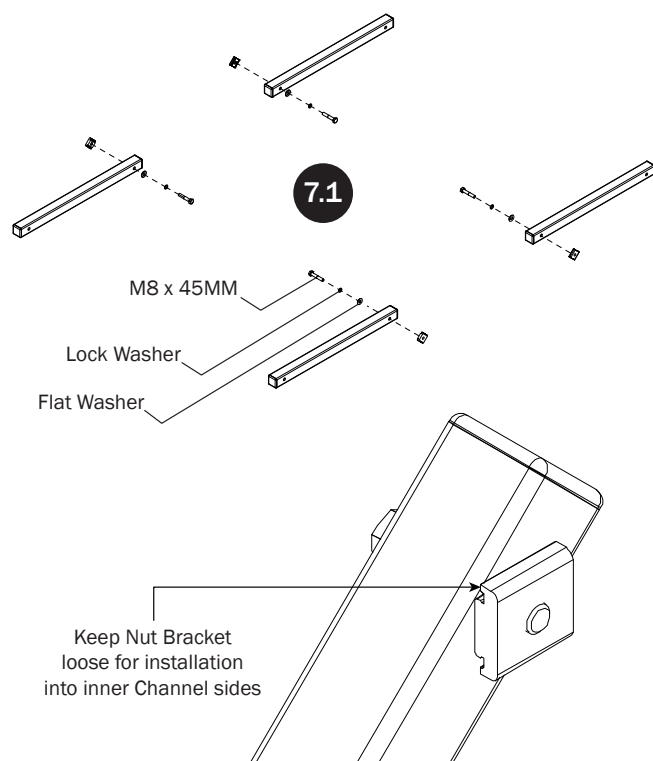
**MOUNTING LEG-CHANNEL
BRACE INSTALLATION**

7.2 Install Braces into the inside of the Channels as shown.

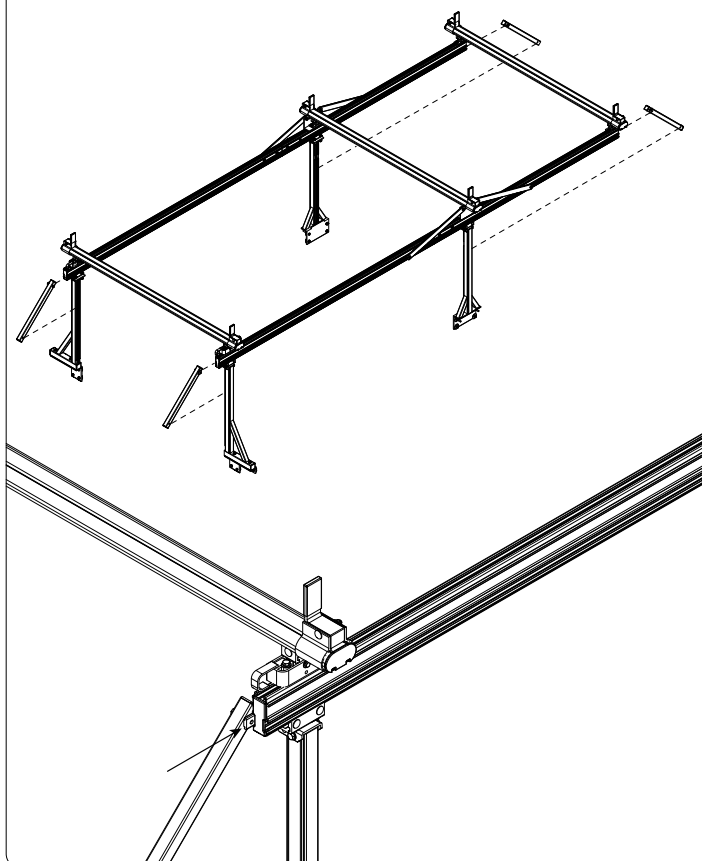

7.3 Install the lower end of the Braces into the Mounting Foot channels using the Nut Brackets installed in Steps 6.1-6.2, and Hardware as shown. Torque to 90 in-lbs.

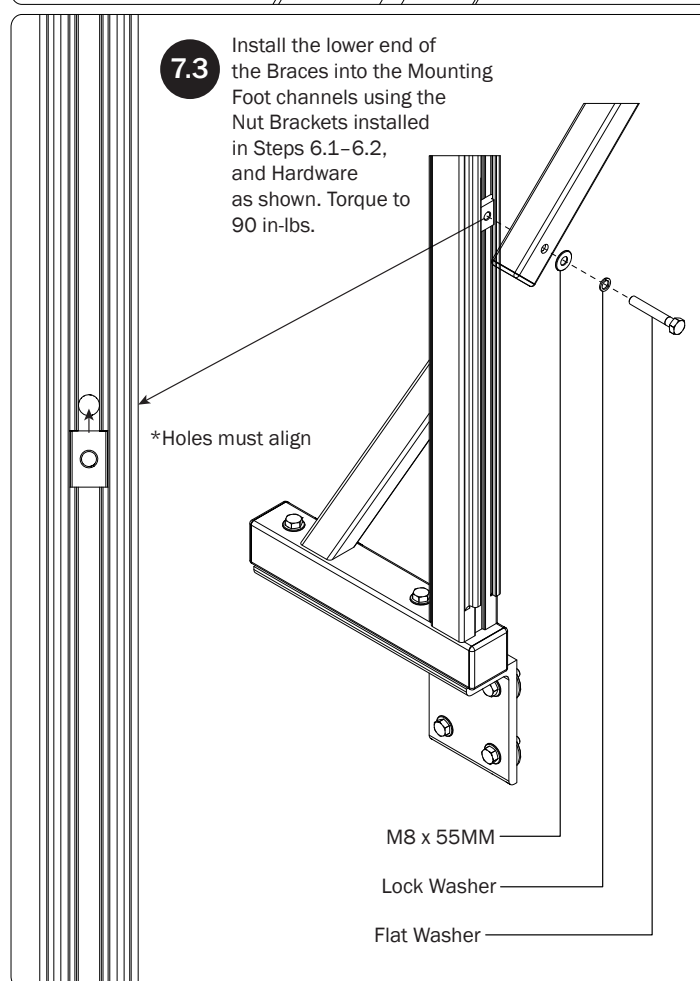
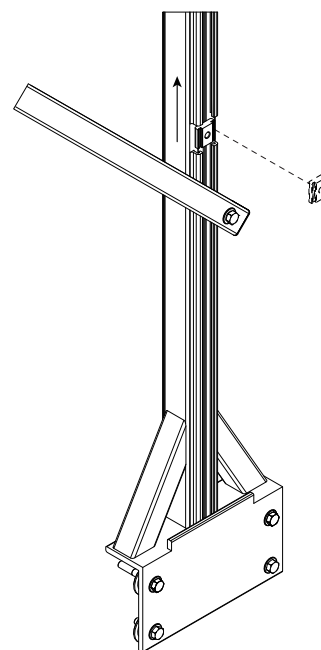
**ADDITIONAL FRONT MOUNTING
FOOT NUT BRACKETS**

8 Install a second M8 Nut Brackets in each front Mounting Foot channel as shown.

MID CROSSBAR BRACE INSTALLATION

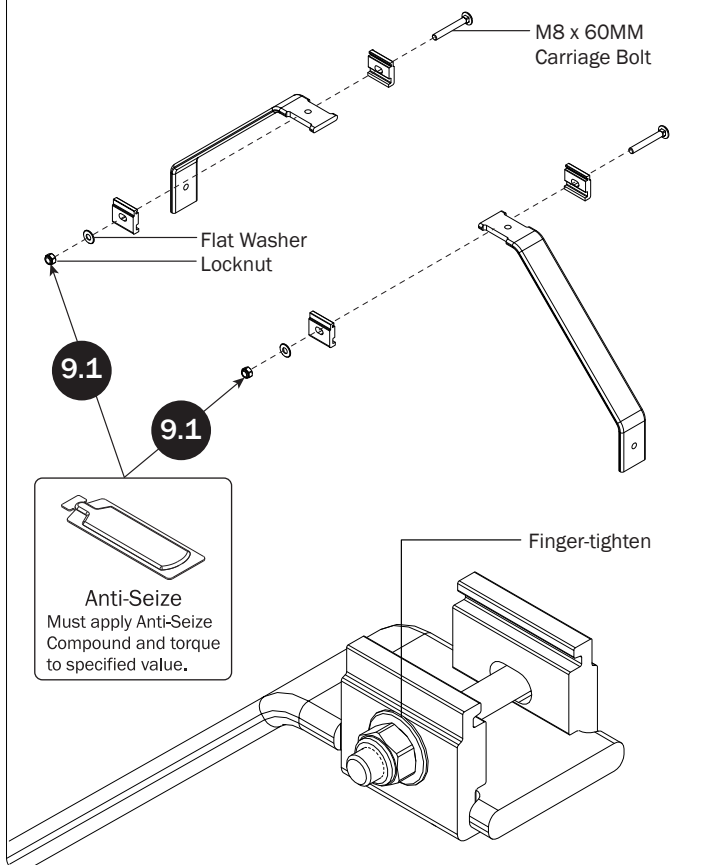

9.2 Install the mid Crossbar Braces as shown. Do not torque until Step 9.3.

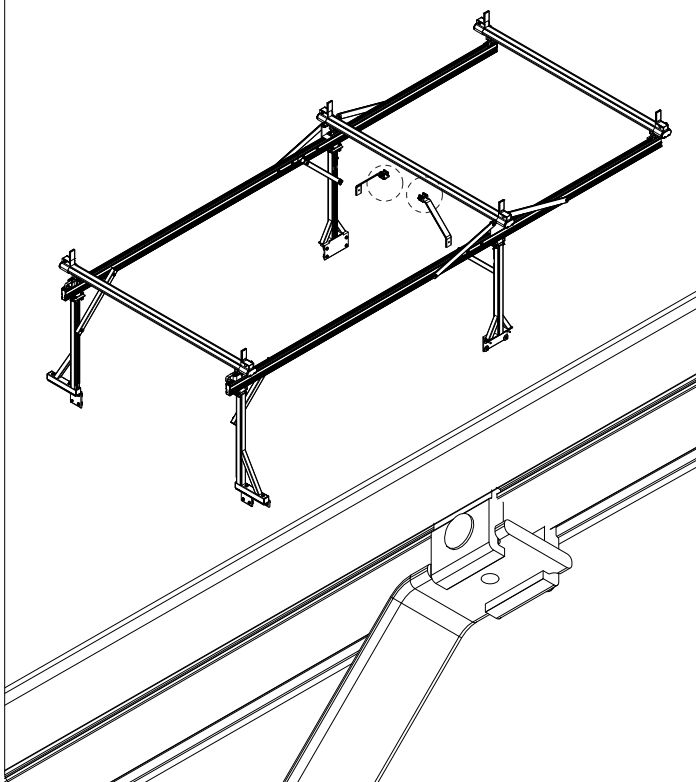

9.3 Install the mid Crossbar Brace Hardware into the top Nut Bracket from Step 8 as shown. Torque all Hardware to 90 in-lbs.

