

# PRIME DESIGN™

A Safe Fleet Brand

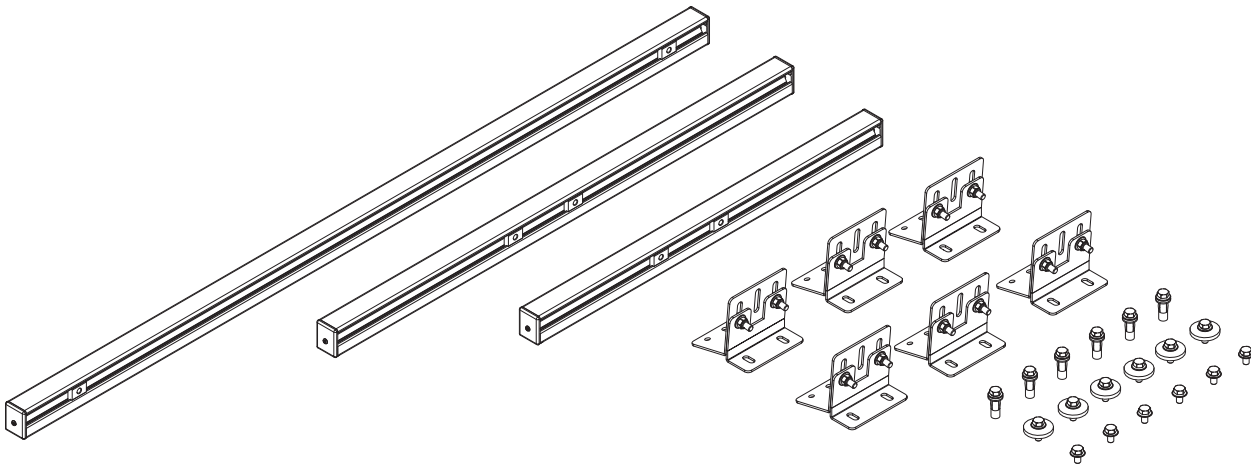

2 Person Lift Recommended

## Cantilever Shelving Mounting Assembly– Ford Transit High Roof

Page 2	Packaging Contents
Page 3–4	Requirements
Pages 4–5	Assembly Instructions

# CSM-1001

## CONTENTS OVERVIEW

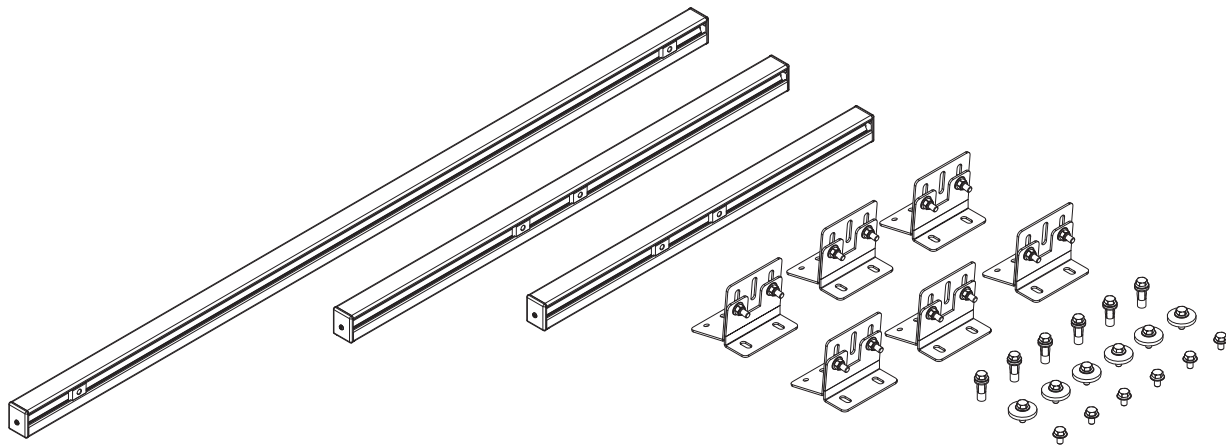

1—Cantilever Shelving Mounting System ..... (Qty 1)  
Ford Transit, High Roof



Interior Mounting Assembly (6X)



51.00" Mounting Channel Assembly (1X)

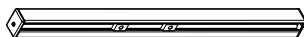

24.00" Mounting Channel Assembly (1X)



32.00" Mounting Channel Assembly (1X)

2—HKT-0203 ..... (Qty 1)

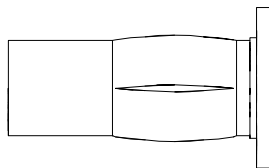

Nut Rivet (6X)

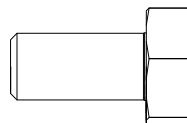

M8 x 18MM (6X)

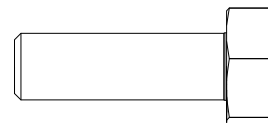

M8 x 25MM (12X)

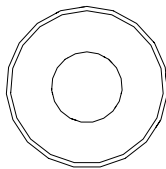

Flat Washer (18X)

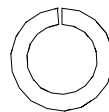

Lock Washer (18X)

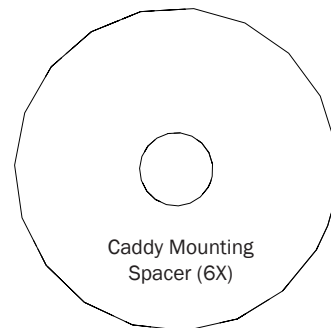
Caddy Mounting  
Spacer (6X)

3—Hardware supplied in Cantilever Shelving Upright  
Packaging (CSU-3001 or CSU-3002)-sold separately.

\* Used in Step 4

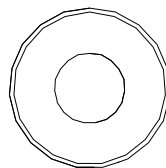

Flat Washer (1X)

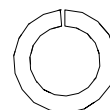

Lock Washer (1X)

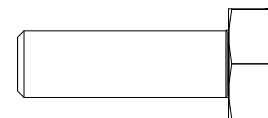

M8 x 25MM (1X)

## ASSEMBLY REQUIREMENTS



**INSTALLER NOTE:** *It is important to correctly follow these assembly instructions. These instructions for assembly are provided by the manufacturer at time of Cantilever Shelving delivery, and reflect the technical specifications applicable at the time of writing.*

- These instructions are subject to change if the manufacturer revises the parts and/or production of the subsystems and accessories used in the brand's vehicles. Following the instructions for assembly will ensure proper installation of the product. The manufacturer will not be held liable if these instructions are not followed.
- The addition of parts and/or components not original to this Cantilever Shelving are discouraged. Use only OEM supplied parts.
- Consultaion of the OEM vehicle may be required during assembly to avoid vehicle damage. Ensure bolt locations will not damage any critical parts of the vehicle–i.e. gas tank, wiring harnesses, or hoses-before drilling.

### REQUIRED

Plus Nut Applicator Tool

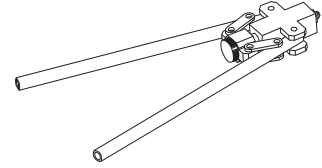

Torque Wrench w/  
13MM Socket

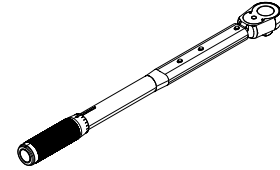

## ASSEMBLY OVERVIEW

NOTE: Mounting Assembly shown installed with Uprights for illustrative purpose only. Separate purchase is required for Uprights and Shelves.

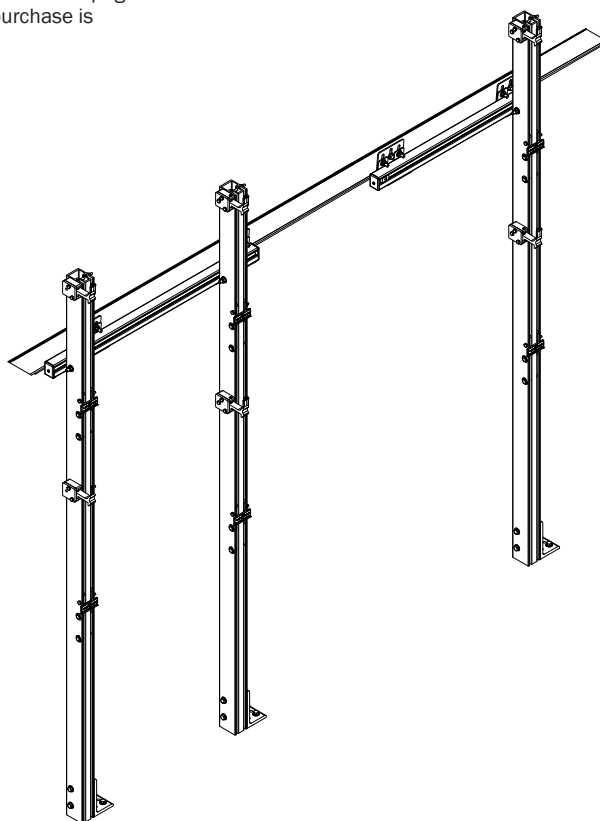

## CSM ASSEMBLY SEQUENCE

- 1.1** Locate the factory tie in hole locations on the Service Body and align with an Interior Mounting Assembly as shown. Hold into position for drilling location in Step 1.2

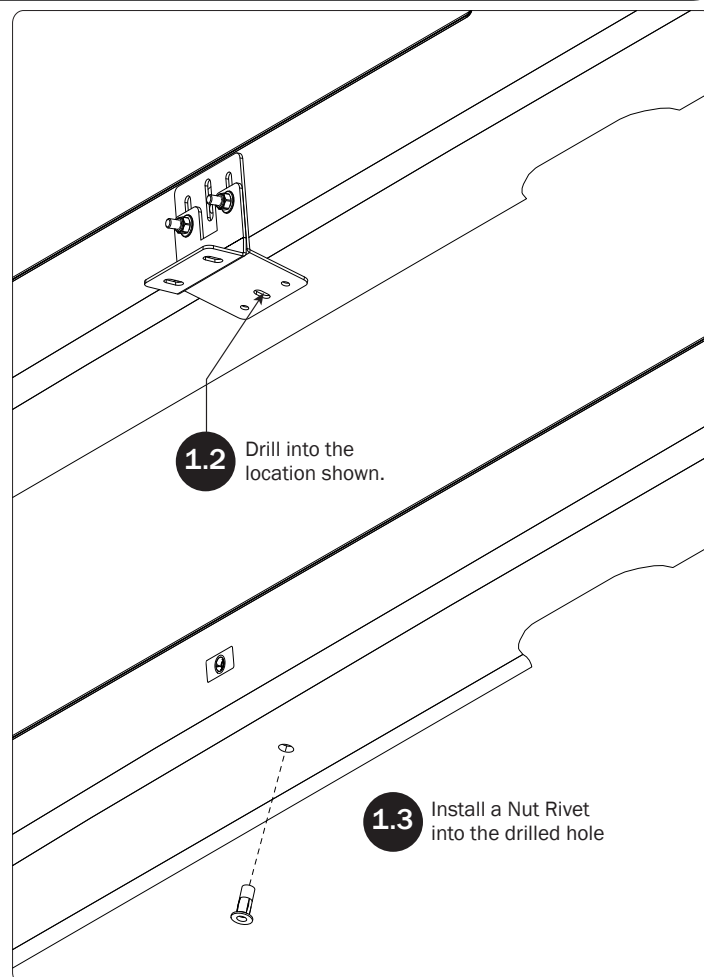
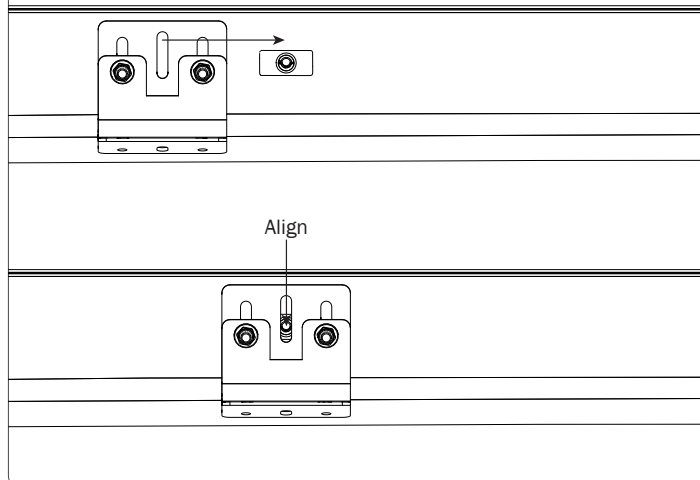

- 2.1** Attach the Interior Mounting Assembly with Hardware as shown into the factory tie in hole. Torque to 90 in-lbs.

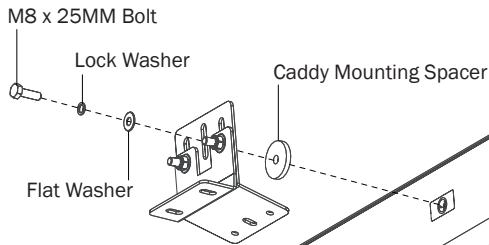

- 2.2** Install Hardware into the lower Mounting Assembly hole as shown. Torque to 90 in-lbs.

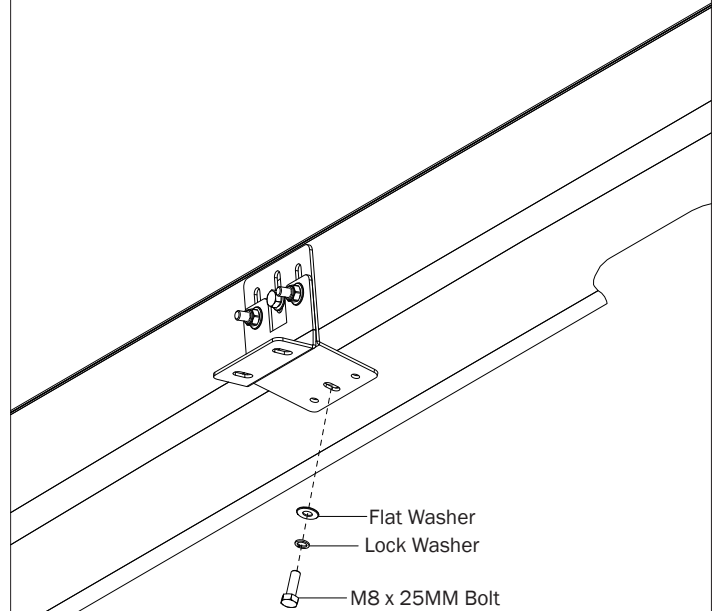

- 3.1** Install the Mounting Channel in its correct orientation using Hardware as shown. Torque to 90 in-lbs.

Correct Channel Orientation

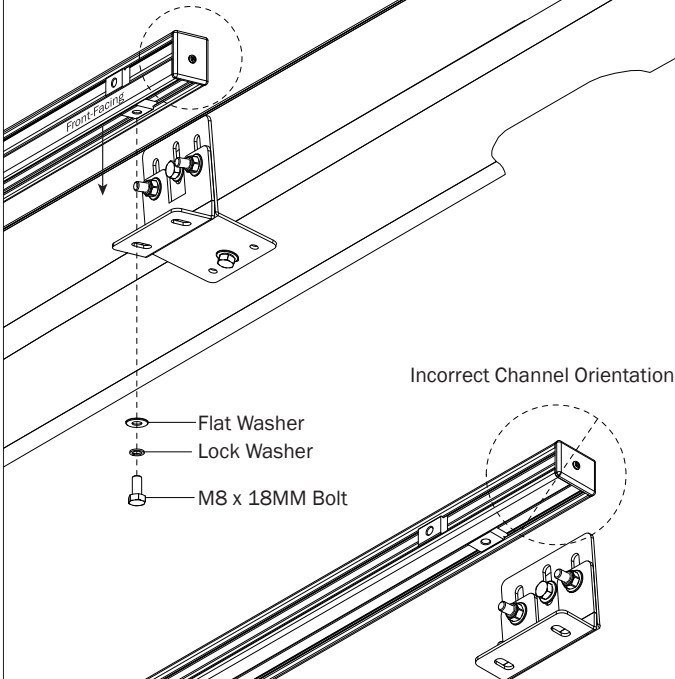

- 3.2** Repeat Steps 1.1–3.1 on all parts and hardware as needed for your specific configuration.

- 4** Uprights (sold separately) are installed into CSM-1001 according to your specific configuration. Torque hardware to 90 in-lbs.

\*Hardware used in Step 4 is from HKT-0204 contained in Upright packaging CSU-3001 or CSU-3002 (sold separately).

NOTE: View below is shown with shelving removed for visual clarity.

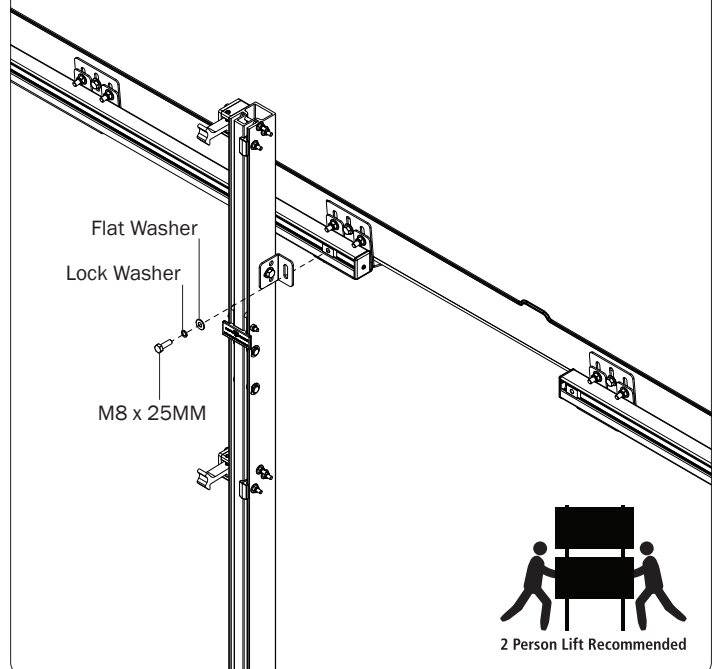

2 Person Lift Recommended

Page Intentionally Left Blank

Page Intentionally Left Blank

