

PRIME DESIGN™

A Safe Fleet Brand

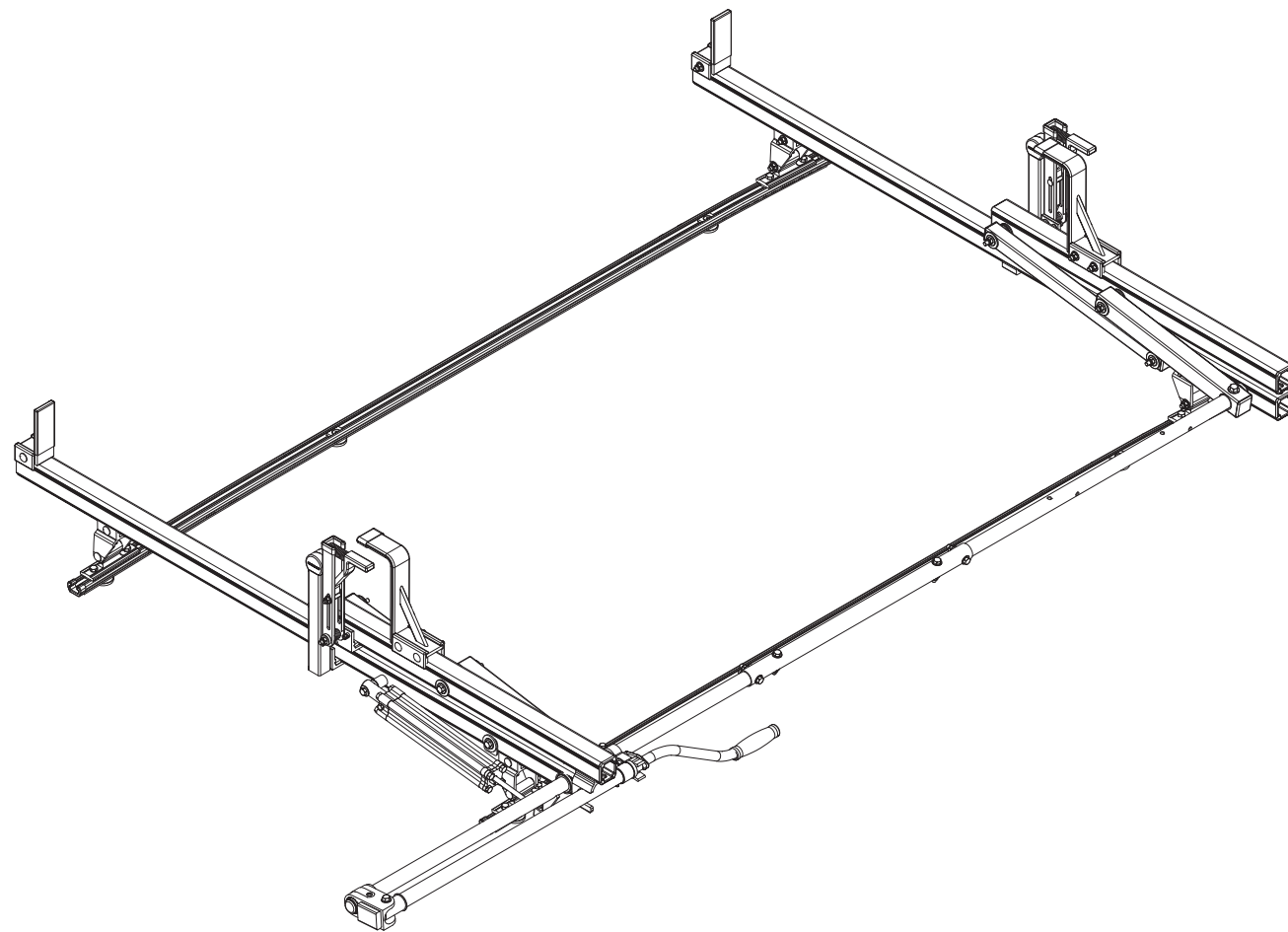

VBR **CH**

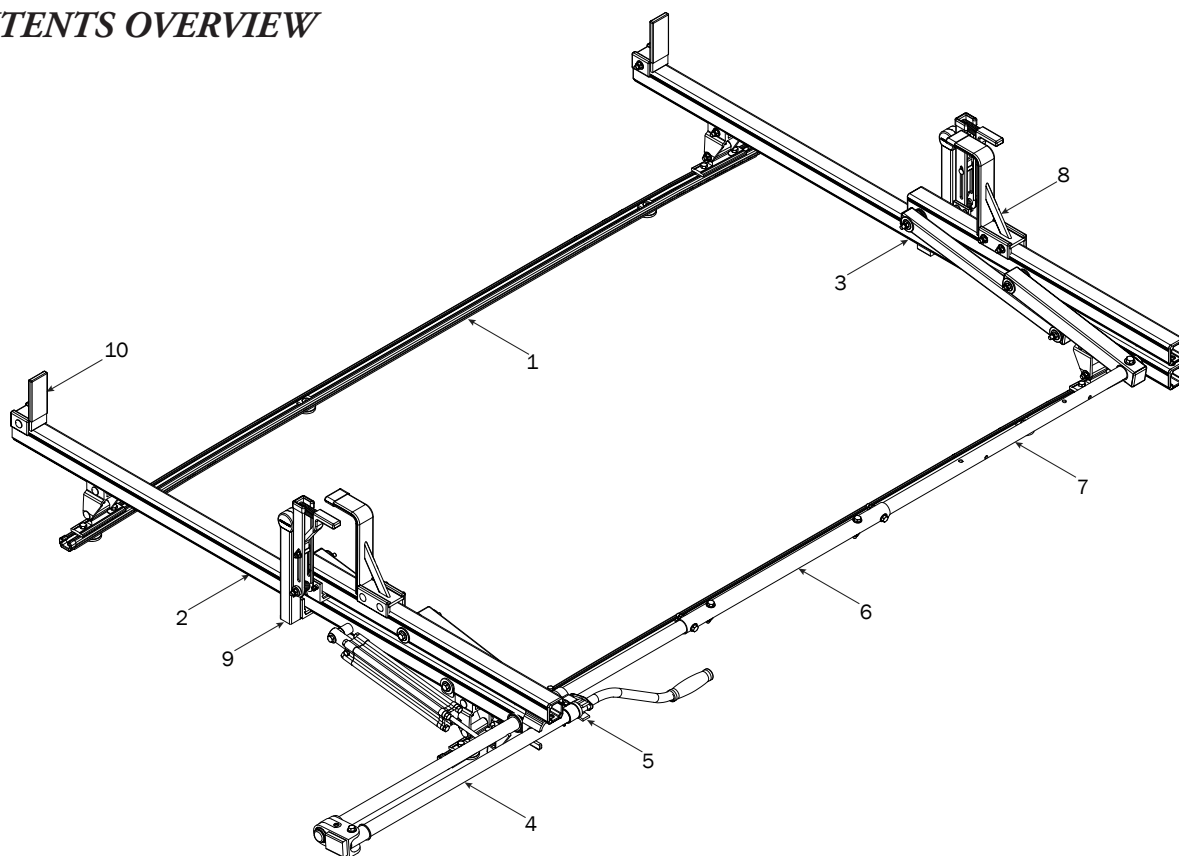

1—FBM-0045 (Qty 1)
Channels with hardware



Channels (2X)

End Caps (4X)

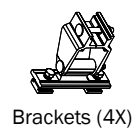

Brackets (4X)

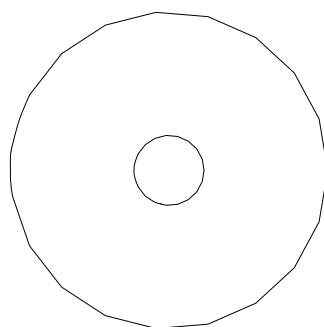

Nylon Washer (6X)

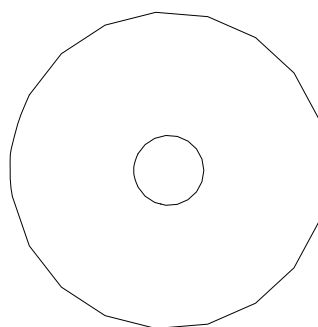

Foam Gasket (6X)

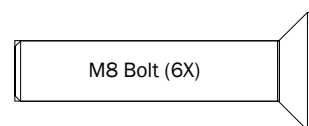

M8 Bolt (6X)

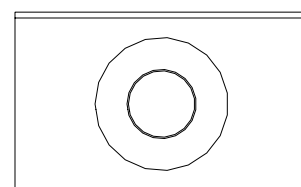

Flex Channel Connector (6X)

2—Rear Crossbar Assembly (Qty 1)

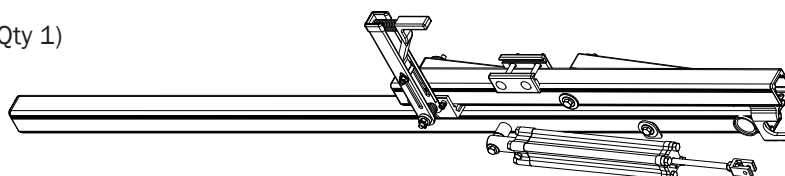

3—Front Crossbar Assembly (Qty 1)

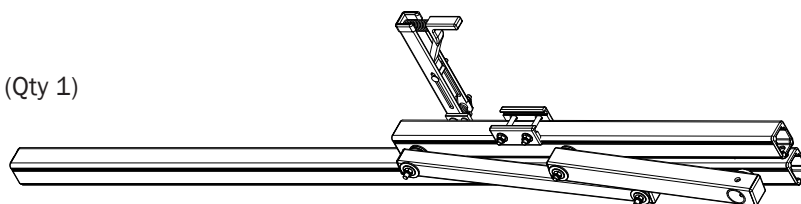

4—Rear Drive Shaft..... (Qty 1)
RH, B4 Version, 46.00"

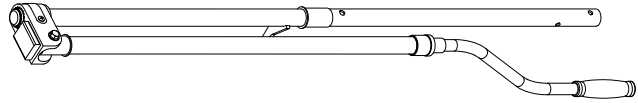

5—Handle Latch Assembly (Qty 1)
Right Hand



6—Connecting Bar..... (Qty 1)
24.00"

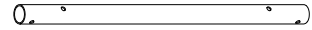

7—Front Drive Shaft (Qty 1)
B Version, 35.75"

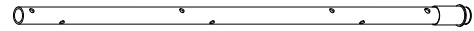

8—Z Post (Qty 2)
Adjustable, 7.25"

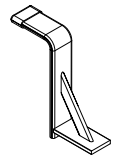

9—L Post (Qty 2)
Gen2, Roller Cap , 9.25"

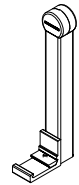

10—Ladder Stop Assembly (Qty 2)
1.75"

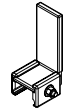

11—HKT-8163-Rotation Hardware Kit (Qty 1)
(Not called out in Overview)



Clevis Pin (1X)



M8 x 50MM (4X)

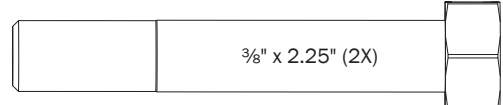

3/8" x 2.25" (2X)

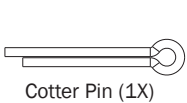

Cotter Pin (1X)



M8 x 25MM (1X)



M8 Lock Nut (5X)

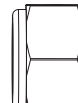

3/8" Lock Nut (2X)

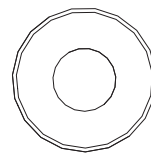

5/16" Flat Washer (10X)

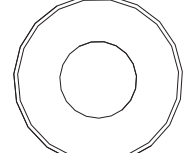

3/8" Flat Washer (4X)

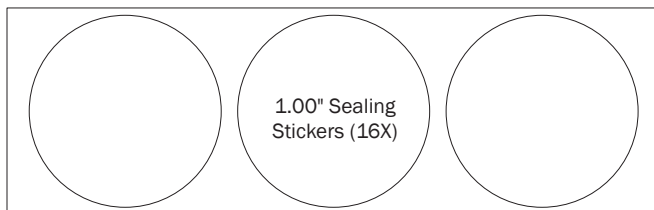

1.00" Sealing
Stickers (16X)



Anti-Seize (1X)

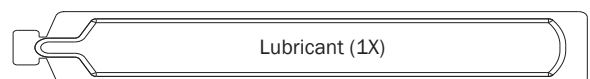

Lubricant (1X)

FBM-0045
CHANNELS TO ROOF

- 0.1**
- Position Channels as shown below in Fig.1

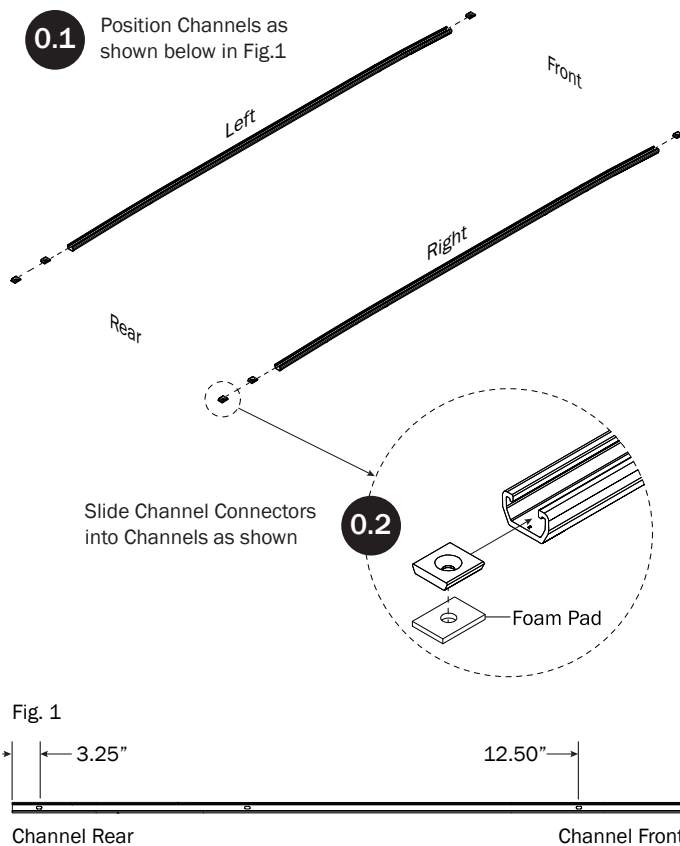

- 0.3**
- Install Channels into roof Channel groove as shown

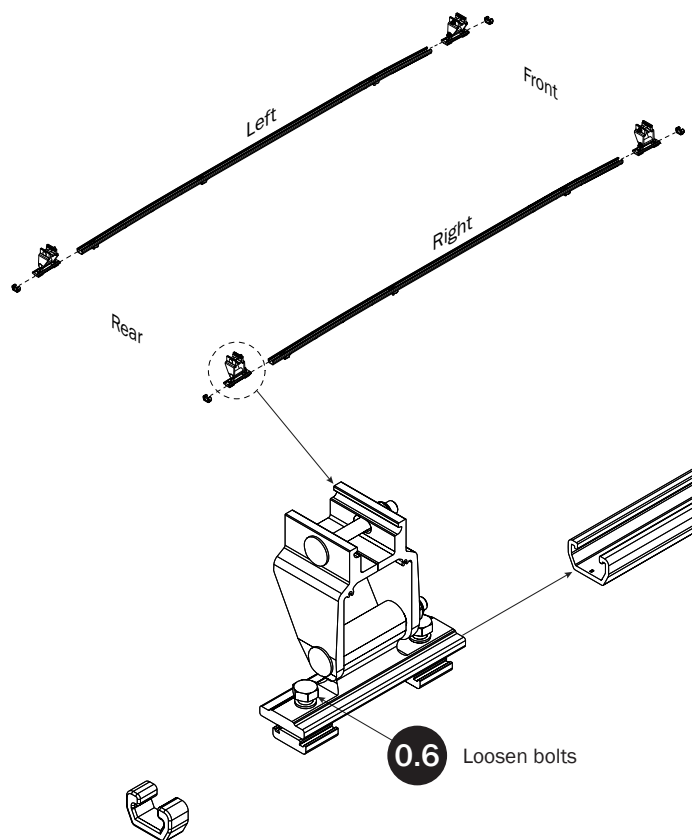
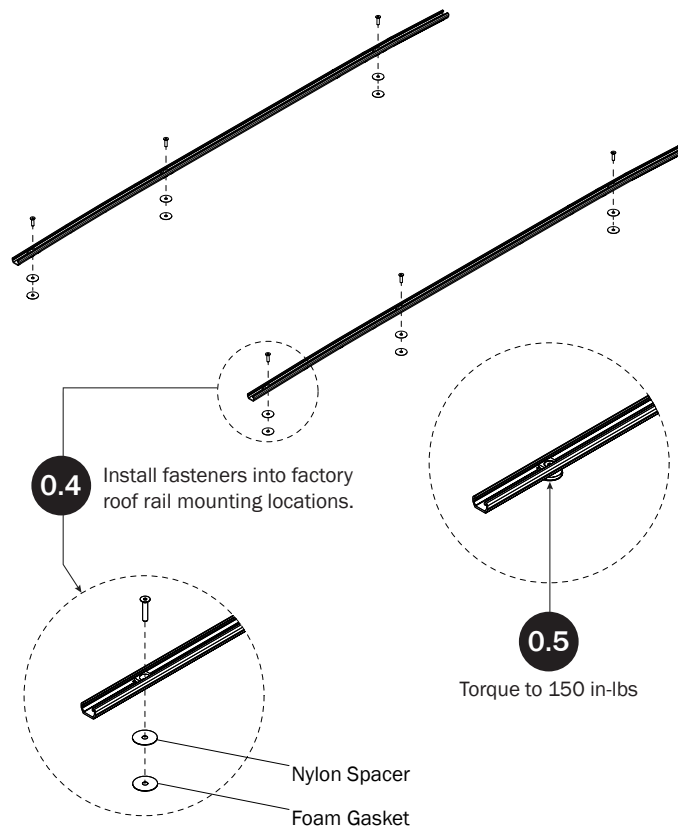

- 0.7**
- Set to distances then torque Rear Bracket nuts to 90 in-lbs

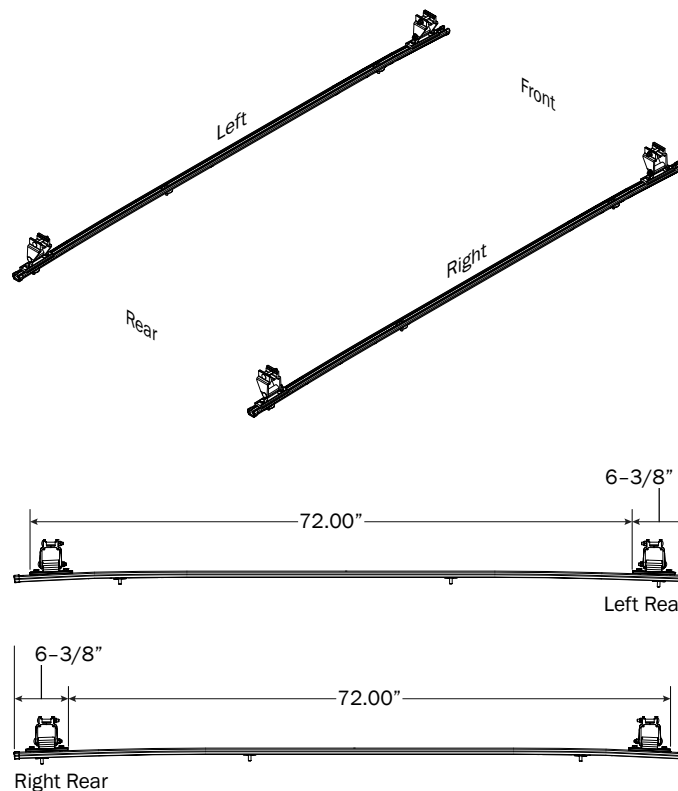

RIGHT ROTATION ASSEMBLY SEQUENCE

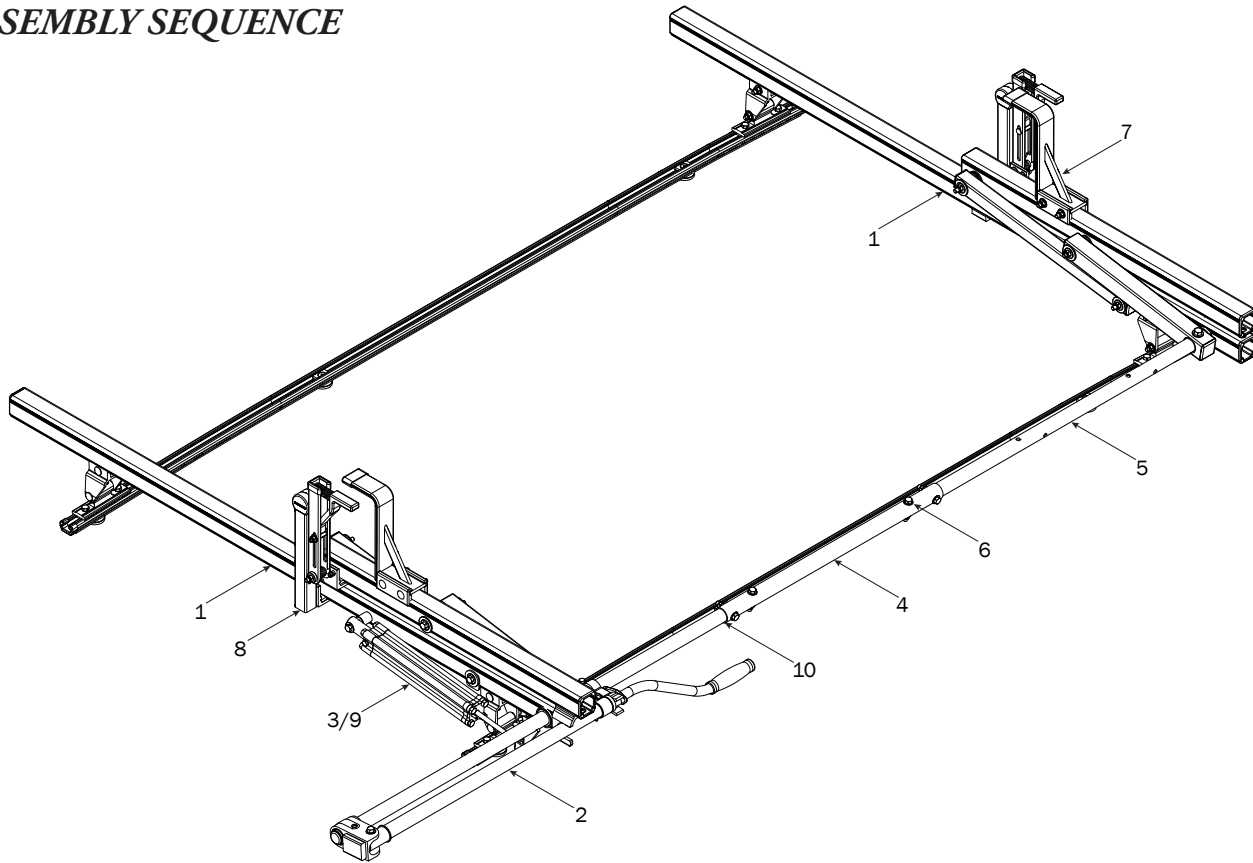

CROSSBARS

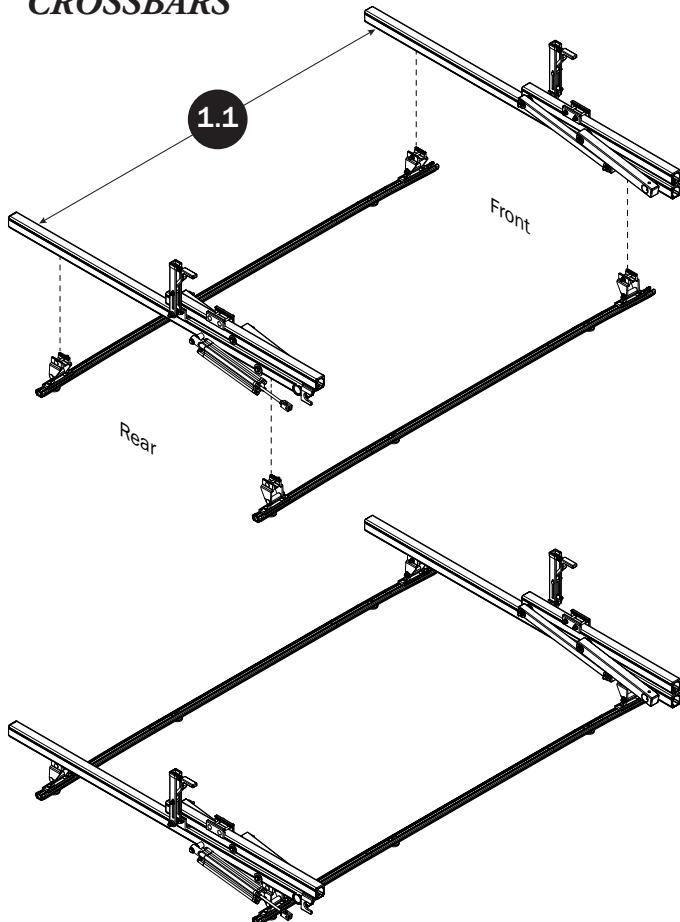

CROSSBAR ADJUSTMENT

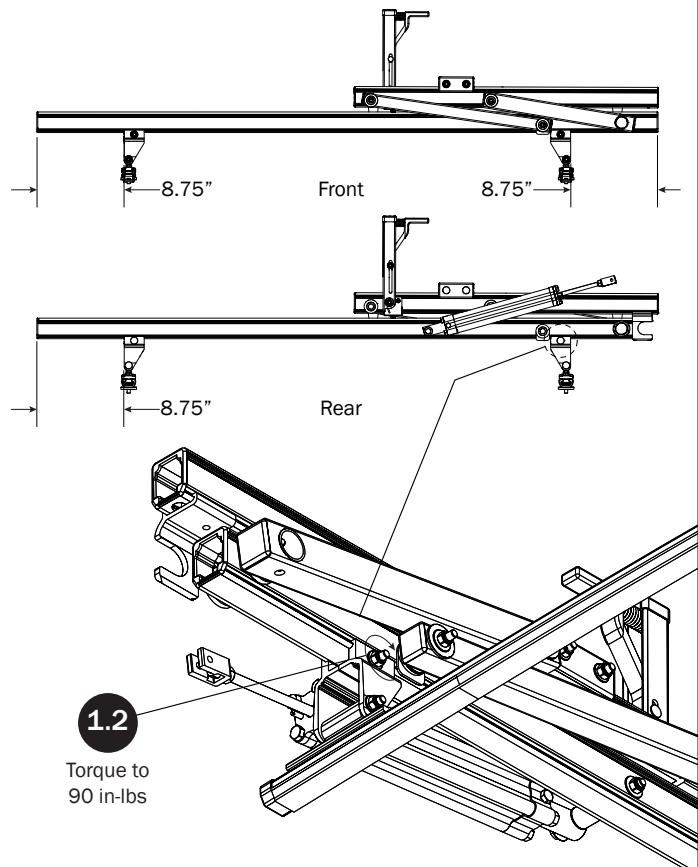

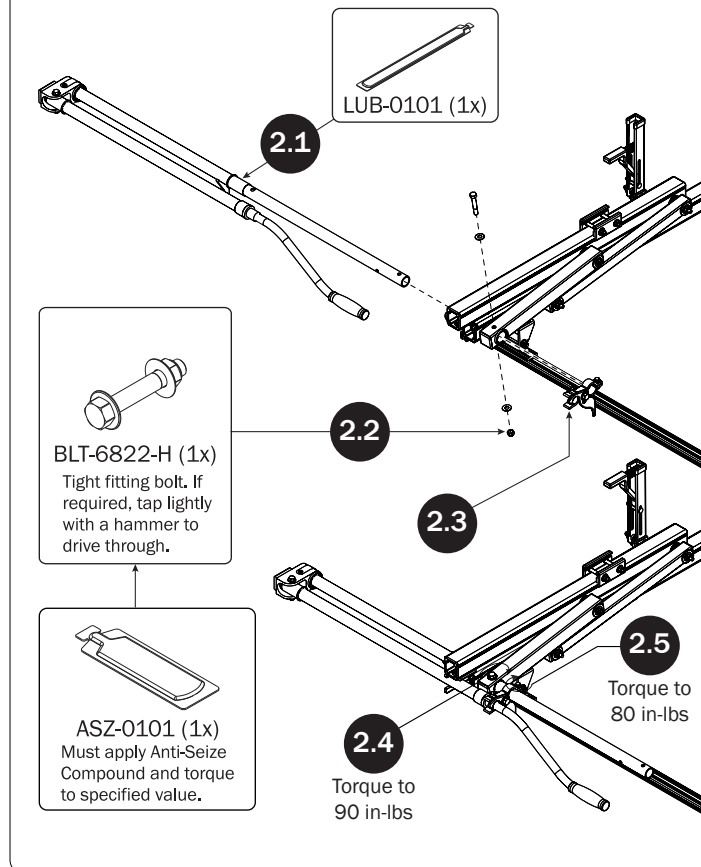
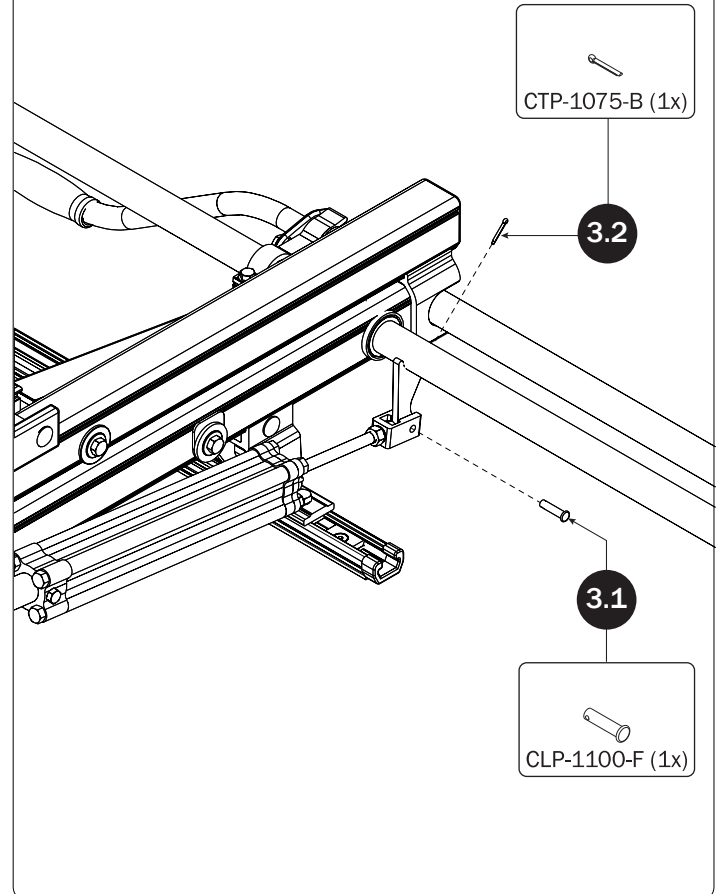
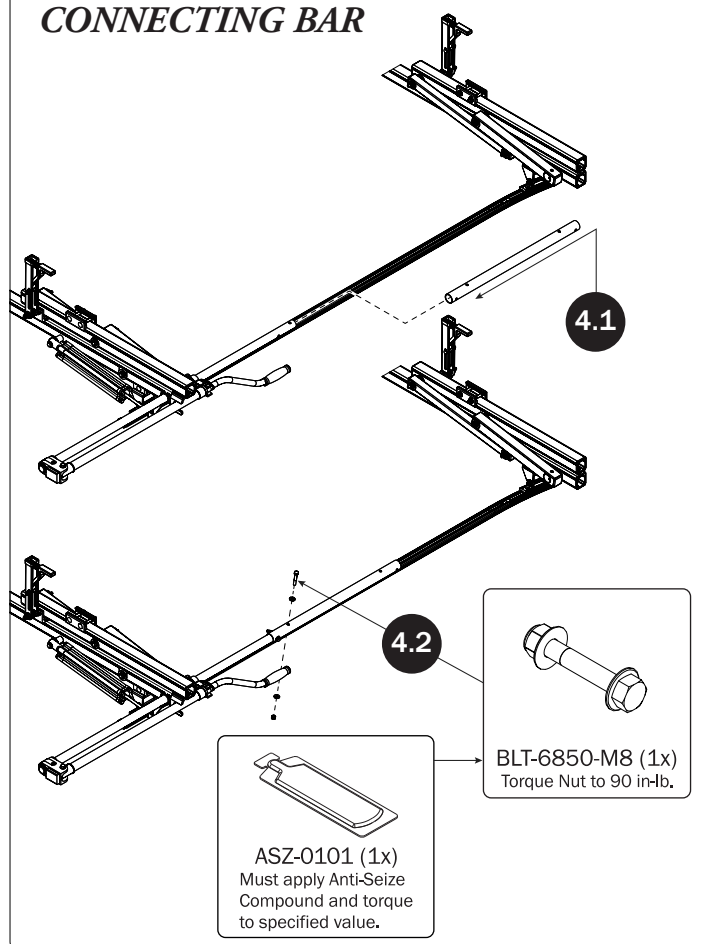
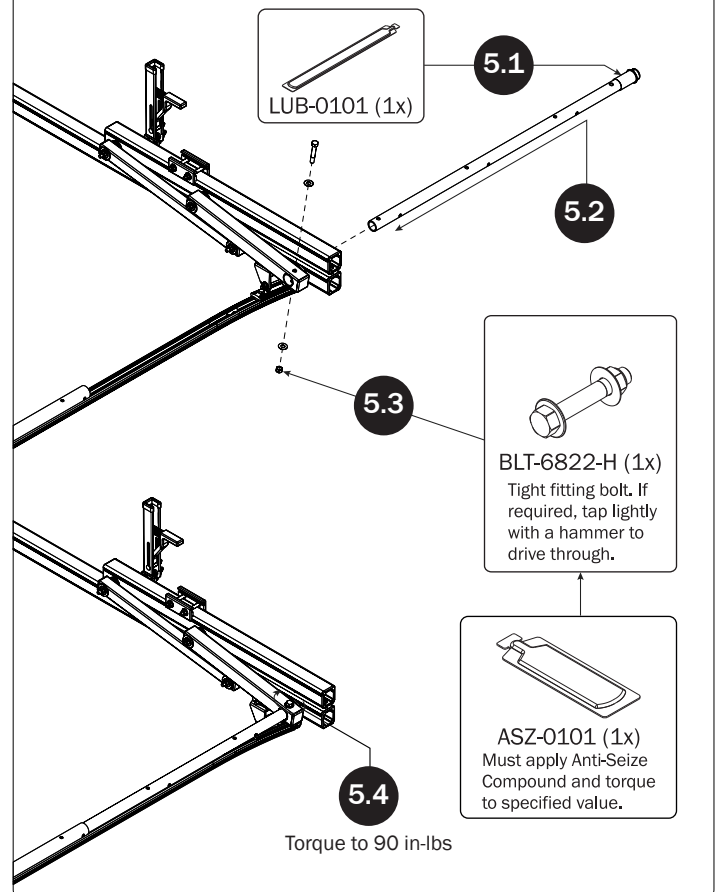
REAR DRIVE SHAFT**CYLINDER HARDWARE****CONNECTING BAR****FRONT DRIVE SHAFT**

CONNECTING BAR FASTENERS

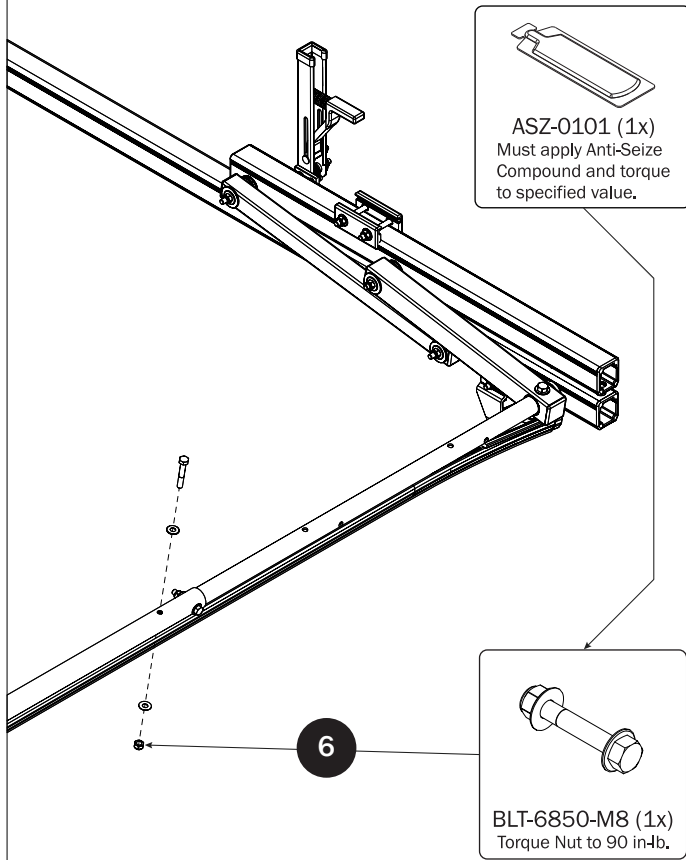

Z POSTS

SEE QUICK START GUIDE FOR ADJUSTMENTS

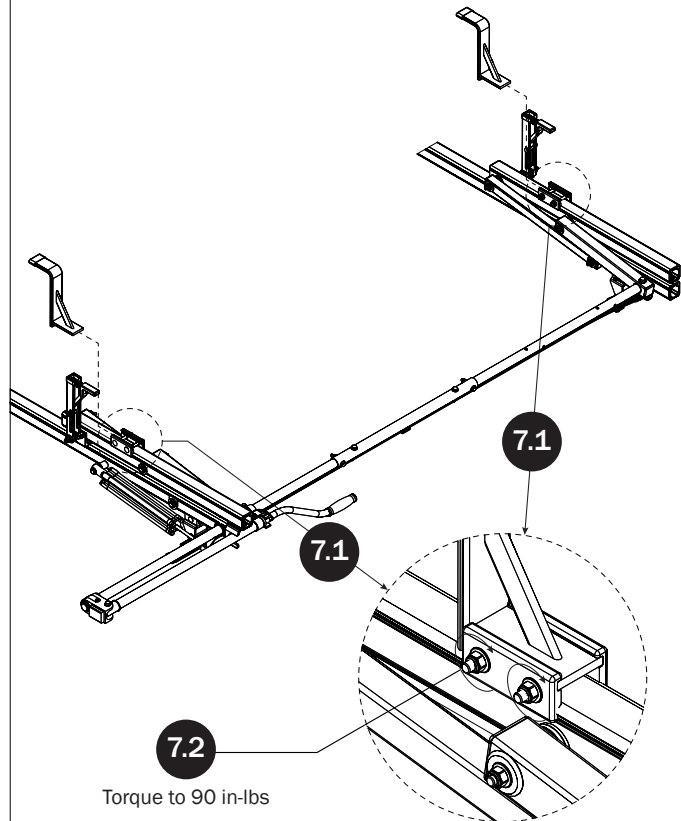

L POSTS

SEE QUICK START GUIDE FOR ADJUSTMENTS

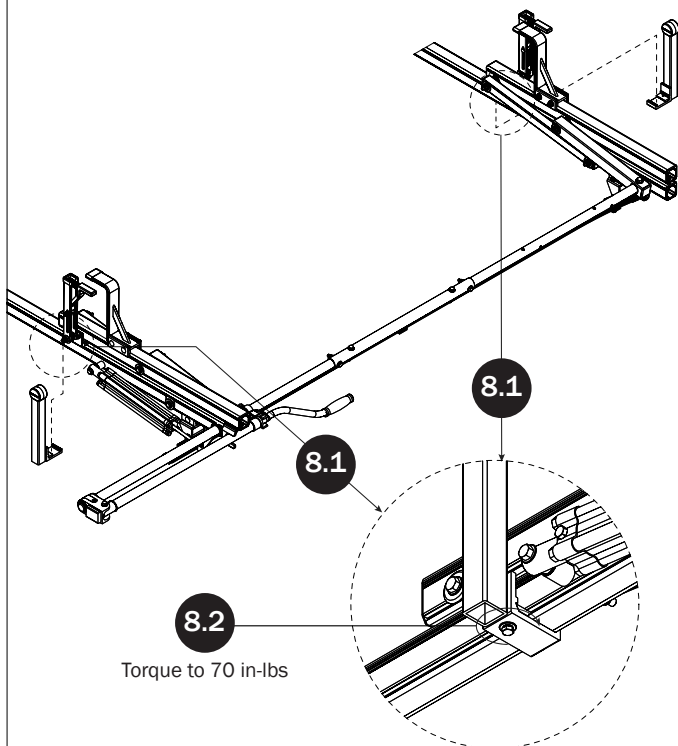

CYLINDER ADJUSTMENT

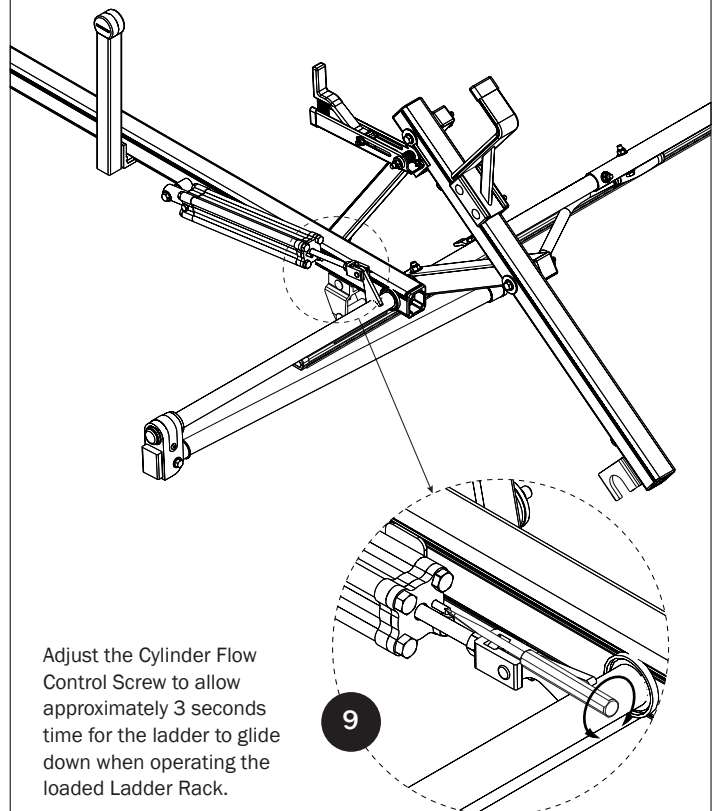

Adjust the Cylinder Flow Control Screw to allow approximately 3 seconds time for the ladder to glide down when operating the loaded Ladder Rack.

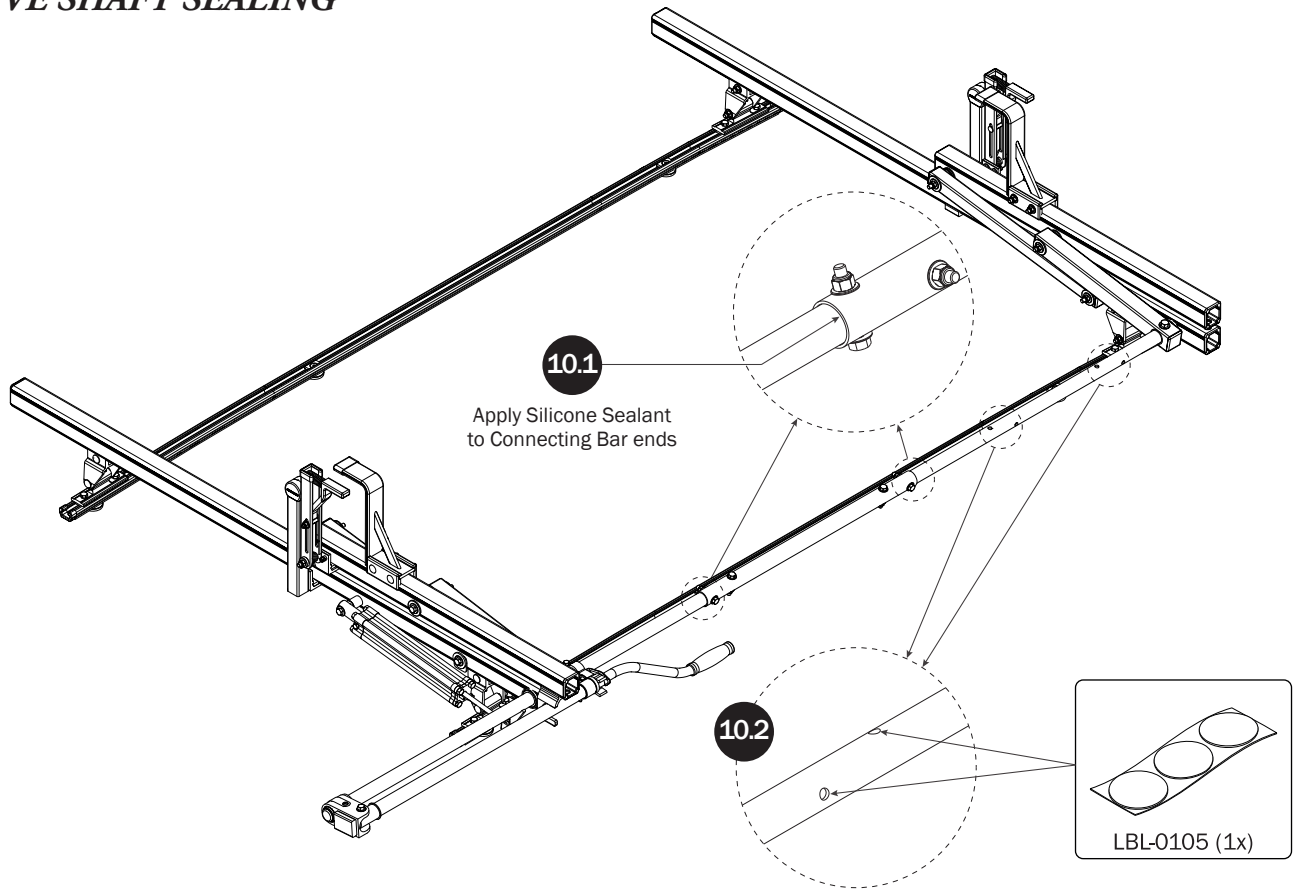

LEFT SIDE BASE

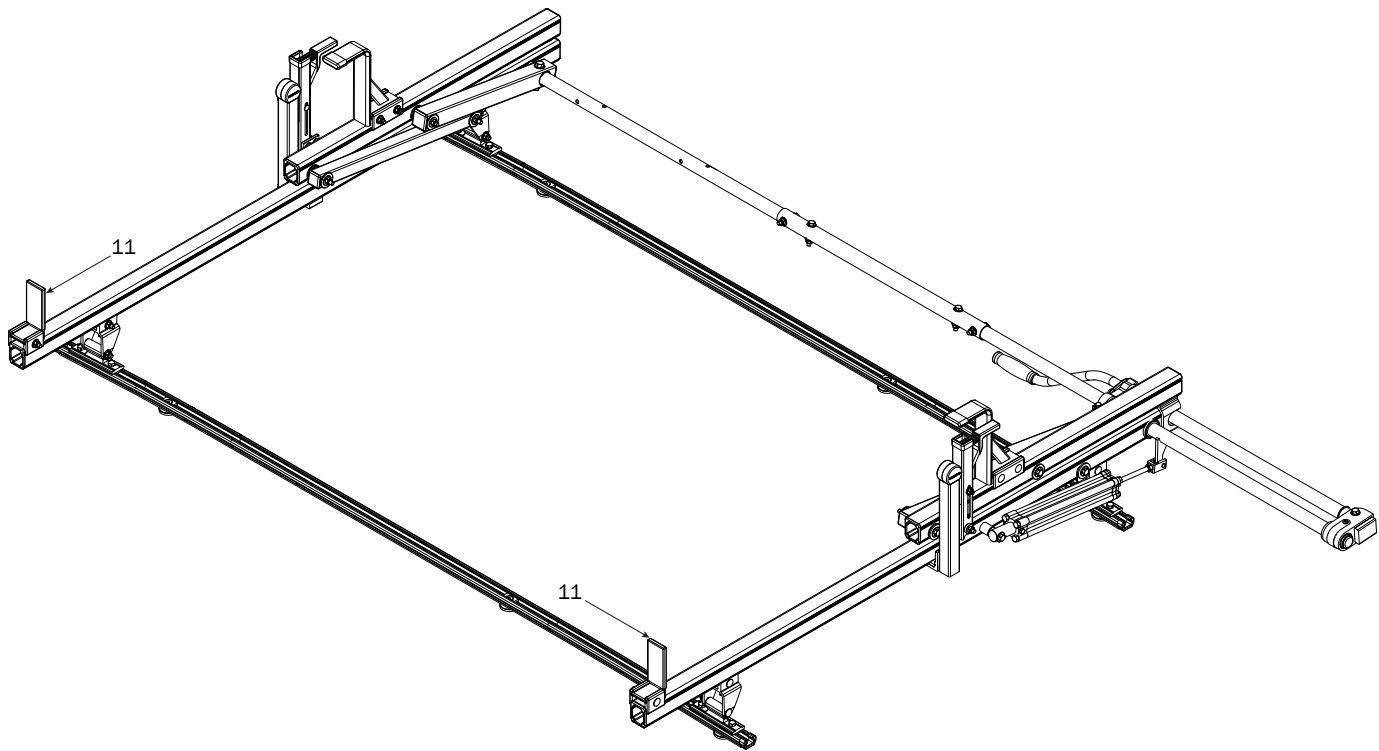

CLAMP DOWN HANDLE

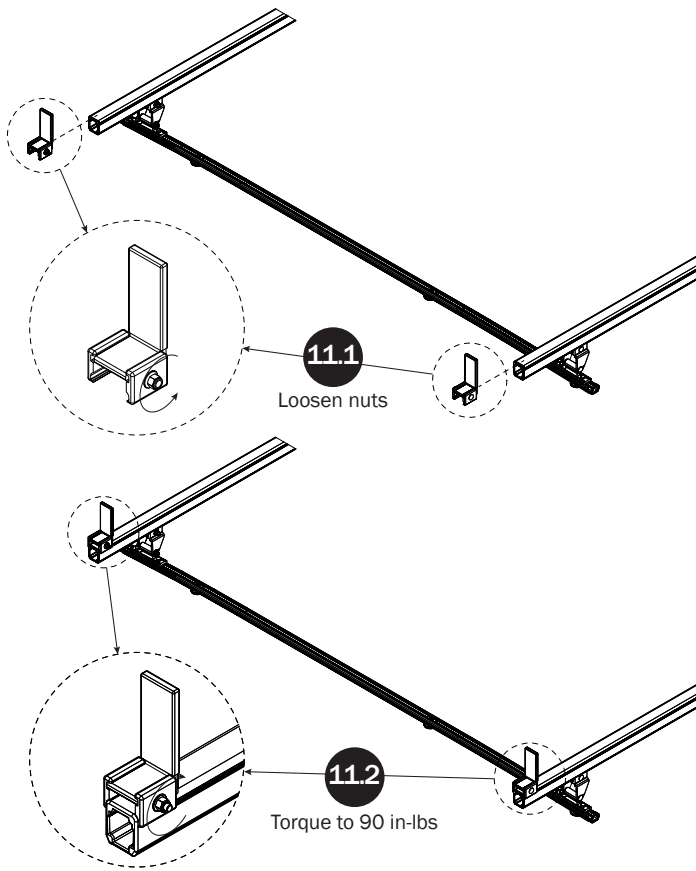

Page Intentionally Left Blank

Page Intentionally Left Blank

