

PRIME DESIGN™

A Safe Fleet Brand

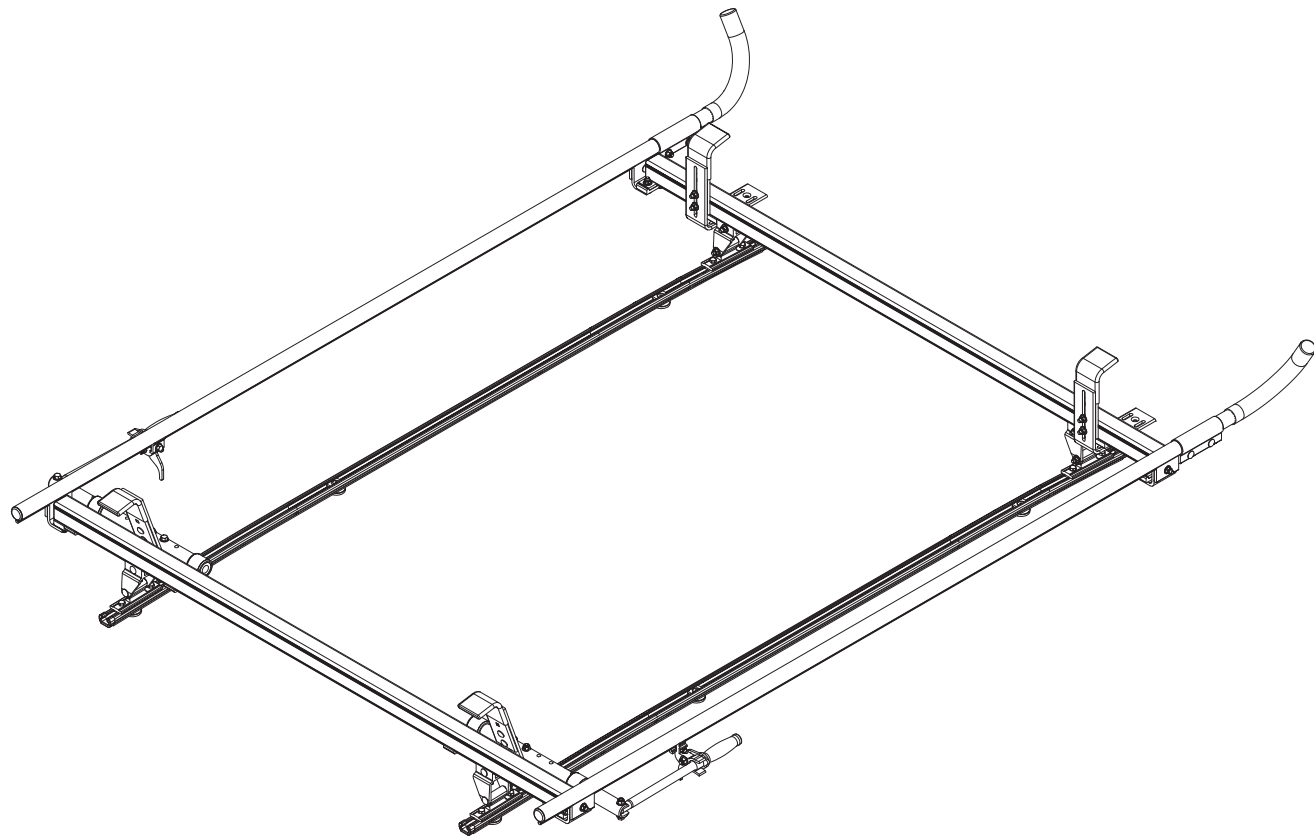

VCC **CH**

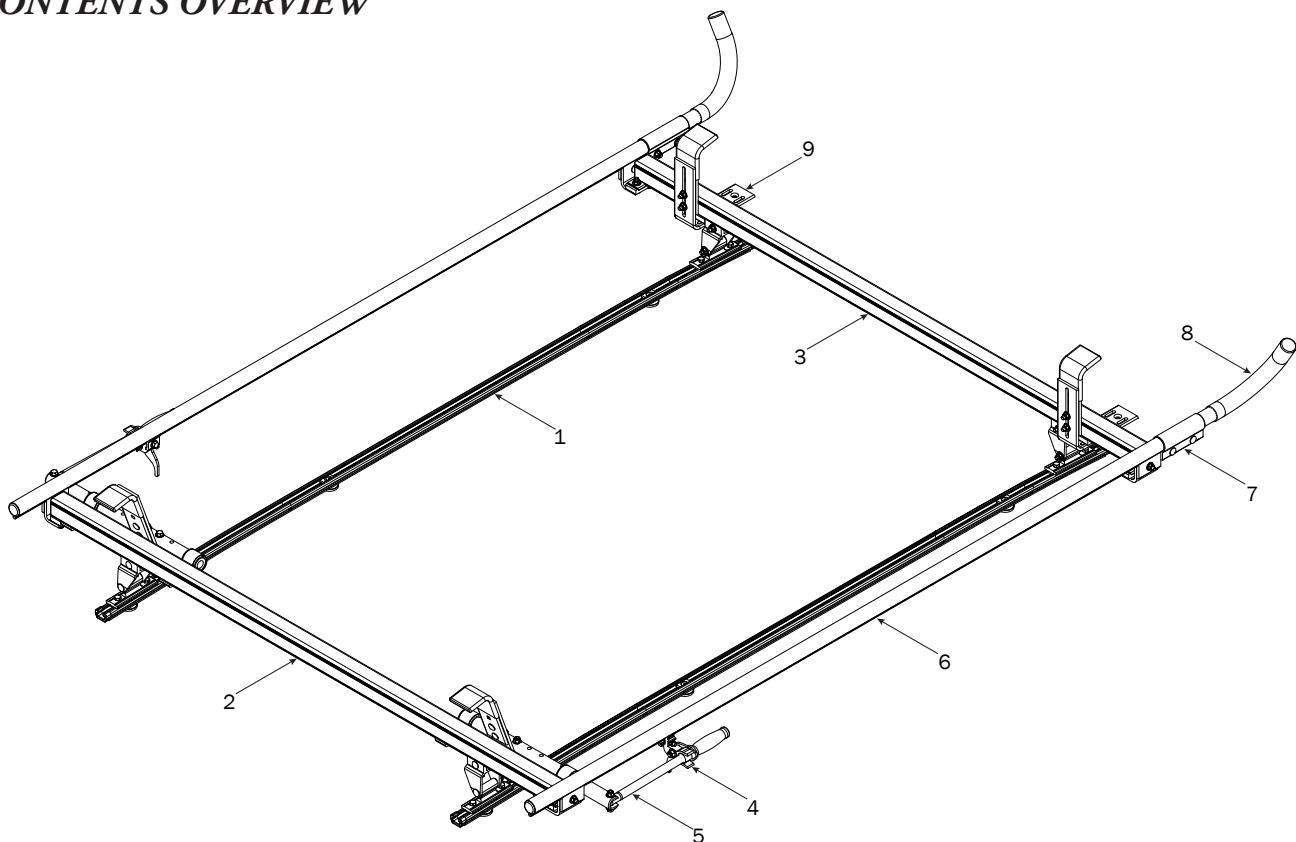

1—FBM-0045 (Qty 1)
Channels with Hardware



Channels (2X)



End Caps (4X)



Brackets (4X)

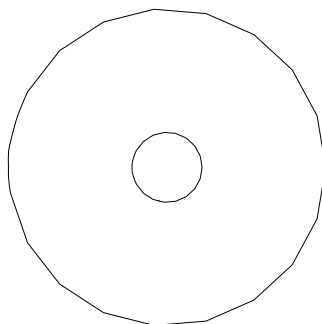

Nylon Washer (6X)

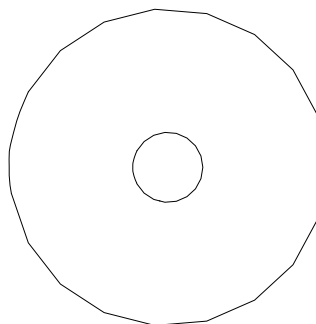

Foam Gasket (6X)

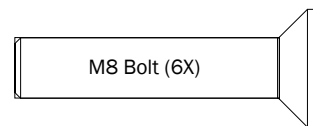

M8 Bolt (6X)

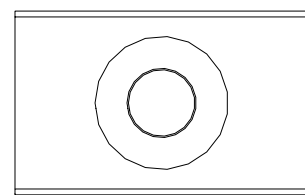

Flex Channel Connector (6X)

2—Rear Crossbar Assembly (Qty 1)

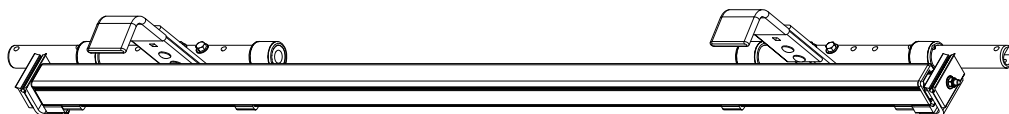

3—Front Crossbar Assembly (Qty 1)

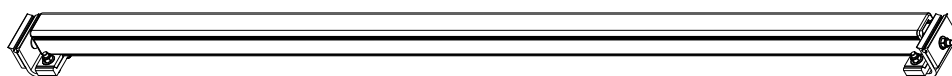

4—Handle Latch Assembly (Qty 2)



5—Clamp Down Handle Assembly (Qty 2)

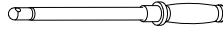

6—Clamp Down Tube (Qty 2)
80.00"

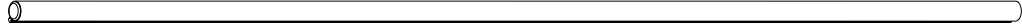

7—Quick Clamp Tube Splice Assembly (Qty 2)
5.00"



8—Removeable Horn with Cap (Qty 2)
15.00"

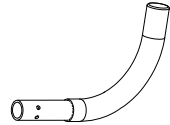

9—HD Front Hook Assembly (Qty 2)

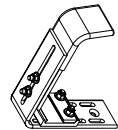

10—Anti-Seize (Qty 1)

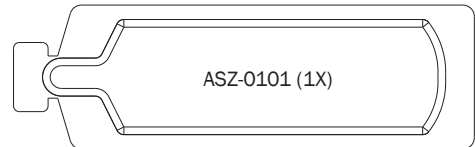

FBM-0045
CHANNELS TO ROOF

- 0.1** Position Channels as shown below in Fig.1

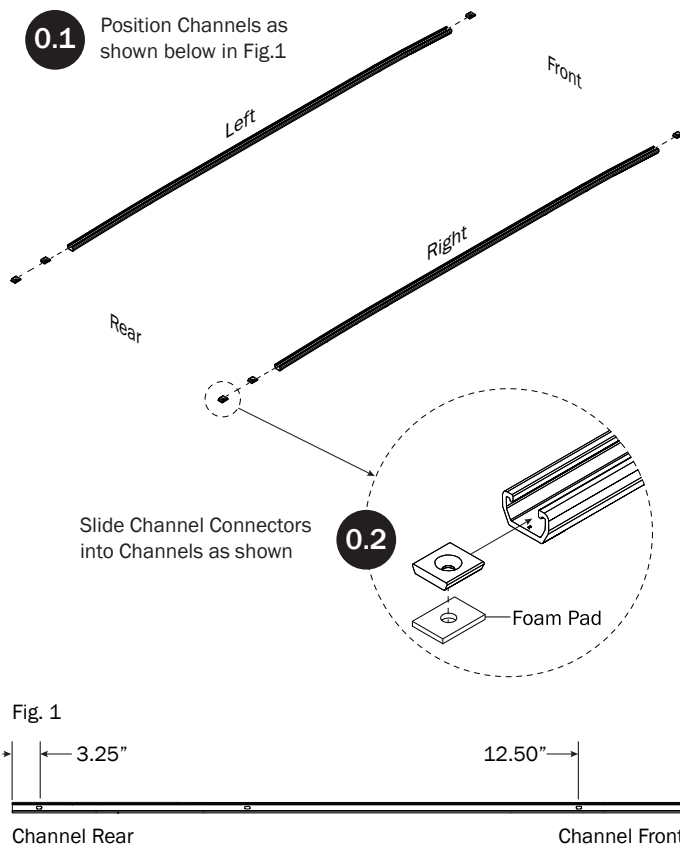

- 0.3** Install Channels into roof Channel groove as shown

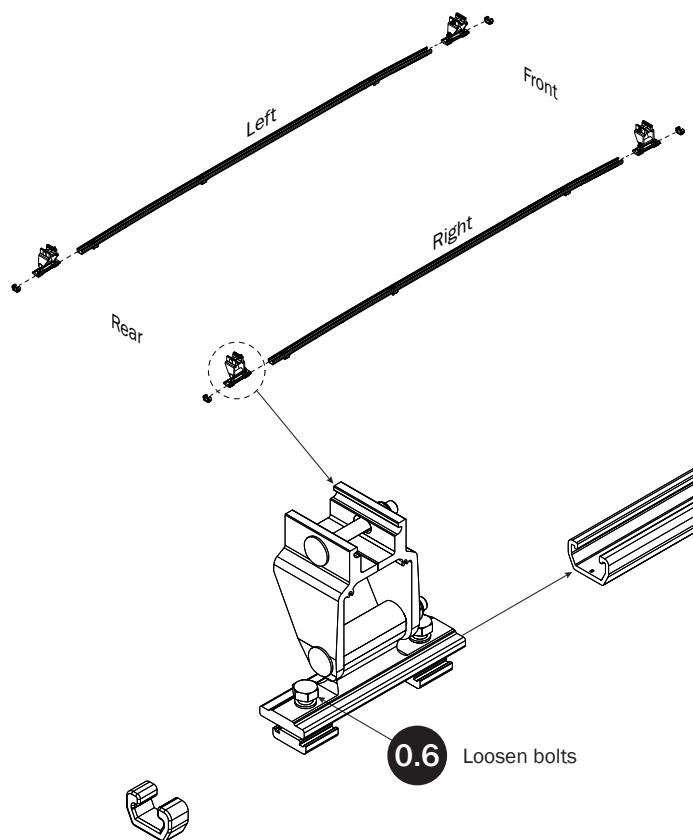
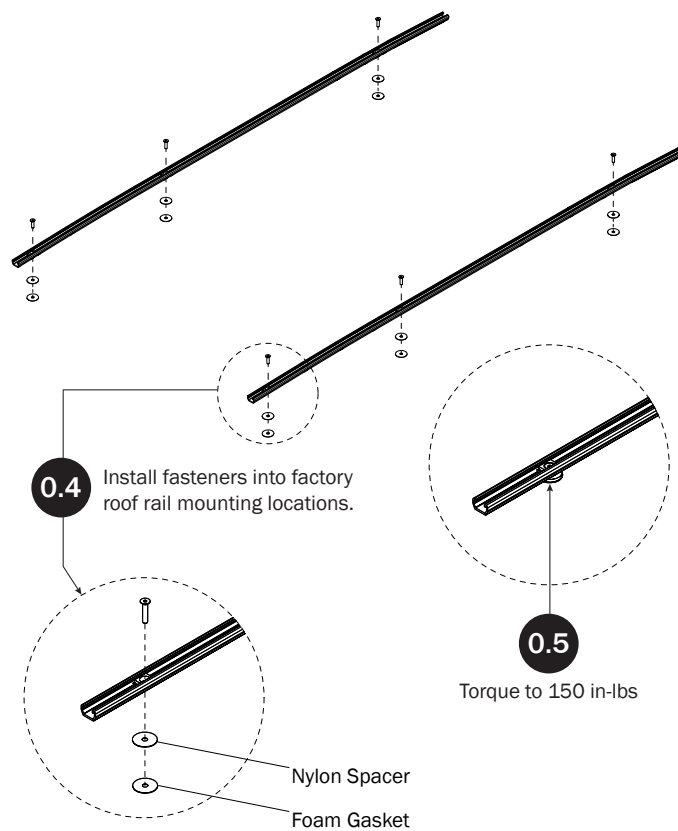

- 0.7** Set to distances then torque Rear Bracket nuts to 90 in-lbs

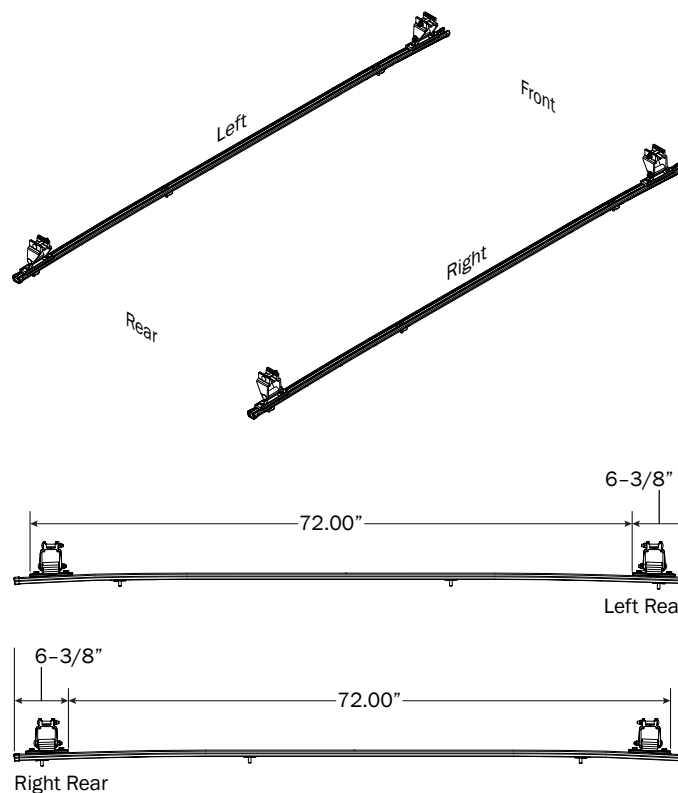

RIGHT CLAMP DOWN ASSEMBLY

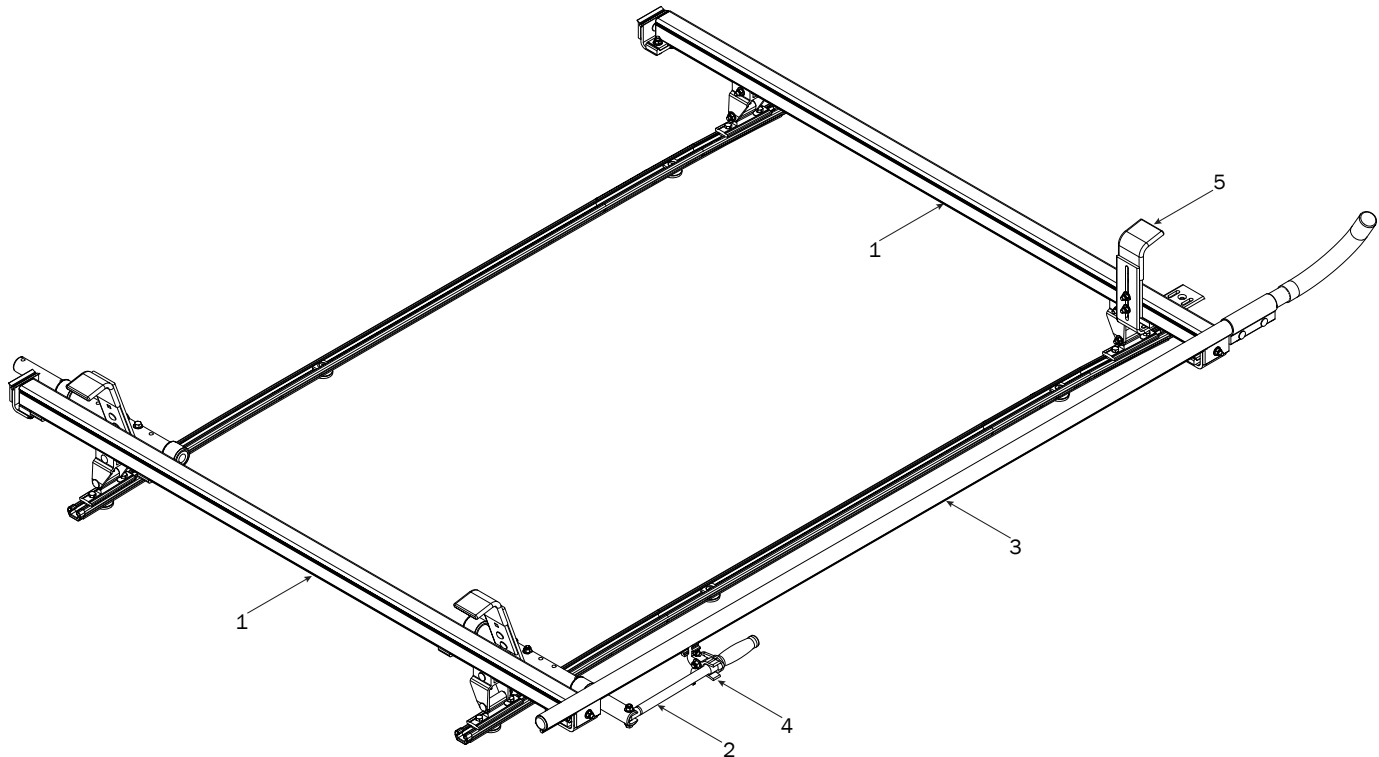

CROSSBARS

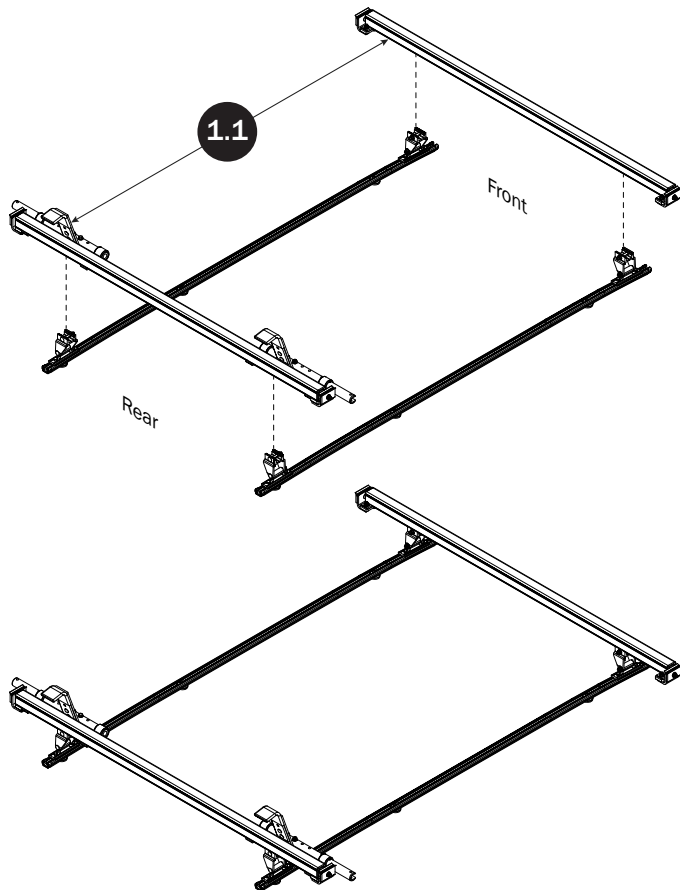

CROSSBAR ADJUSTMENT

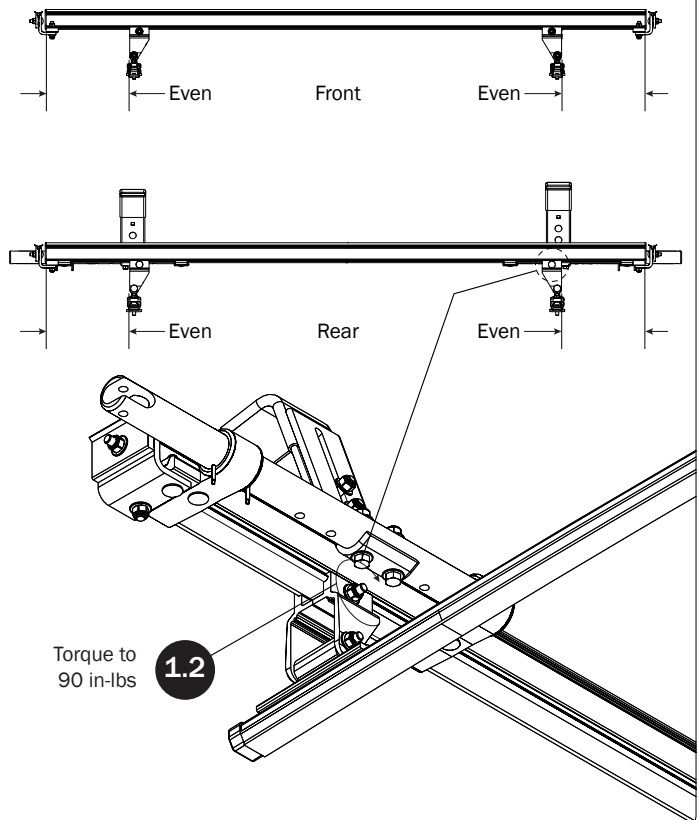

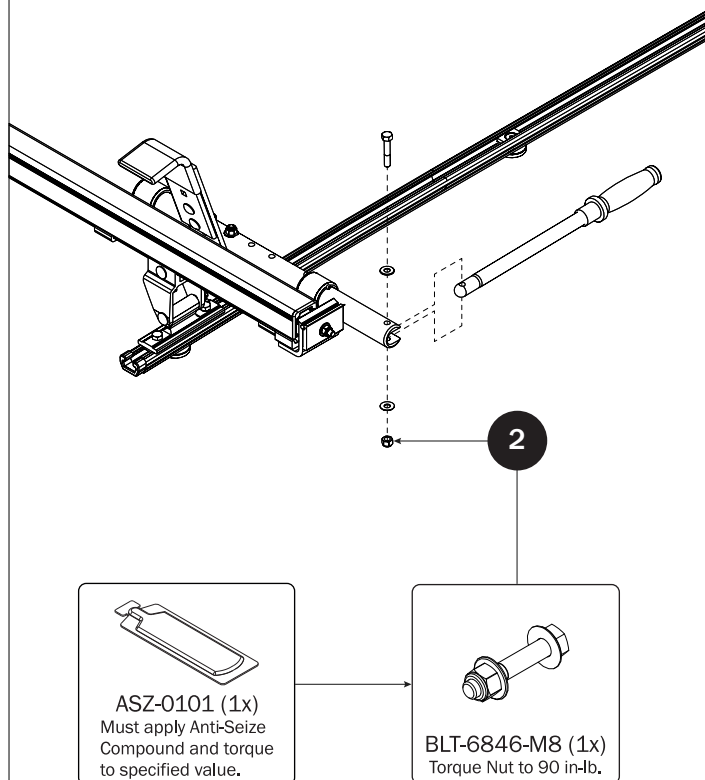
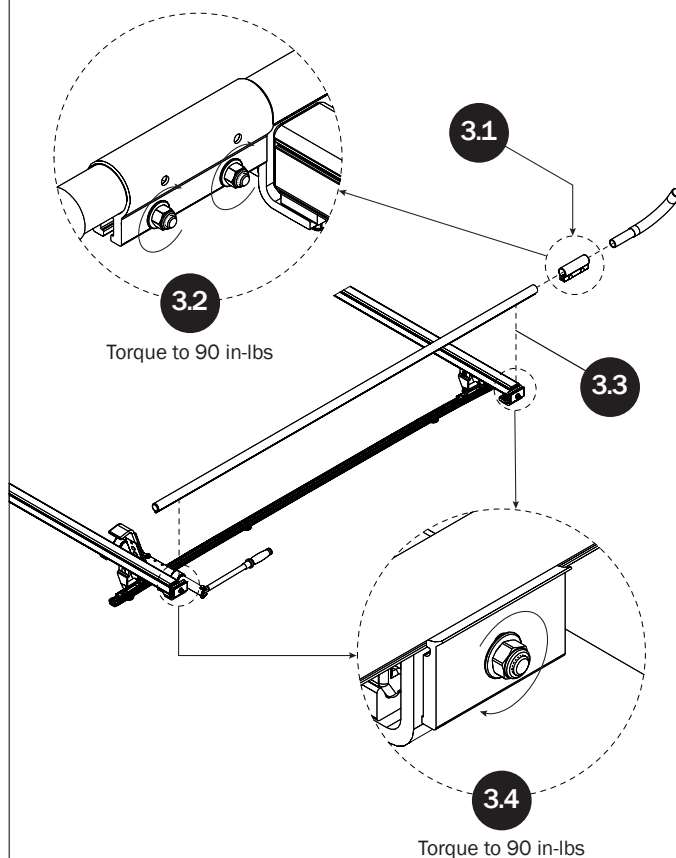
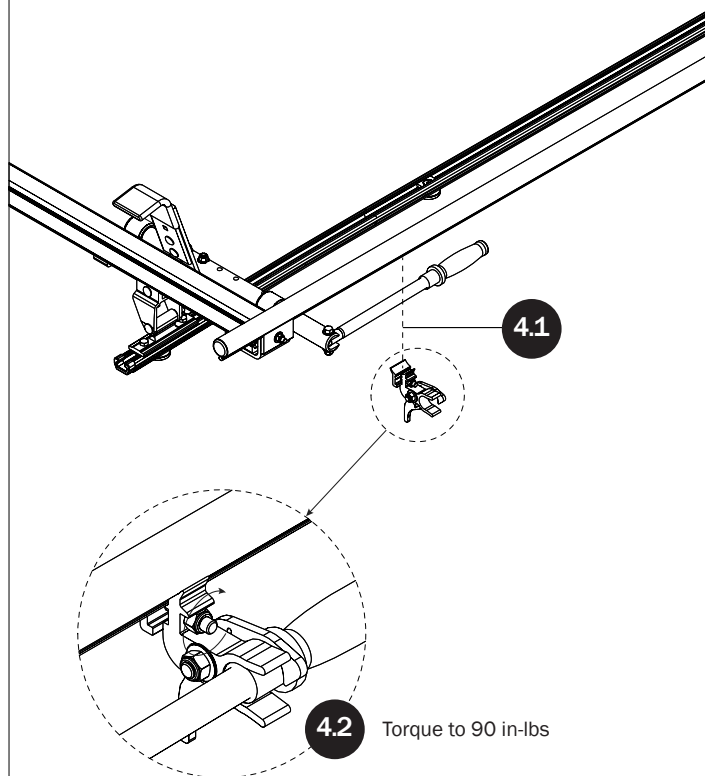
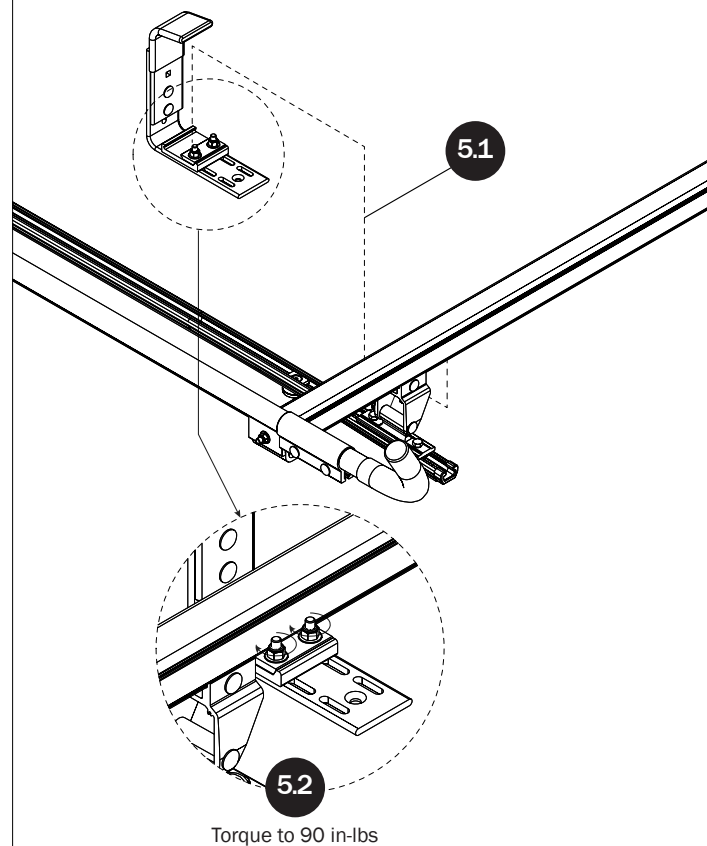
CLAMP DOWN HANDLE**CLAMP DOWN TUBE****HANDLE LATCH****FRONT LADDER HOOK**
SEE QUICK START GUIDE FOR ADJUSTMENTS

LEFT CLAMP DOWN ASSEMBLY

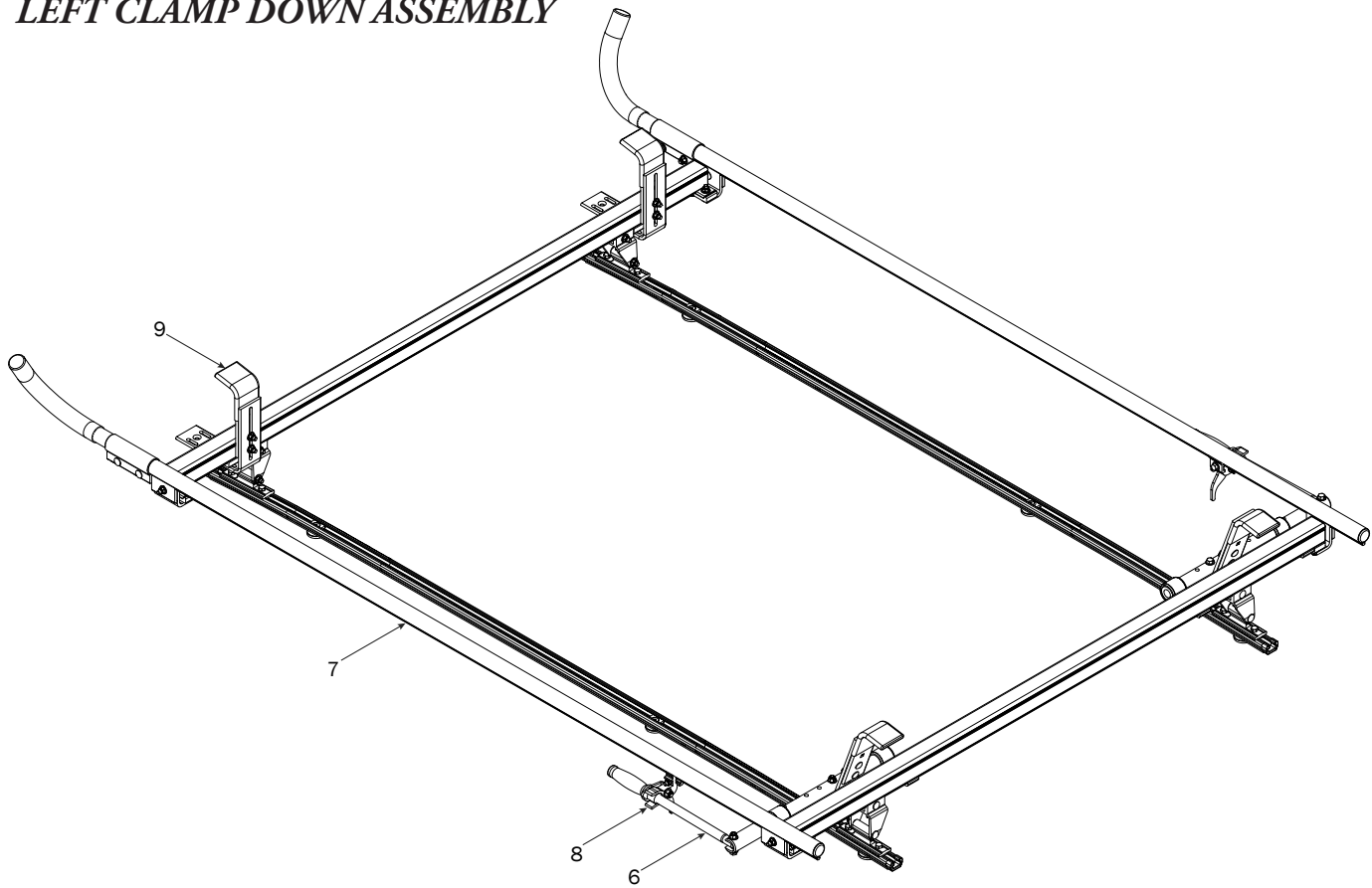

CLAMP DOWN HANDLE

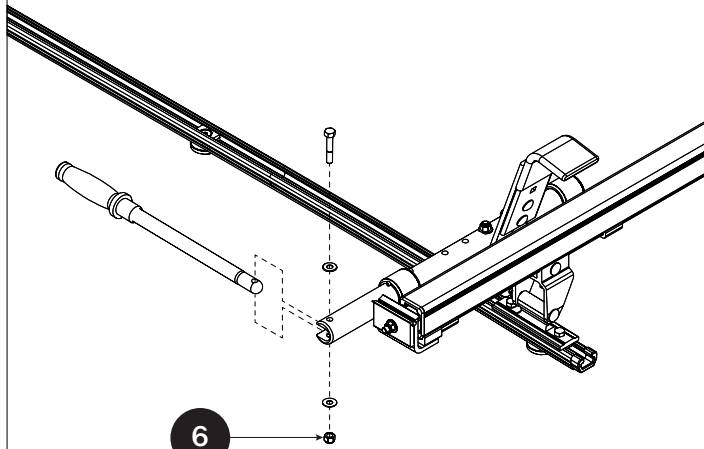

6

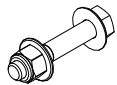

BLT-6846-M8 (1x)
Torque Nut to 90 in-lb.

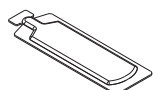

ASZ-0101 (1x)
Must apply Anti-Seize
Compound and torque
to specified value.

CLAMP DOWN TUBE

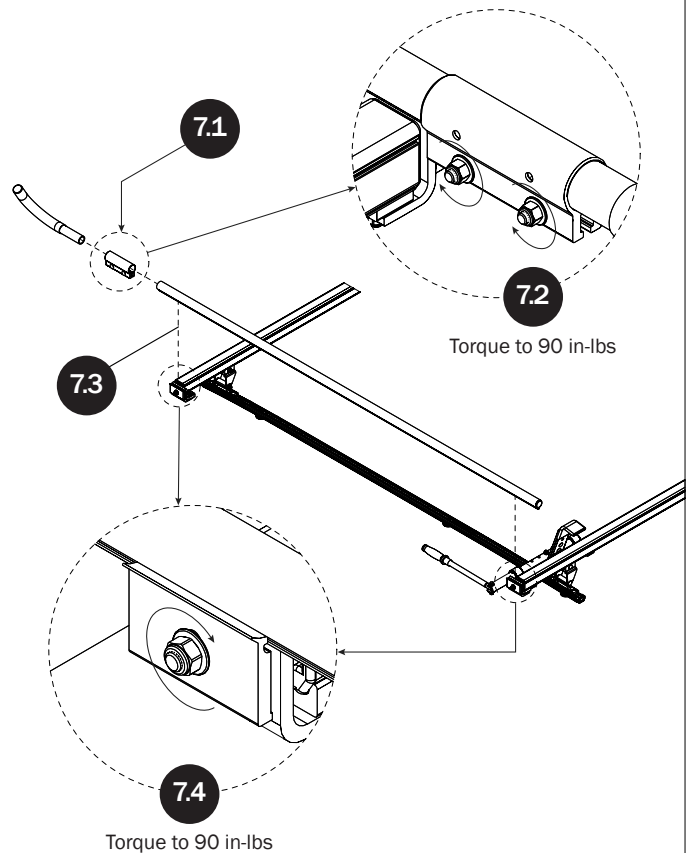

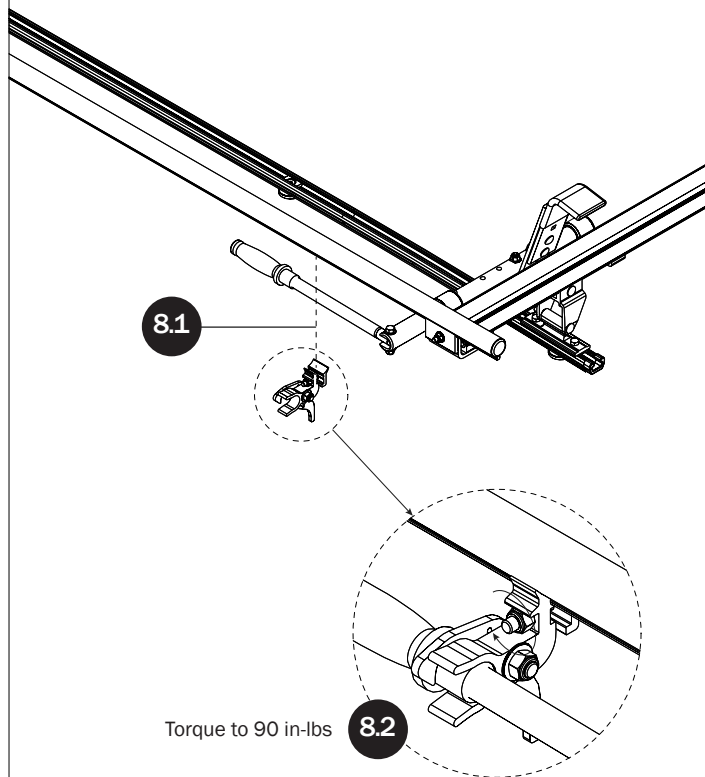
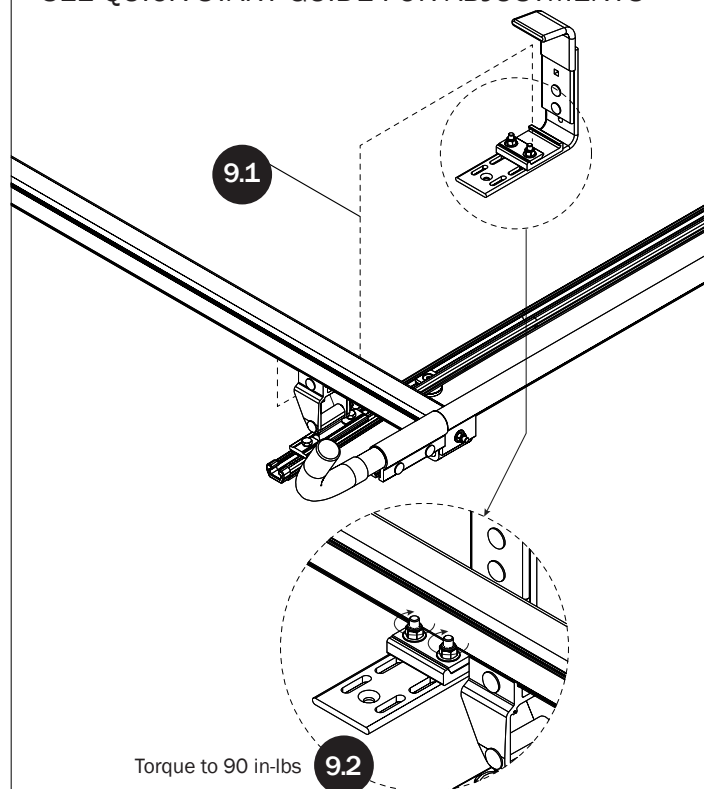
HANDLE LATCH**FRONT LADDER HOOK**
SEE QUICK START GUIDE FOR ADJUSTMENTS

USAM-VCCCE-US01 Rev-A 0618