

PRIME DESIGN™

A Safe Fleet Brand

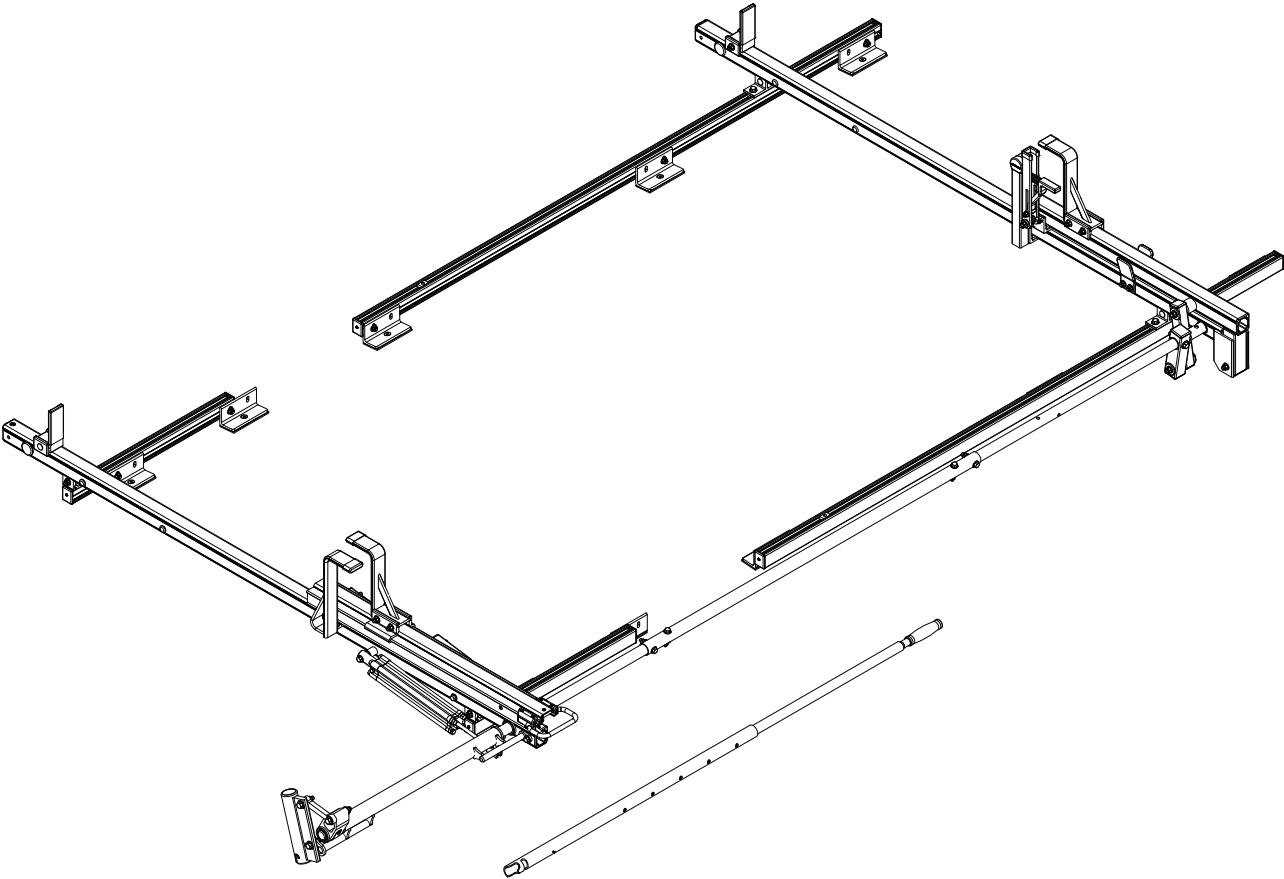

3574 HBI-E

CONTENTS OVERVIEW

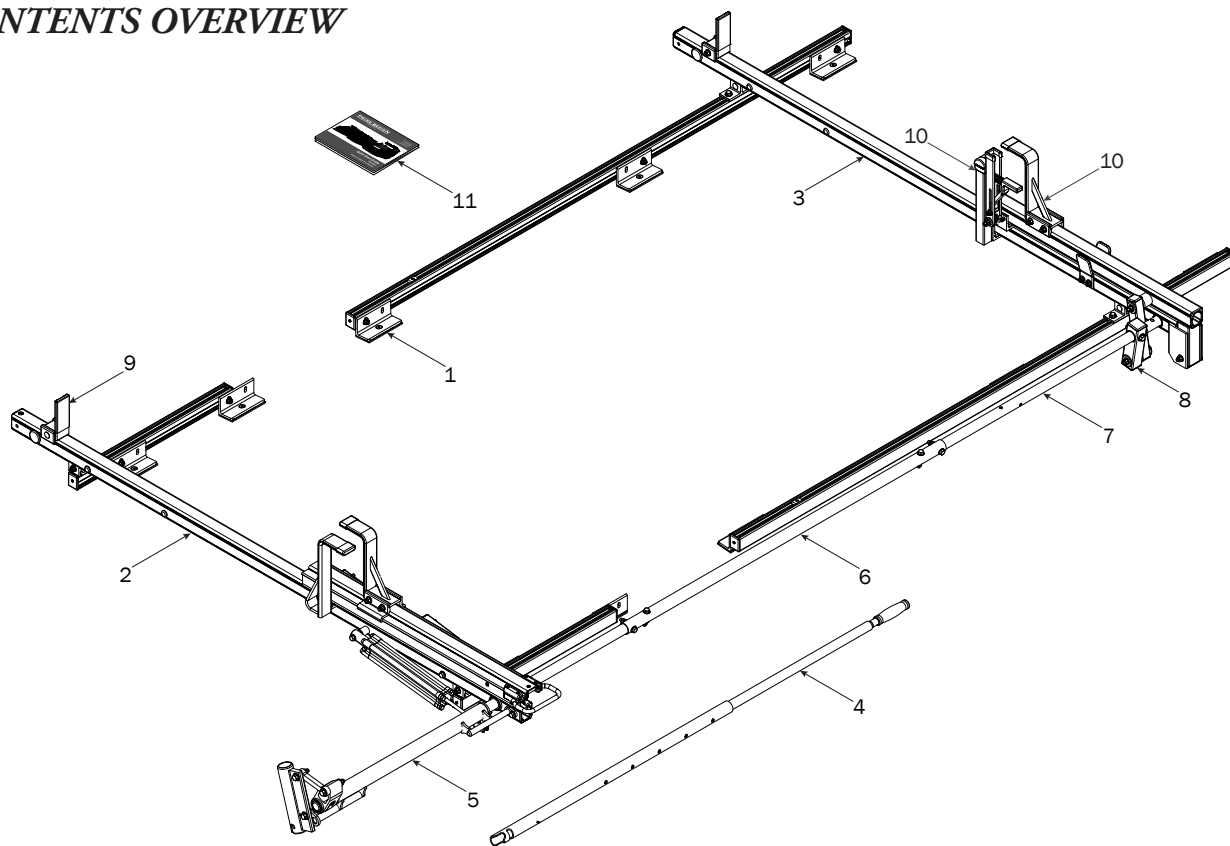

1—FBM-0094 (Qty 1)
Channels w/ Hardware



Channel Bracket (4X)

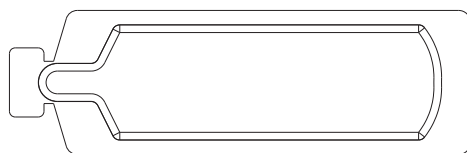
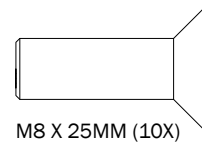
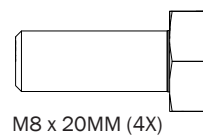

Anti-Seize (1X)

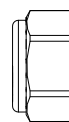

M8 Lock Nut (10X)

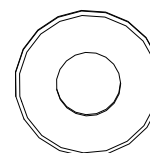

5/16" Flat Washer (14X)



Mounting Bracket (10X)



Foam Pad (10X)

2—Rear Crossbar Assembly (Qty 1)

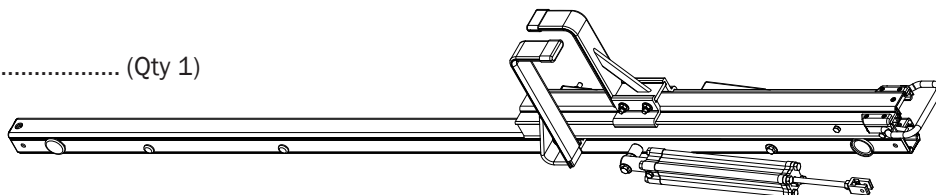

3—Front Crossbar Assembly (Qty 1)

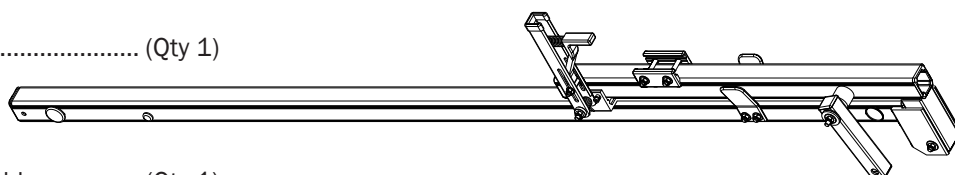

4—HRR Removeable Handle Assembly (Qty 1)



5—Drive Shaft (Qty 1)
Rear, Right Hand, 50.00"

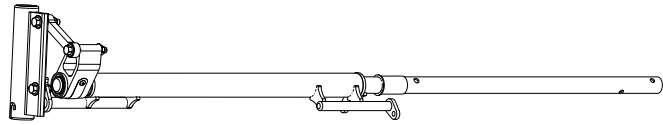

6—Connecting Bar (Qty 1)
48.00"

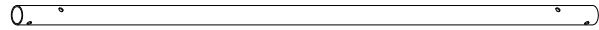

7—Front Drive Shaft (Qty 1)
B Version, 38.75"

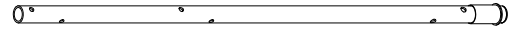

8—Drive Arm (Qty 1)
Incline Version with Bushing and Hardware

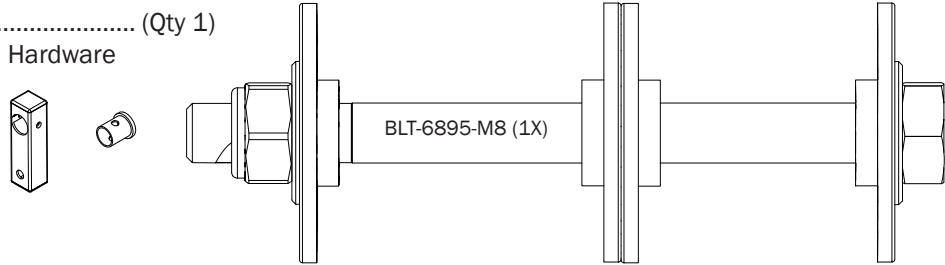

9—Ladder Stop Assembly (Qty 2)
1.75"

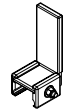

10—L & Z Post Kit..... (Qty 1)
Adj. Z Post, 7.25", L Post, w/HKT-0160

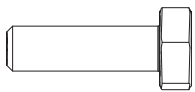

M6 x 20MM (1X)



1/4 Lock Washer (1X)

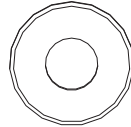

1/4 Flat Washer (1X)

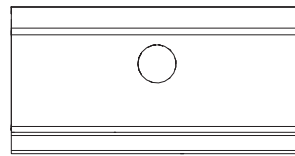

L Post Bracket Clamp (1X)

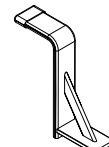

Z Post (1X)

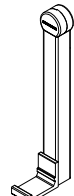

L Post (1X)

11—USQSG-Ergorack (Qty 1)
Quick Start Guide, Rotation



12—HKT-8163 (Not called out in Overview)..... (Qty 1)

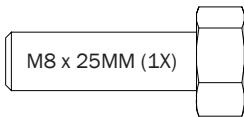

M8 x 25MM (1X)

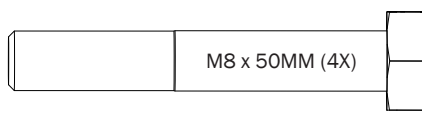

M8 x 50MM (4X)

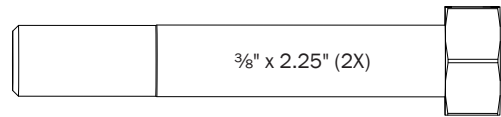

3/8" x 2.25" (2X)



Cotter Pin (1X)

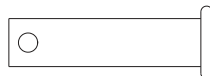

Clevis Pin (1X)

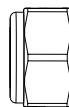

M8 Lock Nut (5X)



3/8" Lock Nut (2X)

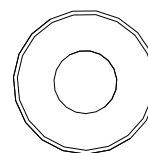

5/16" Flat Washer (10X)

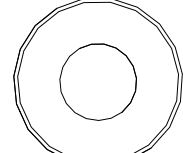

3/8" Flat Washer (4X)

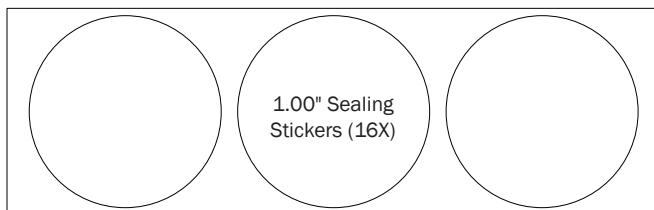

1.00" Sealing
Stickers (16X)



Anti-Seize (1X)

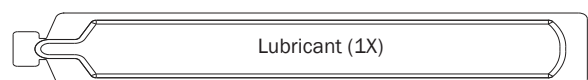

Lubricant (1X)

RIGHT SIDE ASSEMBLY SEQUENCE

Prior to assembling the Channels and hardware, the OEM roof holes must be chased using an M8 x 1.25 Chasing or Thread Cleaning tap and fluid. Doing so will ensure accurate torque is achieved.

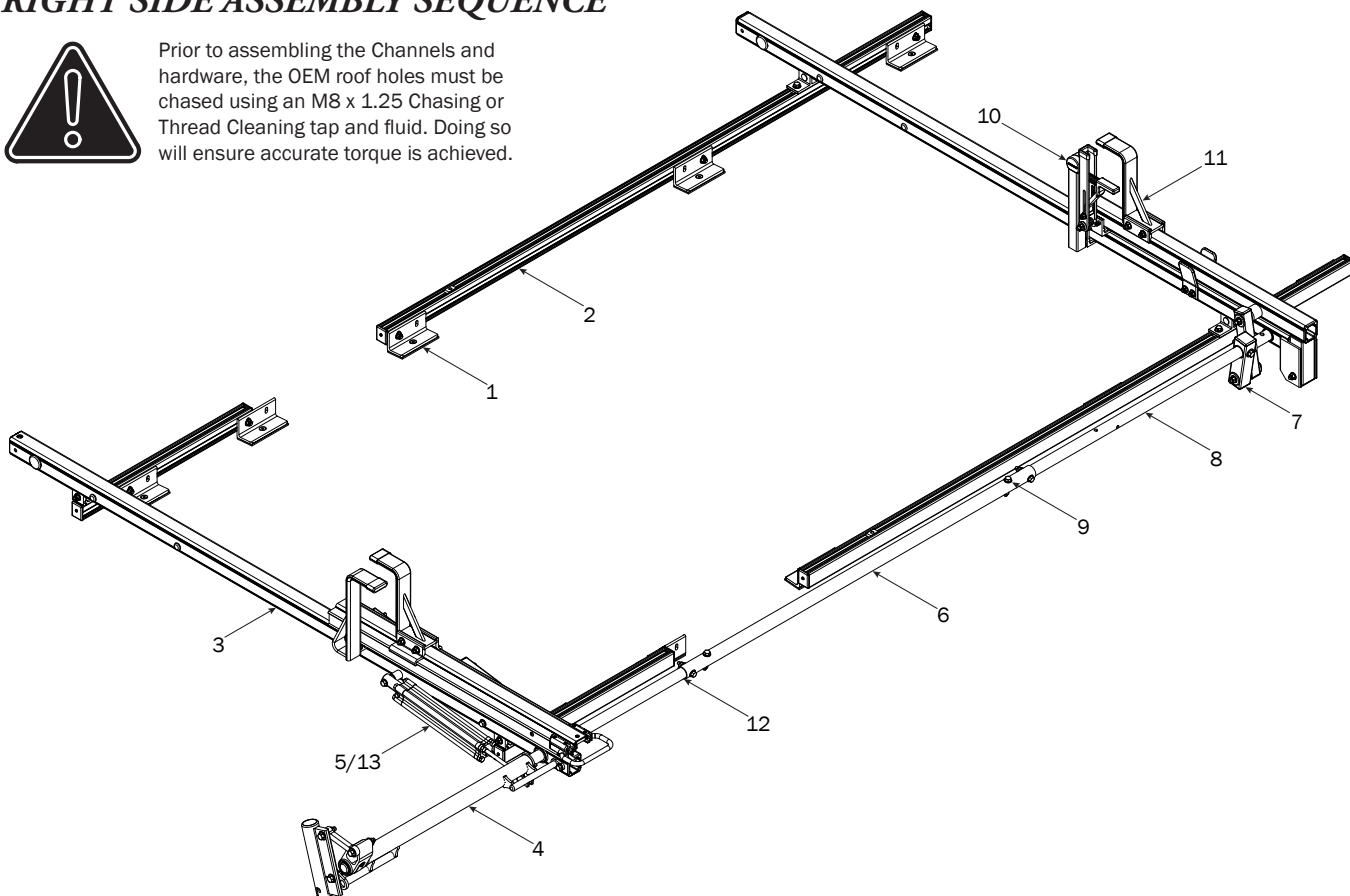
**MOUNTING BRACKETS****1**

Apply Anti-Seize to all M8 x 25MM Flat Head Screws and install the Channel Mounting Brackets with Foam Pads onto the vehicle's roof mounting holes. Do not tighten screws until Step 2.3

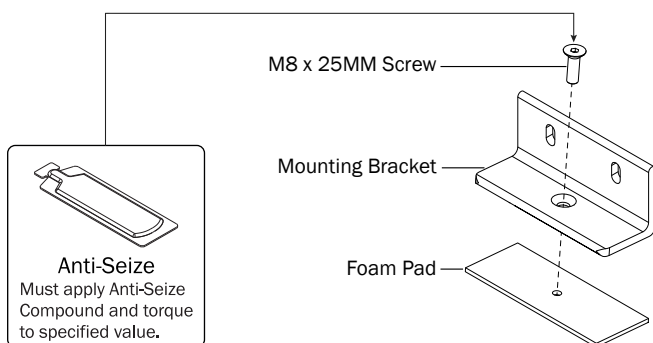
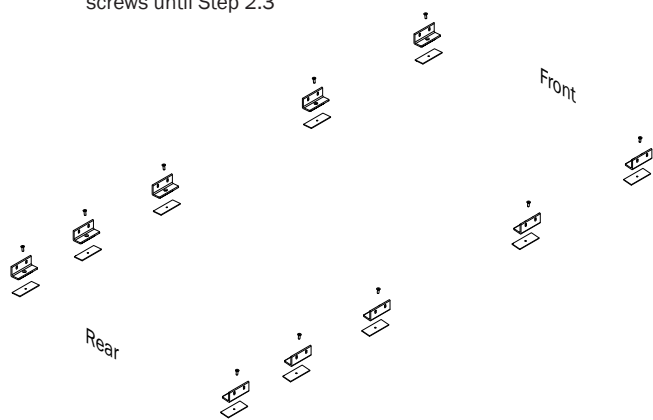
**CHANNELS****2.1**

Apply Anti-Seize to all M8 T Bolt studs, then attach to Mounts using the indicated hardware. Do not tighten until Step 2.2

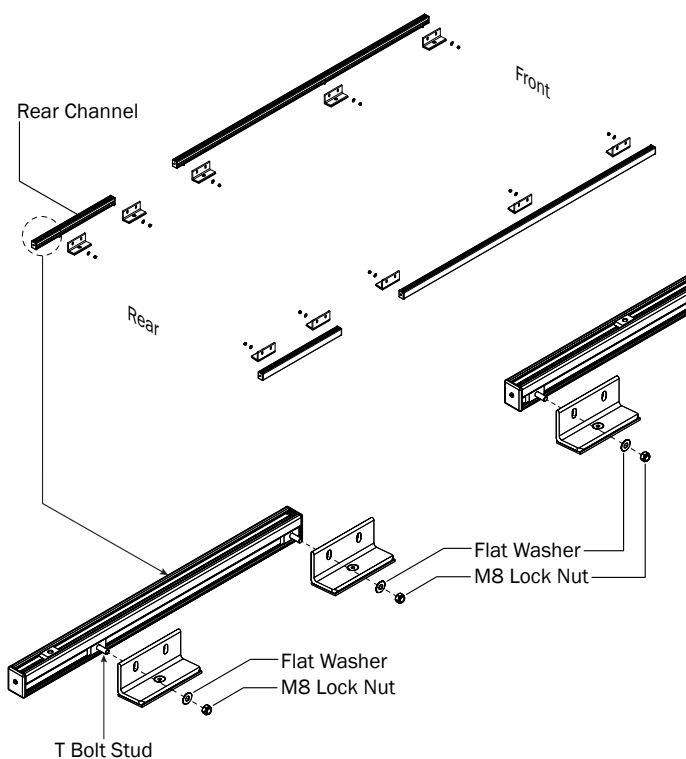



The Front Channels include two aluminum Strip Nuts per Channel for use in a three Crossbar configuration. For two Crossbar configurations, disregard the rear Strip Nut in each Front Channel.

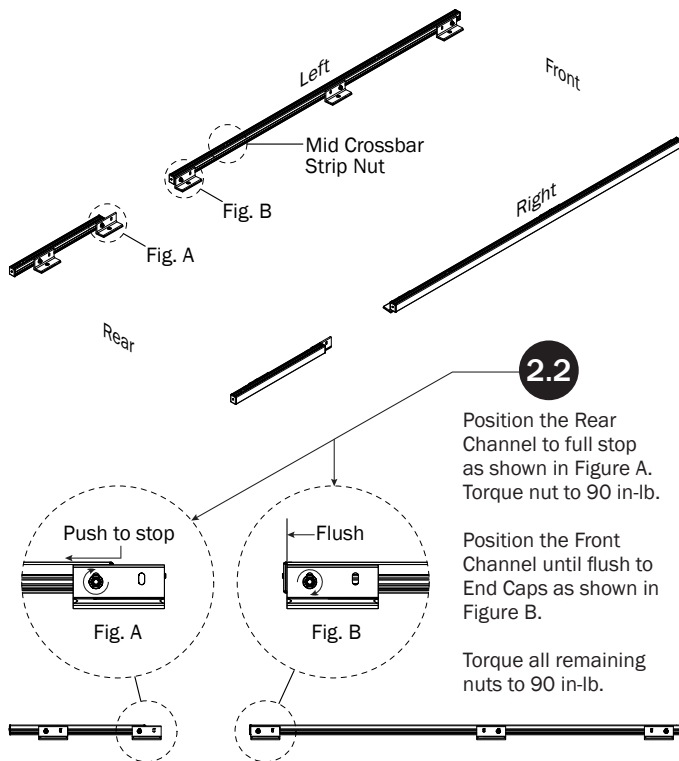

2.3

Torque all M8 x 25MM Flat Head Screws to 150 in-lbs. Apply Silicone Sealant to screw heads to seal against water intrusion.

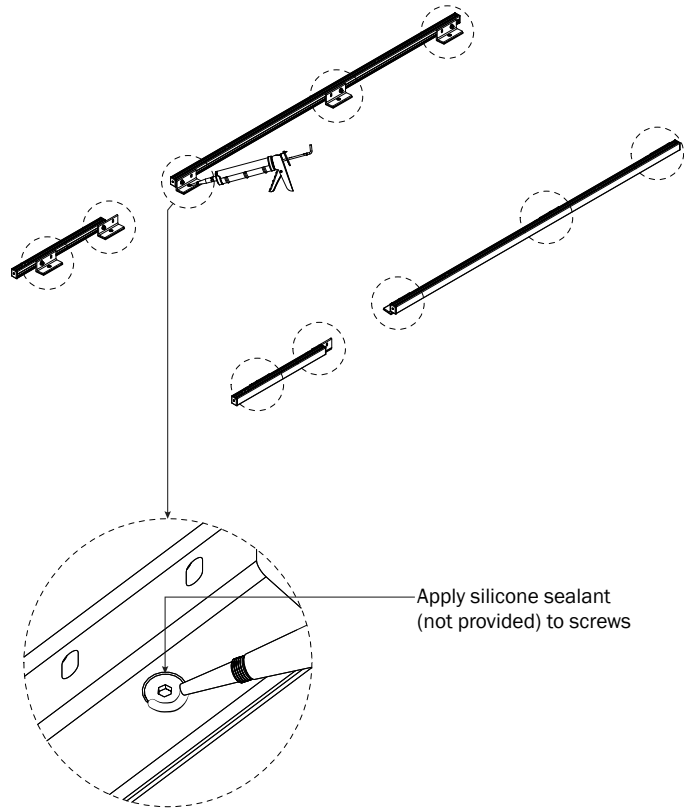

2.4

Attach Mounting Brackets to the Aluminum Strip Nuts located in the Channels

Position the rear and center Mounting Brackets as shown.

Position the front Mounting Brackets as shown.

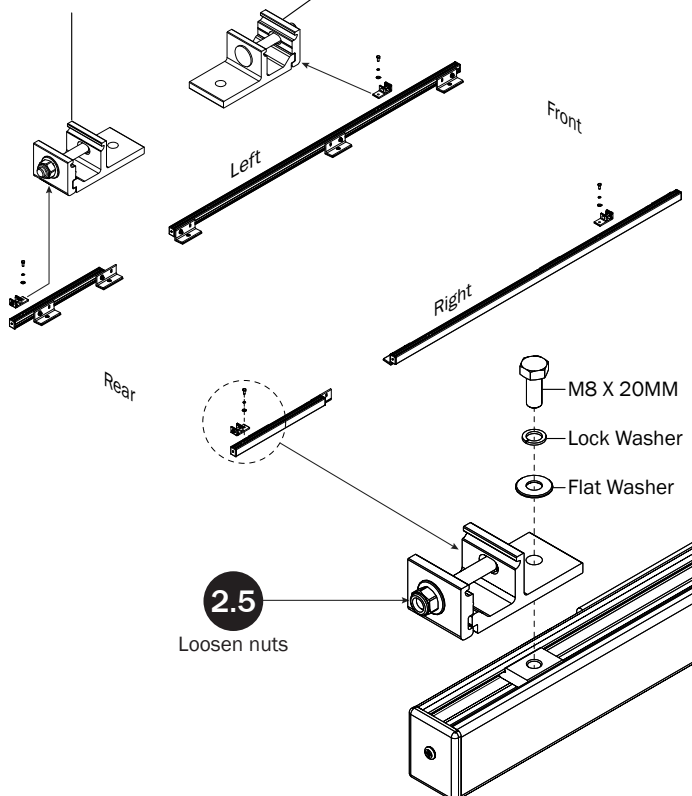

2.6

Position Mounting Brackets to designated dimension shown below, then torque the M8 X 20MM bolt to 90 in-lbs. Proceed to Step 3.1.

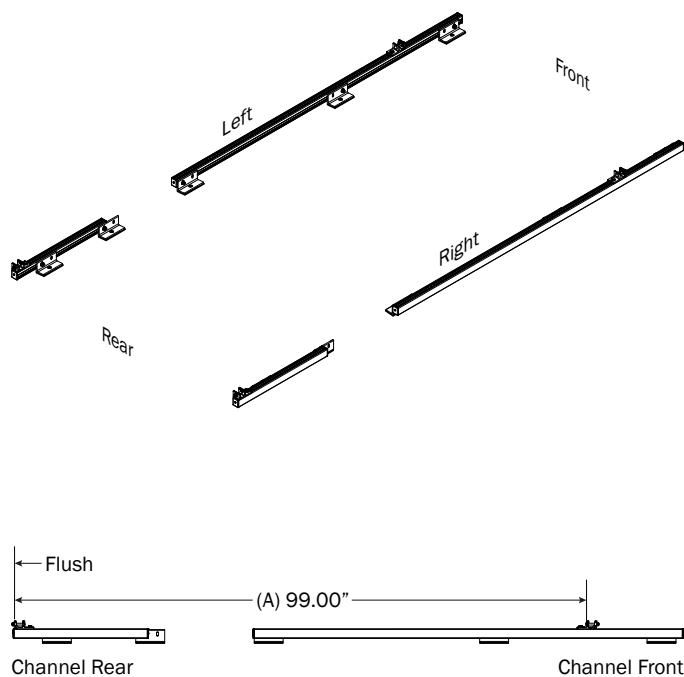

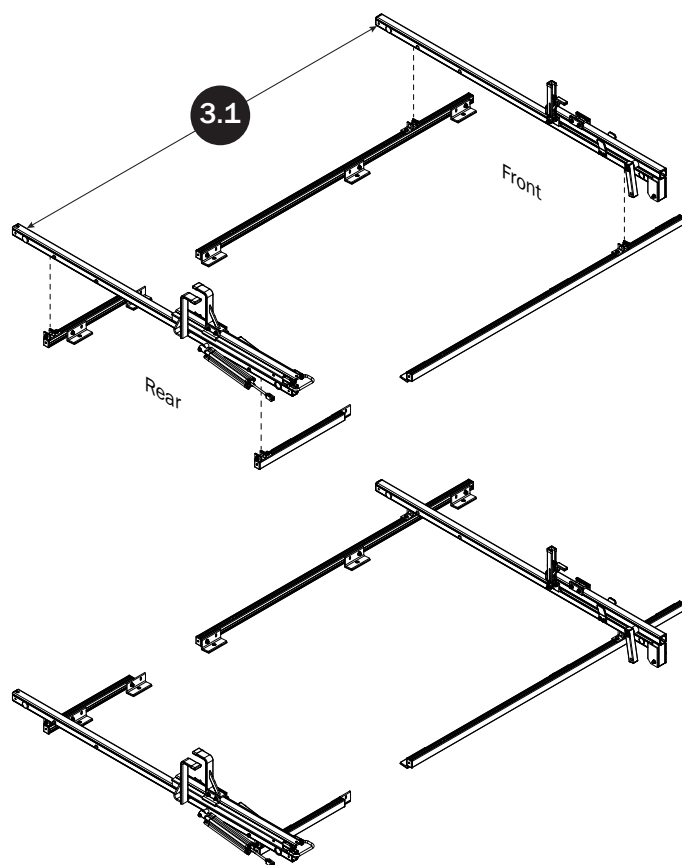
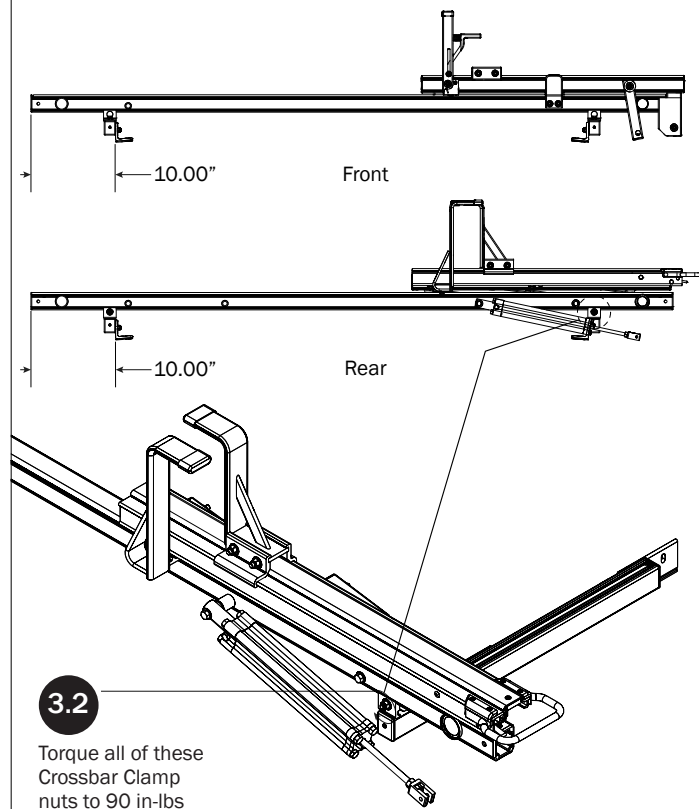
CROSSBARS**CROSSBAR ADJUSTMENT****REAR DRIVE SHAFT**

NOTE: For instructional clarity, the FBM Mounting System will not be shown for the remainder of this Assembly Manual.

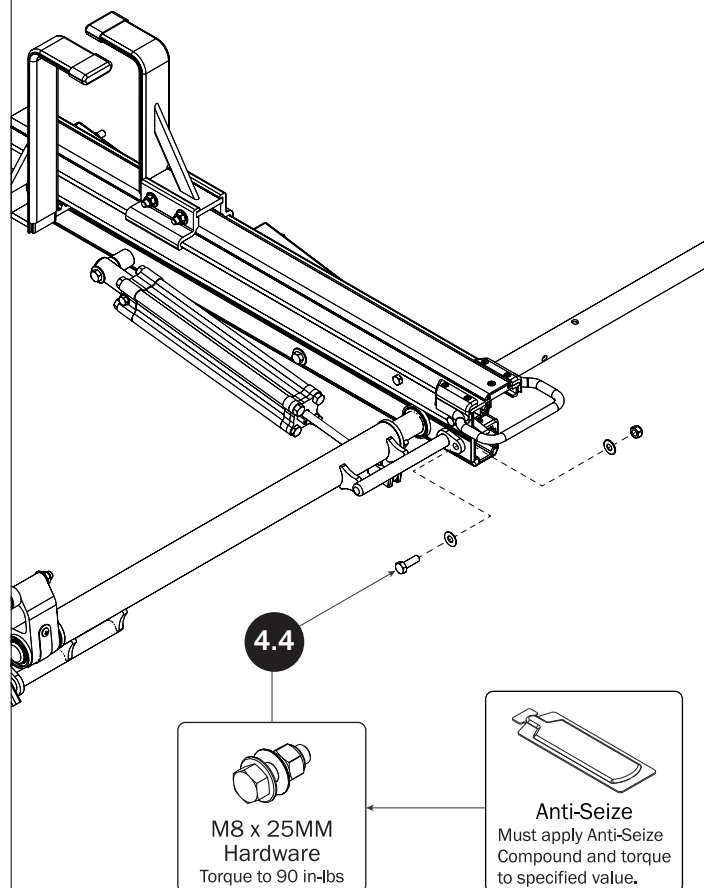
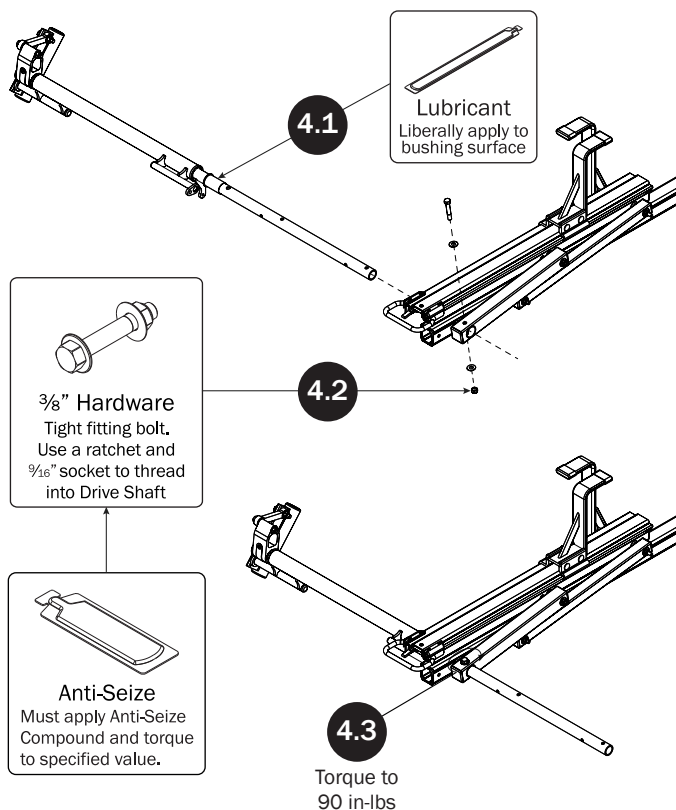

CYLINDER HARDWARE

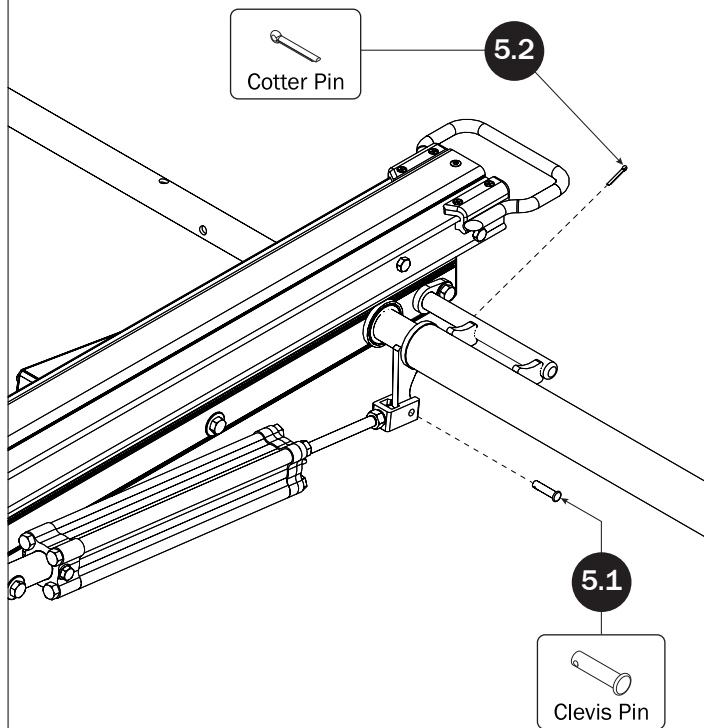

CONNECTING BAR

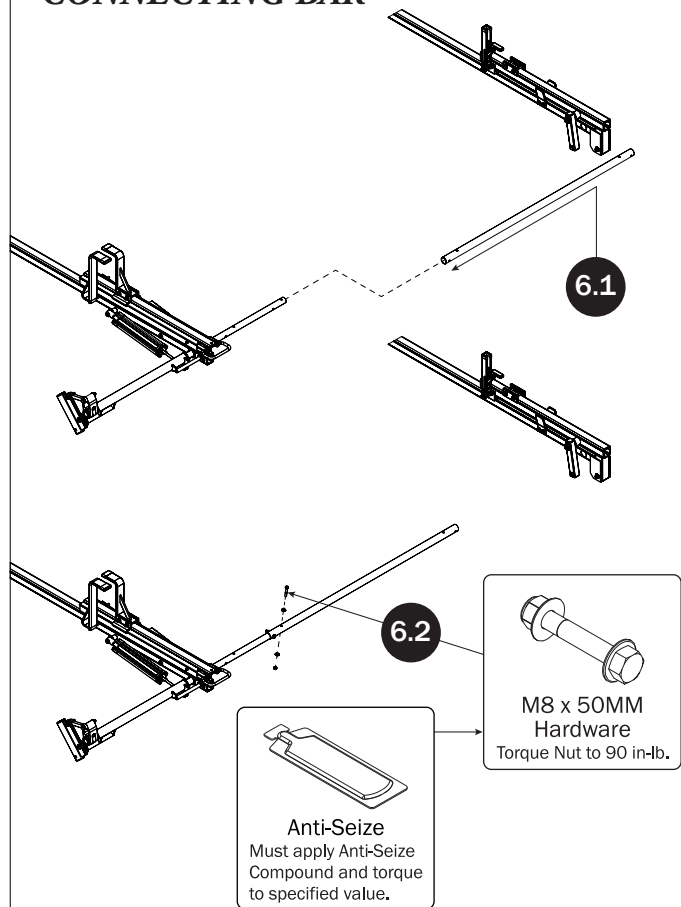

FRONT DRIVE ARM

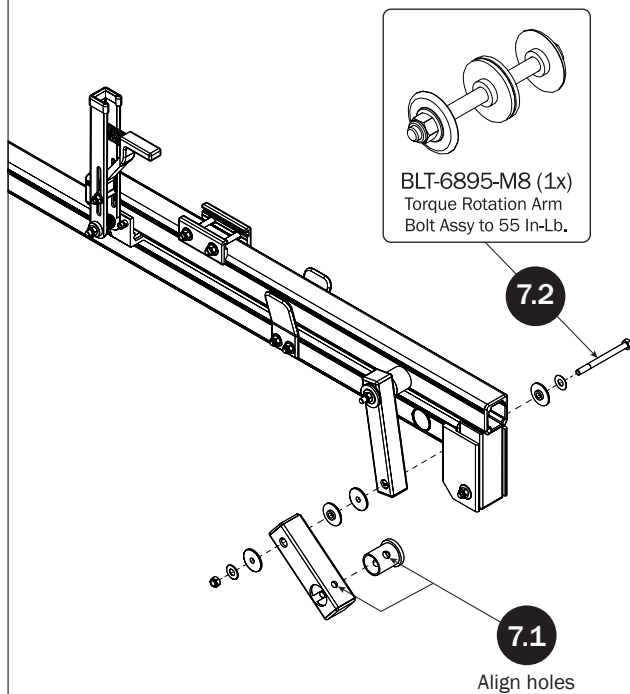

FRONT DRIVE SHAFT

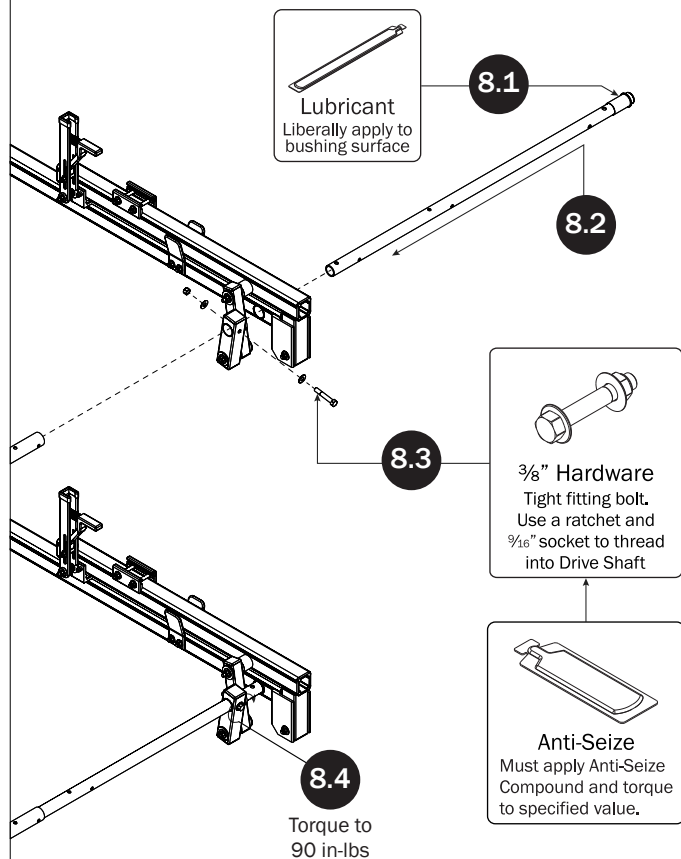

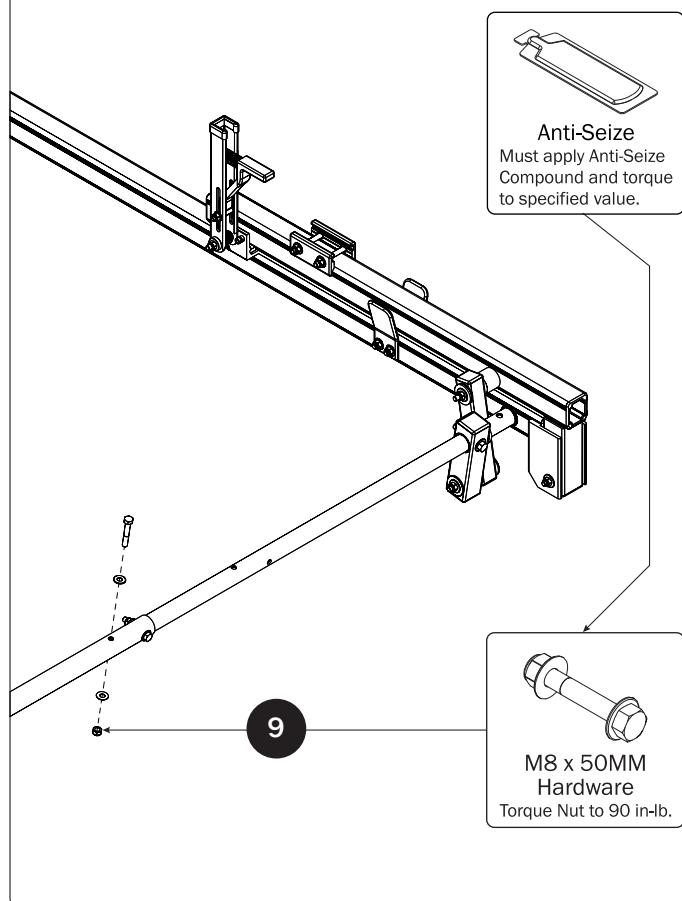
CONNECTING BAR FASTENERS**L POSTS****SEE QUICK START GUIDE FOR ADJUSTMENTS**

NOTE: The front Auto Clamp come preset from the factory for packaging purposes only. To assemble the L Post to the Crossbar, the Auto Clamps must be repositioned.

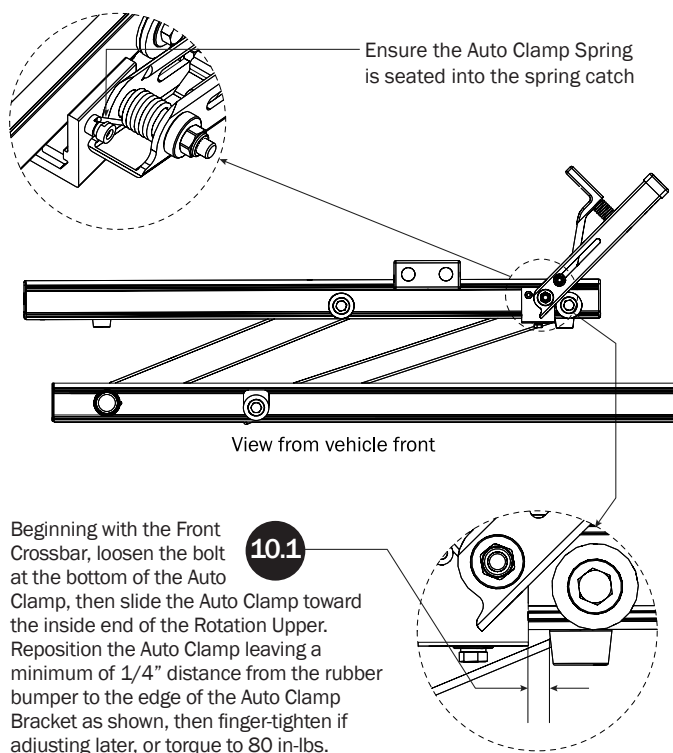

- 10.2** Place an L Post into the bottom groove of the Front Crossbar

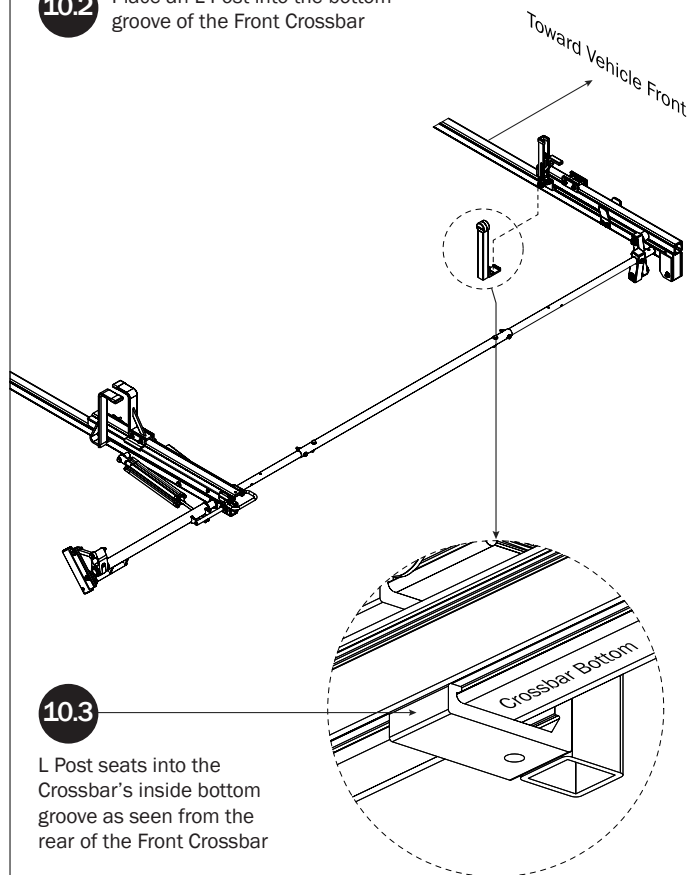

- 10.4**

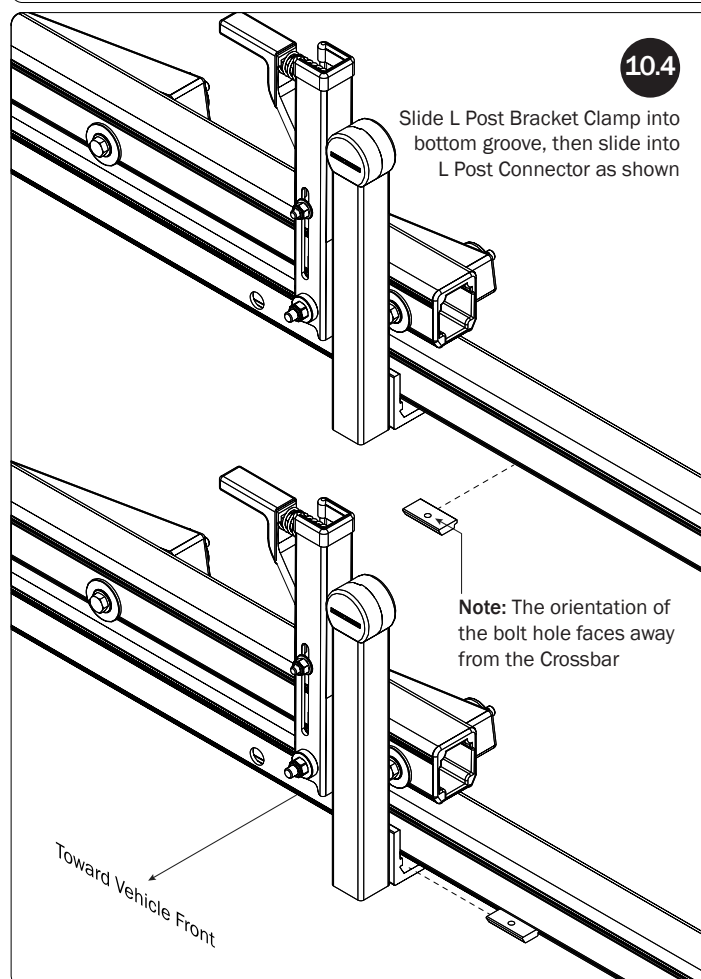

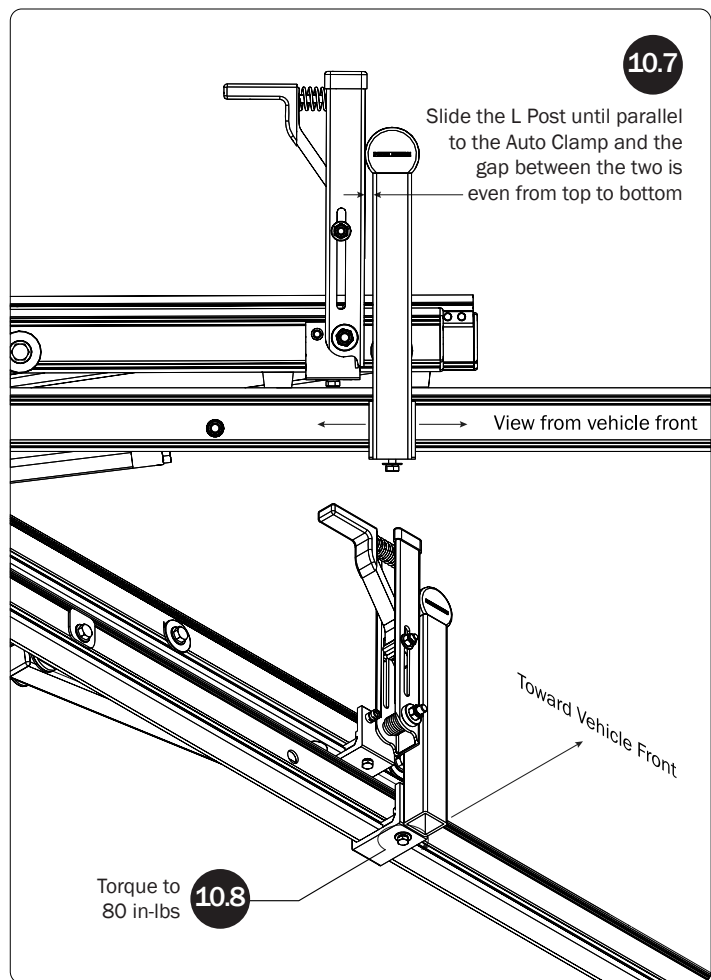
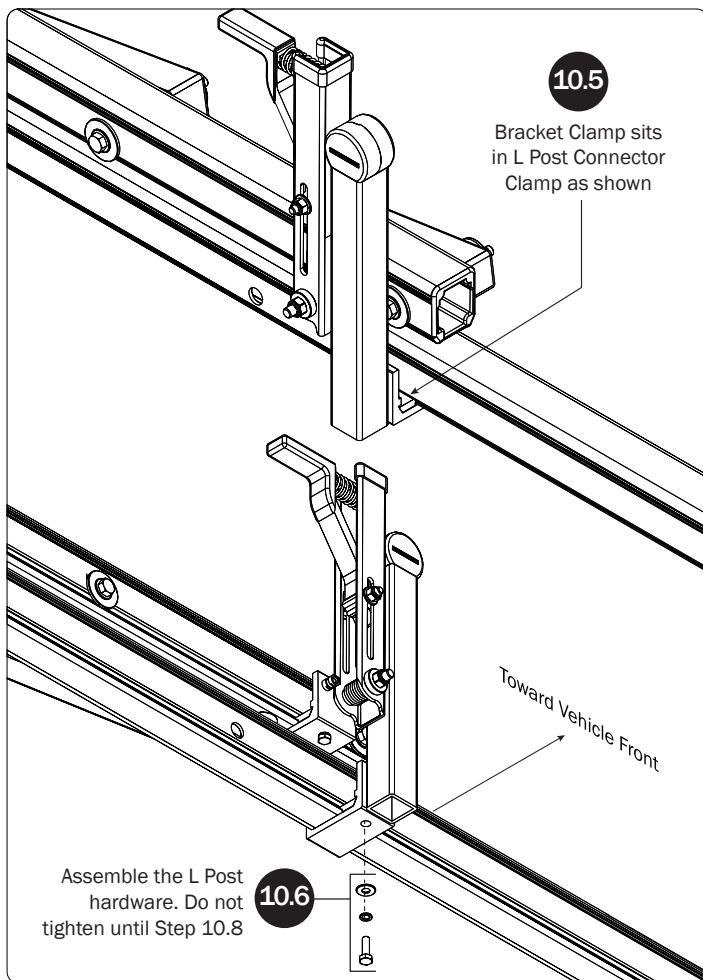

Z POSTS

SEE QUICK START GUIDE FOR ADJUSTMENTS

- 11.1** Assemble the Z Post Mounting Clamp Assembly onto the Rotation Upper. Do not tighten until Step 11.4

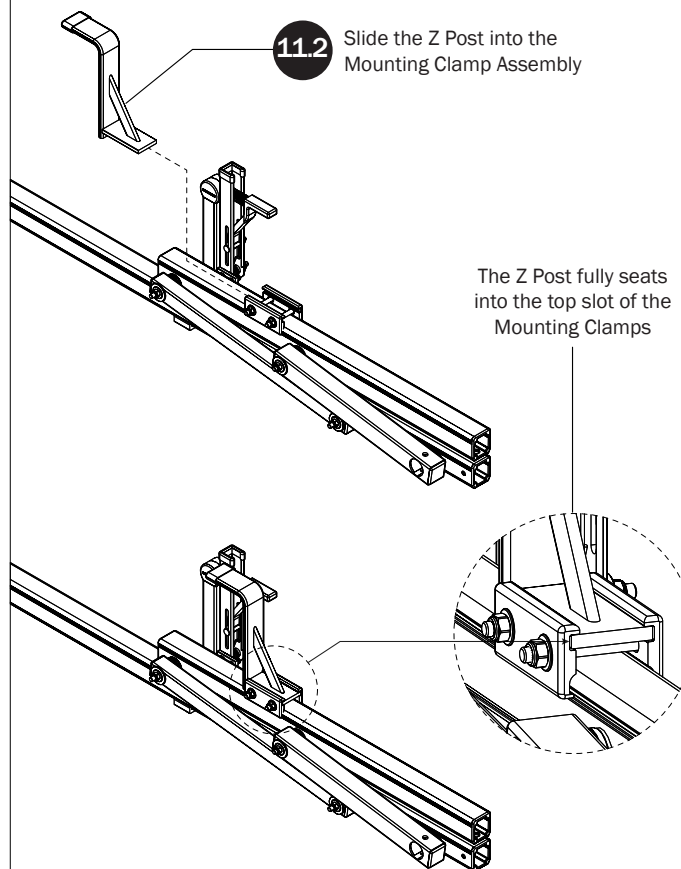
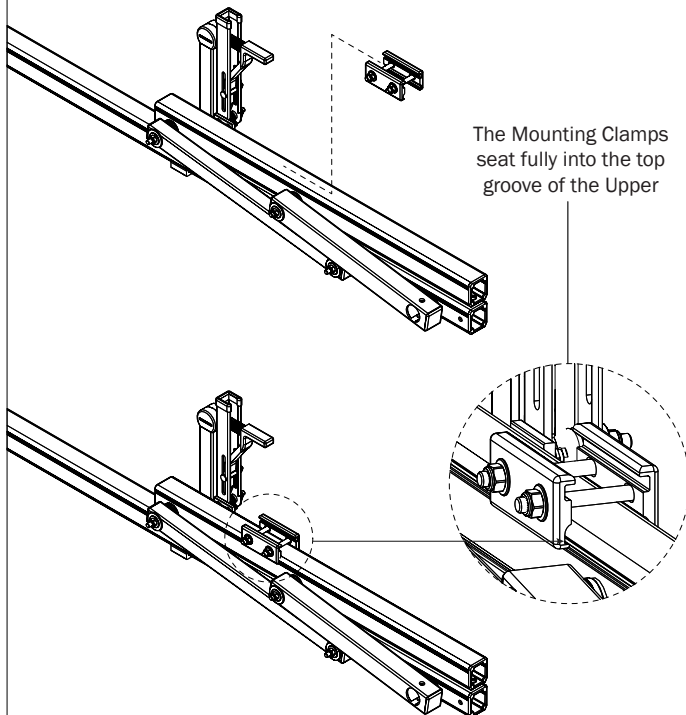

11.3

Refer to the Quick Start Guide for Z Post positioning.

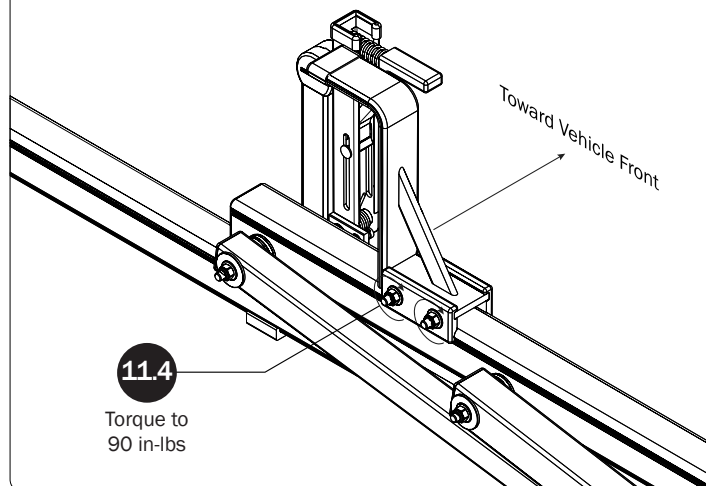
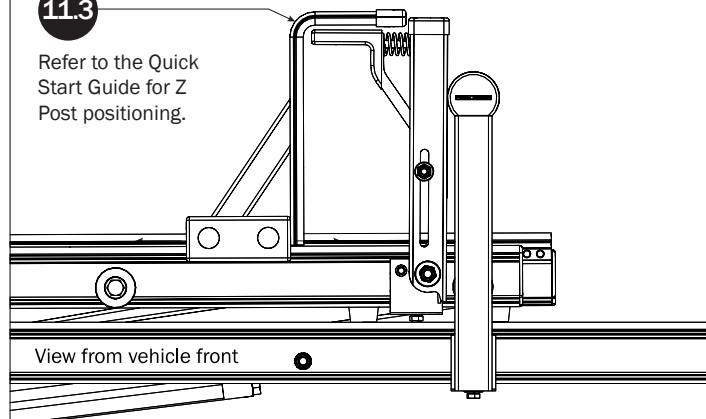

CYLINDER ADJUSTMENT

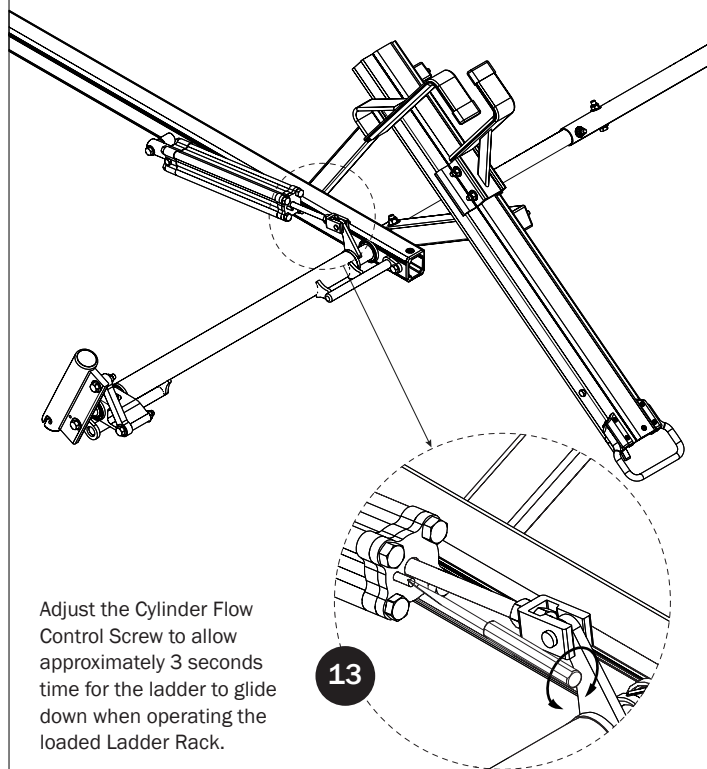

DRIVE SHAFT SEALING

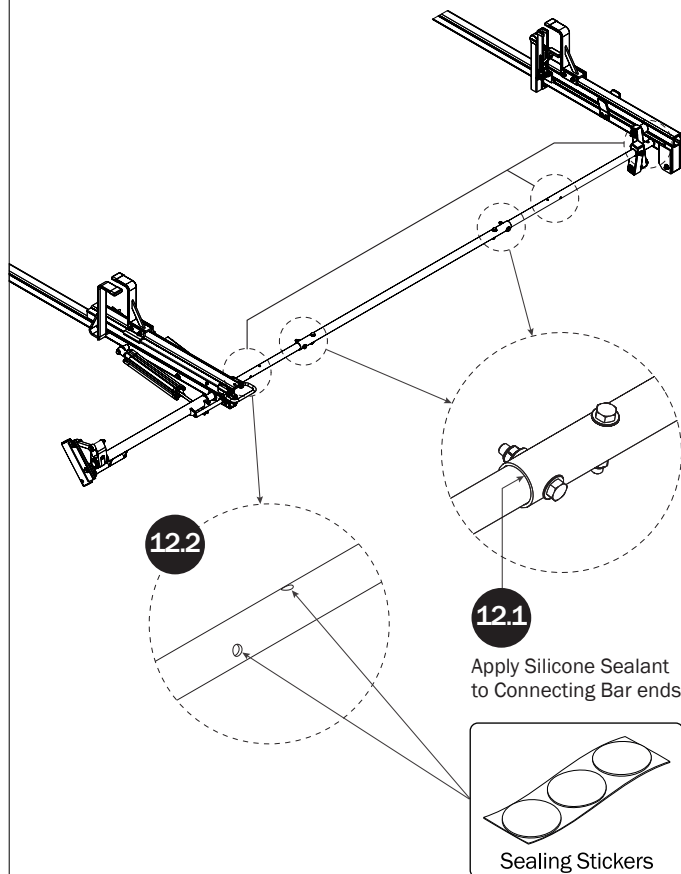

LEFT SIDE ASSEMBLY SEQUENCE

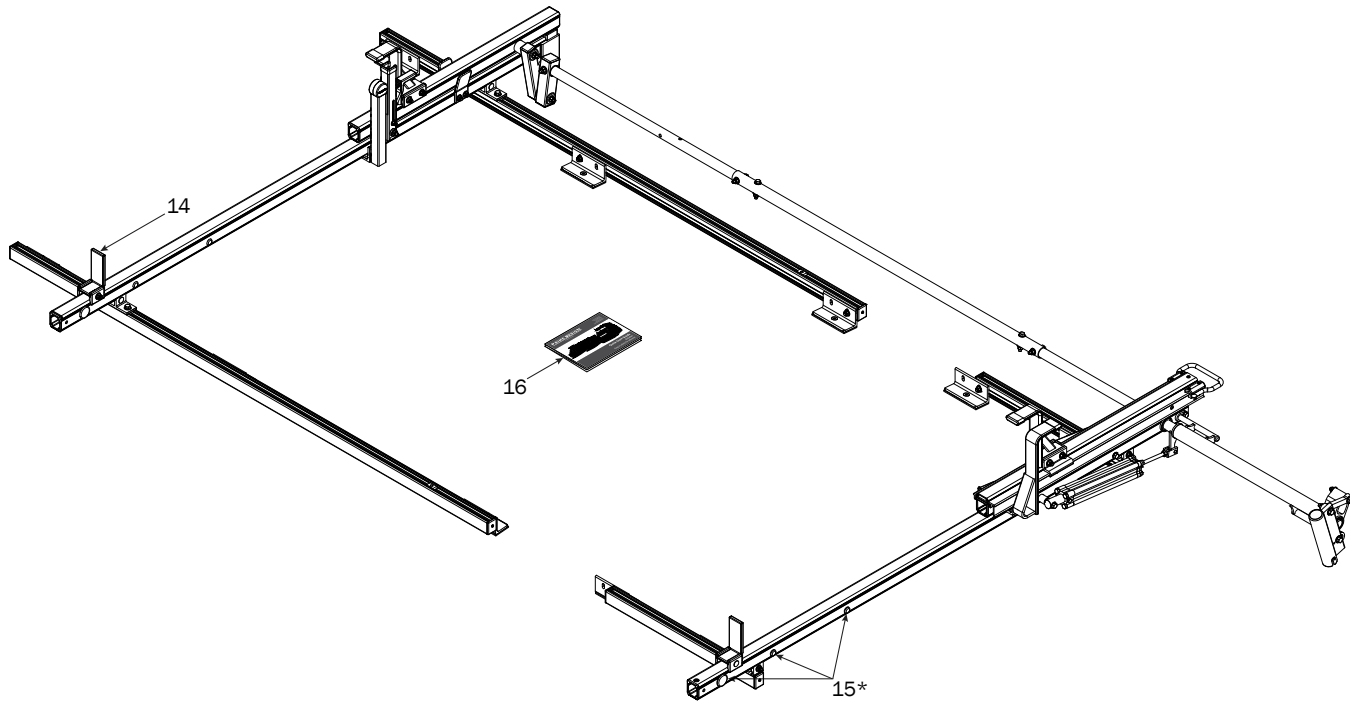

* NOTE: Crossbars may not have Caps installed from the factory. If factory-installed, proceed to Step 14 and ignore Step 15. If not installed, Caps will be included in the Hardware Kit. Press them into the Crossbars as shown in Step 15.

LADDER STOPS

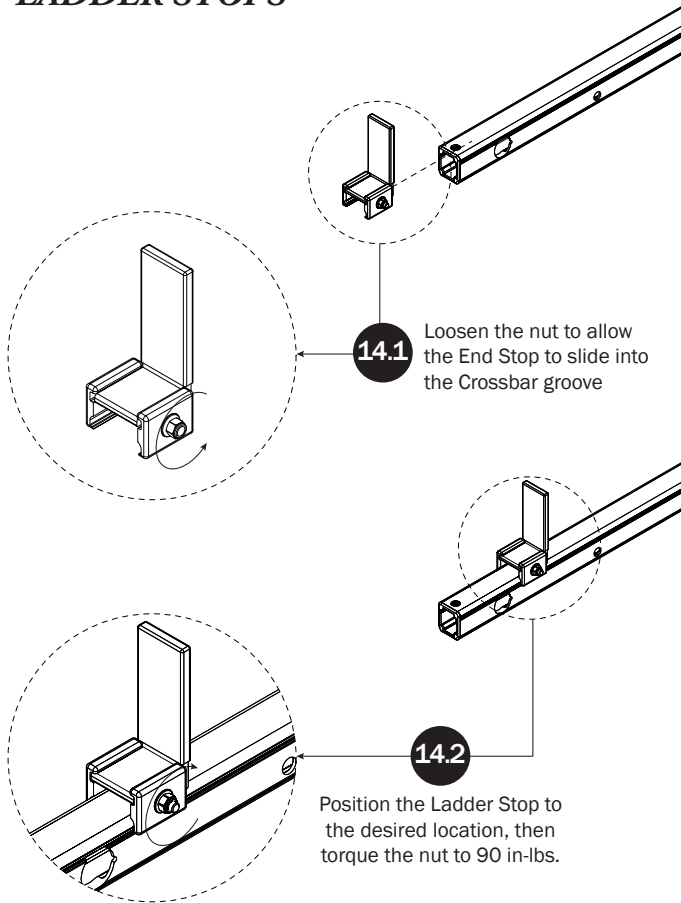

CROSSBAR CAPS

NOTE: Some Front Crossbars may have additional drilled holes. Press Crossbar Caps into Crossbar holes if present and unused.

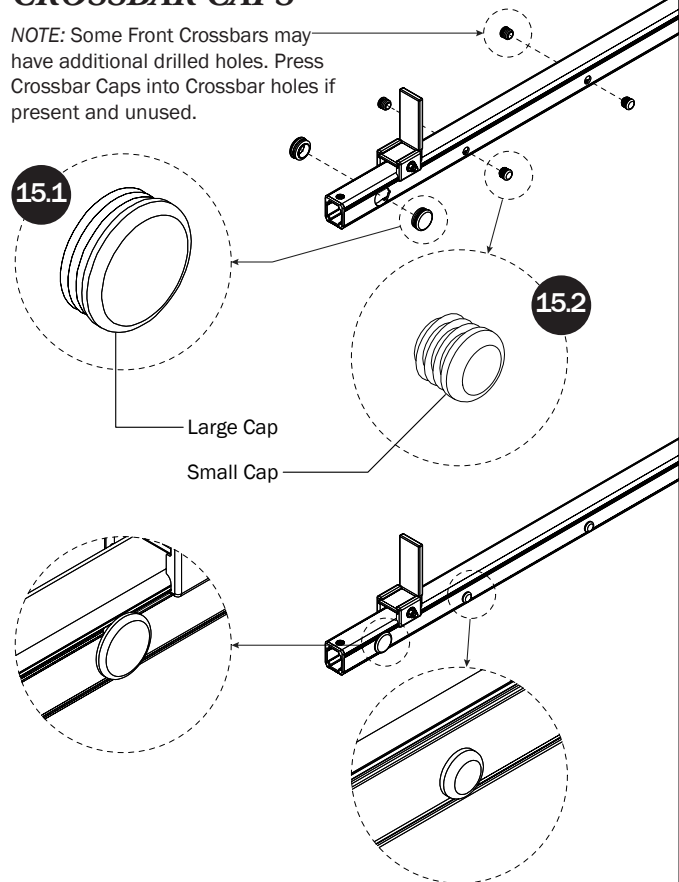

QUICK START GUIDE**16**

Place the Quick Start Guide into the vehicle's glove box for ladder setup and adjustment.

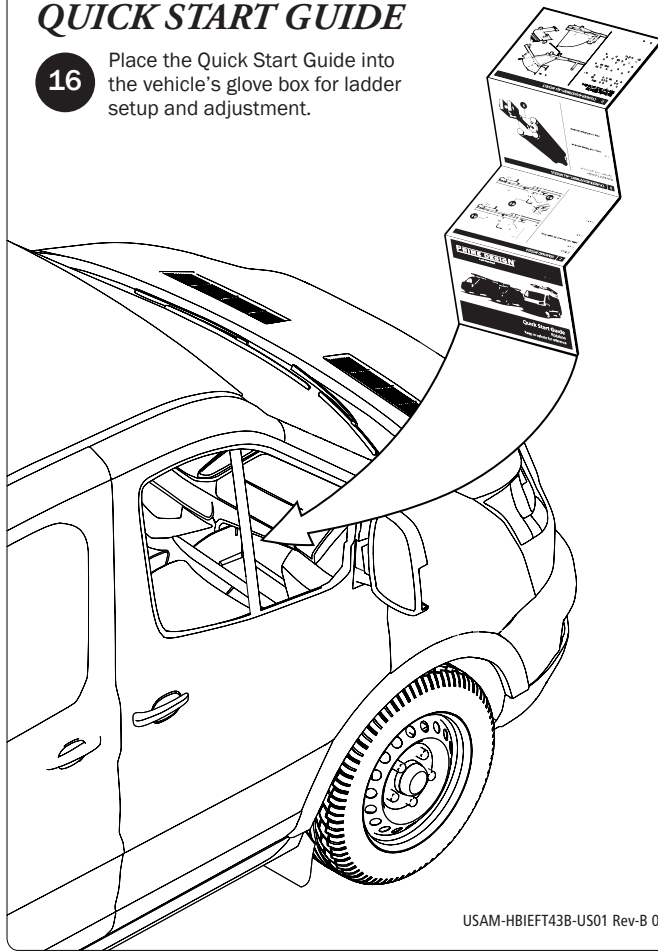

USAM-HBIEFT43B-US01 Rev-B 0419