

**PRIME DESIGN™**

A Safe Fleet Brand

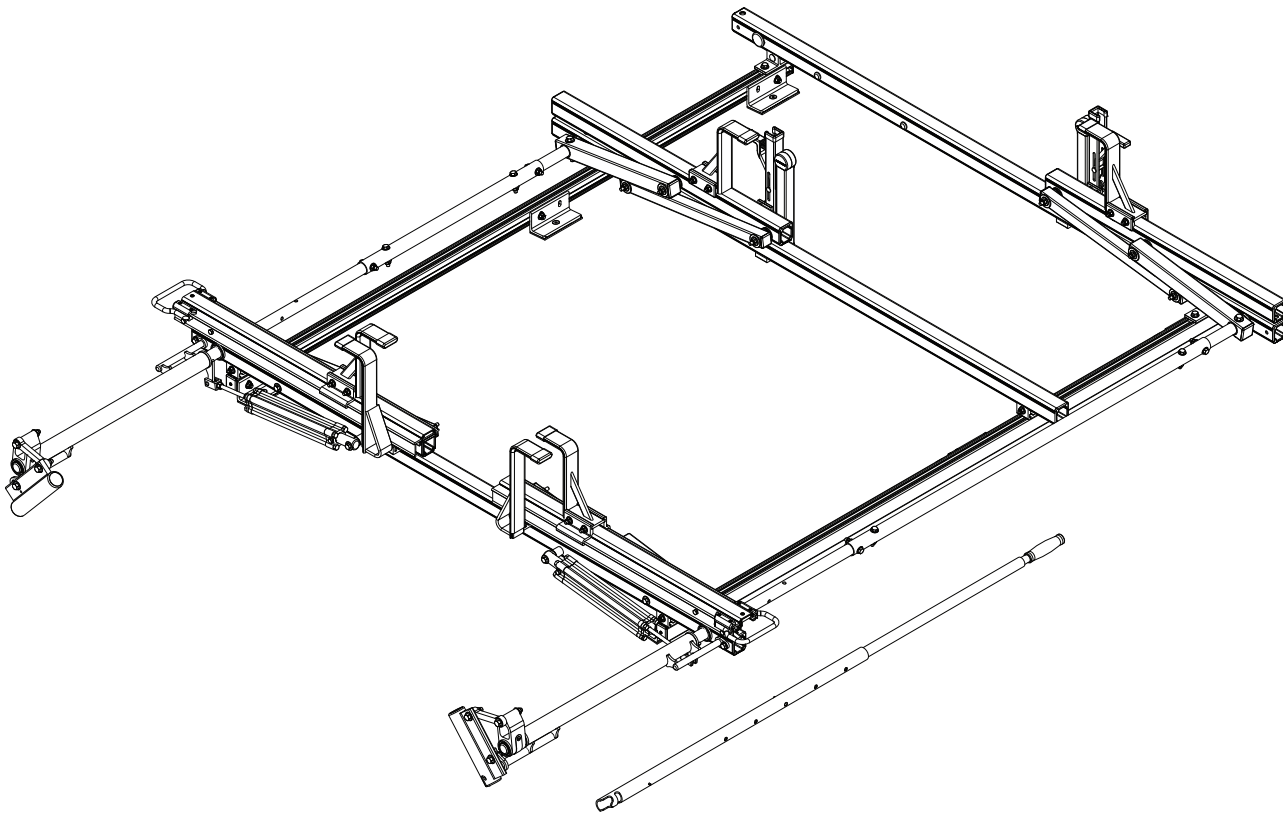

**PRIME**  
**HR3-E**

## CONTENTS OVERVIEW

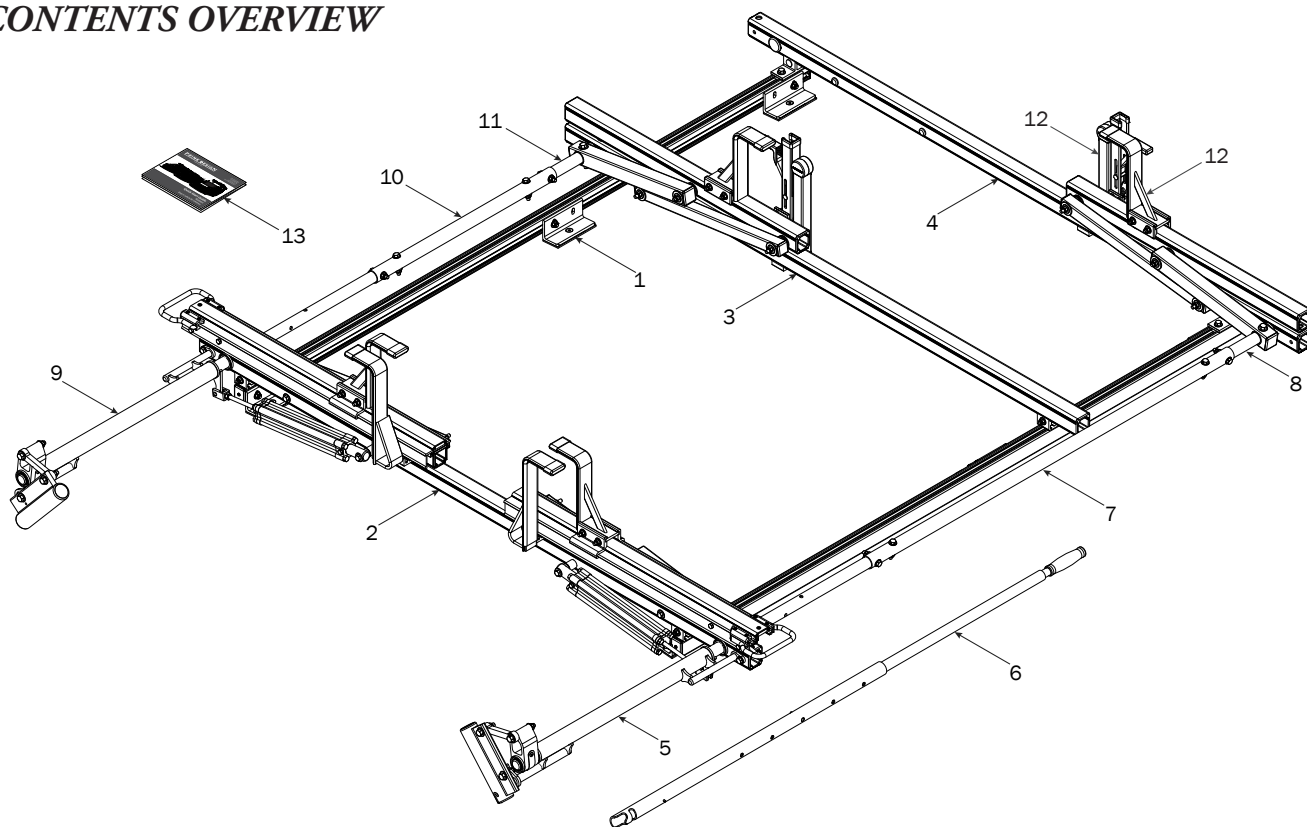

1—FBM3-0096 ..... (Qty 1)

Channels w/ Hardware

74" Channels, Pre-assembled (2X)



Mounting Bracket (6X)



Foam Pad (6X)



Channel Bracket (6X)

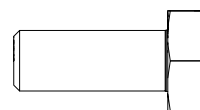

M8 x 20MM (6X)



M8 X 25MM (6X)

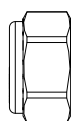

M8 Lock Nut (6X)

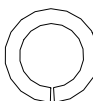

5/16" Lock Washer (6X)

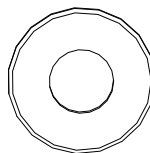

5/16" Flat Washer (12X)



Anti-Seize (1X)

2—Rear Crossbar Assembly ..... (Qty 1)

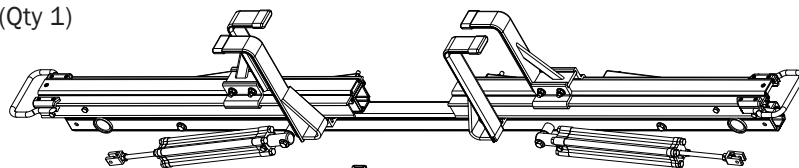

3—Center Crossbar Assembly ..... (Qty 1)

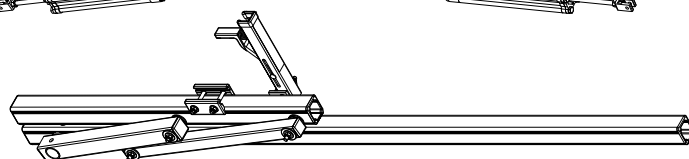

4—Front Crossbar Assembly ..... (Qty 1)

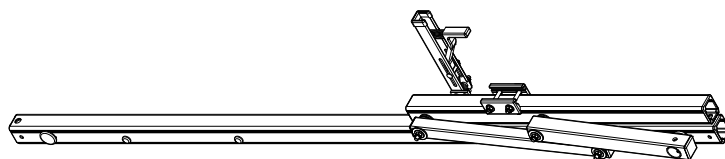

5—Rear Drive Shaft ..... (Qty 1)  
Right Hand, A Version, 50.00"

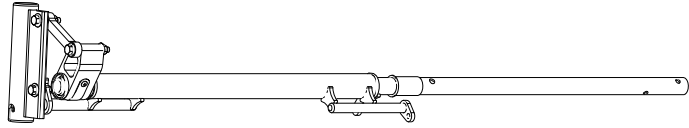

6—HHR Handle Assembly ..... (Qty 1)  
35.00"

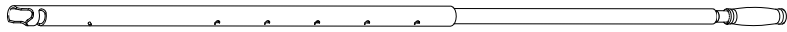

7—Connecting Bar ..... (Qty 1)  
4.00'

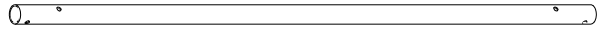

8—Front Drive Shaft ..... (Qty 1)  
B Version, 35.75"

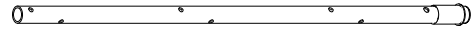

9—Rear Drive Shaft ..... (Qty 1)  
Left Hand, A Version, 50.00"

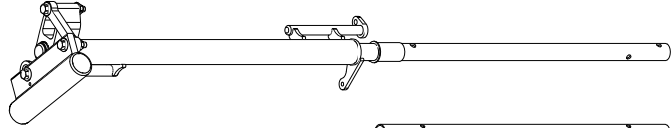

10—Connecting Bar..... (Qty 1)  
24.00"

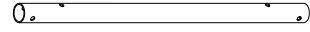

11—Front Drive Shaft..... (Qty 1)  
LH, B Version, 11.75"

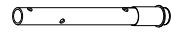

12—L & Z Post Kit ..... (Qty 2)  
Adj. Z Post, 7.25", L Post, w/HKT-0160

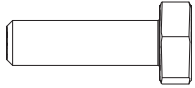

M6 x 20MM (1X)



1/4 Lock Washer (1X)

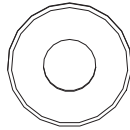

1/4 Flat Washer (1X)

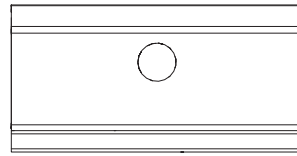

L Post Bracket Clamp (1X)

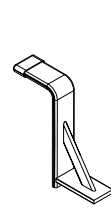

Z Post (1X)

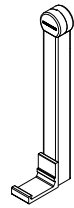

L Post (1X)

13—USQSG-Ergorack ..... (Qty 1)  
Quick Start Guide, Rotation



14—HKT-8163 (Not called out in Overview)..... (Qty 2)



Clevis Pin (1X)

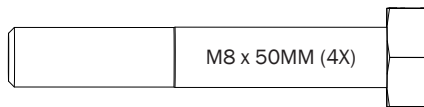

M8 x 50MM (4X)

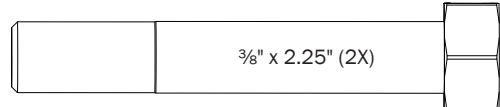

3/8" x 2.25" (2X)



Cotter Pin (1X)



M8 x 25MM (1X)



M8 Lock Nut (5X)

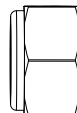

3/8" Lock Nut (2X)

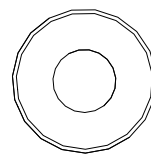

5/16" Flat Washer (10X)

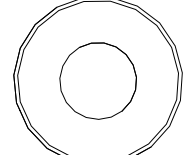

3/8" Flat Washer (4X)

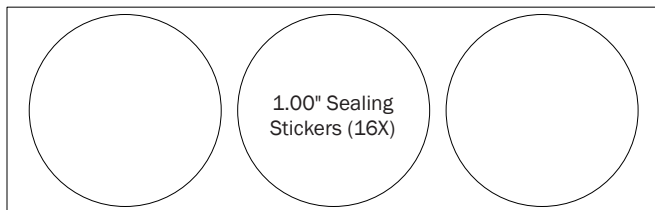

1.00" Sealing  
Stickers (16X)



Anti-Seize (1X)

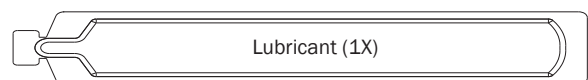

Lubricant (1X)

**RIGHT SIDE ASSEMBLY SEQUENCE**

Prior to assembling the Channels and hardware, the OEM roof holes must be chased using an M8 x 1.25 Chasing or Thread Cleaning tap and fluid. Doing so will ensure accurate torque is achieved.

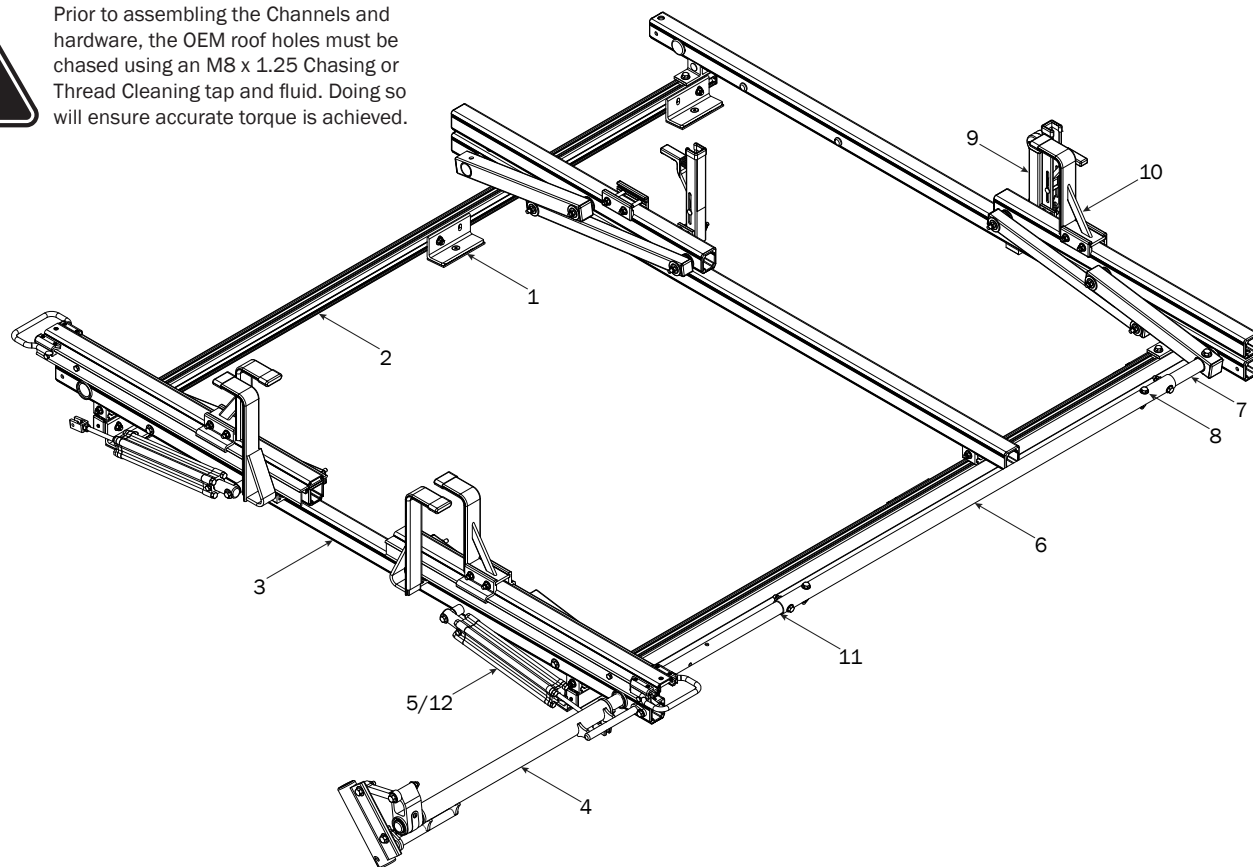
**MOUNTING BRACKETS****1**

Apply Anti-Seize to all M8 x 25MM Flat Head Screws and install the Channel Mounting Brackets with Foam Pads onto the vehicle's roof mounting holes. Do not tighten screws until Step 2.3

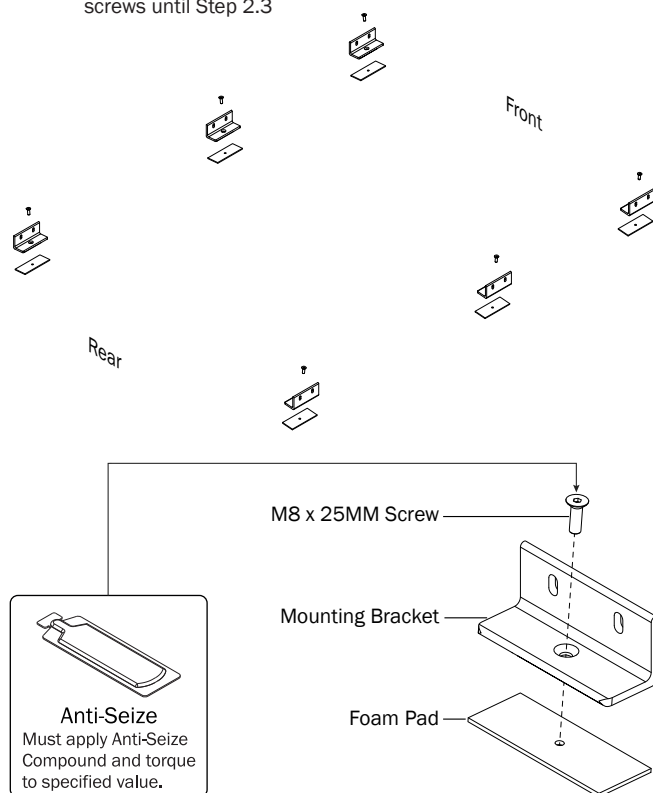
**CHANNELS****2.1**

Apply Anti-Seize to all M8 T Bolt studs, then attach the Channels to the Mounting Brackets using the indicated hardware. Do not tighten until Step 2.2

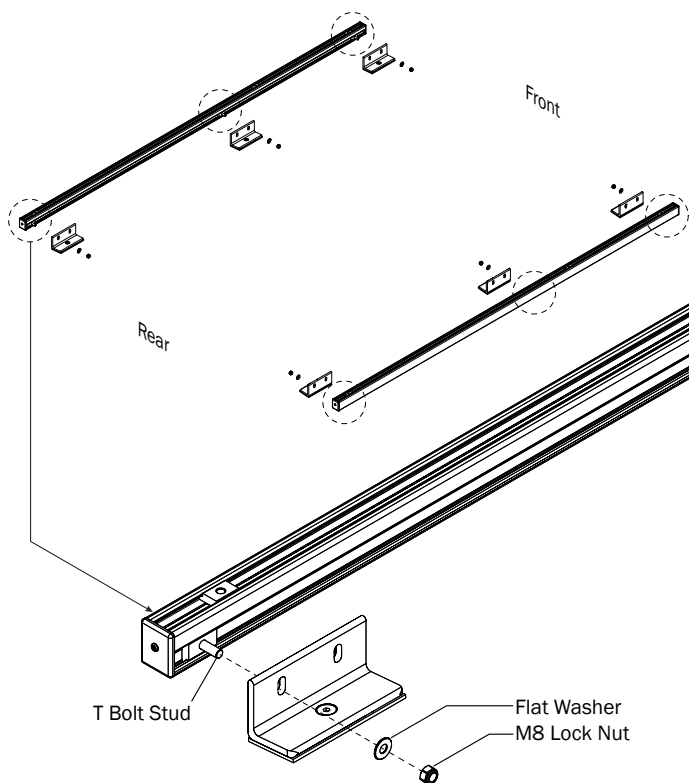

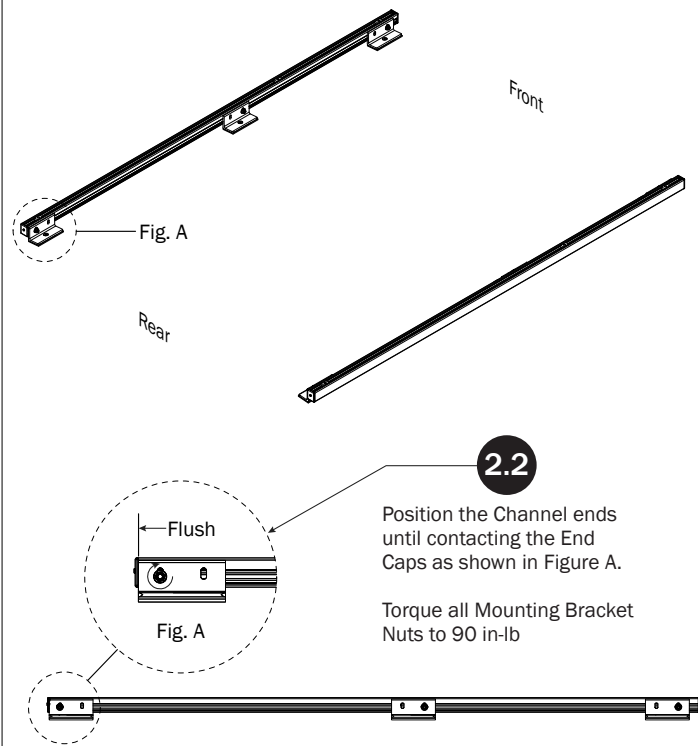

**2.3** Torque all M8 x 25MM Flat Head Screws to 150 in-lbs. Apply Silicone Sealant to screw heads to seal against water intrusion.

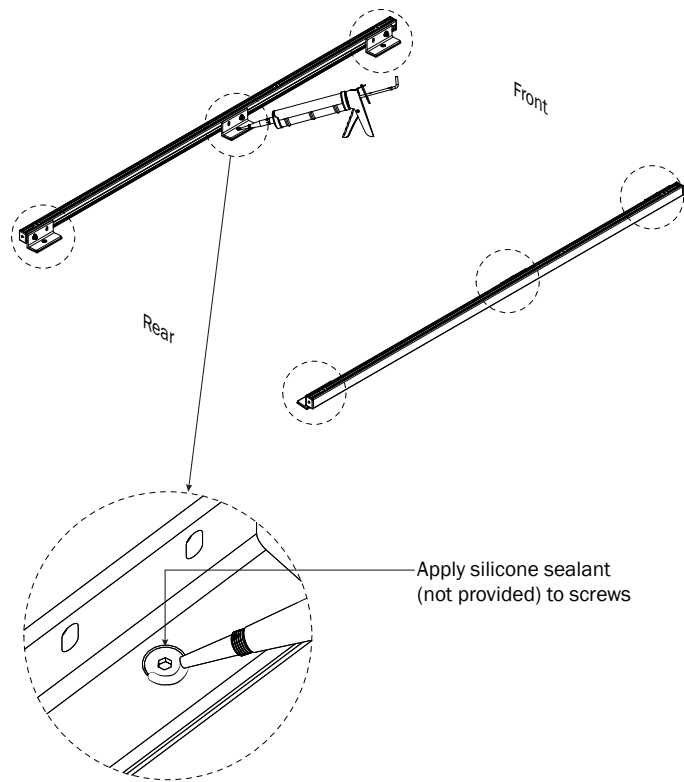

**2.4** Attach Mounting Brackets to the Aluminum Strip Nuts located in the Channels

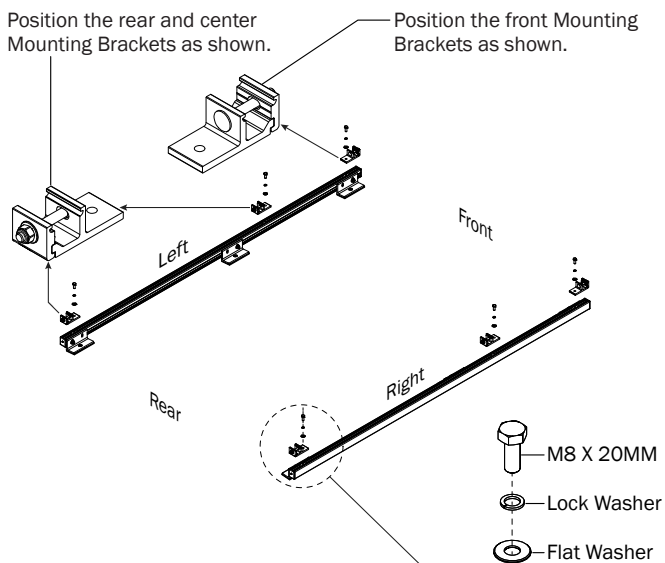

**2.5** Loosen nuts

**2.6** Position Mounting Brackets to designated dimension shown below, then torque the M8 X 20MM bolt to 90 in-lbs. Proceed to Step 3.1.

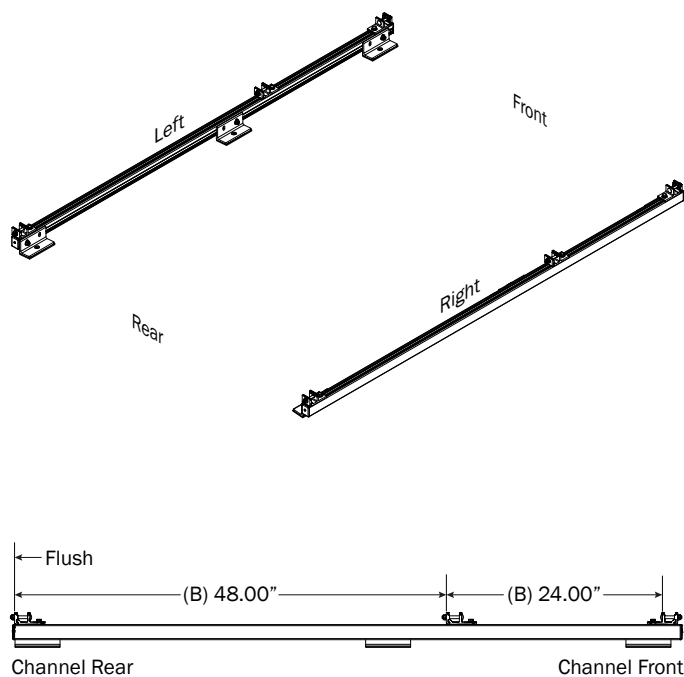

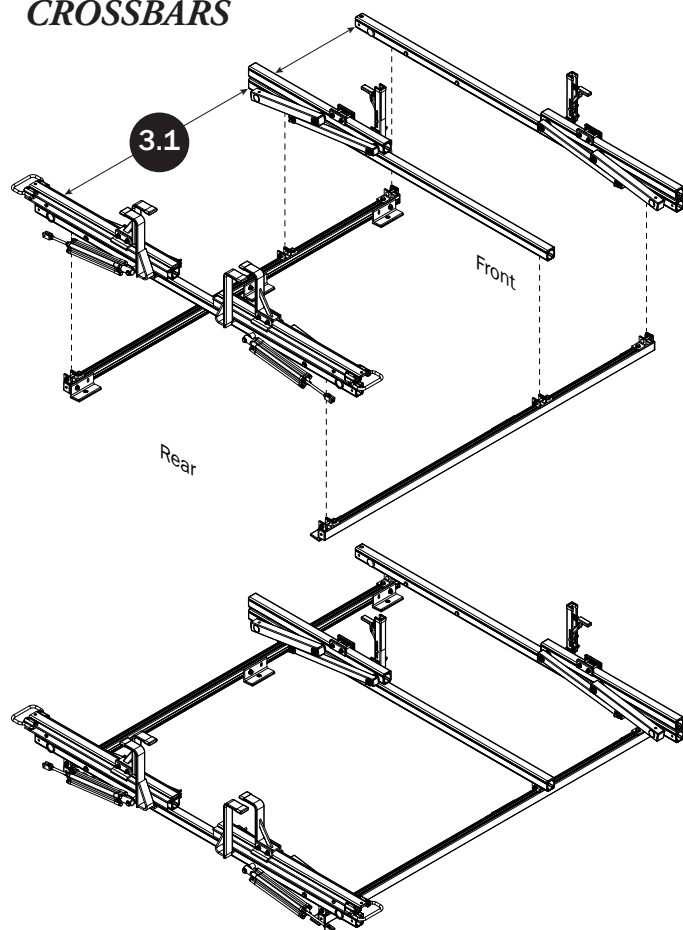
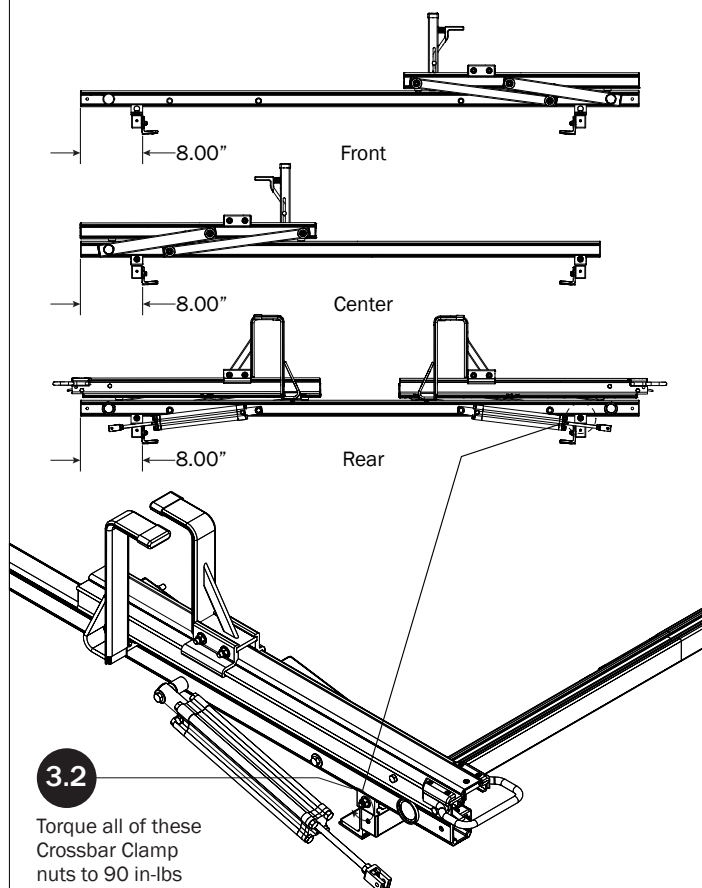
**CROSSBARS****CROSSBAR ADJUSTMENT****REAR DRIVE SHAFT**

NOTE: For instructional clarity, the FBM Mounting System will not be shown for the remainder of this Assembly Manual.

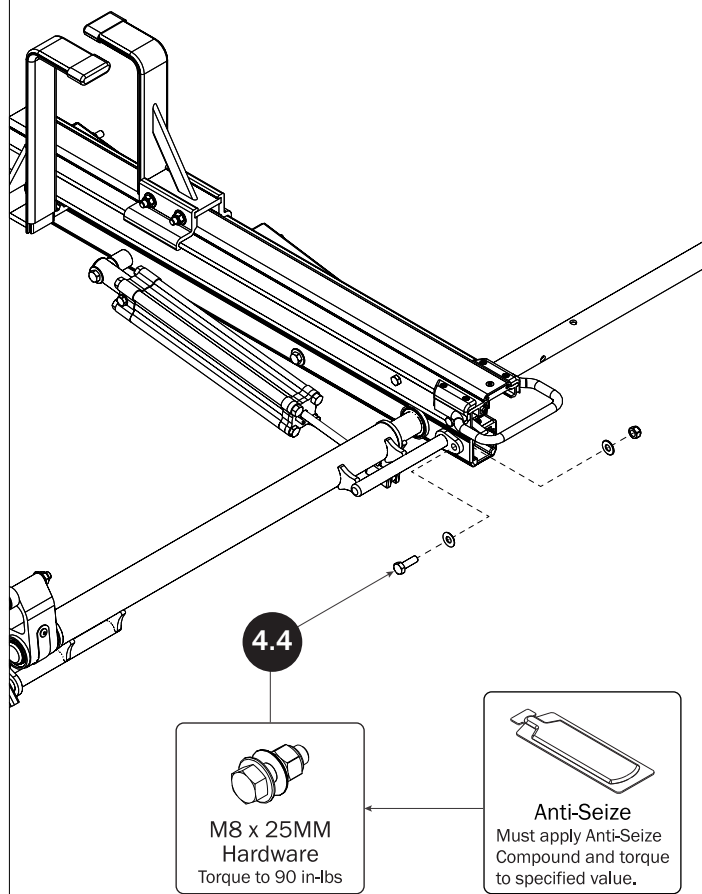
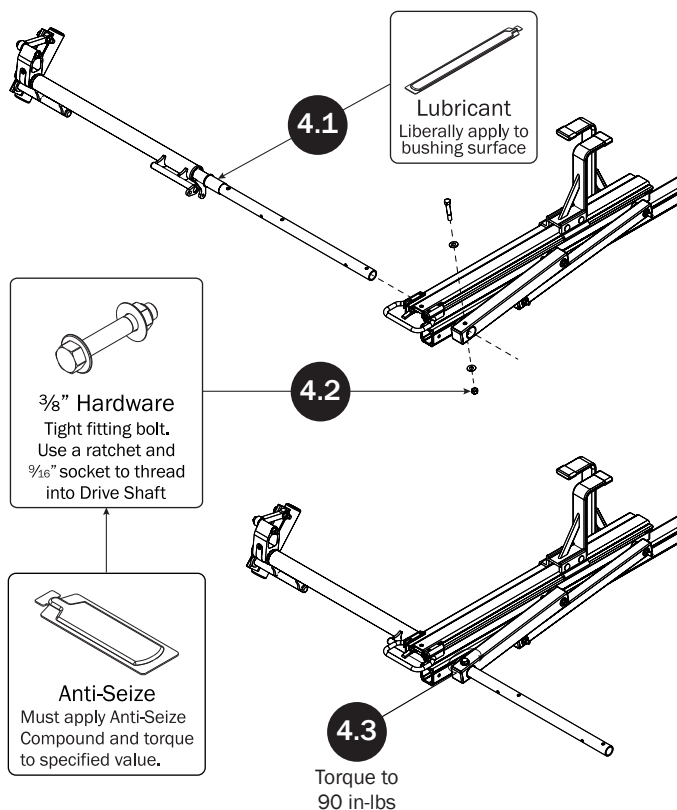



## CYLINDER HARDWARE

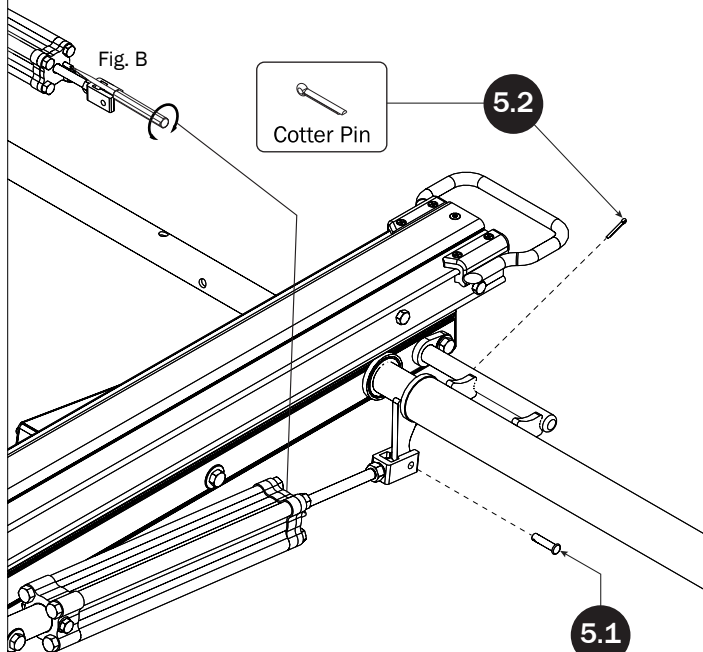

NOTE: Loosen the Cylinder Flow Control Screw (Fig. B) as needed to allow movement for this step sequence.

When finished with Cylinder Hardware, tighten the Flow Control Screw all the way closed then turn back open 1½ turn.

## CONNECTING BAR

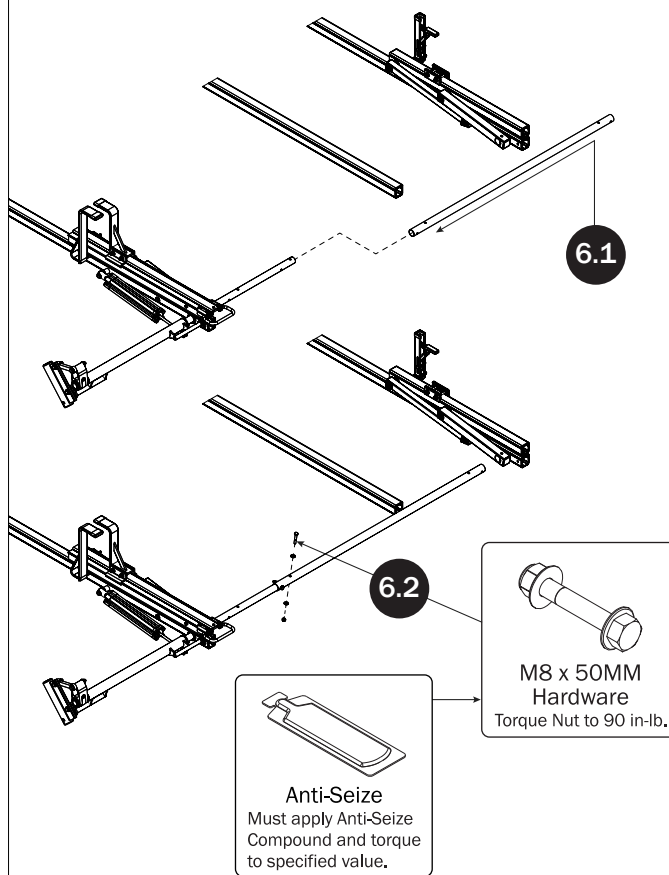

## FRONT DRIVE SHAFT

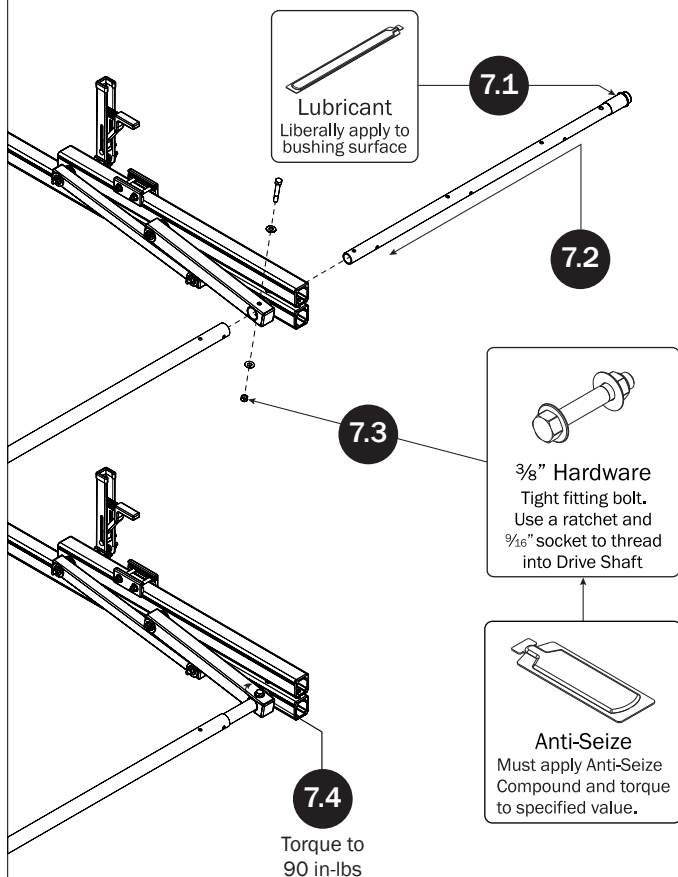

## CONNECTING BAR FASTENERS

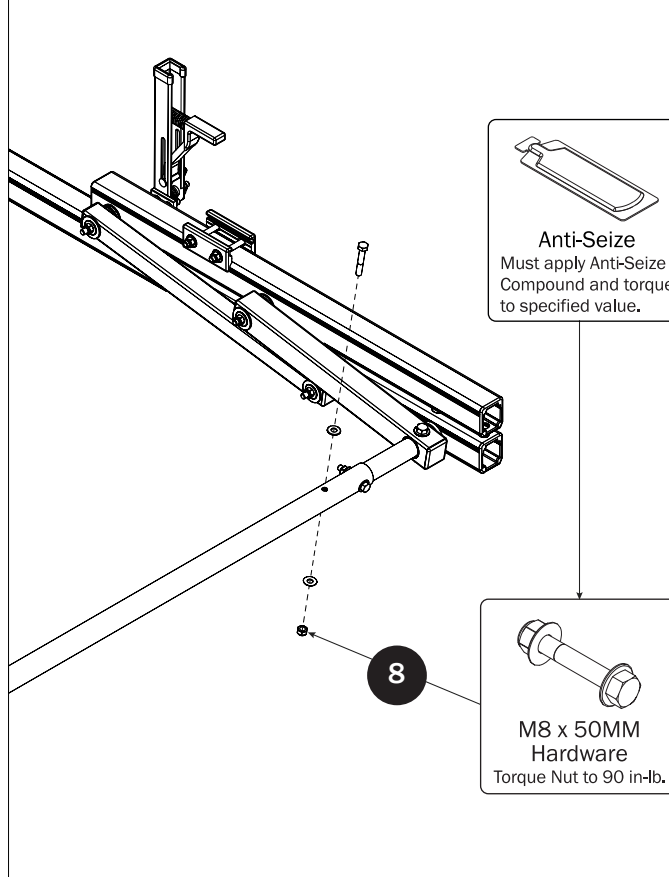

**L POSTS****SEE QUICK START GUIDE FOR ADJUSTMENTS**

**NOTE:** The front Auto Clamp come preset from the factory for packaging purposes only. To assemble the L Post to the Crossbar, the Auto Clamps must be repositioned.

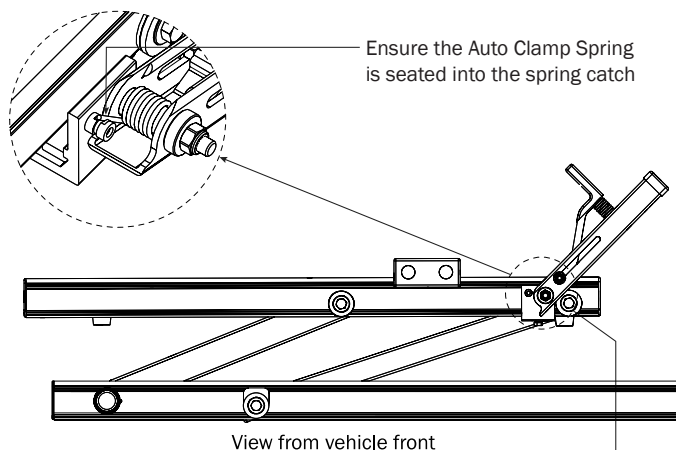

Beginning with the Front Crossbar, loosen the bolt at the bottom of the Auto Clamp, then slide the Auto Clamp toward the inside end of the Rotation Upper. Reposition the Auto Clamp leaving a minimum of 1/4" distance from the rubber bumper to the edge of the Auto Clamp Bracket as shown, then finger-tighten if adjusting later, or torque to 80 in-lbs.

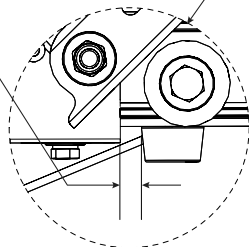
**9.1****9.2**

Place an L Post into the bottom groove of the Front Crossbar

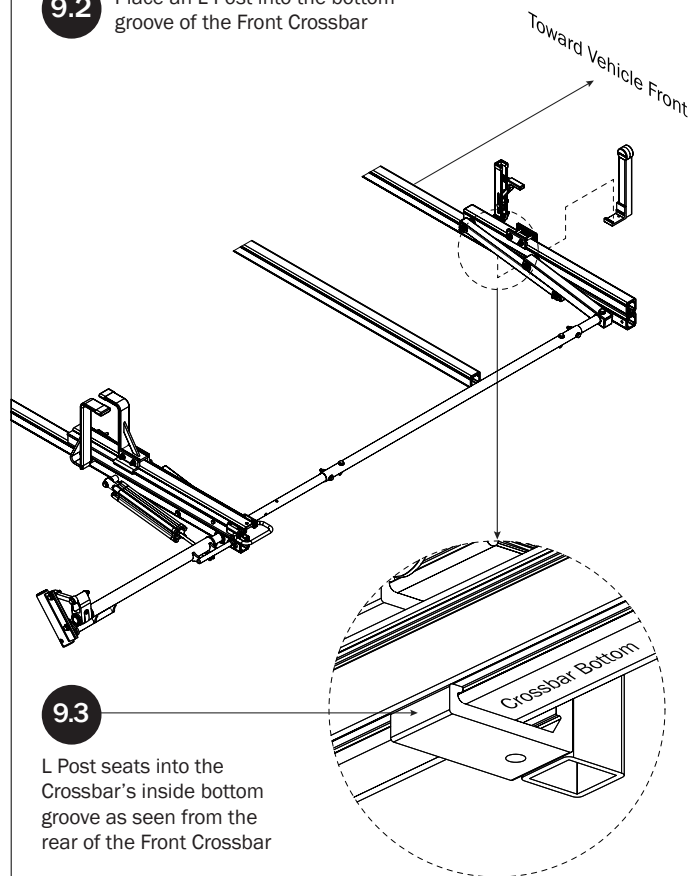
**9.3**

L Post seats into the Crossbar's inside bottom groove as seen from the rear of the Front Crossbar

**9.4**

Slide L Post Bracket Clamp into bottom groove, then slide into L Post Connector as shown

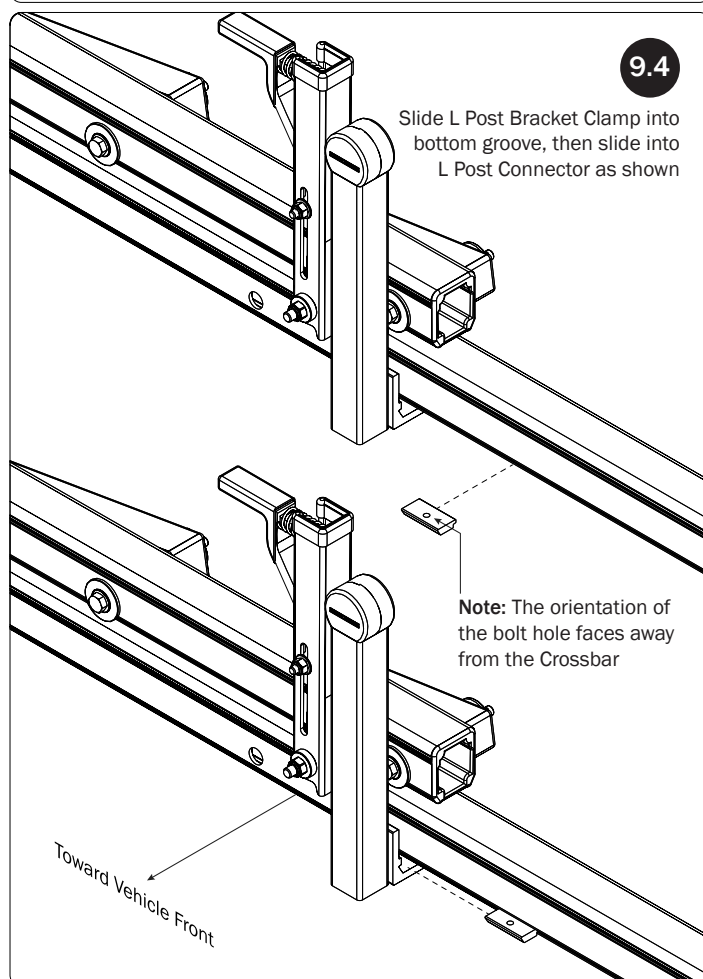
**9.5**

Bracket Clamp sits in L Post Connector Clamp as shown

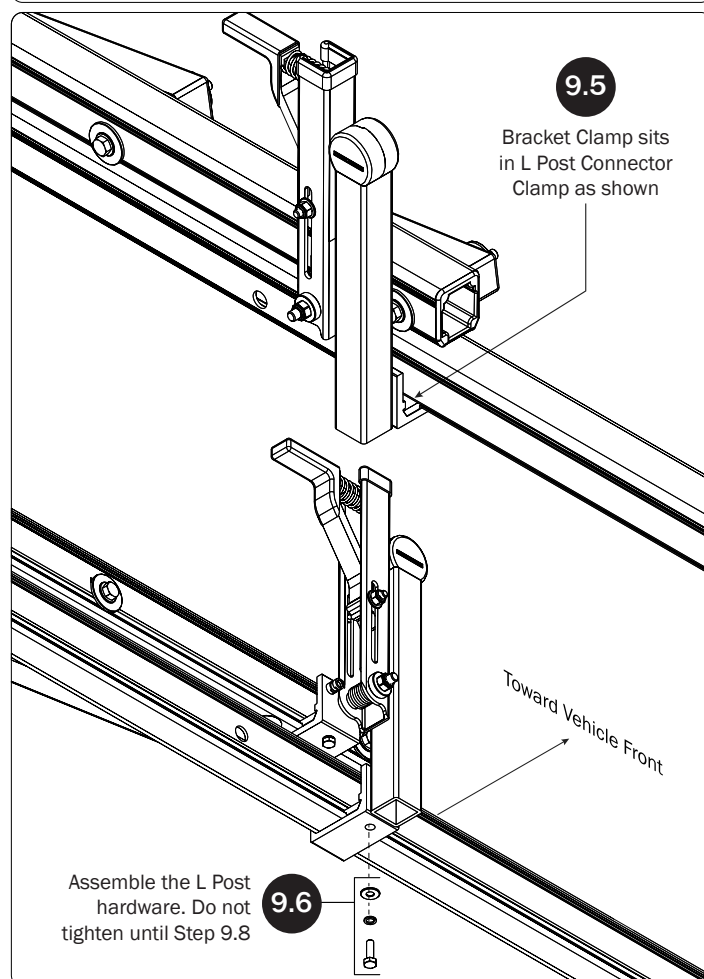

Assemble the L Post hardware. Do not tighten until Step 9.8

**9.6**



9.7

Slide the L Post until parallel to the Auto Clamp and the gap between the two is even from top to bottom

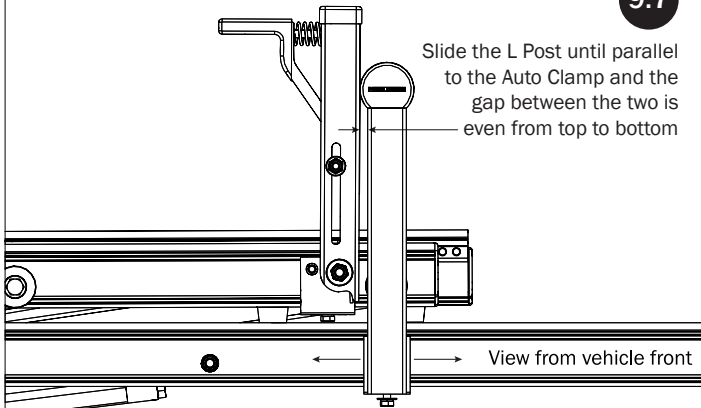

Torque to 80 in-lbs

9.8

Toward Vehicle Front

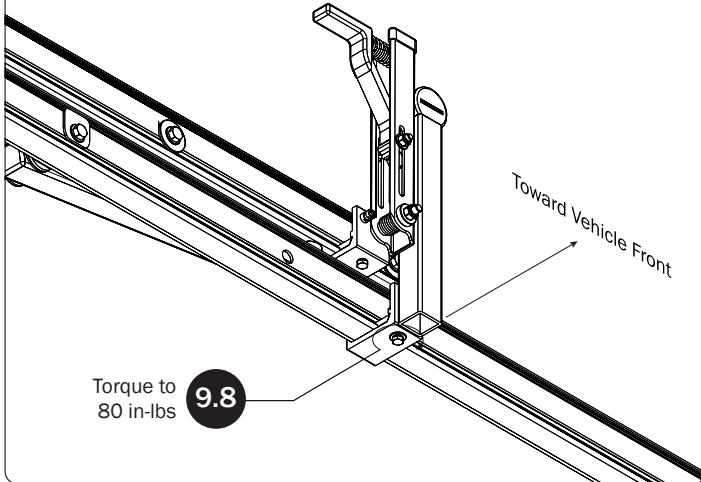
**Z POSTS**

SEE QUICK START GUIDE FOR ADJUSTMENTS

10.1

Assemble the Z Post Mounting Clamp Assembly onto the Rotation Upper. Do not tighten until Step 10.4

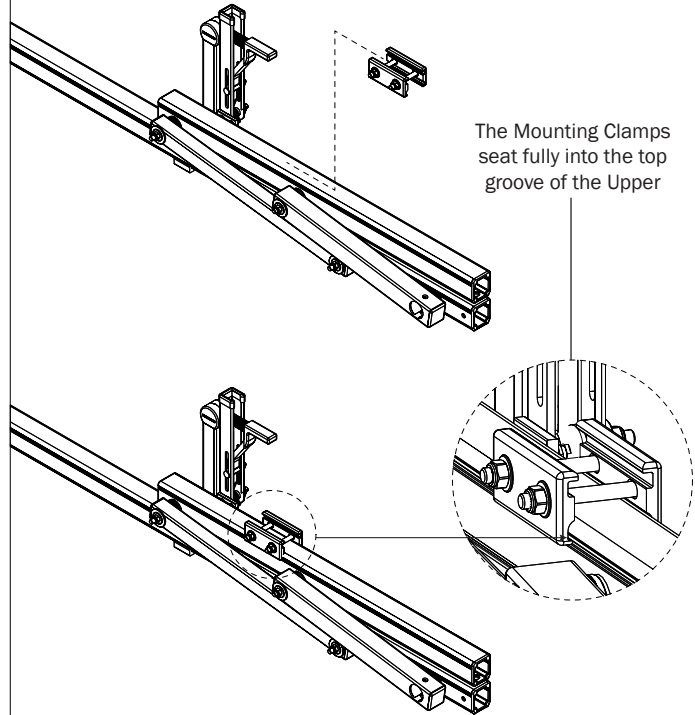

10.2

Slide the Z Post into the Mounting Clamp Assembly

The Z Post fully seats into the top slot of the Mounting Clamps

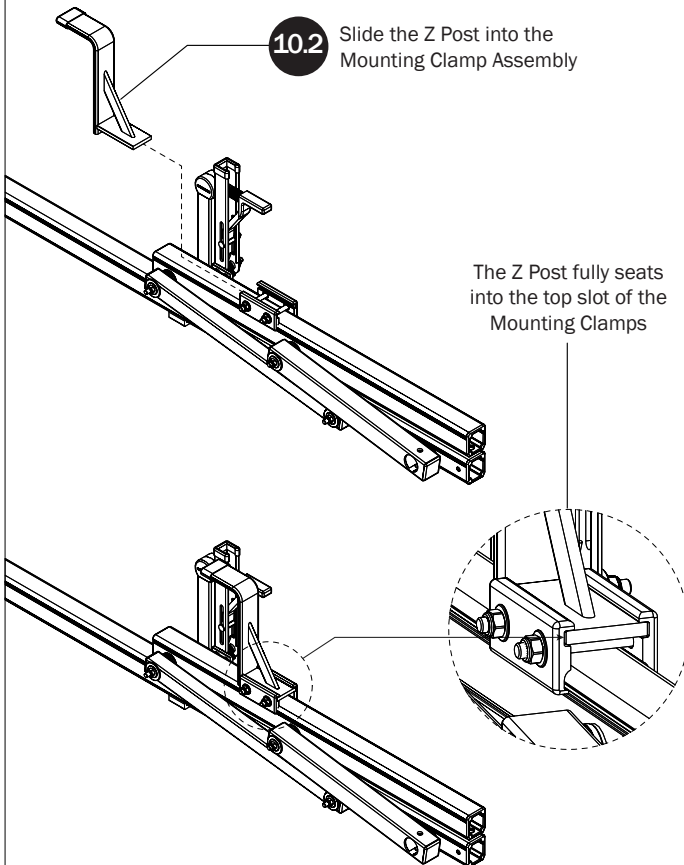

10.3

Refer to the Quick Start Guide for Z Post positioning.

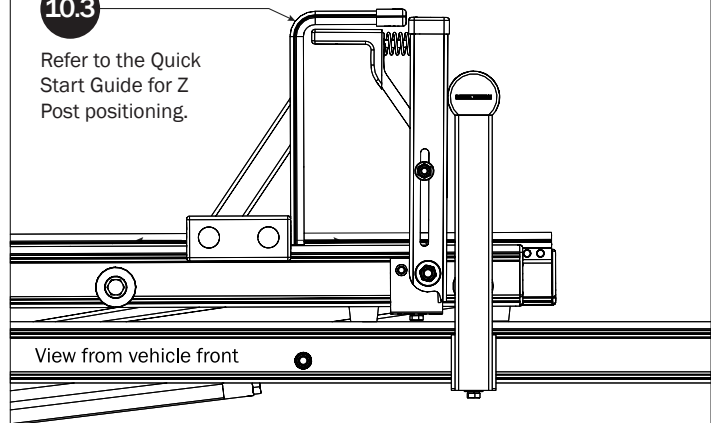

10.4

Torque to 90 in-lbs

Toward Vehicle Front

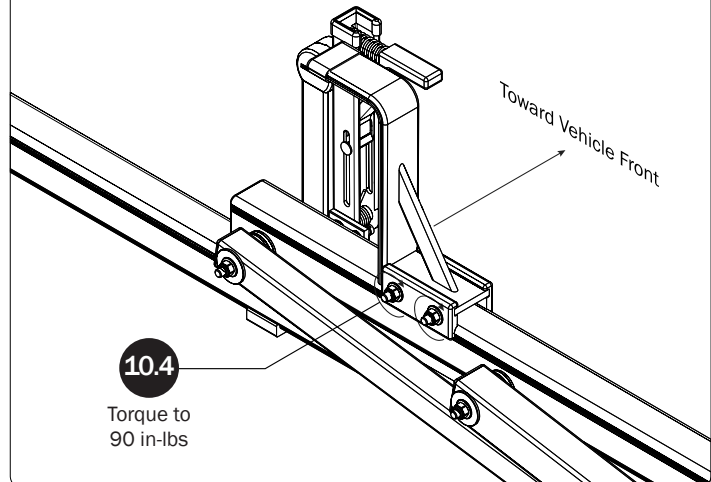

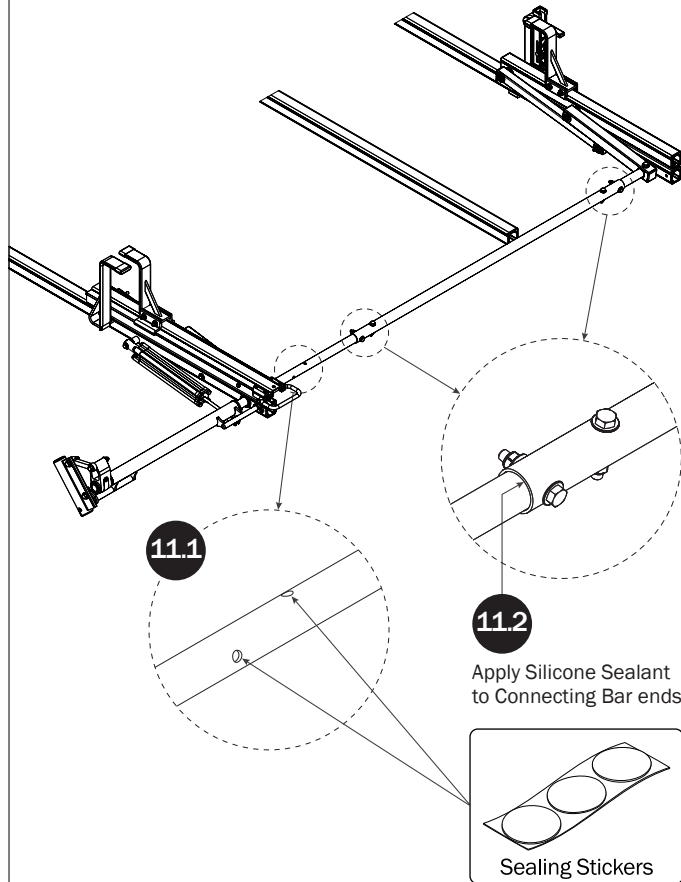
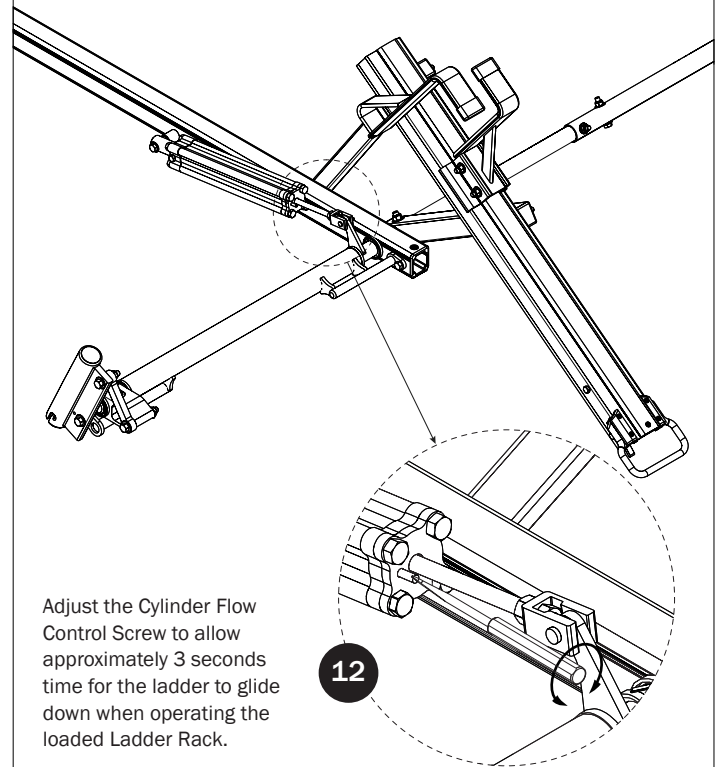
**DRIVE SHAFT SEALING****CYLINDER ADJUSTMENT**

## LEFT SIDE ASSEMBLY SEQUENCE

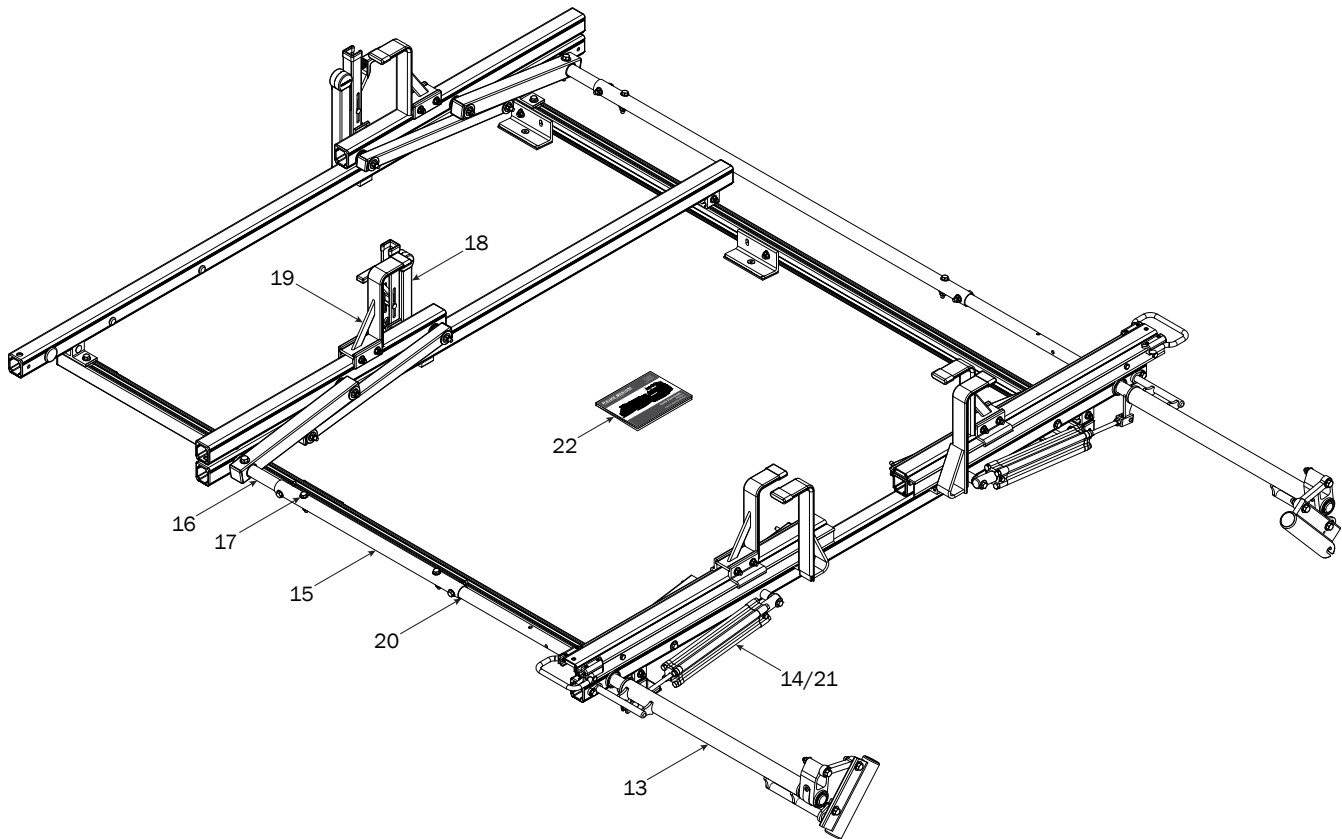

## REAR DRIVE SHAFT

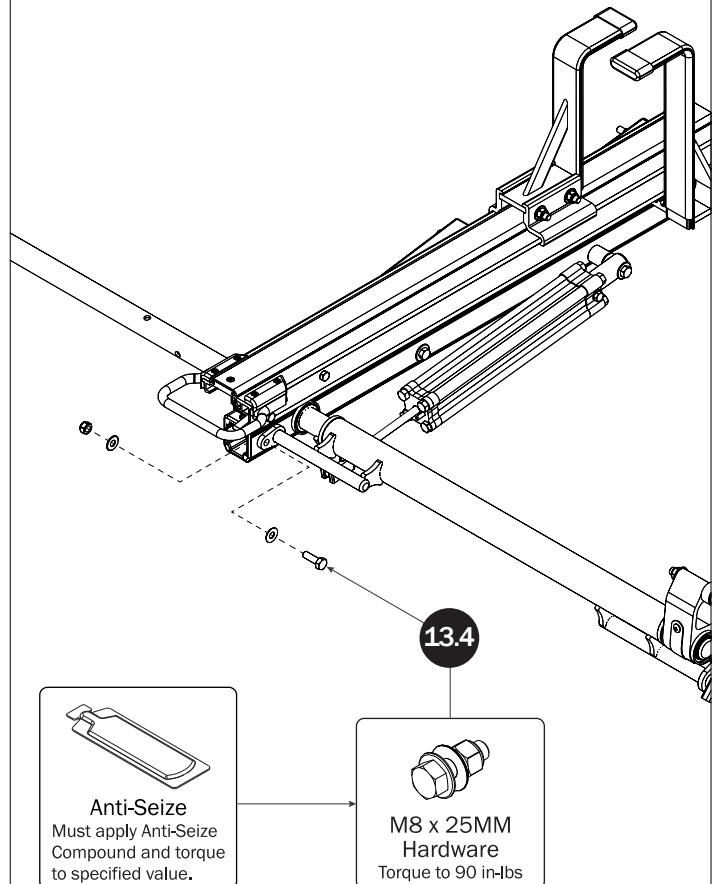
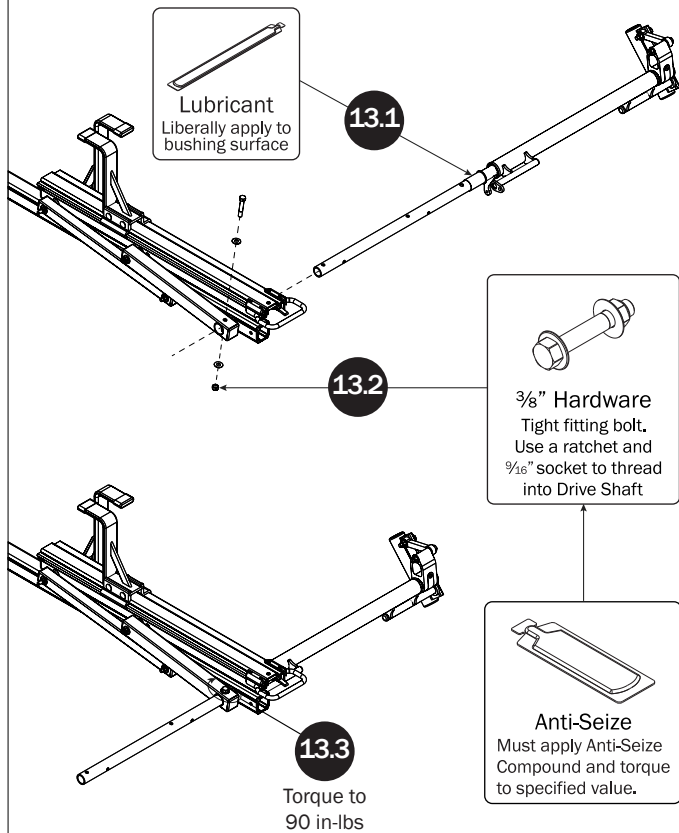

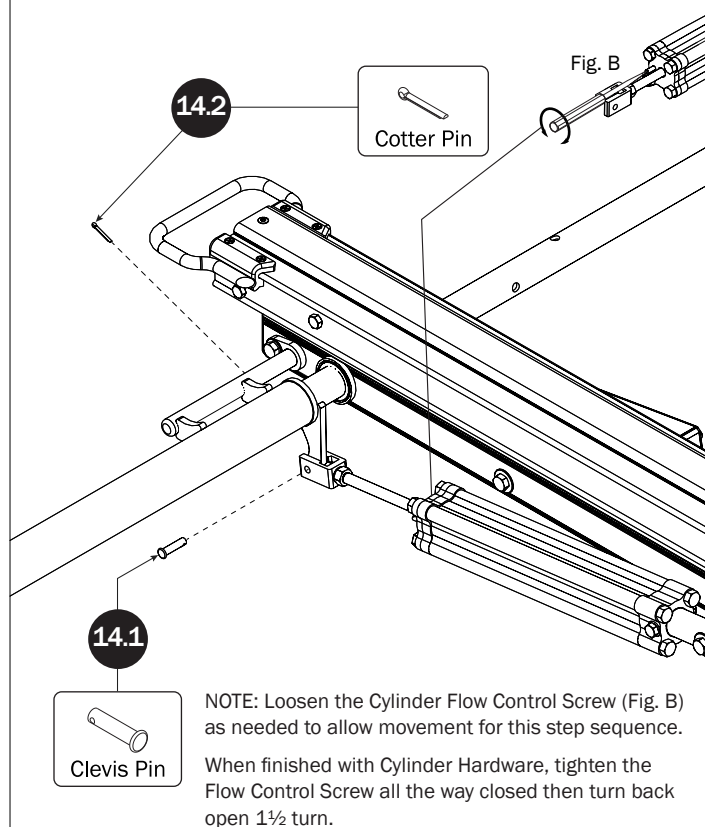
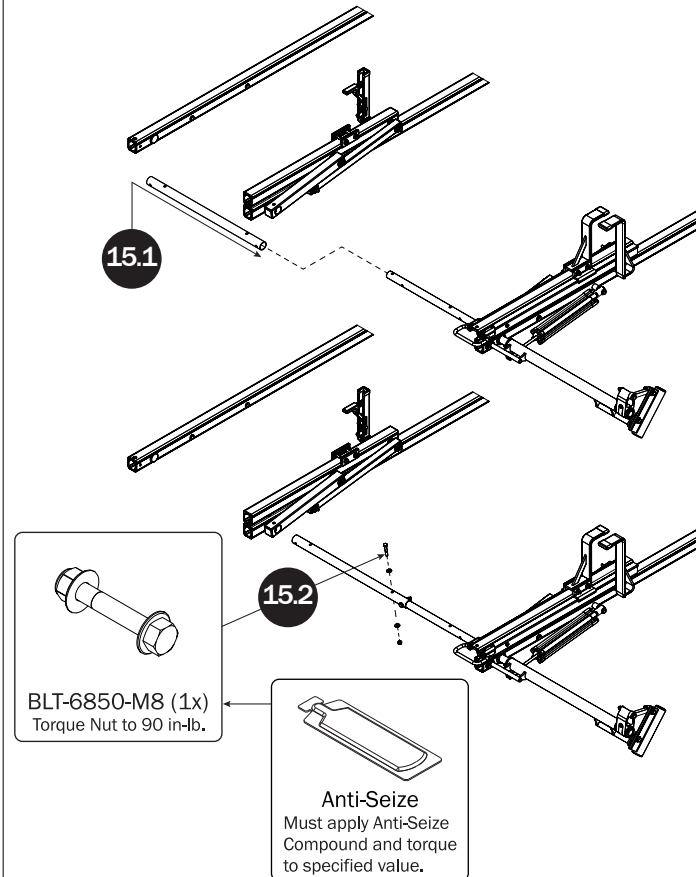
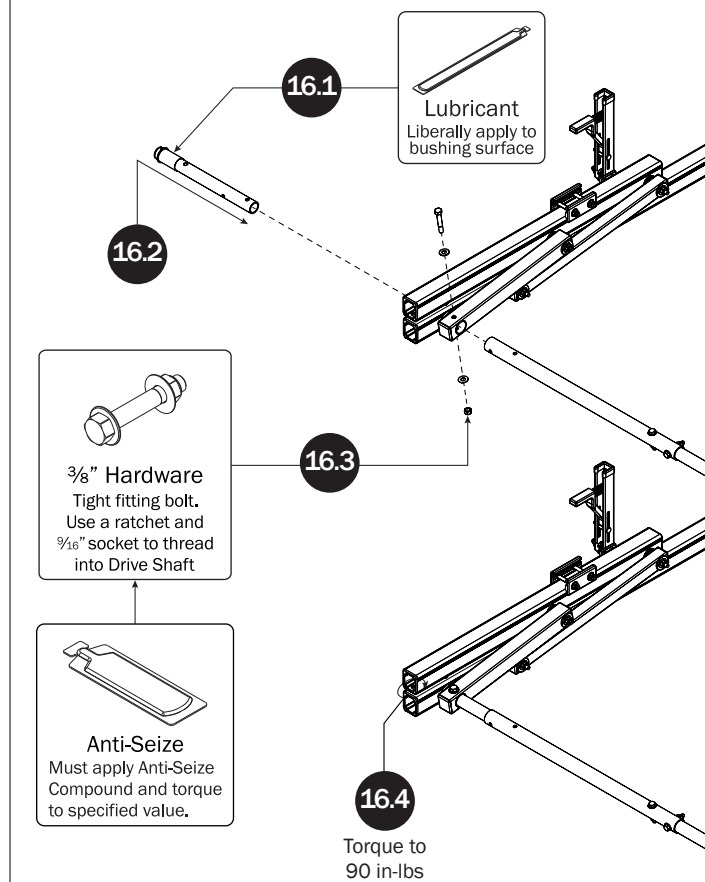
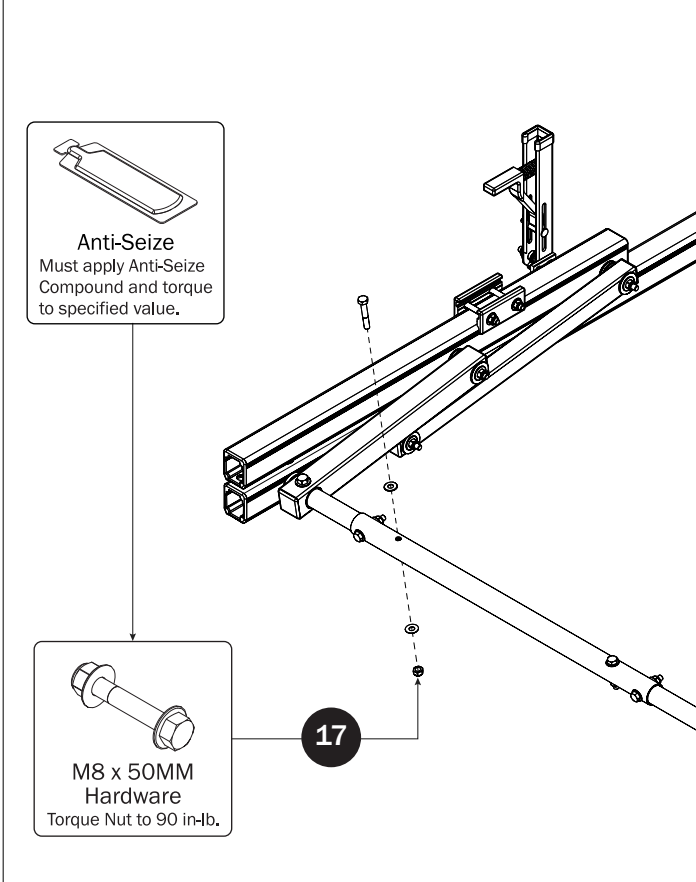
**CYLINDER HARDWARE****CONNECTING BAR****FRONT DRIVE SHAFT****CONNECTING BAR FASTENERS**

## L POSTS

### SEE QUICK START GUIDE FOR ADJUSTMENTS

**NOTE:** The front Auto Clamp come preset from the factory for packaging purposes only. To assemble the L Post to the Crossbar, the Auto Clamps must be repositioned.

Ensure the Auto Clamp Spring is seated into the spring catch

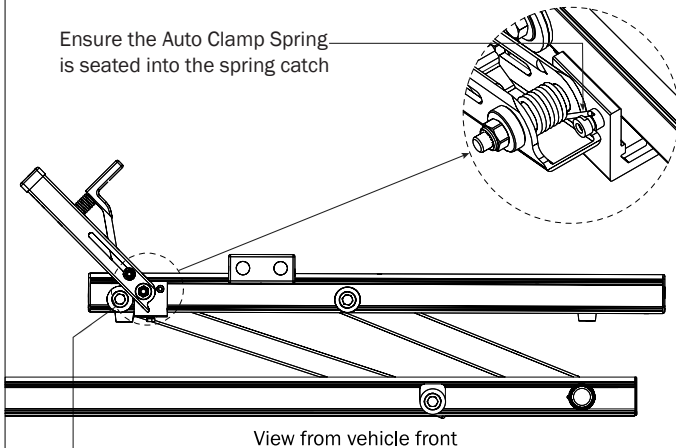

View from vehicle front

**18.1** Beginning with the Front Crossbar, loosen the bolt at the bottom of the Auto Clamp, then slide the Auto Clamp toward the inside end of the Rotation Upper. Reposition the Auto Clamp leaving a minimum of 1/4" distance from the rubber bumper to the edge of the Auto Clamp Bracket as shown, then finger-tighten if adjusting later, or torque to 80 in-lbs.

**18.2** Place an L Post into the bottom groove of the Front Crossbar

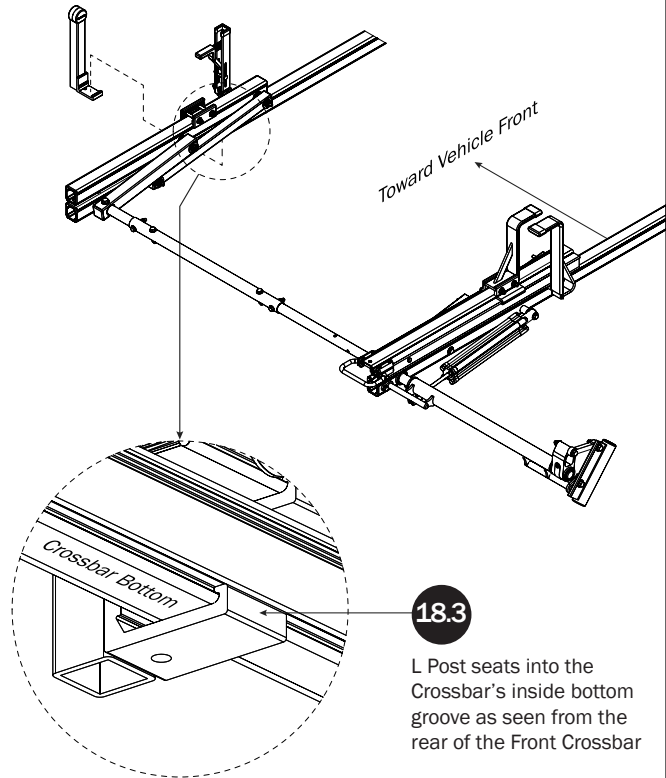

**18.3** L Post seats into the Crossbar's inside bottom groove as seen from the rear of the Front Crossbar

**18.4**

Slide L Post Bracket Clamp into bottom groove, then slide into L Post Connector as shown

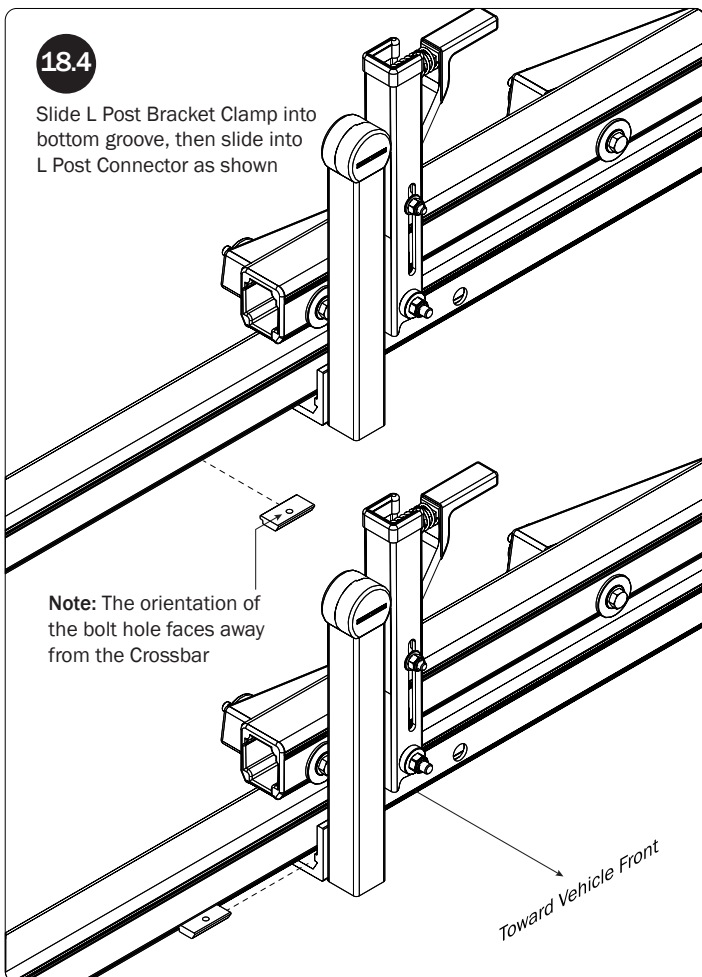

**Note:** The orientation of the bolt hole faces away from the Crossbar

**18.5**

Bracket Clamp sits in L Post Connector as shown

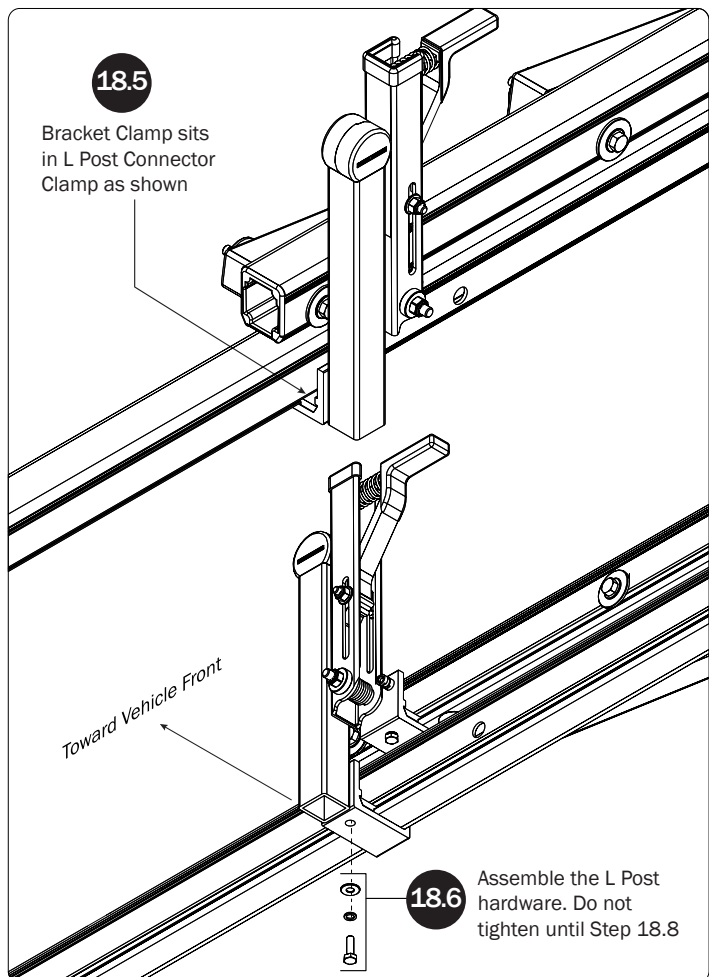

**18.6** Assemble the L Post hardware. Do not tighten until Step 18.8



18.7

Slide the L Post until parallel to the Auto Clamp and the gap between the two is even from top to bottom

View from vehicle front

Toward Vehicle Front

18.8

Torque to 80 in-lbs

**Z POSTS**

SEE QUICK START GUIDE FOR ADJUSTMENTS

19.1

Assemble the Z Post Mounting Clamp Assembly onto the Rotation Upper. Do not tighten until Step 19.4.

The Mounting Clamps seat fully into the top groove of the Upper

19.3

Refer to the Quick Start Guide for Z Post positioning.

View from vehicle front

Toward Vehicle Front

19.4

Torque to 90 in-lbs

Slide the Z Post into the Mounting Clamp Assembly

19.2

The Z Post fully seats into the top slot of the Mounting Clamps



## DRIVE SHAFT SEALING

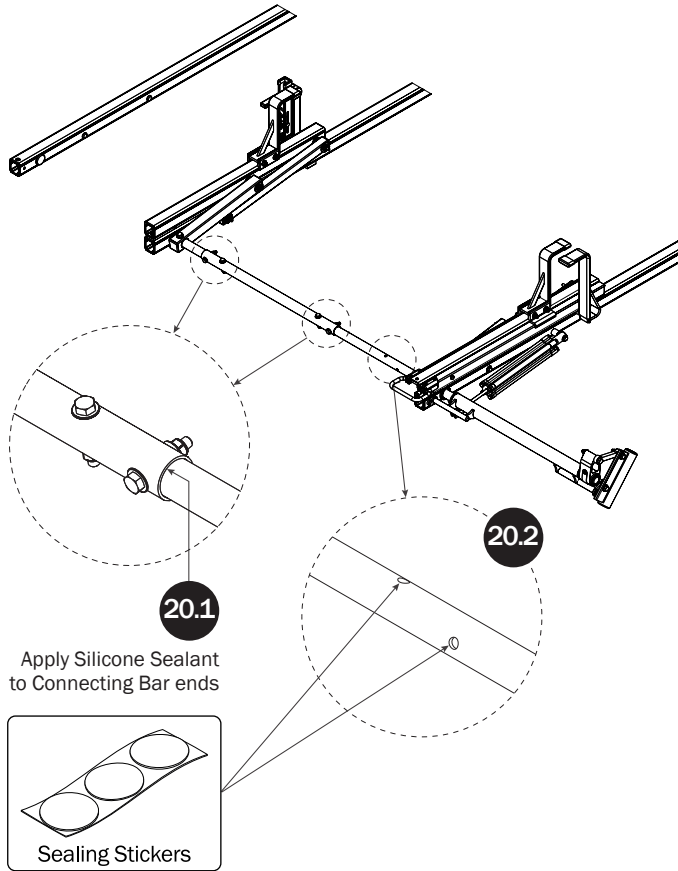

## CYLINDER ADJUSTMENT

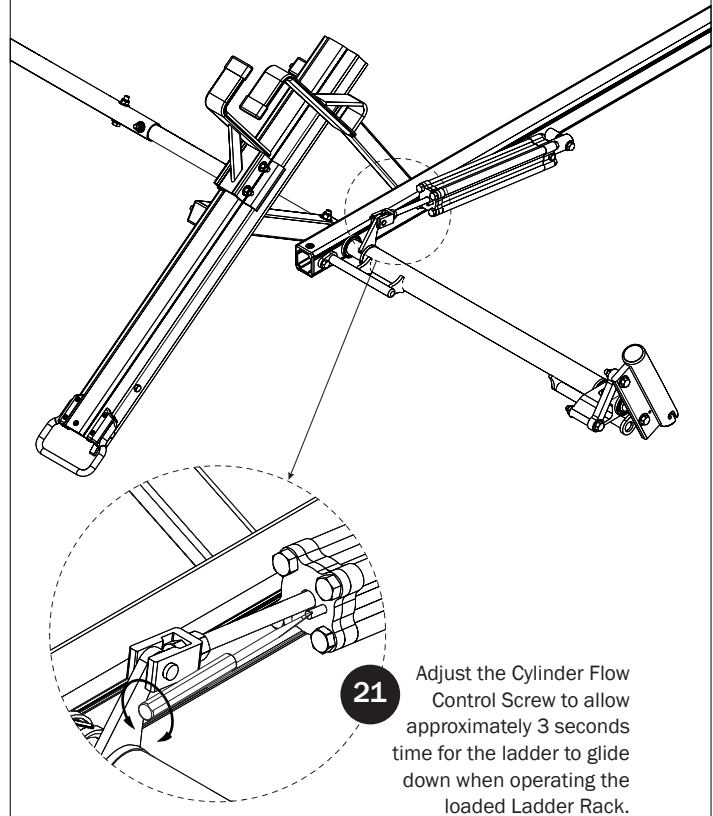

## QUICK START GUIDE

- 22 Place the Quick Start Guide into the vehicle's glove box for ladder setup and adjustment.

