

PRIME DESIGN™

A Safe Fleet Brand

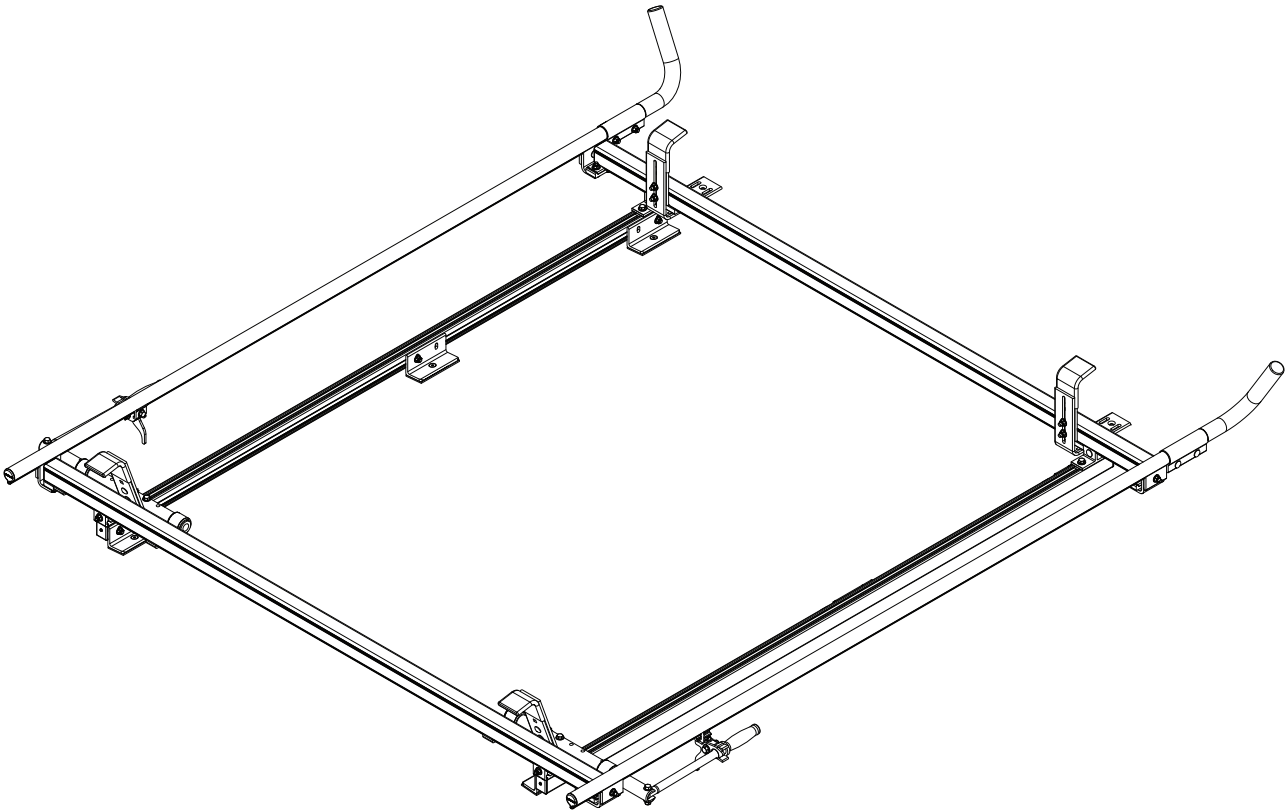

VCC
TRUCK

CONTENTS OVERVIEW

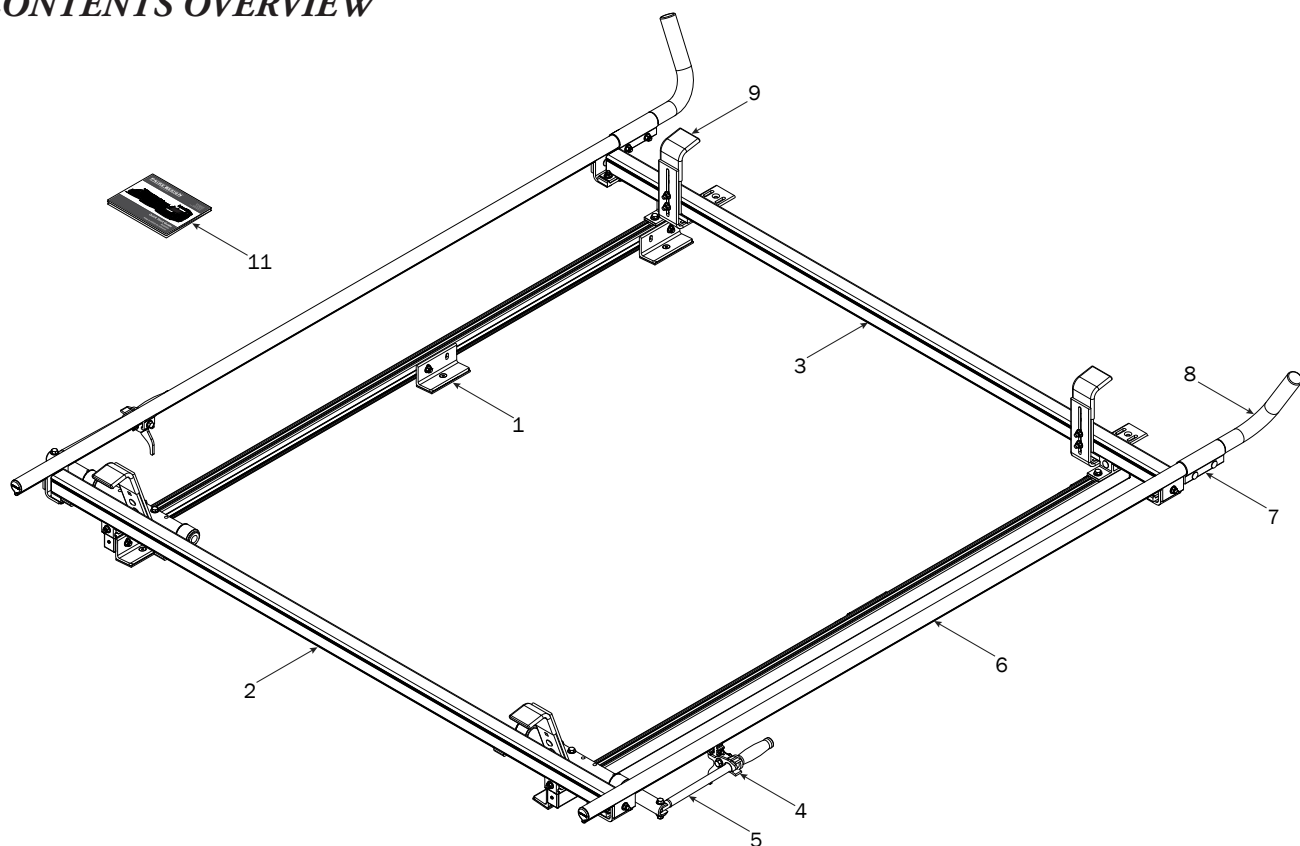

1—FBM-0096 (Qty 1)

Channels w/ Hardware

74" Channels, Pre-assembled (2X)



Mounting Bracket (6X)



Foam Pad (6X)



Channel Bracket (4X)

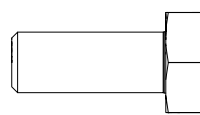

M8 x 20MM (4X)

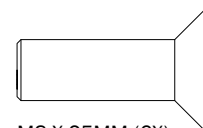

M8 X 25MM (6X)

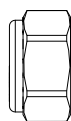

M8 Lock Nut (6X)

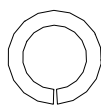
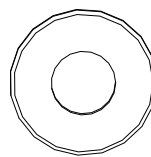
 $\frac{5}{16}$ " Lock Washer (4X) $\frac{5}{16}$ " Flat Washer (10X)

Anti-Seize (1X)

2—Rear Crossbar Assembly (Qty 1)

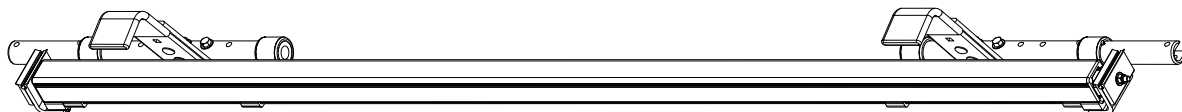

3—Front Crossbar Assembly (Qty 1)



4—Handle Latch Assembly (Qty 2)



5—Clamp Down Handle Assembly (Qty 1)

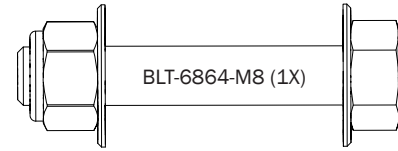
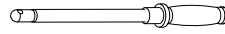

6—Clamp Down Tube (Qty 2)
80.00"

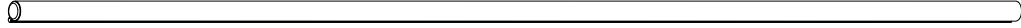

7—Quick Clamp Tube Splice Assembly (Qty 2)
5.00"



8—Removeable Horn with Cap (Qty 2)
15.00"

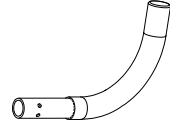

9—HD Front Hook Assembly (Qty 2)
(Requires partial disassembly for installation)

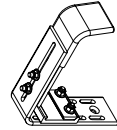

10—Anti-Seize (Qty 1)



11—USQSG-Ergorack (Qty 1)
Quick Start Guide, Clamp Down

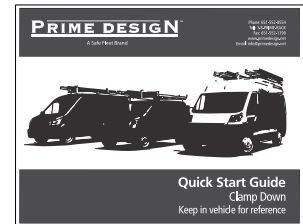

RIGHT SIDE ASSEMBLY SEQUENCE

Prior to assembling the Channels and hardware, the OEM roof holes must be chased using an M8 x 1.25 Chasing or Thread Cleaning tap and fluid. Doing so will ensure accurate torque is achieved.

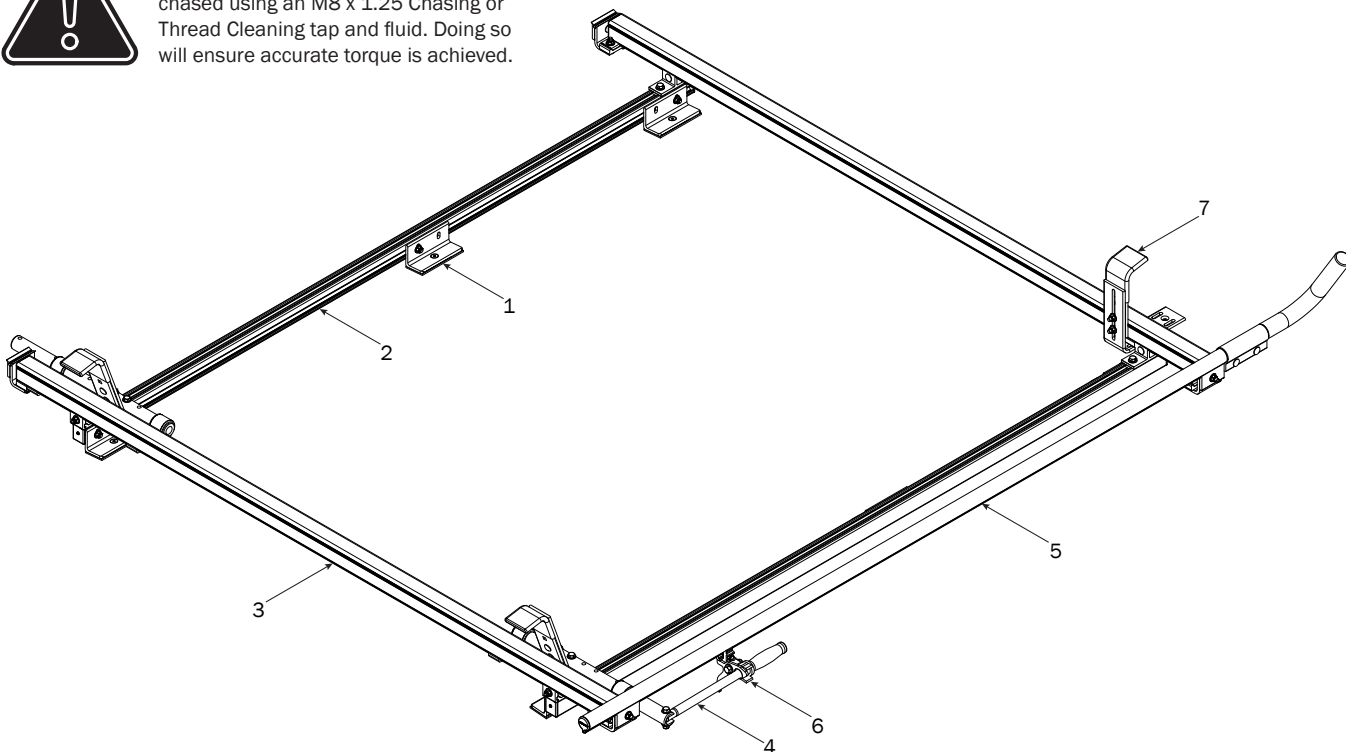
**MOUNTING BRACKETS****1**

Apply Anti-Seize to all M8 x 25MM Flat Head Screws and install the Channel Mounting Brackets with Foam Pads onto the vehicle's roof mounting holes. Do not tighten screws until Step 2.3

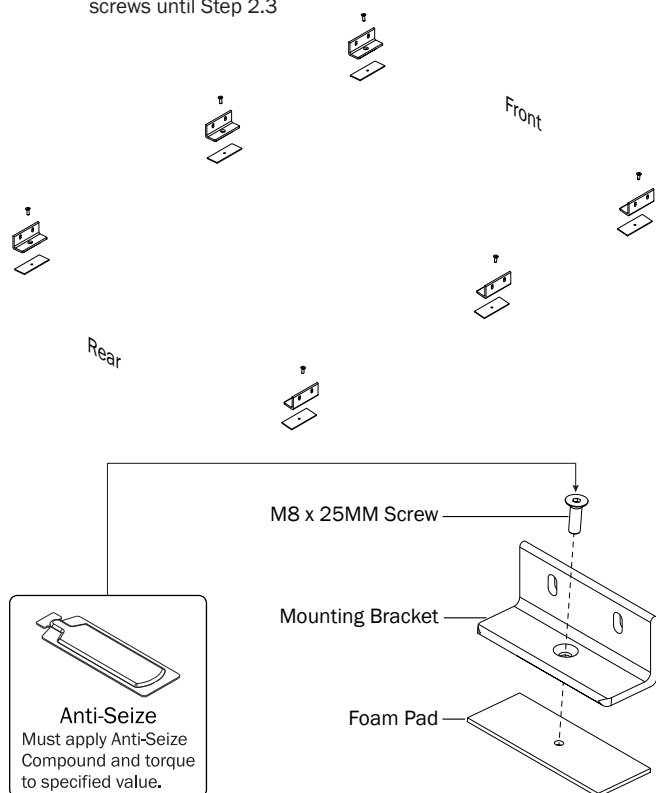
**CHANNELS****2.1**

Apply Anti-Seize to all M8 T Bolt studs, then attach the Channels to the Mounting Brackets using the indicated hardware. Do not tighten until Step 2.2

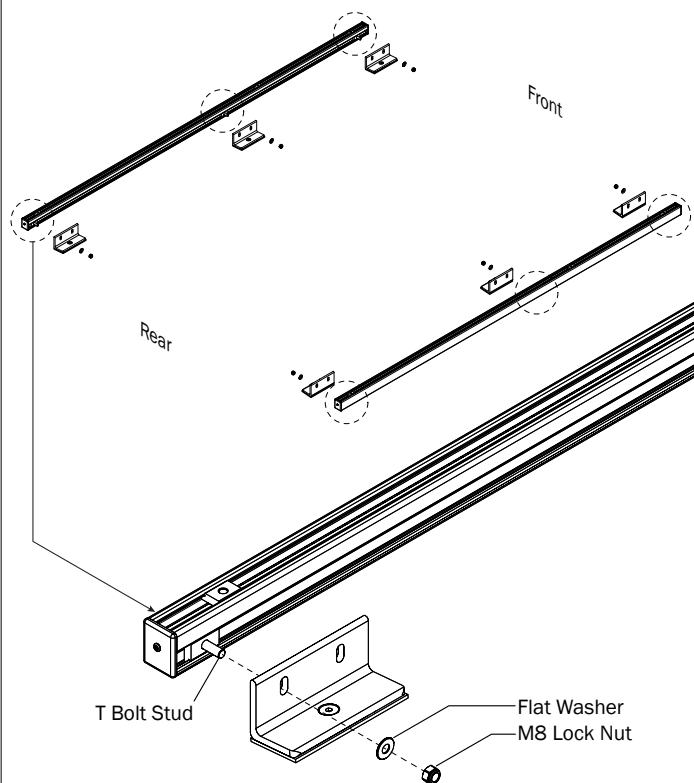

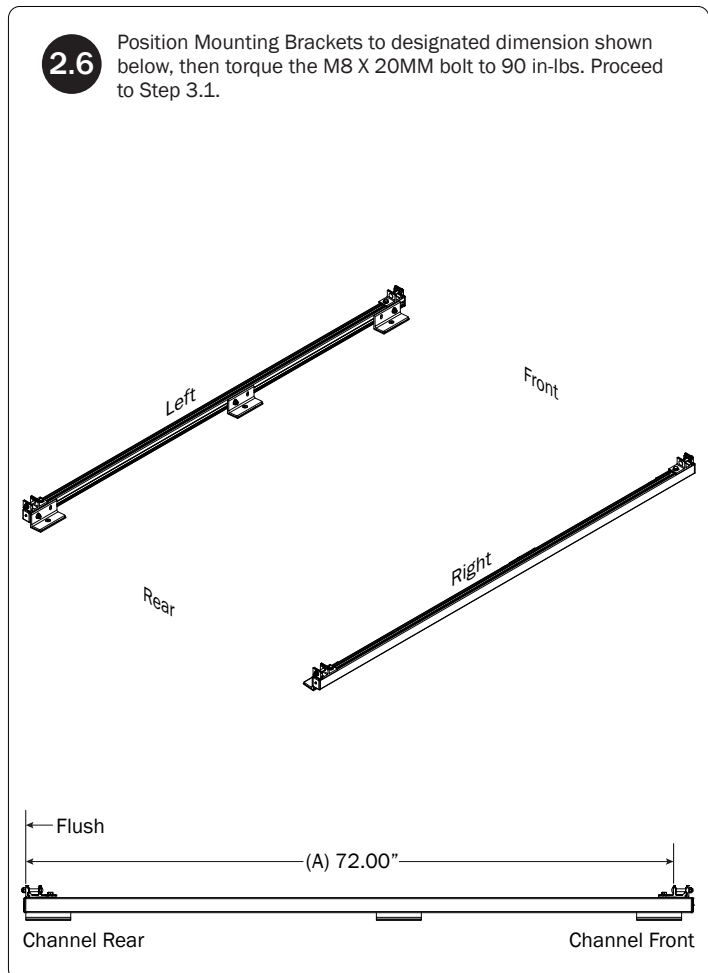
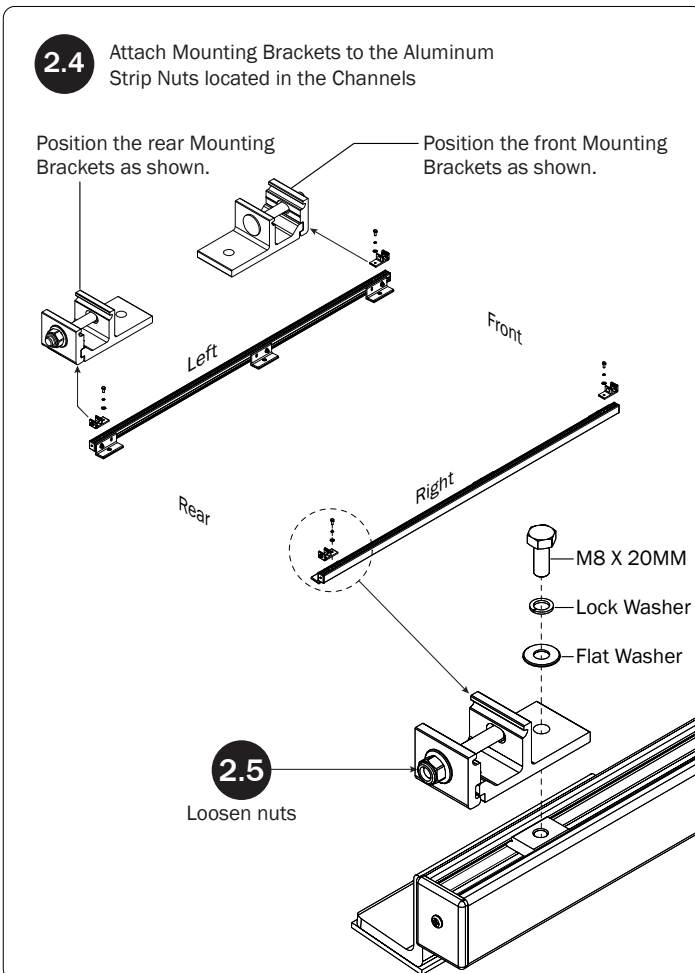
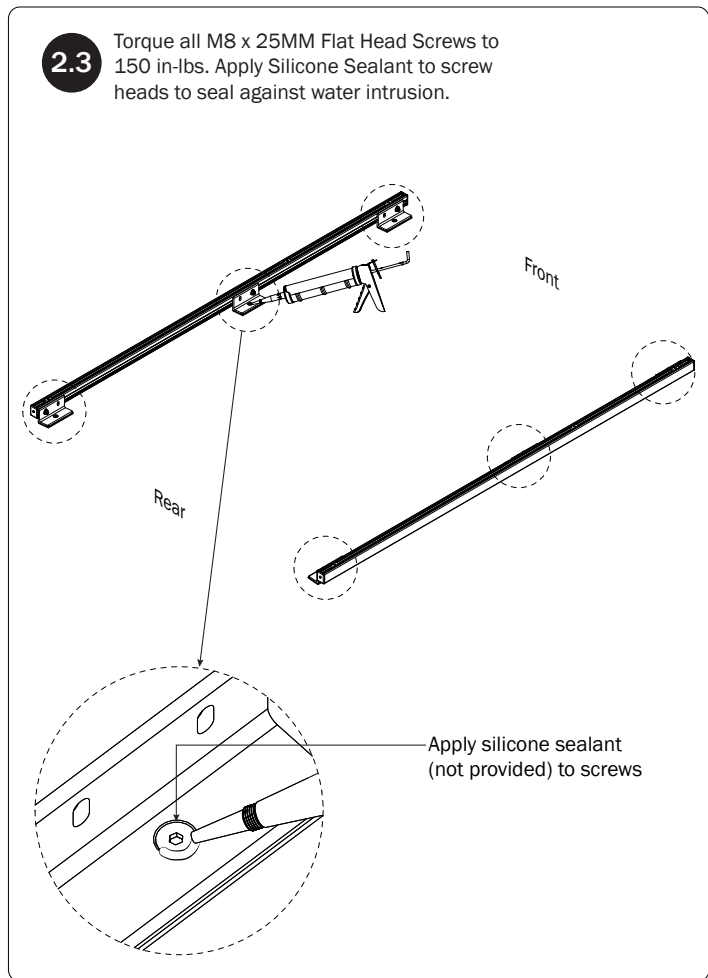
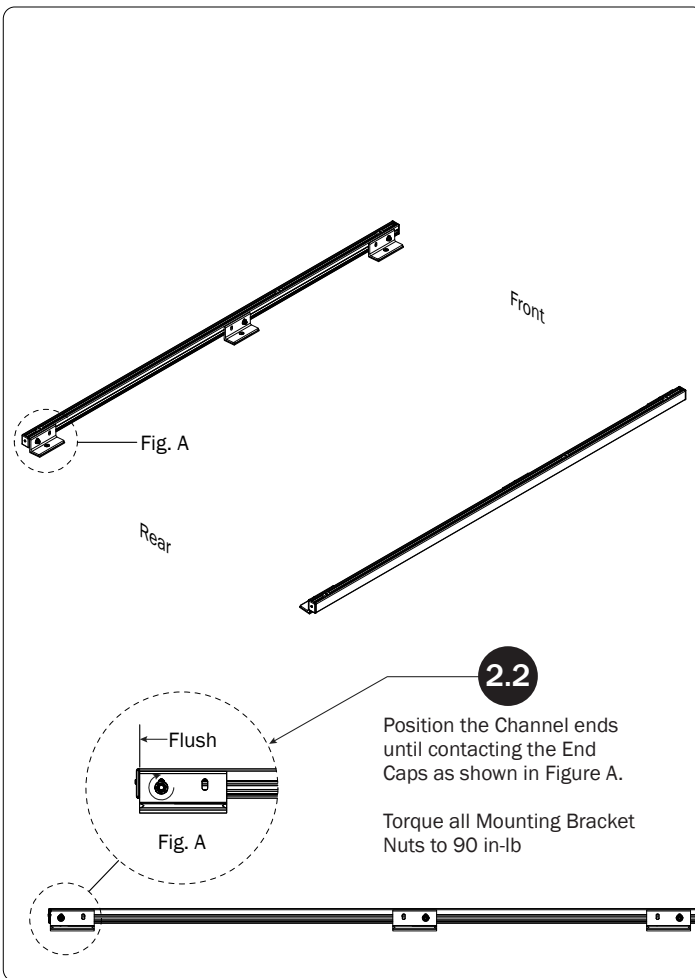

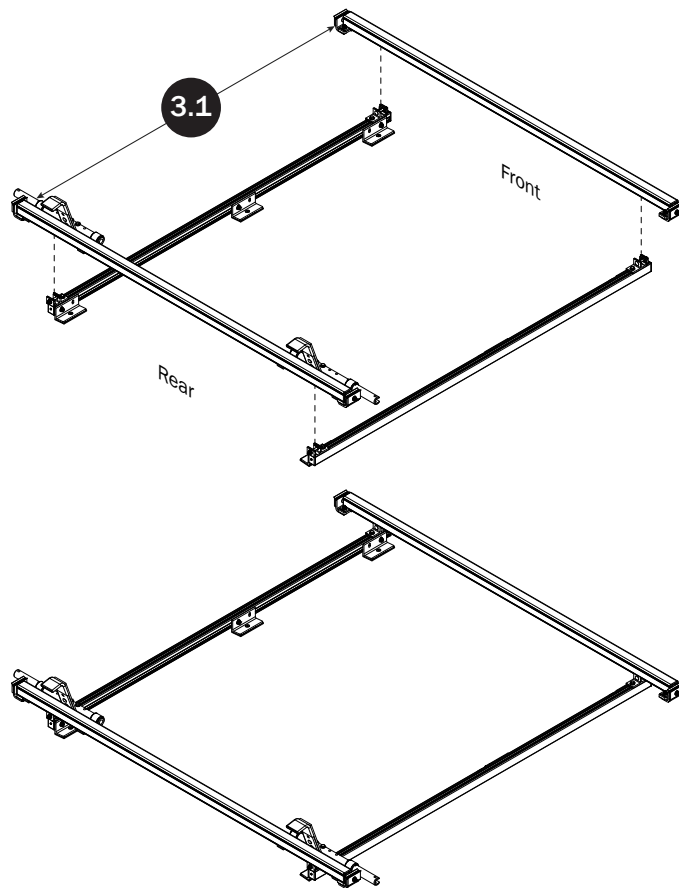
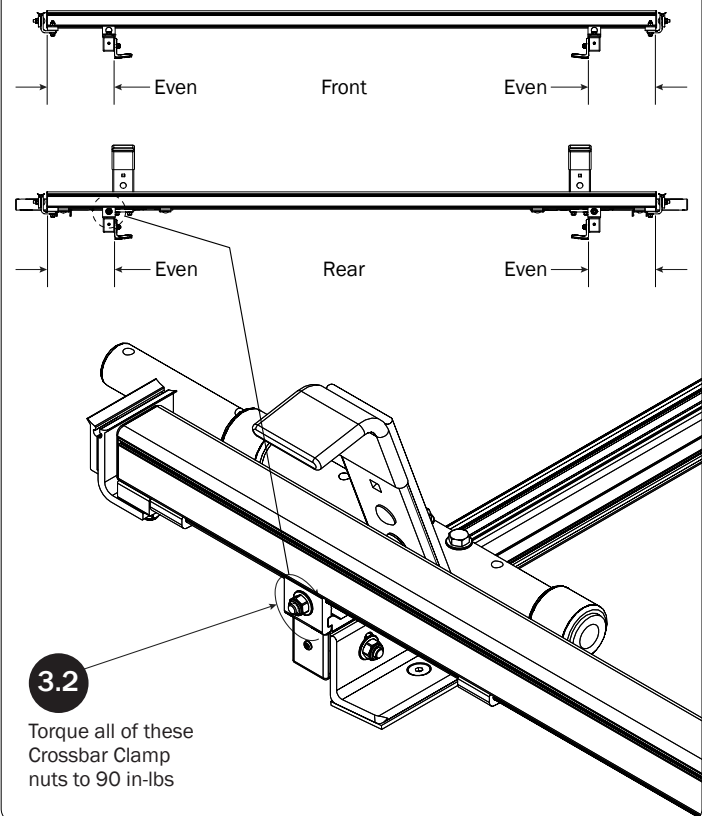
CROSSBARS**CROSSBAR ADJUSTMENT****CLAMP DOWN HANDLE**

NOTE: For instructional clarity, the FBM Mounting System will not be shown for the remainder of this Assembly Manual.

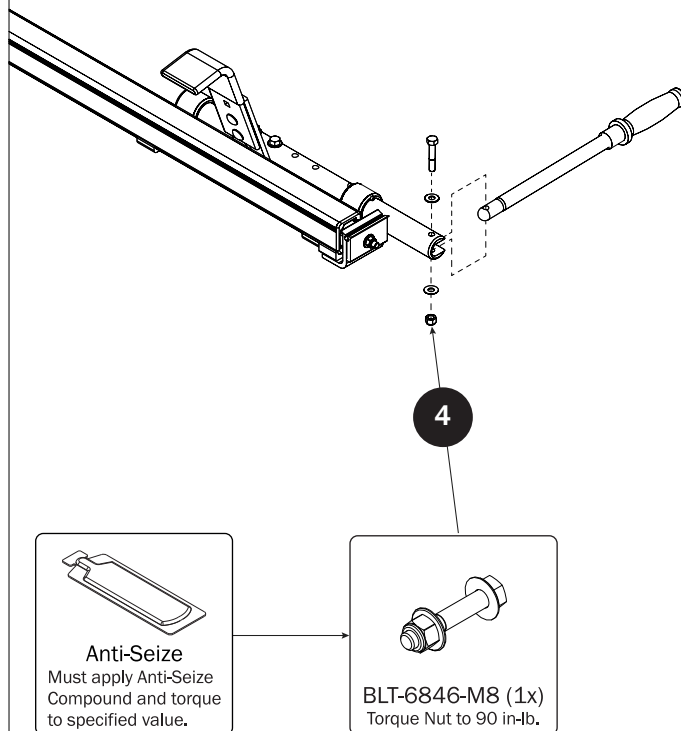
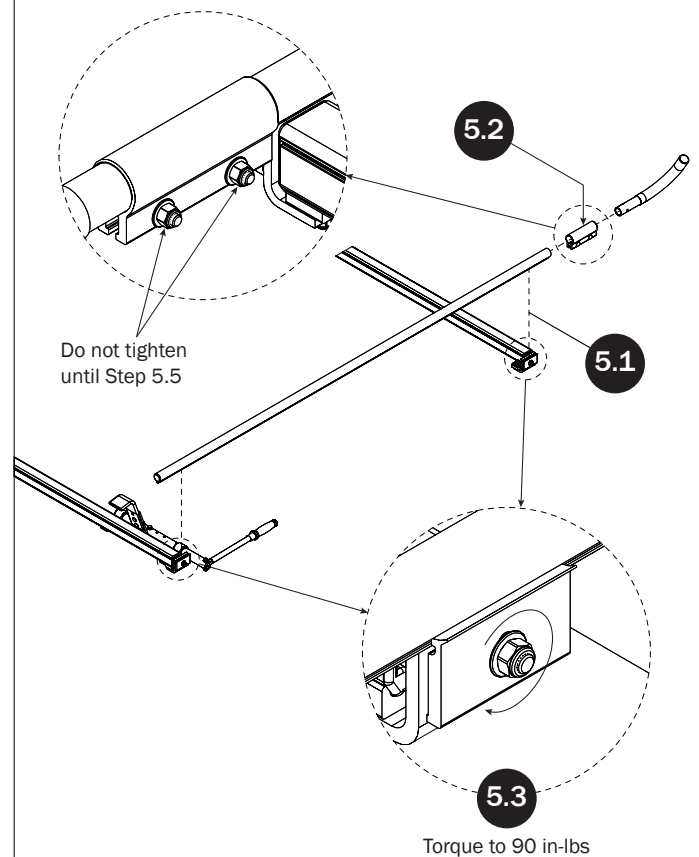
**CLAMP DOWN TUBE**

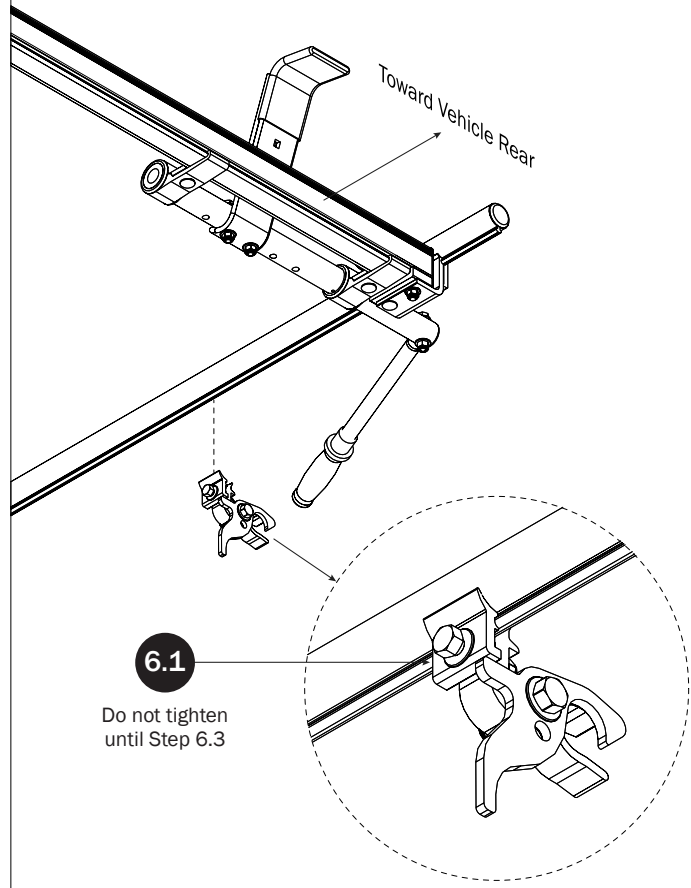
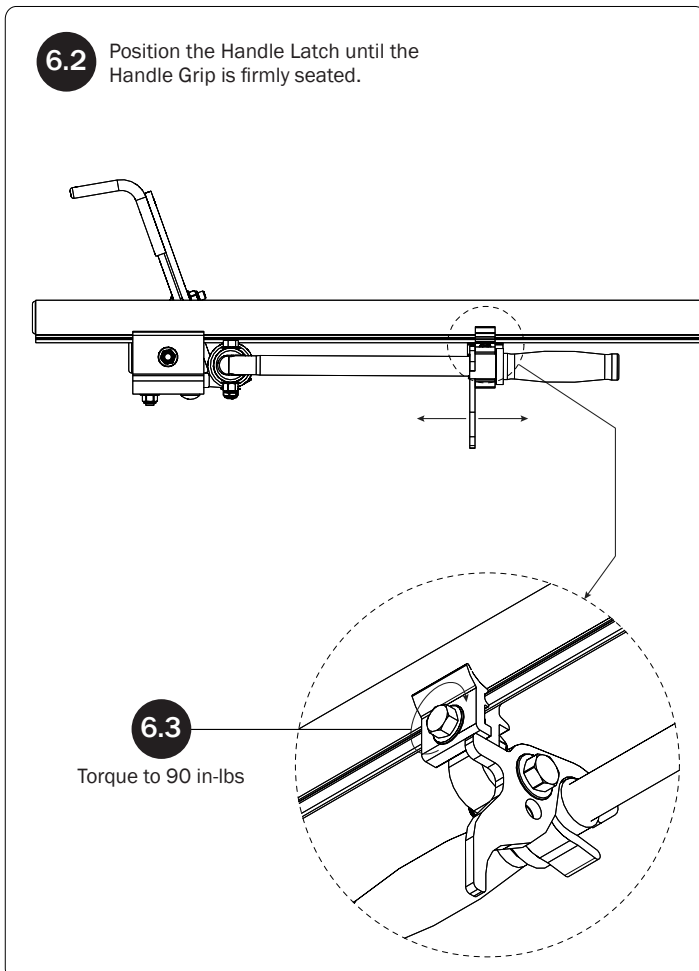
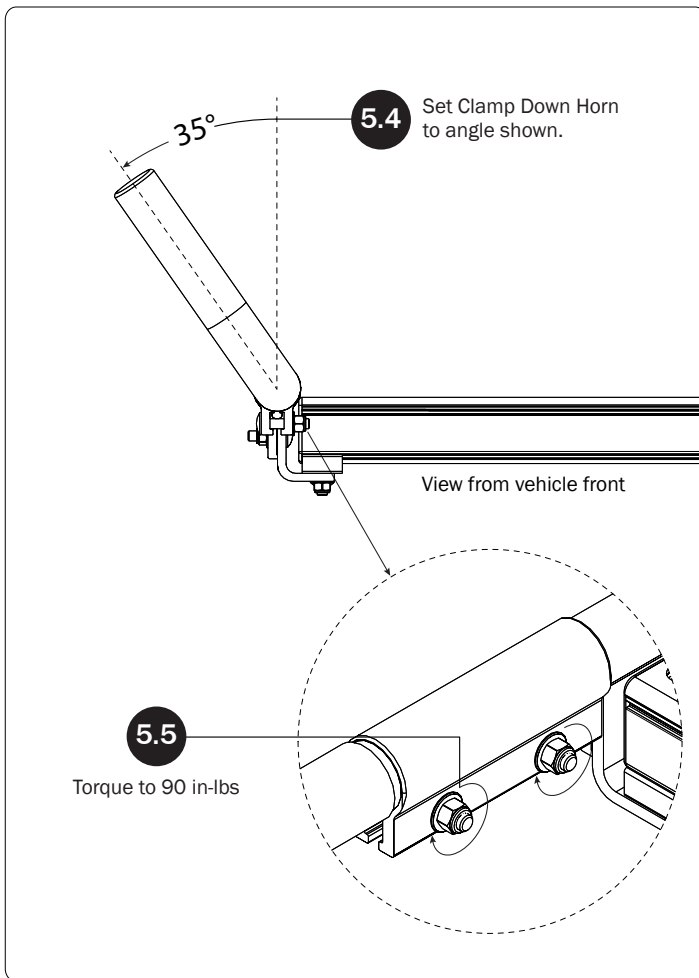
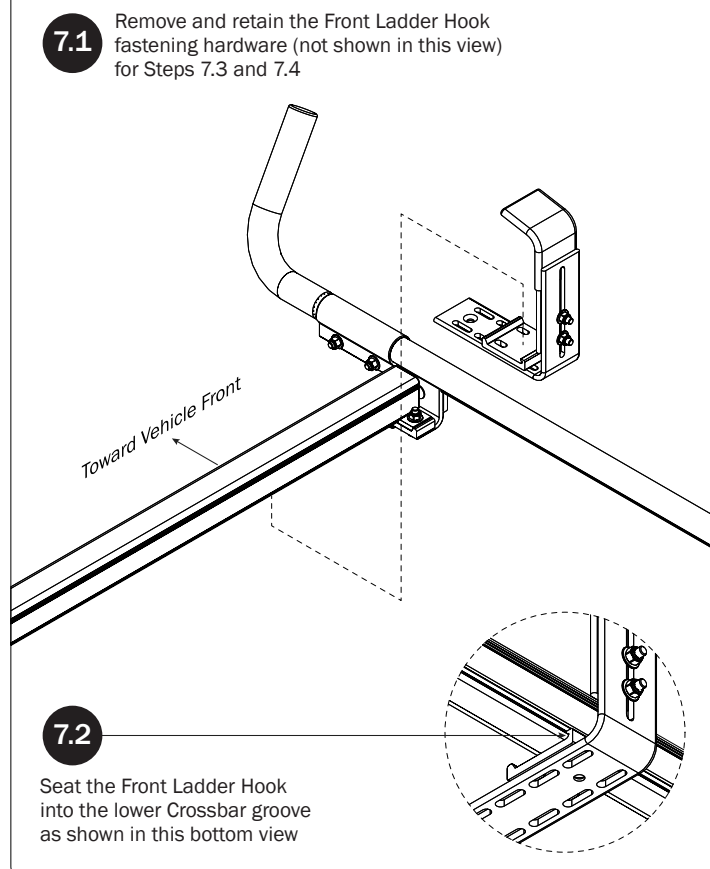
HANDLE LATCH**FRONT LADDER HOOK****SEE QUICK START GUIDE FOR ADJUSTMENTS**

7.3

Place the Front Hook Clamp Bracket removed in Step 7.1 into the lower groove of the Crossbar, and slide it on top of the Front Ladder Hook Clamp

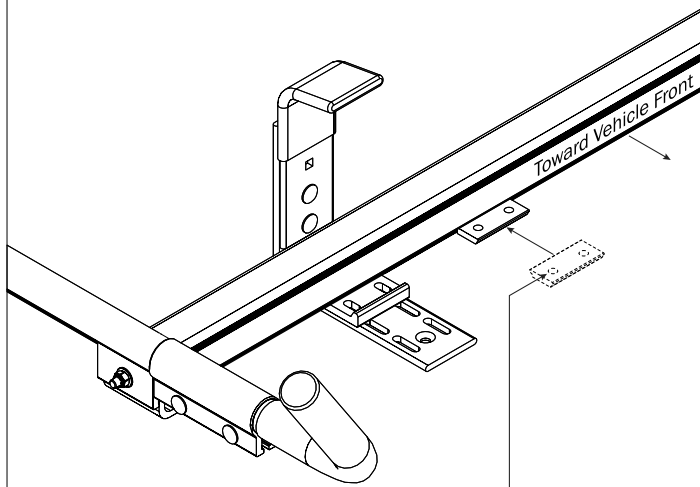

NOTE: The orientation of the bolt hole faces away from the Crossbar

7.4

Reassemble the Front Clamp Down Tube Holder using the fastening hardware removed at Step 7.1. Do not tighten until Step 7.6

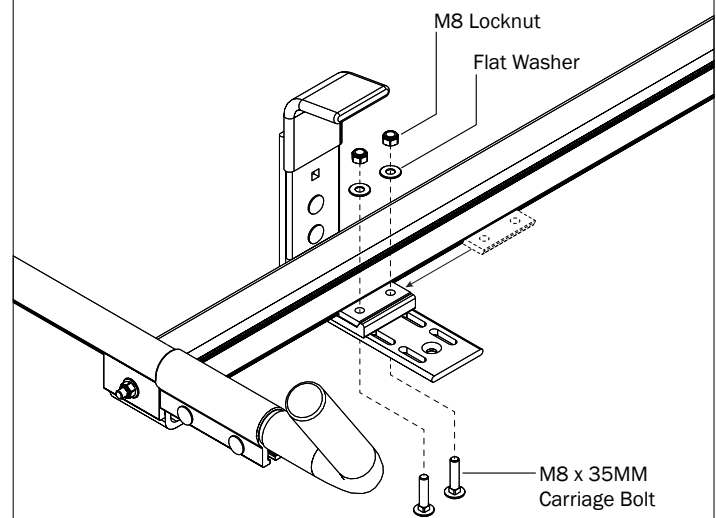

7.5

Adjust the Front Hook until it aligns with the Rear Hook. Perfect alignment may not be possible in all instances, and depends upon the location of the Crossbar Mounting Brackets. If such interference should occur, align the Hook as close as possible.

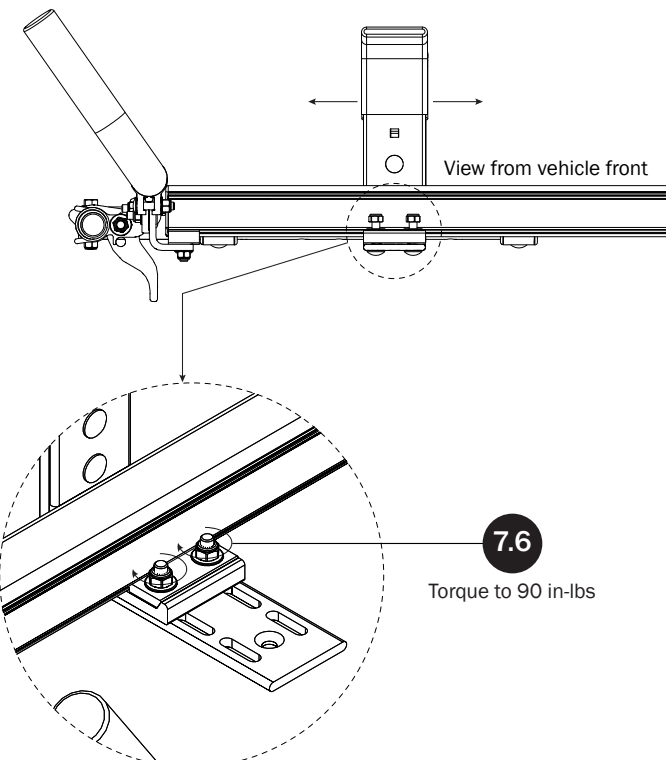

7.6

Torque to 90 in-lbs

LEFT SIDE ASSEMBLY SEQUENCE

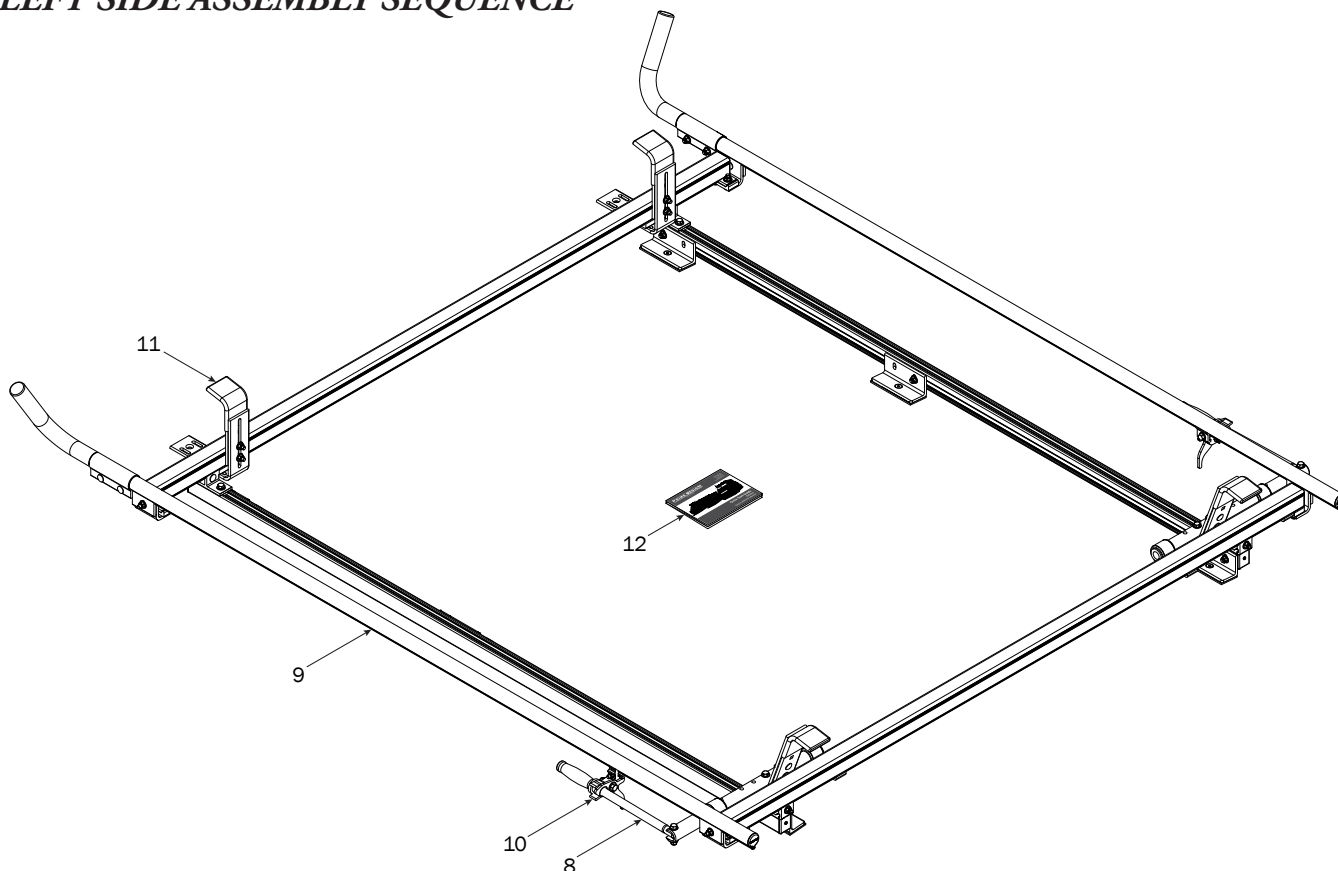

CLAMP DOWN HANDLE

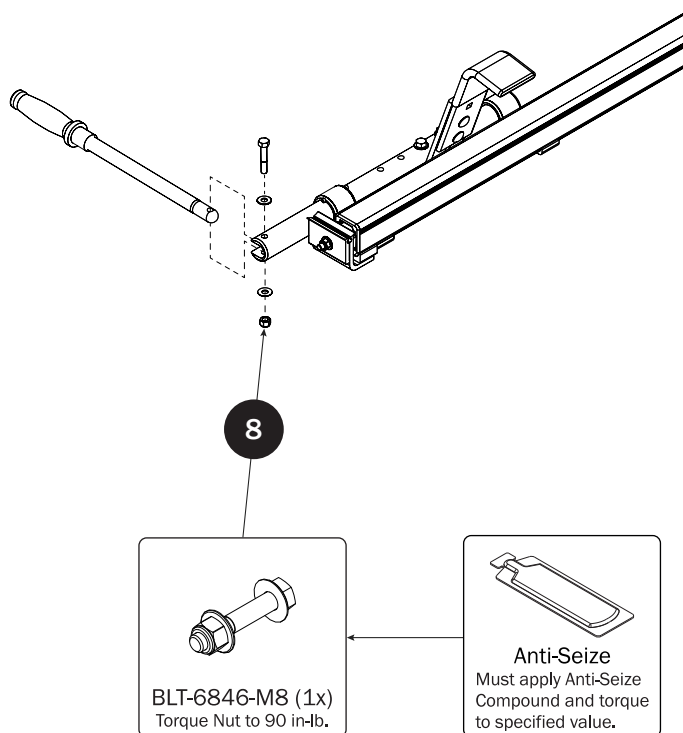

CLAMP DOWN TUBE

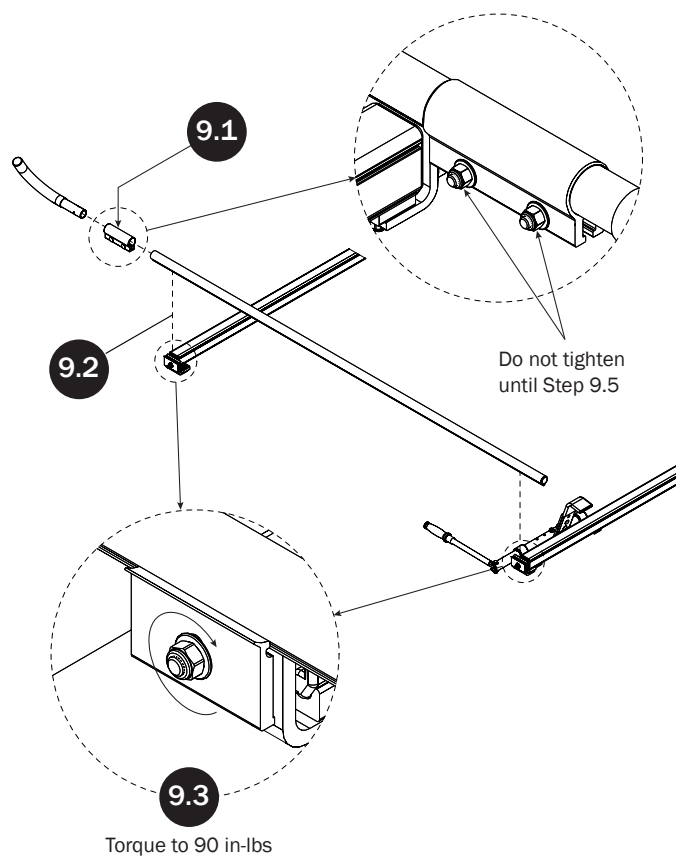

Set Clamp Down Horn
to angle shown.

9.4

35°

View from vehicle front

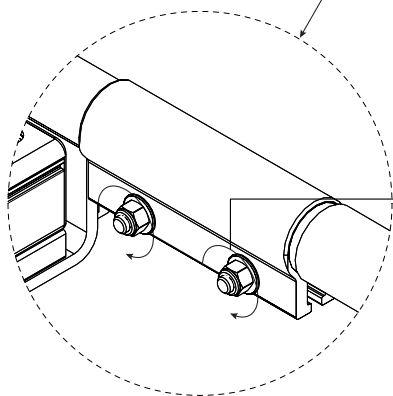

9.5

Torque to 90 in-lbs

HANDLE LATCH

Toward Vehicle Rear

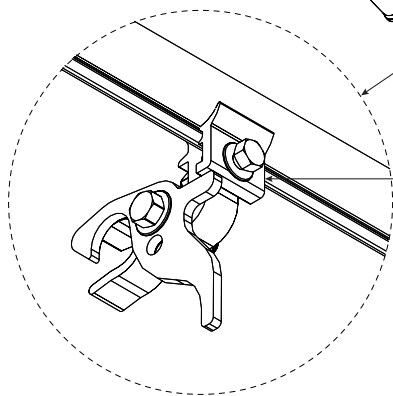

10.1

Do not tighten
until Step 10.3

10.2

Position the Handle Latch until the
Handle Grip is firmly seated.

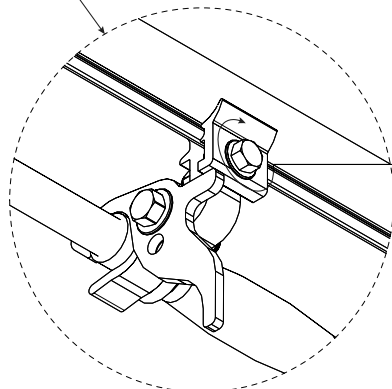
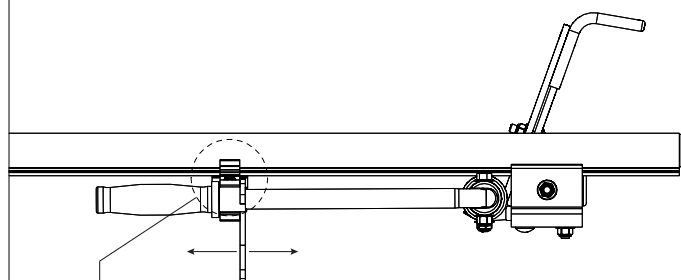

10.3

Torque to 90 in-lbs

FRONT LADDER HOOK SEE QUICK START GUIDE FOR ADJUSTMENTS

11.1

Remove and retain the Front Ladder Hook
fastening hardware (not shown in this view)
for Steps 11.3 and 11.4

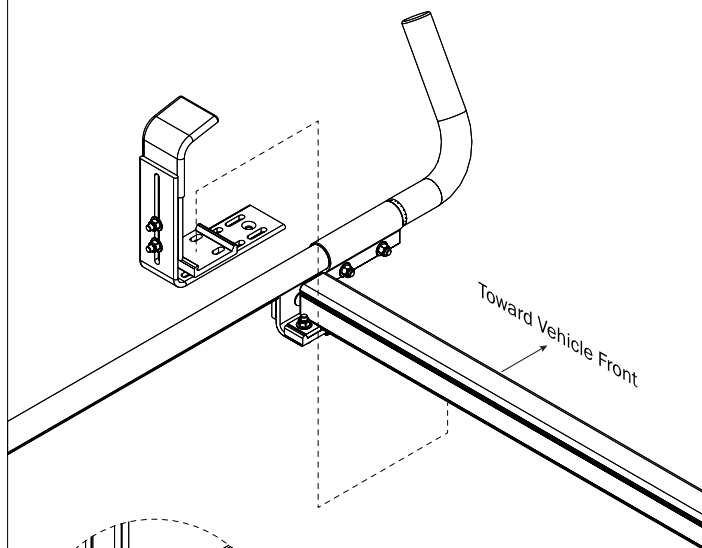

Toward Vehicle Front

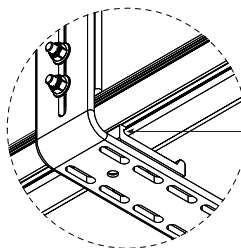

11.2

Seat the Front Ladder Hook
into the lower Crossbar groove
as shown in this bottom view

11.3

Place the Front Hook Clamp Bracket removed in Step 11.1 into the lower groove of the Crossbar, and slide it on top of the Front Ladder Hook Clamp

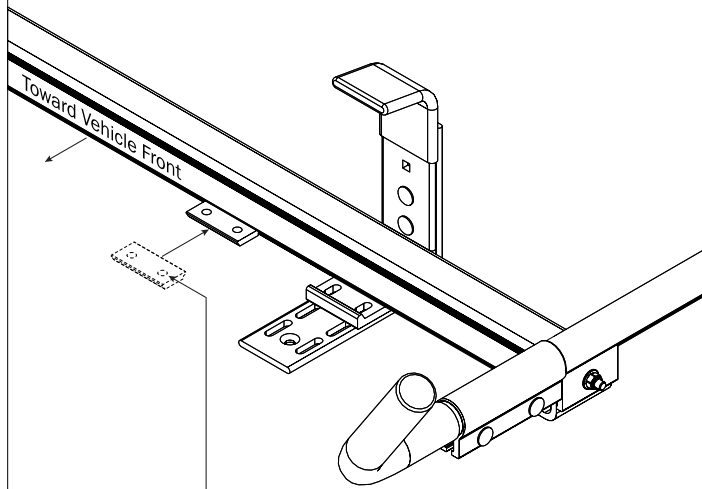

NOTE: The orientation of the bolt hole faces away from the Crossbar

11.4

Reassemble the Front Clamp Down Tube Holder using the fastening hardware removed at Step 11.1. Do not tighten until Step 11.6

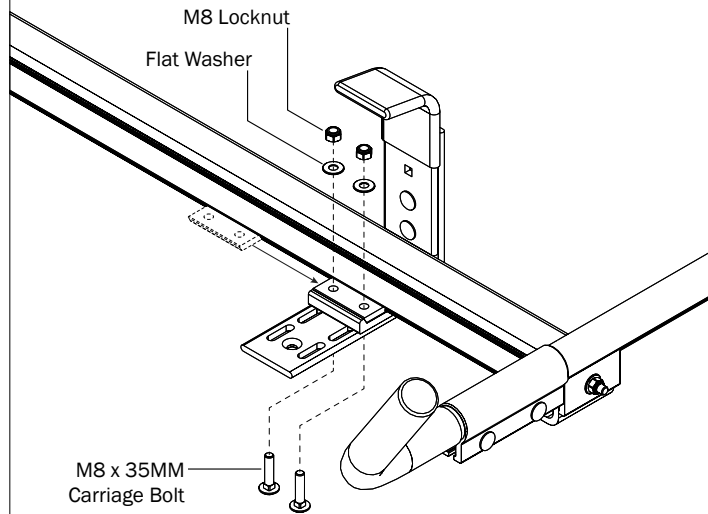

11.5

Adjust the Front Hook until it aligns with the Rear Hook. Perfect alignment may not be possible in all instances, and depends upon the location of the Crossbar Mounting Brackets. If such interference should occur, align the Hook as close as possible.

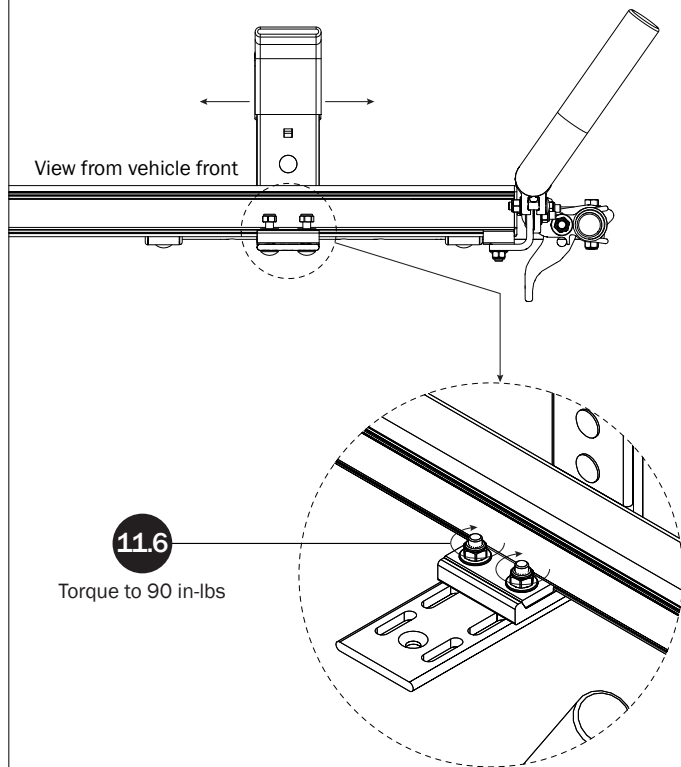

Torque to 90 in-lbs

QUICK START GUIDE

12

Place the Quick Start Guide into the vehicle's glove box for ladder setup and adjustment.

