

**PRIME DESIGN™**

A Safe Fleet Brand

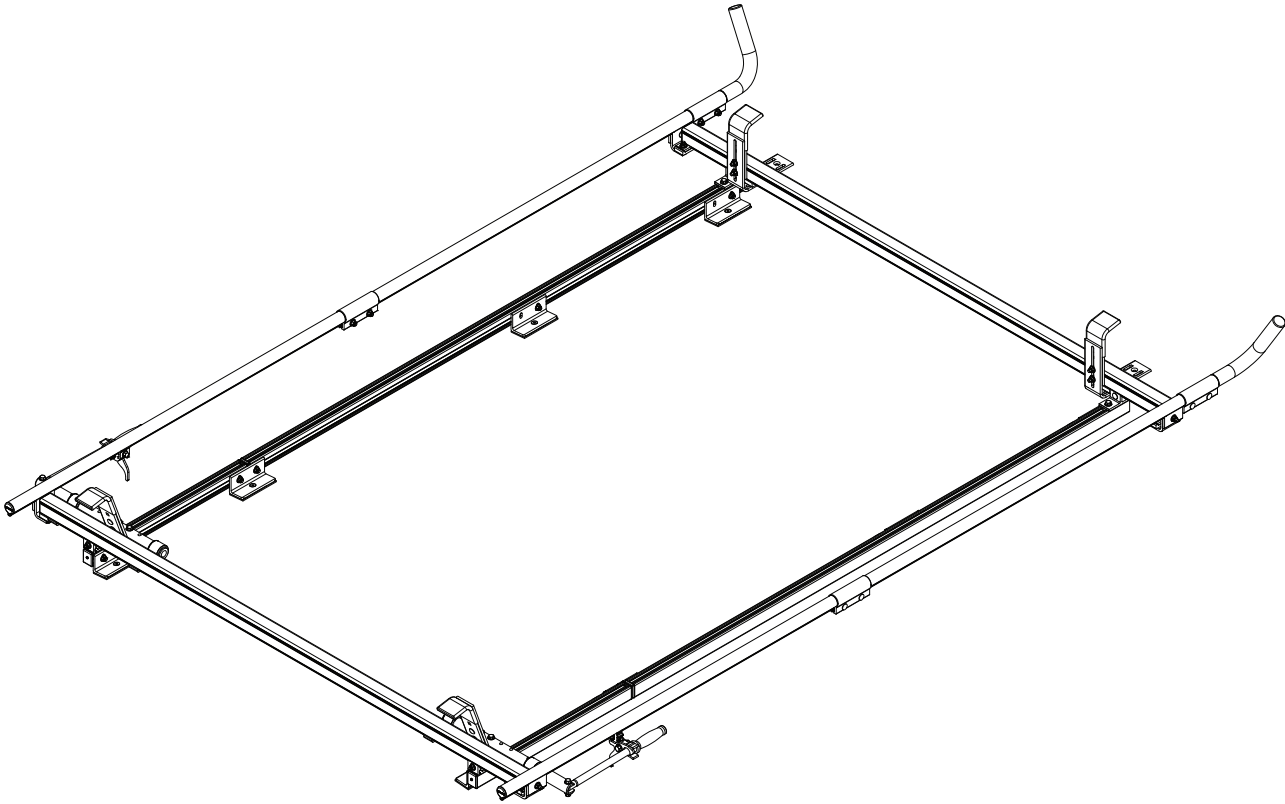

**VCC**  
**4131B**

## CONTENTS OVERVIEW

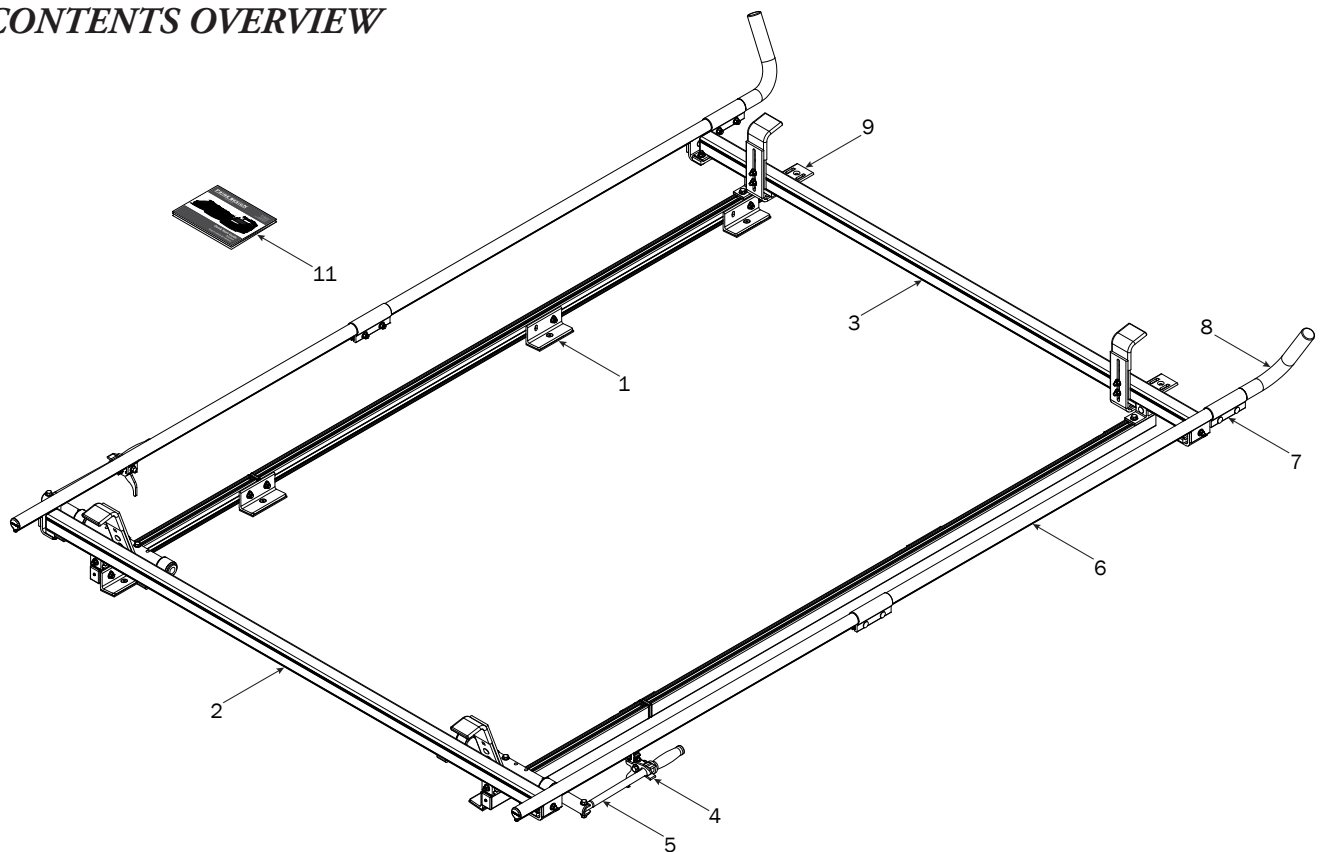

1—FBM-0095 ..... (Qty 1)  
Channels w/ Hardware



23" Channels (2X)



74" Channels, Pre-assembled (2X)



Channel Bracket (4X)

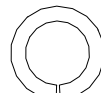

5/16" Lock Washer (4X)

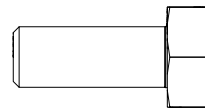

M8 x 20MM (4X)



M8 X 25MM (8X)

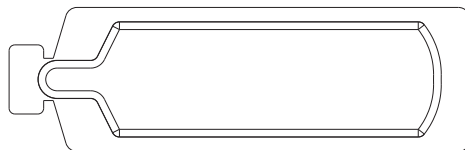

Anti-Seize (1X)

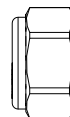

M8 Lock Nut (10X)

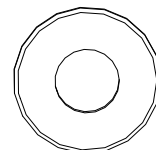

5/16" Flat Washer (14X)

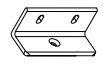

Mounting Bracket (8X)

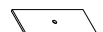

Foam Pad (8X)

2—Rear Crossbar Assembly ..... (Qty 1)

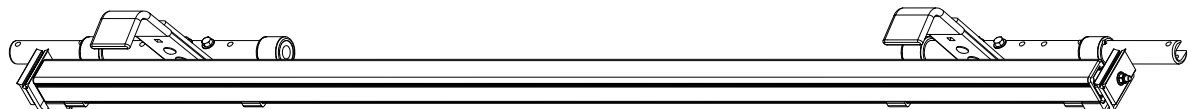

3—Front Crossbar Assembly ..... (Qty 1)

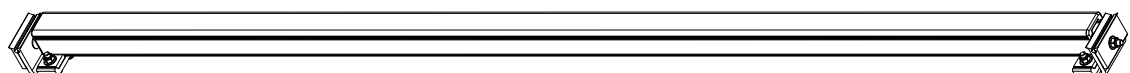

4—Handle Latch Assembly ..... (Qty 2)



5—Clamp Down Handle Assembly ..... (Qty 2)

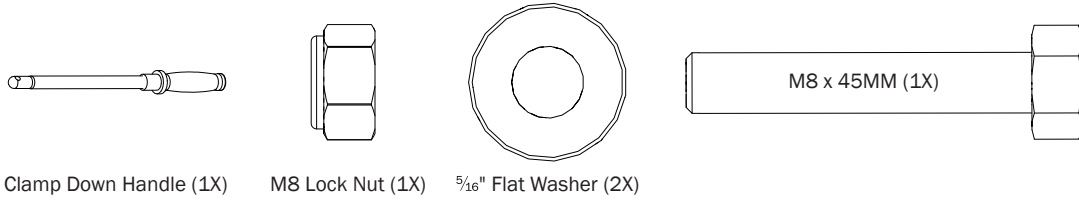

6—Clamp Down Tube Assembly ..... (Qty 2)  
104.00"

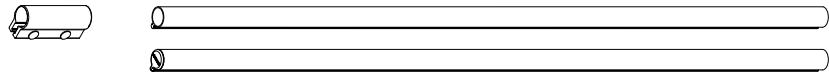

7—Quick Clamp Tube Splice Assembly ..... (Qty 2)  
5.00"



8—Removeable Horn with Cap ..... (Qty 2)  
15.00"

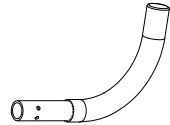

9—HD Front Hook Assembly ..... (Qty 2)

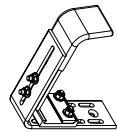

10—Anti-Seize ..... (Qty 1)



11—USQSG-Ergorack ..... (Qty 1)  
Quick Start Guide, Clamp Down



**RIGHT SIDE ASSEMBLY SEQUENCE**

Prior to assembling the Channels and hardware, the OEM roof holes must be chased using an M8 x 1.25 Chasing or Thread Cleaning tap and fluid. Doing so will ensure accurate torque is achieved.

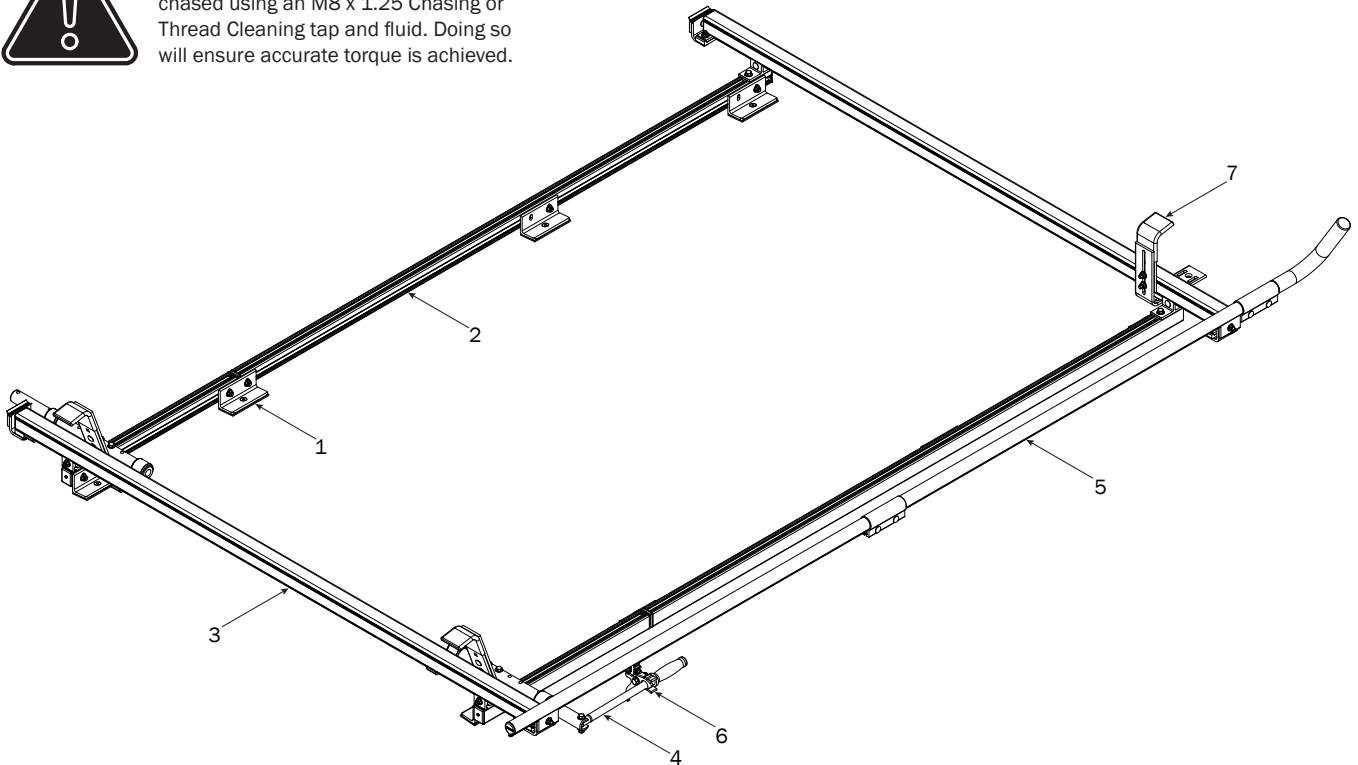
**MOUNTING BRACKETS****1**

Apply Anti-Seize to all M8 x 25MM Flat Head Screws and install the Channel Mounting Brackets with Foam Pads onto the vehicle's roof mounting holes. Do not tighten screws until Step 2.3

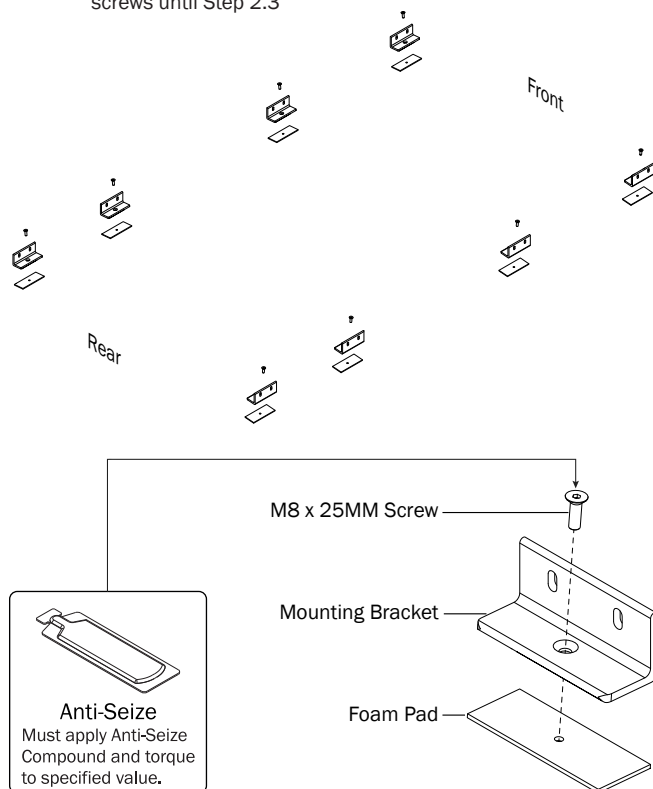
**CHANNELS****2.1**

Apply Anti-Seize to all M8 T Bolt studs, then attach to Mounts using the indicated hardware. Do not tighten until Step 2.2

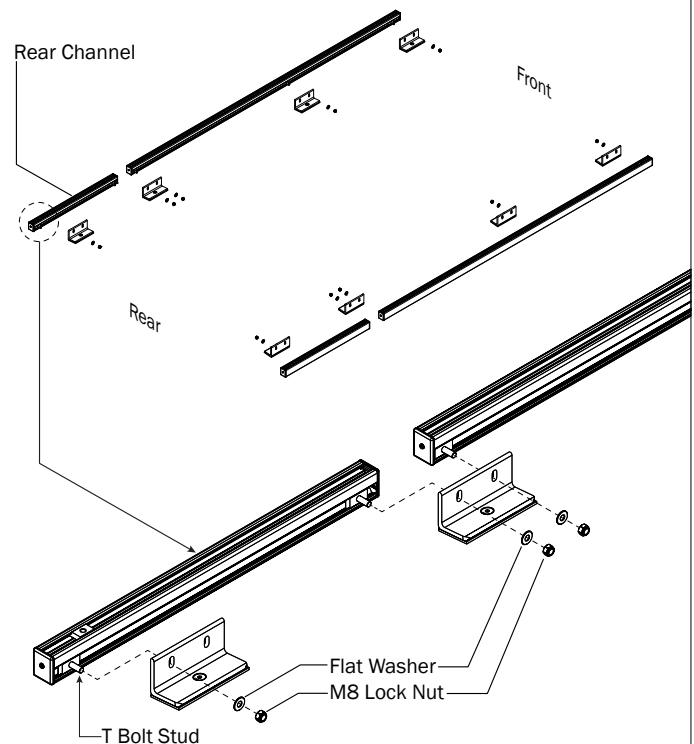



The Front Channels include two aluminum Strip Nuts per Channel for use in a three Crossbar configuration. For two Crossbar configurations, disregard the spare Strip Nut in each Front Channel.

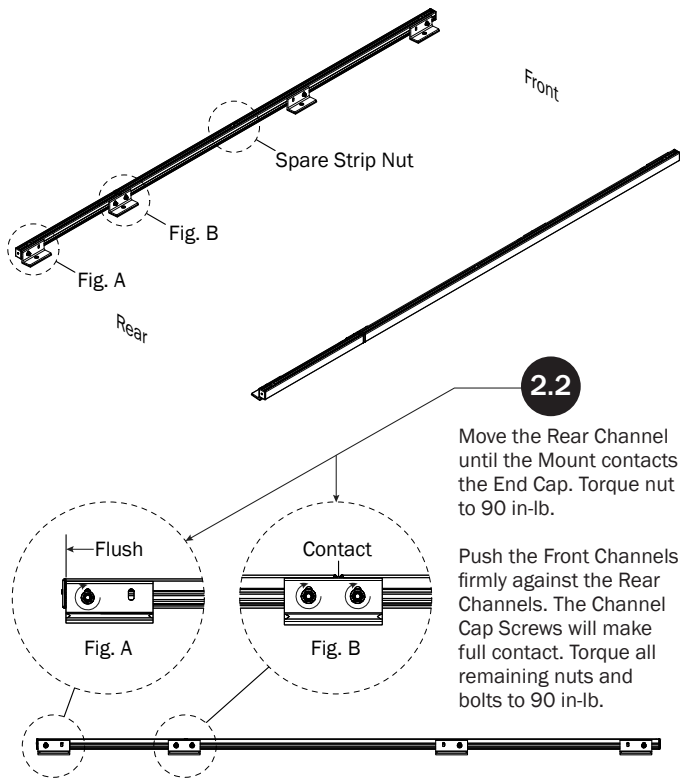

2.3

Torque all M8 x 25MM Flat Head Screws to 150 in-lbs. Apply Silicone Sealant to screw heads to seal against water intrusion.

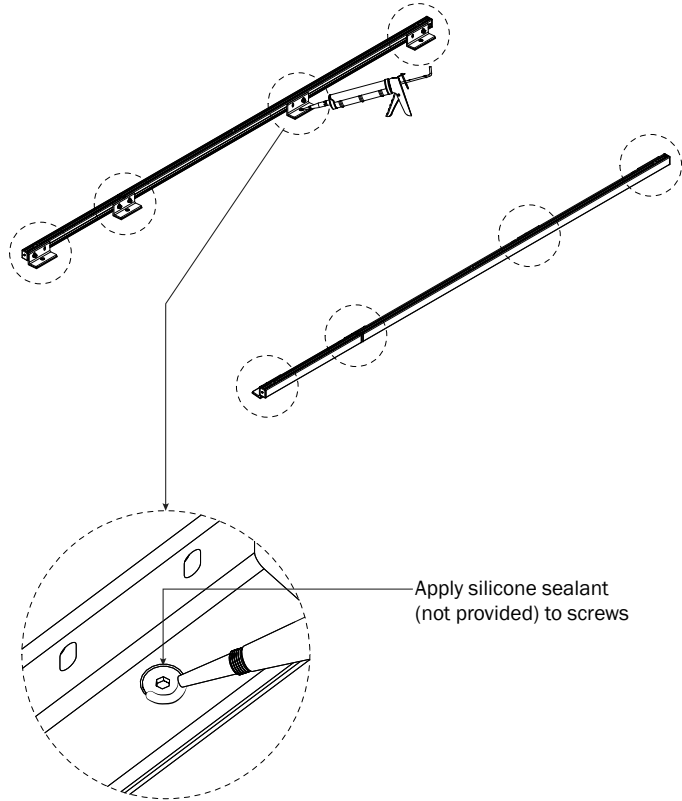

2.4

Attach Mounting Brackets to the Aluminum Strip Nuts located in the Channels

Position the rear and center Mounting Brackets as shown.

Position the front Mounting Brackets as shown.

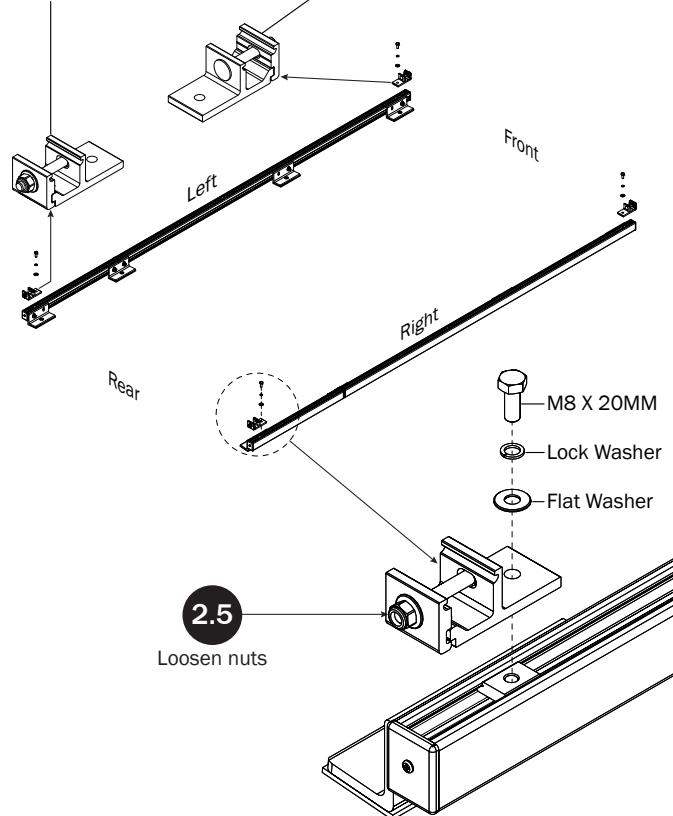

2.6

Position Mounting Brackets to designated dimension shown below, then torque the M8 X 20MM bolt to 90 in-lbs. Proceed to Step 3.1.

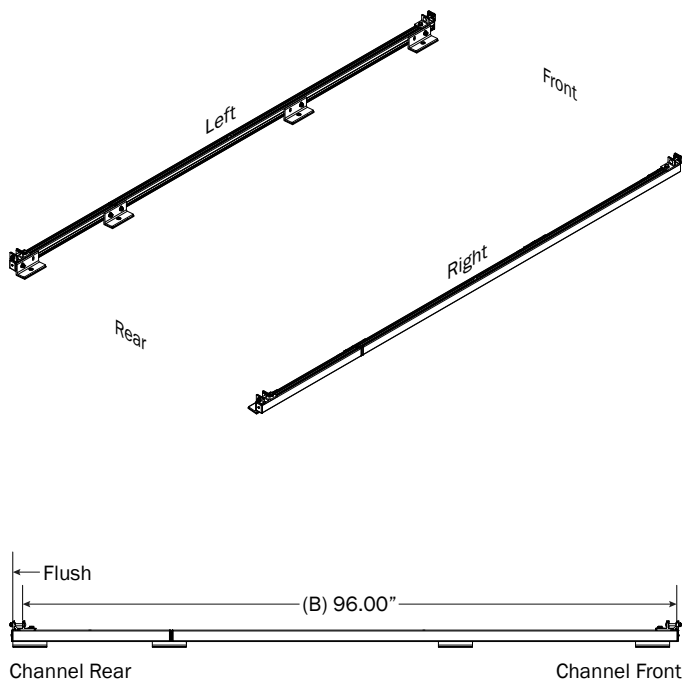

5

VCC-FT31B ASSEMBLY INSTRUCTIONS—RIGHT SIDE CLAMP DOWN

PRIME DESIGN™  
A Safe Fleet Brand

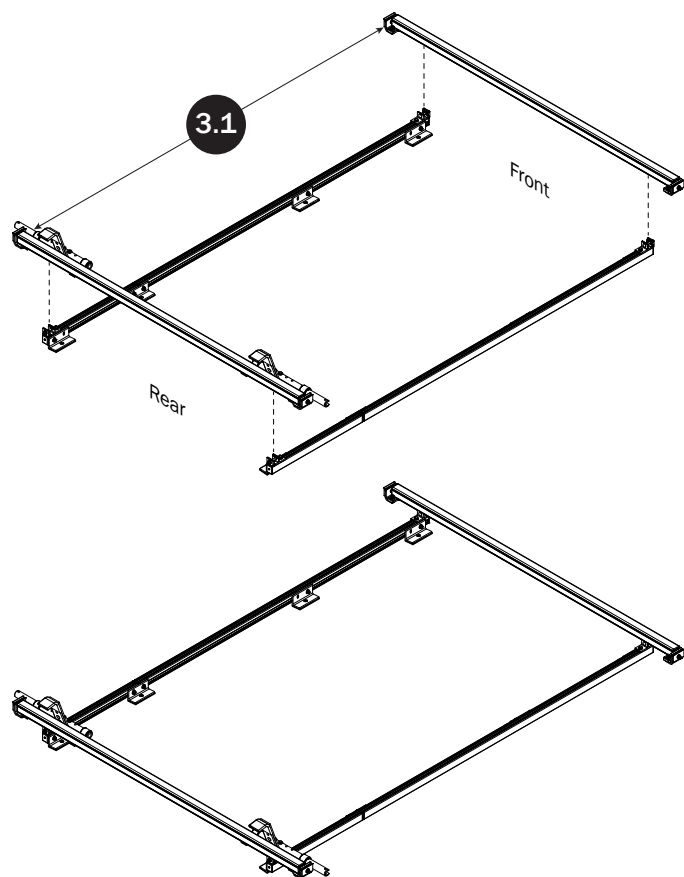
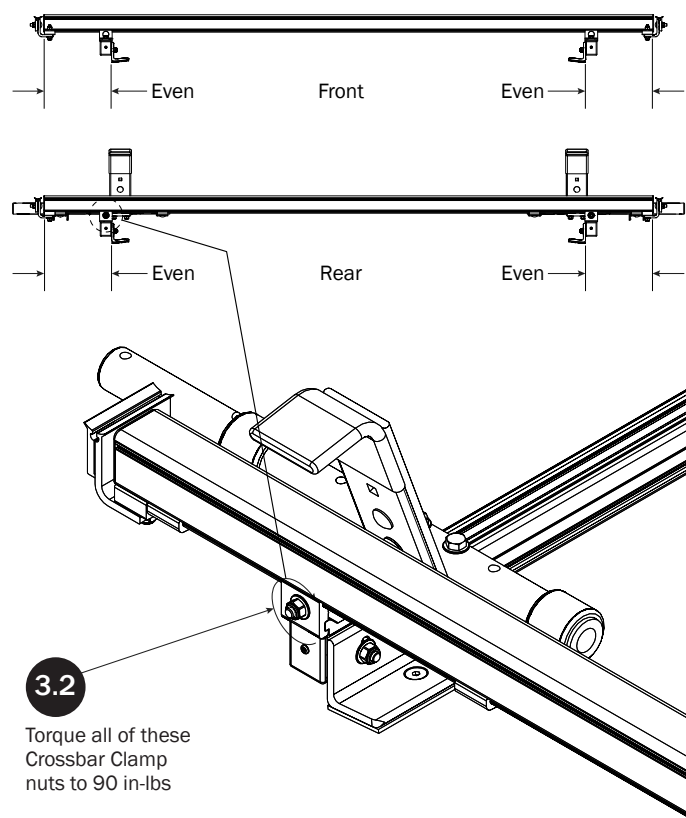
**CROSSBARS****CROSSBAR ADJUSTMENT****CLAMP DOWN HANDLE**

NOTE: For instructional clarity, the FBM Mounting System will not be shown for the remainder of this Assembly Manual.

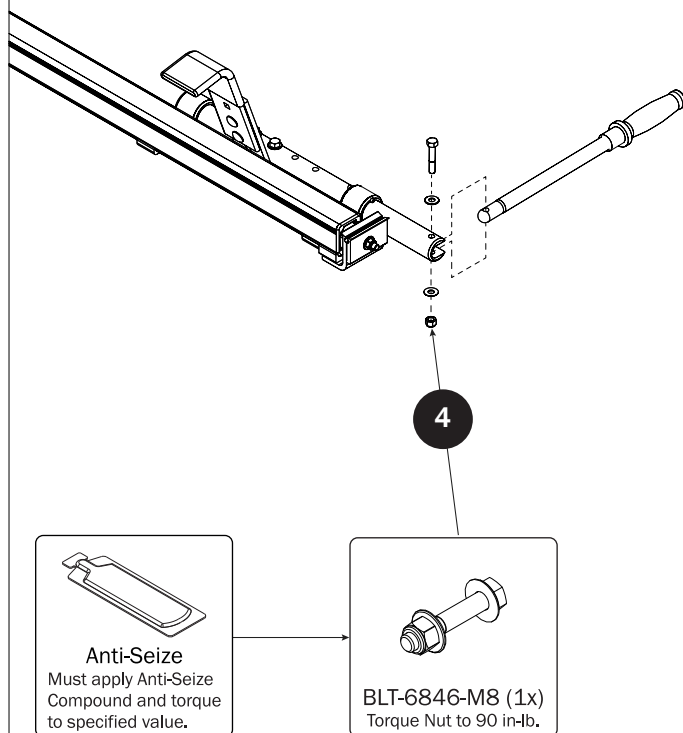
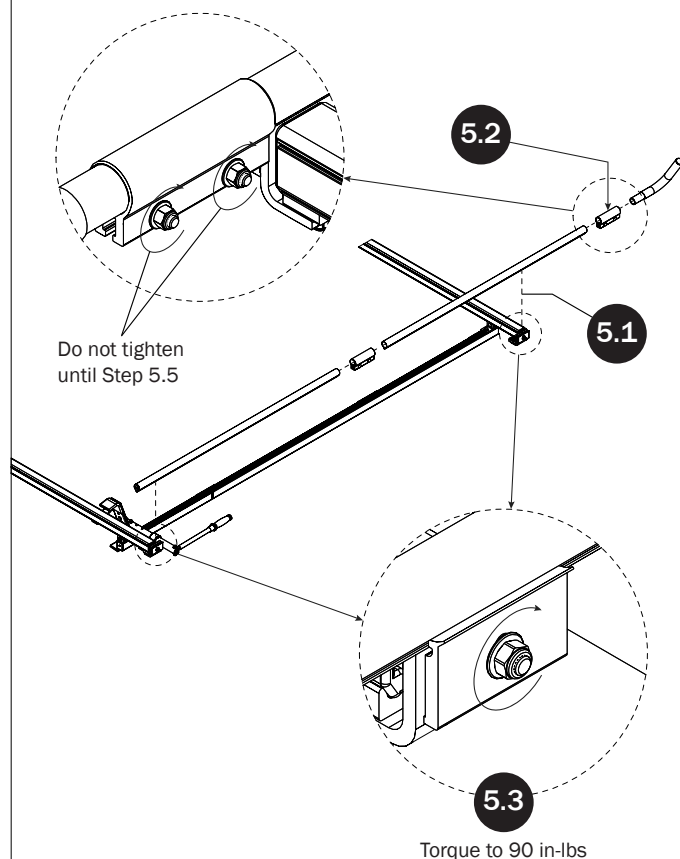
**CLAMP DOWN TUBE**

- 5.4** Set Clamp Down Horn to angle shown.

35°

View from vehicle front

**5.5**

Torque to 90 in-lbs

**HANDLE LATCH**

Toward Vehicle Rear

**6.1**

Do not tighten until Step 6.3

- 6.2** Position the Handle Latch until the Handle Grip is firmly seated.

**7.1**

Remove and retain the Front Ladder Hook fastening hardware (not shown in this view) for Steps 7.3 and 7.4

**FRONT LADDER HOOK**  
SEE QUICK START GUIDE FOR ADJUSTMENTS**7.2**

Seat the Front Ladder Hook into the lower Crossbar groove as shown in this bottom view

**6.3**

Torque to 90 in-lbs

7.3

Place the Front Hook Clamp Bracket removed in Step 7.1 into the lower groove of the Crossbar, and slide it on top of the Front Ladder Hook Clamp

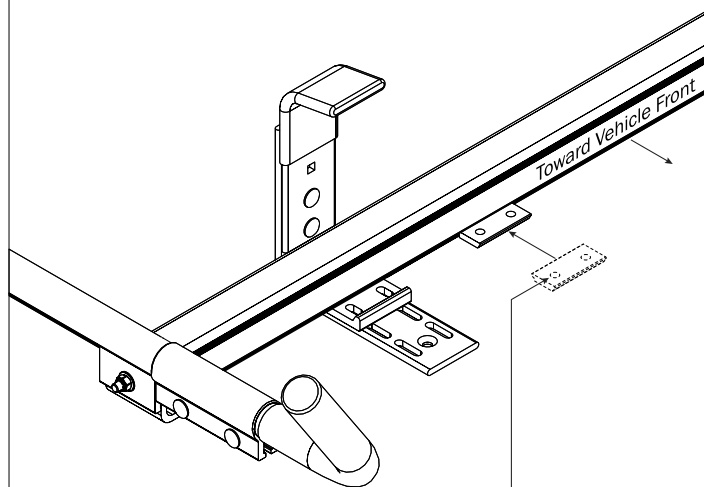

**NOTE:** The orientation of the bolt hole faces away from the Crossbar

7.4

Reassemble the Front Clamp Down Tube Holder using the fastening hardware removed at Step 7.1. Do not tighten until Step 7.6

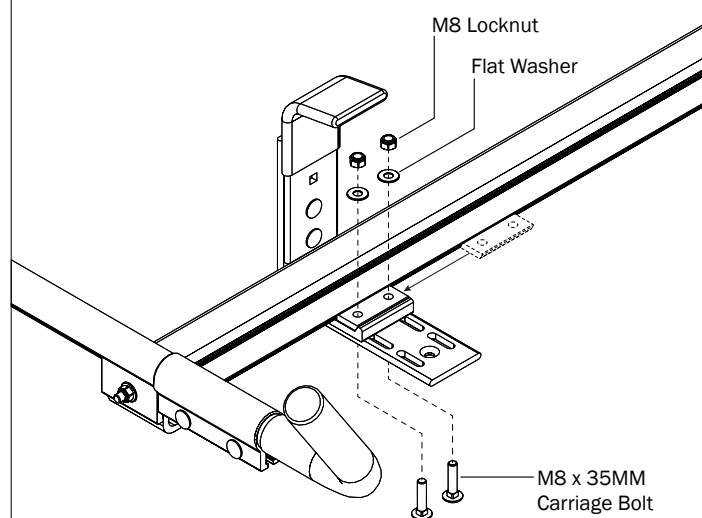

7.5

Adjust the Front Hook until it aligns with the Rear Hook. Perfect alignment may not be possible in all instances, and depends upon the location of the Crossbar Mounting Brackets. If such interference should occur, align the Hook as close as possible.

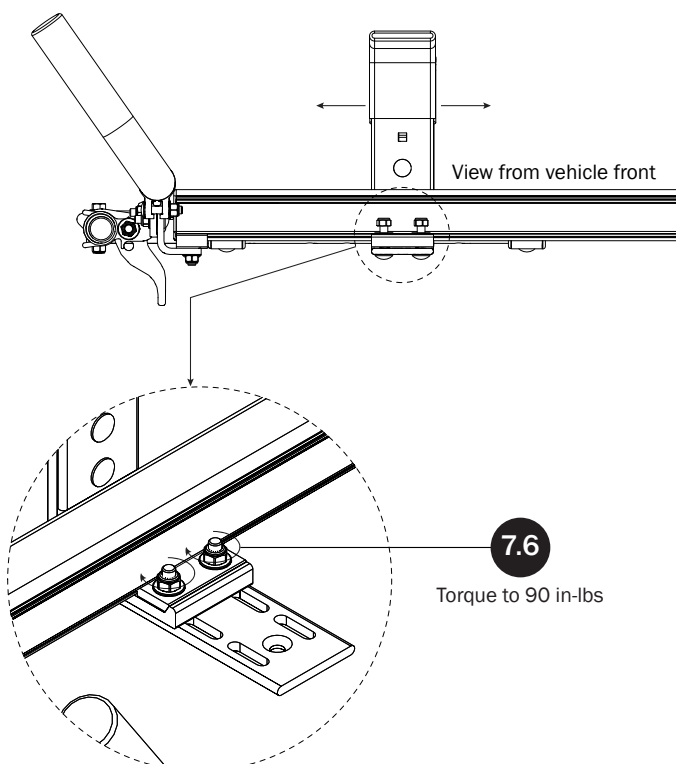

7.6

Torque to 90 in-lbs



## LEFT SIDE ASSEMBLY SEQUENCE

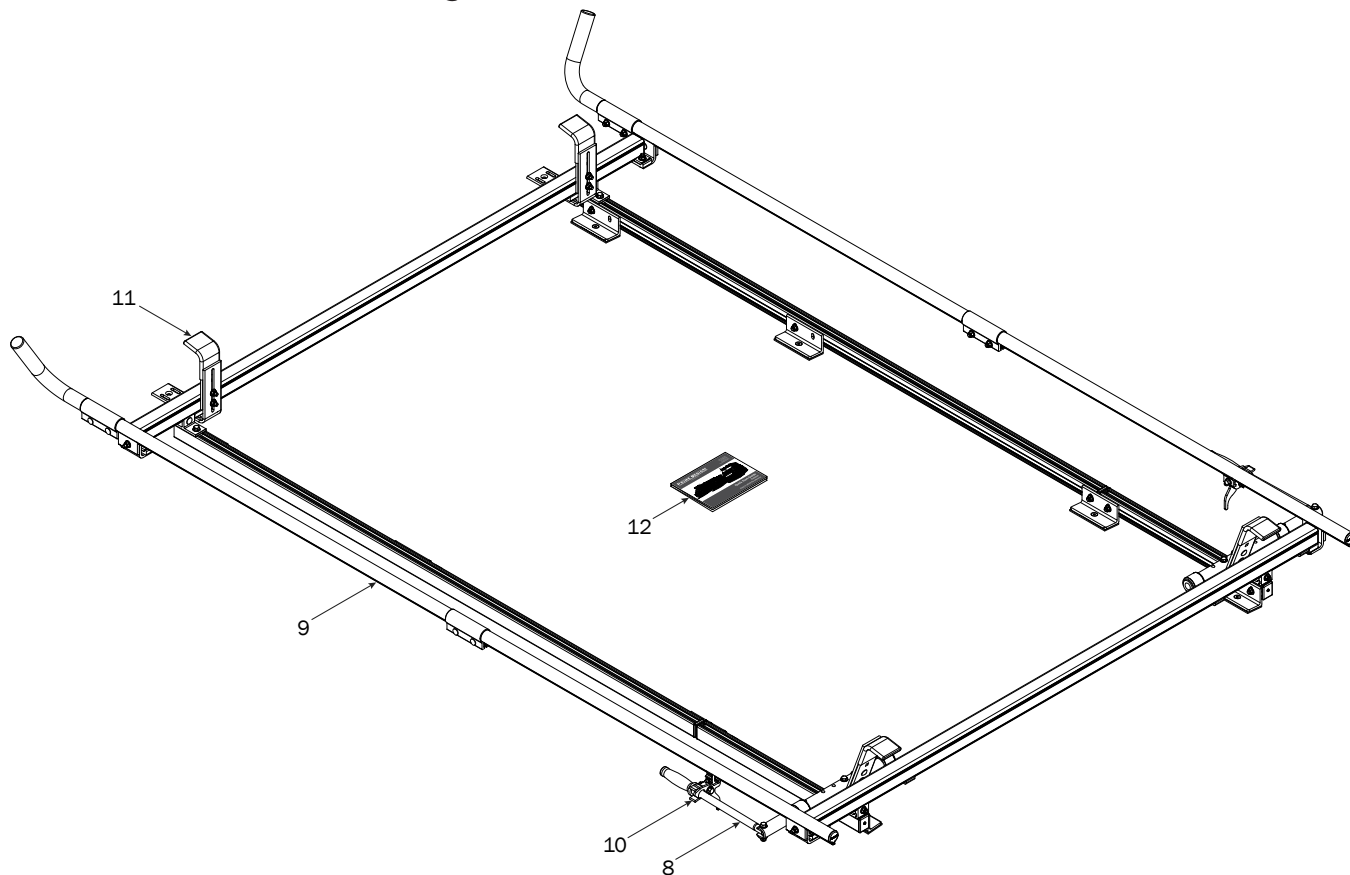

### CLAMP DOWN HANDLE

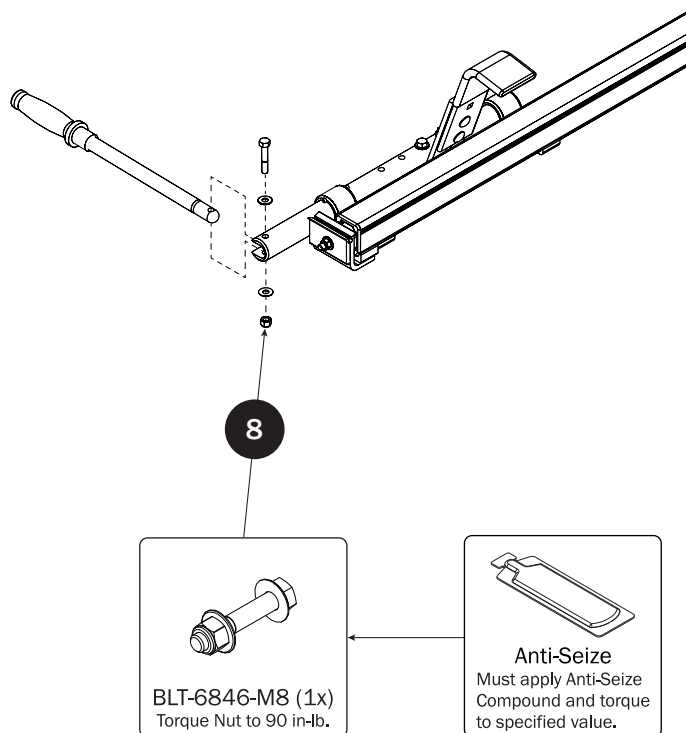

### CLAMP DOWN TUBE

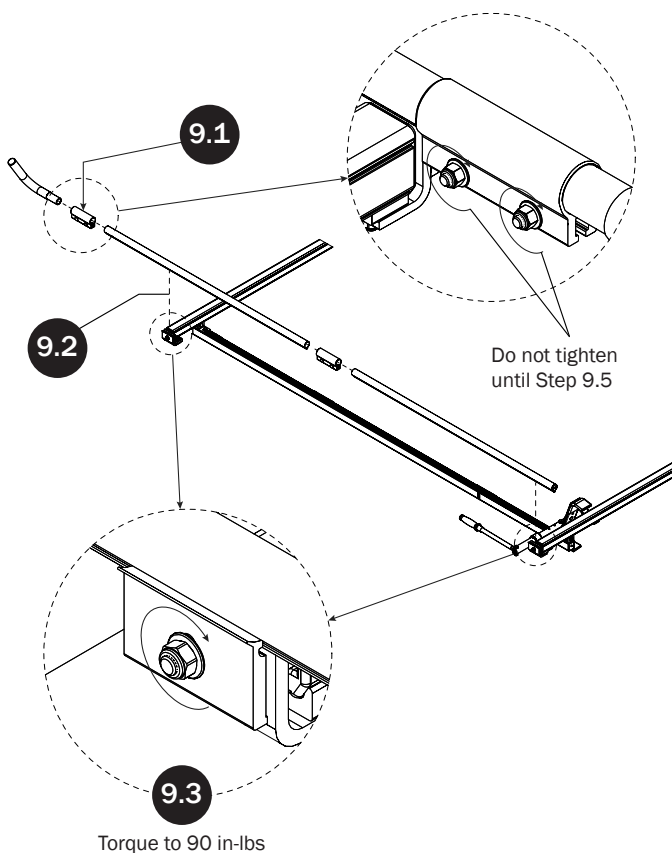

Set Clamp Down Horn  
to angle shown.

9.4

35°

View from vehicle front

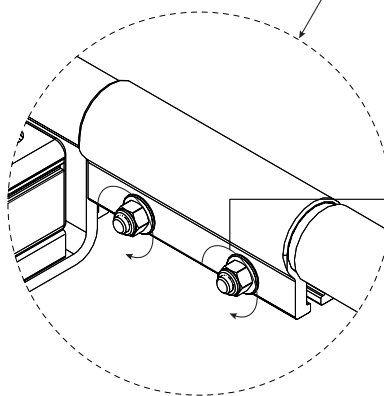

9.5

Torque to 90 in-lbs

## HANDLE LATCH

Toward Vehicle Rear

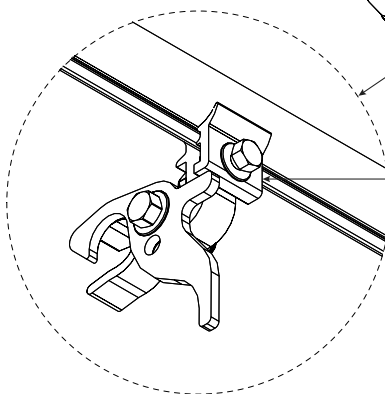

10.1

Do not tighten  
until Step 10.3

10.2

Position the Handle Latch until the  
Handle Grip is firmly seated.

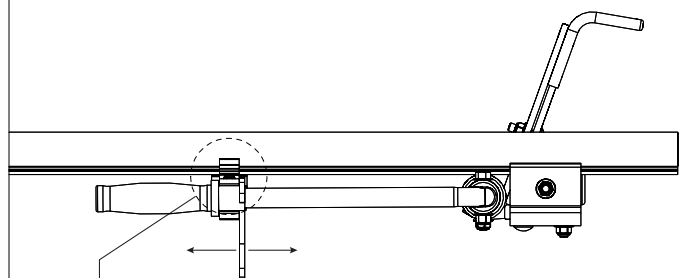

10.3

Torque to 90 in-lbs

## FRONT LADDER HOOK SEE QUICK START GUIDE FOR ADJUSTMENTS

11.1

Remove and retain the Front Ladder Hook  
fastening hardware (not shown in this view)  
for Steps 11.3 and 11.4

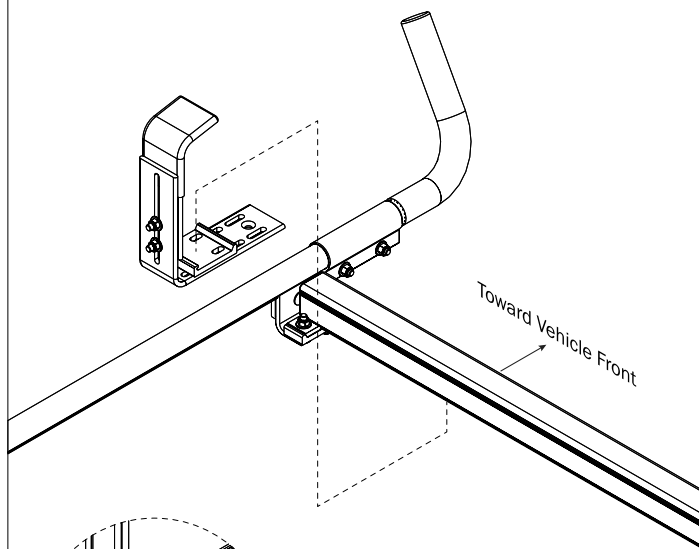

11.2

Seat the Front Ladder Hook  
into the lower Crossbar groove  
as shown in this bottom view

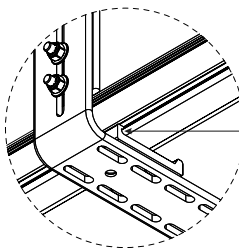

- 11.3** Place the Front Hook Clamp Bracket removed in Step 11.1 into the lower groove of the Crossbar, and slide it on top of the Front Ladder Hook Clamp

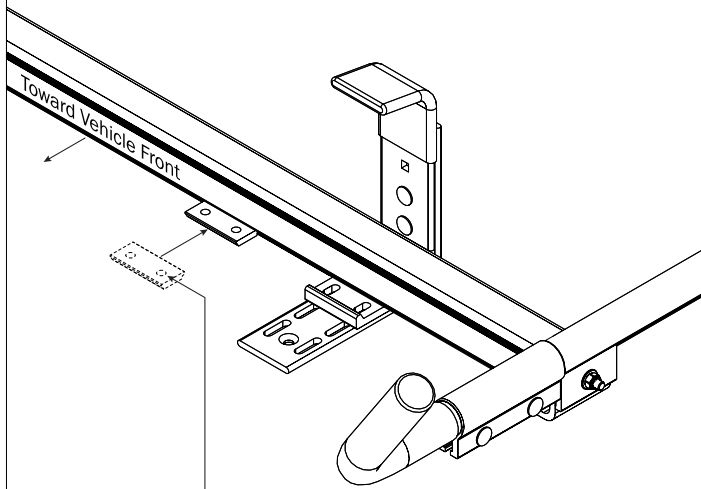

**NOTE:** The orientation of the bolt hole faces away from the Crossbar

- 11.4** Reassemble the Front Clamp Down Tube Holder using the fastening hardware removed at Step 11.1. Do not tighten until Step 11.6

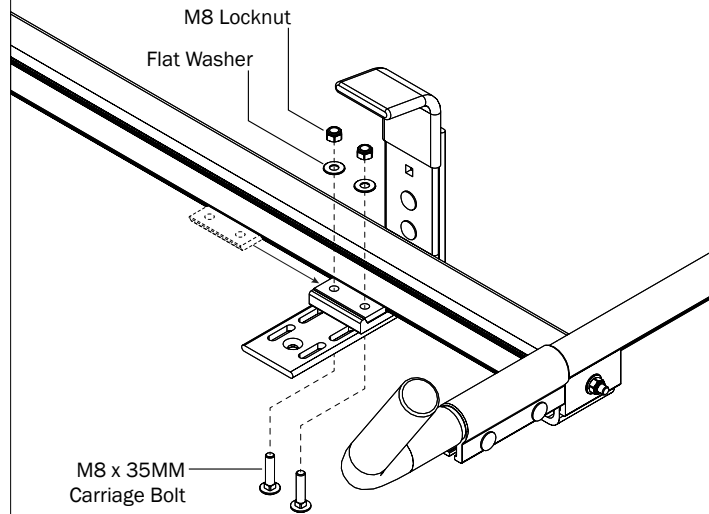

- 11.5** Adjust the Front Hook until it aligns with the Rear Hook. Perfect alignment may not be possible in all instances, and depends upon the location of the Crossbar Mounting Brackets. If such interference should occur, align the Hook as close as possible.

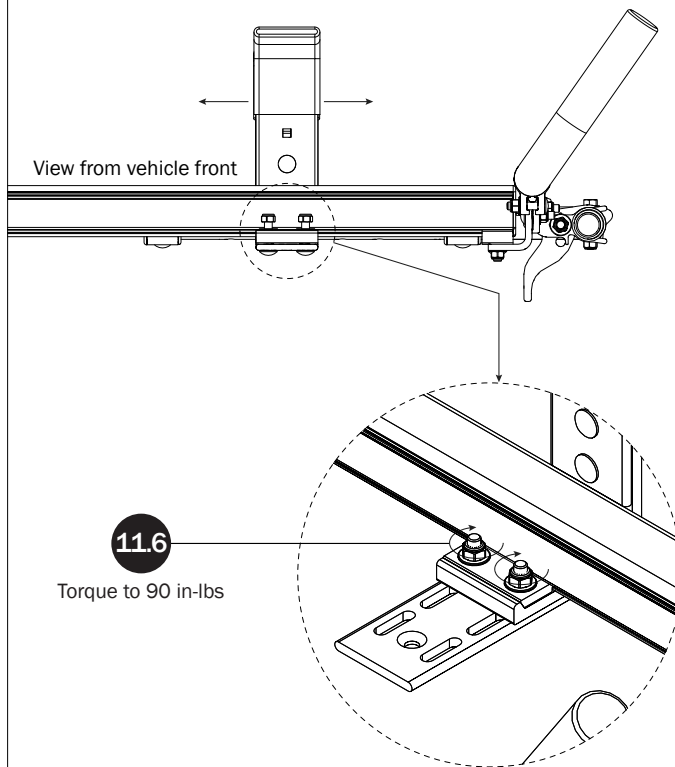

- 11.6**  
Torque to 90 in-lbs

## QUICK START GUIDE

- 12** Place the Quick Start Guide into the vehicle's glove box for ladder setup and adjustment.

