

VCR-FT21B

2015+ Ford Transit L2H1 Regular Wheel Base, Low Roof

Dimensional Specifications on Page 2

Configuration as shown:

Clamp Down Left/Rotation Right

Two Crossbars, US Gen4

Finish: White Powder Coat

FBM-0096 Ford Transit Mounting System

Overall Weight (empty): 82 lbs

Load specifications as shown:

Maximum Ladder Weight LH..... 100 lbs

Maximum Ladder Length LH..... 24 ft

Maximum Ladder Section LH..... 12 ft

Maximum Ladder Weight RH..... 75 lbs

Maximum Ladder Length RH..... 24 ft

Maximum Ladder Section RH..... 12 ft

* Note: Crossbars are not centered on the vehicle. Set Crossbars according to the LH dimensions as shown in the Assembly Manual.

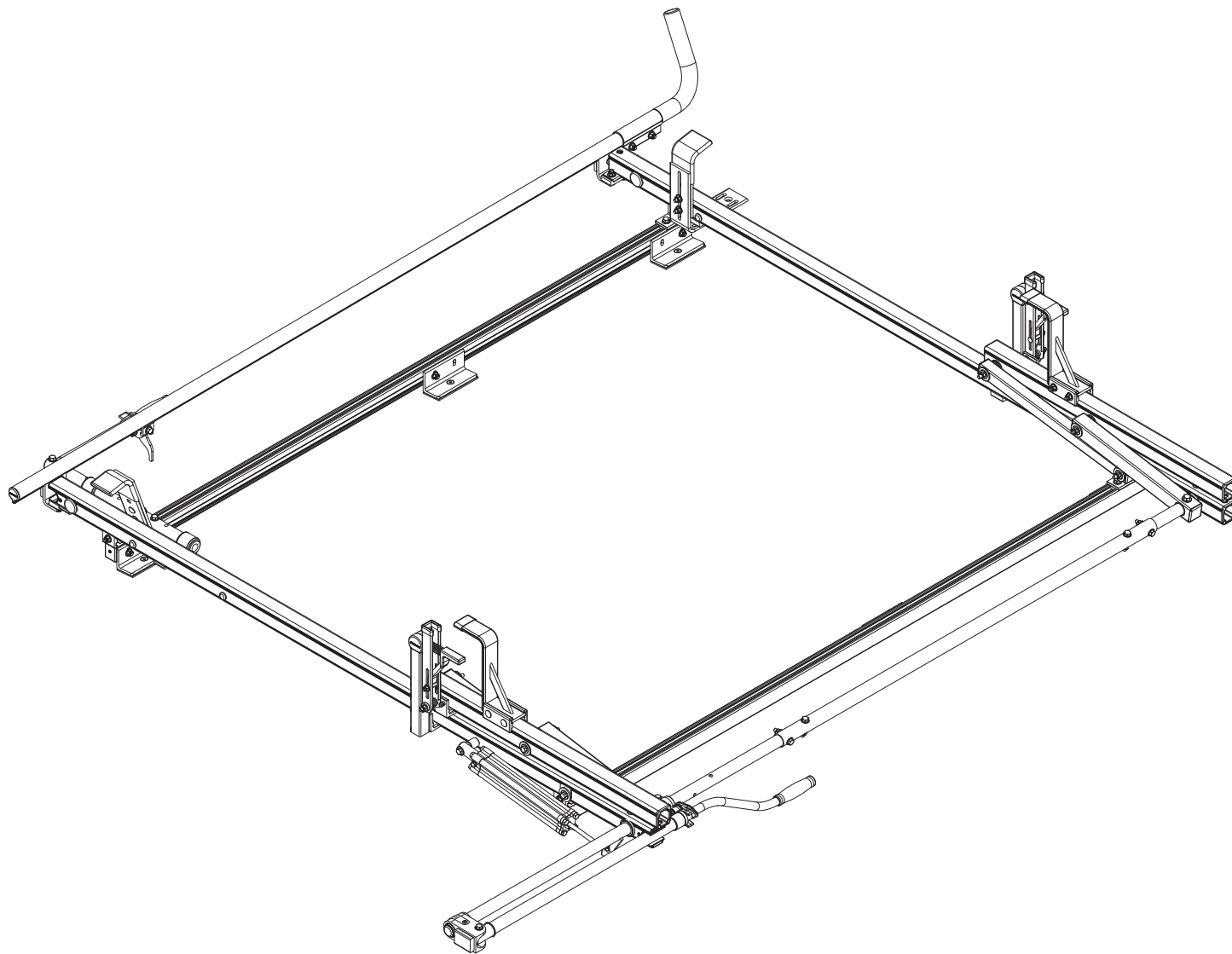

VCR-FT21B

2015+ Ford Transit L2H1
Regular Wheel Base, Low Roof

Approximate dimensions as shown:

A: Wheel Base.....	130"
B: Roof Height.....	82"
C: Rack Length.....	108.50"
D: Rack Height.....	15"
E: Crossbar Spacing.....	6'
F: Overall Height.....	97"
G: Rack Width.....	82.50"
H: Mount Bolt Spacing L/R.....	54"
I: Rear Crossbar Offset (Left).....	9.25"

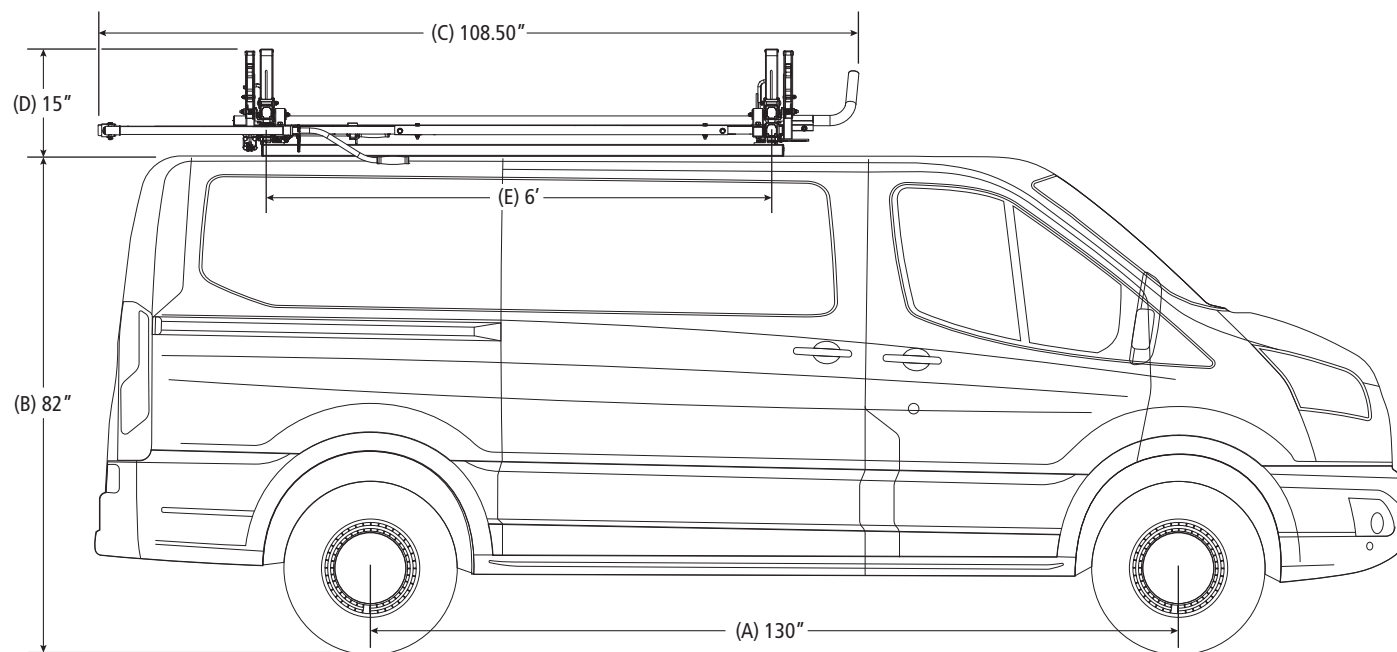
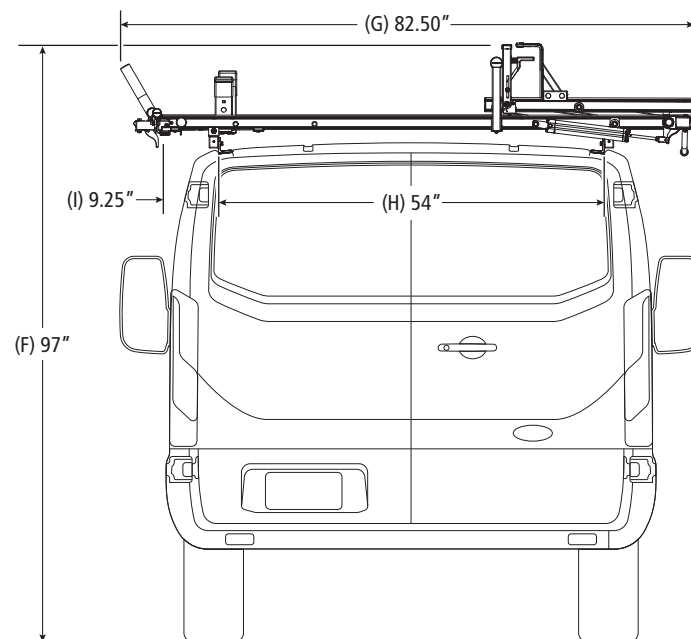
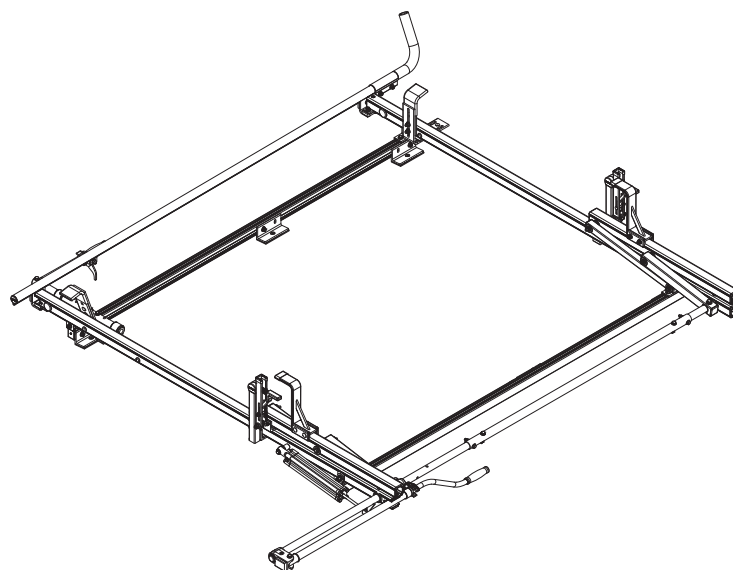

* Note: Crossbars are not centered on the vehicle. Set Crossbars according to the LH dimensions as shown in the Assembly Manual.

Assembly Manual also available:

VCR-FT21B

USOV-VCRFT21B-US01 Rev-D 0318