

PRIME DESIGN™

A Safe Fleet Brand

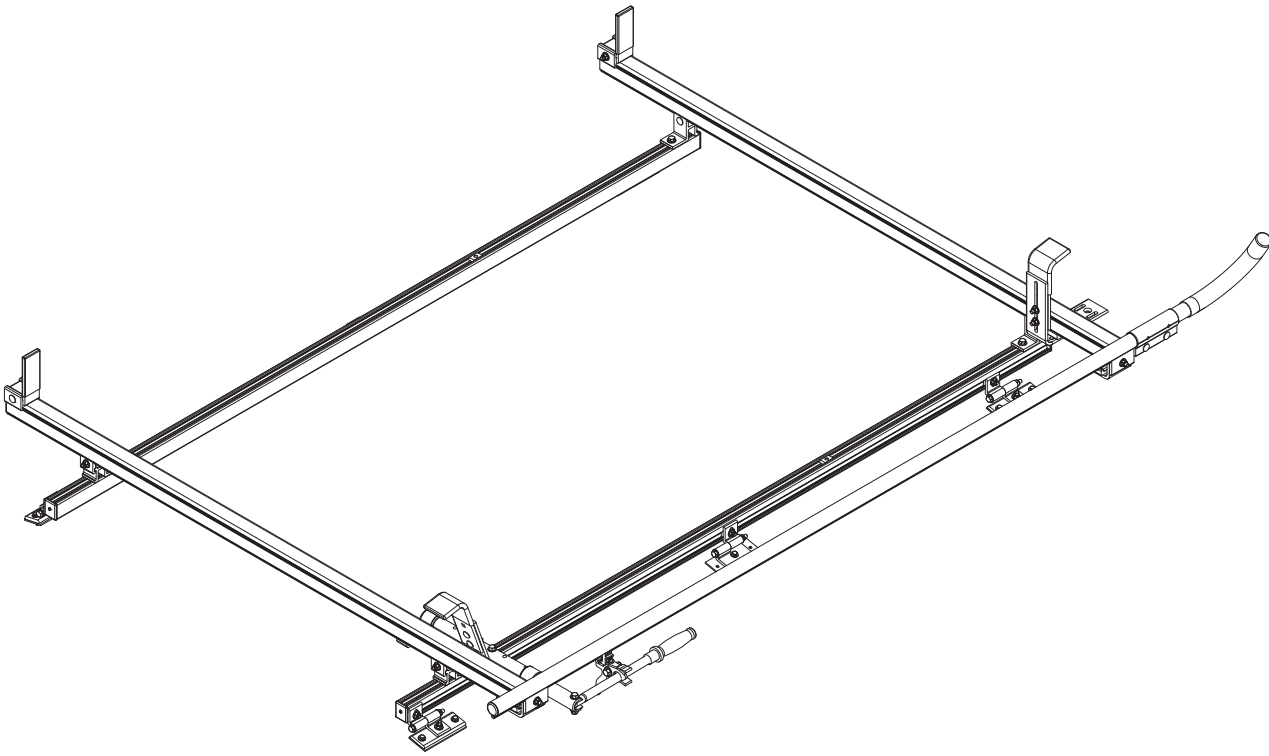

VBC

CONTENTS OVERVIEW

NOTE: This Manual contains Channels and Hardware fitting both two and three Crossbar configurations.

If your model is a two Crossbar configuration, disregard the extra Hardware contained in the Channels and HKT-0166.

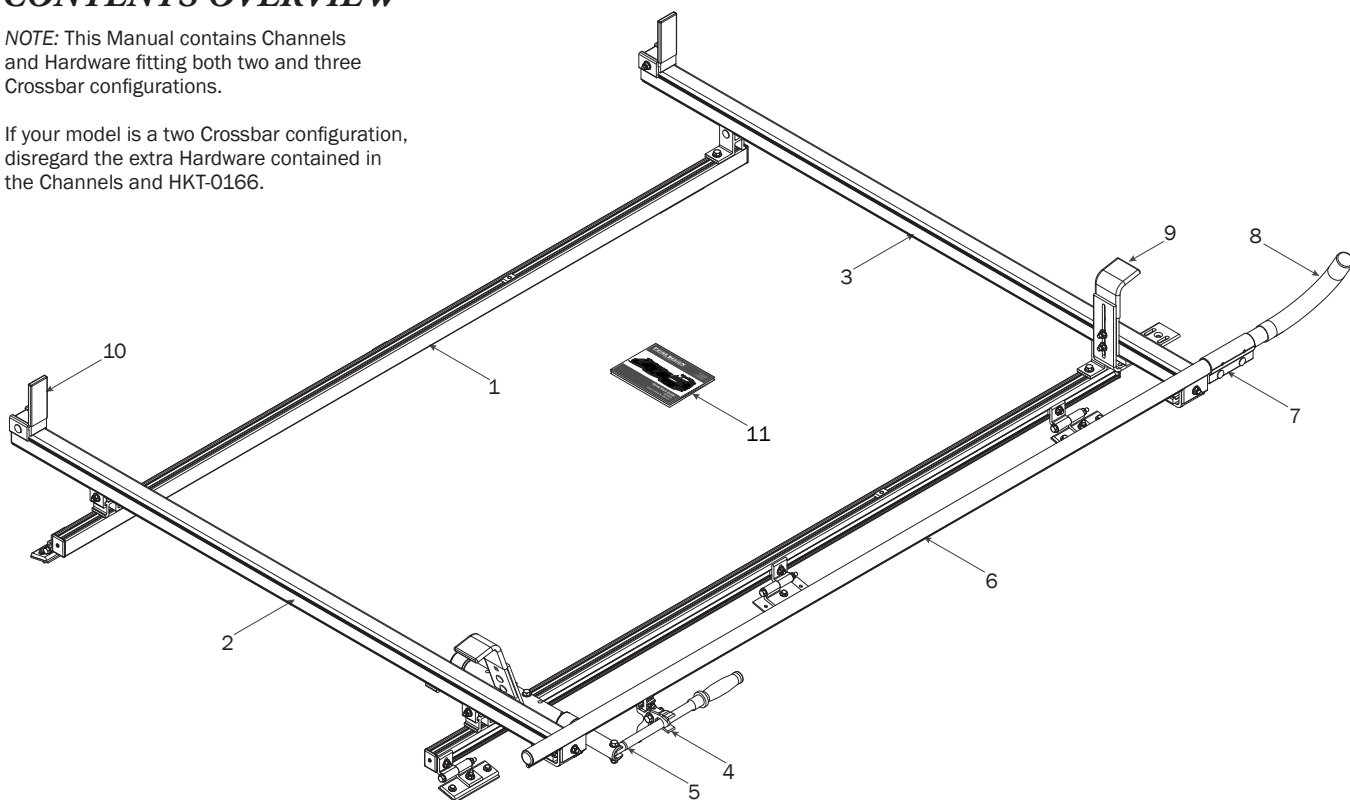

1—FBM-0113 (Qty 1)

Channels with hardware

Stiff Channel 78" (2X)

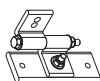

Mounting Foot (4X)



Mounting Mid-Foot (2X)

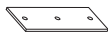

Foam Pad (6X)



Channel Bracket (4X)

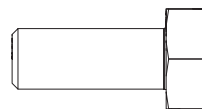

M8 x 20MM (6X)



M6 X 25MM (10X)

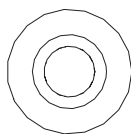

Sealing Washer (10X)

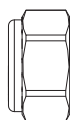

M8 Lock Nut (6X)

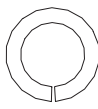

5/16" Lock Washer (6X)

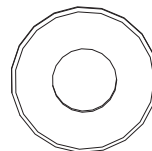

5/16" Flat Washer (22X)



Anti-Seize (1X)

2—Rear Crossbar Assembly (Qty 1)



3—Front Crossbar Assembly (Qty 1)



4—Handle Latch Assembly (Qty 1)

Clamp Down, Right Hand

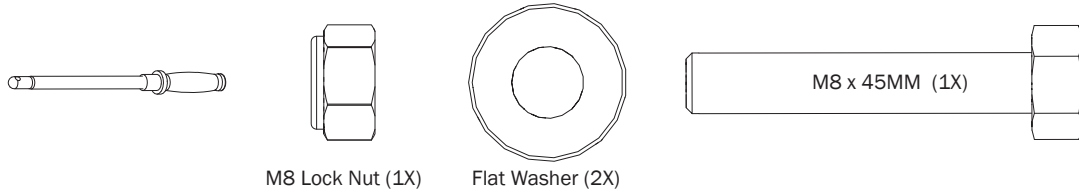
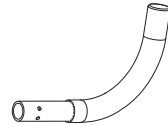

5—Clamp Down Handle Assembly (Qty 1)

6—Clamp Down Tube (Qty 2)
80.00"7—Quick Clamp Tube Splice Assembly (Qty 1)
5.00"8—Removeable Horn with Cap (Qty 1)
15.00"

9—Front Hook Assembly (Qty 1)

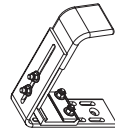
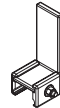
10—Ladder Stop Assembly (Qty 2)
1.75"11—USQSG-Ergorack (Qty 1)
Quick Start Guide, Clamp Down

* Once rack installation is complete, place the Quick Start Guide into the vehicle's glove box for future ladder setup and adjustment.

12—Anti-Seize..... (Qty 1)



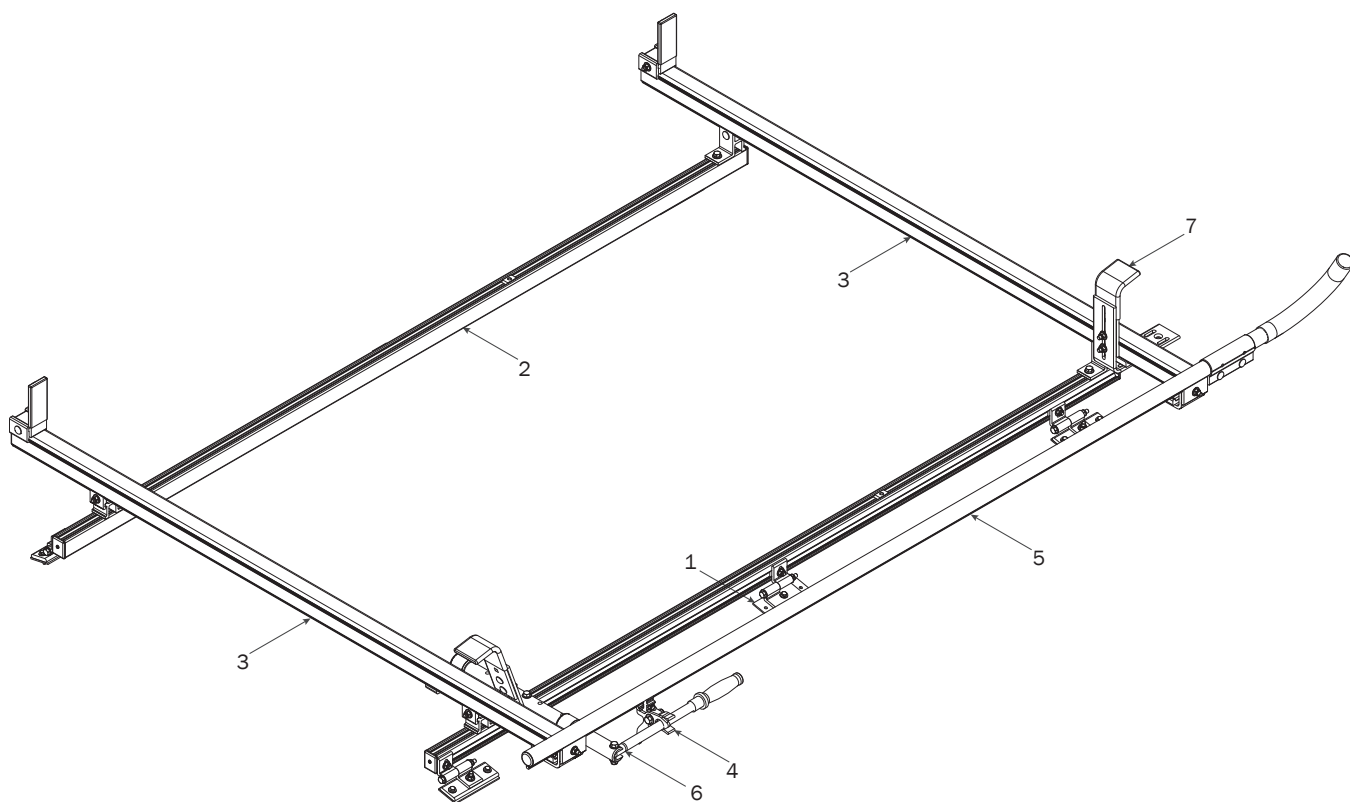

MOUNTING BRACKETS

- 1** Install the Channel Mounting Brackets into the vehicle's roof mounting holes and torque to 60 in-lb.

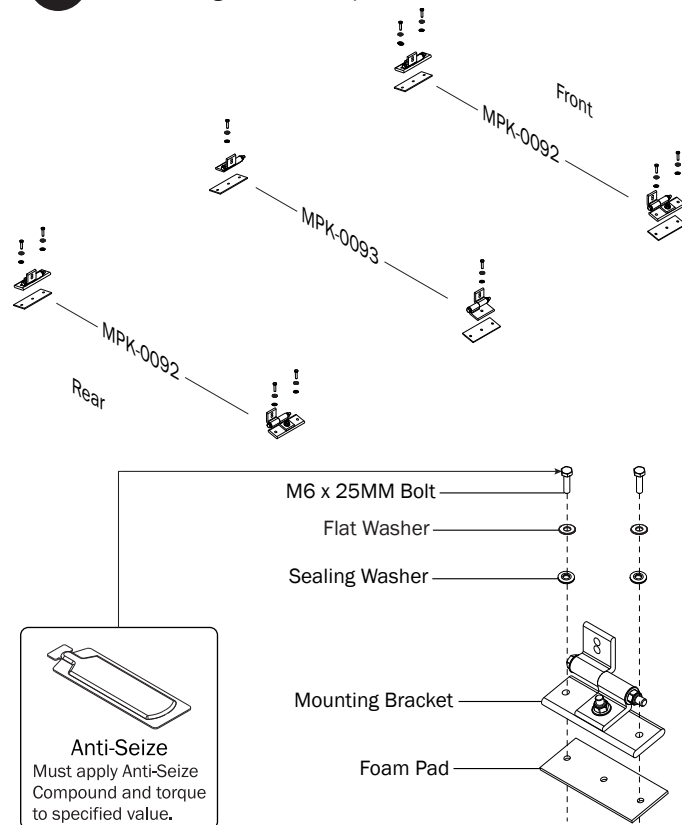

CHANNELS

- 2.1** Apply Anti-Seize to all M8 T Bolt studs, then attach the Channels to the Mounting Brackets using the indicated hardware. Do not tighten until Step 2.2

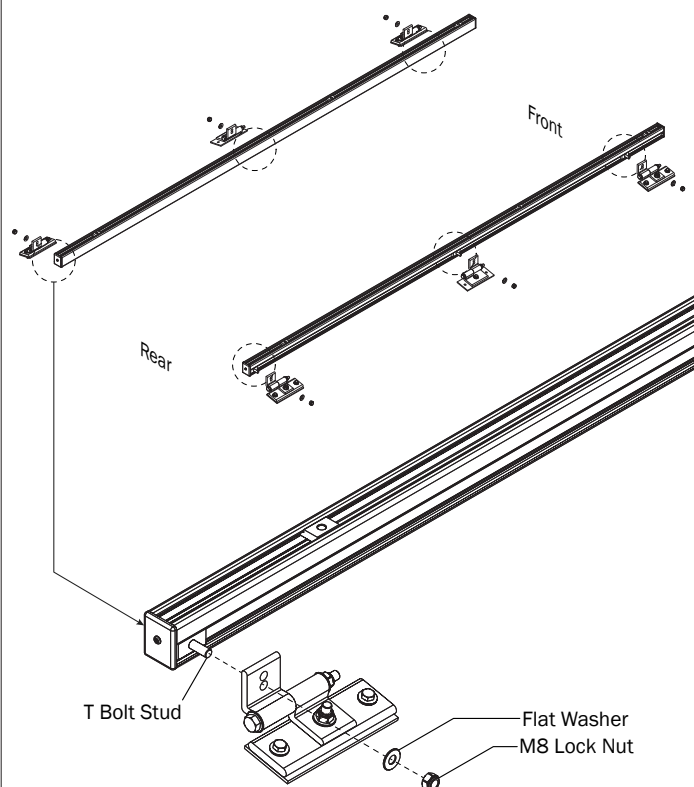

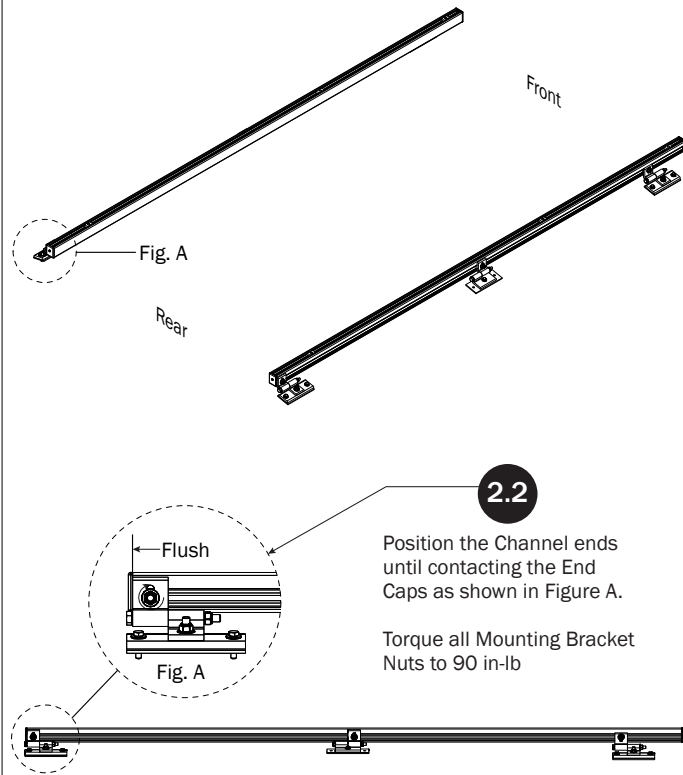

2.3 Attach Mounting Brackets to the Aluminum Strip Nuts located in the Channels

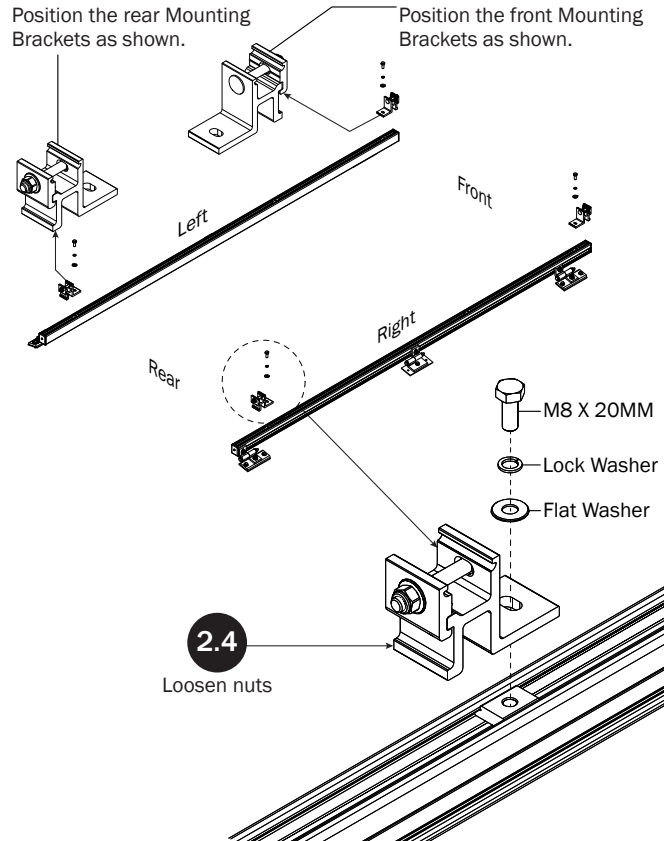

2.6 Position Mounting Brackets to designated dimension shown below, then torque the M8 X 20MM bolt to 90 in-lbs. Proceed to Step 3.1.

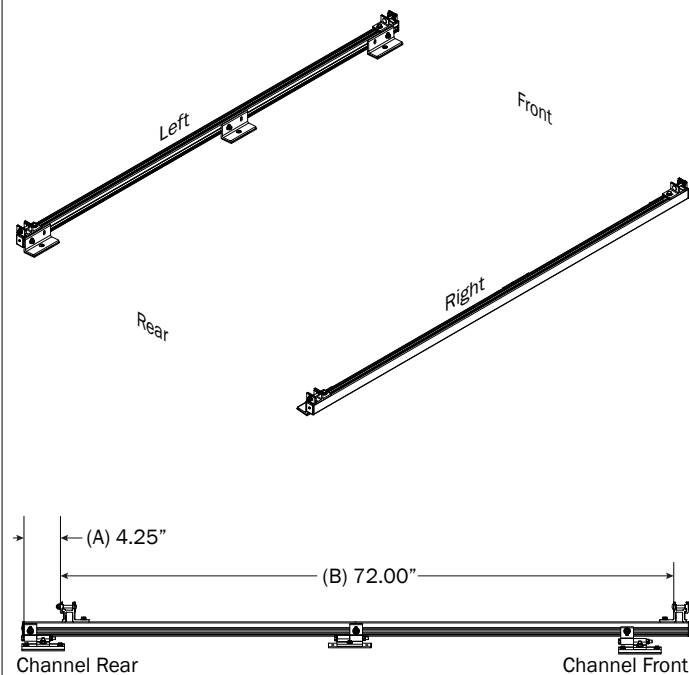

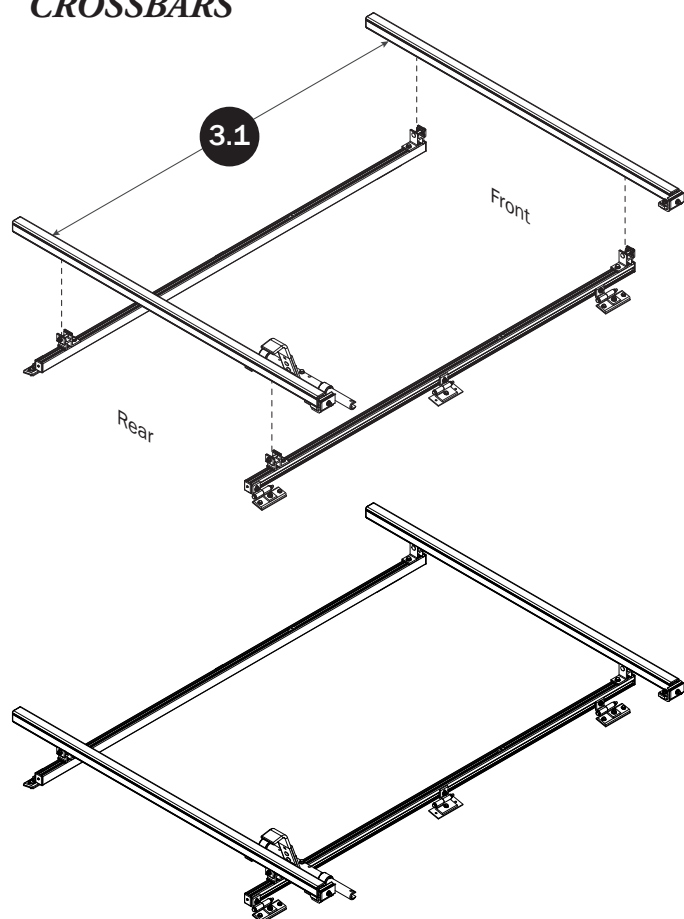
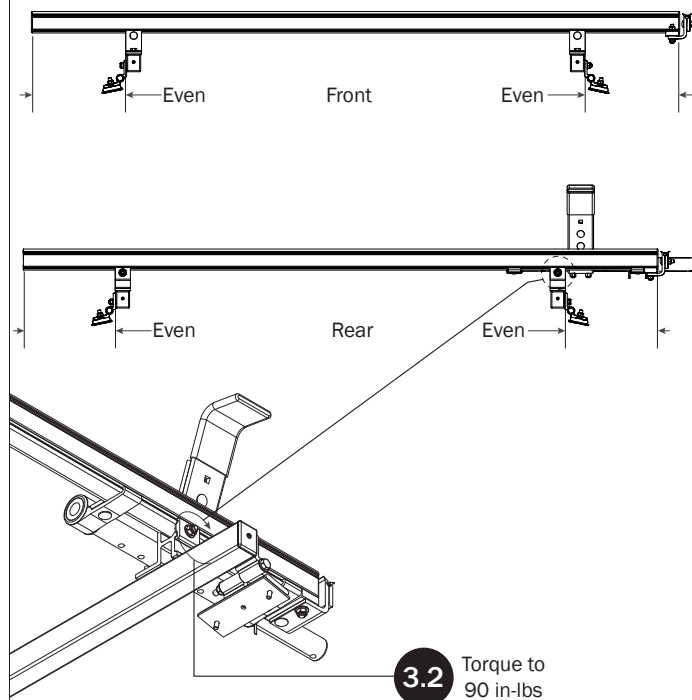
CROSSBARS**CROSSBAR ADJUSTMENT****CLAMP DOWN HANDLE**

NOTE: For instructional clarity, the FBM Mounting System will not be shown for the remainder of this Assembly Manual.

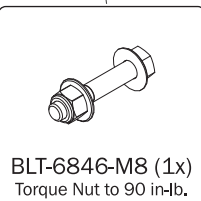
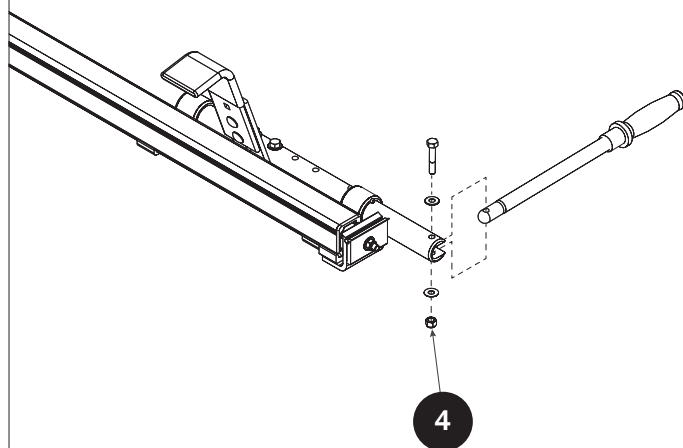
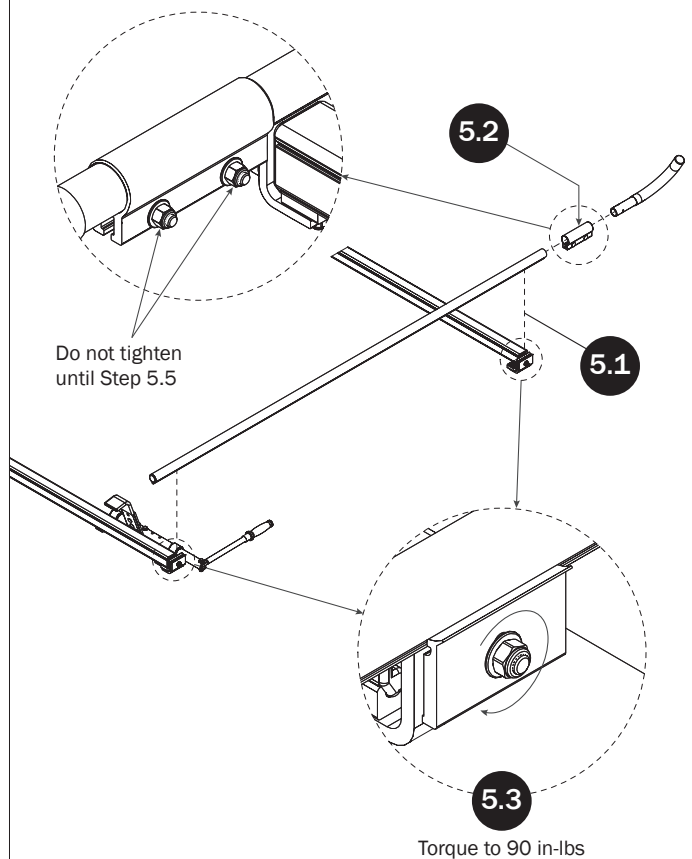
**CLAMP DOWN TUBE**

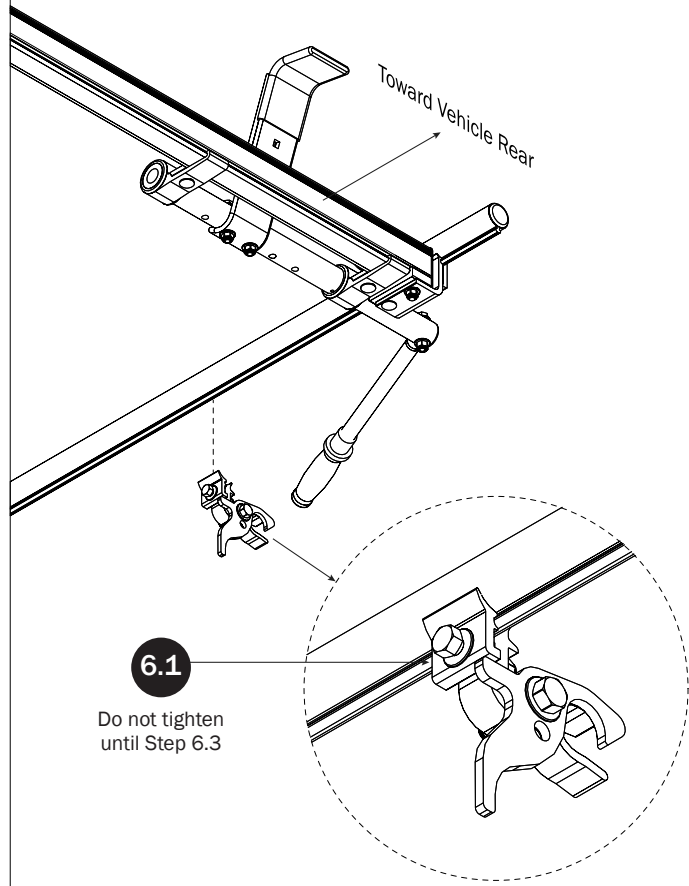
HANDLE LATCH**FRONT LADDER HOOK****SEE QUICK START GUIDE FOR ADJUSTMENTS**

- 7.1 Remove and retain the Front Ladder Hook fastening hardware (not shown in this view) for Steps 7.3 and 7.4

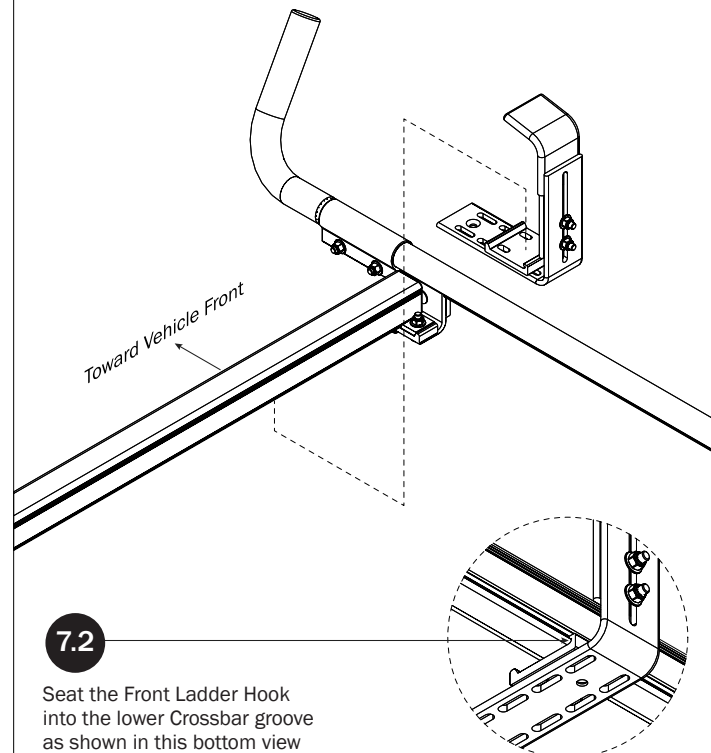

- 3.4 Set Clamp Down Horn to angle shown.

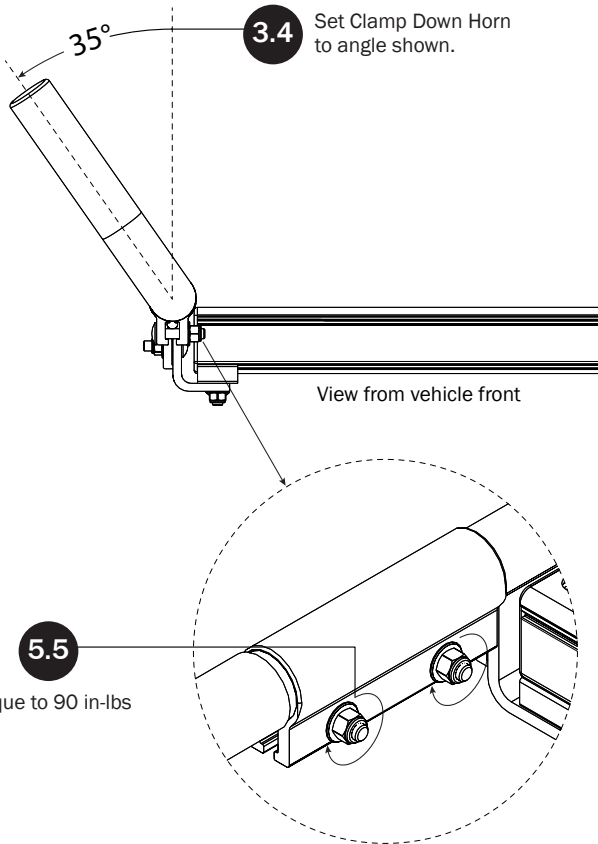

- 6.2 Position the Handle Latch until the Handle Grip is firmly seated.

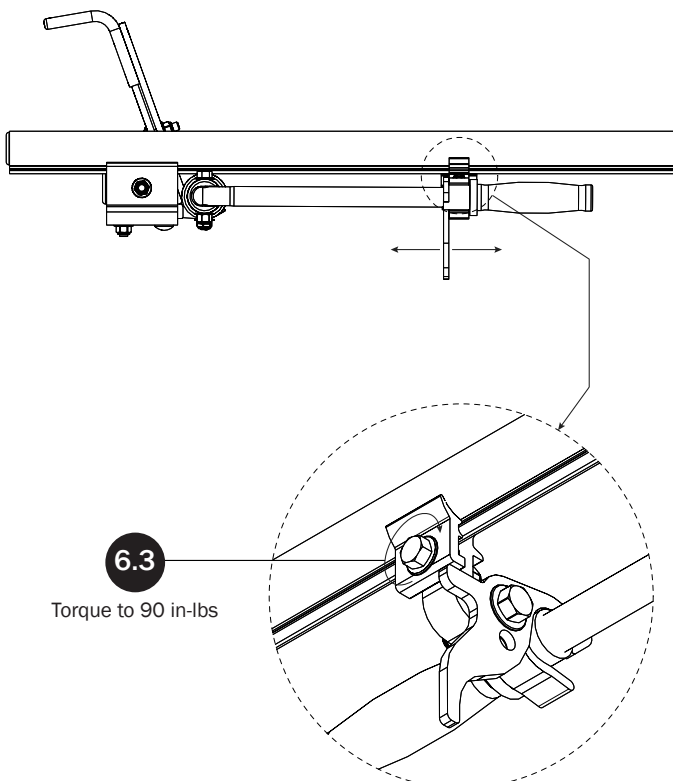

- 7.3** Place the Front Hook Clamp Bracket removed in Step 7.1 into the lower groove of the Crossbar, and slide it on top of the Front Ladder Hook Clamp

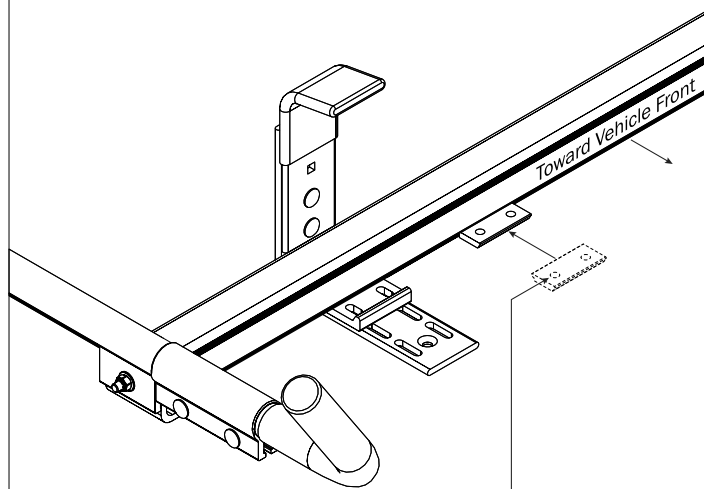

NOTE: The orientation of the bolt hole faces away from the Crossbar

- 7.4** Reassemble the Front Clamp Down Tube Holder using the fastening hardware removed at Step 7.1. Do not tighten until Step 7.6

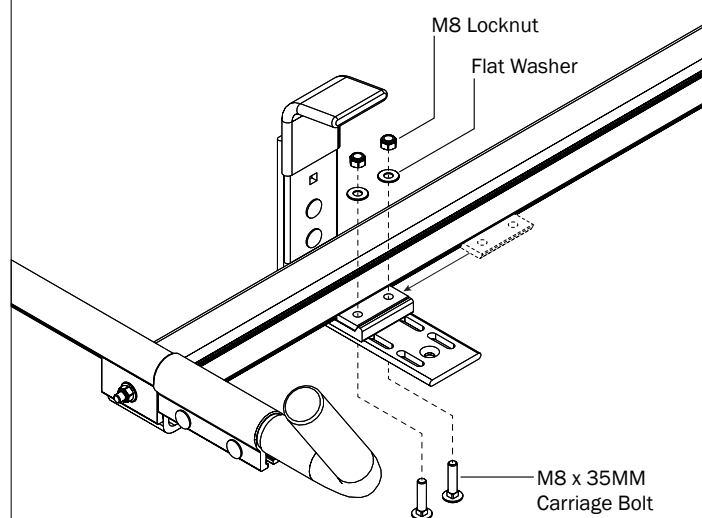

- 7.5** Adjust the Front Hook until it aligns with the Rear Hook. Perfect alignment may not be possible in all instances, and depends upon the location of the Crossbar Mounting Brackets. If such interference should occur, align the Hook as close as possible.

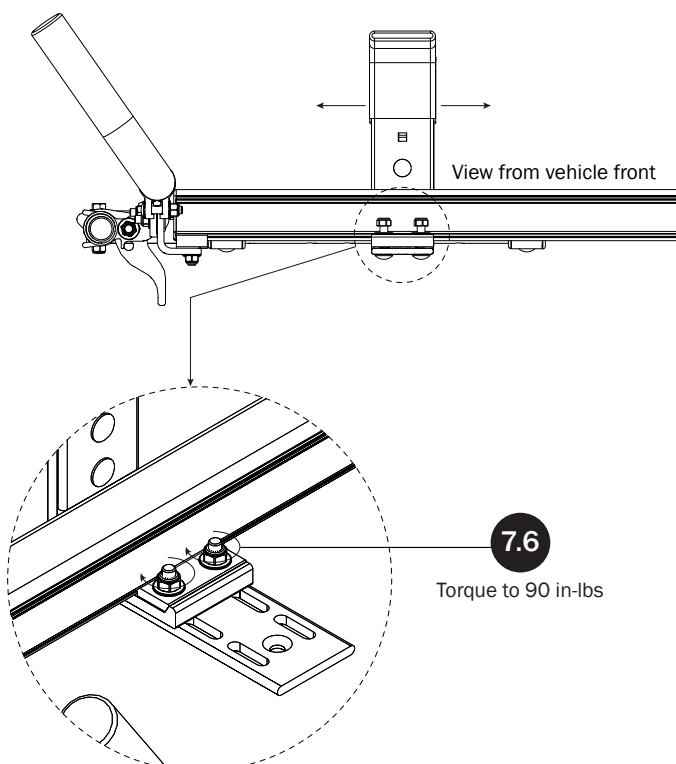

LADDER STOPS

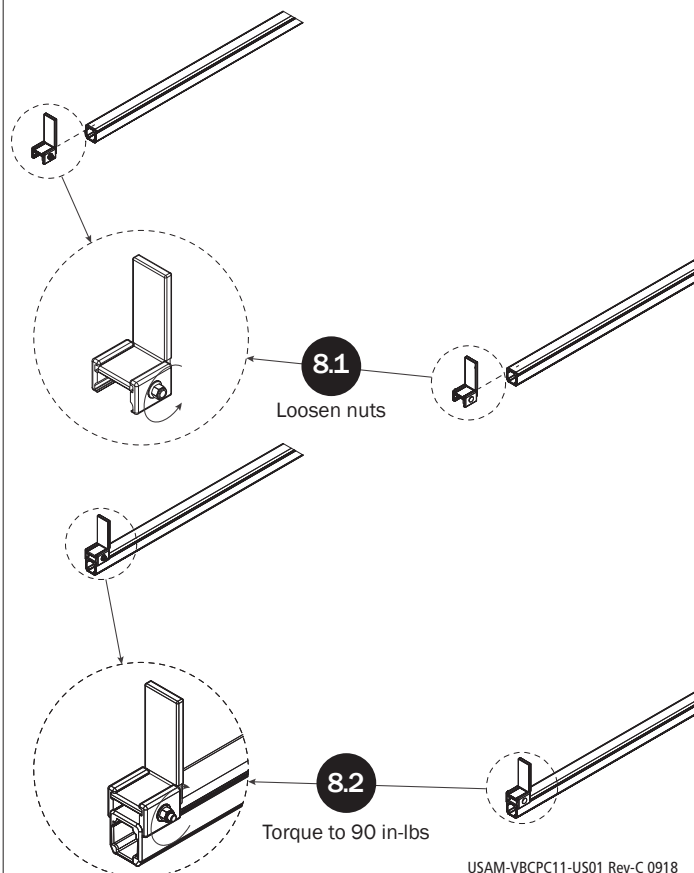

USAM-VBCPC11-US01 Rev-C 0918