

PRIME DESIGN™

A Safe Fleet Brand

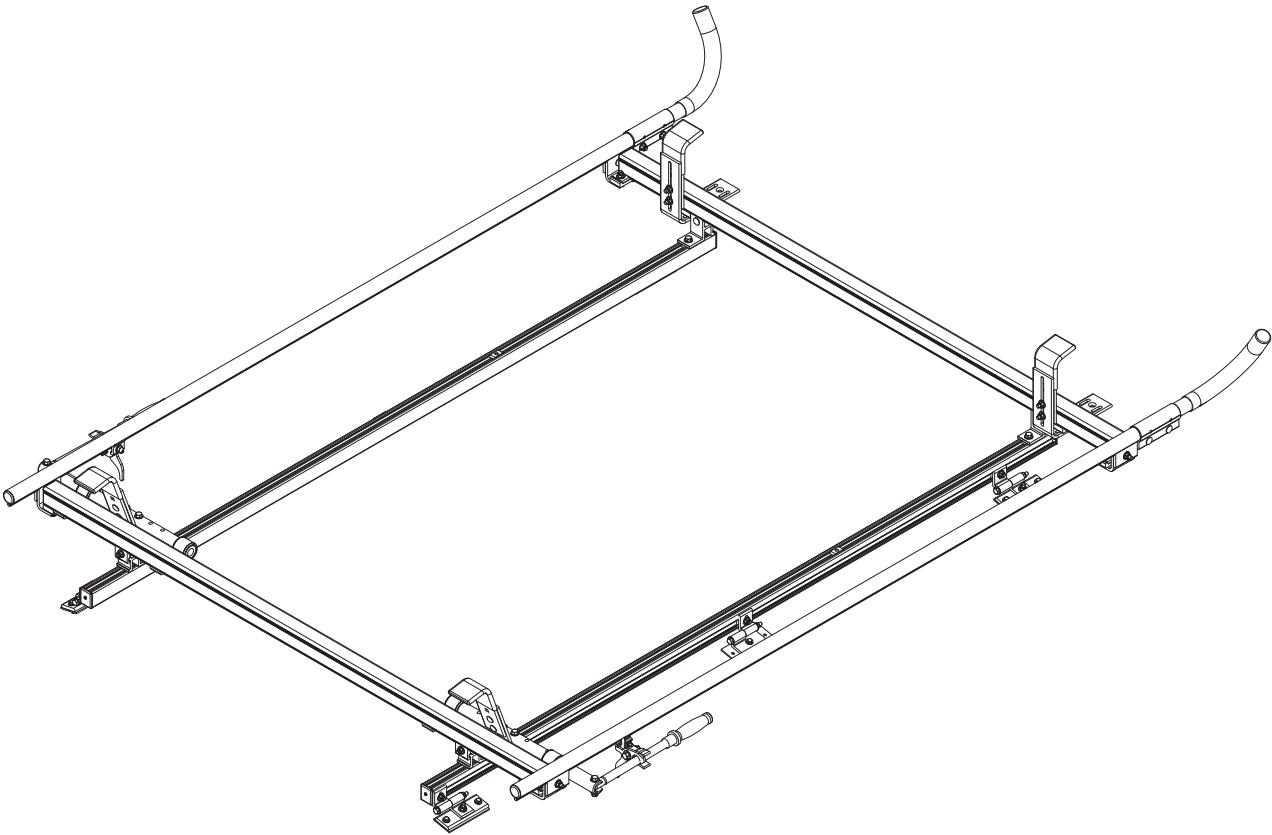

VCC **DCI**

CONTENTS OVERVIEW

NOTE: This Manual contains Channels and Hardware fitting both two and three Crossbar configurations.

If your model is a two Crossbar configuration, disregard the extra Hardware contained in the Channels and HKT-0166.

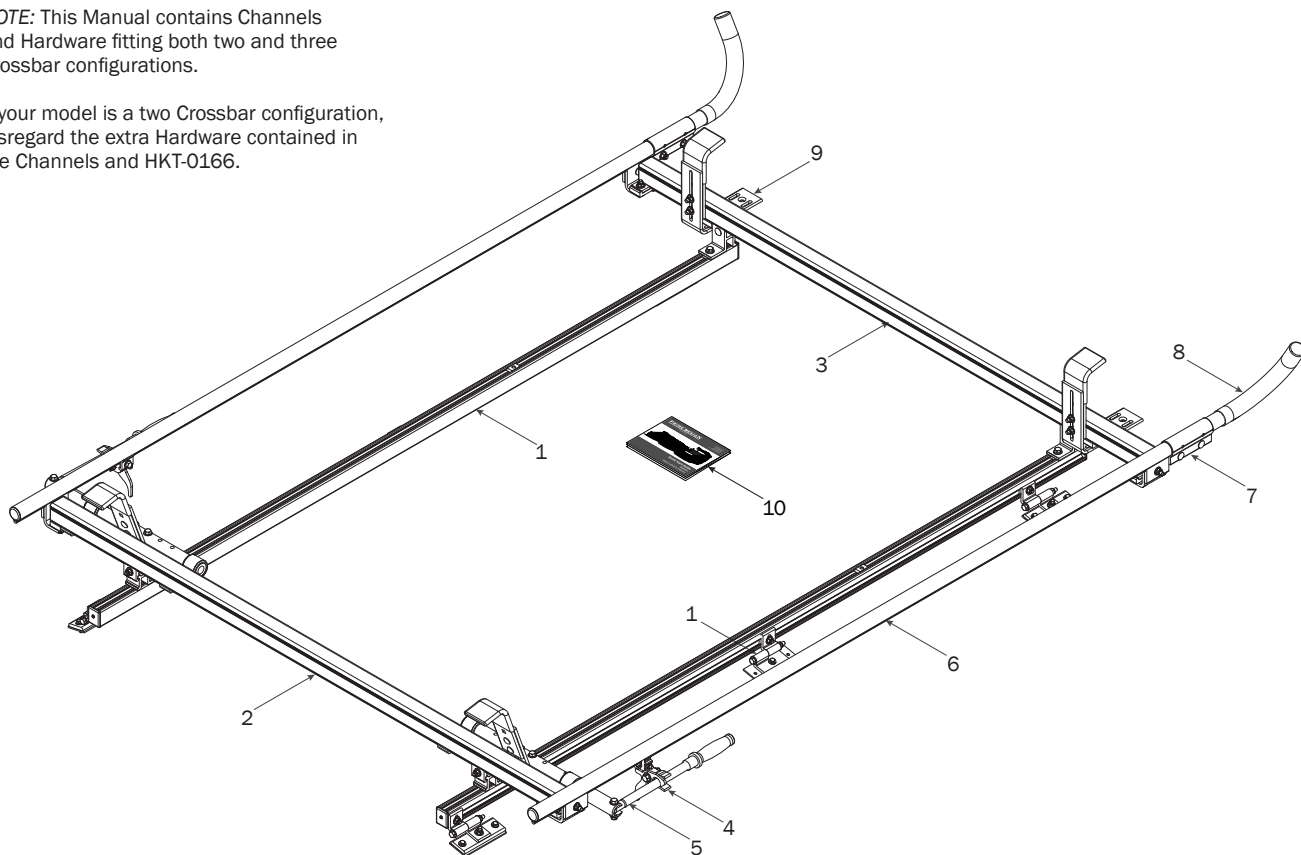

1—FBM-0113 (Qty 1)
Channels with hardware



Stiff Channel 78" (2X)

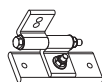

Mounting Foot (4X)



Mounting Mid-Foot (2X)

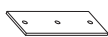

Foam Pad (6X)



Channel Bracket (4X)

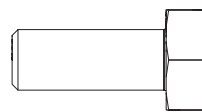

M8 x 20MM (6X)

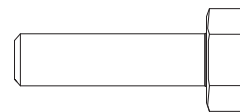

M6 x 25MM (10X)

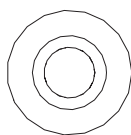

Sealing Washer (10X)

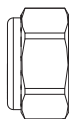

M8 Lock Nut (6X)

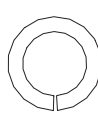

5/16" Lock Washer (6X)

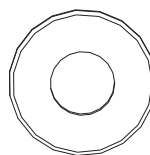

5/16" Flat Washer (22X)



Anti-Seize (1X)

2—Rear Crossbar Assembly (Qty 1)

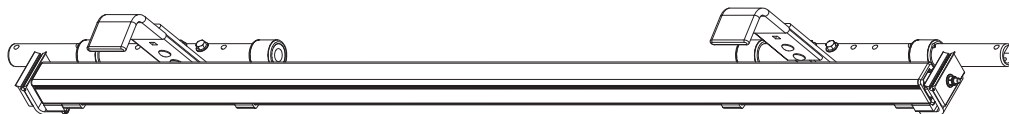

3—Front Crossbar Assembly (Qty 1)

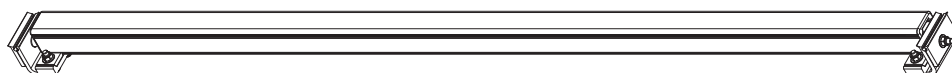

4—Handle Latch Assembly (Qty 2)



5—Clamp Down Handle Assembly (Qty 2)

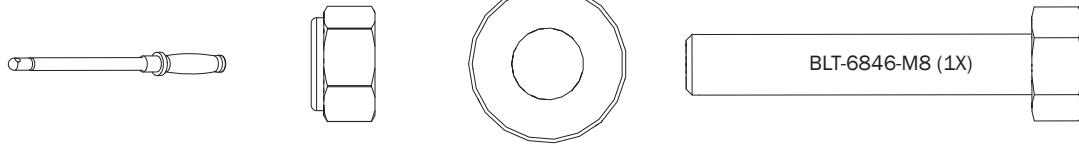

6—Clamp Down Tube (Qty 2)
80.00"

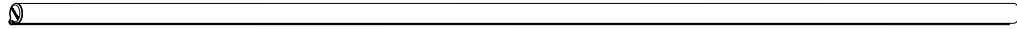

7—Quick Clamp Tube Splice Assembly (Qty 2)
5.00"



8—Removeable Horn with Cap (Qty 2)
15.00"

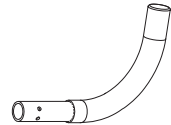

9—HD Front Hook Assembly (Qty 2)

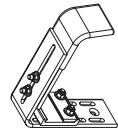

10—USQSG-Ergorack (Qty 1)
Quick Start Guide, Clamp Down

* Once rack installation is complete, place the Quick Start Guide into the vehicle's glove box for future ladder setup and adjustment.



11—Anti-Seize..... (Qty 1)

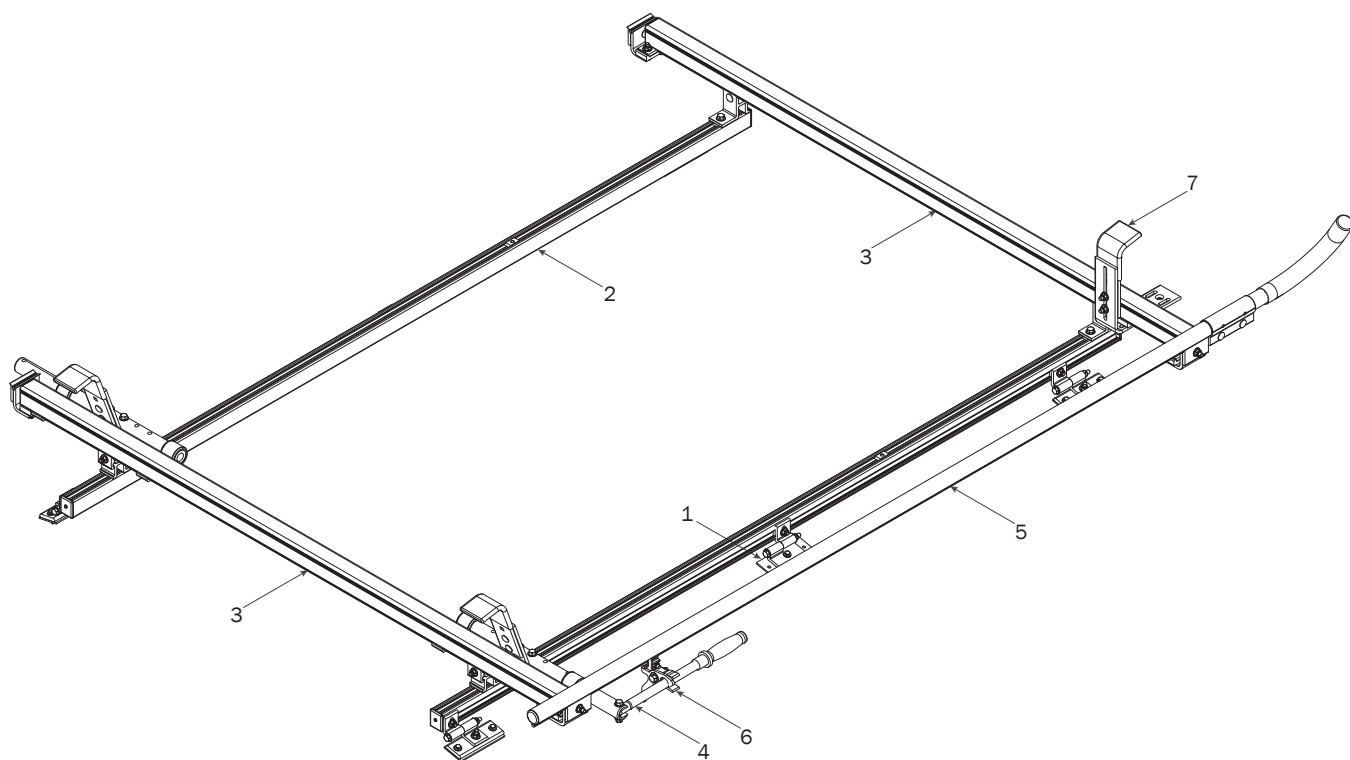

RIGHT SIDE ASSEMBLY SEQUENCE**MOUNTING BRACKETS**

- 1** Install the Channel Mounting Brackets into the vehicle's roof mounting holes and torque to 60 in-lb.

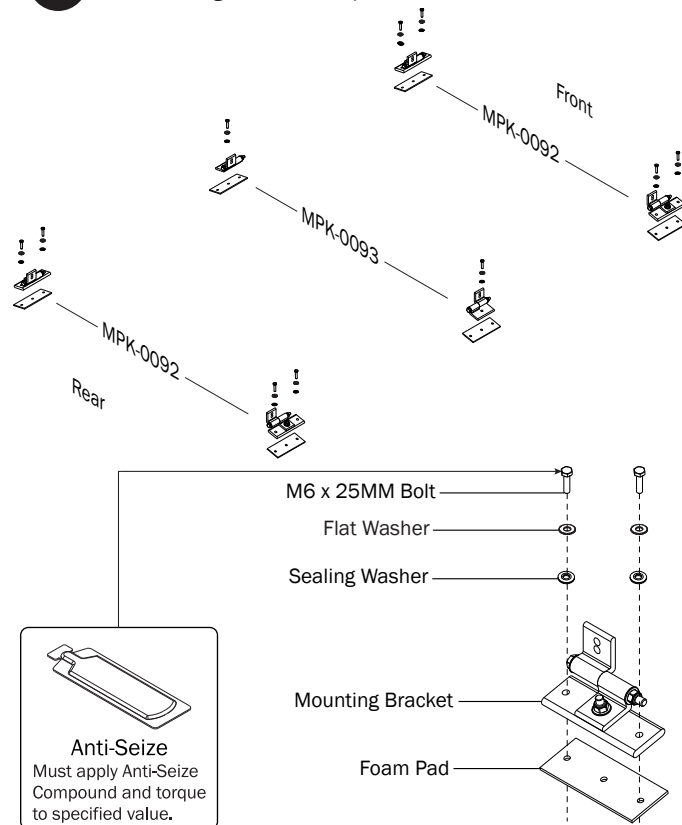
**CHANNELS**

- 2.1** Apply Anti-Seize to all M8 T Bolt studs, then attach the Channels to the Mounting Brackets using the indicated hardware. Do not tighten until Step 2.2

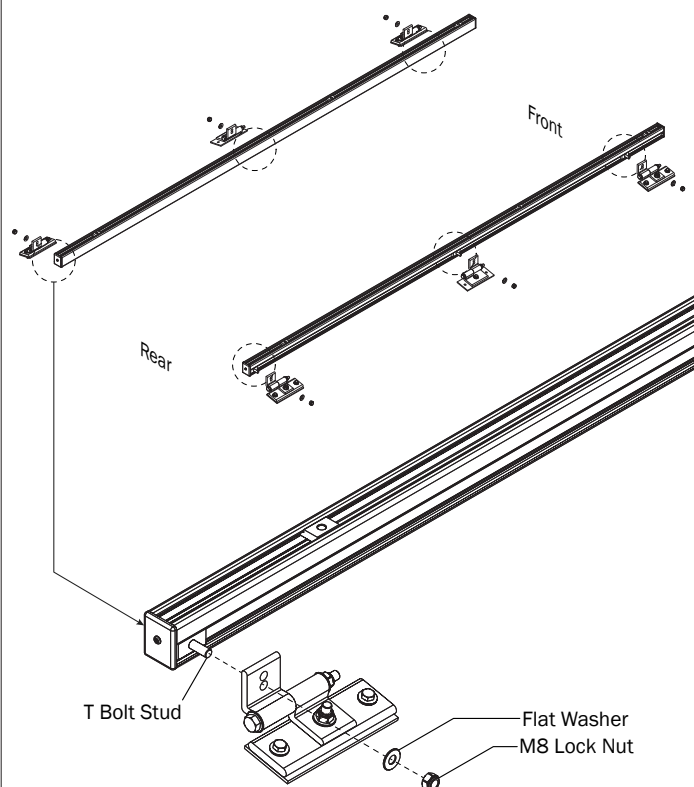

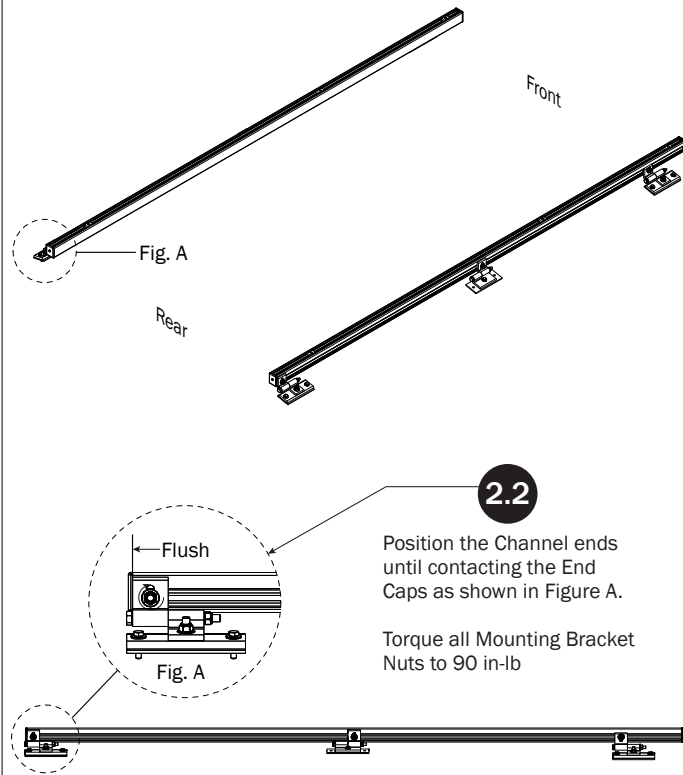

2.3 Attach Mounting Brackets to the Aluminum Strip Nuts located in the Channels

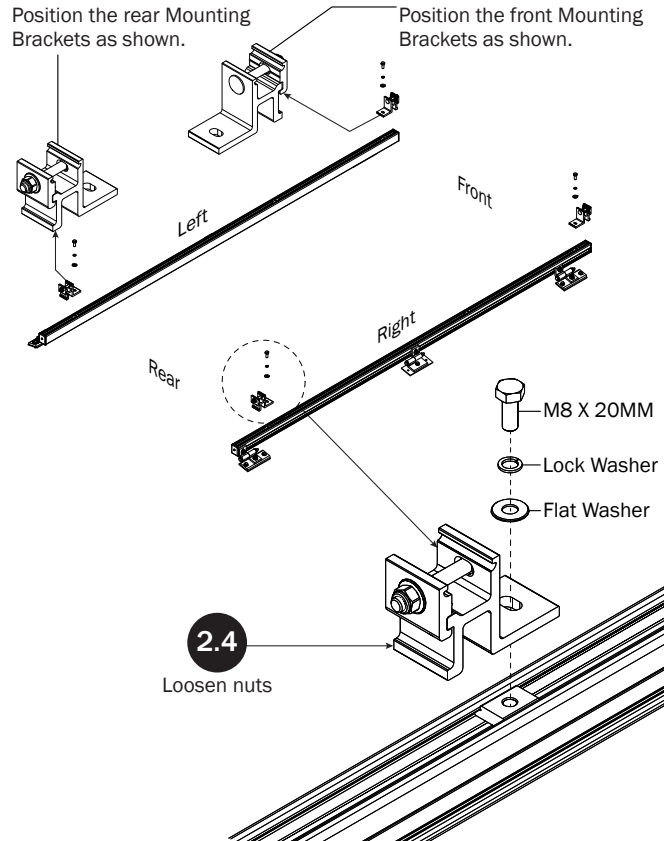

2.6 Position Mounting Brackets to designated dimension shown below, then torque the M8 X 20MM bolt to 90 in-lbs. Proceed to Step 3.1.

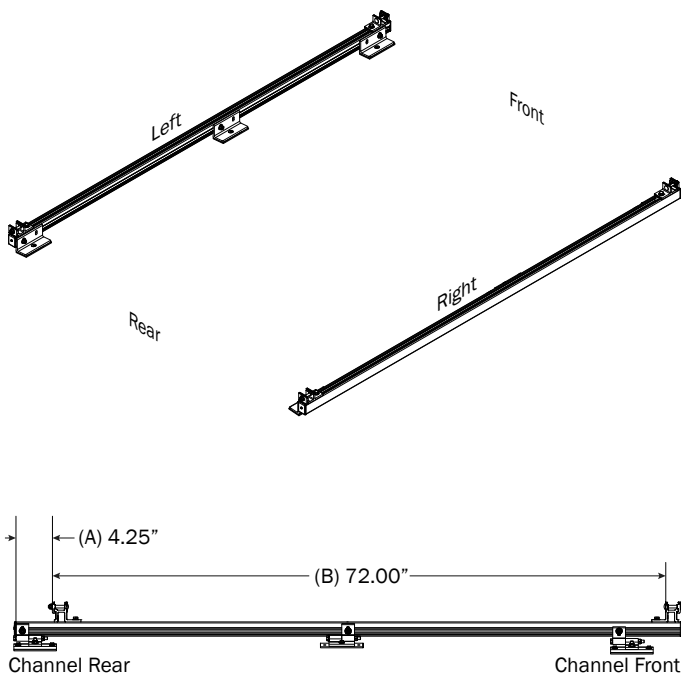

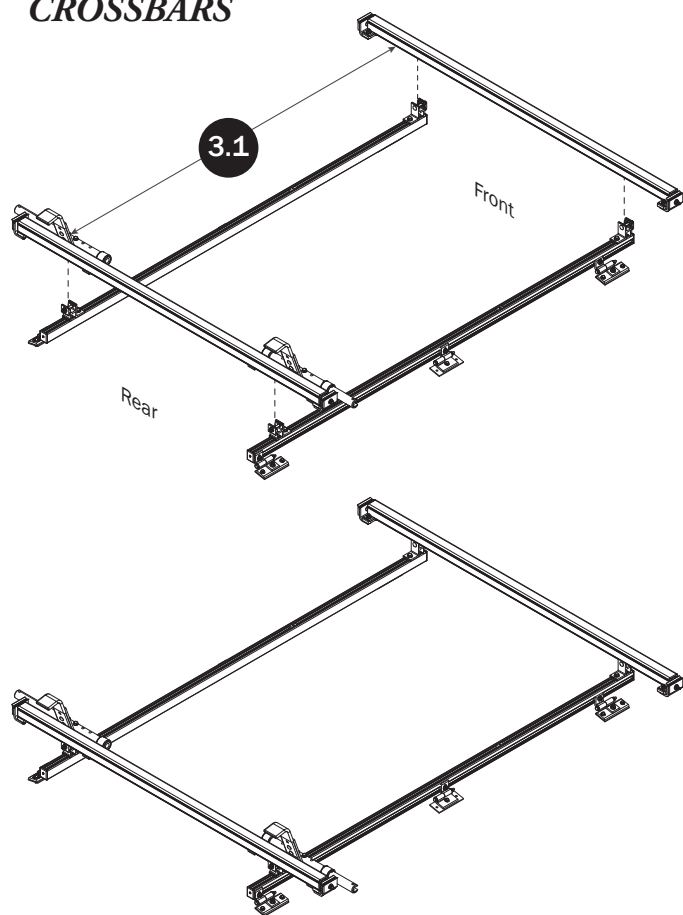
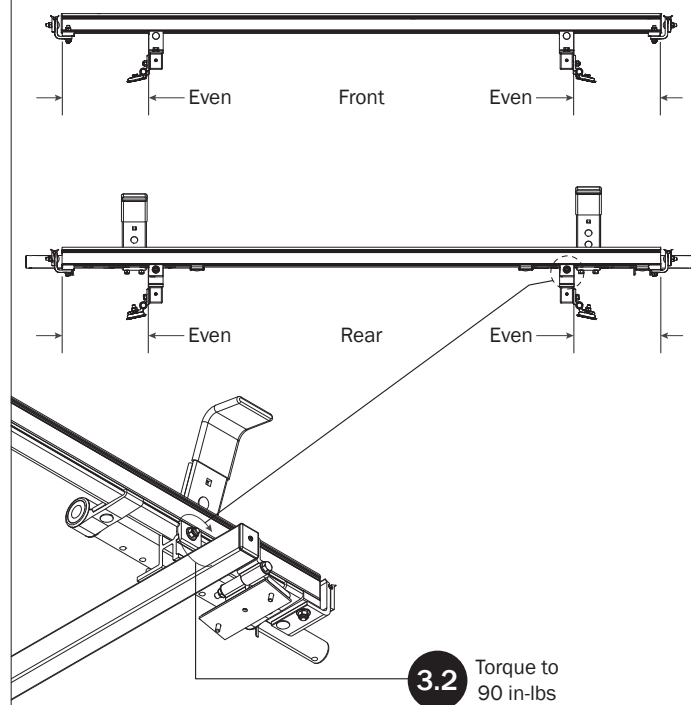
CROSSBARS**CROSSBAR ADJUSTMENT****CLAMP DOWN HANDLE**

NOTE: For instructional clarity, the FBM Mounting System will not be shown for the remainder of this Assembly Manual.

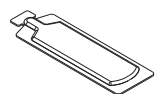
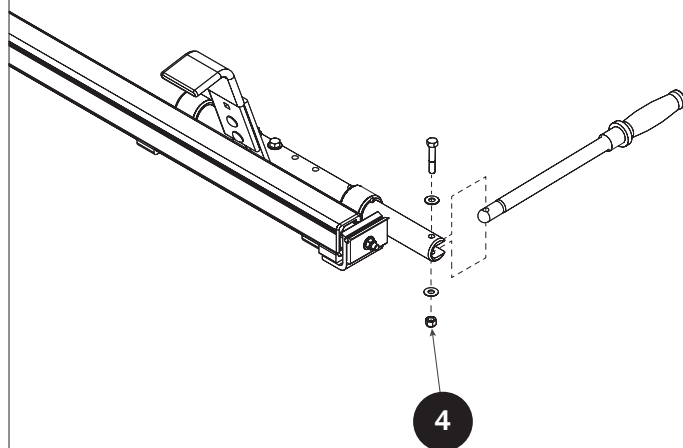

Anti-Seize
Must apply Anti-Seize Compound and torque to specified value.

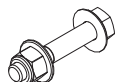

BLT-6846-M8 (1x)
Torque Nut to 90 in-lb.

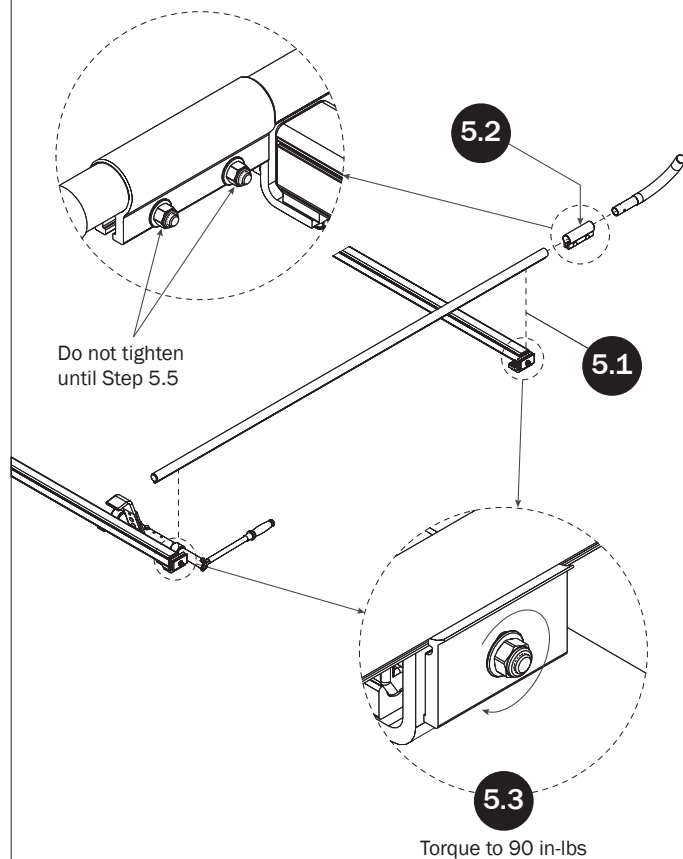
CLAMP DOWN TUBE

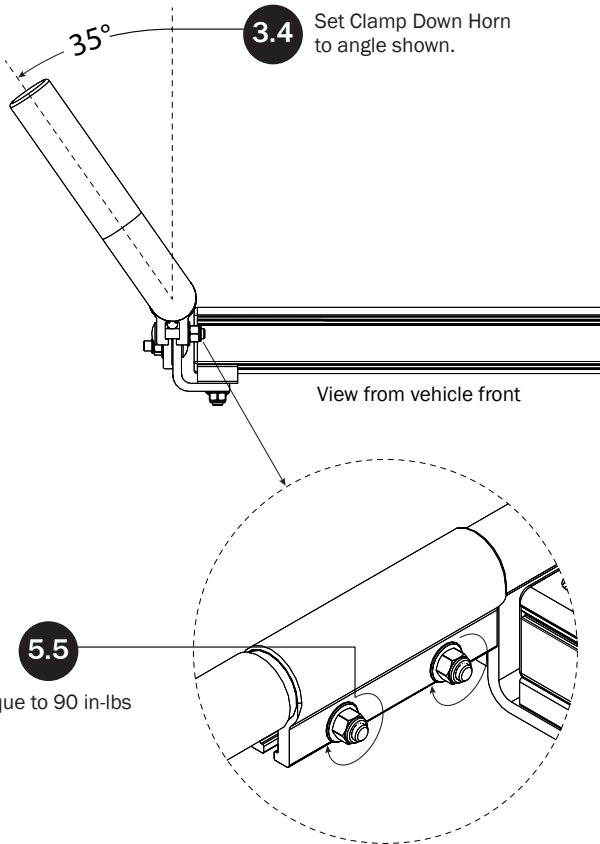
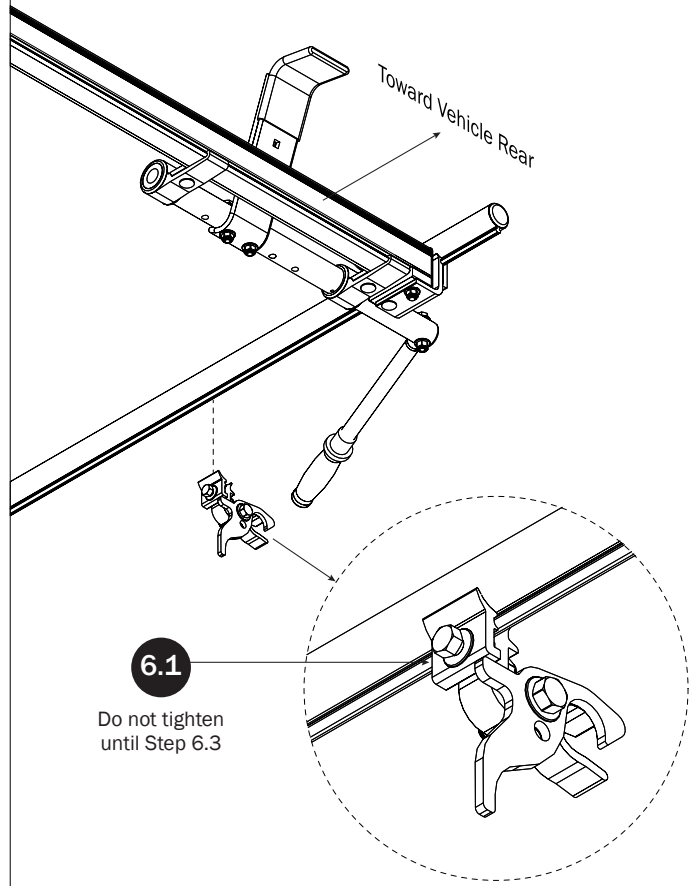
**HANDLE LATCH**

- 6.2** Position the Handle Latch until the Handle Grip is firmly seated.

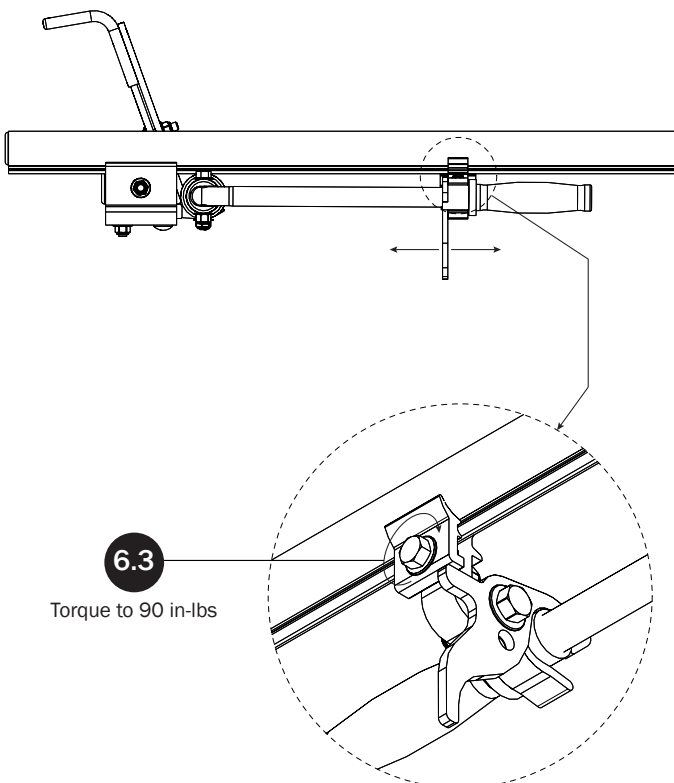
**FRONT LADDER HOOK**
SEE QUICK START GUIDE FOR ADJUSTMENTS

- 7.1** Remove and retain the Front Ladder Hook fastening hardware (not shown in this view) for Steps 7.3 and 7.4

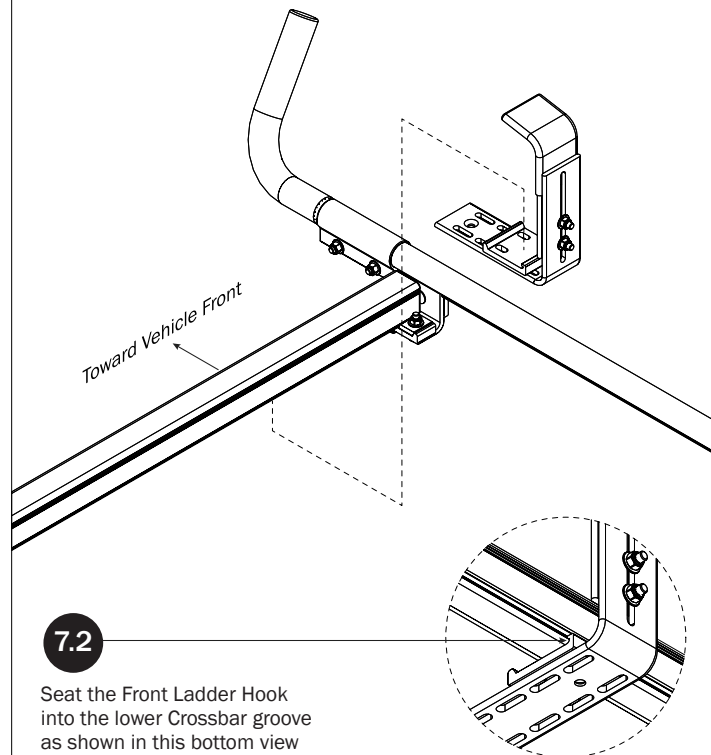

7.3

Place the Front Hook Clamp Bracket removed in Step 7.1 into the lower groove of the Crossbar, and slide it on top of the Front Ladder Hook Clamp

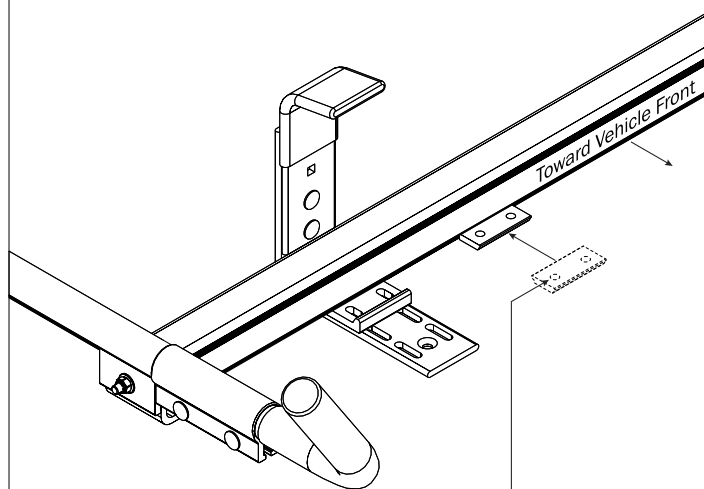

NOTE: The orientation of the bolt hole faces away from the Crossbar

7.4

Reassemble the Front Clamp Down Tube Holder using the fastening hardware removed at Step 7.1. Do not tighten until Step 7.6

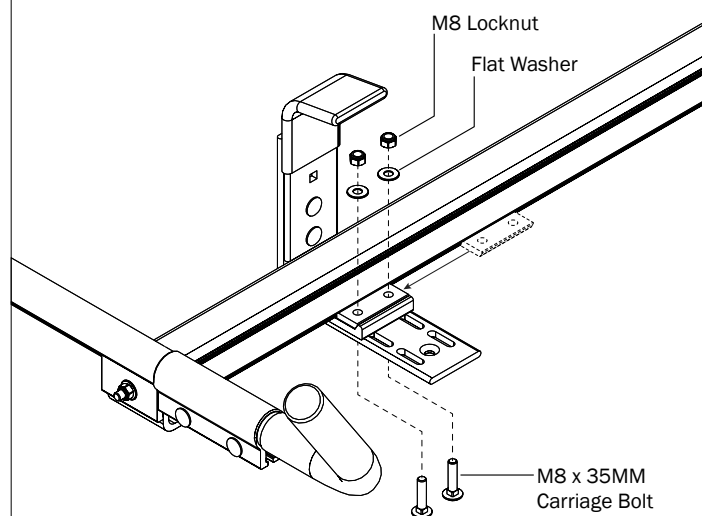

7.5

Adjust the Front Hook until it aligns with the Rear Hook. Perfect alignment may not be possible in all instances, and depends upon the location of the Crossbar Mounting Brackets. If such interference should occur, align the Hook as close as possible.

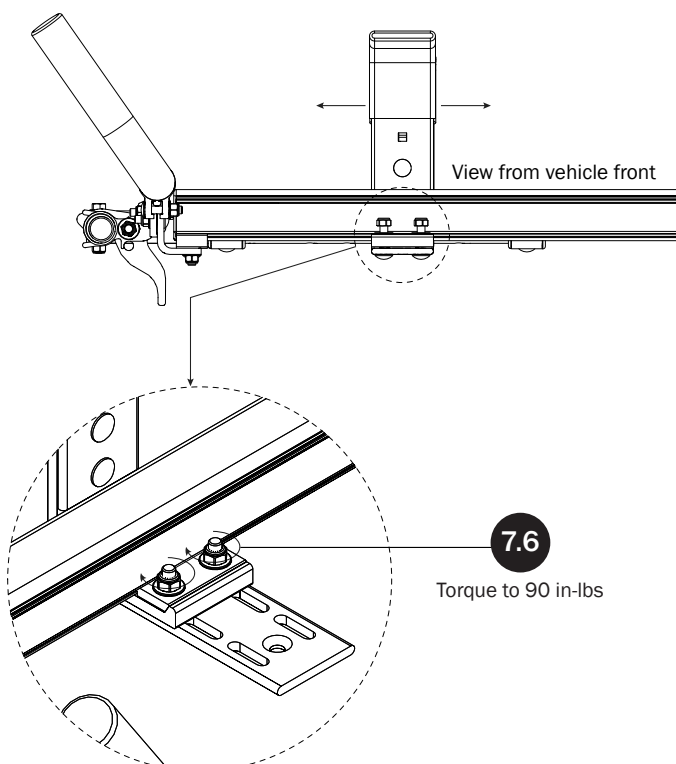

7.6

Torque to 90 in-lbs

LEFT SIDE ASSEMBLY SEQUENCE

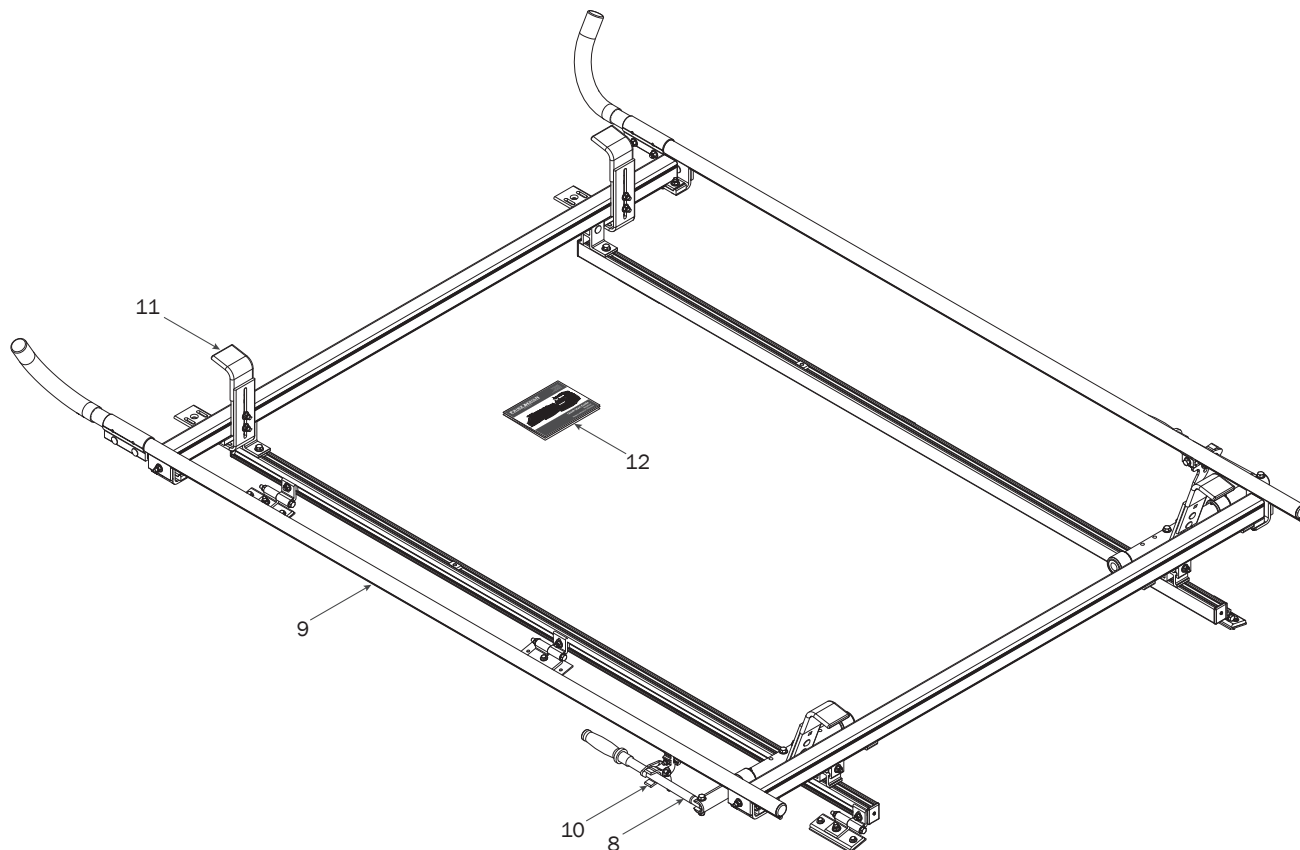

CLAMP DOWN HANDLE

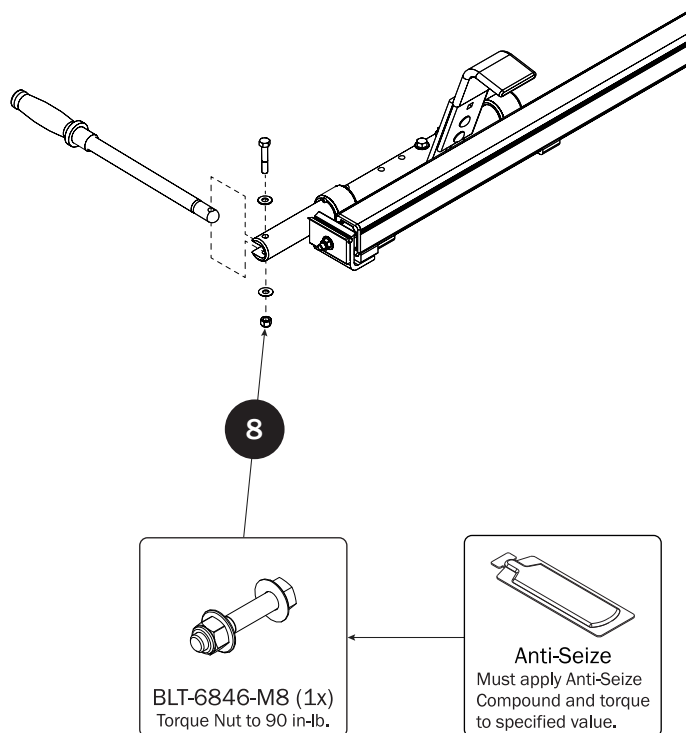

CLAMP DOWN TUBE

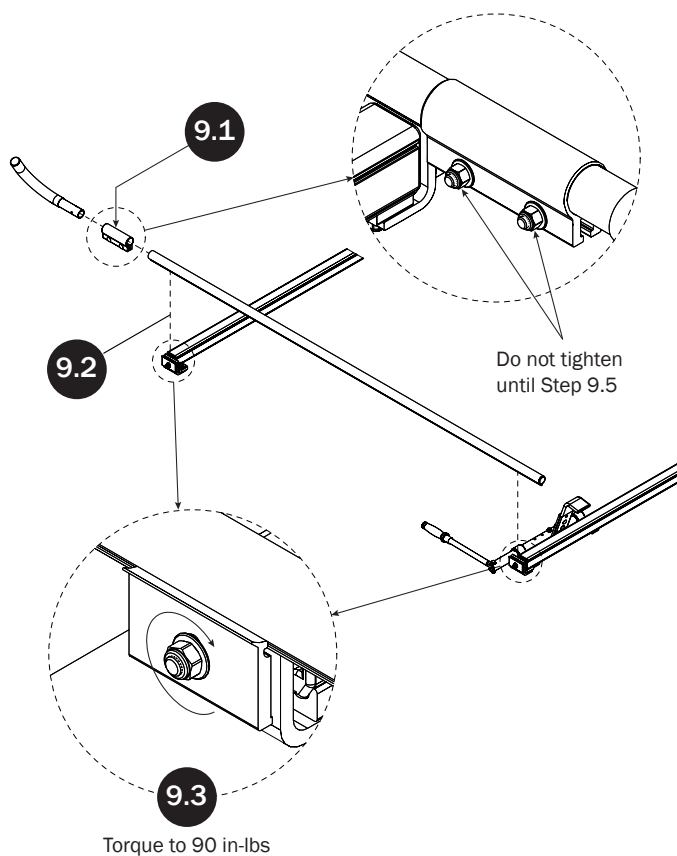

Set Clamp Down Horn
to angle shown.

9.4

35°

View from vehicle front

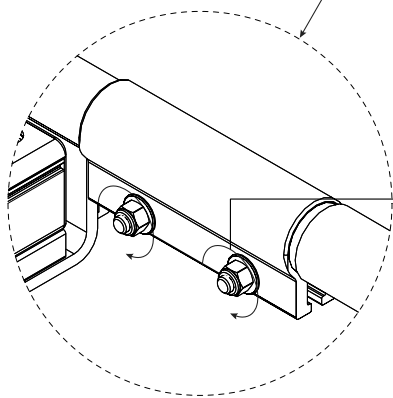

9.5

Torque to 90 in-lbs

HANDLE LATCH

Toward Vehicle Rear

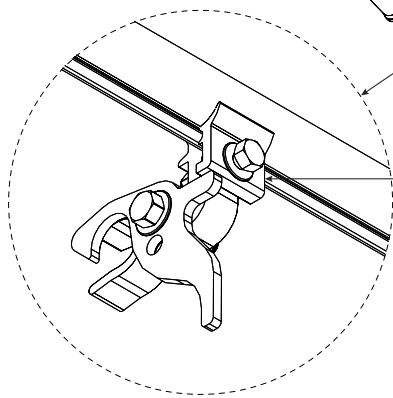

10.1

Do not tighten
until Step 10.3

10.2

Position the Handle Latch until the
Handle Grip is firmly seated.

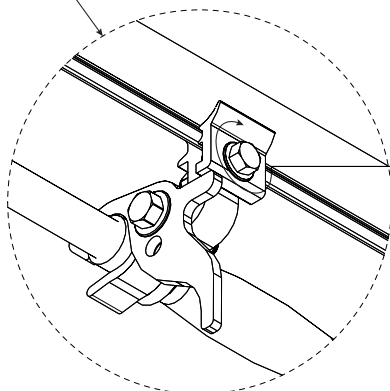
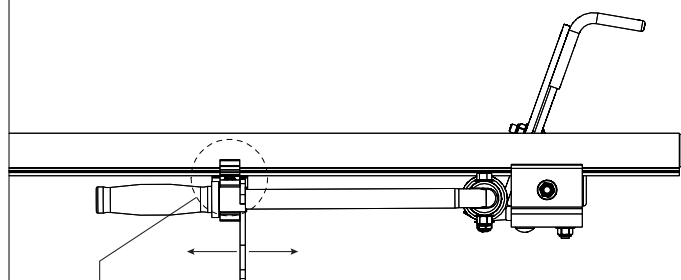

10.3

Torque to 90 in-lbs

FRONT LADDER HOOK SEE QUICK START GUIDE FOR ADJUSTMENTS

11.1

Remove and retain the Front Ladder Hook
fastening hardware (not shown in this view)
for Steps 11.3 and 11.4

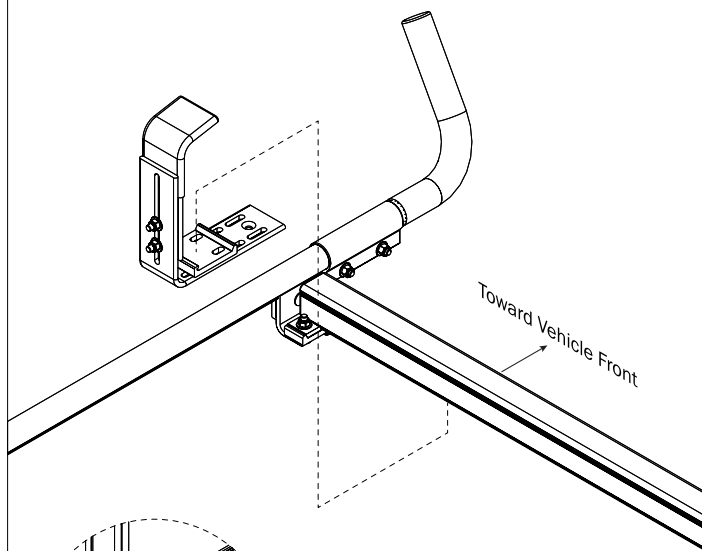

Toward Vehicle Front

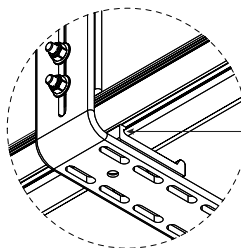

11.2

Seat the Front Ladder Hook
into the lower Crossbar groove
as shown in this bottom view

11.3

Place the Front Hook Clamp Bracket removed in Step 11.1 into the lower groove of the Crossbar, and slide it on top of the Front Ladder Hook Clamp

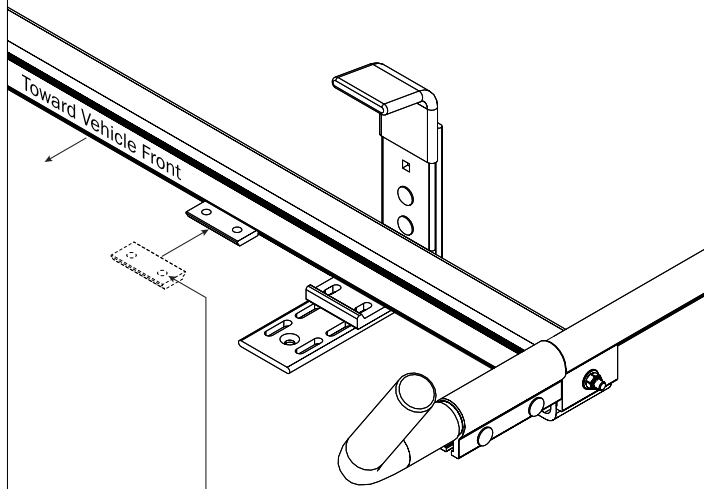

NOTE: The orientation of the bolt hole faces away from the Crossbar

11.4

Reassemble the Front Clamp Down Tube Holder using the fastening hardware removed at Step 11.1. Do not tighten until Step 11.6

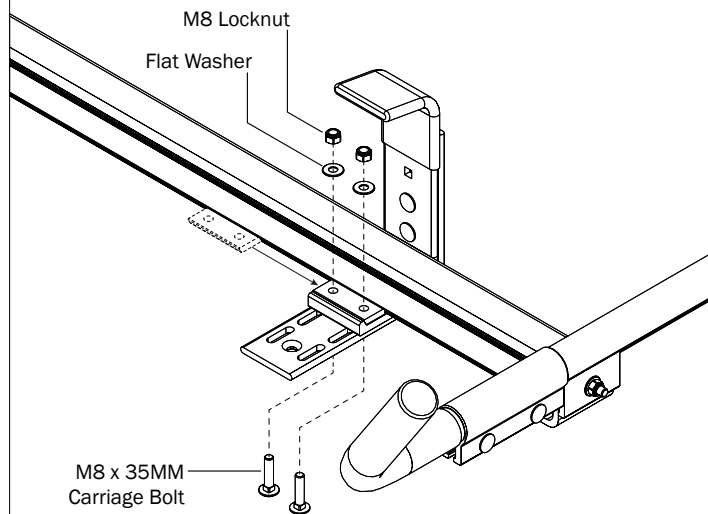

11.5

Adjust the Front Hook until it aligns with the Rear Hook. Perfect alignment may not be possible in all instances, and depends upon the location of the Crossbar Mounting Brackets. If such interference should occur, align the Hook as close as possible.

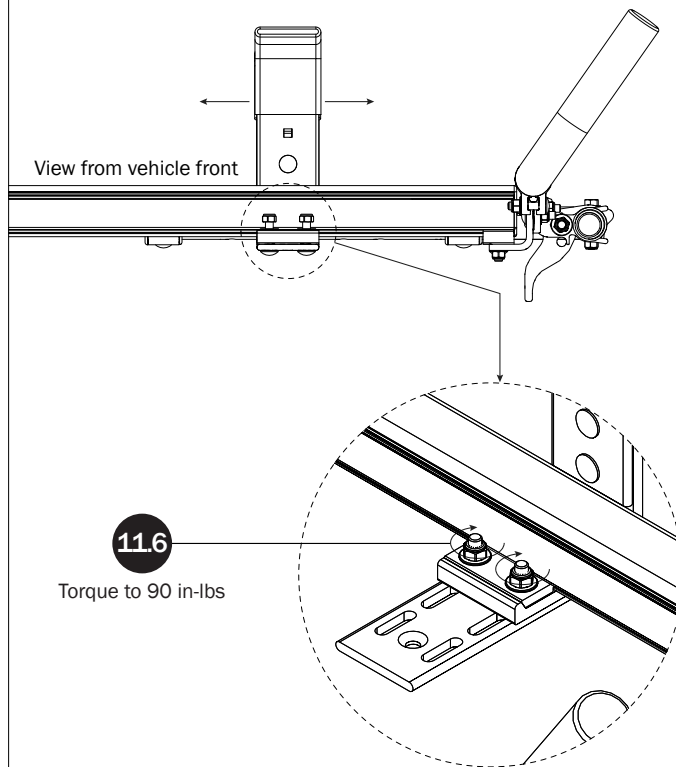

11.6

Torque to 90 in-lbs

QUICK START GUIDE

12

Place the Quick Start Guide into the vehicle's glove box for ladder setup and adjustment.

