

PRIME DESIGN™

A Safe Fleet Brand

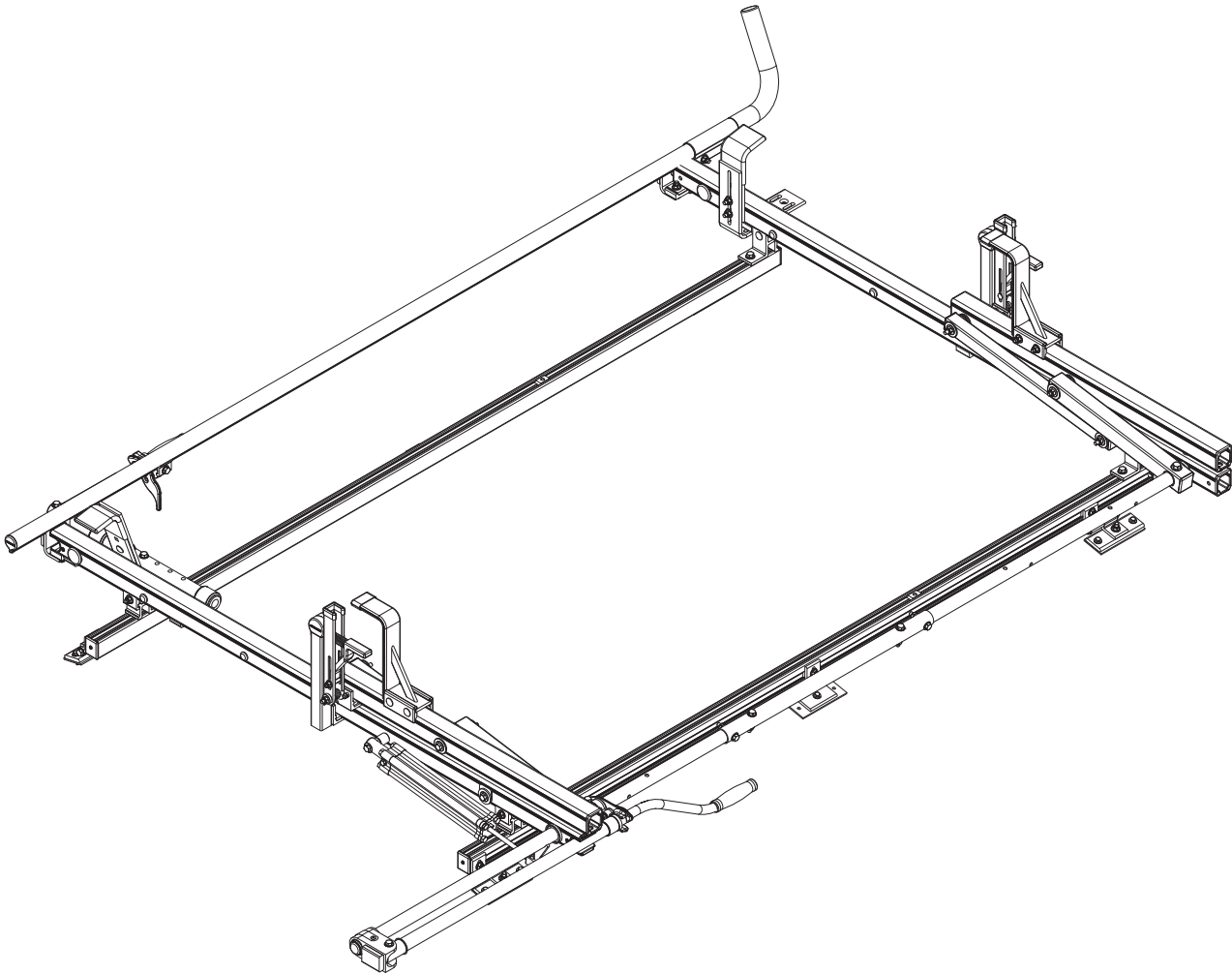

CONTENTS OVERVIEW

NOTE: This Manual contains Channels and Hardware fitting both two and three Crossbar configurations.

If your model is a two Crossbar configuration, disregard the extra Hardware contained in the Channels and HKT-0166.

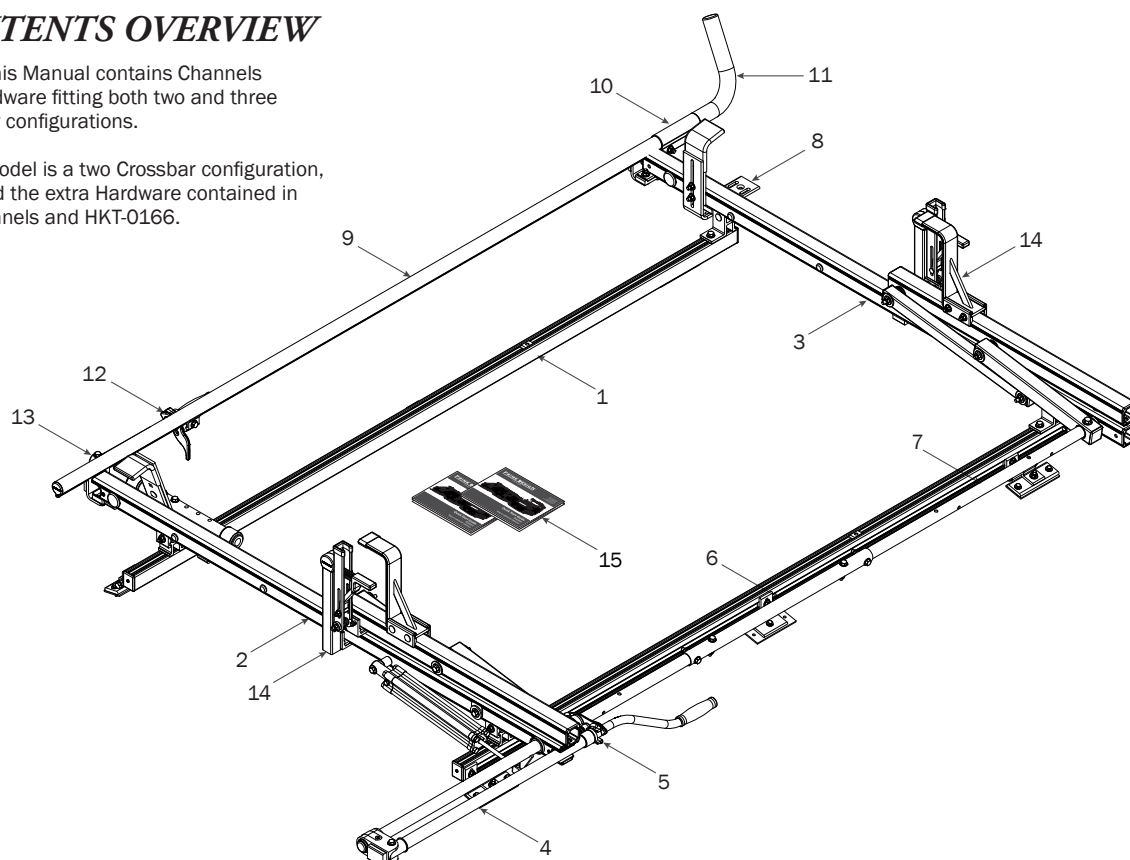

1—FBM-0113..... (Qty 1)

Channels with hardware

Stiff Channel 78" (2X)

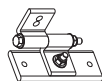

Mounting Foot (4X)



Mounting Mid-Foot (2X)



Foam Pad (6X)



Channel Bracket (4X)

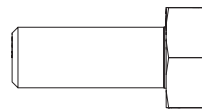

M8 x 20MM (6X)

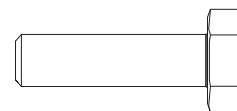

M6 X 25MM (10X)

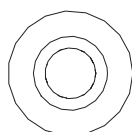

Sealing Washer (10X)

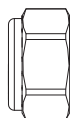

M8 Lock Nut (6X)



5/16" Lock Washer (6X)

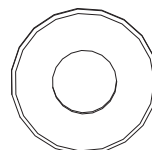

5/16" Flat Washer (22X)



Anti-Seize (1X)

2—Rear Crossbar Assembly..... (Qty 1)

3—Front Crossbar Assembly (Qty 1)

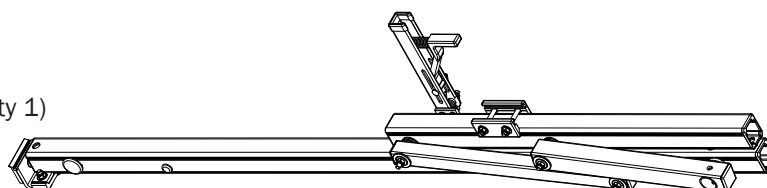

4—Rear Drive Shaft..... (Qty 1)

Right Hand, B4 Version, 46.00"

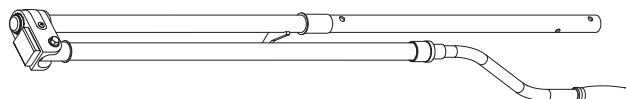

5—Handle Latch Assembly (Qty 1)

6—Connecting Bar..... (Qty 1)

2.00'



7—Front Drive Shaft (Qty 1)
B Version, 35.75"

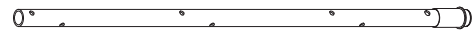

8—HD Front Hook Assembly (Qty 1)

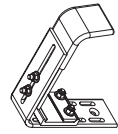

9—Clamp Down Tube (Qty 1)
80.00"

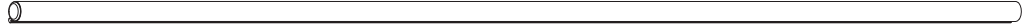

10—Quick Clamp Tube Splice Assembly (Qty 1)
5.00"



11—Removeable Horn with Cap..... (Qty 1)
15.00"

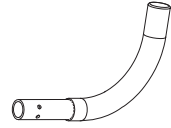

12—Clamp Down Handle Latch Assembly..... (Qty 1)



13—Clamp Down Handle Assembly (Qty 1)

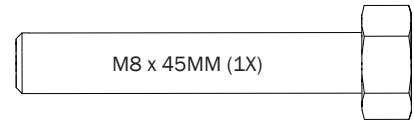
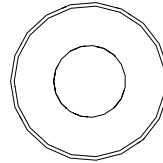
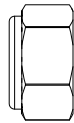
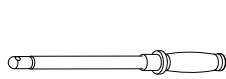

Clamp Down Handle (1X)

M8 Lock Nut (1X)

5/16" Flat Washer (2X)

14—L & Z Post Kit..... (Qty 1)
Adj. Z Post, 7.25", L Post, w/HKT-0160

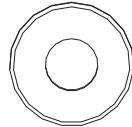

M6 x 20MM (2X)

1/4 Lock Washer (2X)

1/4 Flat Washer (2X)

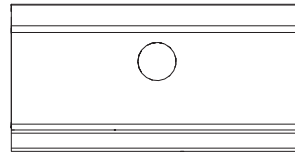

L Post Bracket Clamp (2X)

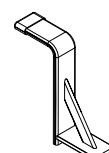

Z Post (2X)

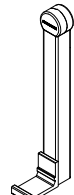

L Post (2X)

15—USQSG-Ergorack (Qty 1)
Quick Start Guide, Clamp Down, Rotation

* Once rack installation is complete, place the Quick Start Guide into the vehicle's glove box for future ladder setup and adjustment.

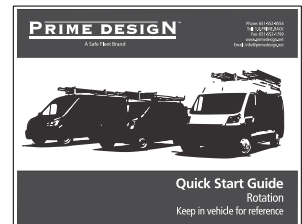
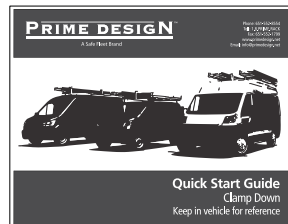

16—HKT-8163 (Not called out in Overview) (Qty 1)



Clevis Pin (1X)

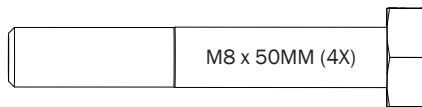

M8 x 50MM (4X)

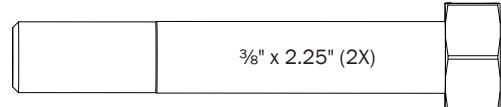

3/8" x 2.25" (2X)



Cotter Pin (1X)



M8 x 25MM (1X)



M8 Lock Nut (5X)

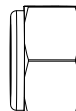

3/8" Lock Nut (2X)

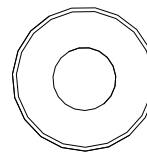

5/16" Flat Washer (10X)

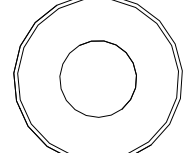

3/8" Flat Washer (4X)

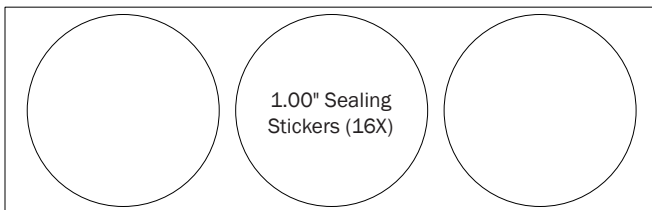

1.00" Sealing
Stickers (16X)



Anti-Seize (1X)

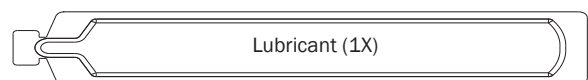

Lubricant (1X)

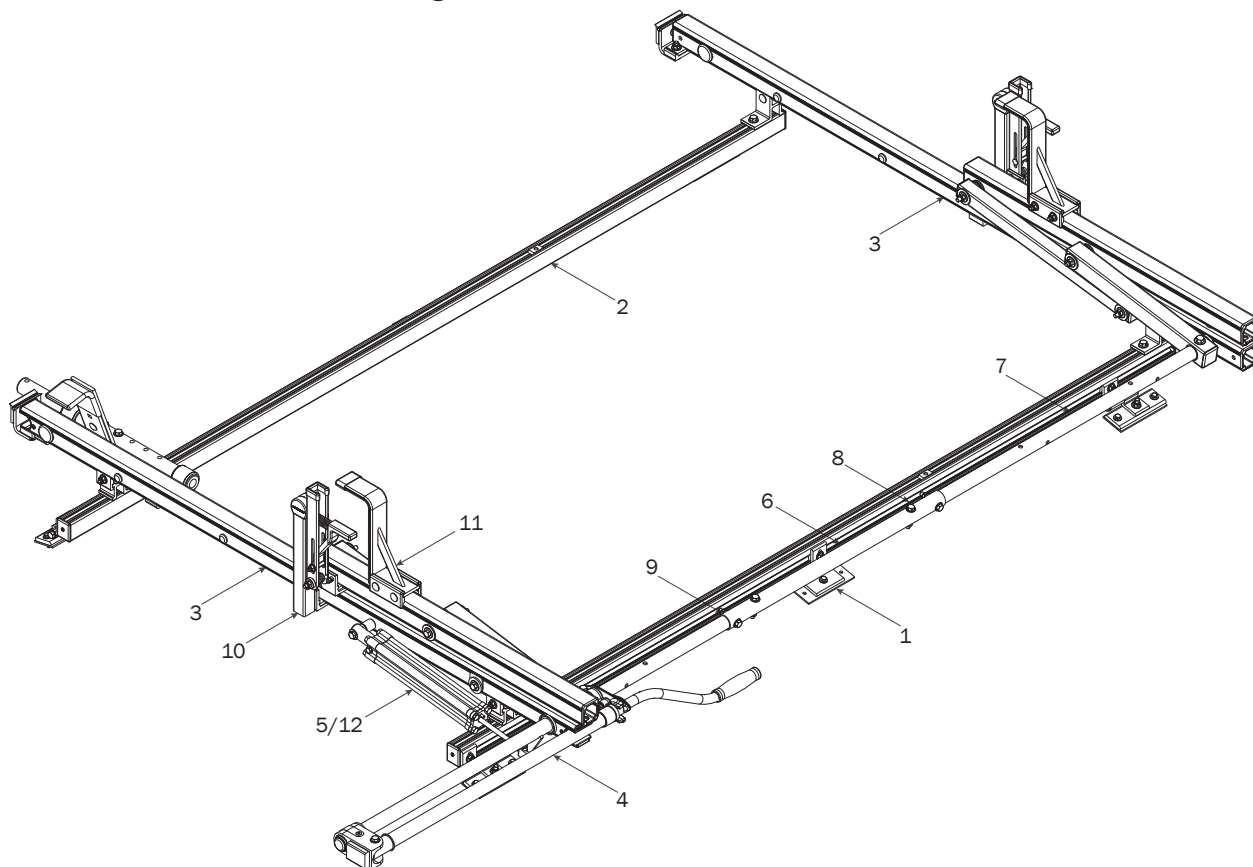
RIGHT SIDE ASSEMBLY SEQUENCE**MOUNTING BRACKETS**

- 1** Install the Channel Mounting Brackets into the vehicle's roof mounting holes and torque to 60 in.-lb.

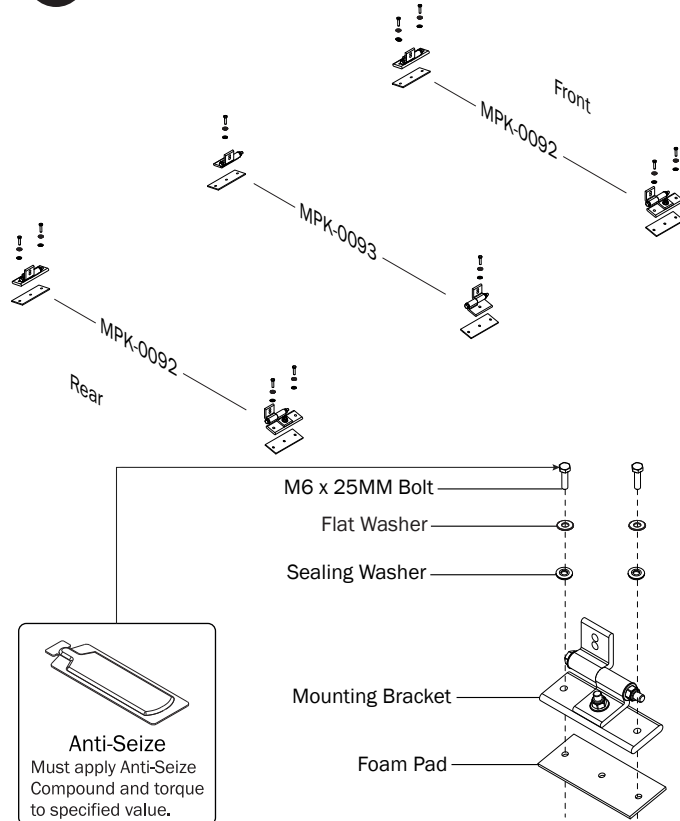
**CHANNELS**

- 2.1** Apply Anti-Seize to all M8 T Bolt studs, then attach the Channels to the Mounting Brackets using the indicated hardware. Do not tighten until Step 2.2

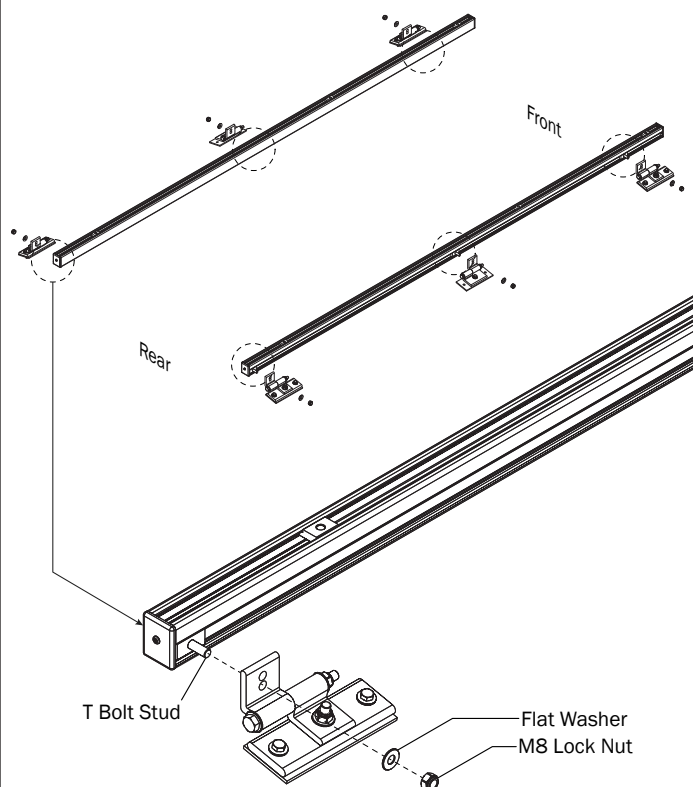

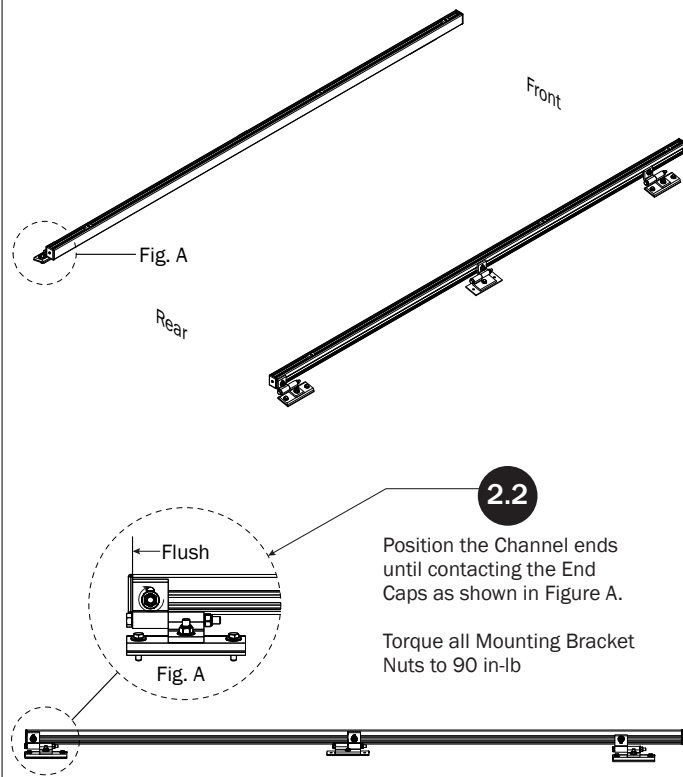

2.3 Attach Mounting Brackets to the Aluminum Strip Nuts located in the Channels

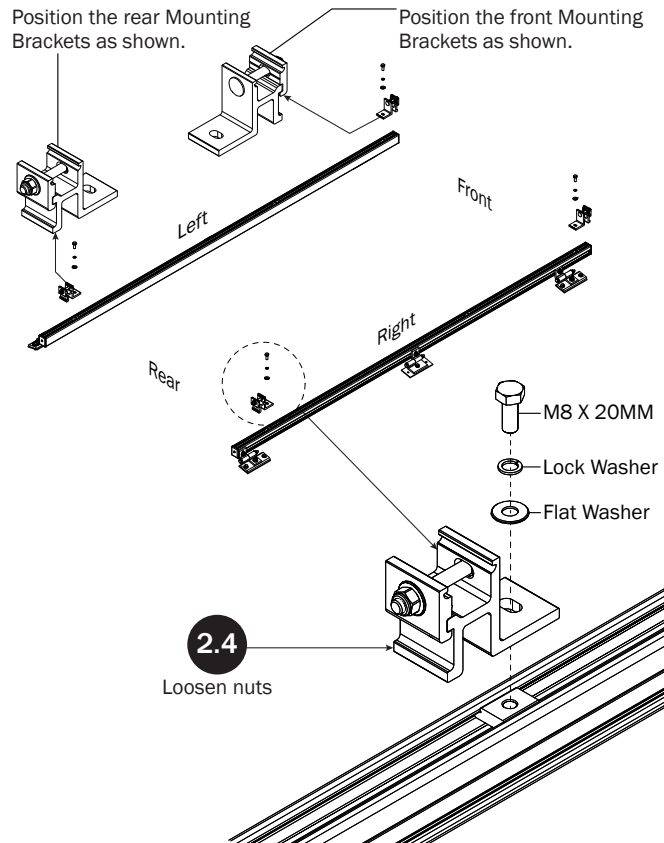

2.6 Position Mounting Brackets to designated dimension shown below, then torque the M8 X 20MM bolt to 90 in-lbs. Proceed to Step 3.1.

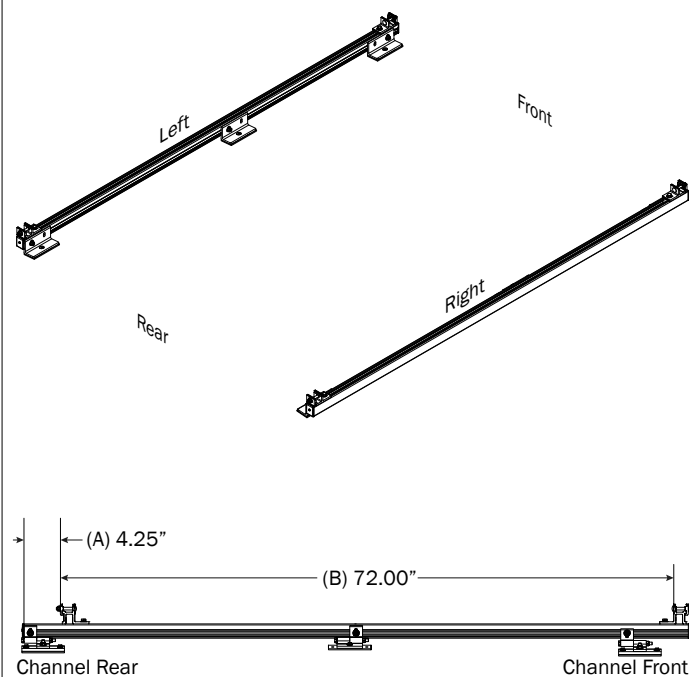

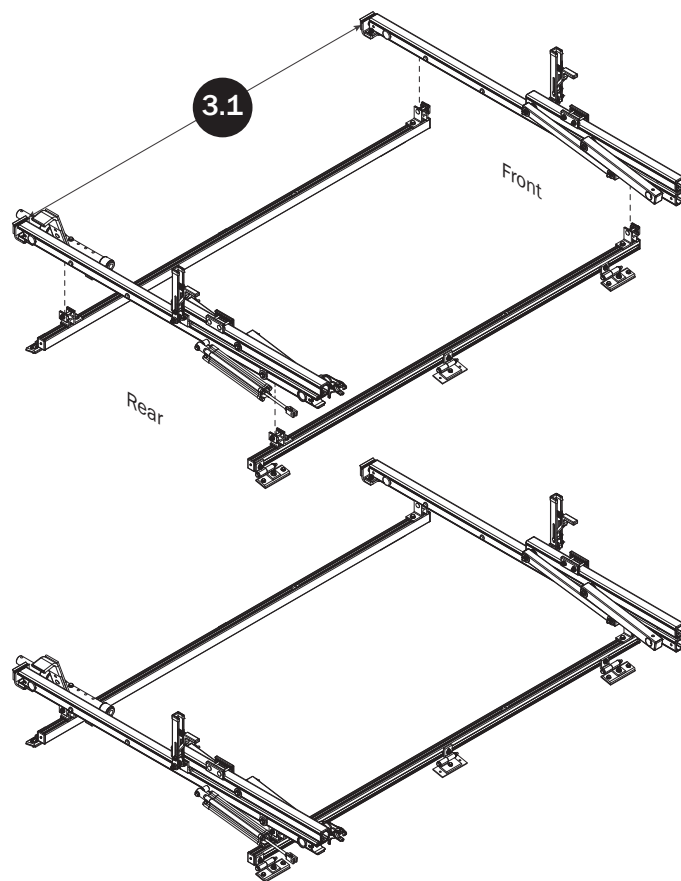
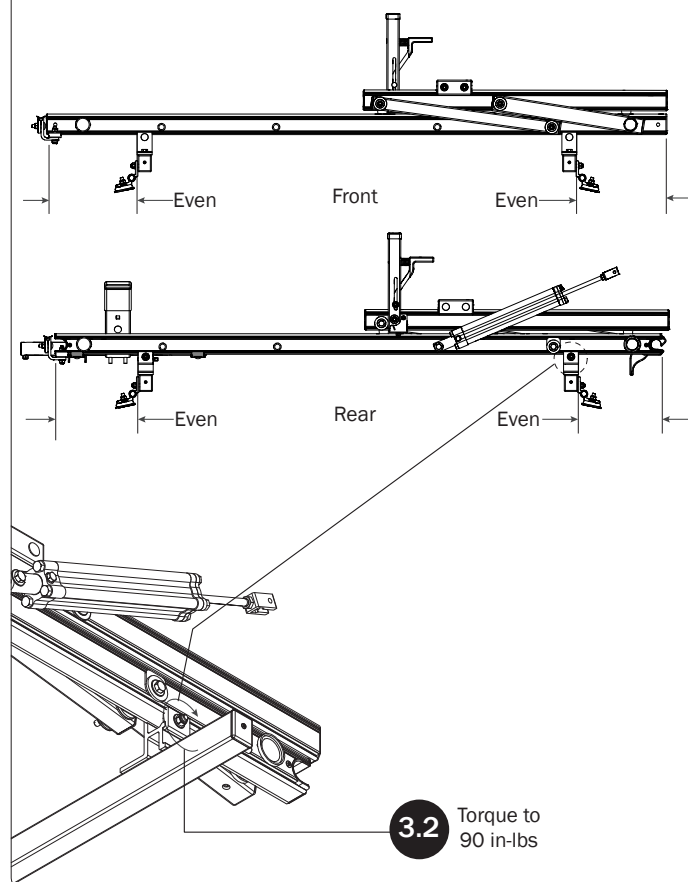
CROSSBARS**CROSSBAR ADJUSTMENT****REAR DRIVE SHAFT**

NOTE: For instructional clarity, the FBM Mounting System will not be shown for the remainder of this Assembly Manual.

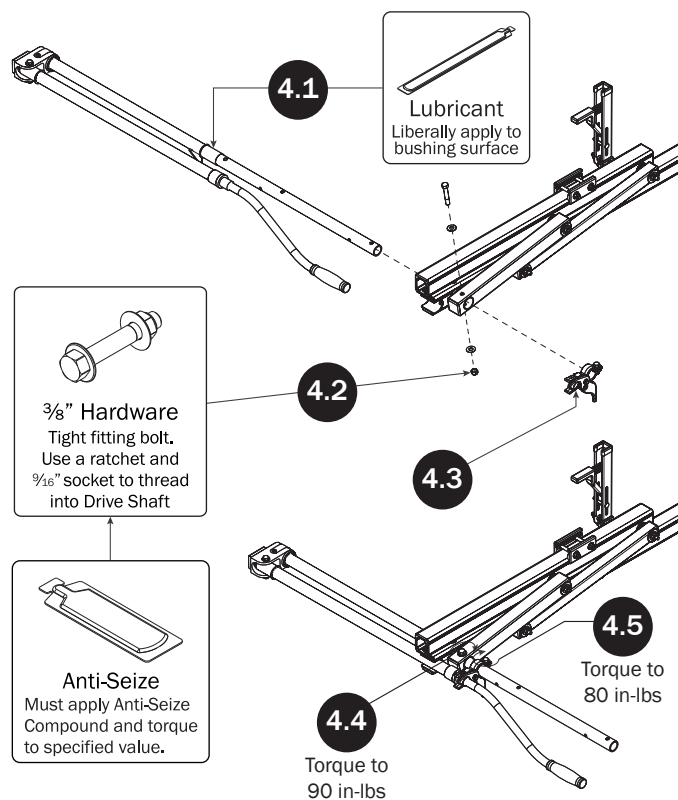
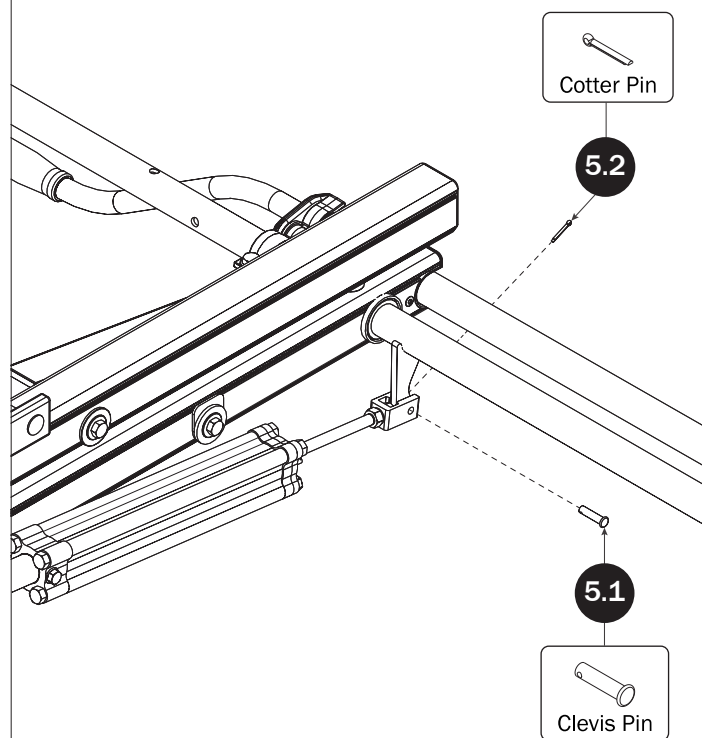
**CYLINDER HARDWARE**

CONNECTING BAR

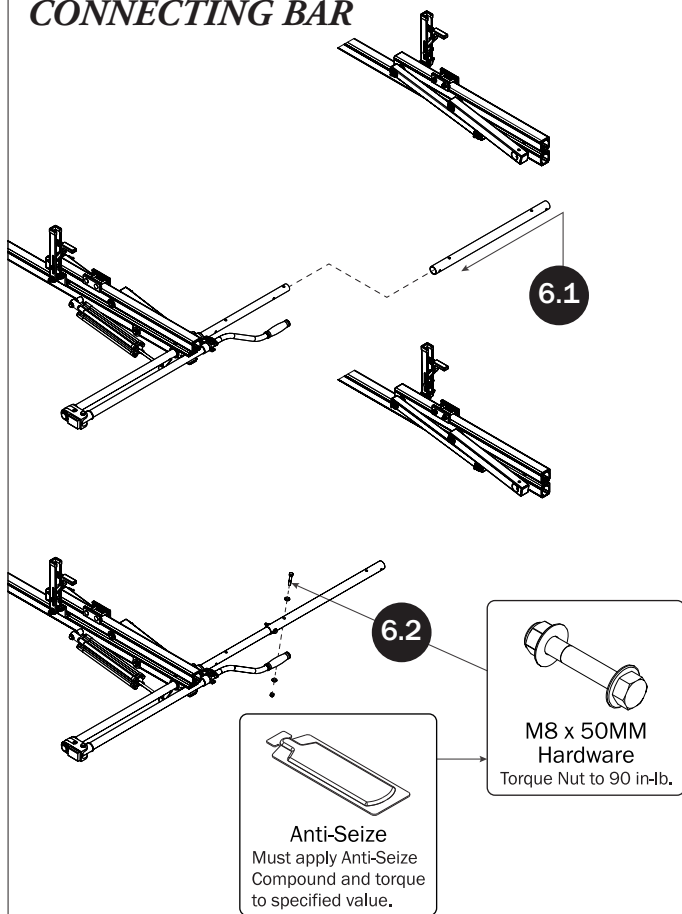

FRONT DRIVE SHAFT

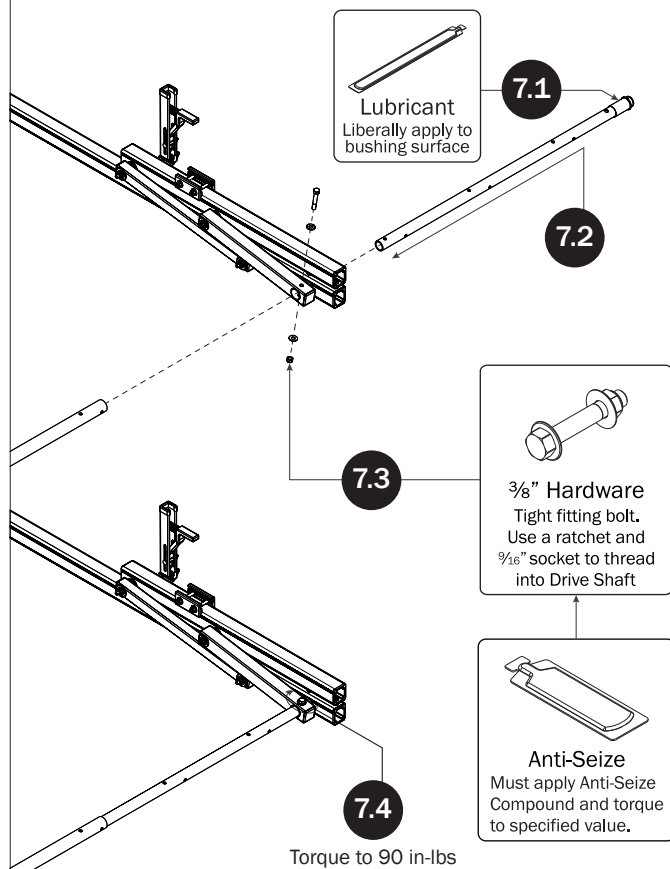

CONNECTING BAR FASTENERS

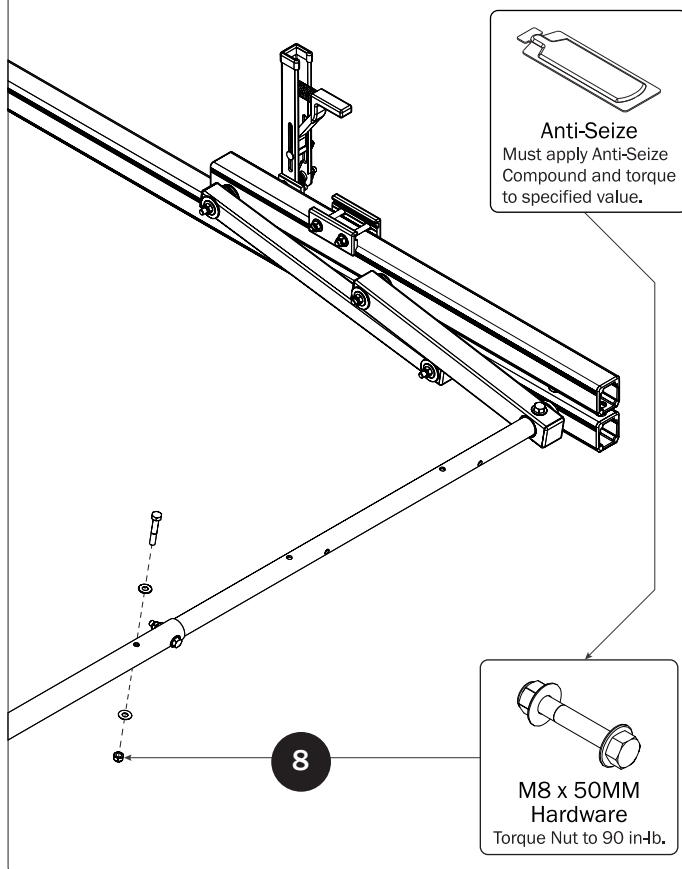

DRIVE SHAFT SEALING

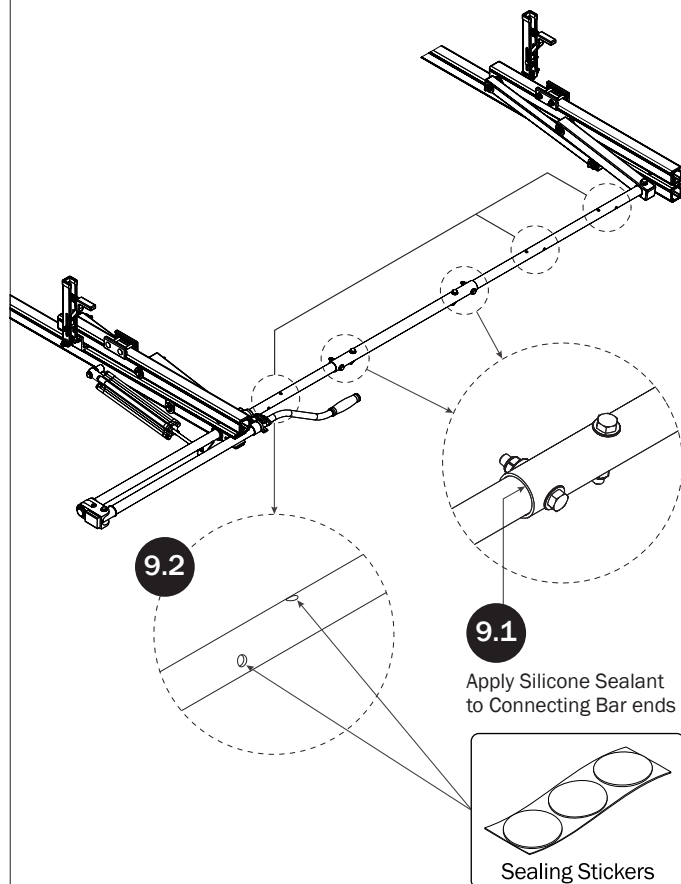

L POSTS**SEE QUICK START GUIDE FOR ADJUSTMENTS**

NOTE: The Auto Clamps may come preset from the factory for packaging purposes only. To assemble the L Posts to the Crossbars, the Auto Clamps may need to be repositioned.

Ensure the Auto Clamp Spring is seated into the spring catch

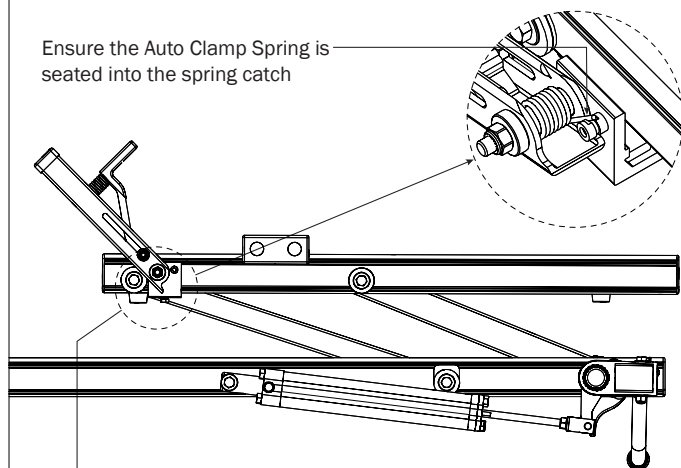

- 10.1** Beginning with the Rear Crossbar, loosen the bolt at the bottom of the Auto Clamp, then slide the Auto Clamp toward the inside end of the Rotation Upper. Reposition the Auto Clamp leaving a minimum of 1/4" distance from the rubber bumper to the edge of the Auto Clamp Bracket as shown, then finger-tighten if adjusting later, or torque to 80 in-lbs.

10.4

Slide L Post Bracket Clamp into bottom groove, then slide into L Post Bracket as shown

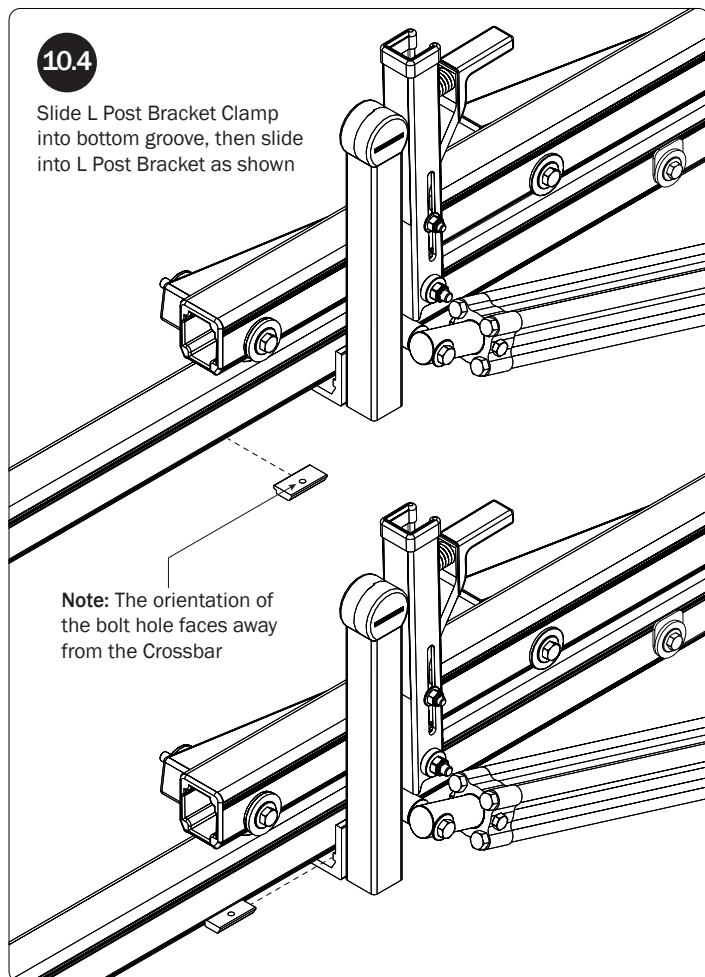

Note: The orientation of the bolt hole faces away from the Crossbar

10.2

Prepare the L Post by removing the hex head bolt, lock washer, flat washer, and Bracket Clamp. Retain for installation Steps 10.4—10.8.

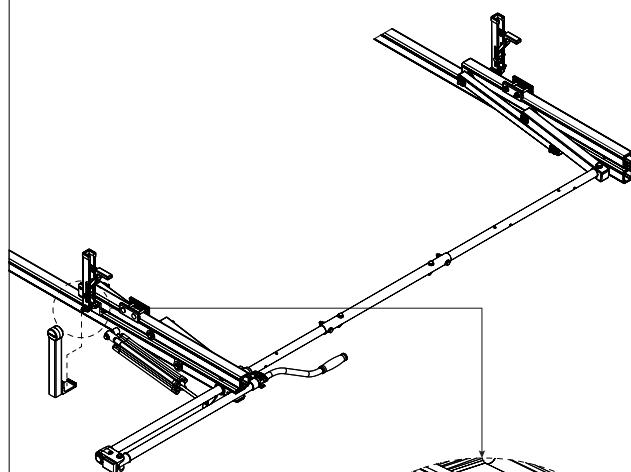
**10.3**

Place the L Post into the bottom groove of the Rear Crossbar, ensuring the L Post seats into the Crossbar's inside bottom groove as seen from the front of the Rear Crossbar

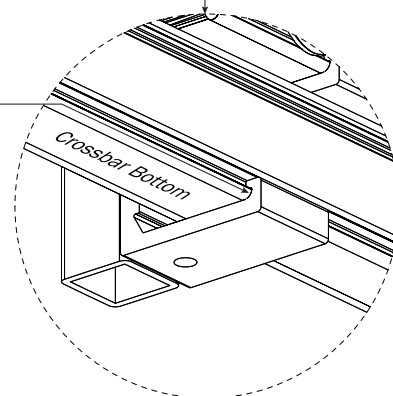
**10.5**

Bracket Clamp sits in L Post Bracket as shown

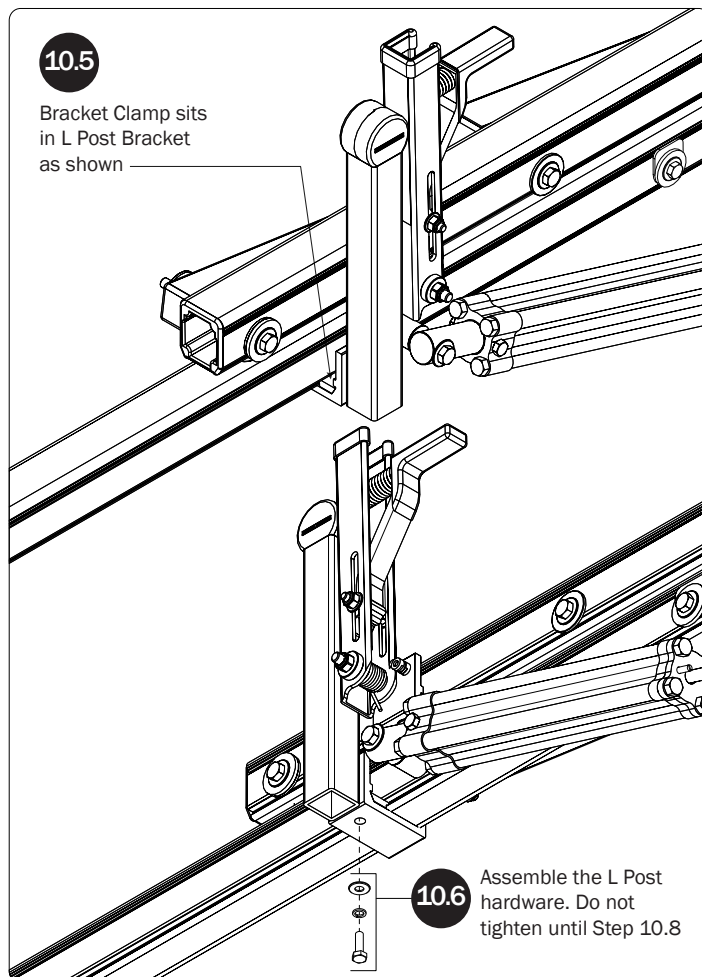
**10.6**

Assemble the L Post hardware. Do not tighten until Step 10.8

8.7

Slide the L Post until parallel to the Auto Clamp and the gap between the two is even from top to bottom

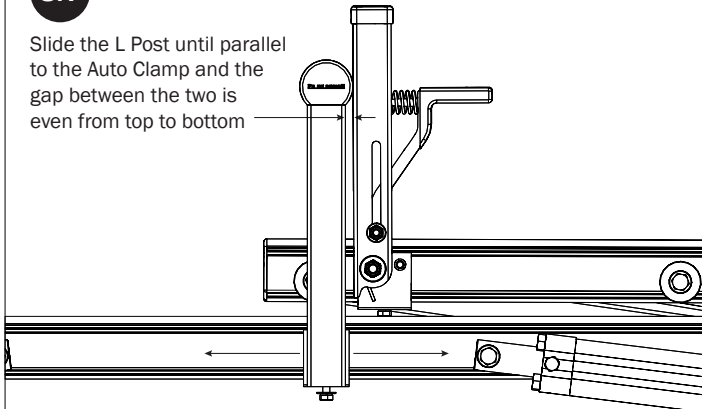

Torque to 80 in-lbs

10.8

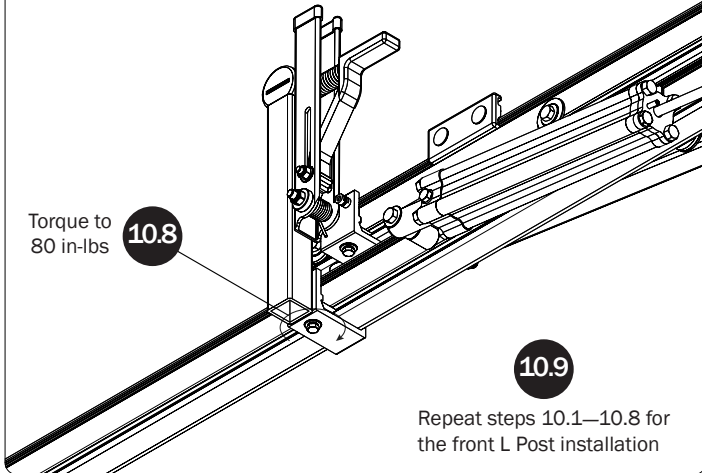

10.9

Repeat steps 10.1–10.8 for the front L Post installation

11.2

Refer to the Quick Start Guide for Z Post positioning.

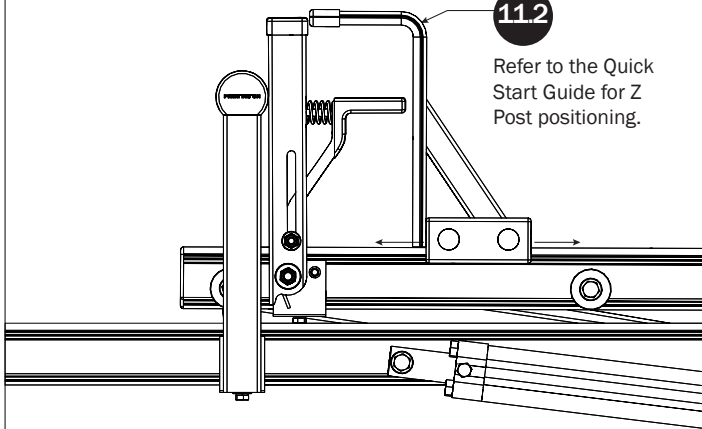

11.3

Torque to 90 in-lbs

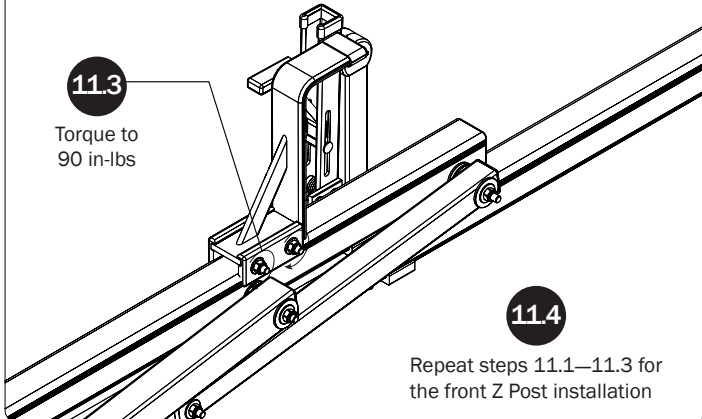

11.4

Repeat steps 11.1–11.3 for the front Z Post installation

Z POSTS

SEE QUICK START GUIDE FOR ADJUSTMENTS

11.1

Slide the Z Post into the Mounting Clamp Assembly

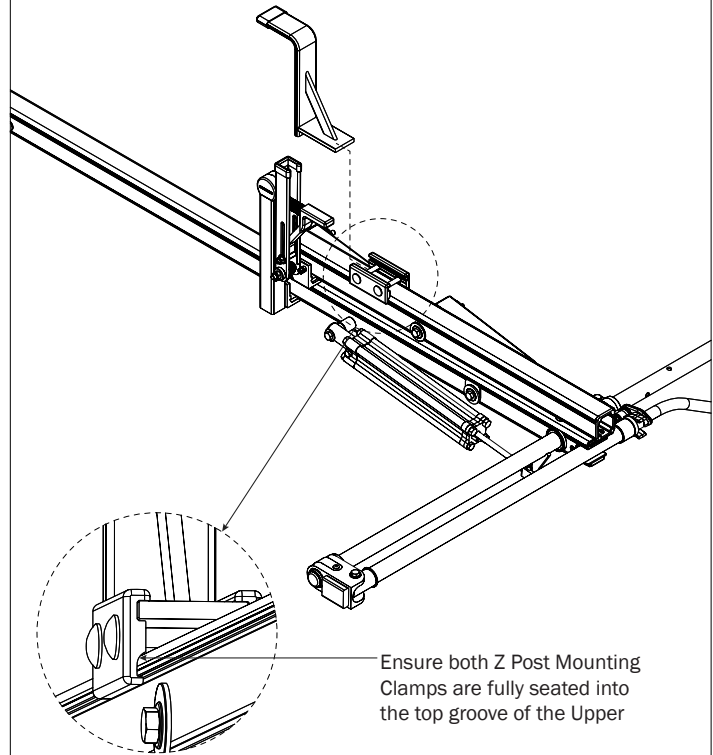

Ensure both Z Post Mounting Clamps are fully seated into the top groove of the Upper

CYLINDER ADJUSTMENT

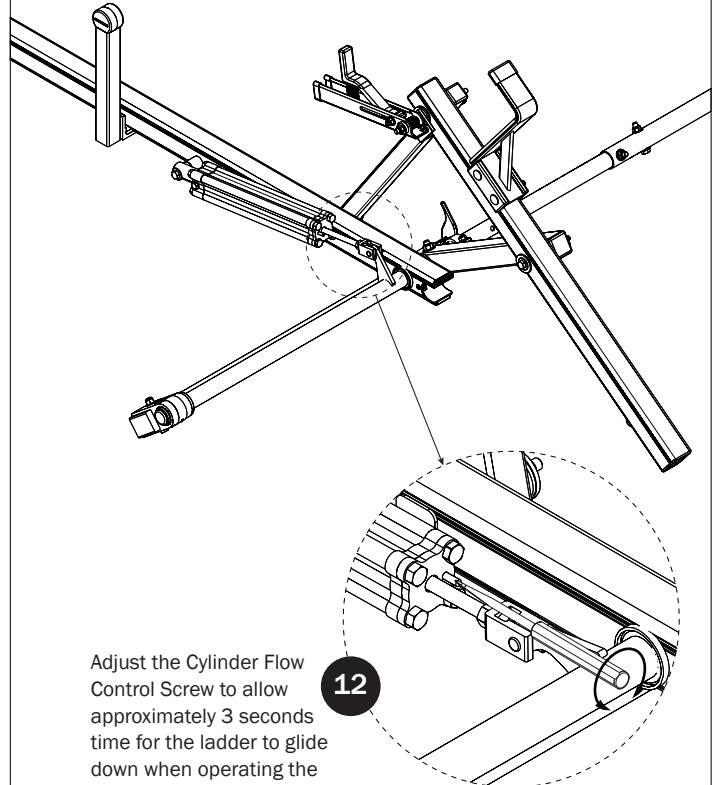

12

Adjust the Cylinder Flow Control Screw to allow approximately 3 seconds time for the ladder to glide down when operating the loaded Ladder Rack.

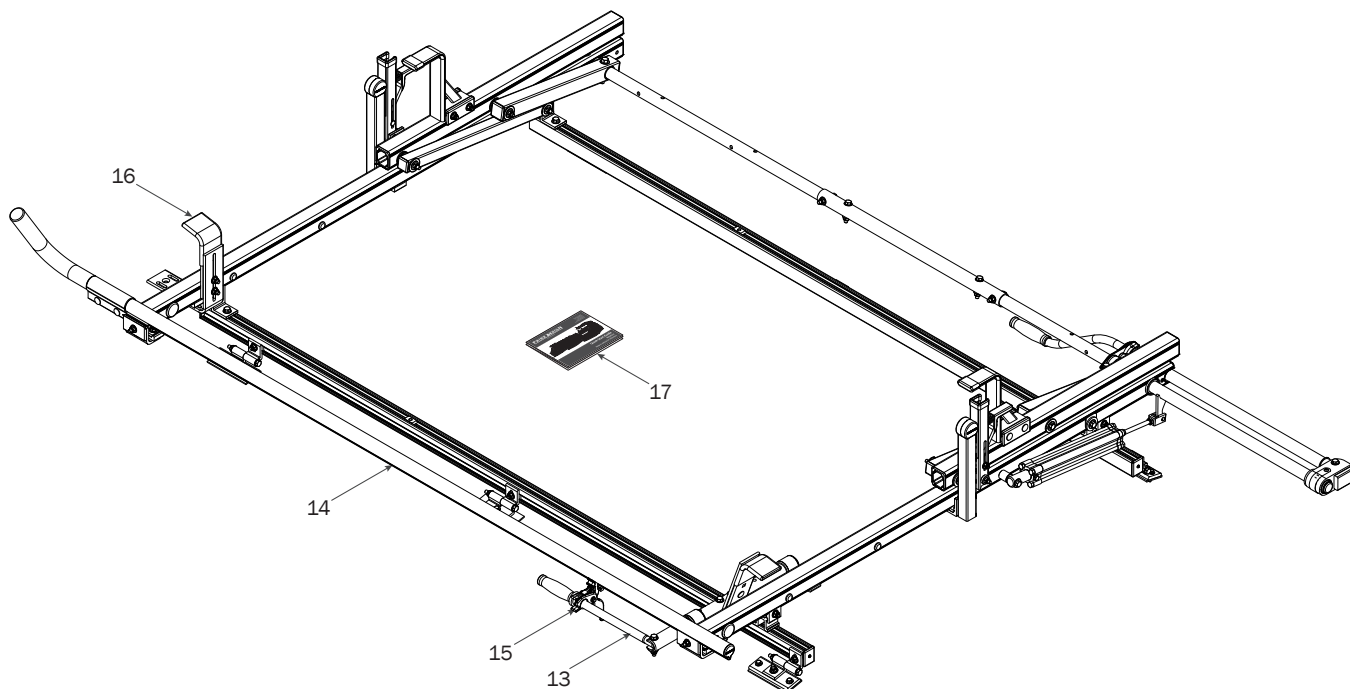
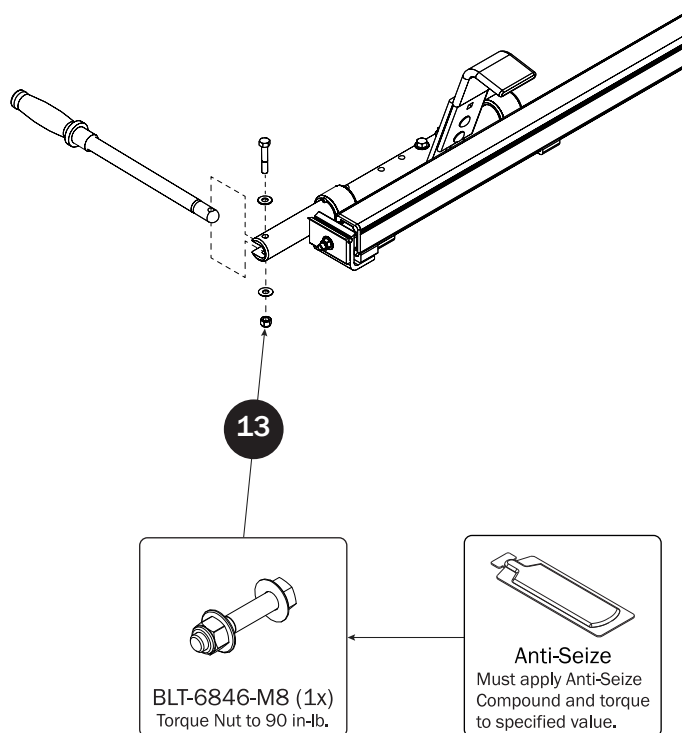
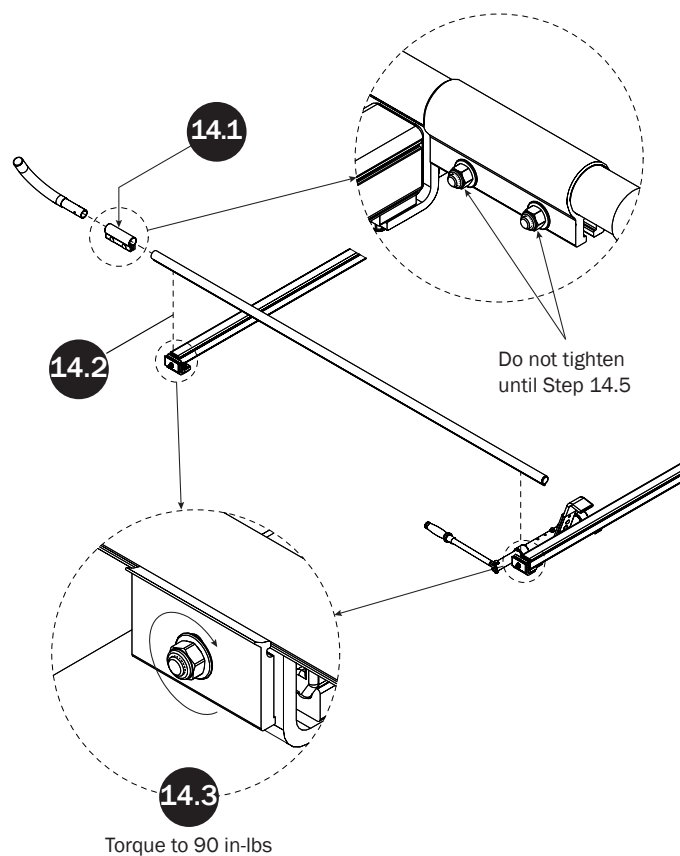
**CLAMP DOWN HANDLE****CLAMP DOWN TUBE**

Set Clamp Down Horn
to angle shown.

14.4

35°

View from vehicle front

14.5

Torque to 90 in-lbs

HANDLE LATCH

Toward Vehicle Rear

15.1

Do not tighten
until Step 15.3

15.2

Position the Handle Latch until the
Handle Grip is firmly seated.

FRONT LADDER HOOK

SEE QUICK START GUIDE FOR ADJUSTMENTS

16.1

Remove and retain the Front Ladder Hook
fastening hardware (not shown in this view)
for Steps 16.3 and 16.4

15.3

Torque to 90 in-lbs

16.2

Seat the Front Ladder Hook
into the lower Crossbar groove
as shown in this bottom view

16.3

Place the Front Hook Clamp Bracket removed in Step 16.1 into the lower groove of the Crossbar, and slide it on top of the Front Ladder Hook Clamp

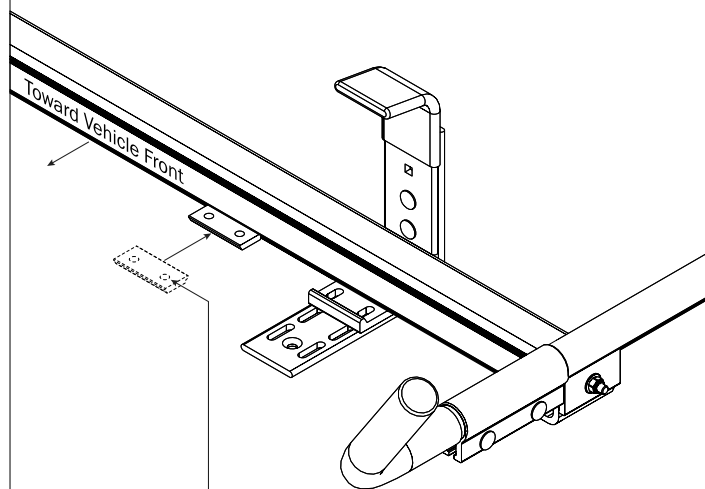

NOTE: The orientation of the bolt hole faces away from the Crossbar

16.4

Reassemble the Front Clamp Down Tube Holder using the fastening hardware removed at Step 16.1. Do not tighten until Step 16.6

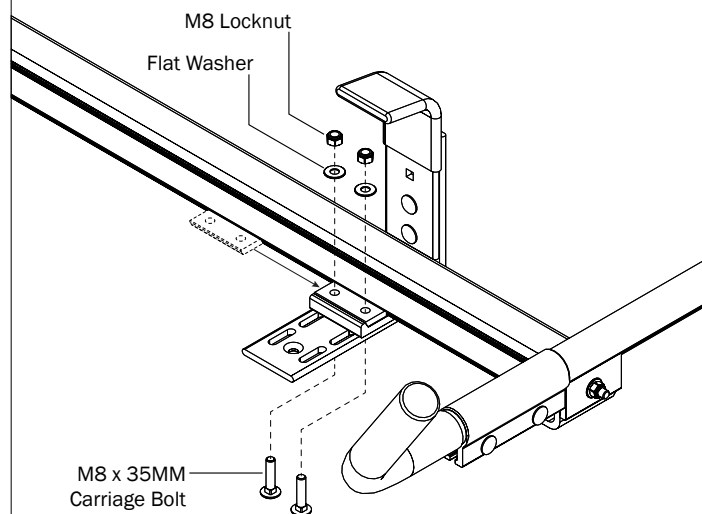

16.5

Adjust the Front Hook until it aligns with the Rear Hook. Perfect alignment may not be possible in all instances, and depends upon the location of the Crossbar Mounting Brackets. If such interference should occur, align the Hook as close as possible.

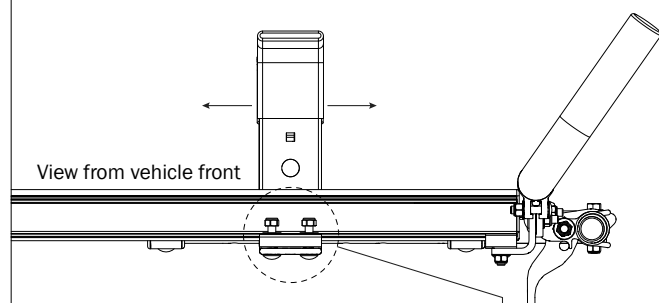

16.6

Torque to 90 in-lbs

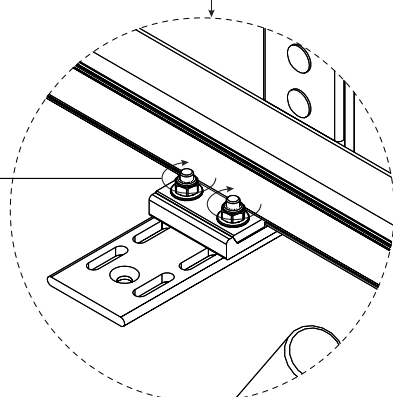

QUICK START GUIDE

17

Place the Quick Start Guide into the vehicle's glove box for ladder setup and adjustment.

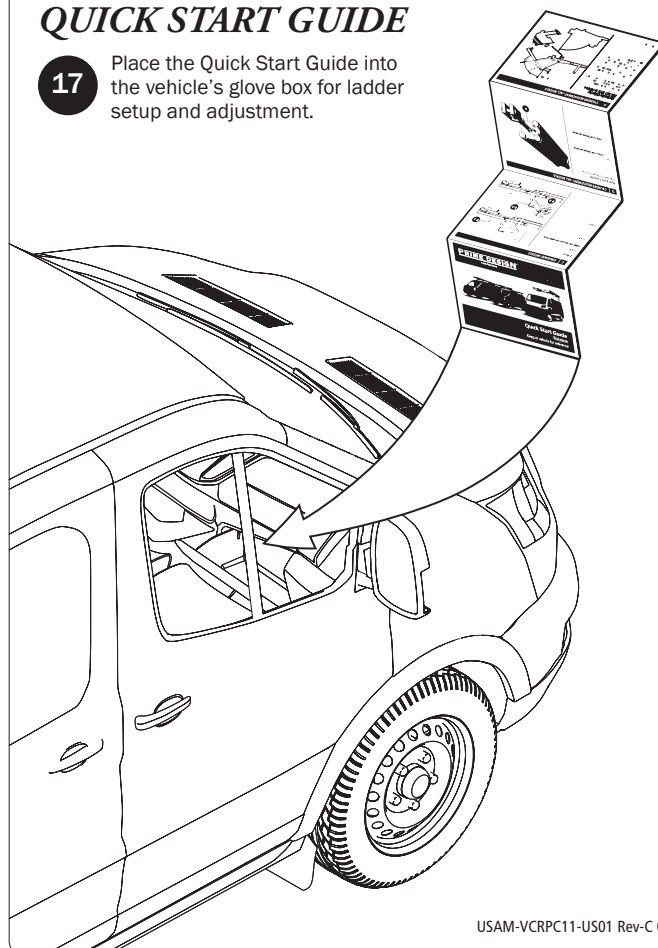

USAM-VCRPC11-US01 Rev-C 0918