

# PRIME DESIGN™

A Safe Fleet Brand

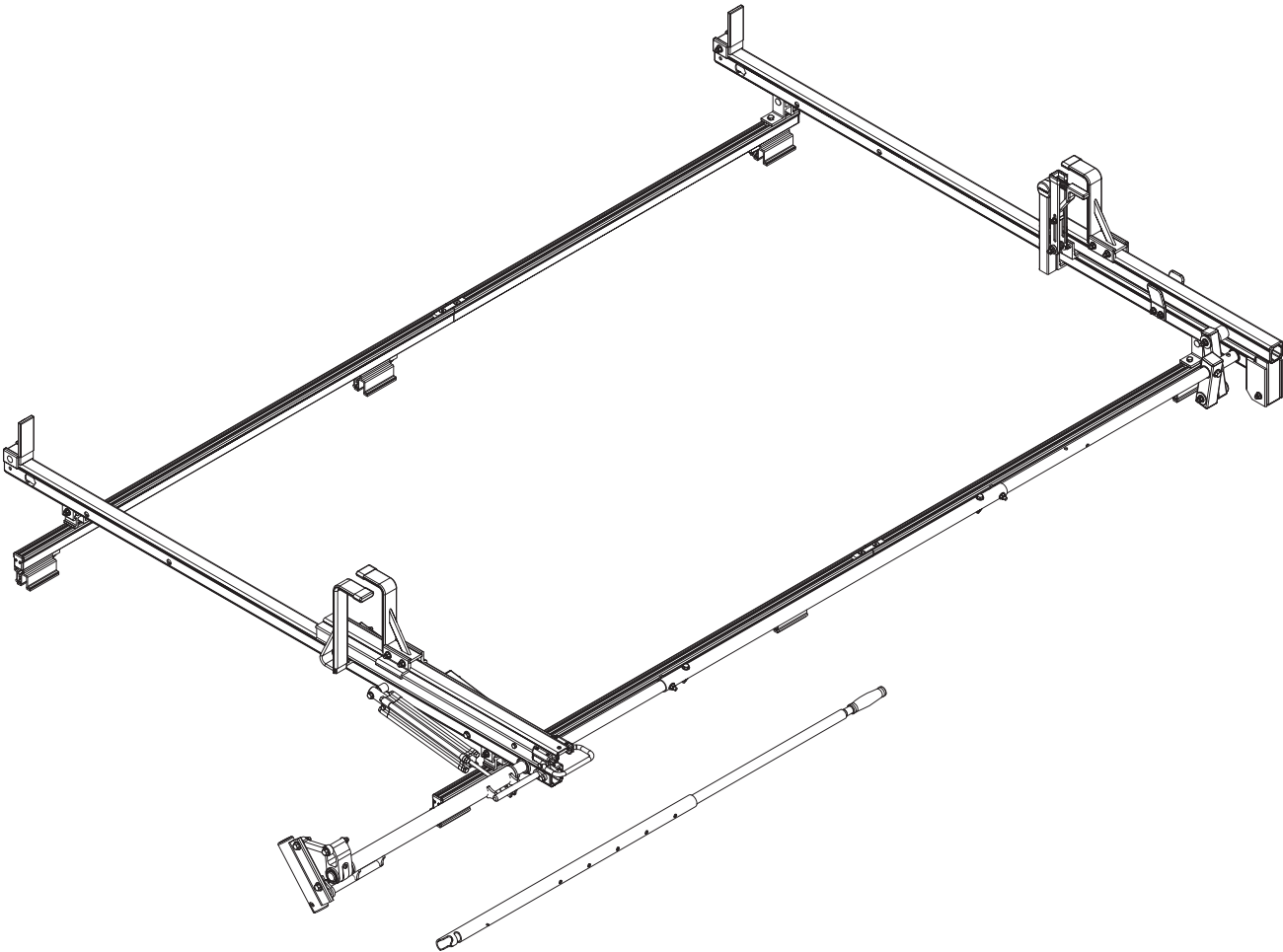

2500  
HBI-E

## CONTENTS OVERVIEW

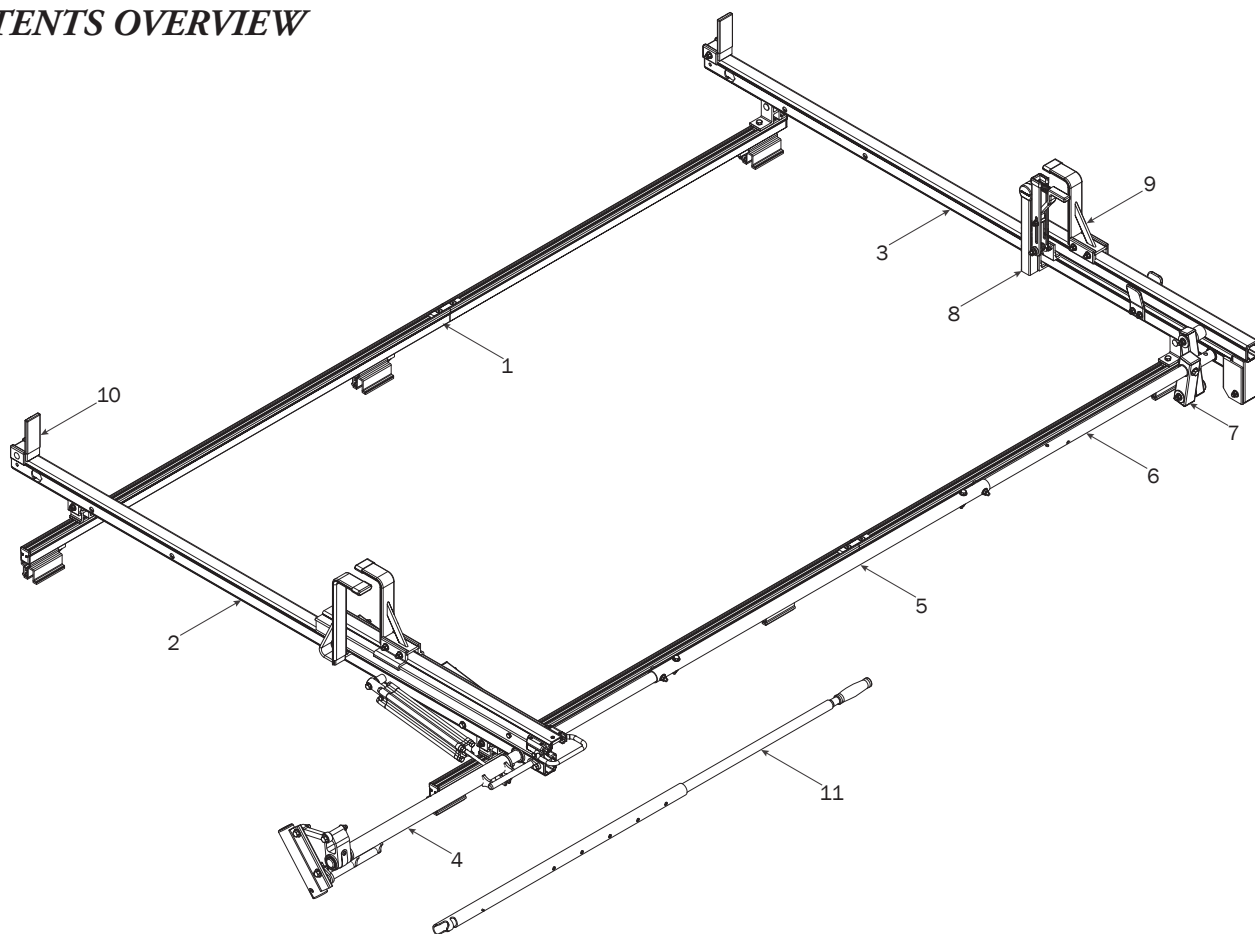

- 1—FBM-0013 ..... (Qty 1)  
Channels with hardware



48" Channels (2X)



60" Channels (2X)



End Caps (4X)



Screws (8X)



Top Connector (2X)



Bottom Connector (2X)



Brackets (4X)

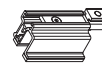

Mountings (6X)

M8 Bolt (4X)

- 2—Rear Crossbar Assembly ..... (Qty 1)

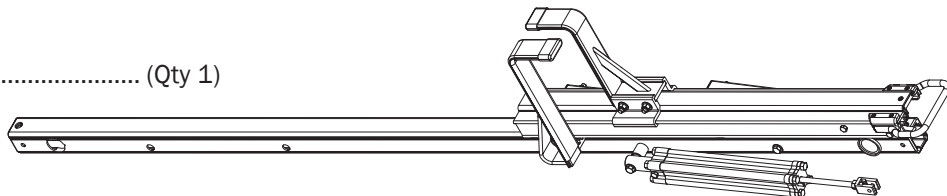

- 3—Front Crossbar Assembly ..... (Qty 1)

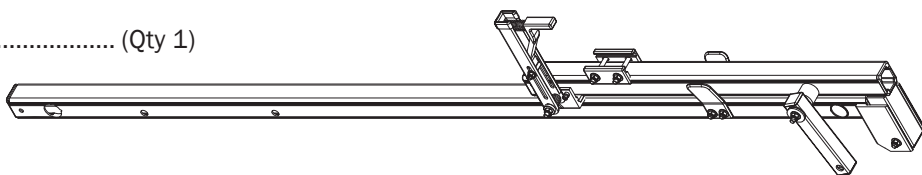

- 4—Drive Shaft ..... (Qty 1)  
Rear, Right Hand, 50.00"

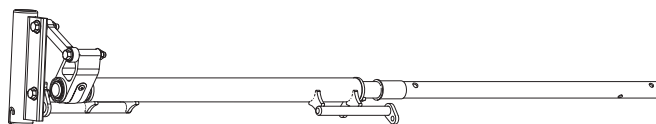

5—Connecting Bar ..... (Qty 1)  
48.00"



6—Front Drive Shaft ..... (Qty 1)  
B Version, 35.75"

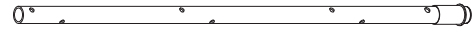

7—Drive Arm ..... (Qty 1)  
Incline Version with Bushing and Hardware

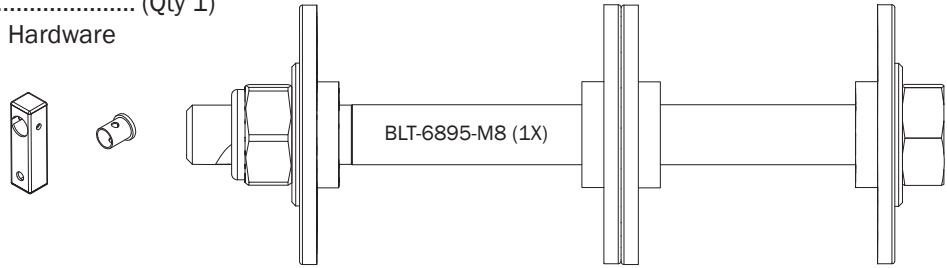

8—Z Post ..... (Qty 1)  
Adjustable, 7.25"

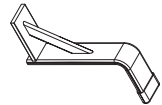

9—L Post ..... (Qty 1)  
Gen2, AC2, 9.25"

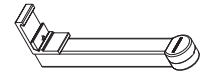

10—Ladder Stop Assembly ..... (Qty 2)  
1.75"

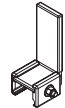

11—HRR Removeable Handle Assembly ..... (Qty 1)

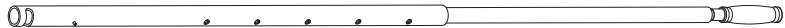

HKT-8163-Rotation Hardware Kit

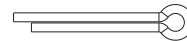

Cotter Pin (1X)

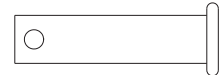

Clevis Pin (1X)

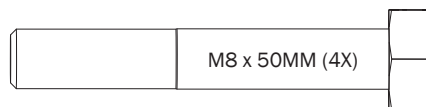

M8 x 50MM (4X)

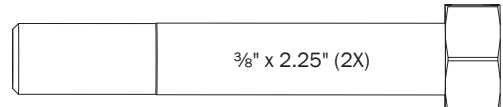

$\frac{3}{8}$ " x 2.25" (2X)

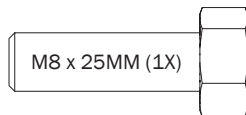

M8 x 25MM (1X)

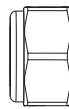

M8 Lock Nut (5X)

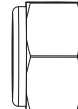

$\frac{3}{8}$ " Lock Nut (2X)

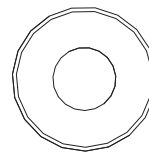

$\frac{5}{16}$ " Flat Washer (10X)

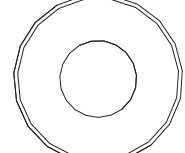

$\frac{3}{8}$ " Flat Washer (4X)

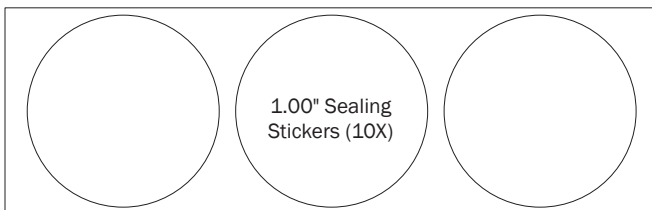

1.00" Sealing  
Stickers (10X)



Anti-Seize (1X)

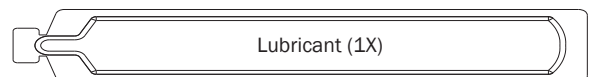

Lubricant (1X)

## FBM-0013 MOUNTING BRACKETS

**INSTALLER NOTE:** Mounting Brackets must be disassembled for installation onto the vehicle's roof.

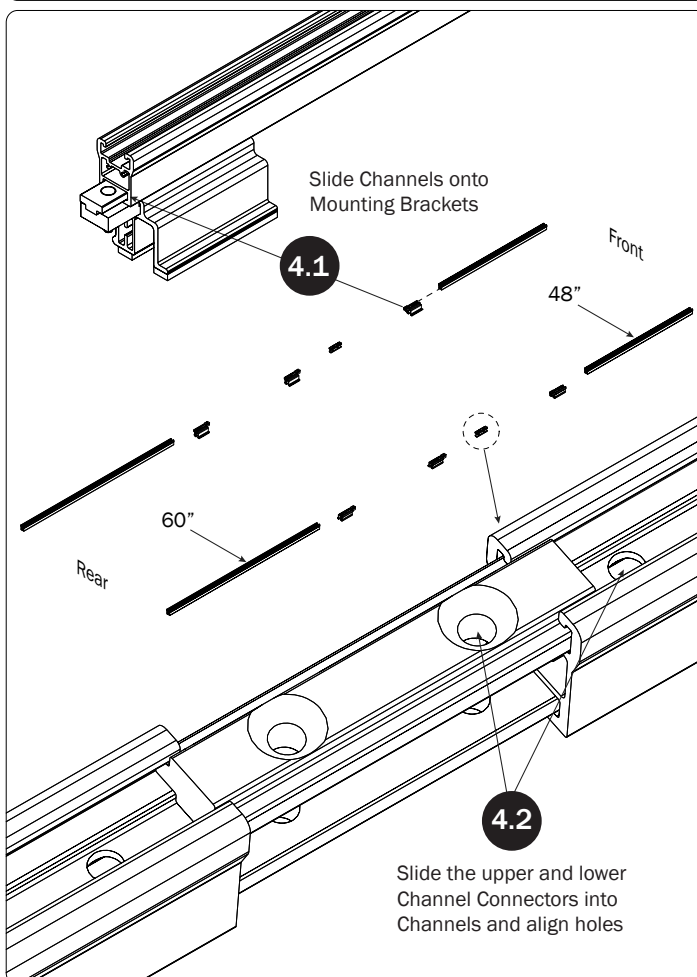
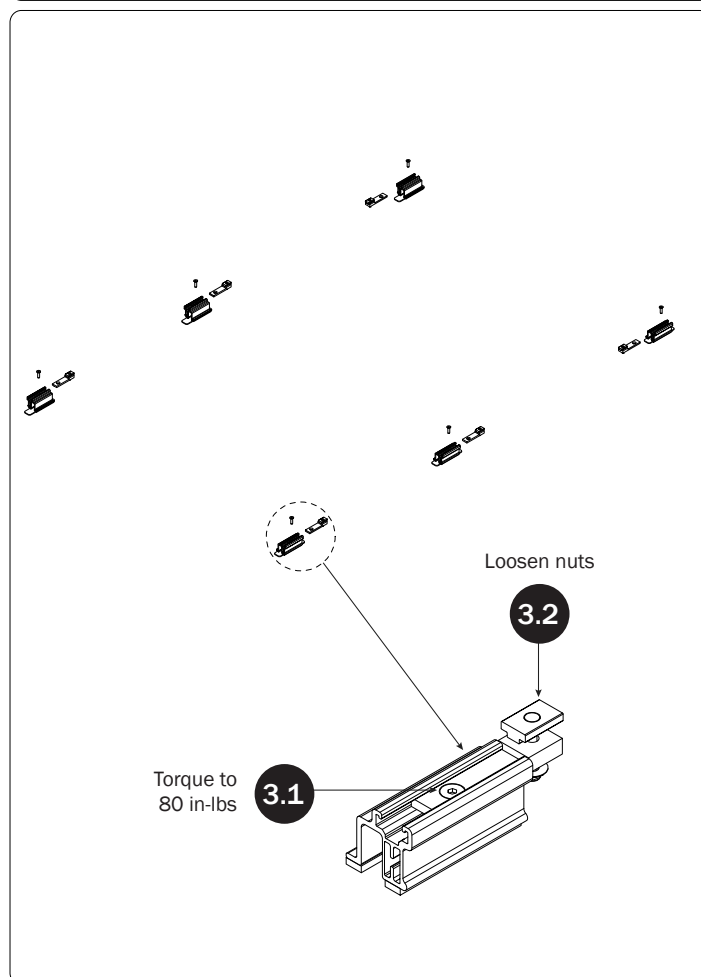
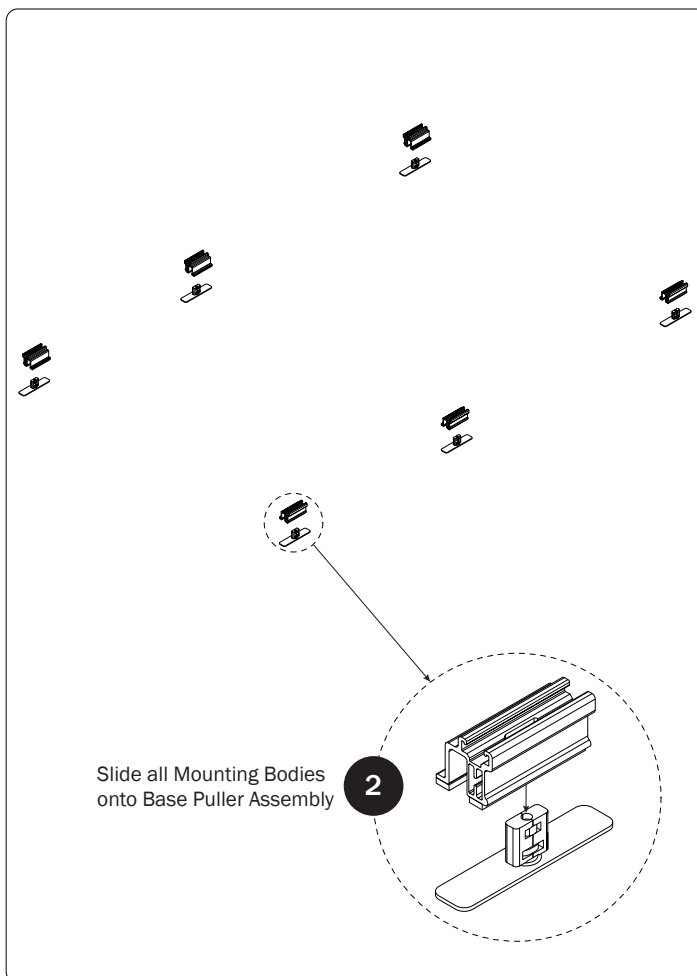
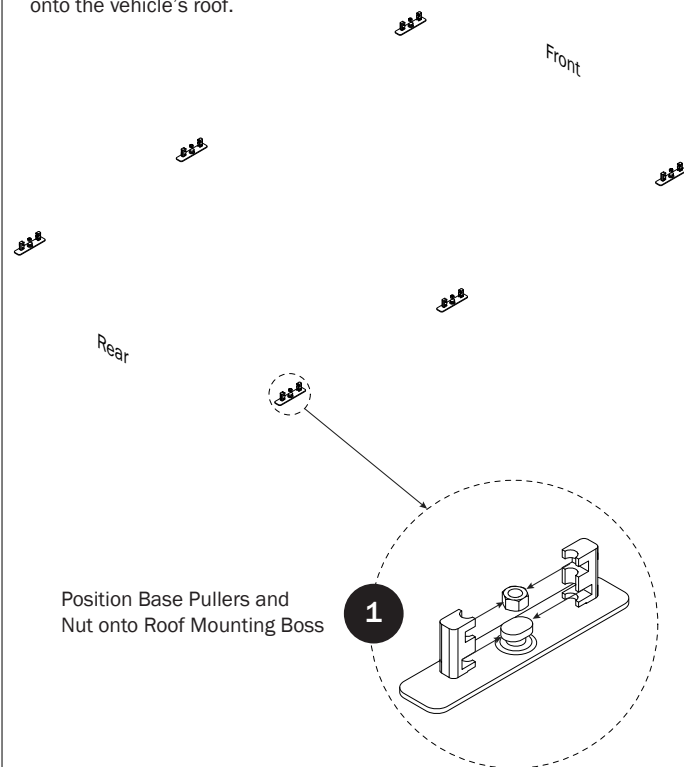

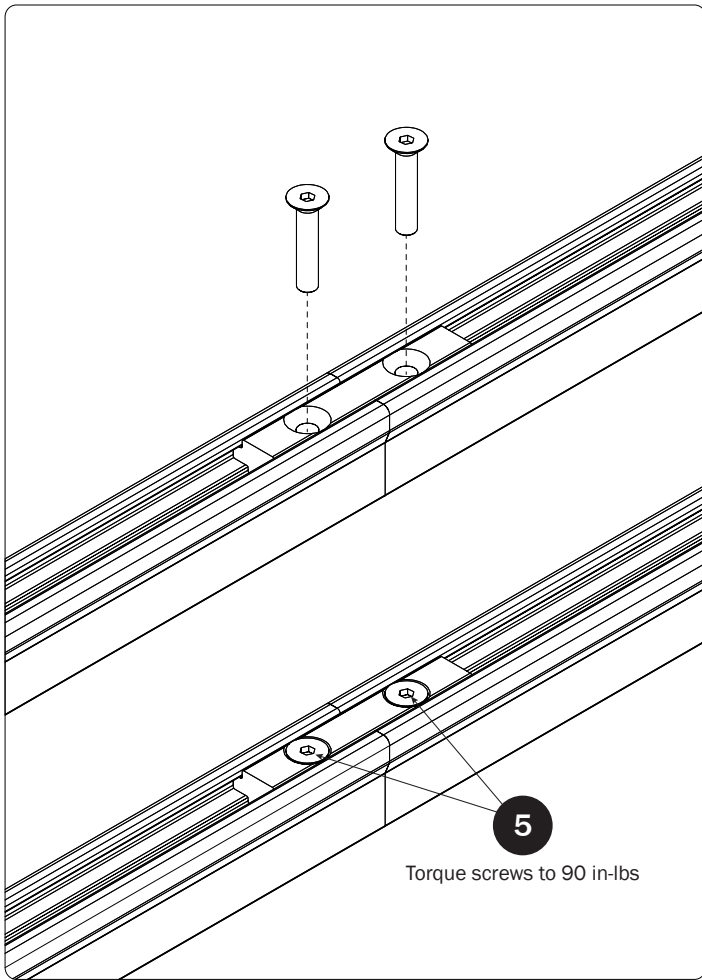

6 Set to distances then torque Mounting Bracket nuts to 80 in-lbs

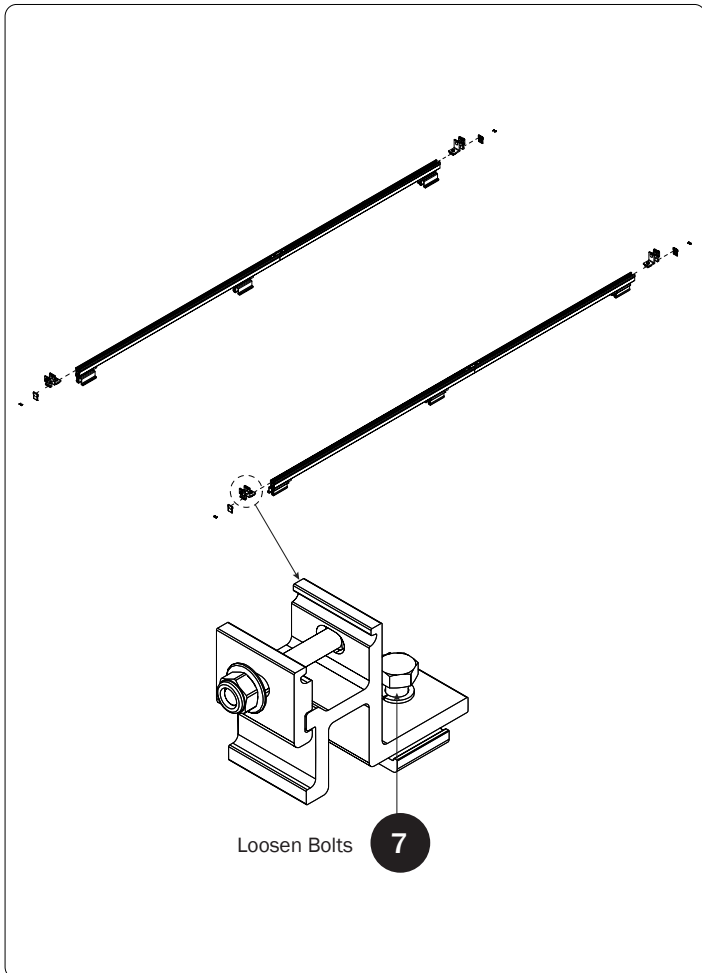
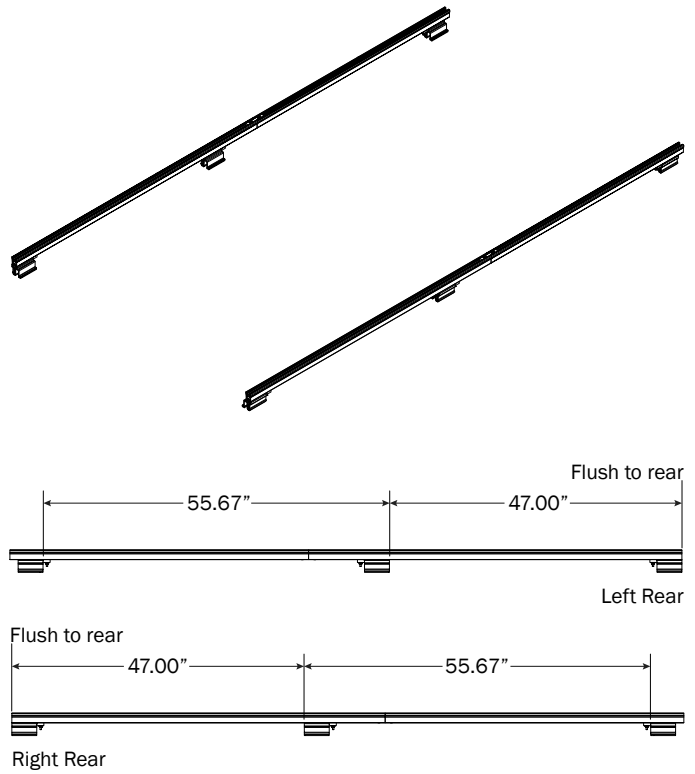

8 Set to distances then torque Mounting Bracket nuts to 90 in-lbs

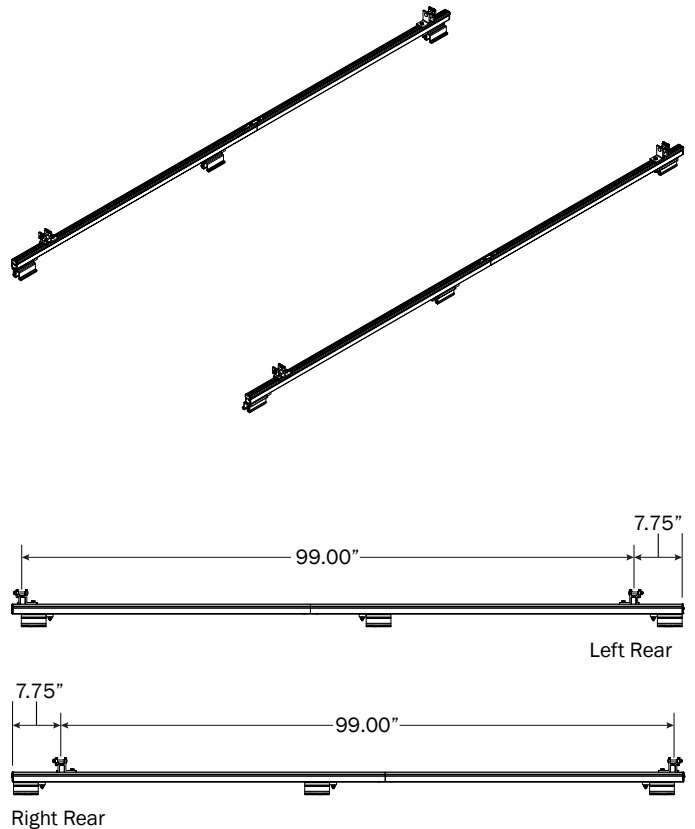

# RIGHT ROTATION ASSEMBLY

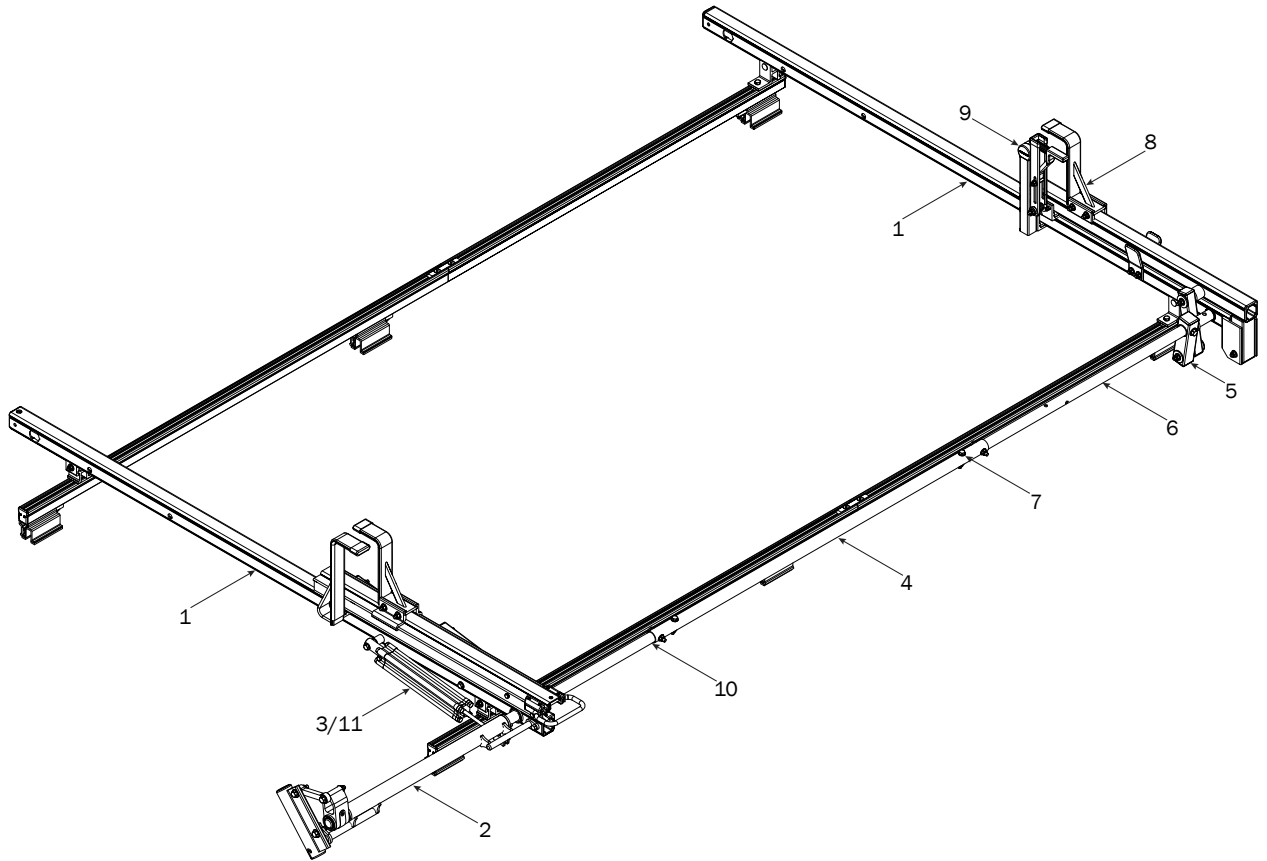

## CROSSBARS

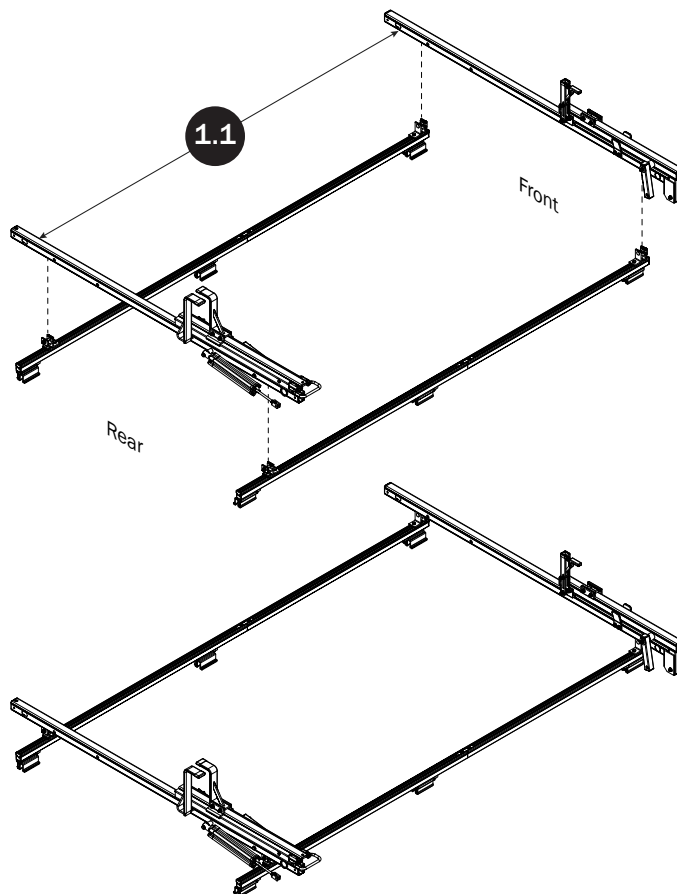

## CROSSBAR ADJUSTMENT

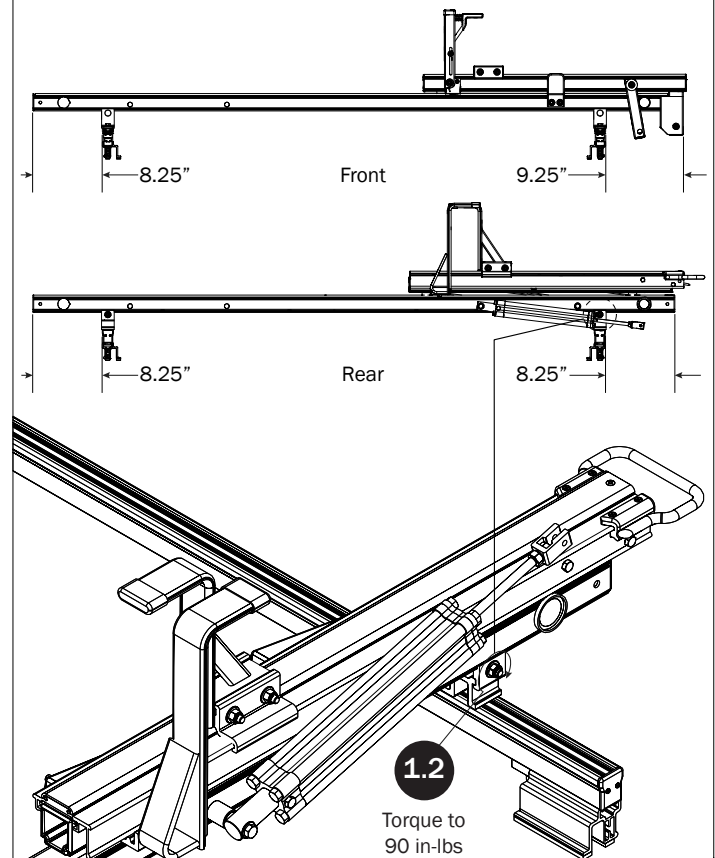

## REAR DRIVE SHAFT

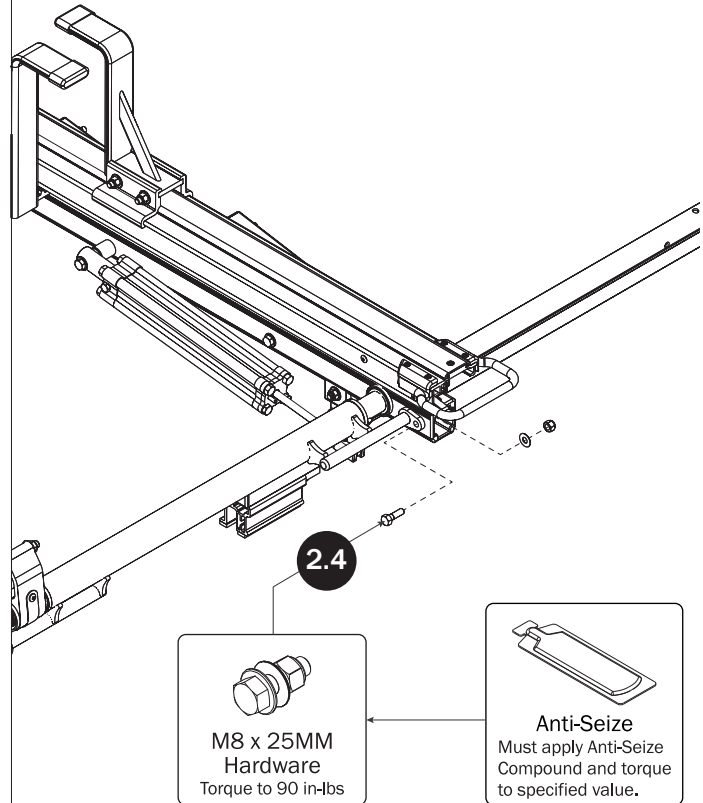
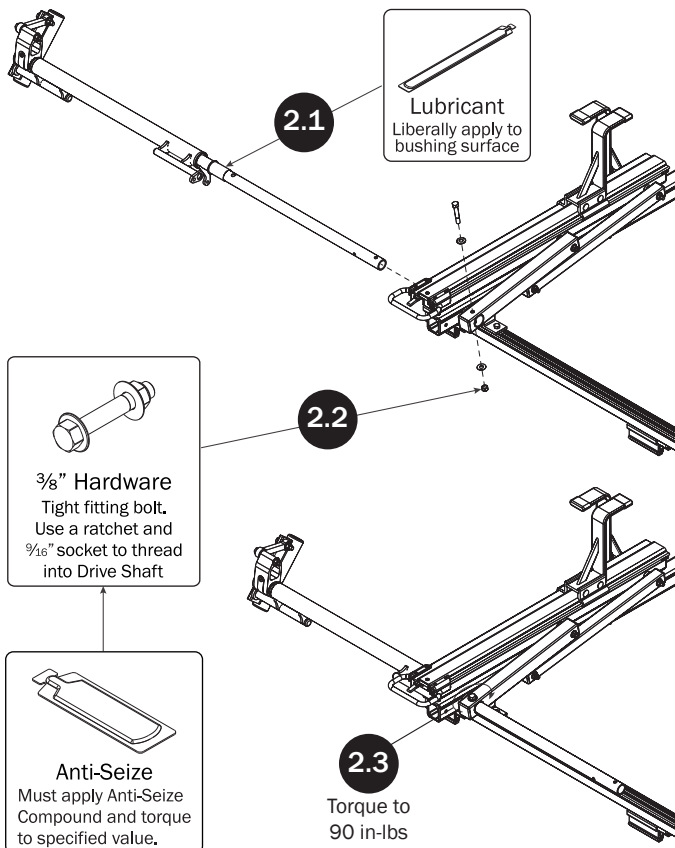

## CYLINDER HARDWARE

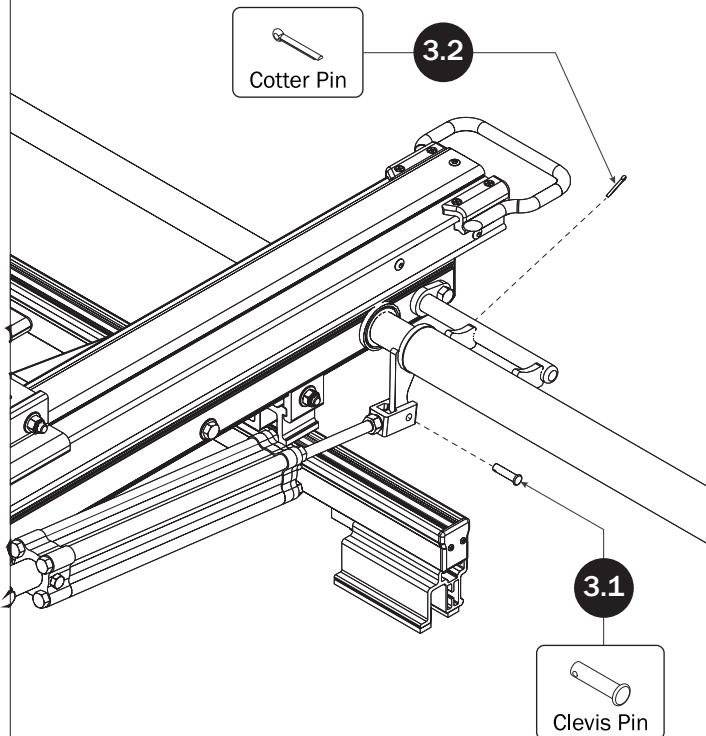

## CONNECTING BAR

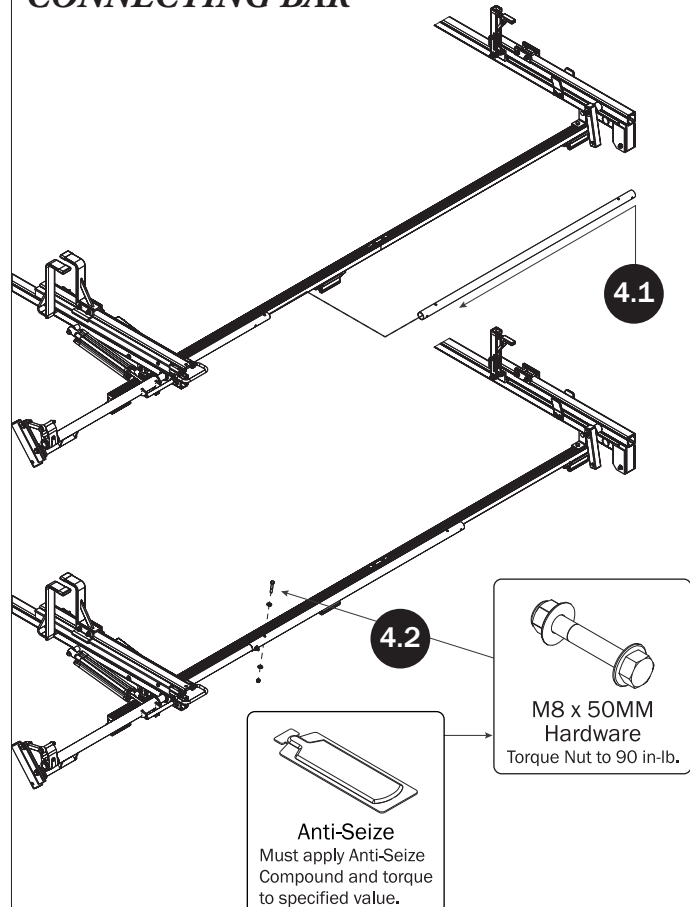



## FRONT DRIVE ARM

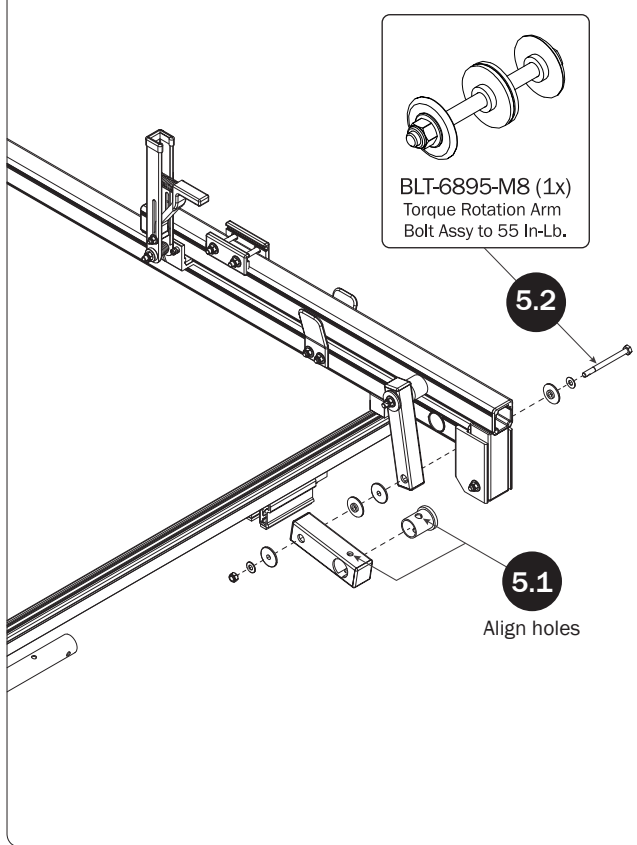

## FRONT DRIVE SHAFT

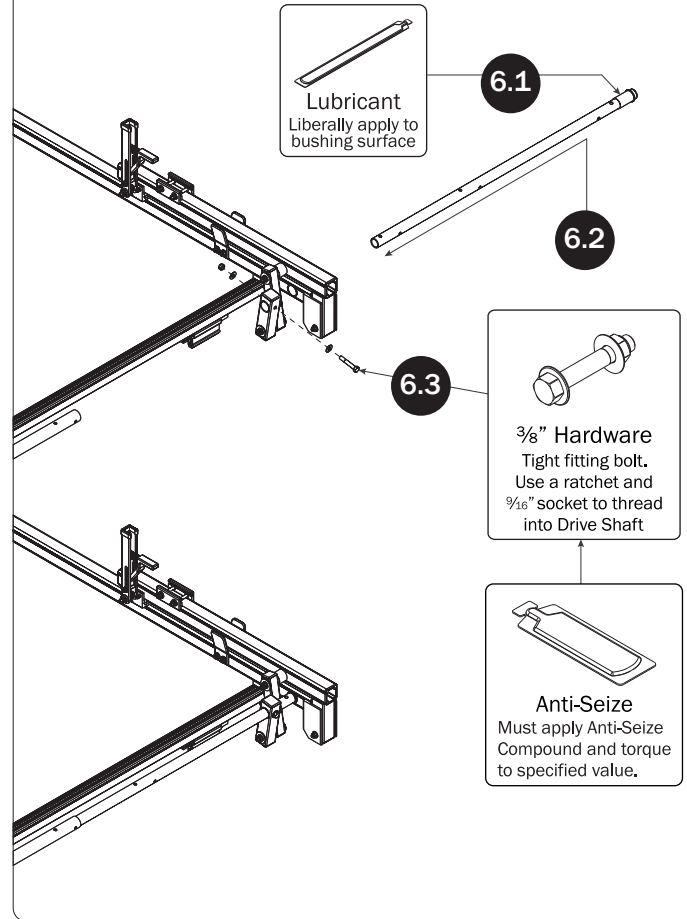

## CONNECTING BAR FASTENERS

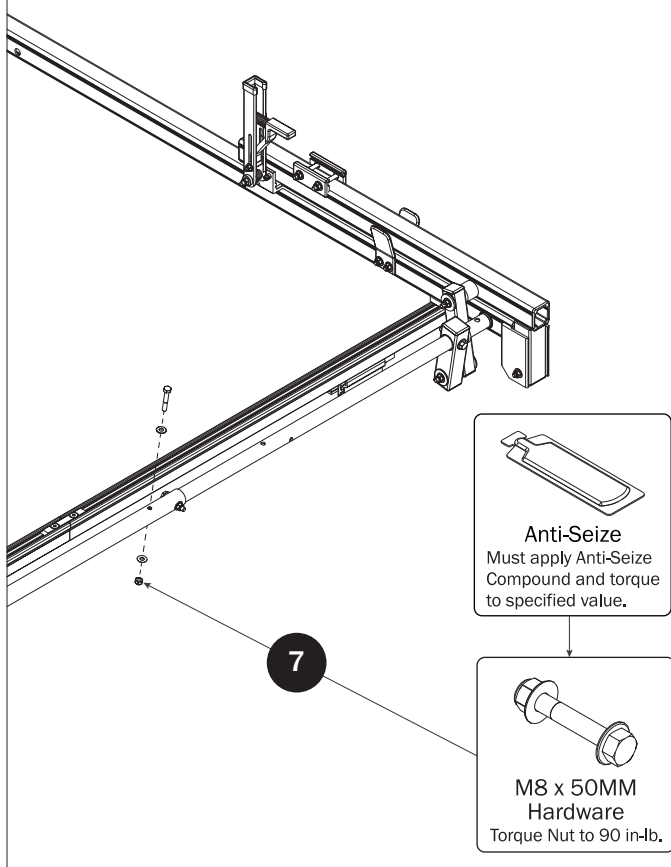

## L POST SEE QUICK START GUIDE FOR ADJUSTMENTS

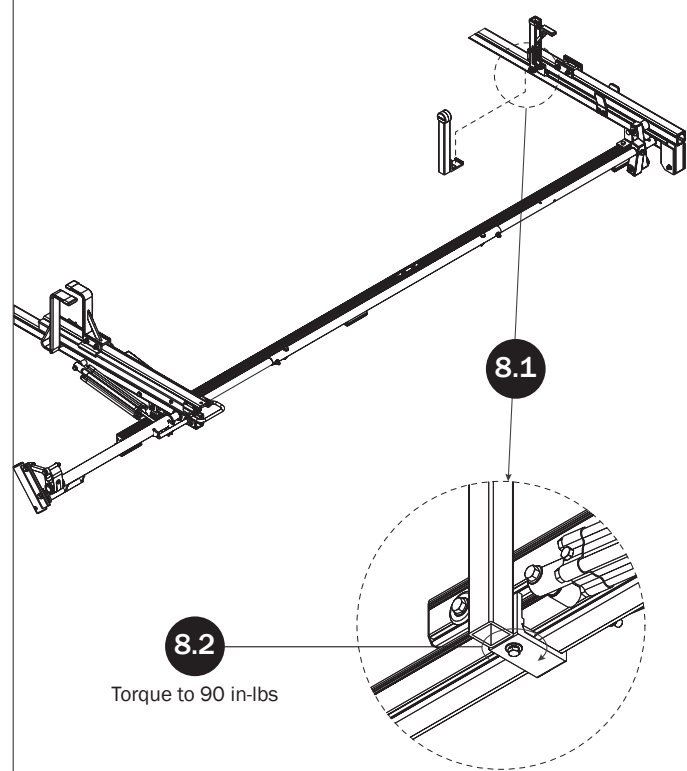



**Z POST**

SEE QUICK START GUIDE FOR ADJUSTMENTS

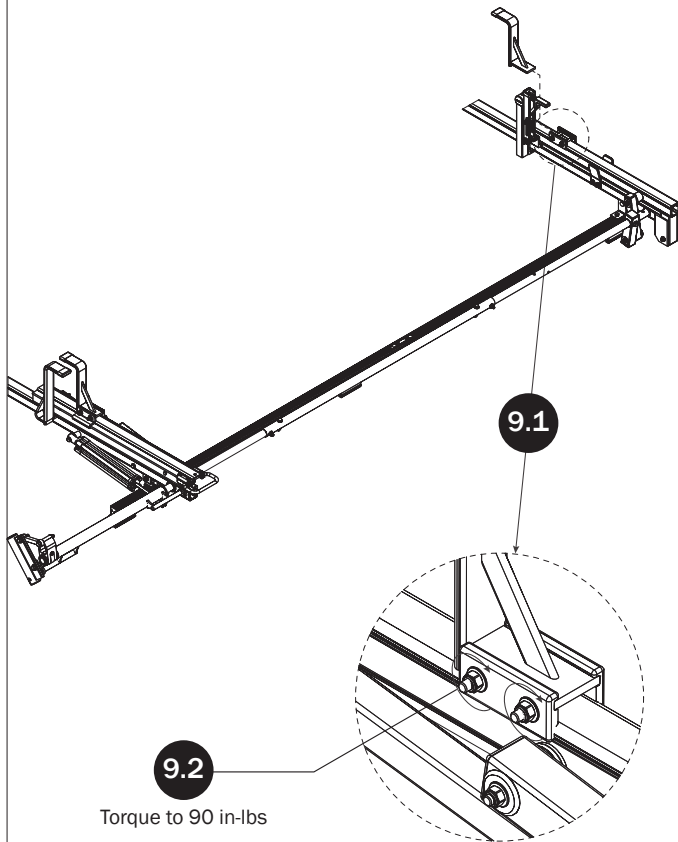
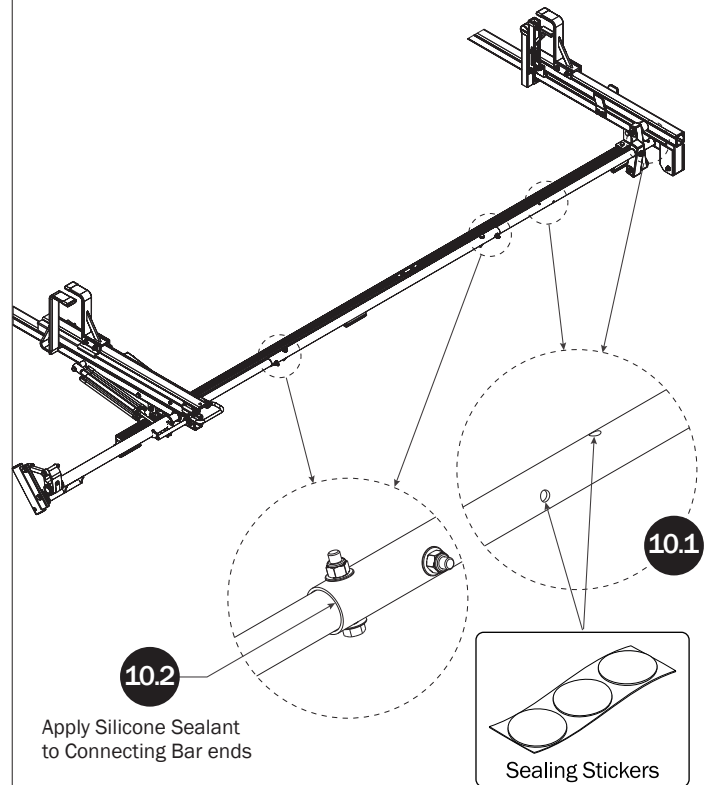
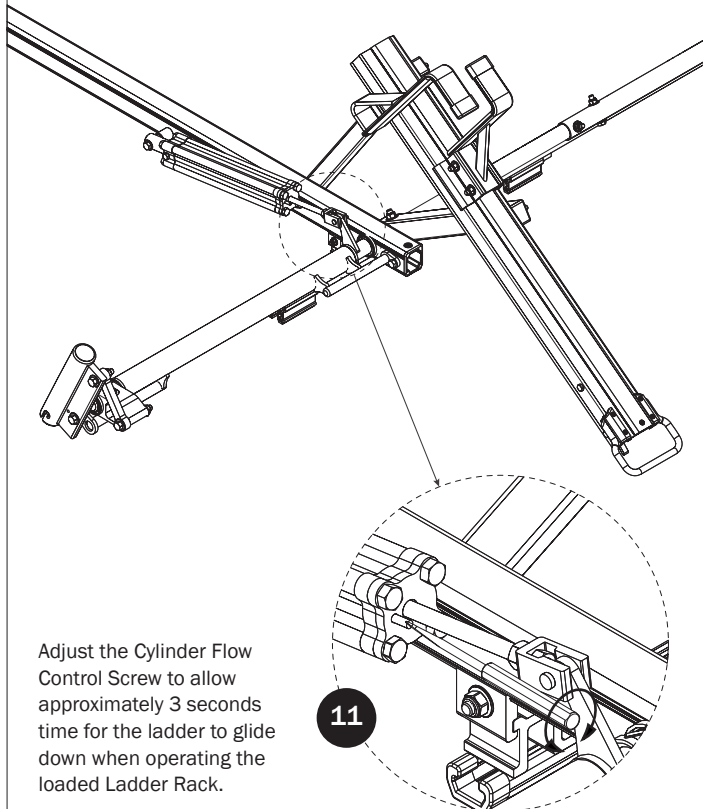
**DRIVE SHAFT SEALING****CYLINDER ADJUSTMENT**

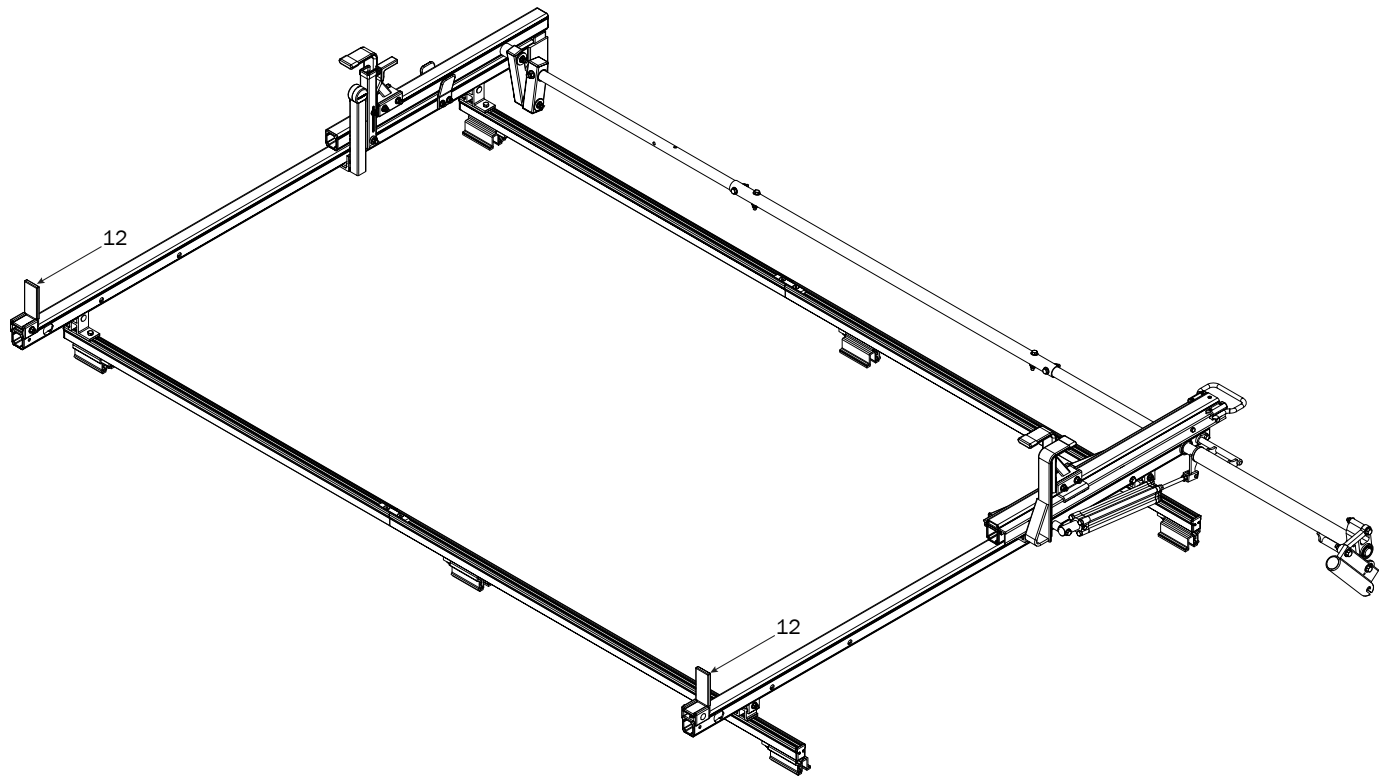
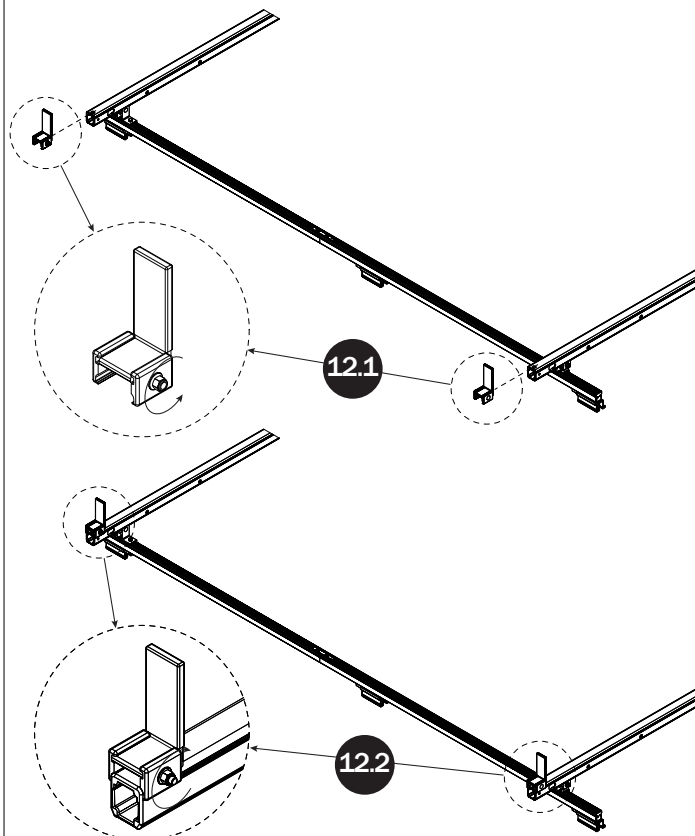
*LEFT SIDE BASE**LADDER STOPS*

Page Intentionally Left Blank

