

# PRIME DESIGN™

A Safe Fleet Brand

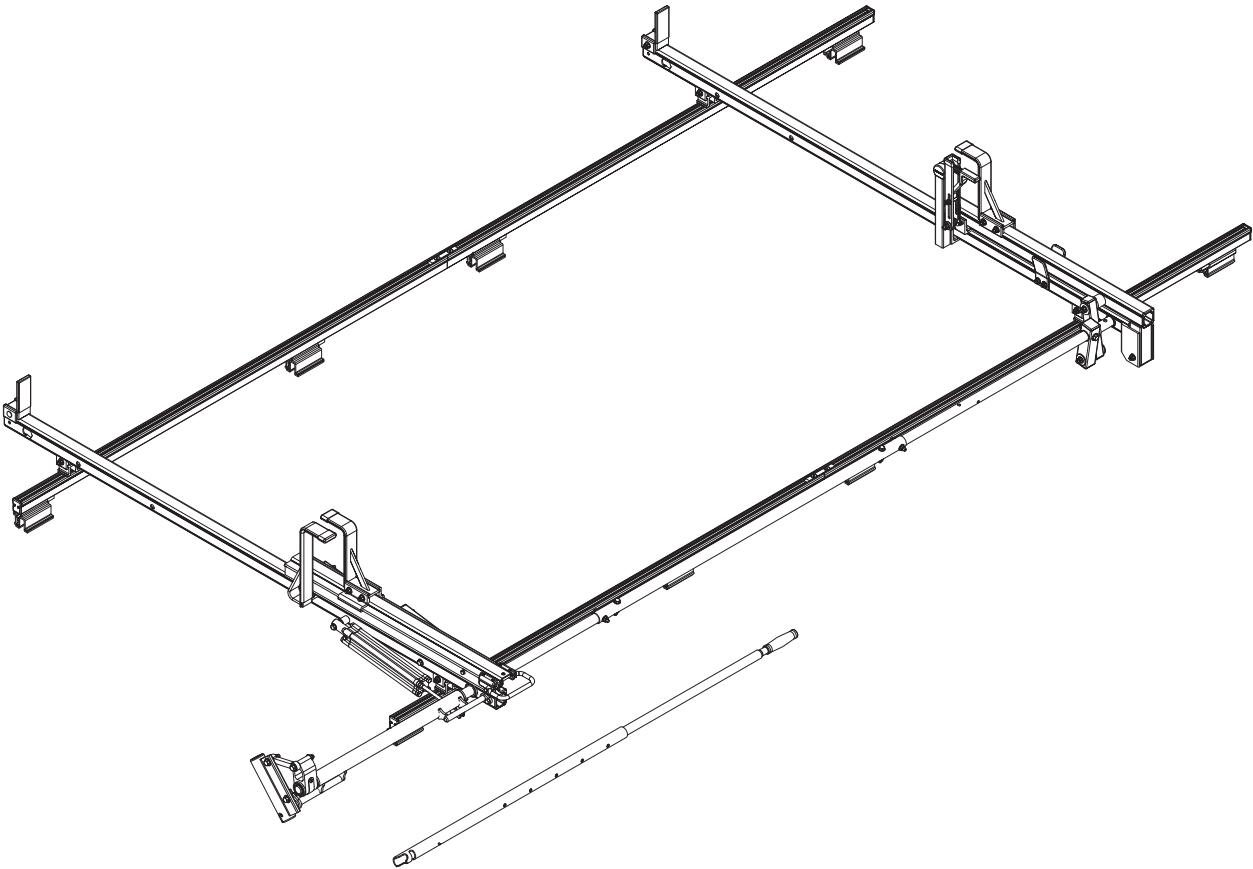

STANLEY  
E-BLH

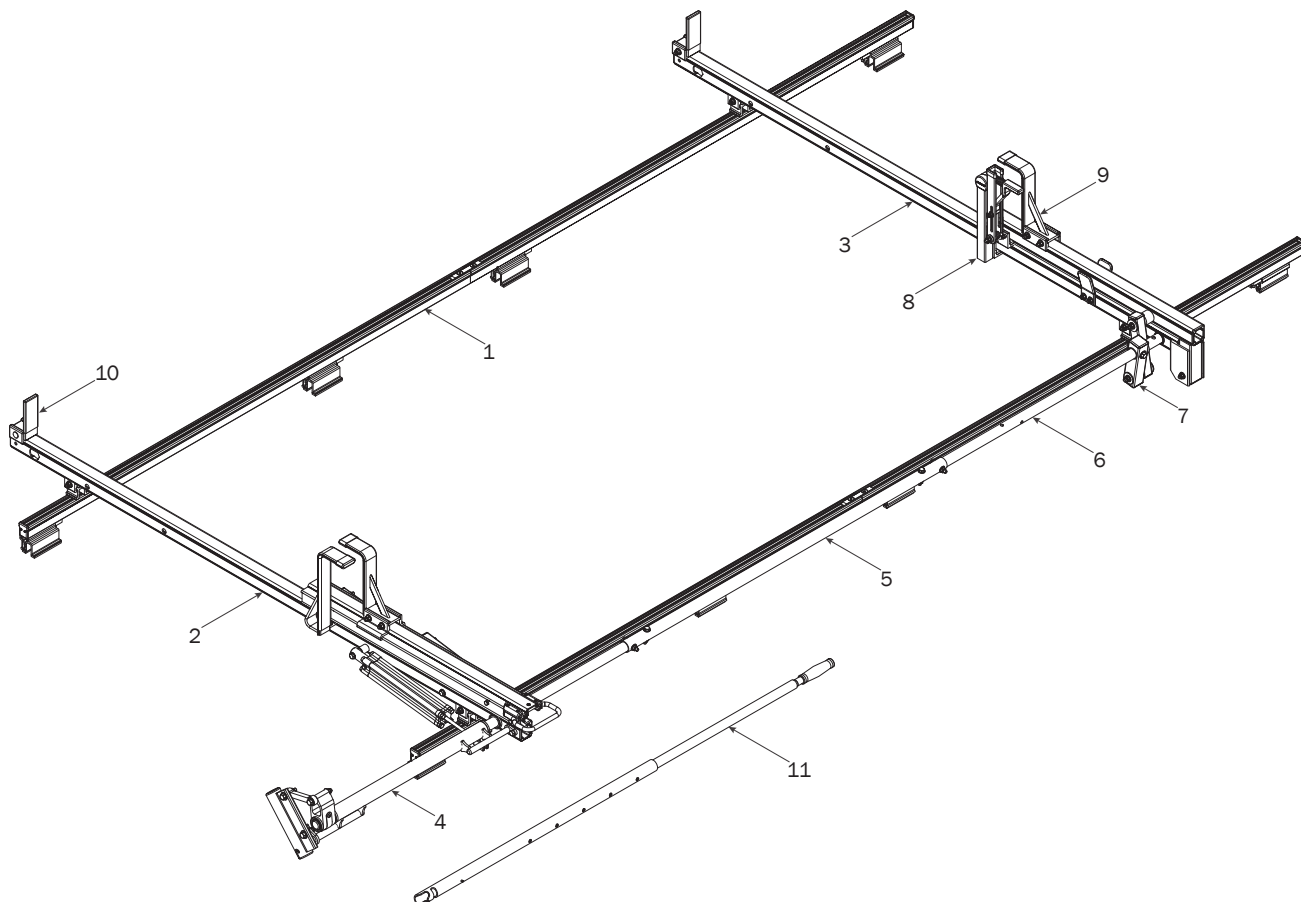

1—FBM-0014 ..... (Qty 1)  
Channels with hardware



66" Channels (4X)



End Caps (4X)



Screws (8X)



Top Connector (2X)



Bottom Connector (2X)



Brackets (4X)



Mountings (8X)

M8 Bolt (4X)

2—Rear Crossbar Assembly ..... (Qty 1)

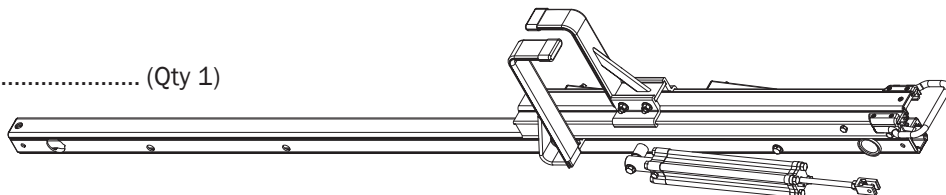

3—Front Crossbar Assembly ..... (Qty 1)

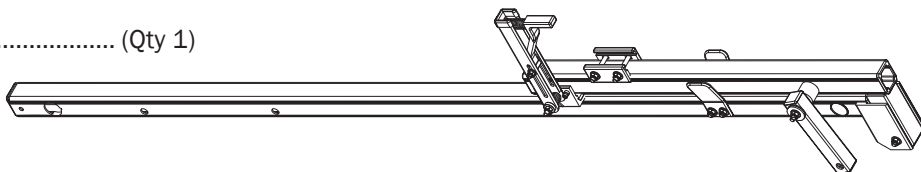

4—Drive Shaft ..... (Qty 1)  
Rear, Right Hand, 50.00"

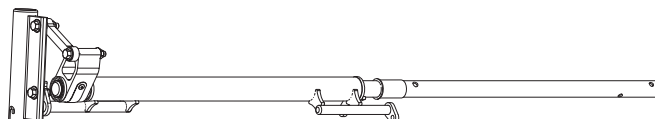

5—Connecting Bar ..... (Qty 1)  
48.00"

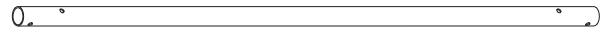

6—Front Drive Shaft ..... (Qty 1)  
B Version, 38.75"

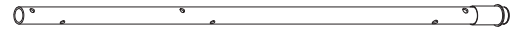

7—Drive Arm ..... (Qty 1)  
Incline Version with Bushing and Hardware

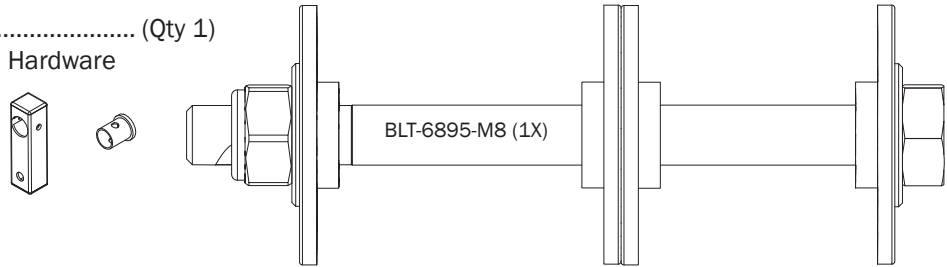

8—Z Post ..... (Qty 1)  
Adjustable, 7.25"

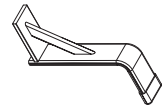

9—L Post ..... (Qty 1)  
Gen2, Roller Cap, 9.25"

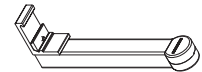

10—Ladder Stop Assembly ..... (Qty 2)  
1.75"

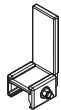

11—HRR Removeable Handle Assembly ..... (Qty 1)

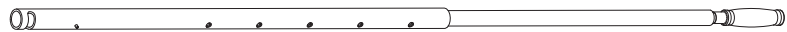

HKT-8163-Rotation Hardware Kit

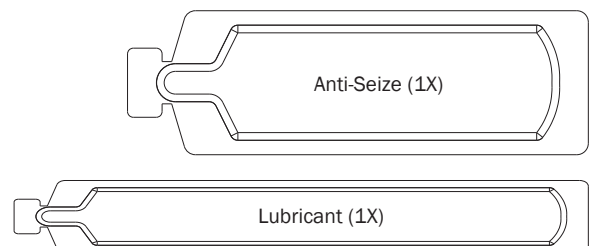
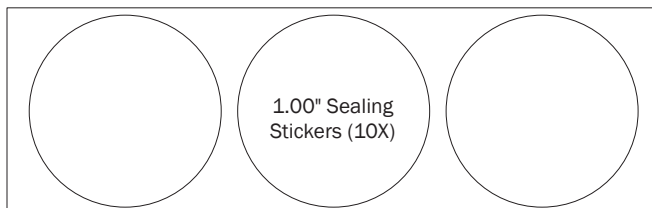
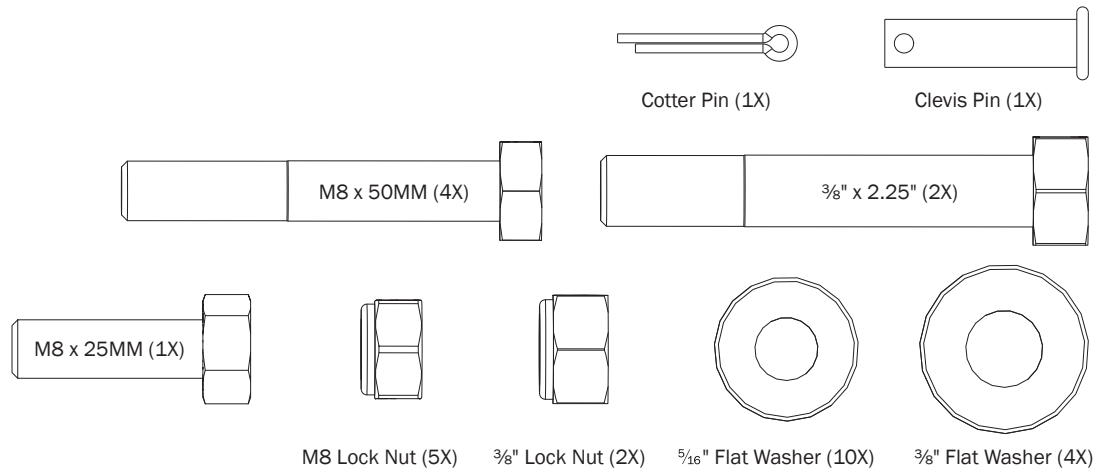

## FBM-0014 MOUNTING BRACKETS

**INSTALLER NOTE:** Mounting Brackets must be disassembled for installation onto the vehicle's roof.

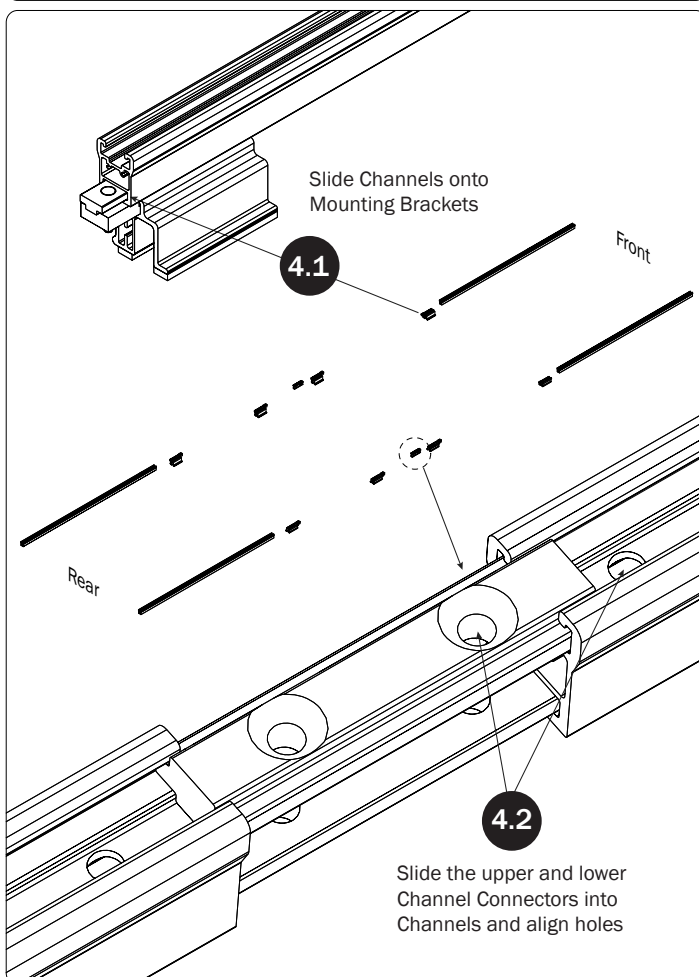
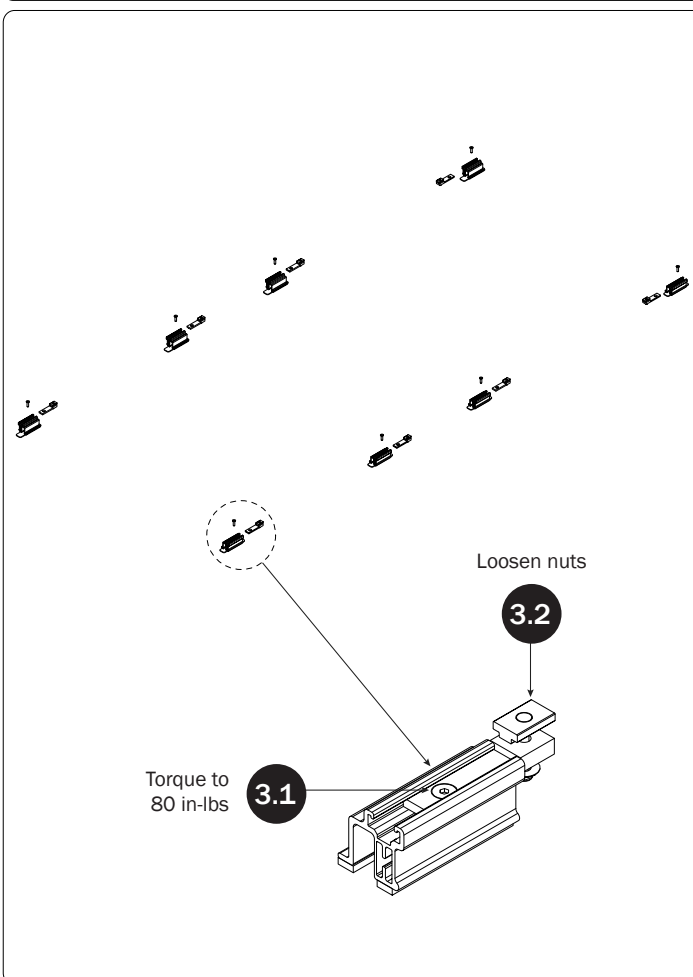
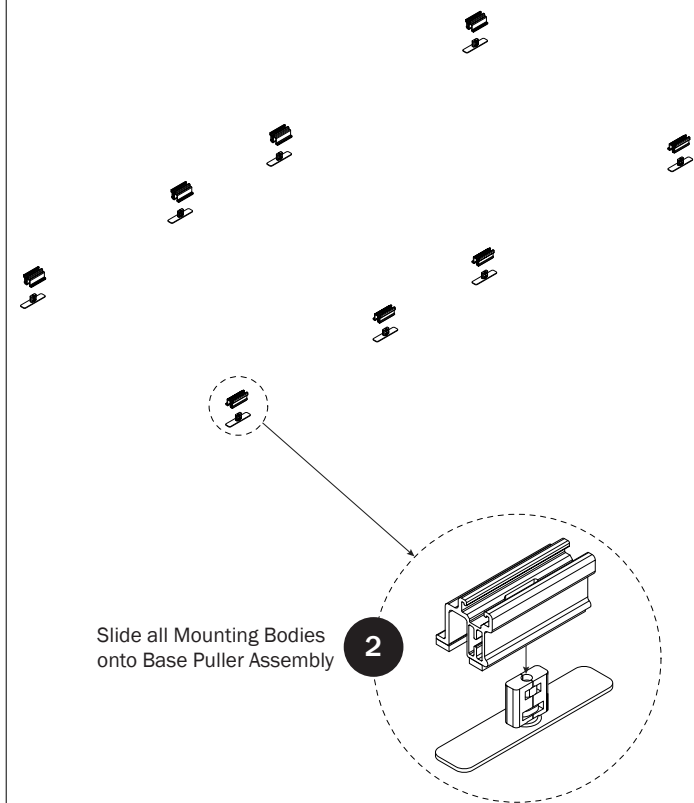
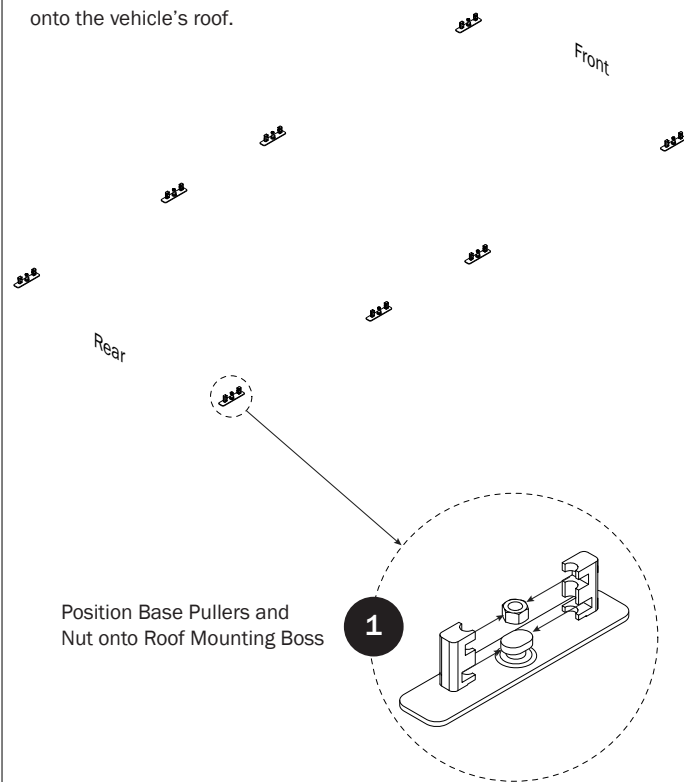

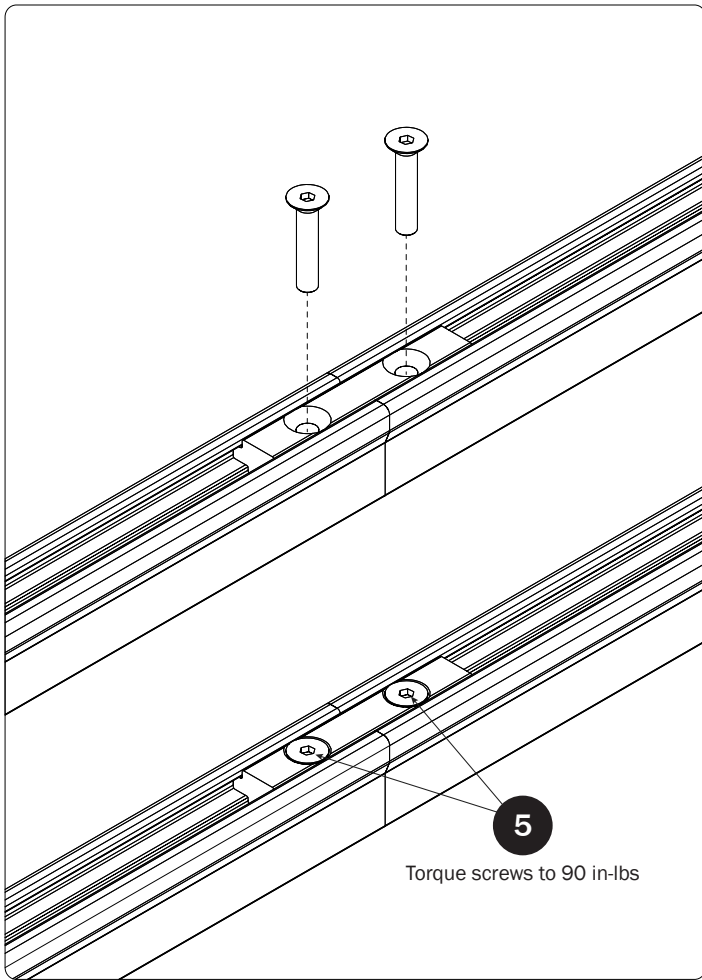

6 Set to distances then torque Mounting Bracket nuts to 80 in-lbs

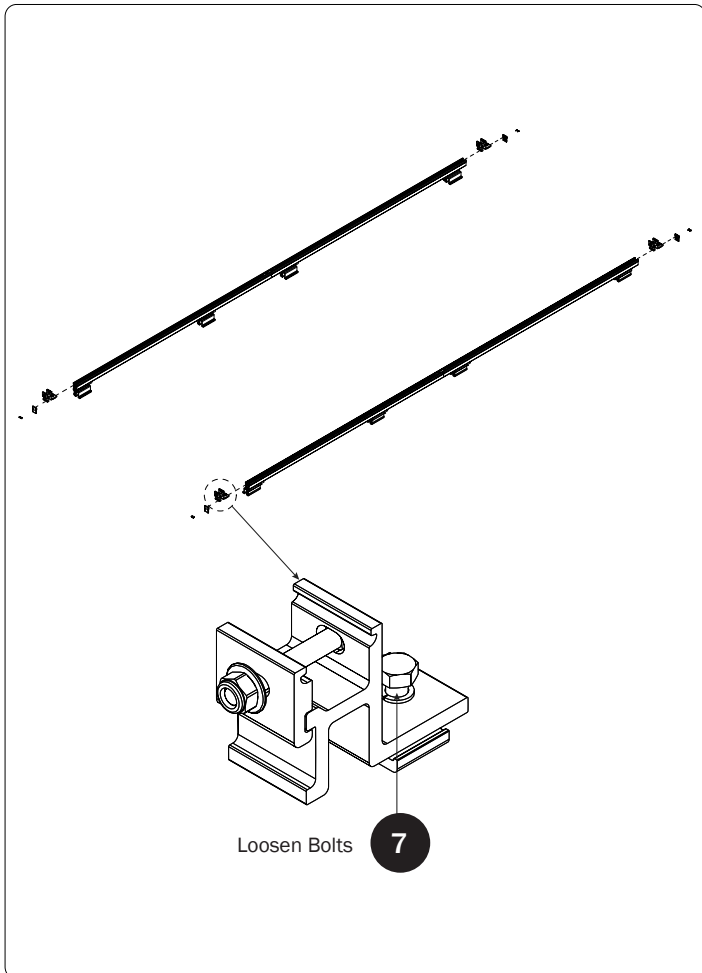
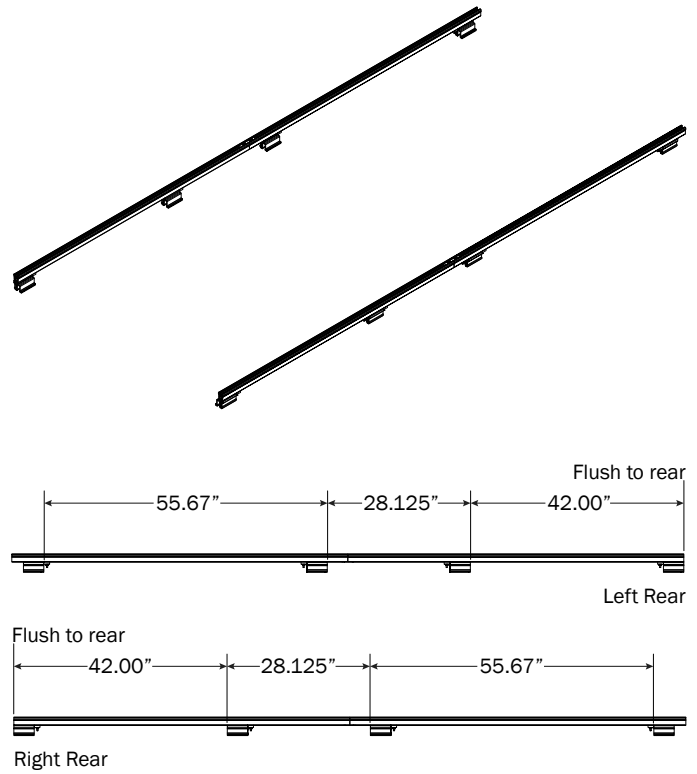

8 Set to distances then torque Mounting Bracket nuts to 90 in-lbs

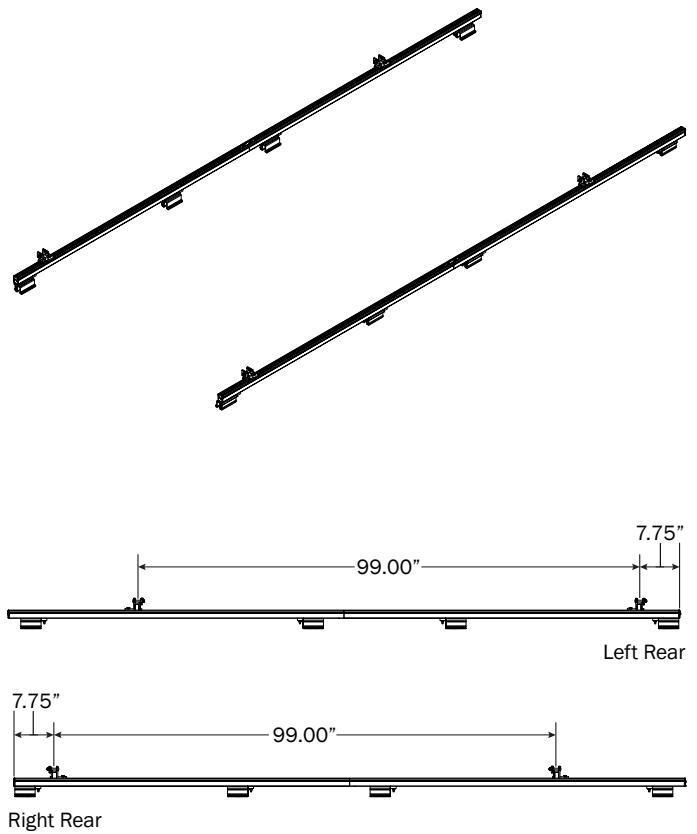

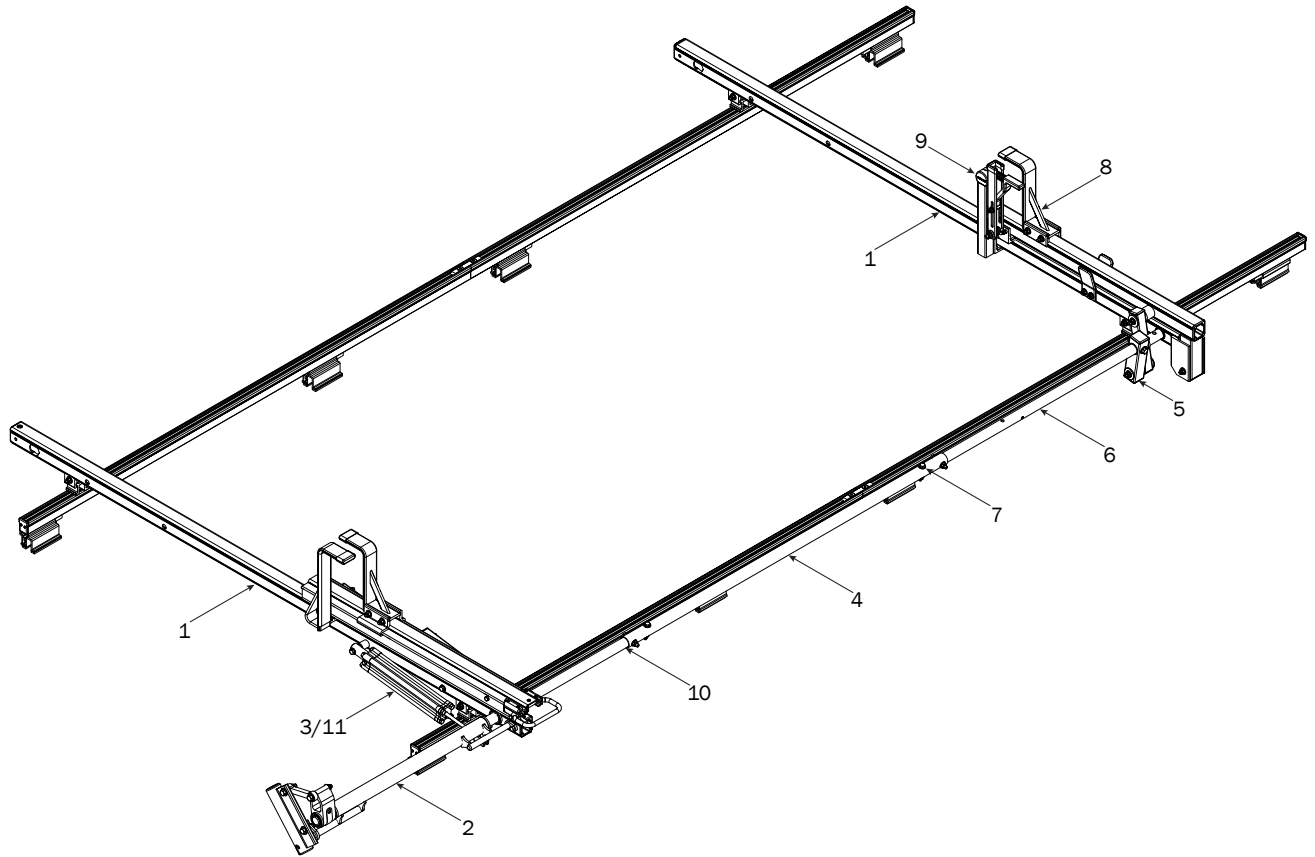
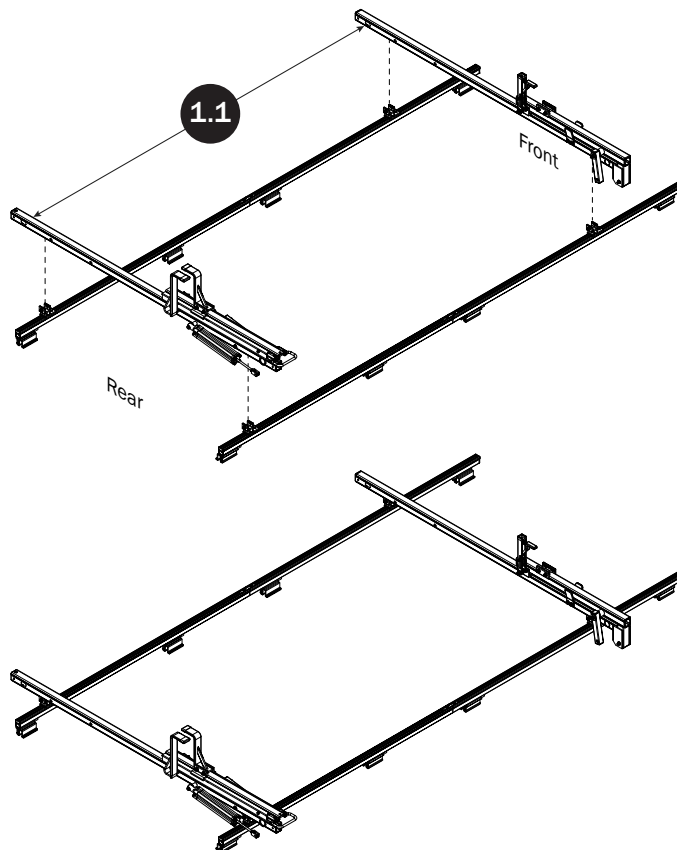
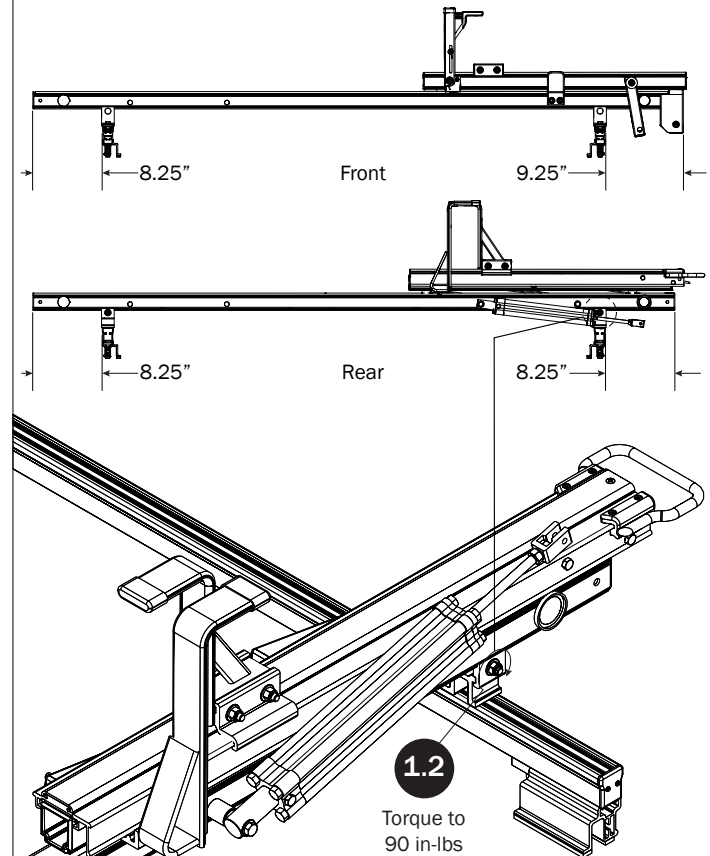
**RIGHT ROTATION ASSEMBLY****CROSSBARS****CROSSBAR ADJUSTMENT**

## REAR DRIVE SHAFT

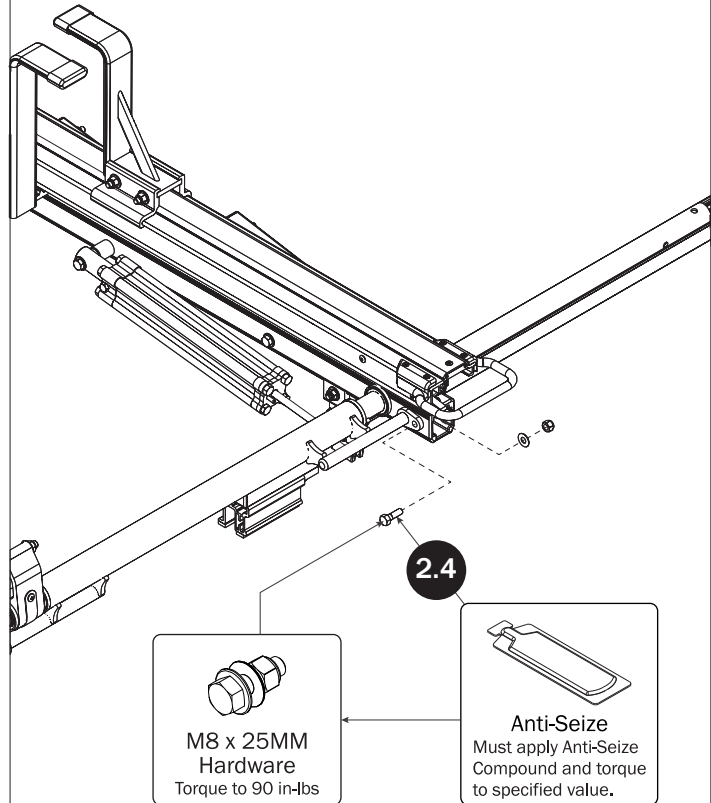
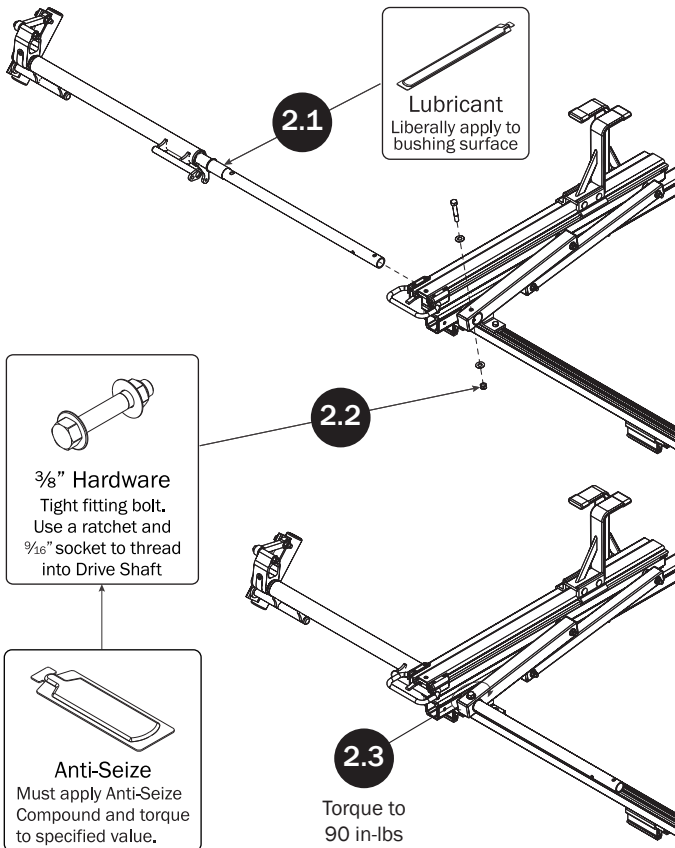

## CYLINDER HARDWARE

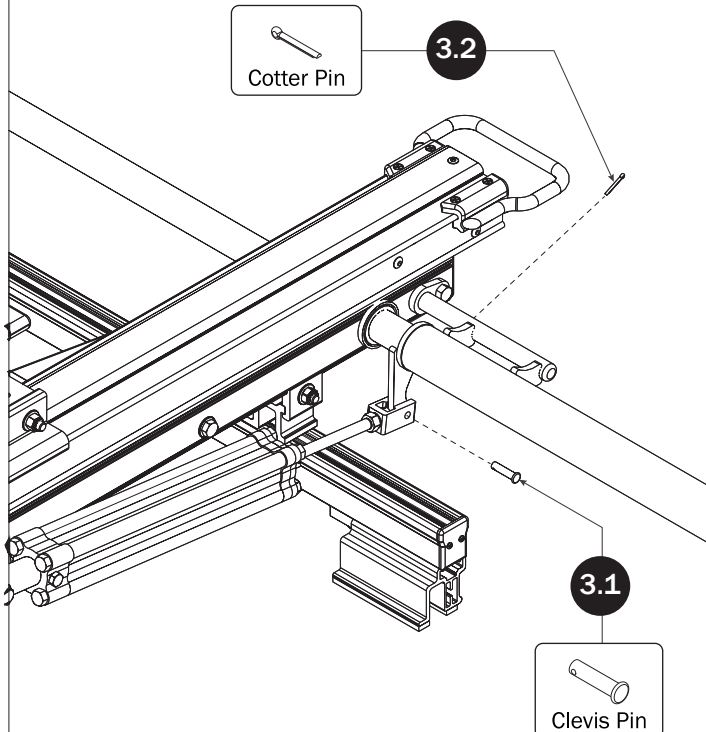

## CONNECTING BAR

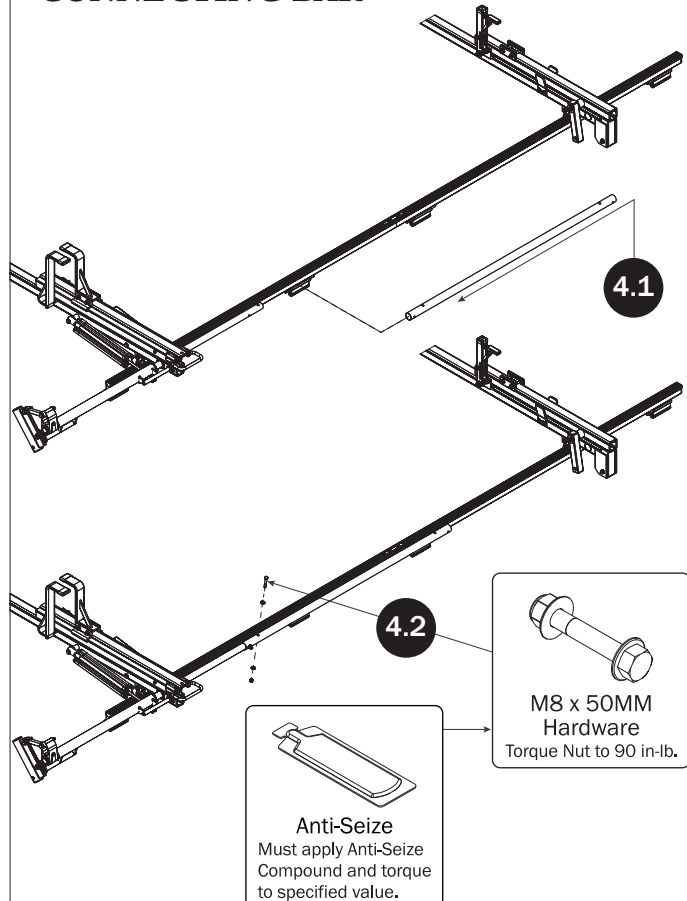



## FRONT DRIVE ARM

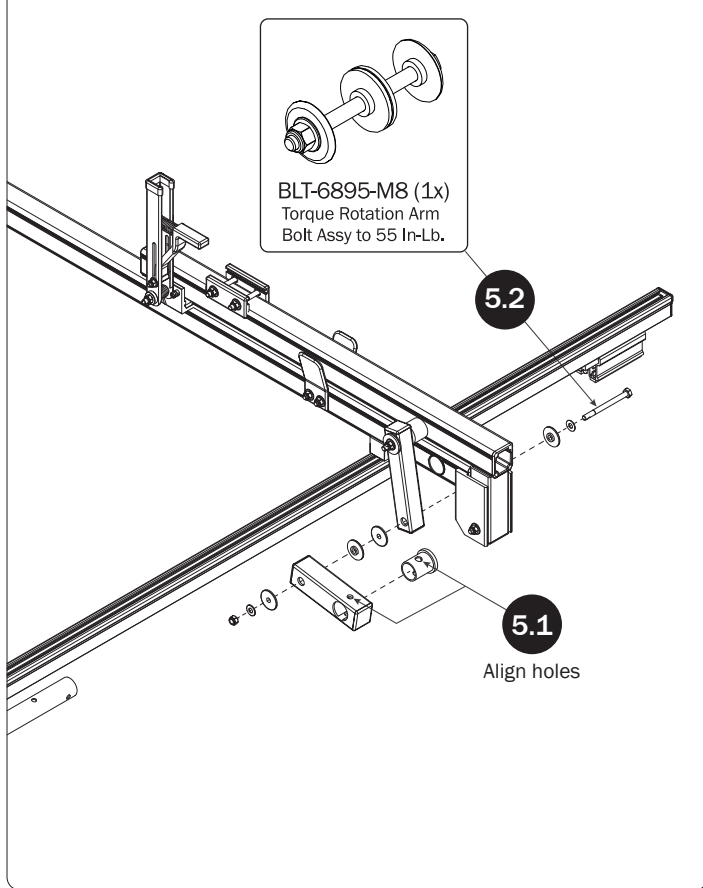

## FRONT DRIVE SHAFT

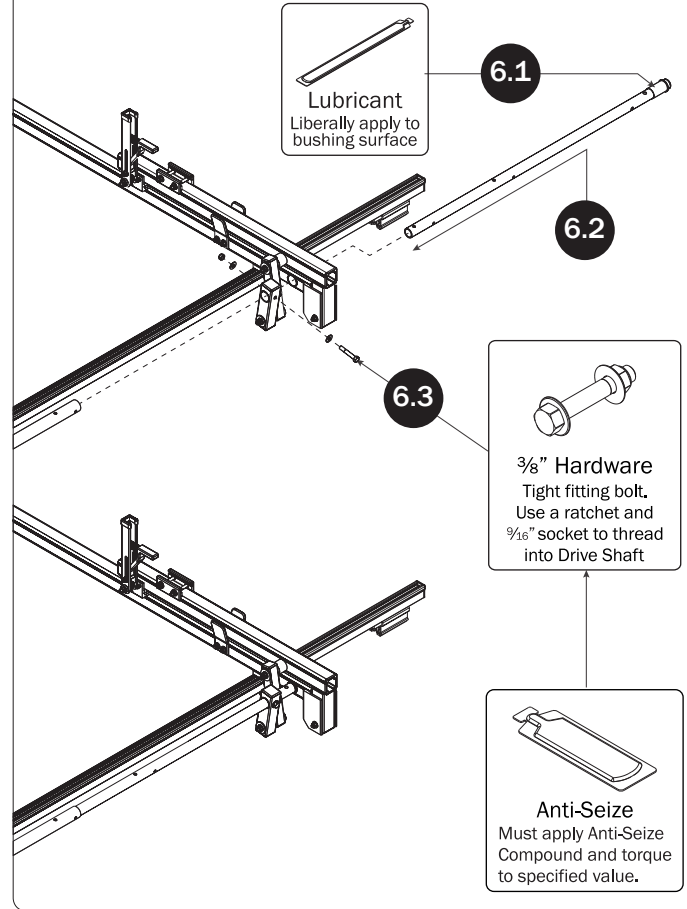

## CONNECTING BAR FASTENERS

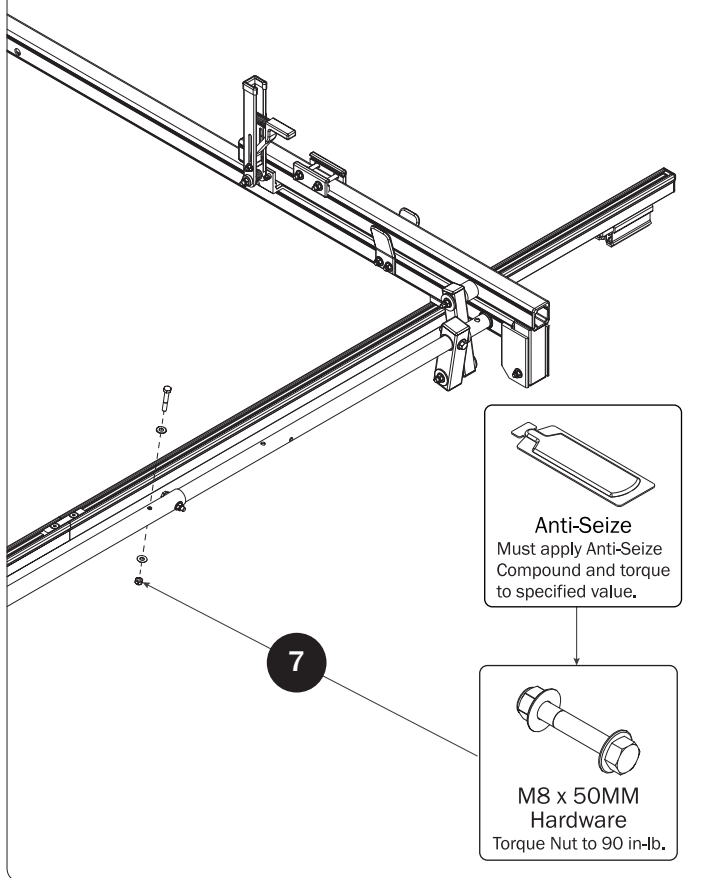

## L POST

SEE QUICK START GUIDE FOR ADJUSTMENTS

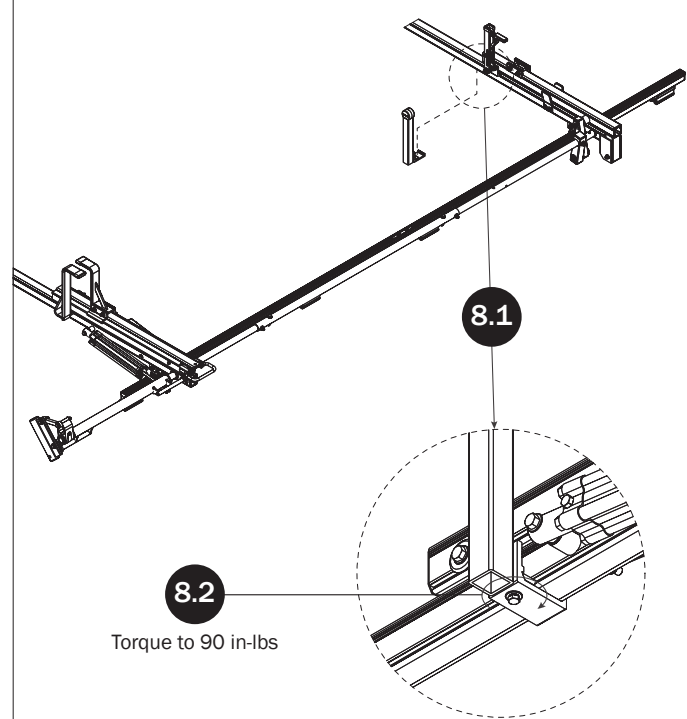



**Z POST**

SEE QUICK START GUIDE FOR ADJUSTMENTS

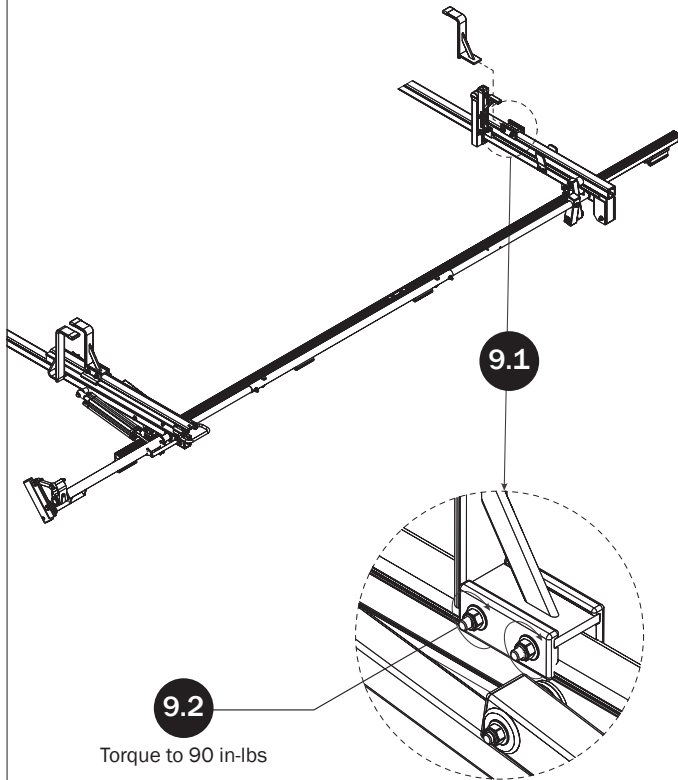
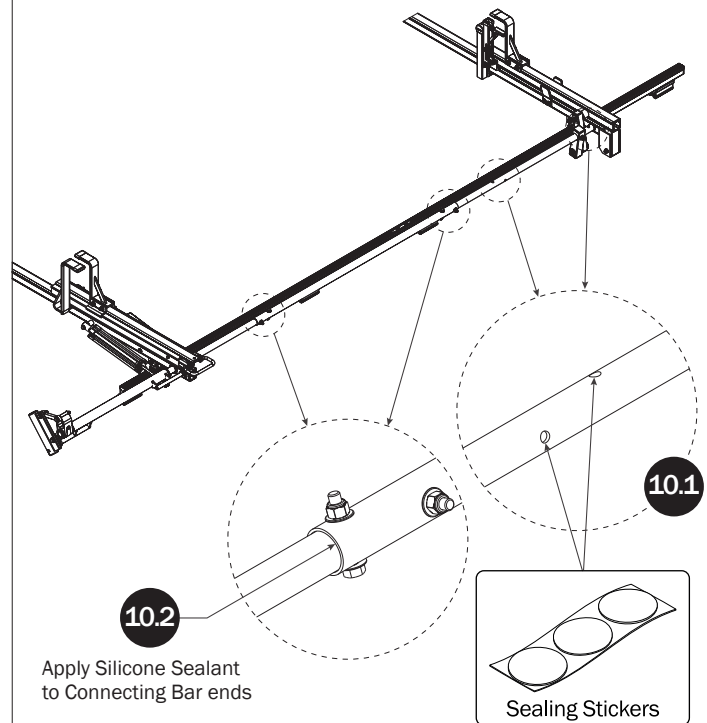
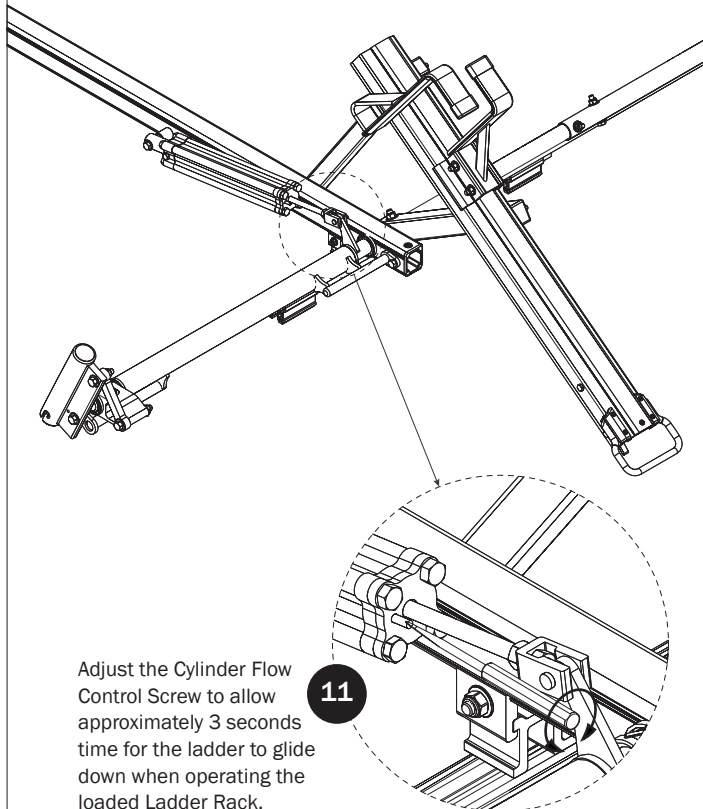
**DRIVE SHAFT SEALING****CYLINDER ADJUSTMENT**

Adjust the Cylinder Flow Control Screw to allow approximately 3 seconds time for the ladder to glide down when operating the loaded Ladder Rack.

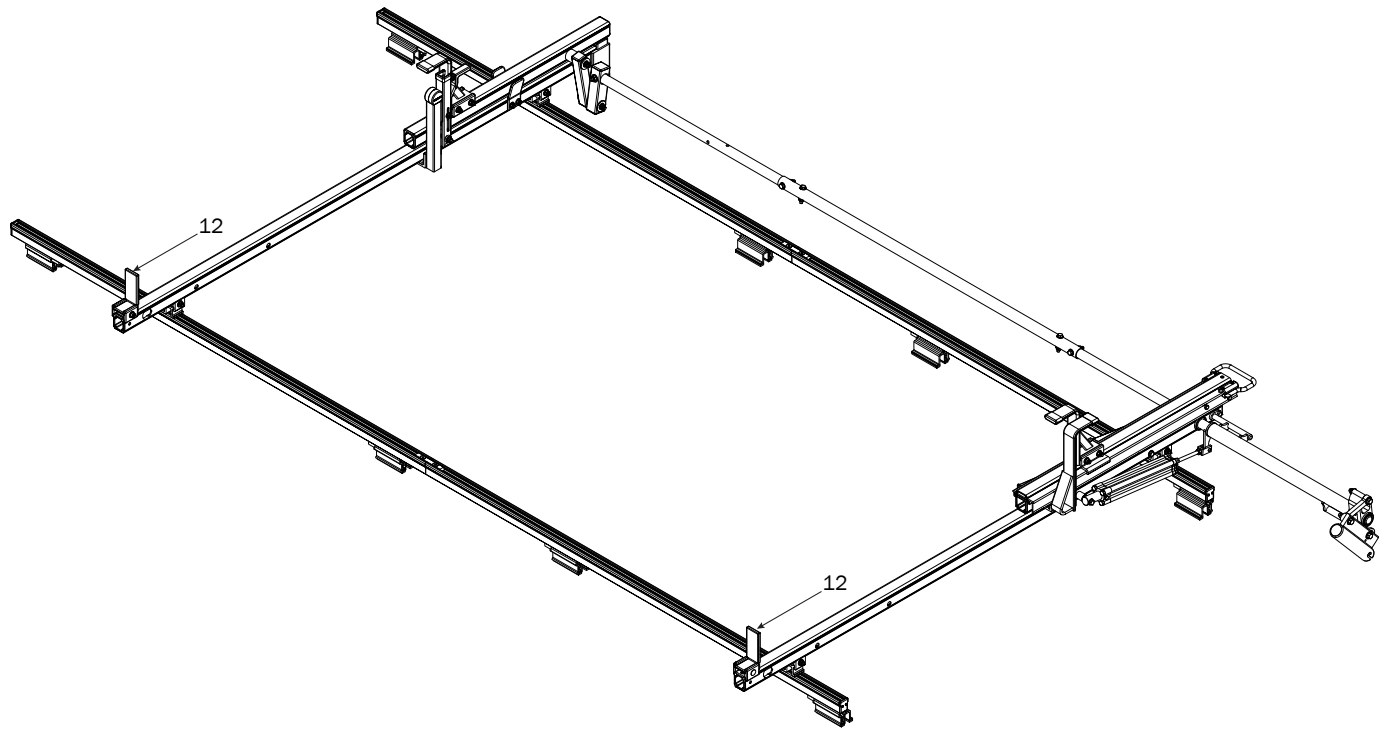
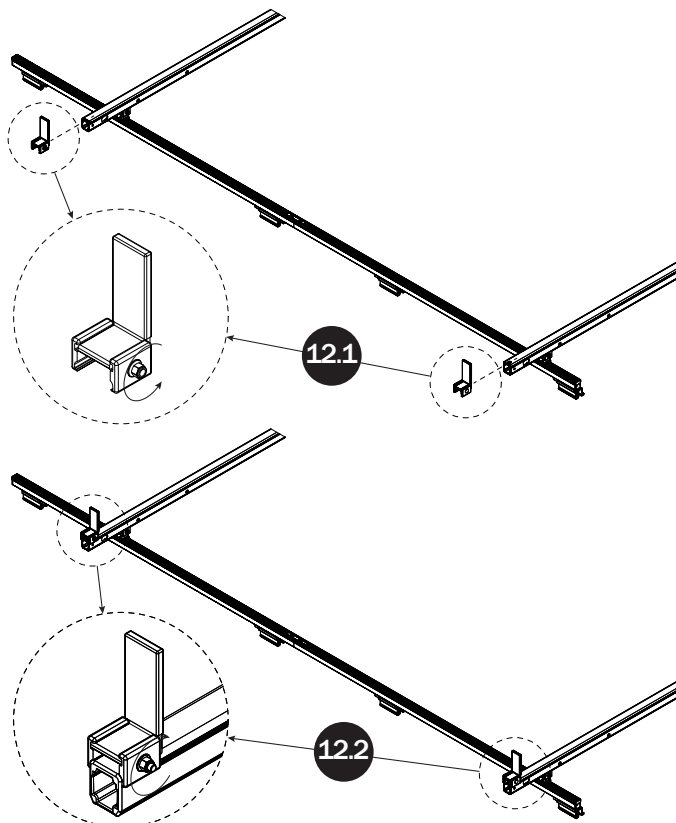
*LEFT SIDE BASE**LADDER STOPS*

Page Intentionally Left Blank

