

PRIME DESIGN™

A Safe Fleet Brand

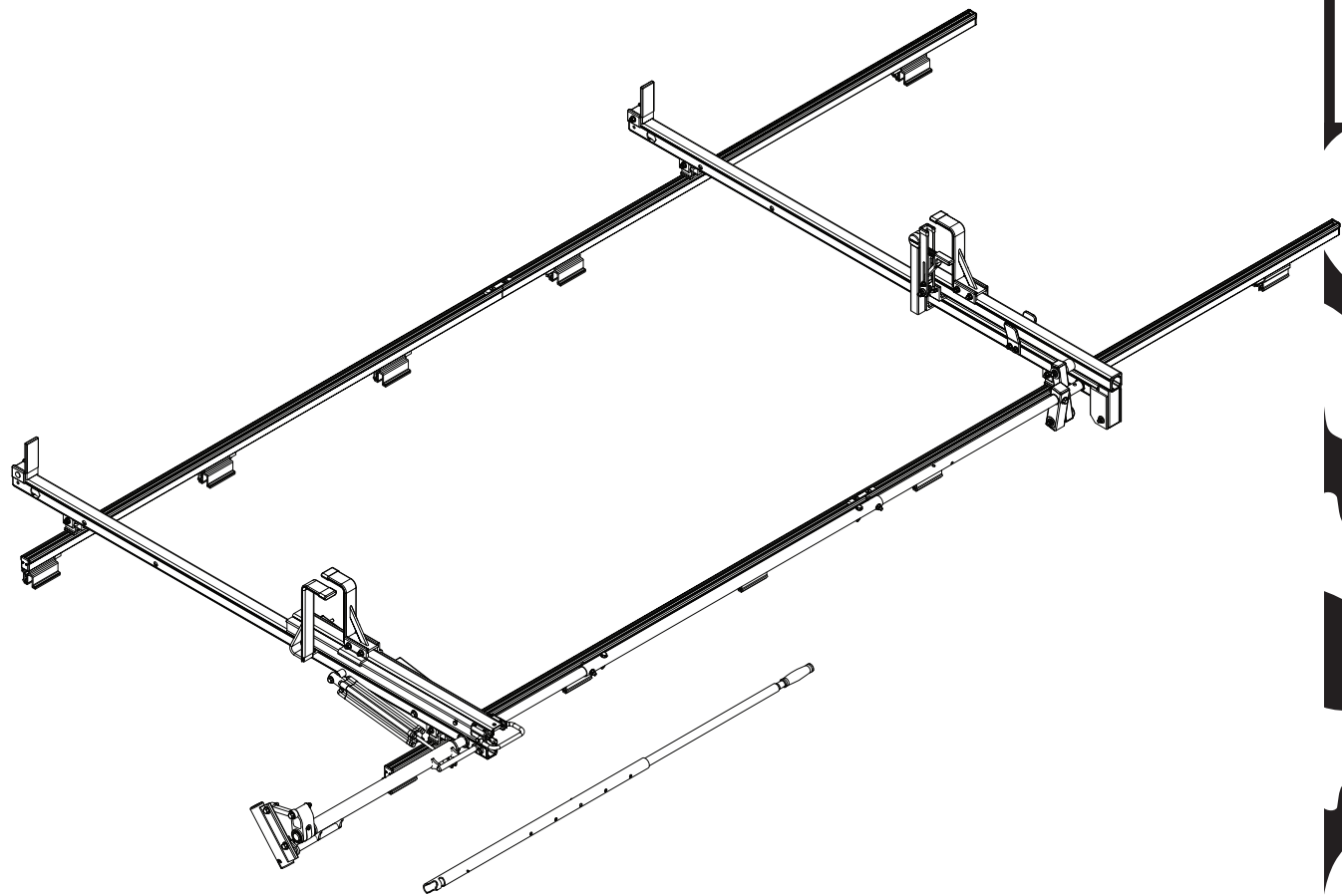

DN5
E-BI-E

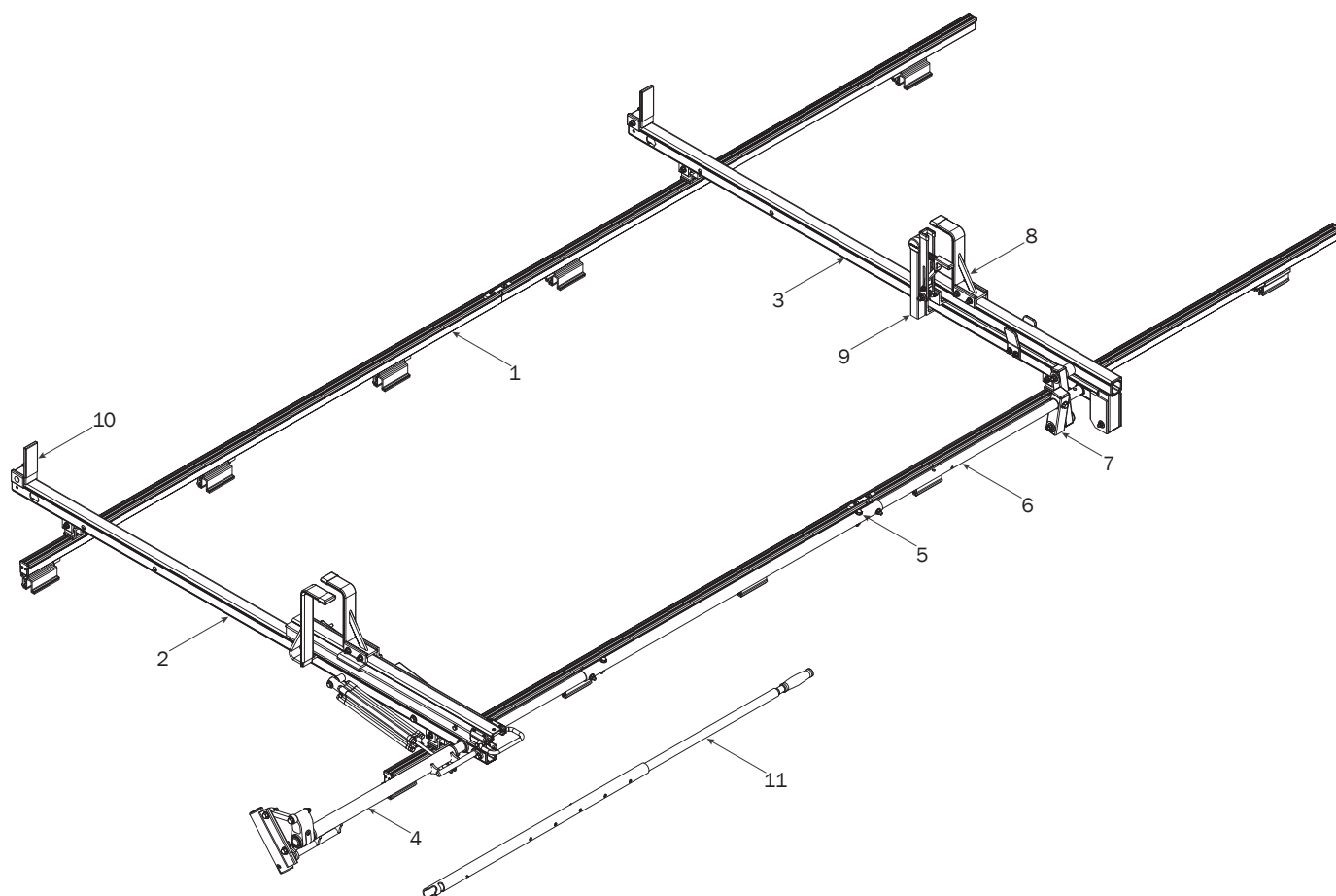

- 1—FBM-0015 (Qty 1)
Channels with hardware



76" Channels (4X)

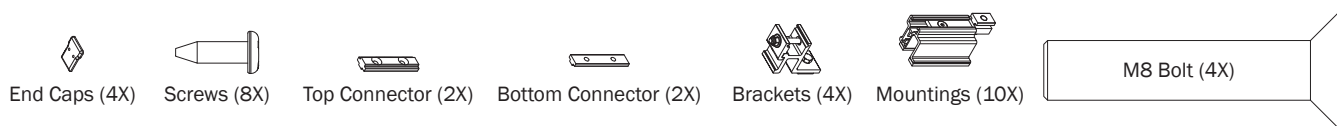

- 2—Rear Crossbar Assembly (Qty 1)

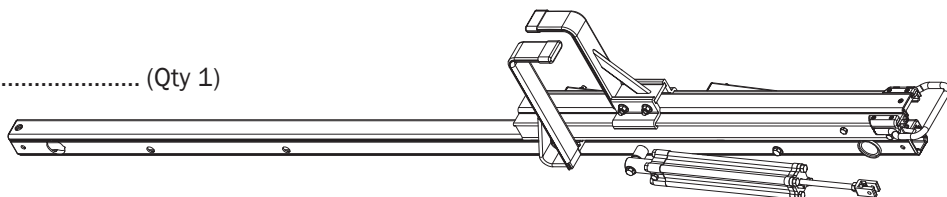

- 3—Front Crossbar Assembly (Qty 1)

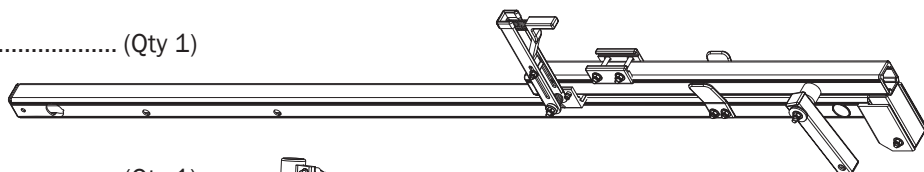

- 4—Drive Shaft (Qty 1)
Rear, Right Hand, 50.00"

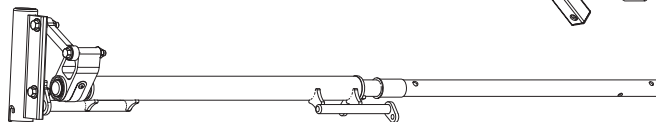

5—Connecting Bar (Qty 1)
48.00"

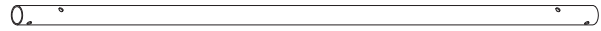

6—Front Drive Shaft (Qty 1)
B Version, 38.75"

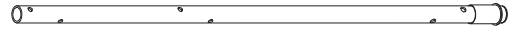

7—Drive Arm (Qty 1)
Incline Version with Bushing and Hardware

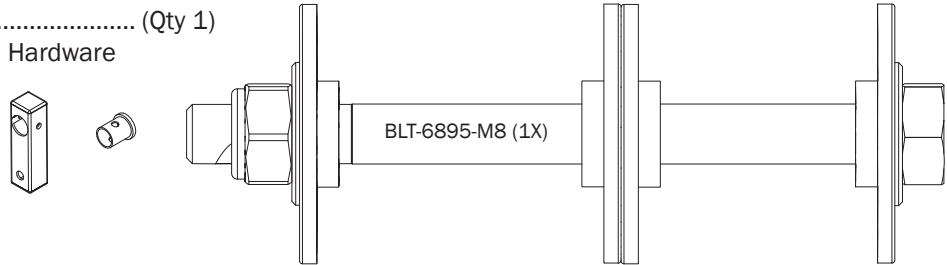

8—Z Post (Qty 1)
Adjustable 7.25"

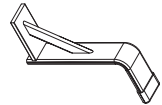

9—L Post (Qty 1)
Gen2, Roller Cap , 9.25"

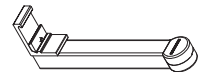

10—Ladder Stop Assembly (Qty 2)
1.75"

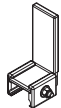

11—HRR Removeable Handle Assembly (Qty 1)

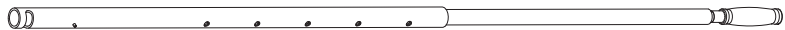

HKT-8163-Rotation Hardware Kit

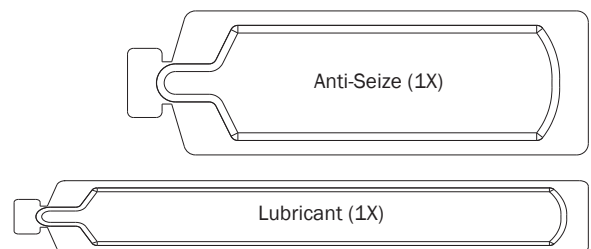
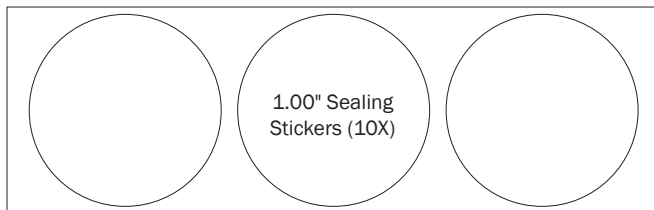
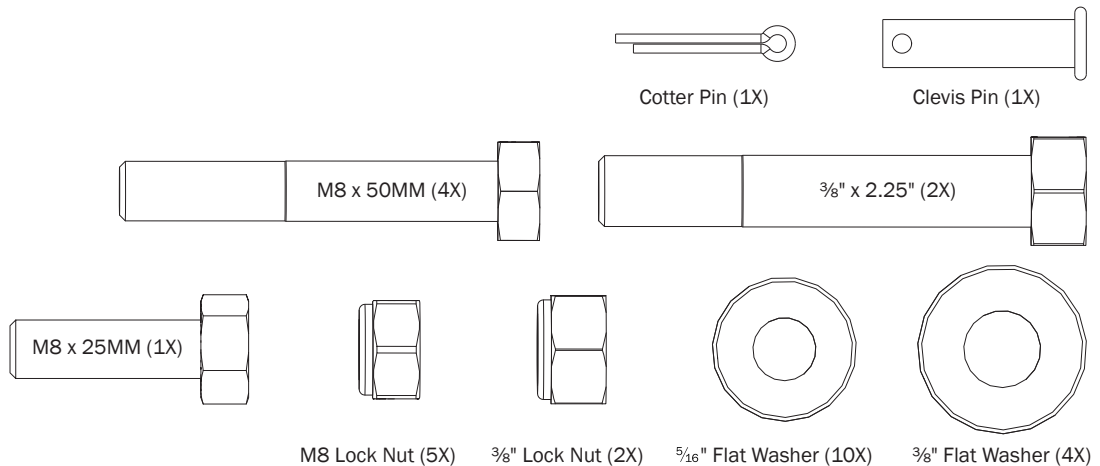

FBM-0015 MOUNTING BRACKETS

INSTALLER NOTE: Mounting Brackets must be disassembled for installation onto the vehicle's roof.

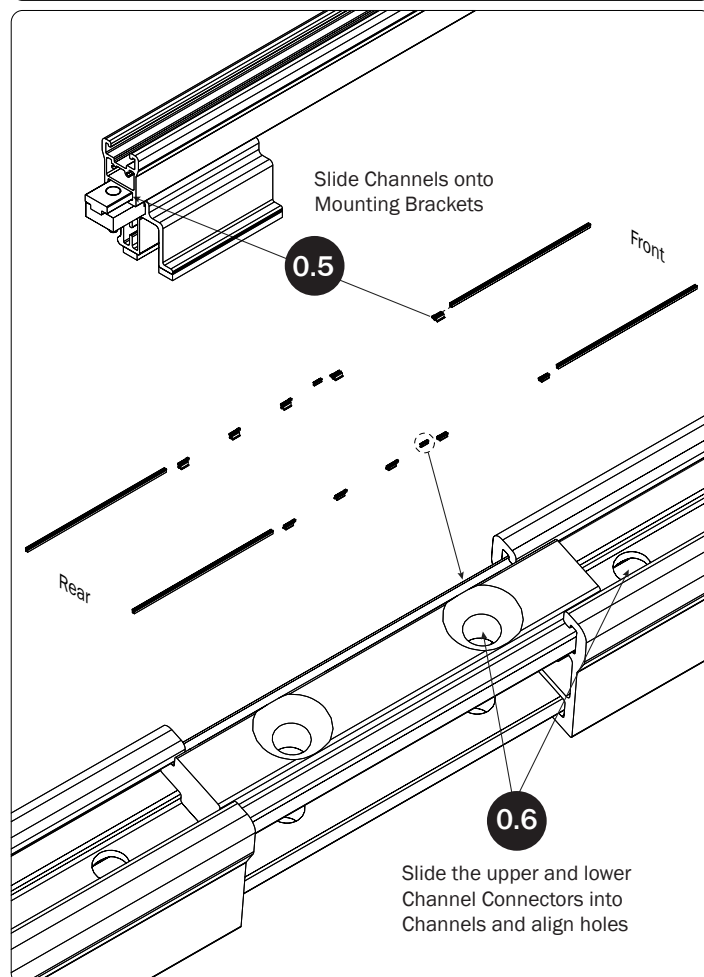
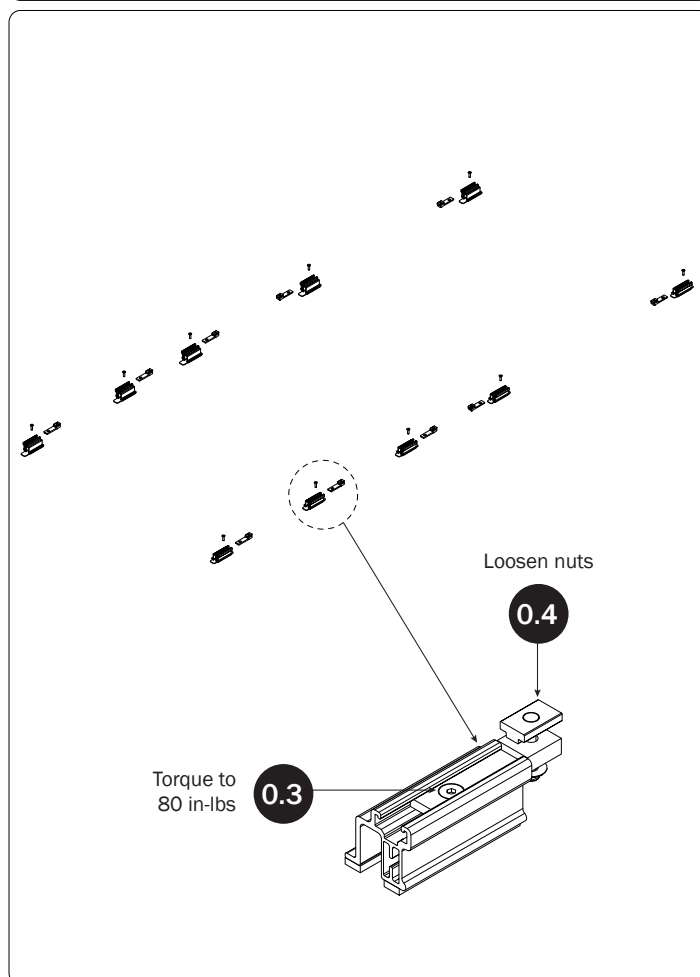
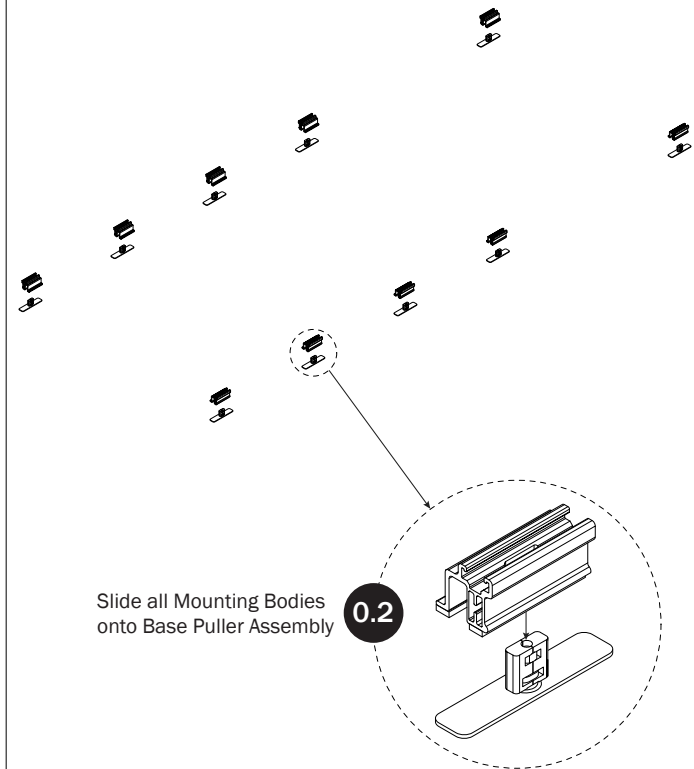
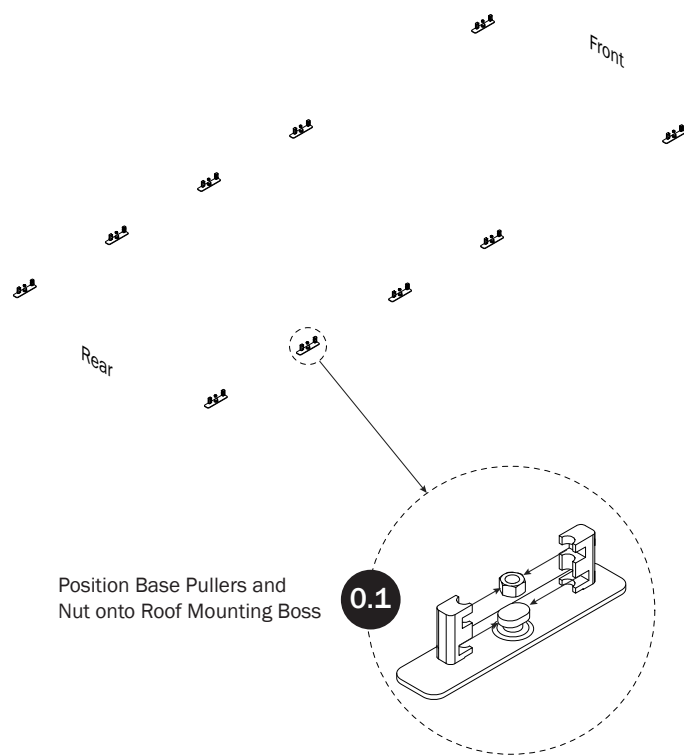

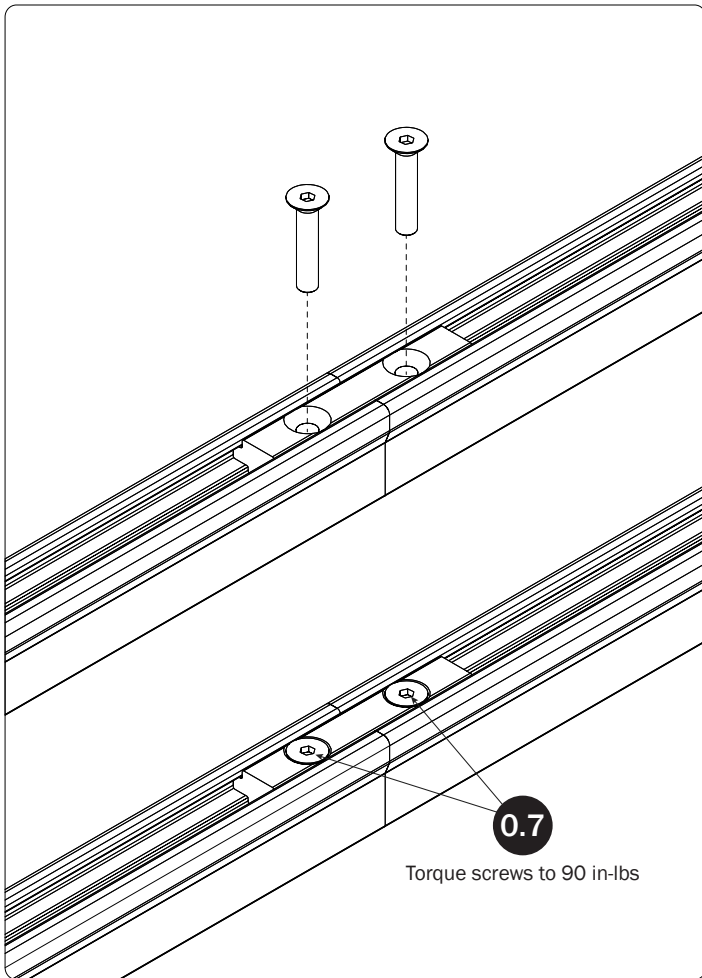

0.8 Set to distances then torque Mounting Bracket nuts to 80 in-lbs

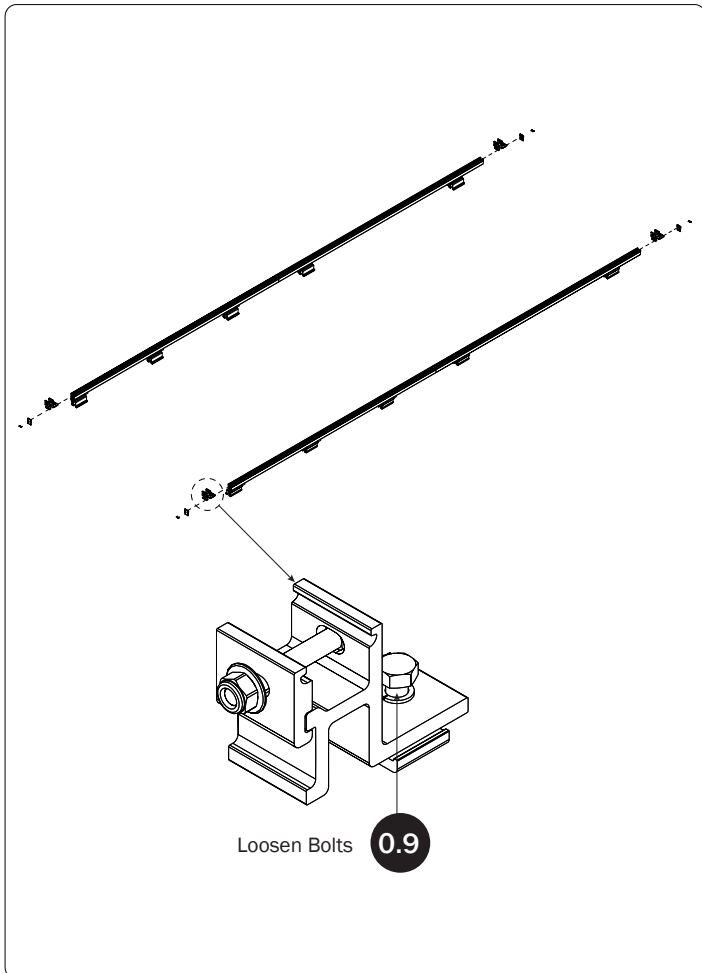
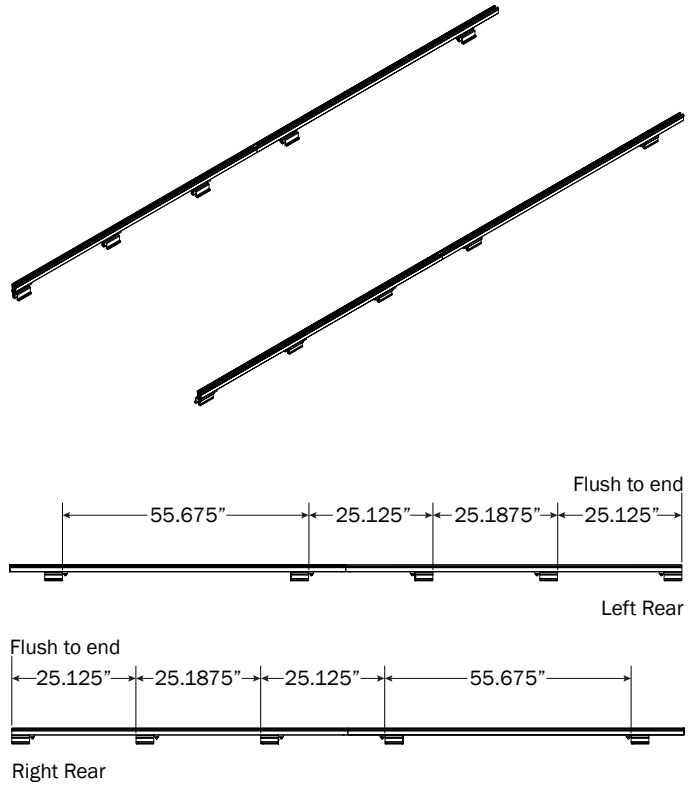

0.10 Set to distances then torque Mounting Bracket nuts to 90 in-lbs

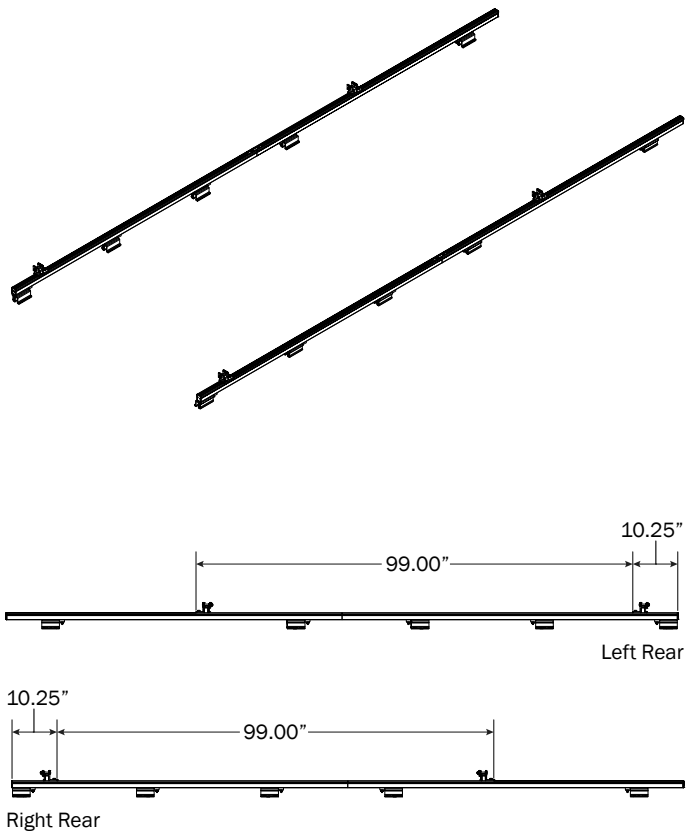

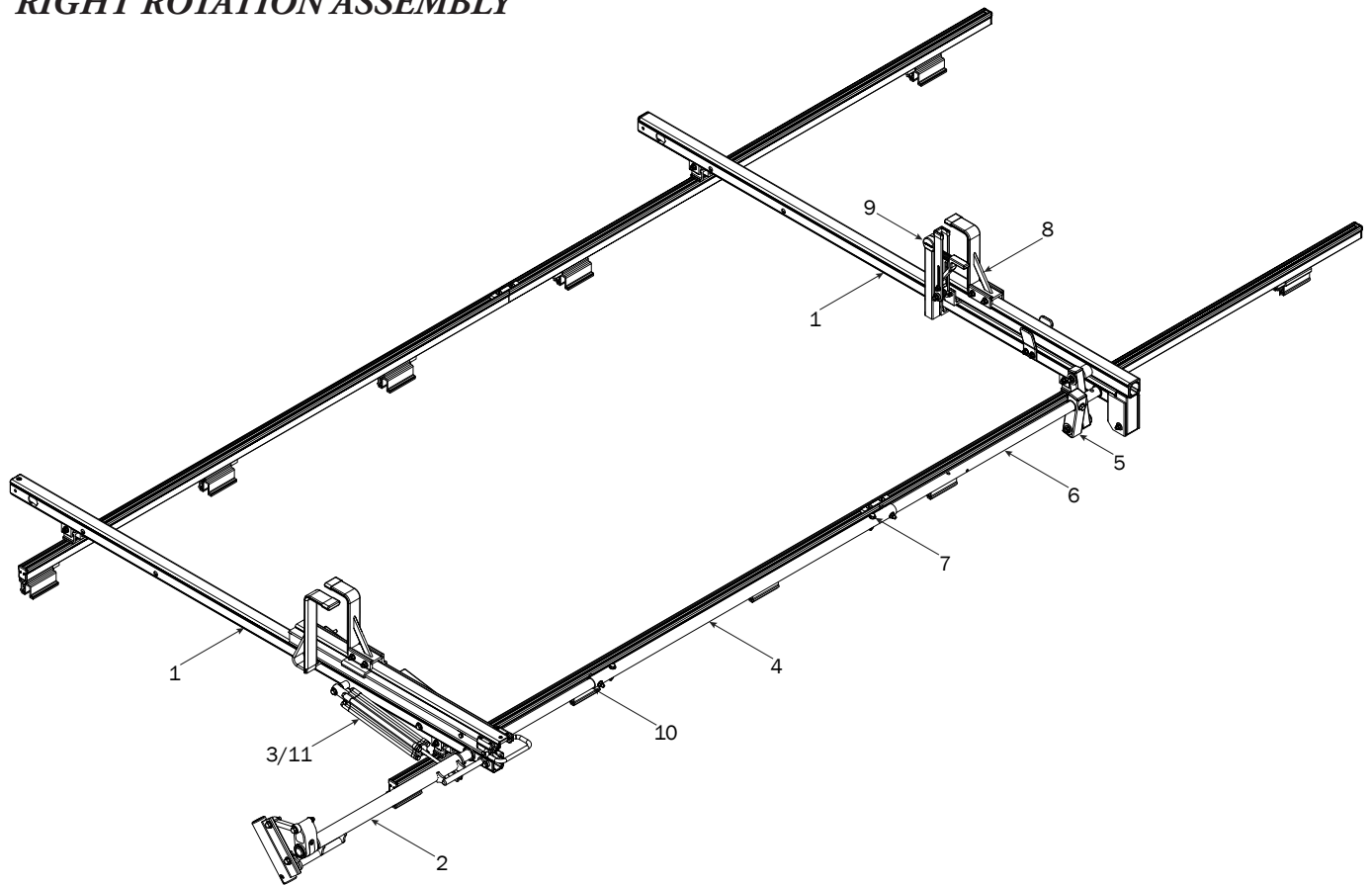
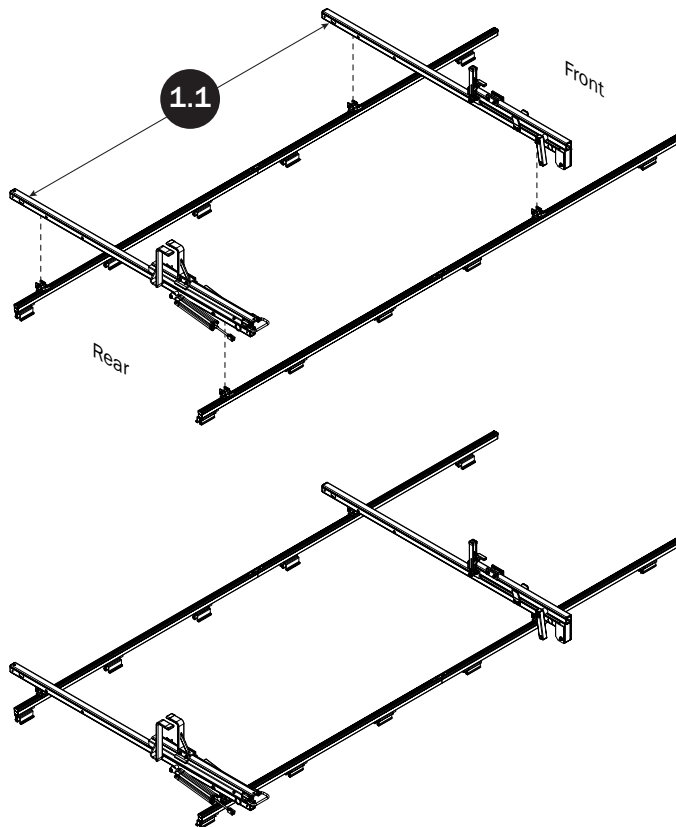
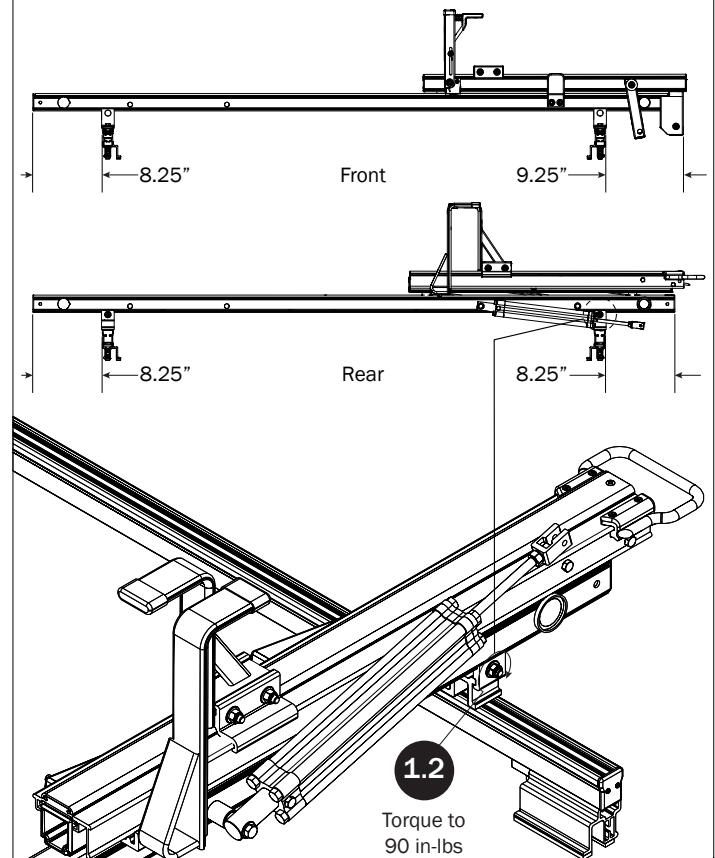
RIGHT ROTATION ASSEMBLY**CROSSBARS****CROSSBAR ADJUSTMENT**

REAR DRIVE SHAFT

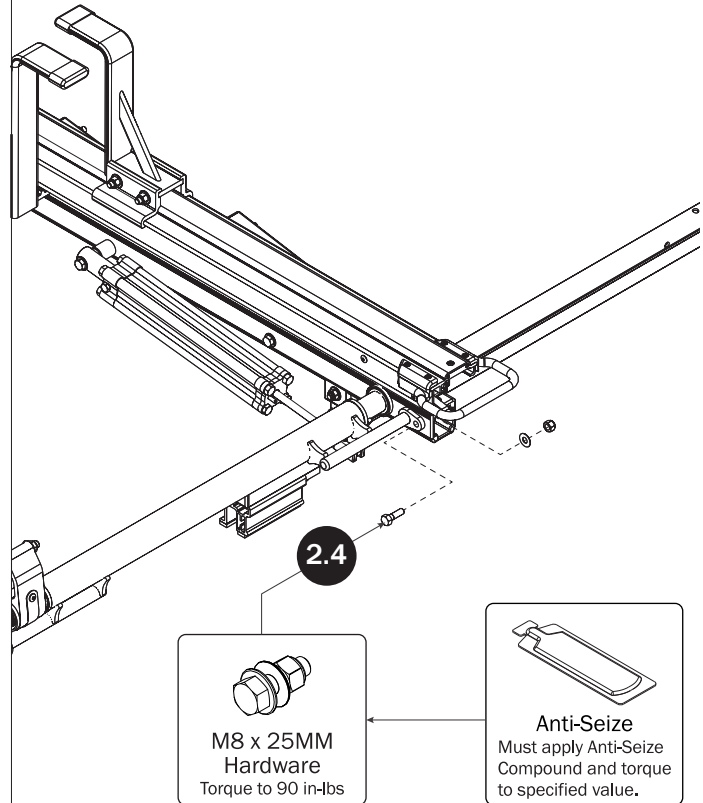
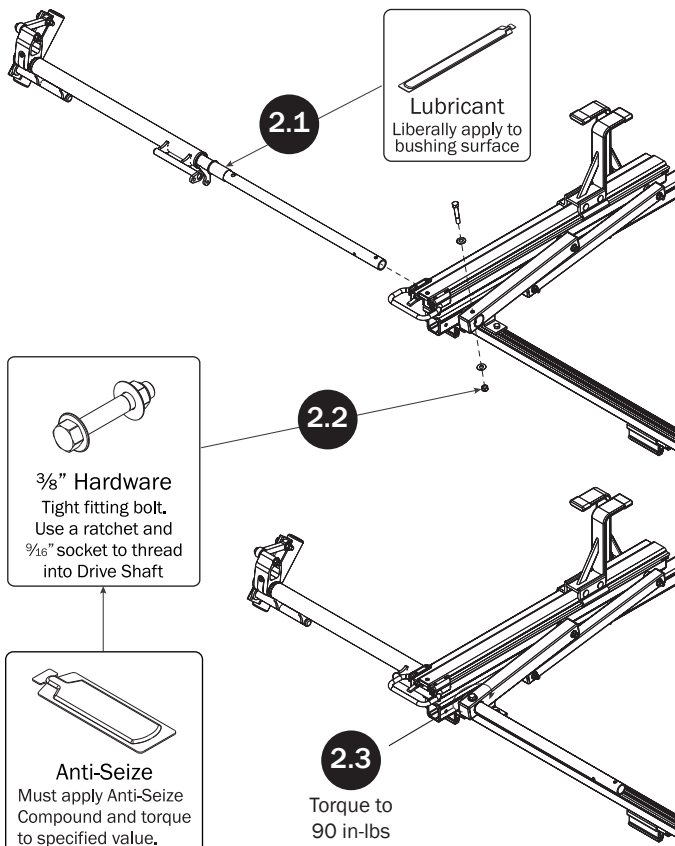

CYLINDER HARDWARE

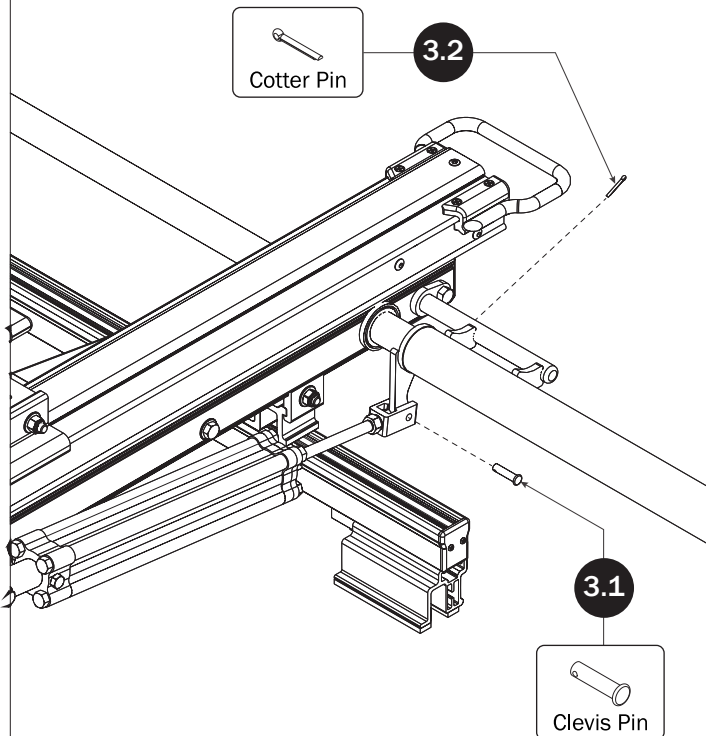

CONNECTING BAR

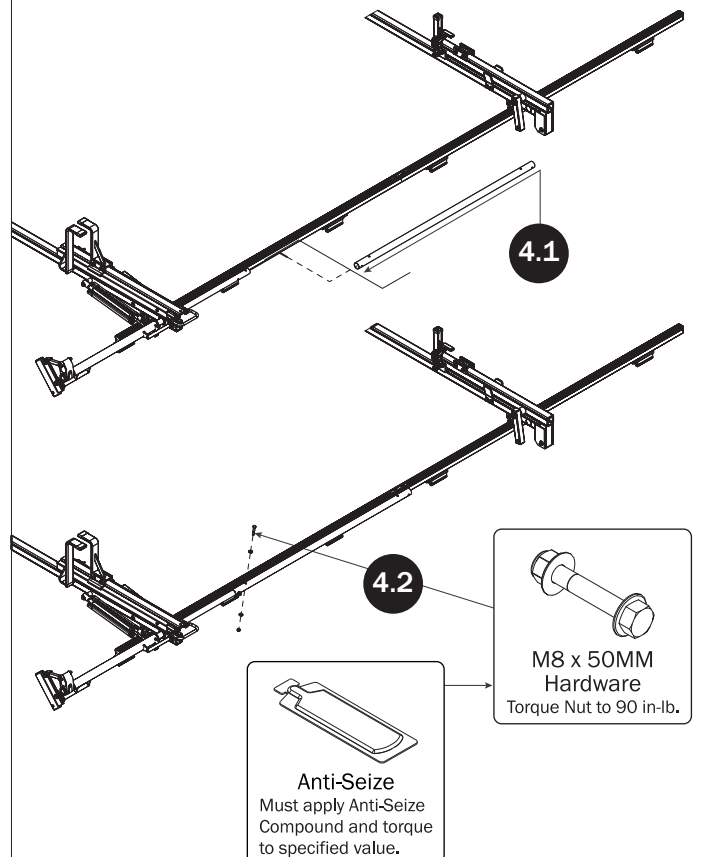

FRONT DRIVE ARM

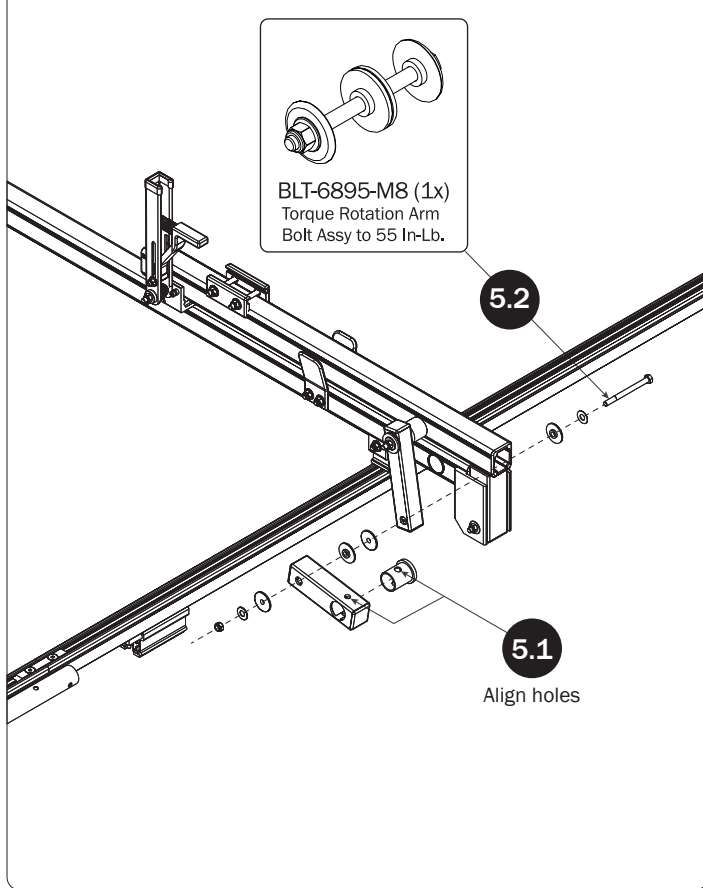

FRONT DRIVE SHAFT

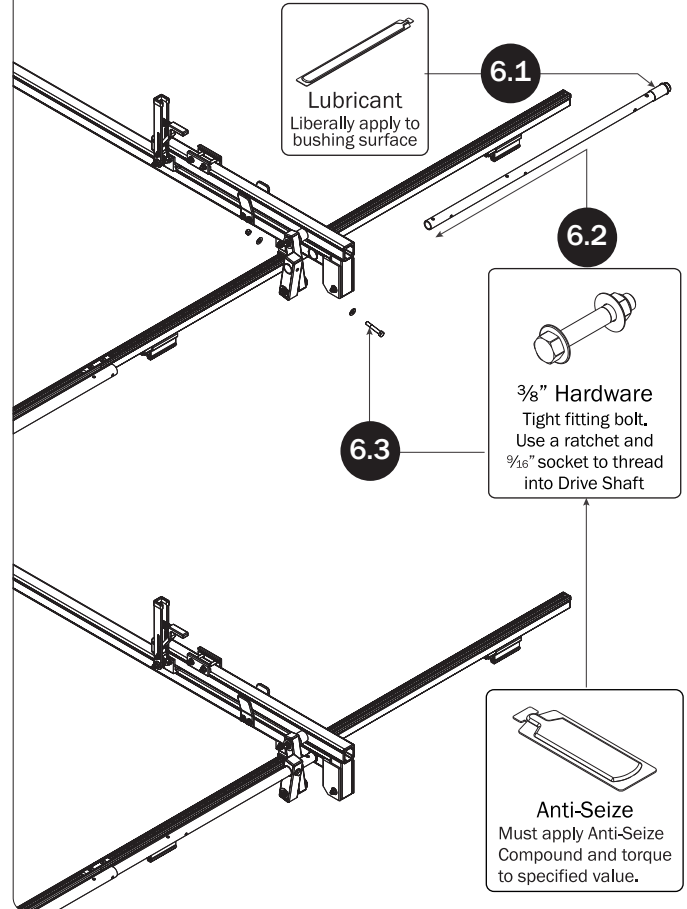

CONNECTING BAR FASTENERS

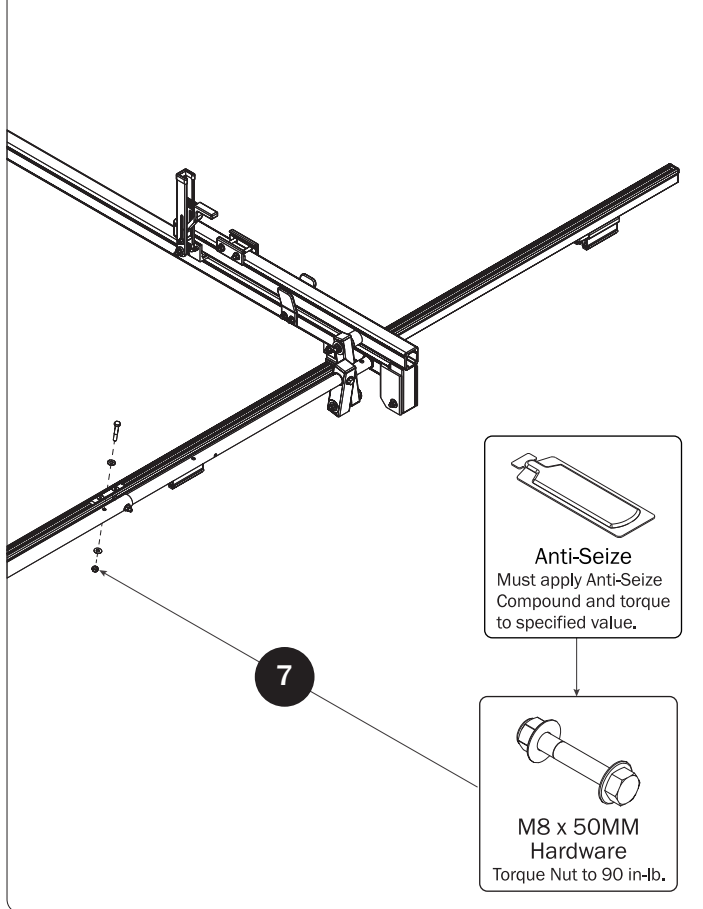

Z POST SEE QUICK START GUIDE FOR ADJUSTMENTS

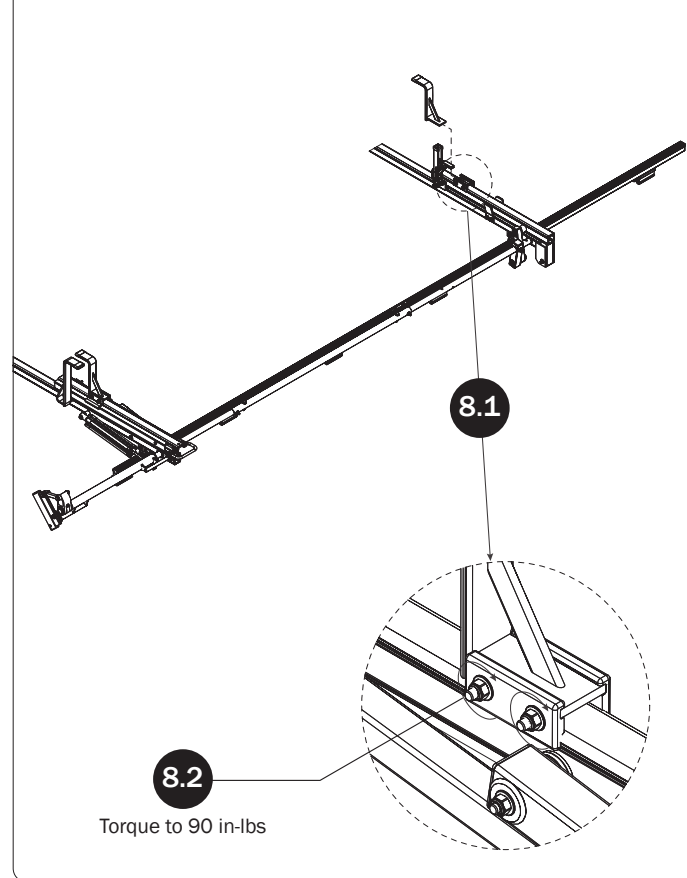

L POST

SEE QUICK START GUIDE FOR ADJUSTMENTS

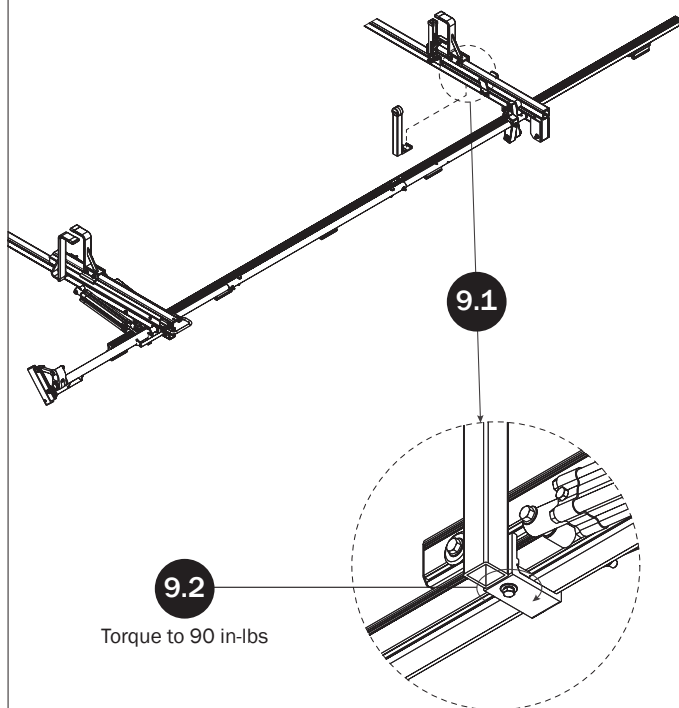

DRIVE SHAFT SEALING

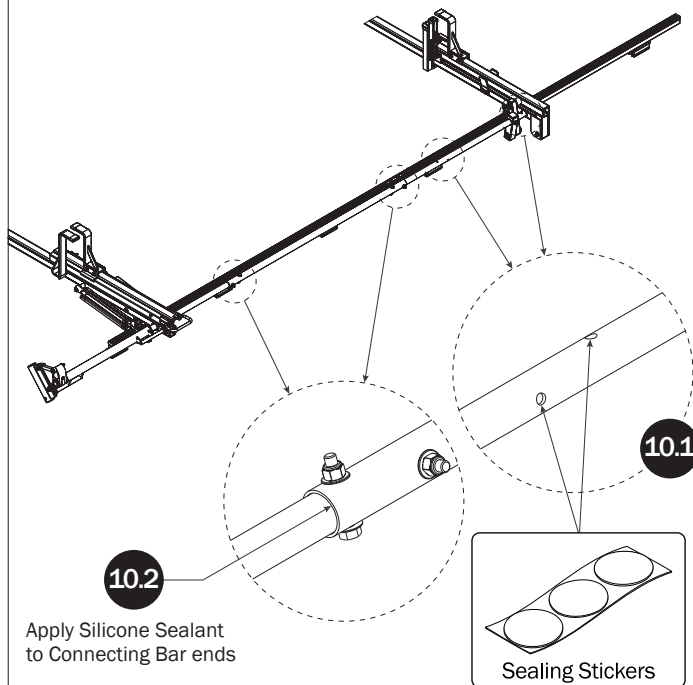

CYLINDER ADJUSTMENT

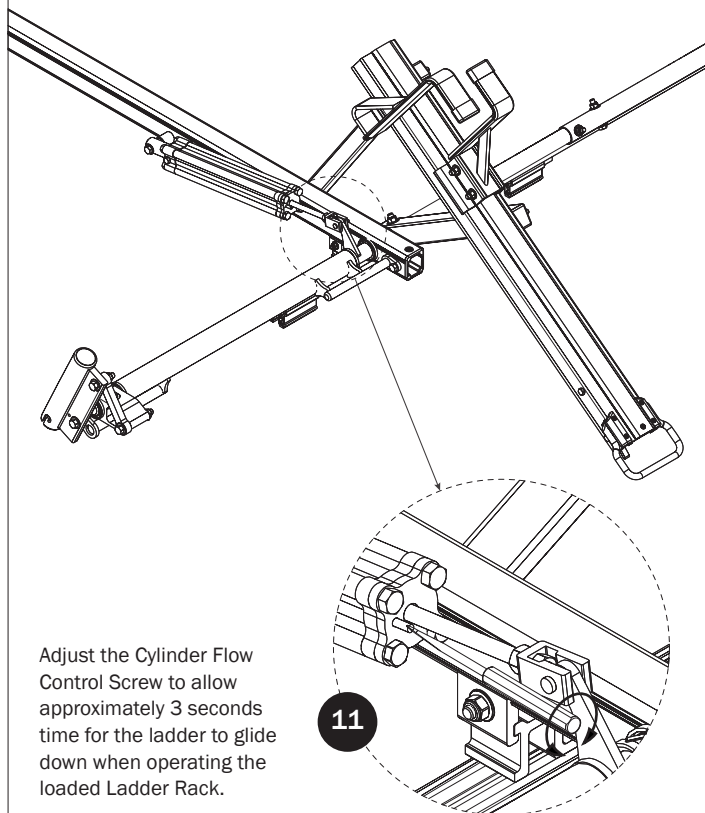

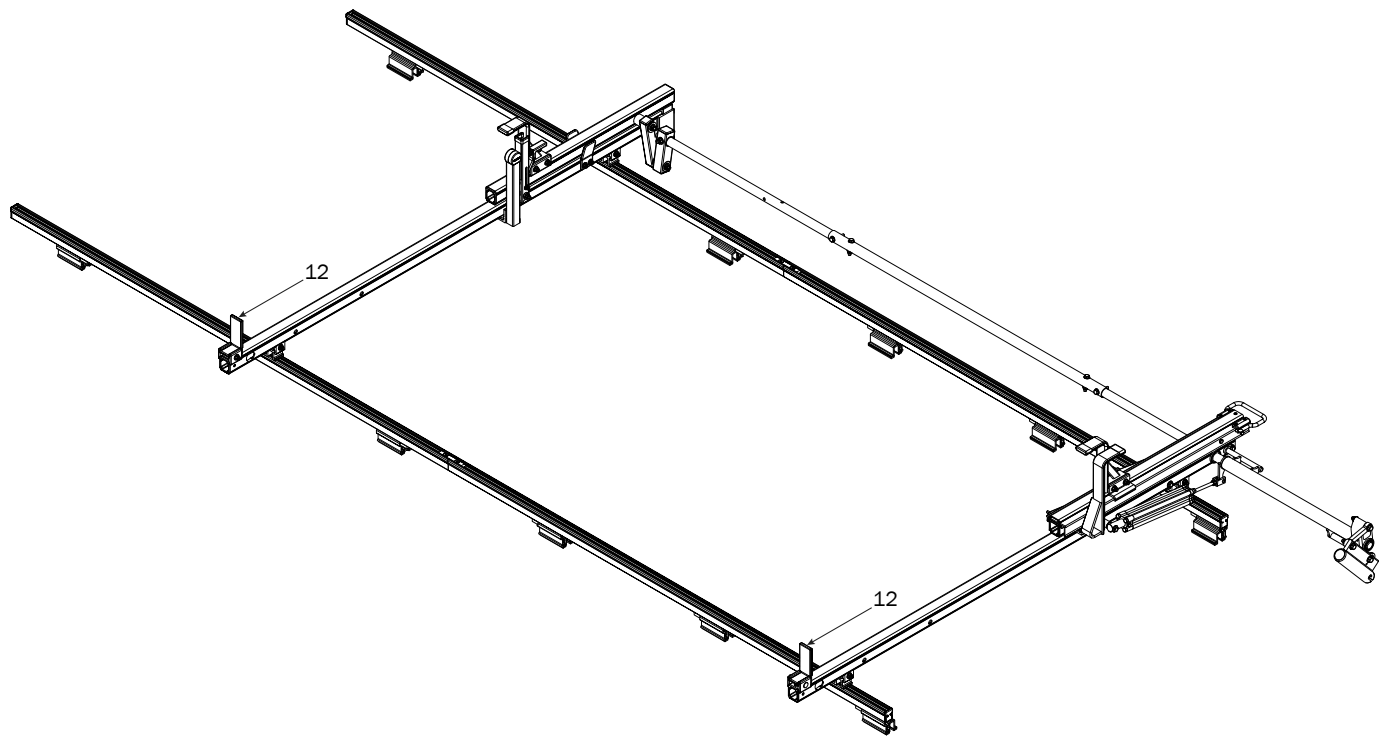
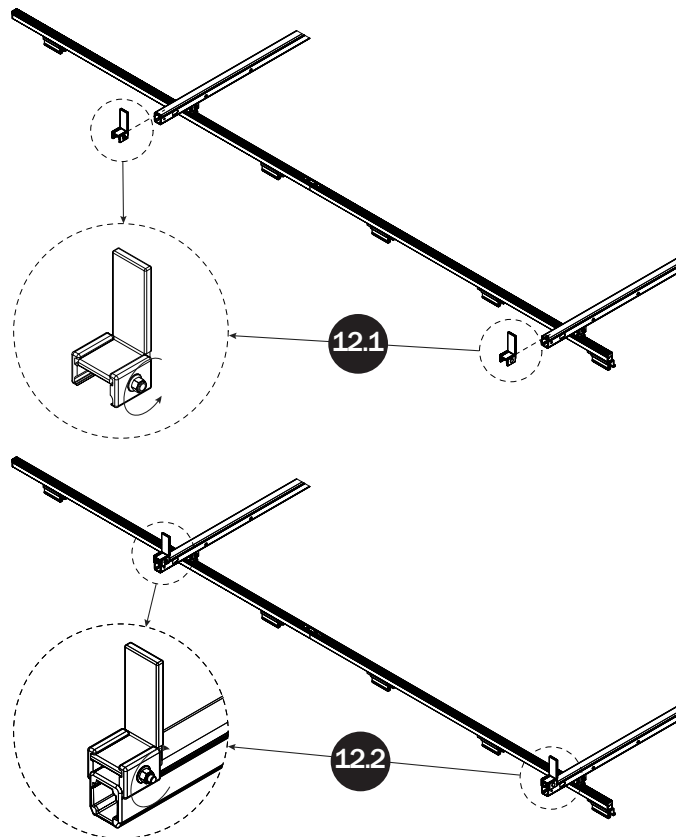
LEFT SIDE BASE*LADDER STOPS*

Page Intentionally Left Blank

