

PRIME DESIGN™

A Safe Fleet Brand

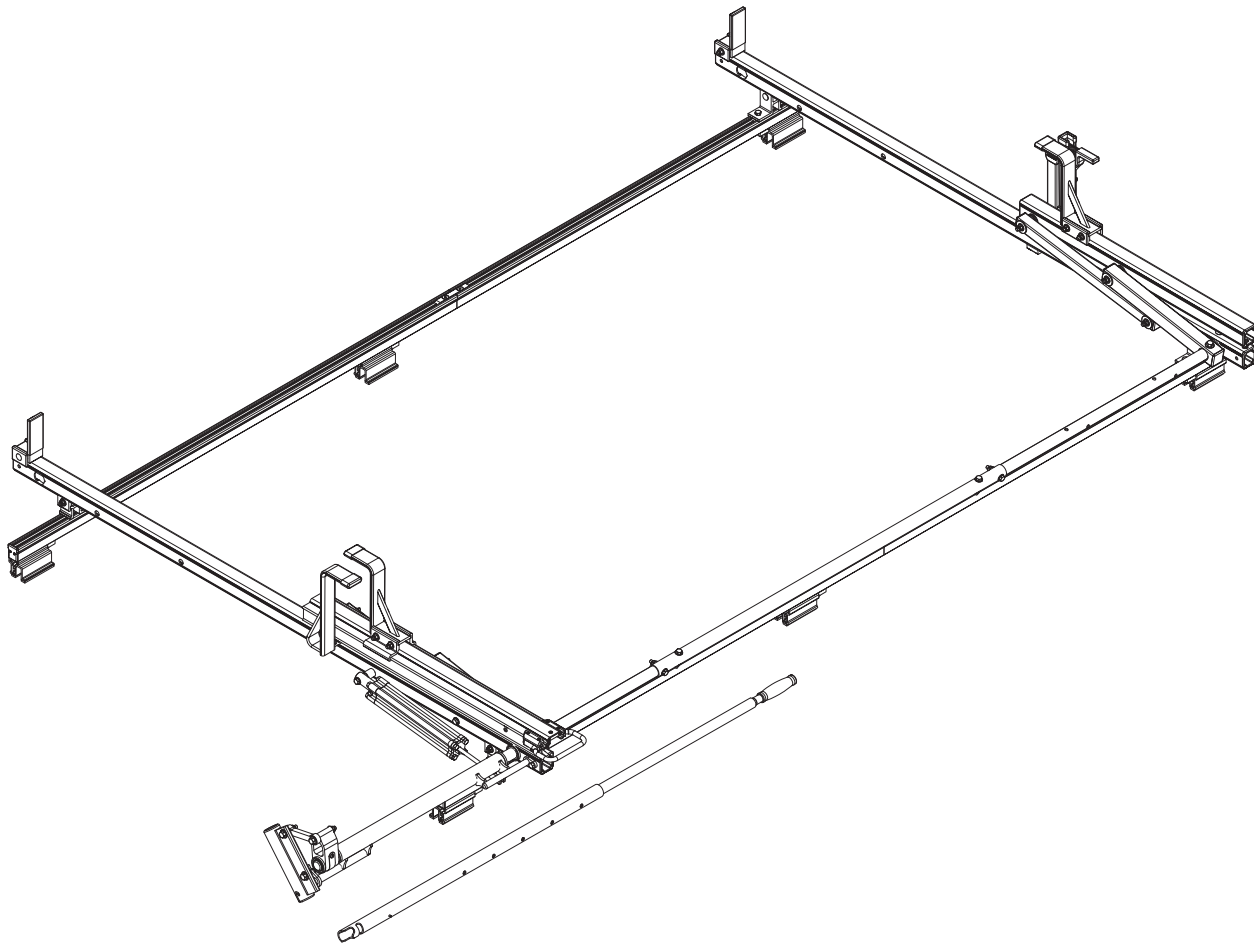

PN2

HBR-E

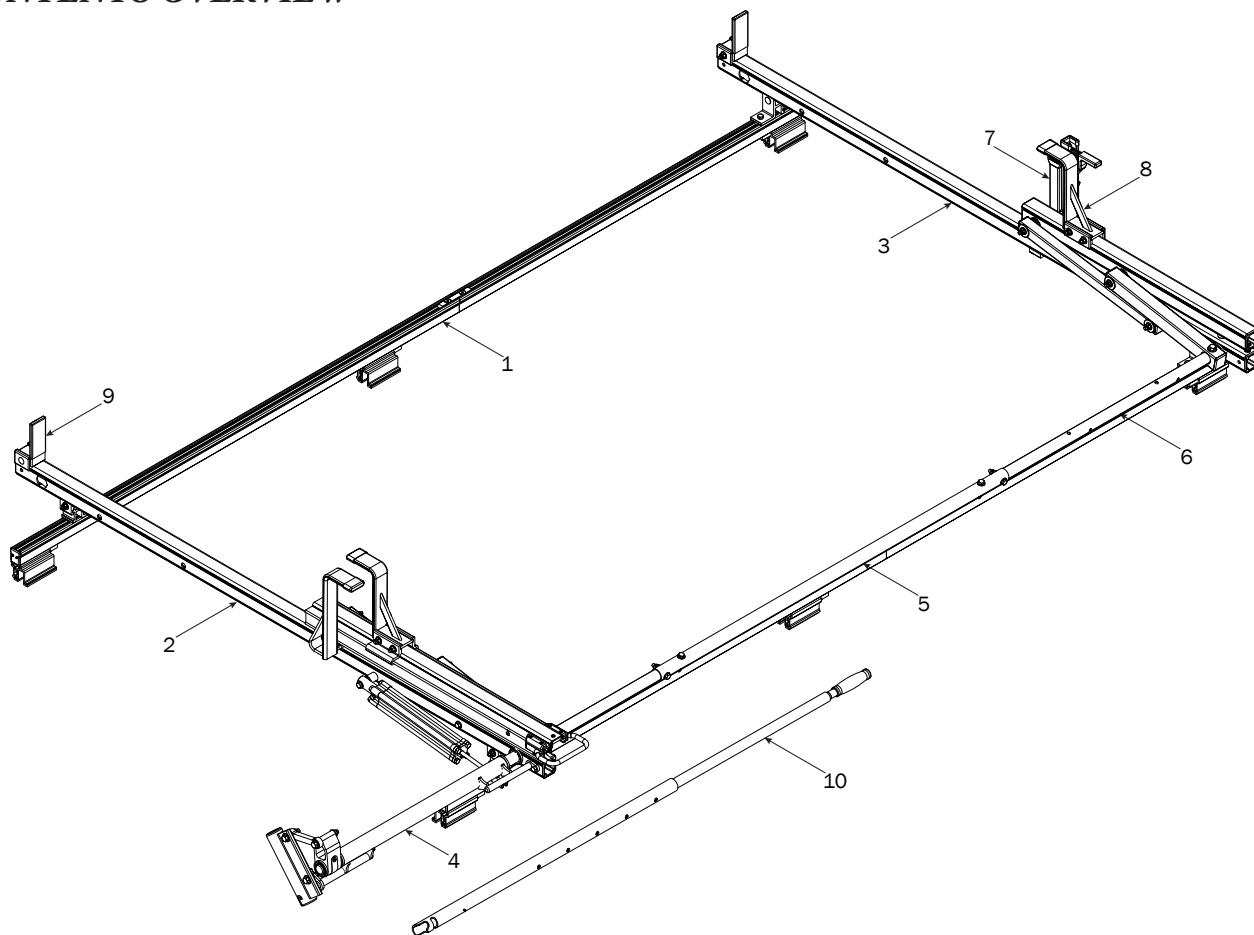

1—FBM-0013 (Qty 1)
Channels with hardware



48" Channels (2X)



60" Channels (2X)



End Caps (4X)



Screws (8X)



Top Connector (2X)



Bottom Connector (2X)



Brackets (4X)

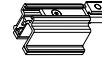

Mountings (6X)

M8 Bolt (4X)

2—Rear Crossbar Assembly..... (Qty 1)

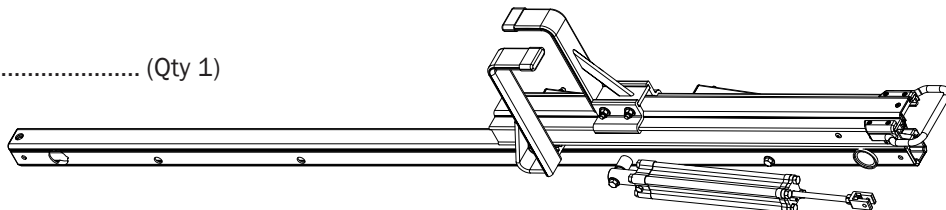

3—Front Crossbar Assembly (Qty 1)

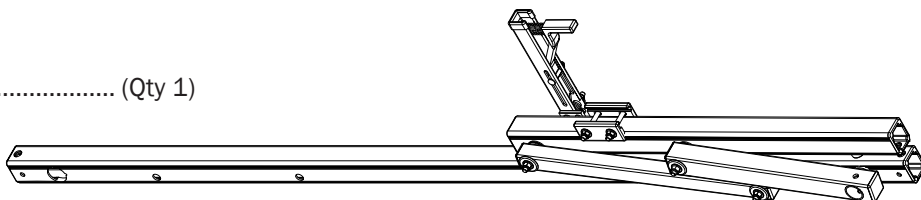

4—Drive Shaft (Qty 1)
Rear, Right Hand, 50.00"

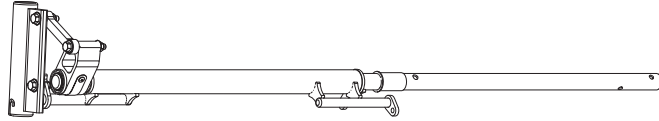

5—Connecting Bar (Qty 1)
48.00"



6—Front Drive Shaft (Qty 1)
B Version, 35.75"



7—Z Post (Qty 1)
Adjustable, 7.25"

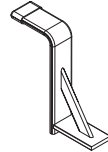

8—L Post (Qty 1)
Gen2, Roller Cap, 9.25"



9—Ladder Stop Assembly (Qty 2)
1.75"

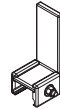

10—HRR Removeable Handle Assembly (Qty 1)

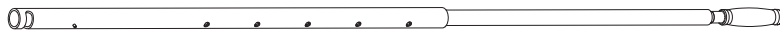

11—HKT-8163 (Not called out in Overview) (Qty 1)

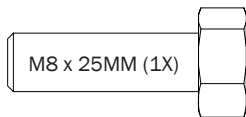

M8 x 25MM (1X)

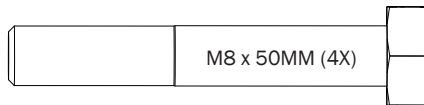

M8 x 50MM (4X)

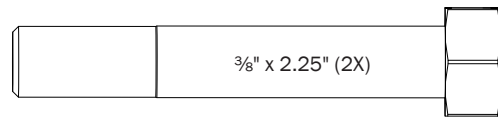

3/8" x 2.25" (2X)



Cotter Pin (1X)

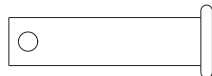

Clevis Pin (1X)

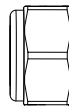

M8 Lock Nut (5X)

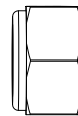

3/8" Lock Nut (2X)

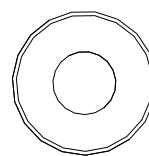

5/16" Flat Washer (10X)

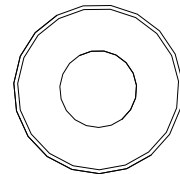

3/8" Flat Washer (4X)

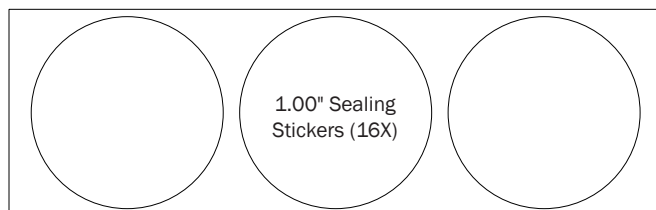

1.00" Sealing
Stickers (16X)



Anti-Seize (1X)

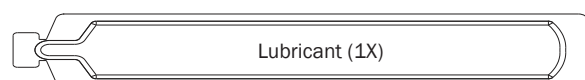

Lubricant (1X)

FBM-0013 MOUNTING BRACKETS

INSTALLER NOTE: Mounting Brackets must be disassembled for installation onto the vehicle's roof.

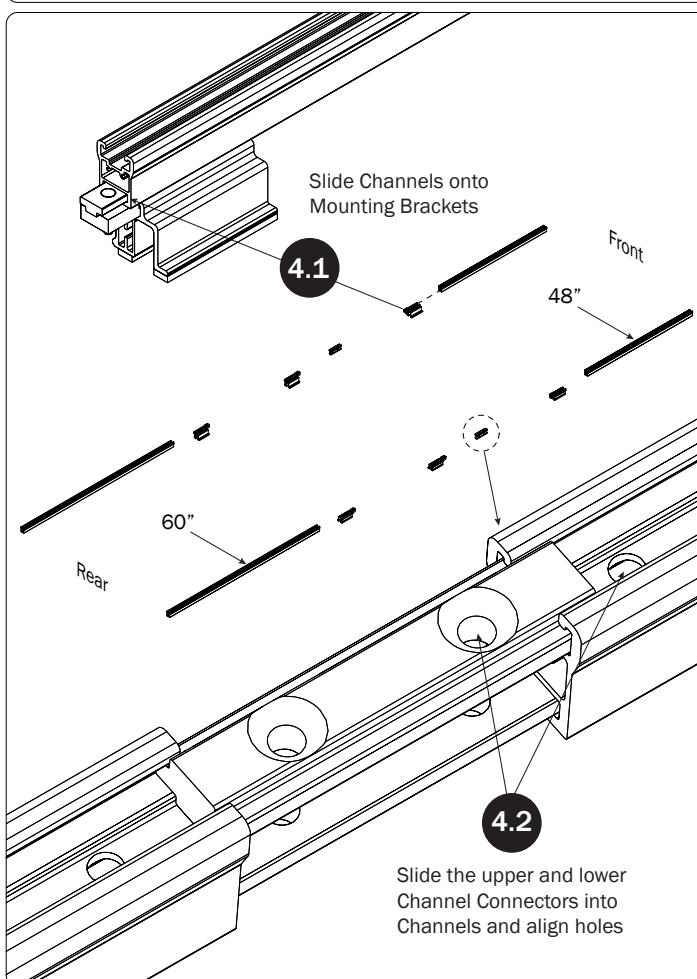
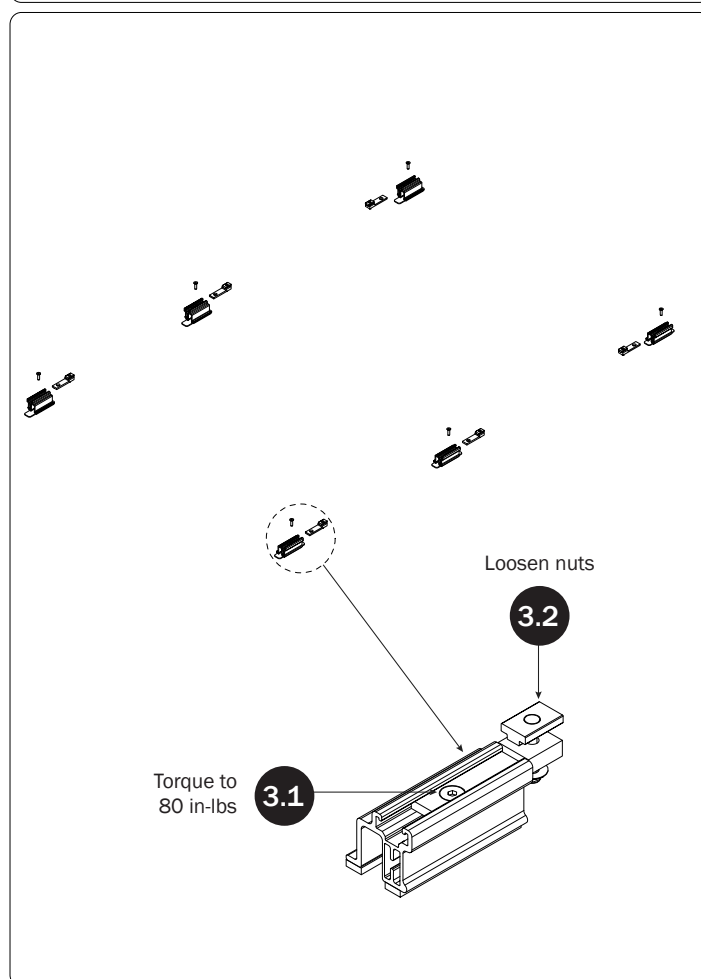
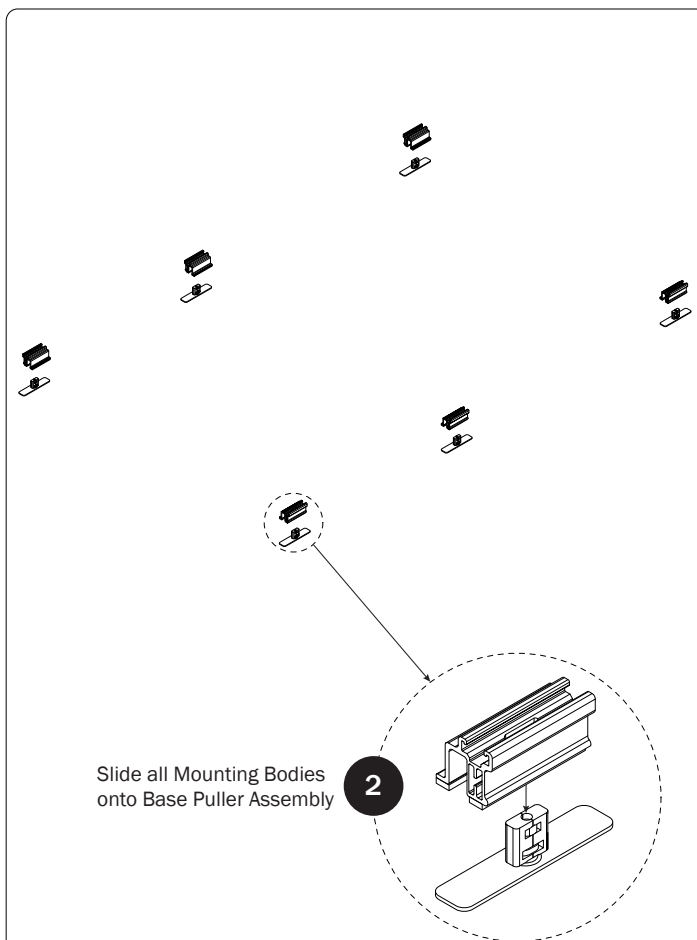
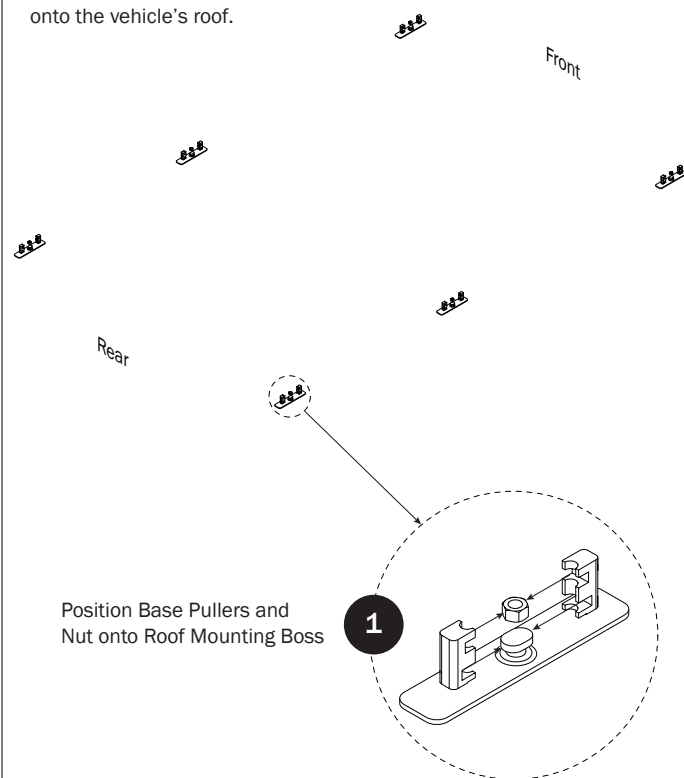

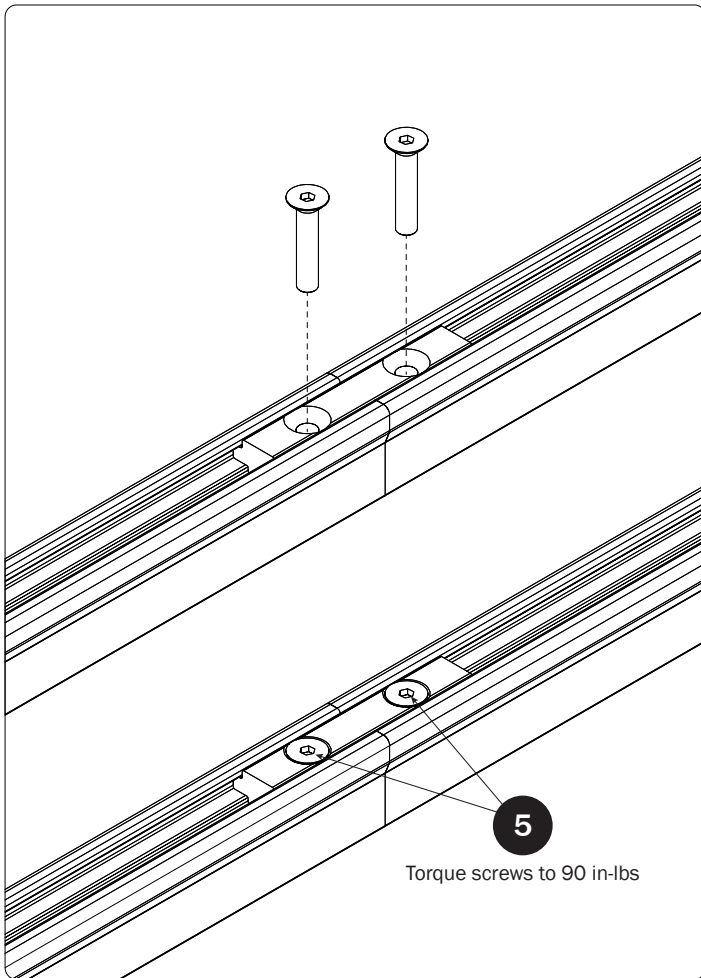

6 Set to distances then torque Mounting Bracket nuts to 80 in-lbs

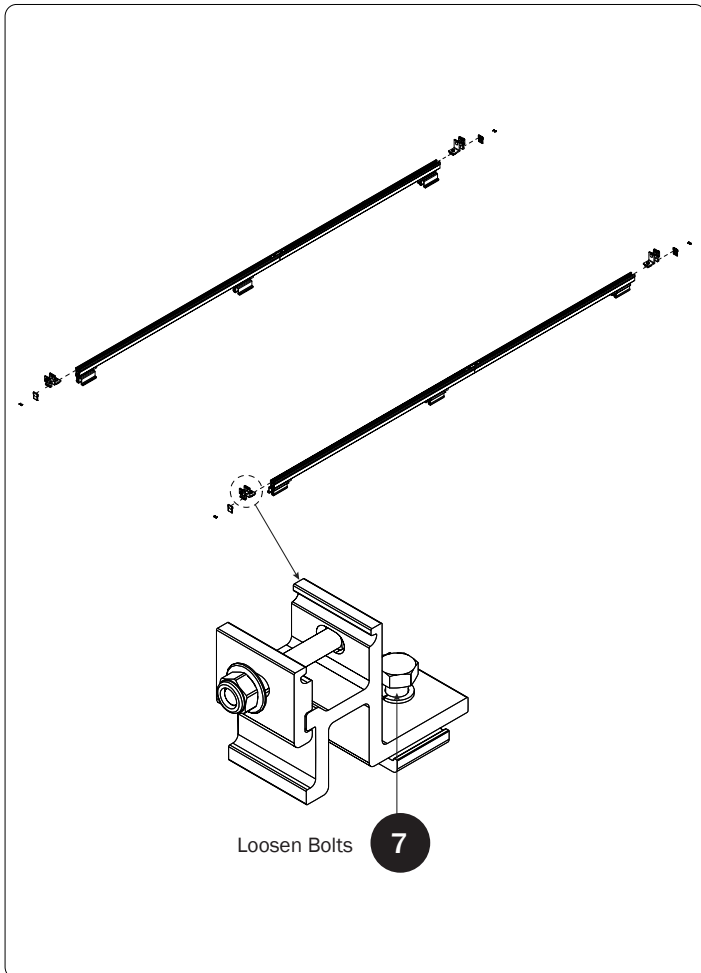
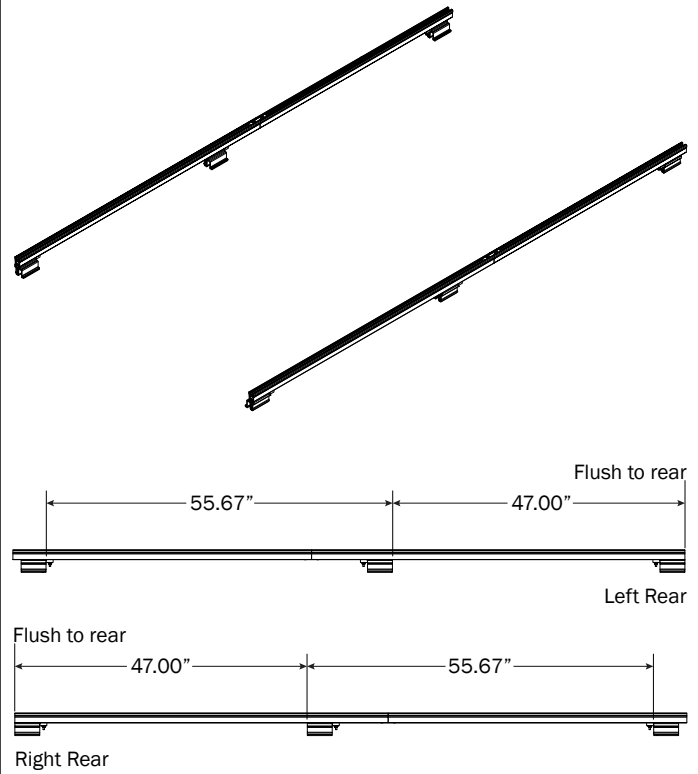

8 Set to distances shown, but do not tighten at this time

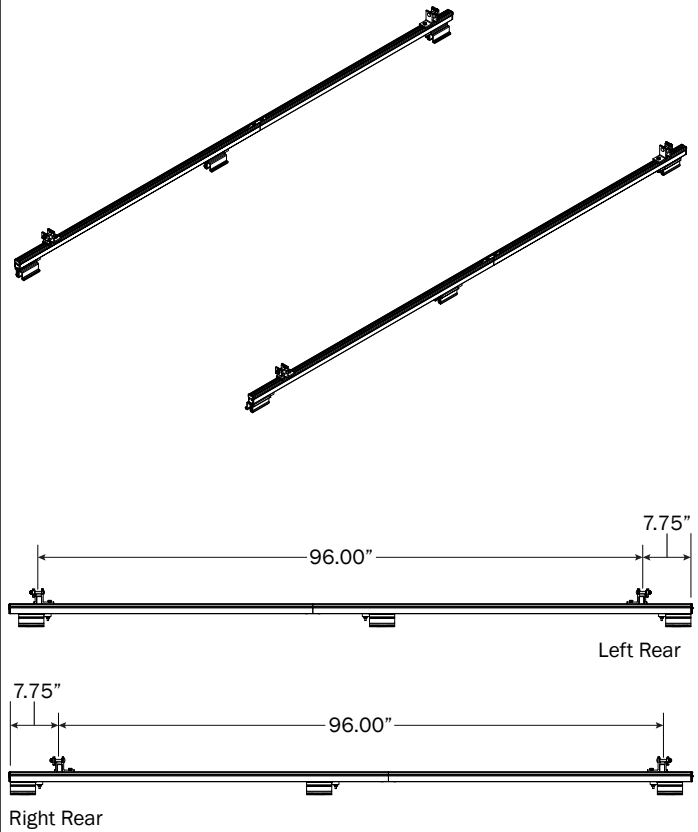

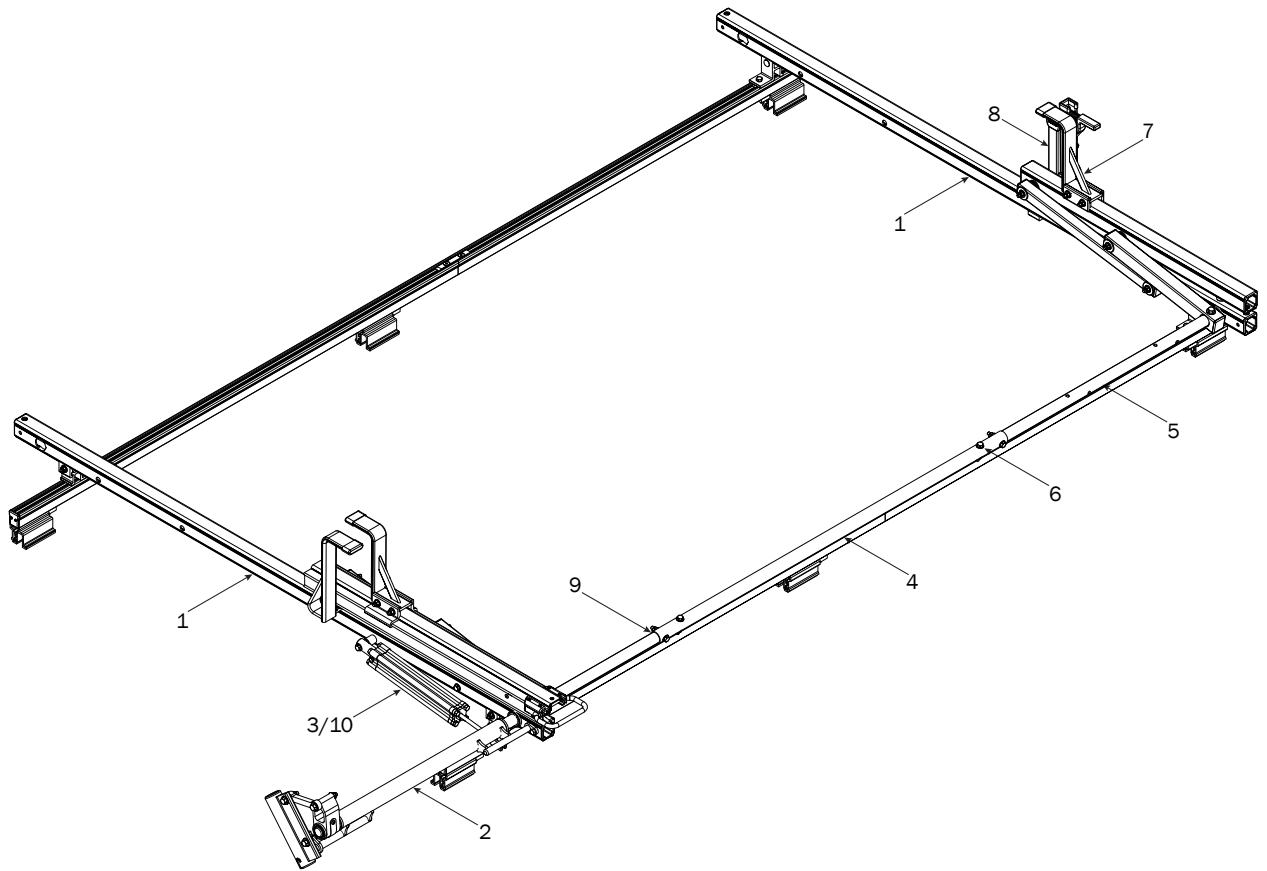
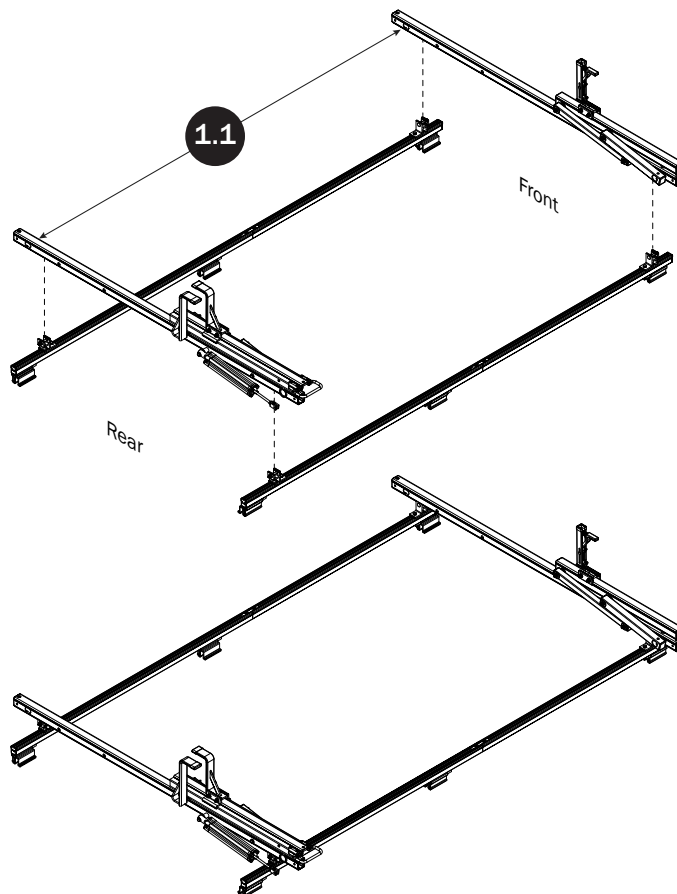
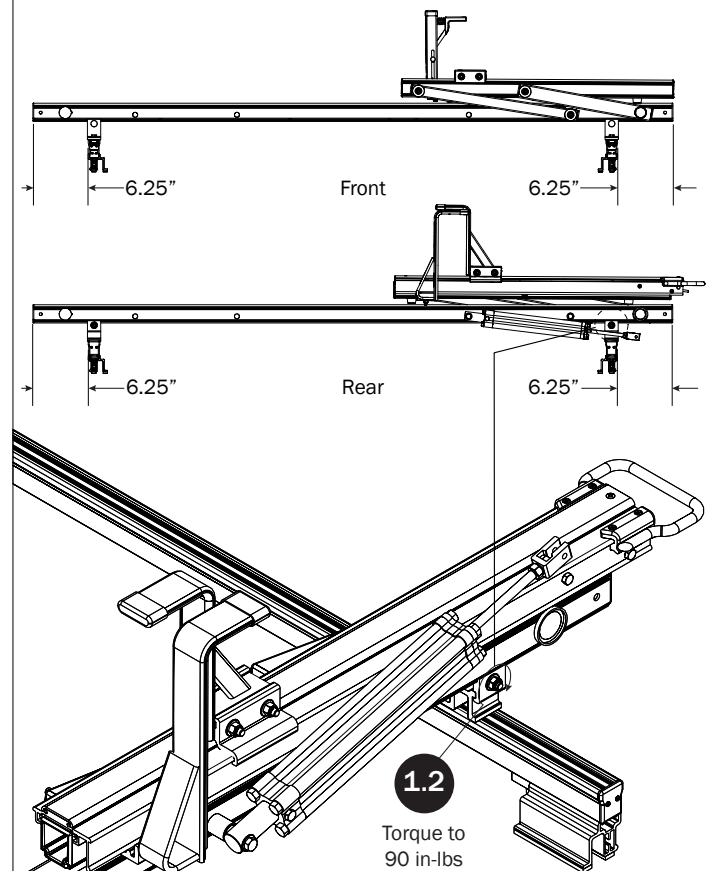
RIGHT ROTATION ASSEMBLY**CROSSBARS****CROSSBAR ADJUSTMENT**

REAR DRIVE SHAFT

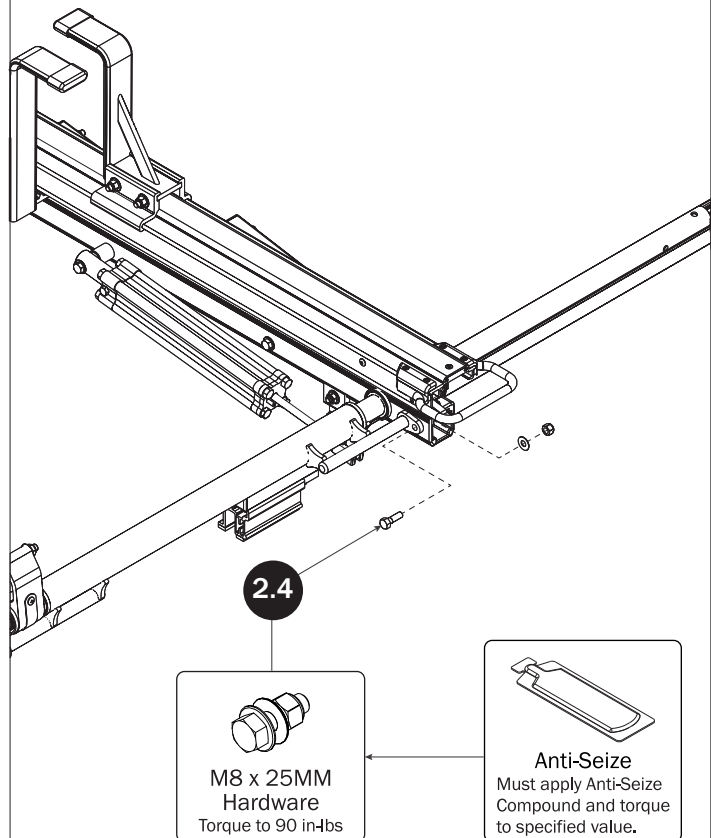
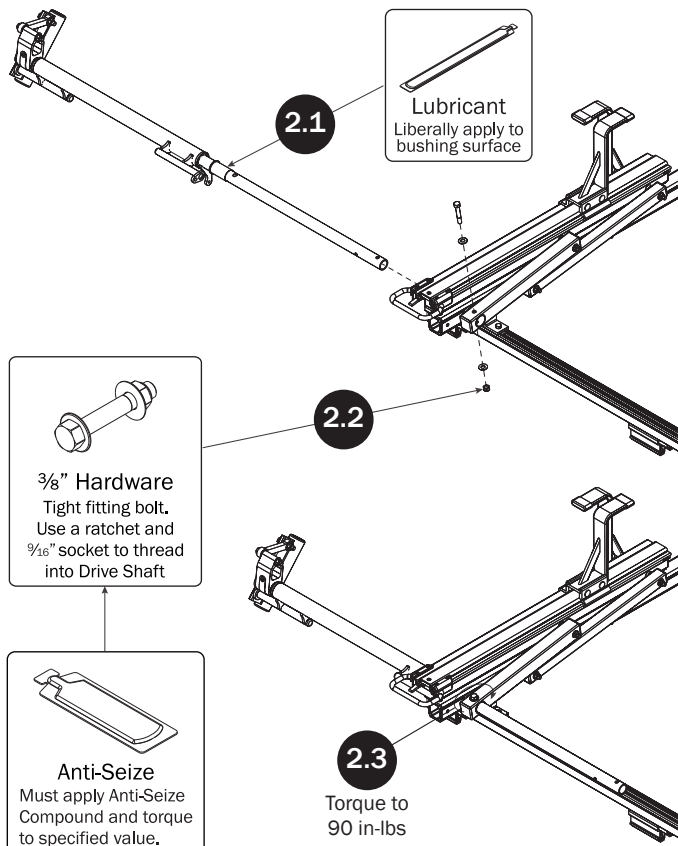

CYLINDER HARDWARE

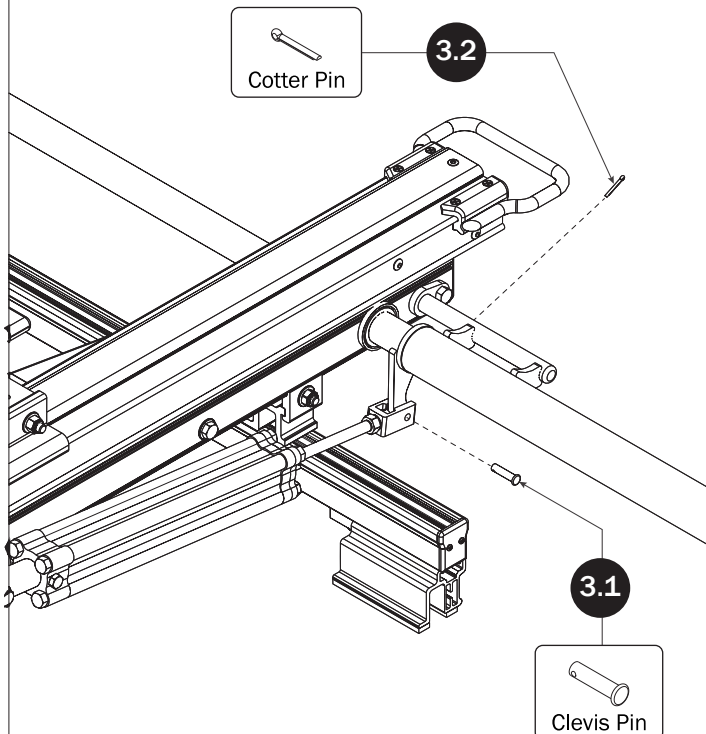

CONNECTING BAR

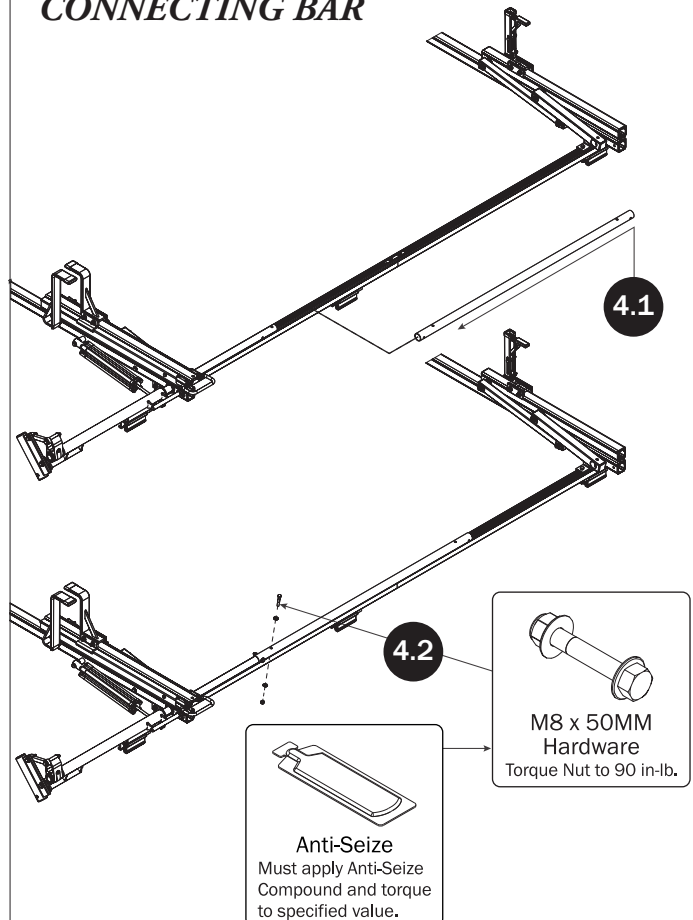

FRONT DRIVE SHAFT

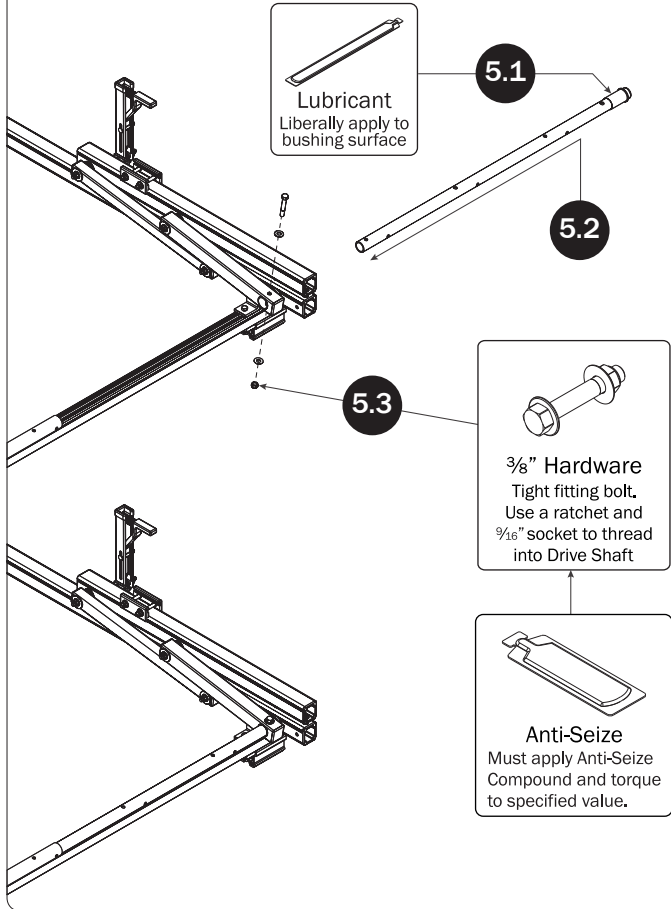

CONNECTING BAR FASTENERS

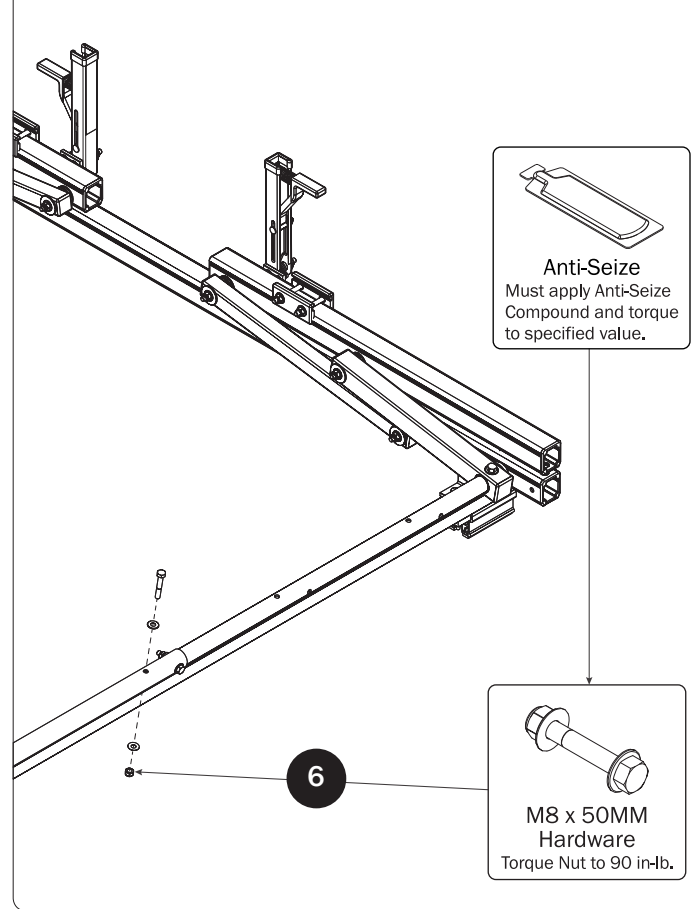

L POST SEE QUICK START GUIDE FOR ADJUSTMENTS

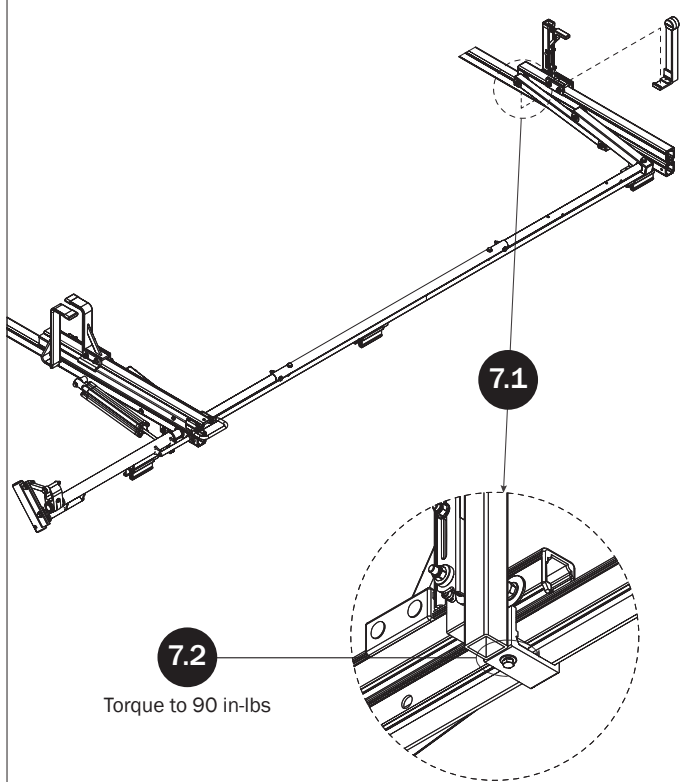

Z POST SEE QUICK START GUIDE FOR ADJUSTMENTS

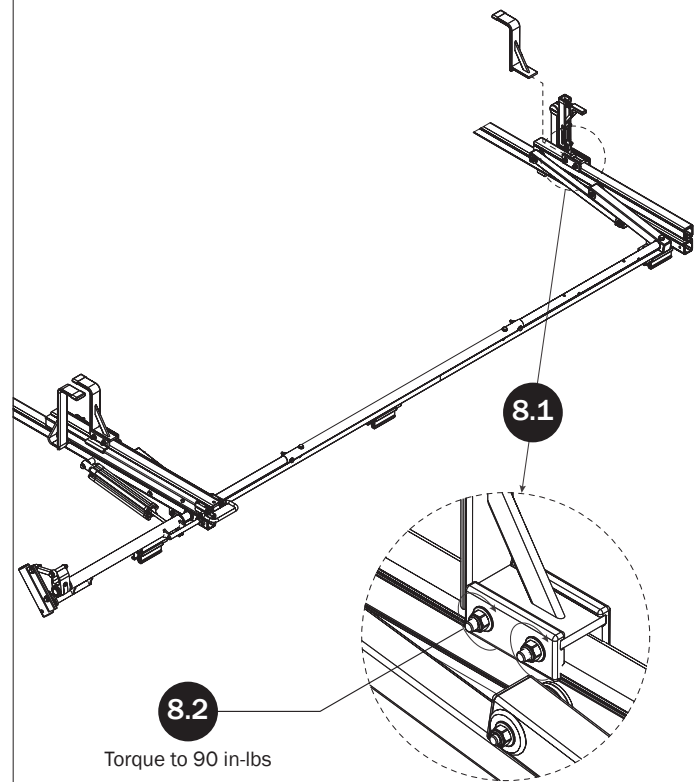

DRIVE SHAFT SEALING

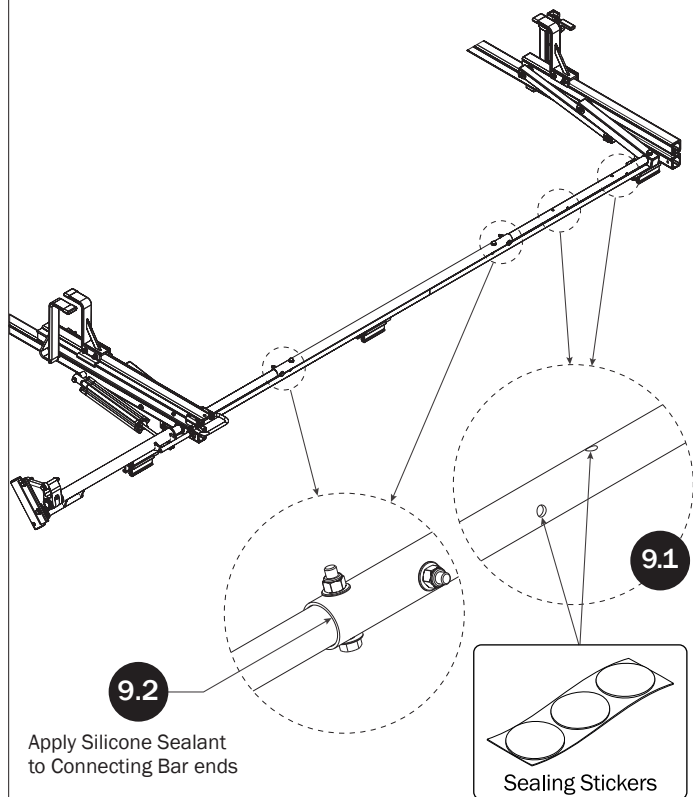

CYLINDER ADJUSTMENT

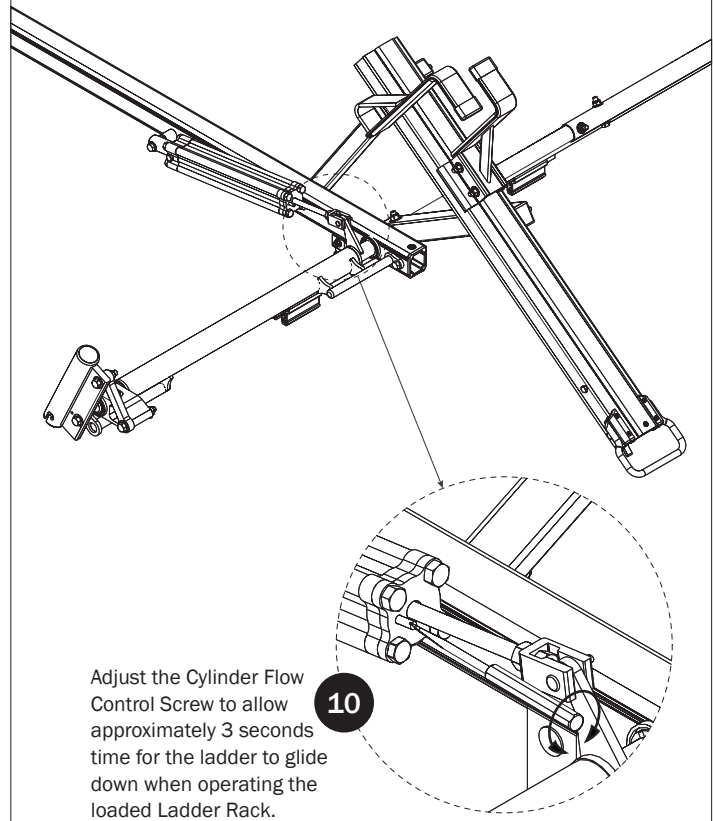

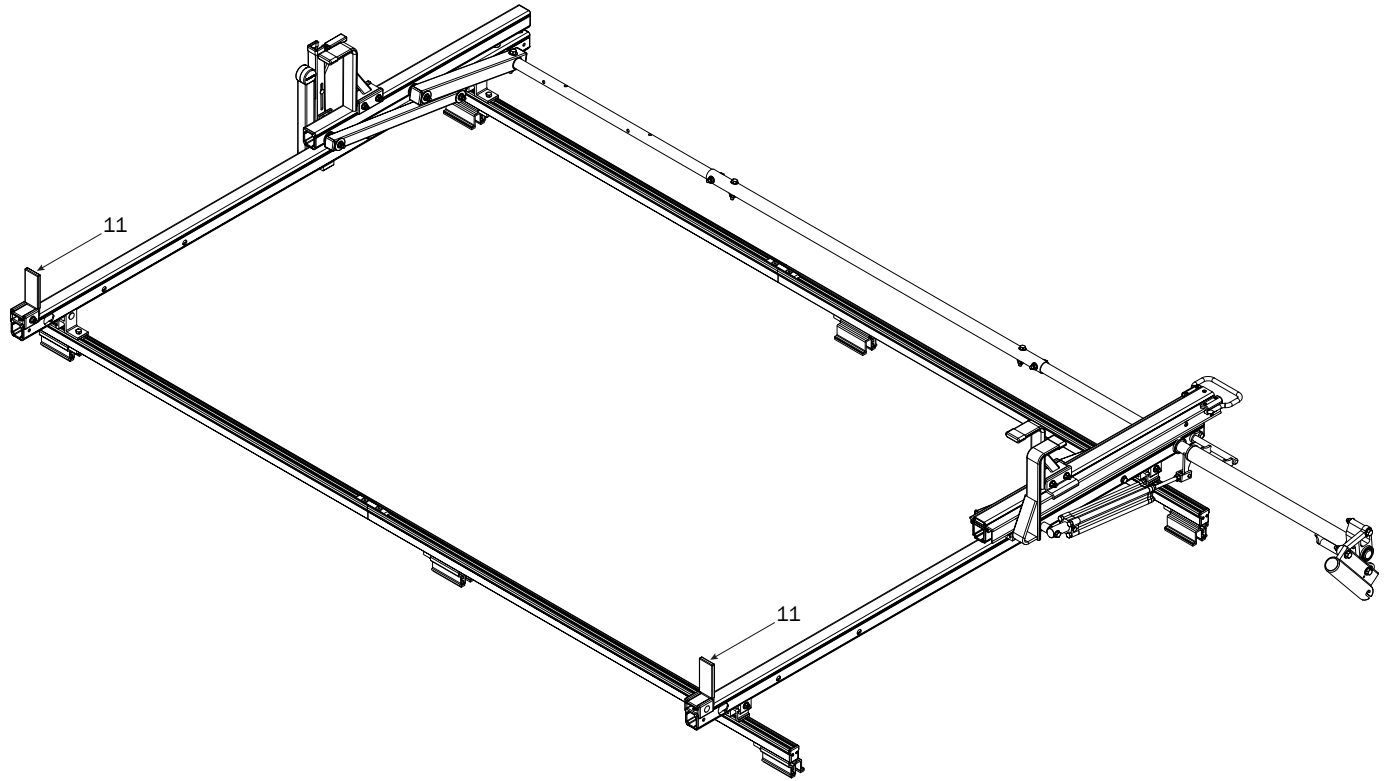
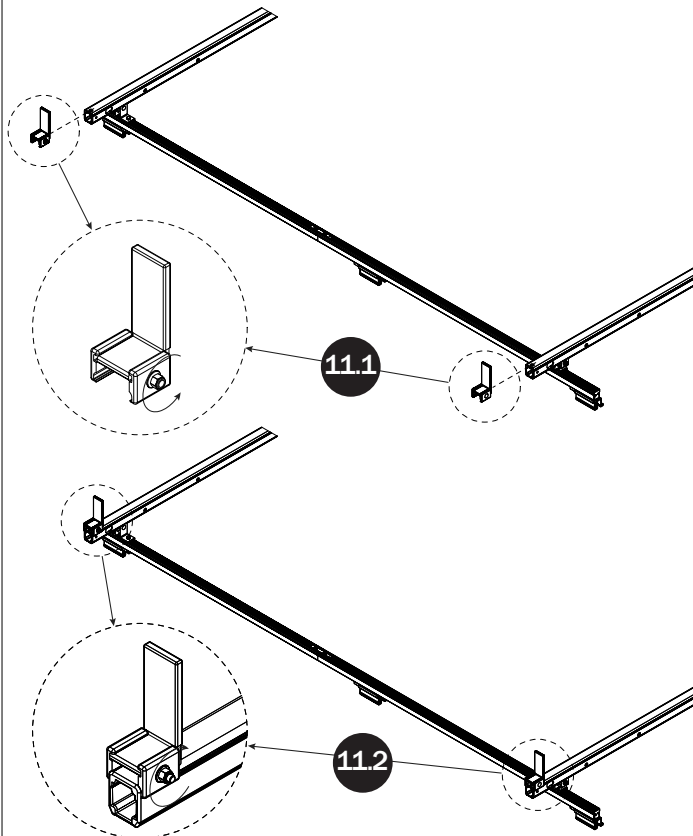
LEFT SIDE BASE*LADDER STOPS*

Page Intentionally Left Blank

