

# PRIME DESIGN™

A Safe Fleet Brand

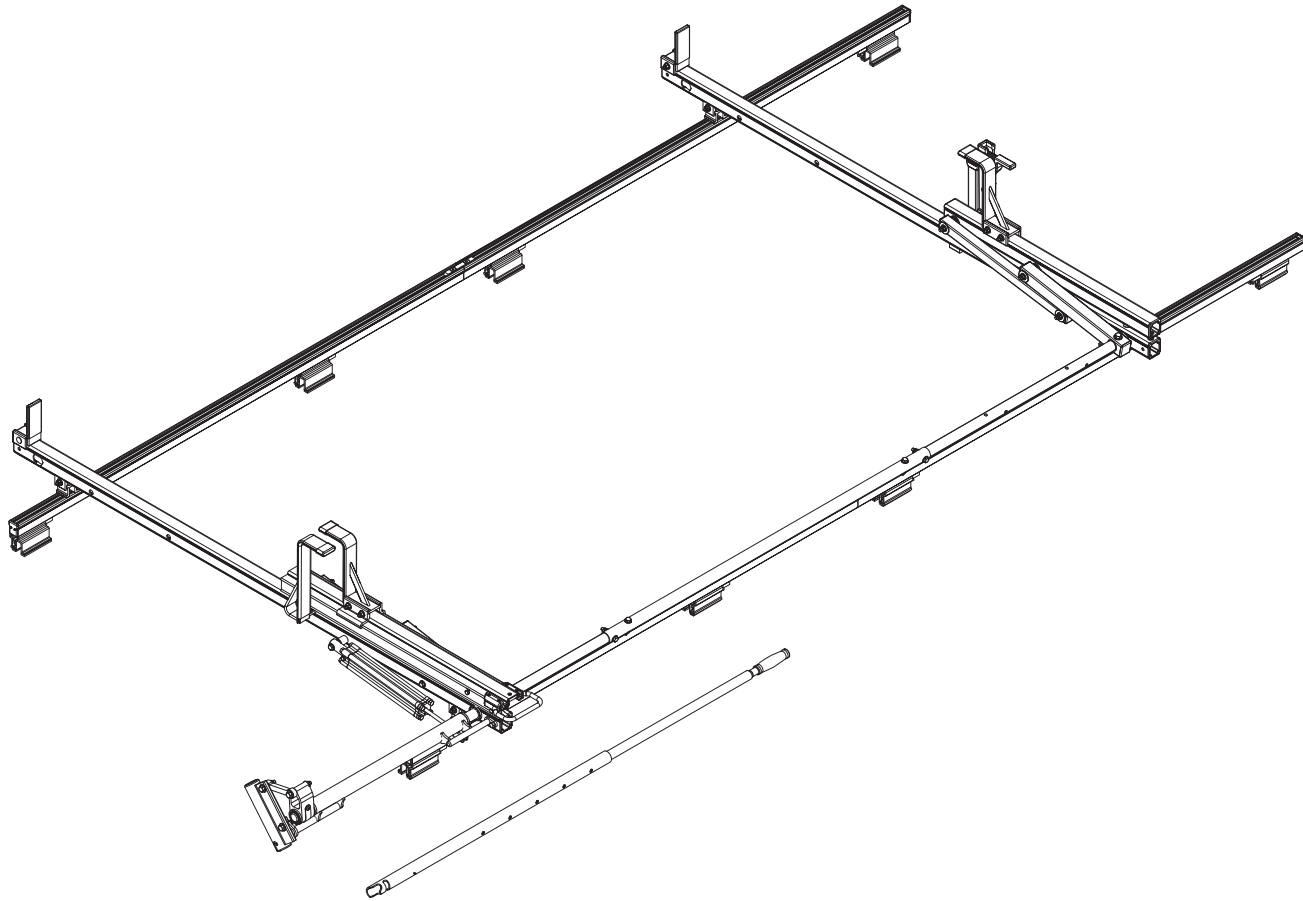

# STANLEY

## HBR-E

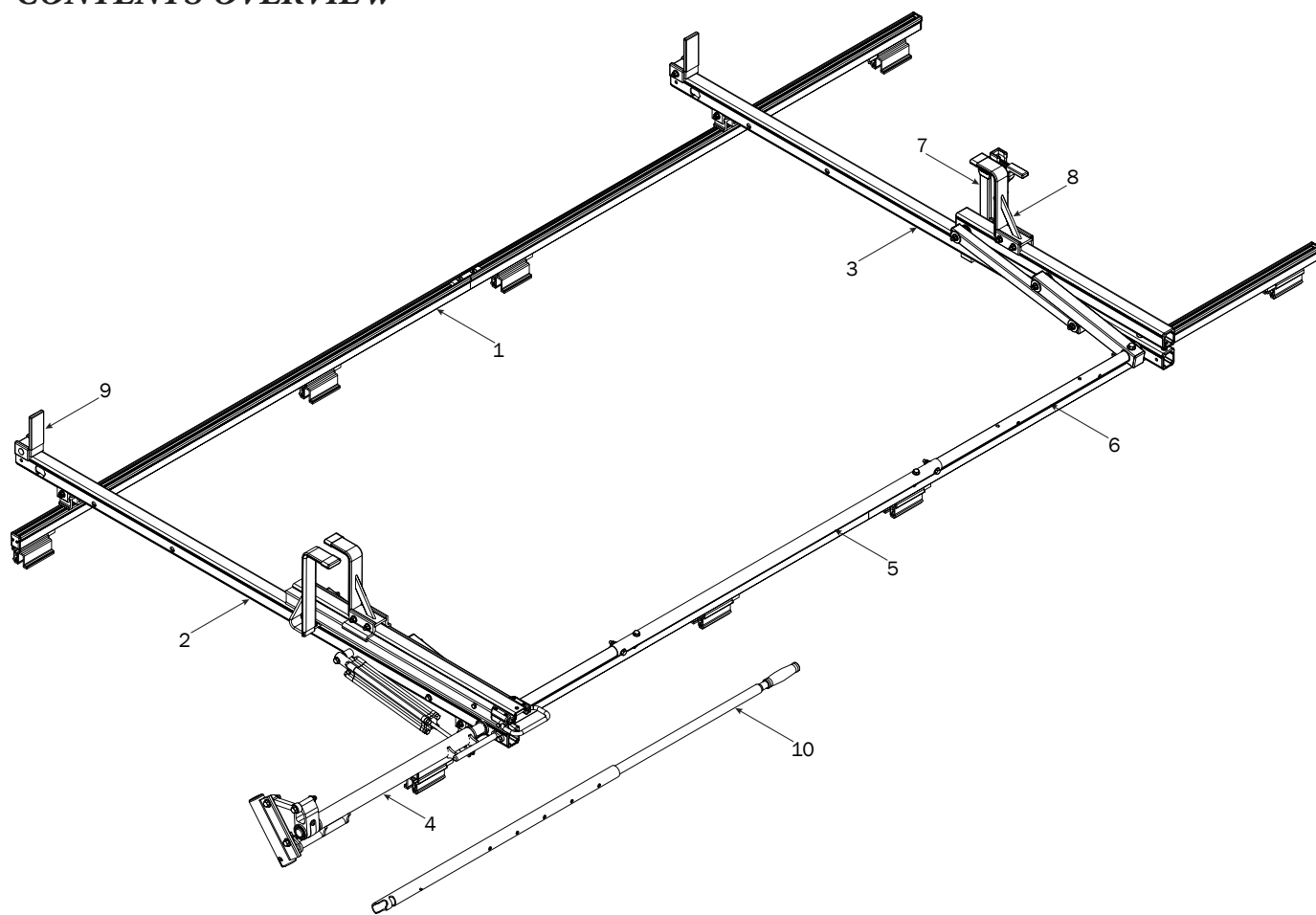

1—FBM-0014 ..... (Qty 1)  
Channels with hardware



66" Channels (4X)



End Caps (4X)



Screws (8X)



Top Connector (2X)



Bottom Connector (2X)



Brackets (4X)



Mountings (8X)

M8 Bolt (4X)

2—Rear Crossbar Assembly..... (Qty 1)

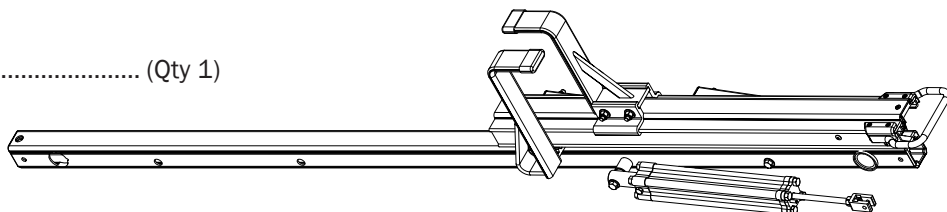

3—Front Crossbar Assembly ..... (Qty 1)

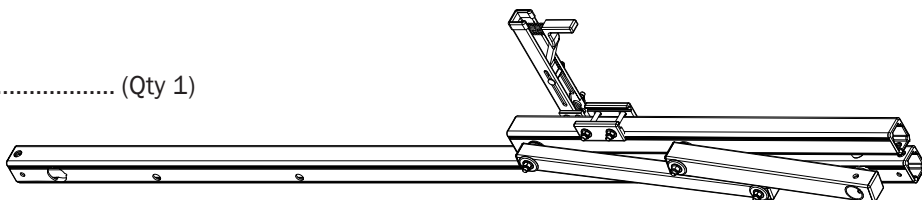

4—Drive Shaft ..... (Qty 1)  
Rear, Right Hand, 50.00"

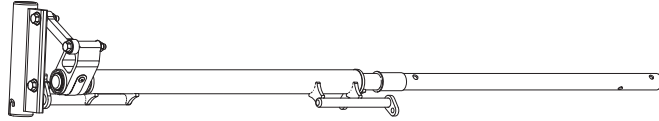

5—Connecting Bar ..... (Qty 1)  
48.00"



6—Front Drive Shaft ..... (Qty 1)  
B Version, 35.75"



7—Z Post ..... (Qty 1)  
Adjustable, 7.25"

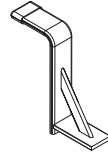

8—L Post ..... (Qty 1)  
Gen2, Roller Cap, 9.25"



9—Ladder Stop Assembly ..... (Qty 2)  
1.75"

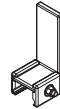

10—HRR Removeable Handle Assembly ..... (Qty 1)

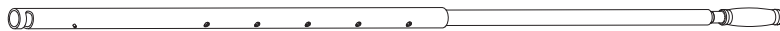

11—HKT-8163 (Not called out in Overview) ..... (Qty 1)

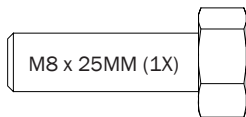

M8 x 25MM (1X)

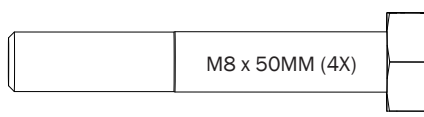

M8 x 50MM (4X)

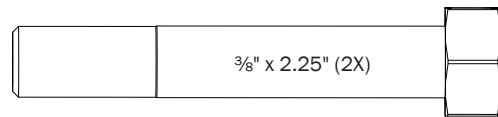

3/8" x 2.25" (2X)



Cotter Pin (1X)

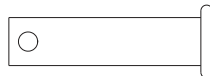

Clevis Pin (1X)

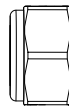

M8 Lock Nut (5X)

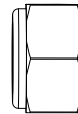

3/8" Lock Nut (2X)

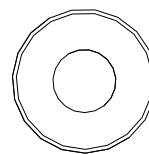

5/16" Flat Washer (10X)

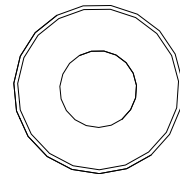

3/8" Flat Washer (4X)

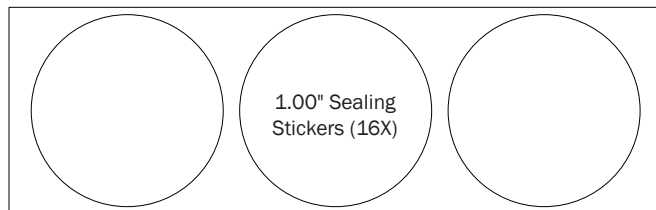

1.00" Sealing  
Stickers (16X)



Anti-Seize (1X)

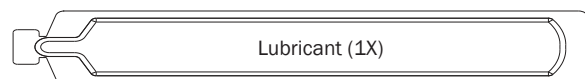

Lubricant (1X)

## FBM-0014 MOUNTING BRACKETS

**INSTALLER NOTE:** Mounting Brackets must be disassembled for installation onto the vehicle's roof.

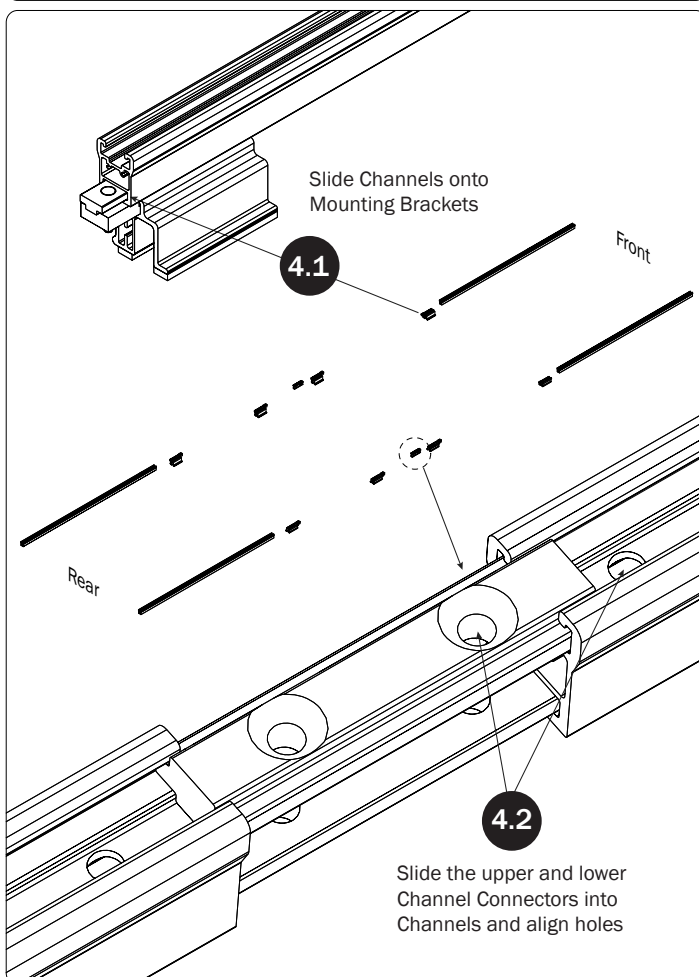
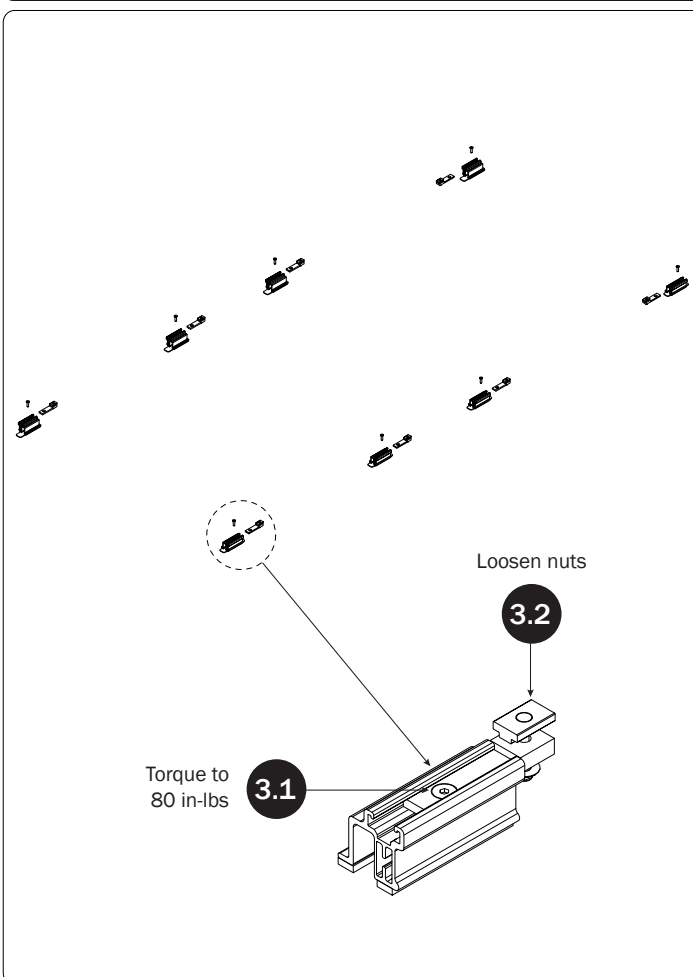
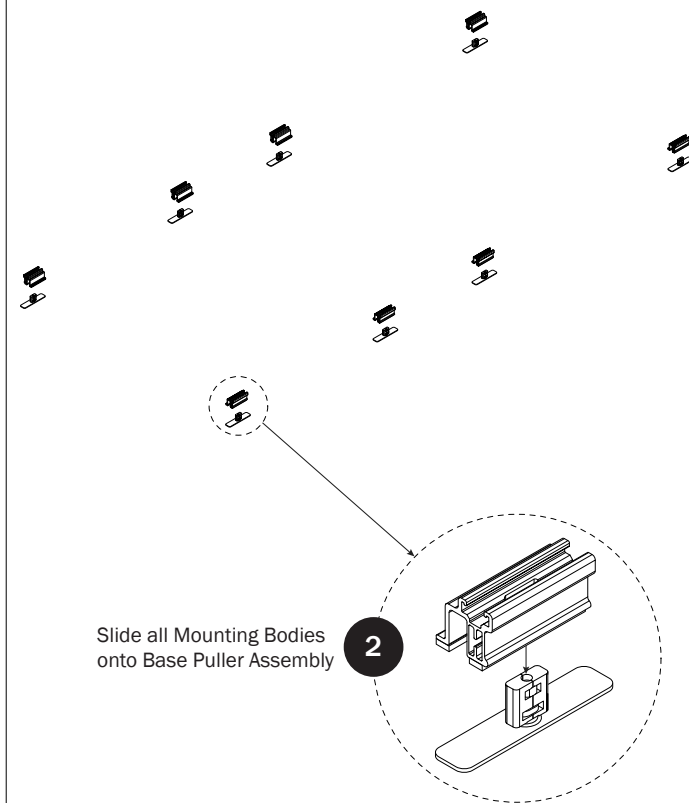
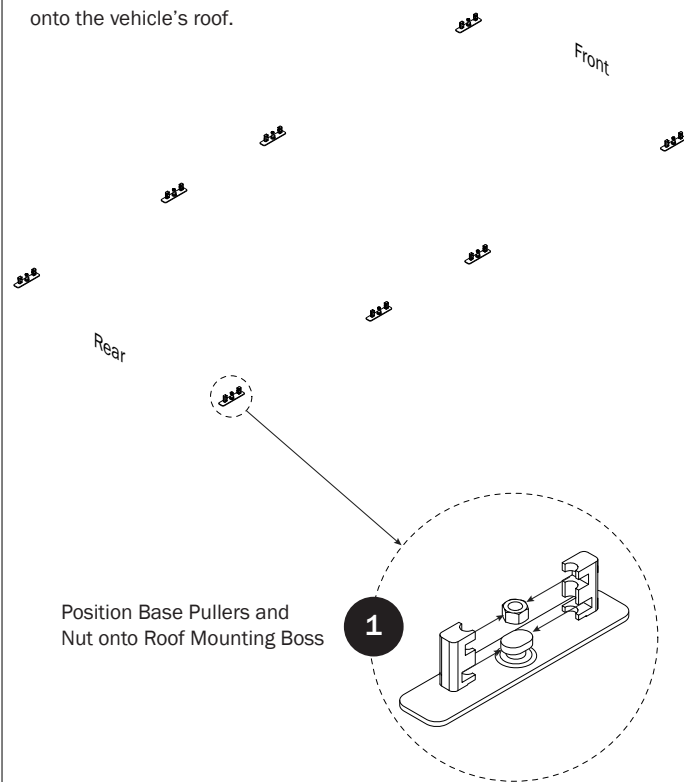

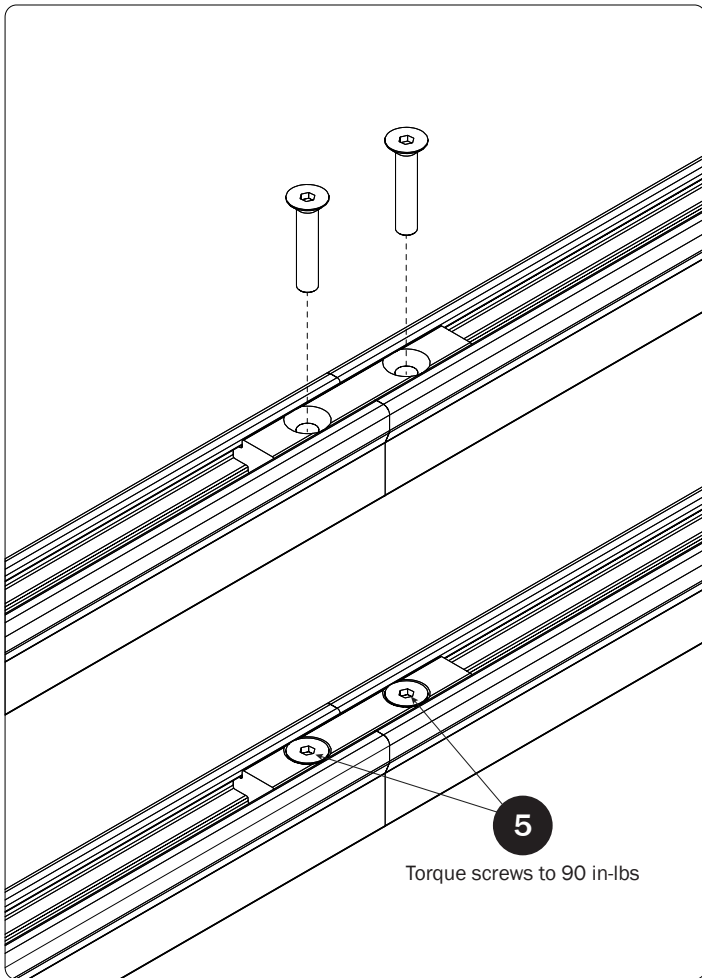

6 Set to distances then torque Mounting Bracket nuts to 80 in-lbs

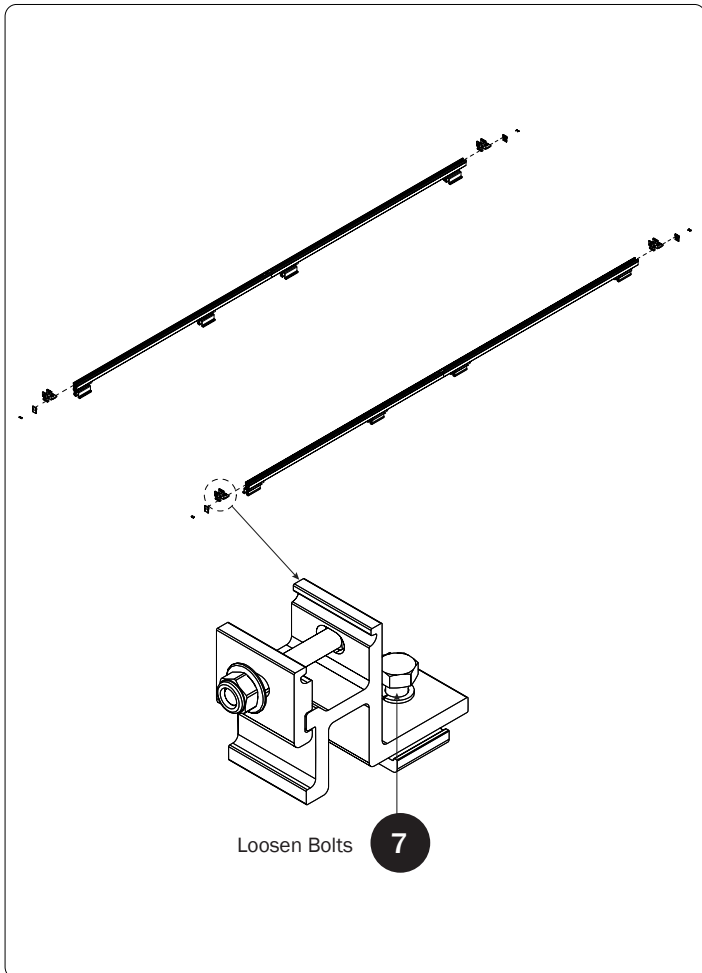
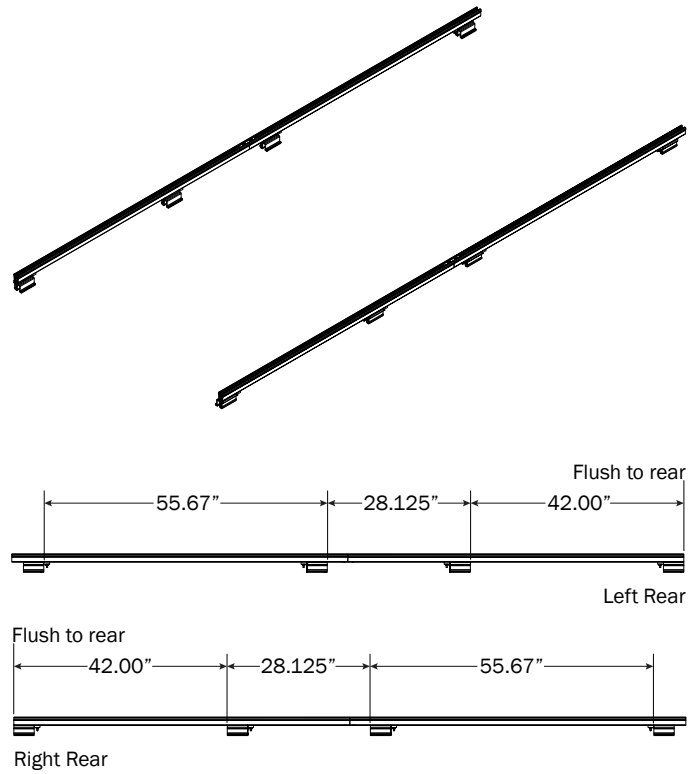

8 Set to distances then torque Mounting Bracket nuts to 90 in-lbs

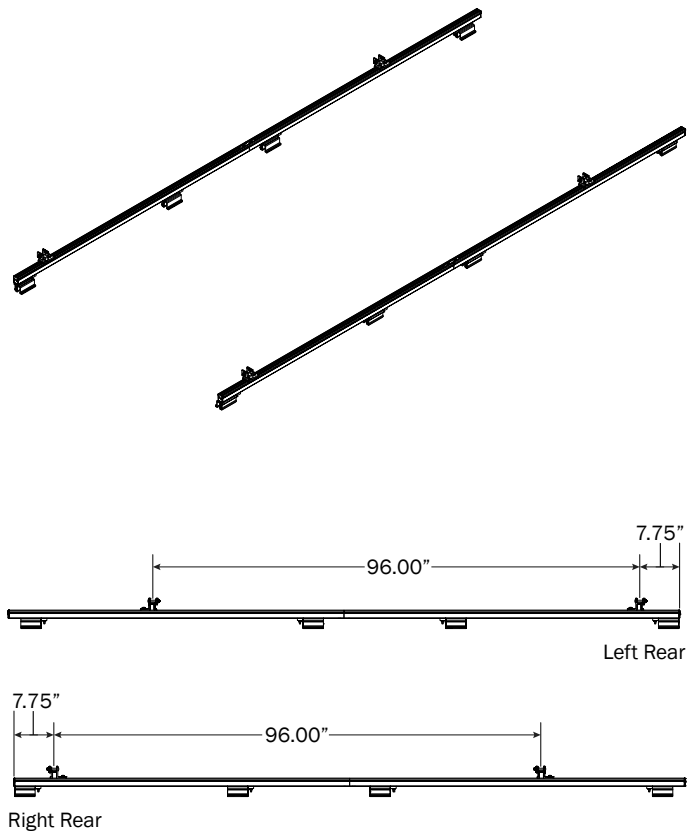

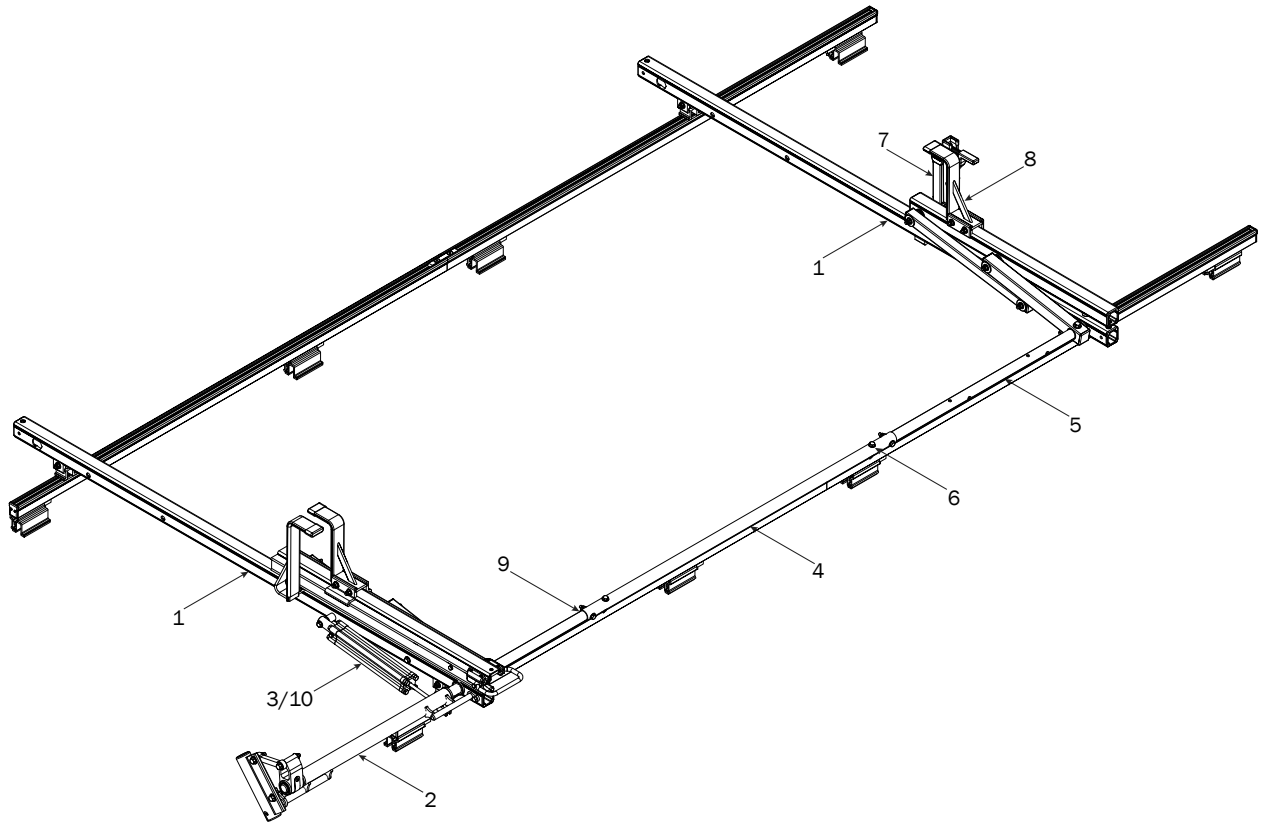
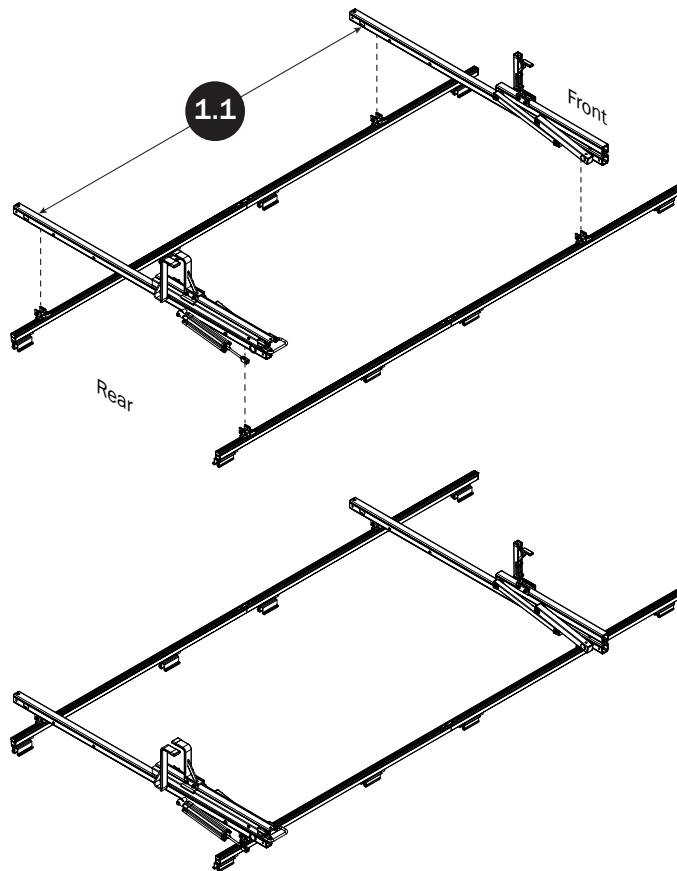
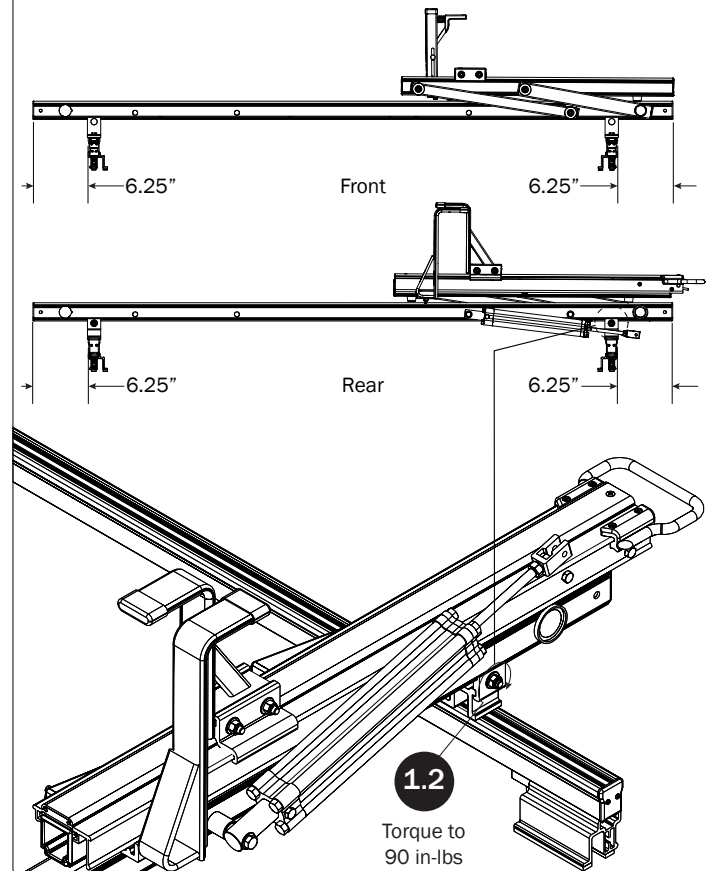
**RIGHT ROTATION ASSEMBLY****CROSSBARS****CROSSBAR ADJUSTMENT**

## REAR DRIVE SHAFT

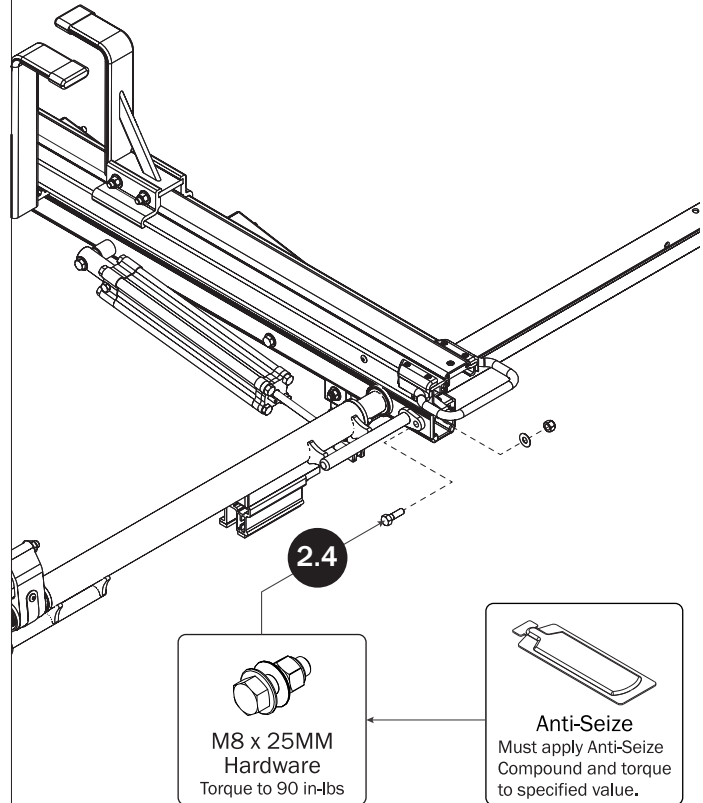
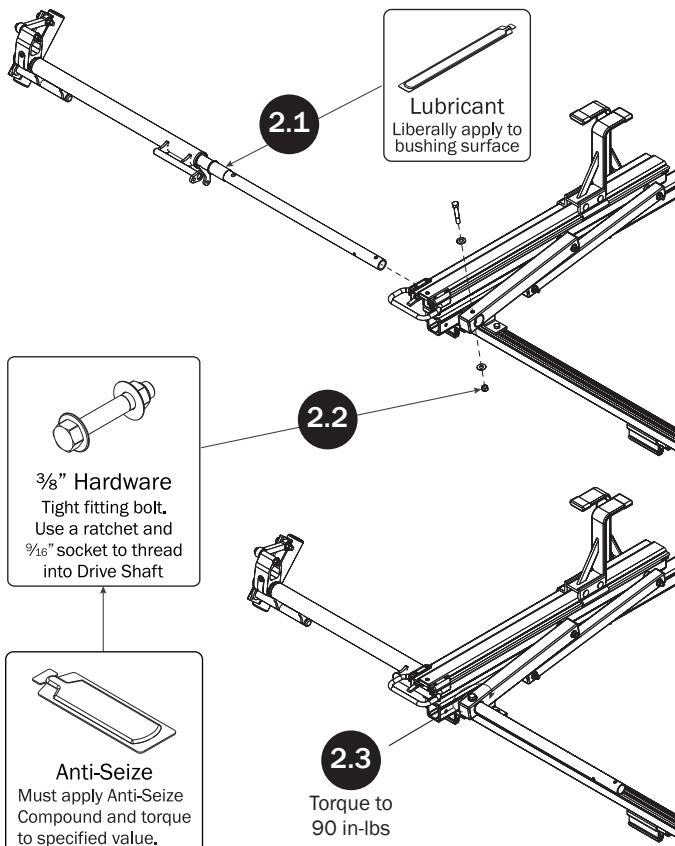

## CYLINDER HARDWARE

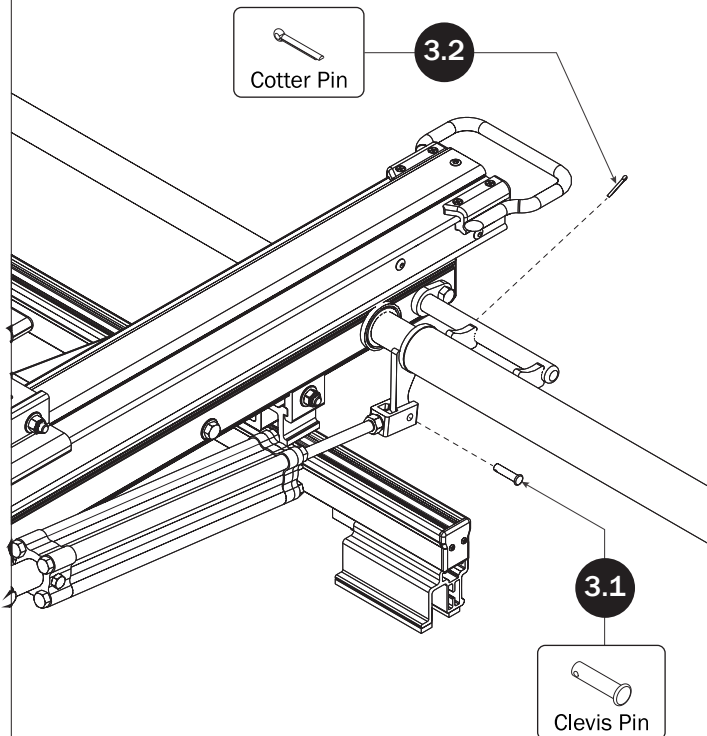

## CONNECTING BAR

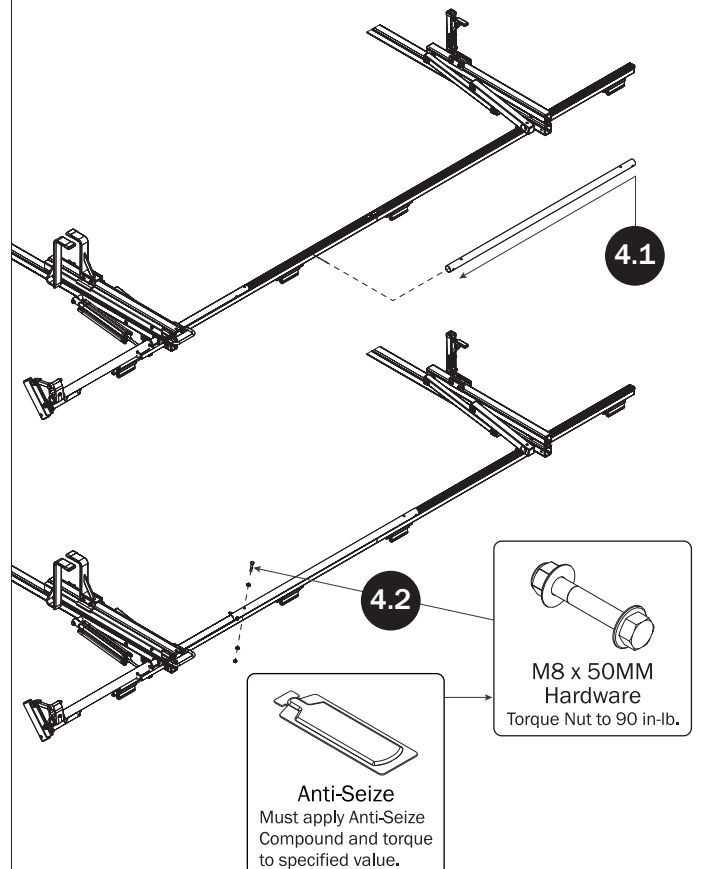



# FRONT DRIVE SHAFT

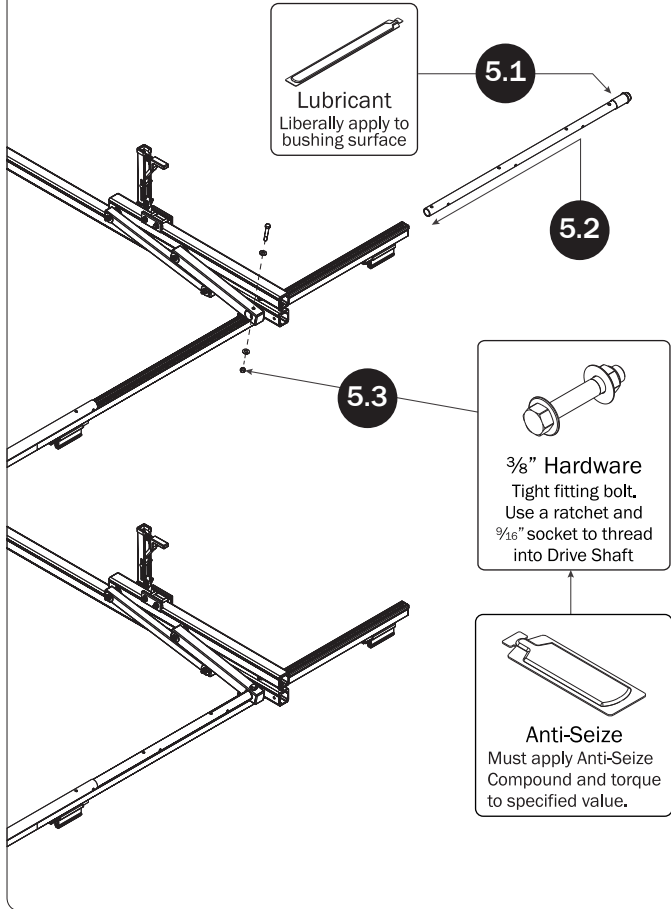

# CONNECTING BAR FASTENERS

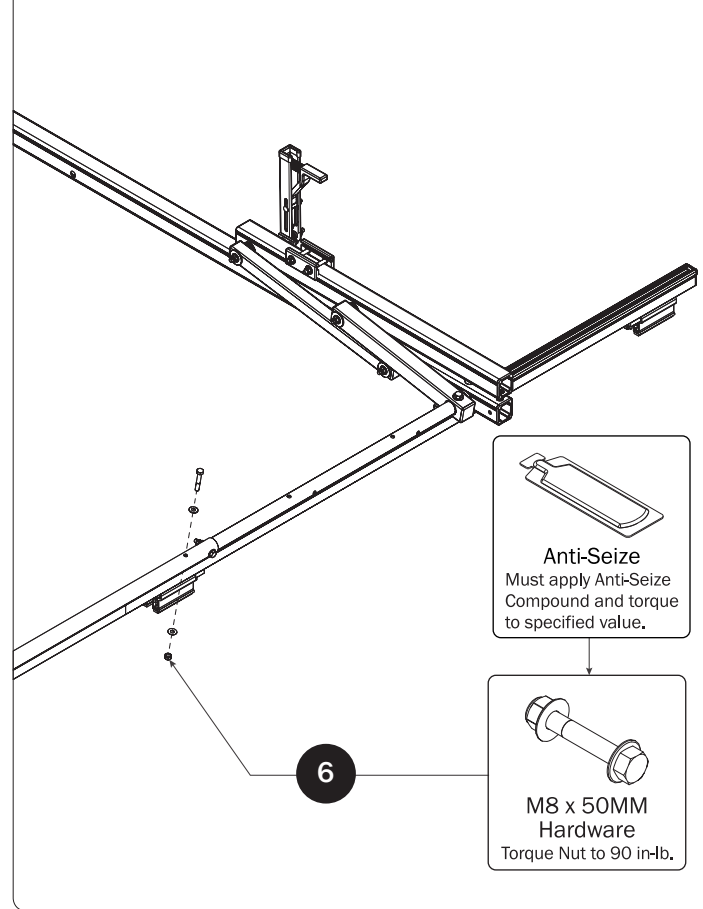

## L POST SEE QUICK START GUIDE FOR ADJUSTMENTS

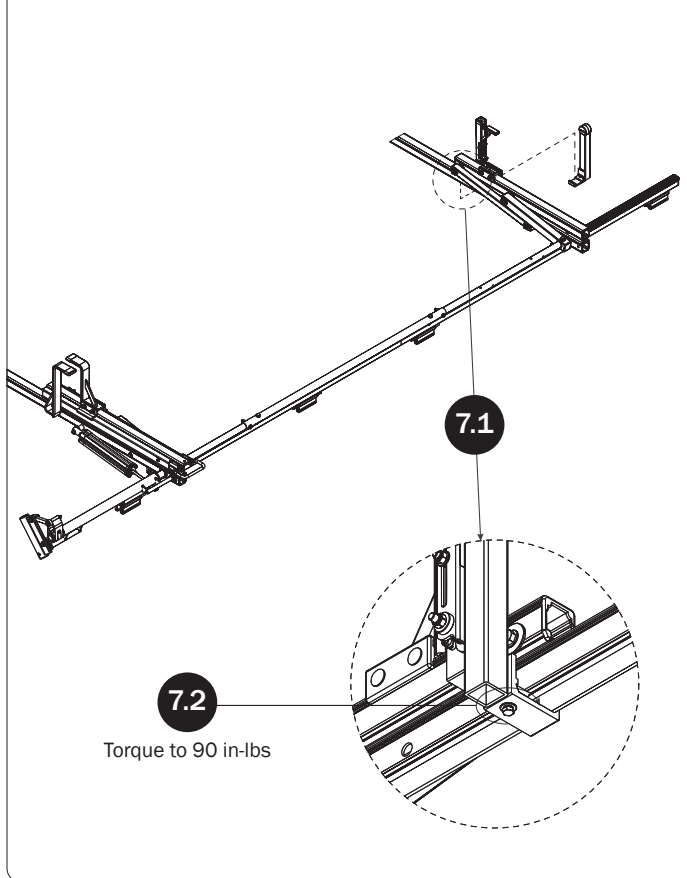

## Z POST SEE QUICK START GUIDE FOR ADJUSTMENTS

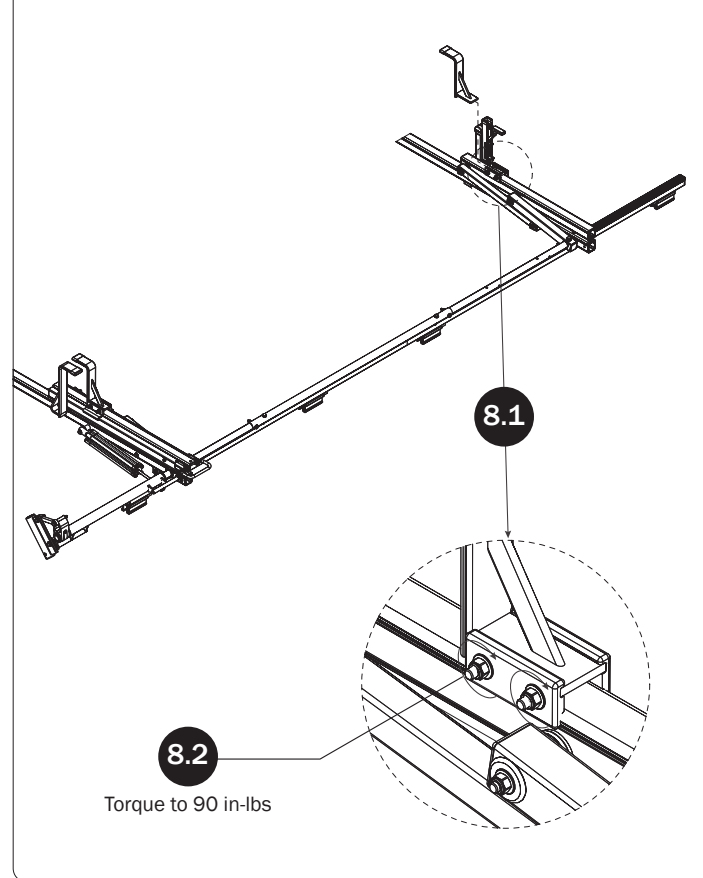



## DRIVE SHAFT SEALING

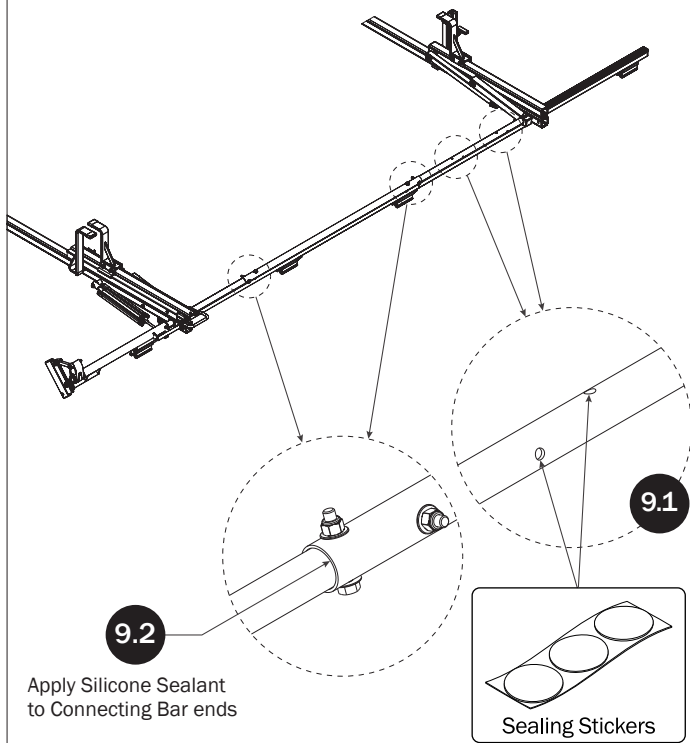

## CYLINDER ADJUSTMENT

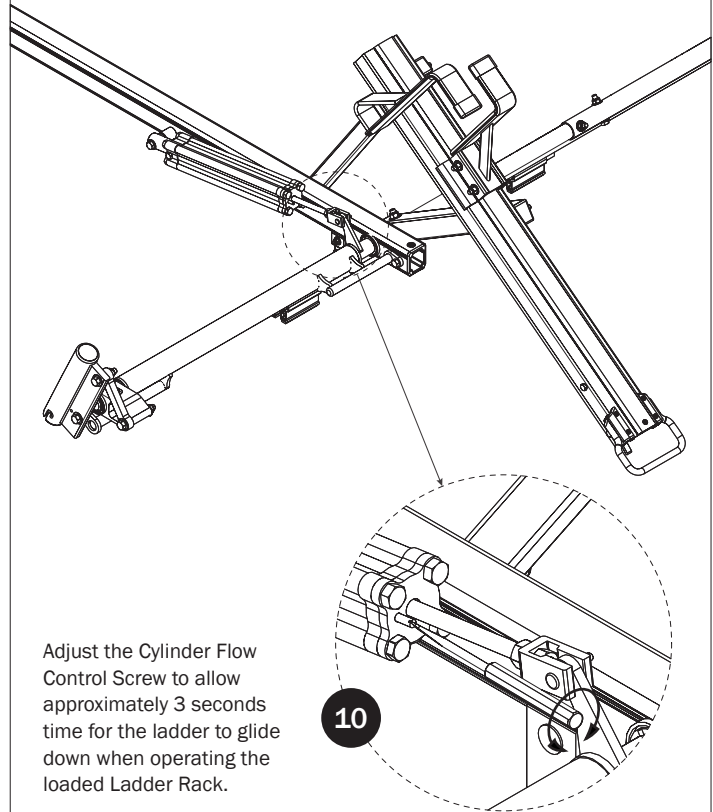

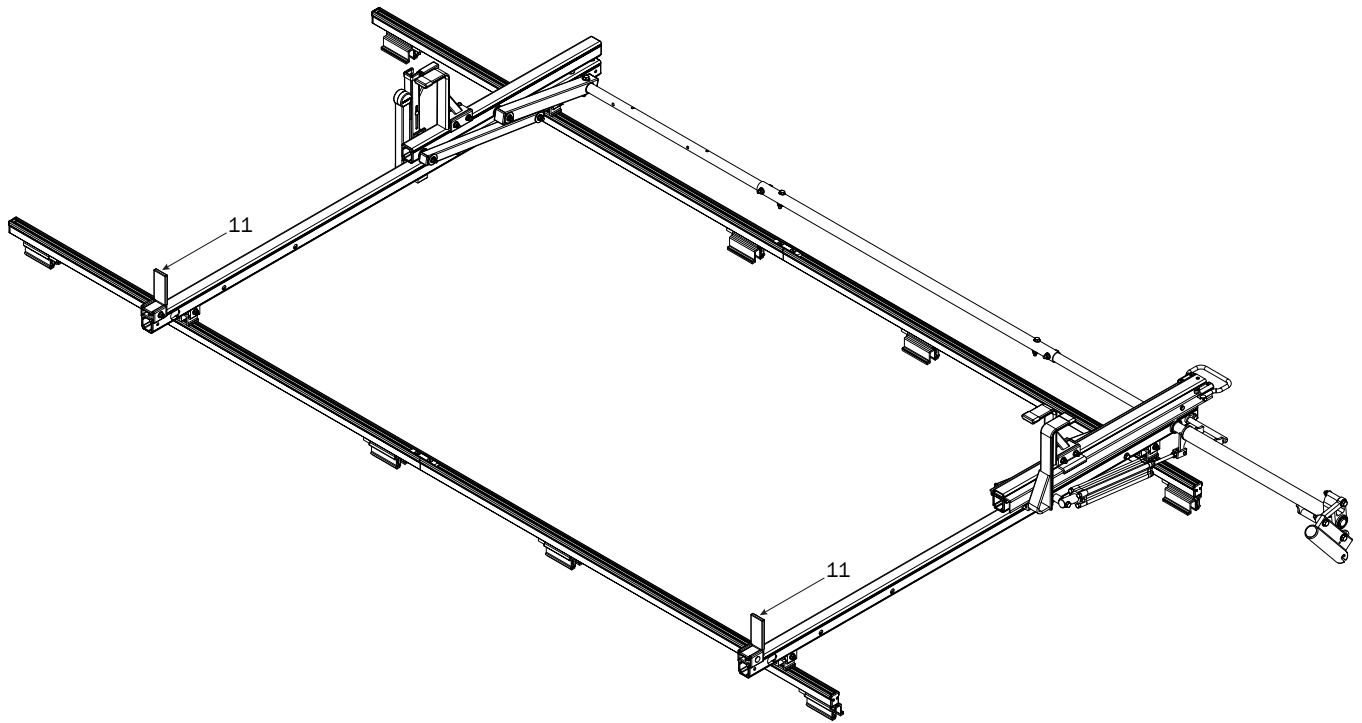
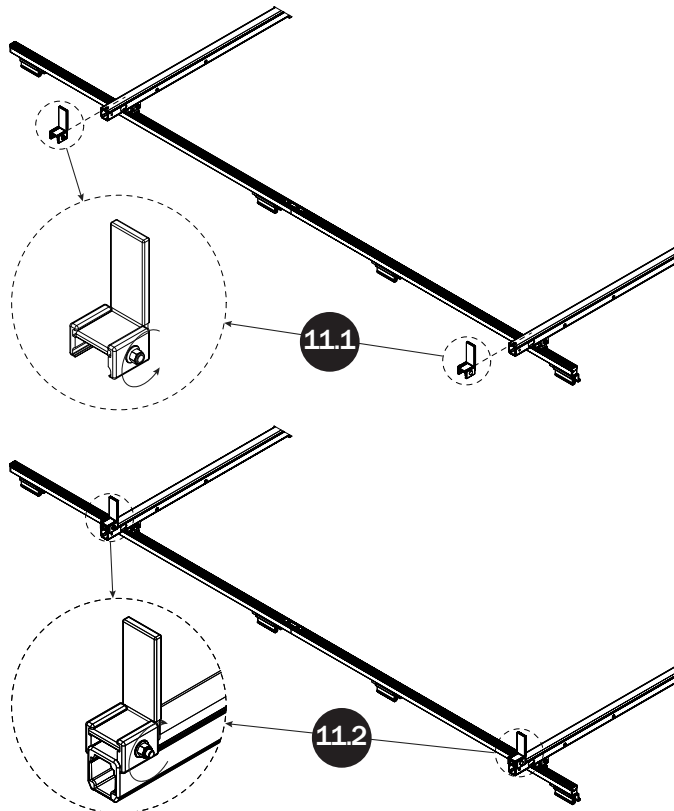
*LEFT SIDE BASE**LADDER STOPS*

Page Intentionally Left Blank

