

PRIME DESIGN™

A Safe Fleet Brand

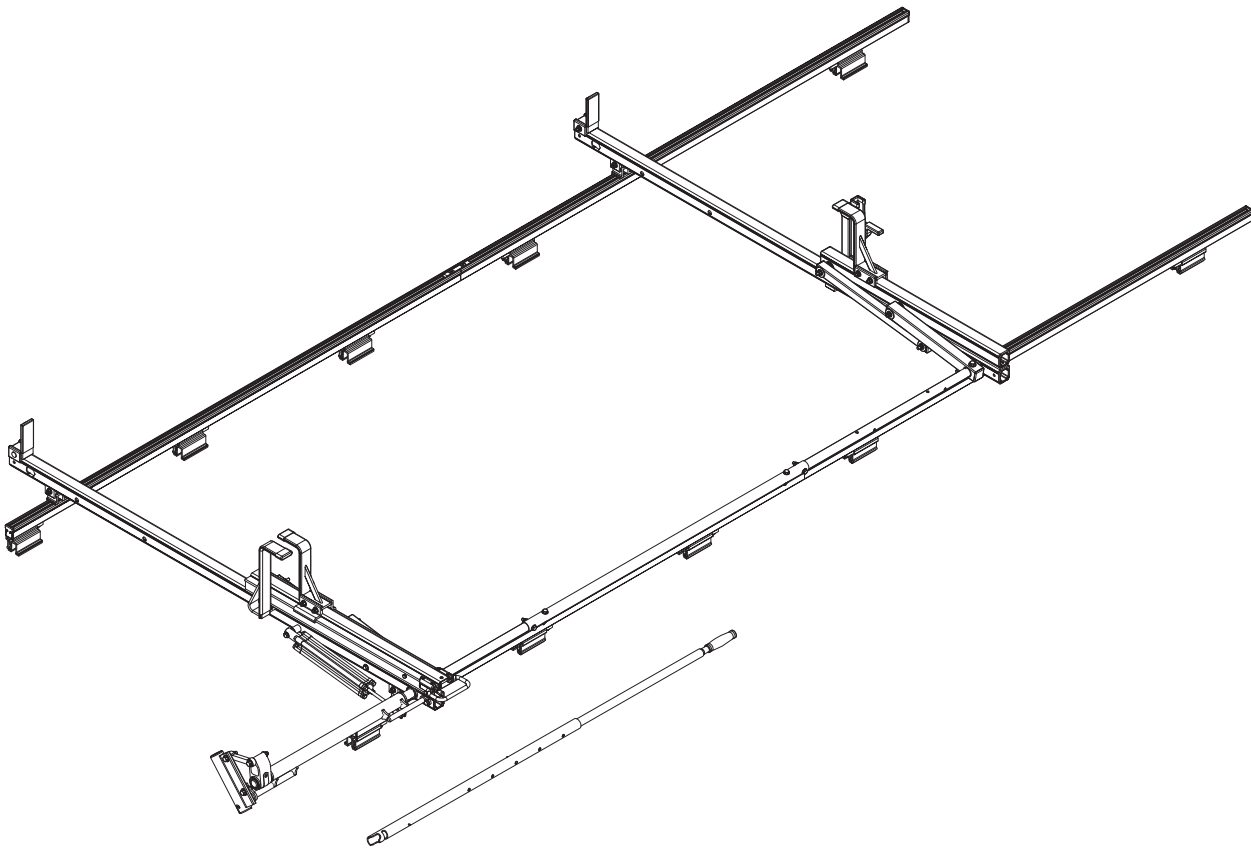

PN5

HBR-E

CONTENTS OVERVIEW

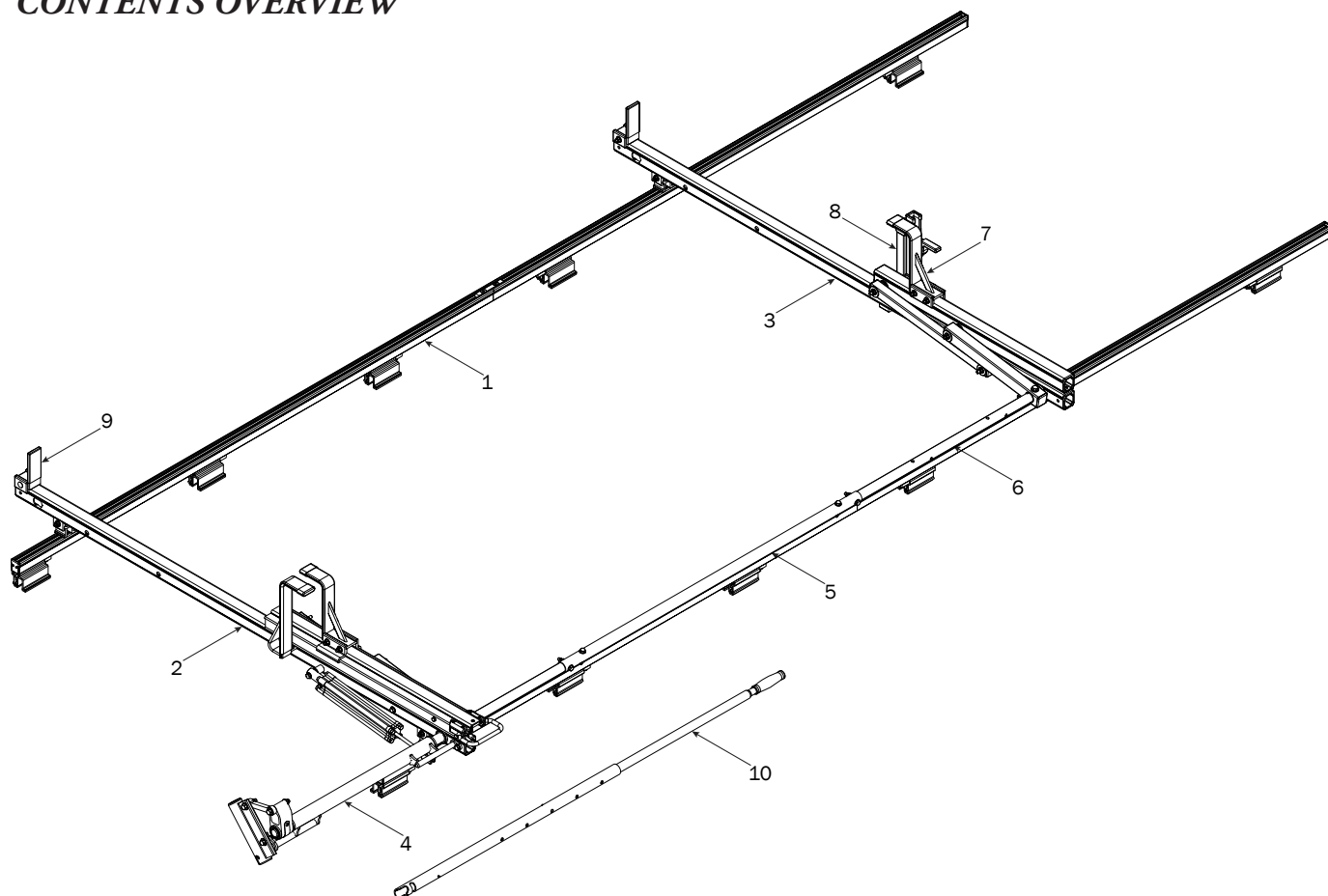

1—FBM-0015 (Qty 1)
Channels with hardware



76" Channels (4X)



End Caps (4X)



Screws (8X)



Top Connector (2X)



Bottom Connector (2X)



Brackets (4X)

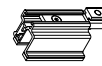

Mountings (10X)

M8 Bolt (4X)

2—Rear Crossbar Assembly (Qty 1)

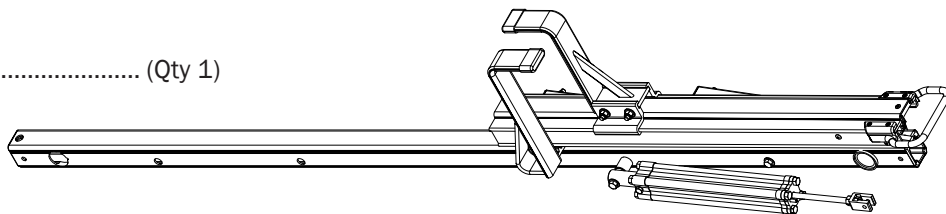

3—Front Crossbar Assembly (Qty 1)

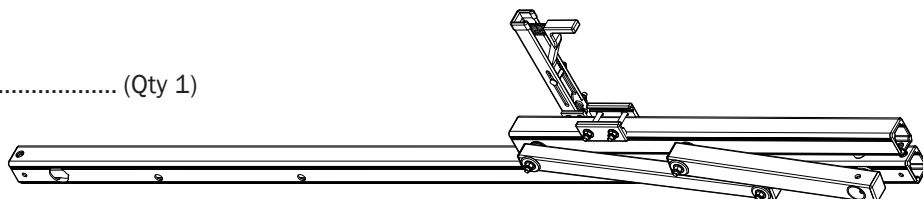

4—Drive Shaft (Qty 1)
Rear, Right Hand, 50.00"

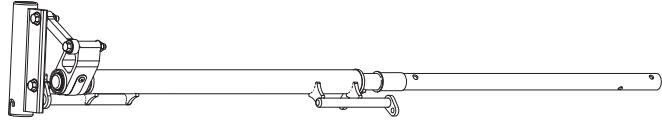

5—Connecting Bar (Qty 1)
48.00"



6—Front Drive Shaft (Qty 1)
B Version, 35.75"

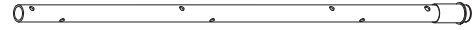

7—Z Post (Qty 1)
Adjustable, 7.25"

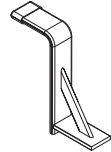

8—L Post (Qty 1)
Gen2, Roller Cap, 9.25"

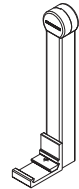

9—Ladder Stop Assembly (Qty 2)
1.75"

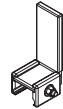

10—HRR Removeable Handle Assembly (Qty 1)

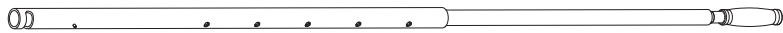

11—HKT-8163 (Not called out in Overview) (Qty 1)

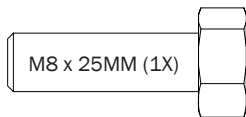

M8 x 25MM (1X)

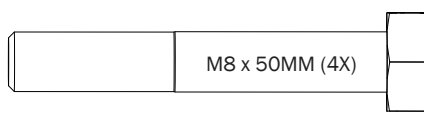

M8 x 50MM (4X)

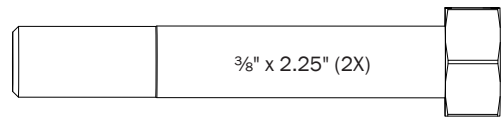

3/8" x 2.25" (2X)



Cotter Pin (1X)

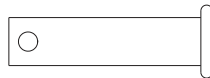

Clevis Pin (1X)

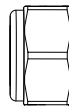

M8 Lock Nut (5X)

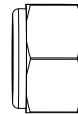

3/8" Lock Nut (2X)

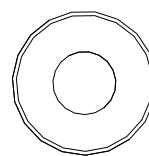

5/16" Flat Washer (10X)

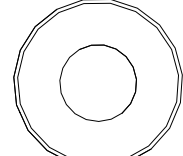

3/8" Flat Washer (4X)

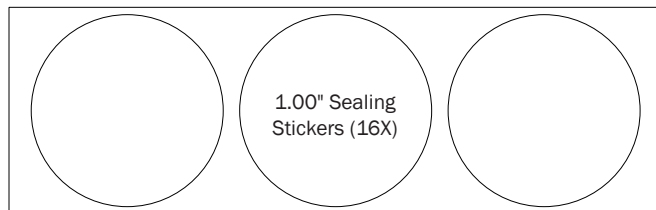

1.00" Sealing
Stickers (16X)



Anti-Seize (1X)

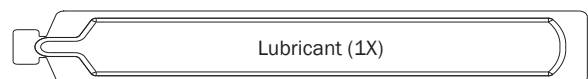

Lubricant (1X)

FBM-0015 MOUNTING BRACKETS

INSTALLER NOTE: Mounting Brackets must be disassembled for installation onto the vehicle's roof.

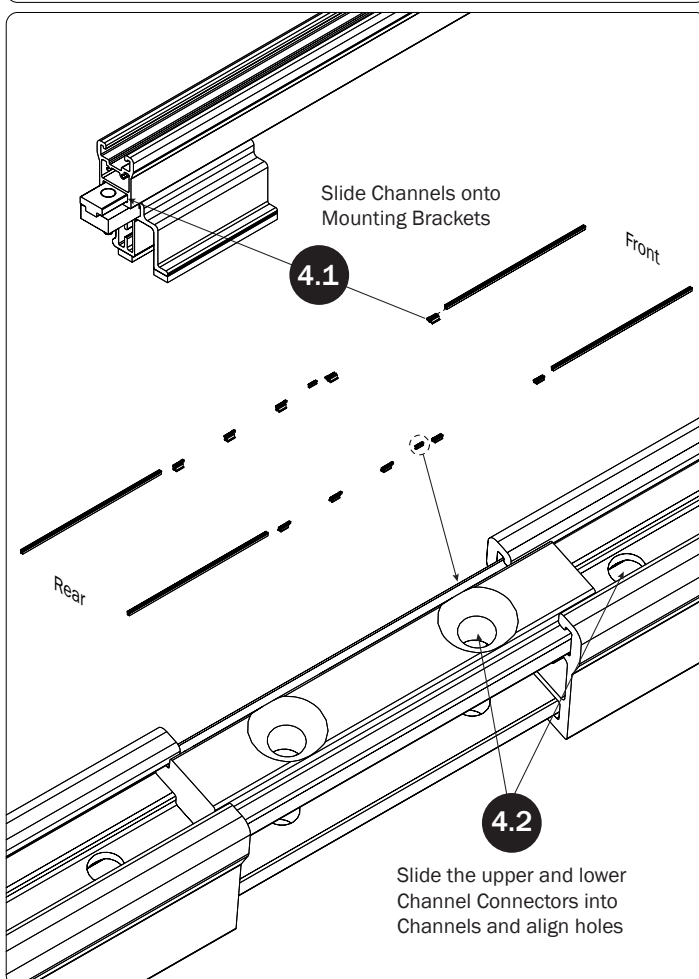
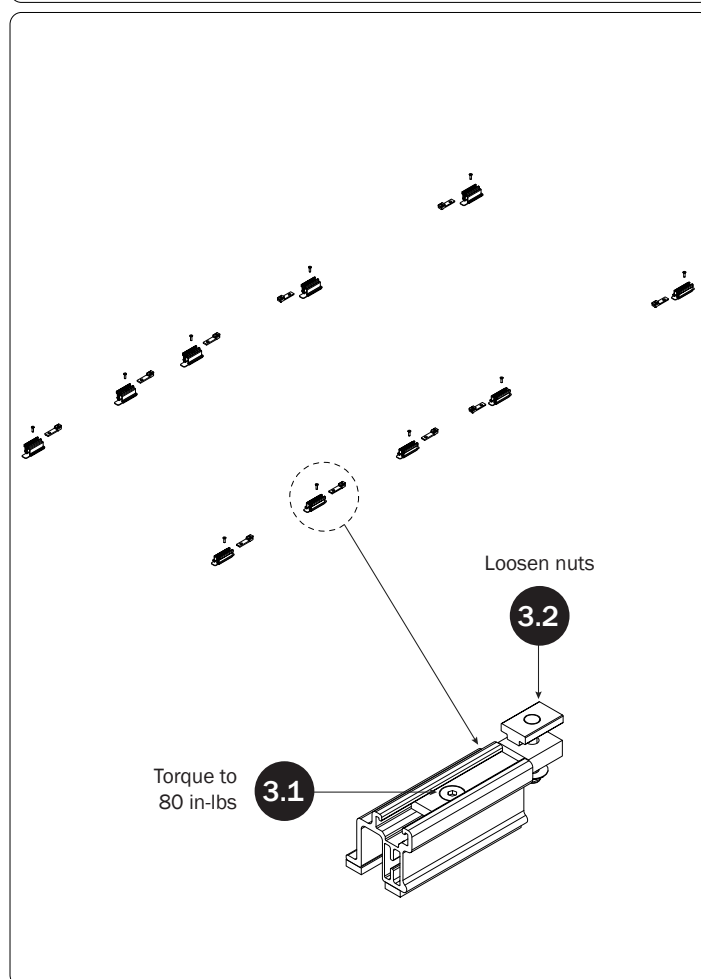
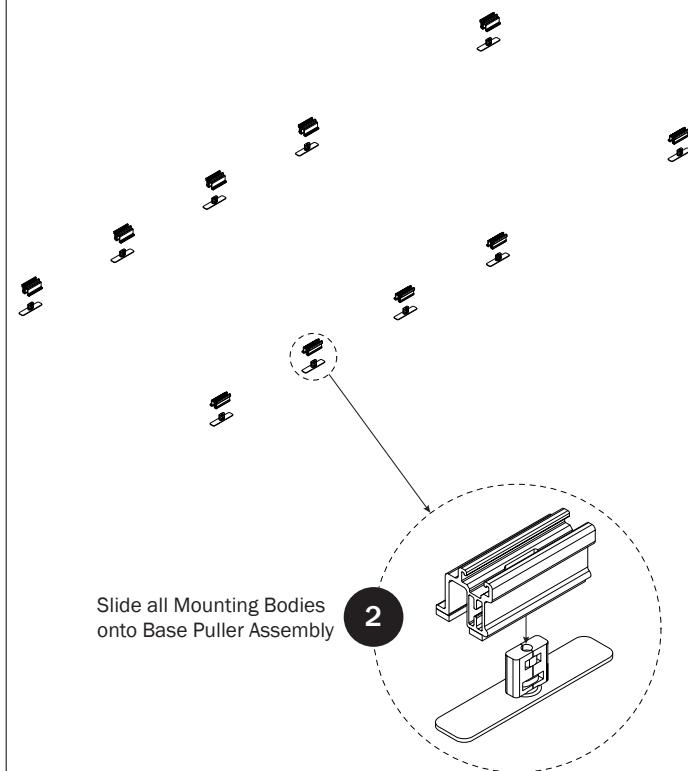
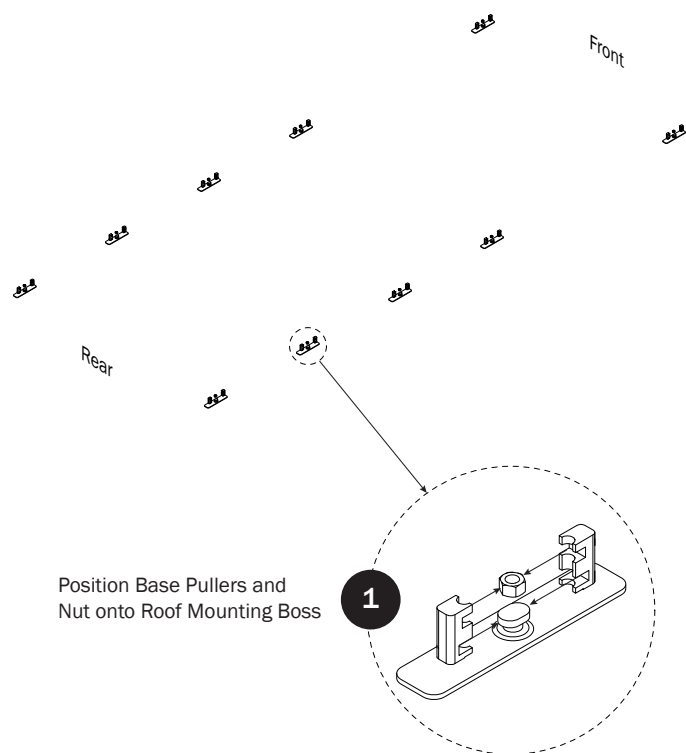

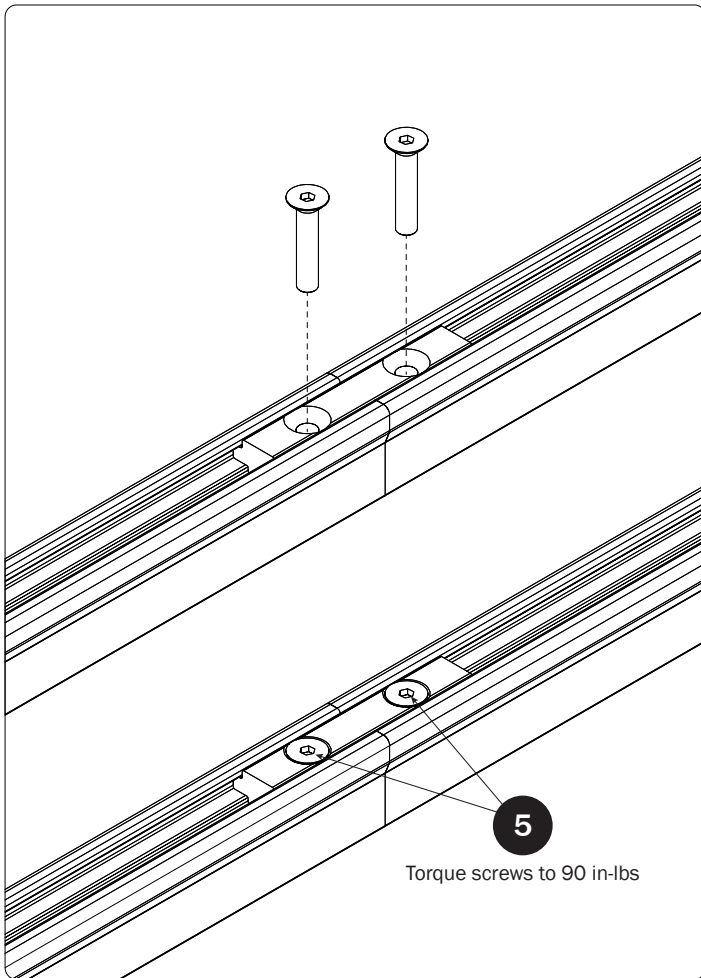

6 Set to distances then torque Mounting Bracket nuts to 80 in-lbs

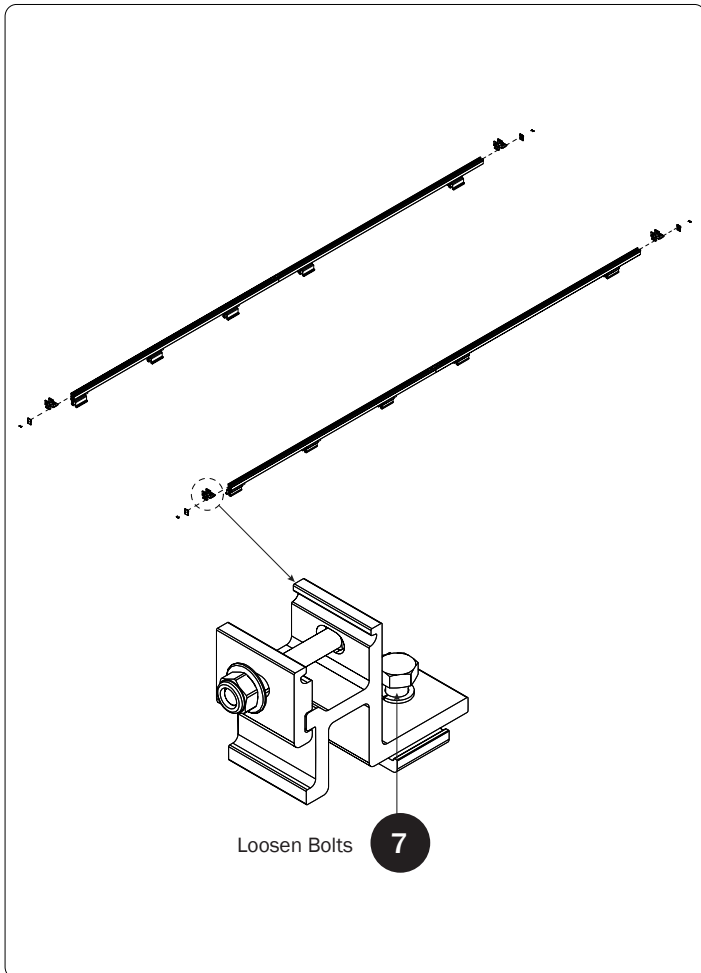
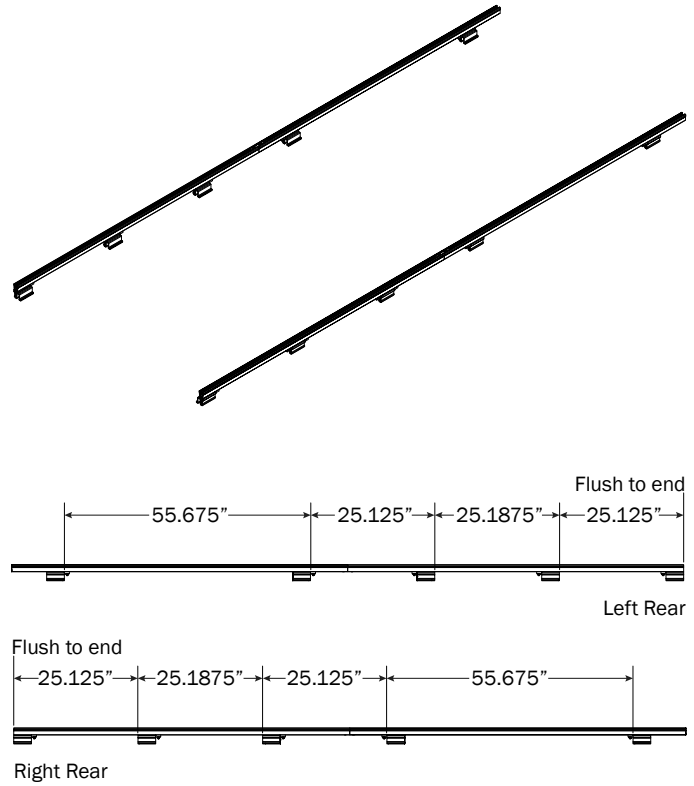

8 Set to distances shown, but do not tighten at this time

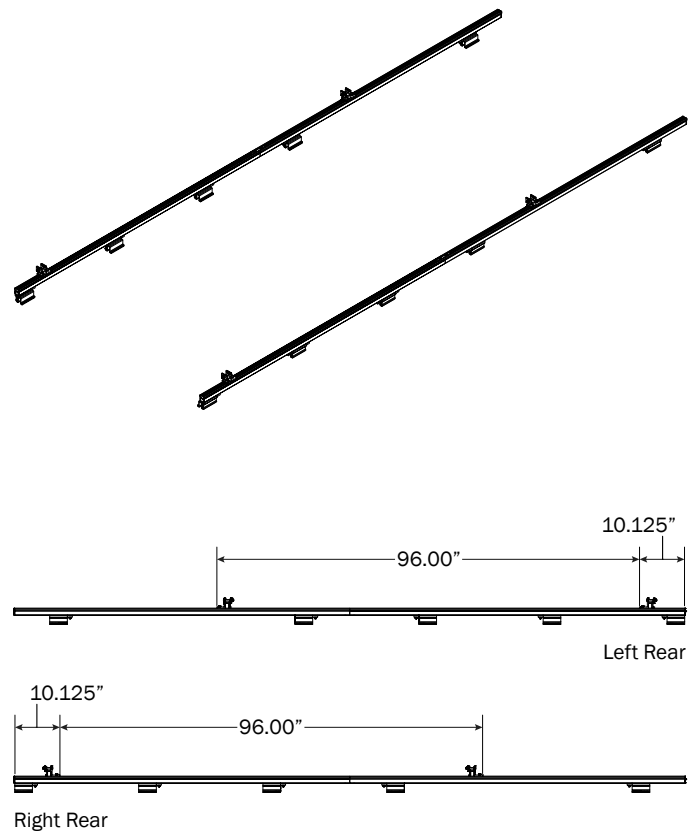

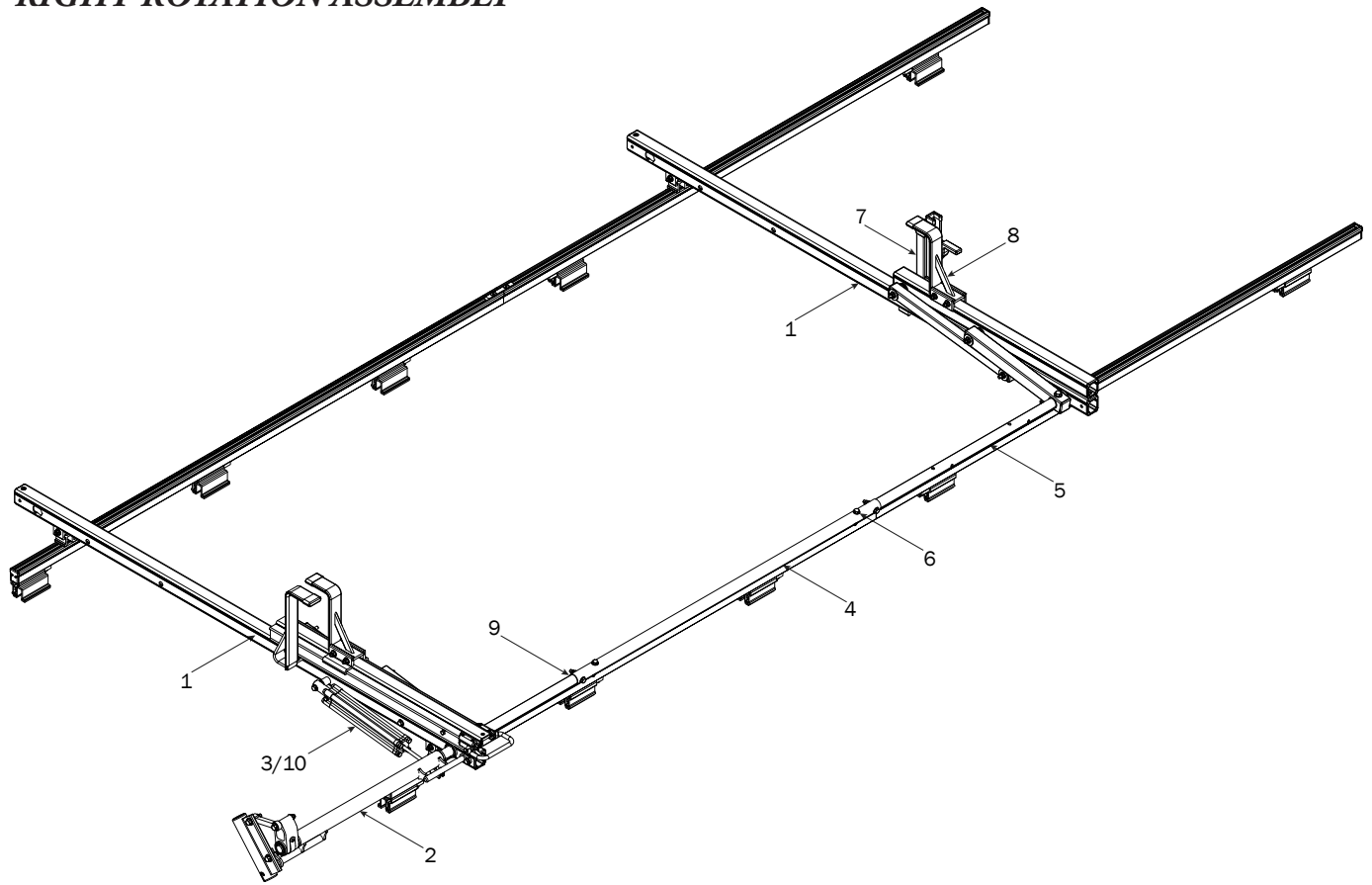
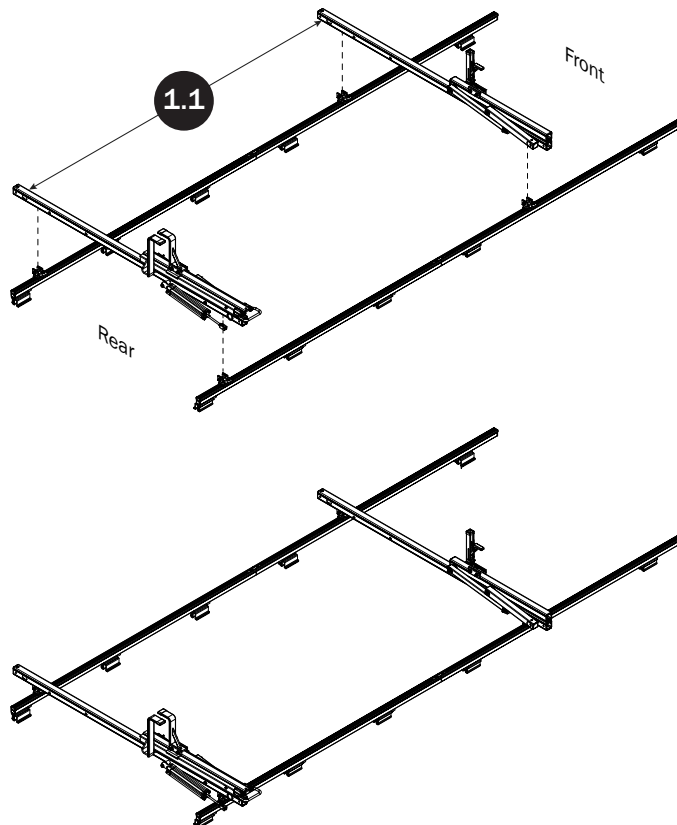
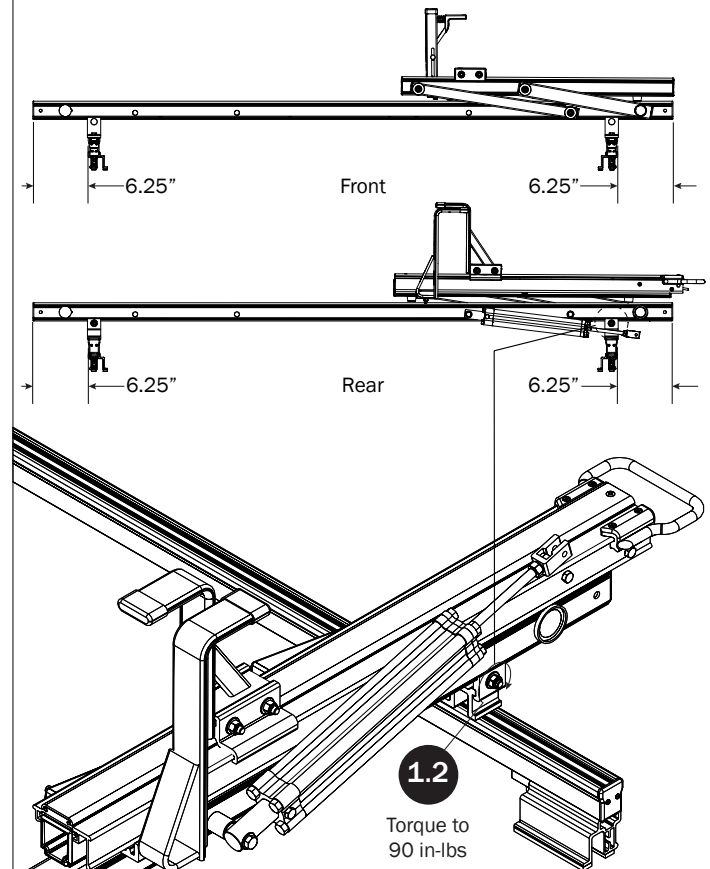
RIGHT ROTATION ASSEMBLY**CROSSBARS****CROSSBAR ADJUSTMENT**

REAR DRIVE SHAFT

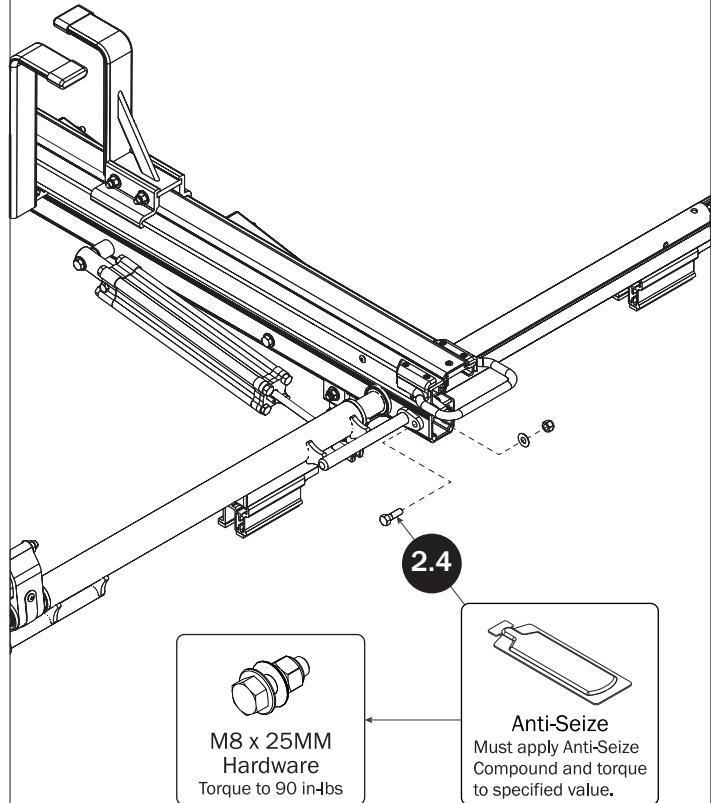
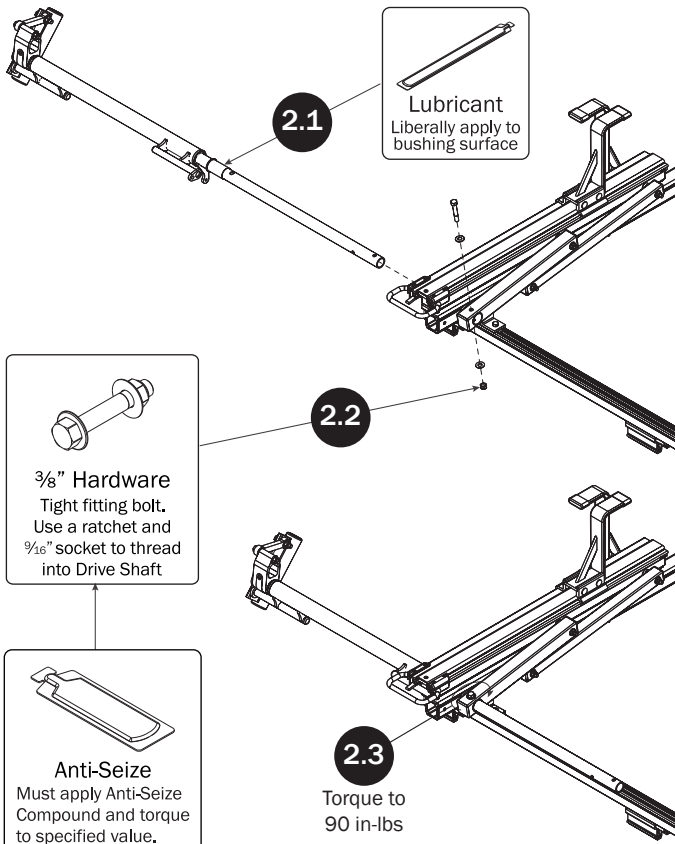

CYLINDER HARDWARE

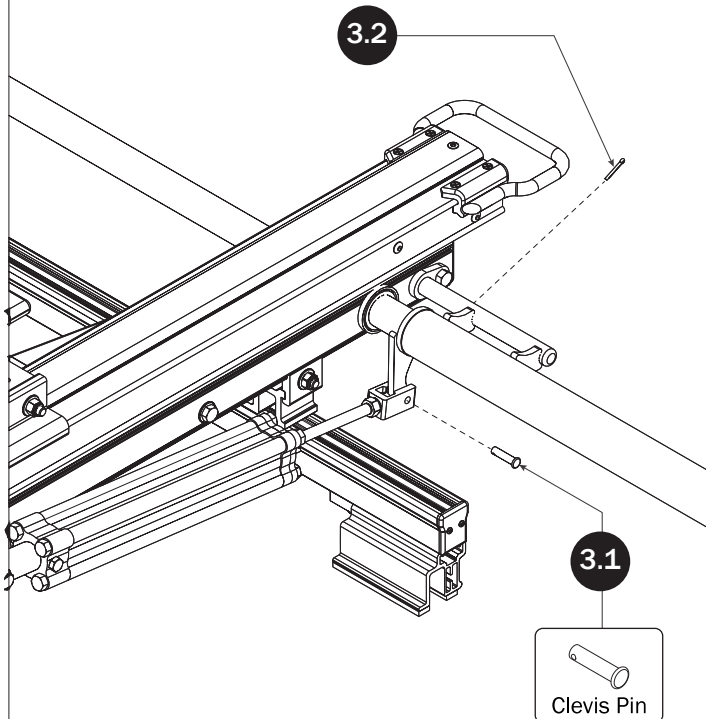

CONNECTING BAR

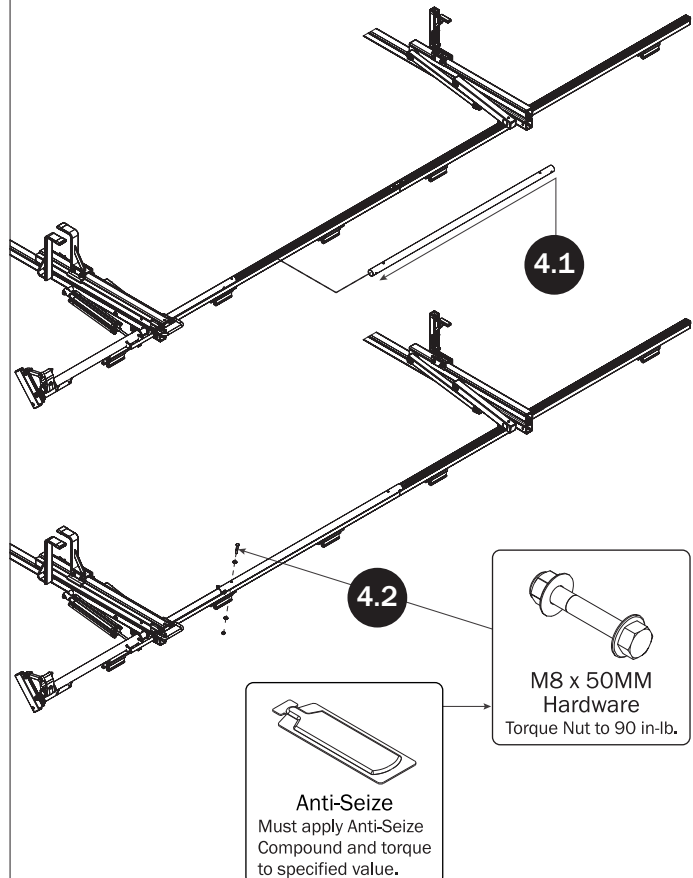

FRONT DRIVE SHAFT

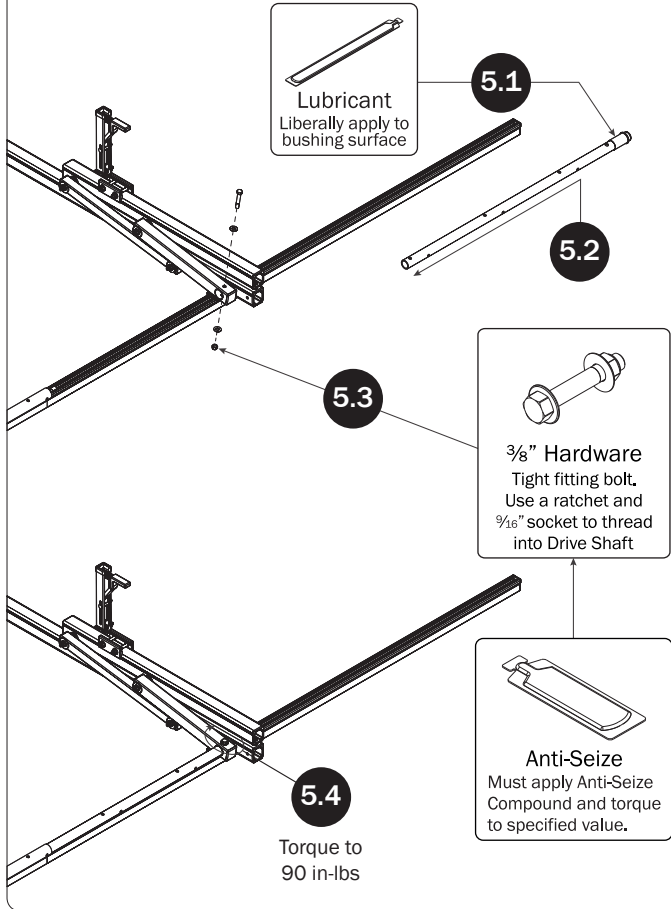

CONNECTING BAR FASTENERS

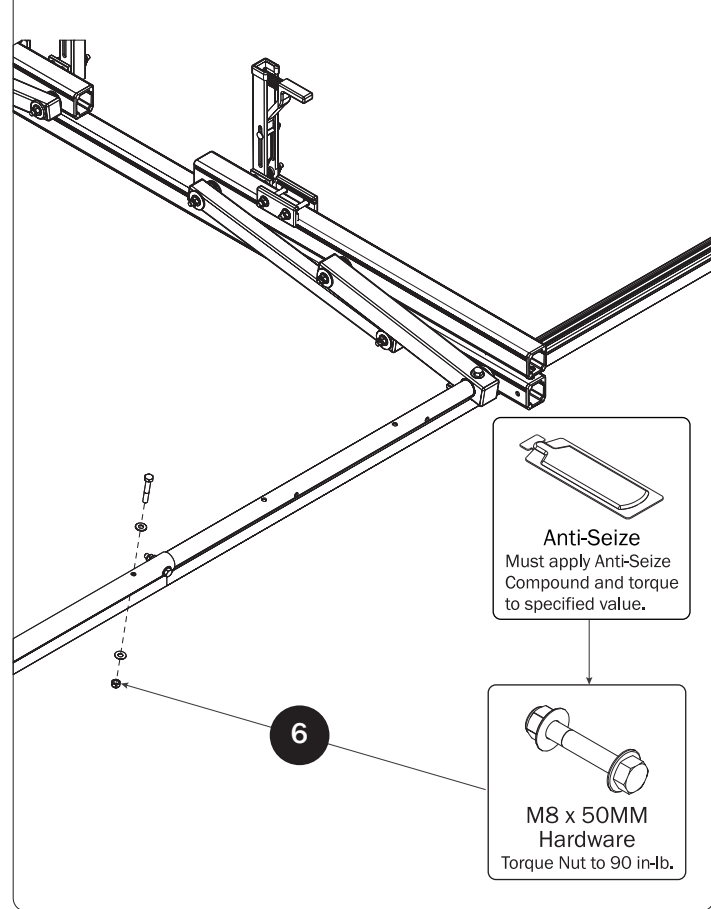

L POSTS SEE QUICK START GUIDE FOR ADJUSTMENTS

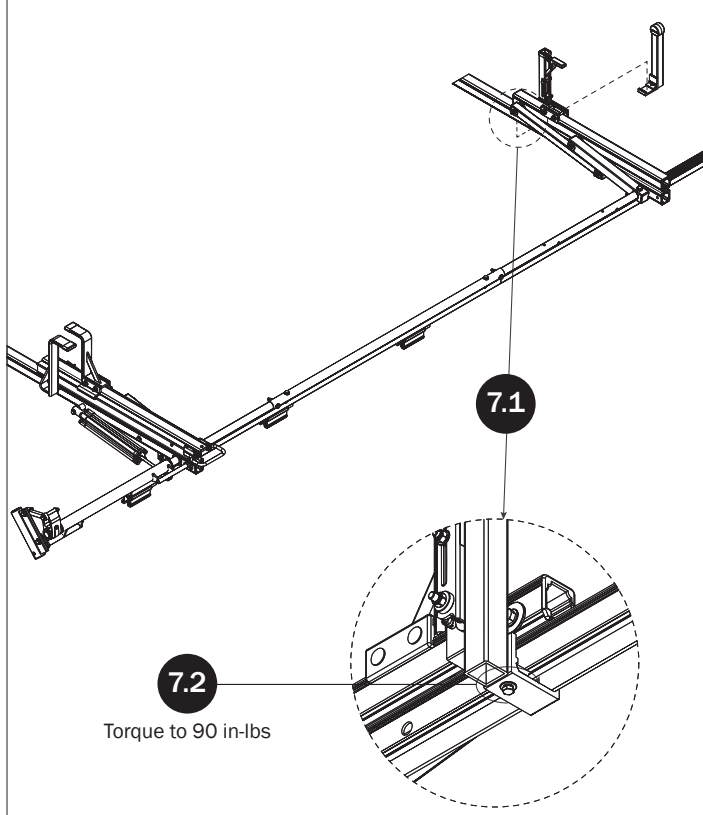

Z POSTS SEE QUICK START GUIDE FOR ADJUSTMENTS

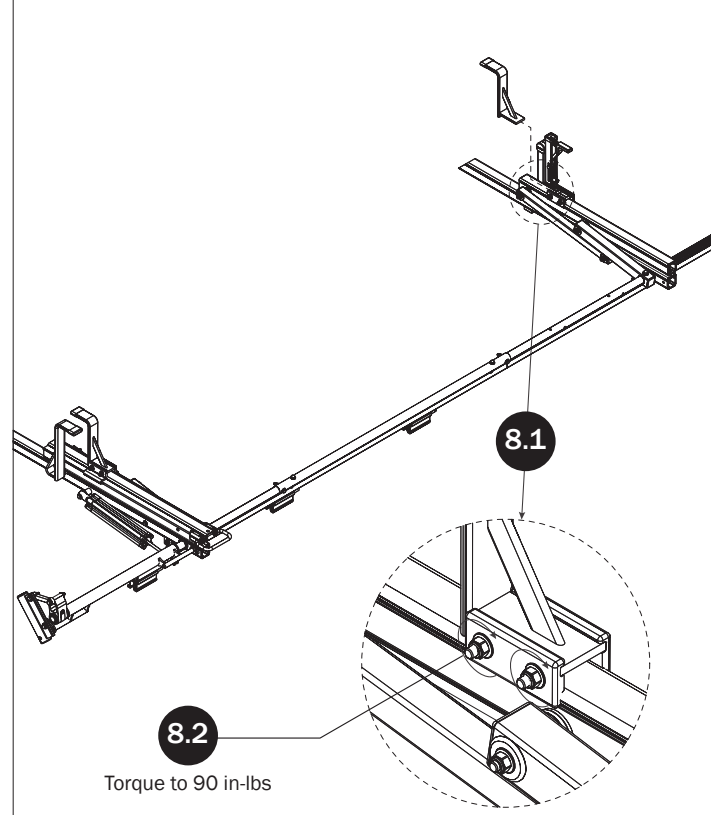

LEFT SIDE BASE

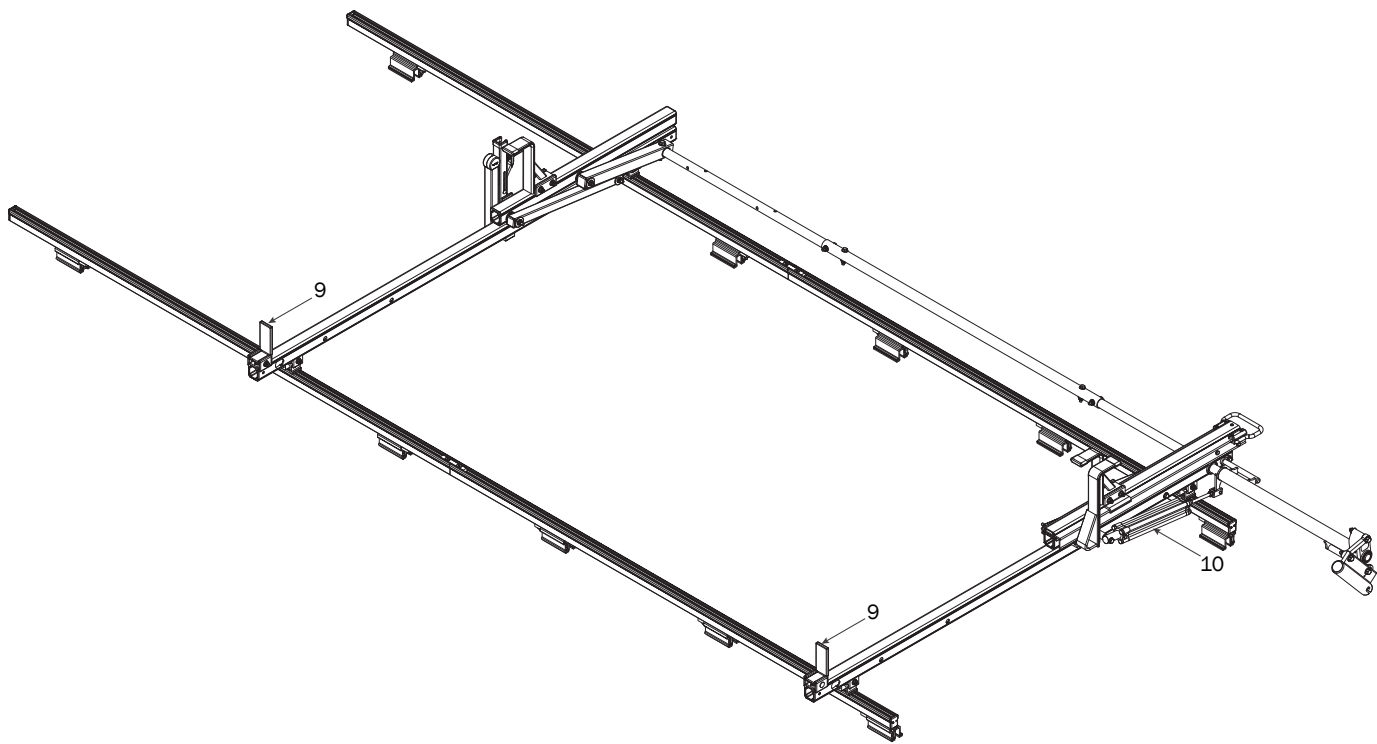

LADDER STOPS

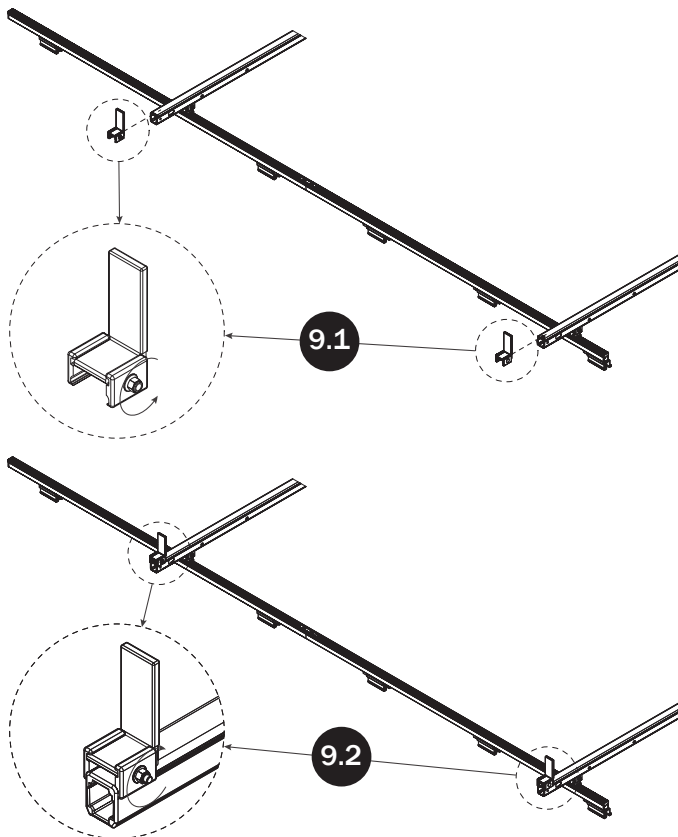

CYLINDER ADJUSTMENT

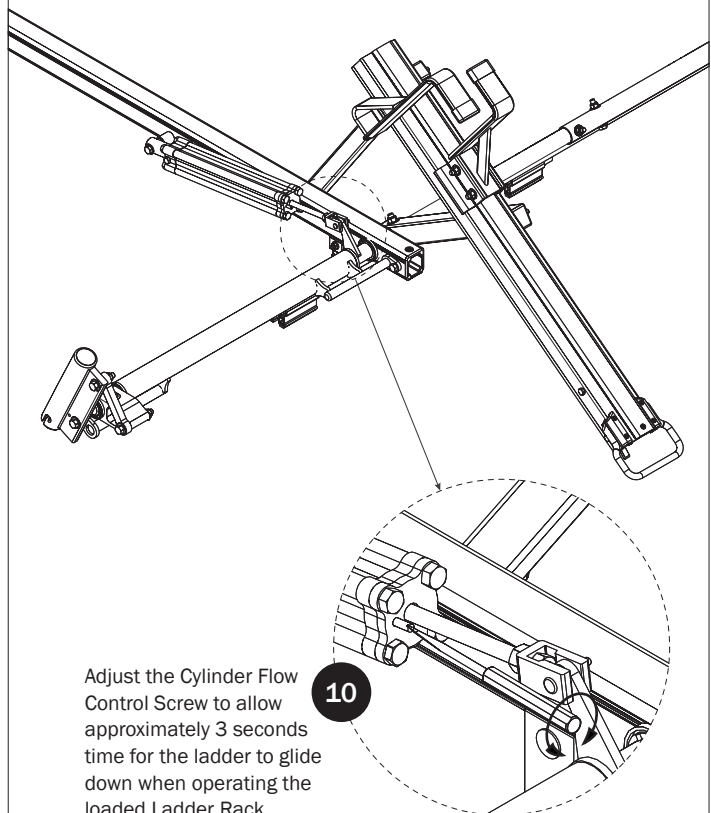

Page Intentionally Left Blank

Page Intentionally Left Blank

