

PRIME DESIGN™

A Safe Fleet Brand

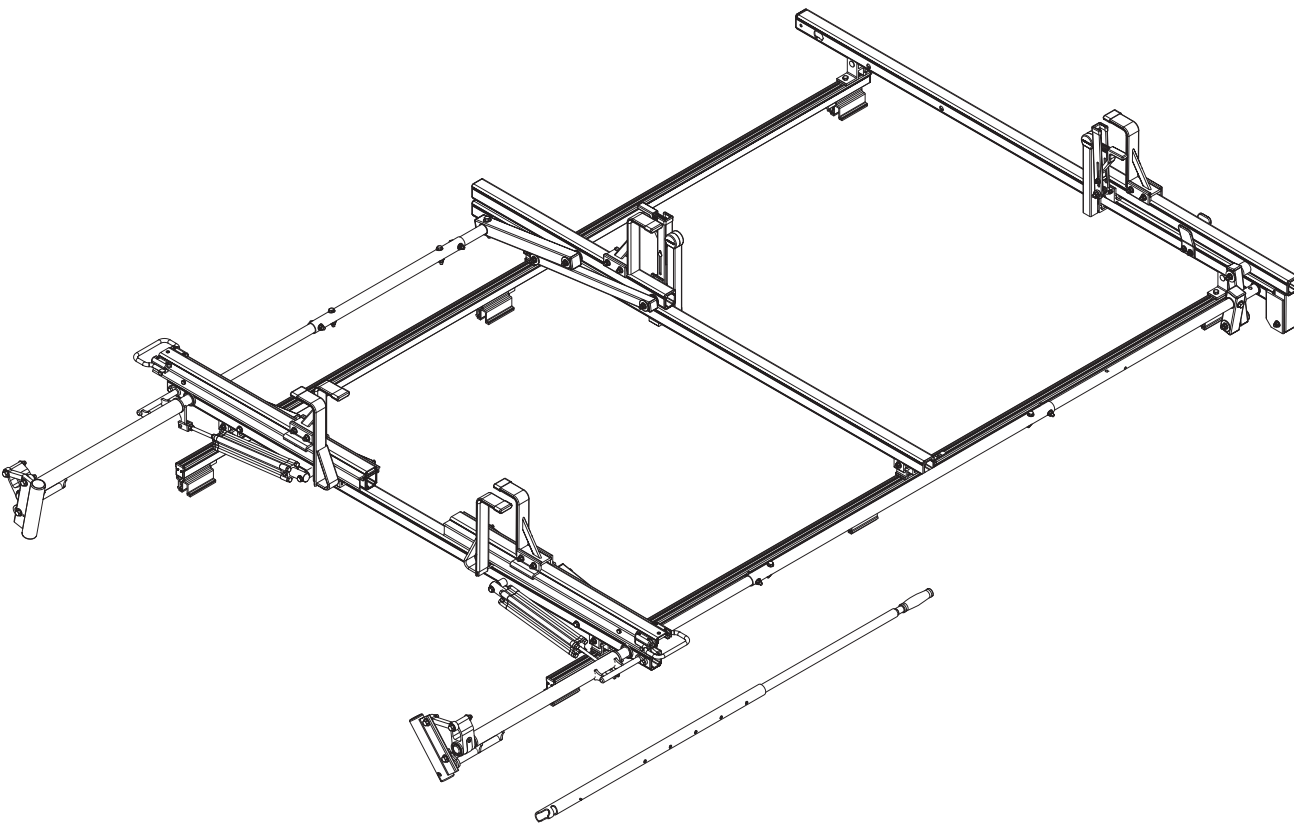

PRIME DESIGN

HR13-E

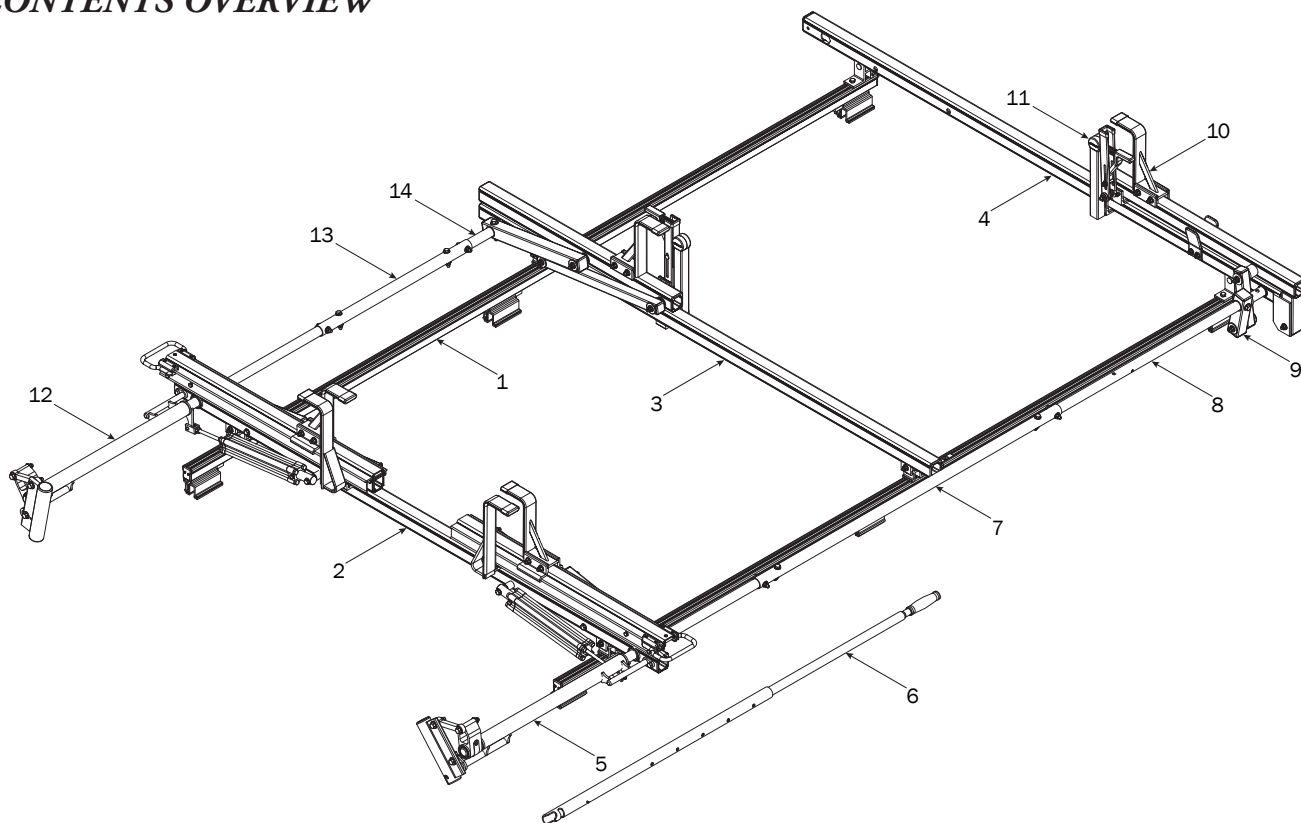

- 1—FBM3-0013 (Qty 1)
Channels with hardware

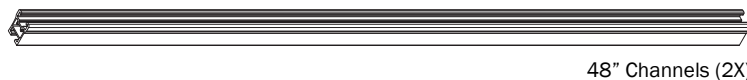

48" Channels (2X)



60" Channels (2X)



End Caps (4X)



Screws (8X)



Top Connector (2X)



Bottom Connector (2X)



Brackets (6X)

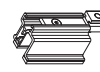

Mountings (6X)

M8 Bolt (4X)

- 2—Rear Crossbar Assembly (Qty 1)

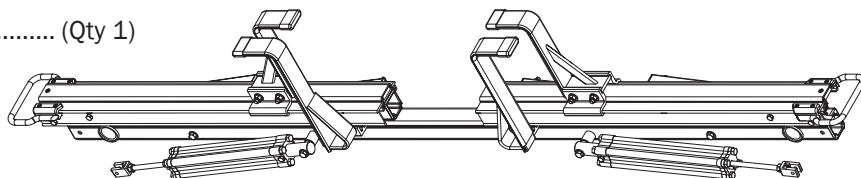

- 3—Center Crossbar Assembly (Qty 1)

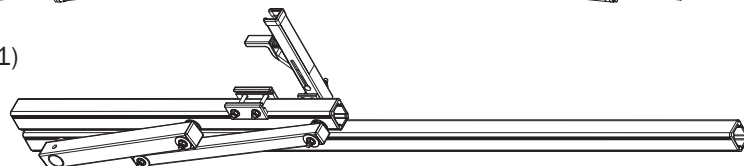

- 4—Front Crossbar Assembly (Qty 1)

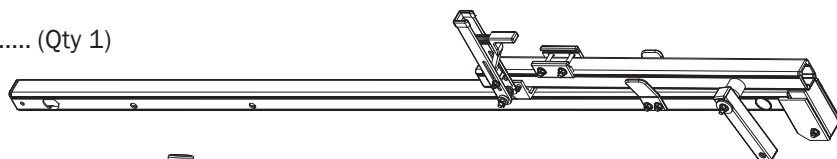

- 5—Rear Drive Shaft (Qty 1)
Right Hand, A Version, 50.00"

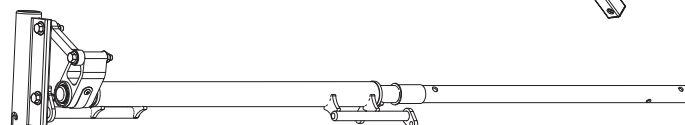

6—HHR Handle Assembly (Qty 1)
35.00"

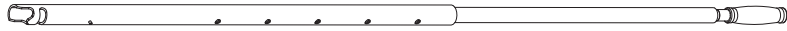

7—Connecting Bar (Qty 1)
4.00'



8—Front Drive Shaft (Qty 1)
B Version, 35.75"



9—Drive Arm (Qty 1)
Incline Version with Bushing and Hardware



10—Z Post (Qty 2)
Adjustable, 7.25"

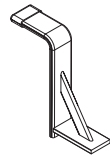

11—L Post (Qty 2)
Gen2, Roller Cap, 9.25"



12—Rear Drive Shaft (Qty 1)
Left Hand, A Version, 50.00"

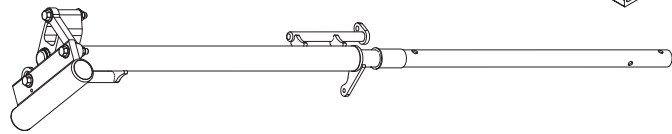

13—Connecting Bar (Qty 1)
24.00"

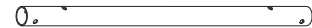

14—Front Drive Shaft (Qty 1)
B Version, 11.75"

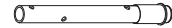

15—HKT-8163 (Not called out in Overview)..... (Qty 1)

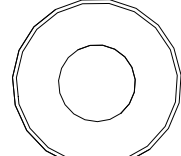
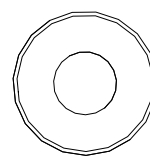
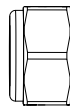
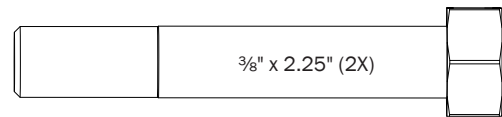
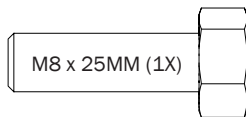

Cotter Pin (1X)

Clevis Pin (1X)

M8 Lock Nut (5X)

3/8" Lock Nut (2X)

5/16" Flat Washer (10X)

3/8" Flat Washer (4X)

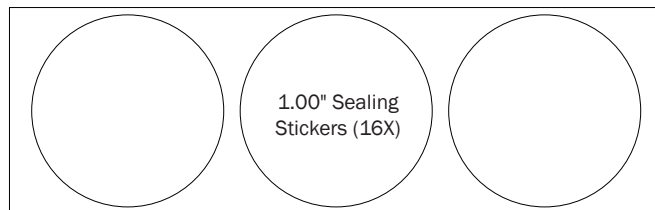

1.00" Sealing
Stickers (16X)



Anti-Seize (1X)

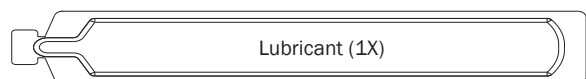

Lubricant (1X)

FBM3-0013 MOUNTING BRACKETS

INSTALLER NOTE: Mounting Brackets must be disassembled for installation onto the vehicle's roof.

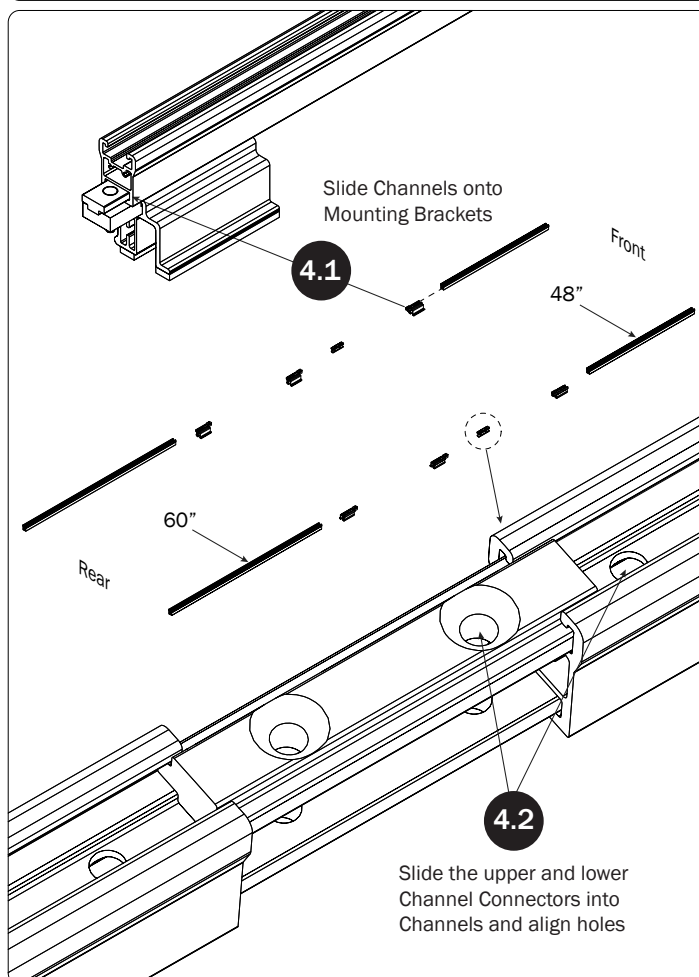
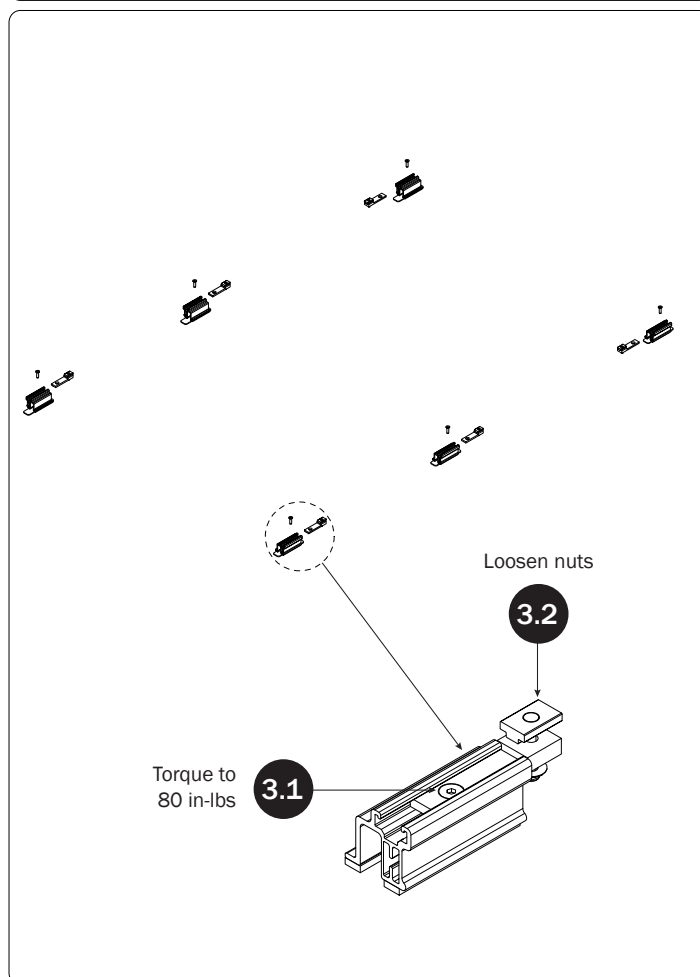
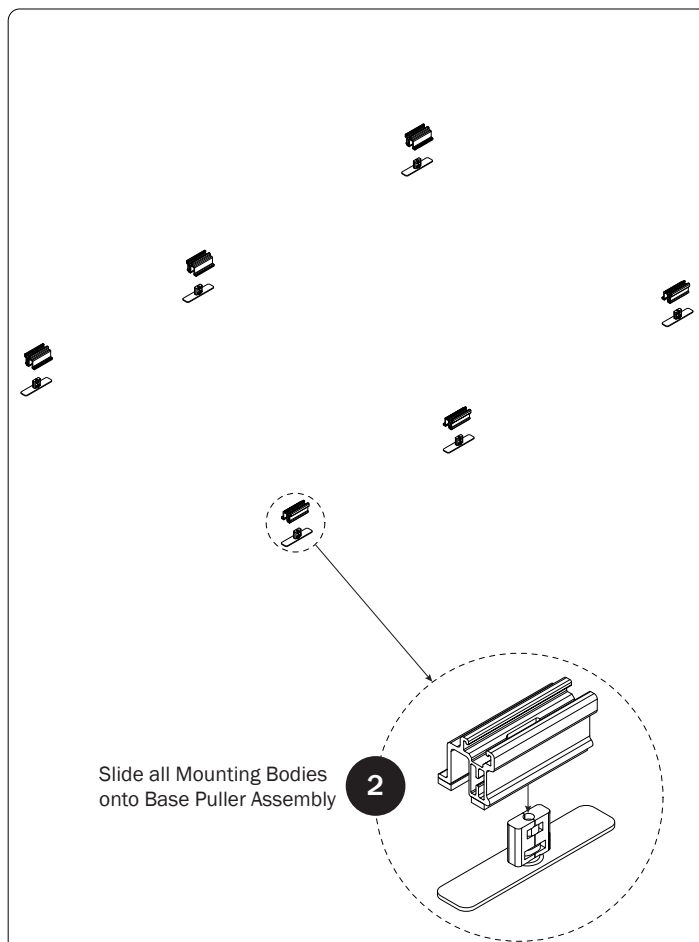
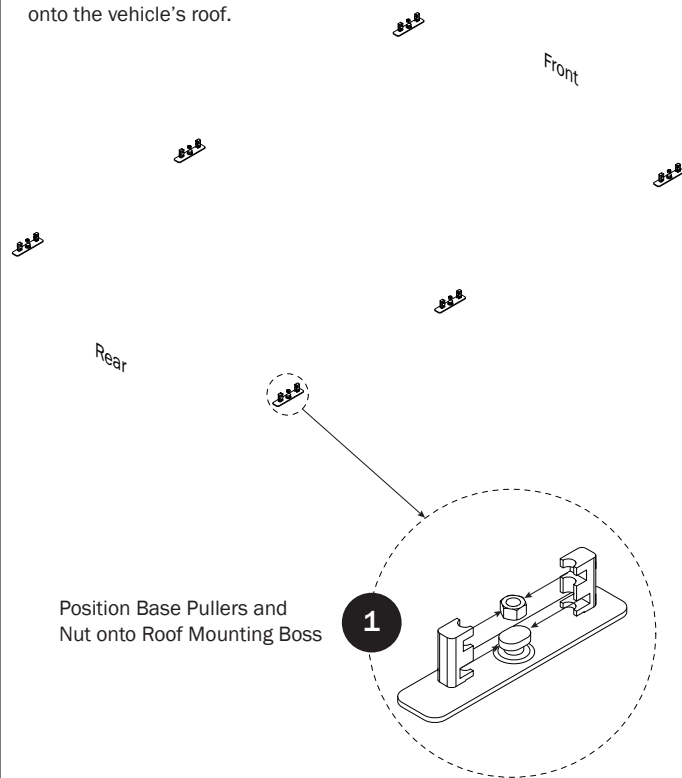

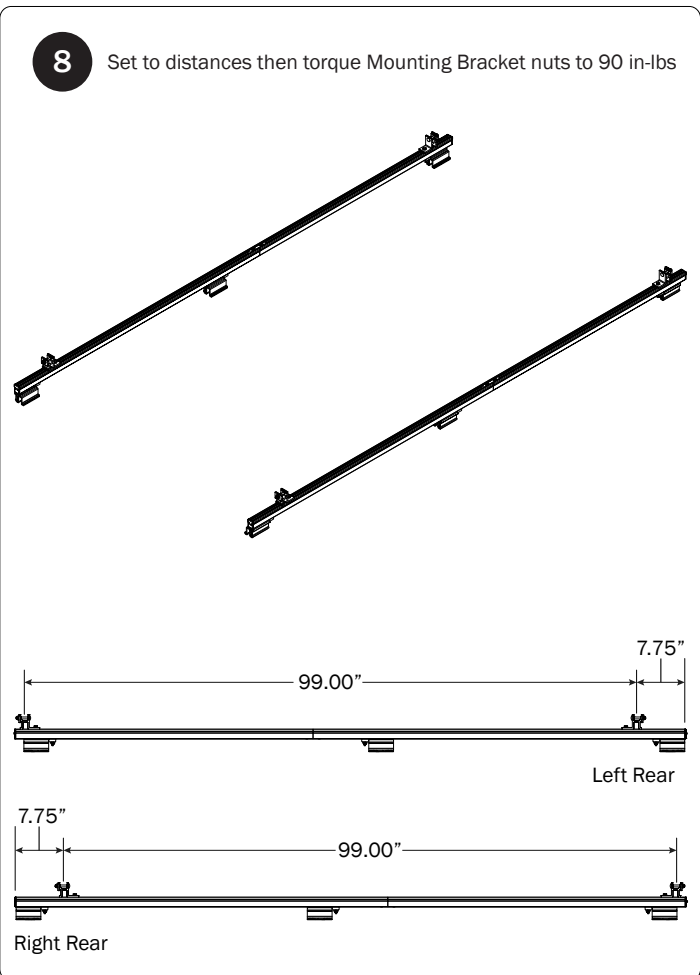
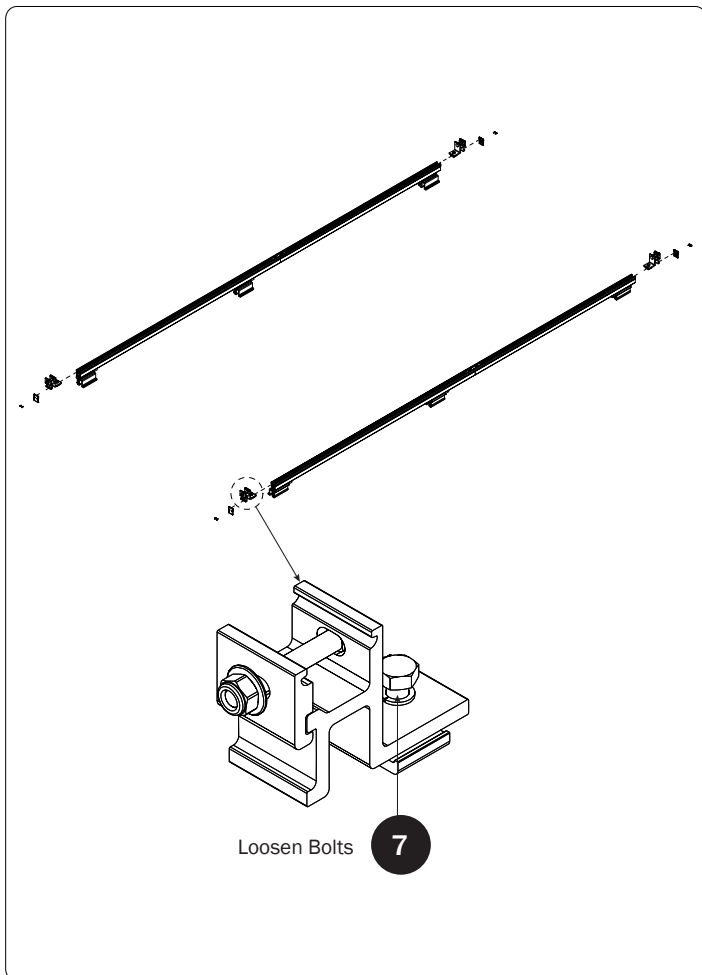
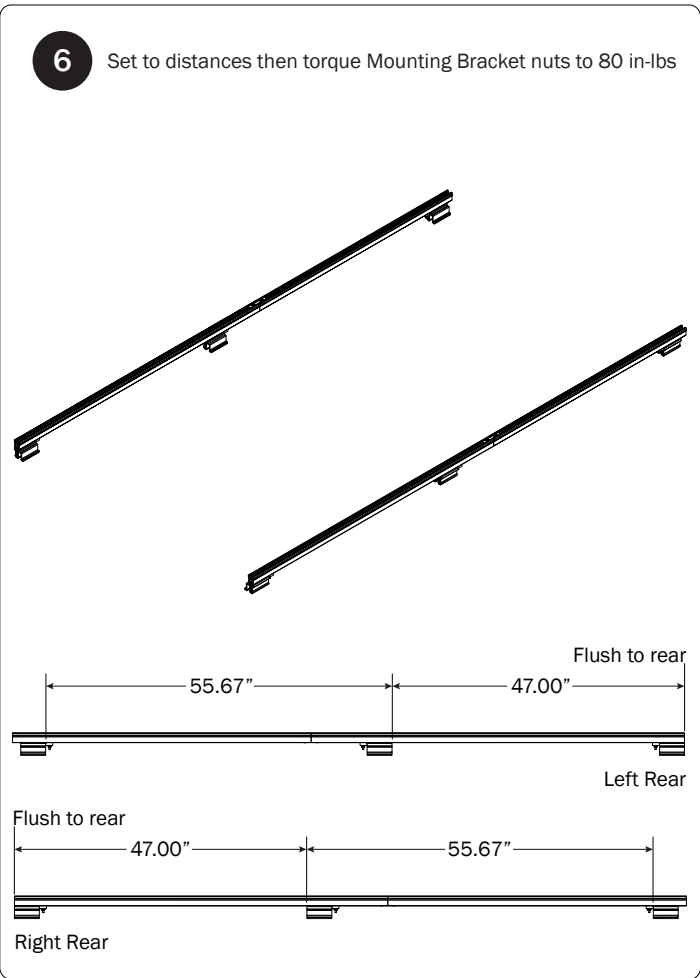
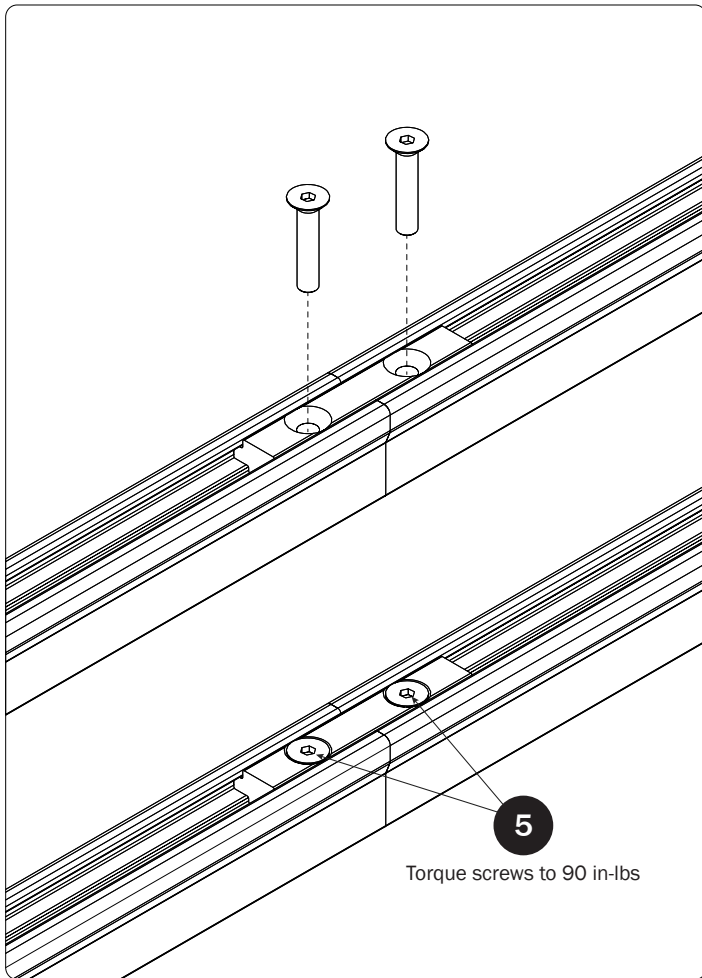

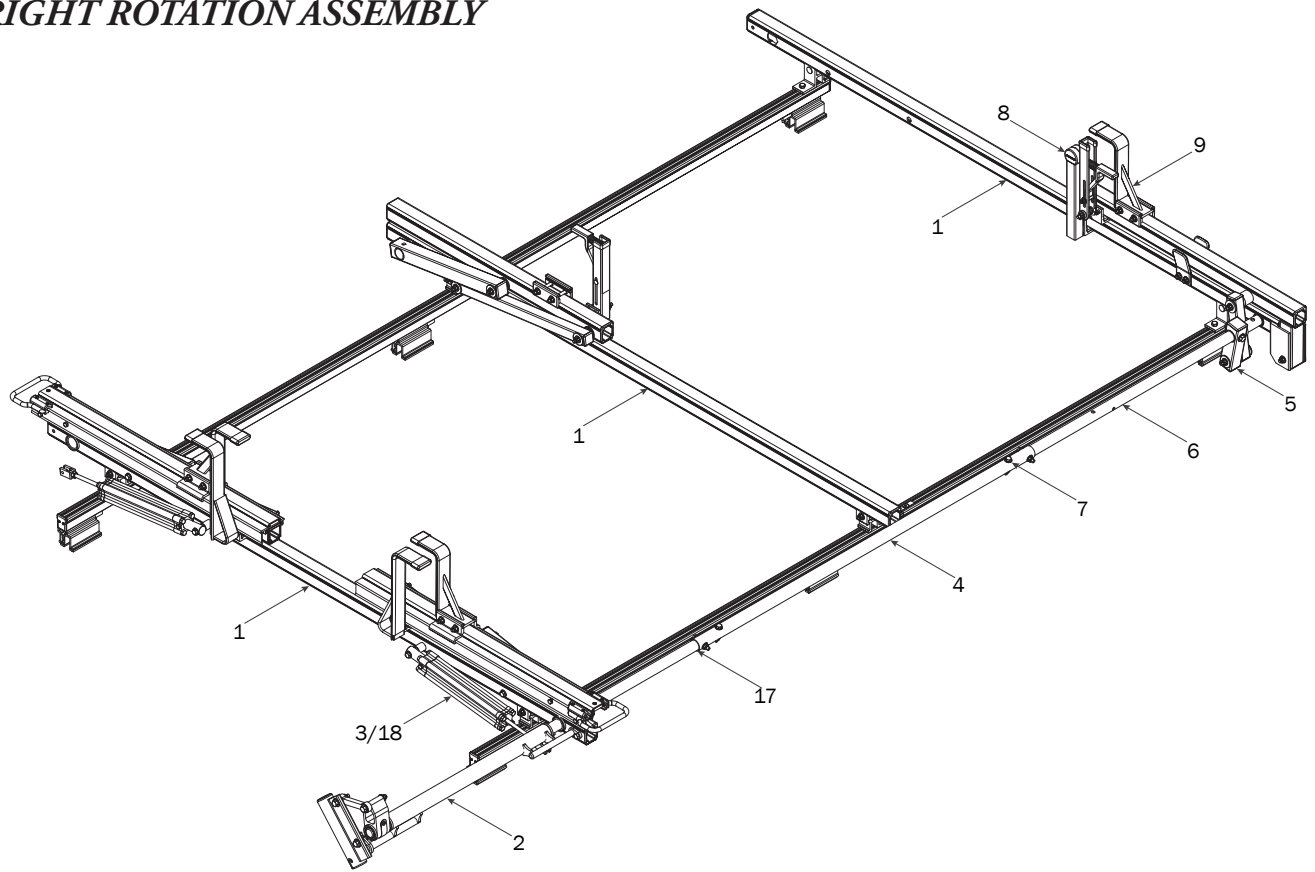
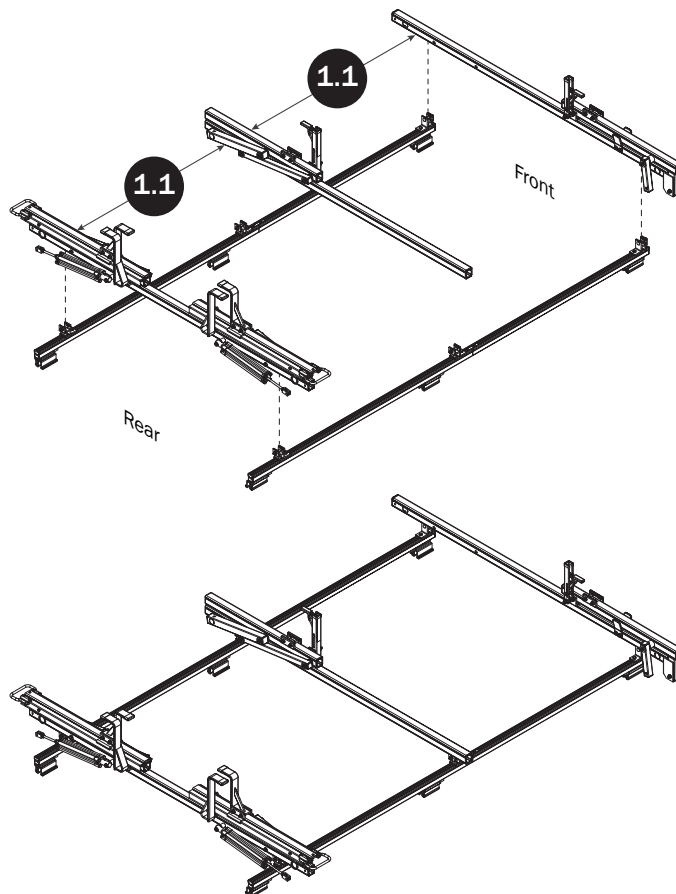
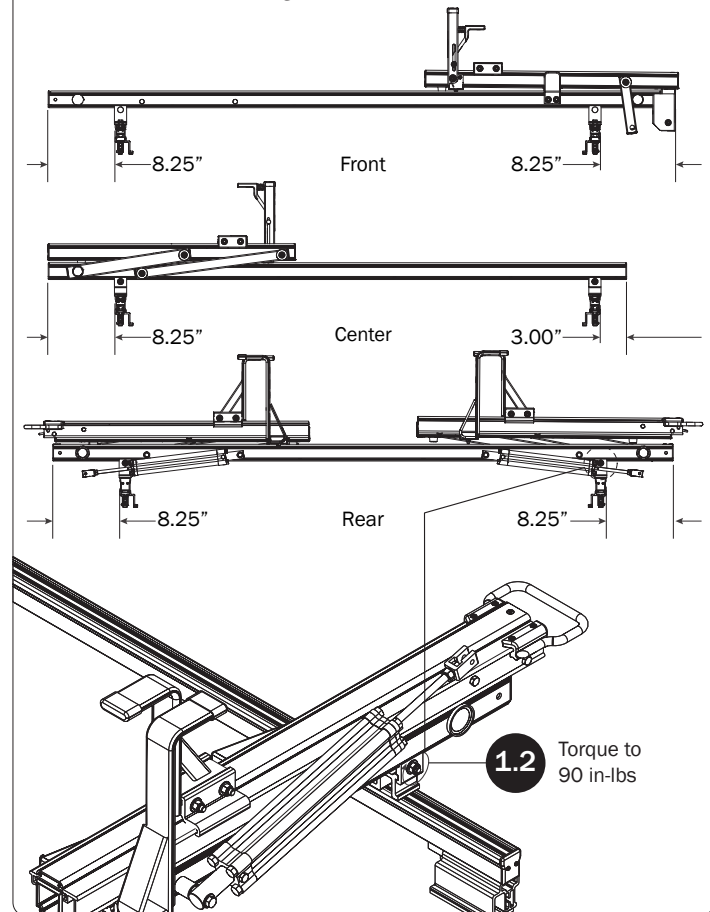
RIGHT ROTATION ASSEMBLY**CROSSBARS****CROSSBAR ADJUSTMENT**

REAR DRIVE SHAFT

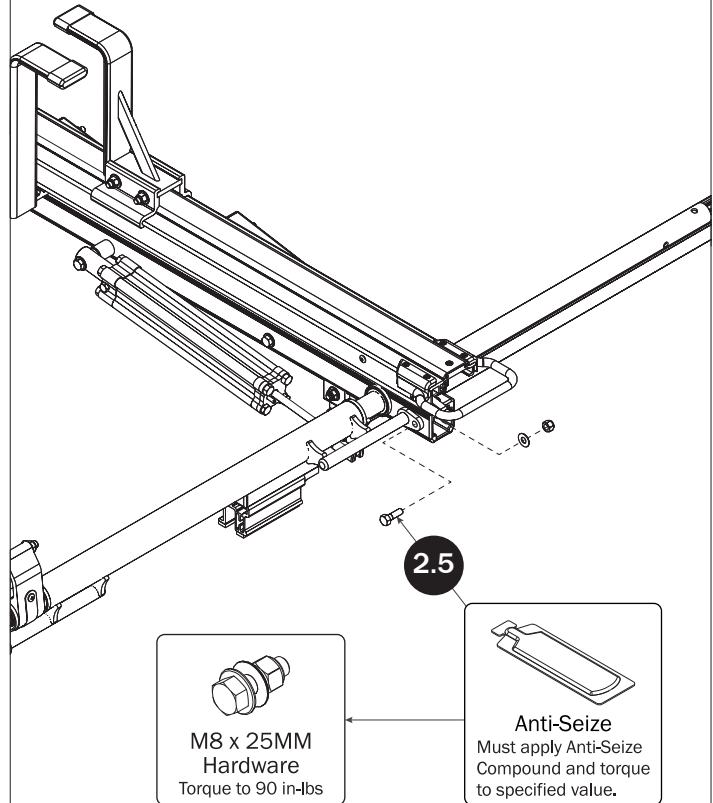
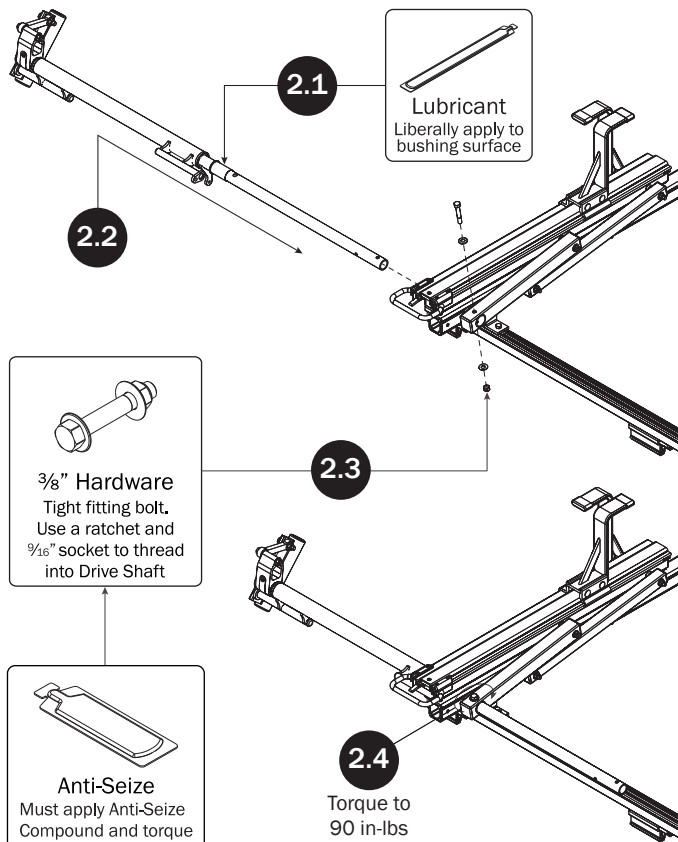

CYLINDER HARDWARE

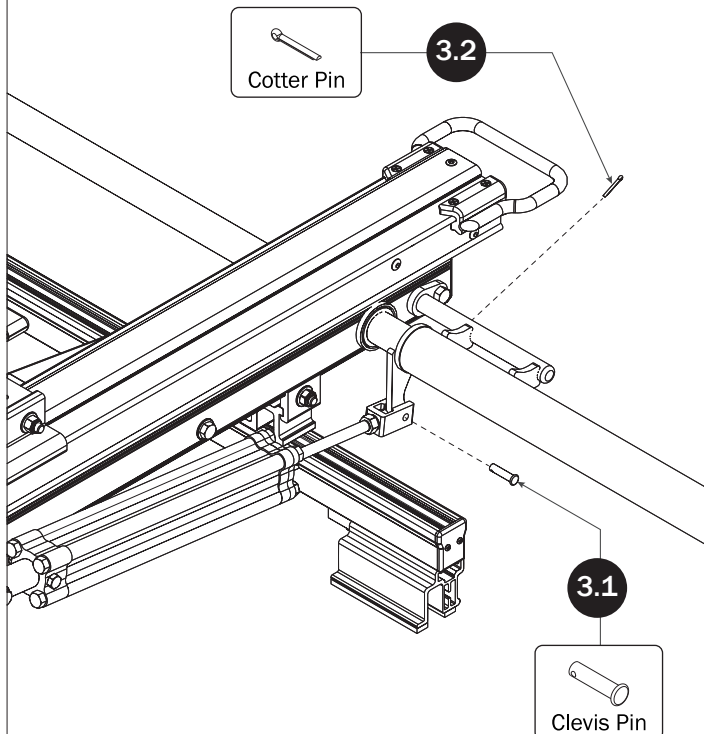

CONNECTING BAR

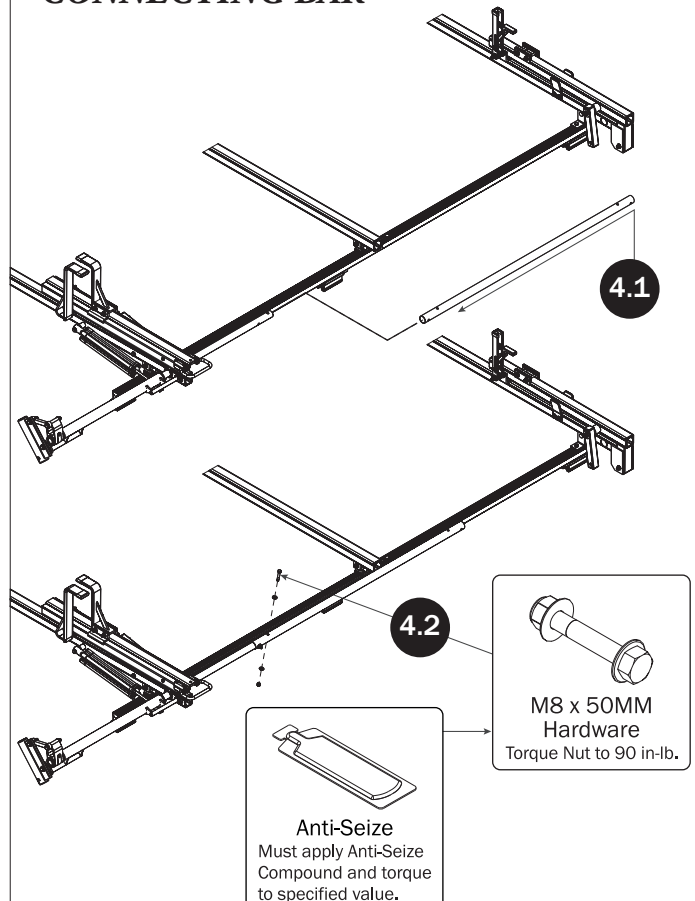

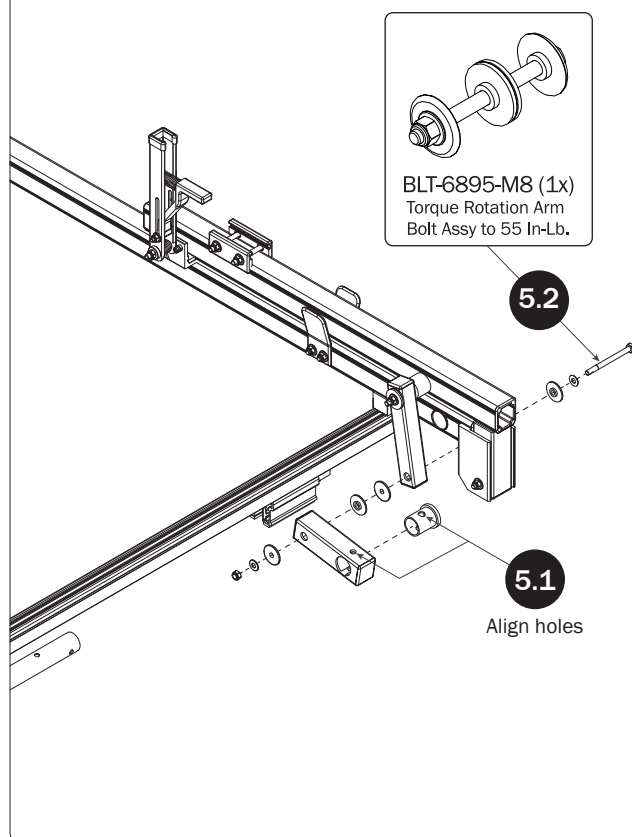
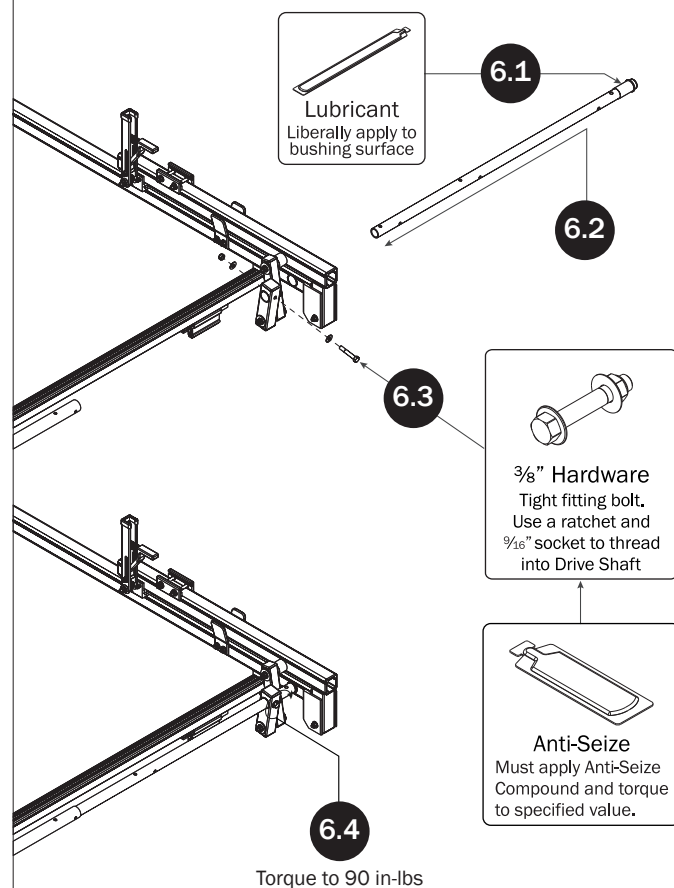
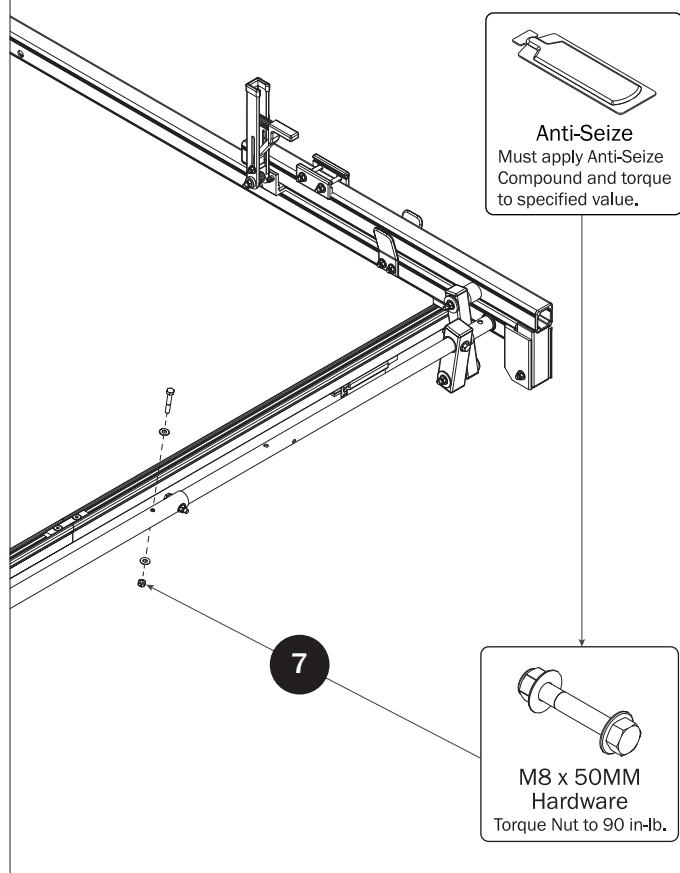
FRONT DRIVE ARM**FRONT DRIVE SHAFT****CONNECTING BAR FASTENERS****L POST**

SEE QUICK START GUIDE FOR ADJUSTMENTS

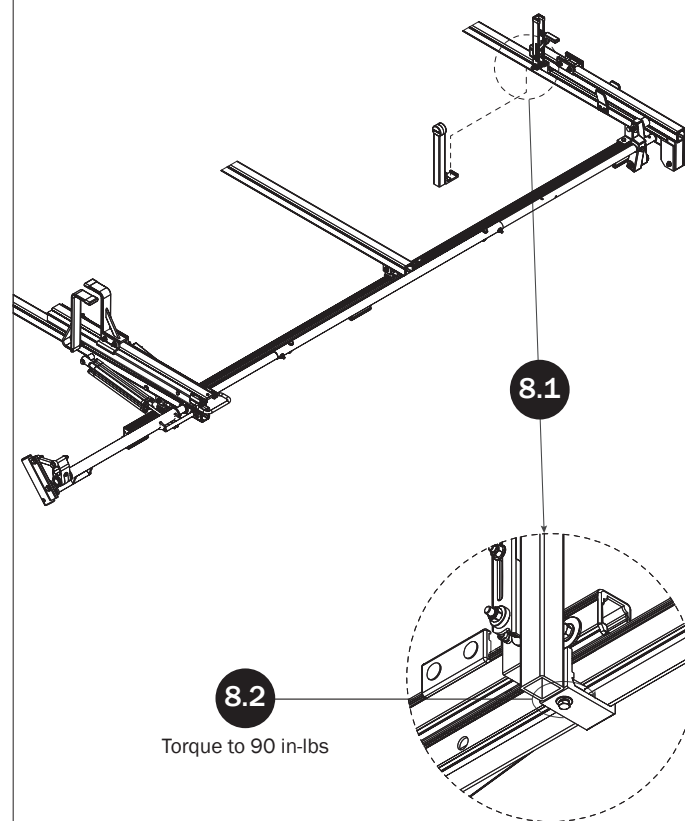

Z POST

SEE QUICK START GUIDE FOR ADJUSTMENTS

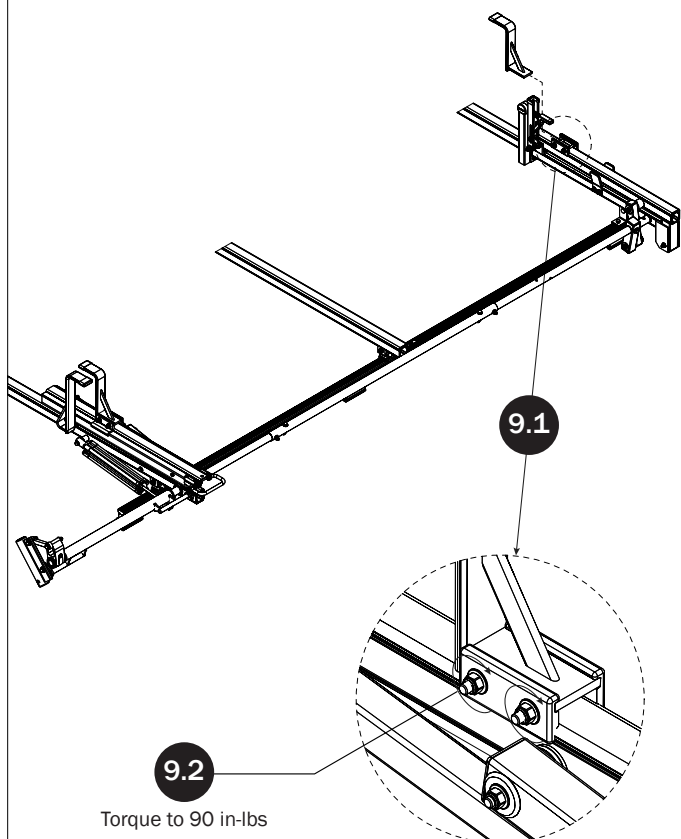

LEFT ROTATION ASSEMBLY

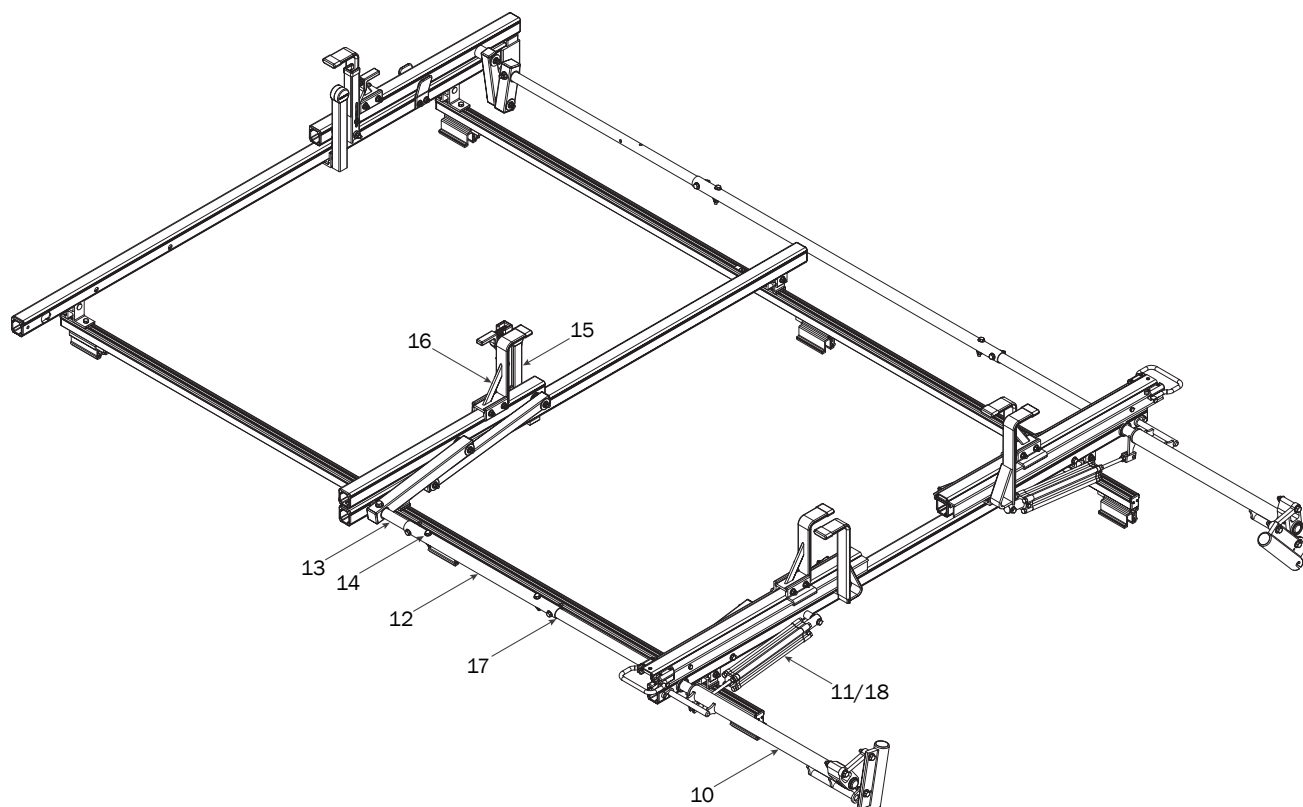

REAR DRIVE SHAFT

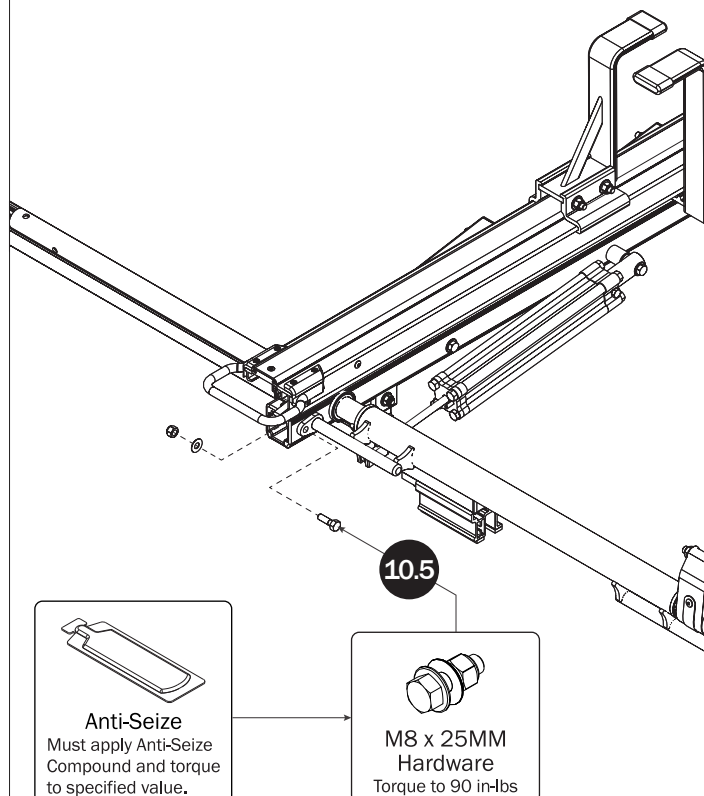
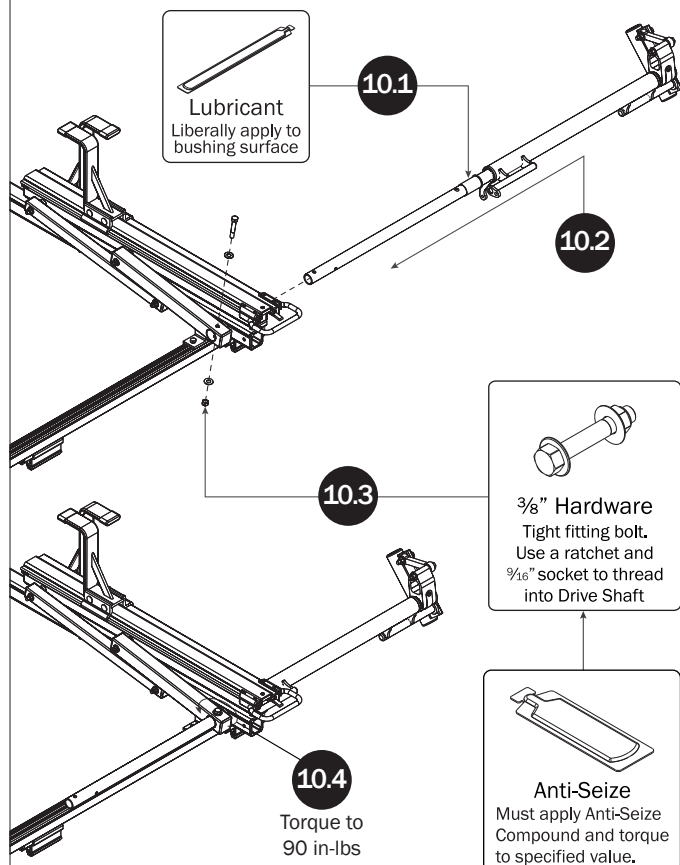

CYLINDER HARDWARE

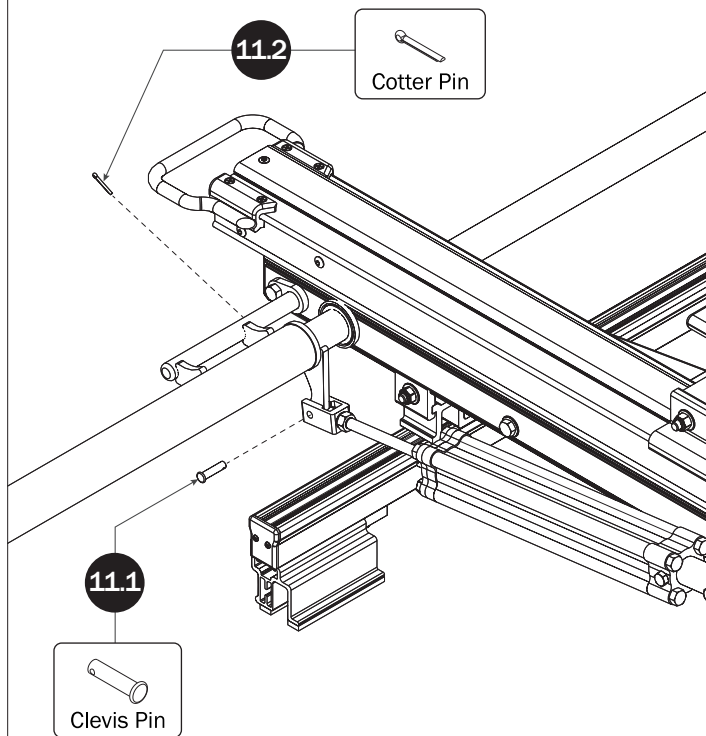

CONNECTING BAR

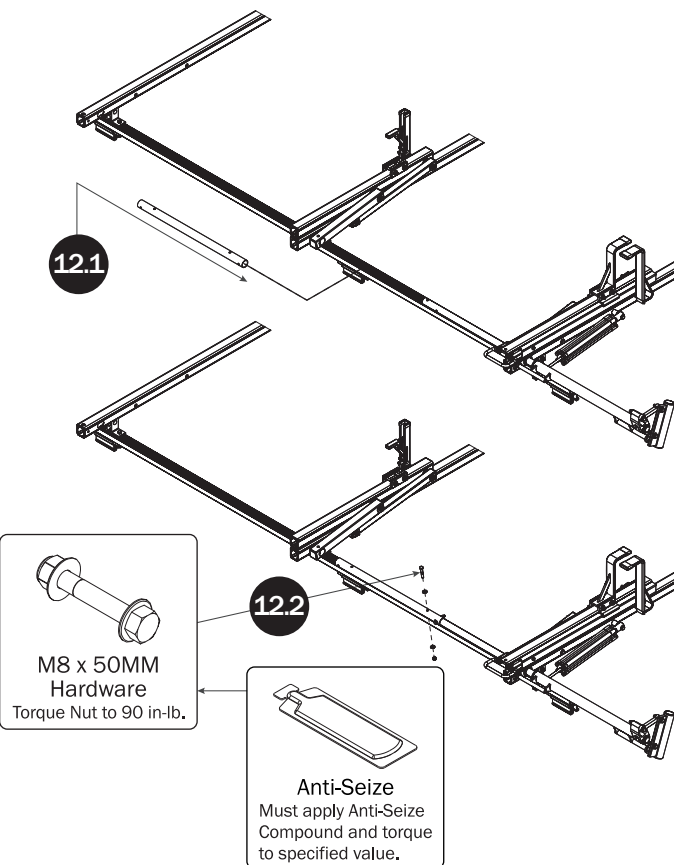

FRONT DRIVE SHAFT

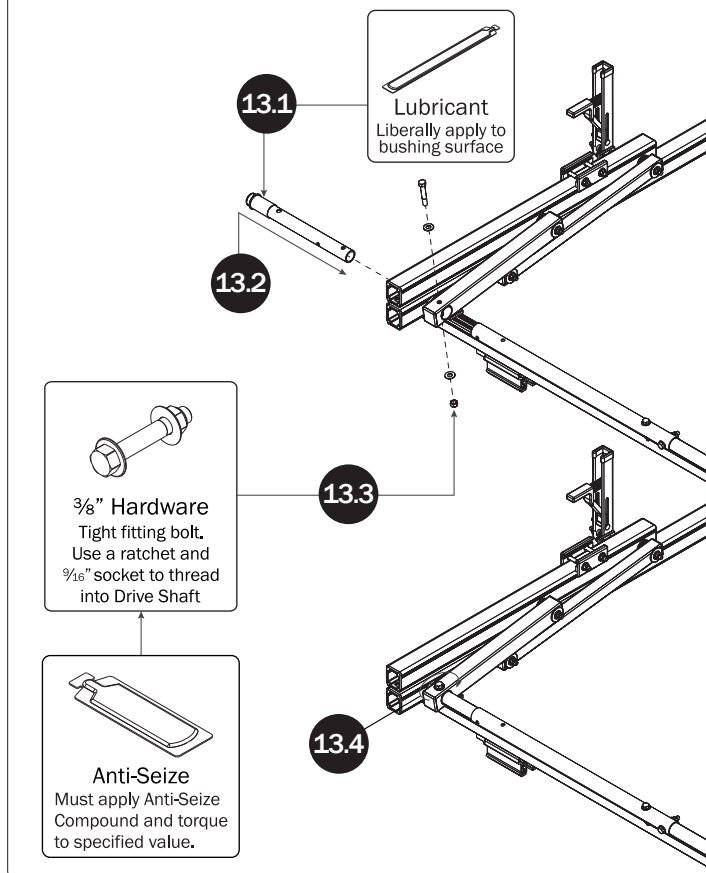

CONNECTING BAR FASTENERS

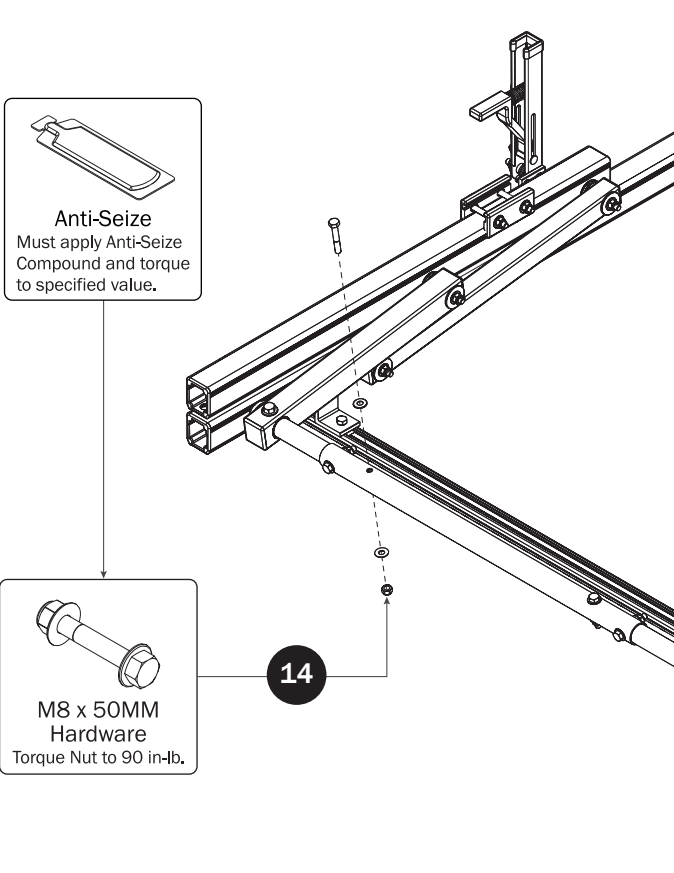

L POSTS

SEE QUICK START GUIDE FOR ADJUSTMENTS

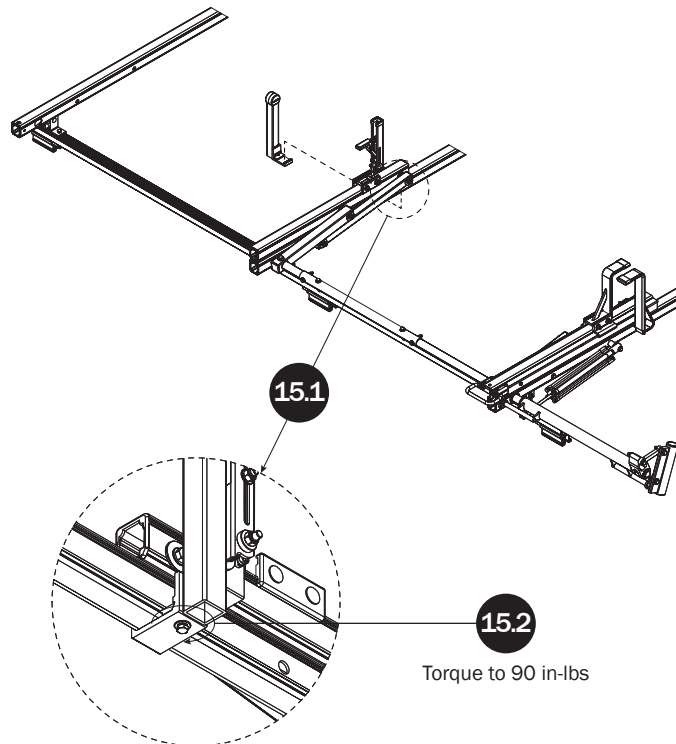
**Z POSTS**

SEE QUICK START GUIDE FOR ADJUSTMENTS

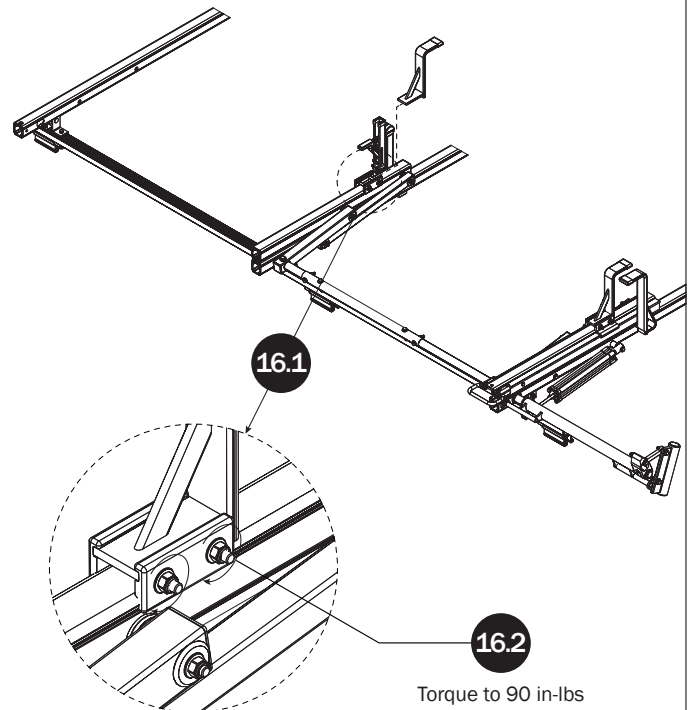
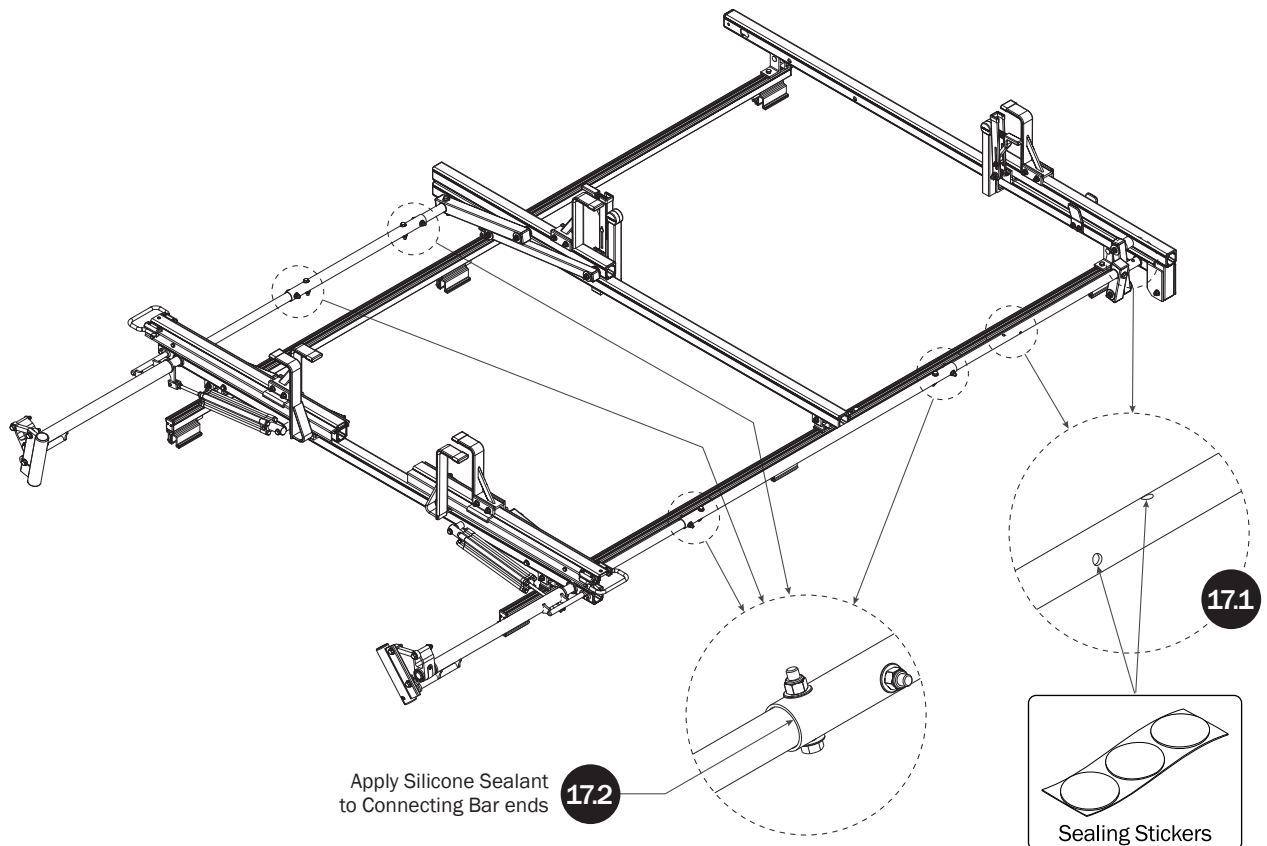
**DRIVE SHAFT SEALING**

CYLINDER ADJUSTMENT

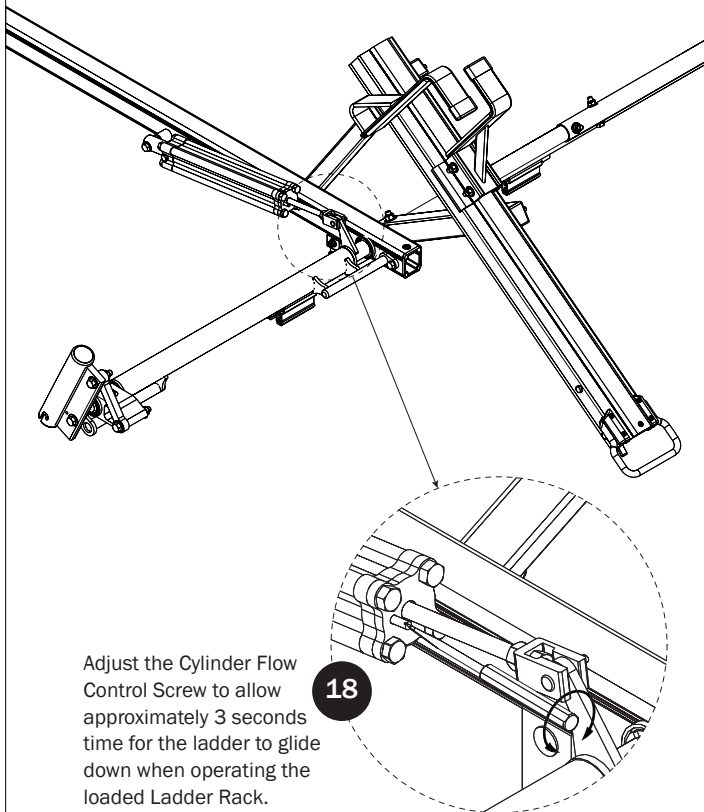

Page Intentionally Left Blank

Page Intentionally Left Blank

