

PRIME DESIGN™

A Safe Fleet Brand

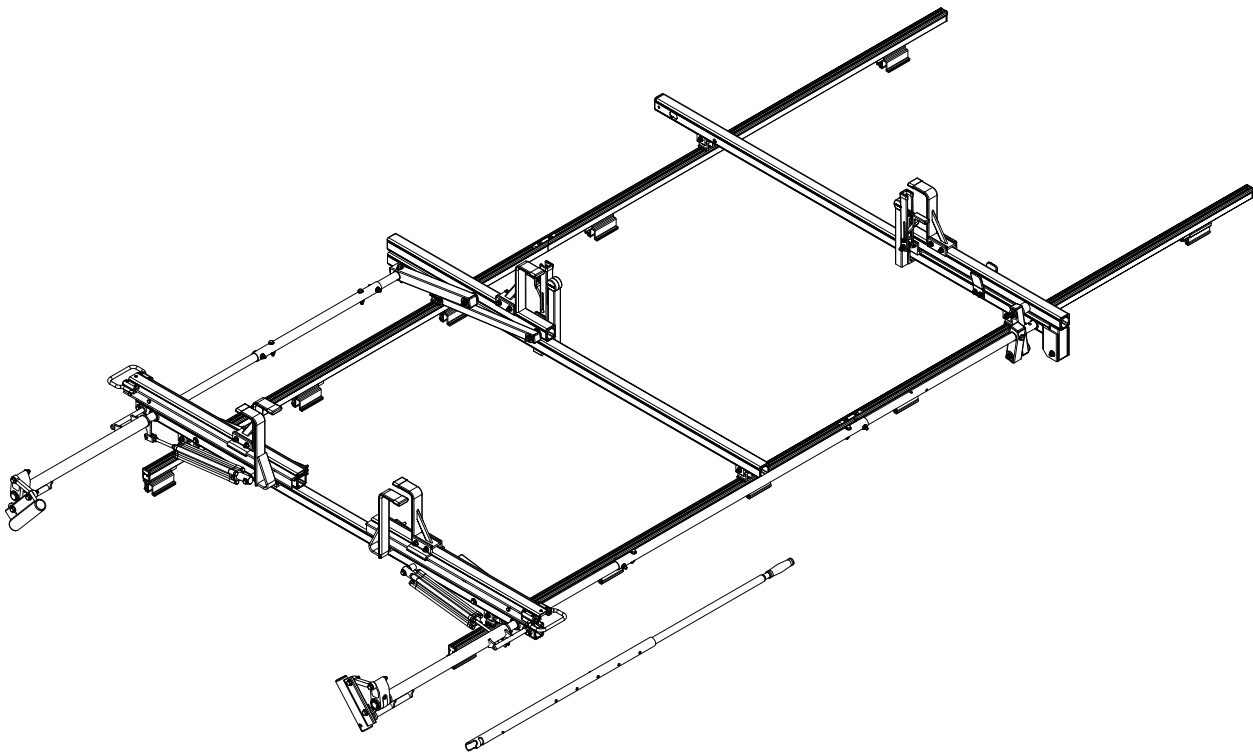

HR13-E

CONTENTS OVERVIEW

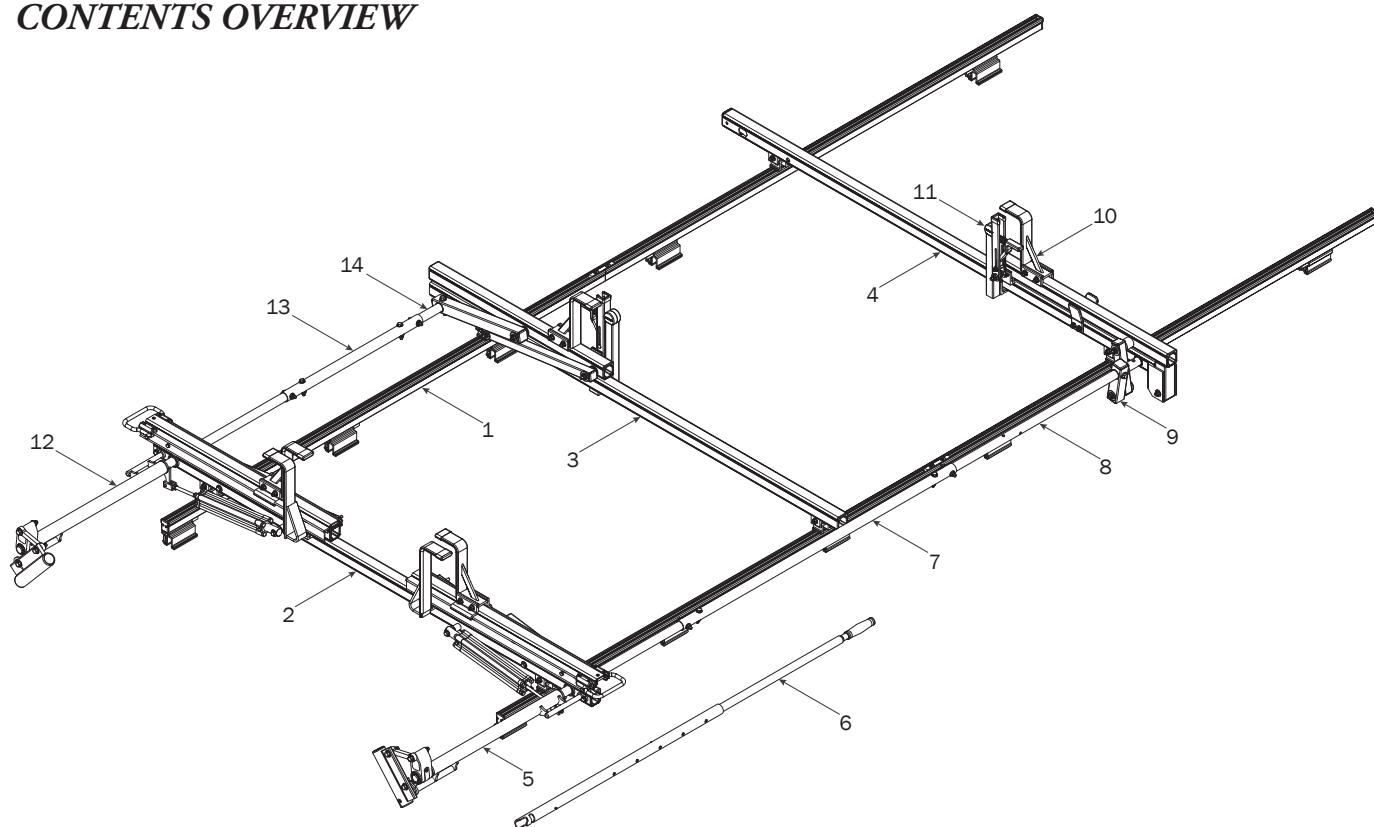

- 1—FBM3-0015 (Qty 1)
Channels with hardware



76" Channels (4X)

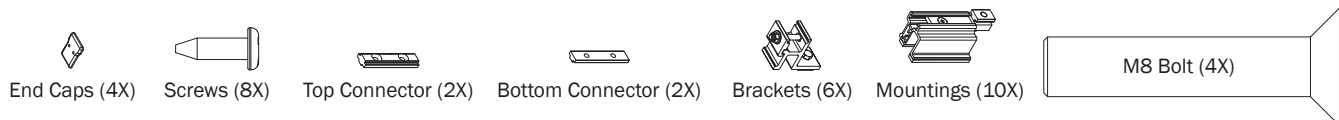

- 2—Rear Crossbar Assembly (Qty 1)

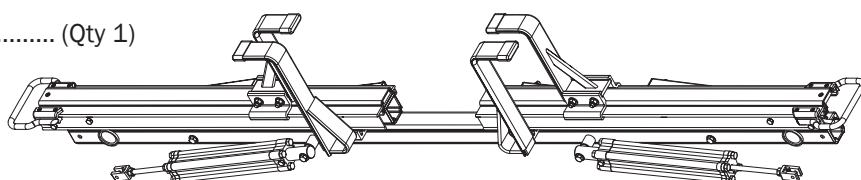

- 3—Center Crossbar Assembly (Qty 1)

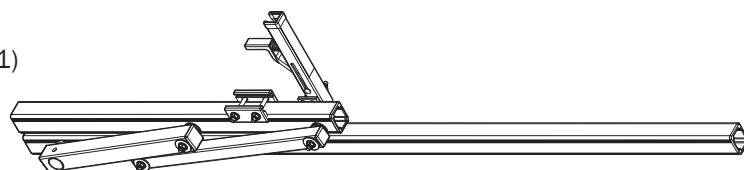

- 4—Front Crossbar Assembly (Qty 1)

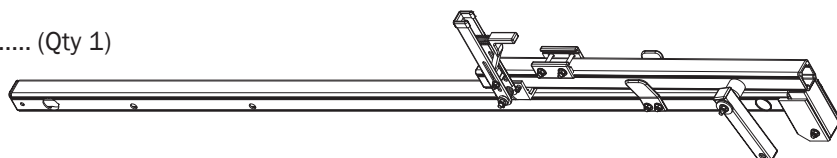

- 5—Rear Drive Shaft (Qty 1)
Right Hand, A Version, 50.00"

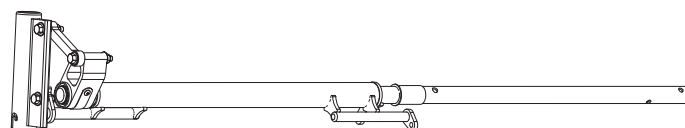

6—HHR Handle Assembly (Qty 1)
35.00"

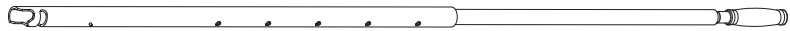

7—Connecting Bar (Qty 1)
4.00'



8—Front Drive Shaft (Qty 1)
B Version, 35.75"



9—Drive Arm (Qty 1)
Incline Version with Bushing and Hardware

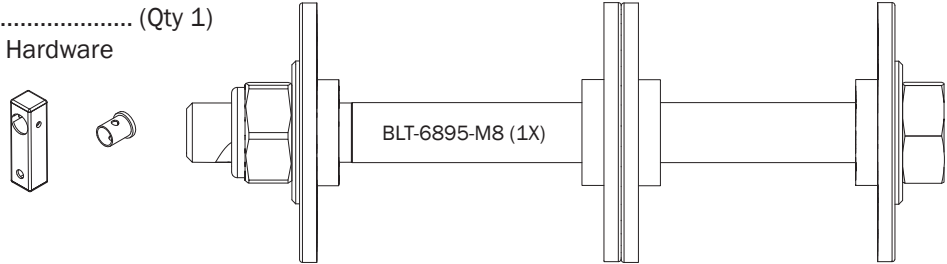

10—Z Post (Qty 2)
Adjustable, 7.25"

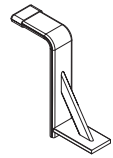

11—L Post (Qty 2)
Gen2, Roller Cap, 9.25"

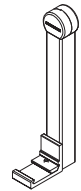

12—Rear Drive Shaft (Qty 1)
Left Hand, A Version, 50.00"

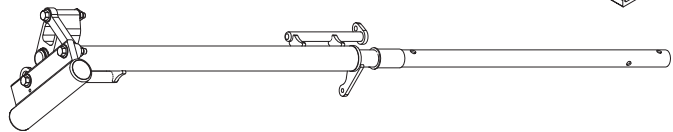

13—Connecting Bar (Qty 1)
24.00"

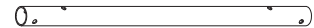

14—Front Drive Shaft (Qty 1)
B Version, 11.75"



15—HKT-8163 (Not called out in Overview)..... (Qty 1)

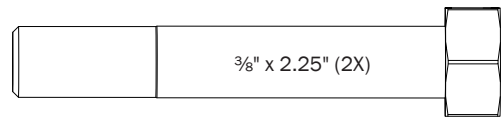
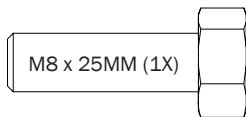

Cotter Pin (1X)



Clevis Pin (1X)

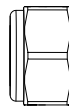

M8 Lock Nut (5X)

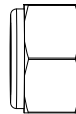

3/8" Lock Nut (2X)

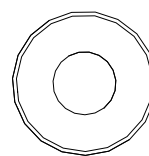

5/16" Flat Washer (10X)

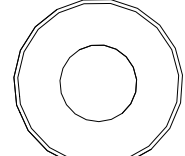

3/8" Flat Washer (4X)

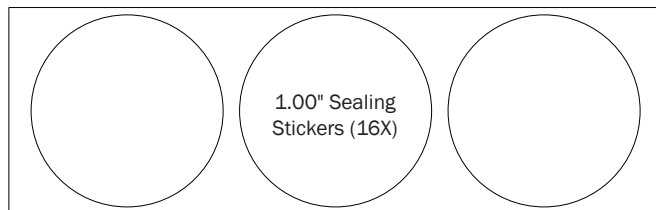

1.00" Sealing
Stickers (16X)



Anti-Seize (1X)

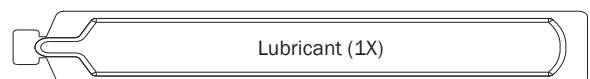

Lubricant (1X)

FBM3-0015 MOUNTING BRACKETS

INSTALLER NOTE: Mounting Brackets must be disassembled for installation onto the vehicle's roof.

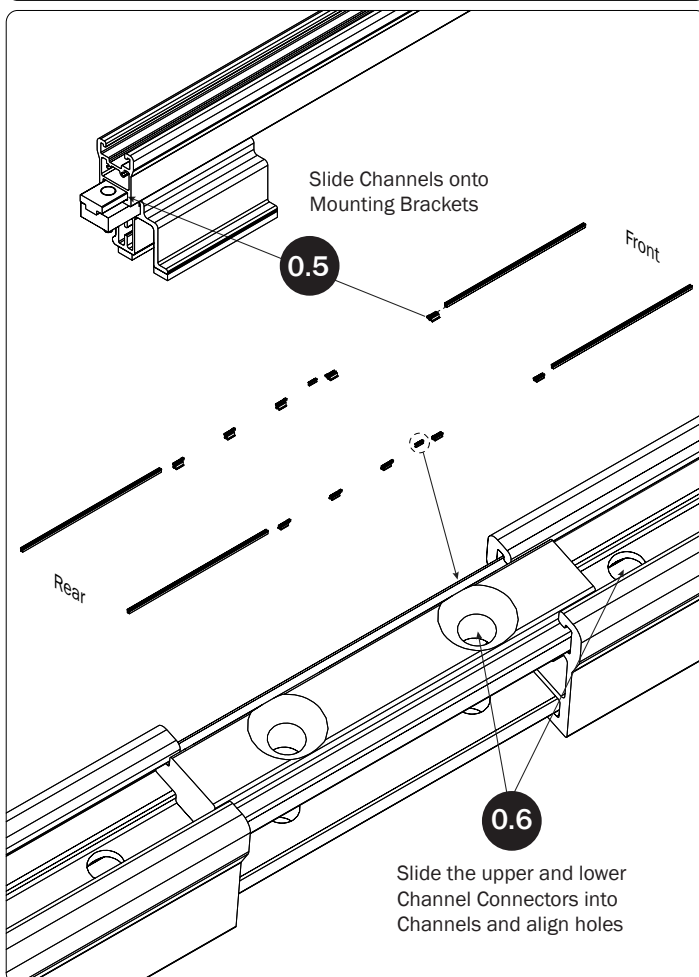
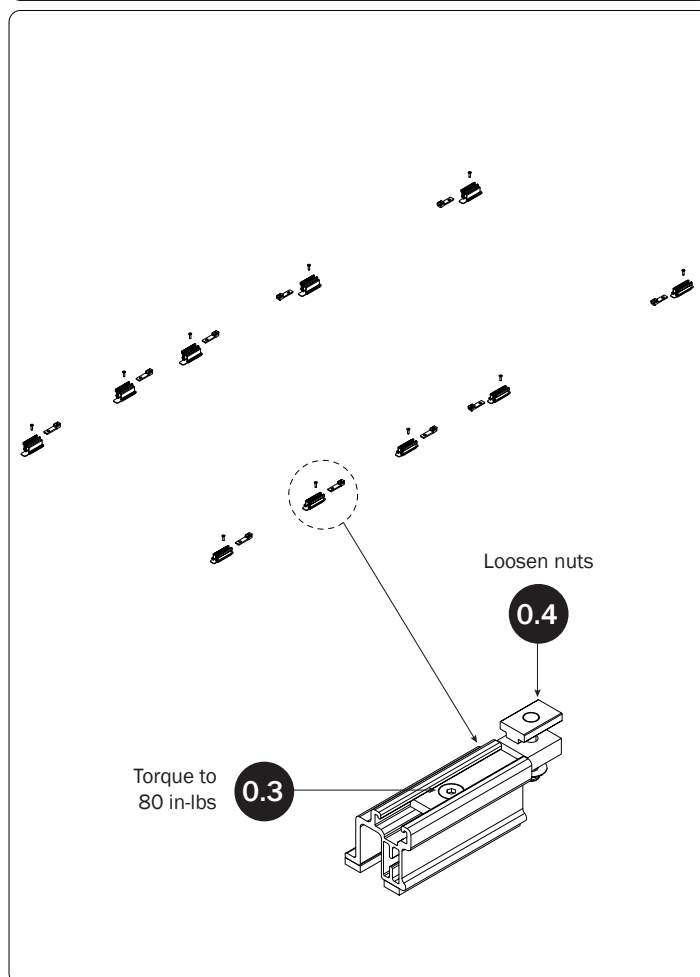
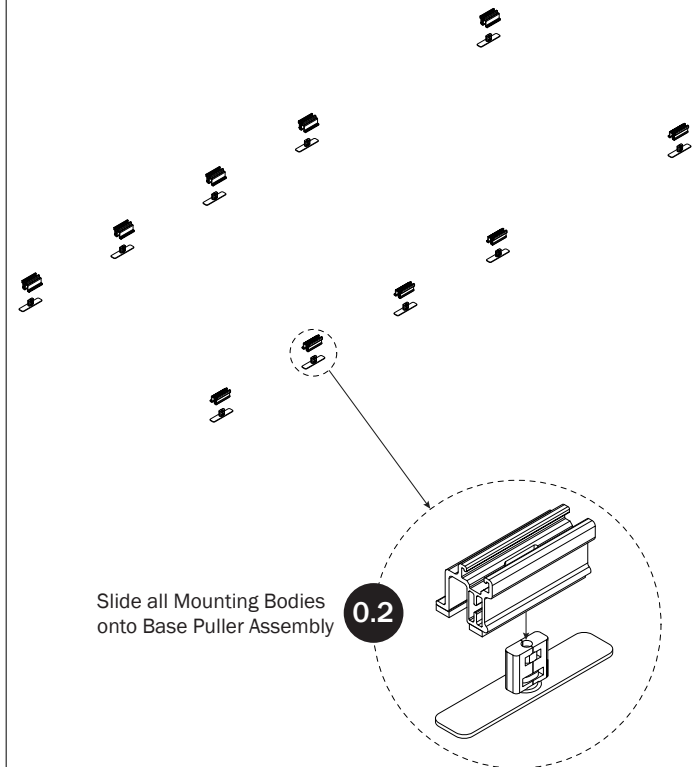
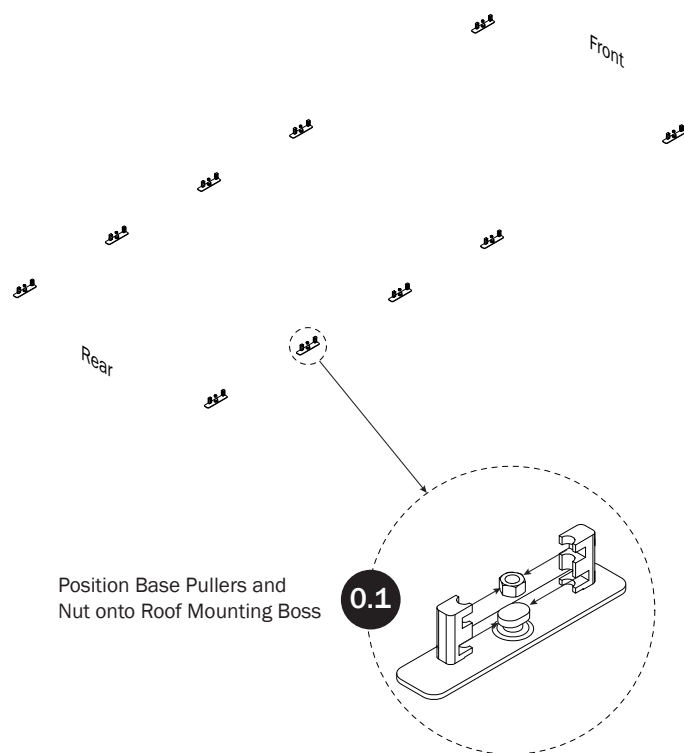

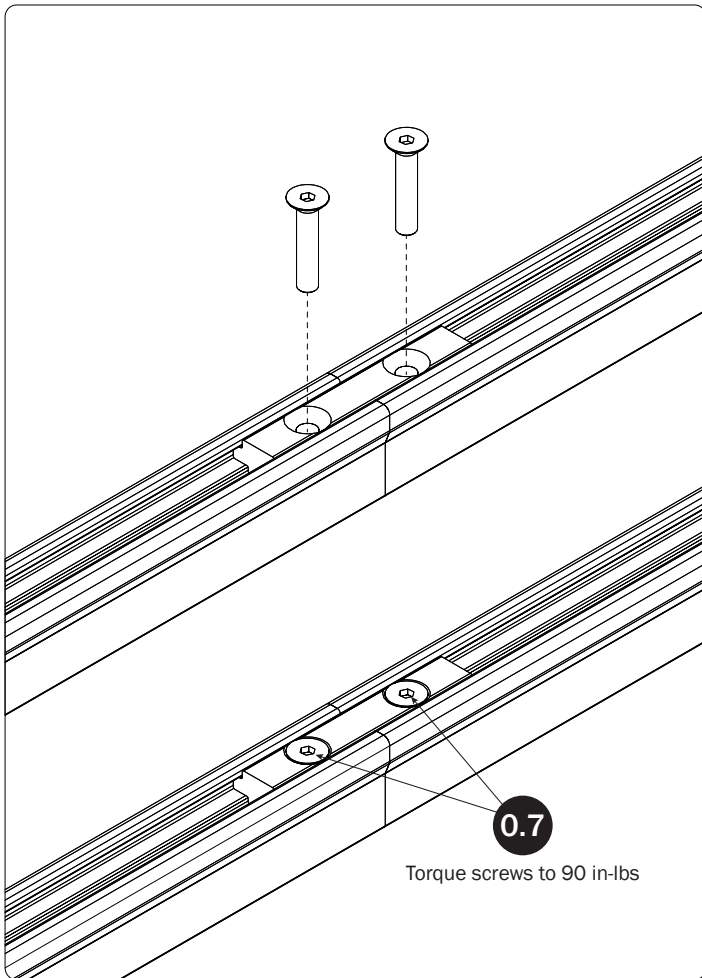

0.8 Set to distances then torque Mounting Bracket nuts to 80 in-lbs

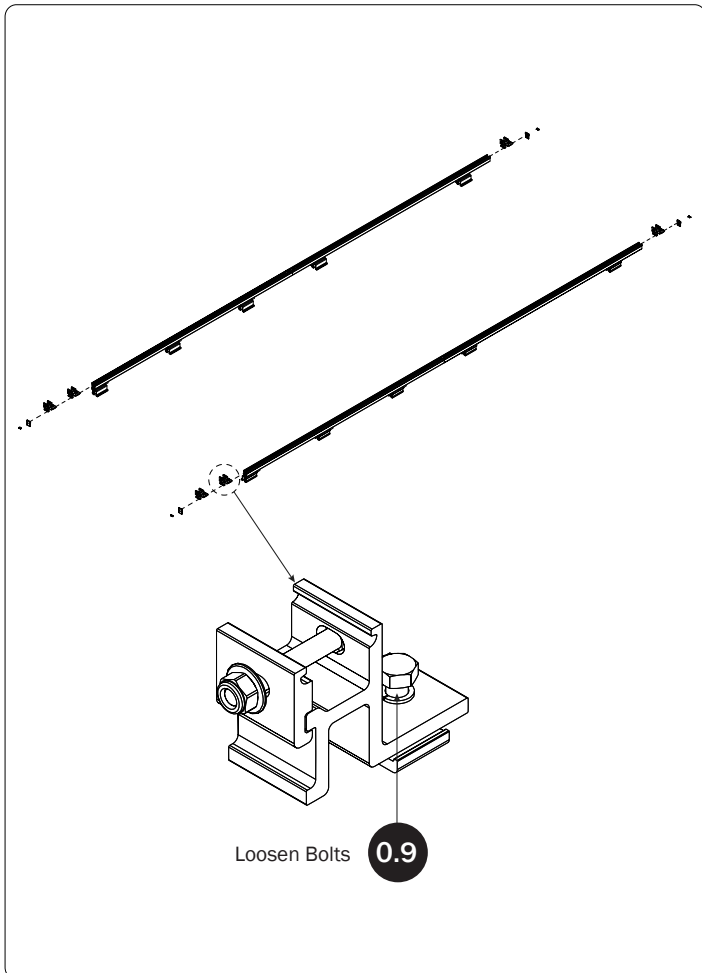
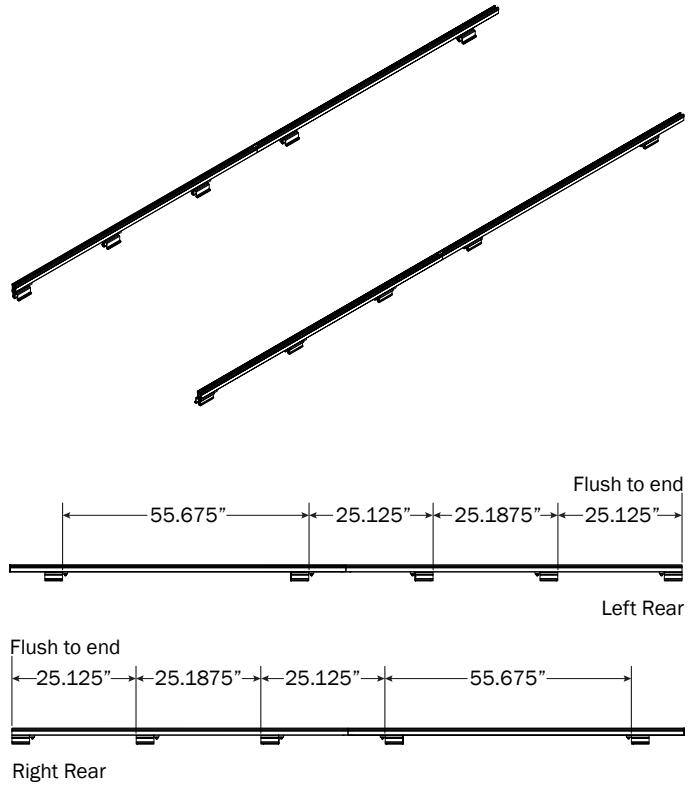

0.10 Set to distances then torque Mounting Bracket nuts to 90 in-lbs

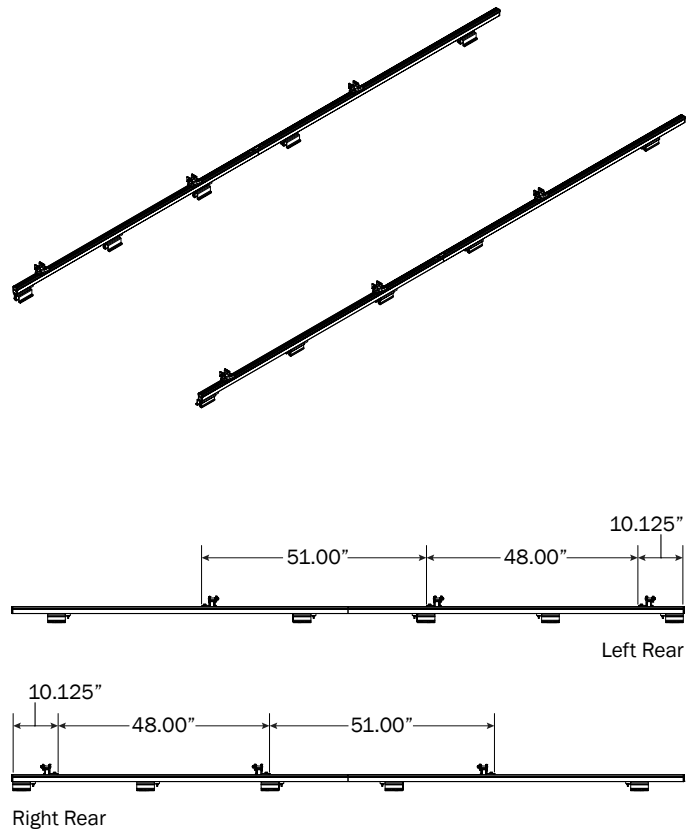

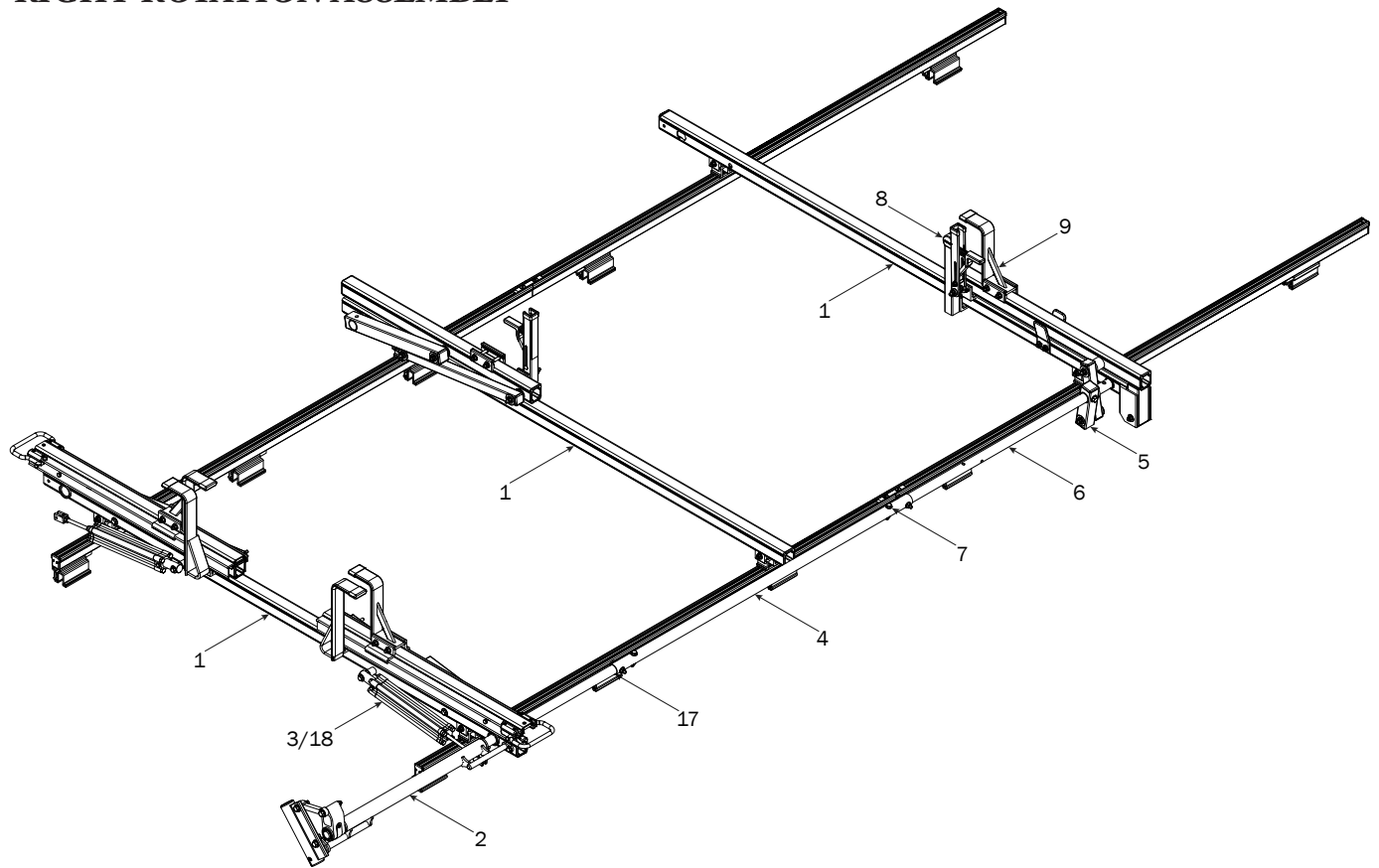
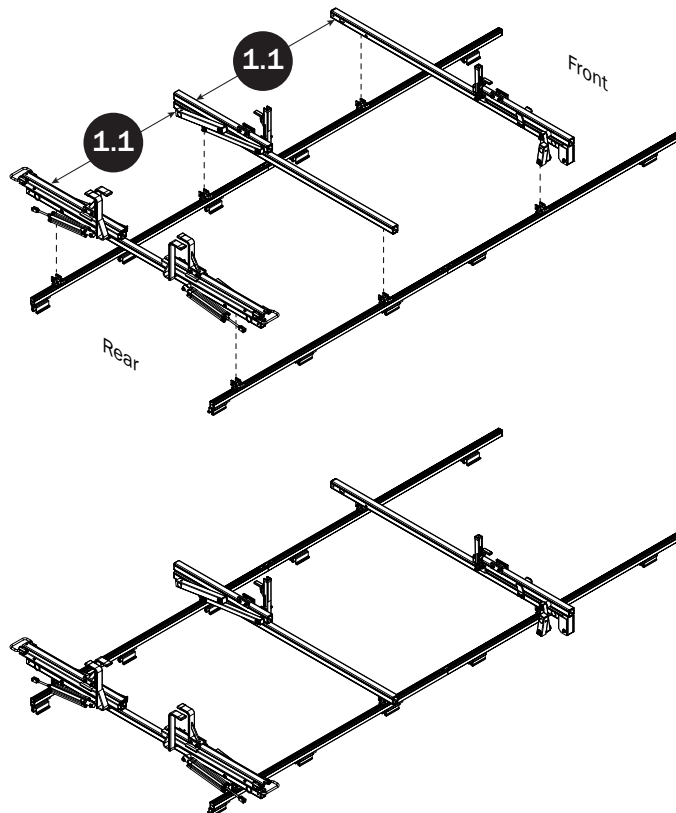
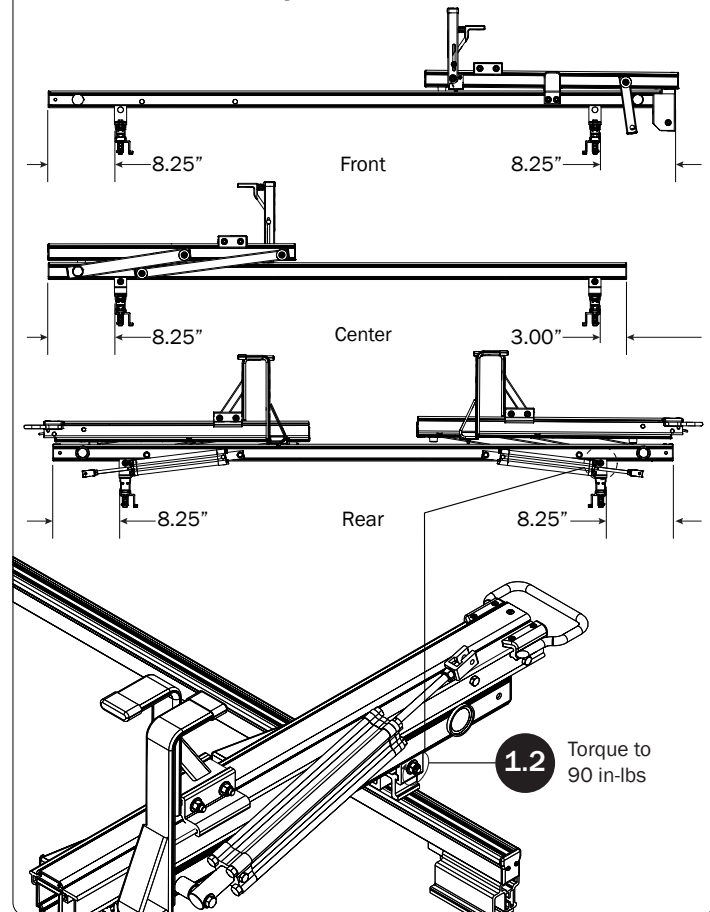
RIGHT ROTATION ASSEMBLY**CROSSBARS****CROSSBAR ADJUSTMENT**

REAR DRIVE SHAFT

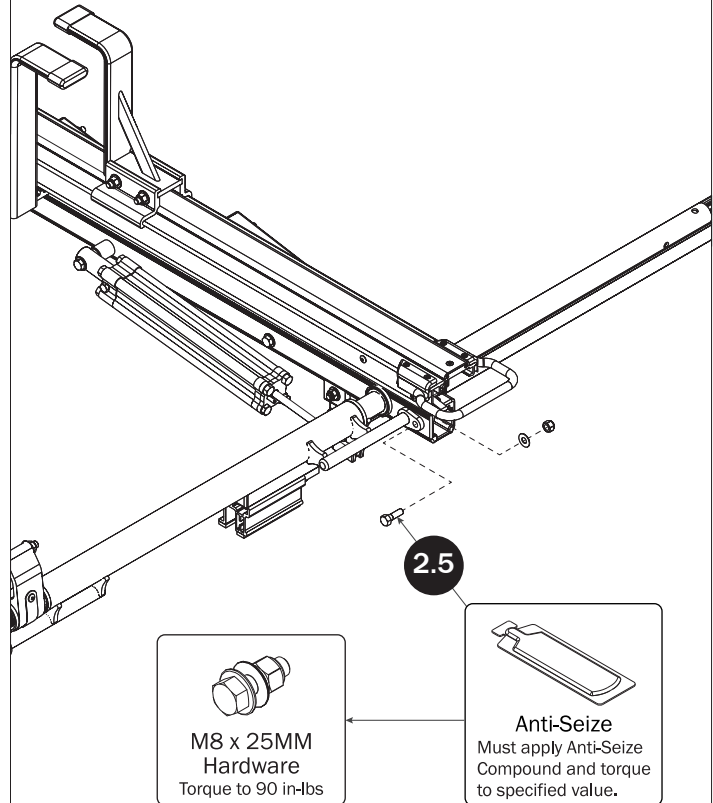
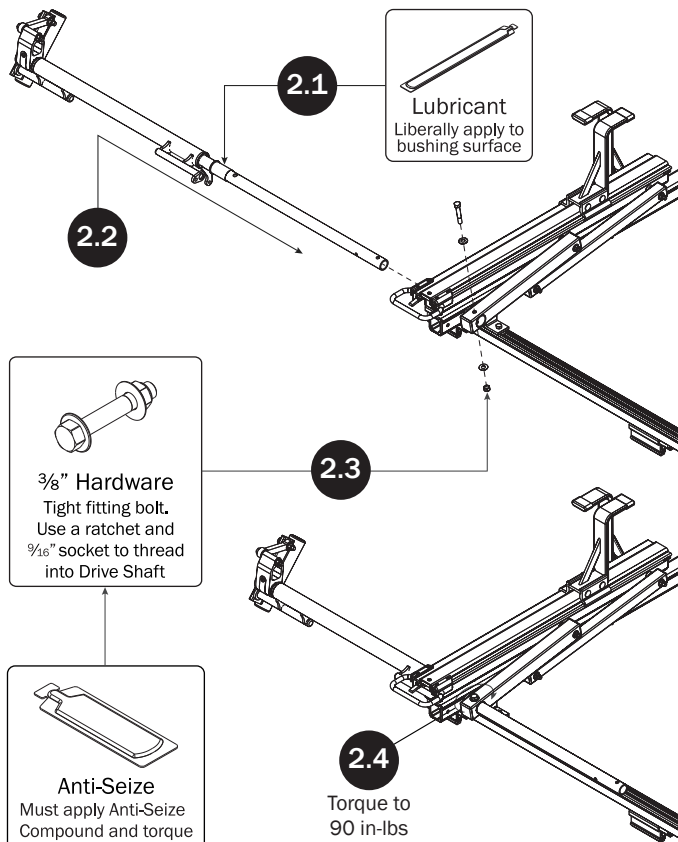

CYLINDER HARDWARE

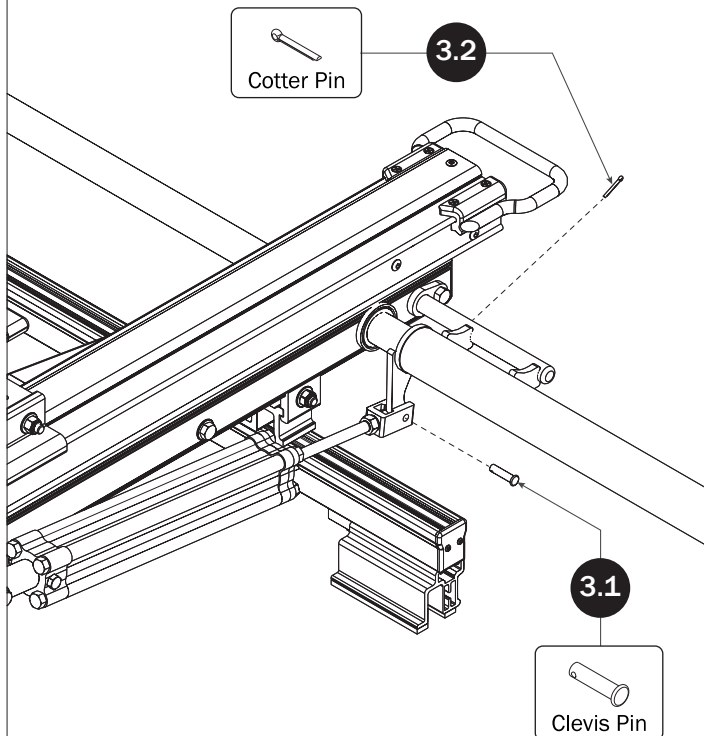

CONNECTING BAR

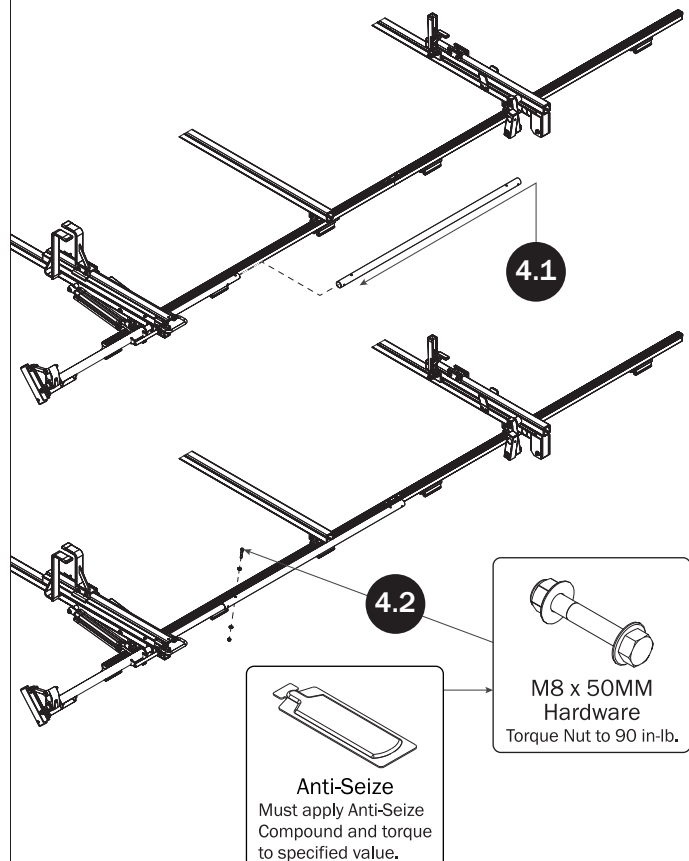

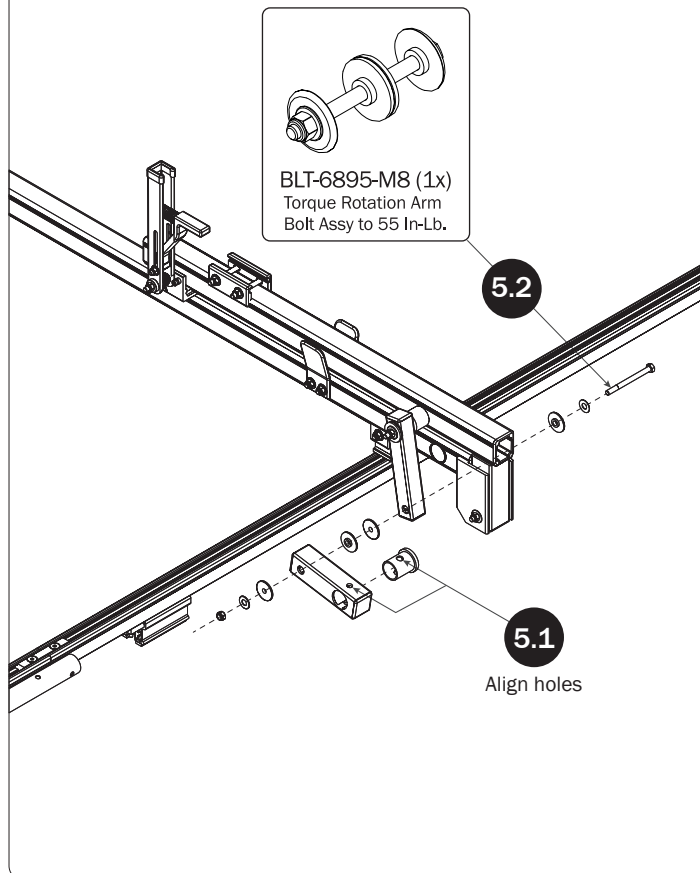
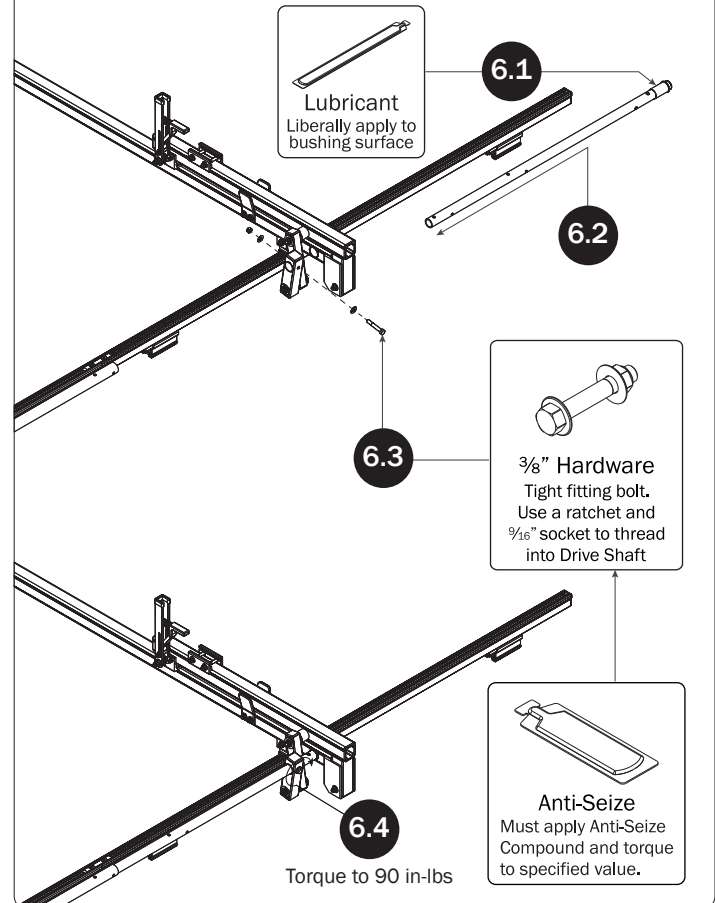
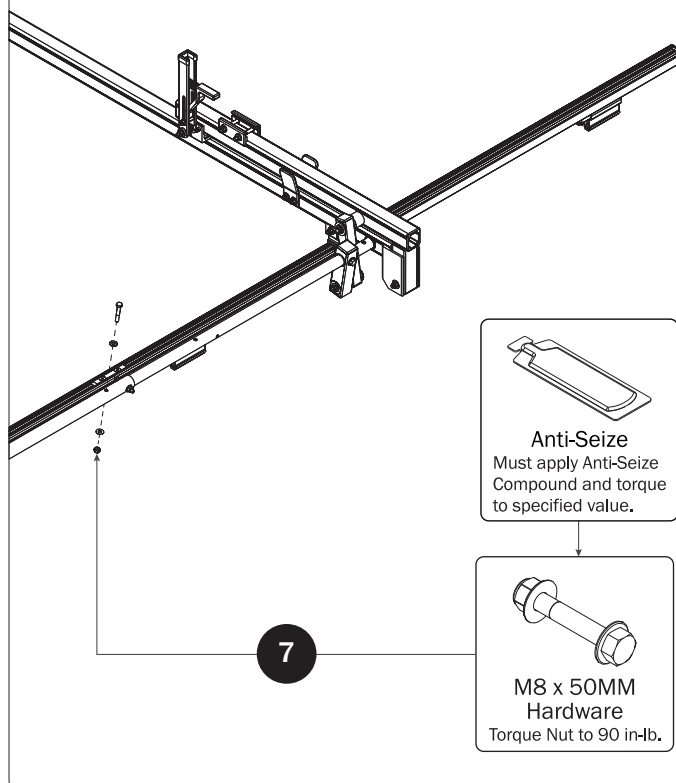
FRONT DRIVE ARM**FRONT DRIVE SHAFT****CONNECTING BAR FASTENERS****L POST**

SEE QUICK START GUIDE FOR ADJUSTMENTS

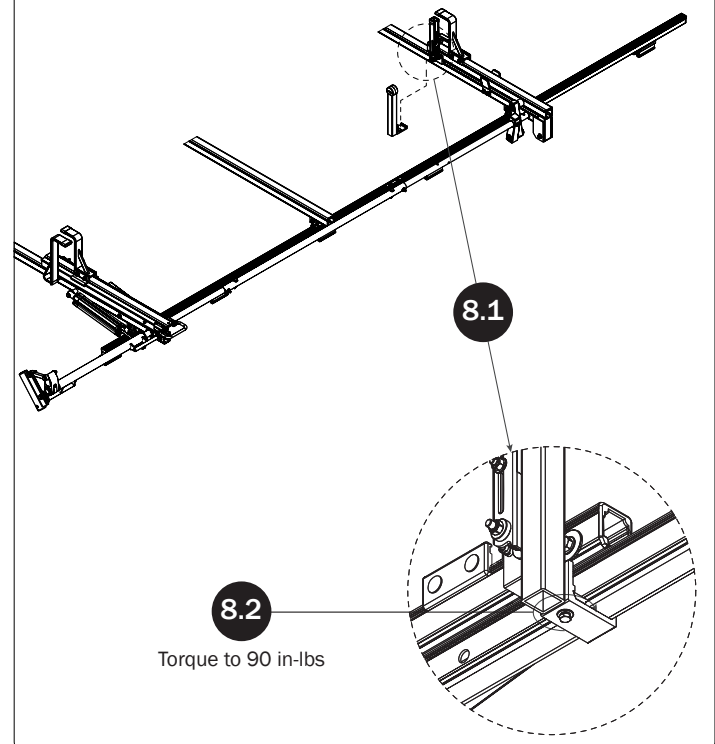

Z POST

SEE QUICK START GUIDE FOR ADJUSTMENTS

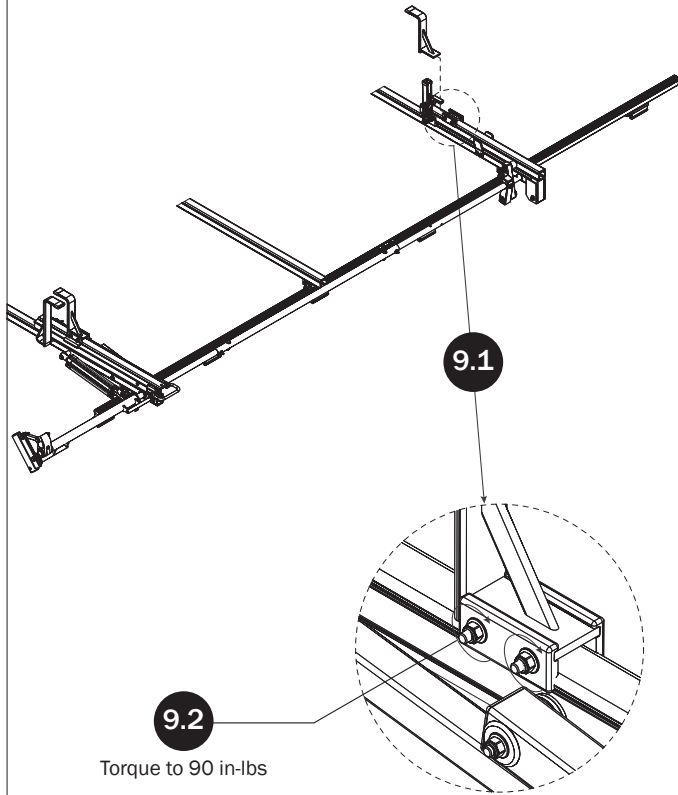

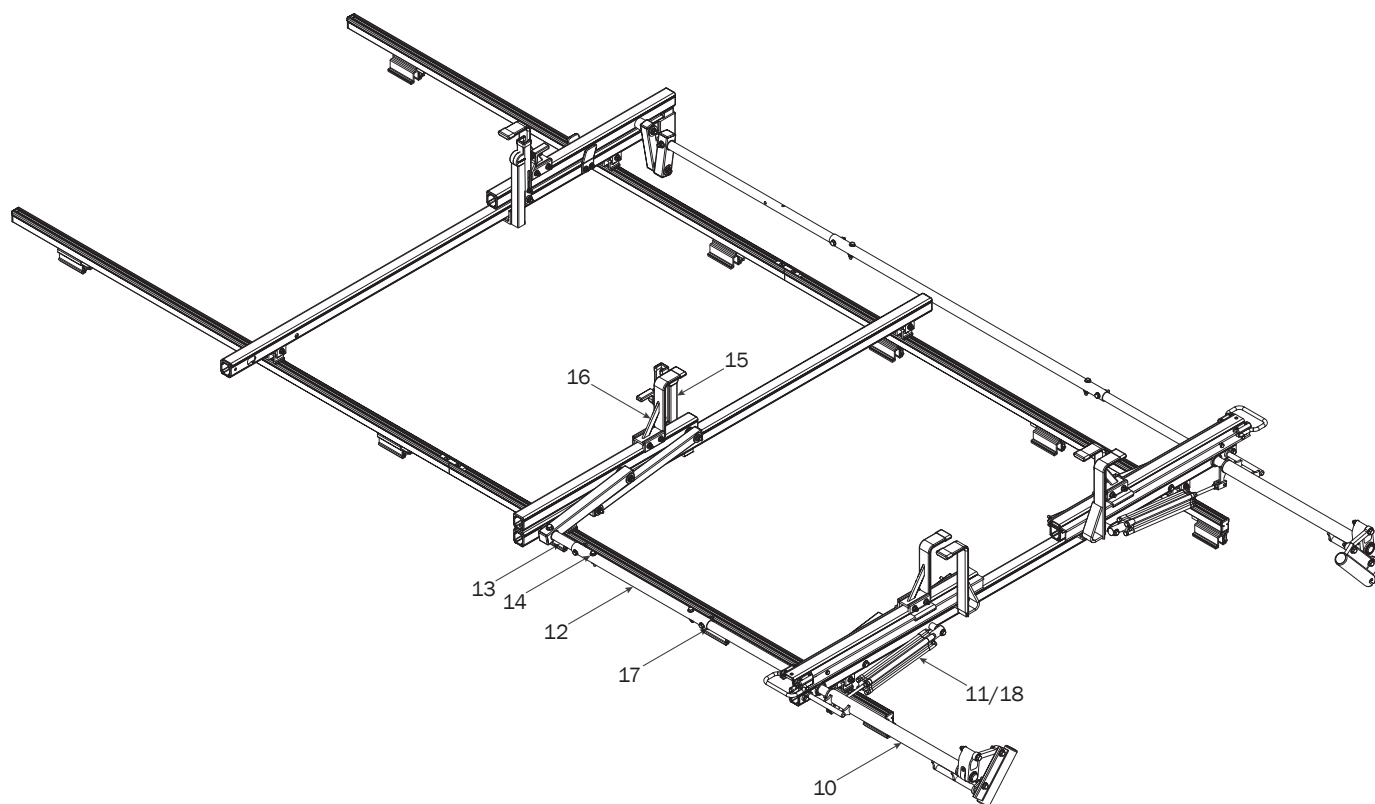
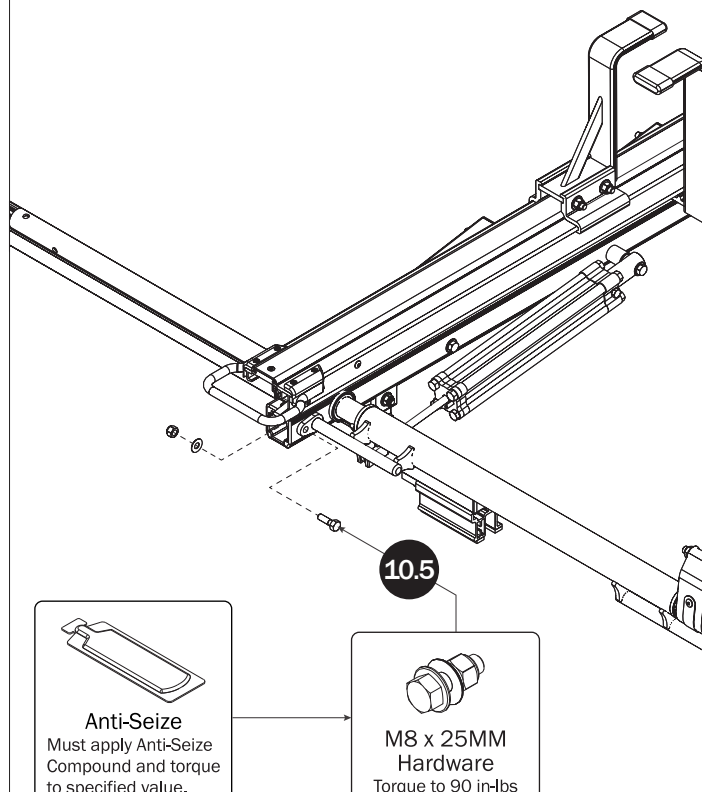
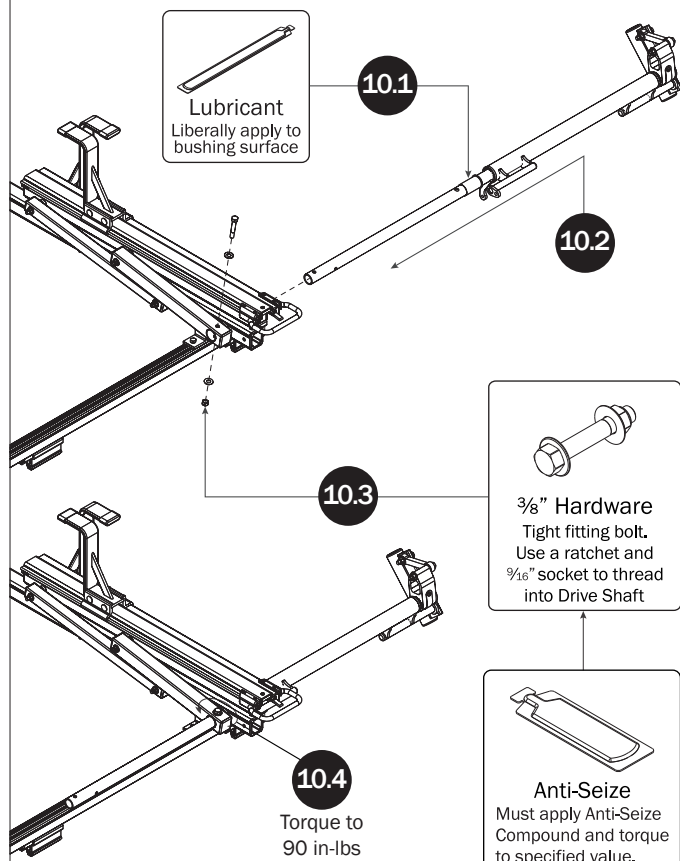
LEFT ROTATION ASSEMBLY**REAR DRIVE SHAFT**

CYLINDER HARDWARE

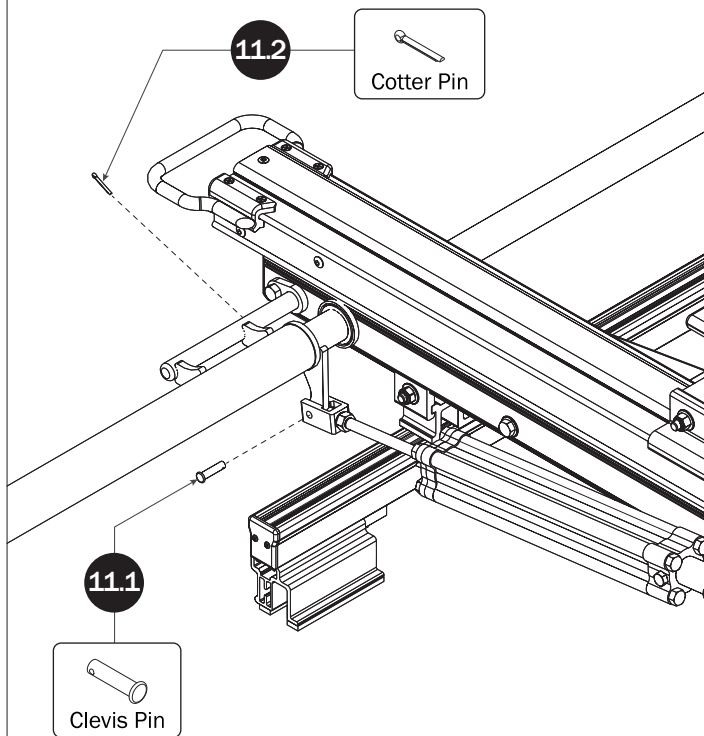

CONNECTING BAR

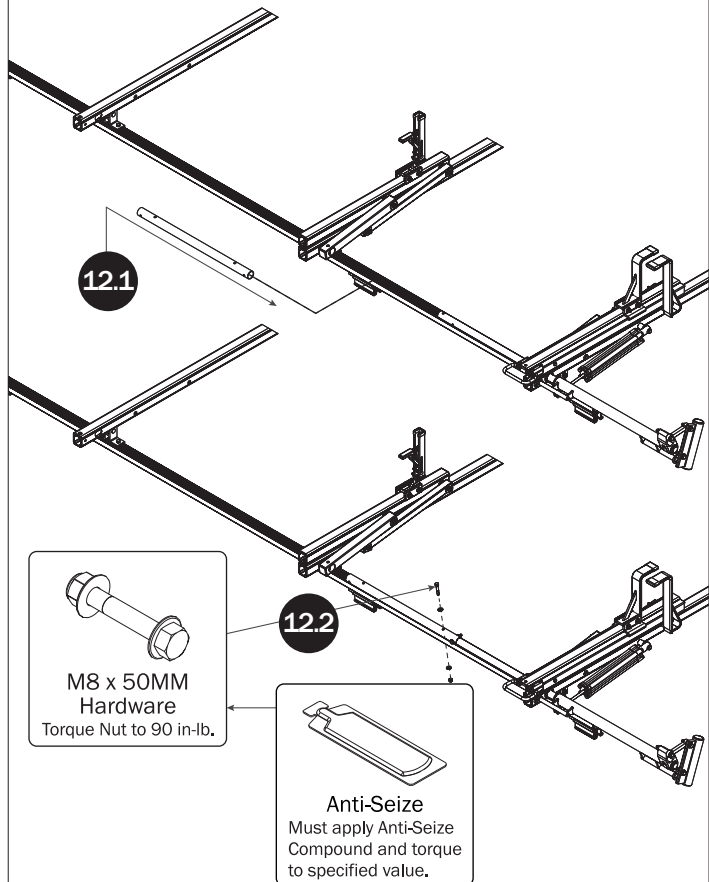

FRONT DRIVE SHAFT

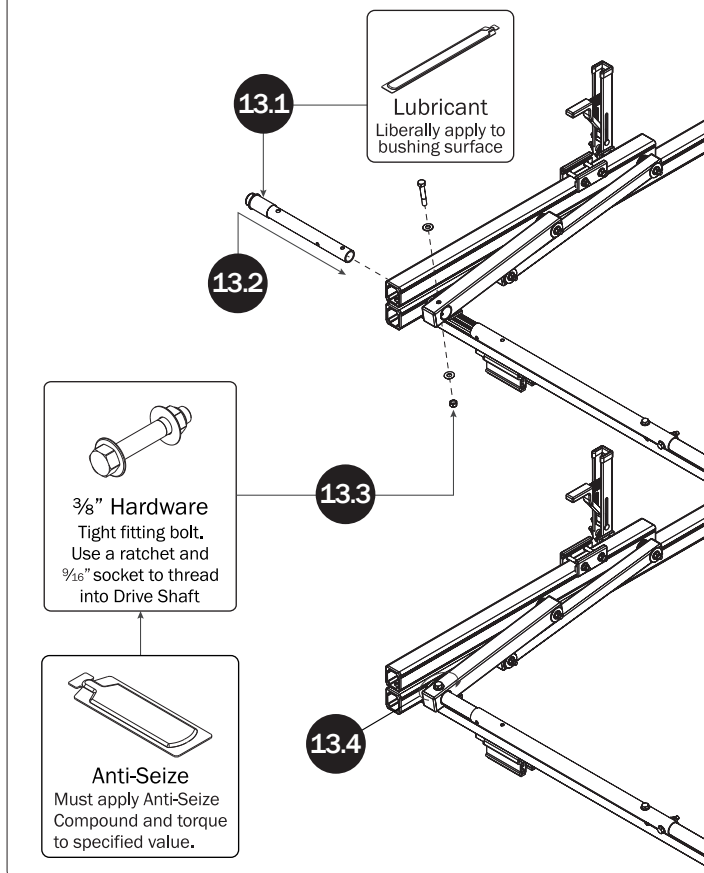

CONNECTING BAR FASTENERS

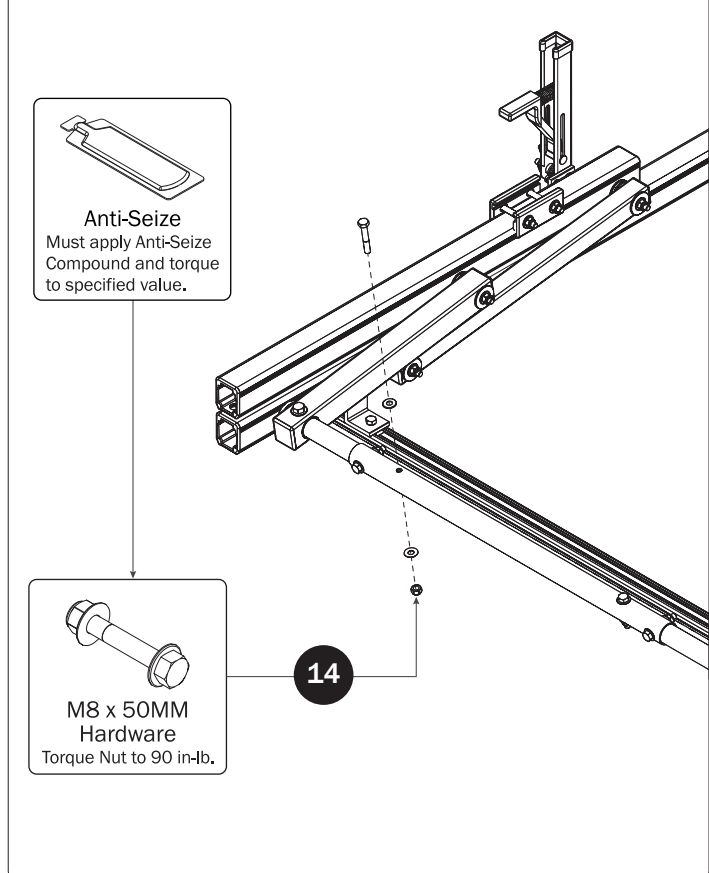

L POSTS

SEE QUICK START GUIDE FOR ADJUSTMENTS

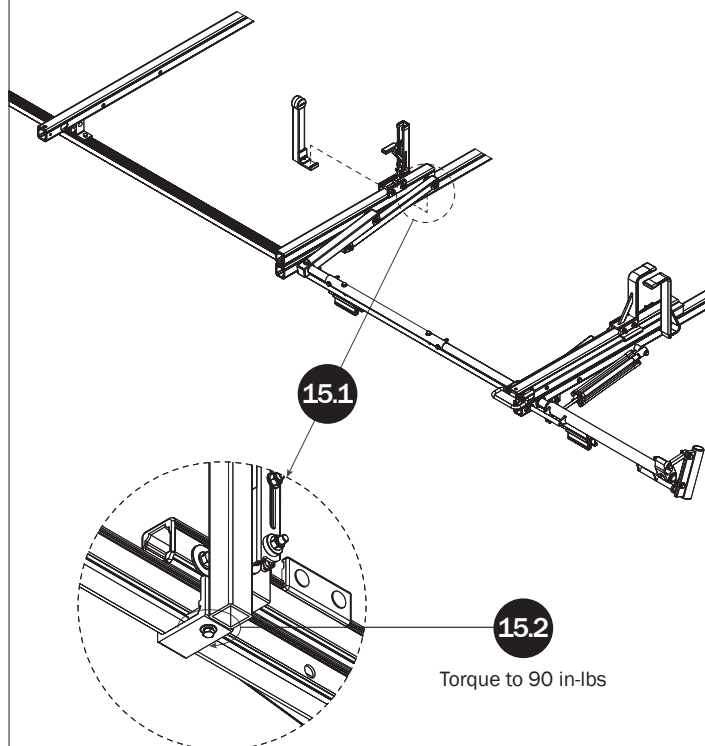
**Z POSTS**

SEE QUICK START GUIDE FOR ADJUSTMENTS

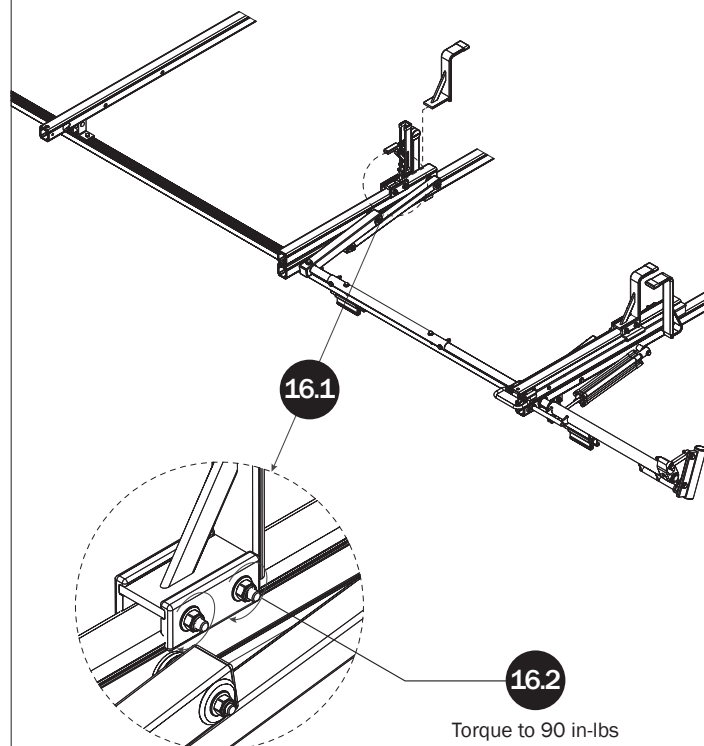
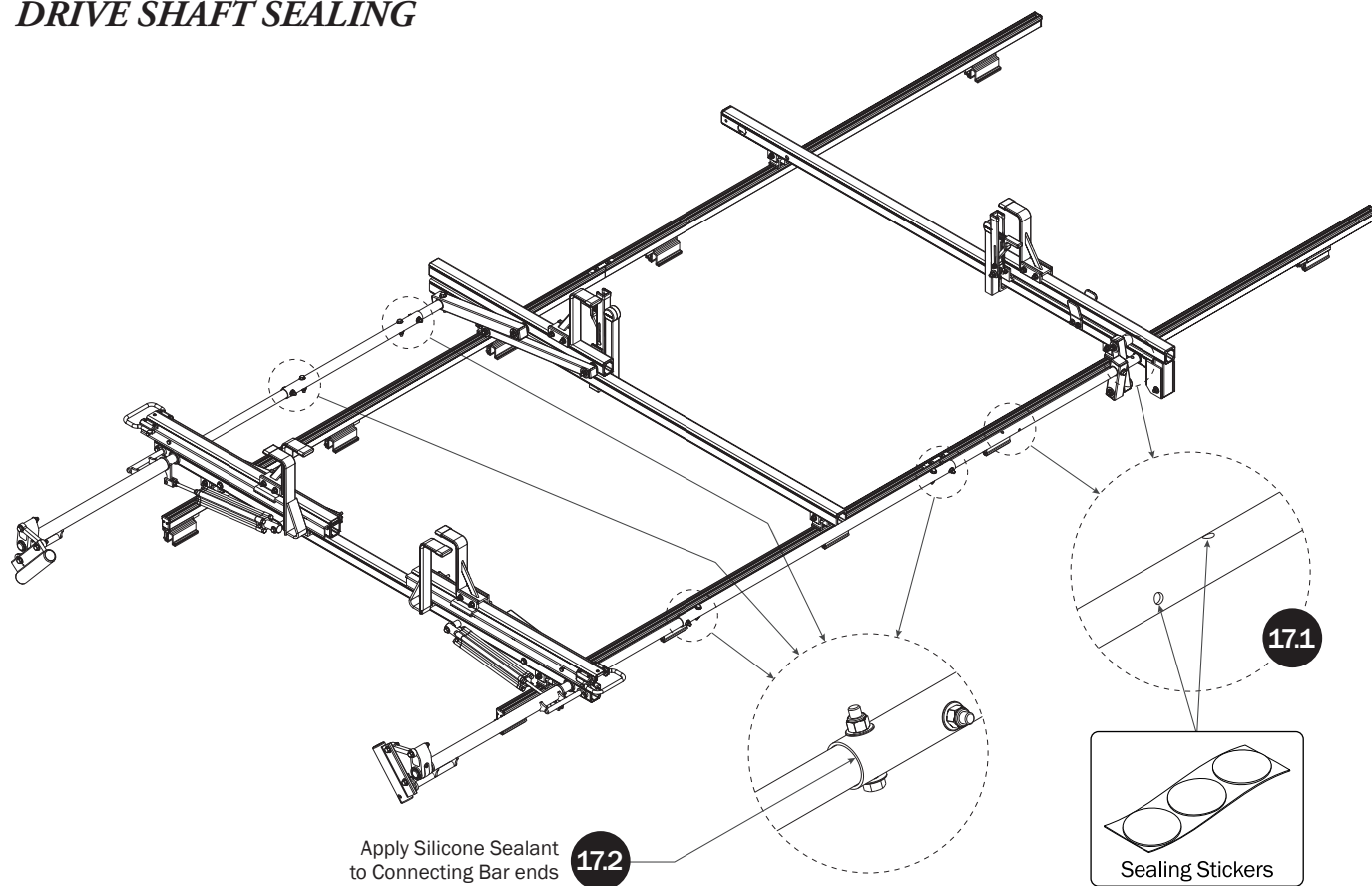
**DRIVE SHAFT SEALING**

CYLINDER ADJUSTMENT

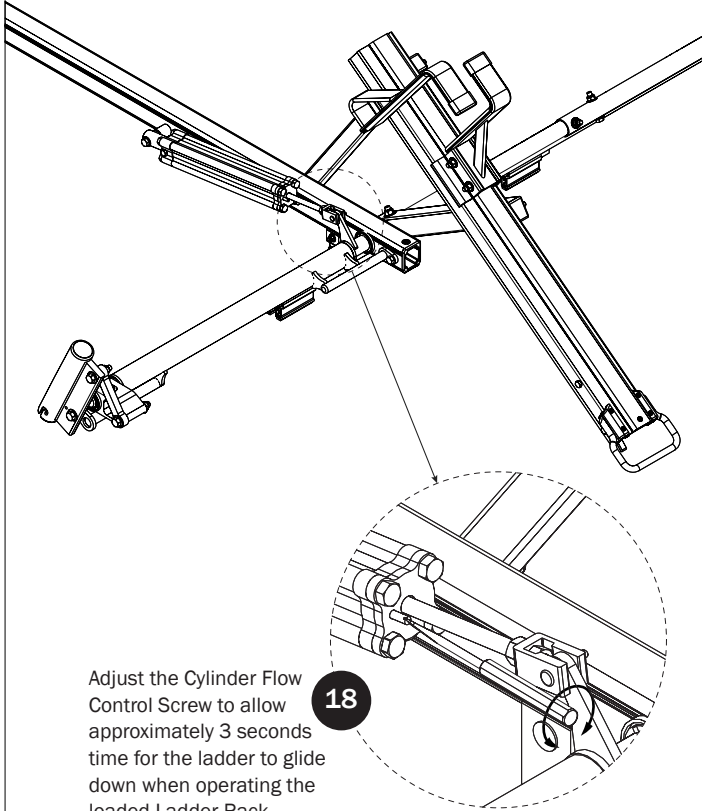

Page Intentionally Left Blank

Page Intentionally Left Blank

