

**PRIME DESIGN™**

A Safe Fleet Brand

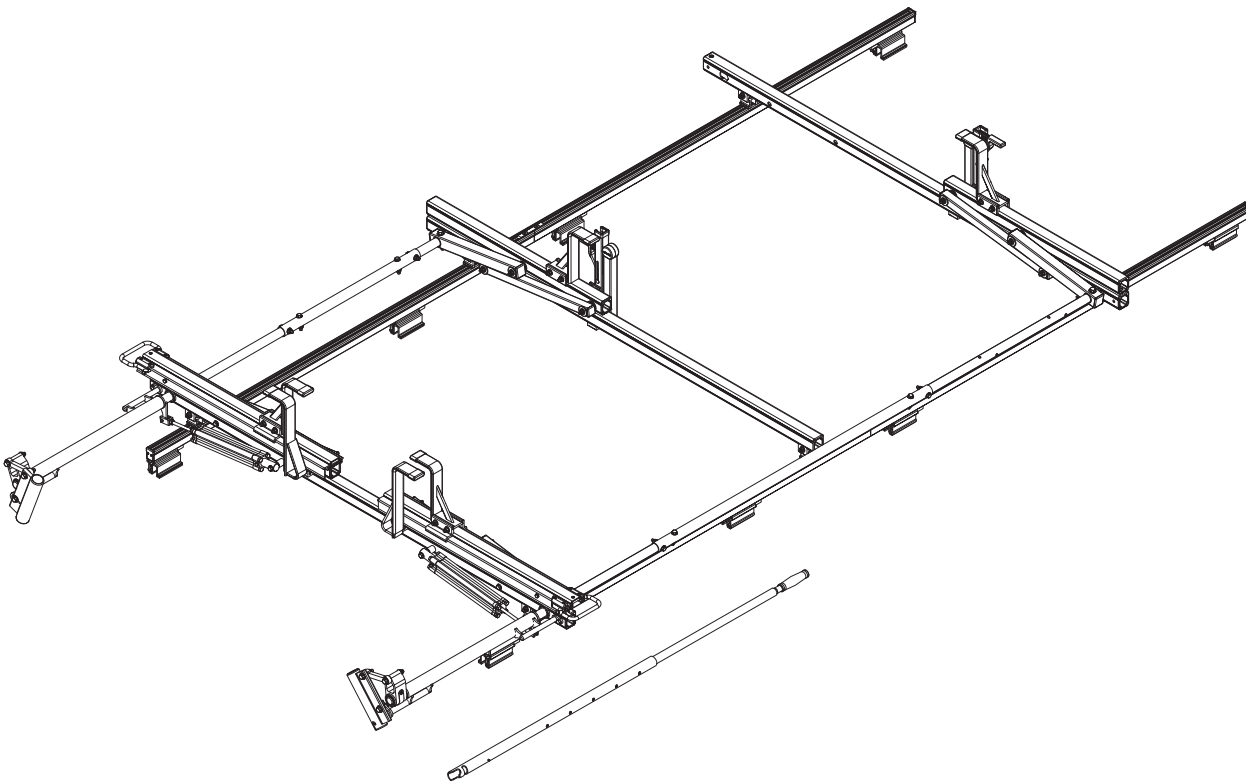

**PRIME DESIGN**  
**HRP3-E**

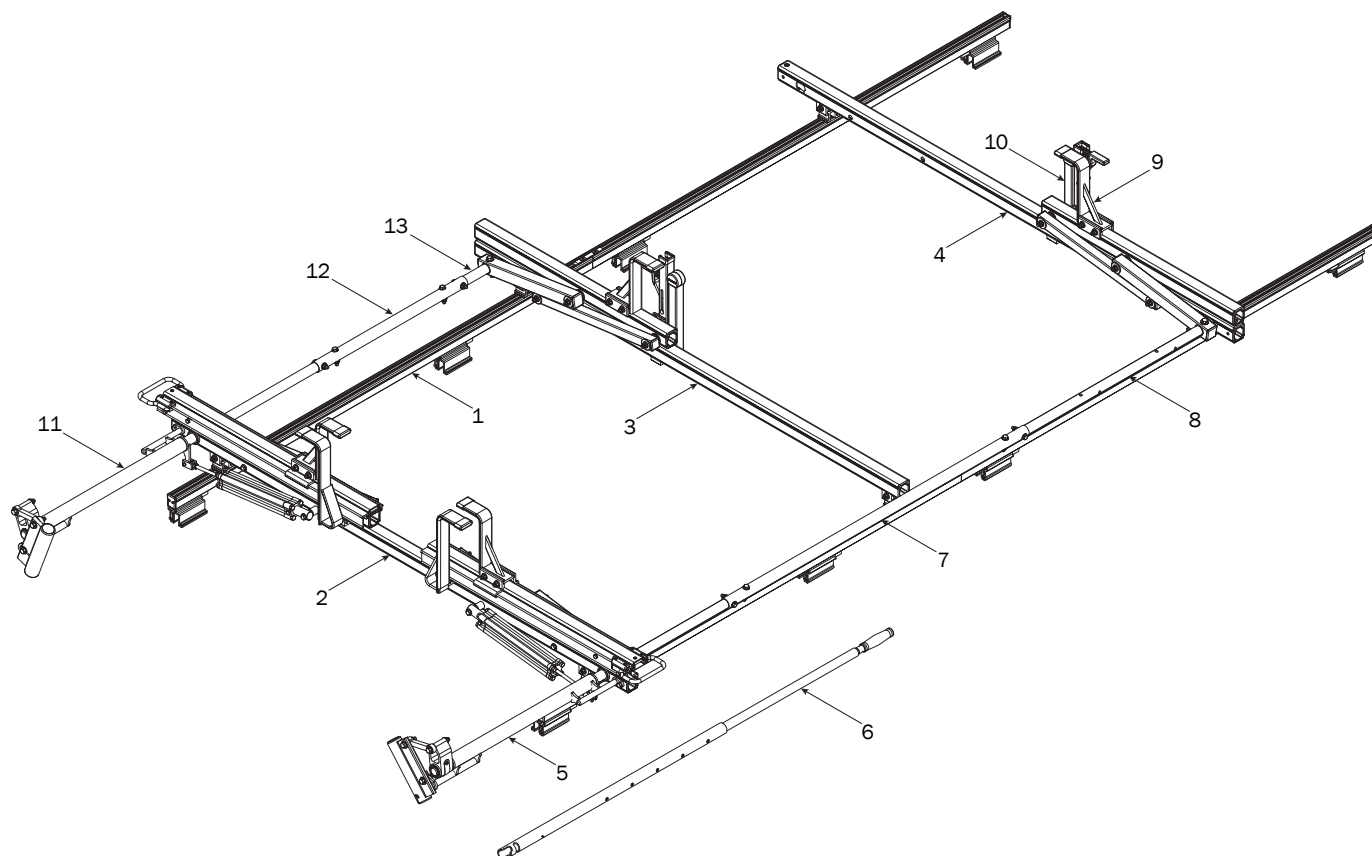

- 1—FBM3-0014 ..... (Qty 1)  
Channels with hardware



66" Channels (4X)



End Caps (4X)



Screws (8X)



Top Connector (2X)



Bottom Connector (2X)



Brackets (6X)

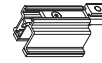

Mountings (8X)

M8 Bolt (4X)

- 2—Rear Crossbar Assembly ..... (Qty 1)

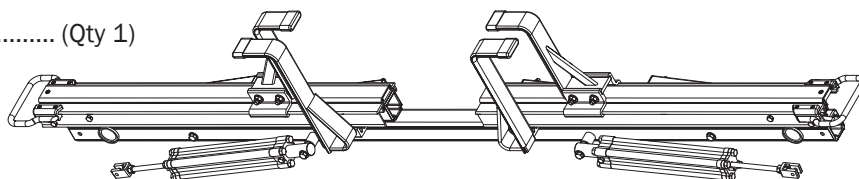

- 3—Center Crossbar Assembly ..... (Qty 1)

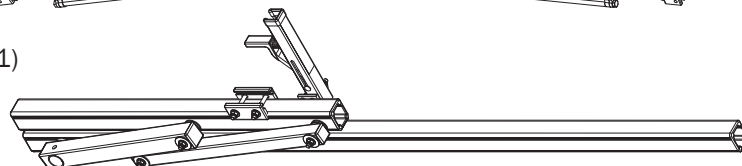

- 4—Front Crossbar Assembly ..... (Qty 1)

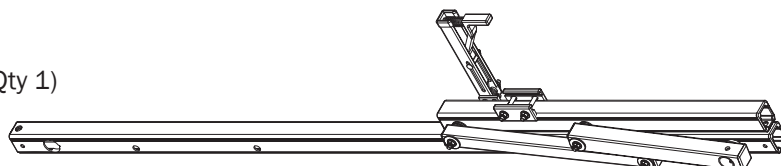

- 5—Rear Drive Shaft ..... (Qty 1)  
Right Hand, A Version, 50.00"

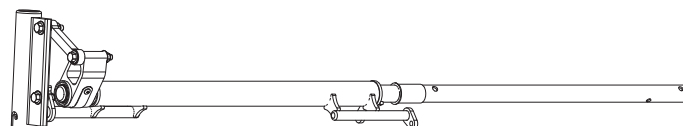

6—HHR Handle Assembly ..... (Qty 1)  
35.00"

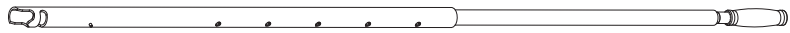

7—Connecting Bar ..... (Qty 1)  
4.00'

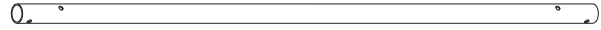

8—Front Drive Shaft ..... (Qty 1)  
B Version, 35.75"

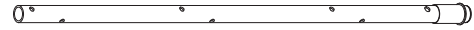

9—Z Post ..... (Qty 2)  
Adjustable, 7.25"

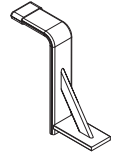

10—L Post ..... (Qty 2)  
US3, Roller Cap, 9.25"

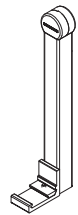

11—Rear Drive Shaft ..... (Qty 1)  
Left Hand, A Version, 50.00"

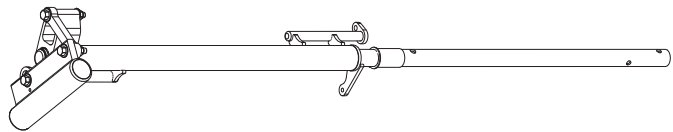

12—Connecting Bar ..... (Qty 1)  
24.00"

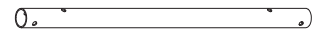

13—Front Drive Shaft ..... (Qty 1)  
B Version, 11.75"

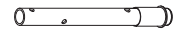

14—HKT-8163 (Not called out in Overview)..... (Qty 2)

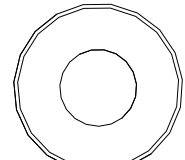
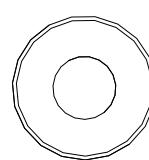
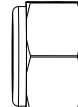
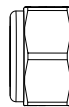
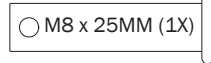
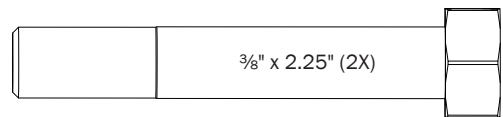
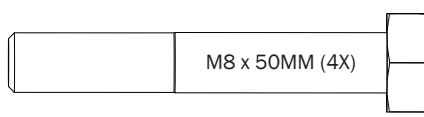

M8 Lock Nut (5X)

3/8" Lock Nut (2X)

5/16" Flat Washer (10X)

3/8" Flat Washer (4X)

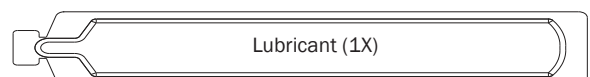
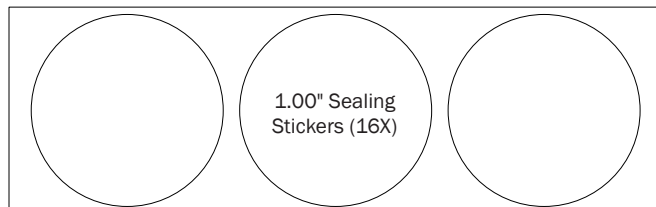

## FBM3-0014 MOUNTING BRACKETS

**INSTALLER NOTE:** Mounting Brackets must be disassembled for installation onto the vehicle's roof.

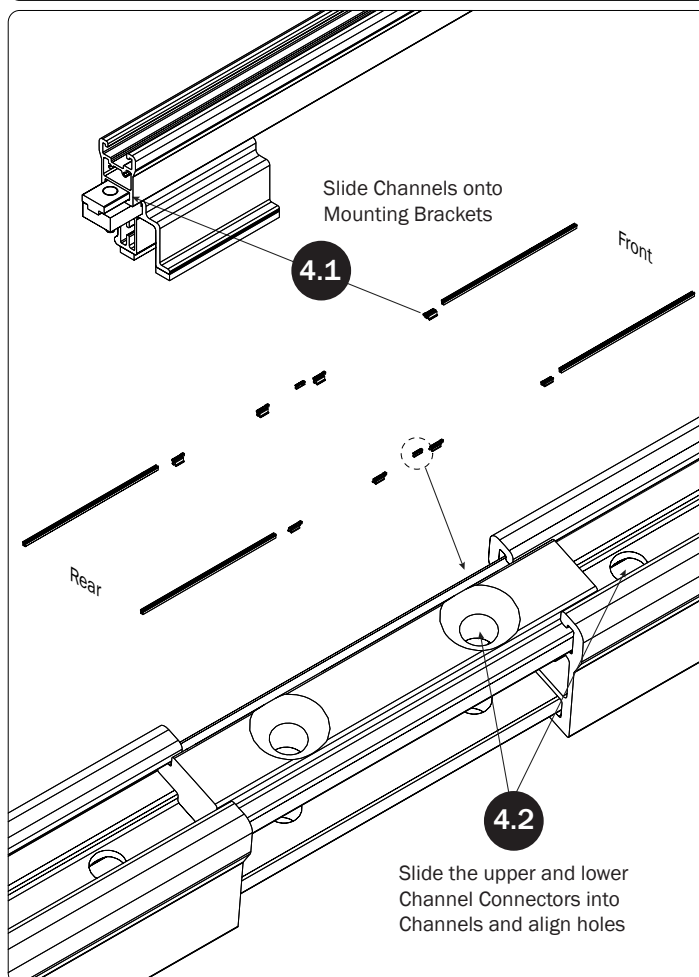
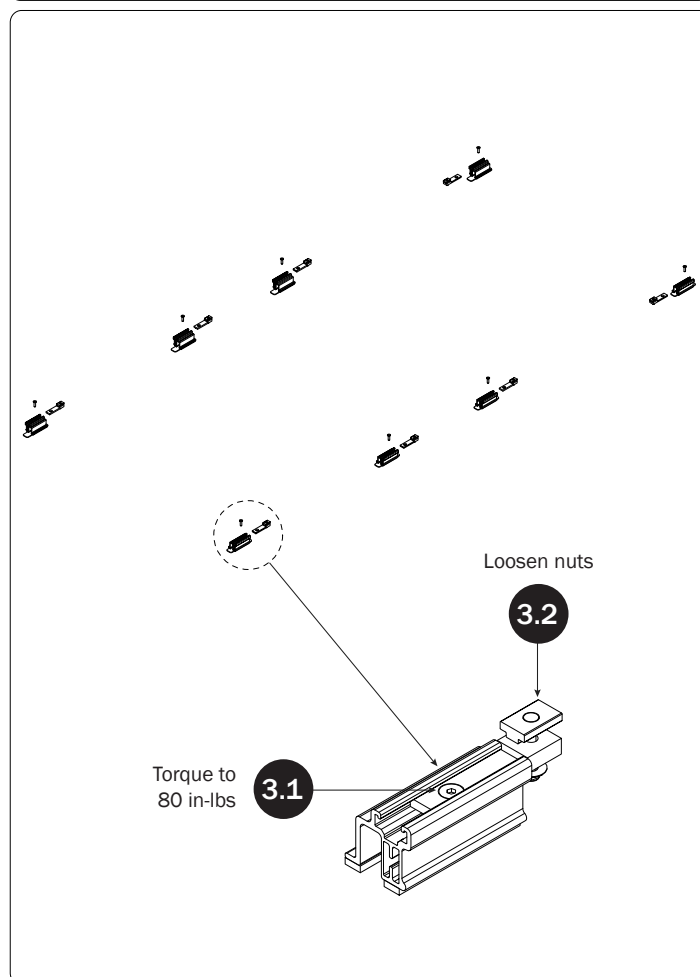
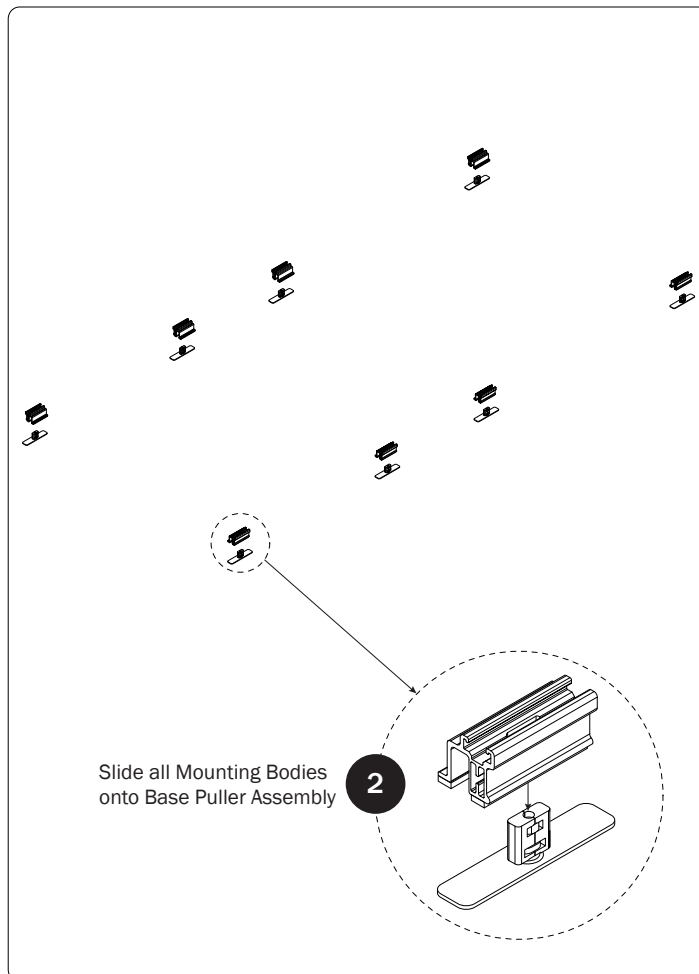
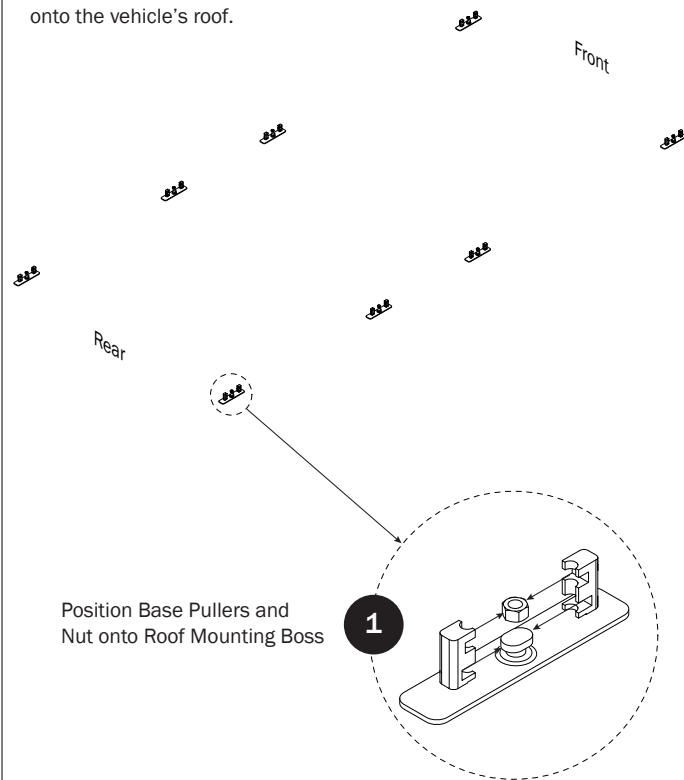

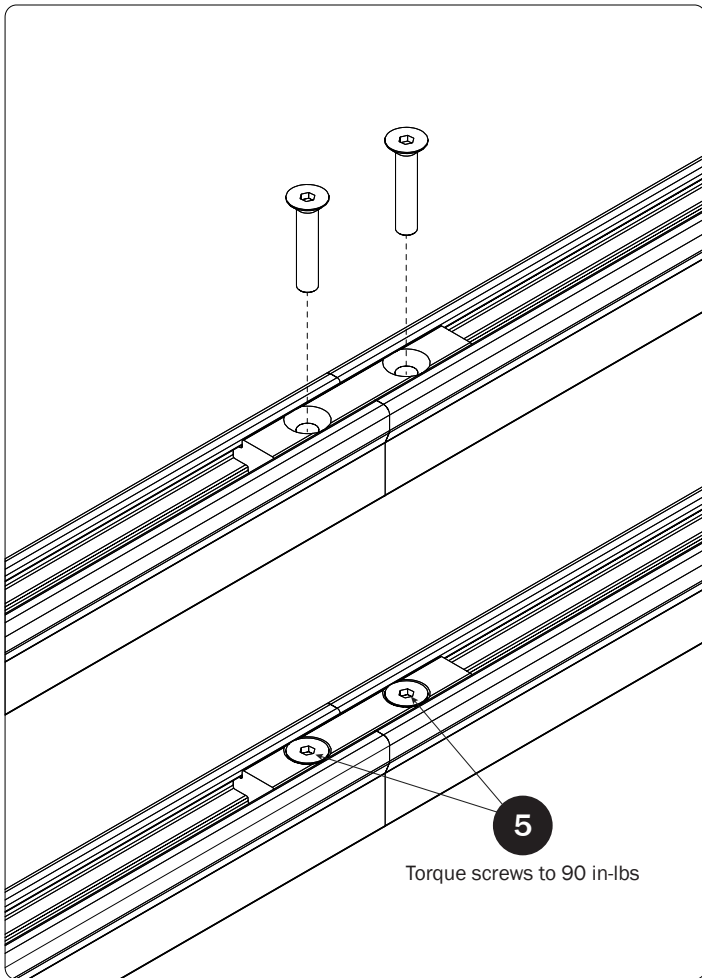

6 Set to distances then torque Mounting Bracket nuts to 80 in-lbs

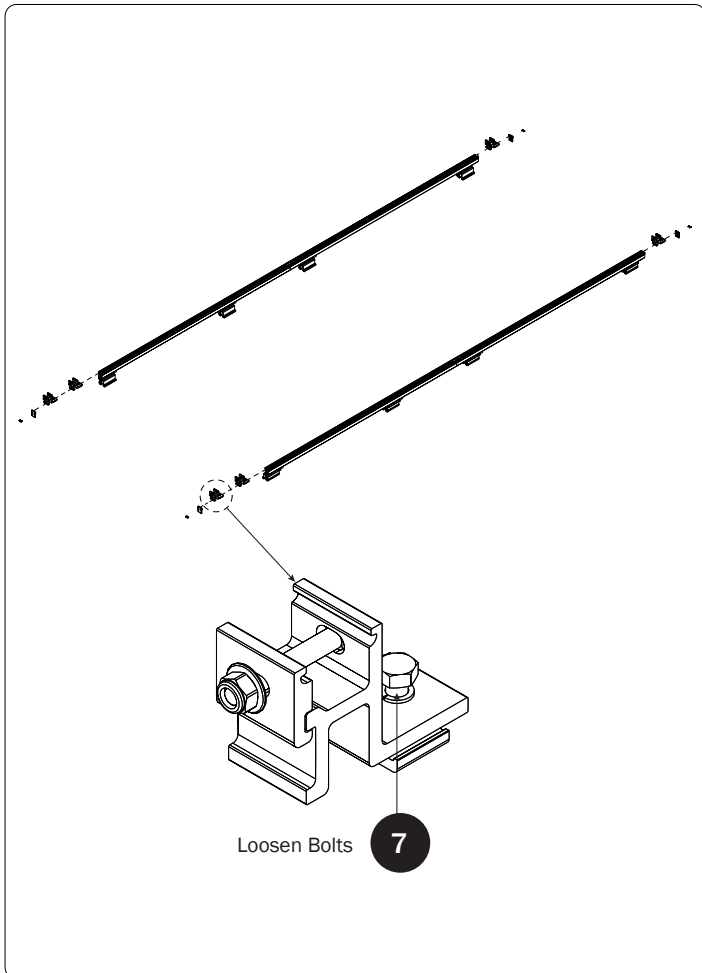
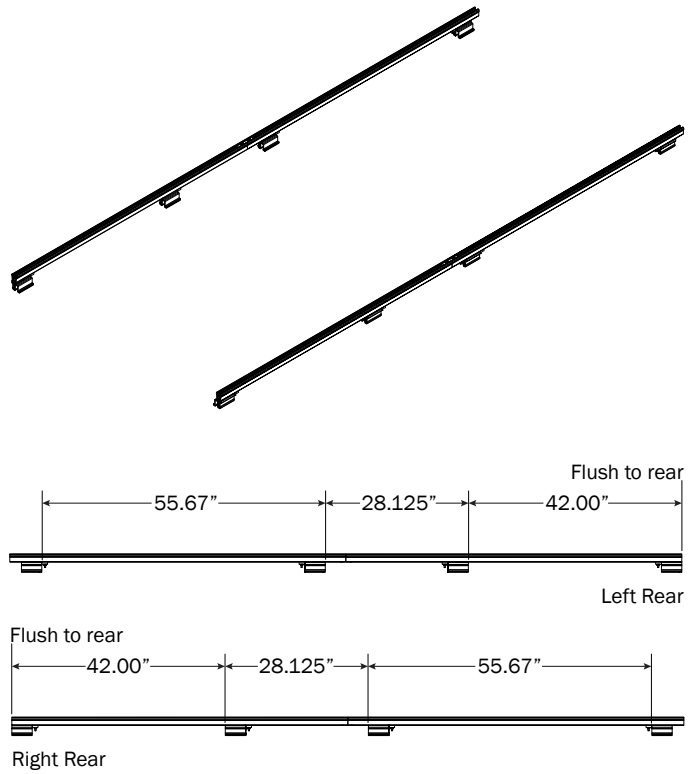

8 Set to distances then torque Mounting Bracket nuts to 90 in-lbs

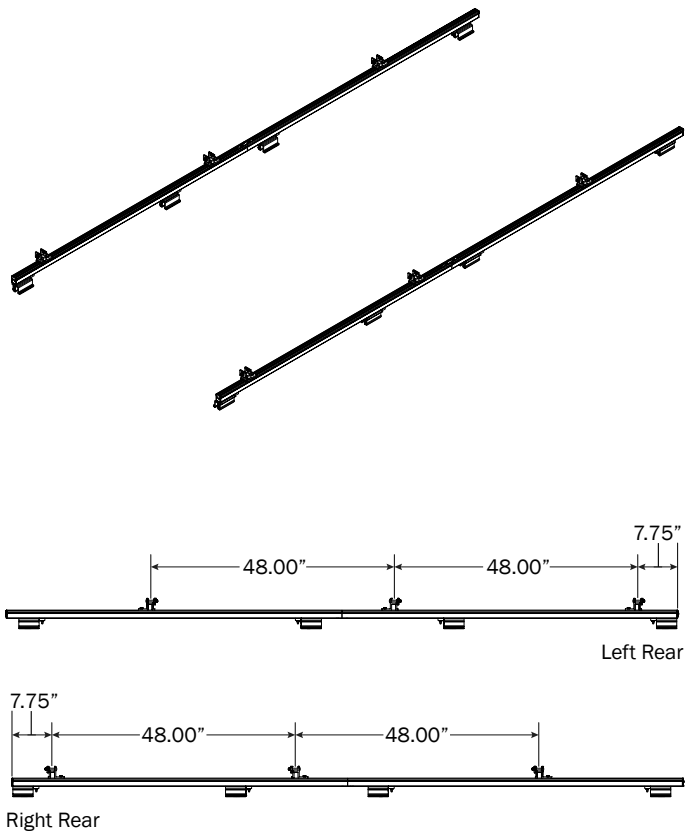

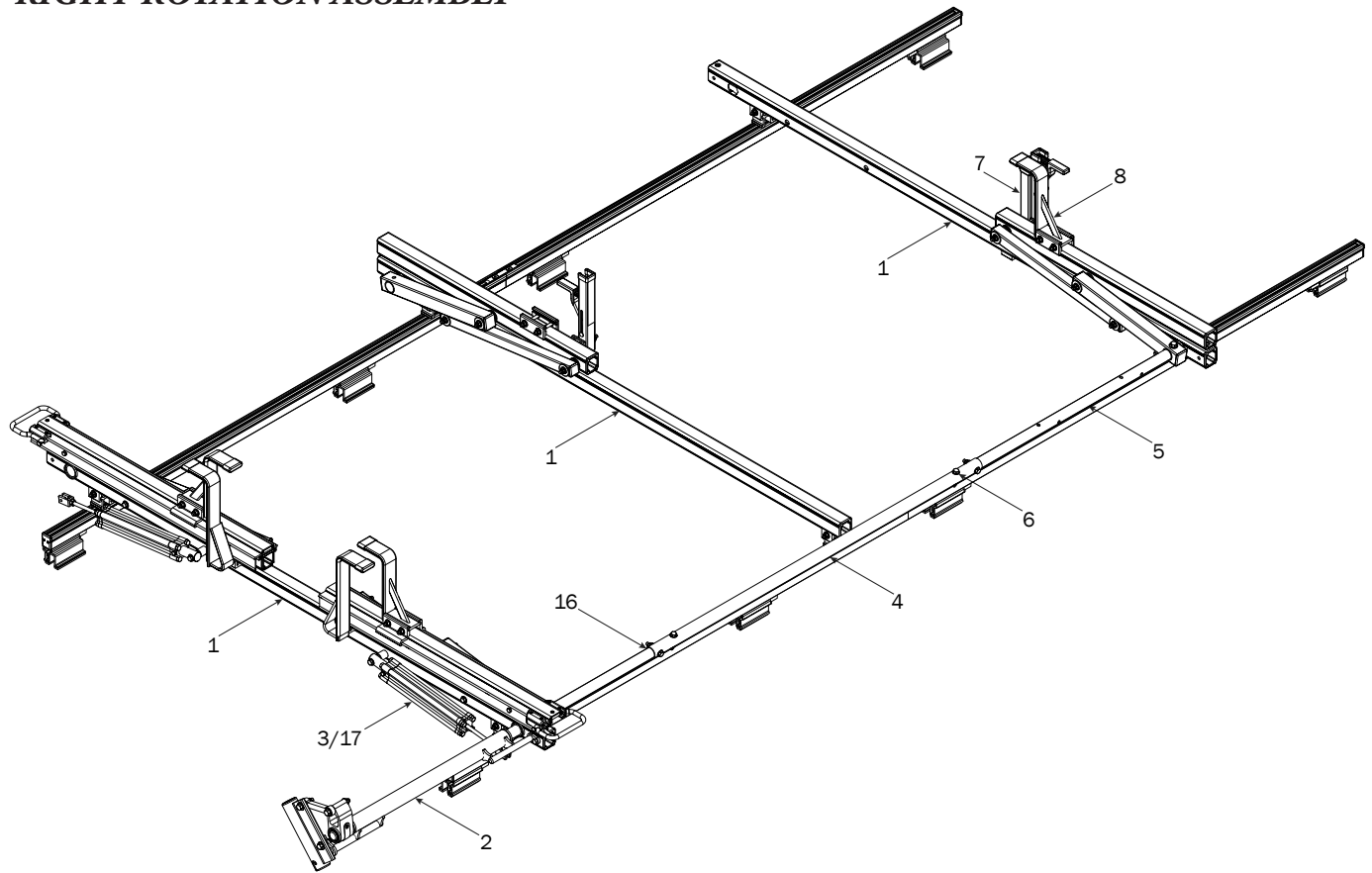
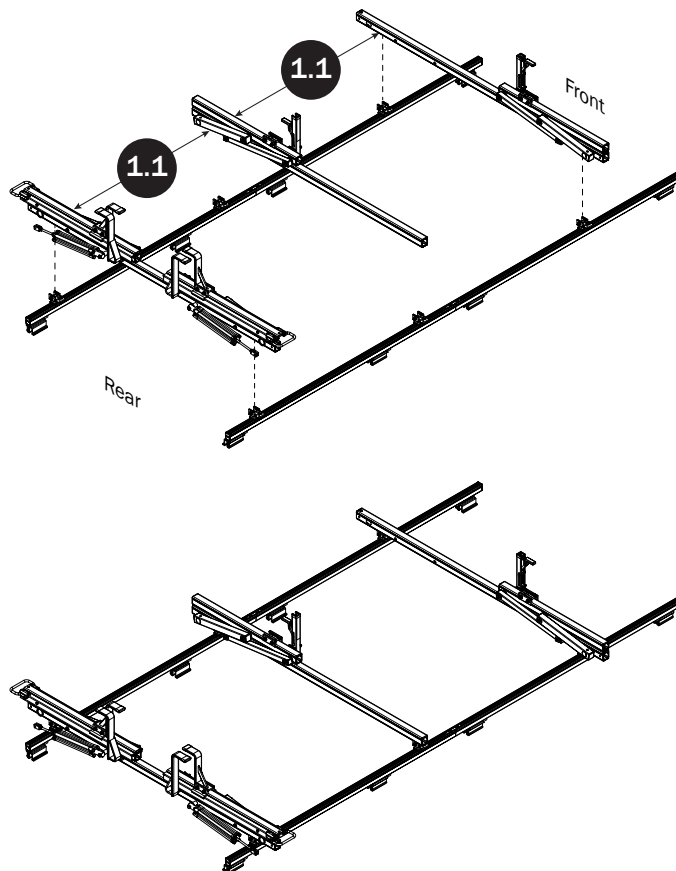
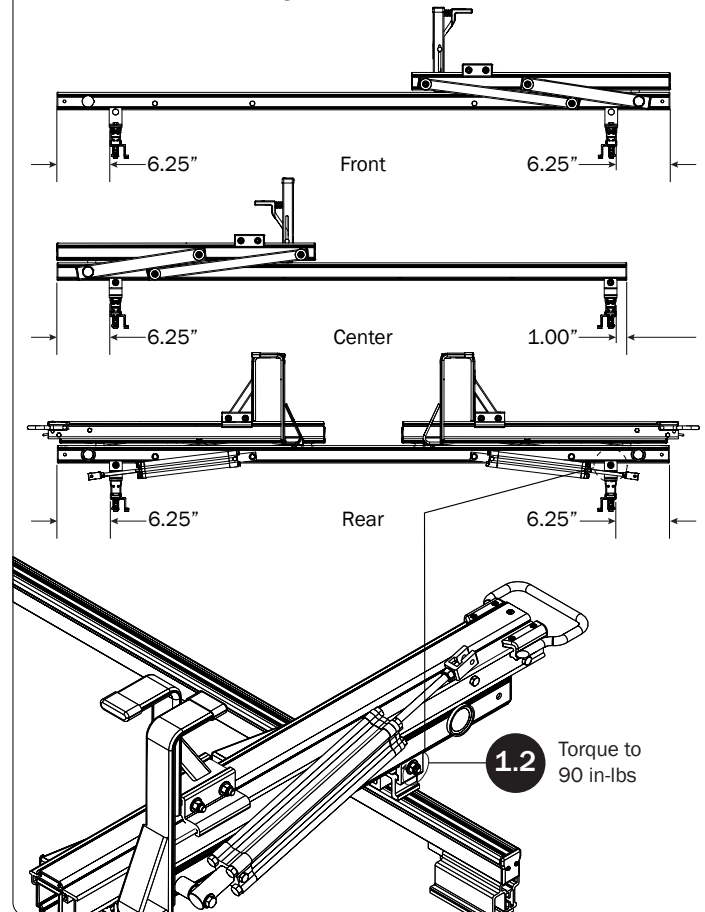
**RIGHT ROTATION ASSEMBLY****CROSSBARS****CROSSBAR ADJUSTMENT**

## REAR DRIVE SHAFT

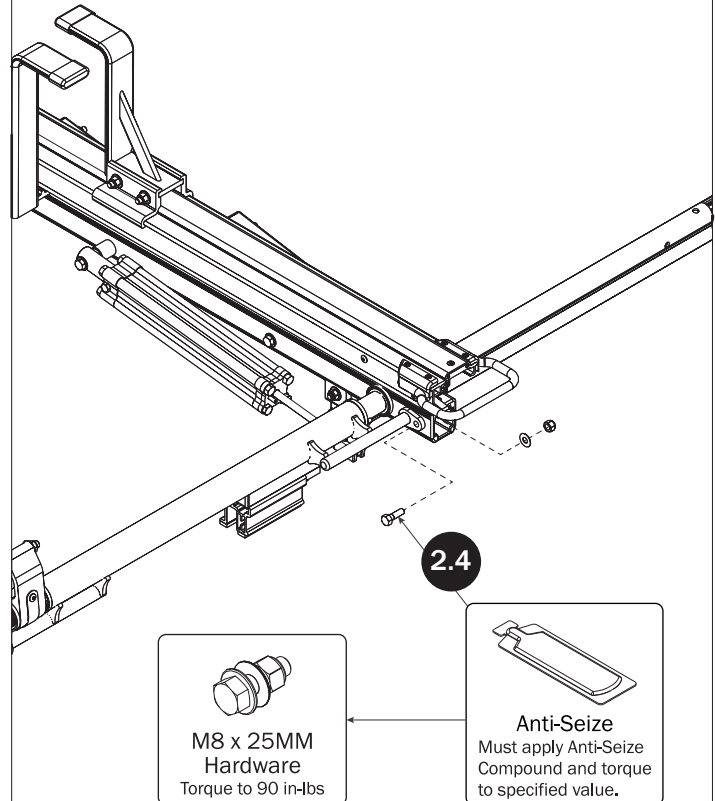
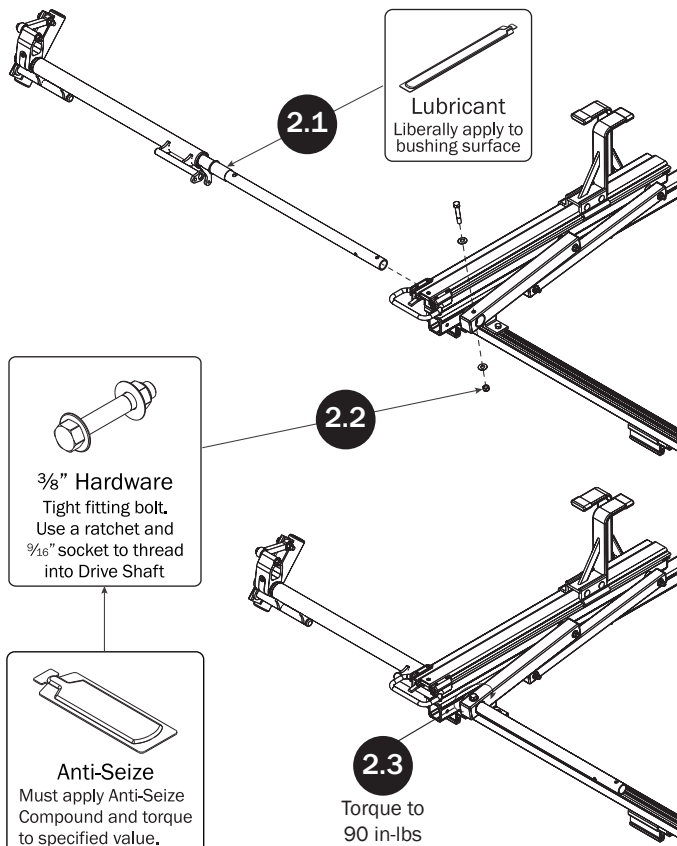

## CYLINDER HARDWARE

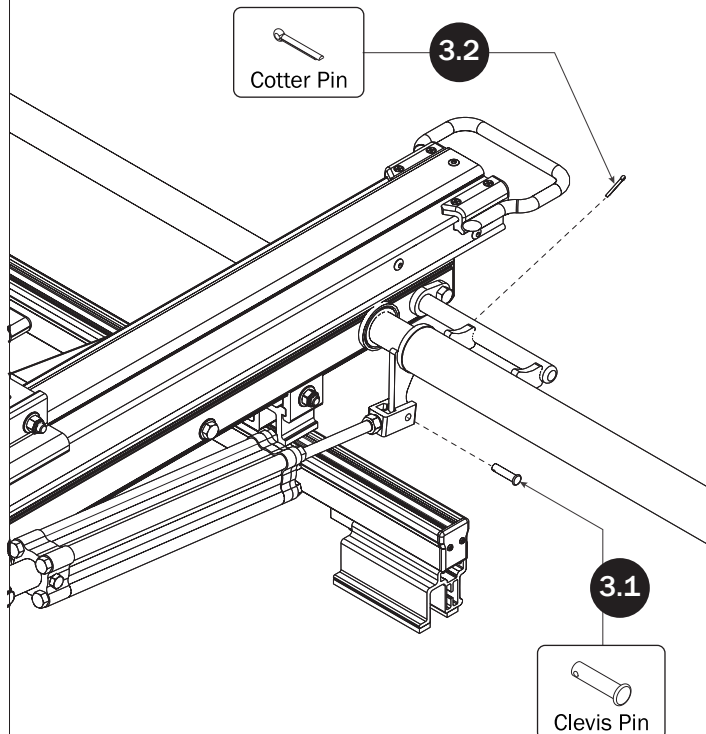

## CONNECTING BAR

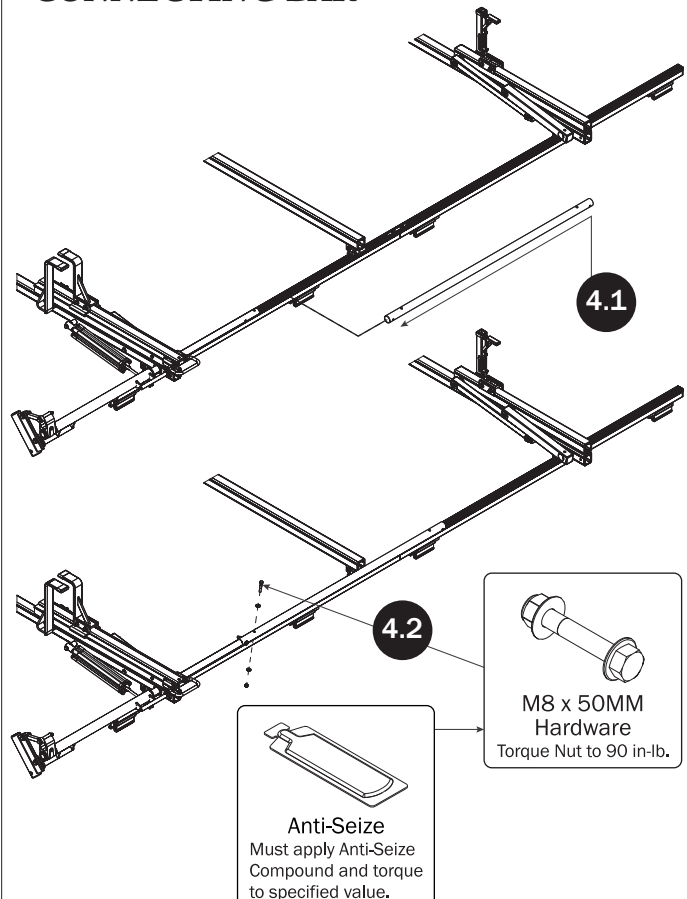

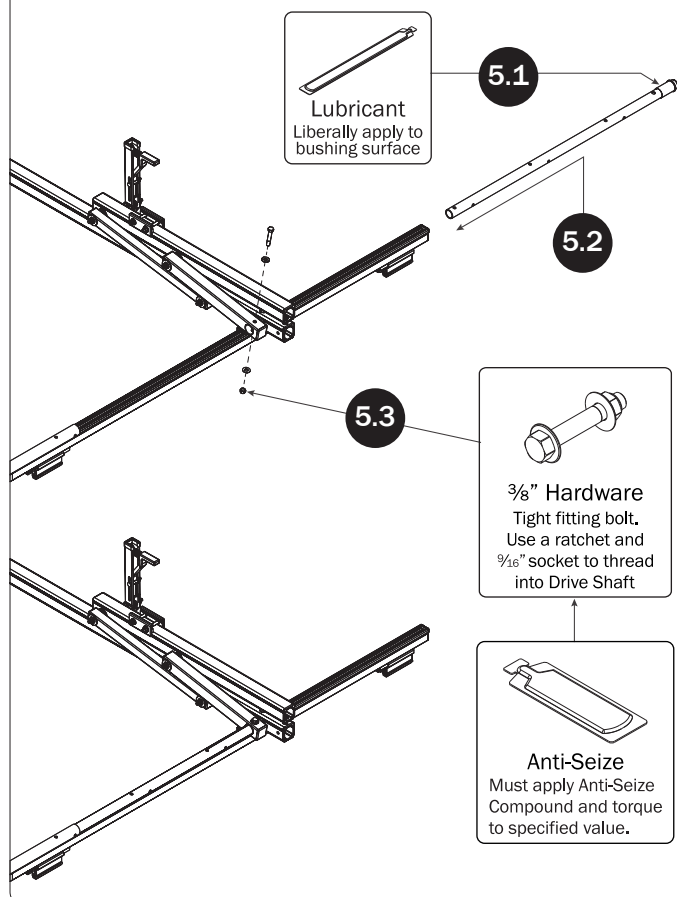
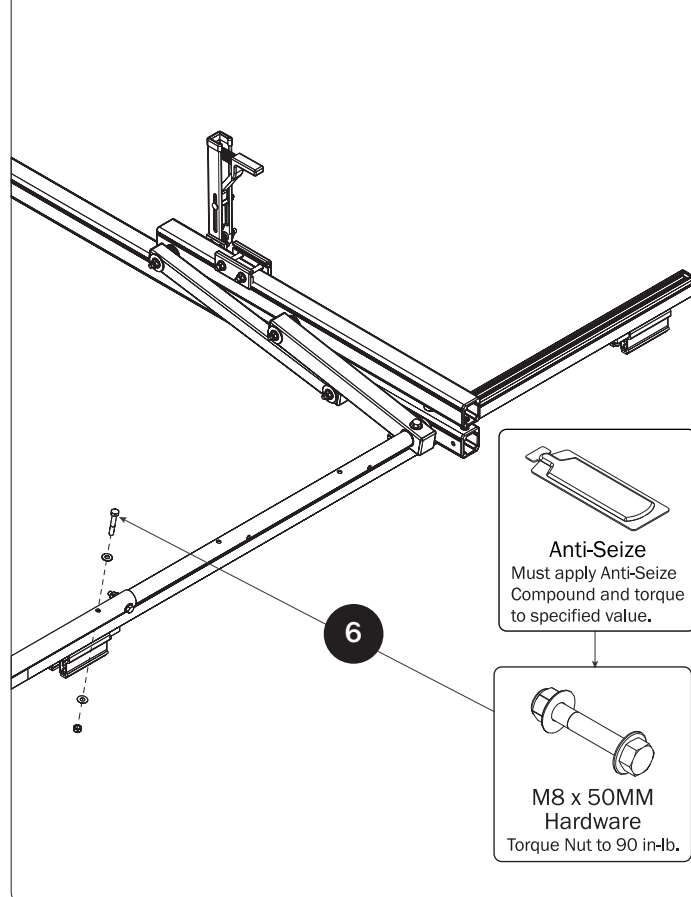

**FRONT DRIVE SHAFT****CONNECTING BAR FASTENERS****L POST**

SEE QUICK START GUIDE FOR ADJUSTMENTS

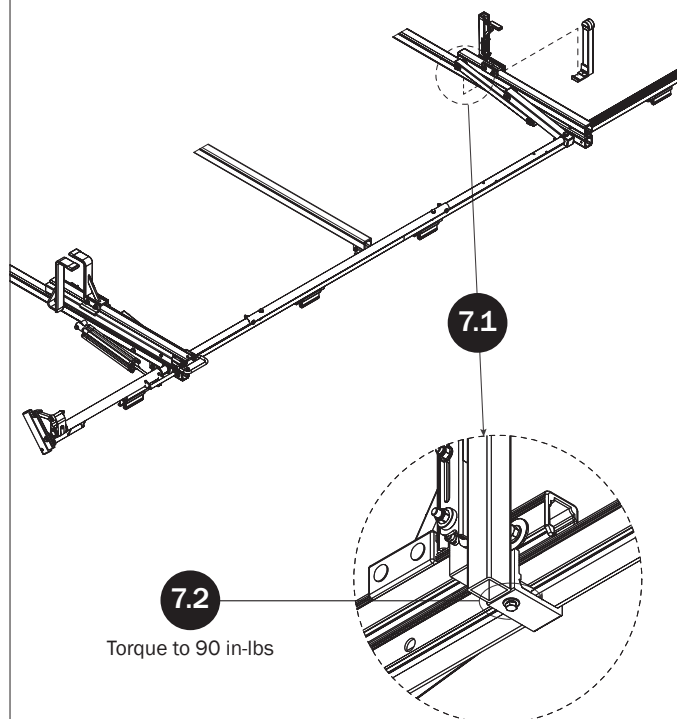
**Z POST**

SEE QUICK START GUIDE FOR ADJUSTMENTS

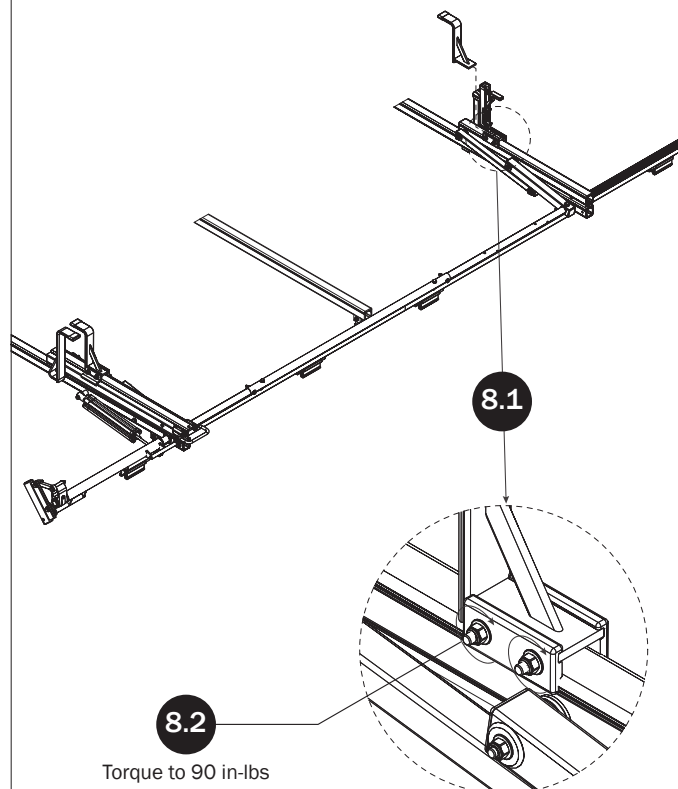



## LEFT ROTATION ASSEMBLY

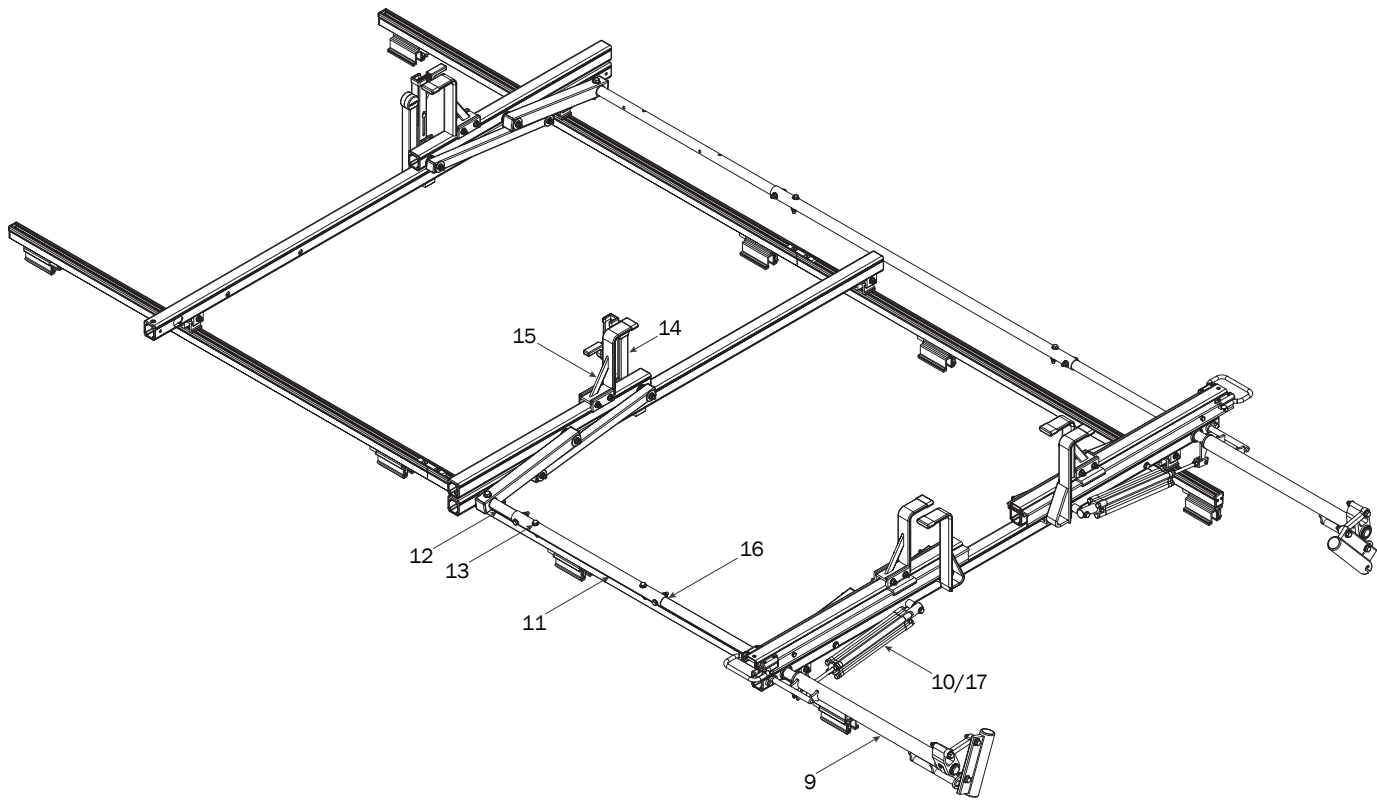

## REAR DRIVE SHAFT

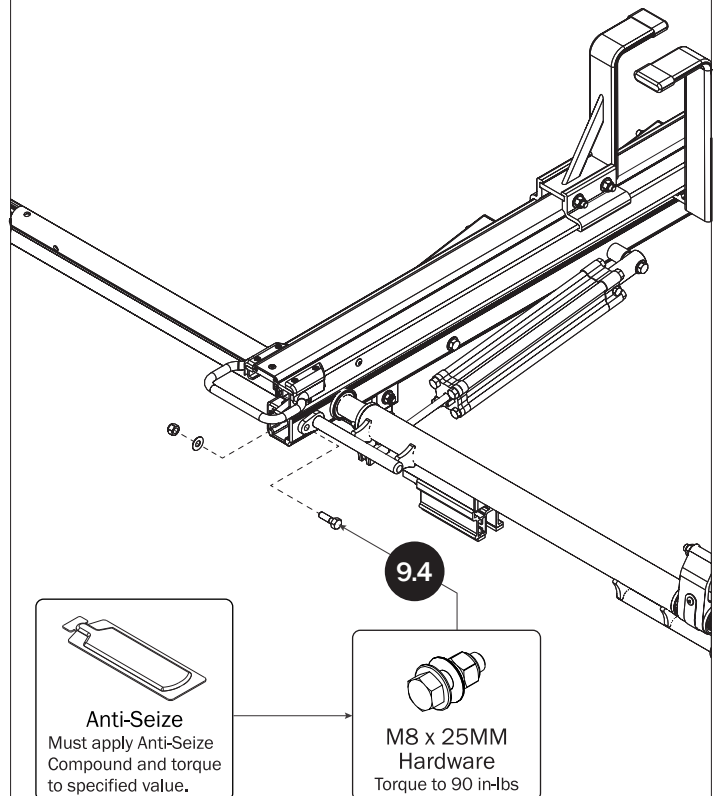
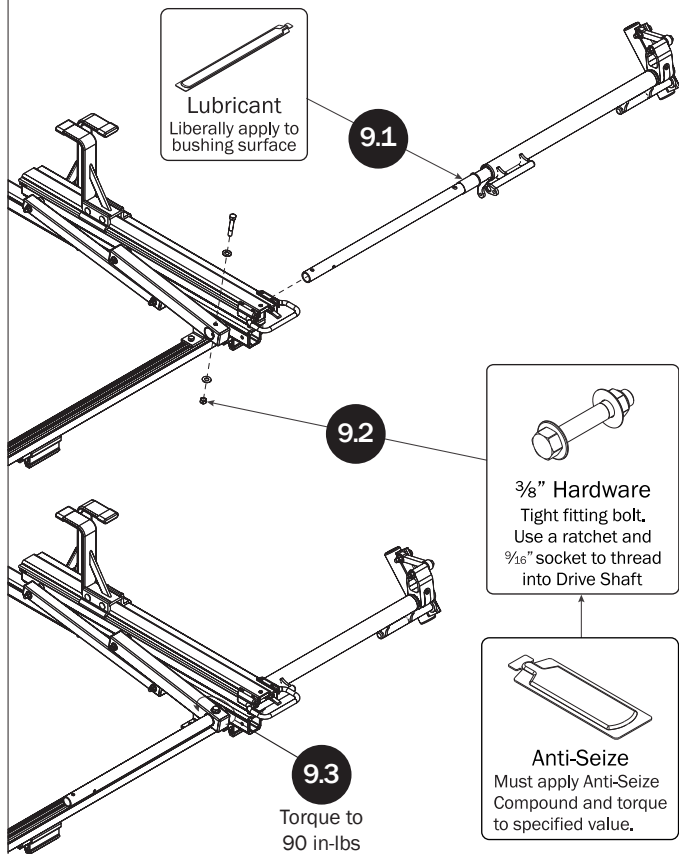

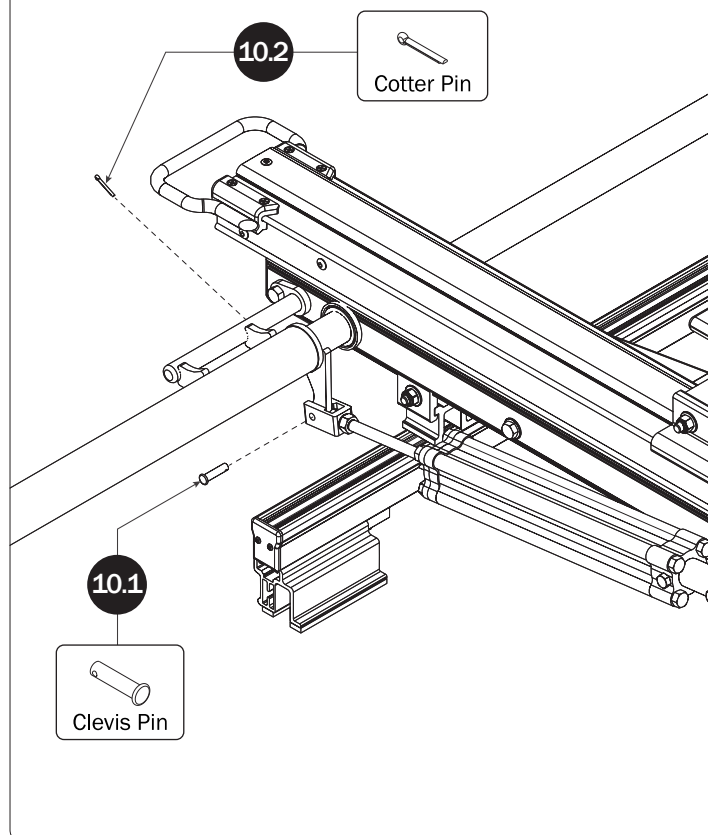
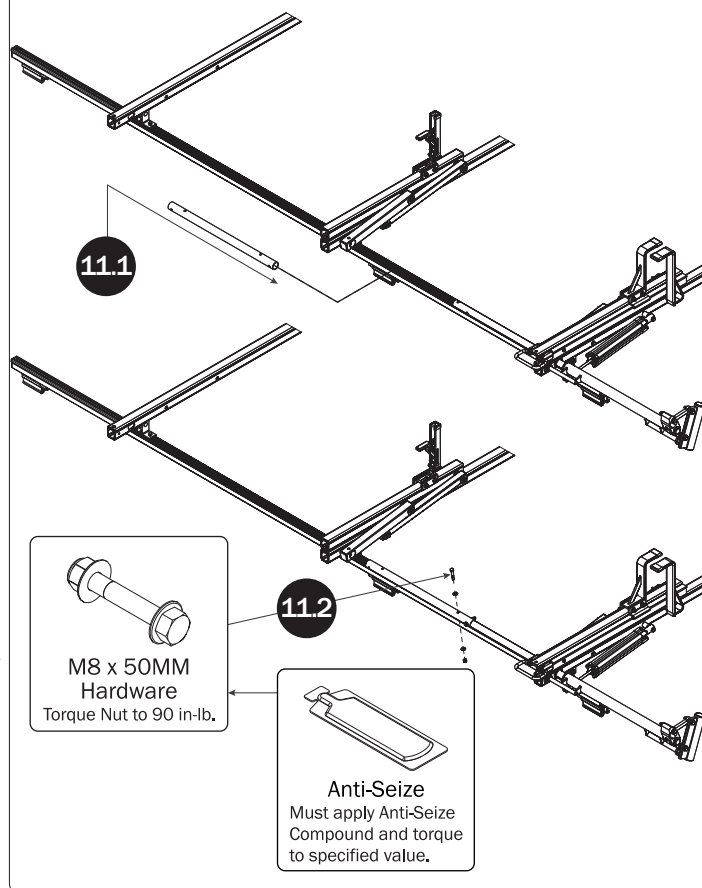
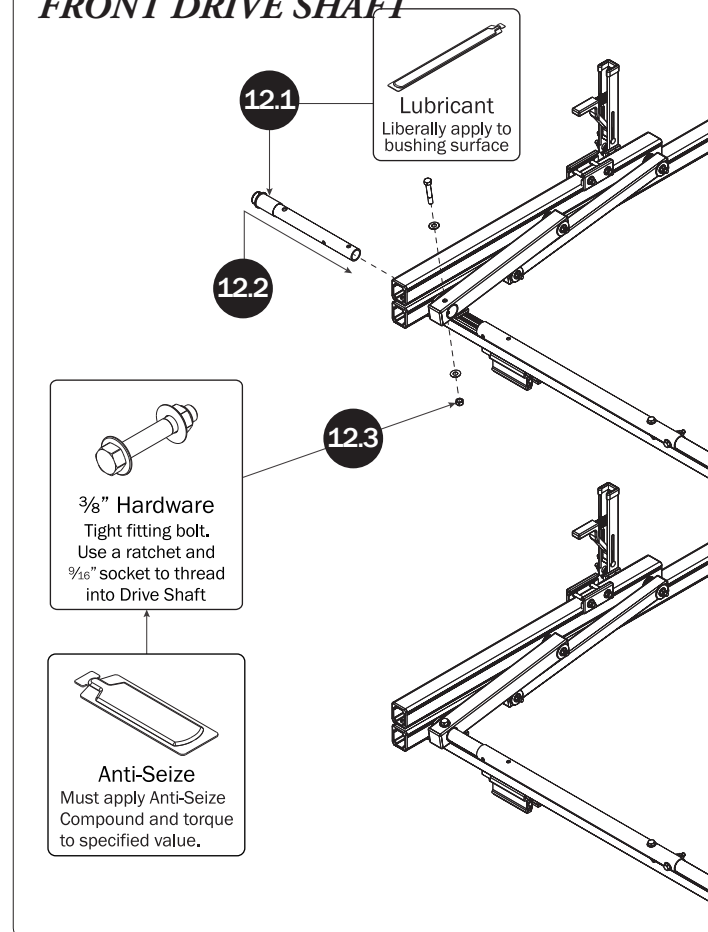
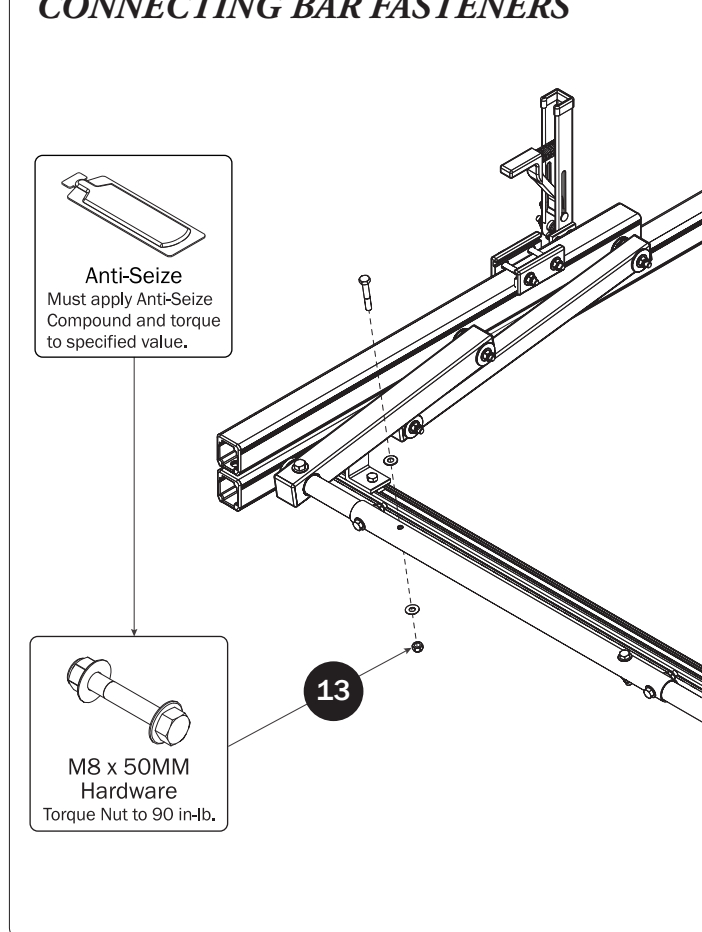
**CYLINDER HARDWARE****CONNECTING BAR****FRONT DRIVE SHAFT****CONNECTING BAR FASTENERS**

## L POSTS

SEE QUICK START GUIDE FOR ADJUSTMENTS

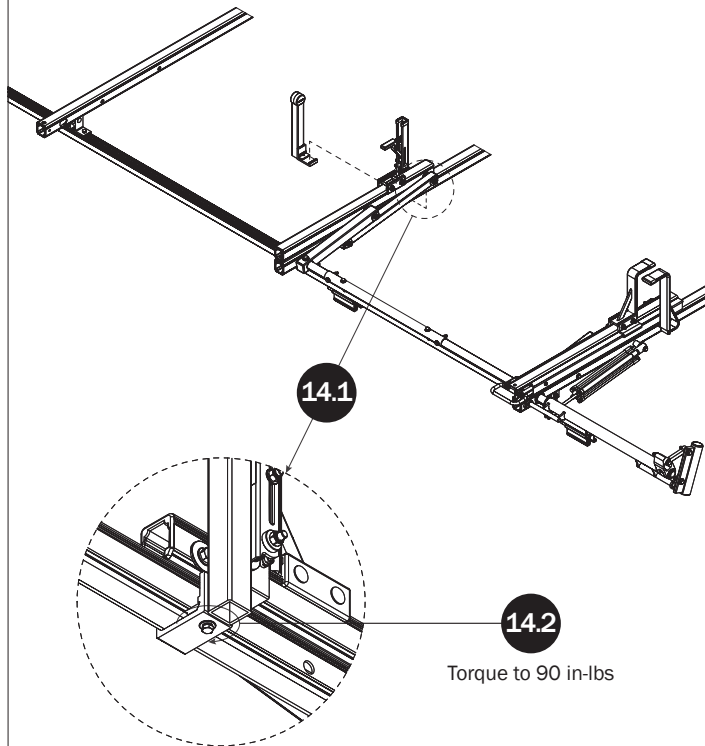

## Z POSTS

SEE QUICK START GUIDE FOR ADJUSTMENTS

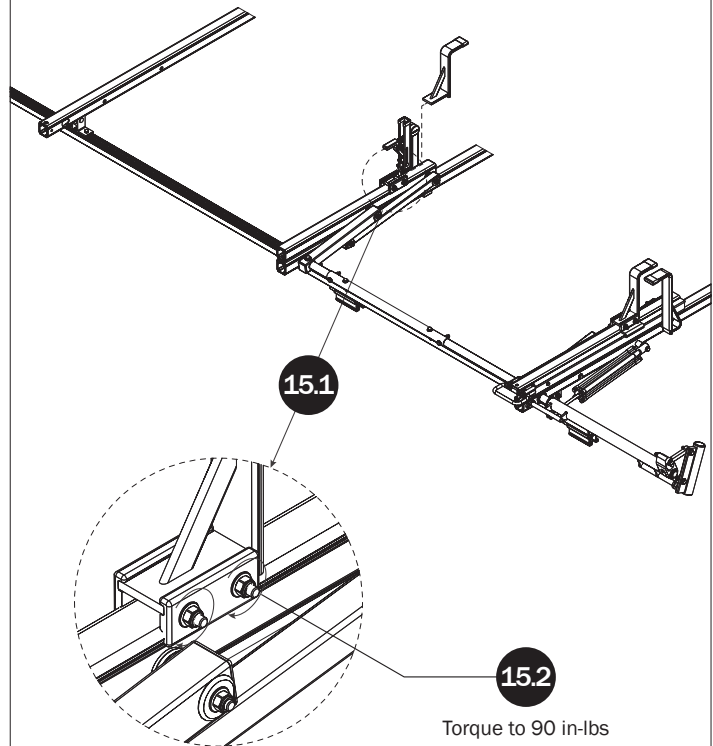

## DRIVE SHAFT SEALING

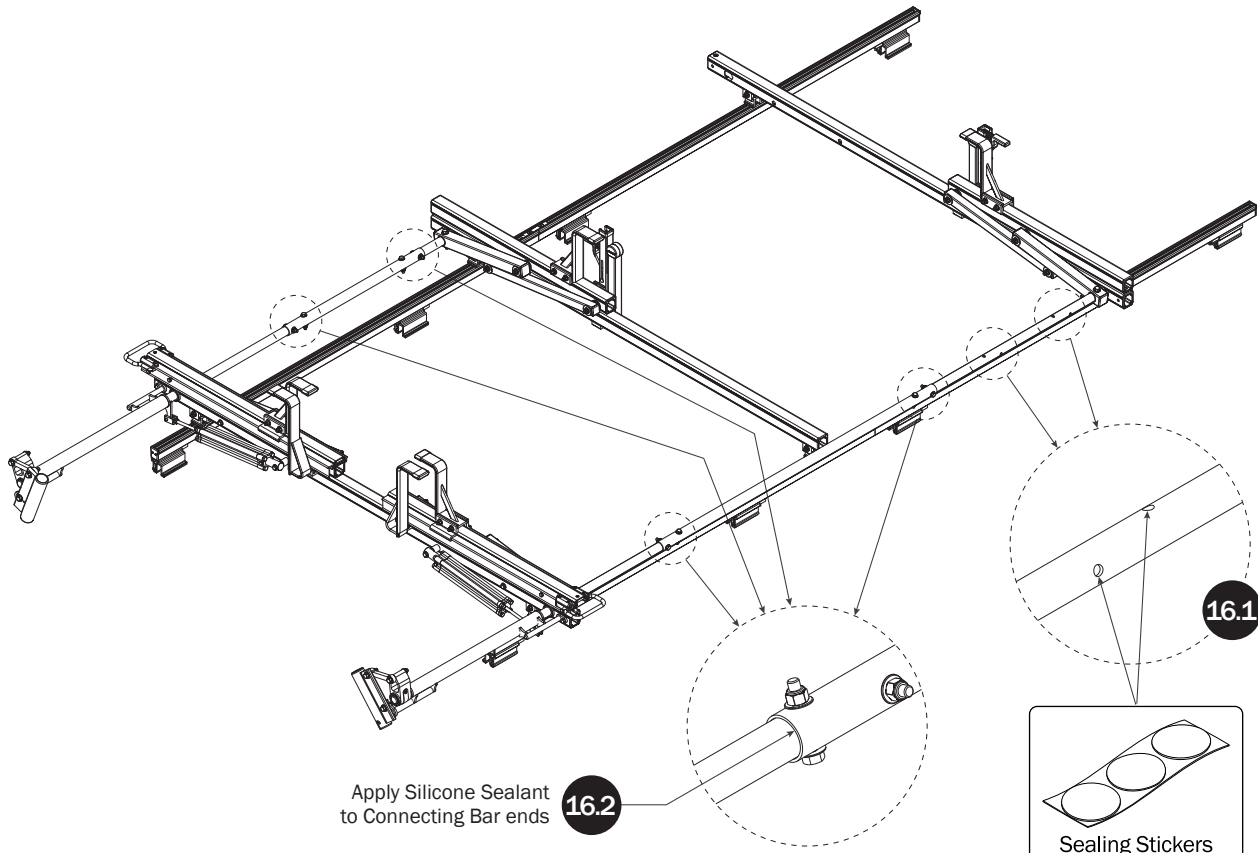

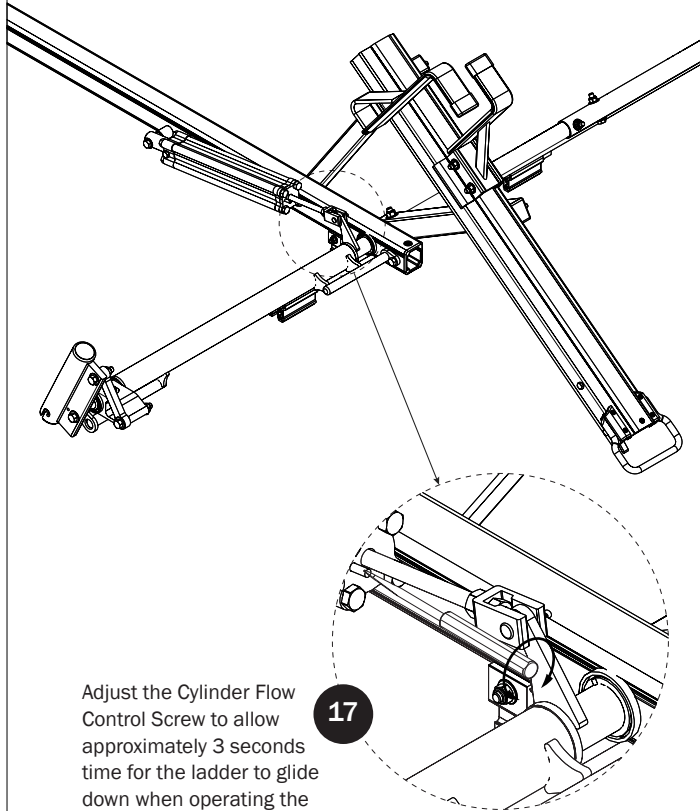
*CYLINDER ADJUSTMENT*

USAM-HRR3EPM42-US01 Rev-B 0118