

PRIME DESIGN™

A Safe Fleet Brand

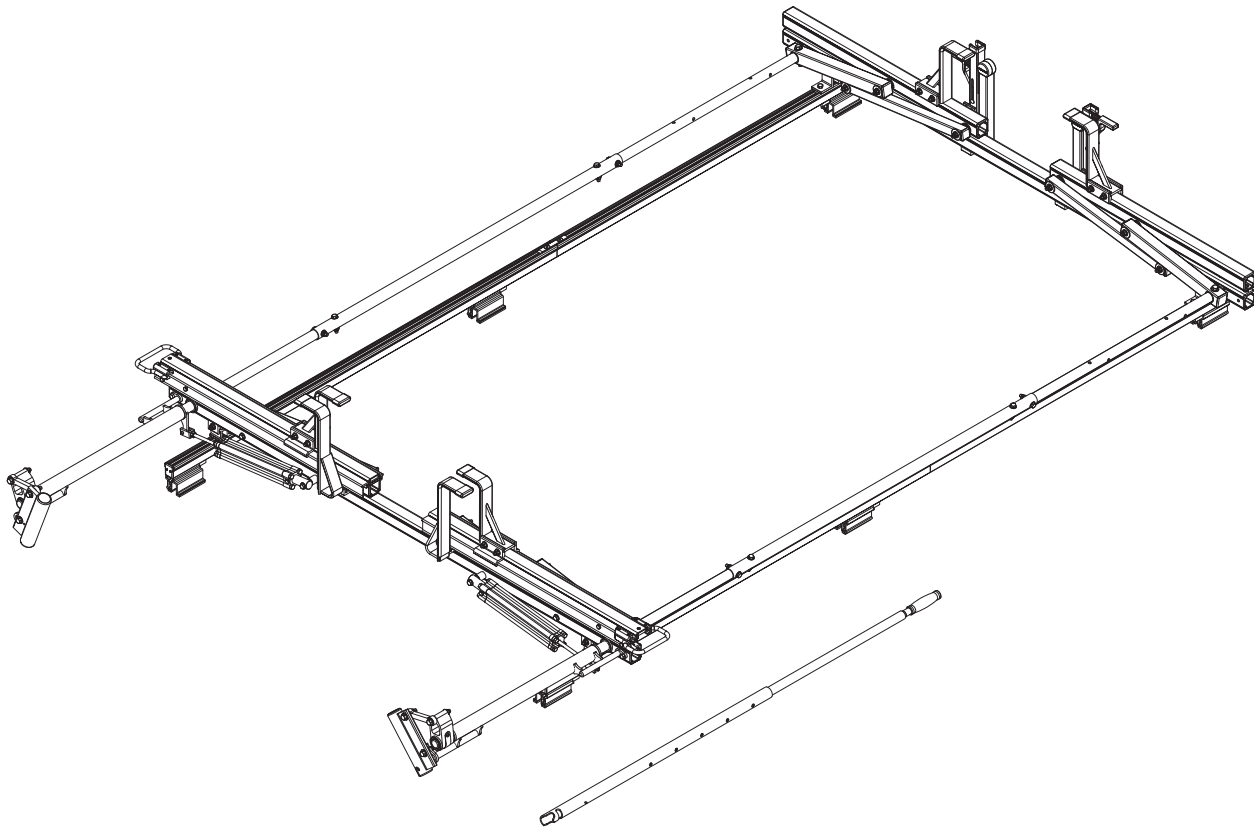

HRR-E

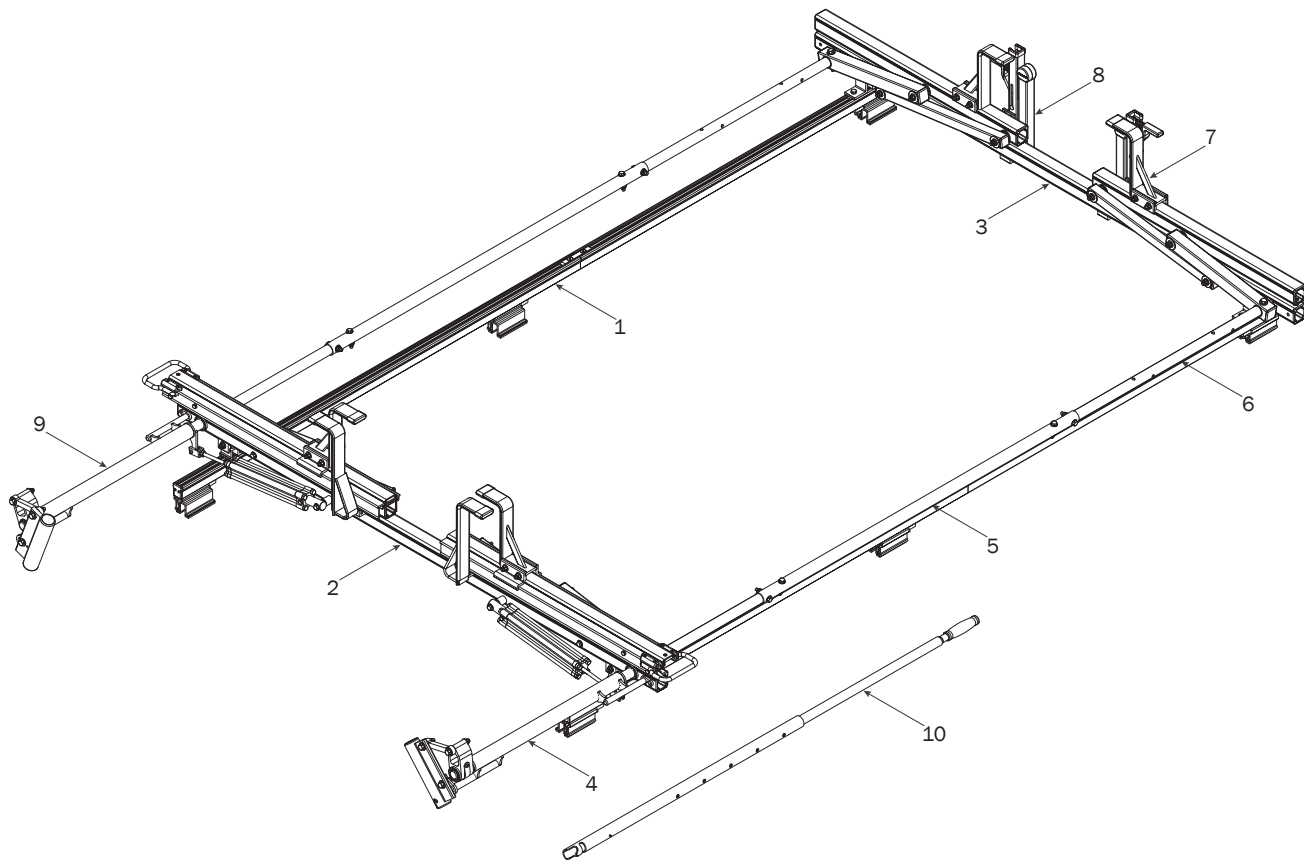

1—FBM-0013 (Qty 1)
Channels with hardware



48" Channels (2X)



60" Channels (2X)

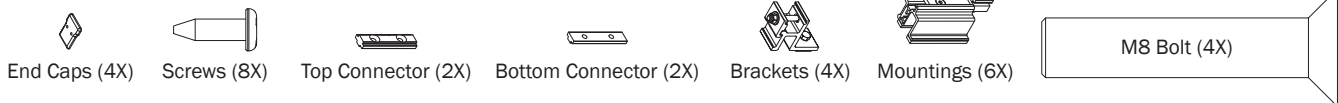

2—Rear Crossbar Assembly (Qty 1)

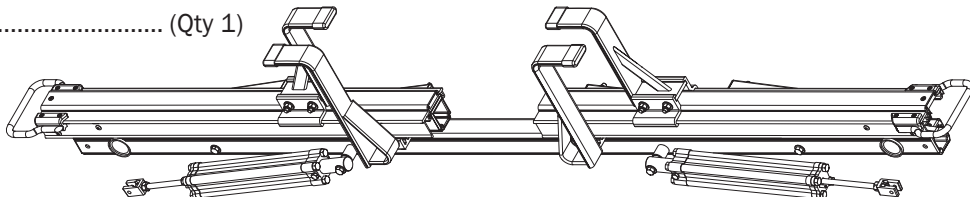

3—Front Crossbar Assembly (Qty 1)

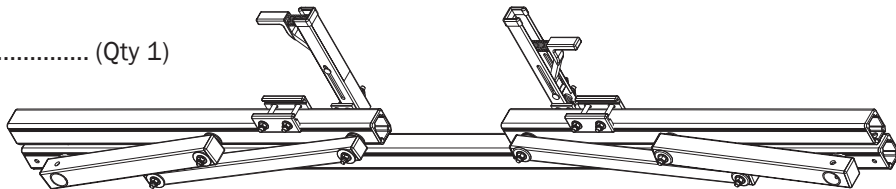

4—Drive Shaft (Qty 1)
Rear, Right Hand, 50.00"

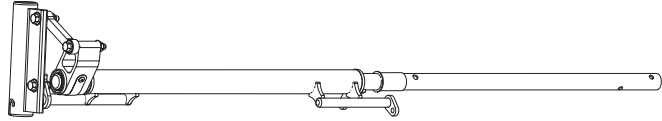

5—Connecting Bar (Qty 2)
48.00"



6—Front Drive Shaft (Qty 2)
B Version, 35.75"

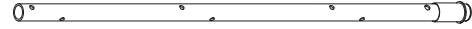

7—Z Post (Qty 2)
Adjustable, 7.25"

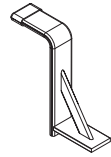

8—L Post (Qty 2)
Gen2, Roller Cap, 9.25"

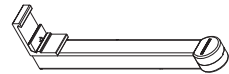

9—Drive Shaft (Qty 1)
Rear, Left Hand, 50.00"

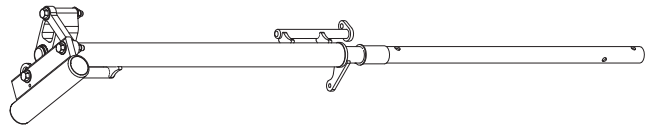

10—HRR Removeable Handle Assembly (Qty 1)

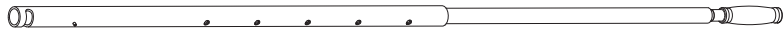

11—HKT-8163 (Not called out in Overview) (Qty 2)

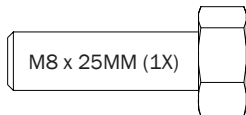

M8 x 25MM (1X)

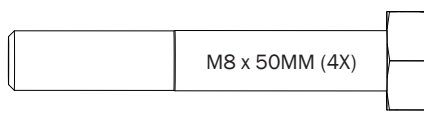

M8 x 50MM (4X)

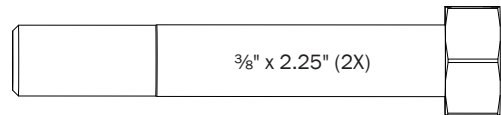

3/8" x 2.25" (2X)

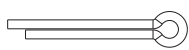

Cotter Pin (1X)

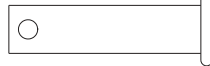

Clevis Pin (1X)

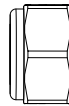

M8 Lock Nut (5X)

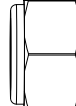

3/8" Lock Nut (2X)

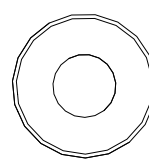

5/16" Flat Washer (10X)

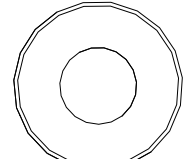

3/8" Flat Washer (4X)

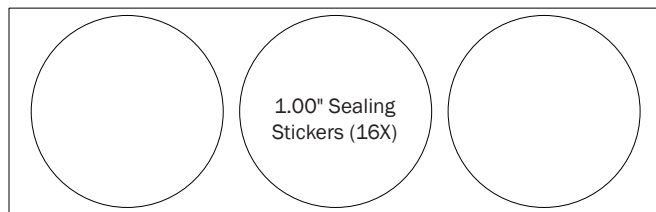

1.00" Sealing
Stickers (16X)



Anti-Seize (2X)



Lubricant (2X)

FBM-0013 MOUNTING BRACKETS

INSTALLER NOTE: Mounting Brackets must be disassembled for installation onto the vehicle's roof.

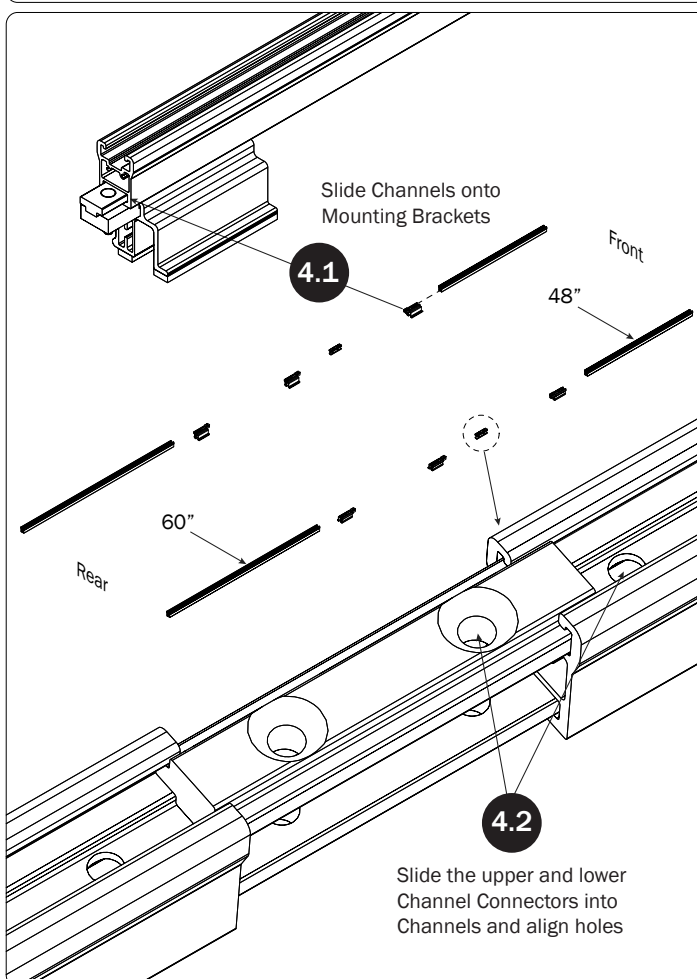
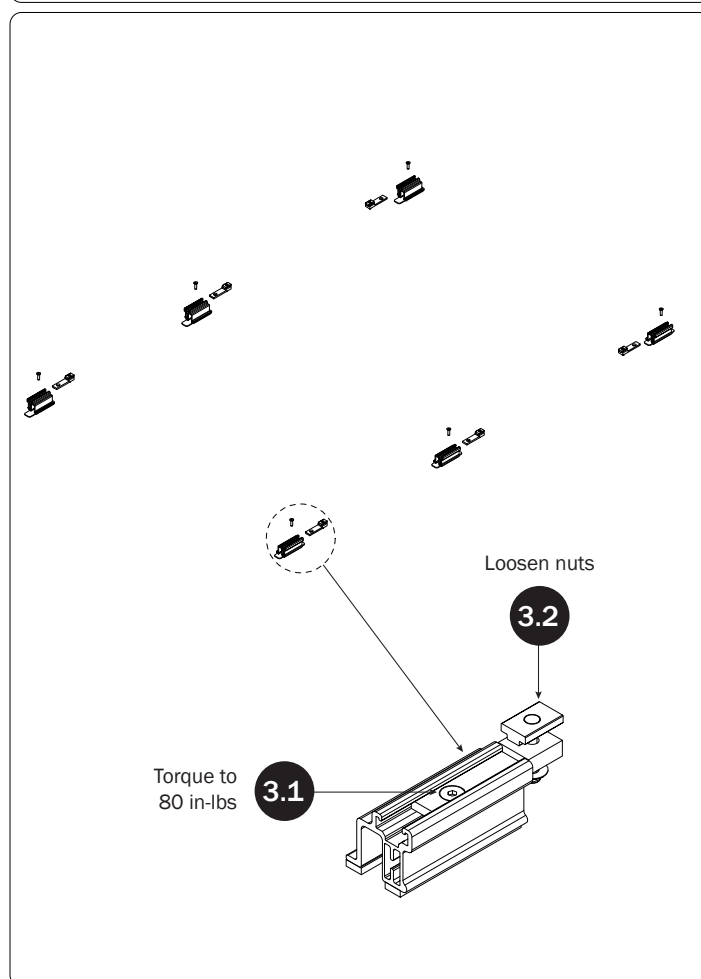
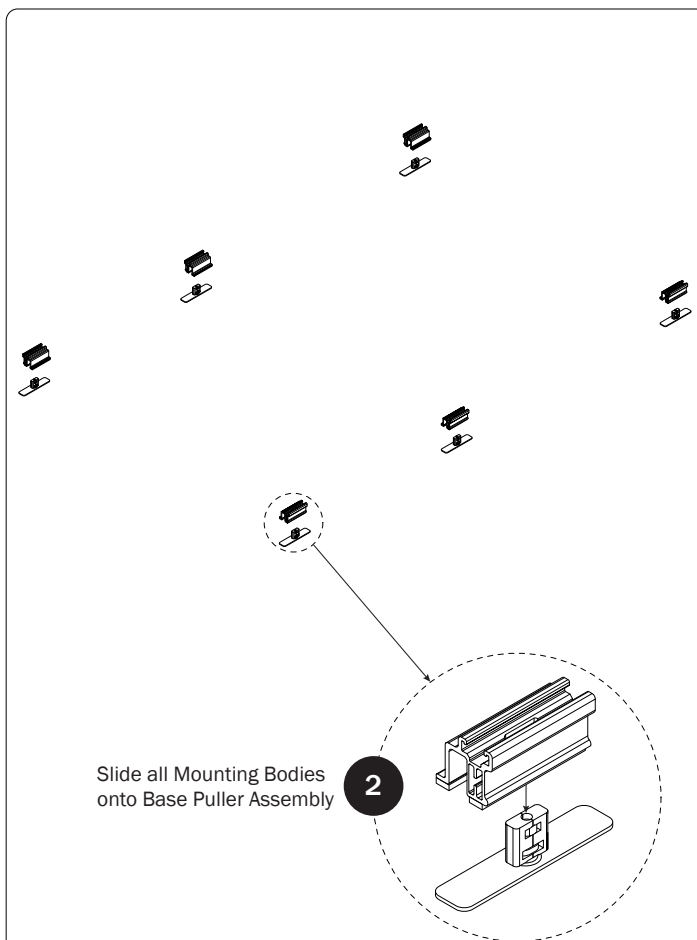
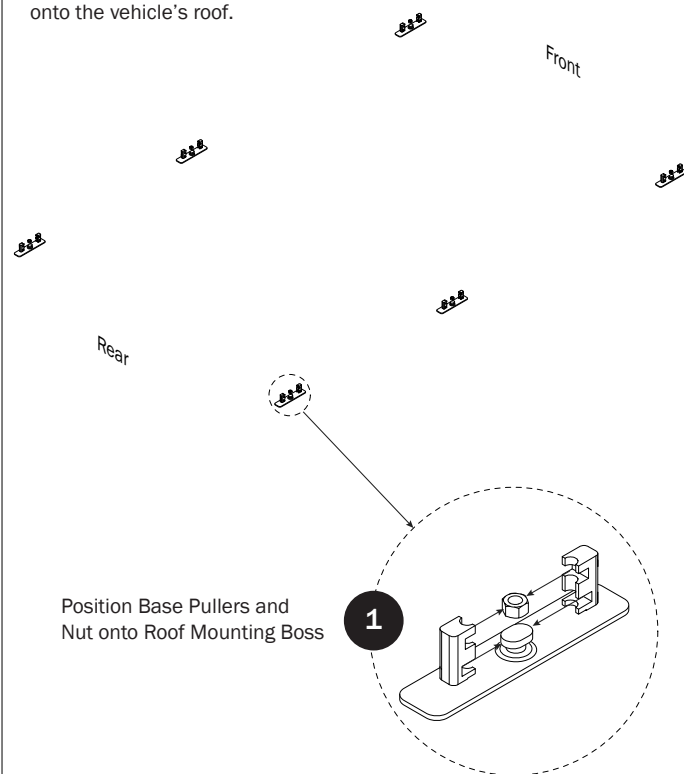

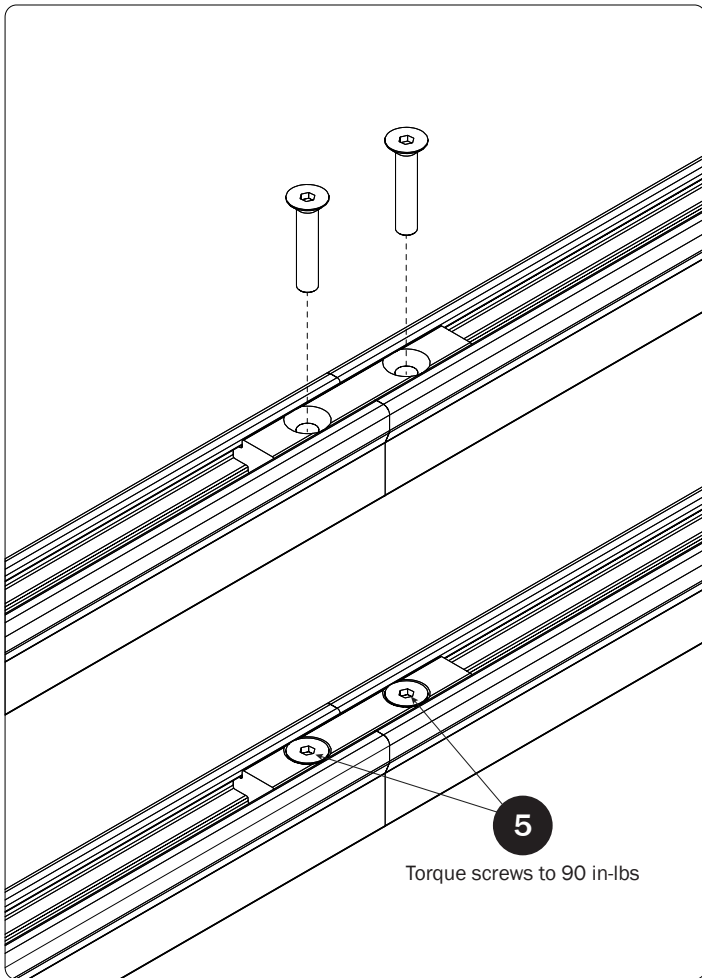

6 Set to distances then torque Mounting Bracket nuts to 80 in-lbs

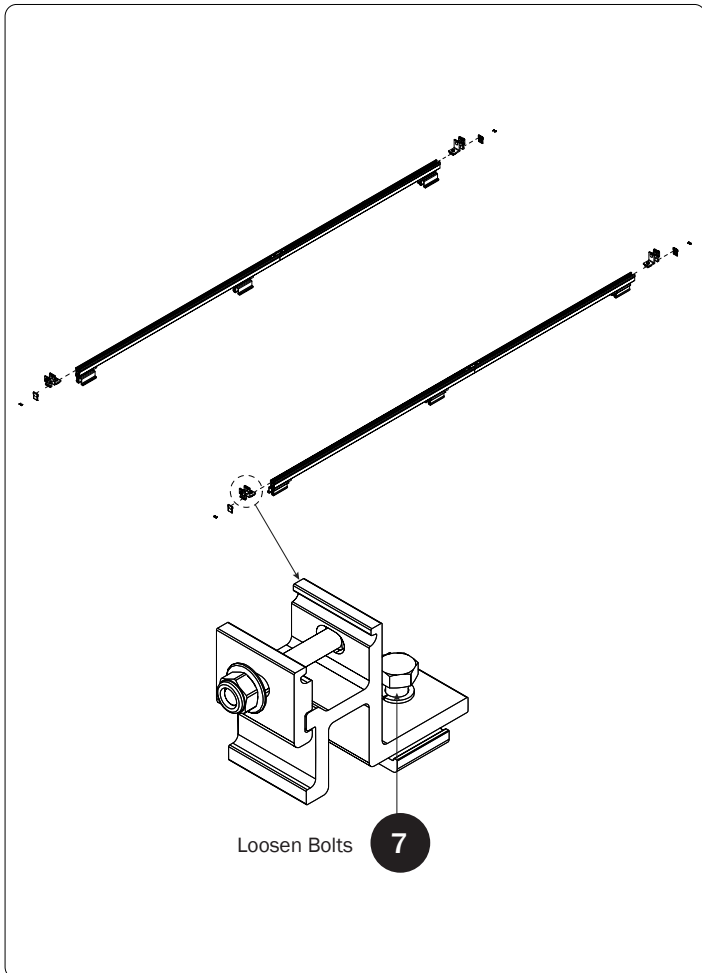
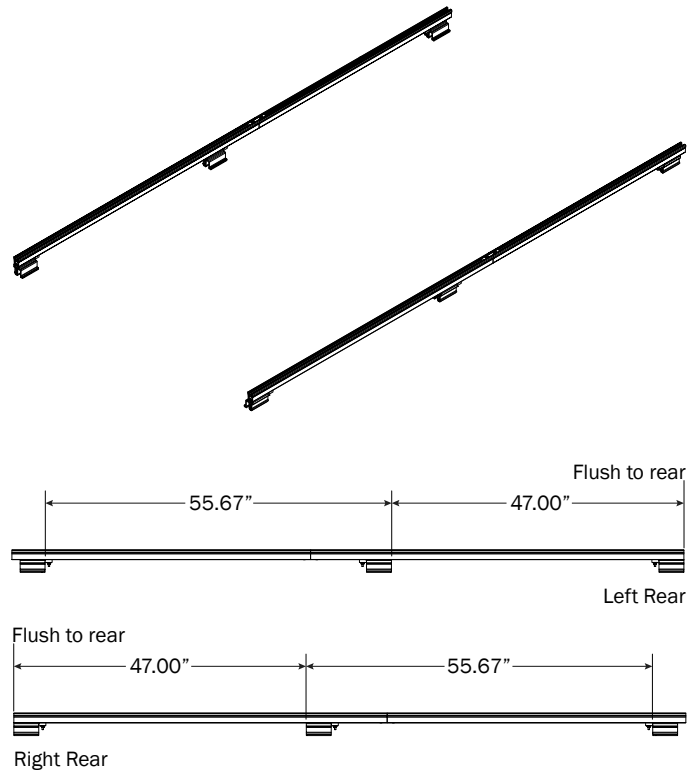

8 Set to distances shown, but do not tighten at this time

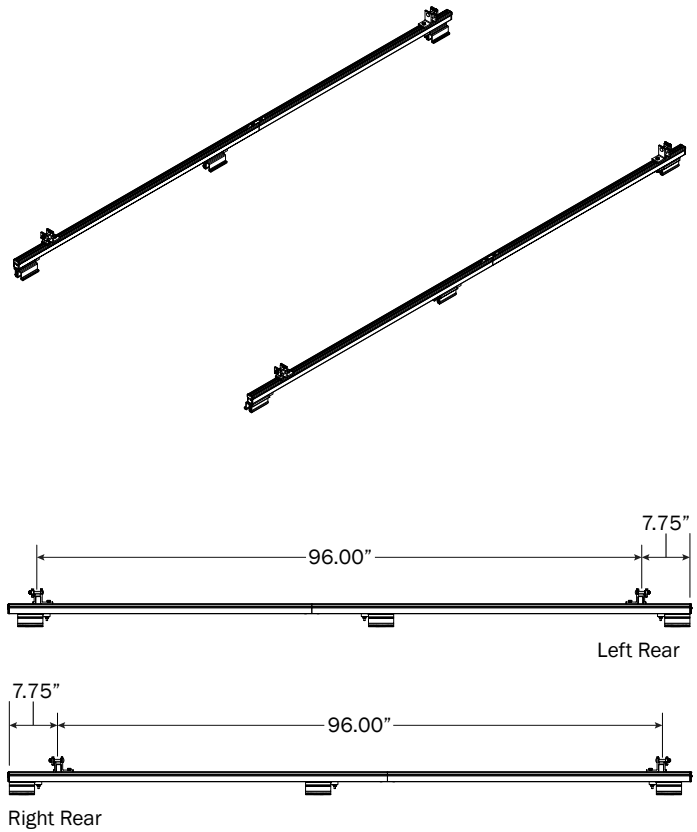

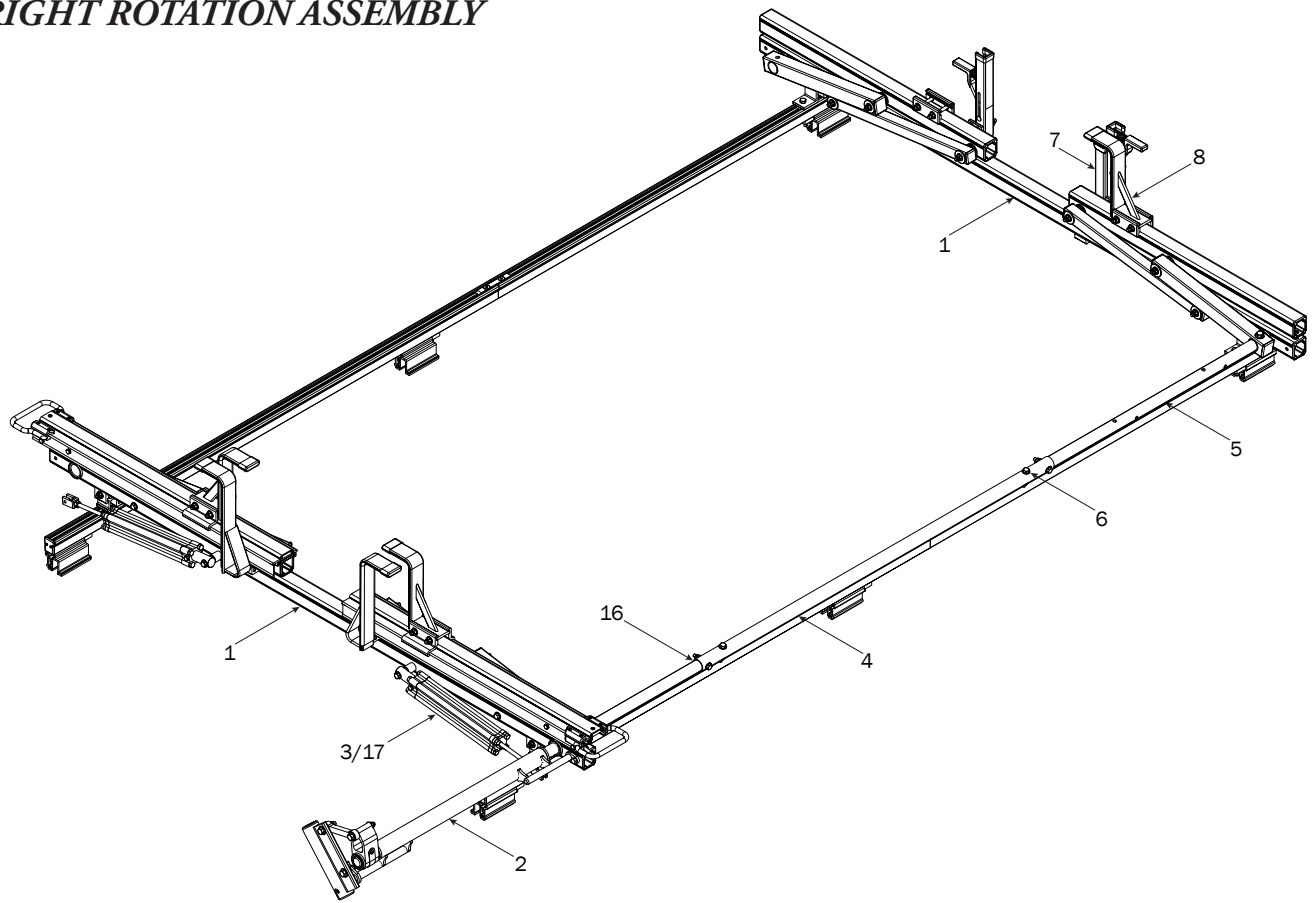
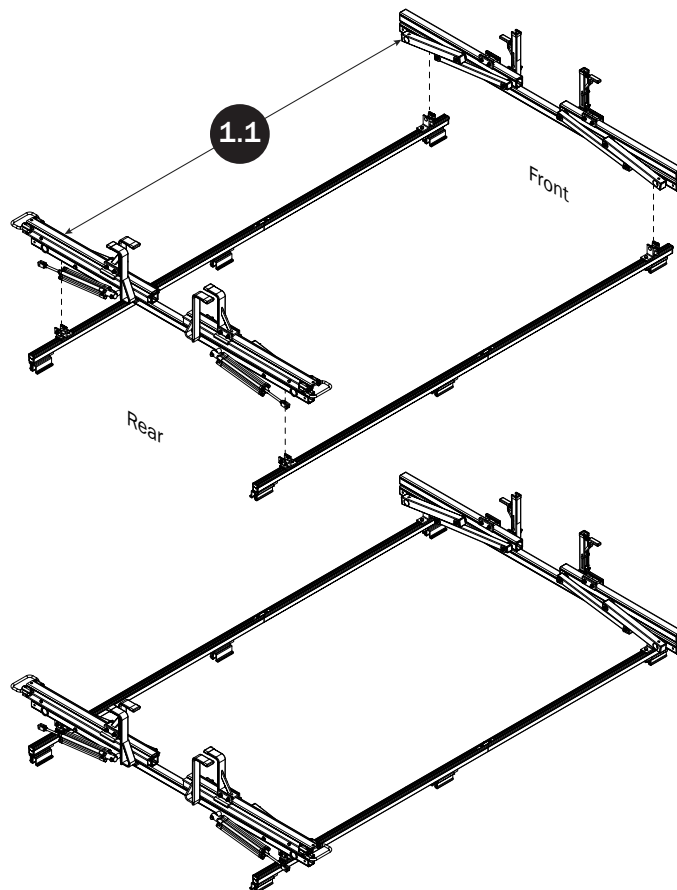
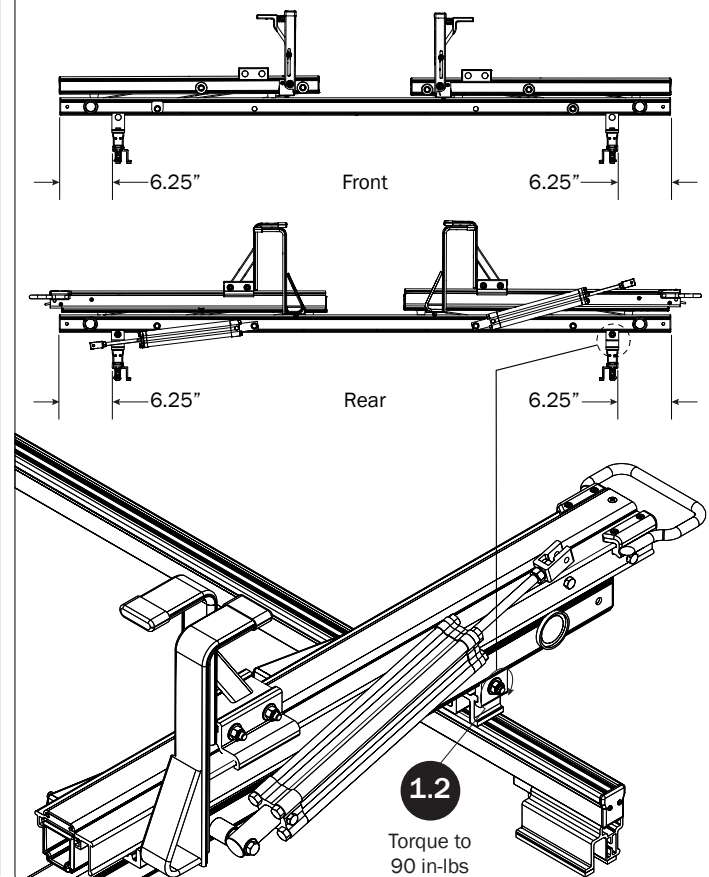
RIGHT ROTATION ASSEMBLY**CROSSBARS****CROSSBAR ADJUSTMENT**

REAR DRIVE SHAFT

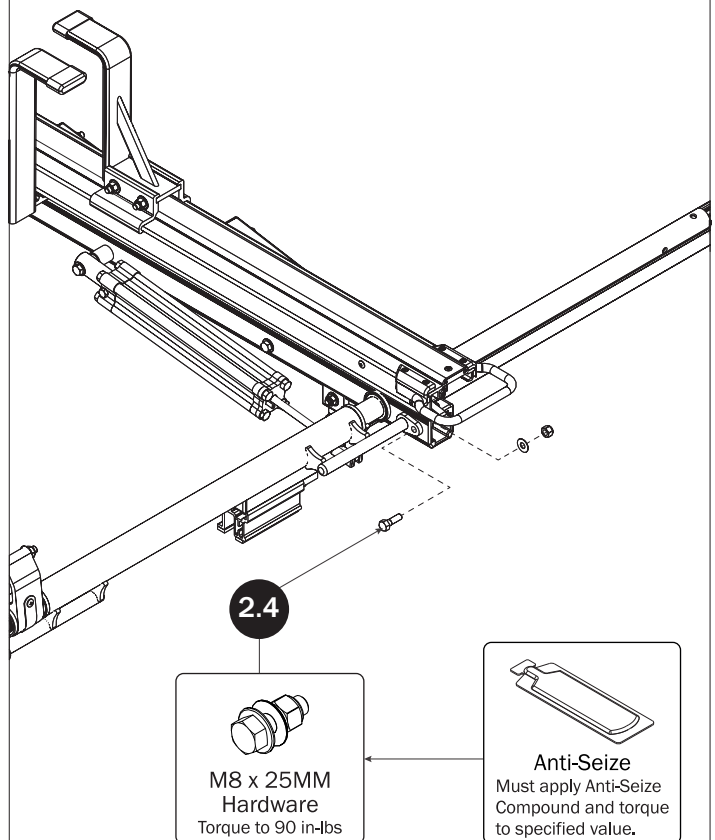
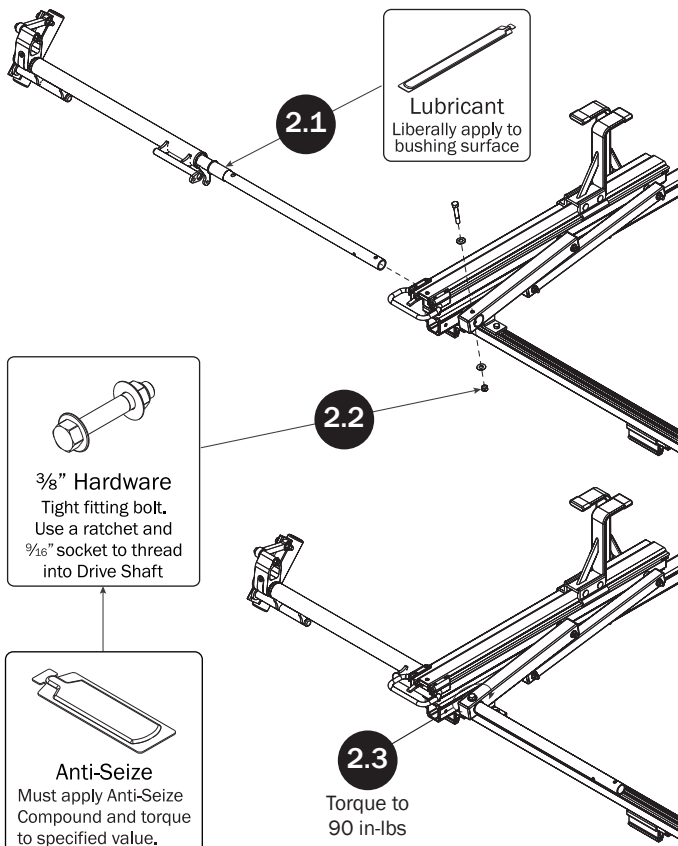

CYLINDER HARDWARE

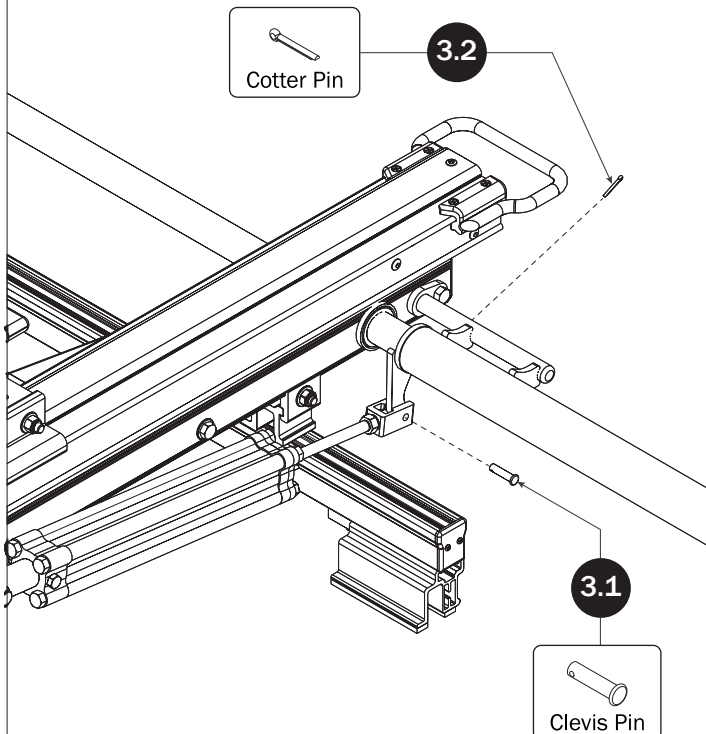

CONNECTING BAR

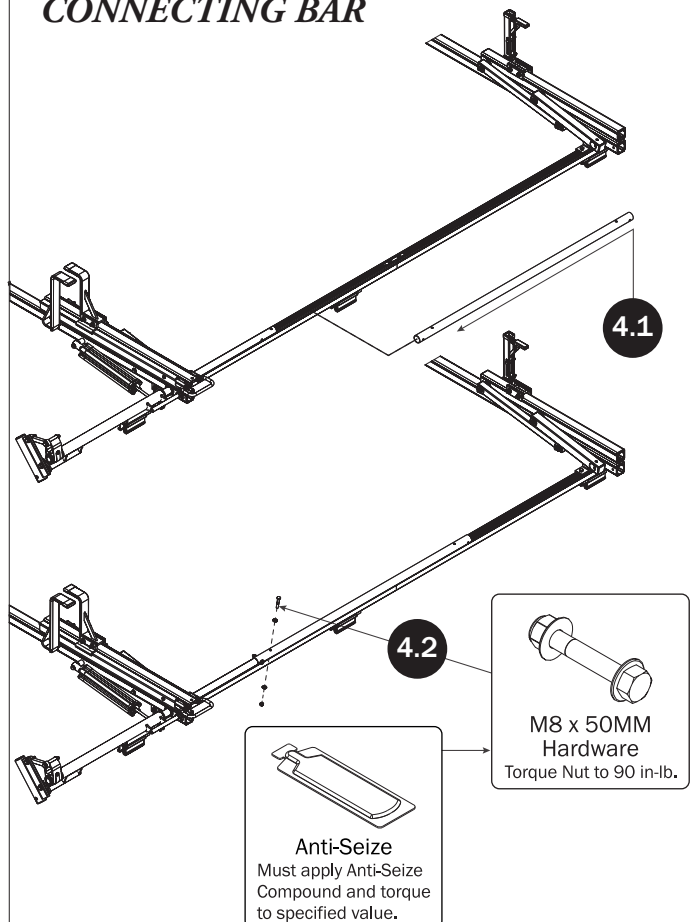

FRONT DRIVE SHAFT

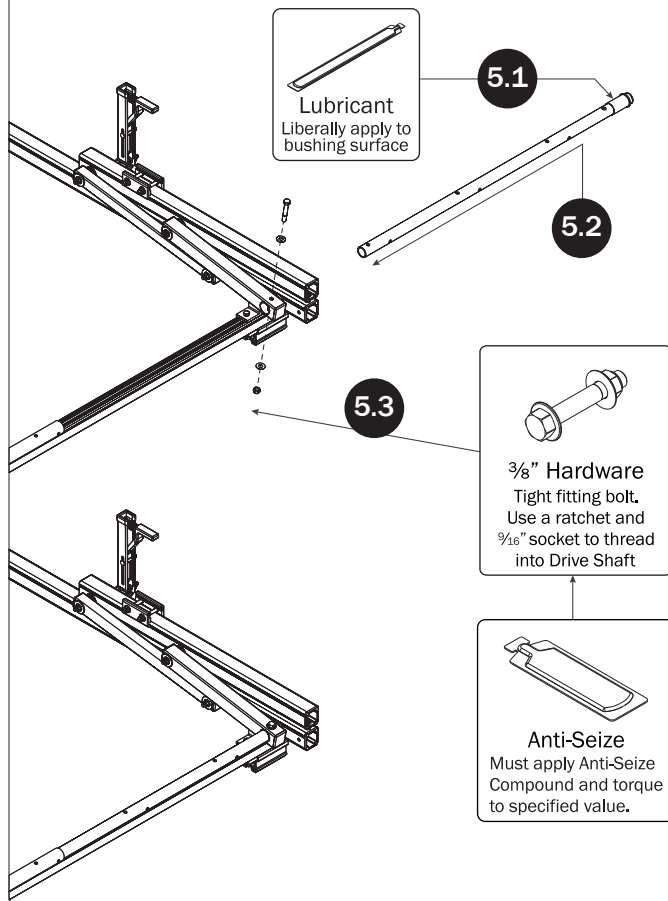

CONNECTING BAR FASTENERS

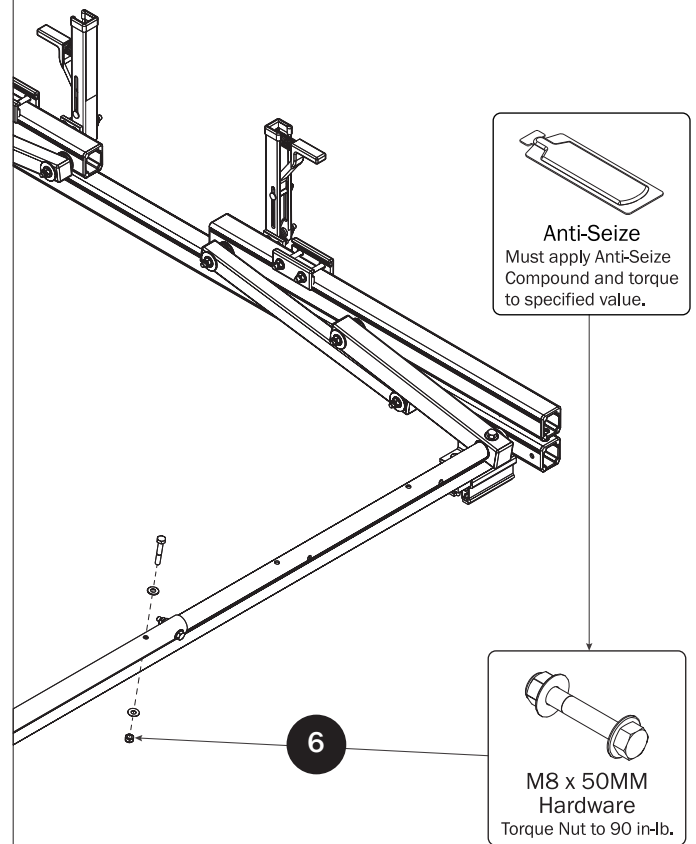

L POST

SEE QUICK START GUIDE FOR ADJUSTMENTS

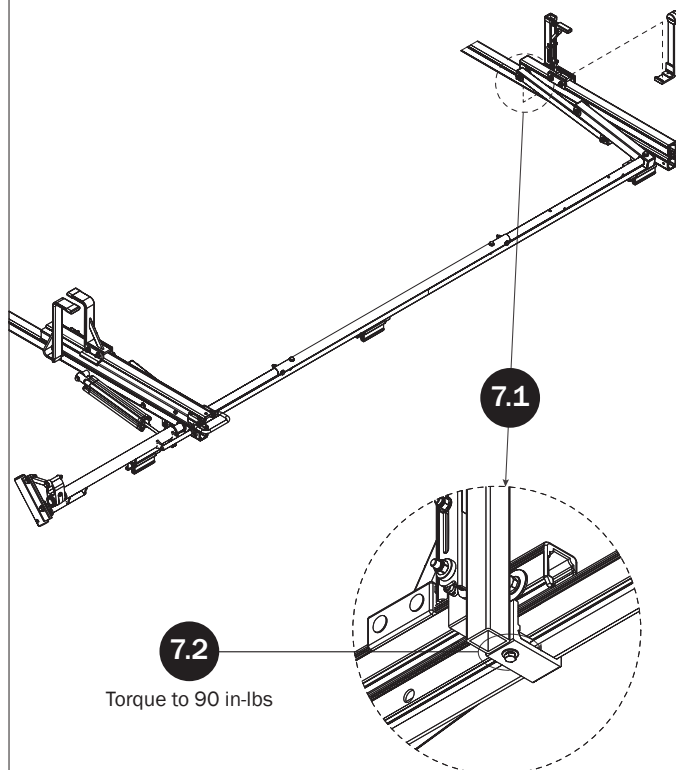

Z POST

SEE QUICK START GUIDE FOR ADJUSTMENTS

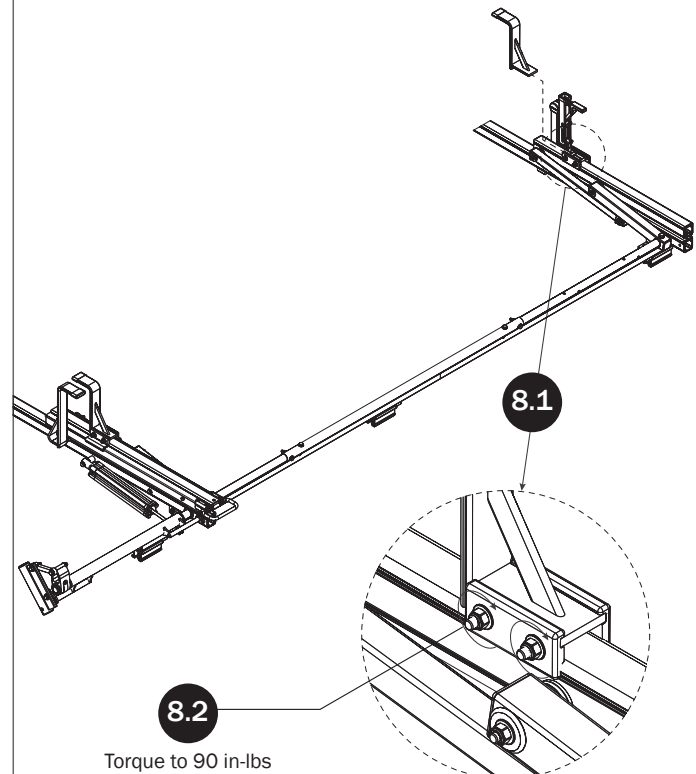

LEFT ROTATION ASSEMBLY

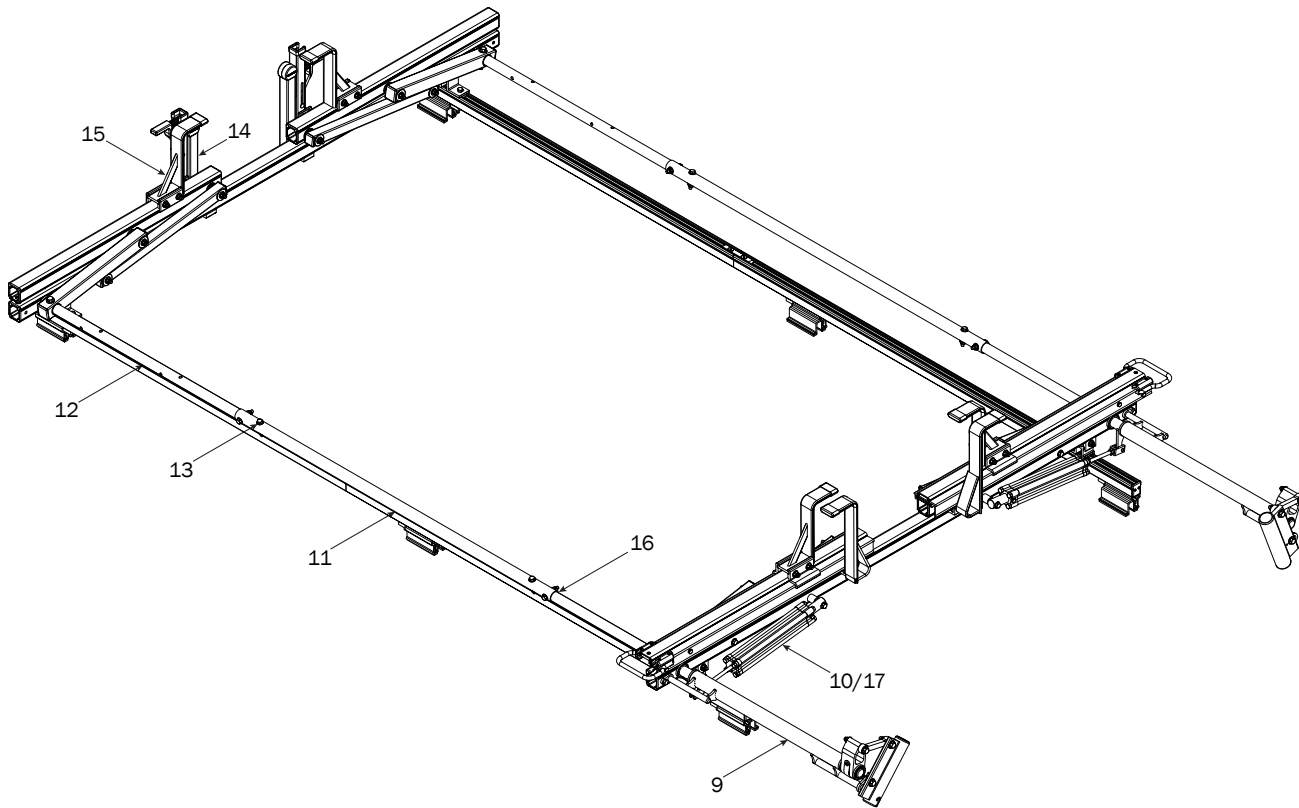

REAR DRIVE SHAFT

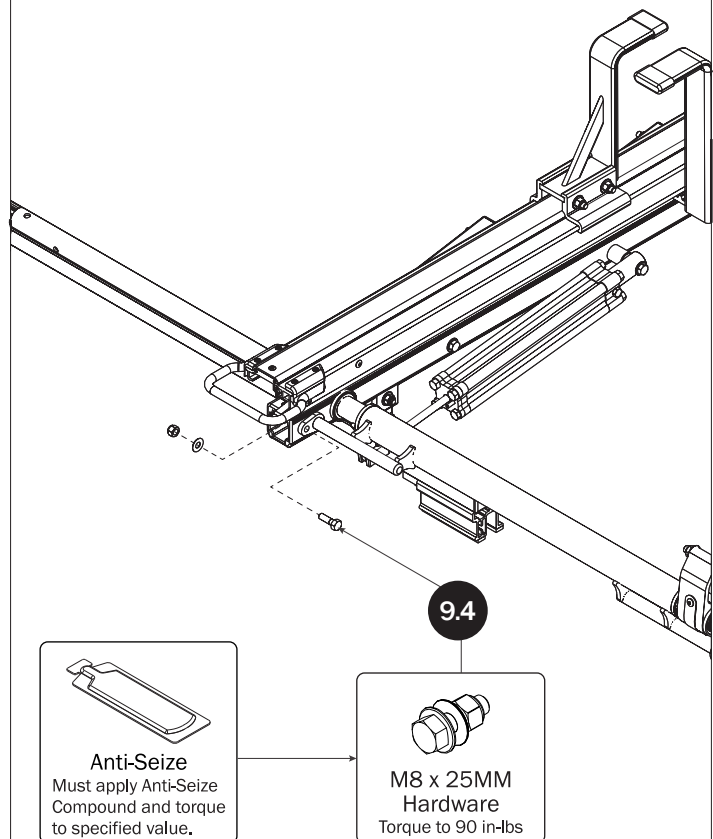
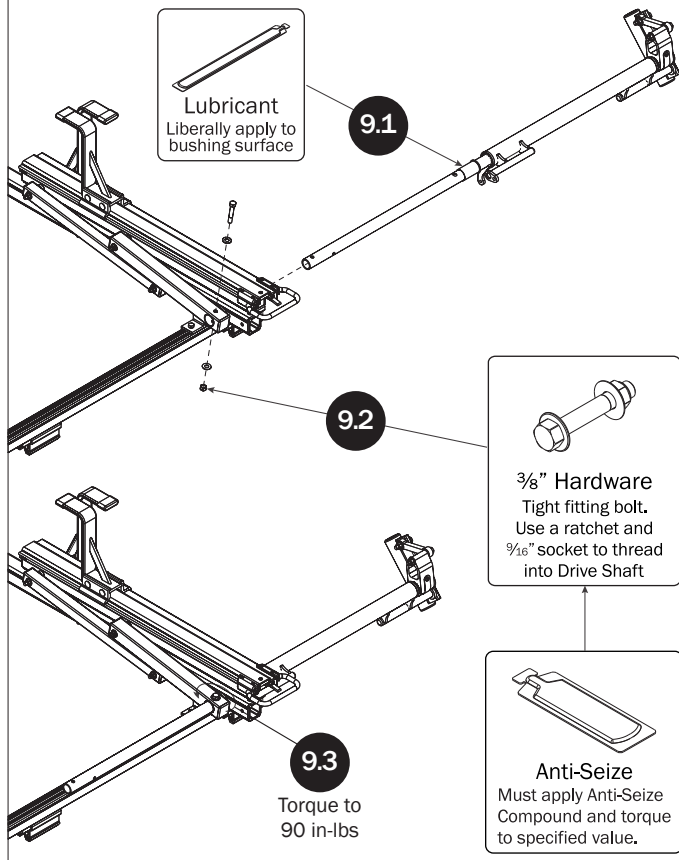

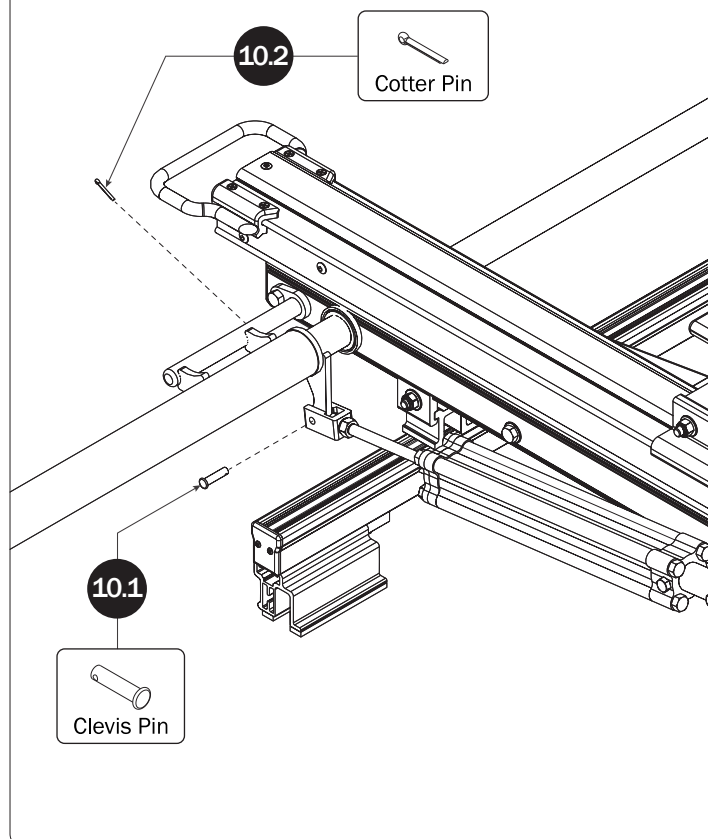
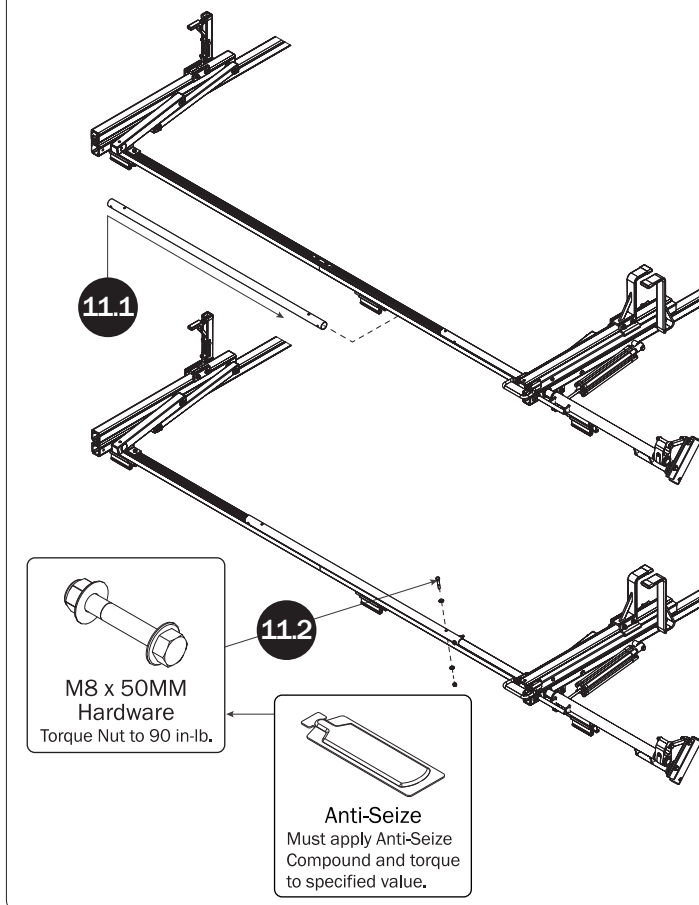
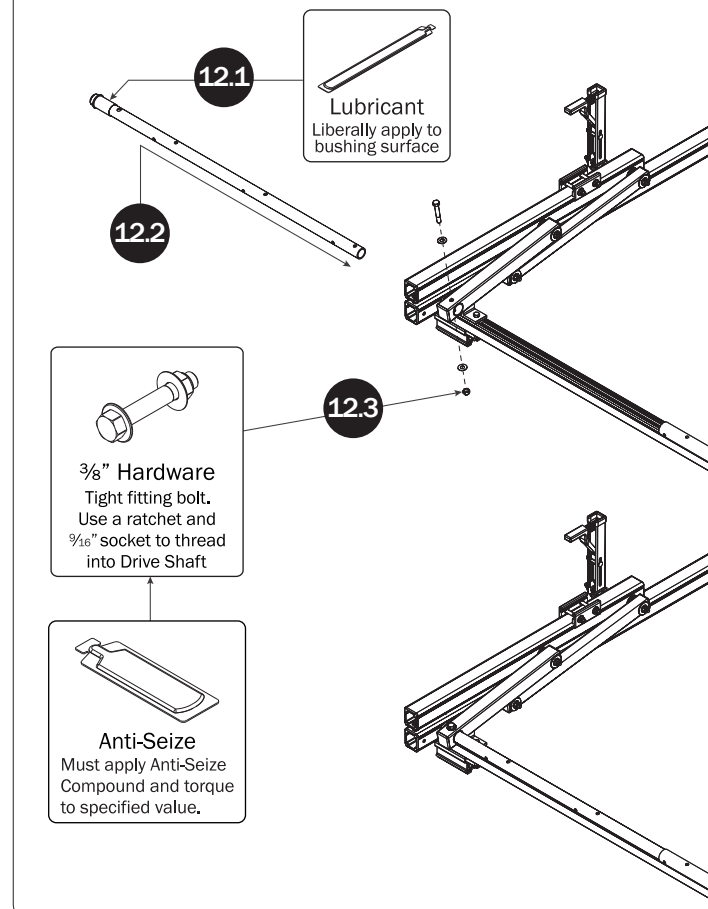
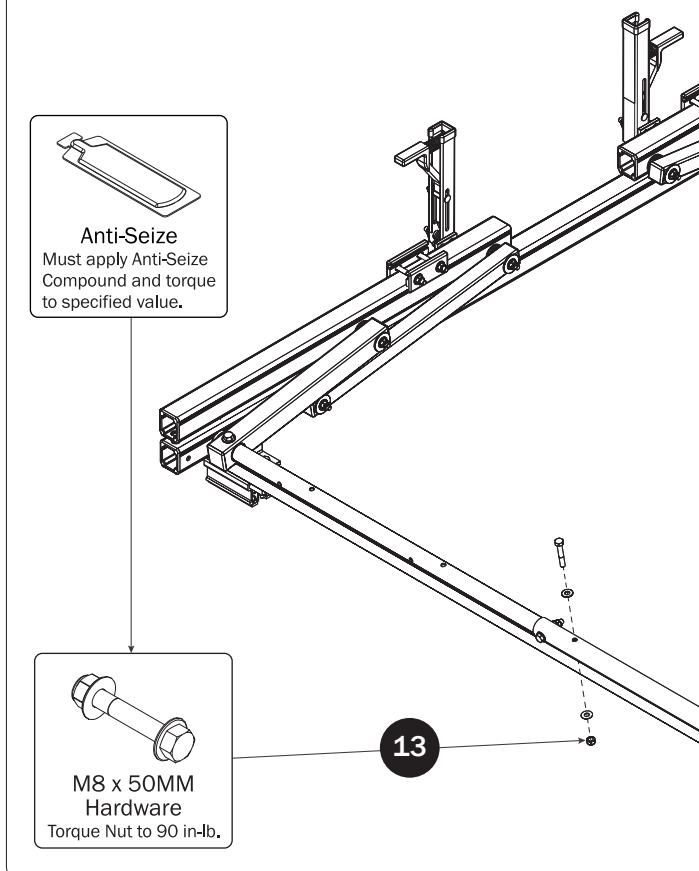
CYLINDER HARDWARE**CONNECTING BAR****FRONT DRIVE SHAFT****CONNECTING BAR FASTENERS**

L POSTS

SEE QUICK START GUIDE FOR ADJUSTMENTS

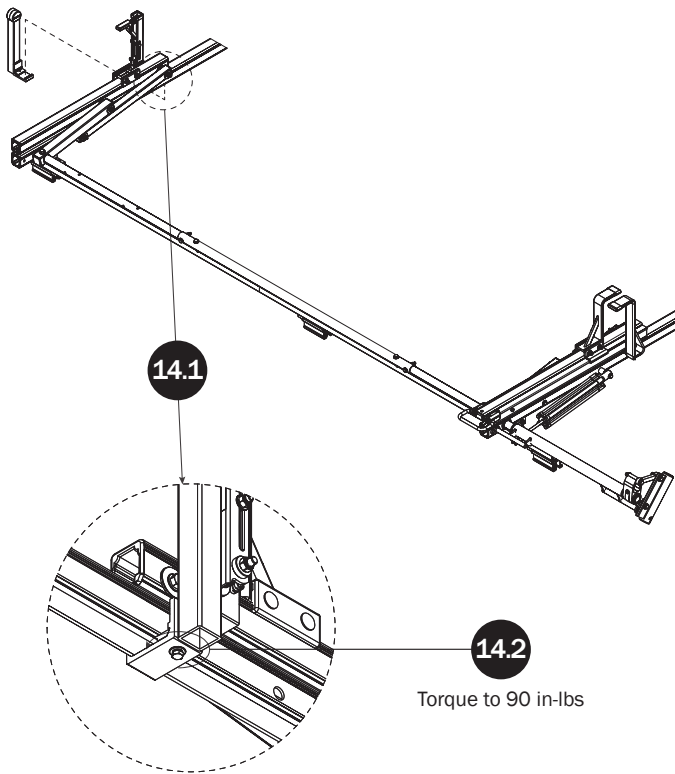
**Z POSTS**

SEE QUICK START GUIDE FOR ADJUSTMENTS

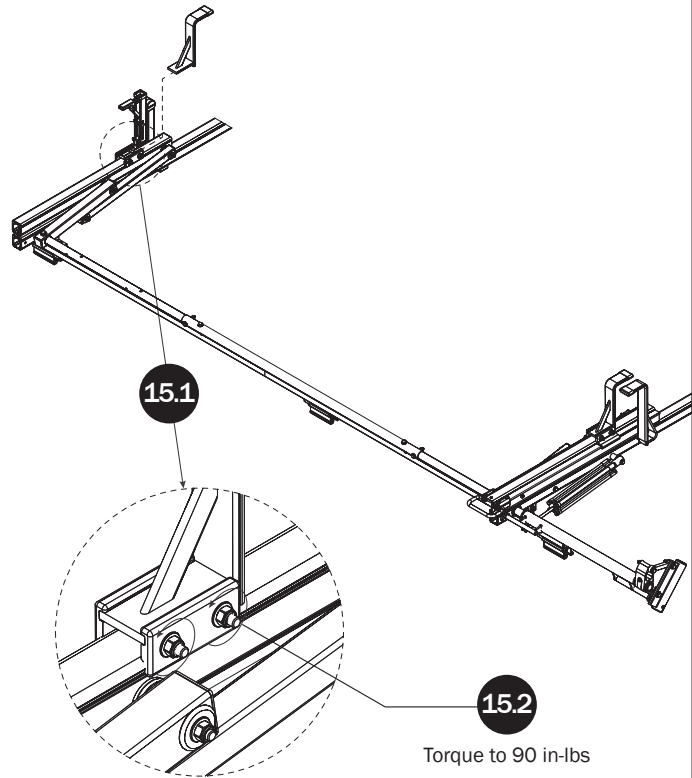
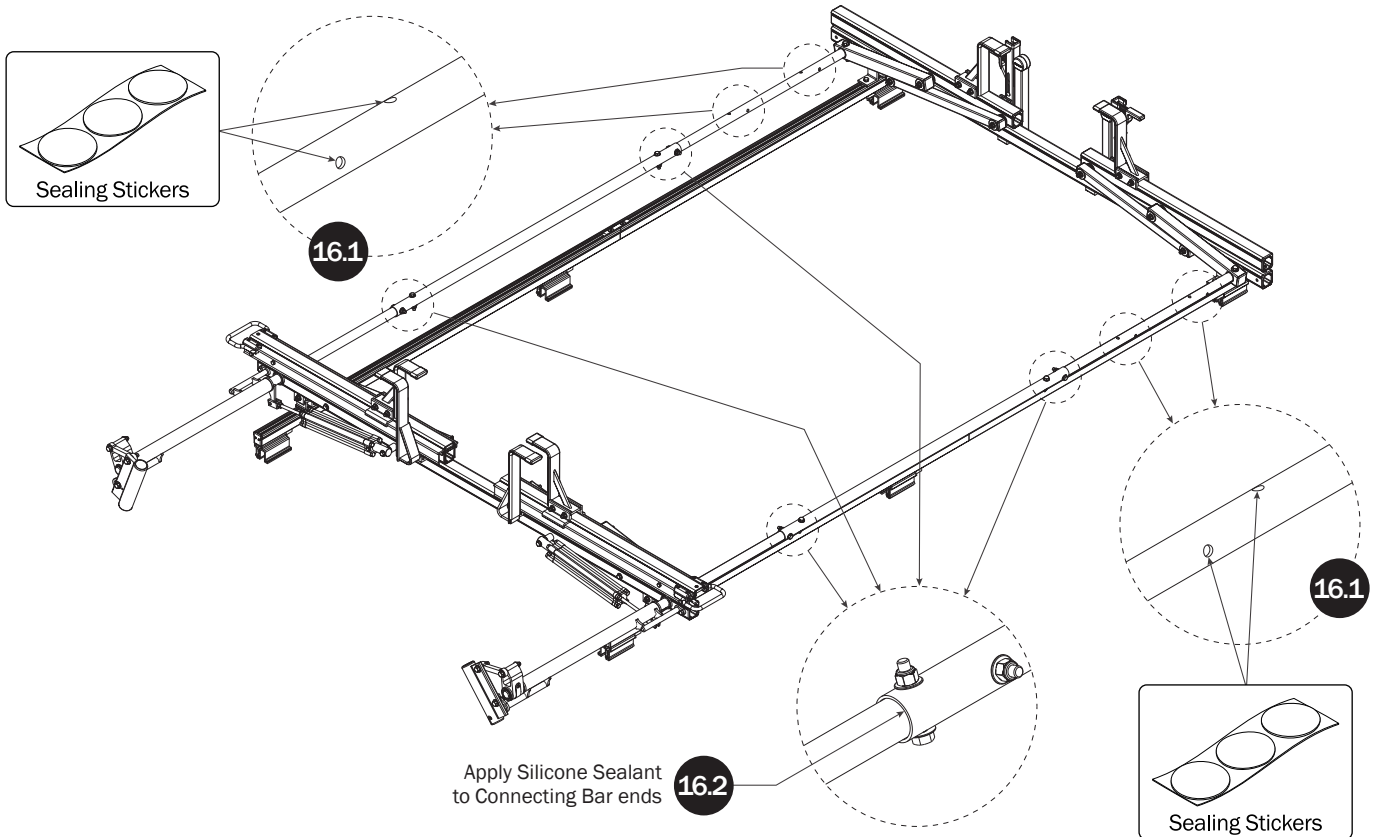
**DRIVE SHAFT SEALING**

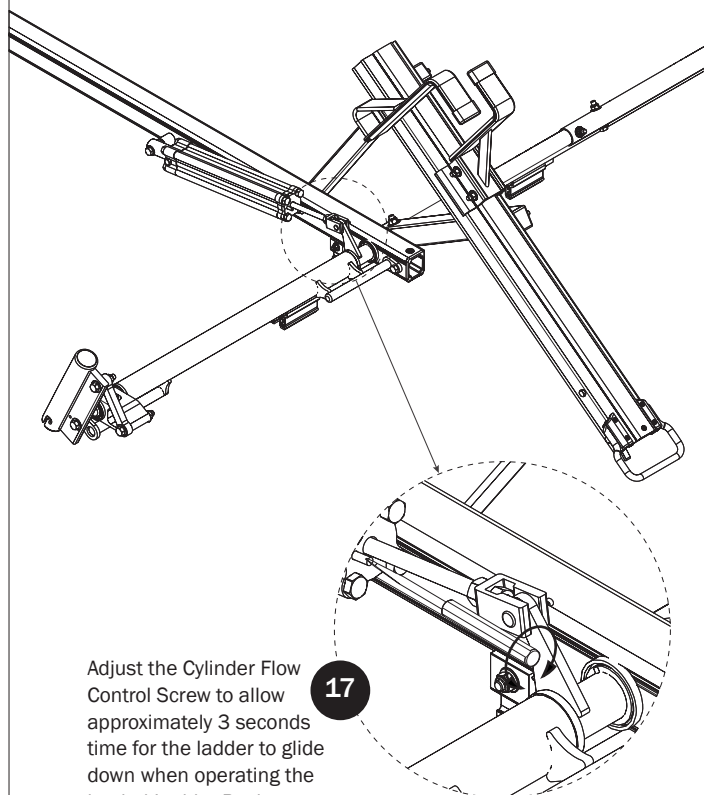
CYLINDER ADJUSTMENT

USAM-HRREPM22-US01 Rev-B 0218