

PRIME DESIGN™

A Safe Fleet Brand

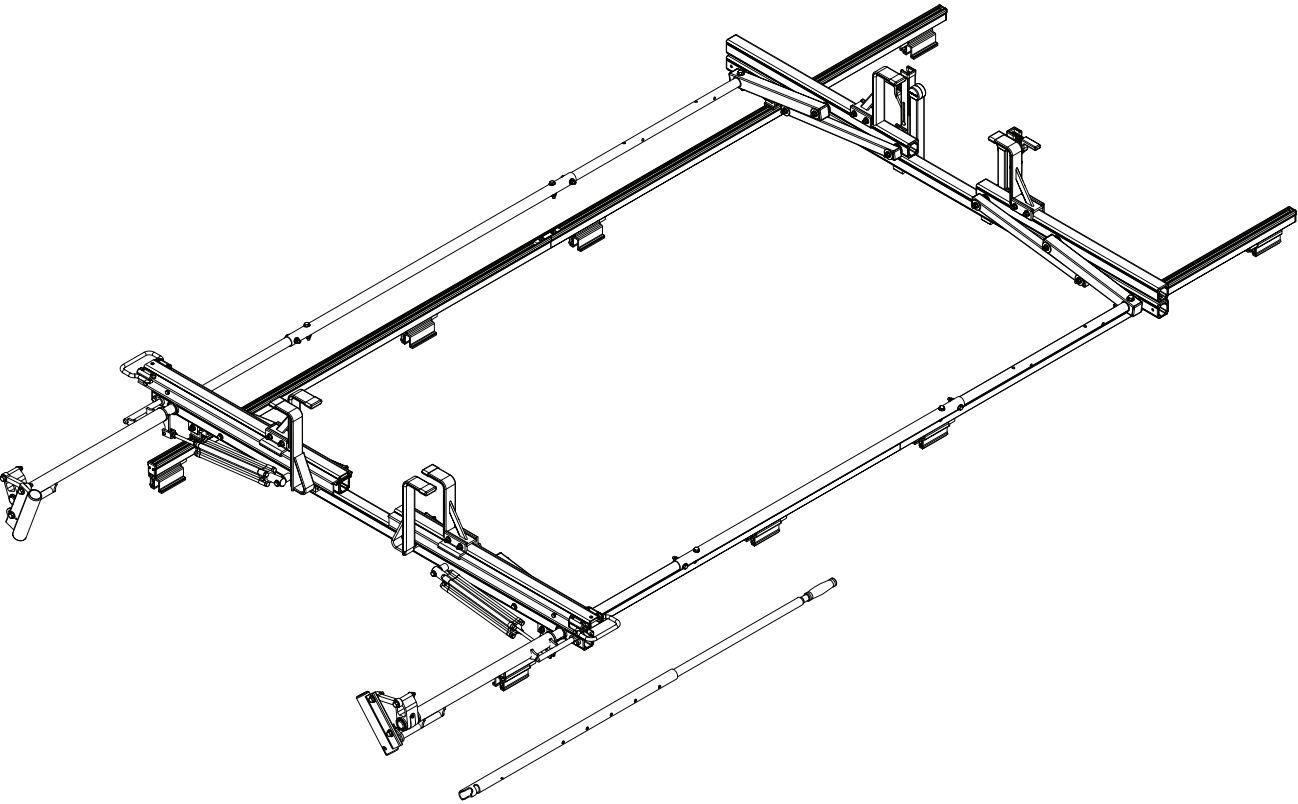

STANLEY
HRR-E

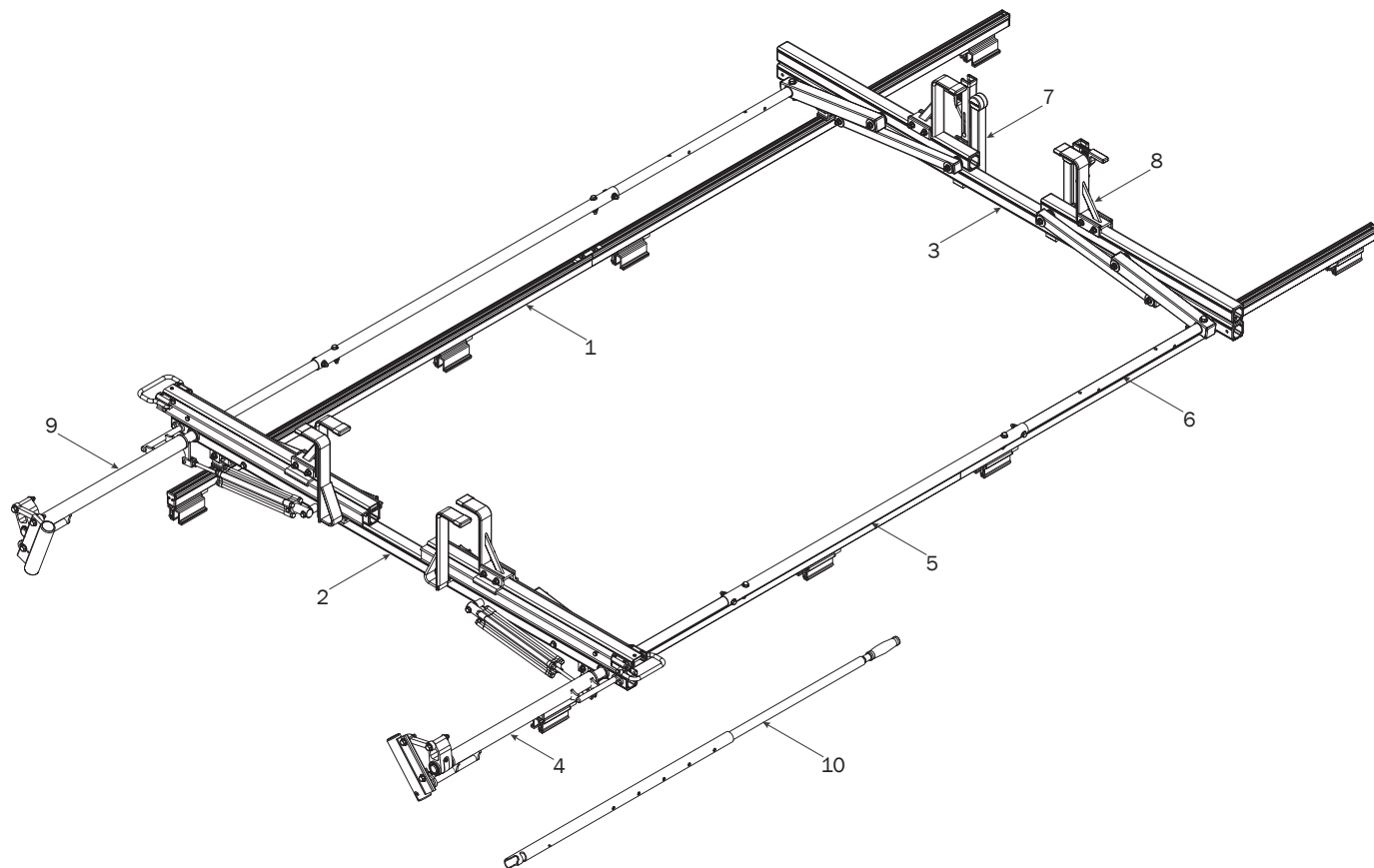

- 1—FBM-0014 (Qty 1)
Channels with hardware



66" Channels (4X)



End Caps (4X)



Screws (8X)



Top Connector (2X)



Bottom Connector (2X)



Brackets (4X)

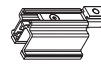

Mountings (8X)

M8 Bolt (4X)

- 2—Rear Crossbar Assembly (Qty 1)

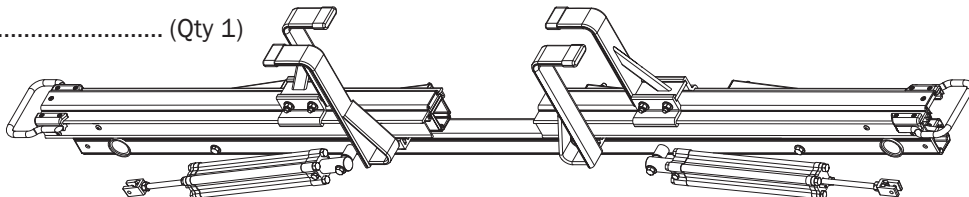

- 3—Front Crossbar Assembly (Qty 1)

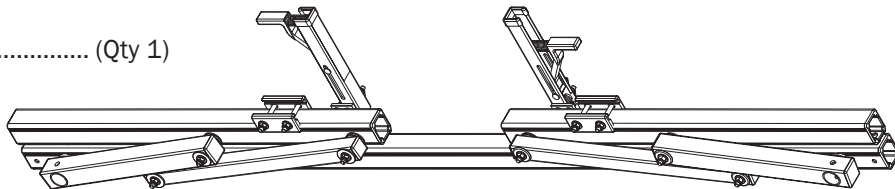

4—Drive Shaft (Qty 1)
Rear, Right Hand, 50.00"

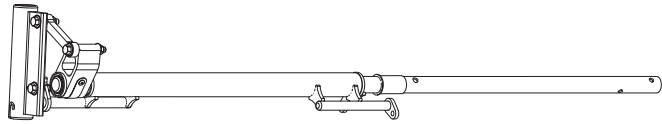

5—Connecting Bar (Qty 2)
48.00"

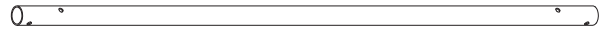

6—Front Drive Shaft (Qty 2)
B Version, 35.75"

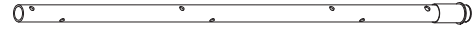

7—Z Post (Qty 2)
Adjustable, 7.25"

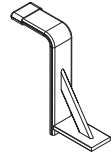

8—L Post (Qty 2)
Gen2, Roller Cap, 9.25"



9—Drive Shaft (Qty 1)
Rear, Left Handed, 50.00"

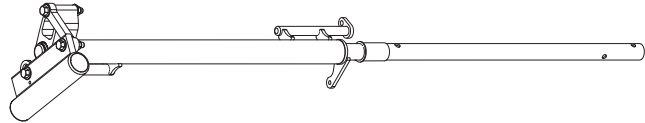

10—HRR Removeable Handle Assembly (Qty 1)

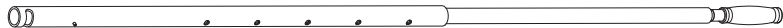

11—HKT-8163 (Not called out in Overview) (Qty 2)

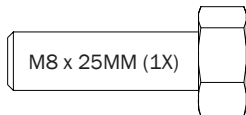

M8 x 25MM (1X)

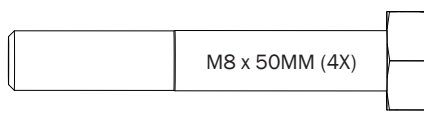

M8 x 50MM (4X)

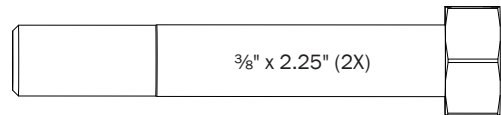

3/8" x 2.25" (2X)

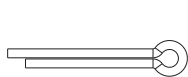

Cotter Pin (1X)



Clevis Pin (1X)

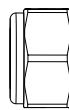

M8 Lock Nut (5X)

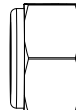

3/8" Lock Nut (2X)

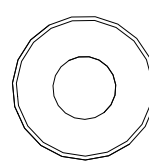

5/16" Flat Washer (10X)

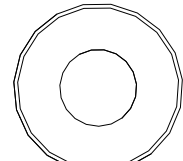

3/8" Flat Washer (4X)

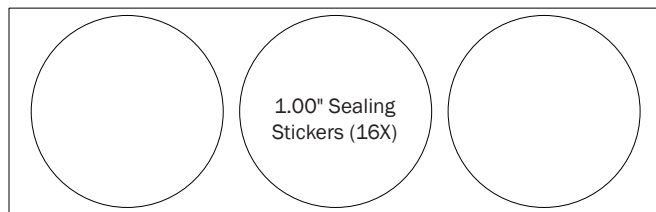

1.00" Sealing
Stickers (16X)



Anti-Seize (2X)

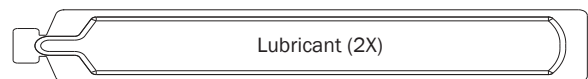

Lubricant (2X)

FBM-0014 MOUNTING BRACKETS

INSTALLER NOTE: Mounting Brackets must be disassembled for installation onto the vehicle's roof.

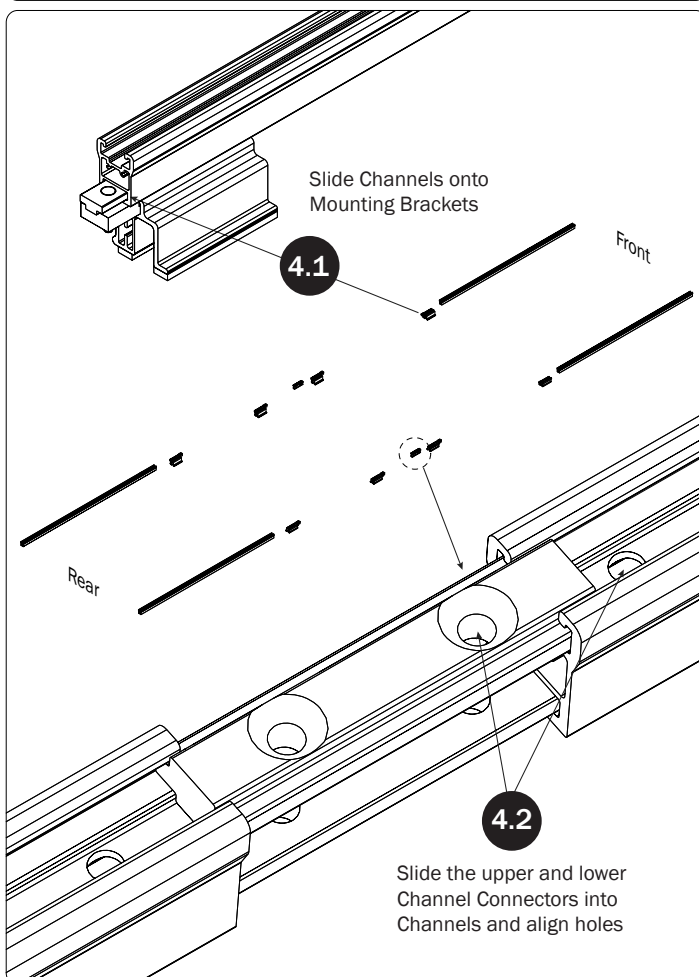
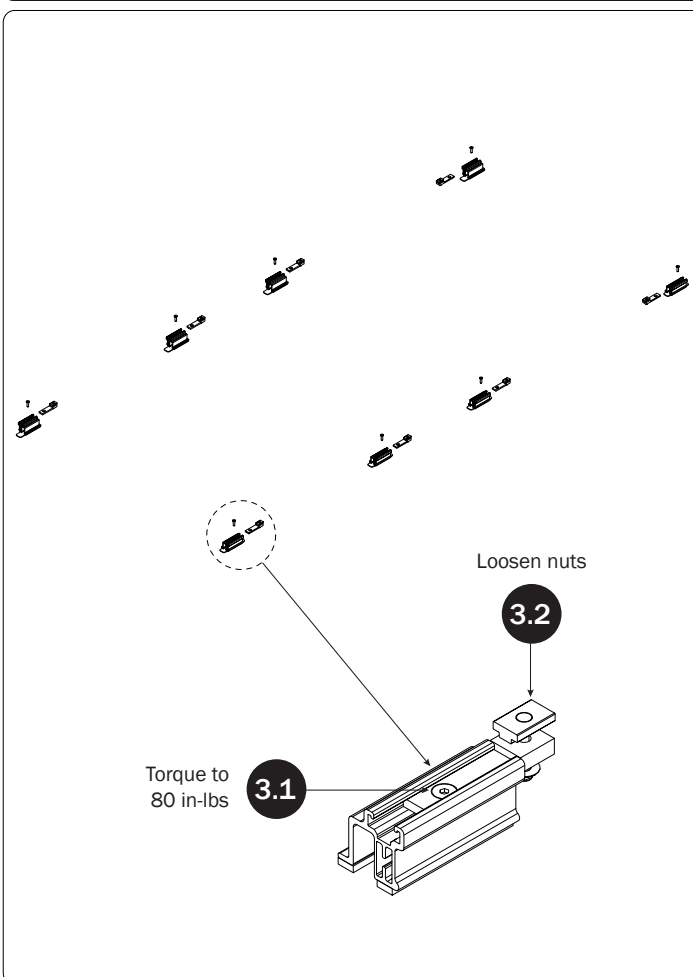
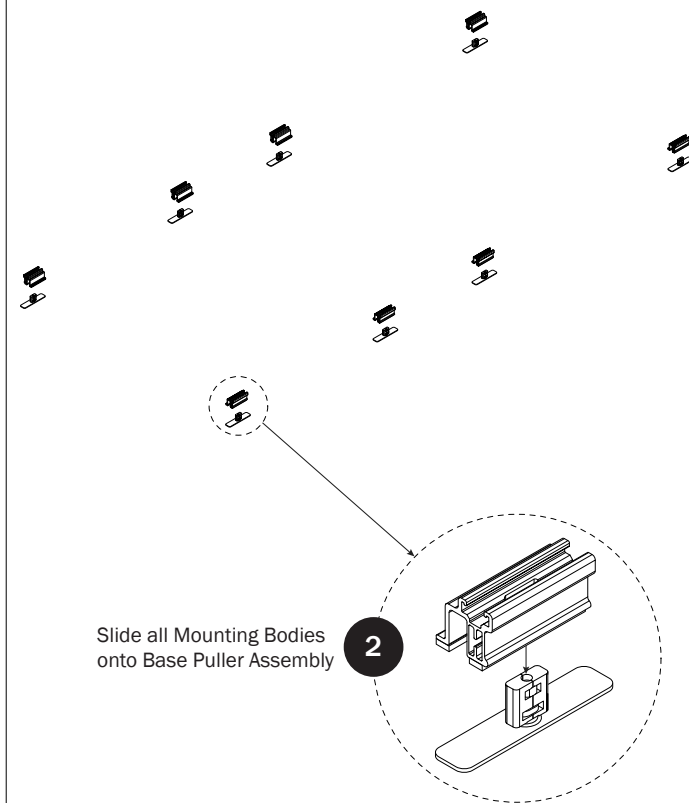
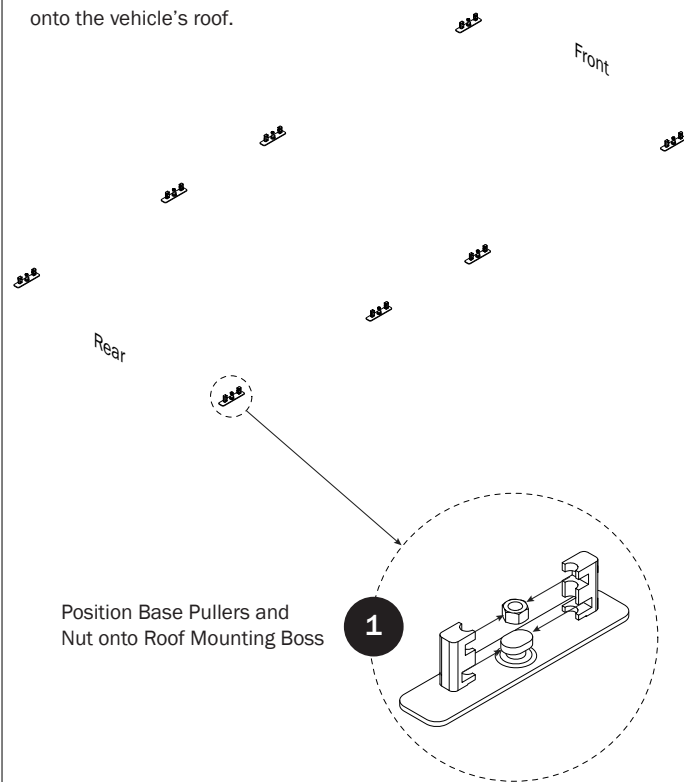

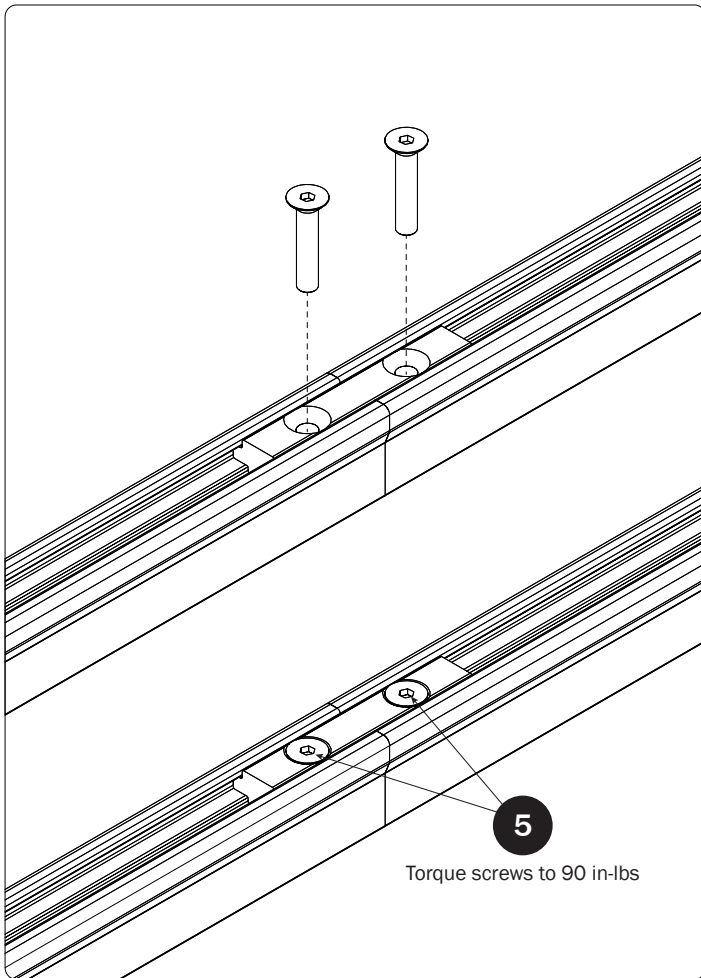

6 Set to distances then torque Mounting Bracket nuts to 80 in-lbs

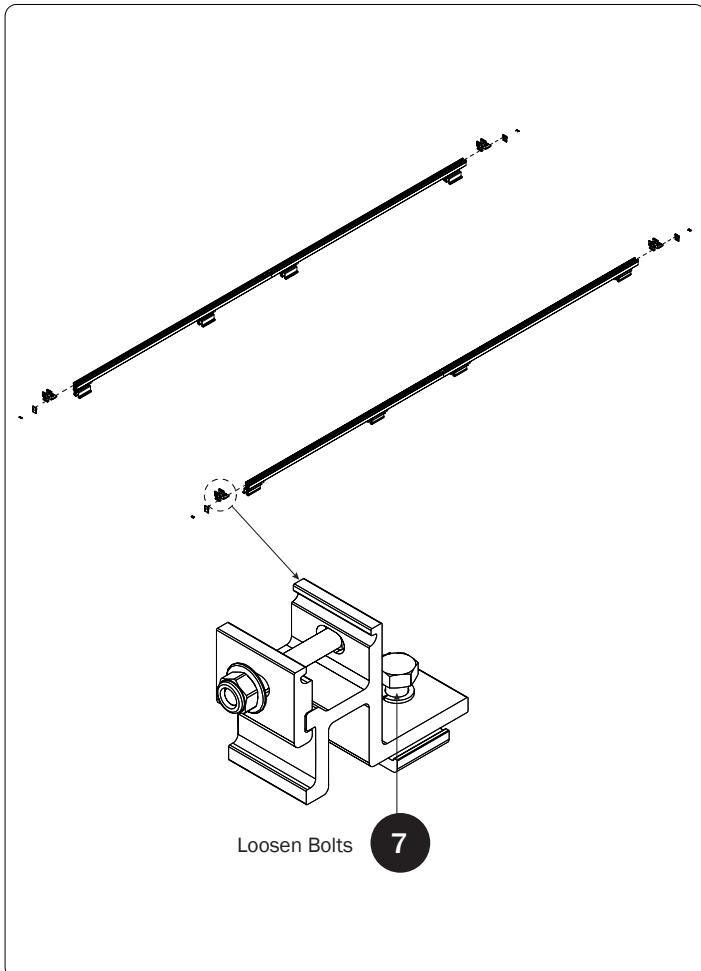
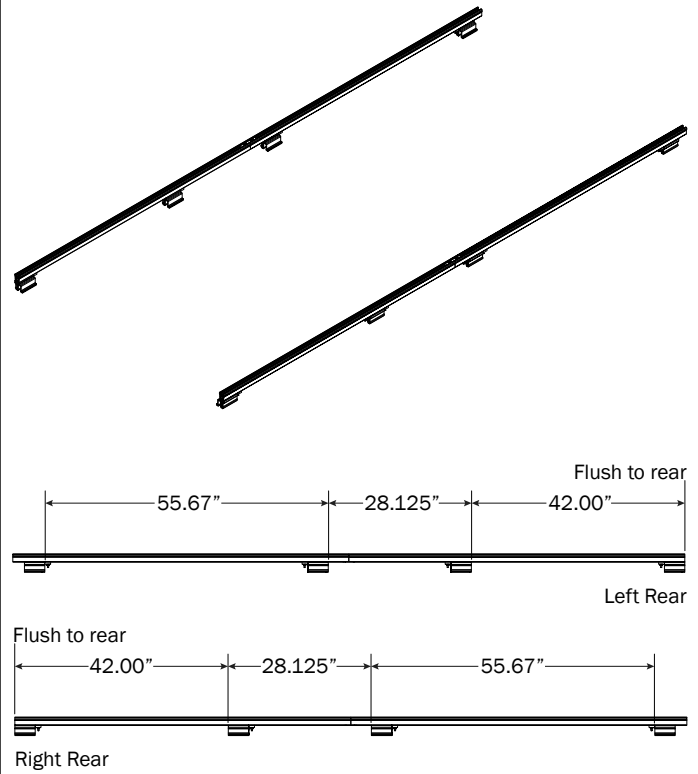

8 Set to distances then torque Mounting Bracket nuts to 90 in-lbs

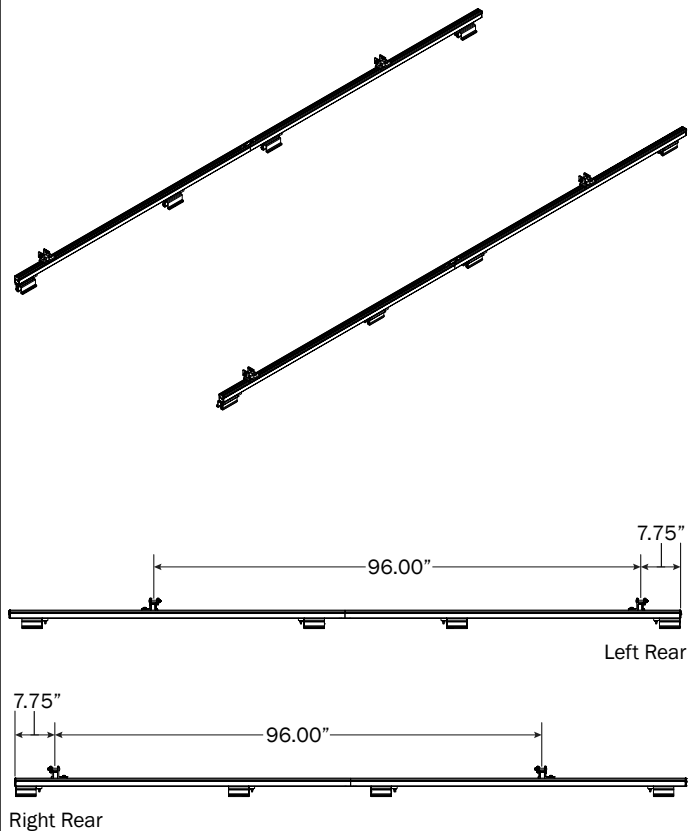

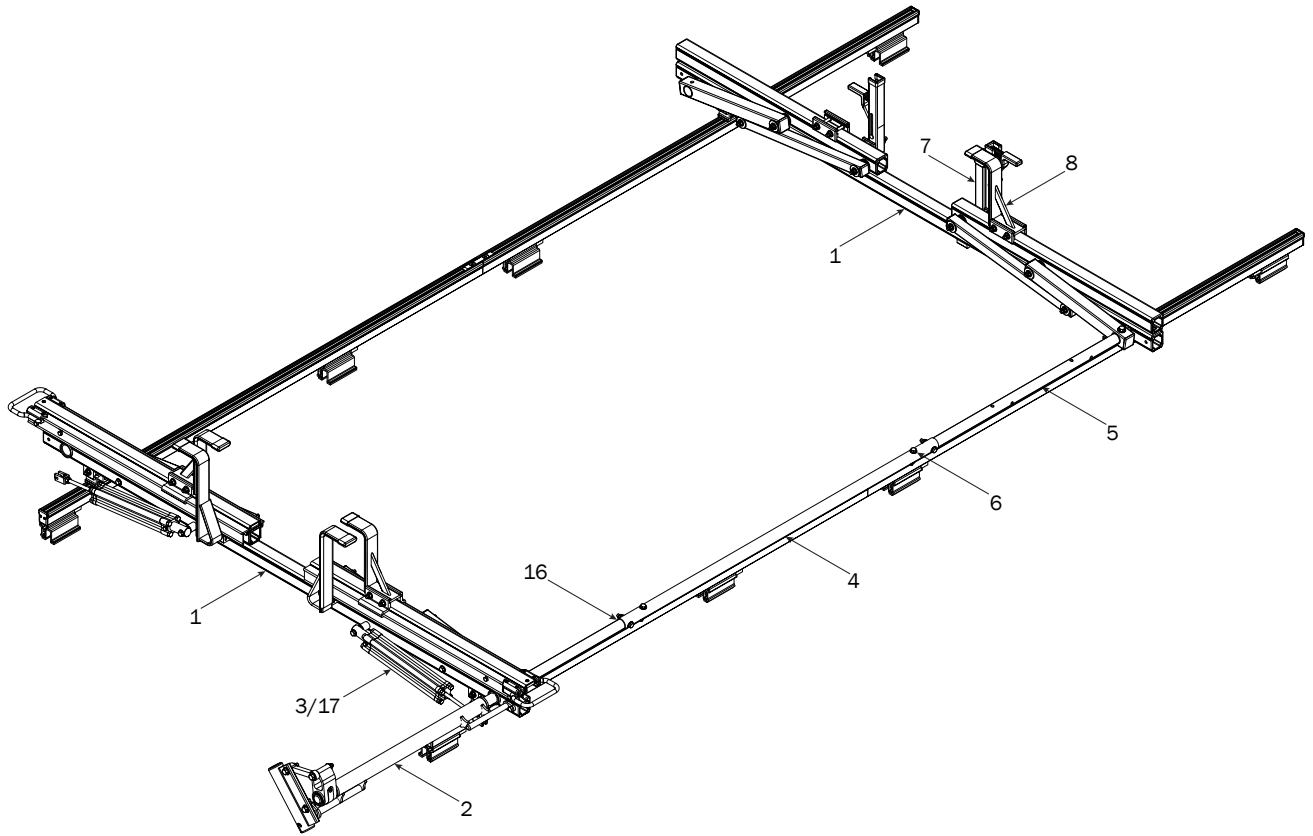

CROSSBARS

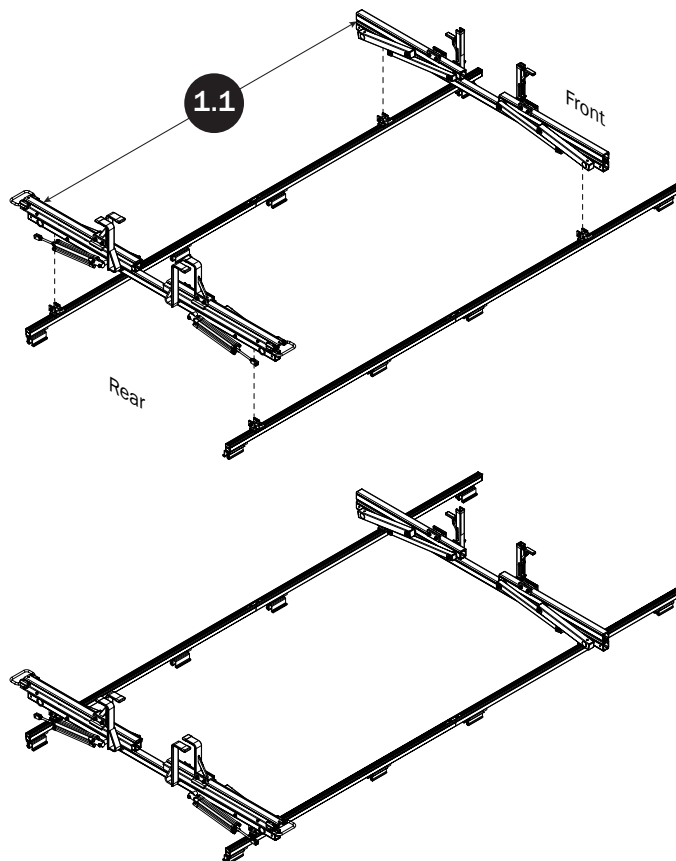

CROSSBAR ADJUSTMENT

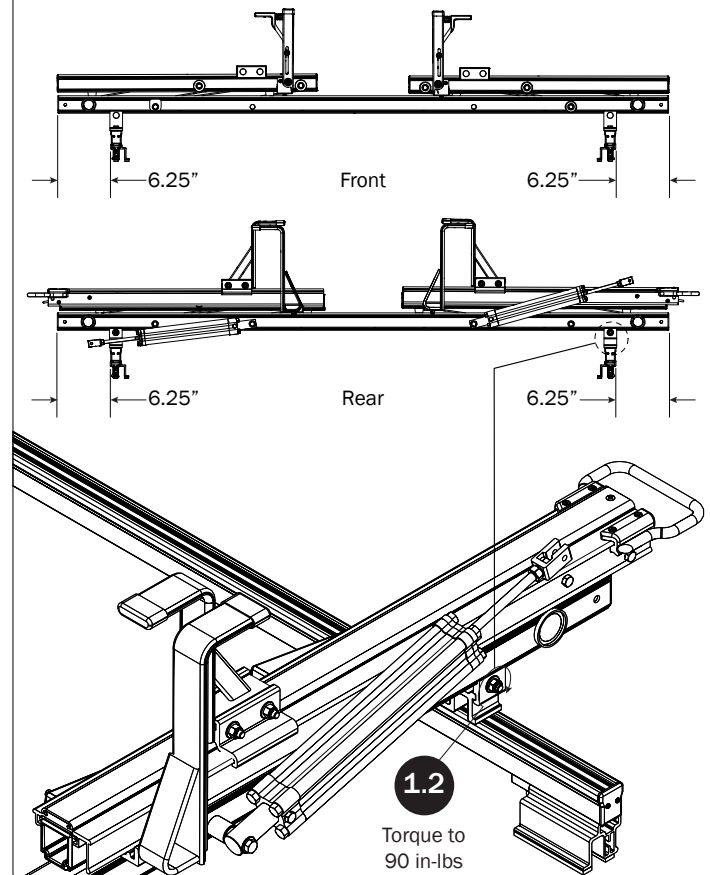

REAR DRIVE SHAFT

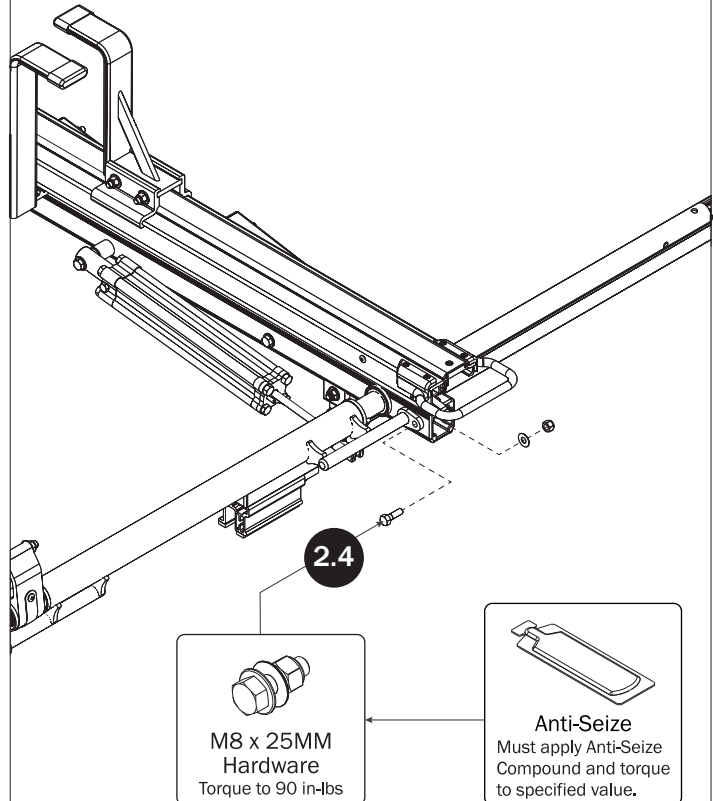
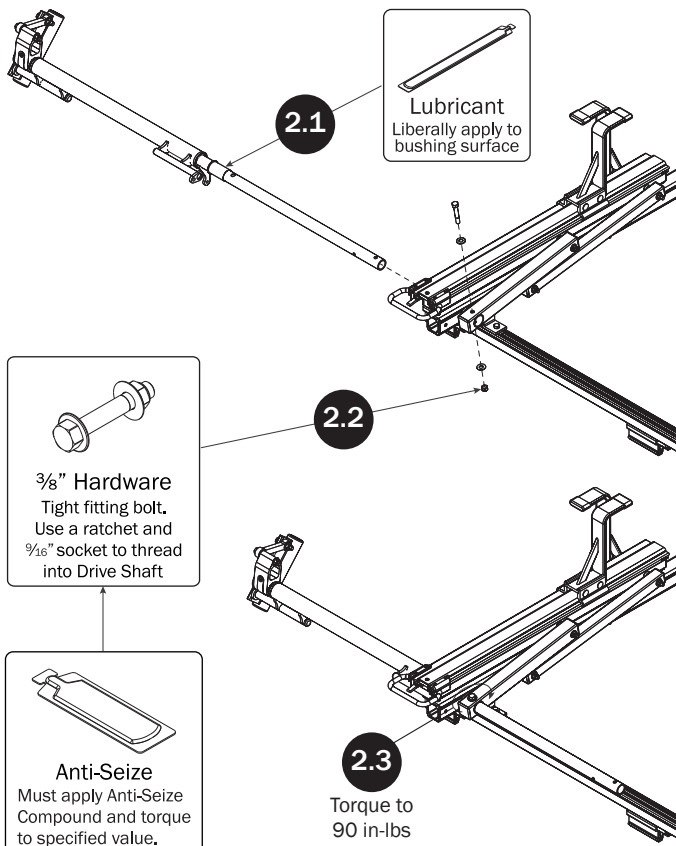

CYLINDER HARDWARE

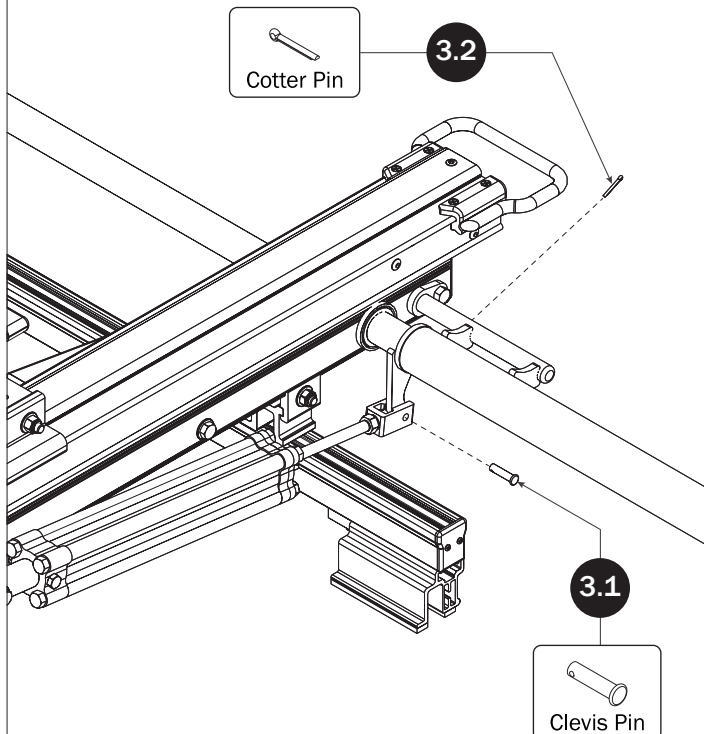

CONNECTING BAR

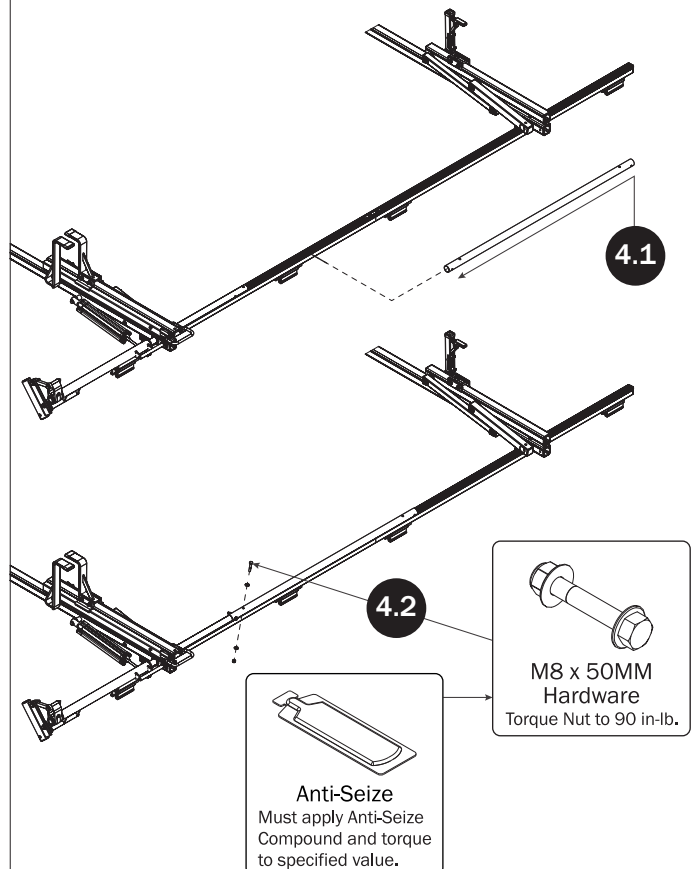

FRONT DRIVE SHAFT

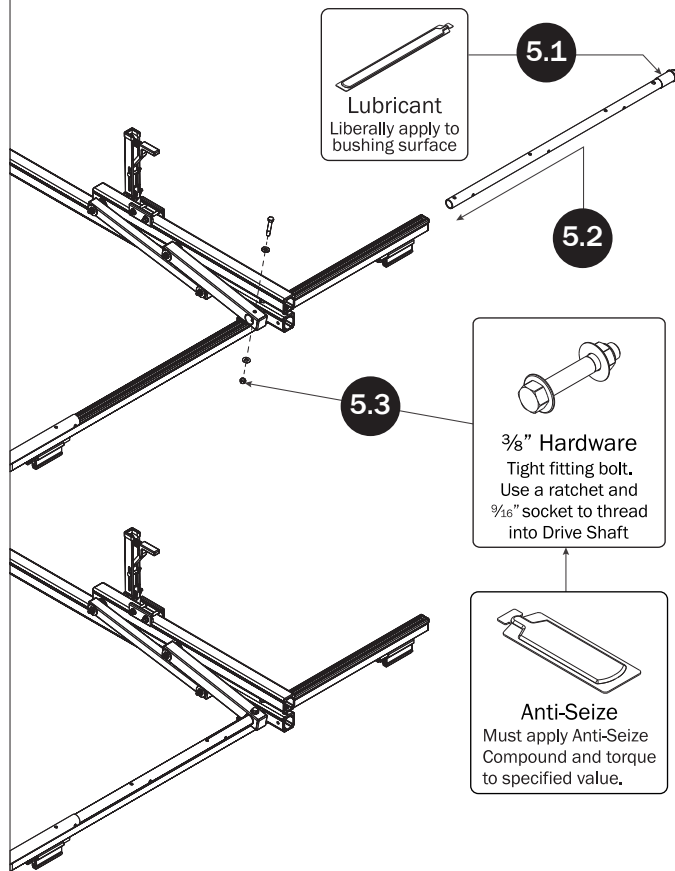

CONNECTING BAR FASTENERS

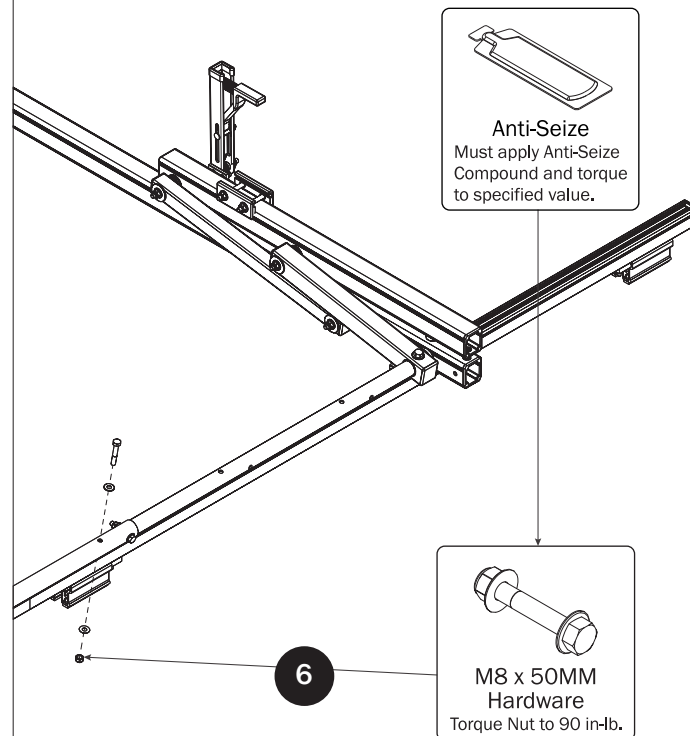

L POST

SEE QUICK START GUIDE FOR ADJUSTMENTS

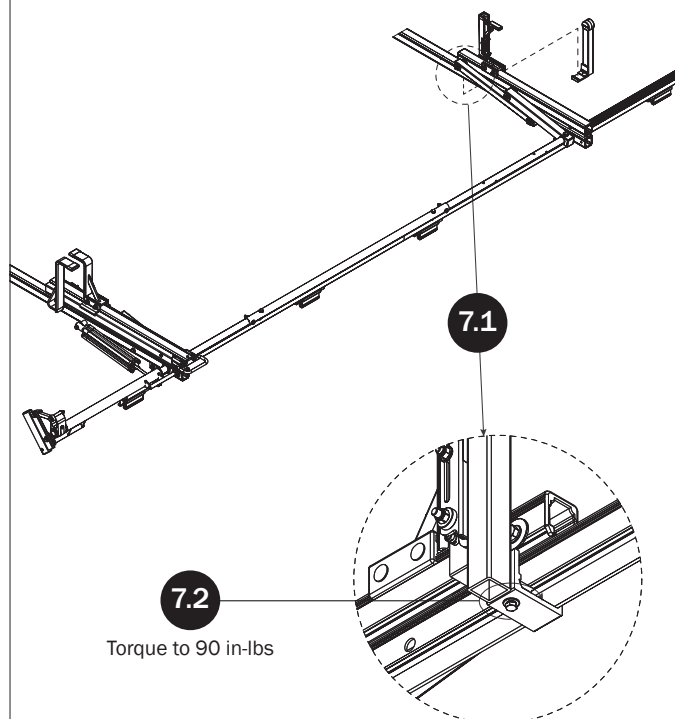

Z POST

SEE QUICK START GUIDE FOR ADJUSTMENTS

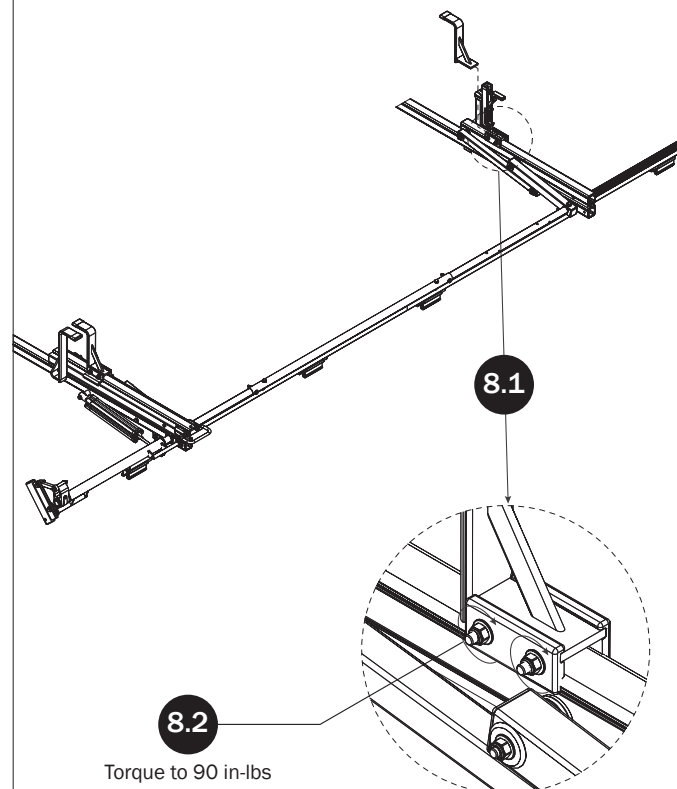

LEFT ROTATION ASSEMBLY

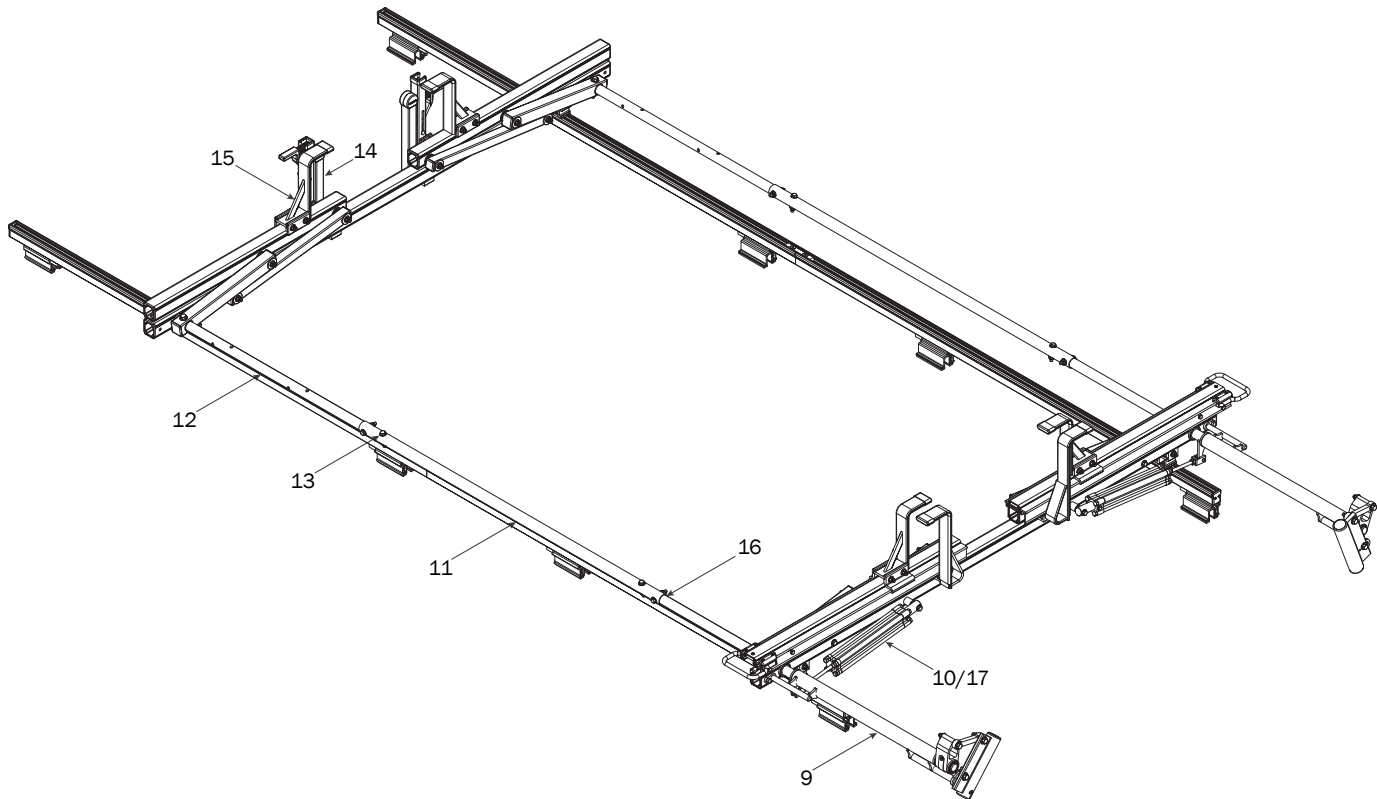

REAR DRIVE SHAFT

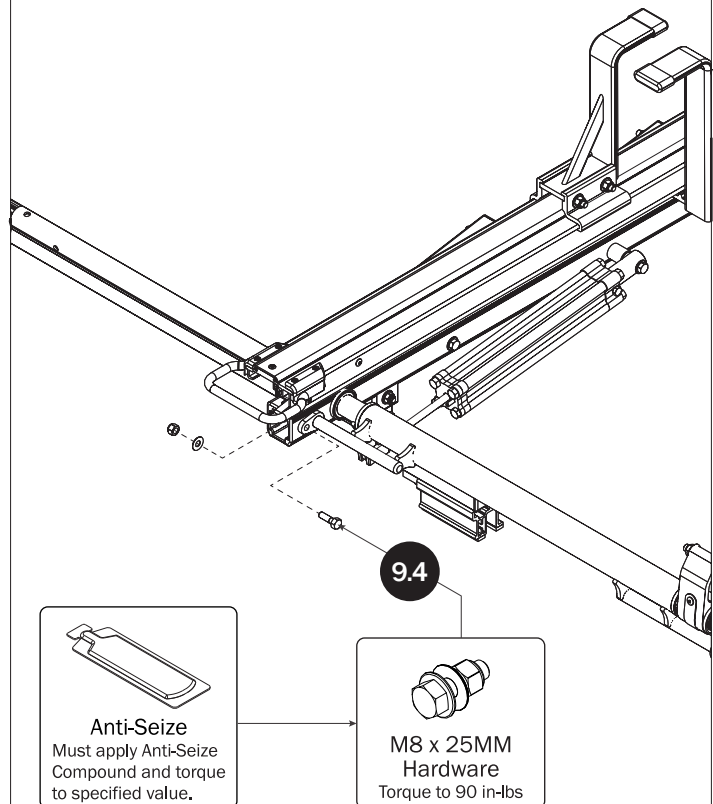
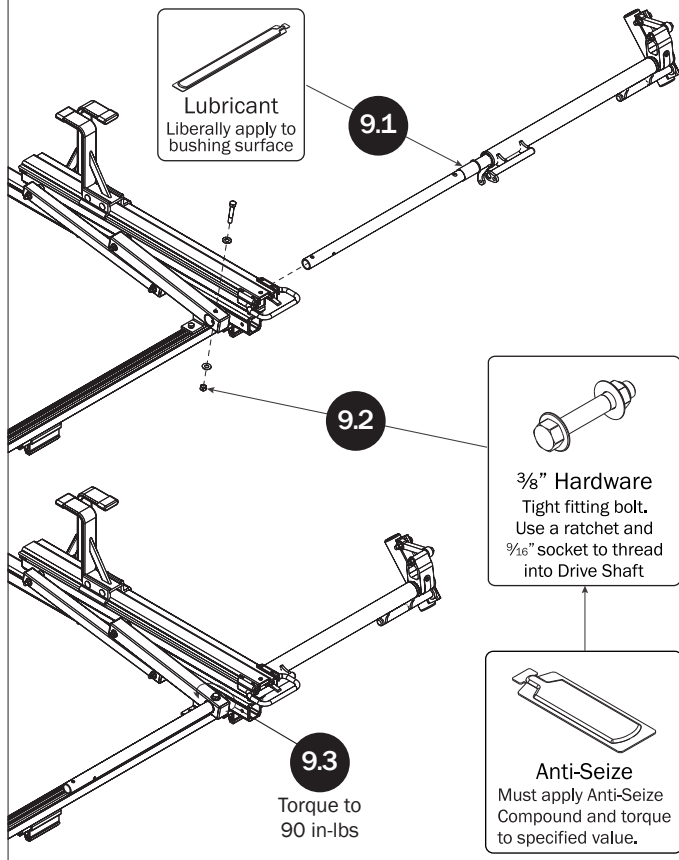

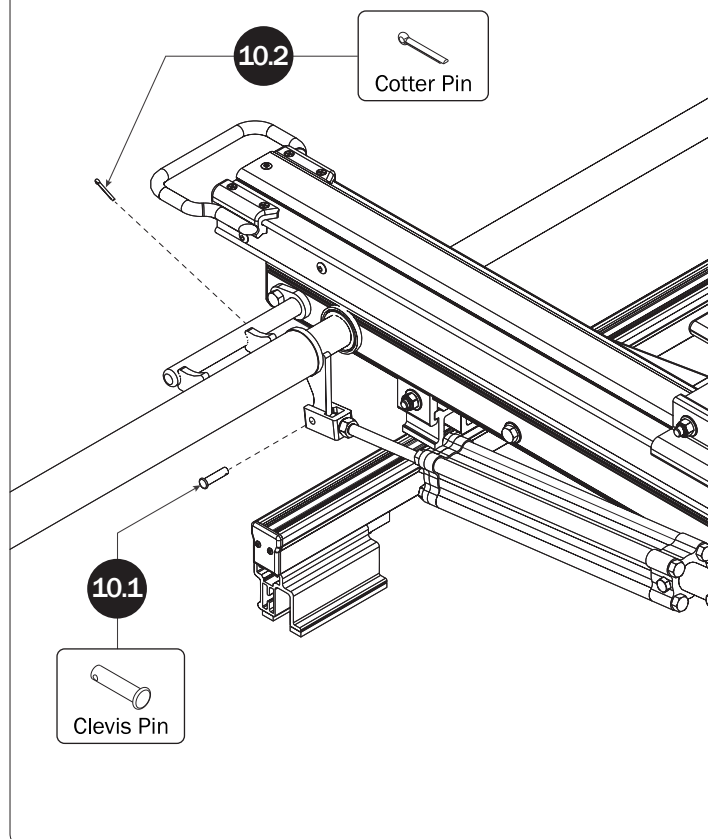
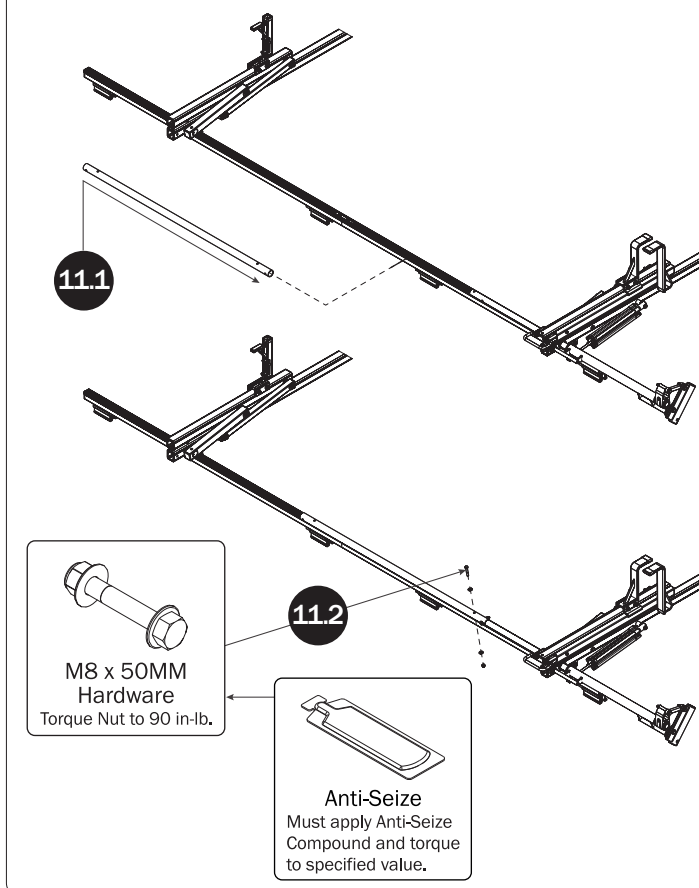
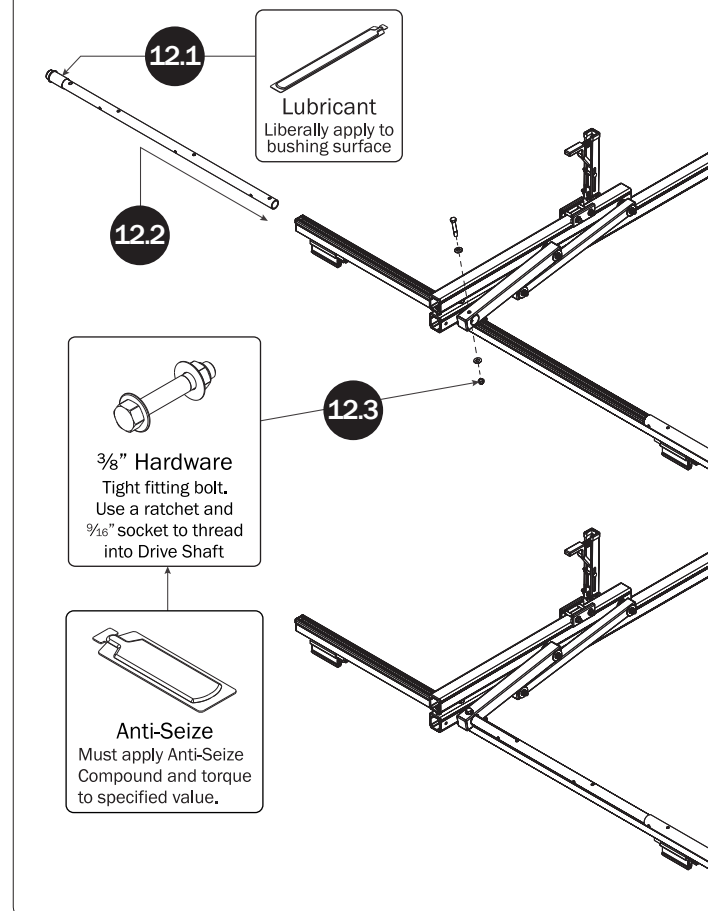
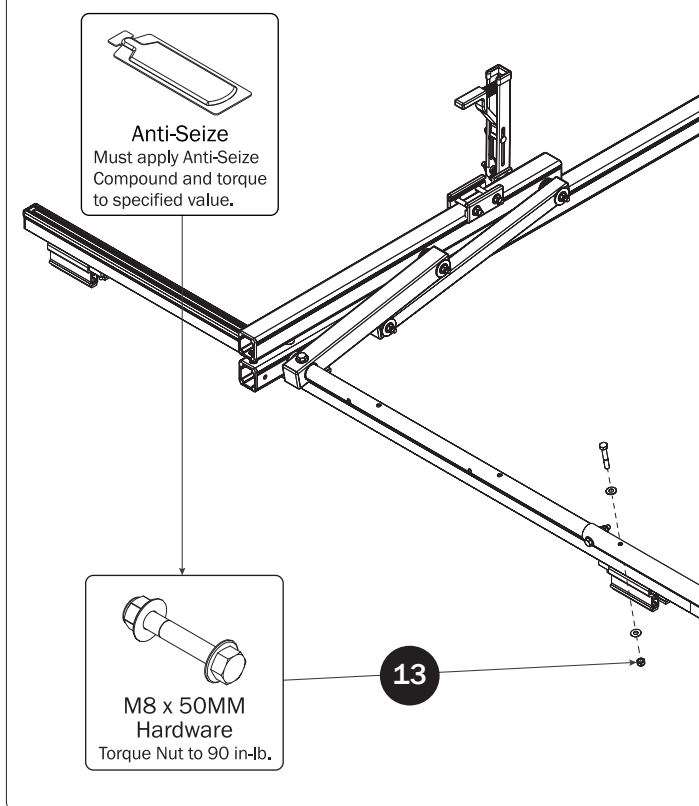
CYLINDER HARDWARE**CONNECTING BAR****FRONT DRIVE SHAFT****CONNECTING BAR FASTENERS**

L POSTS

SEE QUICK START GUIDE FOR ADJUSTMENTS

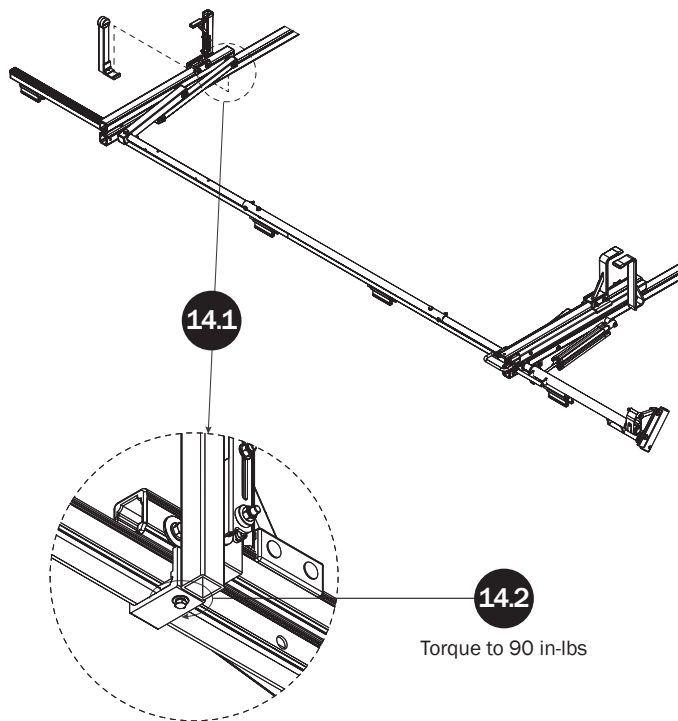

Z POSTS

SEE QUICK START GUIDE FOR ADJUSTMENTS

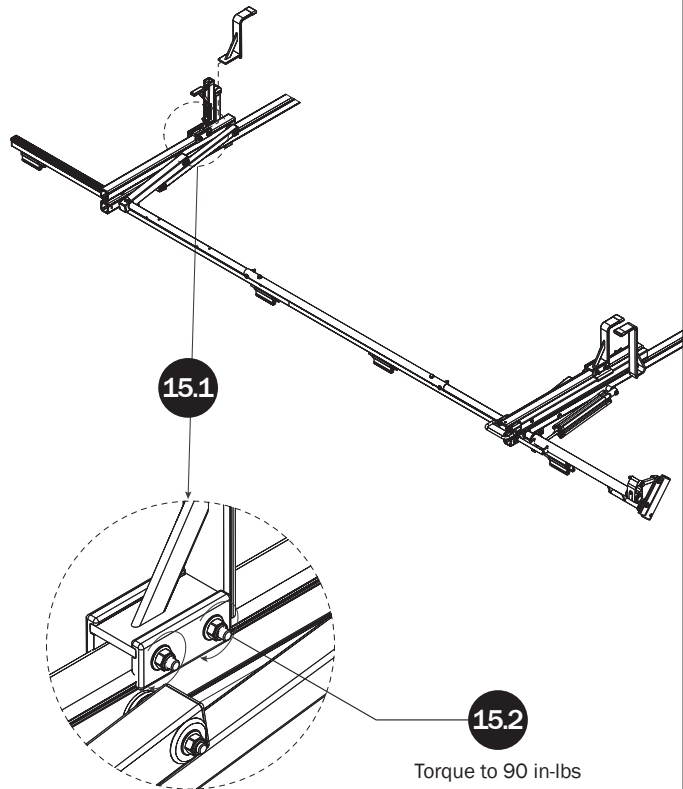

DRIVE SHAFT SEALING

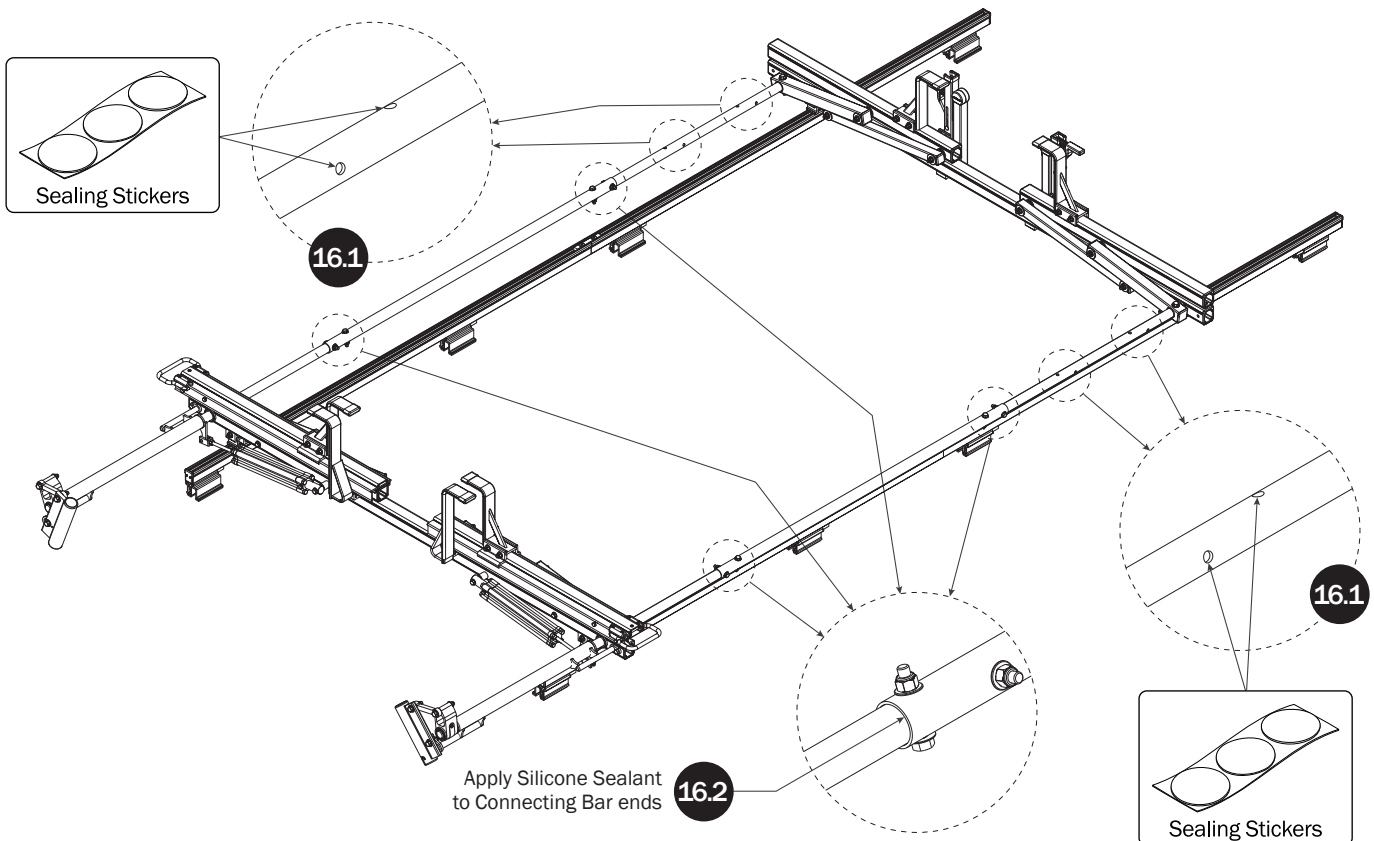

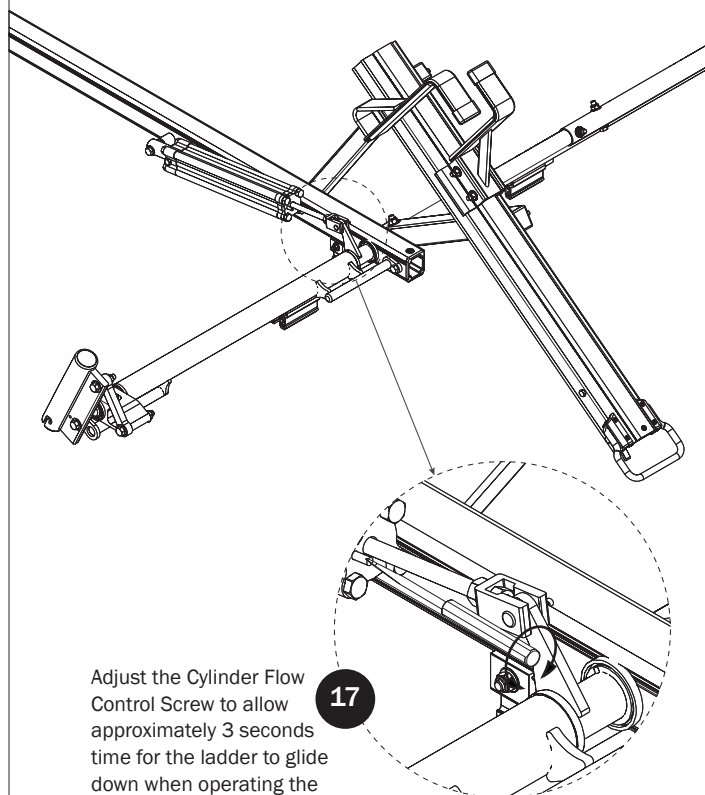
CYLINDER ADJUSTMENT

USAM-HRREPM42-US01 Rev-B 0218