

# PRIME DESIGN™

A Safe Fleet Brand

# PN5 HRR-E

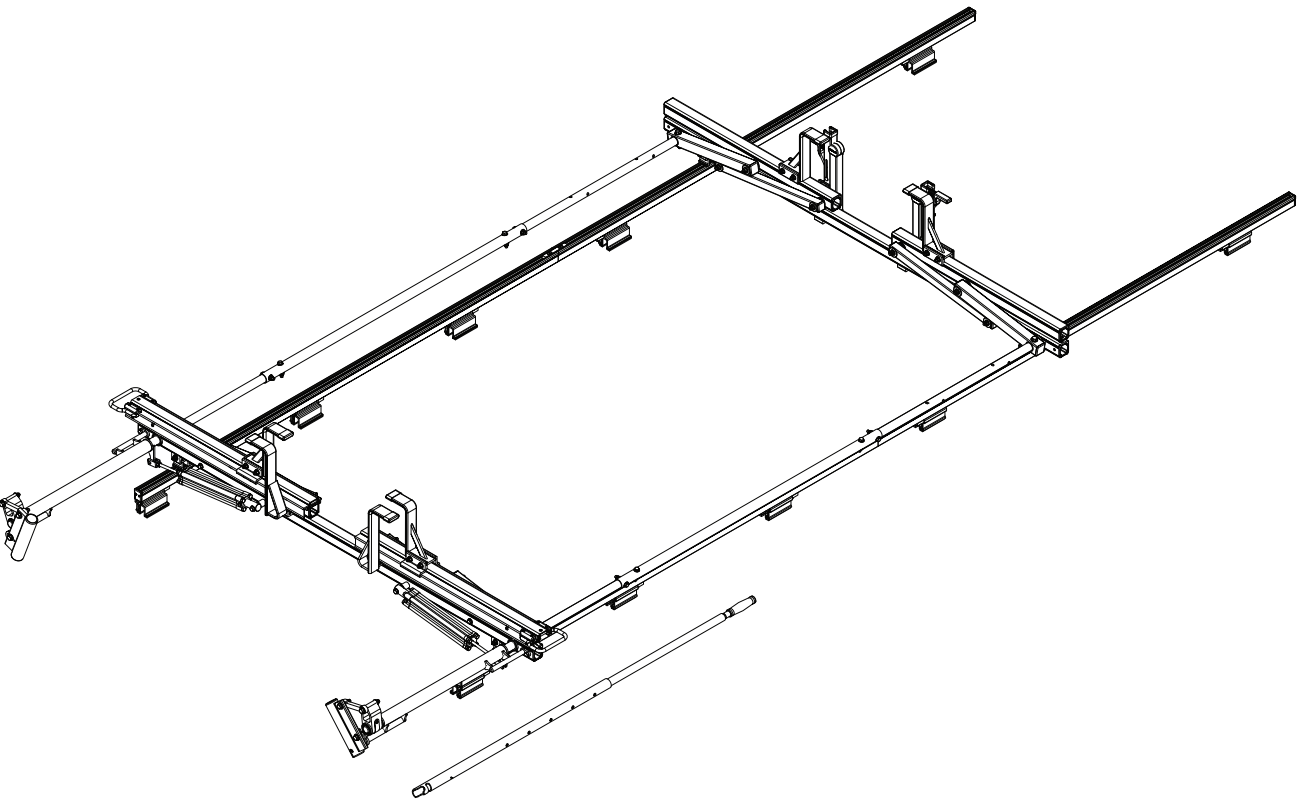

## CONTENTS OVERVIEW

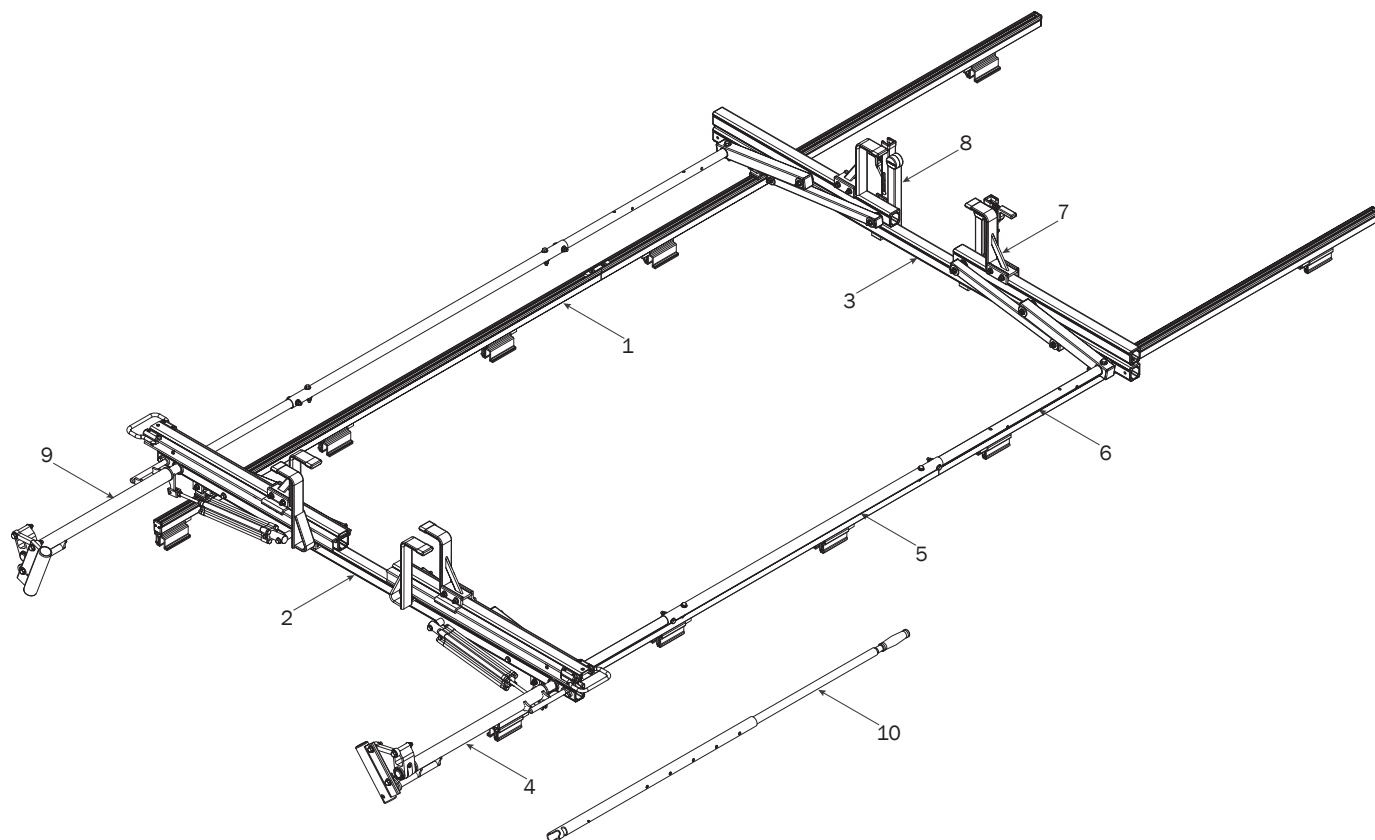

- 1—FBM-0015 ..... (Qty 1)  
Channels with hardware



76" Channels (4X)



End Caps (4X)



Screws (8X)



Top Connector (2X)



Bottom Connector (2X)



Brackets (4X)



Mountings (10X)

M8 Bolt (4X)

- 2—Rear Crossbar Assembly ..... (Qty 1)

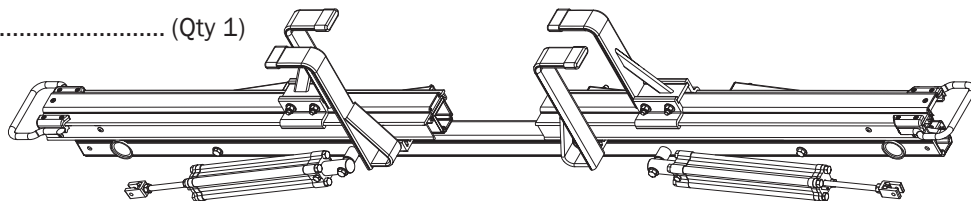

- 3—Front Crossbar Assembly ..... (Qty 1)

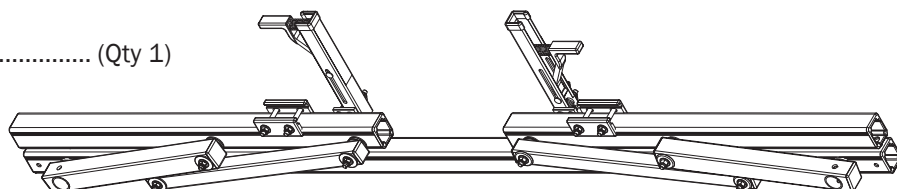

4—Drive Shaft ..... (Qty 1)  
Rear, Right Hand, 50.00"

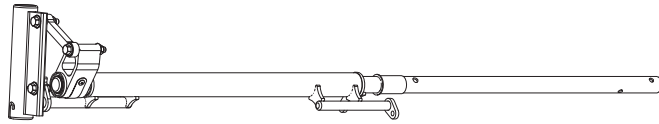

5—Connecting Bar ..... (Qty 2)  
48.00"

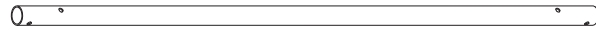

6—Front Drive Shaft ..... (Qty 2)  
B Version, 35.75"

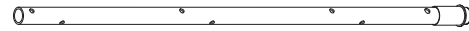

7—Z Post ..... (Qty 2)  
Adjustable, 7.25"

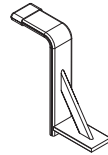

8—L Post ..... (Qty 2)  
US3, Roller Cap, 9.25"



9—Drive Shaft ..... (Qty 1)  
Rear, Left Hand, 50.00"

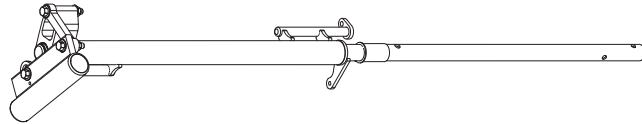

10—HRR Removeable Handle Assembly ..... (Qty 1)

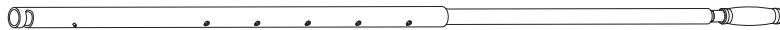

11—HKT-8163 (Not called out in Overview) ..... (Qty 2)

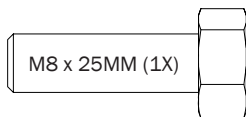

M8 x 25MM (1X)

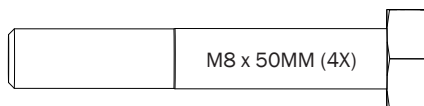

M8 x 50MM (4X)

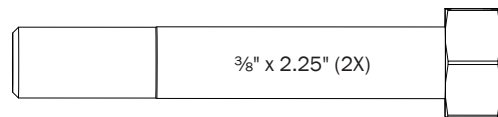

3/8" x 2.25" (2X)

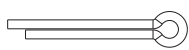

Cotter Pin (1X)

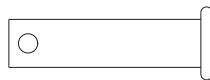

Clevis Pin (1X)

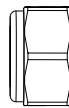

M8 Lock Nut (5X)

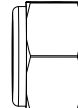

3/8" Lock Nut (2X)

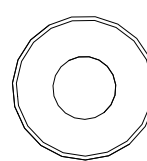

5/16" Flat Washer (10X)

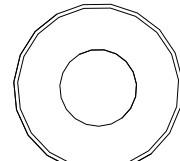

3/8" Flat Washer (4X)

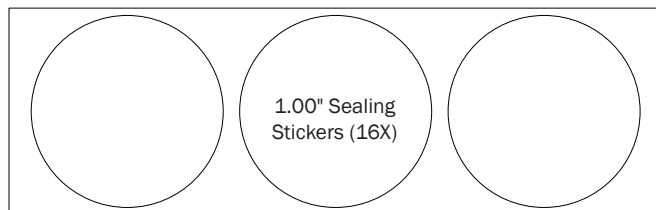

1.00" Sealing  
Stickers (16X)



Anti-Seize (2X)

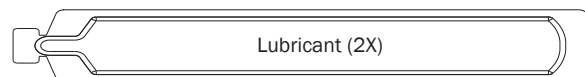

Lubricant (2X)

## FBM-0015 MOUNTING BRACKETS

**INSTALLER NOTE:** Mounting Brackets must be disassembled for installation onto the vehicle's roof.

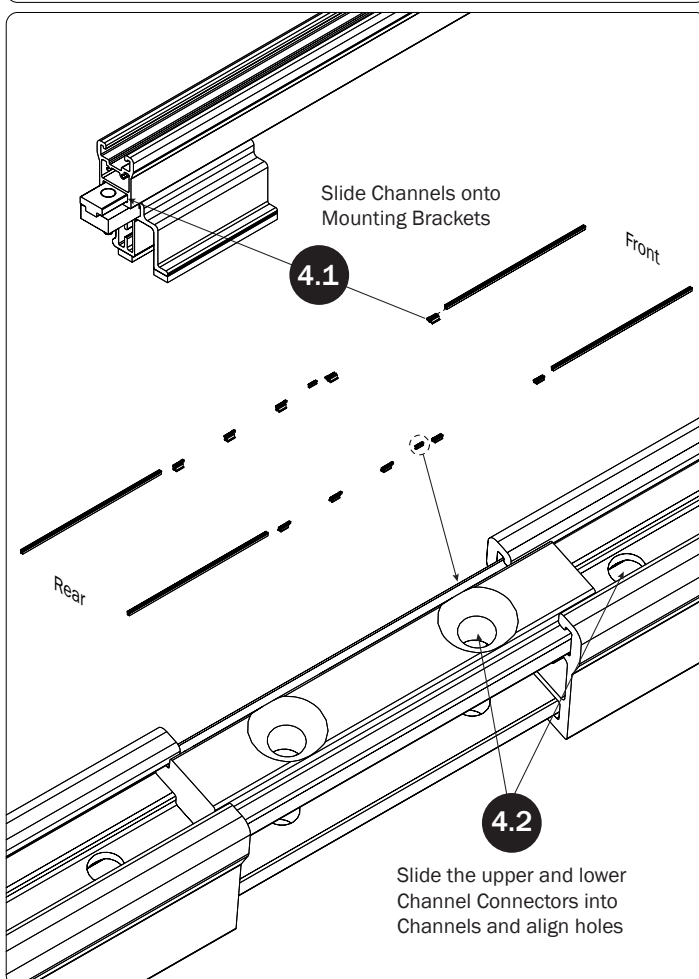
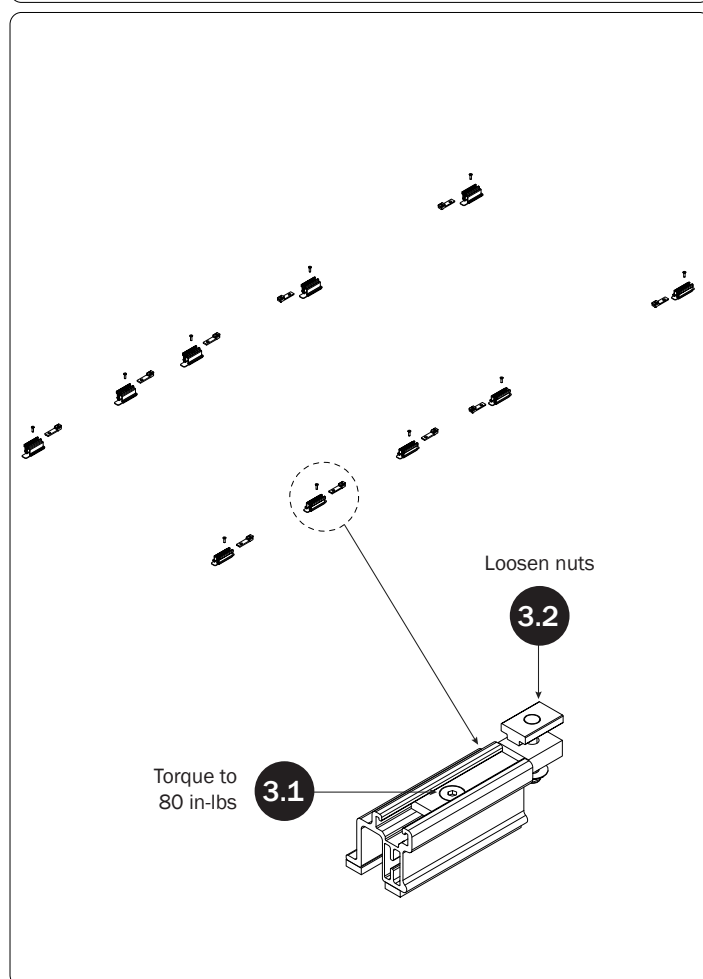
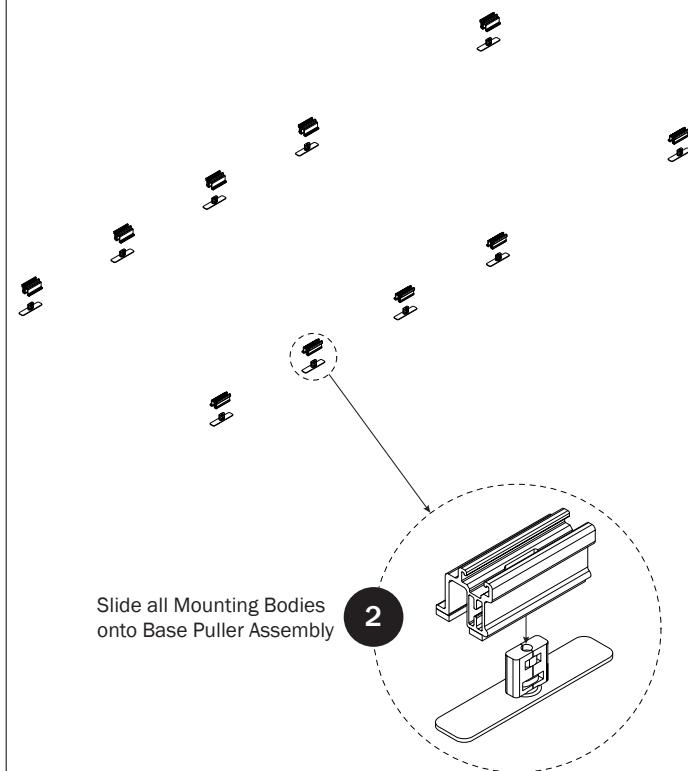
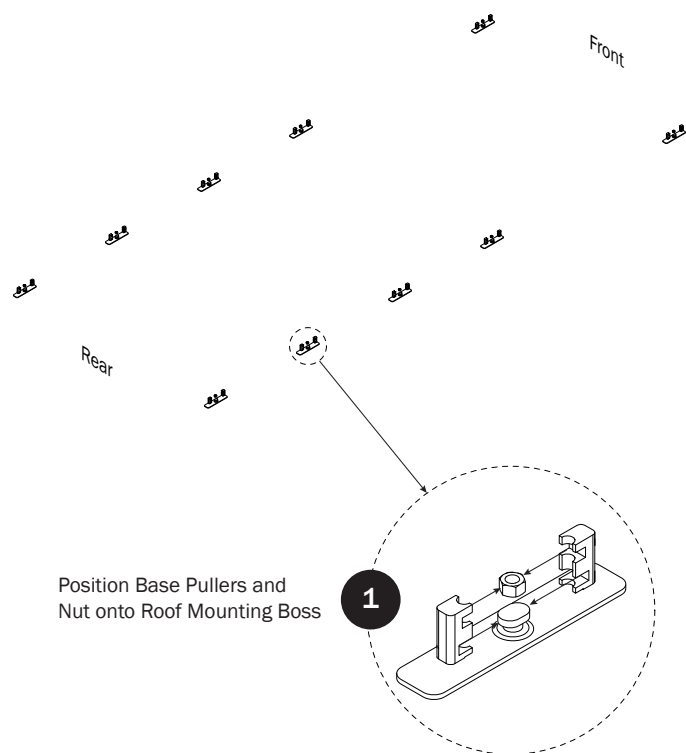

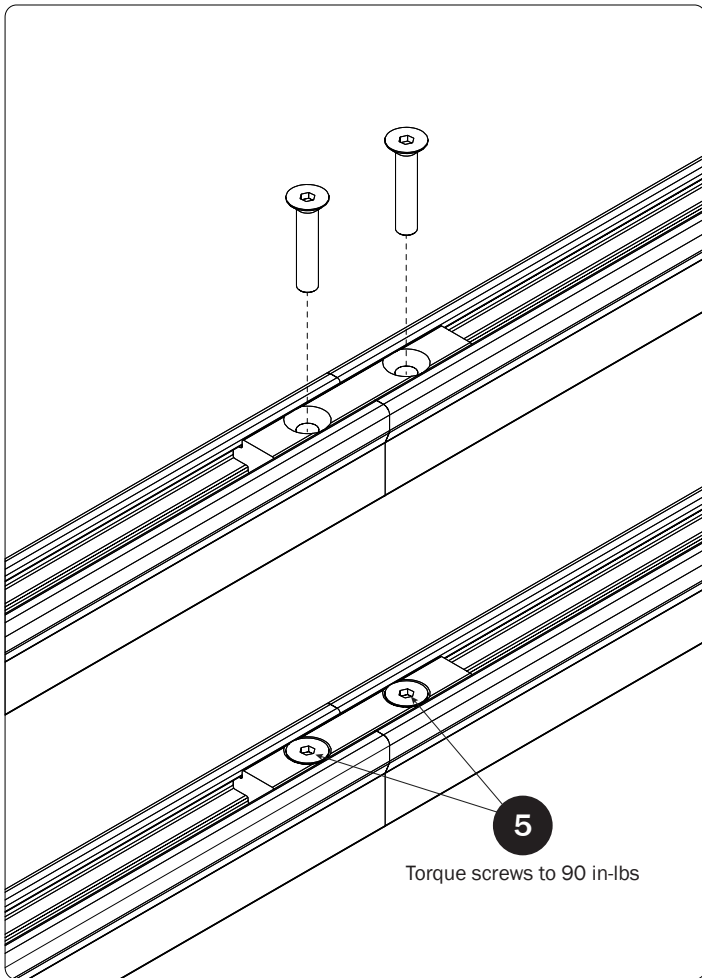

6 Set to distances then torque Mounting Bracket nuts to 80 in-lbs

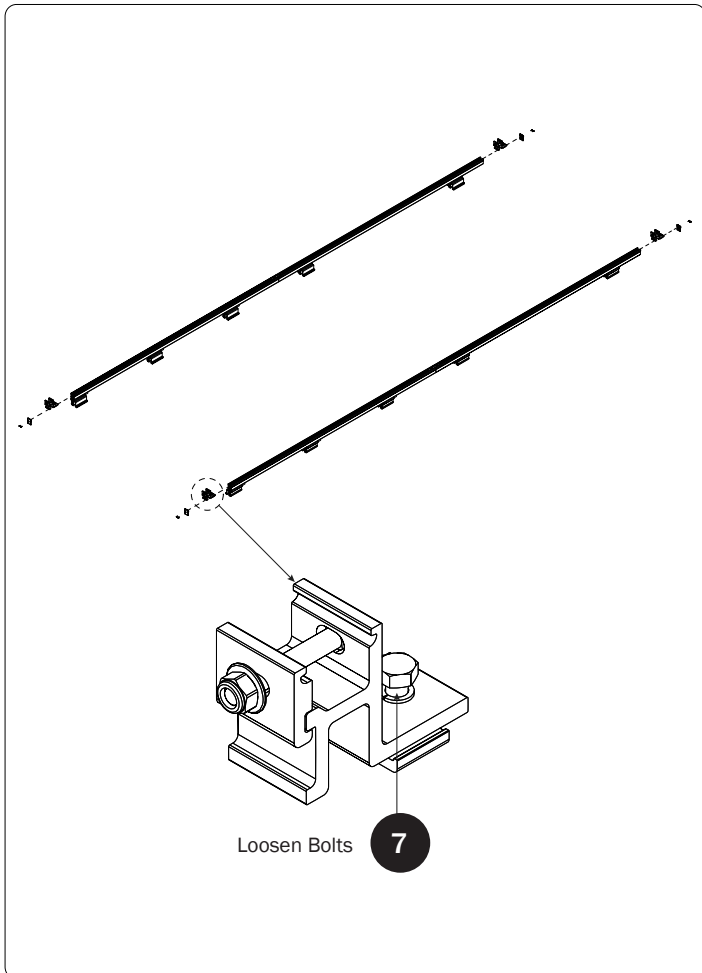
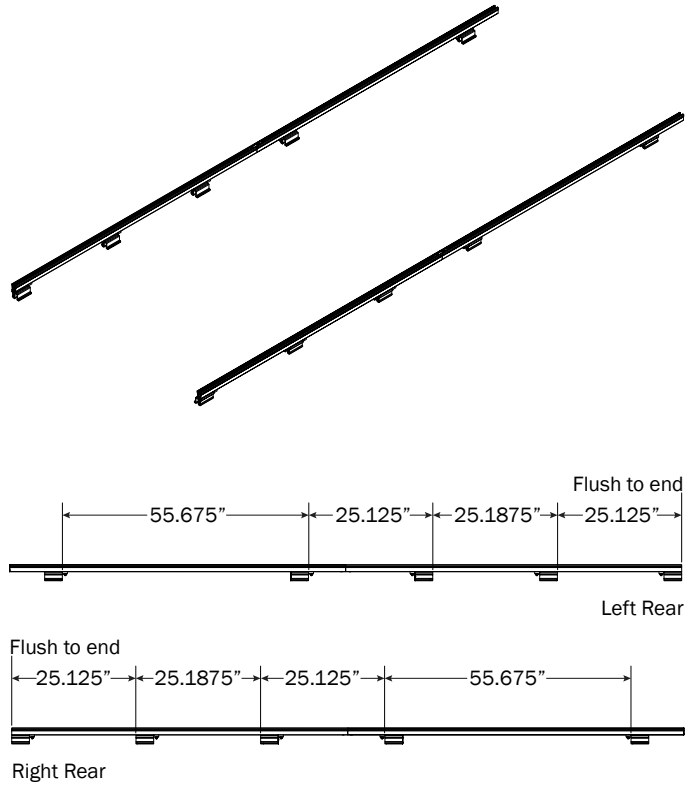

8 Set to distances shown, but do not tighten at this time

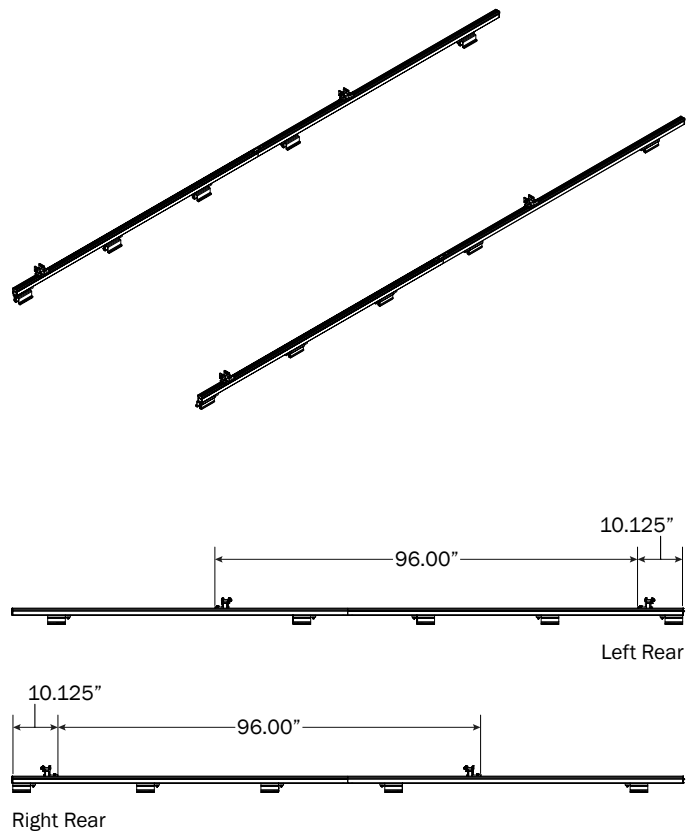

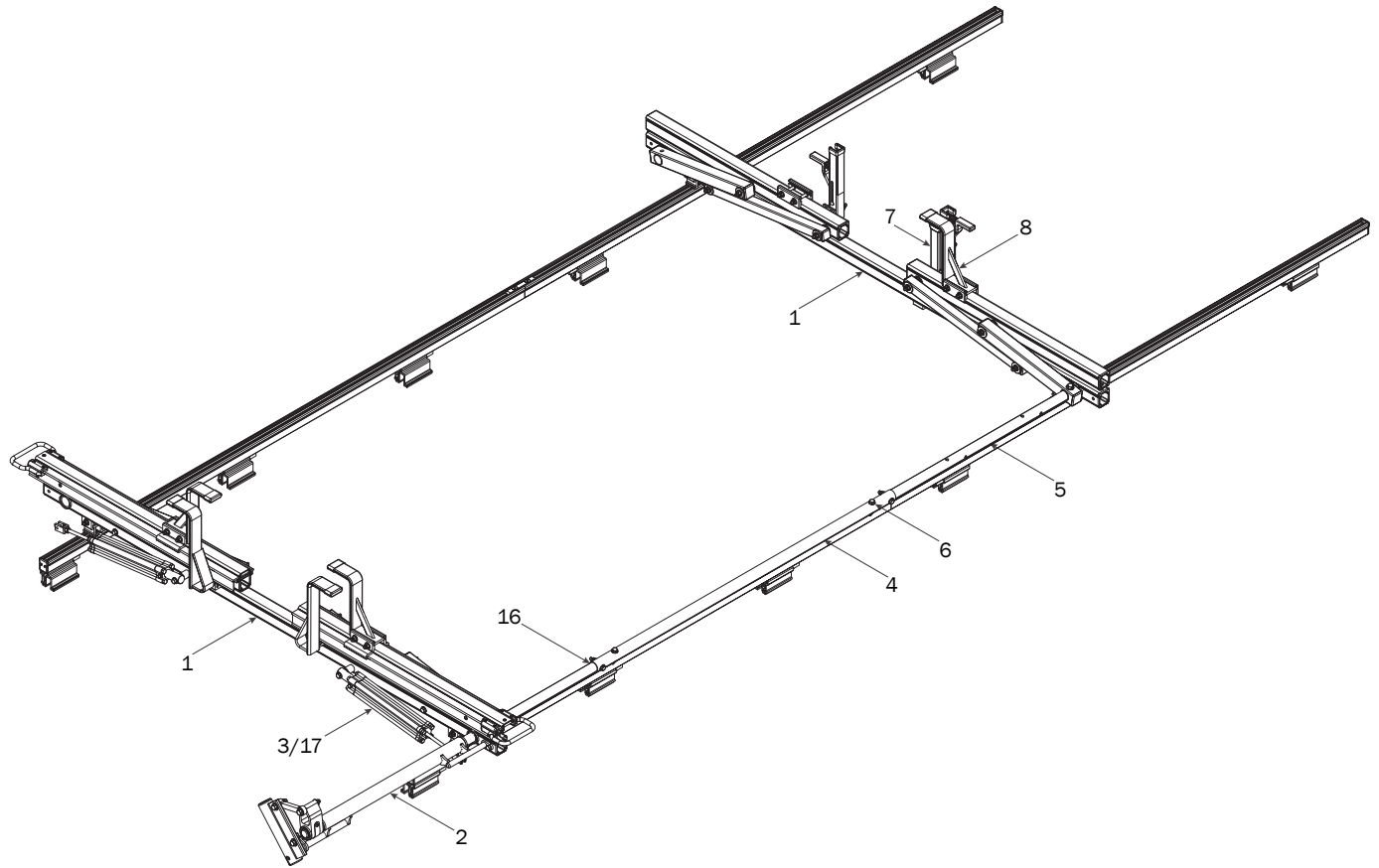
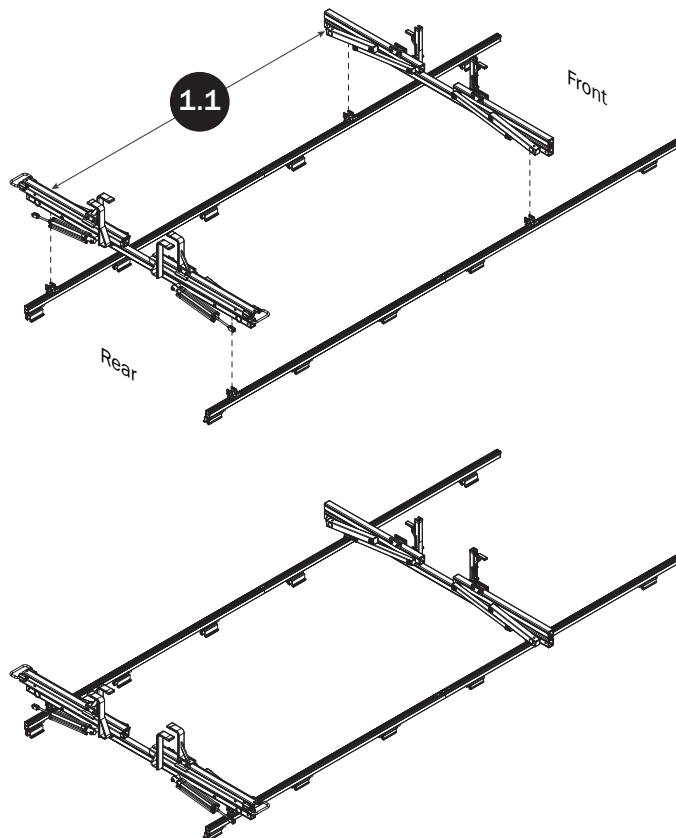
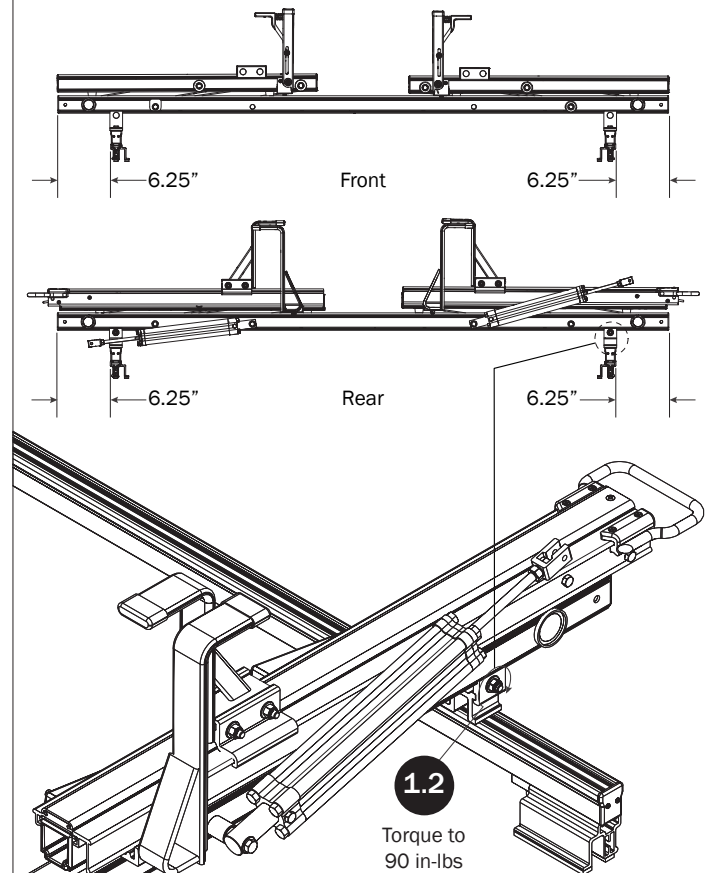
**RIGHT ROTATION ASSEMBLY****CROSSBARS****CROSSBAR ADJUSTMENT**

## REAR DRIVE SHAFT

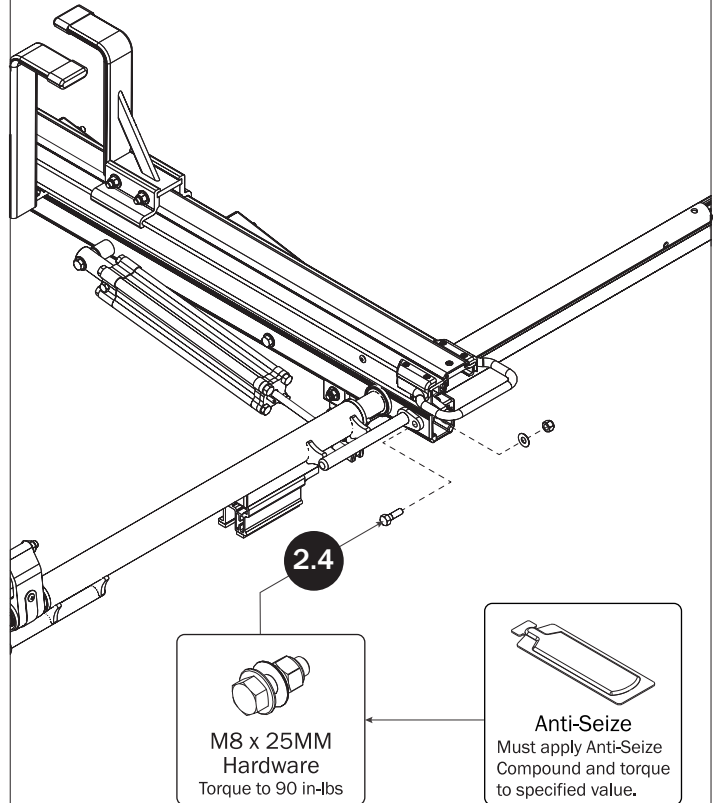
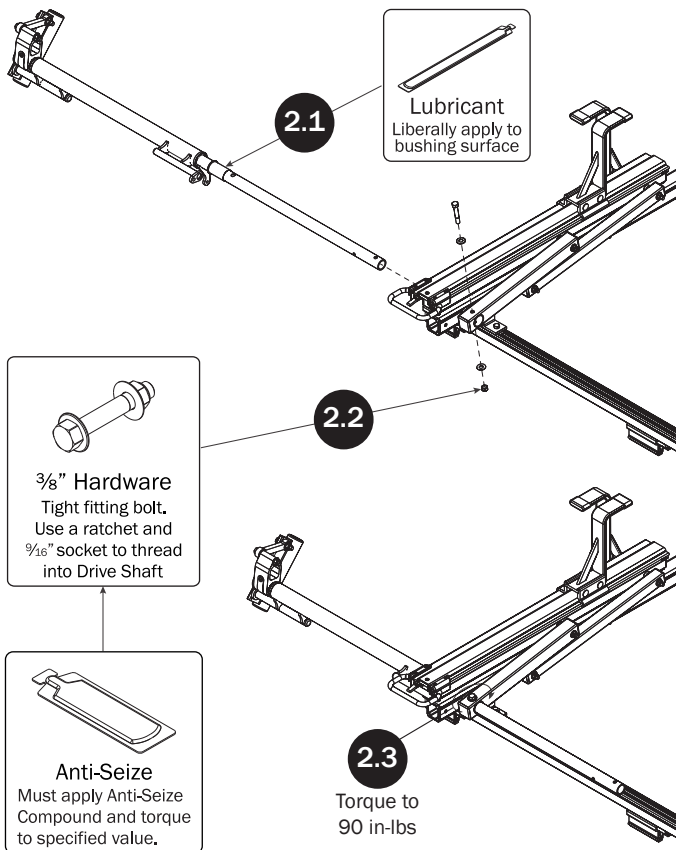

## CYLINDER HARDWARE

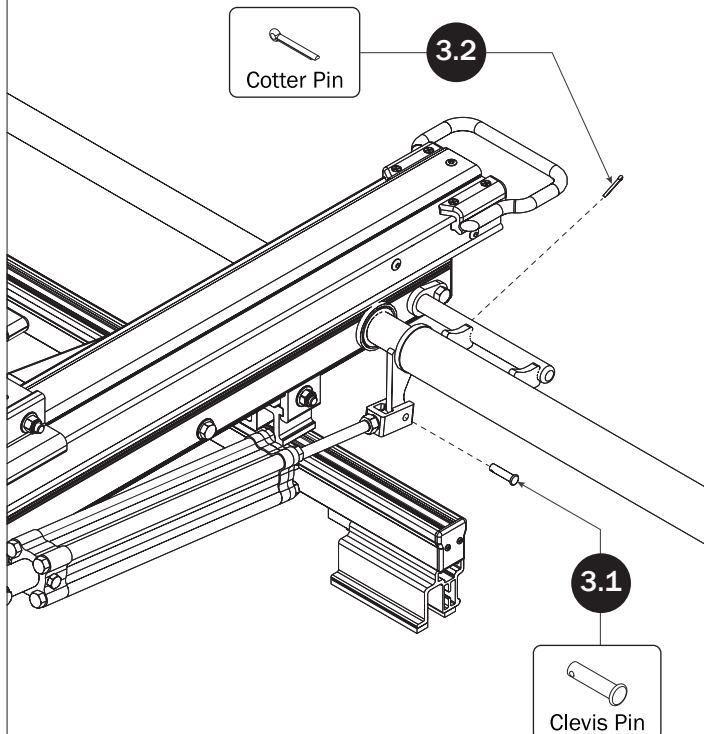

## CONNECTING BAR

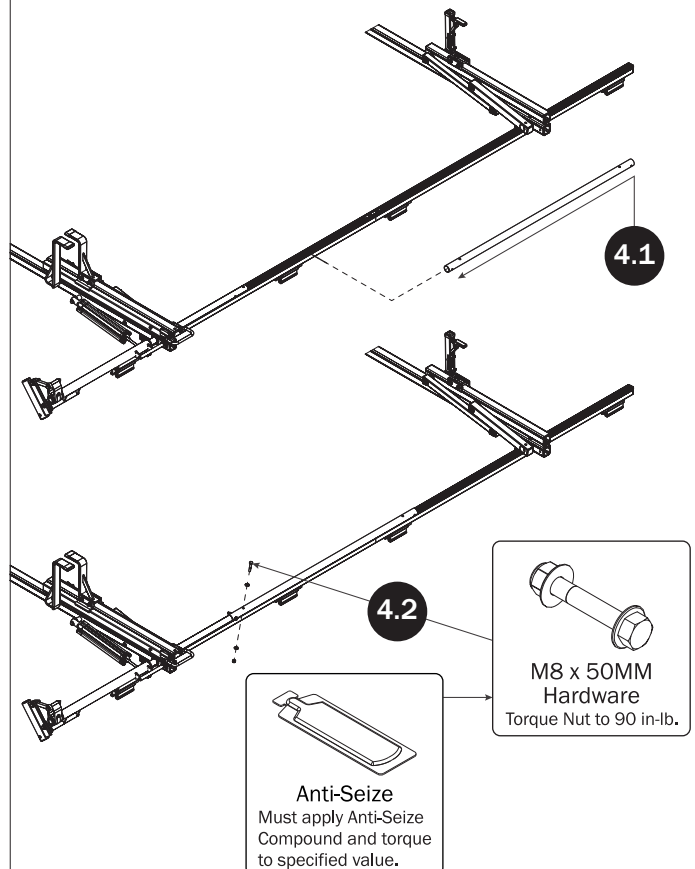



## FRONT DRIVE SHAFT

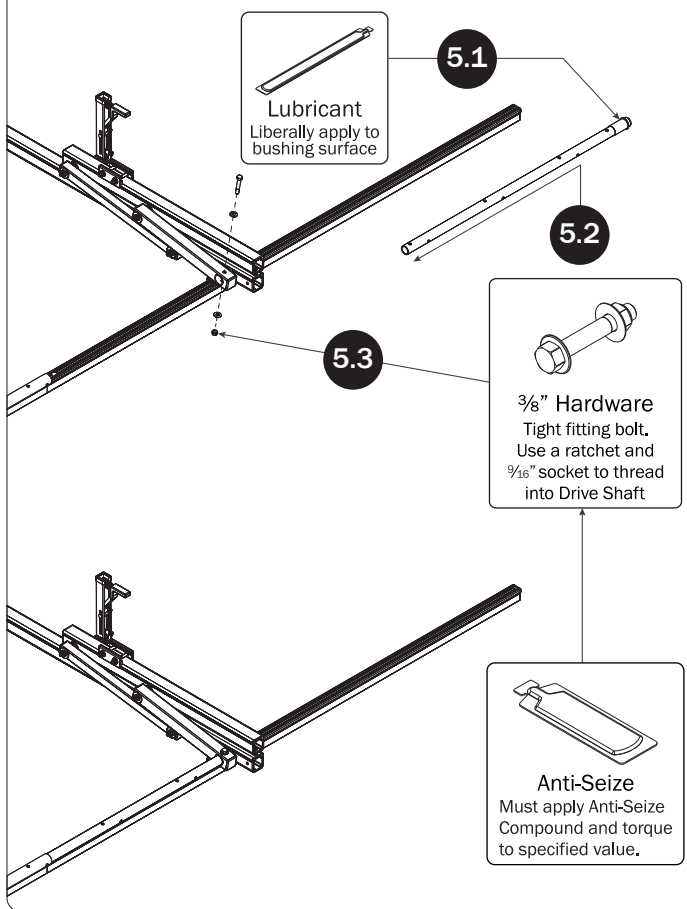

## CONNECTING BAR FASTENERS

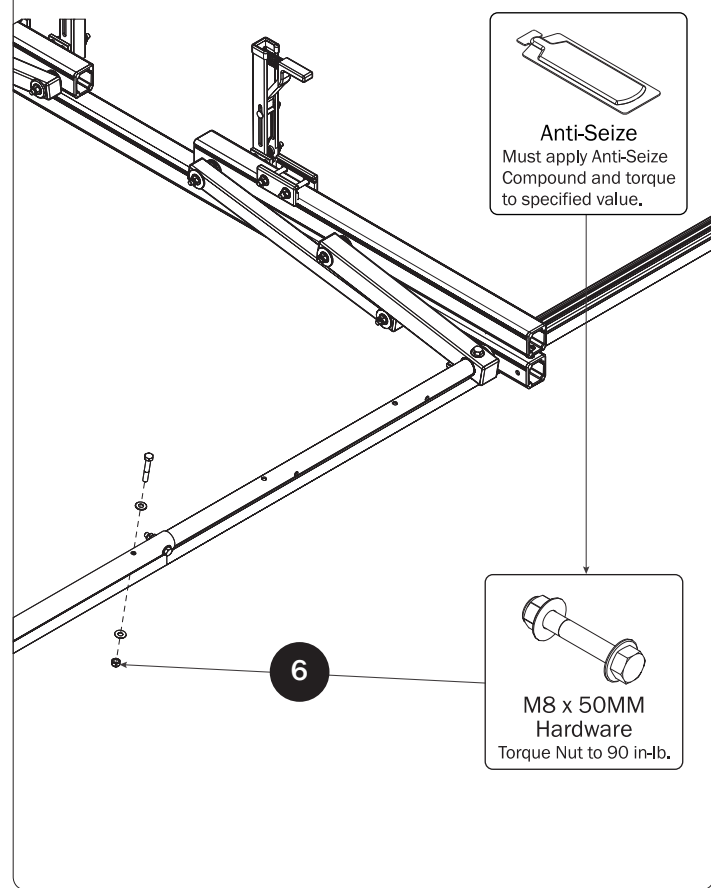

## L POSTS

SEE QUICK START GUIDE FOR ADJUSTMENTS

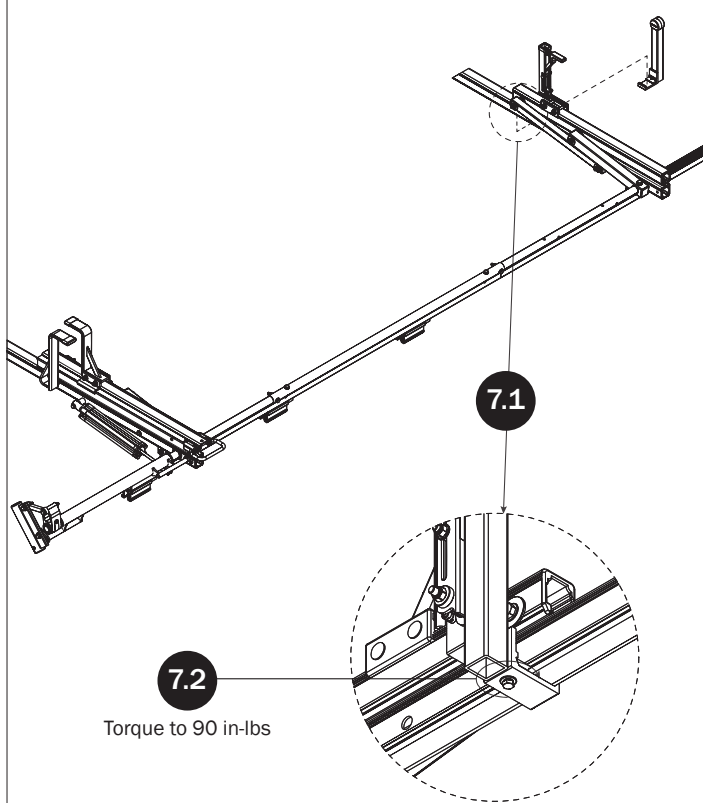

## Z POSTS

SEE QUICK START GUIDE FOR ADJUSTMENTS

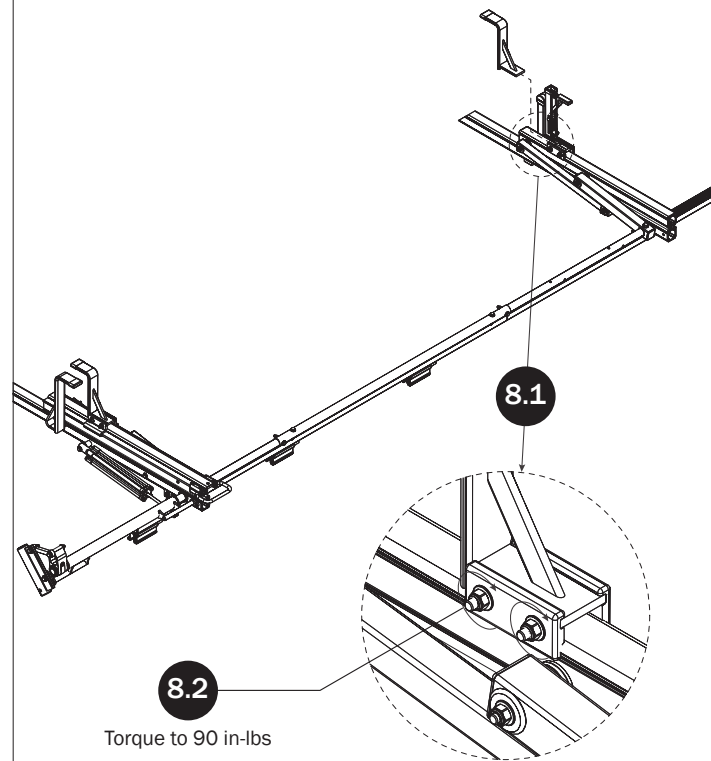



## LEFT ROTATION ASSEMBLY

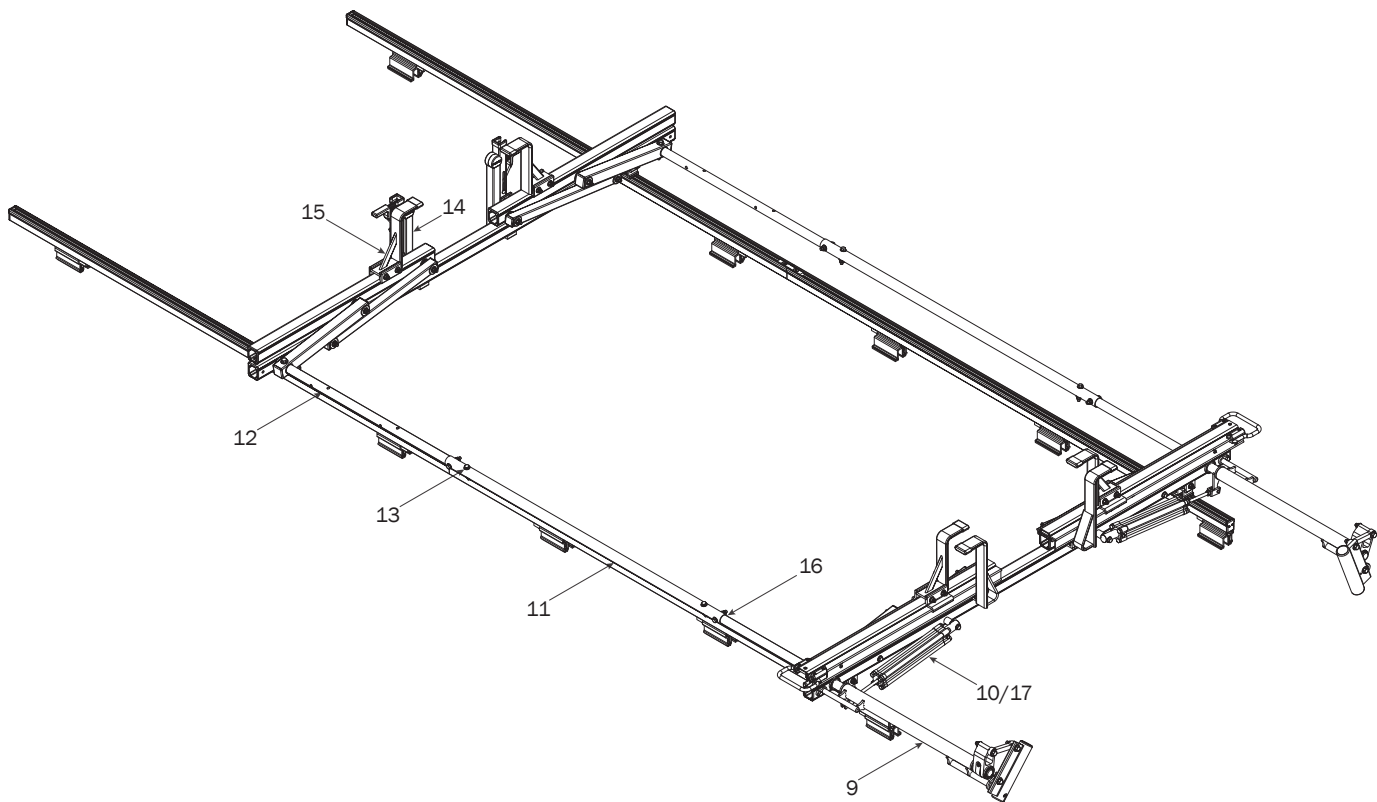

## REAR DRIVE SHAFT

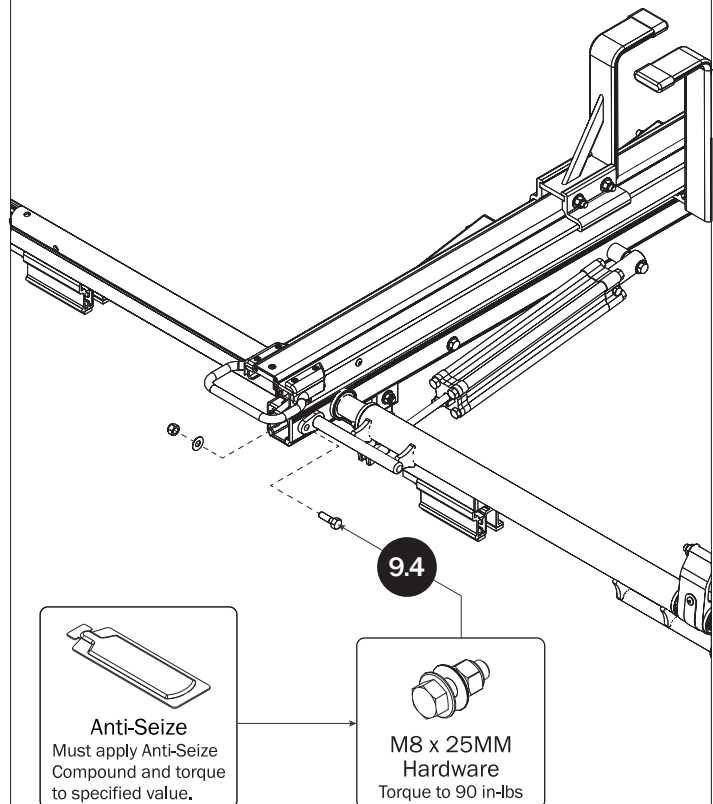
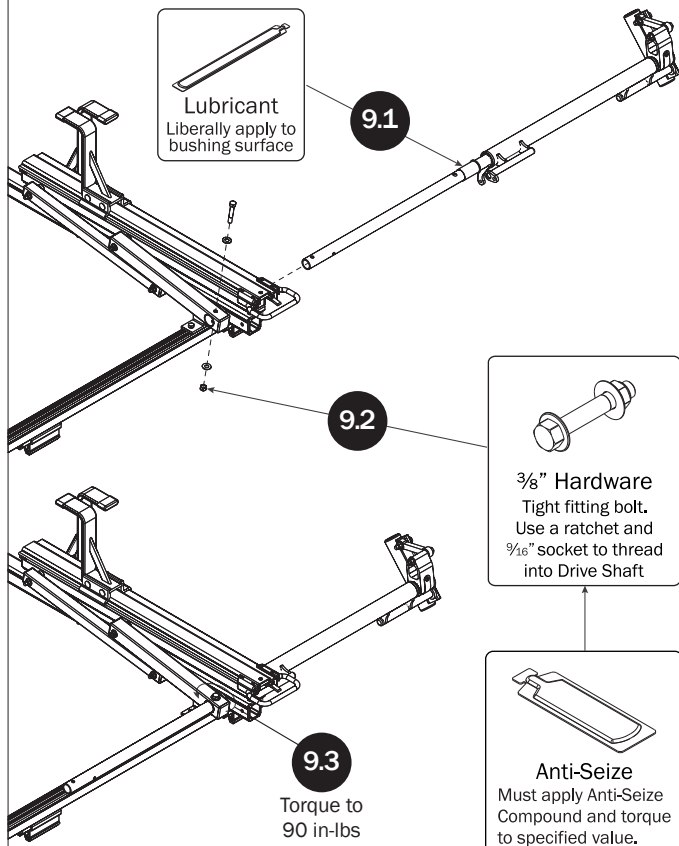

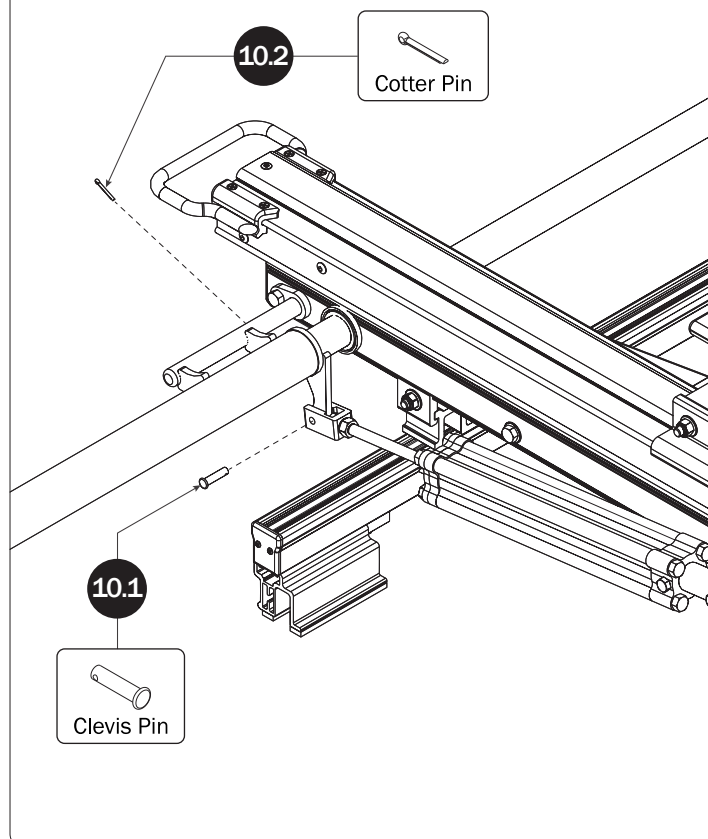
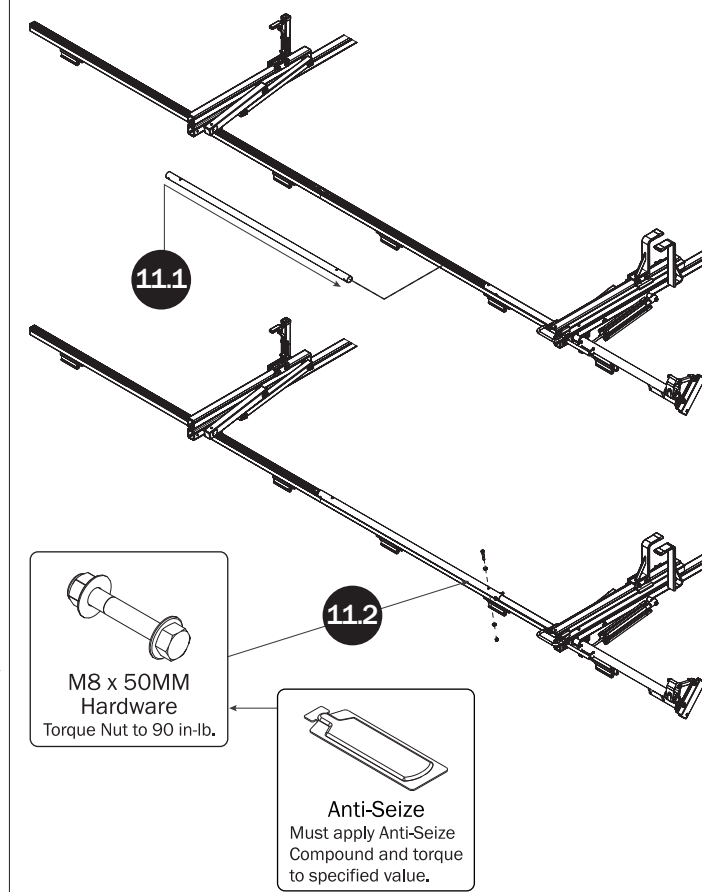
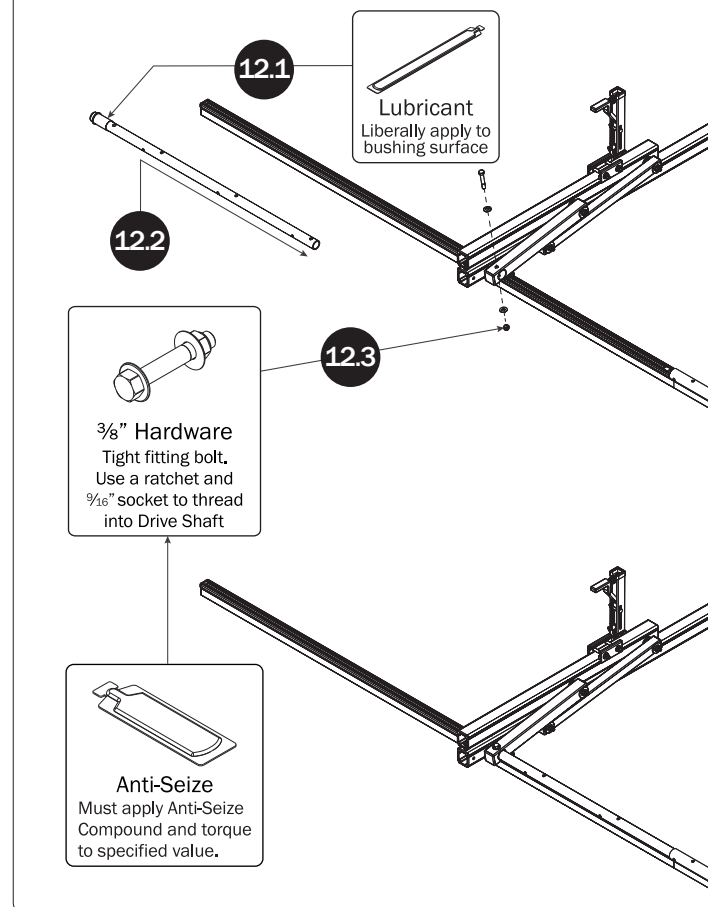
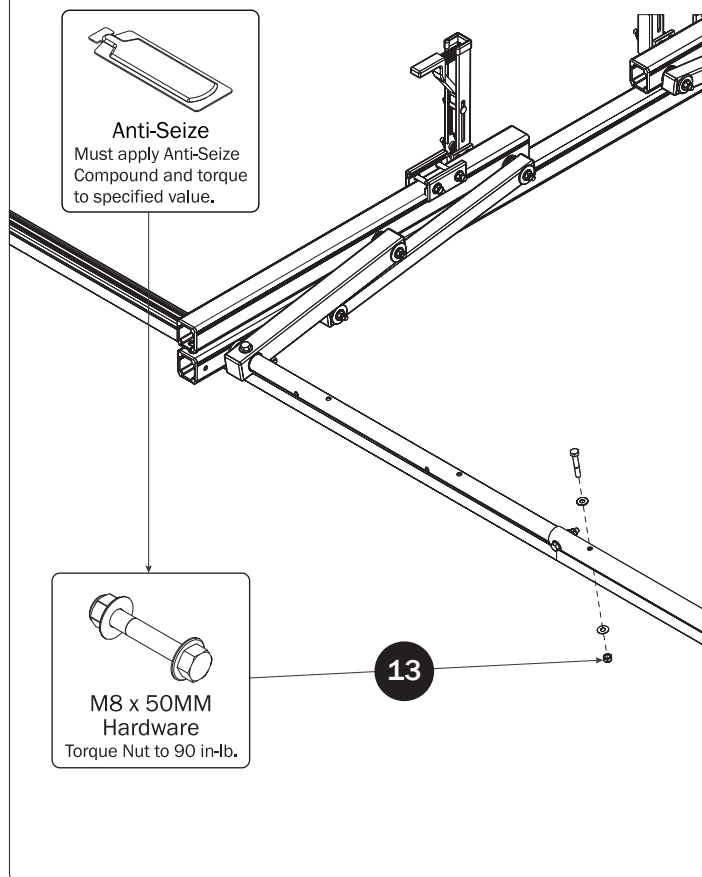
**CYLINDER HARDWARE****CONNECTING BAR****FRONT DRIVE SHAFT****CONNECTING BAR FASTENERS**

**L POSTS**

SEE QUICK START GUIDE FOR ADJUSTMENTS

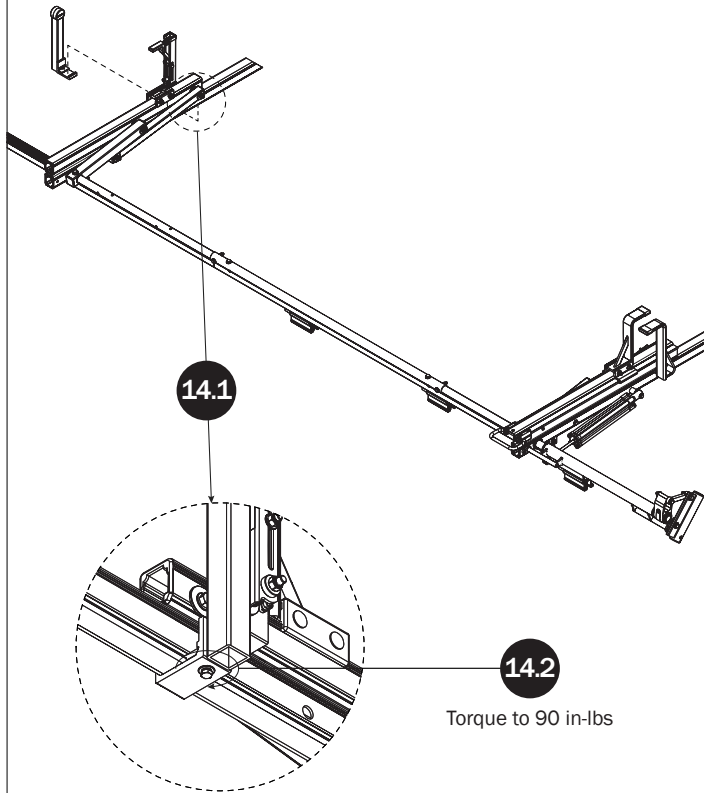
**Z POSTS**

SEE QUICK START GUIDE FOR ADJUSTMENTS

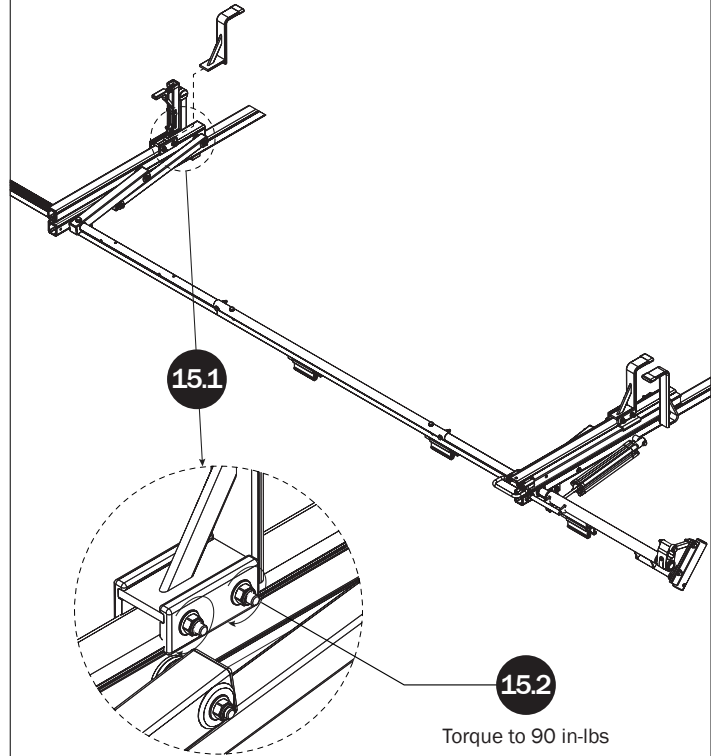
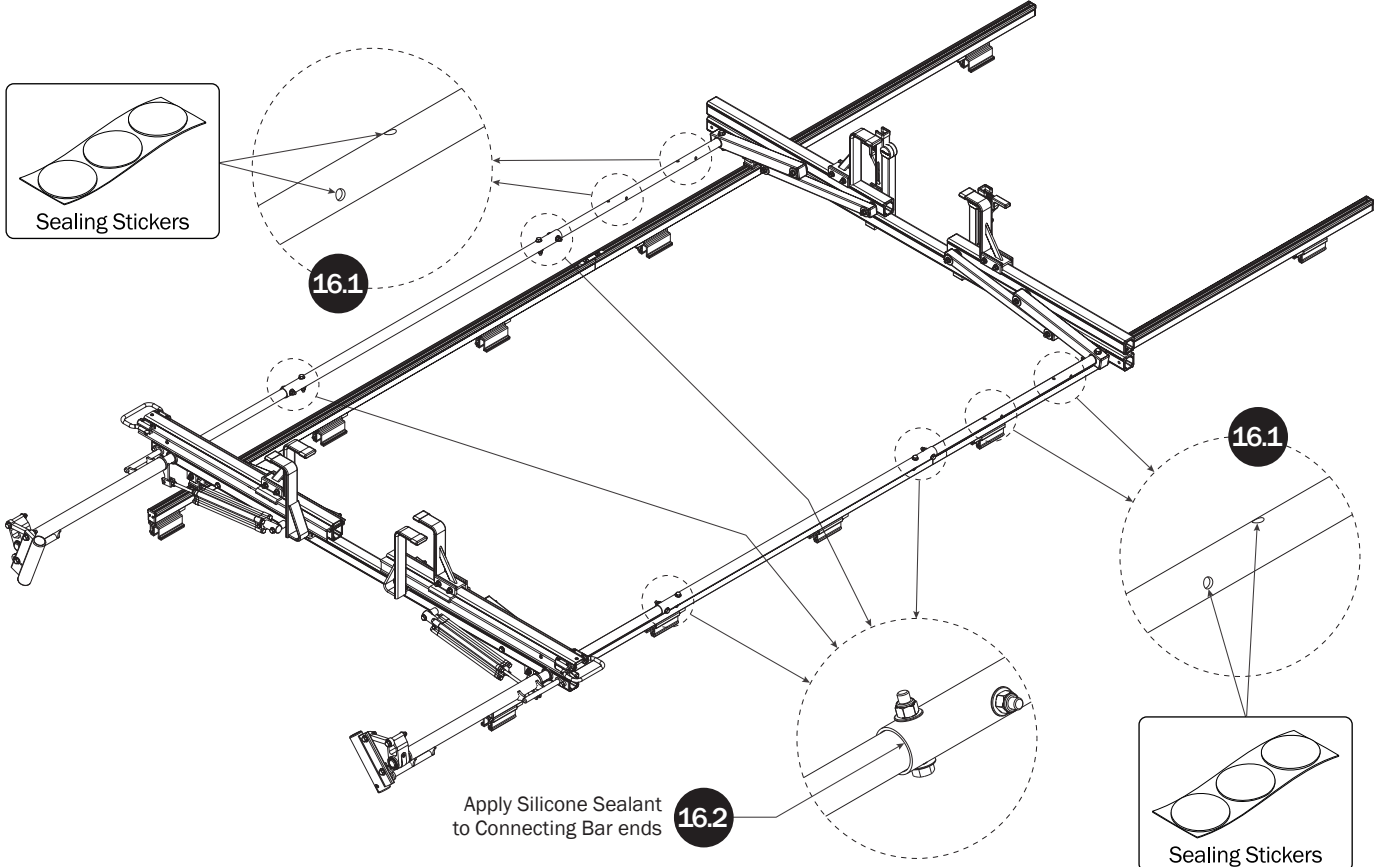
**DRIVE SHAFT SEALING**

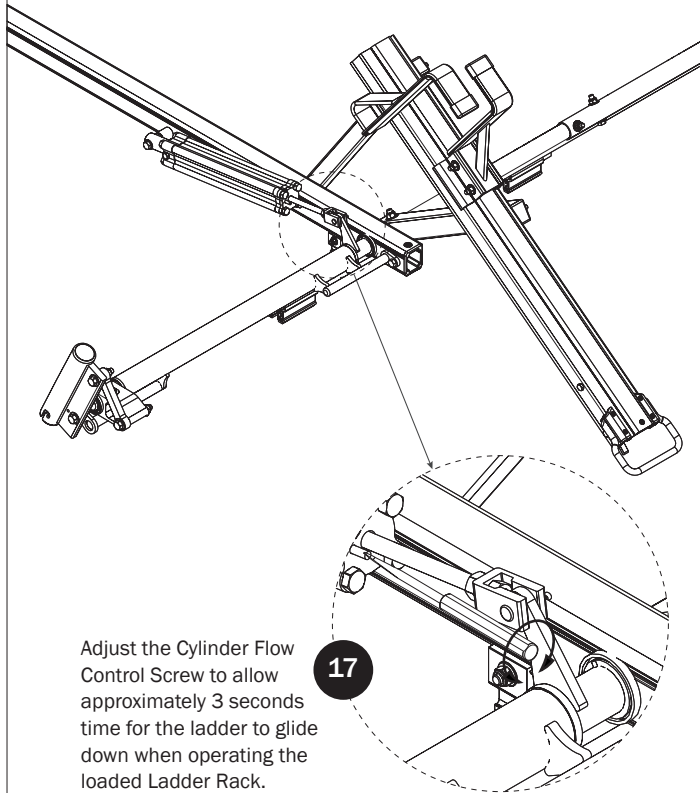
*CYLINDER ADJUSTMENT*

USAM-HRREPM52-US01 Rev-B 0218